

**GROUP 22 - WHEELS**

BEARINGS AND HARDWARE, FRONT B1-2-3, CB3, MB3, AD1, D1-2 3300-3600 LB. FRONT AXLE .....	Fig. 22-350
BEARINGS AND HARDWARE, FRONT CB, MB, B3, D2 HVY. DUTY, D3-4 4000 LB. FRONT AXLE .....	Fig. 22-400
BEARINGS AND HARDWARE, FRONT M3-4-5-6 .....	Fig. 22-450
BEARINGS AND HARDWARE, FRONT, AW, W1-2, RD2 (SPICER #44) 3500 LB. AXLE .....	Fig. 22-500
BEARINGS AND HARDWARE, FRONT, W2-3-4 (SPICER #60) 4500 LB. AXLE .....	Fig. 22-600
CAPS AND COVERS, WHEEL .....	Fig. 22-100
CARRIER, SPARE WHEEL AD-AW, D-W .....	Fig. 22-1100
CARRIER, SPARE WHEEL (OUTSIDE) AD-AW .....	Fig. 22-1000
CARRIER, SPARE WHEEL - B .....	Fig. 22-1400
CARRIER, UNDERSLUNG GLIDE-OUT D1-2-3, W1-2-3-4 .....	Fig. 22-1300
DRUMS AND HARDWARE, REAR A-D-W100, B100-200 10 X 2.5 - 11 X 2.5 BRAKES .....	Fig. 22-700
HUBS, DRUMS AND BEARINGS, REAR D2-3-4, W2-3-4, B3, CB-MB3, M3-4 12.12 X 2 - 12 X 2.5 - 12 X 3 BRAKES ...	Fig. 22-800
HUBS, DRUMS AND BEARINGS, REAR CB4 - MB4, W/13 X 3.5 BRAKES M 5-6, W/15 X 4 BRAKES .....	Fig. 22-900
TIRE-WHEEL CHART ALL LIGHT DUTY VEHICLES .....	Fig. 22-250
WHEELS AND HARDWARE LIGHT DUTY .....	Fig. 22-300

CAPS AND COVERS, WHEEL

8322 100C

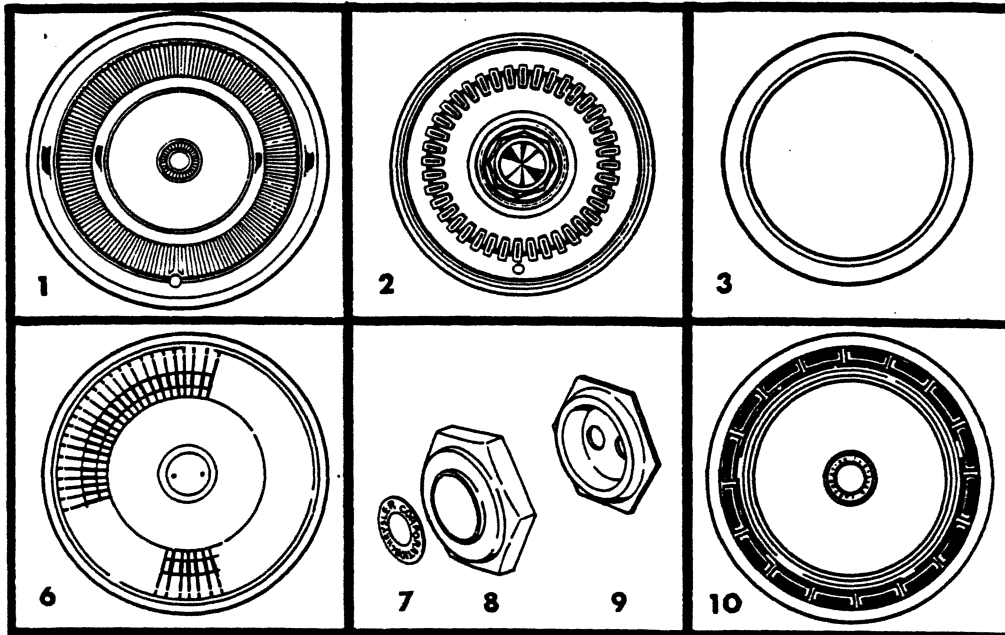

COVERS

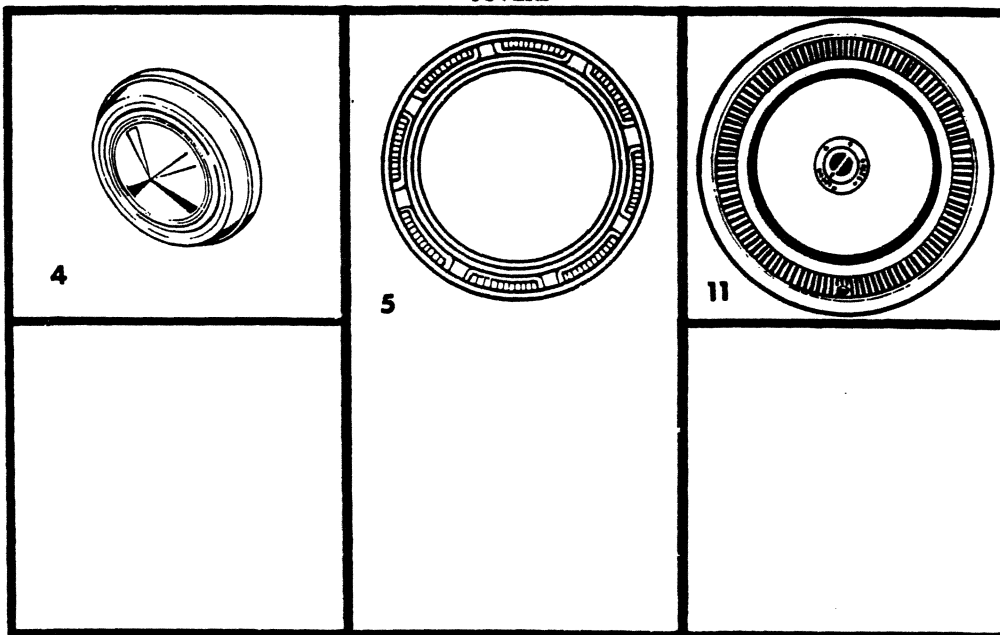

HUB CAPS

ITEM	PART NUMBER	QTY	MODEL	DESCRIPTION
<b>CAPS AND COVERS, WHEEL</b>				
<b>NOTE: Caps and Covers listed below for W200 Models can be used only on vehicles with 3500 lb. front axle.</b>				
1	4032 947	4	All	COVER ASSY., Wheel, 15", 1978 (Use Trim Rings 4026533)
2	3580 180	4	B1-2,A-D-W1	COVER ASSY., Wheel, 15", 1978
3	4026 533	4	All	RING, Trim, w/16.5 x 6.00 Wheel 1978-79-80-81
	4026 532	4	All	w/16.5 x 6.75 Wheel 1978-79-80-81
4				CAP, Hub, w/16" and 16.5" Wheels
	4032 548	4	B3,CB-MB3	Bright 1978-79-80-81
	4032 548	4	D-W2,RD2	Bright 1978-79-80-81
	4089 169	2	W2	FRT. w/Center Hole 1980-81,16.5" Bright
	4089 167	2	AW1,W1	Rear,Bright w/o Center Hole 1980-81 15"
	4089 168	2	AW1,W1	Frnt.,Bright w/Center Hole 1980-81,15"
	4036 782	4	B3,CB-MB3	Painted
	4036 782	4	D-W2,RD2	Painted
5				CAP, Hub, w/15" Wheels
	3461 450	4	B1-2,A-D-W1	Bright 1978-81
	3822 301	4	B1-2,A-D-W1	Painted
6	3699 496	4	B1-2,A-D-W1	COVER, Wheel, 15", u/w 15"x7" Wheel Only, 1979
7	3880 944	4	B1-2,A-D-W1	DECAL,Wheel Cover Cap (Chrysler Corporation)(Medallion)
	4126 519	4		DECAL,1979-80-81
8	3699 494	4	B1-2,A-D-W1	CAP, Wheel Cover Dome
	4164 032	4		1980-81
9	3766 051	4	B1-2,A-D-W1	DOME, Wheel Cover
<b>NOTE:--Use Items 6, 7, 8, 9 to Make Wheel Cover Assembly.</b>				
10	3880 961	4	B1-2-3,CB-MB	COVER ASSY., Wheel, 15", 1979 (Note:--Use Trim Rings, Ref. #3, for 16.5" Wheels)
	3880 961	4	D,W1-2,A,D3	
11	3880 960	AR		COVER,15" 1980 w/o Center Hole
	4126 516	4	A,D1-B1,2	15" Class-Plastic Deluxe 1980-81 Use w/4164032
	4089 170	2	W1,2-AW1	w/Center Hole 1980-81

<b>LIGHT</b>	A = All Sport Utility (Ramcharger).	B = All Compact Models.	D = Conventional Cab.
<b>DUTY</b>	AD = 2 Wheel Drive Only (Ramcharger).	CB-MB = Compact Front Section Only.	W = Conventional Cab 4 Wheel Drive.
<b>CODES:</b>	AW = 4 Wheel Drive Only (Ramcharger).	P = Forward Control Chassis.	M = Motor Home.

**MEDIUM-HEAVY CODES:** XNT = Low Cab Forward. D = Conventional Cab. S = School Bus. W = 4-Wheel Drive.

AR=Use as Required

# = New Part Number

Printed in U.S.A.

June, 1982

8322 250

**TIRE-WHEEL CHART  
ALL LIGHT DUTY VEHICLES**

**ILLUSTRATION**

**TO**

**FOLLOW**

ITEM	PART NUMBER	QTY	MODEL	DESCRIPTION
------	-------------	-----	-------	-------------

**TIRE-WHEEL CHART  
ALL LIGHT DUTY VEHICLES**

B/C	STUDS	WHEEL SIZE	TIRE SIZE
4.5	5	15 x 5.5	E78-15-B
4.5	5		ER78-15-B
4.5	5		F78-15-B
4.5	5		FR78-15-B
4.5	5		G78-15-B
4.5	5		GR78-15-B
4.5	5		G78-15-D
4.5	5		H78-15-B
4.5	5	15 x 6.5	HR78-15-B
4.5	5		HR70-15-B
4.5	5		L78-15-B
4.5	5		HZ8-15-B
4.5	5		L78-15-C
4.5	5		LR70-15-B
4.5	5		LR78-15-B
4.5	5		J78-15-B
4.5	5		LR78-15-C
4.5	5		7.00-15-C
4.5	5		7.00-15-D
4.5	5	15 x 7 (SPORT & DISC)	H70-15-B
4.5	5		H78-15-B
4.5	5		GR60-15
4.5	5		LR60-15-B
4.5	5		HR78-15-B
4.5	5	15 x 8 (SPORT & DISC)	H70-15-B
4.5	5		HR70-15-B
4.5	5		L78-15-B
4.5	5		LR60-15-B
4.5	5		LR70-15-B
4.5	5		LR78-15-B
4.5	5		10-15LT-B
4.5	5	16 x 5.00	6.50-16-C
6.5	8	16 x 5.50	7.00-16-C
6.5	8		7.50-16-C
6.5	8		7.50-16-D
6.5	8		7.50-16-E
6.5	8	16 x 6.00	7.50-16-E
	5	16 x 6.5 (EXPORT ONLY)	9.00-16-D
	5		9.00-16-E
6.5	8	16.5 x 6.00	8.00-16.5-C
6.5	8		8.00-16.5-D
6.5	8		8.00-16.5-E
6.5	8		8.00R-16.5-D
6.5	8		8.00R-16.5-E
6.5	8	16.5 x 6.75	8.75-16.5-E
6.5	8		8.75-16.5-F
6.5	8		8.75R-16.5-E
6.5	8		9.50-16.5-D

**LIGHT** A = All Sport Utility (Ramcharger). B = All Compact Models. D = Conventional Cab.  
**DUTY** AD = 2 Wheel Drive Only (Ramcharger). CB-MB = Compact Front Section Only. W = Conventional Cab 4 Wheel Drive.  
**CODES:** AW = 4 Wheel Drive Only (Ramcharger). P = Forward Control Chassis. M = Motor Home.

**MEDIUM-HEAVY CODES:** XNT = Low Cab Forward. D = Conventional Cab. S = School Bus. W = 4-Wheel Drive.

AR=Use as Required

# = New Part Number

Printed in U.S.A.

June, 1982

# 1978-81 LIGHT DUTY TRUCK PARTS CATALOG

WHEELS

ITEM	PART NUMBER	QTY	MODEL	DESCRIPTION
------	-------------	-----	-------	-------------

## TIRE-WHEEL CHART ALL LIGHT DUTY VEHICLES

6.5	8			9.50-16.5-E
6.5	8			9.50R-16.5-E
6.5	8	17.5 x 5.25		8.00-17.5-C
6.5	8			8.00-17.5-D
8.0	5	19.5 x 6.00		8.00-19.5-D
8.0	5			8.00-19.5-E
8.75	6			8.00R-19.5-E
8.75	6			8.00R-19.5-F

<b>LIGHT</b>	A = All Sport Utility (Ramcharger).	B = All Compact Models.	D = Conventional Cab.
<b>DUTY</b>	AD = 2 Wheel Drive Only (Ramcharger).	CB-MB = Compact Front Section Only.	W = Conventional Cab 4 Wheel Drive.
<b>CODES:</b>	AW = 4 Wheel Drive Only (Ramcharger).	P = Forward Control Chassis.	M = Motor Home.

---

**MEDIUM-HEAVY CODES:** XNT = Low Cab Forward. D = Conventional Cab. S = School Bus. W = 4-Wheel Drive.

AR=Use as Required      # =New Part Number      Printed in U.S.A.      June, 1982



WHEELS AND HARDWARE  
LIGHT DUTY

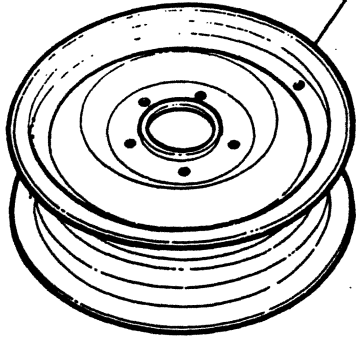

DISC TYPE

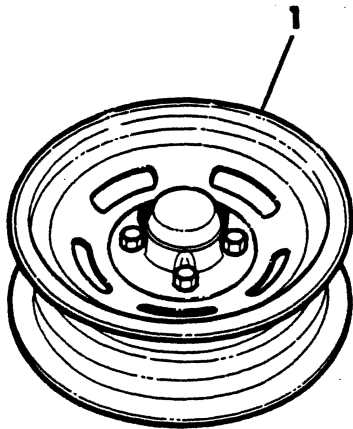
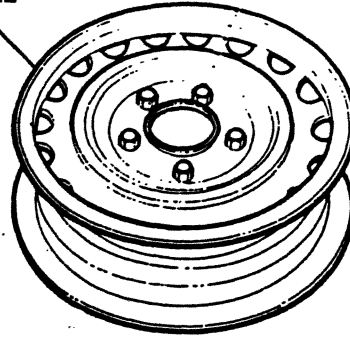

CHROME SLCT TYPE

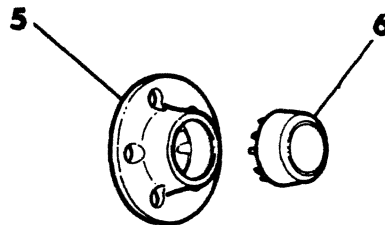
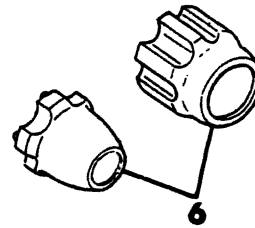
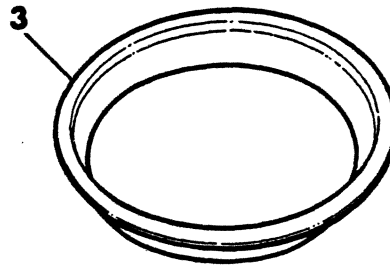

CHROME STYLED-ROAD TYPE

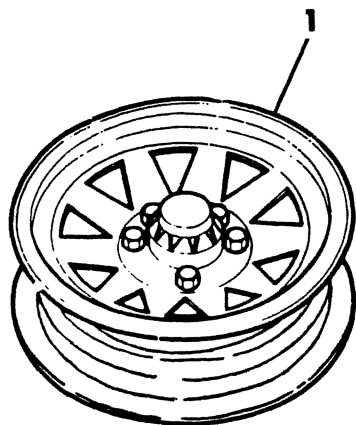

PAINTED SPOKE TYPE

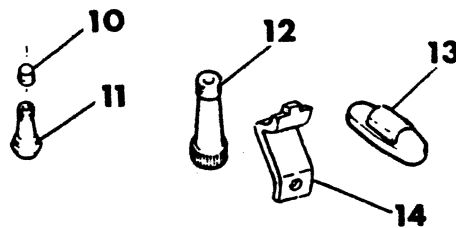

HARDWARE



ITEM	PART NUMBER	QTY	MODEL	DESCRIPTION
------	-------------	-----	-------	-------------

**WHEELS AND HARDWARE  
LIGHT DUTY**

WHEELS LISTED BY DIA.x WIDTH -- BOLT CIRCLE

ITEM	PART NUMBER	QTY	MODEL	DESCRIPTION
1				WHEELS,DISC
	4126 747			15 x 5.5, 4-1/2 B.C. .... 1978-79-80-81
	4126 760			15 x 6.5, 4-1/2 B.C. .... 1978-79-80-81
	3699 222			15 x 6.5, 4-1/2 B.C. .... 1978-79-80-81
	4238 045			15 x 6.5, 5-1/2 B.C. .... 1980-81
	3821 550			15 x 8, 4-1/2 B.C. .... 1978
	3736 952			16 x 5,4-1/2 B.C. .... 1978
	4117 054			15 x 7, 4-1/2 B.C. .... 1979-80-81
	4089 134			15 x 7, 5-1/2 B.C. .... 1980-81
	4238 043			15 x 7, 4-1/2 B.C. .... 1981
	4238 047			15 x 7, 5-1/2 B.C. .... 1981
	3640 280			16 x 5-1/2, SINGLE 6-1/2 B.C. .... 1978
	4112 029			16 x 6, DUAL 6-1/2 B.C. .... 1978
	4112 028			16 x 6, SINGLE 6-1/2 B.C. .... 1979-80-81
	4112 029			16 x 6, DUAL 6-1/2 B.C. .... 1979-80-81
	4026 537			16-1/2 x 6,SINGLE 6-1/2 B.C. .... 1978-79-80-81
	2909 277			16-1/2 x 6, DUAL 6-1/2 B.C. .... 1978-79-80-81
	4167 846			16.5 x 6-3/4,w/o Camper Pkg.,6-1/2 B.C. .... 1978-80-81
	4164 949			16.5 x 6-3/4, w/Camper Pkg. 6-1/2 B.C. .... 1978
	4167 846	AR		16.5 x 6.75, 6-1/2 B.C. .... 1979-80-81
	3733 583			17-1/2 x 5-1/4, 6-1/2 B.C. .... 1978-79-80-81
	3733 584			19-1/2 x 6, 8" B.C. .... 1979-80-81
	3898 980	AR		19-1/2 x 6, 8-3/4 B.C. .... 1979-80-81
				WHEELS,SPOKE
	4210 555			15 x 7, 5-1/2 B.C. Yellow .... 1980-81
	4238 181			15 x 7, 5-1/2 B.C. Orange .... 1981
	4036 088			15 x 7, 4-1/2 B.C. Painted .... 1978-79
	4238 010			15 x 7, 4-1/2 B.C.   1980
	4238 011			15 x 7, 5-1/2 B.C. Painted .... 1980
	4238 048			15 x 7, 4-1/2 B.C. Painted .... 1981
	4238 050			15 x 7, 5-1/2 B.C. Painted .... 1981
	4036 090			15 x 8, 4-1/2 B.C. .... 1978-79
				WHEEL,CHROME SLOTTED
	4036 089			15 x 7, 4-1/2 B.C. .... 1978-79
	4167 358			15 x 7, 4-1/2 B.C. .... 1980-81
	4116 466			15 x 7, 5-1/2 B.C. .... 1980
	4036 091			15 x 8, 4-1/2 B.C. .... 1979
	4036 089			15 x 7, Frt.,4-1/2 B.C. .... 1978
	4036 091			15 x 7, Rr.,4-1/2 B.C. .... 1978
				WHEEL,ALUMINUM
	4167 836			15 x 7, 4-1/2 B.C. Cap & Decal .... 1980-81
	4116 237			15 x 7, 5-1/2 B.C. .... 1980-81
2	3699 471	AR		WHEEL, 15", Styled 1978-79
3	3461 012	AR		RING, Trim, 15" Styled 1978-79
4	4115 216	AR		NUT, Chrome w/Steel Wheels
	6031 535	AR		NUT, Chrome w/Alum. Wheels
5	3699 011	AR		DOME, Styled
	6029 190	12		SCREW, Dome Mounting

<b>LIGHT DUTY</b>	A = All Sport Utility (Ramcharger).	B = All Compact Models.	D = Conventional Cab.
<b>CODES:</b>	AD = 2 Wheel Drive Only (Ramcharger).	CB-MB = Compact Front Section Only.	W = Conventional Cab 4 Wheel Drive.
	AW = 4 Wheel Drive Only (Ramcharger).	P = Forward Control Chassis.	M = Motor Home.

**MEDIUM-HEAVY CODES:** XNT = Low Cab Forward. D = Conventional Cab. S = School Bus. W = 4-Wheel Drive.  
AR=Use as Required # =New Part Number Printed in U.S.A. June, 1982

# 1978-81 LIGHT DUTY TRUCK PARTS CATALOG

WHEELS

ITEM	PART NUMBER	QTY	MODEL	DESCRIPTION
<b>WHEELS AND HARDWARE LIGHT DUTY</b>				
6	3580 360	AR		CAP, Dome, Styled
	4164 412	AR		Frt. Wheels w/Center Holes
	4164 411	AR		Rear Wheels w/o Center Holes
9	4036 092	AR		CAP, Center, Sport Chrome
	4213 324	AR		CAP, Center, Sport Chrome 1980-81
10	3496 888	AR		CAP, Valve Stem
11	2073 355	AR		STEM, Valve, w/15" Wheel
	3496 887	AR		w/16"-17" Wheel
12	3461 079	AR		EXTENSION, Valve Stem, w/15" Wheel
	4026 524	AR		w/16.5" Wheel
13	1615 349	AR		WEIGHT, Wheel Balance, 1/2 Ounce
	1615 350	AR		1 Ounce
	1615 351	AR		1-1/2 Ounce
	1615 352	AR		2 Ounce
	1615 353	AR		2-1/2 Ounce
	1615 354	AR		3 Ounce
14	4186 953	AR		CLIP, Hub Cap Retaining

\*NOTE:--For colors other than White, paint as required. On Warlock use Ditzler #2738, R&M #2849 or DuPont #43496. On MACHO with black wheels use passenger car code TX9 and TL1 for yellow stripe.

<b>LIGHT</b>	A = All Sport Utility (Ramcharger).	B = All Compact Models.	D = Conventional Cab.
<b>DUTY</b>	AD = 2 Wheel Drive Only (Ramcharger).	CB-MB = Compact Front Section Only.	W = Conventional Cab 4 Wheel Drive.
<b>CODES:</b>	AW = 4 Wheel Drive Only (Ramcharger).	P = Forward Control Chassis.	M = Motor Home.

**MEDIUM-HEAVY CODES:** XNT = Low Cab Forward. D = Conventional Cab. S = School Bus. W = 4-Wheel Drive.

AR=Use as Required

# =New Part Number

Printed in U.S.A.

June, 1982



BEARINGS AND HARDWARE, FRONT  
B1-2-3, CB3, MB3, AD1, D1-2  
3300-3600 LB. FRONT AXLE

8322 350

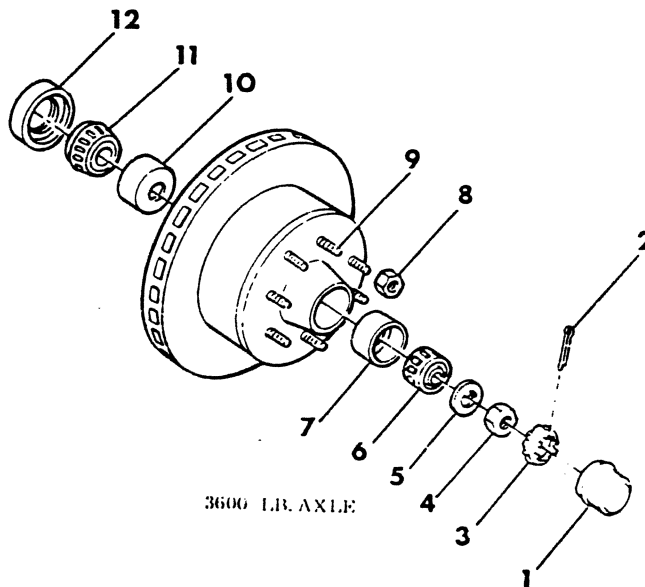
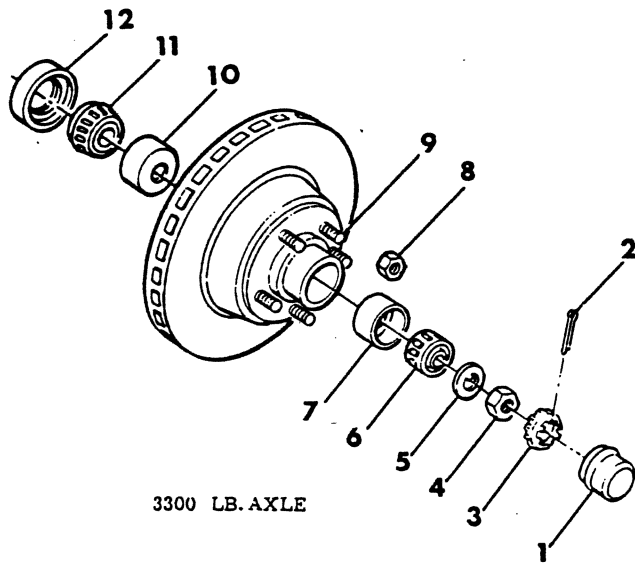

ITEM	PART NUMBER	QTY	MODEL	DESCRIPTION
<b>BEARINGS AND HARDWARE, FRONT</b>				
<b>B1-2-3, CB3, MB3, AD1, D1-2</b>				
<b>3300-3600 LB. FRONT AXLE</b>				
1	3580 894	2	All	CAP, Grease
2		2	All	PIN, Cotter (Not Serviced)
3	1873 324	2	All	LOCK, Adjusting Nut
4	6029 692	2	All	NUT, Adjusting
5	600 194	2	All	WASHER, Thrust
6	3580 888	2	All	CONE AND ROLLER, Outer
7	3683 974	2	All	CUP W/CONE AND ROLLER, Outer
8	2409 826	10	All	NUT, Wheel Stud, w/3300 lb. Front Axle, 1/2-20
	2909 542	16	All	w/3600 lb. Front Axle, 1/2-20
	4115 216	10	All	w/Styled Wheel, w/3300 lb. Front Axle, 1/2-20
9	3580 693	AR	All	STUD, Wheel, w/Kelsey Rotor
	3880 830	AR	All	w/Budd Rotor
10	3683 975	2	All	CUP W/CONE, ROLLER AND SEAL, Inner, w/3300 lb. Front Axle
	3580 893	2	All	CUP ONLY, w/3300 lb. Front Axle, 5 Stud Rotor
	3780 531	2	D2	w/3300 lb. Front Axle, 8 Stud Rotor, 1979-80-81
	3780 531	2	All	w/3600 lb. Front Axle
	4117 803	2	All	w/3500 lb. Front Axle
11	3580 892	2	All	CONE AND ROLLER, Inner, w/3300 lb. Front Axle, 5 Stud Rotor
	3699 676	2	D2	w/3300 lb. Front Axle, 8 Stud Rotor, 1979-80-81
	3699 676	2	All	w/3600 lb. Front Axle
12	3580 723	2	All	SEAL, Oil, w/3300 lb. Front Axle, 5 Stud Rotor
	3699 678	2	D2	w/3300 lb. Front Axle, 8 Stud Rotor, 1979-80-81
	3699 678	2	All	w/3600 lb. Front Axle

**LIGHT** A = All Sport Utility (Ramcharger).  
**DUTY** AD = 2 Wheel Drive Only (Ramcharger).  
**CODES:** AW = 4 Wheel Drive Only (Ramcharger).

B = All Compact Models.  
 CB-MB = Compact Front Section Only.  
 P = Forward Control Chassis.

D = Conventional Cab.  
 W = Conventional Cab 4 Wheel Drive.  
 M = Motor Home.

**MEDIUM-HEAVY CODES:** XNT = Low Cab Forward. D = Conventional Cab. S = School Bus. W = 4-Wheel Drive.

AR=Use as Required

# = New Part Number

Printed in U.S.A.

June, 1982

8322 400A

BEARINGS AND HARDWARE, FRONT  
CB, MB, B3, D2 HVY. DUTY, D3-4  
4000 LB. FRONT AXLE

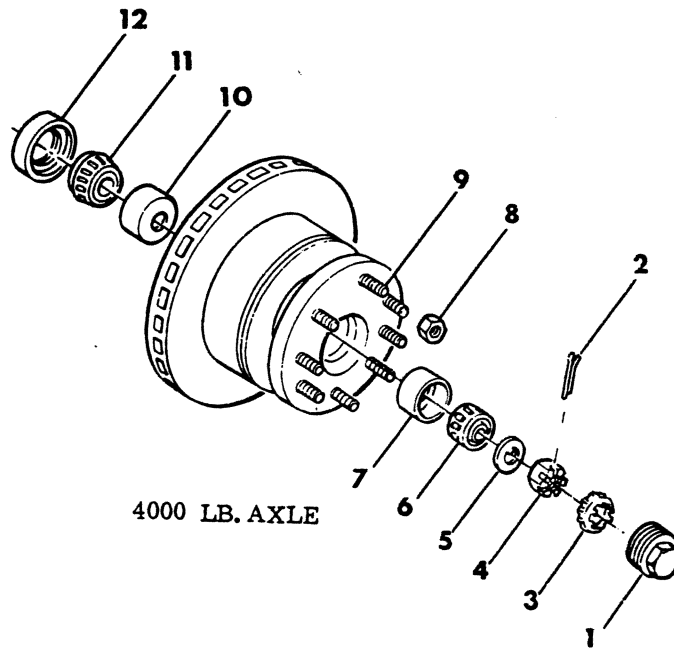

ITEM	PART NUMBER	QTY	MODEL	DESCRIPTION
<b>BEARINGS AND HARDWARE, FRONT CB, MB, B3, D2 HVY. DUTY, D3-4 4000 LB. FRONT AXLE</b>				
1	3634 741	2	All	CAP, Grease
2		2	All	PIN, Cotter (Not Serviced)
3	6029 986	2	All	LOCK, Adjusting Nut
4	6029 985	2	All	NUT, Adjusting
5	6029 984	2	All	WASHER, Thrust
6	1790 546	2	All	CONE AND ROLLER, Outer
7	1139 293	2	All	CUP, Bearing, Outer
8	1273 556	16	All	NUT, Wheel Stud, w/Single Rears, 5/8-18
	2909 542	16	D2,MB3,B3	w/Single Rears, 1/2-20
	3637 720	16	All	w/Duals Rears, 5/8-18
9				STUD, Wheel
	3641 662	16	D2,CB-MB3,B3	5/8", 1978
	3641 662	16	B3,D3	5/8", 1979-80-81
	4116 934	16	D2,MB3,B3	1/2", 1979-80-81
	3641 576	16	All	w/Dual Rear Wheels
10	1937 770	2	All	CUP, Bearing, Inner
11	1937 771	2	All	CONE AND ROLLER, Inner
12	3820 197	2	All	SEAL, Oil

<b>LIGHT</b>	A = All Sport Utility (Ramcharger).	B = All Compact Models.	D = Conventional Cab.
<b>DUTY</b>	AD = 2 Wheel Drive Only (Ramcharger).	CB-MB = Compact Front Section Only.	W = Conventional Cab 4 Wheel Drive.
<b>CODES:</b>	AW = 4 Wheel Drive Only (Ramcharger).	P = Forward Control Chassis.	M = Motor Home.
<b>MEDIUM-HEAVY CODES:</b> XNT = Low Cab Forward. D = Conventional Cab. S = School Bus. W = 4-Wheel Drive.			
AR=Use as Required	#=New Part Number	Printed in U.S.A.	June, 1982

## BEARINGS AND HARDWARE, FRONT

M3-4-5-6

8322 450

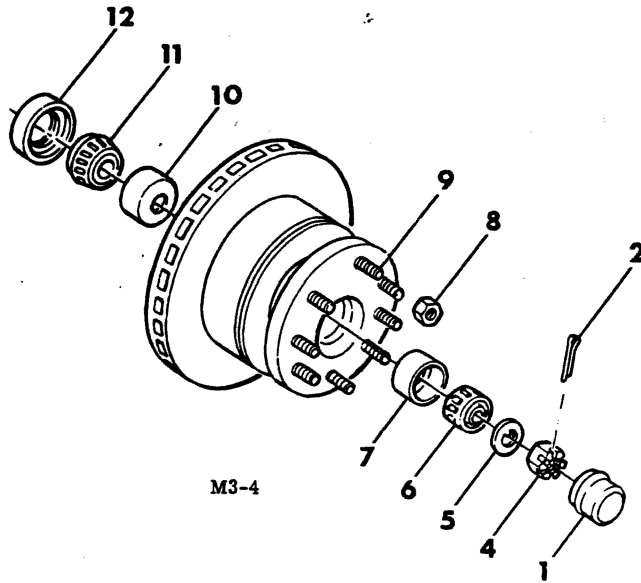

M3-4

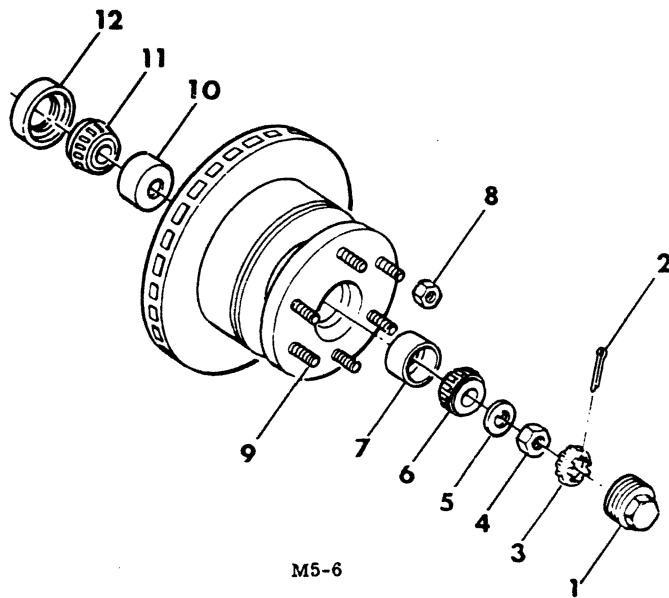

M5-6



ITEM	PART NUMBER	QTY	MODEL	DESCRIPTION
<b>BEARINGS AND HARDWARE, FRONT M3-4-5-6</b>				
1	3634 741	2	M3	CAP, Grease, 1978
	564 052	2	M3,4,5,6	1979-80-81
2		2	All	PIN, Cotter (Not Serviced)
3	6030 029	2	M6	LOCK, Adjusting Nut, 1978
	6030 029	2	M3-4-5-6	1979-80
4	1263 313	2	M3	NUT, Adjusting, 1978
	564 045	2	M4-5	1978
	6030 028	2	M6	1978
	6030 028	2	M3-4-5-6	1979-80
5	1262 540	2	M3	WASHER, Thrust, 1978
	564 046	2	M4-5	1978
	6030 027	2	M6	1978
	6030 027	2	M3-4-5-6	1979-80
6	1790 546	2	M3	CONE AND ROLLER, Outer, 1978
	1790 525	2	M3,4,5,6	1979-80-81
7	1139 293	2	M3	CUP, Bearing, Outer, 1978
	698 394	2	M3	1979-80-81
	698 394	2	M4-5-6	1979-80-81
8	3637 720	16	M3-4	NUT, Wheel Stud, 5/8-18
	585 192-3	6	M5-6	3/4-16
9	3641 576	16	M3	STUD, Wheel, 1978
	3640 138	16	M3-4	1979-80-81
	3640 124-5	5	M5-6	
10	1790 538	2	M3	CUP, Bearing, Inner, 1978
	698 403	2	M3	1979
	698 403	2	M4-5-6	
11	1790 541	2	M3	CONE AND ROLLER, Inner, 1978
	1790 523	2	M3,4,5,6	1979-80-81
12	3820 197	2	M3	SEAL, Oil, 1978
	3820 196	2	M3,4,5,6	1979-80-81

<b>LIGHT</b>	A = All Sport Utility (Ramcharger).	B = All Compact Models.	D = Conventional Cab.
<b>DUTY</b>	AD = 2 Wheel Drive Only (Ramcharger).	CB-MB = Compact Front Section Only.	W = Conventional Cab 4 Wheel Drive.
<b>CODES:</b>	AW = 4 Wheel Drive Only (Ramcharger).	P = Forward Control Chassis.	M = Motor Home.

**MEDIUM-HEAVY CODES:** XNT = Low Cab Forward. D = Conventional Cab. S = School Bus. W = 4-Wheel Drive.

AR=Use as Required

#=New Part Number

Printed in U.S.A.

June, 1982

BEARINGS AND HARDWARE, FRONT, AW, W1-2, RD2  
(SPICER #44) 3500 LB. AXLE

8322 500B

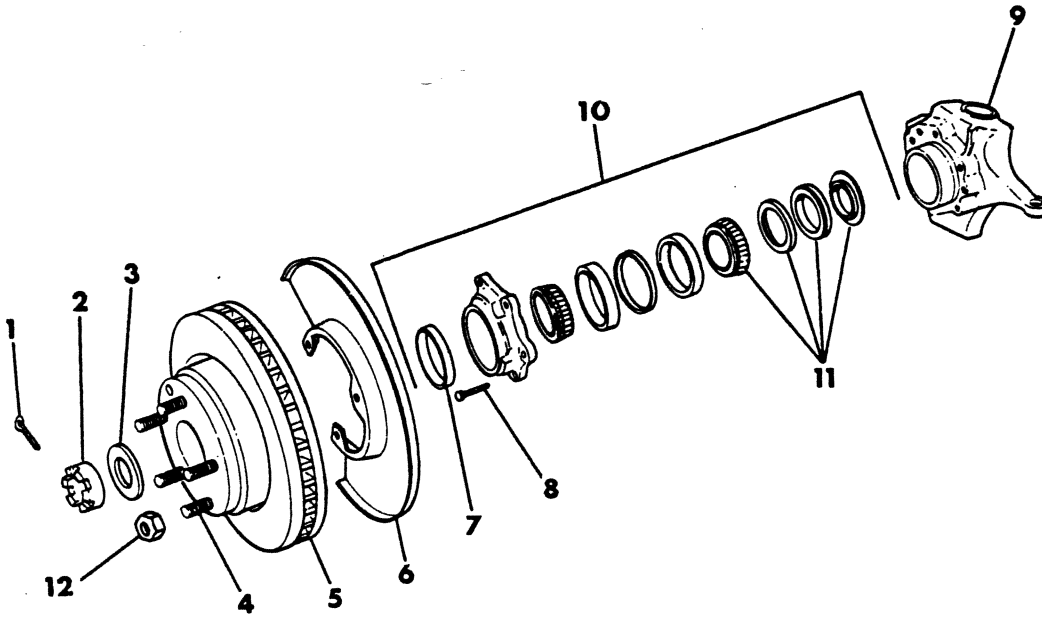

ITEM	PART NUMBER	QTY	MODEL	DESCRIPTION
<b>BEARINGS AND HARDWARE, FRONT, AW, W1-2, RD2 (SPICER #44) 3500 LB. AXLE</b>				
1		2		PIN, Cotter (Not Serviced)
2	3822 832	2		NUT, Lock
	4210 532			NUT,1980-81
	4210 534			LOCKNUT,1980-81
3	3822 833	2		WASHER, Lock
4	3736 751	10	AW,W1	STUD, Wheel
	4031 973	16	W2,RD2	
	4219 119	16	W2,RD2	1981
	4219 119	10		w/Locking Hubs
5		2		HUB AND ROTOR (Refer to Group 5)
6		2		SHIELD (Refer to Group 5)
7	3822 829	2		SEAL, Bearing Outer <i>CR# 26153</i>
8	3828 623	12		BOLT
9		2		KNUCKLE (Refer to Group 2)
10	4036 428	2		RETAINER, BEARING AND SEAL KIT
				Consists of:
				4036429 Ret. and Seal
				4036430 Cup
				4036431 Slinger
				4036432 Wiper
				4036433 Bearing
11	4089 276	2	AW-W	KIT, Bearing and Seal
12	2409 826	10	AW-W1	NUT, Wheel Stud, 1/2-20
	2909 542	16	W2	1/2-20
	4115 216	10	AW-W1	w/Styled Wheel, 1/2-20
	4117 803	2	AW-W1	CUP,Inner w/Locking Hubs
	2852 729	2	AW-W1	CONE,Inner w/Locking Hubs
	1937 770	2	AW-W1	CUP,Outer w/Locking Hubs
	1937 771	2	AW-W1	CONE,Outer w/Locking Hubs
	4210 952	2	AW-W1	SEAL,Inner Brg.w/Locking Hubs
	4210 533	2	AW-W1	NUT & PIN,Frt.Whl.Brg.

<b>LIGHT</b>	A = All Sport Utility (Ramcharger).	B = All Compact Models.	D = Conventional Cab.
<b>DUTY</b>	AD = 2 Wheel Drive Only (Ramcharger).	CB-MB = Compact Front Section Only.	W = Conventional Cab 4 Wheel Drive.
<b>CODES:</b>	AW = 4 Wheel Drive Only (Ramcharger).	P = Forward Control Chassis.	M = Motor Home.

**MEDIUM-HEAVY CODES:** XNT = Low Cab Forward. D = Conventional Cab. S = School Bus. W = 4-Wheel Drive.

AR=Use as Required

# =New Part Number

Printed in U.S.A.

June, 1982

## BEARINGS AND HARDWARE, FRONT, W2-3-4 (SPICER #60) 4500 LB. AXLE

8322 600A

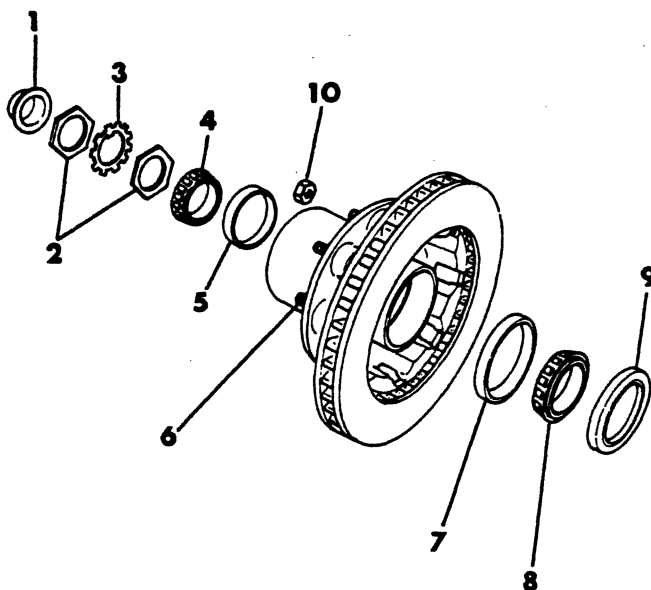

ITEM	PART NUMBER	QTY	MODEL	DESCRIPTION
<b>BEARINGS AND HARDWARE, FRONT, W2-3-4 (SPICER #60) 4500 LB. AXLE</b>				
1	2953 959	2		CAP, Grease
2	2909 258	4		NUT, Lock
3	2909 259	2		WASHER, Lock
4	2852 729	2		BEARING, Outer
5	2955 374	2		CUP, Outer
6	4030 779	16	W2	STUD, Wheel
	2515 316	16	W3	w/Single Rear Wheels
	3641 576	16	W3-4	w/Dual Rear Wheels
7	568 500	2		CUP, Inner
8	1799 296	2		BEARING, Inner
9	3821 519	2		SEAL, Wheel
10	2909 542	16	W2	NUT, Wheel Stud, 1/2-20
	1273 556	16	W3	w/Single Rear Wheels, 5/8-18
	3637 720	16	W3-4	w/Dual Rear Wheels, 5/8-18
	4086 641			KIT, Frt. Whl. Brg. & Seal

<b>LIGHT</b>	A = All Sport Utility (Ramcharger).	B = All Compact Models.	D = Conventional Cab.
<b>DUTY</b>	AD = 2 Wheel Drive Only (Ramcharger).	CB-MB = Compact Front Section Only.	W = Conventional Cab 4 Wheel Drive.
<b>CODES:</b>	AW = 4 Wheel Drive Only (Ramcharger).	P = Forward Control Chassis.	M = Motor Home.

**MEDIUM-HEAVY CODES:** XNT = Low Cab Forward. D = Conventional Cab. S = School Bus. W = 4-Wheel Drive.

AR=Use as Required

# =New Part Number

Printed in U.S.A.

June, 1982

DRUMS AND HARDWARE, REAR  
A-D-W100, B100-200  
10 X 2.5 - 11 X 2.5 BRAKES

8322 700

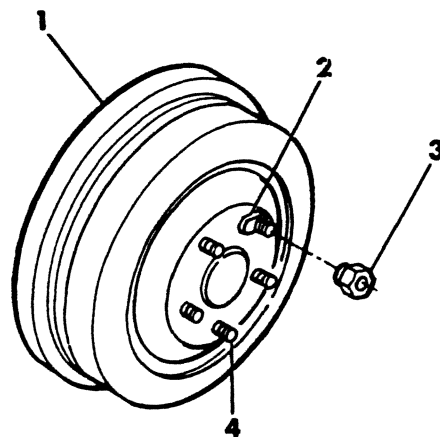

ITEM	PART NUMBER	QTY	MODEL	DESCRIPTION
------	-------------	-----	-------	-------------

**DRUMS AND HARDWARE, REAR  
A-D-W100, B100-200  
10 X 2.5 - 11 X 2.5 BRAKES**

1	4049 661	2		DRUM, Brake, w/10x2.5 Brakes
	4267 347	2	A-W1	1980-81
	4176 771	2	B1,2-AD,D1	1980-81
	3780 537	2		w/11x2.5 Brakes
2	6026 430	6		RETAINER, Brake Drum to Axle Shaft
3	2409 826	10		NUT, Wheel Stud, w/o Styled Wheel, 1/2-20
	4115 216	10		w/Styled Wheel, 1/2-20
4	3432 698	10		STUD, Wheel

NOTE:--Refer to Group 3 for Bearings, Cups, Seals, etc.

<b>LIGHT</b>	A = All Sport Utility (Ramcharger).	B = All Compact Models.	D = Conventional Cab.
<b>DUTY</b>	AD = 2 Wheel Drive Only (Ramcharger).	CB-MB = Compact Front Section Only.	W = Conventional Cab 4 Wheel Drive.
<b>CODES:</b>	AW = 4 Wheel Drive Only (Ramcharger).	P = Forward Control Chassis.	M = Motor Home.
<b>MEDIUM-HEAVY CODES:</b> XNT = Low Cab Forward. D = Conventional Cab. S = School Bus. W = 4-Wheel Drive.			

AR=Use as Required

# =New Part Number

Printed in U.S.A.

June, 1982

8322 800C

### HUBS, DRUMS AND BEARINGS, REAR D2-3-4, W2-3-4, B3, CB-MB3, M3-4 12.12 X 2 - 12 X 2.5 - 12 X 3 BRAKES

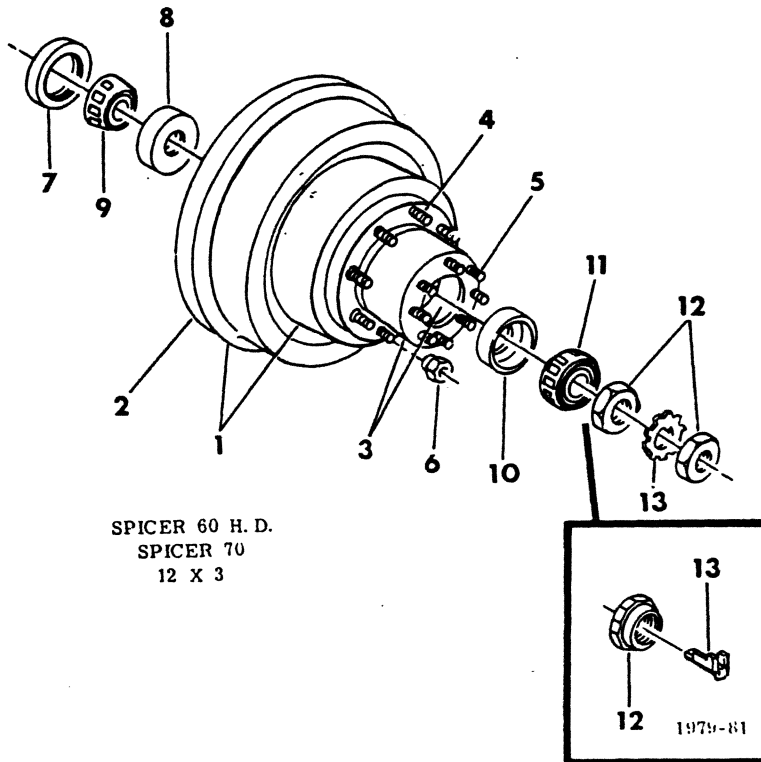
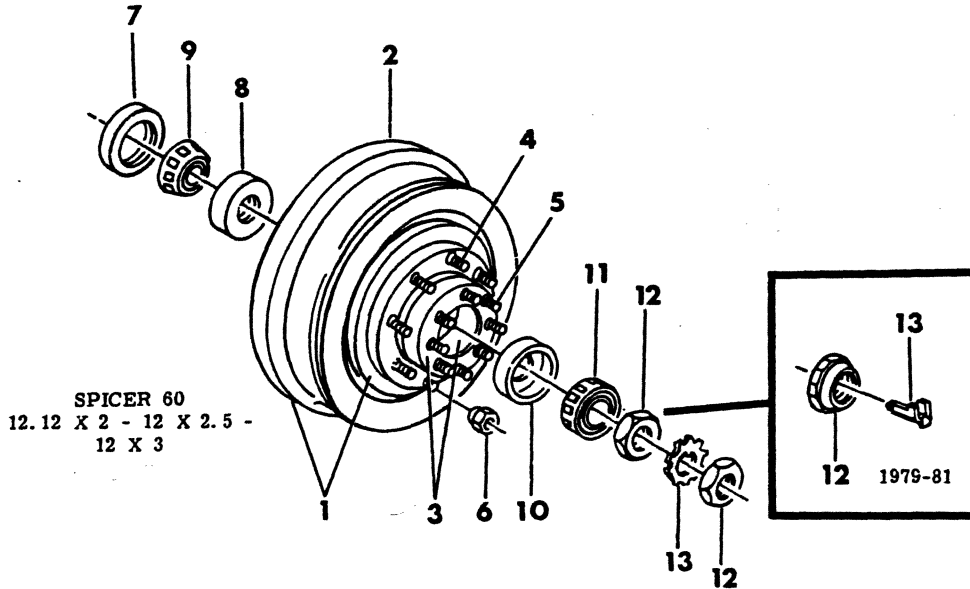



WHEELS

1978-81 LIGHT DUTY TRUCK PARTS CATALOG

ITEM	PART NUMBER	QTY	MODEL	DESCRIPTION
<b>HUBS, DRUMS AND BEARINGS, REAR</b>				
<b>D2-3-4, W2-3-4, B3, CB-MB3, M3-4</b>				
<b>12.12 X 2 - 12 X 2.5 - 12 X 3 BRAKES</b>				
1	<b>HUB AND DRUM, Brake</b>			
	4049 680	2	All	w/12.12x2 Brakes
	4032 856	2	All	w/12x2.5 & 12x3 Brks.Stamped 95961 up to 2-1-81
	4131 287	2	All	after 2-1-81
	3496 560	2	All	w/12x3 Brakes, Single Wheels
	3637 776	2	All	w/12x3 Brakes, Dual Wheels
	4037 687	2	B3	w/12x3 Brakes, w/9000 lb. GVW
2	<b>DRUM, Brake</b>			
	2516 423	2	All	w/12.12x2 Brakes, Motor Wheel
	2953 719	2	All	w/12.12x2 Brakes, Budd
	3491 675	2	All	w/12x2.5 Brakes, up to 2-1-81
	4238 193	2	All	after 2-1-81
	3496 563	2	All	w/12x3 Brakes, Except 9000 lb. GVW
	4112 626	2	B3	w/12x3 Brakes, w/9000 lb. GVW
	<b>SLINGER, Grease</b>			
	3496 566	2	All	w/12x3 Brakes, Single Wheels
	2952 194	2	All	w/12x3 Brakes, Dual Wheels
3	<b>HUB AND CUP, Brake Drum</b>			
	4036 930	2	All	w/12.12x2 and 12x2.5 Brakes
	3496 574	2	All	w/12x3 Brakes, Single Wheels
4	<b>STUD, Wheel</b>			
	2952 858	AR	All	w/12.12x2 Brakes, Motor Wheel
	2910 132	AR	All	w/12.12x2 Brakes, Budd
	2955 940	AR	All	w/12x2.5 Brakes
	3496 564	AR	All	w/12x3 Brakes, Single Wheels
	3637 878	AR	All	w/12x3 Brakes, Dual Wheels
5	<b>STUD, Axle Driveshaft (Refer to Group 3)</b>			
6	<b>NUT, Wheel Stud</b>			
	2909 542	AR	All	w/12.12x2 and 12x2.5 Brakes, 1/2-20
	1273 556	AR	All	w/12x3 Brakes, Single Wheels, 5/8-18
	3637 720	AR	All	w/12x3 Brakes, Dual Wheels, 5/8-18
7	<b>SEAL, Wheel Oil</b>			
	4032 450	2	All	w/12.12x2 and 12x2.5 Brakes
	2954 738	2	All	w/12x3 Brakes, Except 9000 lb. GVW
	3496 557	2	B3	w/12x3 Brakes, w/9000 lb. GVW
8	<b>CUP, Wheel Bearing, Inner</b>			
	2955 374	2	All	w/12.12x2 and 12x2.5 Brakes
	2910 218	2	All	w/12x3 Brakes, Except 9000 lb. GVW
	927 015	2	B3,D2,3	w/12x3 Brakes, w/9000 lb. GVW
9	<b>CONE AND ROLLER, Wheel, Inner</b>			
	2852 729	2	All	w/12.12x2 and 12x2.5 Brakes
	2959 942	2	All	w/12x3 Brakes, Except 9000 lb. GVW
	927 017	2	B3,D2,3	w/12x3 Brakes, w/9000 lb. GVW
10	2955 374	2	All	CUP, Wheel Bearing, Outer
11	2852 729	2	All	CONE, Wheel Bearing, Outer
12	2909 258	4	All	NUT, Bearing Adjusting, 1978
	2909 258	4	B-D-W-M	1979, Up to Approx. 1-8-79
	4116 600	2	B-D-W-M	After Approx. 1-8-79 1979-80
	4116 600	2	CB-MB	1979-80-81

<b>LIGHT</b>	A = All Sport Utility (Ramcharger).	B = All Compact Models.	D = Conventional Cab.
<b>DUTY</b>	AD = 2 Wheel Drive Only (Ramcharger).	CB-MB = Compact Front Section Only.	W = Conventional Cab 4 Wheel Drive.
<b>CODES:</b>	AW = 4 Wheel Drive Only (Ramcharger).	P = Forward Control Chassis.	M = Motor Home.

**MEDIUM-HEAVY CODES:** XNT = Low Cab Forward. D = Conventional Cab. S = School Bus. W = 4-Wheel Drive.

AR=Use as Required

# =New Part Number

Printed in U.S.A.

June, 1982

# 1978-81 LIGHT DUTY TRUCK PARTS CATALOG

WHEELS

ITEM	PART NUMBER	QTY	MODEL	DESCRIPTION
<b>HUBS, DRUMS AND BEARINGS, REAR</b>				
<b>D2-3-4, W2-3-4, B3, CB-MB3, M3-4</b>				
<b>12.12 X 2 - 12 X 2.5 - 12 X 3 BRAKES</b>				
13	2909 259	2	All	LOCK, Bearing Adjusting Nut, 1978
	2909 259	2	B-D-W-M	1979, Up to Approx. 1-8-79
	4116 576	2	B-D-W-M	After Approx. 1-8-79 1979-80
	4116 576	2	CB-MB	1979-80-81

<b>LIGHT</b>	A = All Sport Utility (Ramcharger).	B = All Compact Models.	D = Conventional Cab.
<b>DUTY</b>	AD = 2 Wheel Drive Only (Ramcharger).	CB-MB = Compact Front Section Only.	W = Conventional Cab 4 Wheel Drive.
<b>CODES:</b>	AW = 4 Wheel Drive Only (Ramcharger).	P = Forward Control Chassis.	M = Motor Home.

**MEDIUM-HEAVY CODES:** XNT = Low Cab Forward. D = Conventional Cab. S = School Bus. W = 4-Wheel Drive.

AR=Use as Required

# = New Part Number

Printed in U.S.A.

June, 1982



HUBS, DRUMS AND BEARINGS, REAR  
CB4 - MB4, W/13 X 3.5 BRAKES  
M 5-6, W/15 X 4 BRAKES

8322 900C

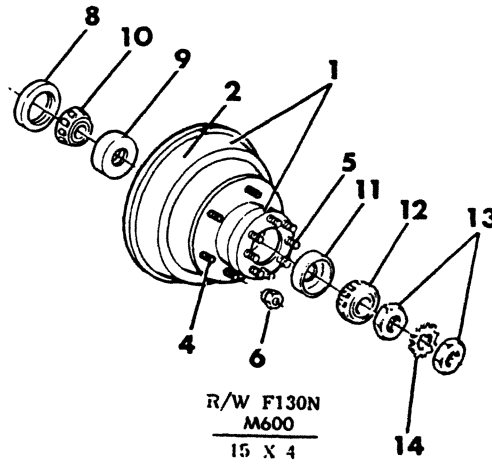
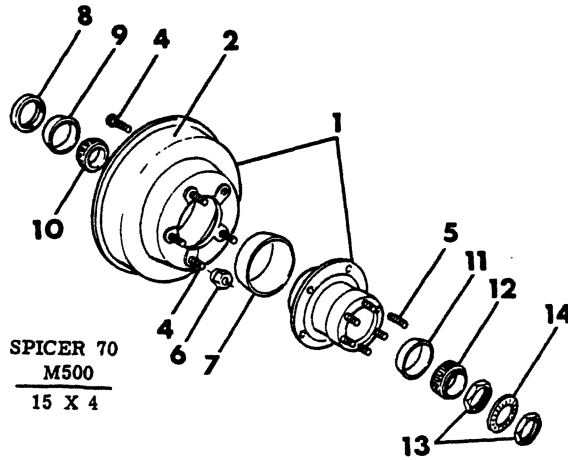
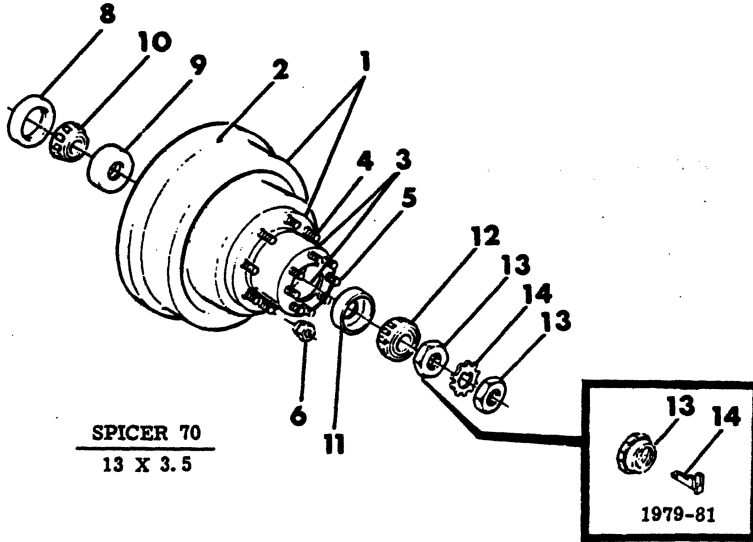

ITEM	PART NUMBER	QTY	MODEL	DESCRIPTION
<b>HUBS, DRUMS AND BEARINGS, REAR</b>				
<b>CB4 - MB4, W/13 X 3.5 BRAKES</b>				
<b>M 5-6, W/15 X 4 BRAKES</b>				
1				HUB AND DRUM, Brake
	4037 546	2	CB-MB	w/13x3.5 Brakes
	3640 046-7	1	M5	w/15x4 Brakes
	1788 130-1	1	M6	w/15x4 Brakes
2	4089 100	2	CB-MB	DRUM, Brake, w/13x3.5 Brakes
	3821 456	2	M5	w/15x4 Brakes
	1788 125	2	M6	w/15x4 Brakes, w/Slinger
3	4089 177	2	CB-MB	HUB AND CUP, Brake, w/13x3.5 Brakes
4	3637 878	16	CB-MB	STUD, Wheel, w/13x3.5 Brakes
	2907 740-1	5	M5	w/15x4 Brakes
	532 062-3	6	M6	w/15x4 Brakes
5		AR		STUD, Axle Flange (Refer to Group 3)
6	3637 720	16	CB-MB	NUT, Wheel Stud, w/13x3.5 Brakes, 5/8-18
	427 363	12	M6	w/15x4 Brakes, Inside of Drum
	503 551	AR	M5-6	w/15x4 Brakes, Cap, Inner, Right, 13/16
	503 550	AR	M5-6	w/15x4 Brakes, Cap, Inner, Left, 13/16
	585 194-5	AR	M5-6	w/15x4 Brakes, Cap, Outer, 1 1/8-18
7	2952 194	2	CB-MB	SLINGER, Brake Drum, w/13x3.5 Brakes
	3640 049	2	M5	w/15x4 Brakes
8	2954 738	2	CB-MB	SEAL, Wheel Oil, w/13x3.5 Brakes
	2914 518	2	M5	w/15x4 Brakes
	3879 241	2	M6	w/15x4 Brakes
9				CUP, Wheel Bearing, Inner
	2910 218	2	CB-MB	w/13x3.5 Brakes
	1662 783	2	M5	w/15x4 Brakes
	1662 784	2	M6	w/15x4 Brakes
10				CONE AND ROLLER, Inner
	2959 942	2	CB-MB	w/13x3.5 Brakes
	1662 785	2	M5	w/15x4 Brakes
	1796 948	2	M6	w/15x4 Brakes
11				CUP, Wheel Bearing, Outer
	2955 374	2	CB-MB	w/13x3.5 Brakes
	2955 182	2	M5	w/15x4 Brakes
	1662 783	2	M6	w/15x4 Brakes
12				CONE AND ROLLER, Outer
	2852 729	2	CB-MB	w/13x3.5 Brakes
	2955 183	2	M5	w/15x4 Brakes
	1662 785	2	M6	w/15x4 Brakes
13				NUT, Wheel Bearing Adjusting
	2909 258	4	CB-MB	w/13x3.5 Brakes, 1978
	4116 600	4	CB-MB	w/13x3.5 Brakes, 1979-80-81
	2914 494	2	M5	w/15x4 Brakes, Inner, w/Pin
	2914 496	2	M5	w/15x4 Brakes, Outer
	4032 401	4	M6	w/15x4 Brakes
14				LOCK, Wheel Bearing Adjusting Nut
	2909 259	2	CB-MB	w/13x3.5 Brakes, 1978
	4116 576	2	CB-MB	w/13x3.5 Brakes, 1979-80-81
	2914 497	2	M5	w/15x4 Brakes
	2229 883	2	M6	w/15x4 Brakes

LIGHT A = All Sport Utility (Ramcharger).

B = All Compact Models.

D = Conventional Cab.

DUTY AD = 2 Wheel Drive Only (Ramcharger).

CB-MB = Compact Front Section Only.

W = Conventional Cab 4 Wheel Drive.

CODES: AW = 4 Wheel Drive Only (Ramcharger).

P = Forward Control Chassis.

M = Motor Home.

MEDIUM-HEAVY CODES: XNT = Low Cab Forward. D = Conventional Cab. S = School Bus. W = 4-Wheel Drive.

AR=Use as Required

# =New Part Number

Printed in U.S.A.

June, 1982

CARRIER, SPARE WHEEL (OUTSIDE)  
AD-AW

8322 1000

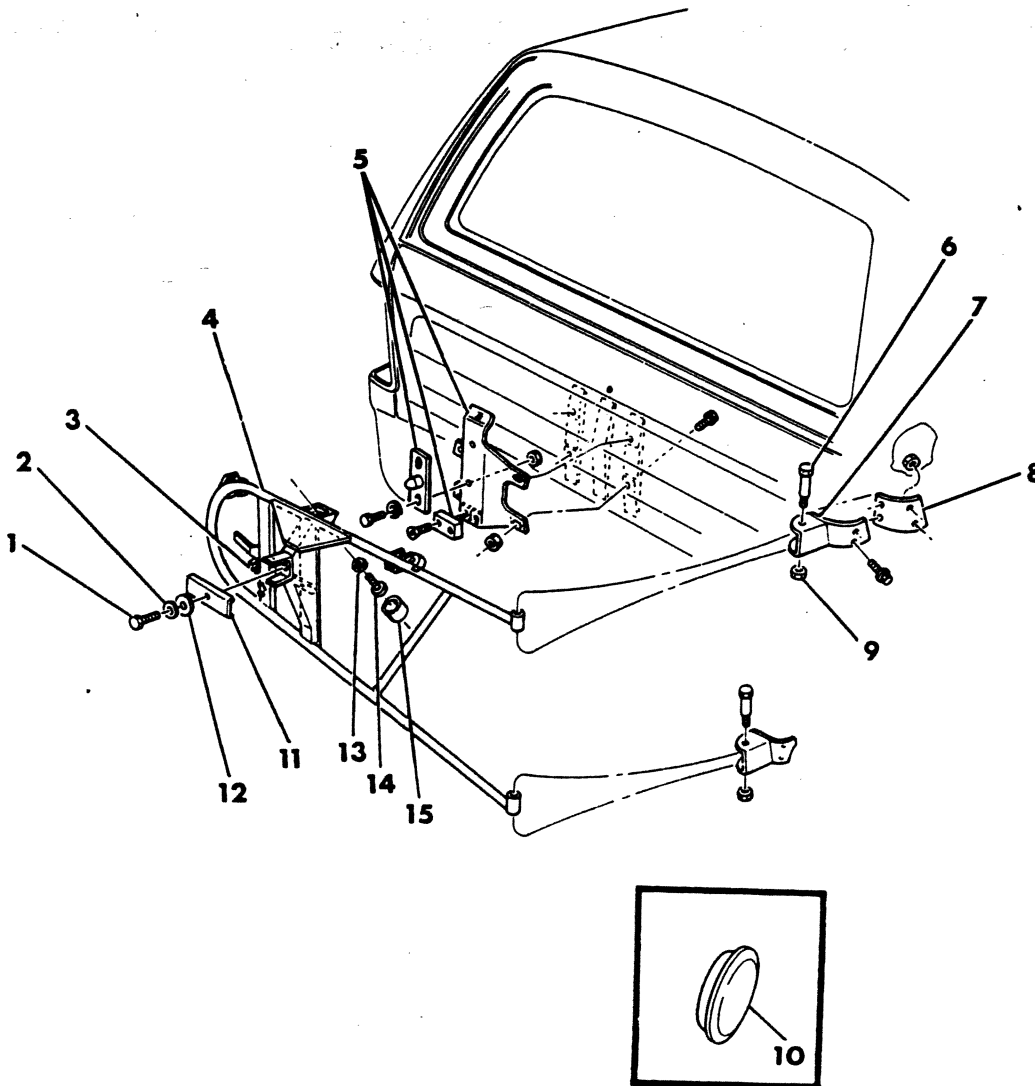

ITEM	PART NUMBER	QTY	MODEL	DESCRIPTION
<b>CARRIER, SPARE WHEEL (OUTSIDE) AD-AW</b>				
1	6030 828	1		BOLT
2	3633 162	1		NUT
3	3829 743	1		SPRING
4	3899 295	1		SUPPORT ASSEMBLY, Spare Tire, Up to 3-1-78
	4113 032	1		After 3-1-78 1979-80
5	3899 302	1		BRACKET ASSEMBLY, Spare Tire Carrier
6	6030 826	1		BOLT, Upper
	6030 825	1		Lower
7	3829 767	1		HINGE, Upper, Up to 3-1-78
	4113 157	1		After 3-1-78 1979-80
	3829 768	1		Lower, Up to 3-1-78
	4113 159	1		Lower, After 3-1-78 1979-80
8	3829 741	1		REINFORCEMENT, Upper, Up to 3-1-78
	4113 030	1		After 3-1-78 1979-80
	3829 742	1		Lower, Up to 3-1-78
	4113 031	1		Lower, After 3-1-78 1979-80
9	152 366	AR		NUT
10	1882 735	AR		PLUG, 1"
11	3498 235	1		BAR
12	3893 708	1		INSERT
13	6023 531	1		SCREW, 5/16-18 x 1.50
14	118 614	1		JAM NUT
15	3788 362	1		BUMPER

<b>LIGHT</b>	A = All Sport Utility (Ramcharger).	B = All Compact Models.	D = Conventional Cab.
<b>DUTY</b>	AD = 2 Wheel Drive Only (Ramcharger).	CB-MB = Compact Front Section Only.	W = Conventional Cab 4 Wheel Drive.
<b>CODES:</b>	AW = 4 Wheel Drive Only (Ramcharger).	P = Forward Control Chassis.	M = Motor Home.

**MEDIUM-HEAVY CODES:** XNT = Low Cab Forward. D = Conventional Cab. S = School Bus. W = 4-Wheel Drive.

AR=Use as Required

# = New Part Number

Printed in U.S.A.

June, 1982

## CARRIER, SPARE WHEEL AD-AW, D-W

8322 1100

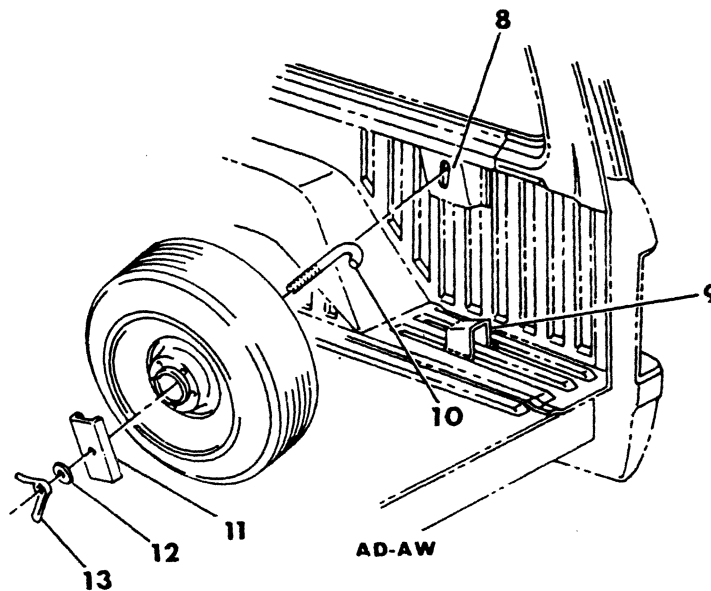
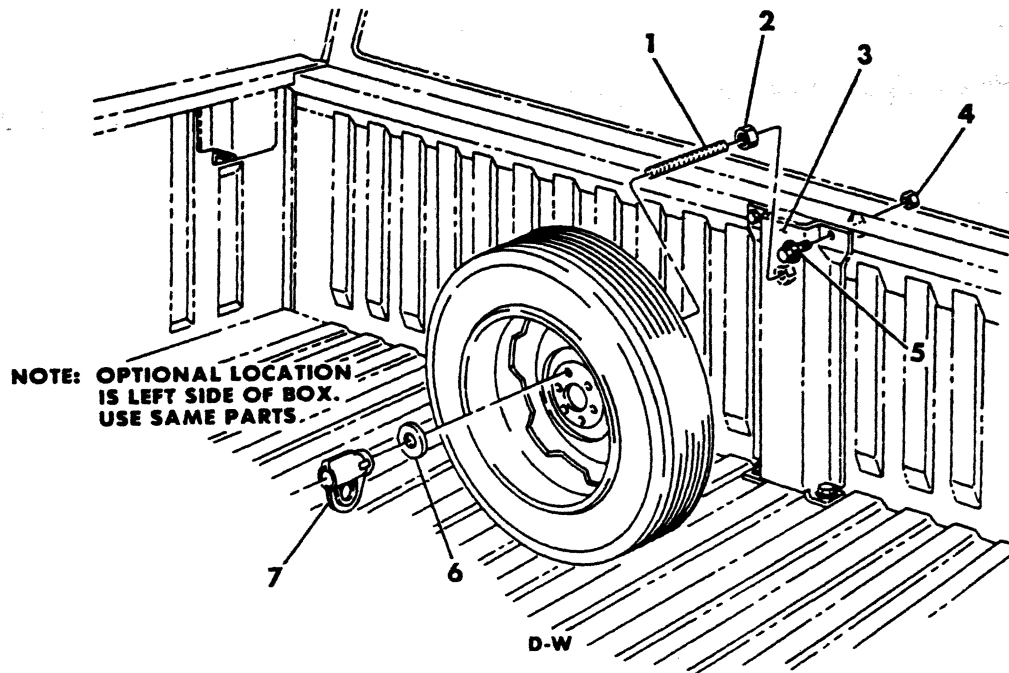



ITEM	PART NUMBER	QTY	MODEL	DESCRIPTION
<b>CARRIER, SPARE WHEEL AD-AW, D-W</b>				
1	6030 247	1		STUD, 1/2" - 13 x 5.12
2	219 467	1		NUT, 1/2 - 13
3	3494 093	1		BRACKET, Tire Carrier
	2976 714	1		SUPPORT, Tire Carrier Brkt.(6-1/2 Foot Utiline Only)
4	118 615	4		NUT, 3/8 - 16
5	9416 171	4		SCREW AND WASHER, 3/8 - 16 x .875
6		1		PLAIN WASHER (Not Serviced)
7	3893 707	1		WINGNUT, 1/2 - 13
8	3899 811	1		BRACKET, "J" Bolt
	4168 103	1		1981
9	3899 812	1		BRACKET, Floor
10	3899 869	1		HOOK BOLT
11	3498 235	1		BAR
12	1239 880	1		WASHER
13	2842 961	1		WINGNUT
	2979 773	1		LOCK PKG.

<b>LIGHT</b>	A = All Sport Utility (Ramcharger).	B = All Compact Models.	D = Conventional Cab.
<b>DUTY</b>	AD = 2 Wheel Drive Only (Ramcharger).	CB-MB = Compact Front Section Only.	W = Conventional Cab 4 Wheel Drive.
<b>CODES:</b>	AW = 4 Wheel Drive Only (Ramcharger).	P = Forward Control Chassis.	M = Motor Home.

---

**MEDIUM-HEAVY CODES:** XNT = Low Cab Forward. D = Conventional Cab. S = School Bus. W = 4-Wheel Drive.

AR=Use as Required      # =New Part Number      Printed in U.S.A.      June, 1982

CARRIER, UNDERSLUNG GLIDE-OUT  
D1-2-3, W1-2-3-4

8322 1300A

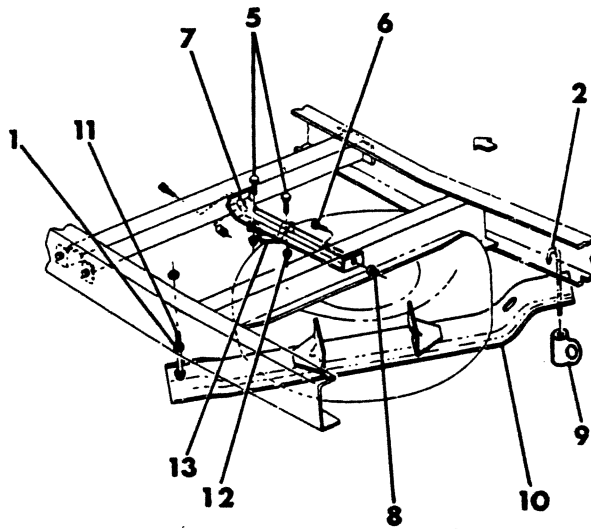
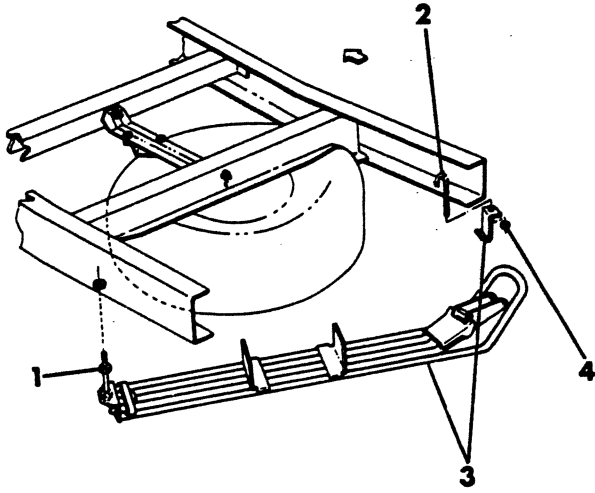

ITEM	PART NUMBER	QTY	MODEL	DESCRIPTION
<b>CARRIER, UNDERSLUNG GLIDE-OUT D1-2-3, W1-2-3-4</b>				
1	118 617	2		NUT
2	3497 538	1		ROD
3	3898 300	1		HANGER ASSEMBLY, Underslung Tire Carrier
4	152 348	1		NUT
5	181 063	2		BOLT
6	182 774	2		BOLT
7	3497 537	1		BRACKET
8	6025 022	2		NUT
9	3893 707	1		NUT AND INSERT
	3893 708	1		INSERT, Nut
10	3497 536	1		HANGER
11	6030 983	1		BOLT
12	6025 004	2		NUT
13	3497 540	1		EXTENSION, (Use With Dual Rear Wheels)

<b>LIGHT</b>	A = All Sport Utility (Ramcharger).	B = All Compact Models.	D = Conventional Cab.
<b>DUTY</b>	AD = 2 Wheel Drive Only (Ramcharger).	CB-MB = Compact Front Section Only.	W = Conventional Cab 4 Wheel Drive.
<b>CODES:</b>	AW = 4 Wheel Drive Only (Ramcharger).	P = Forward Control Chassis.	M = Motor Home.

**MEDIUM-HEAVY CODES:** XNT = Low Cab Forward. D = Conventional Cab. S = School Bus. W = 4-Wheel Drive.

AR=Use as Required

# = New Part Number

Printed in U.S.A.

June, 1982

CARRIER, SPARE WHEEL - B

8322 1400

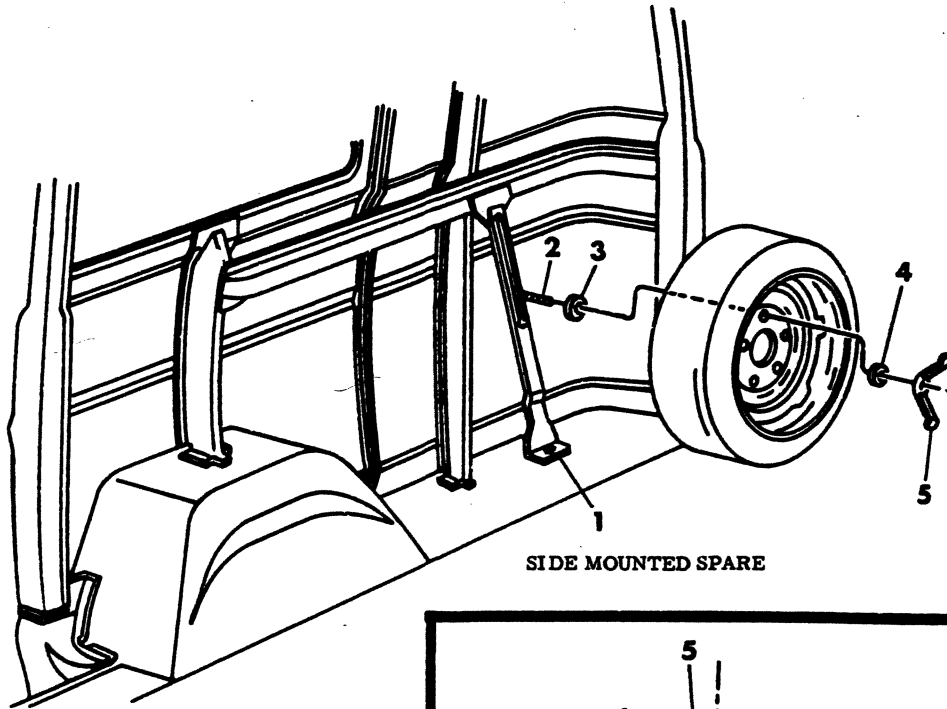

SIDE MOUNTED SPARE

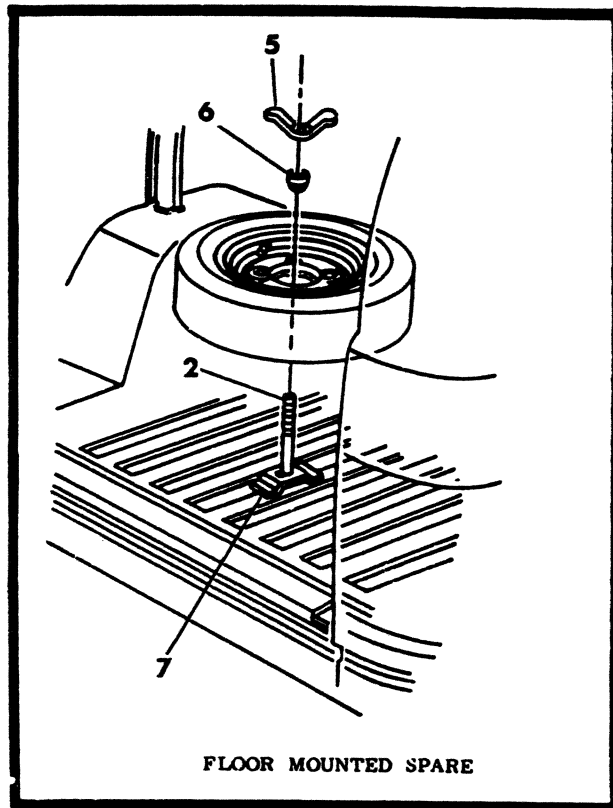

FLOOR MOUNTED SPARE

ITEM	PART NUMBER	QTY	MODEL	DESCRIPTION
<b>CARRIER, SPARE WHEEL - B</b>				
1	4087 449	1		CHANNEL, Side Mount
2	6029 839	1		BOLT, Wheel Retaining, 9"
	6022 801	1		10 3/4"
3	6026 648	1		RETAINER, Bolt
4	1239 880	1		LOCKWASHER, Wingnut
5	2842 961	1		WINGNUT, Bolt
6	2909 542	1		SPACER NUT, Bolt
7	3829 814	1		CHANNEL, Floor Mount

<b>LIGHT</b>	A = All Sport Utility (Ramcharger).	B = All Compact Models.	D = Conventional Cab.
<b>DUTY</b>	AD = 2 Wheel Drive Only (Ramcharger).	CB-MB = Compact Front Section Only.	W = Conventional Cab 4 Wheel Drive.
<b>CODES:</b>	AW = 4 Wheel Drive Only (Ramcharger).	P = Forward Control Chassis.	M = Motor Home.

**MEDIUM-HEAVY CODES:** XNT = Low Cab Forward. D = Conventional Cab. S = School Bus. W = 4-Wheel Drive.

AR=Use as Required

# =New Part Number

Printed in U.S.A.

June, 1982

