

**GROUP 13 - FRAME & BUMPERS**

BATTERY TRAY-LIGHT DUTY A - B - D - W - P .....	Fig. 13-1200
BUMPERS A-D-W .....	Fig. 13-800
BUMPERS B-CB-MB .....	Fig. 13-750
FRAME B MODEL .....	Fig. 13-100
FRAME CB - MB .....	Fig. 13-200
FRAME AD - AW .....	Fig. 13-300
FRAME D - W .....	Fig. 13-400
FRAME MOTOR HOME .....	Fig. 13-500
FRAME P MODEL (Picture to Follow) .....	Fig. 13-700
FRAME - M3-4-5-6, WITH I.H.C. 446 ENG. ....	Fig. 13-550
FRAME - WM300 EXPORT .....	Fig. 13-600
JACK ASSEMBLE B MODEL .....	Fig. 13-900
JACK STORAGE A - D - W .....	Fig. 13-1000
MOTOR HOME JACK, HANDLES, AND WRENCH .....	Fig. 13-1100

8313 100E

## FRAME B MODEL

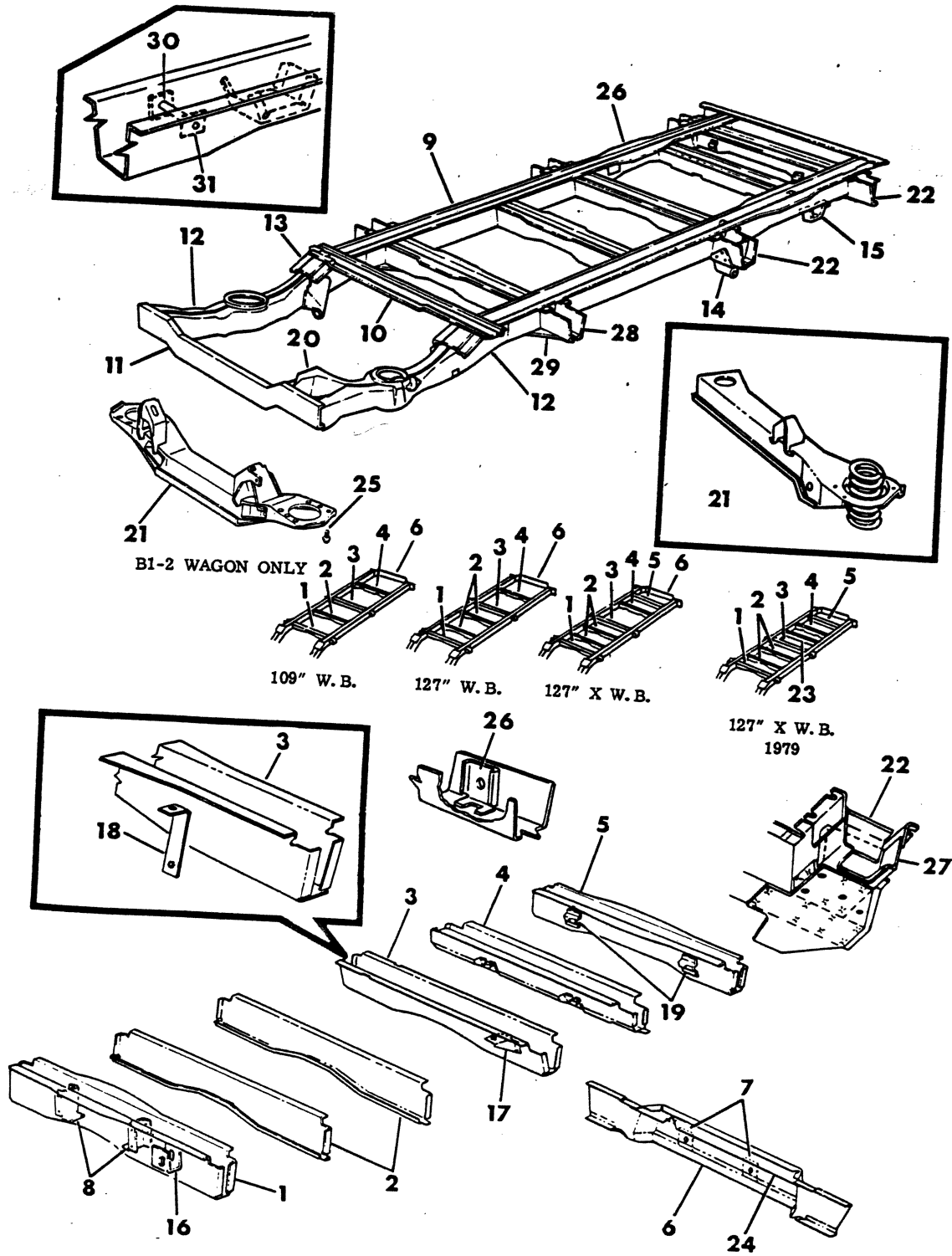

ITEM	PART NUMBER	QTY	MODEL	DESCRIPTION
<b>FRAME B MODEL</b>				
1	4084 093	1		C/MBR, U/ Body Trans. Mtg. 1978
	4113 048	1		1979
	4160 027	1		1980-81
2	4033 814	1		C/MBR, U/ Body Fr. Supt.
3	4033 800	1		C/MBR, U/ Body Rr. Sprg. Frt. Mtg. 1978
3	4113 047	1		1979-80
	4161 804	1		1981-
4	4087 164	1		C/MBR, U/Body Fuel Tank mtg. 1978-79
	4113 210	1		C/MBR, u/body Fuel Tank mtg. 1978-79
	4166 764	1		1980-81
5	3739 730	1	B2-3	C/MBR, U/Body Fuel Tank mtg. Rr. Crew Cab
6	4080 662	1		Panel, U/Body Rear Sill inner. 1978
	4084 852	1		1979
7	4087 169	2		Reinf., U/Body Rear Seill Inner Fuel Tank mtg.
8	2956 060	2		Reinf., U/Body Trans mtg. c/mbr.
9	4038 786-7	1	B1-2	RAIL, w/ 109" W.B. 1978
	4211 134-5	1	B1-2-3	w/ 109" W.B. 1979-80
	4038 788-9	1		w/ 127" W.B. 1978
	4211 138-9	1	B1-2-3	w/ 127" W.B. 1979-80-81
	4211 144-5	1	B2-3	w/127" W.B. Maxi. Van 1979-80-81
10	3824 656	1		REINFORCMENT, Frt. Panel 1978
	4087 599	1	B1-2-3	1979
	4166 293	1	B1-2-3	1980
11	2956 585	1		REINFORCMENT, Rad. Gr. Lwr. Supt. 1978
	4113 517	1		Center 1979-80
	4112 918-9	1		Ends 1979-80-81
12	4031 836-7	1		EXTENSION, Long Rail Frt. 1978
	4032 424-5	1		EXTENSION, ASSY. 1979-80-81
13	2956 431	2		REINFORCMENT, Long Rail to Long Ext. 1978
14	3899 694-5	1		SUPPORT, Rr. Sprg. Frt. Mtg.
15	3493 606	1		BRACKET, long Rail Tail Pipe
16	2956 683	1		REINF., U/Body Trans mtg. c/mbr. Parking Brake 1978-79
17	4032 956	1		Bracket, U/body c/mbr. Tailpipe (109" w.b.)
18	2914 615	1		Bracket, Brace Tube and Hose Union
19	4033 989	2		Bracket, U/Body Fuel Tank mtg. Rr. c/mbr. 127x w.b.
20	2956 391	AR		Bracket, strg. gear mtg. 1978
	4037 177	1	B1-2-3	SUPPORT, U/Body Long Rail Ext. Strg. Gear Mt. Brkt
	4089 339	1		BRACKET, U/Body Long Rail Ext. Strg. Gr. Mt. 1979-80-81
21	4030 424	1		C/mbr. Frm. Frt. Susp. w/3300 - 3600 lbs. Frt Axle 1978
	3637 017	1	B3	w/4000 Lbs. Front Axle 1978
	4032 139	1	B3	C/MBR. Frt. Susp. & Eng. Supt All Axles 1979-80
	4032 139	1	B3	w/4000 lb. Frt. Axle 1981
	4032 139	1	B1-2	w/1650lb.Frt.Spring 1980
	4032 139	1	B3-2	w/1230lb.Frt.Spring 1980
	4032 735	1	B1,2	All 1979-80
22	3729 364-5	1		Reinforcement, Rr. sprg. Rr. mtg. brkt. supt.
23	4033 808	1		CROSSMEMBER, u/Body Fr. Supt. Rear 1978
24	4113 497	1		EXTENSION, u/body flr. supt. rear

NOT SHOWN

<b>LIGHT</b>	A = All Sport Utility (Ramcharger).	B = All Compact Models.	D = Conventional Cab.
<b>DUTY</b>	AD = 2 Wheel Drive Only (Ramcharger).	CB-MB = Compact Front Section Only.	W = Conventional Cab 4 Wheel Drive.
<b>CODES:</b>	AW = 4 Wheel Drive Only (Ramcharger).	P = Forward Control Chassis.	M = Motor Home.

**MEDIUM-HEAVY CODES:** XNT = Low Cab Forward. D = Conventional Cab. S = School Bus. W = 4-Wheel Drive.

AR=Use as Required

# =New Part Number

Printed in U.S.A.

June, 1982

# 1978-81 LIGHT DUTY TRUCK PARTS CATALOG

FRAME & BUMPERS

ITEM	PART NUMBER	QTY	MODEL	DESCRIPTION
<b>FRAME B MODEL</b>				
	2956 048	1		Bracket, Lg. Rail to side Panel Rt. w/o sliding door
	3636 980	1		w/Sliding door
25	6030 507	8		Screw, assy. (1/2-13x1.25)
26	3899 686	2		REINFORCEMENT, U/Body Long Rail Rr Shipping Hold Down 127 W.B. 1978-79-80
27	4038 464	1	B2-3	SUPPORT, U/Body Rr Sprg. Rr Mtg. Brkt. Right LEFT
	3829 389	1		
28	3729 363	2	B1-2-3	REINFORCEMENT, U/Body Long Rail To Side Panel Brkt
29	3824 639	2	B1-2-3	PLATE, U/Body Trans. Mtg. C/Mbr. To Long Rail 1978-79
30	2956 824	2	B1-2-3	SLEEVE, U/Body Rr S/Abs. Mtg.
31	2956 068	2	B1-2-3	PLATE, U/Body Rr S/Abs. Mtg. Sleeve
32	4033 805	2	B2-3	REINFORCEMENT, U/Body Lng. Rail Rr Axle Bmpr. w/127 W.B. 1979-80-81
33	3636 215	2	B2-3	PLATE, U/Body Rr Sprg. Rr Mtg. Brkt. Supt. 1978

<b>LIGHT</b>	A = All Sport Utility (Ramcharger).	B = All Compact Models.	D = Conventional Cab.
<b>DUTY</b>	AD = 2 Wheel Drive Only (Ramcharger).	CB-MB = Compact Front Section Only.	W = Conventional Cab 4 Wheel Drive.
<b>CODES:</b>	AW = 4 Wheel Drive Only (Ramcharger).	P = Forward Control Chassis.	M = Motor Home.

**MEDIUM-HEAVY CODES:** XNT = Low Cab Forward. D = Conventional Cab. S = School Bus. W = 4-Wheel Drive.

AR=Use as Required

# =New Part Number

Printed in U.S.A.

June, 1982



8313 200C

FRAME  
CB - MB

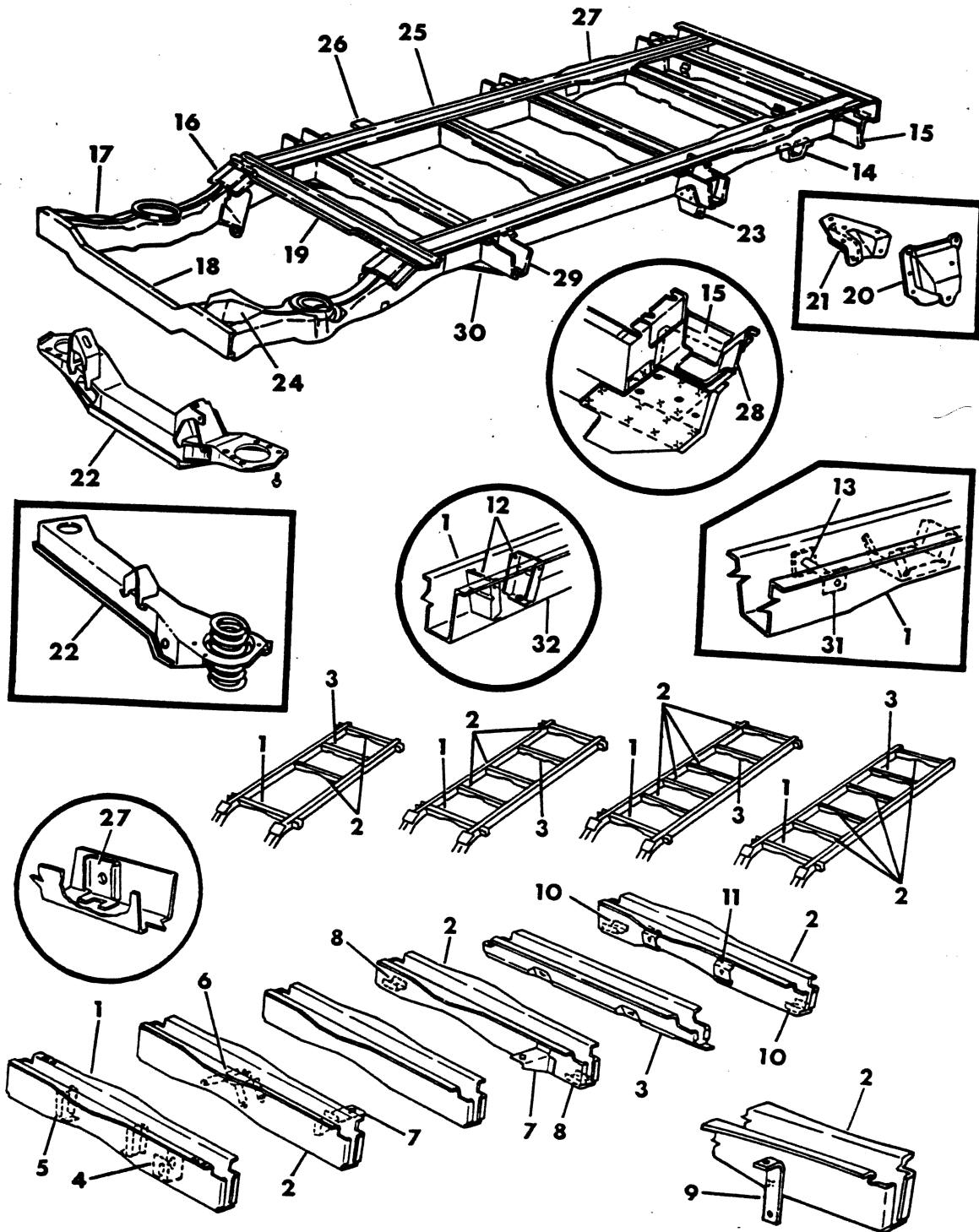

ITEM	PART NUMBER	QTY	MODEL	DESCRIPTION
<b>FRAME</b>				
<b>CB - MB</b>				
1	4084 093	1		C/MBR. Trans. Mtg. 1978
	4113 048	1		1979
	4160 027	1		1980-81
2	4080 291	1	CB,MB	C/MBR. U/Body Mtg. 1978
	4113 048	1	CB,MB	1979
	4160 027	1		1980-81
3	3824 637	1		C/MBR. Fuel Tank Mtg. 1978
4	2956 683	1		REINFORCEMENT, Trans Mtg. 1978-79
5	2956 060	2		REINFORCEMENT, Trans Mtg.
6	4080 311	1		REINFORCEMENT, Ctr. Bearing 145",165" W. B.
7	3493 605	1		BRACKET, Tail Pipe C/MBR.
8	3739 713	2		REINFORCEMENT, Rear Sprg. Frt. 163" W.B.
9	2914 615	2		BRACKET, Brake Tube & Hose Union
10	3739 713	2		REINFORCEMENT, Rear Sprg. Rear Mtg. 163" W.B.
11	4033 989	AR		BRACKET, Fuel Tank Rear
12	4087 430		CB	REINF. Lg. Rail,Rr. Sprg. Frt. Mtg. Brkt. Frt. Rt. 109",127" W.B.
	4087 430		MB3	All
	4087 430		MB4	127" W.B.
	4083 996			145" W.B.
	4087 430		CB3	REINF, lg. rail Rr. Sprg. frt. mtg. brkt. Rr. Lt. 109",127" W.B.
	4087 430		MB3	All
	4087 430		MB4	127" W.B.
	4083 996		CB,MB	145" W.B.
	4087 431		CB3	REINF. lg. rail Rr. sprg. frt. brkt: Rr. Rt.109" 127" W.B.
	4087 431		MB3	All
	4087 431		MB4	127" W.B.
	4083 997		CB,MB	145" W.B.
	4087 431		CB3	REINF, lg. rail Rr. sprg. frt. brkt. frt. lt. 109,127" W.B.
	4087 431		MB3	All
	4087 431		MB4	127" W.B.
	4083 997		CB,MB	145" W.B.
13	2956 824	2		SLEEVE, Rr S/Abs. Mtg.
14	3493 606	1		BRACKET, Tail Pipe
15	3729 364-5	1		REINF. Rear Sprg. Rear Mtg. Supt.
16	2956 431	2		REINF. Rail to Long Rail Ext. 1978
17	4031 836-7	1	CB,MB3	EXTENSION, Long Rail Frt. 109,127" w.b. 1978-9
	4115 652-3	1	CB,MB4	ALL 1978
	4032 424-5	1	CB,MB4	ALL 1979-80-81
	4032 424-5	1	CB3	145",163" W.B. 1979-80-81
18	2956 585	1		REINF. Rad Grille Panel Supt. 1978
	4113 517	1		Center 1979-80
	4112 918-9	1		Ends 1979-80
19	4087 599	1		REINF. Frt. Panel 1979
	4166 293	1		1980
20	4039 145	2	CB,MB4	BRACKET, Rear Sprg. Frt. 163" W. B.
21	3827 869	2		BRACE,Rr Sprg. Frt. Brkt. Lt. 1978-79
	4117 553	1	CB3,MB3-4	127, 145" W.B. MB4, CB3, All MB3 1980-81
	4117 555	1	CB,MB4	163" W.B. MB4,CB3-4 All 1980-81
22	3637 017	1	CB-MB3	C/MBR. Frt. Susp MB3 127" W.B. CB3 145" W.B W/ 1725# Frt. Axle 1978

**LIGHT** A = All Sport Utility (Ramcharger). B = All Compact Models. D = Conventional Cab.  
**DUTY** AD = 2 Wheel Drive Only (Ramcharger). CB-MB = Compact Front Section Only. W = Conventional Cab 4 Wheel Drive.  
**CODES:** AW = 4 Wheel Drive Only (Ramcharger). P = Forward Control Chassis. M = Motor Home.

**MEDIUM-HEAVY CODES:** XNT = Low Cab Forward. D = Conventional Cab. S = School Bus. W = 4-Wheel Drive.

AR=Use as Required

# = New Part Number

Printed in U.S.A.

June, 1982

# 1978-81 LIGHT DUTY TRUCK PARTS CATALOG

FRAME & BUMPERS

ITEM	PART NUMBER	QTY	MODEL	DESCRIPTION
<b>FRAME CB - MB</b>				
	3637 017	1	MB4	ALL W.B.1978
	4030 421	1	CB3-MB3	1400 # W.B. 1978
	4032 139	1	CB-MB3	C/mbr., frt. susp & eng supt. w/ 1710 # frt.sprg. 1979-80
	4032 139	1	CB3	w/1230 Lb Front Spring 1980
	4032 139	1	CB-MB4	All 1979-80
	4032 139	1	MB3	w/1575 Lb. Front Spring 1980
	4032 139	1	CB,MB3-4	w/1400 Lb. Front Spring 1981
	4032 735	1	CB-MB3	w/o 1710 Lb. Front Spring 1979-80
	4039 320-1	1	CB4-MB4	BRACKET, Frm. Rear Sprg. Rear (Not Shown)
23	3827 864	2		BRACKET, Rear Sprg. Frt.
	4037 596	2	CB3,MB3-4	BRACKET, Frame RR Sprg. Frt. CB3,MB4 127-145" W.B.MB3 All 1979-80-81
24	2956 391	1		BRACKET, Strg Gear Mtg. 1978
	4089 339	1		1979-80-81
	4037 177	1	CB,MB3-4	SUPPORT, U/Body Long Rail Ext. Strg. Gear Mt. Brkt
25	4211 136-7	1	CB,MB3	RAIL, w/109" W.B. 1979-80
	4211 136-7	1	MB2-3	1981
	4211 140-1	1	CB,MB3	w/127" W.B. 1979-80
	4211 140-1	1	CB3,MB2-3	1981
	4211 142-3	1	MB4	w/127" W.B. 1979
	4212 254-5	1	MB4	1980-81
	4211 146-7	1	CB3,MB4	w/145" W.B. 1979
	4212 256-7	1		1980-81
	4211 148-9	1	CB,MB4	w/163" W.B. 1979
	4212 258-9	1	CB3-4,MB4	1980-81
26	4164 051	1	CB,MB3-4	BRACKET, U/Body Muff. Frt. Supt. Rt (Up To 5-12-80)
	4150 453	1	CB-MB2,3,4	(Aft 5-12-80)
27	3899 686	2	CB3,MB3-4	REINFORCEMENT, U/Body Long Rail Rr Shipping Hold Down CB3 w/127 W.B MB3 All
28	4038 464	1	CB3,MB3-4	SUPPORT, U/Body Rr Sprg. Rr Mtg Brkt. Right
	3829 389	1		Left
29	3729 363	2	CB,MB3-4	REINFORCEMENT, U/Body Long Rail To Side Panel Brkt
30	3824 639	2	CB,MB3-4	PLATE, U/Body Trans. Mtg. C/Mbr. To Long Rail 1978-79
31	2956 068	2	CB,MB3-4	PLATE, U/Body Rear S/Abs. Mtg. Sleeve
32	3739 793	2	CB,MB3-4	T/Plate U/Body Long Rail Rr Axle Bumper
33	4033 805	2	CB,MB2-3-4	REINFORCEMENT, U/Body Ig. Rail Rr. Axle Bmpr. 127 W.B. 1979-80-81
34	3636 215	2	CB,MB3-4	PLATE, U/Body Rr Sprg. Rr Mtg. Brkt. Supt. 1978
FOLLOWING ITEMS NOT SHOWN				
	4083 998	4		Reinforcement, Long Rail rr. sprg. Frt. mtg. brkt.145" W.B. 1978
	2956 048			BRACKET, u/body Ig. Rail Reinf. to Side Pnl. Rt

<b>LIGHT</b>	A = All Sport Utility (Ramcharger).	B = All Compact Models.	D = Conventional Cab.
<b>DUTY</b>	AD = 2 Wheel Drive Only (Ramcharger).	CB-MB = Compact Front Section Only.	W = Conventional Cab 4 Wheel Drive.
<b>CODES:</b>	AW = 4 Wheel Drive Only (Ramcharger).	P = Forward Control Chassis.	M = Motor Home.

**MEDIUM-HEAVY CODES:** XNT = Low Cab Forward. D = Conventional Cab. S = School Bus. W = 4-Wheel Drive.

AR=Use as Required

# = New Part Number

Printed in U.S.A.

June, 1982





8313 300B

## FRAME AD - AW

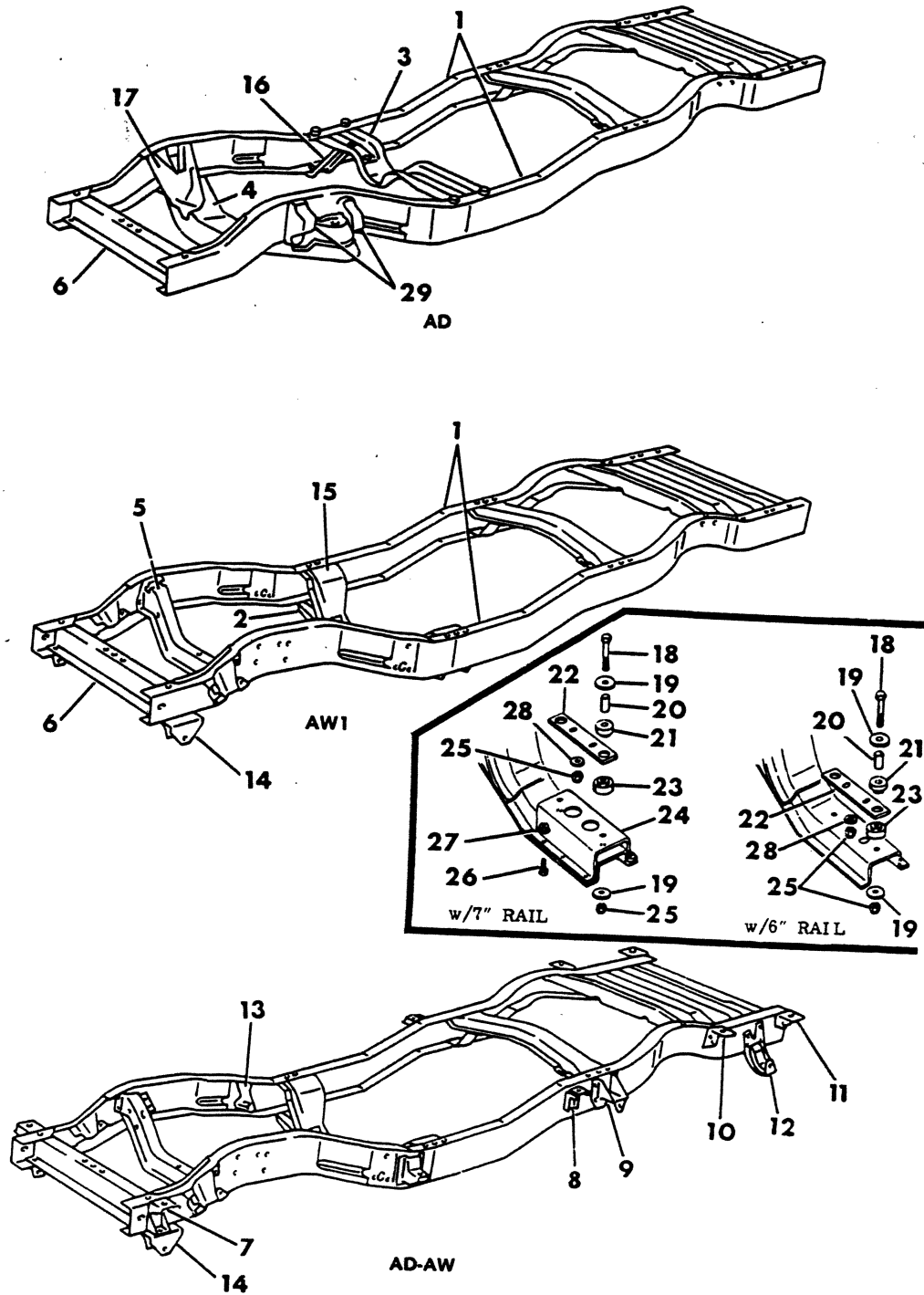

ITEM	PART NUMBER	QTY	MODEL	DESCRIPTION
<b>FRAME</b>				
<b>AD - AW</b>				
1	3897 220	1	AD	FRAME Assy, 1978-79-80
1	4164 216	1	AD	1981
	3897 231	1	AW	1978-79-80
	4164 217	1	AW	1981
2	3822 887	1	AW	C/MBR. Eng. Rr. Supt.
3	3822 892	1	AD	C/MBR. Eng. Rr. Supt.
4	4086 978	1	AD	C/MBR. Eng. Frt. Susp. 1978-79
	3491 139	1	AD	BRACKET, Frm. Frt. Susp. Lwr. Cntrl Arm
5	3898 292	1	AW	C/MBR, Eng. Frt Supt.
6	4039 718	1	AD	C/MBR. Frm. Frt.
	4039 714	1	AW	C/MBR, frm. frt.
7	3823 097	2	AW	BRACKET, Frt. Body Mtg. w/Brace Reinf.
	3823 099	2	W,AW	BRACKET, Frt. End Body Mtg. w/o Brace Reinf. 1978
8	3823 099	2	AD-AW	BRACKET, Cab Hold Down Rear
9	3823 095	2	AD,AW	BRACKET, Rear Sprg. Frt. 1978-79-80
	4164 315	2	AD,AW	1981
10	3827 142-3	1	AD-AW	BRACKET, Body Hold Down Frt.
11	3822 725	2	AD-AW	BRACKET, Body Hold Down Rear
12	3823 096	2	AD-AW	BRACKET, Rear Sprg. Rear
13	3497 469	2	AW	BRACKET, Frt. Sprg. Rear
	2953 700	4	AW	BUSHING, Frm. Frt. Sprg. Rear Brkt.
14	3736 986-7	1	AW	BRACKET, Frt. Sprg.
15	3823 355	2	AW	BRACE, Eng. Rear Supt.
16	3822 893	2	AD	BRACE
17	3822 890-1	1	AD	BRACKET, Eng. Frt. Supt.
	2231 677	AR	AD-AW	Grommet, Frm. C/mbr.
18	271 885	2	AW	BOLT (5/8 - 11 x 3.25)
19		4	AW	WASHER, flat
20		2	AW	SPACER
21	3820 921	2	AW	INSULATOR, upper
22	3820 924	1	AW	PLATE
23	3822 897	2	AW	INSULATOR, Lower 1978
	4106 710	2	AW	1979-80-81
24	3821 225	1	AW	ADAPTER
25	152 372	4	AW	NUT, Lock (5/8 - 11)
26	6029 735	6	AW	BOLT, (7/16 - 14 x 1.25)
27		6	AW	NUT, (7/16 - 14)
28	6028 776	2	AW	WASHER, Coned
29	4086 982-3	1	AD	BRACKET assy.
30	4115 061	1		CROSSMEMBER, Rear Sprg. Frt. Brkt. 1979-80-81
	4115 493	2	AD,AW	BRACE, Rear Sprg. Frt. Bracket 1979-80-81 (Not Shown)

<b>LIGHT</b>	A = All Sport Utility (Ramcharger).	B = All Compact Models.	D = Conventional Cab.
<b>DUTY</b>	AD = 2 Wheel Drive Only (Ramcharger).	CB-MB = Compact Front Section Only.	W = Conventional Cab 4 Wheel Drive.
<b>CODES:</b>	AW = 4 Wheel Drive Only (Ramcharger).	P = Forward Control Chassis.	M = Motor Home.

**MEDIUM-HEAVY CODES:** XNT = Low Cab Forward. D = Conventional Cab. S = School Bus. W = 4-Wheel Drive.

AR=Use as Required

#=New Part Number

Printed in U.S.A.

June, 1982

8313 400C

FRAME  
D - W

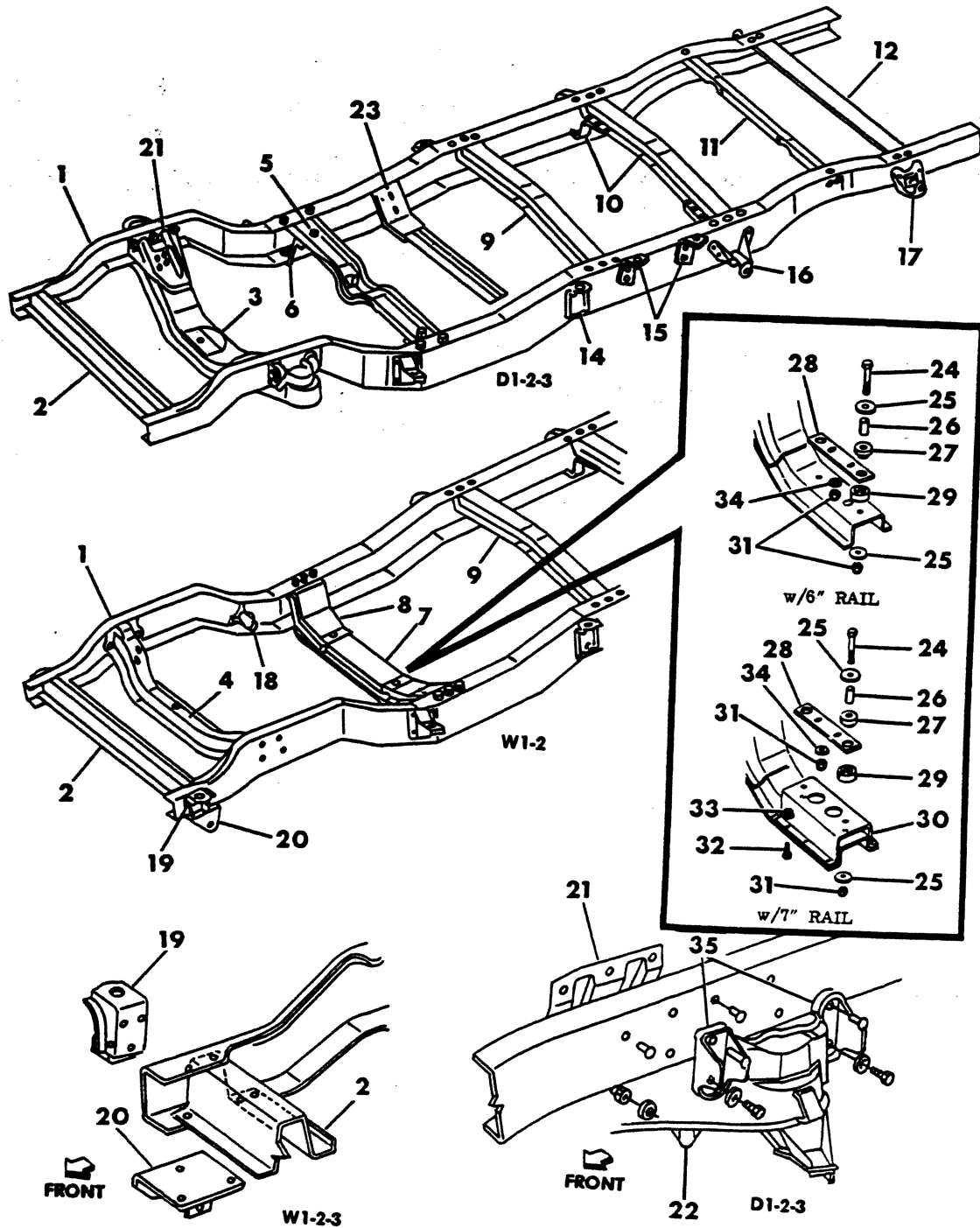

ITEM	PART NUMBER	QTY	MODEL	DESCRIPTION
<b>FRAME</b>				
<b>D - W</b>				
1	4039 601	1	D1	FRAME Assy, 115" W.B. 1978-79-80
	4213 915	1	D1	115" W.B. 1981
	4039 603	1	D1-2	131" W.B. w/o Hvy. Dty. Pkg. 1978-79-80
	4213 434	1	D2	131" W.B. w/4000# Frt. Axle 1980
	4213 916	1	D1	131" W.B. 1981
	4213 917	1	D2	131" W.B. w/3300# Frt.Axle 1981
	4039 604	1	D2	131" W.B. w/ Hvy. Dty. Pkg. 1978
	4039 604	1	D3	131" W.B. conv. cab 1979-80
	4213 918	1	D3	131" W.B. 1981
	4213 935	1	D3	131" W.B. Conv. Cab w/Frame Reinf. 1981
	4115 691	1	D3	131" W.B. Club Cab w/Frame Reinf. 1978-79-80
	4039 609	1	D1	133" W.B. 1978-79-80
	4213 923	1	D1	133" W.B. 1981
	4039 605	1	D3-4	135" W.B. 1978
	4039 605	1	D4	135" W.B. 1979-80
	4213 919	1	D3-4	135" W.B. 1981
	4115 692	1	D3	135" W.B. w/Frame Reinf. 1979-80
	4213 936	1	D3	135" W.B. 1981
	4039 606	1	D2	149" W.B. Crew Cab 1979-80
	4213 920	1	D2	149" W.B. Crew Cab 1981
	4039 611	1	D2-3	149" W.B. Club Cab 1978
	4039 611	1	D1-2-3	1979-80
	4213 925	1	D3	1981
	4213 924	1	D1-2	149" W.B. D1 All W.B. D2 1981
	4115 693	1	D3	149" W.B. w/Frame Reinf. 1979-80
	4213 937	1	D3	149" W.B. 1981
	4039 607	1	D3-4	159" W.B. 1978
	4039 607	1	D4	1979-80
	4213 921	1	D3-4	1981
	4115 694	1	D3	159" W.B. w/Frame Reinf. 1979-80
	4213 938	1	D3	159" W.B. 1981
	4039 608	1	D2-3	165" W.B. 1978-79-80
	4213 922	1	D2-3	165" W.B. 1981
	4039 612	1	W1	115" W.B. 1978-79-80
	4213 926	1	W1	115" W.B. 1981
	4039 613	1	W1-2	131" W.B. 1978-79-80
	4213 927	1	W1-2	131" W.B. 1981
	4039 614	1	W3-4	135" W.B. 1978-79-80
	4213 928	1	W3-4	ALL W.B. 1981
	4039 617	1	W1-2	149" W.B. Club Cab 1978-79-80
	4213 931	1	W1-2	1981
	4039 615	1	W2	149" W.B. Crew Cab 1979-80
	4213 929	1	W2.RD2	1981
	4039 616	1	W1	133" W.B. 1978-79-80
	4213 930	1	W1	133" W.B. 1981
	4115 695	1	W3	All w/Frame Reinf. 1979-80
	4032 738	1	RD2	131" W.B. 1978-79-80
	4213 932	1	RD2	131" W.B. 1981
	4032 742	1	RD2	149" W.B. Club Cab 1978

**LIGHT** A = All Sport Utility (Ramcharger). B = All Compact Models. D = Conventional Cab.  
**DUTY** AD = 2 Wheel Drive Only (Ramcharger). CB-MB = Compact Front Section Only. W = Conventional Cab 4 Wheel Drive.  
**CODES:** AW = 4 Wheel Drive Only (Ramcharger). P = Forward Control Chassis. M = Motor Home.

**MEDIUM-HEAVY CODES:** XNT = Low Cab Forward. D = Conventional Cab. S = School Bus. W = 4-Wheel Drive.

AR=Use as Required

# = New Part Number

Printed in U.S.A.

June, 1982

# 1978-81 LIGHT DUTY TRUCK PARTS CATALOG

ITEM	PART NUMBER	QTY	MODEL	DESCRIPTION
<b>FRAME</b>				
<b>D - W</b>				
	4039 528	1	RD2	149" W.B. Crew Cab 1979-80
	4213 934	1	RD2	1981
2	4039 705	1	D1	C/MBR., Frm. Frt. 149" W.B.
	4039 705	1	D2-3	All W.B.
	4039 718	1	D1	Except 149" W.B.
	4039 714	1	W-RD	All
3				C/MBR., Frt. Susp. and Eng. Supt.
	4086 978	1	D1	115", 133", 149" W.B. 1978
	4086 978	1	D1	115", 131", 133" W.B. 1979-80-81
	4086 978	1	D2	131", 149" W.B. w/o Hvy. Dty. Pkg.
	4086 978	1	D1-2	131", 149" W.B. w/3300# Frt. Axle 1980
	4086 978	1	D1-2	All W.B. w/3300# Frt. Axle 1981
	4086 979	1	D2	131", 149" W.B. w/Hvy. Dty. Pkg. 1978
	4086 979	1	D2	165 W.B. D2, All W.B. D3, 4 1979
	4086 979	1	D2-3-4	All W.B. w/4000# Frt. Axle 1980-81
4	3898 292	1	W-RD2	C/MBR., Eng. Frt. Supt.
5	3822 892	1	D	C/MBR., Eng. Rr. Supt.
	3822 892	1	RD	1981
6	3822 893	1	D-RD	BRACE, Frm. Eng. Rr. Supt. 6" Rail
	4039 654	1	D-RD	7" Rail
7	3822 887	1	W	C/MBR., Eng. Rr. Supt. 6" Rail
	4039 666	1	W	7" Rail
8	3823 355	1	W	BRACE, Frm. Eng. Rr. Supt. 6" Rail
	4039 653	1	W	7" Rail
9		1	D-W-RD	C/MBR., Intermediate (Serv. in Assy) 1978
	4115 061	1	D-W-RD	C/MBR., Intermediate, Except Crew Cab 1979
	4115 061	2	D-W	With Crew Cab 1979-80-81
	4115 061	2	D-W	With 149" Club Cab 1979
10		1	D-W-RD	C/MBR., Rr. Sprg. Frt. (Serv. in Assy.) 1978
	4115 061	1	D-W-RD	C/MBR., Rr. Sprg. Frt. 1979-80
	4210 996	1	D-W-RD	1981
		1	D-W-RD	BRACE, C/MBR. Frm. Rear Spring Frt. (Serv. in Assy.) 1978
	4115 494	2	D-W-RD	BRACE, Frame Rr Sprg. Frt. 1979-80
	4210 994	2	D-W-RD	133, 149, 165 W.B. 1981
	4210 995	2	D-W-RD	115, 131, W.B. 1981
	4115 493	2	D-W-RD	Except Crew Cab, w/6" Rail 1979-80
	4115 494	2	D-W	With Crew Cab, w/7" Rail 1979-80
	4115 494	2	D3-4	BRACE, Intermediate C/MBR. Frm. 159 W.B. 1979-80-81
11		1	D-W	C/MBR., Shock Mtg. (Serv. in Assy.)
	3898 355	1	D-W	C/MBR., Fuel Tank Mtg. Frt. w/21 Gal. Tank (Not Shown)
	4036 025	1	D-W-RD	C/MBR., Fuel Tank Interm. Supt. w/18 or 20 Gal. Tank (Not Shown)
12	4039 655	1	D-W-RD	C/MBR., Rear Spring, Rear
14	3823 099	2	D-W	BRACKET, Cab Hold Down Rear
15	4039 652	AR	D-W	BRACKET, Box Hold Down
16	4039 668	2	D	BRACKET, Rr. Sprg. Frt. D1 Std. Cab, or 133" W.B. Club Cab 1978
	4039 668	2	D1	ALL 1979-80-81
	3823 095	2	D	BRACKET, D2 131" W.B. Std. Cab w/o Hvy. Dty. 1979-80-81
	3823 095	2	D	D1-2 w/149" W.B. Club Cab w/o Hvy. Dty.
	3823 095	2	D	D1-2 w/149" W.B. Crew Cab w/o Hvy. Dty.

**LIGHT DUTY CODES:** A = All Sport Utility (Ramcharger). B = All Compact Models. D = Conventional Cab.  
 AD = 2 Wheel Drive Only (Ramcharger). CB-MB = Compact Front Section Only. W = Conventional Cab 4 Wheel Drive.  
 AW = 4 Wheel Drive Only (Ramcharger). P = Forward Control Chassis. M = Motor Home.

**MEDIUM-HEAVY CODES:** XNT = Low Cab Forward. D = Conventional Cab. S = School Bus. W = 4-Wheel Drive.

ITEM	PART NUMBER	QTY	MODEL	DESCRIPTION
<b>FRAME</b>				
<b>D - W</b>				
	3823 095	2	W-RD	All
	4039 669	2	D	D2 w/Hvy. Dty. and D3-4 All
	4039 669	2	D	D2 w/165" W.B. and W3-4 All
17	4039 659	2	D1	BRACKET, Rear Sprg. Rear Std. Cab
	3823 096	2	D2	131"-149", W.B. w/o Hvy. Dty.
	3823 096	2	D1	149", W.B.
	3823 096	2	W1-2, RD	149", W.B.
	3823 096	2	W1-2, RD	All W.B. 1981
	4039 660	2	D	D2 w/Hvy. Dty. Susp. and All D3-4 1978-79-80
	4039 660	2	D2	149,131,165 W.B. w/4000 lb. Frt.Axle 1981
	4039 660	2	D-W	D2 165" W.B. and All W3-4
	4039 660	2	D,W3-4	All W.B. 1981
18	3497 469	2	W-RD	BRACKET, Frt. Sprg. Rear
	4112 681	2	W3	BRACKET w/BUSHING, Frm. Frt. Sprg. Rear
	4112 231	2	W3	SPACER, Frm. Frt. Sprg. Brkt. Bushing
	2953 700	4	W-RD	BUSHING, Frm. Sprg. Rr. Brkt.
19	3823 097	2	W-RD	BRACKET, w/Brace Body Hold Down, Frt.
	3823 099	2	W-RD	BRACKET, w/o Brace Body Hold Down, Frt. 1978-79
	3823 099	2	D-W	w/MMC DIESEL Eng. 1978-79
20	3736 986-7	2	W-RD	BRACKET, Frt. Spring
21	3822 890-1	2	D	BRACKET, Eng. Frt. Support
22	3491 226	2	D2	BRACKET, Frm. Frt. Susp. Lower Control Arm Mtg. w/Hvy. Dty. Susp.
	3491 226	2	D2	165" W.B.
	3491 226	2	D2-3-4	All W.B.
	3491 139	2	D1	All W.B.
	3491 139	2	D2	131, 149, W.B. 1981
	3491 139	2	D2	w/o Hvy. Dty. Suspension
23	4039 663	2	D-W-RD	BRACE, C/Mbr. Prop Shaft Ctr. Bearing 1978
	4115 494	2	D,W,RD	1979-80-81
	2231 677	AR	D-W	GROMMET, Frm. C/Mbr. (Not Shown)
	3729 032	2		EXTENSION, U/Body Rail Rear Club Cab
24	271 885	2	W	BOLT, (5/8-11 x 3.25)
25		4	W	WASHER, Flat
26		2	W	SPACER
27	3820 921	2	W	INSULATOR, Upper
28	3820 924	1	W	PLATE
29	4106 710	2	W	INSULATOR, Lower
30	3821 225	2	W	ADAPTER
31	152 372	4	W	NUT, Lock (5/8-11)
32	6029 735	6	W	BOLT, (7/16-14 x 1.25)
33		6	W	NUT, (7/16-14)
34	6028 776	2	W	WASHER, Coned
35	4086 982-3	1	D	BRACKET, Upper Control Arm, Shock Abs. Mtg. 1978-79
36	4115 061	1	D-W	C/MBR., Frame Prop Shaft Ctr. Bearing 1979-80-81
	4115 061	1	RD	149" W.B. 1979-80-81

Following Items Not Shown

4112 212-3	1	D,W3	REINF, Frm. Side Rail Frt., Rear 1979-80-81
------------	---	------	---

**LIGHT** A = All Sport Utility (Ramcharger). B = All Compact Models. D = Conventional Cab.  
**DUTY** AD = 2 Wheel Drive Only (Ramcharger). CB-MB = Compact Front Section Only. W = Conventional Cab 4 Wheel Drive.  
**CODES:** AW = 4 Wheel Drive Only (Ramcharger). P = Forward Control Chassis. M = Motor Home.

**MEDIUM-HEAVY CODES:** XNT = Low Cab Forward. D = Conventional Cab. S = School Bus. W = 4-Wheel Drive.

AR=Use as Required

#=New Part Number

Printed in U.S.A.

June, 1982

8313 500A

FRAME  
MOTOR HOME

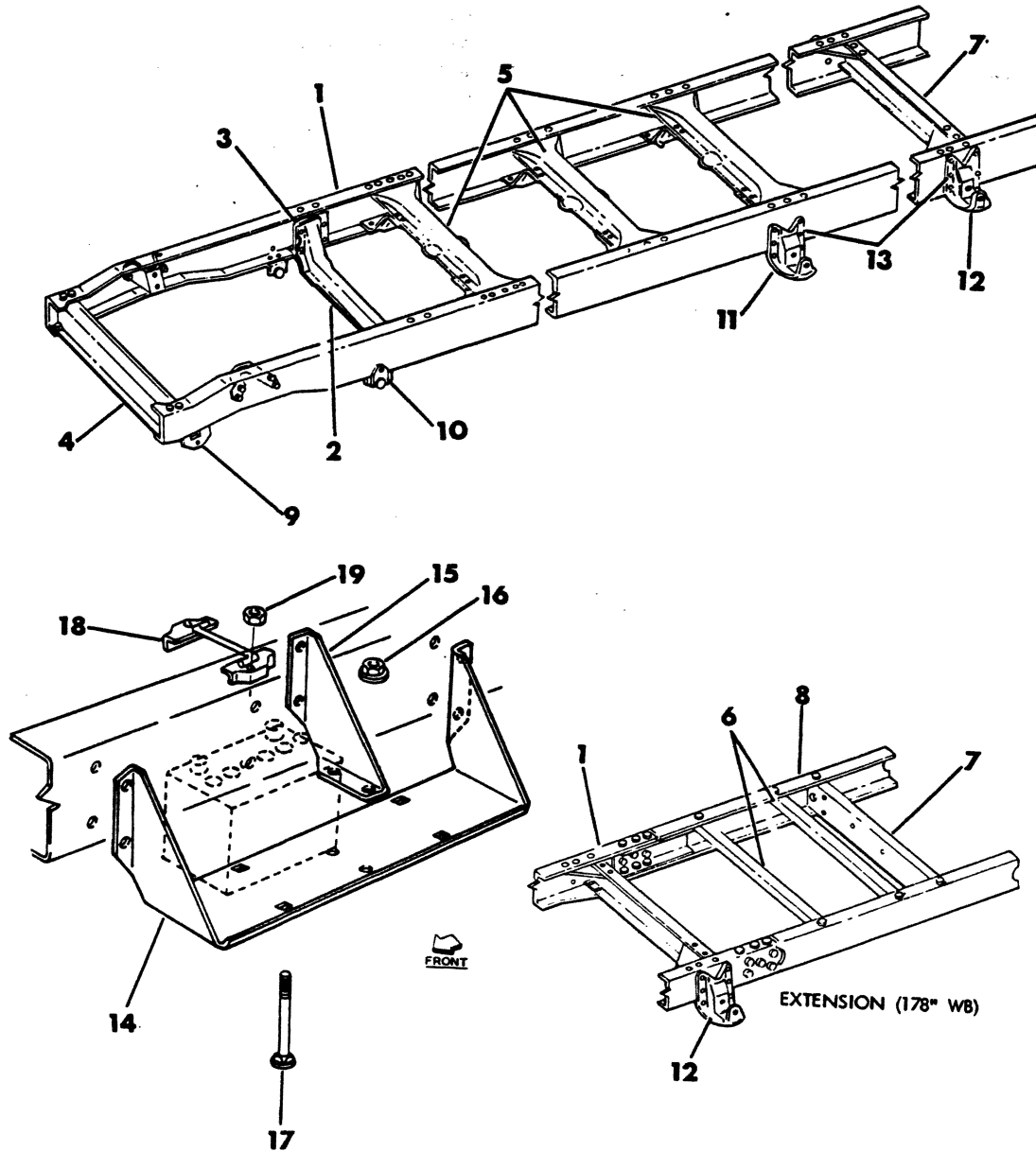



ITEM	PART NUMBER	QTY	MODEL	DESCRIPTION
<b>FRAME MOTOR HOME</b>				
1	3823 863			FRAME Assy. 104" W.B.
	3823 864			125" W.B. 1978
	3638 614			137" W.B. 1978
	3638 615			159" W.B. 1978
	3638 616			178" W.B. 1978
	4031 141			208" W.B. 1978
	4116 561		M3	125" W.B. 1979
	4116 562		M3,4	137" W.B. w/440 Eng. 1979
	4117 978		M3,4	137" W.B. w/360-3 Eng. 1980-81
	4116 563		M4,5	159" W.B. w/440 Eng. 1979
	4117 979		M4-5	159" W.B. w/360-3 Eng. 1980
	4117 979		M3-4-5	159" W.B. All Eng. 1981
	4116 564		M5	178" W.B. 1979
	4117 980		M5	178" W.B. 1980-81
	4116 565		M6	ALL W.B. 1979
	4117 245		M6	ALL W.B. 1980-81
2	2832 541	2		C/MBR. Eng. Rr Supt. 1978-79
	2832 541	2	M3-4-5	M3,4 All M5 159 W.B. 1980
	2832 541	2	M5-6	M6 All M5 178" W.B. 1981
3	3823 808-9	1		BRKT, Eng. Rr Supt. 1980-81
	4164 064-5	1	M3-4	137 W.B" w/360 Eng. 1978-79
	4117 206-7	1	M4	159" W.B w/360 Eng. 1979
4	3638 601	1		C/MBR. Frm. Frt. Susp.
5	2908 212	AR		C/MBR. Intermediate
6	3634 434	AR		C/MBR. Fuel Tank 1978-79
	4164 416	AR		1980
7	4030 335	AR	M6	C/MBR. Frm. Rear
8	3641 346-7	2	M5	EXTENSION, Frm. Rr. 178" W.B. 1978-79
	4164 422-3	1	M3-4	137" W.B. 1980-81
	4164 422-3	1	M4-5	159" W.B. 1980-81
	4164 422-3	1	M5	178" W.B.1980-81
9	3638 670-1	1	M3-4-5	HANGER, Frm. Frt. Susp. Frt.
	4031 144-5	1	M6	
	3638 622	AR		BUSHING, Frt. Sprg. Rr.
10	3638 624	2		BRACKET, Frt. Sprg. Rr.
11	3823 273	4	M6	BRACKET, Rr Sprg. 1978
	3823 273	4	M3-4-5-6	1979-80-81
12	3638 650	2		BRACKET, Rr Sprg. Rr. 1978
	3823 273	2		1979
13	3736 216-7	4		BRACE, Rr. Sprg. Brkt. 1978
	3823 270-1	1	M3,4,5	1979
	4030 344	4		BRACE, Rr. Sprg. Brkt. 1978
	4112 683	2		BRACE, Frm. Rr. Sprg. Frt. Brkt. 1979-80-81
	4112 683	2		BRACE, Interm. 1979-80-81
	2231 677	AR		GROMMET, Frm. C/Mbr. (Not Shown)
	4030 344	4		BRACE, Intermediare C/Mbr. 1978
14	3638 639	1		TRAY, Battery 1978
	4112 849	1		TRAY, Battery 1979 (Up To 11-27-78)
	4164 067	1		1979 (After 11-27-78)

**LIGHT** A = All Sport Utility (Ramcharger). B = All Compact Models. D = Conventional Cab.  
**DUTY** AD = 2 Wheel Drive Only (Ramcharger). CB-MB = Compact Front Section Only. W = Conventional Cab 4 Wheel Drive.  
**CODES:** AW = 4 Wheel Drive Only (Ramcharger). P = Forward Control Chassis. M = Motor Home.

**MEDIUM-HEAVY CODES:** XNT = Low Cab Forward. D = Conventional Cab. S = School Bus. W = 4-Wheel Drive.

AR=Use as Required

# =New Part Number

Printed in U.S.A.

June, 1982

# 1978-81 LIGHT DUTY TRUCK PARTS CATALOG

FRAME & BUMPERS

ITEM	PART NUMBER	QTY	MODEL	DESCRIPTION
------	-------------	-----	-------	-------------

## FRAME MOTOR HOME

15	4112 850	1		SUPPORT, Battery Tray 1979-80-81
16	271 502	8		NUT (7/16-14)
17	1924 103	AR		BOLT, Battery Hold Down Brkt.
18	2512 893	1		COVER, BATTERY, Hold Down 70 Amp. 1978-79
	2910 973	1		90 AMP. 1978
	2125 893	1		COVER, Battery Hold Down w/Aux.Batt. 1979 (Up To 11-27-78)
	3491 736	1		(After 11-27-78)
	4116 875	1		COVER, Battery Hold Down 1979 (Up To 11-27-78)
	3491 736	1		1979 (After 11-27-78)
19		AR		NUT (7/16 - 14) Not Serviced
FOLLOWING ITEMS NOT SHOWN				
	2954 150	1		HANDLE, 3 Ton Hydraulic Jack
	1924 260	1	M6	HANDLE, 16000 Lb. Hyd. Jack
	4088 927	AR	M3,4,5	JACK Assy. Up To 9-7-78
	4089 657	1	M3,4,5	12000 Lb. After 9-7-78
	4088 928	1	M6	Hydraulic, 16000 Lb.
	2960 719	1		HANDLE, Jack Up To 9-7-78
	4117 132	1		After 9-7-78
	3735 529	1		WRENCH, w/ Single or Dual Wheels
	3735 528	1		SOCKET, Wheel Wrench

<b>LIGHT</b>	A = All Sport Utility (Ramcharger).	B = All Compact Models.	D = Conventional Cab.
<b>DUTY</b>	AD = 2 Wheel Drive Only (Ramcharger).	CB-MB = Compact Front Section Only.	W = Conventional Cab 4 Wheel Drive.
<b>CODES:</b>	AW = 4 Wheel Drive Only (Ramcharger).	P = Forward Control Chassis.	M = Motor Home.

**MEDIUM-HEAVY CODES:** XNT = Low Cab Forward. D = Conventional Cab. S = School Bus. W = 4-Wheel Drive.

AR=Use as Required

#=New Part Number

Printed in U.S.A.

June, 1982



8313 550

FRAME - M3-4-5-6, WITH I.H.C. 446 ENG.

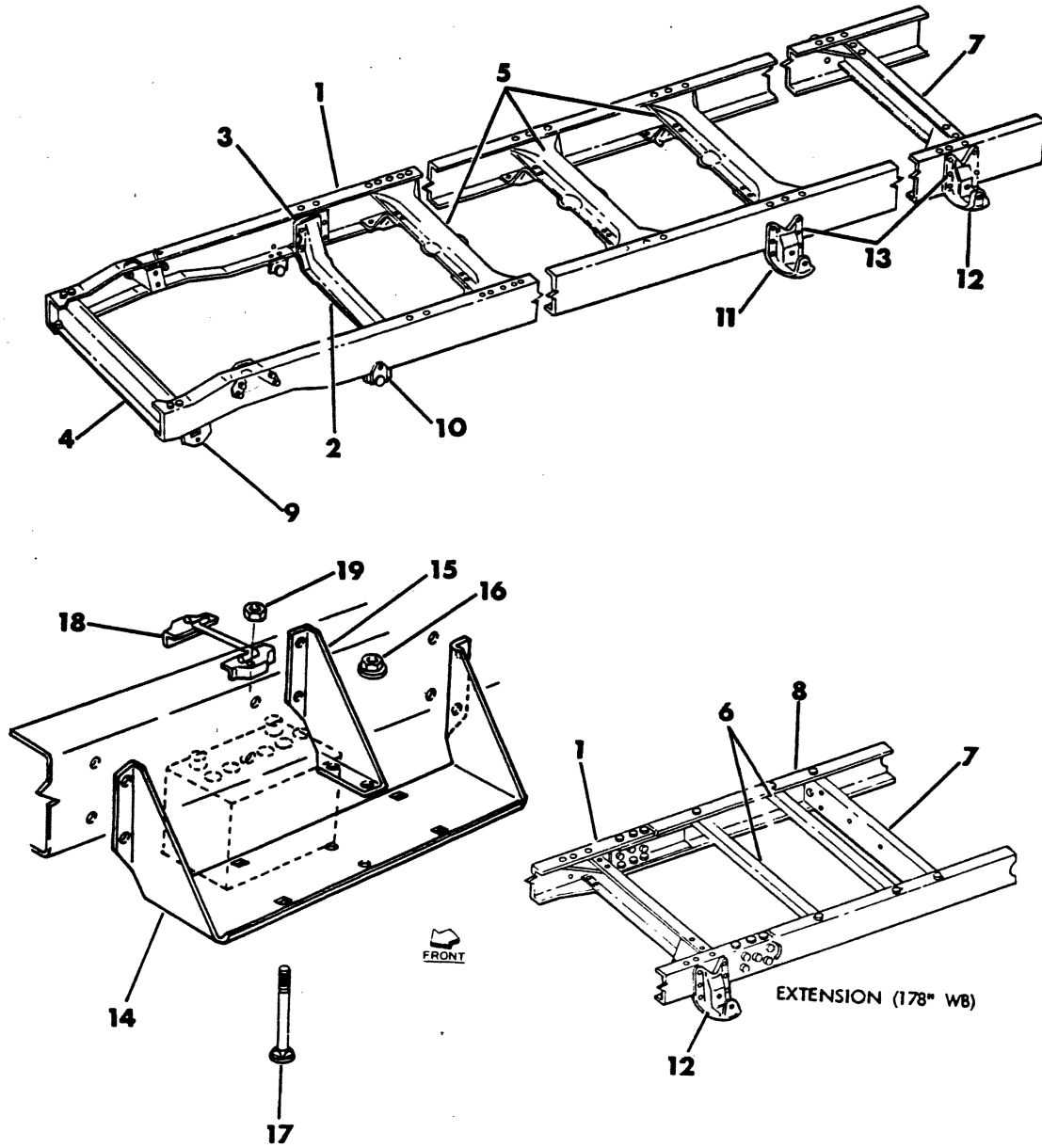

ITEM	PART NUMBER	QTY	MODEL	DESCRIPTION
<b>FRAME - M3-4-5-6, WITH I.H.C. 446 ENG.</b>				
1	4117 978		M3-4	FRAME, Assy. 137" W.B 1979-80-81
	4117 979		M4-5	159" W.B 1979-80
	4117 979		M3-4-5	159" W.B 1981
	4117 980		M5	178" W.B 1979-80
	4117 981		M6	208" W.B 1979
	4117 245		M6	ALL 1980-81
2	2832 541	1	M5-6	C/MBR Eng. Rear Support 1979-80
3	4117 206-7	1		BRACKET, Eng. Rear Supt. 1979
	3823 808-9	1		1980
	4029 723	7		BOLT, Eng. Frt. Supt. Brkt. 1979-80
4	3638 601	1		C/MBR Frame Frt. Susp. 1979-80
	6029 333	8	M4	NUT, And Washer Eng. Rear Supt. C/MBR. Brkt. Bolt
5	2908 212	AR		C/MBR Intermediate 1979-80-81
6	3634 434	AR	M5-6	C/MBR Fuel Tank M5 178" W.B. M6 All 1979
	4164 416	AR	M4-5-6	ALL 1980
7	4030 335	AR	M6	C/Mbr Frame Rear 1979-80-81
	4167 835	2	M6	BRACE, Rr Guide C/Mbr to Rail w/Tag Axle 1980 Not Shown)
8	3641 346-7	1	M5	EXTENSION, Frame Side Rail Rr 178W.B. 1979
	4164 422-3	1	M4-5	M4 137-159 W.B. M5 159-178 W.B. 1980
	4164 422-3	1	M3-4-5	M3,4 137" W.B. M3,4,5 159 W.B. M5 178 W.B. 1981
9	3638 670-1	1	M4-5	HANGER, Frt. Spring Frt. 1979-80-81
	4031 144-5	1	M6	1979-80-81
	3638 622	2		BUSHING, Frt. Sprng. Rr Brkt. (Not Shown) 1979-80
10	3638 624	2	M4-5-6	BRACKET, Front Spring Rr 1979-80
11	3823 273	4	M4-5-6	BRACKET, Rear Spring 1979-80
12	3823 273	2	M4-5-6	BRACKET, Rear Spring Rr 1979-80
	3638 622	2	M4-5-6	BUSHING, Frt. Spring Rr Bracket 1979-80-81
13	4112 683	2	M4-5-6	BRACE, Rear Sprng. Front Bracket 1979-80-81
	4112 683	4	M4-5-6	BRACE, Intermediate C/Mbr 1979-80-81
14	4164 067	1		TRAY, Battery 1979-80-81
15	4112 850	1		SUPPORT, Battery Tray 1979-80-81
16	271 502	8		NUT (7/16 -14 )
	2231 677	AR		GROMMET, Frame C/Mbr. 1979-80-81
	1924 103	AR		BOLT, Battery Hold Down Cover 1979-80-81
	3491 736	AR		COVER, Battery Hold Down 1979-80-81
	118 614	2		NUT, Battery Hold Down Cover Bolt
	4088 927	1		JACK, Assy (Up To 9-7-78)
	4089 657	1		After 9-7-78 12000 Lb.
	2906 719	1		HANDLE, Jack (Up To 9-7-78)
	4117 132	1		After 9-7-78
	3735 529	1	M4	WRENCH, w/Single or Dual Wheels (5/8 x 18-1) 1/8 Hex 1979-80
3735 528	1	M5-6	SOCKET, Wheel Wrench (3/4-16) 1979-80-81	

**LIGHT** A = All Sport Utility (Ramcharger). B = All Compact Models. D = Conventional Cab.  
**DUTY** AD = 2 Wheel Drive Only (Ramcharger). CB-MB = Compact Front Section Only. W = Conventional Cab 4 Wheel Drive.  
**CODES:** AW = 4 Wheel Drive Only (Ramcharger). P = Forward Control Chassis. M = Motor Home.

**MEDIUM-HEAVY CODES:** XNT = Low Cab Forward. D = Conventional Cab. S = School Bus. W = 4-Wheel Drive.

AR=Use as Required

#=New Part Number

Printed in U.S.A.

June, 1982

8313 600

## FRAME - WM300 EXPORT

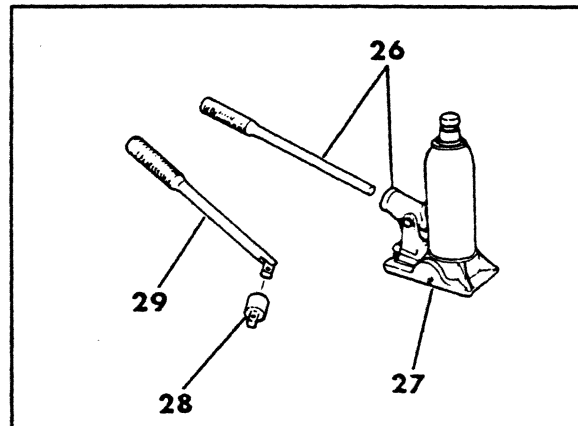
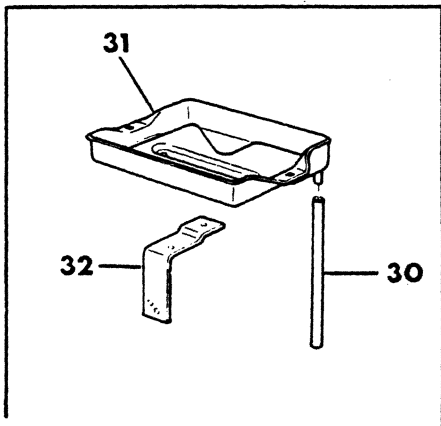
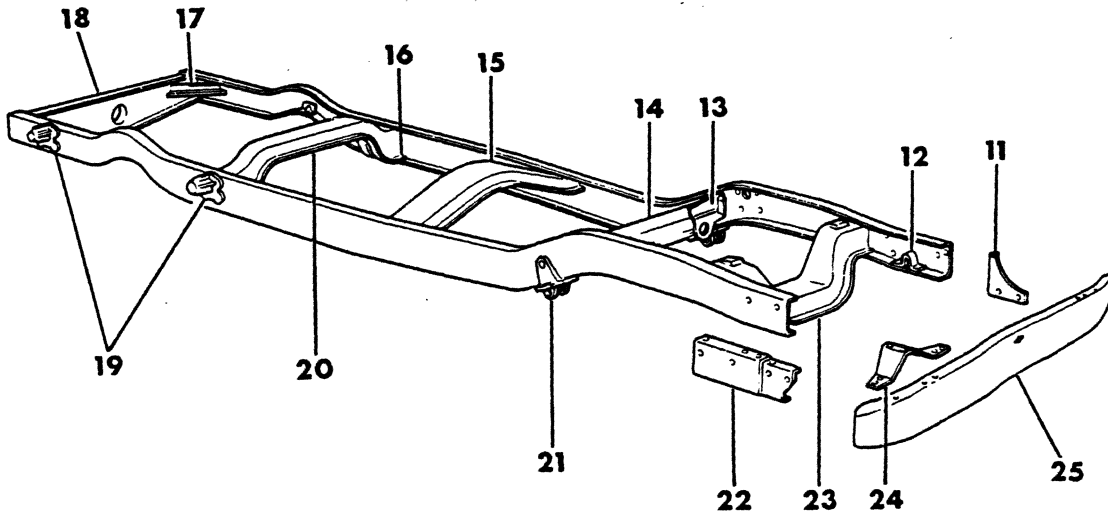
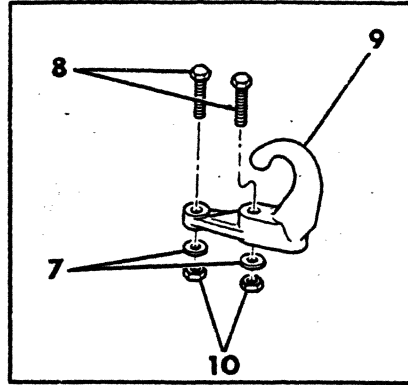
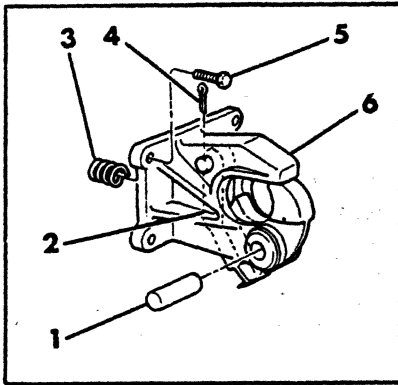

ITEM	PART NUMBER	QTY	MODEL	DESCRIPTION
------	-------------	-----	-------	-------------

FRAME - WM300 EXPORT

1	928 366	1		ROLLER, Latch
	928 367	1		PIN, Roller
2	928 364	1		LATCH, Pintle Hook
3	928 368	1		SPRING, Hook Latch
4	929 843	1		PIN, Latch
5	271 745	4		SCREW, Pintle Hook to Frm.
6	920 762	1		HOOK, Pintle Complete
	928 361	1		HOOK Only
7	6023 054	4		WASHER, Tow Hook Bolt
8	9419 523	2		BOLT, Hook to Frm. Frt.
	602 9834	2		REAR
9	1189 195	2		HOOK, Tow
10	6029 335	4		NUT, Tow Hook Bolt
11	1090 168-9	1		BRACKET, Supt
12	2513 291	2		HANGER, Frt. Sprg.
	594 254	2		BUSHING, Frt. Sprg. Hanger
13	3496 698	1		BRACKET, Frm. Eng. Fr. Supt. C/Mbr. Rt.
	3497 387	1		LEFT
	3497 385	1		BRACE, Eng. Fr. Supt.
14	3641 312	1		C/MBR. Eng. Fr. Supt.
15	3491 765	1		C/MBR. Frm. Transfer Case
	1270 930	1		BRACKET, Frt. Right
	1270 931	1		LEFT
	1270 934	1		REAR, Rt.
	1270 935	1		LEFT
17	1189 215	1		BRACE, Frm. Fr. C/Mbr.
18	1189 214	1		C/MBR. Frm. Fr.
19	1089 205	4		BRACKET, Fr. Sprg.
20		1		C/MBR. (Serv. in Ref. # 20)
21	1928 276	1		BRACKET, Frt. Sprg. Hanger RT.
	1928 277	1		LEFT
22	2225 696	1		EXTENSION, Side Rail w/Winch RT.
	2225 697	1		LEFT
23	3491 560	1		C/MBR. Frame Frt.
	2229 589	1		REINFORCMENT, Frm. Frt. C/Mbr.
	2505 884	2		GROMMET, Frm. C/Mbr.
24	921 484	1		BRACKET, Reinf. w/Winch Right
	921 485	1		LEFT
	923 750	1		w/o Winch Right
	923 751	1		LEFT
25	921 483	1		BUMPER, w/o Winch
	921 488	1		W/ Winch Right
	921 489	1		LEFT
26	3733 665	1		JACK and Handle, Hyd. 2 Ton
28	3735 528	1		SOCKET, Wheel Wrench
29	525 076	1		HANDLE, Socket
30	785 785	1		TUBE, Battery Tray Drain 1/2" I.D., 5/8" O.D.
31	921 793	1		TRAY, Battery w/59 Amp. Battery
	2512 904	1		w/70 Amp. Battery 1978-79

**LIGHT** A = All Sport Utility (Ramcharger). B = All Compact Models. D = Conventional Cab.  
**DUTY** AD = 2 Wheel Drive Only (Ramcharger). CB-MB = Compact Front Section Only. W = Conventional Cab 4 Wheel Drive.  
**CODES:** AW = 4 Wheel Drive Only (Ramcharger). P = Forward Control Chassis. M = Motor Home.

**MEDIUM-HEAVY CODES:** XNT = Low Cab Forward. D = Conventional Cab. S = School Bus. W = 4-Wheel Drive.

AR=Use as Required

# = New Part Number

Printed in U.S.A.

June, 1982

# 1978-81 LIGHT DUTY TRUCK PARTS CATALOG

FRAME & BUMPERS

ITEM	PART NUMBER	QTY	MODEL	DESCRIPTION
------	-------------	-----	-------	-------------

## FRAME - WM300 EXPORT

32	3491 758	1		SUPPORT, Tray
	1792 054	1		COVER, Battery Hold Down 59 Amp. Battery
	2512 893	1		70 Amp. Battery 1978-79
	1924 103	2		BOLT, Batt. Hold Down Cover

<b>LIGHT</b>	A = All Sport Utility (Ramcharger).	B = All Compact Models.	D = Conventional Cab.
<b>DUTY</b>	AD = 2 Wheel Drive Only (Ramcharger).	CB-MB = Compact Front Section Only.	W = Conventional Cab 4 Wheel Drive.
<b>CODES:</b>	AW = 4 Wheel Drive Only (Ramcharger).	P = Forward Control Chassis.	M = Motor Home.

**MEDIUM-HEAVY CODES:** XNT = Low Cab Forward. D = Conventional Cab. S = School Bus. W = 4-Wheel Drive.

AR=Use as Required

# =New Part Number

Printed in U.S.A.

June, 1982