

GROUP 7 - COOLING

COOLING SYSTEM ALL MODELS	Fig. 7-200
DIESEL ENGINE B-D-W BELTS,PULLEYS,COOLING SYSTEM	Fig. 7-850
FAN AND DRIVE BELT AND PULLEYS 225 ENGINE B-CB-MB	Fig. 7-900
FAN AND DRIVE BELT AND PULLEYS 225 ENGINE A-D-W MODELS	Fig. 7-925
FAN AND DRIVE BELTS AND PULLEYS 318, 360 ENG. B MODELS	Fig. 7-950
FAN AND DRIVE BELTS AND PULLEYS 318, 360 ENG. A-D-W MODELS	Fig. 7-975
FAN AND DRIVE BELTS AND PULLEYS 400- 440 Engine 1978	Fig. 7-1100
FAN AND DRIVE BELTS AND PULLEYS B 400 and 440 ENGINES 1978	Fig. 7-1200
FAN AND DRIVE BELTS AND PULLEYS MOTOR HOME	Fig. 7-1300
FAN BELTS AND PULLEYS MB3-4 440 ENGINE	Fig. 7-1225
FAN CHART A-B-D-W-P	Fig. 7-300
GRILLE AND ATTACHING PARTS A-D-W-RD 1979-80-81	Fig. 7-850
GRILLE AND COOLANT RESERVE TANK B-CB-MB 1979-80-81	Fig. 7-525
GRILLE AND COOLANT RESERVE TANK A-D-W 1978	Fig. 7-600
GRILLE AND COOLANT TANK B1-2-3 1978	Fig. 7-500
PULLEYS AND BELTS M3-4-5-6-446 ENG.	Fig. 7-1350
RADIATOR AND HOSES M-3-4-5-6	Fig. 7-800
RADIATOR AND HOSES M3-4-5-6 - I.H.C 446 ENG.	Fig. 7-810
RADIATOR CORE A-B-D-W-RD 1978	Fig. 7-100
RADIATOR CORE A-B-D-W-RD-M 1979-80	Fig. 7-105
RADIATOR, SHROUD AND HOSES P300	Fig. 7-700
THERMOSTAT AND WATER PUMP ALL LIGHT DUTY MODELS	Fig. 7-400
WATER PUMP FAN AND MOUNTING M3-4-5-6 -446 ENG.	Fig. 7-450

1978-81 LIGHT DUTY TRUCK PARTS CATALOG

COOLING

8307 100A

RADIATOR CORE A-B-D-W-RD 1978

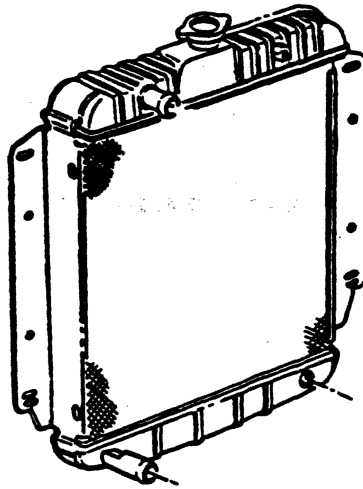

ENGINE	STAMPED PART NO.	SERVICE PART NO.	CORE SIZE
225 C. I.	3736 930	3736 930	19/1.25/ 9
	3736 931	3736 931	19/1.25/ 9
	3893 237	3893 237	22/1.5 /14
	3893 455	3893 455	22/1.25/12
318-360 C. I.	4032 886	3893 461	22/1.25/ 9
	4030 373	4036 927	26/1.25/14
	4032 887	3893 461	22/1.25/ 9
	4032 888	4036 927	26/1.25/13
	4032 889	4036 094	26/1.25/13
	4030 318	4036 094	26/1.25/14
	4030 319	4036 927	26/1.25/14
	3893 457	3893 461	22/1.25/13
	4036 927	4036 927	26/1.46/17
	3893 458	3893 461	22/1.5 /13
3827 617	3827 617	26/2.25/15	
400-440 C. I.	4032 889	4036 094	26/1.25/13
	3827 619	4086 796	26/2.25/15
	4086 796	4086 796	26/
	4037 118	4037 118	28/
	4039 032	4039 032	28/
318-360 C. I. Med. Duty	3894 560	3894 566	26/2.25/15
	3736 632	3736 632	26/1.46/16
	3894 216	3894 216	26/2.25/15
	3827 351	3827 351	26/1.46/13
361-413 C. I. Med. Duty	3898 260	3898 260	
	3898 262	3898 262	
	3898 261	3898 261	
Perkins Diesel	3821 668	3821 668	

ITEM	PART NUMBER	QTY	MODEL	DESCRIPTION
RADIATOR CORE				
A-B-D-W-RD 1978				
RADIATOR CORE 1978				
225	3736 930		A-B-D-W	Man Trans w/o inc. cooling
225	3736 931		A-B-CB-D-W	Auto Trans w/o inc. cooling
225	3893 455		A-B-CB-D-W	Auto or Man Trans. w/ inc. cooling
225	3893 237		D3-W3	Auto Trans. w/ inc. cooling
318-360	4032 888		A-B-D-W	Man Trans. w/ inc. cooling
318-360	4032 889		AD-B1-2-D1	Auto Trans.w/ inc. cooling
360	4032 889		CB	W/ inc. cooling
318-360	4032 889		W1-2-3	Auto. Trans. w/ inc. cooling
318-360	4032 889		AD	Auto. Trans. w/ inc. cooling
318-360	4032 889		AW	Auto. Trans.
318	4030 318		B3	Auto. Trans. w/ air cond
360	4030 318		B1	W/ air cond
360	4030 318		B2	Auto w/ air cond
360	4030 318		B3	Auto w/ inc cooling
318	4030 318		CB3	Auto w/ inc cooling 109", 127" W.B.
318	4030 318		CB3	W/o air cond 145" W.B.
360	4030 318		CB1	W/ air cond
360	4030 318		CB3	W/ inc cooling 109", 127" W.B.
360	4030 318		CB3	W/o air cond 145" W.B.
318-360	4030 318		D-W	Auto w/ inc cooling
360	4030 318		D-W4	Auto w/o air cond
360	4030 318		A	Auto w/ air cond
318	4030 319		B3	W/ air cond and Hvy. dty. trailer pkg.
360	4030 319		B3	W/ air cond w/o Hvy. Dty. trailer pkg.
318	4030 319		CB3	W/ air cond 145" W.B.
360	4030 319		CB3	W/ air cond
318-360	4030 319		MB3	
318-360	4030 319		D2-3, W2	W/ Air Cond w/o Hvy. Dty. Trailer Pkg.
318-360	4030 319		W3-4, D4	W/ Air Cond
360	3893 458		B1,3,CB1	W/o Air Cond or Inc. Cooling
360	3893 458		B2	Auto. Trans. w/o Inc Cooling
360	3893 458		CB3	W/o Air or Inc Cooling 109", 127" W.B.
318	3893 458		D2-3	Auto. Trans. w/o Air or Inc. Cooling
360	3893 458		D1, AD1	Auto. Trans. w/o Air or Inc. Cooling
360	3893 458		D2-3	W/o Air or Inc. Cooling
360	3893 458		W2-3	W/o Auto. Trans.
360	3893 458		AD	Auto. Trans. w/o Inc. Cooling
360	3827 617		B3	Air Cond. and Hvy. Dty. Trailer Pkg.
318-360	3827 617		D2-3,W2	Air Cond. and Hvy. Dty. Trailer Pkg.
	3827 617		RD2	All
318	4032 886		B1-2-3	W/o Auto Trans. or Inc. Cooling 109",127" W.B.
318	4032 886		CB3,D1,AD1	W/o Auto Trans. or Inc. Cooling
318	4030 373		B3	W/ Inc. Cooling or Air Cond. w/o Auto. Trans.
360	4030 373		B2	W/ Air Cond. w/o Auto. Trans.
360	4030 373		B3	W/ Inc. Cooling w/o Auto. Trans.
318	4030 373		CB3	w/Inc. Cooling or Air Cond. w/o Auto. Trans 109"-127" W.B.
318-360	4030 373		D,W2-3	w/Inc. Cooling w/o Auto. Trans.
360	4030 373		D,W1	w/Air Cond., w/o Auto Trans.

LIGHT A = All Sport Utility (Ramcharger).

B = All Compact Models.

D = Conventional Cab.

DUTY AD = 2 Wheel Drive Only (Ramcharger).

CB-MB = Compact Front Section Only.

W = Conventional Cab 4 Wheel Drive.

CODES: AW = 4 Wheel Drive Only (Ramcharger).

P = Forward Control Chassis.

M = Motor Home.

MEDIUM-HEAVY CODES: XNT = Low Cab Forward. D = Conventional Cab. S = School Bus. W = 4-Wheel Drive.

AR=Use as Required

= New Part Number

Printed in U.S.A.

June, 1982

1978-81 LIGHT DUTY TRUCK PARTS CATALOG

COOLING

ITEM	PART NUMBER	QTY	MODEL	DESCRIPTION
RADIATOR CORE				
A-B-D-W-RD 1978				
360	4030 373		D,W4	w/o Auto. Trans or Air Cond.
360	4030 373		AD,AW	w/Air Cond. w/o Auto. Trans.
318	4032 887		B1-2-3,CB3	w/Auto. Trans. w/o Air Cond. or Inc. Cooling 109"-127" W.B.
318	4032 887		D1,AD	w/Auto. Trans. w/o Air Cond. or Inc. Cooling
360	3893 457		A,B2,D,W1	w/o Auto. Trans. or Inc. Cooling
318	3893 457		AW,D,W1-2-3	w/o Auto. Trans. or Inc. Cooling
318-360	4032 889		W1-2-3	Auto. Trans. w/o Air Cond.
360-3	4037 118		CB,MB	All
400-440	4032 889		B,D,W1-2-3	w/o Inc. Cooling or Air Cond.
400-440	3827 619		A,D,W	w/Inc. Cooling or Air Cond.
400-440	4086 796		A,D,W	w/Air Cond.
400-440	4086 796		D,W4	All
400-440	4039 032		B1-2-3	w/Inc. Cooling
400-440	4039 032		CB,MB	w/o Inc. Cooling
400-440	4039 033		B3-CB-MB3,4	w/Air Cond.
	4164 108		D,W1-2	w/MMC Diesel Eng.

LIGHT	A = All Sport Utility (Ramcharger).	B = All Compact Models.	D = Conventional Cab.
DUTY	AD = 2 Wheel Drive Only (Ramcharger).	CB-MB = Compact Front Section Only.	W = Conventional Cab 4 Wheel Drive.
CODES:	AW = 4 Wheel Drive Only (Ramcharger).	P = Forward Control Chassis.	M = Motor Home.

MEDIUM-HEAVY CODES: XNT = Low Cab Forward. D = Conventional Cab. S = School Bus. W = 4-Wheel Drive.

AR=Use as Required

=New Part Number

Printed in U.S.A.

June, 1982

RADIATOR CORE
 A-B-D-W-RD-M 1979-80

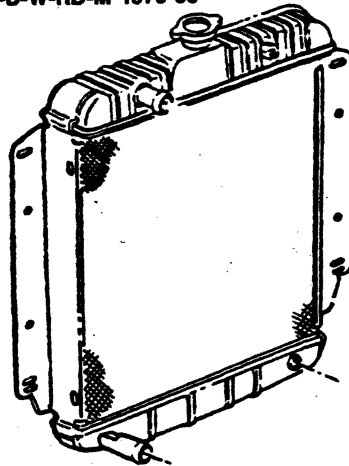

ENGINE	STAMPED PART NO.	SERVICE PART NO.	CORE SIZE
225 Eng.	4089 474	4089 474	19/ .81/
	4089 475	4089 475	19/ .81/
	4089 586	4089 586	28/ .81/ 1
	4089 566	4089 566	
318-360 Eng.	4088 036	4088 036	28/2.25/
	4088 473	4089 737	28/1.25/
	4089 457	4089 460	28/1.23/
	4089 458	4089 460	22/ .81/
	4089 459	4089 460	28/1.23/
	4089 460	4089 460	28/1.23/
	4088 472	4089 737	28/ .81/
	4089 567	4089 732	26/
	4089 568	4089 732	26/
	4089 569	4089 732	26/
	4089 582	4089 737	28/
	4089 731	4089 732	26/
	4089 732	4089 739	26/
	4089 733	4089 737	28/
	4089 737	4089 737	28/1.25/
	4115 541	4115 541	26/
4037 118	4037 118		
4115 442	4115 442	26/	
400-440 Eng.	4112 347	4112 347	28/2.25/
P3	2830 660	2830 660	
M3-4-5-6	4037 686	4037 685	
	4037 685	4037 685	
Diesel	4089 485	4089 485	26/

ITEM	PART NUMBER	QTY	MODEL	DESCRIPTION
RADIATOR CORE				
A-B-D-W-RD-M 1979-80				
RADIATOR CORE 1979				
225	4089 474		B1-2-3	Auto, Trans w/o Inc. Cooling or Air Cond.
	4089 474		AD,D,W1-2	Auto. Trans w/o Inc. Cooling or Air Cond.
318	4116 581		B1-2-3	Man. Trans. w/o Inc. Cooling or Air Cond.
	4116 581		A,D,W1-2	Man. Trans. w/o Inc. Cooling or Air Cond.
	4089 566		A,D,W1-2	w/Inc. Cooling or Air Cond.
	4089 586		B, CB	w/Inc. Cooling or Air Cond.
	4089 460		B1-2-3	Man. Trans. w/o Inc. Cooling or Air Cond.
	4089 460		B1-2-3	Auto. Trans. w/o Inc. Cooling or Air Cond.
	4089 460		CB3	w/o Inc. Cooling or Air Cond. 109"-127" W.B.
	4117 058		B1-2	Man. Trans. w/Inc. Cooling or Air Cond.
	4117 058		B1-2	Auto. Trans. w/Inc. Cooling or Air Cond.
	4117 058		CB3	w/Air Cond. 109"-127" W.B.
	4089 582		B2	Man. Trans. w/Inc. Cooling or Air Cond.
	4117 058		B3	Auto. Trans. w/Inc. Cooling or Air Cond.
	4117 058		CB3	w/Inc. Cooling 109"-127" W.B.
	4117 058		CB3	145" W.B. All
	4117 058		MB4	All
	4089 460		D2-3	Man. Trans. w/o Air Cond. or Inc. Cooling
4089 460		AD-D1	Man. Trans. w/o Air Cond. or Inc. Cooling	
4089 732		AD-D1	Man. Trans. w/Air Cond. or Inc. Cooling	
4089 460		AD-D1	Auto. Trans. w/Air Cond. or Inc. Cooling	
4089 460		D2-3	Auto. Trans. w/o Air Cond. or Inc. Cooling	
4089 732		D2,3	Man. Trans. w/inc. cooling	
4089 732		AD,D1	Auto. Trans. w/ inc. cooling	
4089 732		D2,3	Auto. Trans. w/ inc. cooling	
4089 732		D2,3	Auto. Trans. w/air cond. w/o H.D.trailer towing	
4115 541		D2,3	Auto. Trans. w/Air Cond., w/H.D.Trailer Towing	
4089 460		AW,W1-2	Man. Trans. w/o air cond. or inc. cooling	
4089 732		AW,W1-2	Auto. Trans. w/o air cond. or inc. cooling	
4089 732		W2	Man. Trans. w/ inc. cooling	
4089 732		AW,W1	Man. Trans. w/air cond. or inc. cooling	
4089 732		W2	Auto. Trans. w/inc. cooling	
4089 732		W2	With A/C and w/o HD Trailer Tow Pkg.	
4115 541		W2	With A/C and HD Trailer Tow Pkg.	
4115 541		R2	All Eng.	
360	4117 058		B2	Man. Trans. w/air cond. or inc. cooling
	4117 058		B2-3	Auto. Trans. w/Air cond. or Inc. Cooling
	4117 058		CB,MB3-4	1979
	4089 460		B2	Man. Trans. w/o Air Cond. or Inc. Cooling
	4117 058		B2,3	With A/C, Inc. Cooling and HD Duty Trailer Tow Pkg.
	4117 058		CB,MB 3-4	w/Inc. Cooling w/AC w/HD Trailer Tow Pkg.
	4089 460		B2	Auto.Trans. w/o air cond. or inc. cooling
	4117 058		B2-3-CB-MB	Auto.Trans. w/Inc. Cooling or Air. Cond.
	4088 036		B-CB3-4	All 1979
	4088 036		MB4	360-3 Eng. 1979
	4117 058		B3	w/ air cond. or inc. cooling
	4117 058		CB3	All
4117 058		MB3-4	All	

LIGHT	A = All Sport Utility (Ramcharger).	B = All Compact Models.	D = Conventional Cab.
DUTY	AD = 2 Wheel Drive Only (Ramcharger).	CB-MB = Compact Front Section Only.	W = Conventional Cab 4 Wheel Drive.
CODES:	AW = 4 Wheel Drive Only (Ramcharger).	P = Forward Control Chassis.	M = Motor Home.
MEDIUM-HEAVY CODES: XNT = Low Cab Forward. D = Conventional Cab. S = School Bus. W = 4-Wheel Drive.			

AR=Use as Required

= New Part Number

Printed in U.S.A.

June, 1982

1978-81 LIGHT DUTY TRUCK PARTS CATALOG

COOLING

ITEM	PART NUMBER	QTY	MODEL	DESCRIPTION
RADIATOR CORE				
A-B-D-W-RD-M 1979-80				
	4089 460		A,D,W1	Man. Trans. w/o air cond. or inc. cooling
	4089 732		A,D,W1	Auto. Trans. w/ air cond.
	4089 732		D,W2-3	Auto. Trans. w/ inc. cooling
	4089 732		D4	360 Eng. w/Auto trans. w/o Air. Cond.
	4089 732		W4	Auto. Trans. w/o air cond.
	4089 460		AD,D1	Auto. Trans. w/o inc. cooling or air cond.
	4089 460		W2-3	Man. trans.
	4089 460		D2-3	w/o air cond. or inc. cooling
	4115 541		D2-3,W2	w/ air cond. and H.D. trailer towing pkg.
	4115 541		RD2	All Eng.
	4089 732		D2-3,W2	w/ air cond. w/o H.D. trailer towing pkg.
	4089 732		D4,W3-4	w/air cond.
	4089 732		D1	360 Hi. performance eng.
	4089 732		A,D,W1	Man. Trans. w/Air Cond.
	4089 732		D,W2-3	Man. trans. w/ inc. cooling
	4089 732		D,W4	Man. trans. w/o air cond.
	4112 347		CB,MB	400-440 Eng.
	4164 108		D,W1-2	w/MMC Diesel Eng.
RADIATOR CORE 1980				
225	4164 163		B-CB3	W/o Air Cond. Or Inc. Cooling
	4140 267		B-CB3	W/Max. Cooling
	4164 153		D-W AD1	W/o Air Cond.
	4140 241		D-W AD1	w/Max. Cooling
	4140 227		AD-W1,2	w/o Inc. Cooling Or Air Cond.
318-360	4167 350		B3-CB-MB3-4	w/Max. Cooling
	4164 146		B1-2-3	318-360 Eng. All Trans. w/o Air Cond
	4164 146		D-AD1-W	318-360 Eng. All Trans. w/o Air Cond.
	4167 354		D-W	w/Max. Cooling 1980
	4167 354		D-W	Auto. Trans. w/Max. Cooling w/Aux. Oil Cooler Trans. 1981
	4167 354		RD2	360-4 Eng. w/Max. Cooling 1980-81
	4167 350		B3,CB,MB3-4	w/Max. Cooling 1980
	4140 668		B3,CB,MB3-4	1981
	4164 152		B1,2,3	318 Eng. w/Air. Cond. Or Inc. Cooling
	4164 152		B2,3	360 Eng. B3 W/Std. Cooling B2 W/Max. Cooling
	4164 152		CB3	318-360 Eng. 127 W.B. W/Air Cond.
	4164 156		D1	360 Eng. W/Max. Cooling
	4164 156		D,W,AD,AW	318-360 Eng. W/Max. Cooling
	4164 108		D,W1-2	W/MMC Diesel Eng.
	4164 108		D,W1-2	RADIATOR CROSS REFERENCE 1981

LIGHT A = All Sport Utility (Ramcharger). B = All Compact Models. D = Conventional Cab.
DUTY AD = 2 Wheel Drive Only (Ramcharger). CB-MB = Compact Front Section Only. W = Conventional Cab 4 Wheel Drive.
CODES: AW = 4 Wheel Drive Only (Ramcharger). P = Forward Control Chassis. M = Motor Home.

MEDIUM-HEAVY CODES: XNT = Low Cab Forward. D = Conventional Cab. S = School Bus. W = 4-Wheel Drive.

AR=Use as Required

= New Part Number

Printed in U.S.A.

June, 1982

COOLING SYSTEM
ALL MODELS

8307 200A

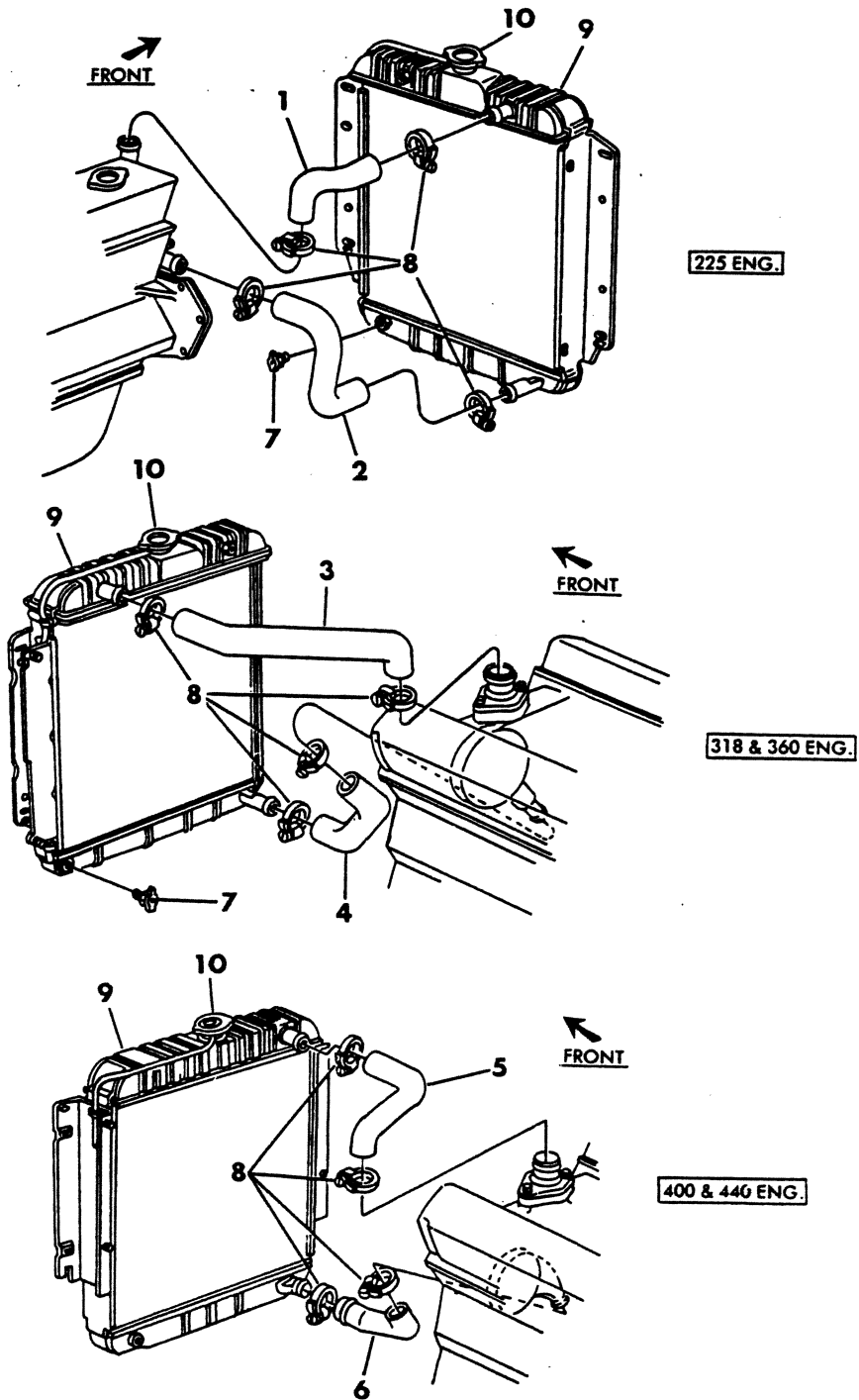

ITEM	PART NUMBER	QTY	MODEL	DESCRIPTION
COOLING SYSTEM				
ALL MODELS				
1	3780 647		A-B-D-W	HOSE, Inlet 225 eng. w/o air cond. or inc. cooling 1978
	2960 783		B	225 eng. w/ air cond. or inc. cooling 1978
	2863 291		A-D-W	225 eng. w/ air cond. or inc. cooling 1978
	4036 197		B-CB	225 Eng. w/o Air Cond. or Inc. Cooling 1979
	4036 197		B1-2	225 Eng. W/Std. Cooling 1980-81
	4088 485		B-CB	225 eng. w/ air cond. or inc. cooling 1979
	4088 485		B-CB	225 eng. W/Std. Cooling 1980-81
	4089 578		A-D-W	225 Eng. w/o Air Cond. or Inc. Cooling 1979-80-81
	3870 128		A-D-W	225 Eng. w/Air Cond. or Inc. Cooling 1979-80-81
	3870 128		A-D-W	225 Eng. W/Std. Cooling 1980
	2	4026 106		B
3780 656			A-D-W	225 eng. 1978
4115 584			B-CB	225 Eng.w/o Air Cond. or Inc. Cooling 1979-80-81
4088 486			B-CB	225 Eng. w/Air Cond. or Inc. Cooling 1979
4088 486			B-CB	225 Eng. W/Std. Cooling 1980-81
4089 577			A-D-W	225 Eng. w/o Air Cond. or Inc. Cooling 1979-80
3870 113			A-D-W	225 Eng. w/Air Cond. or Inc. Cooling 1979
3870 113			A-D-W	225 Eng. W/Std. Cooling 1980-81
3	3780 659		A-B-D-W	HOSE, Inlet 318,360 eng. w/o air cond. or inc. cooling 22" 1978-
	3780 662		A-D-W	318,360 eng. w/ air cond. or inc. cooling 26" 1978
	3497 274		B	360, Eng. w/ Air Cond. 1978
	3780 662		B	360, Eng. w/o Air Cond. 1978-
	4036 183		B-CB-MB	360-3 eng. w/o air cond. or inc. cooling 28" 1978-
	4036 184		B-CB-MB	360-3 eng. w/ air cond. or inc. cooling 28" 1978
	4115 606		B-CB-MB	318,360 Eng. 1979-
	4167 345		B-CB-MB	1980-81
	4115 607		A-D-W	318-360 Eng. D1 Hi. Perf 1979-80-81
	4115 431		D,W2-3	318,360 Eng. w/ Air Cond. & HD Trailer Tow Pkg. 1979
	4115 431		RD2	ALL Eng. 1979-80-81
4	4115 431		D,W	318-360 Eng. w/Max. Cooling 1980-81
	3780 605		A-B-D-W	HOSE, Outlet 318,360 Eng. 1978
	4036 185		B-CB-MB	360-3 eng. 1978
	4115 585		A-B-D-W	318,360 Eng. w/o Air Cond. or Inc. Cooling 1979-80-81
	4036 186	1	B-CB-MB	318,360 eng. w/air cond., w/heavy duty pkg., w/trailer tow pkg., 1979
	4088 746		B	318,360 Eng. w/ Air Cond. or Inc. Cooling w/o Heavy Duty Trl. Pkg. 1979-80-81
	4088 746		CB	318 Eng. w/Air Cond. or Inc. Cooling 109",127"W.B. 1979-80-81
	4088 746		CB-MB	CB3 145" W.B. MB All 1979-80-81
	3780 605		A-D-W	318,360 w/Air Cond. or Inc. Cooling 1979-80-81
	3780 605		W,AW1	318,360 Eng. w/Std. Cooling w/Auto. Trans. 1981
	5	3821 460		B-CB-MB
3827 808			B-CB-MB	400,440 eng. w/ air cond or inc. cooling 28" 1978
4086 337			A-D-W	400,440 Eng. w/o Air Cond. or Inc. Cooling 1978
3733 605			A-D-W	400,440 Eng. w/Air Cond. or Inc. Cooling 1978-79
3733 605			D,W4	All
4088 026			MB	400,440 Eng. 1979
4116 935			D-W	W/Diesel Eng. 1979-80
6	3821 461		B	HOSE, Outlet 400,440 Eng w/Air Cond. or Inc. Cooling 28" 1978
	3821 462		B	400,440 Eng w/o Air Cond. or Inc. Cooling 26" 1978

LIGHT A = All Sport Utility (Ramcharger).

B = All Compact Models.

D = Conventional Cab.

DUTY AD = 2 Wheel Drive Only (Ramcharger).

CB-MB = Compact Front Section Only.

W = Conventional Cab 4 Wheel Drive.

CODES: AW = 4 Wheel Drive Only (Ramcharger).

P = Forward Control Chassis.

M = Motor Home.

MEDIUM-HEAVY CODES: XNT = Low Cab Forward. D = Conventional Cab. S = School Bus. W = 4-Wheel Drive.

AR=Use as Required

=New Part Number

Printed in U.S.A.

June, 1982

1978-81 LIGHT DUTY TRUCK PARTS CATALOG

COOLING

ITEM	PART NUMBER	QTY	MODEL	DESCRIPTION
------	-------------	-----	-------	-------------

COOLING SYSTEM ALL MODELS

	3821 461		CB-MB	400,440 eng all 1978
	4088 027		MB	1979
	4026 102		A-D-W	400,440 Eng. 1978
	4037 941		D-W	W/Diesel Eng.
7	1686 198		All	DRAINCOCK, radiator
8	2448 763		All	CLAMP, adj. 1.50 to 1.75" Dia.
9				RADIATOR (refer to radiator section this group)
10	3781.830			CAP, Radiator

FOLLOWING ITEMS NOT SHOWN

	3837 005			HOSE, Rad. Overflow 3/32 I.D. Roll Stock 1978
	3827 809		MB 3-4	SHIELD, Rad. Inlet Hose 400,440 Eng. 1978-79

LIGHT	A = All Sport Utility (Ramcharger).	B = All Compact Models.	D = Conventional Cab.
DUTY	AD = 2 Wheel Drive Only (Ramcharger).	CB-MB = Compact Front Section Only.	W = Conventional Cab 4 Wheel Drive.
CODES:	AW = 4 Wheel Drive Only (Ramcharger).	P = Forward Control Chassis.	M = Motor Home.

MEDIUM-HEAVY CODES: XNT = Low Cab Forward. D = Conventional Cab. S = School Bus. W = 4-Wheel Drive.

AR=Use as Required # =New Part Number Printed in U.S.A. June, 1982

FAN CHART A-B-D-W-P

8307 300B

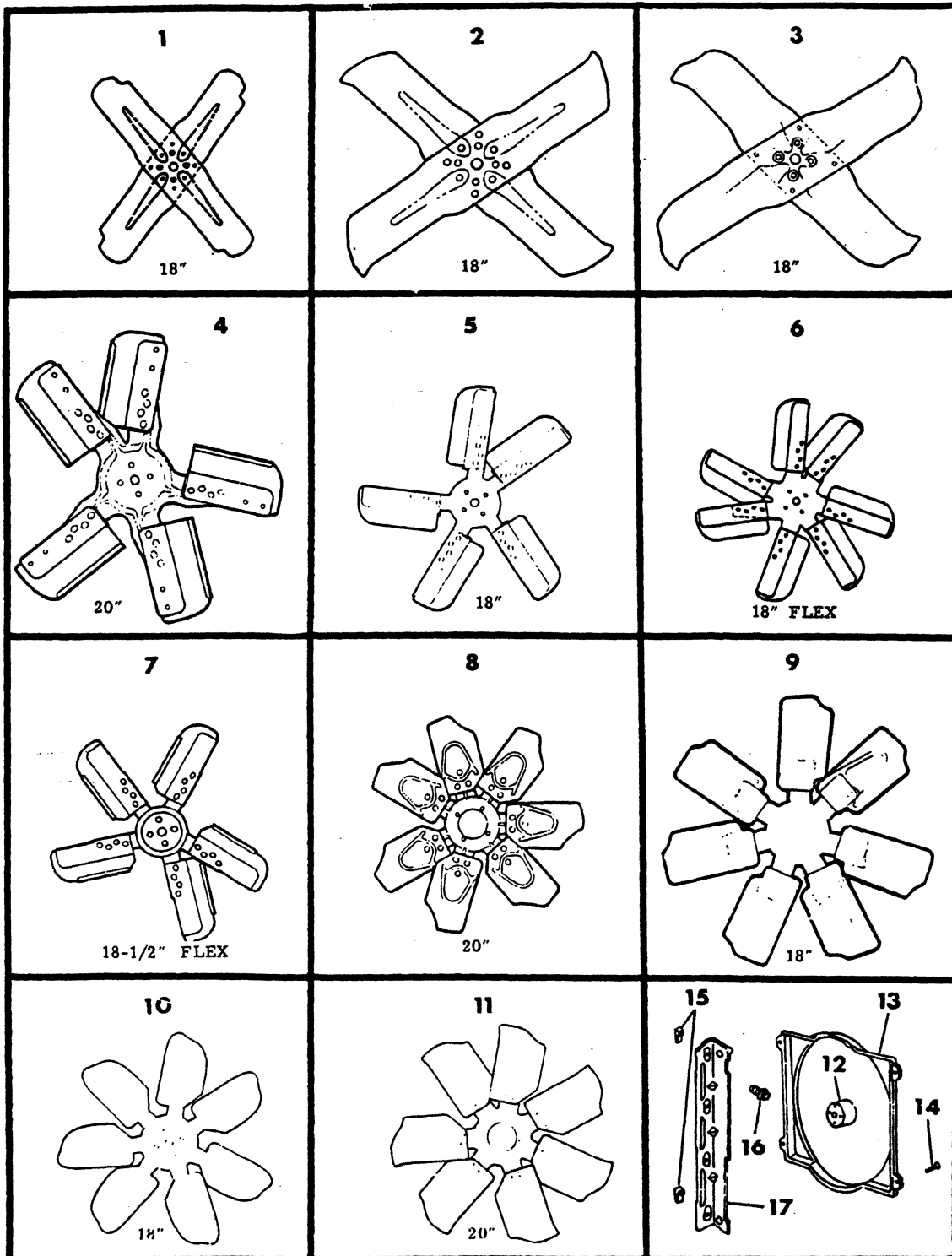

ITEM	PART NUMBER	QTY	MODEL	DESCRIPTION
FAN CHART				
A-B-D-W-P				
1	4117 005	1	A-B-D-W	FAN, Eng. Coolant w/225 Eng. w/o Air Cond. or Inc. Cooling
	3462 185	1	B-D-W	w/Diesel Eng./ 225 Eng. w/ Max. Cooling And Std. Cooling
2	4088 067	1	D,W3	225 Eng. 1978-79
	4088 067	1	A,B,CB-W	318,360 Eng. w/o Sound Control (HK4) w/Air Cond. or Inc. Cooling (CB3 109",127" W.B.) 1978-79
3	4106 007	1	A-B-D-W	318,360 Eng. w/Inc. Cooling w/o Sound Control (CB3109",127" W.B.) 1978-79
	4106 007	1	D,W4	All w/o Sound Control or Air Cond. 1978-79
4	4117 083	1	A-B-D-W	318,360 w/Air Cond. or Inc. Cooling (CB3 109", 127" W.B.) 1978-79
	4117 083	1	CB3,MB3-4	318,360 All (CB3 145" W.B.)1978-79
	4117 083	1	RD2	All 1978-79
5	4071 034	1	A,B,D,W,CB	225,318,360 Eng. w/Air Cond. or Inc. Cooling 1978-79
	4140 063	1	A,B,D,W,CB	225 Eng. W/Max. Cooling 1980-81
	4140 063	1	A,B,D,W	318-360 Eng. W/Std. Cooling 1980-81
	4071 034	1	W1-2	318,360 Eng. w/Sound Control (HK4) w/Pwr. Strg. w/Snow Plow 1978-79
	4071 034	1	AW,W1-2	225 Eng. w/Auto w/o Air Cond. or Inc. Cooling 1978-79
6	3870 107	1	A-B-D-W	318 Eng. w/Sound Control (HK4) Light or Med. Duty Cycle 1978-79
	3870 107	1	W1-2-AW1	318-360 Eng. w/ Snow Plow 1978-79
7	4117 104	1	A-B-D-W	318,360 Eng. w/Sound Control (HK4) w/o Air Cond. or Inc. Cooling 1978-79
	4117 104	1	CB,MB	318,360 Eng. w/o Air Cond. 1978
8	3462 149	1	A-B-D-W	400,440 Eng. 1978
9	2863 215	1	D1	360 HI Performance Eng. 1978-79
10	2863 224	1	P3	All 1978
11	4117 084	1	M	All
	4117 084	1	CB-MB	360, 400, 440 Eng. 1978-79
	4117 084	1	B,D,W,AW	318-360 Eng. W/Air Cond. 1980-81
	4117 084	1	B Cb-MB	360,440 Eng. 1978-79
	4117 084	1	D-AD-AW-RD	360,Eng. w/ Inc. Cooling 1980-81
12	1851 961	1	B	SPACER, Fan 225 Eng. w/o Sound Control HK4 1.30" lg. 1978-79
	1851 961	1	D-W1-2-AD1	w/225 Eng. w/o Inc. Cooling 1980-81
	2846 166	1	D1	w/225 Eng. Man. Trans. w/o Air. Cond. 1981
	2120 510	1	B	225 Eng. w/Sound Control HK4 1.60" lg. 1978
	2863 219	1	A,B,D	318,360 Eng. w/o Sound Control HK4 w/Air Cond. or Inc. Cooling 1.86" lg. 1978-79
	2863 219	1	CB	318,360 Eng. w/o Sound Control w/Air Cond. or Inc. Cooling (109,127" W.B.) 1978-79
	2863 219	1	A,D,W1-2	225 Eng. w/Air Cond. or Inc. Cooling 1.86" lg.
	2863 219	1	D,W3	225 Eng. All 1.86" lg.
	2265 036	1	B	318,360 Eng. w/Sound Control (HK4) 1978-79
	2265 036	1	B	225 Eng. 1980
	2120 130	1	A,B,D,W1-2	225 Eng. w/o Air Cond. or Inc. Cooling 2.38 lg. 1978
	4117 085	1	A,B,D,W1-2	1979
	1825 956	1	B-CB	225 Eng. 1980
	2120 130	1	A,B,D	318,360 Eng. w/Air Cond. or Inc. Cooling 2.38" lg. 1978
	2120 130	1	MB3-4,D,W4,	225,318,360 Eng. 2.38" lg. 1978
	4117 085	1	MB3-4,D,W4,	1979-80
	2120 130	1	RD	225,318,360 Eng. 2.38" lg. 1978

LIGHT A = All Sport Utility (Ramcharger).

B = All Compact Models.

D = Conventional Cab.

DUTY AD = 2 Wheel Drive Only (Ramcharger).

CB-MB = Compact Front Section Only.

W = Conventional Cab 4 Wheel Drive.

CODES: AW = 4 Wheel Drive Only (Ramcharger).

P = Forward Control Chassis.

M = Motor Home.

MEDIUM-HEAVY CODES: XNT = Low Cab Forward. D = Conventional Cab. S = School Bus. W = 4-Wheel Drive.

AR = Use as Required

= New Part Number

Printed in U.S.A.

June, 1982

1978-81 LIGHT DUTY TRUCK PARTS CATALOG

COOLING

ITEM	PART NUMBER	QTY	MODEL	DESCRIPTION
------	-------------	-----	-------	-------------

FAN CHART A-B-D-W-P

	4117 085	1	RD	1979
	4117 085	1	RD	1979-80
	2120 130	1	AW,W	318,360 Eng. w/Auto. Trans. w/Air Cond. or inc. Cooling 2.38" lg. 1978-79
	4117 085	1	AW,W	1979-80
	1853 021	1	P3	All 44 lg. 1978

FAN SHROUDS 1978

ITEM	PART NUMBER	MODEL	DESCRIPTION
13	2998 327		FAN, w/225 Eng.
	3828 288	B3,CB3	318,360 Eng. w/o Inc. Cooling (CB3 109",127" W.B.)
	3828 291	B,CB	318,360 Eng. w/Inc. Cooling (CB3 109",127" W.B.)
	3828 291	CB,MB3-4	318,360 Eng. w/o Inc. Cooling (CB3 145" W.B.)
	3828 289	D4	360 Eng. w/o Air Cond.
	3828 290	D4	360 Eng. w/Air Cond.
	4036 081	CB,MB4	360-3 Eng.
	3828 289	AD,D	318,360 Eng. w/Inc. Cooling
	3828 289	RD,D4	318 Eng. w/o Air Cond.
	3828 288	A,B,D	318,360 Eng. w/o Inc. Cooling
	3828 290	A,D,RD,W	318,360 Eng. w/Air Cond.
	3828 289	AW,W	318,360 Eng. w/Auto. Trans.
	3828 288	AW,W	318,360 Eng. w/Man. Trans.
	4039 031	B	400,440 Eng. w/Inc. Cooling
	4039 031	CB,MB	400,440 Eng. All
	3820 918	B	400,440 Eng. w/o Inc. Cooling
	3733 339	A,D,W	400,440 Eng. w/Air Cond.
	3733 339	D4	400,440 Eng. All
	3828 290	A,D,W	400,440 Eng. w/o Air Cond.
	4037 939	D,W	w/Diesel Eng.

1979-80-81 FAN SHROUDS

	4088 734	B,CB	225 Eng. w/o Air Cond. or Inc. Cooling 19" Core 1979
	4088 734	B1-2	225 Eng. w/o Air Cond. or Inc. Cooling 19" Core 1980
	4089 728	B,CB	225 Eng. w/Inc. Cooling 28" Core 1979
	4089 728	B,CB	225 Eng. w/o Air Cond. or Inc. Cooling 1980
	4089 572	A,D,W1-2	225 Eng. w/Air Cond. or Inc. Cooling 1979-80
	4089 572	D,W	225 Eng. w/Max. Cooling 1981
	4089 572	D,W3	225 Eng. Std. 1979-80
	4089 572	W1-2	225 Eng. Auto. w/o Air Cond. or Inc. Cooling 1979-80
	3869 836	D1	225 Eng. Man. Trans. w/Std. Cooling 1981
	4112 027	DW1-2	225 Eng. Man. Trans. w/Std. Cooling 1980-81
	4112 027	D2,W1-2	225 Eng. Man. Trans. w/Std. Cooling 1981
	4088 731	B,CB	318,360 Eng. w/o Inc. Cooling (CB3 109",127" W.B.)22" Core 1979
	4088 731	B1-2	318,360 Eng. w/o Inc. Cooling 1980
	4088 731	B1-2-3	1981
	4088 737	B,CB	318,360 Eng. w/Inc. Cooling (CB3 109",127" W.B.) 28" Core 1979-80
			(EXCEPT TALL TYPE)
	4088 737	B,CB3	318,360 Eng. w/Air. Cond. 1981
	4088 737	CB	318,360 Eng.(CB3 145" W.B.,MB All) 28" Core 1979
	4088 737	CB3	318,360 Eng.127" W.B. 1980
	4088 737	MB2	ALL Eng. w/Max. Cooling 1981

LIGHT	A = All Sport Utility (Ramcharger).	B = All Compact Models.	D = Conventional Cab.
DUTY	AD = 2 Wheel Drive Only (Ramcharger).	CB-MB = Compact Front Section Only.	W = Conventional Cab 4 Wheel Drive.
CODES:	AW = 4 Wheel Drive Only (Ramcharger).	P = Forward Control Chassis.	M = Motor Home.

MEDIUM-HEAVY CODES: XNT = Low Cab Forward. D = Conventional Cab. S = School Bus. W = 4-Wheel Drive.

AR=Use as Required

= New Part Number

Printed in U.S.A.

June, 1982

ITEM	PART NUMBER	QTY	MODEL	DESCRIPTION
------	-------------	-----	-------	-------------

FAN CHART
A-B-D-W-P

	4088 035		CB,MB4	360-3 Eng. All 28" Core 1979-80 (TALL TYPE)
	4088 035		B2-3-CB-MB	318-360 Eng. w/Air Cond. 28" Core 1979
	4088 035		B3-Cb-MB3-4	318-360 Eng. w/Max. Cooling 1980-81
	4089 573		A,D,W	318,360 Eng. w/Inc. Cooling
	4089 573		D,W4	318,360 Eng. w/o Air Cond.
	4089 573		D1	360 Hi. Performance Eng.
	4089 573		AW,W1-2	318,360 Eng. Auto. Trans. w/o Air Cond. 1979-80
	4089 574		A,D,W	318,360 Eng. w/Air Cond. 1979-80-81
	4089 574		D1	w/Hi Perf. Eng. 1980
	4089 575		D	318,360 Eng. w/o Air Cond. or Inc. Cooling 1979-80-81
	4089 575		A,W	318,360 Eng. Auto. Trans. w/o Air Cond. or Inc. Cooling 1979-80-81
	3733 339		D,W,RD2	318,360 Eng. w/Air Cond. and HD Trailer Tow Pkg. 1979
	3733 339		D,W,RD2	318,360 Eng. w/Max. Cooling 1980-81
	4036 082		MB3-4	400,440 Eng. All 1979
	4036 204		B	w/Diesel Eng. 1979
14	6029 887			SCREW, Fan Shroud 1978-79
15	6000 124			NUT & Retainer 1978
16	6023 092			SCREW 1/4- 20 x 1/2 1978
17	2949 176			BRACKET, Rad. Core Fan Shroud Mtg. 1978

LIGHT	A = All Sport Utility (Ramcharger).	B = All Compact Models.	D = Conventional Cab.
DUTY	AD = 2 Wheel Drive Only (Ramcharger).	CB-MB = Compact Front Section Only.	W = Conventional Cab 4 Wheel Drive.
CODES:	AW = 4 Wheel Drive Only (Ramcharger).	P = Forward Control Chassis.	M = Motor Home.

MEDIUM-HEAVY CODES: XNT = Low Cab Forward. D = Conventional Cab. S = School Bus. W = 4-Wheel Drive.

AR=Use as Required

= New Part Number

Printed in U.S.A.

June, 1982

THERMOSTAT AND WATER PUMP ALL LIGHT DUTY MODELS

8307 400

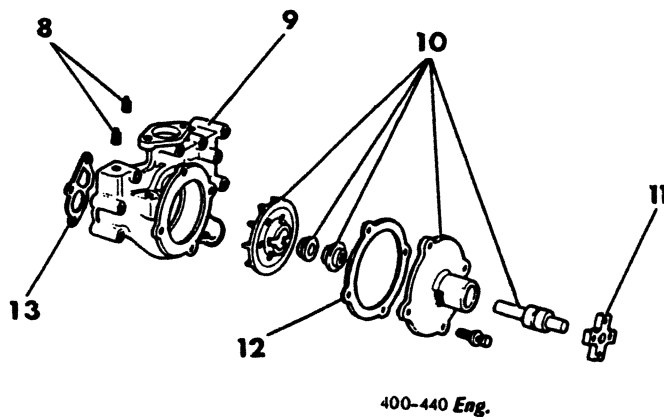
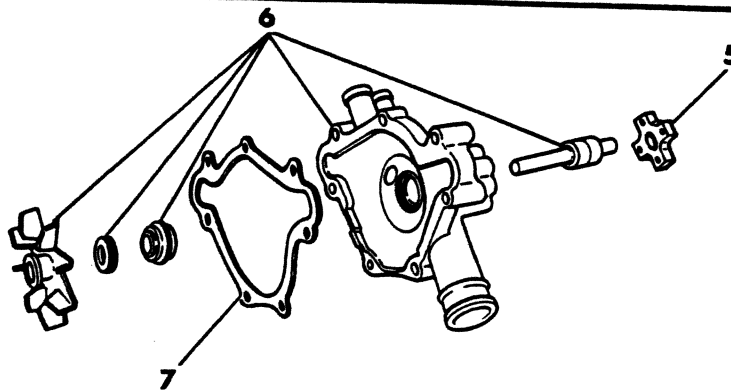
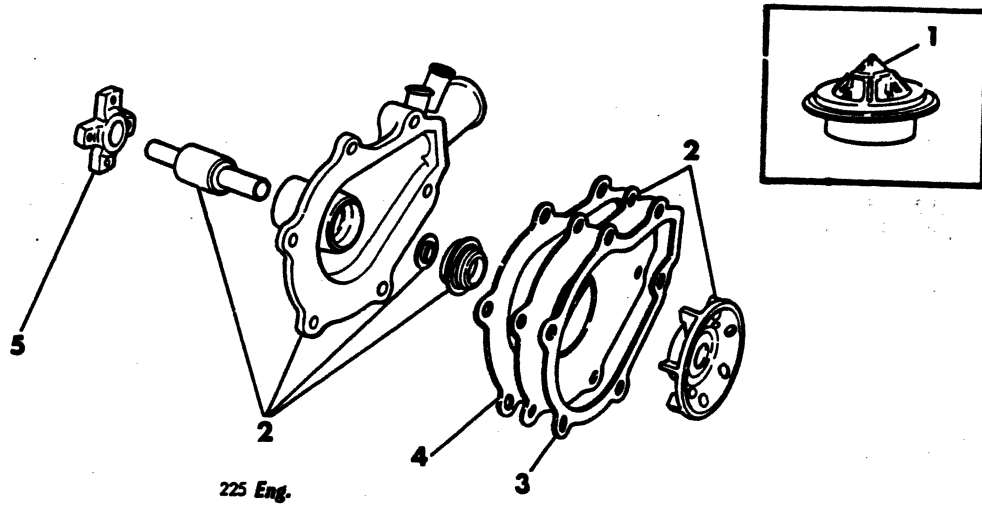

ITEM	PART NUMBER	QTY	MODEL	DESCRIPTION
THERMOSTAT AND WATER PUMP ALL LIGHT DUTY MODELS				
1	4131 068	1		THERMOSTAT, 195 Degrees, 6 Cyl. And 8 Cyl. 1978
	4131 068	1	M3,4	360-3 Eng. 1978
	4131 240	1		1979-80-81
	4131 240	1	M3,4	360-3 Eng. 1979-80-81
	3512 998	1		185 Degrees, 8 cyl. 1978
	4131 239	1		1979
	3418 459	1		195 Degrees, 8 cyl. w/ Light Duty Cycle And Cat. Conv. 1978
2	4106 034	1		PUMP ASSY, Water 1978
	4131 243	1		1979-80-81
	180 124	AR		SCREW, Wtr. Pump Attach.
	1947 643	1		NIPPLE, Pump By-Pass
3	1947 521	1		GASKET, Body
4	1947 523	1		GASKET, Pump intermediate plate
5	3671 525	1		HUB, Fan
6	3780 108	1	MB 3-4	PUMP ASSY, Water 318-360 Eng 1978-79
	3837 641	1	D1	360 Hi-Perf. CB,MB w/360 Eng. w/Air Cond.
	3837 641	1		318-360 Eng. 1978-79-80
	3780 109	1		1981
	3837 641	1	M3,4	360-3 Eng. 1980
	3780 109	1		1981
	2402 903	1		NIPPLE, Pump By-Pass
7	2129 013	1		GASKET, Body
	2129 013	1	M3,4	360-3 Eng.
8	1859 127	AR		PLUG, Heater Hole, 3/8" Pipe Thread
	444 668	AR		1/2" Pipe 1978
	2128 425	AR		CAP, heater hole return nipple
9	3879 725	1		HOUSING, Water Pump 1978
	3751 217	1	M,R,MB	1979
10	3780 127	1	MB	PUMP ASSY, Water 1978-79
	3780 196	1	M-R	1978
11	3671 525	1		HUB, fan
	3751 812	1	M-R	
12	1737 705	1	M,MB	GASKET,Body 1978-79
13	1737 761	1	M,MB	GASKET, Housing to Cylinder Block 1978-79

FOLLOWING ITEMS ARE NOT SHOWN

2128 425			CAP, water pump body heater hole
870 469			CLAMP, w/Pump body htr. hole cap
870 469			CLAMP Wtr. Pump By Pass Hose 225 Eng.
180 122			SCREW, Water Pump Body 3/8-16 x 1"
6024 487	1		3/8-16 x 1 5/8
6027 880	1		3/8-16 x 2
9420 892	2		3/8-16 x 2 3/4
9421 897	1		3/8-16 x 5
6028 166	3		3/8-16 x 5 1/4
1315 466			HOSE, Water Pump By-Pass 225 Eng.
4095 227			HOSE, water pump by-pass 318,360 eng.
4095 227		M3-4	Hose Water Pump by-pass 360-3 Eng.
4033 105		M-MB	BOLT, Water Pump, Hsg. (3/8x3.50)
2448 762	2		CLAMP Water Pump By-Pass Hose 318-360 Eng.

LIGHT A = All Sport Utility (Ramcharger).

B = All Compact Models.

D = Conventional Cab.

DUTY AD = 2 Wheel Drive Only (Ramcharger).

CB-MB = Compact Front Section Only.

W = Conventional Cab 4 Wheel Drive.

CODES: AW = 4 Wheel Drive Only (Ramcharger).

P = Forward Control Chassis.

M = Motor Home.

MEDIUM-HEAVY CODES: XNT = Low Cab Forward. D = Conventional Cab. S = School Bus. W = 4-Wheel Drive.

AR=Use as Required

#=New Part Number

Printed in U.S.A.

June, 1982

8307 450

WATER PUMP FAN AND MOUNTING M3-4-5-6 -446 ENG.

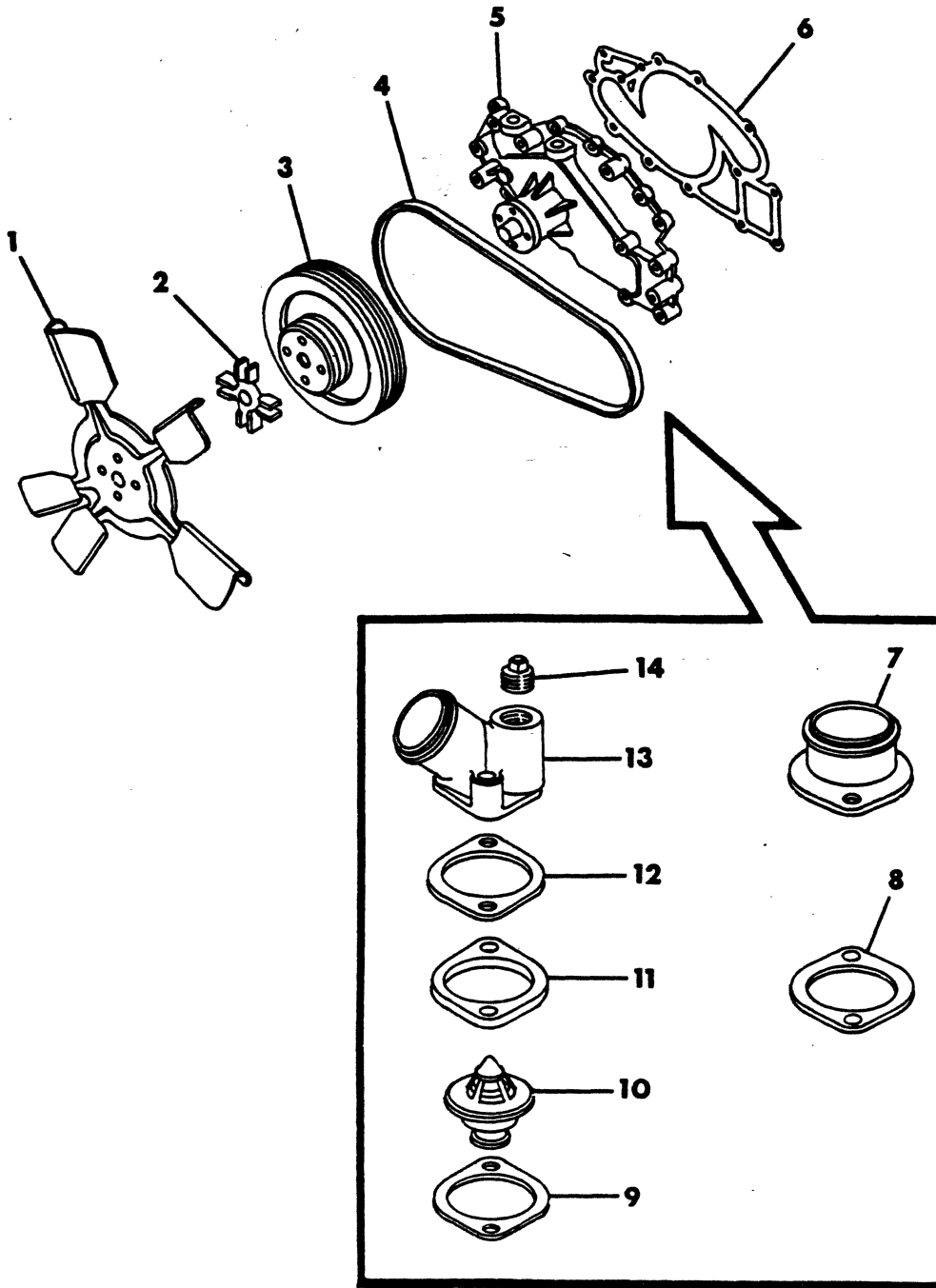

ITEM	PART NUMBER	QTY	MODEL	DESCRIPTION
WATER PUMP FAN AND MOUNTING M3-4-5-6 -446 ENG.				
1	4140 714	1		FAN 1980-81
2		1		SPACER (Not Shown)
	4140 715	1		DRIVE, Assy (Not Shown) 1980-81
3	4167 492	1		PULLEY Water Pump
4	4167 574	1		BELT Fan And Alternator 1980
	4167 818	1		BELT Fan And Alternator 1979
	3730 000	4		SCREW & Washer Fan To Fan Drive
5	4167 207	1		PUMP w/ Gasket
	4167 208	10		BOLT 5/16 X 11/2 (Not Shown)
	4167 209	4		5/16 X 2 3/4 (Not Shown)
6	4167 211	1		GASKET Body
7	4167 214	1		INLET, Eng. Water
8	4167 215	1		GASKET
9	4167 215	1		GASKET
10	4167 217	1		THERMOSTAT, 195 Degree
11	4167 218	1		REATAINER, Thermostat
12	4167 215	1		GASKET
13	4167 212	1		OUTLET, Eng. Water
14		1		PLUG, Pipe 3/4 (Not Serviced)

LIGHT	A = All Sport Utility (Ramcharger).	B = All Compact Models.	D = Conventional Cab.
DUTY	AD = 2 Wheel Drive Only (Ramcharger).	CB-MB = Compact Front Section Only.	W = Conventional Cab 4 Wheel Drive.
CODES:	AW = 4 Wheel Drive Only (Ramcharger).	P = Forward Control Chassis.	M = Motor Home.

MEDIUM-HEAVY CODES: XNT = Low Cab Forward. D = Conventional Cab. S = School Bus. W = 4-Wheel Drive.

AR=Use as Required

= New Part Number

Printed in U.S.A.

June, 1982

GRILLE AND COOLANT TANK
B1-2-3 1978

8307 500A

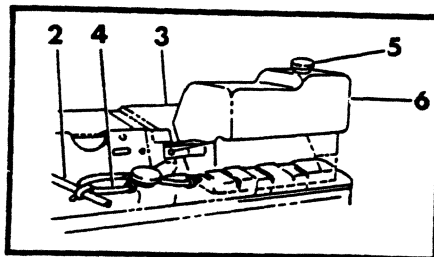
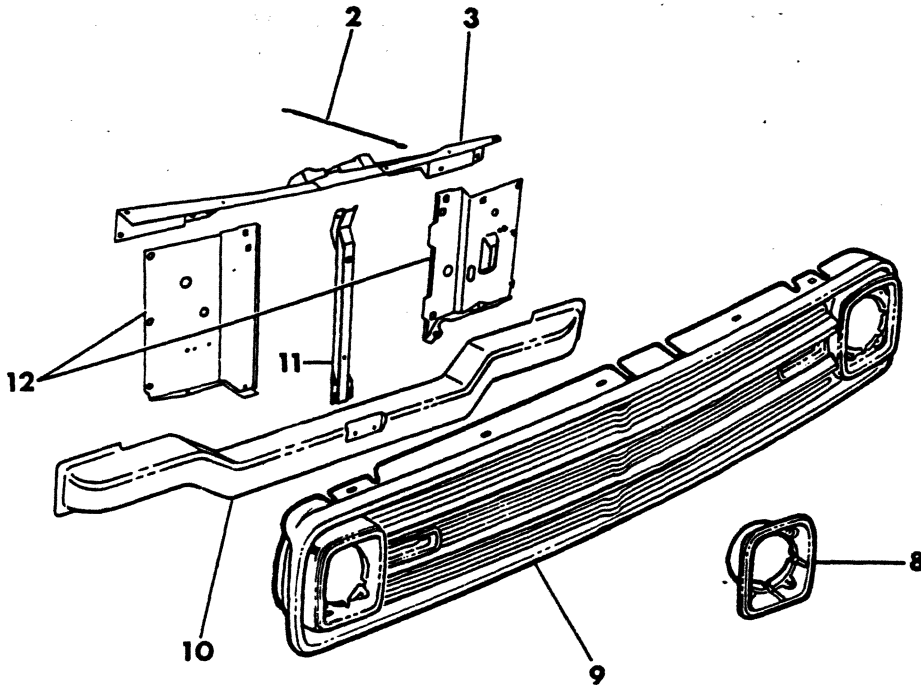

ITEM	PART NUMBER	QTY	MODEL	DESCRIPTION
GRILLE AND COOLANT TANK				
B1-2-3 1978				
2	2956 520	1		BRACE, grille upr. supt. to Eng. housing
3	3739 759	1		SUPPORT, grille upr.
4	3837 005	1		HOSE, core to coolant tank, (50ft. roll)
5	4086 463	1		CAP, reserve tank
6	3821 465	1	B,CB,MB	TANK, Coolant
	2448 761	AR		CLAMP, rad. core to coolant res. tank (res. tank end)
	6029 887	AR		SCREW, Rad coolant res. tank
8				DOOR, headlamp (refer to group 8)
9	3824 453	1		GRILLE
	4081 524	1		Medallion, Rad. Grille (Dodge)
	4081 525	1		(Plymouth)
	6030 441	5		RETAINER, grille mounting
10	4083 895	1		SUPPORT, Grille lower
	2956 585	1		REINFORCEMENT, grille lwr. support
11	4087 364	1		REINFORCEMENT, grille ctr. support 1978
12	4087 146-7	1	B1-2-3,CB3	SUPPORT, rad. grille pnl. side 225 Eng.
	4087 146-7	1	B1-2-3,CB3	w/o air or inc. cooling 318 - 360 Eng.
	4087 150-1	1	B1-2-3,CB3	w/air or inc cooling 318-360 eng.
	4087 150-1	1	B1-2-3	440 Eng. All
	4038 743	1	B1-2-3,CB3	Lt.
	4038 747	1	B1-2-3	400-440 eng., lt.
	4038 747	1	CB4,MB3-4	ALL, lt.

LIGHT	A = All Sport Utility (Ramcharger).	B = All Compact Models.	D = Conventional Cab.
DUTY	AD = 2 Wheel Drive Only (Ramcharger).	CB-MB = Compact Front Section Only.	W = Conventional Cab 4 Wheel Drive.
CODES:	AW = 4 Wheel Drive Only (Ramcharger).	P = Forward Control Chassis.	M = Motor Home.

MEDIUM-HEAVY CODES: XNT = Low Cab Forward. D = Conventional Cab. S = School Bus. W = 4-Wheel Drive.

AR=Use as Required

=New Part Number

Printed in U.S.A.

June, 1982

8307 525B

GRILLE AND COOLANT RESERVE TANK B-CB-MB 1979-80-81

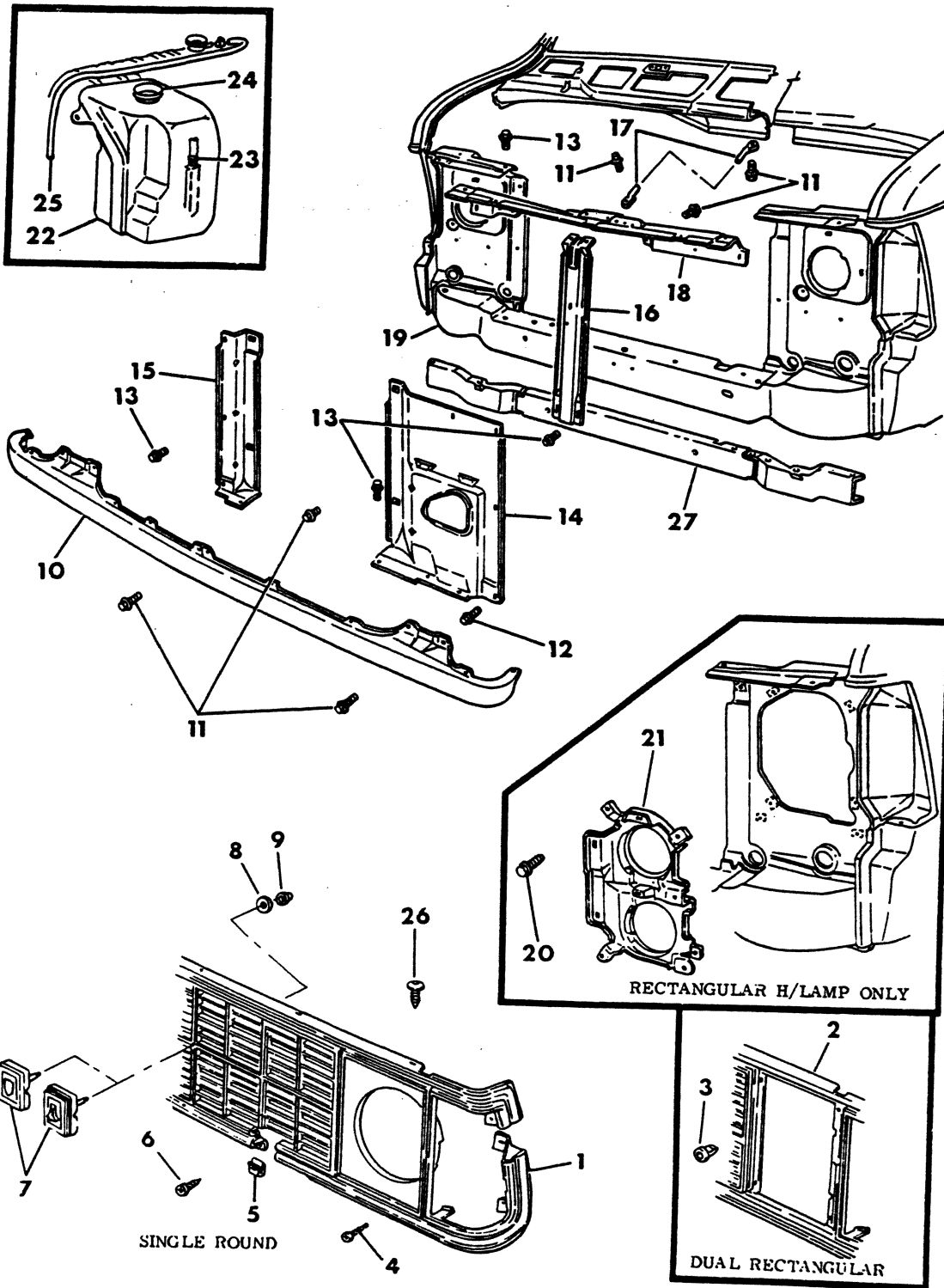

ITEM	PART NUMBER	QTY	MODEL	DESCRIPTION
GRILLE AND COOLANT RESERVE TANK B-CB-MB 1979-80-81				
1	4087 591	1	All	GRILLE, Panel Single Round Painted 1979-80
	4215 529	1	All	1981
2	4087 589	1	All	DUAL, Rectangular Chrome 1979-80
	4168 997	1	All	1981
2	4113 946	1	All	PAINTED
3	6030 480	8	All	NUT, (Snap In)
4		2	All	SCREW (10-16x1/2) Not Serviced
5		7	All	CLIP (Not Serviced)
6	152 383	7	All	SCREW (10x16x3/4)
7	4087 648	1	All	MEDALLION, Rad. Grille Dodge
7	4087 649	1	All	PLYMOUTH
8		1	All	WASHER (Not Serviced)
9		1	All	NUT (Not Serviced)
10	4087 554	1	All	PANEL, Rad, Grille Ext. 1979-80
	4212 052	1	All	1981
11	6025 318	AR	All	SCREW & Washer (1/4-20x5/8)
12	181 088	2	All	SCREW & Washer (5/16-18x1)
13	181 086	6	All	SCREW & Washer (5/16-18x3/4)
14	4087 563	1	All	SUPPORT, Radiator Core, 19" and 22", Left 1979
	4166 185	1	All	1980
	4215 505	1	All	1981
	4087 567	1	All	28" Core, Left 1979
	4166 189	1	All	1980-81
	4087 613	1	All	26" Core, Diesel, Left 1979
15	4087 562	1	All	SUPPORT, Radiator Core, 19" and 22", Right 1979
	4166 184	1	All	1980
	4215 504	1	All	1981
	4087 566	1	All	28" Core, Right 1979
	4166 188	1	All	1980-81
	4087 612	1	All	26" Core, Diesel, Right 1979
16	4087 798	1	All	REINFORCEMENT, Radiator Grille Support, Center 1979
	4166 203	1	All	1980-81
17	4113 505	1	All	BRACE, Grille Upper Support, Center 1979
	4113 846	1	All	1980-81
18	4087 796	1	All	SUPPORT, Grille Panel, Upper, Except Diesel 1979
	4087 608	1	All	W/DIESEL
	4166 194	1	B1-2-3	1980
	4166 774	1	CB-MB	1980
	4211 928	1		1981
19	4087 550	1	All	SUPPORT, Grille Panel, Lower Up To 1-22-79
	4113 993	1	All	Aft. 1-22-79
	4166 769	1	All	1980-81
20	181 063	8	All	SCREW & WASHER (1/4-20x3/4)
21	4080 446	2	All	ADAPTER, Headlamp Support
22	4036 207	1	All	TANK AND CAP ASSY. 1979
	4167 788	1	All	TANK Coolant Reserve w/o Cap 1980-81
23	2448 761	1	All	CLAMP, Tank End
24	4016 624	1	All	CAP, Tank 1979
	4140 108	1	All	1980-81

LIGHT A = All Sport Utility (Ramcharger).

B = All Compact Models.

D = Conventional Cab.

DUTY AD = 2 Wheel Drive Only (Ramcharger).

CB-MB = Compact Front Section Only.

W = Conventional Cab 4 Wheel Drive.

CODES: AW = 4 Wheel Drive Only (Ramcharger).

P = Forward Control Chassis.

M = Motor Home.

MEDIUM-HEAVY CODES: XNT = Low Cab Forward. D = Conventional Cab. S = School Bus. W = 4-Wheel Drive.

AR=Use as Required

= New Part Number

Printed in U.S.A.

June, 1982

1978-81 LIGHT DUTY TRUCK PARTS CATALOG

COOLING

ITEM	PART NUMBER	QTY	MODEL	DESCRIPTION
------	-------------	-----	-------	-------------

**GRILLE AND COOLANT RESERVE TANK
 B-CB-MB 1979-80-81**

25	1904 950	1	All	HOSE, Overflow
26		AR	All	SCREW, Grille Mounting (Not Serviced)
27	4113 517	1	All	REINFORCEMENT, Grille Lwr. Supt. Center 1979-80-81
	4112 918-9	1	All	ENDS 1979-80-81

LIGHT	A = All Sport Utility (Ramcharger).	B = All Compact Models.	D = Conventional Cab.
DUTY	AD = 2 Wheel Drive Only (Ramcharger).	CB-MB = Compact Front Section Only.	W = Conventional Cab 4 Wheel Drive.
CODES:	AW = 4 Wheel Drive Only (Ramcharger).	P = Forward Control Chassis.	M = Motor Home.

MEDIUM-HEAVY CODES: XNT = Low Cab Forward. D = Conventional Cab. S = School Bus. W = 4-Wheel Drive.

AR = Use as Required # = New Part Number

GRILLE AND COOLANT RESERVE TANK
A-D-W 1978

8307 600A

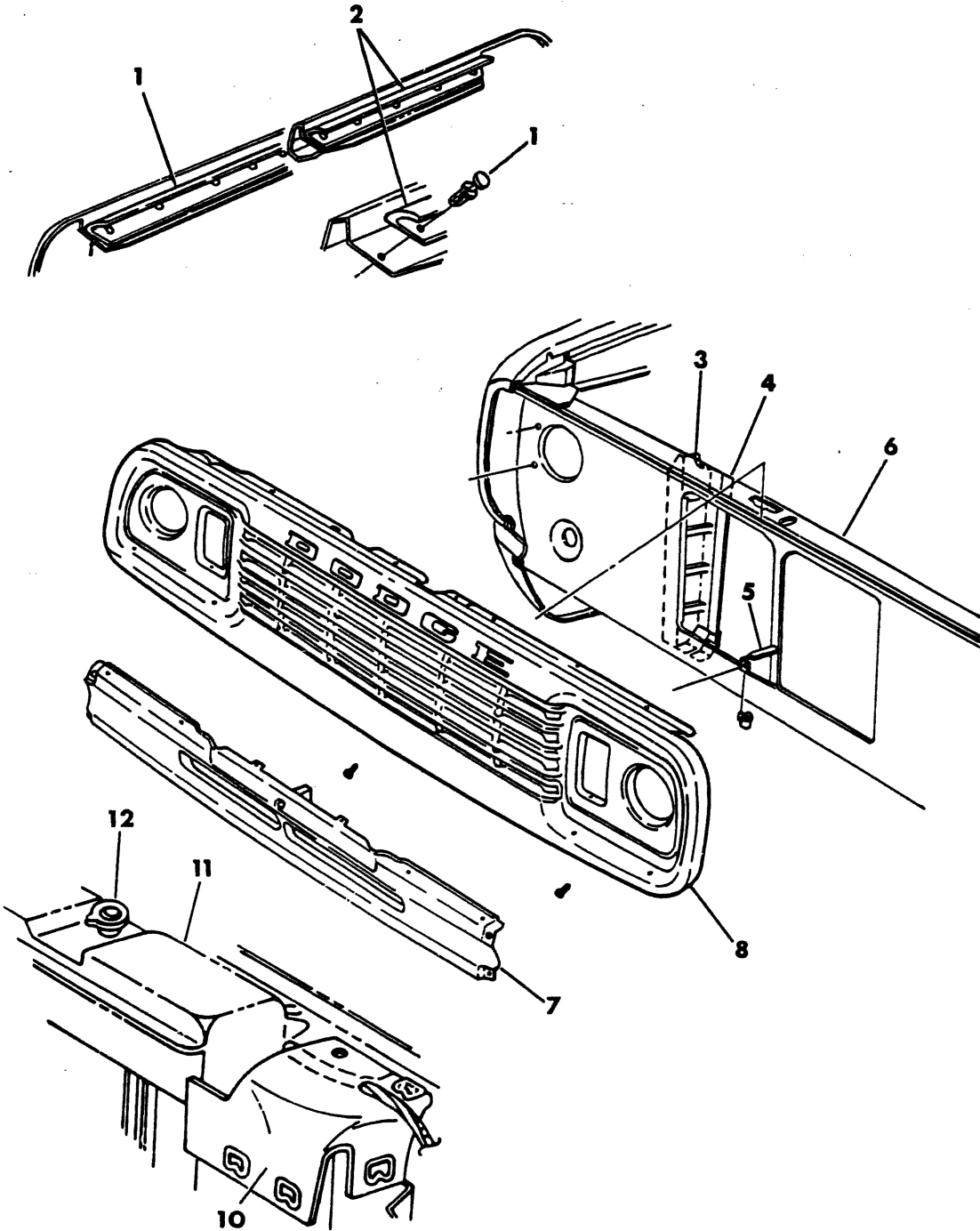

ITEM	PART NUMBER	QTY	MODEL	DESCRIPTION
GRILLE AND COOLANT RESERVE TANK A-D-W 1978				
1	6027 479	10		RETAINER
2	3729 237	1		WEATHERSTRIP, Grille to Hood
3	4083 484-5	1		EXTENSION, Grille w/26" Core
4	3829 360-1	1	D-W	EXTENSION, w/19-22" Core
	3829 362-3	1	A	
	4083 686-7	1	D-W	SUPPORT, Rad. Core Supt. w/Diesel
5	4083 682	1		BRACE, Grille Supt. to Ext. Center
	3495 417	4		INSULATOR, Supt. Bolt
	3636 484	4		SPACER, Rad. Grille Frt. End Sheet Metal Hold Down Bolt
6	4084 822	1	A-D-W	SUPPORT, Grille, w/19"-22" Core
	4084 823	1	A-D- RD	w/26" Core
	4113 574	1	D-W	26" Core w/Diesel
7	4083 683	1		EXTENSION, Radiator Grille, Lower
8	4033 360	1		GRILLE, Radiator Dodge 1978
	4033 361	1		Plymouth 1978
9				DOOR, HEADLAMP (Refer to Group 8)
10				BAFFLE, Radiator Grille Panel Supt.
	3634 031	1	A-D-W	225 Eng. w/o Inc. Cooling 1978
	3634 031	1	A-D-W	318,360,400,440 Eng. w/o Inc. Cooling or Air Cond.1978
	3736 250	2	AW-D-W2	225 Eng. w/Inc. Cooling
	3736 250	2	A-D-W	318,360 Eng. w/Inc. Cooling or Air Cond.
	3736 250	2	AD-D1	400,440 Eng. w/o Air Cond.
	3736 250	2	D-W4	360 Eng. All
	3736 250	2	D1	360 HI Performance Eng.
	3736 250	2	RD	All
	3736 250	2	A-D-W	318,360,400,440 Eng. w/o Air Cond. or Snow Plow
	3736 250	2	AD	400 Eng. w/o Air Cond.
	4036 449	2	A-D-W	318,360,400,440 Eng. w/Air Cond. or Inc. Cooling
	4036 449	2	A-D-W	400,440 Eng. w/Air Cond. or Snow Plow
	4036 449	2	D-W4	400,440 Eng. All
	4037 942	1	D-W	W/Diesel Eng.
11	4086 800	1		TANK, Coolant Reserve
	3733 884	1	D-W	Tank & Cap, Coolant Reserve w/Diesel Eng.
	3837 005	AR		HOSE, Core to Coolant Res. Tank (50ft. Roll)
	3574 155	AR		HOSE, Core to Coolant Res. Tank Approx. 34" Long
	3837 005	AR	D-W	w/Diesel
	2448 761	AR		CLAMP, Rad Core to Coolant Res. Tank Hose
	6029 887	AR		SCREW, Rad Core Coolant Res.
12	4086 463	1		CAP, Reserve Tank
	3829 242	AR	D-W2	REINF., Radiator Grl. Supt. Lwr. Frt. Eng. Sht. Metal Hold Down (Not Shown)
	3498 760-1	1	D-W	REINF. Radiator Grl. Panel Supt. Frt. End Sht. Metal Hold Down w/Diesel (Not Shown)

LIGHT A = All Sport Utility (Ramcharger).

B = All Compact Models.

D = Conventional Cab.

DUTY AD = 2 Wheel Drive Only (Ramcharger).

CB-MB = Compact Front Section Only.

W = Conventional Cab 4 Wheel Drive.

CODES: AW = 4 Wheel Drive Only (Ramcharger).

P = Forward Control Chassis.

M = Motor Home.

MEDIUM-HEAVY CODES: XNT = Low Cab Forward. D = Conventional Cab. S = School Bus. W = 4-Wheel Drive.

AR=Use as Required

= New Part Number

Printed in U.S.A.

June, 1982

GRILLE AND ATTACHING PARTS A-D-W-RD 1979-80-81

8307 650

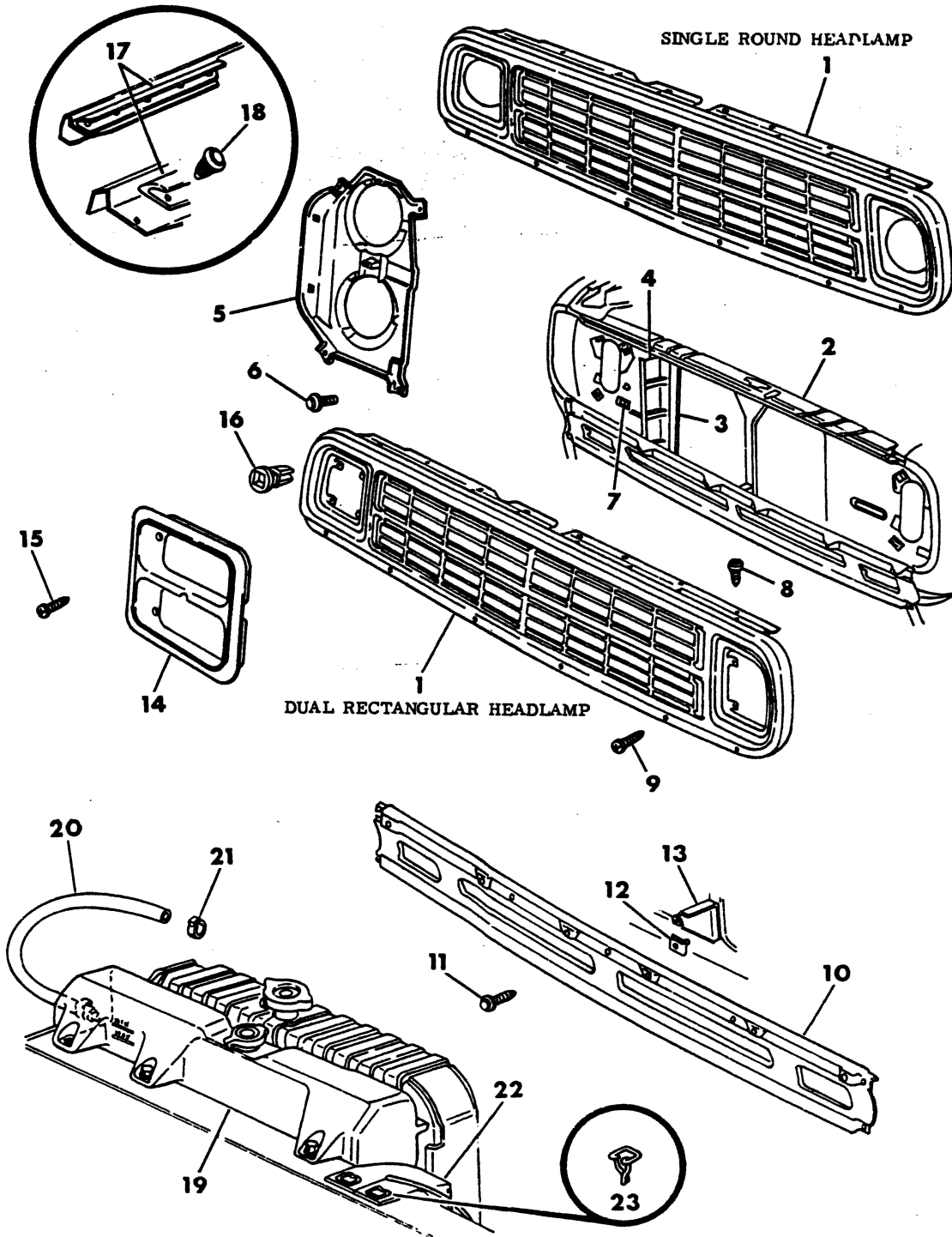

ITEM	PART NUMBER	QTY	MODEL	DESCRIPTION	
GRILLE AND ATTACHING PARTS A-D-W-RD 1979-80-81					
1	4087 286	1	ALL	GRILLE, Radiator w/Round Headlamps (Bright Finish) 1979	
	4211 870	1	ALL	1980	
	4168 722	1	ALL	INSERT, Rad. Grille Panel Bright 1981	
	4087 287	1	ALL	w/Dual Rectangular Headlamps (Bright Finish) 1979	
	4211 872	1	ALL	1980	
	4168 723	1	ALL	INSERT, Rad. Grille Painted 1981	
	4168 721	1	ALL	PANEL, Rad. Grille 1981	
	2	4166 988	1	ALL	SUPPORT, Grille 19 And 22" Core w/Dual and Single H/Lamps
		4215 598	1	ALL	1981 COMP.(up tp 10-17-80)
		4215 619	1	ALL	1981 COMP.(after 10-17-80)
4166 989		1	ALL	26" Core w/Dual And Single H/Lamps	
4215 599		1	ALL	1981 COMP.(up to 10-17-80)	
4215 625		1	ALL	1981 COMP.(after 10-17-80)	
4166 990		1	ALL	26" Core w/Diesel	
4087 972		1	ALL	BRACKET, Radiator Grille Hood Lock Mtg.(Not Shown)	
4083 494		1	ALL	REINFORCEMENT, Radiator Grille Supt. Frt. End Sheet Metal Hold Down	
				Rt.(Up To 12-17-79) Not Shown	
	4211 760	1	ALL	(Aft 12-17-79)	
	4113 207	1	ALL	REINFORCEMENT, Radiator Grille Supt. Frt. End Sheet Metal Hold	
				Down Lt (Up To 12-17-79)	
	4211 759	1	ALL	(Aft 12-17-79)	
3	4087 302	1	ALL	EXTENSION, Rad. Grille 19 And 22" Core Rt	
	4087 303	1	ALL	LEFT, 19 And 22" Core (Up To 9-15-78)	
	4118 673	1	ALL	LEFT, 19 And 22" Core (Aft 9-15-78)	
	4083 686	1	ALL	SUPPORT, Rad. Core w/Diesel	
	4083 687	1	ALL	Left w/Diesel	
	3636 484	4	ALL	SPACER, Rad. Grille Frt End Sheet Metal Hold Down Bolt	
	3495 417	4	ALL	INSULATOR, Support Bolt	
4	4113 037	1	ALL	EXTENSION, Rad. Grille 26" CORE Lt (Up To 9-15-78)	
	4113 036	1	ALL	Right	
	4118 675	1	ALL	26" Core, Left, (After 9-15-78)	
	3498 760-1	1	ALL	REINFORCEMENT, Grille Support Front End Sheet Metal Hold Down,	
				w/Diesel	
5	4087 295	2	ALL	ADAPTER, Grille Support Headlamp 1979-80	
	3868 003	2	ALL	ADAPTER, H/lamp Single Round 1980 (Not Shown)	
6	181 063	8	ALL	SCREW & WASHER (1/4-20x1.00)	
7	152 454	8	ALL	U-NUT (1/4-20)	
8		7	ALL	SCREW (10-6x3/8) Not Serviced	
9		6	ALL	SCREW (10-16x3/4) Not Serviced	
10	4087 290	1	ALL	PANEL, Grille Extension, Lower 1979-80	
	4168 734	1	ALL	1981	
11	181 063	AR	ALL	SCREW & WASHER (1/4-20x7/8)	
12	152 454	AR	ALL	U-NUT (1/4-20)	
13	4118 652	1	ALL	BRACKET, Grille Support, Except Diesel	
	4118 652	2	ALL	w/Diesel	
14		2	ALL	DOOR, Headlamp (Refer to Group 8)	
15		8	ALL	SCREW (8-13x3/4) Not Serviced	
16	6030 480	8	ALL	NUT	
17	4113 046	1	ALL	WEATHERSTRIP w/RETAINERS, Radiator Panel to Hood 1979-80	

LIGHT A = All Sport Utility (Ramcharger).

B = All Compact Models.

D = Conventional Cab.

DUTY AD = 2 Wheel Drive Only (Ramcharger).

CB-MB = Compact Front Section Only.

W = Conventional Cab 4 Wheel Drive.

CODES: AW = 4 Wheel Drive Only (Ramcharger).

P = Forward Control Chassis.

M = Motor Home.

MEDIUM-HEAVY CODES: XNT = Low Cab Forward. D = Conventional Cab. S = School Bus. W = 4-Wheel Drive.

AR=Use as Required

= New Part Number

Printed in U.S.A.

June, 1982

1978-81 LIGHT DUTY TRUCK PARTS CATALOG

COOLING

ITEM	PART NUMBER	QTY	MODEL	DESCRIPTION
GRILLE AND ATTACHING PARTS A-D-W-RD 1979-80-81				
18	6027 429	10	ALL	RETAINER
19	4089 624	1	ALL	TANK, And Cap Coolant Reserve 1979-80
	5201 226	1	ALL	CAP
	4140 751	1	ALL	TANK, Coolant Reserve 1981
	4016 624	1	ALL	CAP, Coolant Reserve Tank 1981
	3733 884	1	ALL	TANK, And Cap Coolant Reserve w/Diesel Eng. 1979-80
20	4026 148	1	ALL	HOSE, Core To Coolant And Res. Tank (18.50 Long) 1980-81
	3574 155	1	ALL	HOSE, Core To Coolant And Res. Tank (34" Long) 1979
	3837 005	1	ALL	w/Diesel Eng.
21	2448 761	1	ALL	CLAMP, Rad. Core To Coolant Res. Tank Hose 1979-80
22	3736 250	2	ALL	BAFFLE, Radiator Grille Panel Supt. w/19" And 22" Tall Core (Up To 10-1-79)
	4140 440	2	ALL	(Aft 10-1-79)
	4140 874	1	ALL	1981
	4036 449	2	ALL	w/26" Tall Core (Up To 10-1-79)
	4140 441	2	ALL	w/Std. Cooling (Aft 10-1-79)
	4115 430	1	D-W	w/26" Core w/Diesel
23	6029 886	9	All	CLIP, Baffle w/225 Engine
	6029 886	8	All	w/318-360 Engine
24	4016 624	1	All	CAP, Reserve Tank

LIGHT	A = All Sport Utility (Ramcharger).	B = All Compact Models.	D = Conventional Cab.
DUTY	AD = 2 Wheel Drive Only (Ramcharger).	CB-MB = Compact Front Section Only.	W = Conventional Cab 4 Wheel Drive.
CODES:	AW = 4 Wheel Drive Only (Ramcharger).	P = Forward Control Chassis.	M = Motor Home.

MEDIUM-HEAVY CODES: XNT = Low Cab Forward. D = Conventional Cab. S = School Bus. W = 4-Wheel Drive.

AR=Use as Required

=New Part Number

Printed in U.S.A.

June, 1982

RADIATOR, SHROUD AND HOSES
P300

8307 700

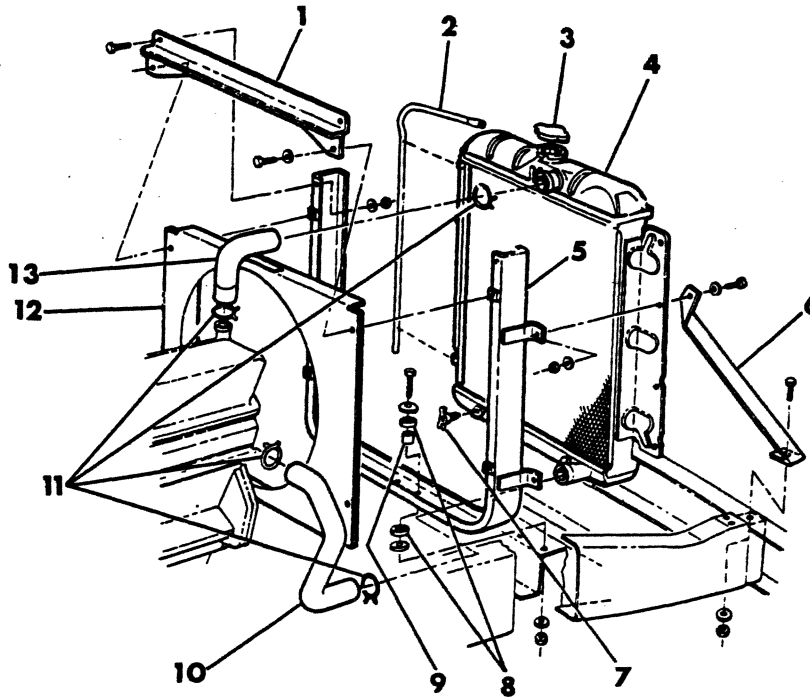

ITEM	PART NUMBER	QTY	MODEL	DESCRIPTION
1	3732 981	1		BAR, radiator core supt. tie
2	3837 005	AR		HOSE, radiator overflow
3	3781 830	1		CAP, radiator
4	2830 660	1		RADIATOR
5	2228 564	1		SUPPORT, radiator
6	2228 566	1		BRACE, radiator supt. to bumper
7	1686 198	1		DRAINCOCK
8	1924 488	4		INSULATOR, support bolt
9	1924 486	2		SPACER, support bolt
10	3780 656	1		HOSE, outlet
11	105 479	AR		CLAMP, 1" to 3" O.D.
12	2228 567	1		SHROUD
13	4026 109	1		HOSE, inlet
	1315 466	AR		HOSE, water pump by-pass (not shown)

LIGHT A = All Sport Utility (Ramcharger). B = All Compact Models. D = Conventional Cab.
DUTY AD = 2 Wheel Drive Only (Ramcharger). CB-MB = Compact Front Section Only. W = Conventional Cab 4 Wheel Drive.
CODES: AW = 4 Wheel Drive Only (Ramcharger). P = Forward Control Chassis. M = Motor Home.

MEDIUM-HEAVY CODES: XNT = Low Cab Forward. D = Conventional Cab. S = School Bus. W = 4-Wheel Drive.

AR=Use as Required

=New Part Number

Printed in U.S.A.

June, 1982

RADIATOR AND HOSES
M-3-4-5-6

8307 800A

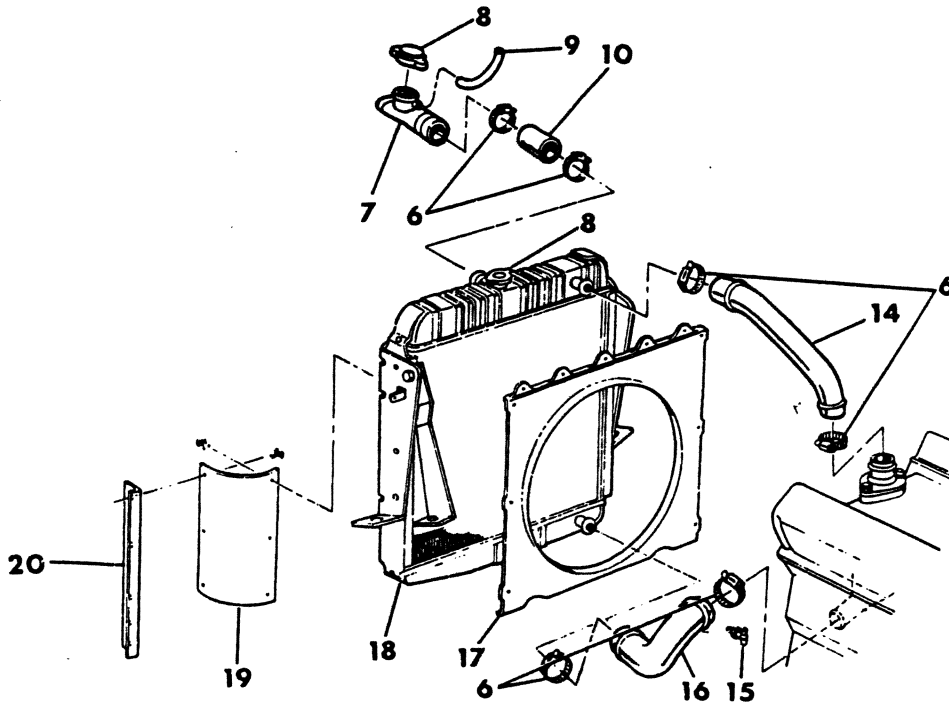
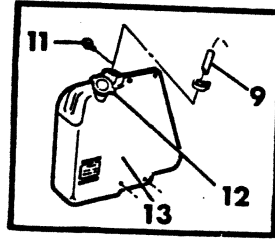
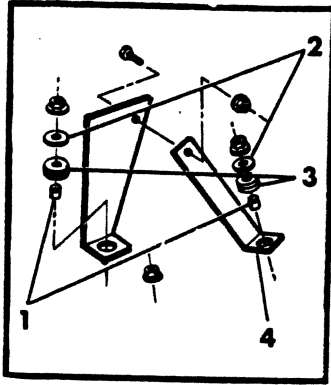

ITEM	PART NUMBER	QTY	MODEL	DESCRIPTION
RADIATOR AND HOSES				
M-3-4-5-6				
1	1394 152	4		SPACER, core to support insulator
2	2228 067	4		WASHER, core to support insulator
3	1924 488	4		INSULATOR, support bolt
	2511 780	4		INSULATOR, core mounting
4	3733 610-1	1		BRACE, support to frame
6	870 469	AR		CLAMP, Hose 1" To 3" Dia.
7	3641 921	1		TUBE, Filler Extension 1978-79
	4164 105	1		1980-81
7	2448 763	2		Clamp, Tube Filler Ext. Hose (Not Shown)
8	3781 830	2		CAP, radiator filler
9	4026 148	AR		HOSE, Core To Coolant Reserve Tank (50ft. roll)
10	3638 117	1		HOSE, filler extension
11	6029 314	4		SCREW, reserve tank mounting
12	4086 463	1		CAP, coolant tank
13	3733 592	1		TANK, Coolant Reserve 1978
	4164 117	1		1979-80-81
	2448 761	1		CLAMP, rad core to reserve tank (res. tank end)
14	3733 603	1		HOSE, Inlet, w/318-3600 eng. (Up to 1-16-79)
	4164 587	1		Aft (1-16-79)
	4140 773	1		360-3 Eng. w/Max. Cooling 1981
	3733 605	1		w/ 400-440 eng.
	4026 101	1		Water pump by-pass
15	1686 198	1		DRAINCOCK
16	3898 064	1	M3-4-5	HOSE, outlet w/ 360 eng.
	3733 606	1	M3-4-5	w/ 440 eng.
17	4031 553	1		SHROUD, radiator
18	4037 685	1	M4-5-6	CORE, Radiator 360-3-440-3 Eng. 1978-79
	4116 707	1	M3-4	360-3 Eng. 1980-81
	186 632	4		BOLT, Raiator Core Mtg.
19	3641 946	1		BAFFLE, lower left 1978-79
	4112 594	1	MB-4	360 Eng. 1980-81
	3641 946	1		Right 1978-79
	6025 020	4		NUT, And C/Wa. Lwr. Baffle Supt.
	4112 595	1		BAFFLE, Lwr. Rt. 360 Eng. 1980-81
	3733 614	1		upper 1979-80
	4140 870	1		1981
20	3641 949	2		SUPPORT, lower baffle
21	6029 886	19		RETAINER, rad baffle
	4095 227	1		HOSE, water pump by-pass (not shown)
	2448 762	2		CLAMP, Wtr. Pump By Pass Hose 1979-80-81

LIGHT	A = All Sport Utility (Ramcharger).	B = All Compact Models.	D = Conventional Cab.
DUTY	AD = 2 Wheel Drive Only (Ramcharger).	CB-MB = Compact Front Section Only.	W = Conventional Cab 4 Wheel Drive.
CODES:	AW = 4 Wheel Drive Only (Ramcharger).	P = Forward Control Chassis.	M = Motor Home.

MEDIUM-HEAVY CODES: XNT = Low Cab Forward. D = Conventional Cab. S = School Bus. W = 4-Wheel Drive.

AR = Use as Required

= New Part Number

Printed in U.S.A.

June, 1982

8307 810

RADIATOR AND HOSES M3-4-5-6 - I.H.C 446 ENG.

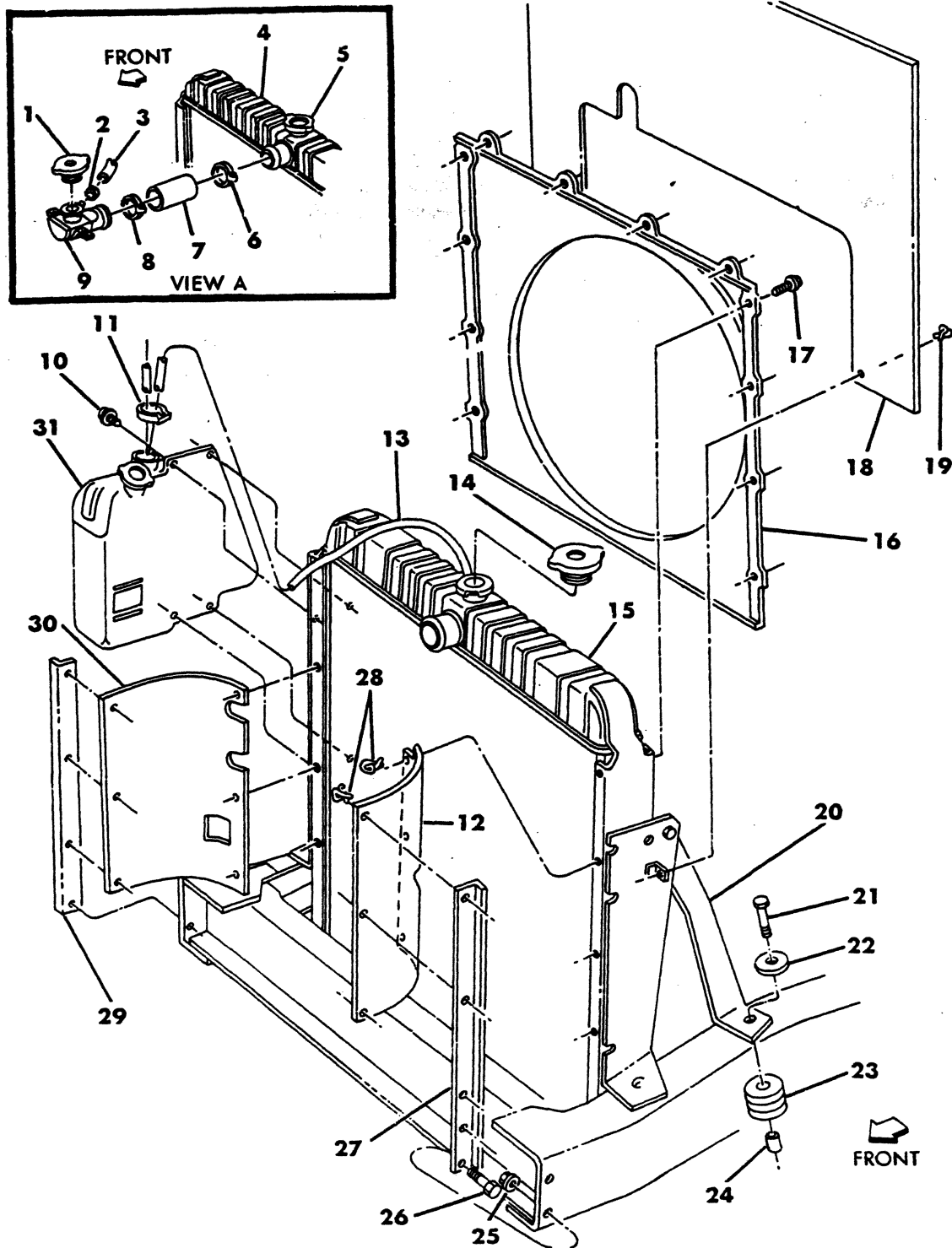

ITEM	PART NUMBER	QTY	MODEL	DESCRIPTION
RADIATOR AND HOSES				
M3-4-5-6 - I.H.C 446 ENG.				
1	3781 830	1		CAP, Radiator Pressure
2		1		CLAMP (Not Serviced)
3	4026 148	1		HOSE, Rad. Siphon
4	4167 315	1		RADIATOR
	1686 198	1		DRAINCOCK, Rad. (Not Shown)
5	3781 830	1		CAP, Radiator Filler
6	870 469	1		CLAMP 2" Dia.
7	3638 117	1		HOSE, Rad. Filler Ext. Tube
8	870 469	1		CLAMP 2" Dia.
9	4164 105	1		TUBE, Rad. Filler Ext.
10		4		SCREW, (1/4 -14 3/8) Not Serviced
11	2448 762	1		CLAMP
12	4167 536	1		BAFFLE, Radiator Lower Lt
13	4026 148	1		HOSE
14	3781 830	1		CAP, Radiator Filler
15	4167 315	1		RADIATOR
16	4112 745	1		SHROUD, Fan (Up To 5-15-79)
	4167 319	1		(Alt 5-15-79)
17	6029 887	8		SCREW, (1/4 - 14 x 7/8)
18	4167 340	1		BAFFLE, Radiator Upper
19	6029 886	18		RETAINER
20	3733 610-1	2		BRACE, Radiator Support
21	186 632	4		BOLT (3/8 - 16 x 1.75)
22	2228 067	4		WASHER
23	2511 780	4		INSULATOR
24	1394 152	4		SPACER
25	6025 020	4		NUT (3/8 - 16)
26	6029 779	4		BOLT (3/8 - 16 x 1.00)
27	3641 949	1		SUPPORT, Baffle Lower
28	6029 886	13		RETAINER
29	3641 949	1		SUPPORT, Baffle Lower
30	4167 535	1		BAFFLE, Radiator Lower Rt
31	4164 117	1		TANK, Rad. Over Flow
	4167 323	1		HOSE, Rad. Inlet 1979-80 (Not Shown)
	4140 774	1		w/Max. Cooling 1981
	4112 587	1		HOSE, Rad. Outlet (Not Shown)
	153 494	4		CLAMP, Rad. Inlet And Outlet Hose (Not Shown) 1979-80
	2513 344	2		1981
	4086 463	1		CAP, Coolant Reserve Tank 1979-80-81

LIGHT	A = All Sport Utility (Ramcharger).	B = All Compact Models.	D = Conventional Cab.
DUTY	AD = 2 Wheel Drive Only (Ramcharger).	CB-MB = Compact Front Section Only.	W = Conventional Cab 4 Wheel Drive.
CODES:	AW = 4 Wheel Drive Only (Ramcharger).	P = Forward Control Chassis.	M = Motor Home.

MEDIUM-HEAVY CODES: XNT = Low Cab Forward. D = Conventional Cab. S = School Bus. W = 4-Wheel Drive.

AR=Use as Required

= New Part Number

Printed in U.S.A.

June, 1982

DIESEL ENGINE B-D-W
BELTS,PULLEYS,COOLING SYSTEM

8307 850B

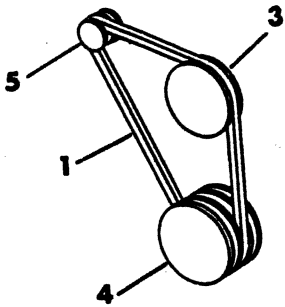

W/O PWR STRG

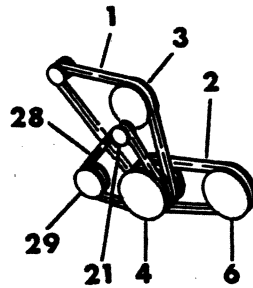

BELT DRIVE

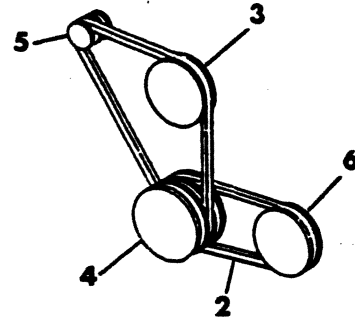

W/PWR STRG

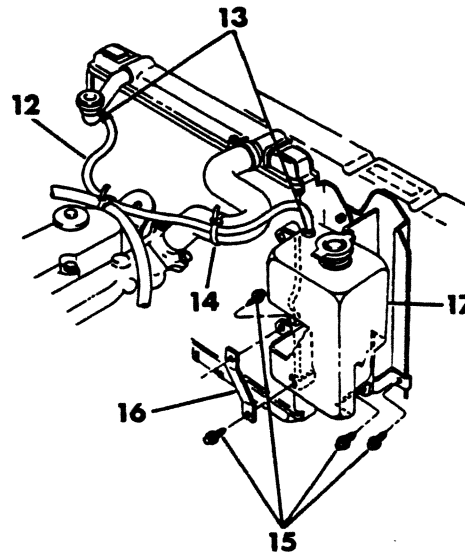
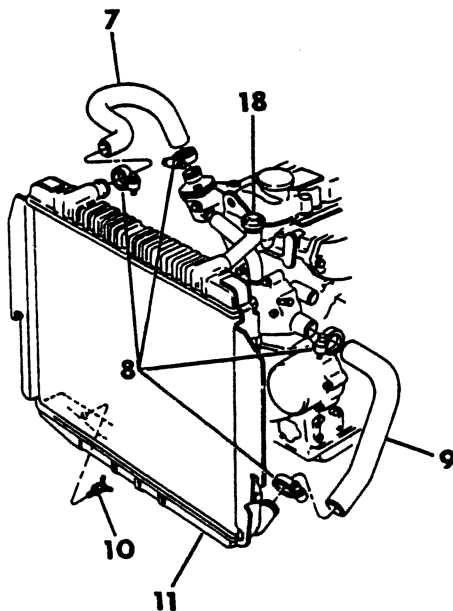
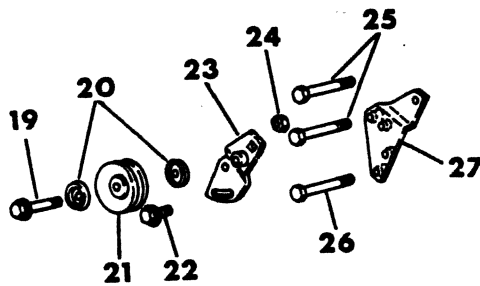

ITEM	PART NUMBER	QTY	MODEL	DESCRIPTION
DIESEL ENGINE B-D-W BELTS,PULLEYS,COOLING SYSTEM				
1	4032 632	1	D,W	Belt, Fan & Alt.
2	4032 633	1	D,W	Belt, Pwr. Strg.
3	ME00 7228	1		Pulley, Fan & Water Pump 1978
4	ME00 7266	1		Pulley, Drive 1978
5		1		Pulley, Alternator (refer to group 8)
6		1		Pulley, Pwr. Strg. (refer to group 19)
7	4039 490	1		Hose, Rad. Inlet 1978
	4116 935	1		1979-80
8	2448 763	AR		Clamp assy, Adj.
9	4037 941	1	D-W	Hose, Rad. Outlet
10	1686 198	1		Draincock, Rad.
11	4089 485	1		Radiator 1978
	4089 735	1	B	1979
	4164 108	1	D-W	1979
12	4026 148	1		Hose, Overflow 31" Long
13		AR		Clamp
14	3489 482	2		Strap
15	9423 829	AR		Screw (1/4 - 14 x .75)
16	4089 734	1		Strap, Tank Support
17	3733 884	1		Tank & Cap Assy.
18	4039 936	1		CAP, rad.
19	6024 473	AR		SCREW (7/16-14x2.00)
20	5214 065	2	B1-2-3	SHIELD, Brg Dust
21	4039 672	1	B1-2-3	PULLEY, Idler w/ Air. Cond
22	6022 254		B1-2-3	SCREW (3/18-16.88)
23	4116 664	1	B1-2-3	BRACKET, Idler Mtg. 1978-79
24	271 502		B1-2-3	NUT (7/16-14)
25	6100 174	2	B1-2-3	BOLT (M8-1.25x65)
26	6100 176		B1-2-3	BOLT (M8-1.25x75)
27	4088 103	1	B1-2-3	SUPPORT Air Cond. Compr. Idler Pulley Brkt. 1978-79
28	4173 114	1	B1-2-3	BELT, Compr Drive (7/16x41.00)
29				PULLEY,A/C Compr (Refer to grp 24)

LIGHT	A = All Sport Utility (Ramcharger).	B = All Compact Models.	D = Conventional Cab.
DUTY	AD = 2 Wheel Drive Only (Ramcharger).	CB-MB = Compact Front Section Only.	W = Conventional Cab 4 Wheel Drive.
CODES:	AW = 4 Wheel Drive Only (Ramcharger).	P = Forward Control Chassis.	M = Motor Home.

MEDIUM-HEAVY CODES: XNT = Low Cab Forward. D = Conventional Cab. S = School Bus. W = 4-Wheel Drive.

AR=Use as Required

=New Part Number

Printed in U.S.A.

June, 1982

FAN AND DRIVE BELT AND PULLEYS
 225 ENGINE B-CB-MB

8307 900C

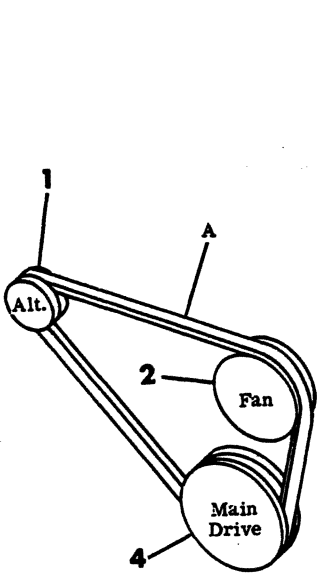

BASIC DRIVE

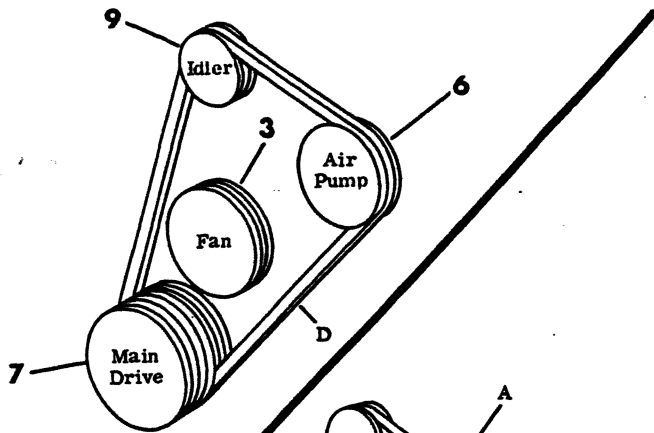

W/AIR PUMP
 1979-80

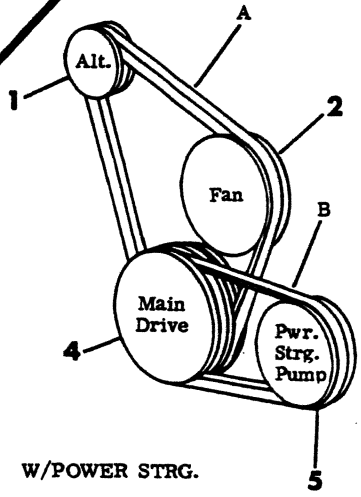

W/POWER STRG.

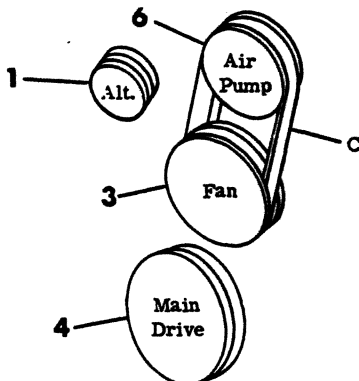

W/AIR PUMP 1978

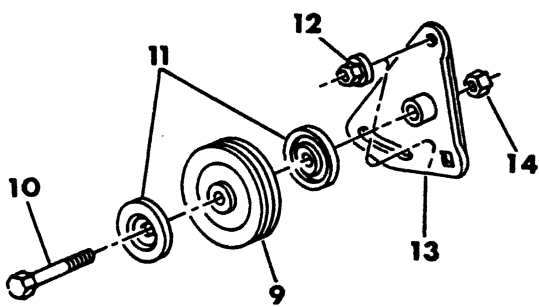

IDLER PULLEY

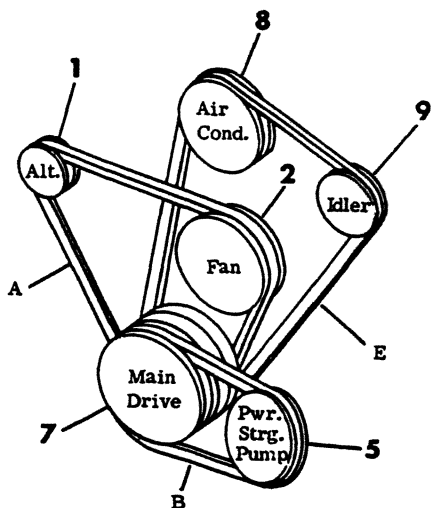

W/AIR COND., POWER STRG.
 AND/OR AIR PUMP

ITEM	PART NUMBER	QTY	MODEL	DESCRIPTION
------	-------------	-----	-------	-------------

**FAN AND DRIVE BELT AND PULLEYS
225 ENGINE B-CB-MB**

1				PULLEY, alternator (refer to group 8)
2	2202 666			PULLEY, Fan w/o Air Pump 1978-79-80 w/Lite And Heavy Duty Cycle 1981
3	2264 450			PULLEY, Fan w/ Air Pump 1978
4	4095 536	1		PULLEY, Drive, w/Power Steering, Single Groove
5				PULLEY, pwr. strg. pump (refer to group 19)
6				PULLEY, Air Pump (Ref To Grp 25)
7	3685 687	1		PULLEY, Drive Auto Trans. w/Pwr. Strg. w/Air Cond and or Air Pump Single Groove 1979-80-81
8				PULLEY, A/C Compressor (Refer To Group 24)
9	3830 197	1		PULLEY, Idler W/Air Cond.
10	6024 473	1		SCREW, (7/16-14x2.00)
11	5214 065	2		SHIELD Bearing Dust
12	6025 020	3		NUT (3/8-16)
13	4089 603	1		BRACKET, Idler Pulley w/Air Cond.
	181 126	1		BOLT, a/Cond. Compr. I/Pulley Brkt.
14	271 502	1		NUT (7/16-14)
A	4106 212			BELT, Fan & Altr. 3/8 x 55-1/2" O.S. Length
	4100 321			BELT, Fan & Altr. w/100 amp. Alt. 3/8 x 56" O.S. Length
B	4027 319			BELT, Pwr. Strg. 3/8 x 39" O.S. Length 1978
	4027 318			3/8 x 40" O.S. Length 1978
	4104 352			3/8 x 39" O.S. Length 1979-80
C	4027 325			BELT, Air Pump 3/8 x 35" O.S. Length 1978
D	4173 458			3/8 x 57" Up To 7-2-79
	5214 667			Aft. 7-2-79
E	4116 952			BELT, A/Cond. Compr. Drive 3/8 x 59" O.S. Length 1979-80-81
FOLLOWING ITEMS NOT SHOWN				
	4173 459	1		BELT, Air Cond. & Air Pump w/100 Amp. Altr. 3/8 x 58" O.S. Length 1979-80
	4106 241	1		3/8 x 56 3/4 1981
	3837 671			Belt, Air Cond. & Air Pump w/o 100 Amp. Alt. 1978
	4106 215	2	CB3-4	Belt, A/cond. Compr. And Alt. Drive w/100 Amp. Alt.(3/8 x 58 1/8 1979-80-81
	4106 210	2		w/60 Amp. Alt. (3/8 x 54 1/4) 1979-80-81
	6028 607	1		Spacer, air cond. compr. idler pulley
	4115 456	1		Bracket, Air Pump Idler Pulley 1978
	4095 467	1		PULLEY, Drive w/Auto And Air/Cond. 1978
	4095 853	1		DRIVE Assy. Viscous w/ Air Cond. And Max. Cooling 1980
	4167 771	1		w/Max. Cooling w/o Air Cond.

LIGHT	A = All Sport Utility (Ramcharger).	B = All Compact Models.	D = Conventional Cab.
DUTY	AD = 2 Wheel Drive Only (Ramcharger).	CB-MB = Compact Front Section Only.	W = Conventional Cab 4 Wheel Drive.
CODES:	AW = 4 Wheel Drive Only (Ramcharger).	P = Forward Control Chassis.	M = Motor Home.

MEDIUM-HEAVY CODES: XNT = Low Cab Forward. D = Conventional Cab. S = School Bus. W = 4-Wheel Drive.

AR=Use as Required

= New Part Number

Printed in U.S.A.

June, 1982

FAN AND DRIVE BELT AND PULLEYS
 225 ENGINE A-D-W MODELS

8307 925

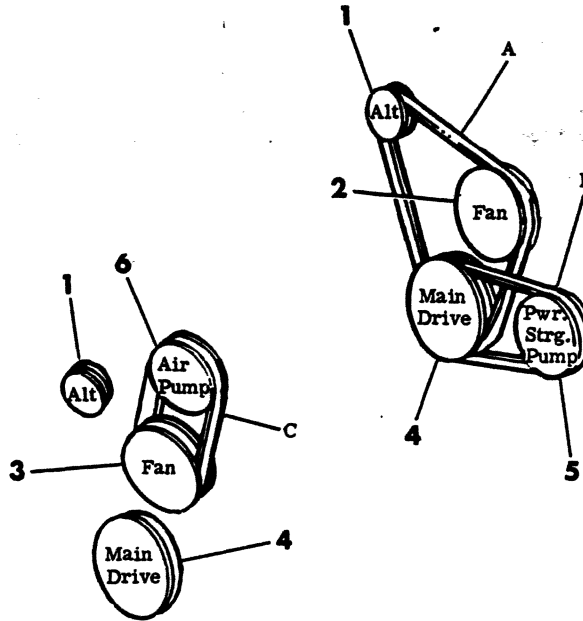
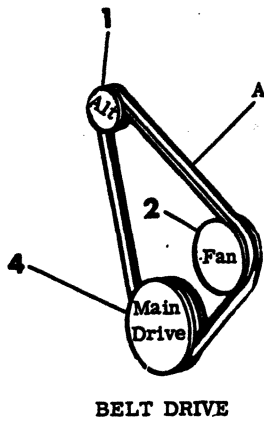

ITEM	PART NUMBER	QTY	MODEL	DESCRIPTION
1				PULLEY, alternator (refer to group 8)
2	2202 666			PULLEY, Fan w/o Air Pump 1978-79-80
	2202 666			w/Lite And Heavy Duty Cycle 1981
3	2264 450			PULLEY, Fan w/Air Pump 1978
4	4095 536			PULLEY, Drive w/ Power Strg. Single Groove
5				Pulley, pwr. strg. (refer to group 19)
6	3830 967			Pulley, air pump
A	4106 241			Belt, Fan & Altr. 3/8 x 56-3/4 o.s Length 1978
	4106 214			3/8 x 57 1/2 1980-81
B	4027 319			Belt, pwr. strg. 1978
	4027 318			Belt, Pwr. Strg. 3/8 x 40 1978
	4104 352			3/8 x 39 1979-80-81
C	4027 325			Belt, Air Pump (3/8 x 35 1/8) 1978
	4173 458			3/8 x 57 Up To 7-2-79
	5214 667			Aft. 7-2-79
	4106 214			3/8 x 57 1/2 o.s Length 1978
FOLLOWING ITEMS NOT SHOWN				
	4173 459			Belt, Air Cond. & Air Pump Drive w/100 Amp. Alt. (3/8 x 58)
	3837 671			Belt, Air Cond. & Air Pump w/o 100 Amp. Alt. 1978
	4106 241			1980-81
	6028 607			Spacer, air cond. compr idler pulley brkt.
	4089 603			Bracket, air cond idler pulley
	181 126	1		BOLT, A/cond. Compr. 1/Pulley Brkt.
LIGHT DUTY CODES:	A = All Sport Utility (Ramcharger).		B = All Compact Models.	D = Conventional Cab.
	AD = 2 Wheel Drive Only (Ramcharger).		CB-MB = Compact Front Section Only.	W = Conventional Cab 4 Wheel Drive.
	AW = 4 Wheel Drive Only (Ramcharger).		P = Forward Control Chassis.	M = Motor Home.
MEDIUM-HEAVY CODES: XNT = Low Cab Forward. D = Conventional Cab. S = School Bus. W = 4-Wheel Drive.				

ITEM	PART NUMBER	QTY	MODEL	DESCRIPTION
				FAN AND DRIVE BELT AND PULLEYS 225 ENGINE A-D-W MODELS
	4115 456			Bracket, Air Pump Idler Pulley 1978
	4095 467			PULLEY, Drive W/Auto W/AC 1978
	3685 687			1979-80-81
	3830 197			PULLEY, Idler w/Air Cond. Compressor 1979-80-81
	4095 853			DRIVE Assy Viscous w/ Air Cond. And Max. Cooling 1980
	4167 771			w/Max Cooling w/o Air Cond.
	4116 952			BELT Air Cond. Compressor Drive 1979-80-81
	4106 215		AD,AW,RD	BELT A/cond. Compr. And Alt. Drive w/100 Amp. Alt. (3/8 x 58 1/8) 1979-80-81
	4106 210			w/60 Amp. Alt. (3/8 x 54 1/4) 1979-80-81
	5214 065			SHIELD Bearing Dust
	6024 473			BOLT, A/C Compr. Idler Pulley

LIGHT A = All Sport Utility (Ramcharger). B = All Compact Models. D = Conventional Cab.
DUTY AD = 2 Wheel Drive Only (Ramcharger). CB-MB = Compact Front Section Only. W = Conventional Cab 4 Wheel Drive.
CODES: AW = 4 Wheel Drive Only (Ramcharger). P = Forward Control Chassis. M = Motor Home.

MEDIUM-HEAVY CODES: XNT = Low Cab Forward. D = Conventional Cab. S = School Bus. W = 4-Wheel Drive.

AR=Use as Required # =New Part Number Printed in U.S.A. June, 1982

FAN AND DRIVE BELTS AND PULLEYS
 318, 360 ENG. B MODELS

8307 950

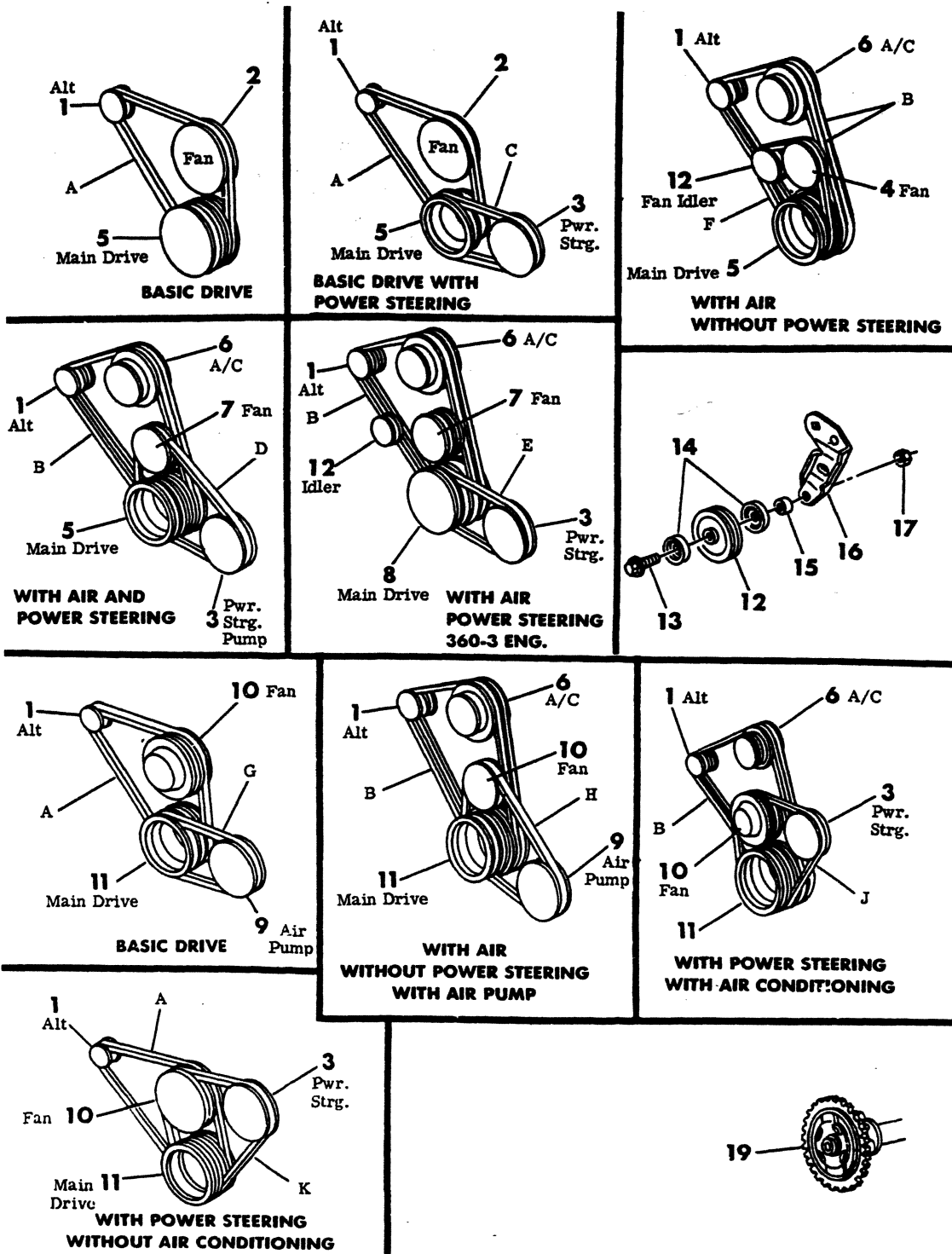

ITEM	PART NUMBER	QTY	MODEL	DESCRIPTION
FAN AND DRIVE BELTS AND PULLEYS 318, 360 ENG. B MODELS				
1				Pulley, Altr. (refer to group 8)
2	2951 836			PULLEY, Fan Single Groove 1978-79
	4031 659		MB3-4	w/100 Amp. Alt. w/o A/C Double Groove 360 Eng. 1979 Up To 2-1-79
	3698 803		MB3-4	After, 2-1-79
	4036 499			w/100 Amp Alt. w/o a/c. Double Groove 360 Eng. Up To 2-1-79
	3698 801			After 2-1-79
	4164 870		CB,MB	w/o Air Cond Double Groove 1980-81
3				Pulley, Pwr. Strg. (refer to group 19)
4	3870 211			Pulley, Fan w/ Air Cond. Double Groove
	3870 212		B1-2-3	Pulley, Fan w/ o Air Cond. Double Groove 1980-81
5	3614 375			Pulley, Drive Single Groove With P/S 1978-79
	3614 378			Double Groove 1978-79
	3640 852			Three Groove 1978-79
	3870 069			PULLEY, Drive w/o Air Cond. Three Groove 1980-81
	3870 074			w/Air Cond Four Groove
6				Pulley, air cond. (refer to Group 24)
7	3698 805			Pulley, Fan w/Air Cond. Double Groove 5 7/8 O.D. 1979-80-81
	4036 499		MB 3-4	Pulley, Fan w/o Air. Cond. And w/o Air Pump Double Groove 1979 After 2-1-79
	3698 801		MB 3-4	After, 2-1-79
8	3614 378			Pulley, Drive w/o Air Pump Double Groove 1978-79
	4031 660			Pulley, Drive w/o Air Pump Four Groove 1978-79
	3640 852			Pulley, Drive w/Air Pump Three Groove 1978-79
	3614 382			Pulley, Drive w/Air Pump Four Groove 1978-79
9				Pulley, air pump (refer to Group 25)
10	2951 836			Pulley, Fan Single Groove w/Air Pump 360 Eng. 1978-79
	3698 803			After, 2-1-79
	4031 659		MB3-4	Pulley, Fan w/100Amp Alt. Double Groove UP To 2-1-79
	4036 499			Pulley, Fan w/Pwr. Strg. w/o Air Cond. Double Groove 1978
	3870 211			Pulley, Fan w/Air Cond. Double Groove 318,360-2,360-4 Eng. 6 3/8 o.d 1978-79
	3751 126		CB-MB4	Pulley, Fan w/Air Cond. 360-3 Eng. Single Groove 5 7/8 O.D. 1979
	3698 805			Double Groove 5 7/8 o.d. 1980-81
	4036 499		MB3-4	PULLEY, Fan w/Air Pump And Power Strg. w/o Air Cond. Up To 2-1-79
	3698 801		MB3-4	After, 2-1-79
11	3640 852			Pulley, Drive Three Groove 1978-79
	3614 377			Pulley, Drive Three Groove 1978-79
12	3830 196			Pulley & Bracket Idler Complete 1978-79
	3879 131			Pulley Idler w/100 Amp. Alt. 1978
13	9418 275			Screw, 318,360 eng. (7/16 - 14 x 1.50)
	6024 473			Screw, 360-3 eng. (7/16 - 14 x 2.00)
14	5214 065	2		SHIELD, Bearing
15	6028 607	2		SPACER 1978
16	3830 226			Bracket, Idler Mtg. w/o 100 Amp Altr. 1978
	4037 612	1		Bracket, Mtg W/ 100 Amp Altr. 1978-79
17	271 502			Nut, (7/16 - 14)
18	6028 166			Screw, (3/8 - 16 x 5.25)
19	4095 703			Drive Assy. Viscous w/o Air. Cond. w/Max. Cooling 318-360 Eng.
	4095 853			W/225 end.W/max cool

LIGHT A = All Sport Utility (Ramcharger).

B = All Compact Models.

D = Conventional Cab.

DUTY AD = 2 Wheel Drive Only (Ramcharger).

CB-MB = Compact Front Section Only.

W = Conventional Cab 4 Wheel Drive.

CODES: AW = 4 Wheel Drive Only (Ramcharger).

P = Forward Control Chassis.

M = Motor Home.

MEDIUM-HEAVY CODES: XNT = Low Cab Forward. D = Conventional Cab. S = School Bus. W = 4-Wheel Drive.

AR=Use as Required

=New Part Number

Printed in U.S.A.

June, 1982

1978-81 LIGHT DUTY TRUCK PARTS CATALOG

COOLING

ITEM	PART NUMBER	QTY	MODEL	DESCRIPTION
	4167 771			318-360 Eng. w/Std. Cooling
	3769 617			w/ Air Cond. 1978-79
225 W / Max. Cooling 1981				
A	4106 207			Belt, Fan & Altr.(3/8x47 3/4")
	4027 328		MB3-4	3/8 x 47 1/8 1979
	4041 438			3/8 x 48 1/4 1979
	4179 866			BELT, Fan And Alt. w/100 Amp. Alt. 318-360 Eng. 1980
B	4106 210			Belt, Fan & Altr.w/Air. Cond. w/o 100 Amp. Altr.(38x54 1/4)
	4106 215			Belt, a/c Compr. & Altr. Drive w/100 Amp. Altr. (3/8x58 1/8) 1979 -80-81
	4106 210			w/60 Amp. Alt. 1979-80-81
C	3870 244			Belt, Pwr. Strg. 318-360 Eng. (3/8 x 36 1/2) 1978-79-80-1
	4106 205			w/100 Amp. Alt. 318-360 Eng. (3/8 x 45-1/2) 1978
D	4027 321			BELT, Pwr. Strg. 318 Eng. (3/8 x 45 1/8) 1978-79
	4041 437			Belt, Power Strg. 318-360 Eng. (3/8 x 44 1/4)
	4106 204			Belt, Pwr. Strg. 318-360 Eng. w/Air. Cond. (3/8x443/4") 1978
E	3870 244			BELT,Pwr. Strg. w/o Air. Cond. 360-3 Eng.(3/8 x 36-5/8) 1978-79
	4027 322			BELT,Pwr. Strg. w/o Air. Cond. 360 Eng.(3/8 x 43-1/2) 1978-79
	5214 161			Belt, Pwr. Strg. w/Air Cond. 360-3 Eng. 1978
F	5214 136			Belt,Fan Drive 318 Eng. (3/8 x 37 1/4) 1978
	4106 201			BELT, Fan Drive 318-360 Eng. 1978
	5214 163		CB-MB	BELT, Fan Drive 360-3 Eng. 1978
G	4027 325			Belt,Air Pump Lt. & Med Cycle Eng. (3/8 x 35 1/8)
	4106 201			(3/8 x 34 1/4) 1980
	3462 866			w/Heavy Duty Cycle Eng. 1978-79
	5214 163			BELT, Air Pump w/o Air Cond. (3/8 x 36)
H	4027 321			BELT, Air Pump w/Air Cond. 1978
	4106 205			3/8 x 45 1/2 1979
	4041 437			3/8 x 44 1/4 1980-81
J	4041 437			Belt, Pwr. Strg. 1978-79-80
K	3837 673			Belt, Pwr. Strg. 318 Eng. 1978

LIGHT A = All Sport Utility (Ramcharger). B = All Compact Models. D = Conventional Cab.
DUTY AD = 2 Wheel Drive Only (Ramcharger). CB-MB = Compact Front Section Only. W = Conventional Cab 4 Wheel Drive.
CODES: AW = 4 Wheel Drive Only (Ramcharger). P = Forward Control Chassis. M = Motor Home.

MEDIUM-HEAVY CODES: XNT = Low Cab Forward. D = Conventional Cab. S = School Bus. W = 4-Wheel Drive.

AR=Use as Required

=New Part Number

Printed in U.S.A.

June, 1982

1978-81 LIGHT DUTY TRUCK PARTS CATALOG

FAN AND DRIVE BELTS AND PULLEYS 318, 360 ENG. A-D-W MODELS

8307 975

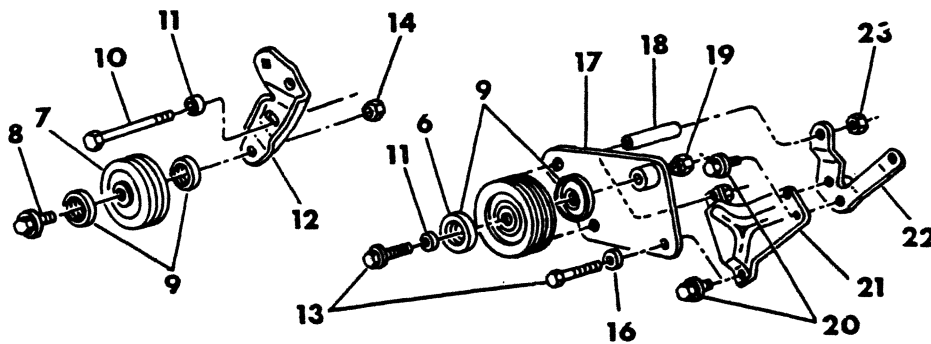
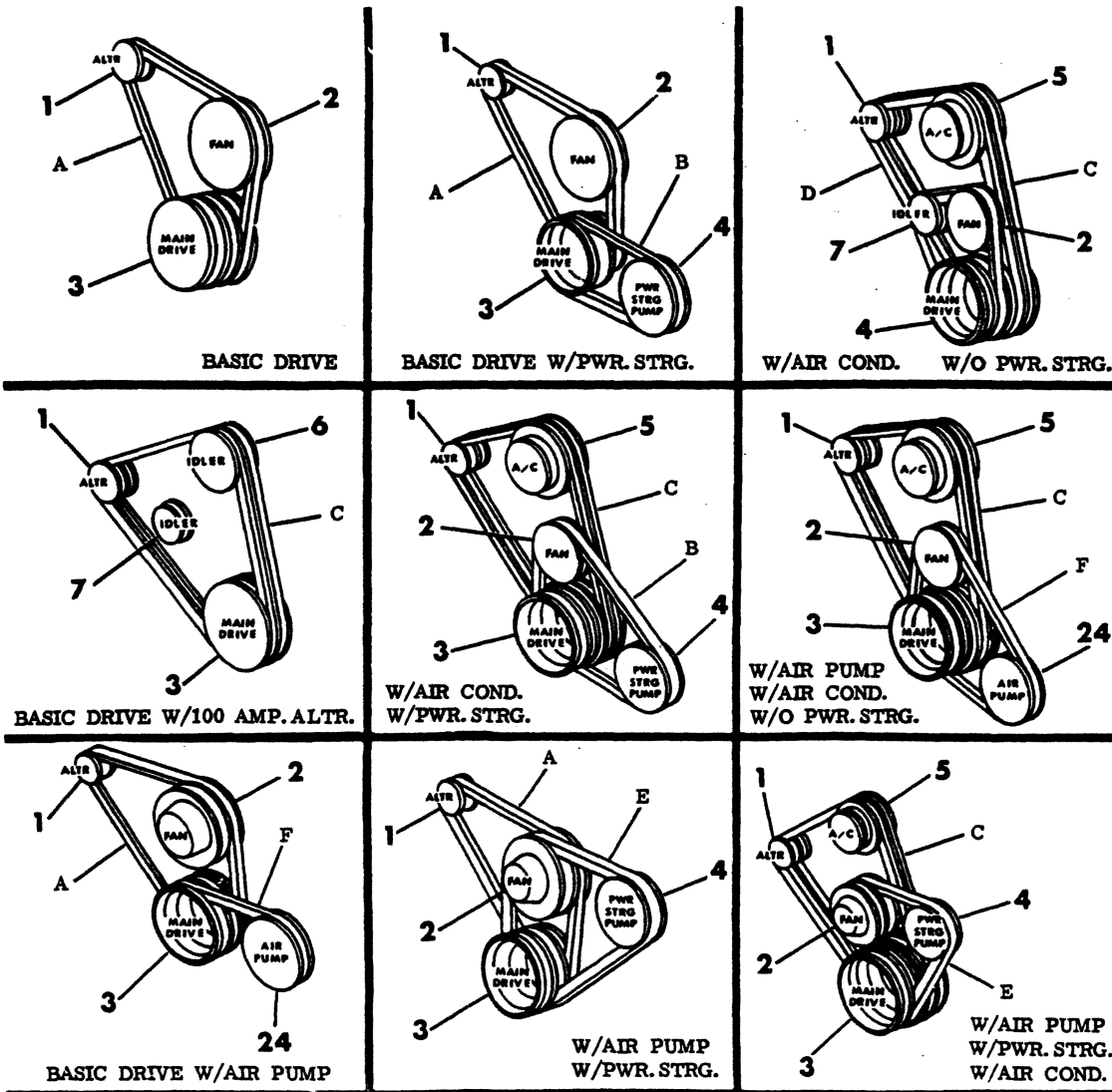

ITEM	PART NUMBER	QTY	MODEL	DESCRIPTION
FAN AND DRIVE BELTS AND PULLEYS				
318, 360 ENG. A-D-W MODELS				
1				PULLEY, altr. (refer to group 8)
2	2951 836			PULLEY, Fan Single Groove 1978-79
	4036 499			PULLEY, Fan w/Pwr Strg. or Air Pump Double Groove 1978
	3870 212			PULLEY, Fan w/o Air Cond. Double Groove 1980-81
	3870 211			PULLEY, Fan w/Air Cond. Double Groove 1978-79
	3698 805			PULLEY, Fan w/Air Cond. 1980-81
	4031 659			PULLEY, Fan w/100 Amp. Alt. Single Groove 1978-79
	4164 870		D1	PULLEY, Fan Double Groove Hi-Perf. 1980
	3751 126			PULLEY, Fan w/360-3 Eng. Double Groove 1978
3	3614 375			PULLEY, Drive w/o Pwr. Strg. Single Groove 1978-79
	3614 377			w/360-Hi. Perf. Eng. Double Groove 1978
	3614 378			PULLEY, Drive w/Pwr. Strg. Double Groove 1978-79
	3640 852			PULLEY, Drive w/Air Pump Three Groove 1978-79
	4031 660			PULLEY, Drive w/100 Amp. Alt. Three Groove 1978-79
	3870 069			PULLEY, Drive w/o Air Cond. Three Groove
	3870 074			PULLEY, Drive w/Air Cond. Four Groove
4				PULLEY, Pwr. Strg. (Refer to Group 19)
5				PULLEY, Air Cond. Compr. (Refer to Group 24)
6	3879 131			PULLEY, Idler w/100 Amp. Alt. 1978
7	3830 196			PULLEY, Idler w/100 Amp. Alt. or w/Air Cond.
	3879 131		D1	PULLEY, Idler 360 Hi Perf. Eng.
8	9418 275			SCREW (7/16 - 14 x 1.50)
9	5214 065			SHIELD, Bearing 1978
	5214 065		D1	SHIELD, Bearing Hi-Perf. 1978
10	9411 857			SCREW (3/8 - 16 x 5.38)
11	6025 705			WASHER, Coned
12	4037 612			BRACKET, Idler w/100 Amp. Alt. 1978-79
	3830 226			BRACKET, Idler w/o 100 Amp. Alt.
13	181 146			BOLT, (7/16 - 14 x 2.25)
14	271 502			NUT, (7/16 - 14)
15	181 129			BOLT, (3/8 - 16 x 2.75)
16				WASHER, Coned
17	4071 734			BRACKET, Alt. Belt Idler 1978-79
18	6030 520			SPACER
19	271 502			NUT (7/16 - 24)
20	181 112			SCREW (3/8 - 16 .88)
21	3830 123			BRACKET, Rear 1978
22	4071 733			BRACKET, Alt. Mtg. Supt. Rear
23				NUT (3/8 - 16)
24				PULLEY, Air Pump (Refer to Group 25)
A	4106 207			BELT, Fan & Alt. (3/8 x 47-3/4")
	4041 438			3/8 x 48 1/4 1979-81
	4179 866			BELT, Fan And Alt. w/o Air cond. w/100 Amp. Alt. 318-360Eng. 1980
	4106 201			BELT, Fan (3/8 x 37) 1978
	4106 210			BELT, Alt. Drive w/o Air Cond. 360 HI. Performance Eng. 1978
B	3870 244			BELT, Pwr. Strg. w/o Air Cond. 1978-79
	2951 898			BELT, Pwr. Strg. (3/8 x 45 1/2) 1978-79
	4041 437			BELT, Pwr. Strg. (3/8 x 44 1/4) 1980-81
	4106 205			BELT, Pwr. Strg. w/100 Amp. Alt. 1978

LIGHT A = All Sport Utility (Ramcharger).
DUTY AD = 2 Wheel Drive Only (Ramcharger).
CODES: AW = 4 Wheel Drive Only (Ramcharger).

B = All Compact Models.
 CB-MB = Compact Front Section Only.
 P = Forward Control Chassis.

D = Conventional Cab.
 W = Conventional Cab 4 Wheel Drive.
 M = Motor Home.

MEDIUM-HEAVY CODES: XNT = Low Cab Forward. D = Conventional Cab. S = School Bus. W = 4-Wheel Drive.

AR=Use as Required

=New Part Number

Printed in U.S.A.

June, 1982

1978-81 LIGHT DUTY TRUCK PARTS CATALOG

COOLING

ITEM	PART NUMBER	QTY	MODEL	DESCRIPTION
------	-------------	-----	-------	-------------

FAN AND DRIVE BELTS AND PULLEYS 318, 360 ENG. A-D-W MODELS

	4027 321			BELT, Pwr. Strg. w/Air Cond. w/o 100 Amp. Alt. 1978-79
	3837 673			BELT, pwr. strg. drive w/o air cond. 1979
C	4027 338			BELT, altr. & compr. w/o 100 amp altr. 3/8 x 54.96 w/o air cond.
	4106 210			BELT, a/c & Altr w/air w/o 100 Amp. Altr. (3/8 x 54 1/4) 1978
	4027 312			w/ 100 Amp Altr. (3/8 x 58-1/8)
	4106 215			Belt, a/c And Altr. Drive w/100 Amp. Altr. (3/8 x 58 1/8)
	4106 210			w/60 Amp. Alt.
D	4027 305			BELT, Fan Drive w/o Pwr Strg. w/o Air Pump (3/8 x 37 1/2) 1978-79
E	3837 673			BELT, Fan And Pump 1978
F	4027 325			BELT, Air Pump w/o Air Cond. Lt. & Med. Cycle (3/8x 35 1/8)
	3462 866			BELT, Air Pump w/o Air Cond. HD. Cycle (3/8 x 36) 1978-79
	4106 201			BELT, Air Pump w/o Air Cond. (3/8 x 34 1/4) 1980
	4106 204			BELT, Air Pump w/ Air Cond. (3/8 x 44 3/4) 1978
	4106 205			BELT, Air Pump w/Air. Cond. (3/8 x 45 1/2) 1979
	4041 437			BELT, Air Pump w/Air. Cond. 3/8 x 4 1/4 1980-81
	5214 163			BELT, Air Pump w/o Air Cond. w/Emission Sys. 1 3/8 x 36 1980-81
	4095 703	D1		DRIVE, Assy Viscous w/Hi Perf. Eng. (Not Shown)
	4095 703	D1-2-3-RD2		w/318-360 Eng. w/o Air Cond. w/Max. Cooling
	4095 704	D-AD-AW-RD		w/Air Cond. And Max. Cooling 318-360 Eng. 1980-81
	4095 704	D1		w/Air Cond. And Max. Cooling Hi Perf 1980
	3769 617	D-AD-AW-RD		w/Air Cond. 318-360 Eng. 1978-79
	4167 771	D-AD-AW		w/Std. Cooling 318-360 Eng. 1978-79-80

LIGHT	A = All Sport Utility (Ramcharger).	B = All Compact Models.	D = Conventional Cab.
DUTY	AD = 2 Wheel Drive Only (Ramcharger).	CB-MB = Compact Front Section Only.	W = Conventional Cab 4 Wheel Drive.
CODES:	AW = 4 Wheel Drive Only (Ramcharger).	P = Forward Control Chassis.	M = Motor Home.
MEDIUM-HEAVY CODES:	XNT = Low Cab Forward.	D = Conventional Cab.	S = School Bus. W = 4-Wheel Drive.

AR = Use as Required

= New Part Number

Printed in U.S.A.

June, 1982

FAN AND DRIVE BELTS AND PULLEYS
 400- 440 Engine 1978

8307 1100

WITHOUT AIR PUMP

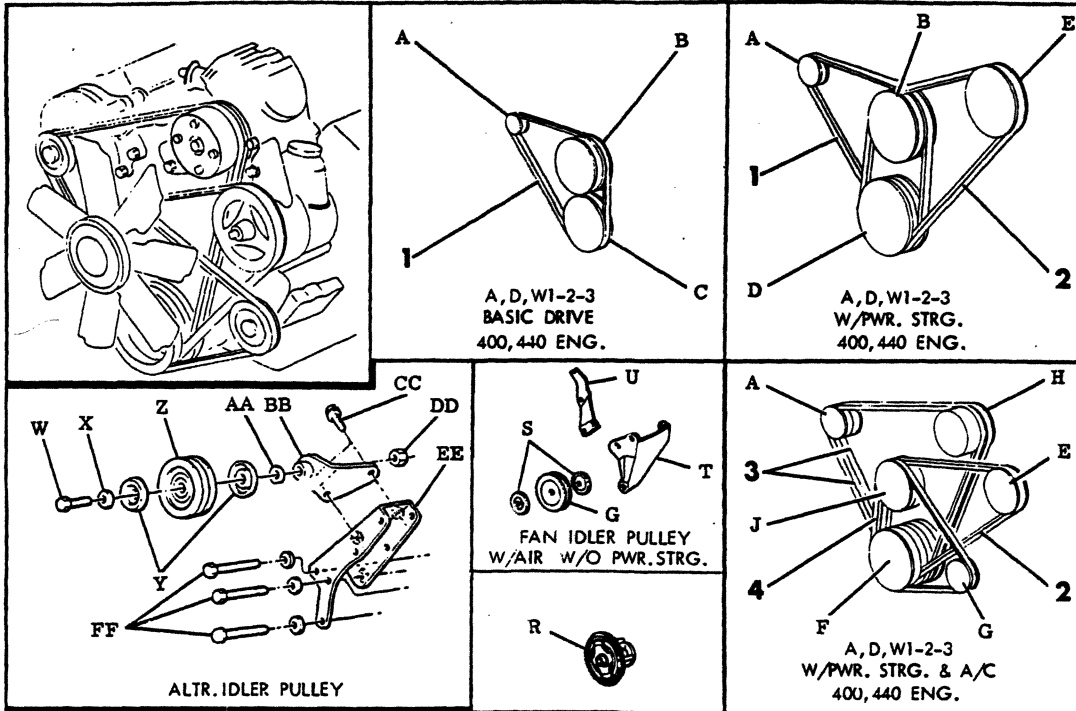

WITH AIR PUMP

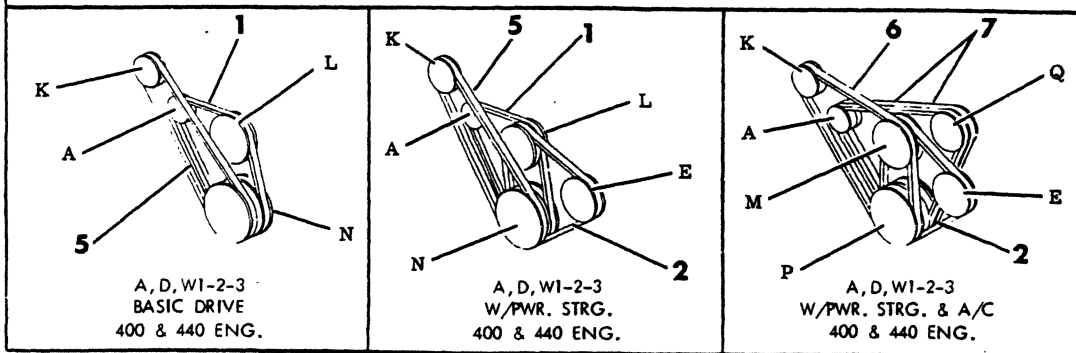

ITEM	PART NUMBER	QTY	MODEL	DESCRIPTION
------	-------------	-----	-------	-------------

FAN AND DRIVE BELTS AND PULLEYS

400- 440 Engine 1978

A				PULLEY, Altr. (refer to group 8)
B	4026 815			PULLEY, Fan
	3870 072	1		w/100 amp. alt.
C	3769 134	1		PULLEY, Drive single groove
D	4030 686	1		PULLEY, Drive double groove
	3870 074	1		three groove
E		1		PULLEY, Pwr. strg. pump drive (refer to group 19)
F	3614 382	1		PULLEY, Drive four groove
G	3830 196	1		PULLEY, Idler
	3830 219	1		PULLEY, Idler w/ bracket
H		1		PULLEY, Air compr., (refer to group 24)
J	3698 917	1		PULLEY, Fan
K		1		PULLEY, Air pump, (refer to group 25)
L	3698 811	1		PULLEY, Fan w/o air cond.
M	3698 917	1		PULLEY, Fan w/ air cond.
N	3769 984	1		PULLEY, Drive w/o air cond.
P	3614 382	1		PULLEY, Drive w/ air cond.
Q		1		PULLEY, Air compr. (refer to group 24)
R	3769 614	1		DRIVE Assy., Fan w/o air cond
	3462 179	1		w/ air cond
S	3769 685	2		SHIELD, Idler pulley
T	3830 220	1		BRACKET
U	3698 652	1		SUPPORT Assy.
W	181 146	1		BOLT, 7/16-14x3.25
X	6023 050	1		WASHER, coned
Y	5214 065	1		SHIELD
Z	3879 131	1		PULLEY, Altr. Idler
AA		1		SPACER (not serviced)
BB	4071 722	1		BRACKET Assy.
CC		1		BOLT (not serviced)
DD	271 502	1		NUT 7/16-14
EE	4027 171	1		BRACKET
FF		1		BOLT (not serviced)
1	4106 206	1		BELT, Fan And Altr. Drive (3/8 x 46")
2	4041 407	1		BELT, Pwr. strg. pump drive
3	4027 310	1		BELT, Air cond and altr. - Dual
	4027 316	2		BELT, Air cond and altr. - Dual 100 amp. alt. 400 eng.
	4027 347	2		BELT, Air cond and altr. - Dual 100 amp. alt. 440 eng.
4	4041 437	1		BELT, Fan drive
5	2658 789	1		BELT, Air pump drive w/o air cond
6	3527 684	1		BELT, Air pump drive w/ air cond
7	3751 382	1		BELT, Dual altr. and air cond compr.
NOTE:	THE FOLLOWING ITEMS ARE NOT SHOWN ON ILLUSTRATION (Use With 100 Amp Alternator)			
	4027 345			440 Eng.
	4027 347			BELT, Air Cond And Altr. Drive w/ 400 440 Eng.
	3879 131			PULLEY assy, Idler w/o air cond.
	3870 204			BRACKET assy idler, w/o air cond.

LIGHT A = All Sport Utility (Ramcharger).

B = All Compact Models.

D = Conventional Cab.

DUTY AD = 2 Wheel Drive Only (Ramcharger).

CB-MB = Compact Front Section Only.

W = Conventional Cab 4 Wheel Drive.

CODES: AW = 4 Wheel Drive Only (Ramcharger).

P = Forward Control Chassis.

M = Motor Home.

MEDIUM-HEAVY CODES: XNT = Low Cab Forward. D = Conventional Cab. S = School Bus. W = 4-Wheel Drive.

AR = Use as Required

= New Part Number

Printed in U.S.A.

June, 1982

1978-81 LIGHT DUTY TRUCK PARTS CATALOG

COOLING

ITEM	PART NUMBER	QTY	MODEL	DESCRIPTION
------	-------------	-----	-------	-------------

FAN AND DRIVE BELTS AND PULLEYS 400- 440 Engine 1978

4094 028

Pulley, Fan and Altr.

LIGHT	A = All Sport Utility (Ramcharger).	B = All Compact Models.	D = Conventional Cab.
DUTY	AD = 2 Wheel Drive Only (Ramcharger).	CB-MB = Compact Front Section Only.	W = Conventional Cab 4 Wheel Drive.
CODES:	AW = 4 Wheel Drive Only (Ramcharger).	P = Forward Control Chassis.	M = Motor Home.

MEDIUM-HEAVY CODES: XNT = Low Cab Forward. D = Conventional Cab. S = School Bus. W = 4-Wheel Drive.

AR=Use as Required

=New Part Number

Printed in U.S.A.

June, 1982

FAN AND DRIVE BELTS AND PULLEYS
B 400 and 440 ENGINES 1978

8307 1200

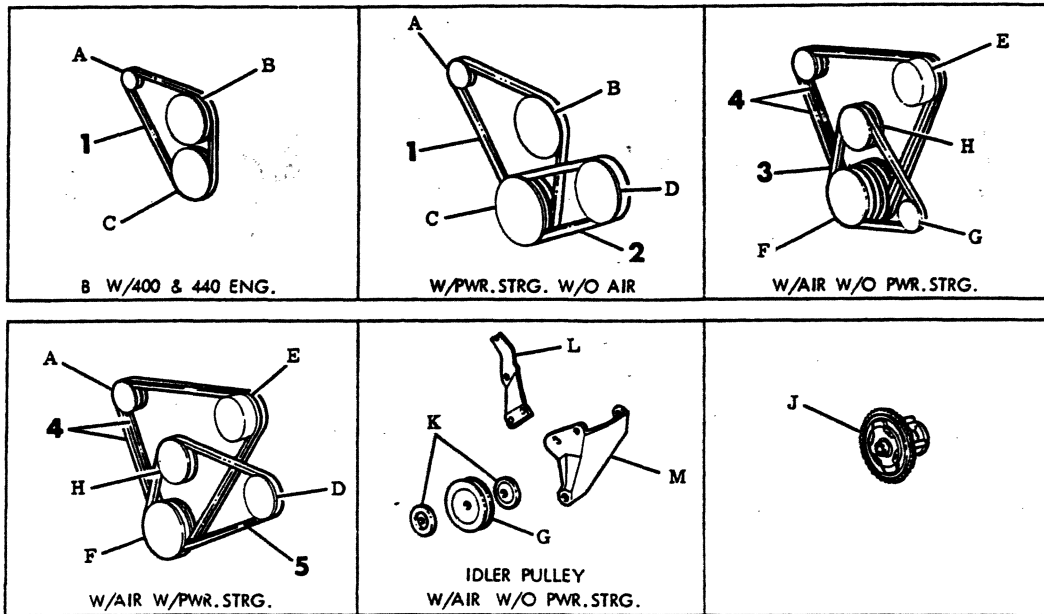

ITEM	PART NUMBER	QTY	MODEL	DESCRIPTION
A				PULLEY, Altr., (refer to group 8)
B	3769 145			PULLEY, Fan 1
C	3769 134			PULLEY, Drive, Single Groove
	3769 148			Double Groove
D				PULLEY, pwr. strg. pump (refer to group 19)
E				CLUTCH, Air cond compr. (refer to group 24)
F	3614 382			PULLEY, Drive Four Groove
G	3830 196			PULLEY, Idler
	3830 219			Idler and Bracket
H	3698 917			PULLEY, Fan
J	3769 614			DRIVE Assy, Fan w/o Air Cond.
	3462 179			w/Air Cond.
K	5214 065			SHIELD, Idler Pulley
L	3698 652			SUPPORT Assy.
M	3830 220			BRACKET
	4027 171		CB-MB	BRACKET, Assy.w/440-3 Eng. w/o Air Cond.
1	4106 206			BELT, Fan And Alternator (3/8 x 46")
	4031 485			BELT, Fan And Idler (3/8 x 35 1/2)
	4106 214		CB-MB	Alternator, Drive
2	4027 331			BELT, Power Strg. (3/8 x 43")
3	4041 437			BELT, Fan And Idler (3/8 x 44 1/2)
4	4027 310			BELT, Fan, altr. and air cond. compr.
5	3837 671			BELT, Power Strg.

LIGHT DUTY CODES: A = All Sport Utility (Ramcharger). B = All Compact Models. D = Conventional Cab.
AD = 2 Wheel Drive Only (Ramcharger). CB-MB = Compact Front Section Only. W = Conventional Cab 4 Wheel Drive.
AW = 4 Wheel Drive Only (Ramcharger). P = Forward Control Chassis. M = Motor Home.

MEDIUM-HEAVY CODES: XNT = Low Cab Forward. D = Conventional Cab. S = School Bus. W = 4-Wheel Drive.

AR=Use as Required

= New Part Number

Printed in U.S.A.

June, 1982

FAN BELTS AND PULLEYS
MB3-4 440 ENGINE

8307 1225A

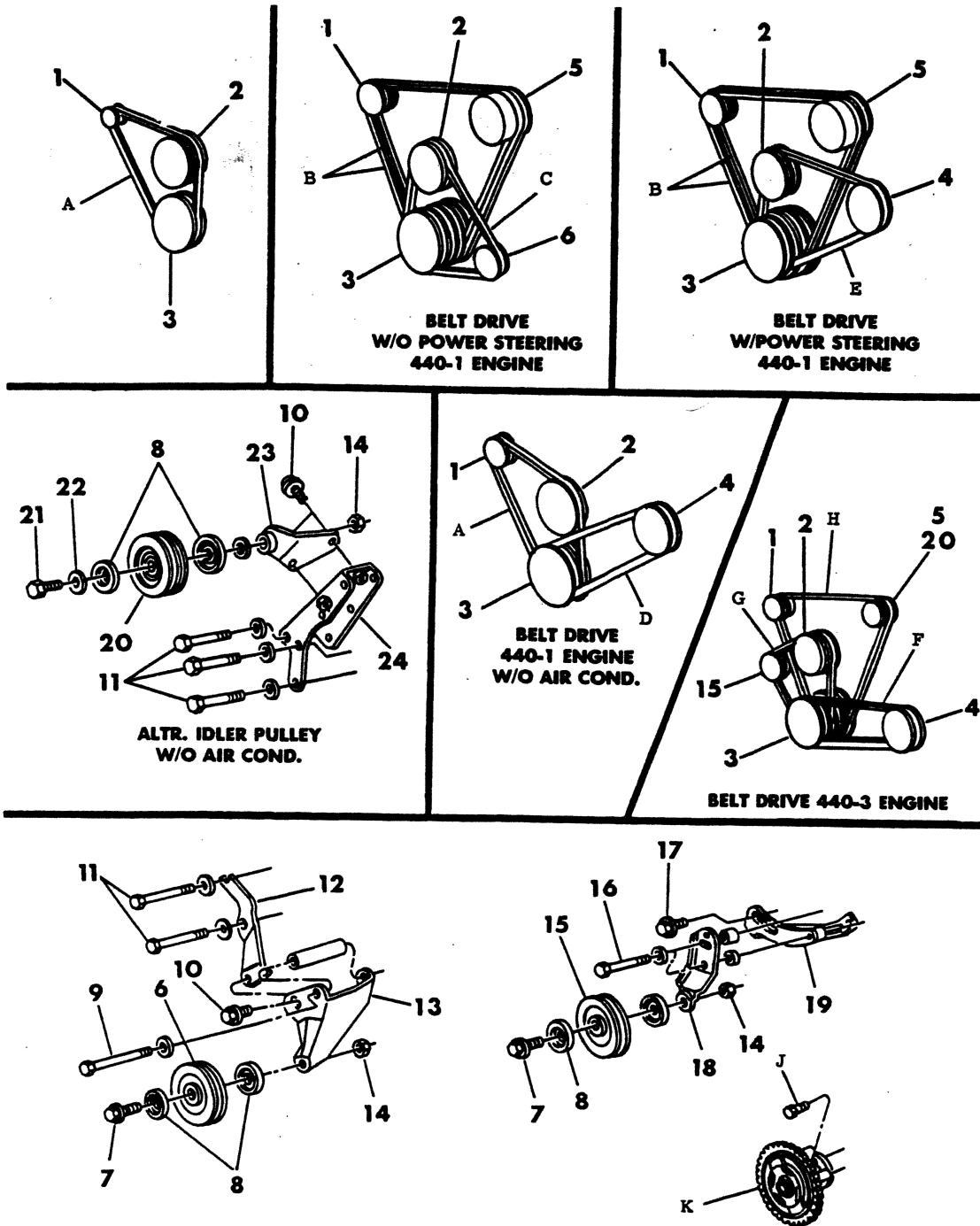

ITEM	PART NUMBER	QTY	MODEL	DESCRIPTION
FAN BELTS AND PULLEYS				
MB3-4 440 ENGINE				
1		1		PULLEY, Altr. (refer to group 8)
2	3769 145	1		PULLEY, Fan 440-1 Eng. Single Groove w/o Air Cond. 1978
	3698 917	1		440-1 Eng. Double Groove w/Air Cond. 1978
	3462 685	1		440-1-440-3 Eng. Doble Groove 1979
3	3769 134	1		PULLEY, Drive 440-1 Single Groove w/o Pwr. Strg. w/o Air Cond. 1978
	3769 148	1		440-1 Double Groove w/o Air Cond. 1978
	4031 660	1		440-1-440-3 Eng. Four Groove w/o Air cond. 1979
	3614 382	1		440-1 Four Groove w/Air Cond. 1978
	4031 660	1		440-1-440-3 Four Groove w/Air Cond 1979
4		1		PULLEY, pwr. strg. (refer to group 19)
5		1		PULLEY, air cond. (refer to group 24)
6	3830 196	1		PULLEY, Idler 1978-79
7	9418 275	1		SCREW, (7/16 - 14 x .875)
8	5214 065	2		SHIELD, Bearing 1978-79
9	9418 259	1		SCREW, (3/8 - 16 x 5.75)
10	181 112	1		SCREW, (3/8 - 18 x .88)
11	433 105	2		SCREW, (3/8 - 16 x 3.50)
12	3698 652	1		SUPPORT, Idler Pulley 1978-79
13	3830 220	1		BRACKET 1978
14	271 502	1		NUT (7/16 - 14)
15	3830 196	1		PULLEY, Idler 1978-79
16	433 111	2		SCREW, (3/8 - 16 x 4.00)
17	181 086	1		SCREW, (7/16 - 18 x .75)
18	4115 786	1		BRACKET, Idler Pulley 1978-79
19	3894 798	1		BRACKET, Adj. 1978-79
20	3879 131	1		PULLEY, Altr. Idler 1978-79
21	181 146	1		BOLT, (7/16 - 14 x 2.25)
22	6025 705	1		WASHER, coned
23	4071 722	1		BRACKET, idler
24	4027 171	1		BRACKET 1978-79
A	4106 206	1		BELT, Alt. And Fan (3/8 x 46") 1978
	4031 485	1		3/8 x 57 1/2 1979
B	4027 310	1		BELT, a/c & Altr. Drive (3/8 x 58) 1978-79
C	4041 437	1		BELT, Fan Drive (3/8 x 44 1/2) 1978-79
D	4027 331	1		BELT, Pump Drive w/o Air Cond. 440-1 Eng. (3/8 x 43) 1978-79
E	4106 208	1		BELT, Pump Drive w/ Air Cond. 440-1 eng. (3/8 x 493/4) 1978-79
F	4106 203	1		BELT, w/ or w/o Air Cond 440-3 Eng.(3/8 x 42) 1978-79
G	4031 485	1		BELT, Fan & Idler 1978-79
H	4106 214	1		BELT, Alt. And Idler Drive (3/8 x 57 1/2) 1978-79
J	220 800	1		SCREW, (5/16 - 18 .75)
K	4095 703	1		Drive Assy. Fan w/o Air Cond. 1978-79
	3769 617	1		w/Air Cond. 1978-79

LIGHT	A = All Sport Utility (Ramcharger).	B = All Compact Models.	D = Conventional Cab.
DUTY	AD = 2 Wheel Drive Only (Ramcharger).	CB-MB = Compact Front Section Only.	W = Conventional Cab 4 Wheel Drive.
CODES:	AW = 4 Wheel Drive Only (Ramcharger).	P = Forward Control Chassis.	M = Motor Home.

MEDIUM-HEAVY CODES: XNT = Low Cab Forward. D = Conventional Cab. S = School Bus. W = 4-Wheel Drive.

AR=Use as Required

#=New Part Number

Printed in U.S.A.

June, 1982

FAN AND DRIVE BELTS AND PULLEYS
 MOTOR HOME

8307 1300

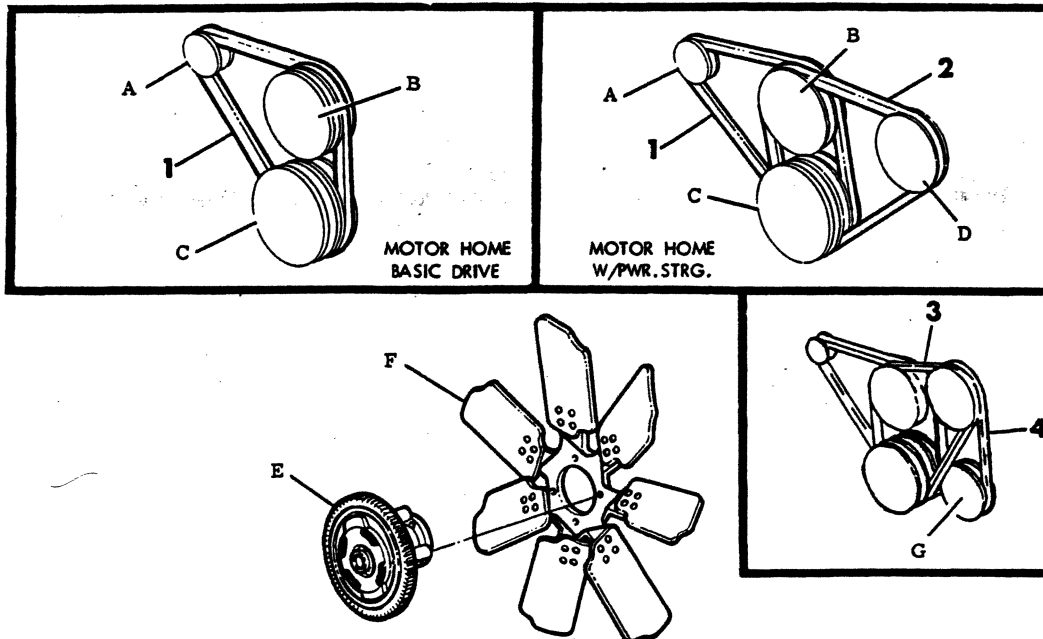

ITEM	PART NUMBER	QTY	MODEL	DESCRIPTION
A				PULLEY, Altr. (refer to code 19)
B	4036 499			PULLEY, Fan Drive w/ 360 Eng. 1978-79
	3897 917			w/ 440 Eng. 1978-79
	4164 870			PULLEY, Fan 360-3 Eng. w/o Air Cond. 1980
	3698 801			361-2,360-3 Eng. 1981
C	4030 644			PULLEY, Drive Assy. w/ 360 Eng. 1978-79
	3870 069			w/360 Eng. Three Groove 1980-81
	3897 916			w/ 440 Eng. 1978-79
D			PULLEY, pwr. strg. pump (refer to code 19)	
E	3898 276			DRIVE Assy., Fan
F	4117 084			FAN Assy, 20"
G	4027 343			PULLEY, Air Pump 1978-79
1	3733 345			BELT, Fan And Altr. w/318 Eng. 1978-79
	4106 207			w/360 Eng. (3/8 x 47-3/4")
	4179 866		M3-4	w/360 Eng. w/o Air Cond. 100 Amp. Alt. 1980
	2951 898			w/440 Eng. 1978-79
	4041 438			w/360-3 Eng. (3/8 x 48 1/4) 1981
2	4106 201		MB3	BELT, Fan w/318-360 Eng. (3/8 x 37) 1978
	3733 346			BELT, Pwr. Strg., w/ 318 Eng. (3/8 x 47) 1978
	4027 321			w/360 Eng. (3/8 x 45 1/8) 1978-79
3	4041 437			w/ 360 Eng. (3/8 x 44 1/2) 1980-81
	3837 673			BELT, Power Strg. 1978
4	4031 485			BELT, Air Pump 1978-79

LIGHT DUTY CODES: A = All Sport Utility (Ramcharger). B = All Compact Models. D = Conventional Cab.
 AD = 2 Wheel Drive Only (Ramcharger). CB-MB = Compact Front Section Only. W = Conventional Cab 4 Wheel Drive.
 AW = 4 Wheel Drive Only (Ramcharger). P = Forward Control Chassis. M = Motor Home.

MEDIUM-HEAVY CODES: XNT = Low Cab Forward. D = Conventional Cab. S = School Bus. W = 4-Wheel Drive.

AR=Use as Required

= New Part Number

Printed in U.S.A.

June, 1982

ITEM	PART NUMBER	QTY	MODEL	DESCRIPTION
------	-------------	-----	-------	-------------

**FAN AND DRIVE BELTS AND PULLEYS
MOTOR HOME**

	5214 136			BELT, Air Pump w/o Air Cond. (3/8 x 37 1/4) 1980
	5214 163		M3-4-5	BELT, Air Pump w/o Air Cond. w/Heavy Duty Cycle 3/8 x 36 1980-81
	4027 325		M3	BELT, Air Pump w/o Air Cond. w/Heavy Duty Cycle 3/8 x 35 1/8 1980-81

LIGHT	A = All Sport Utility (Ramcharger).	B = All Compact Models.	D = Conventional Cab.
DUTY	AD = 2 Wheel Drive Only (Ramcharger).	CB-MB = Compact Front Section Only.	W = Conventional Cab 4 Wheel Drive.
CODES:	AW = 4 Wheel Drive Only (Ramcharger).	P = Forward Control Chassis.	M = Motor Home.

MEDIUM-HEAVY CODES: XNT = Low Cab Forward. D = Conventional Cab. S = School Bus. W = 4-Wheel Drive.

AR=Use as Required

= New Part Number

Printed in U.S.A.

June, 1982

PULLEYS AND BELTS M3-4-5-6-446 ENG.

ILLUSTRATION NOT AVAILABLE AT TIME OF PUBLICATION

ITEM	PART NUMBER	QTY	MODEL	DESCRIPTION
------	-------------	-----	-------	-------------

PULLEYS AND BELTS M3-4-5-6-446 ENG.

NOTE: Items listed below are not illustrated

	4117 822	1		PULLEY, Accessory Drive Four Groove 1979-80
	4213 306	1		1981
	4117 201	1		PULLEY, Air Pump
	3830 197	1		PULLEY, Idler w/Air Cond. Compressor
	4167 573	1		BELT, Air Pump
	4167 574	1		BELT, Fan And Alt. 1980-81
	5214 065	2		SHIELD, Air Cond. Comp. Idler Pulley Dust
	4117 204	1		BRACKET, Air Cond. Comp. Idler Pulley
	4167 880	1		BRACKET, Air Cond. Compressor w/o Emission Reduc. Ststem 1979-80
	4213 303	1		w/o Emission Reduction System 1981
	4167 838	1		SUPPORT, Air Cond. Compr. Mtg. Brkt. 1979-80-81
	602 2250	2		BOLT, And Washer Air Cond. Idler Brkt. Mtg.
	4112 464	1		BELT, Power Strg. (1 1/2 x 41) 1980

LIGHT	A = All Sport Utility (Ramcharger).	B = All Compact Models.	D = Conventional Cab.
DUTY	AD = 2 Wheel Drive Only (Ramcharger).	CB-MB = Compact Front Section Only.	W = Conventional Cab 4 Wheel Drive.
CODES:	AW = 4 Wheel Drive Only (Ramcharger).	P = Forward Control Chassis.	M = Motor Home.

MEDIUM-HEAVY CODES: XNT = Low Cab Forward. D = Conventional Cab. S = School Bus. W = 4-Wheel Drive.

AR=Use as Required

= New Part Number

Printed in U.S.A.

June, 1982

