

GROUP 5 - BRAKE-SERVICE

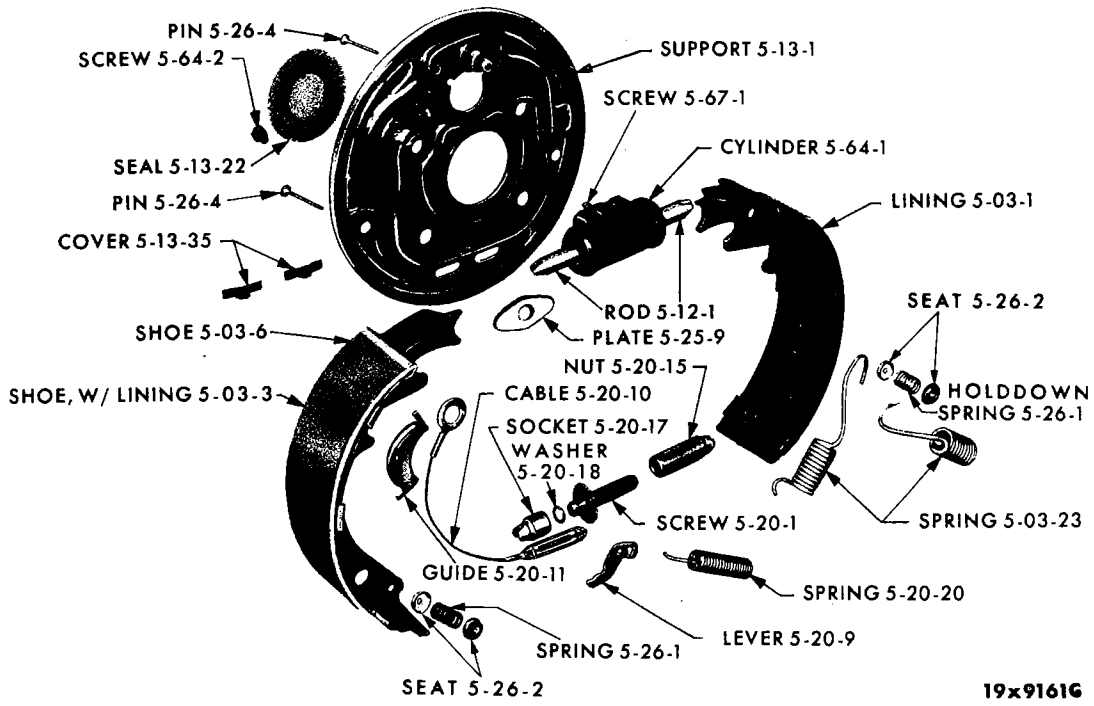

FRONT WHEEL BRAKE

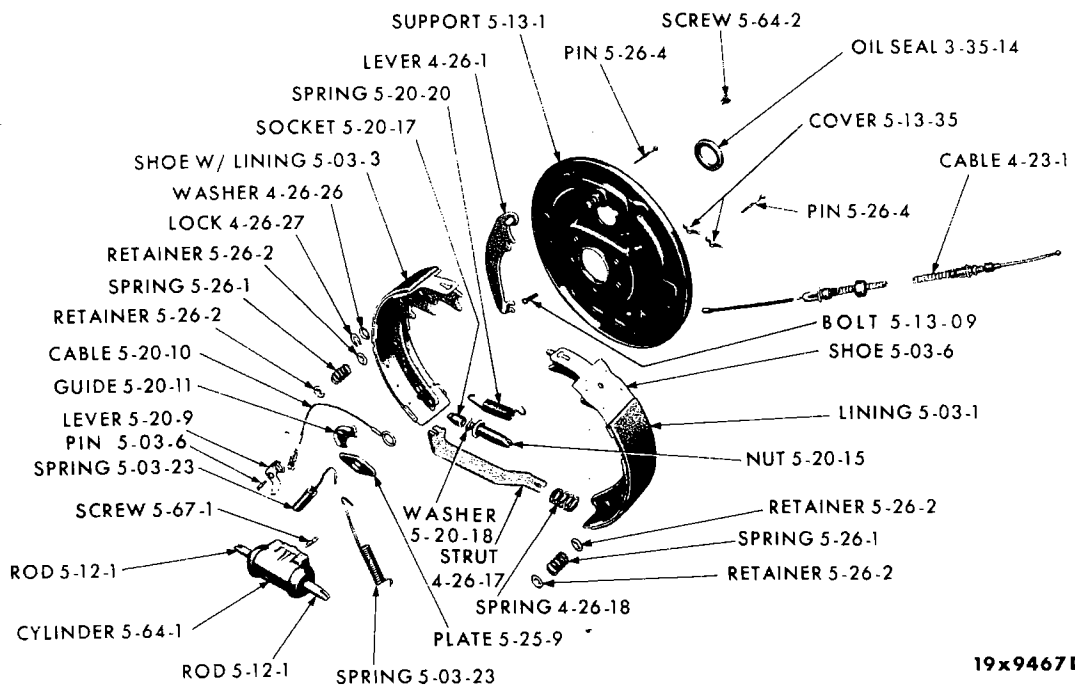

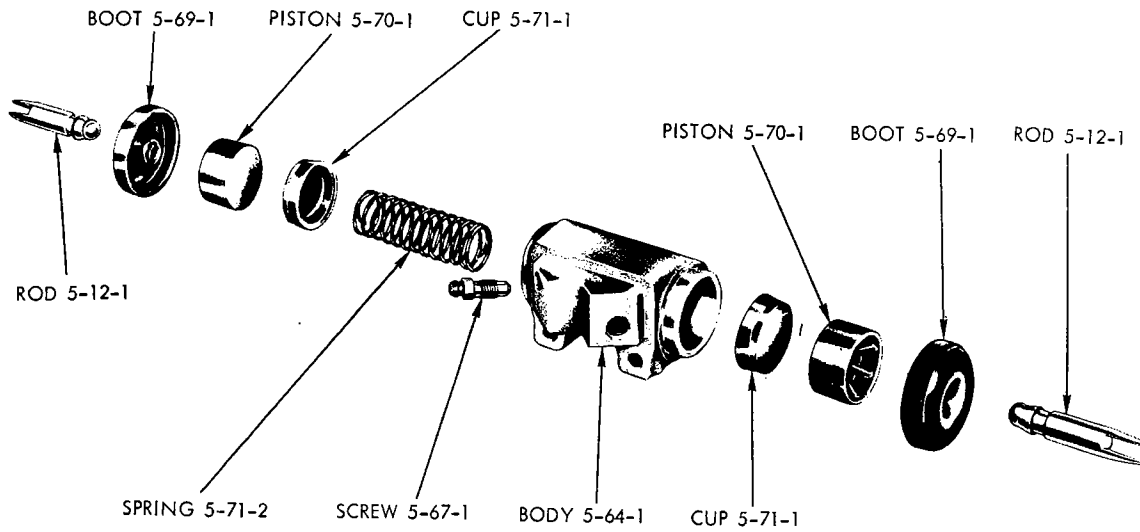

19a2879

FRONT WHEEL CYLINDER

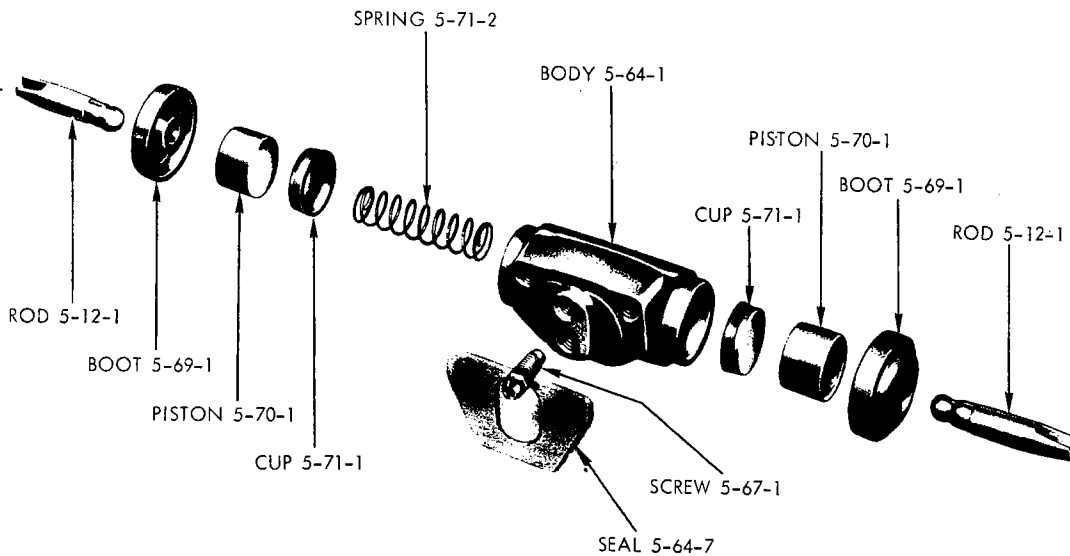

19a1099

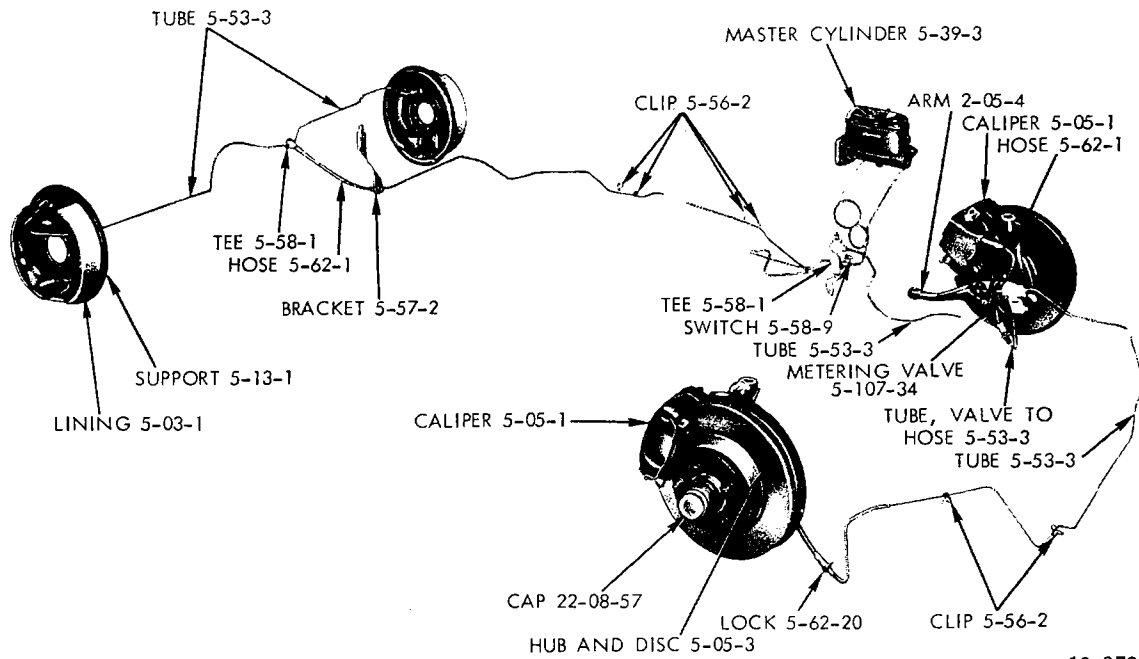

19a2790

DISC BRAKE SYSTEM - PLYMOUTH, DODGE, CHRYSLER AND IMPERIAL

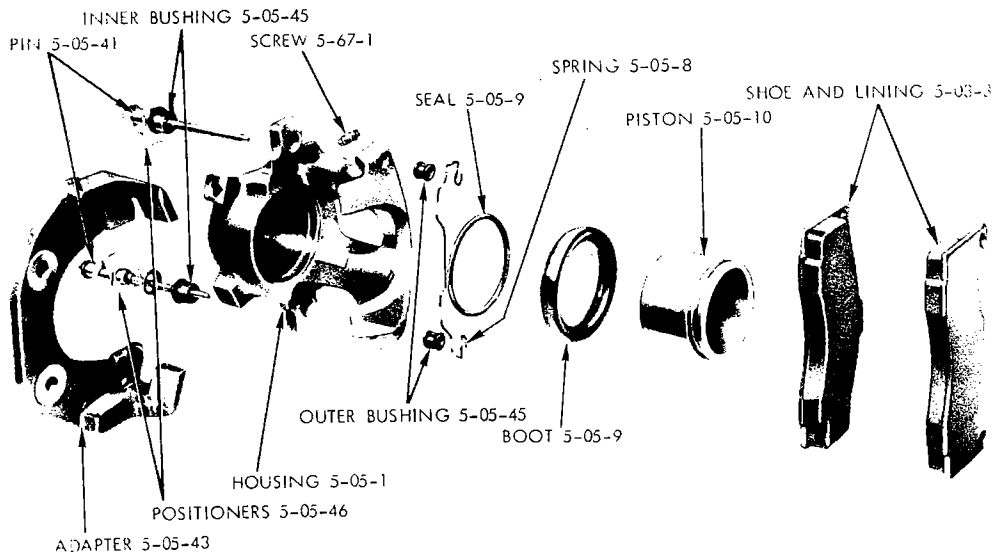

19a2432B

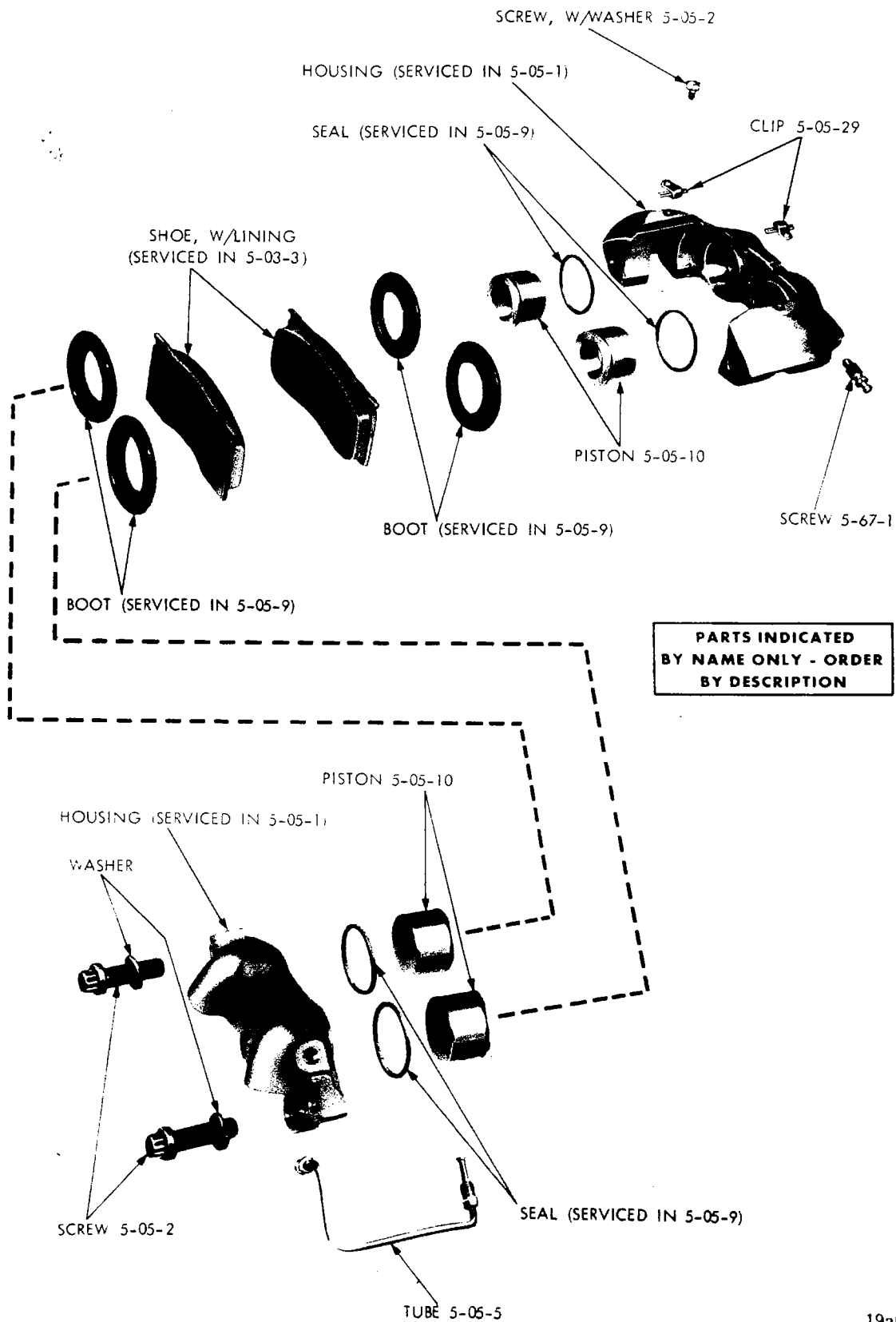

19a0487G

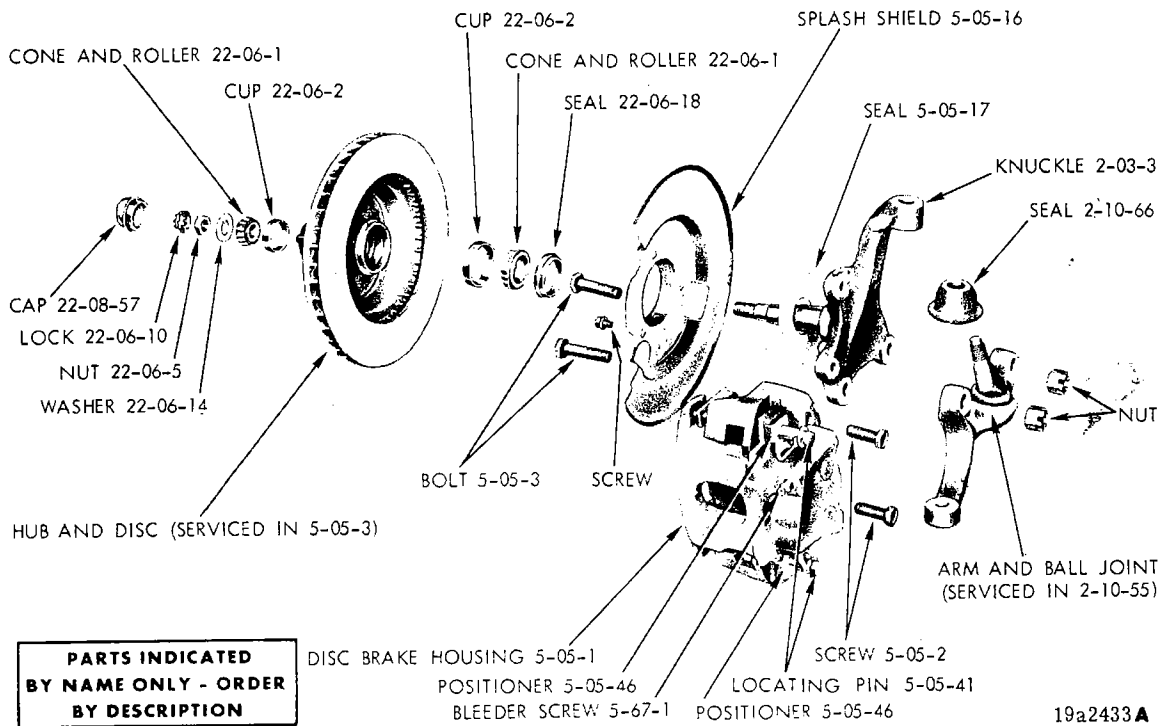

DISC BRAKE AND CALIPER - PLYMOUTH, DODGE,
CHRYSLER AND IMPERIAL

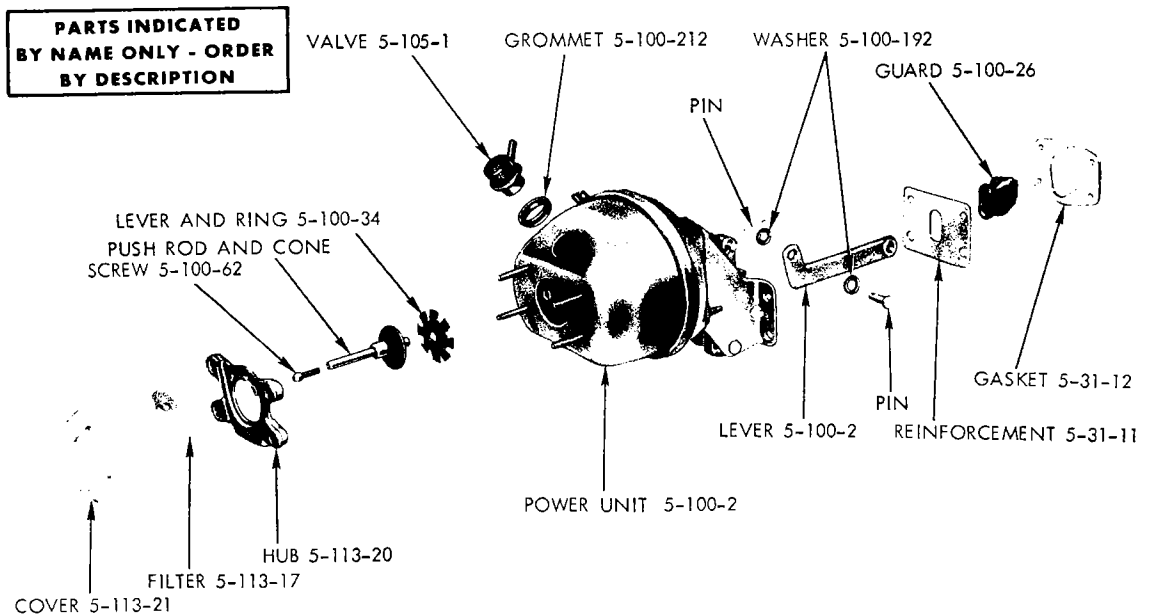

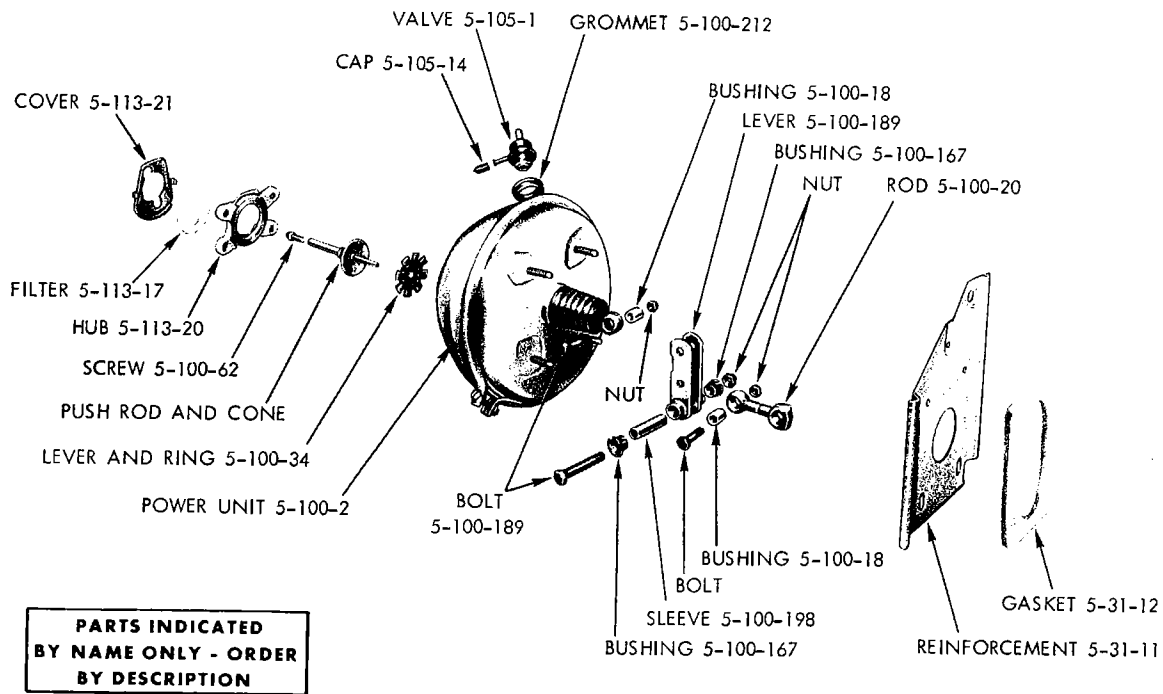

19a2442B

POWER BRAKE UNIT - BELVEDERE, CORONET, CHARGER, BARRACUDA AND CHALLENGER
 (TYPICAL OF PLYMOUTH, DODGE, CHRYSLER AND IMPERIAL)

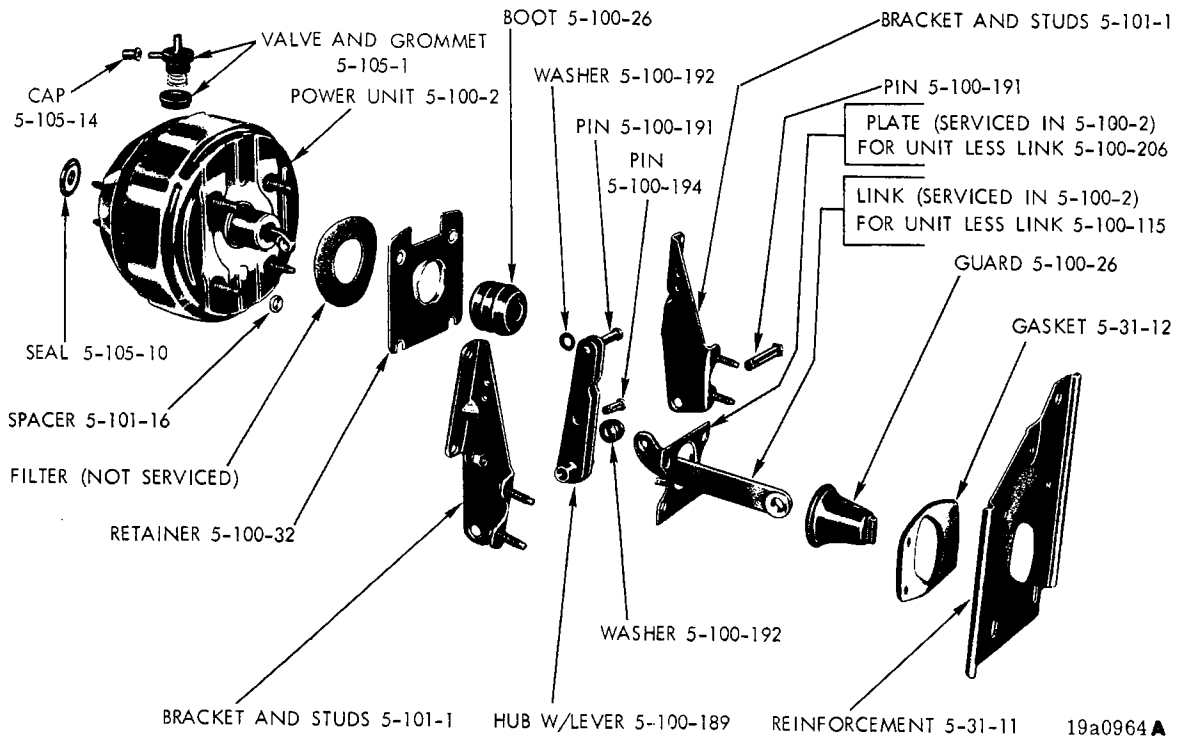

19a0964A

POWER BRAKE UNIT - BELVEDERE, CORONET, CHARGER, BARRACUDA
 AND CHALLENGER (WITH 480 ENGINE)

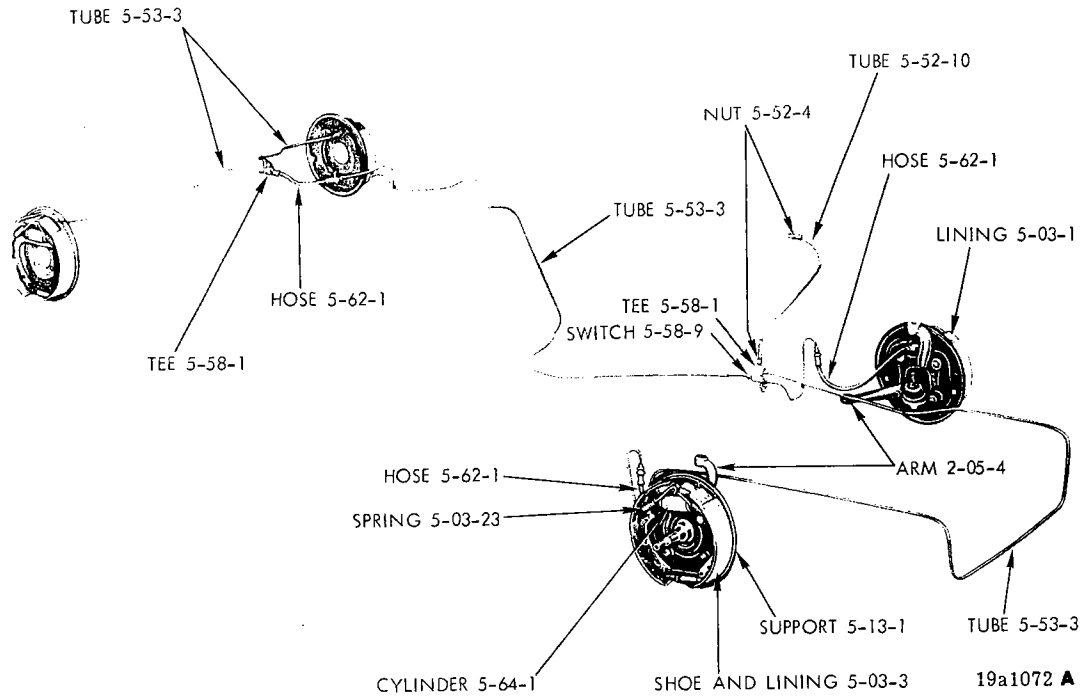

HYDRAULIC BRAKE SYSTEM - ALL

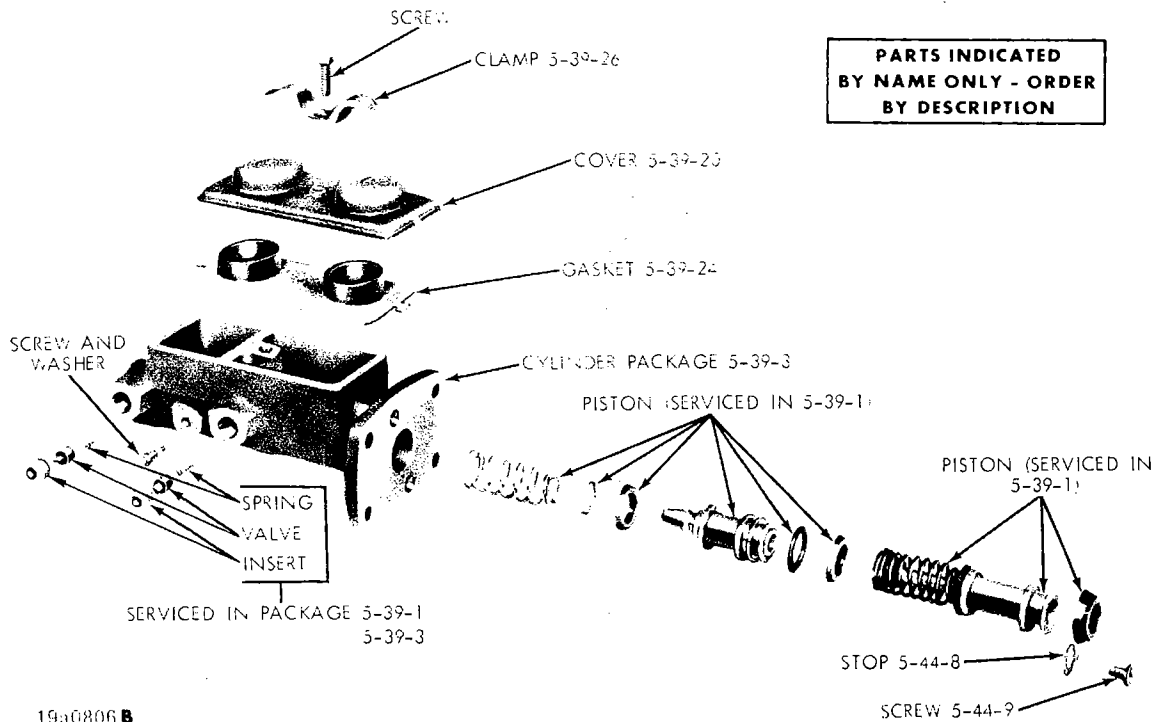

PARTS INDICATED
BY NAME ONLY - ORDER
BY DESCRIPTION

19a0806 B

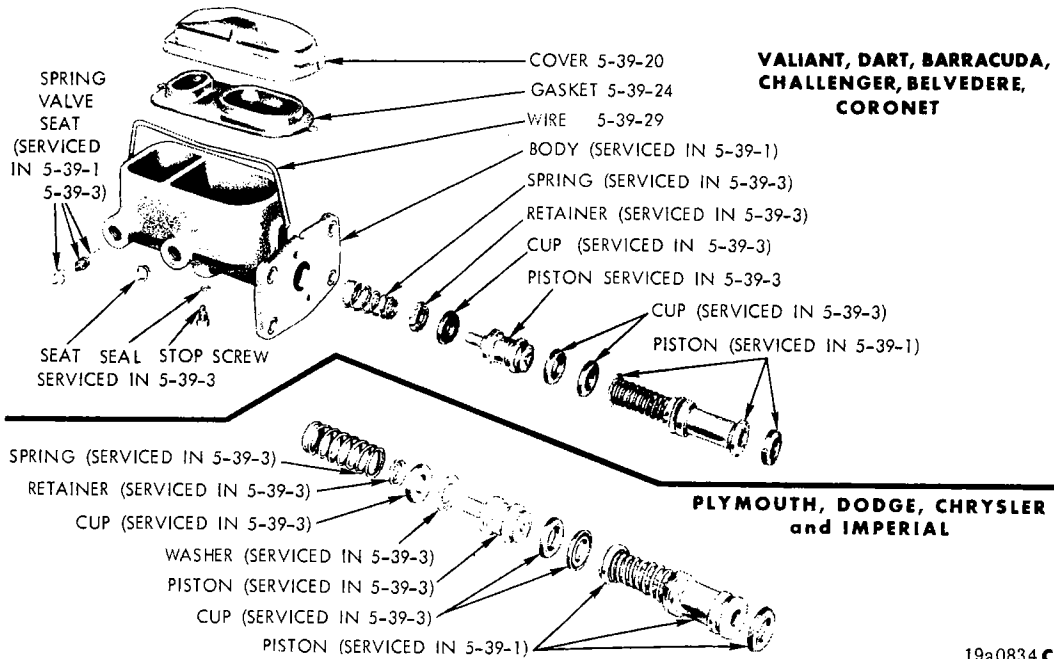

19a0834 C

MASTER CYLINDER (WITH DISC BRAKES) - ALL (1970)

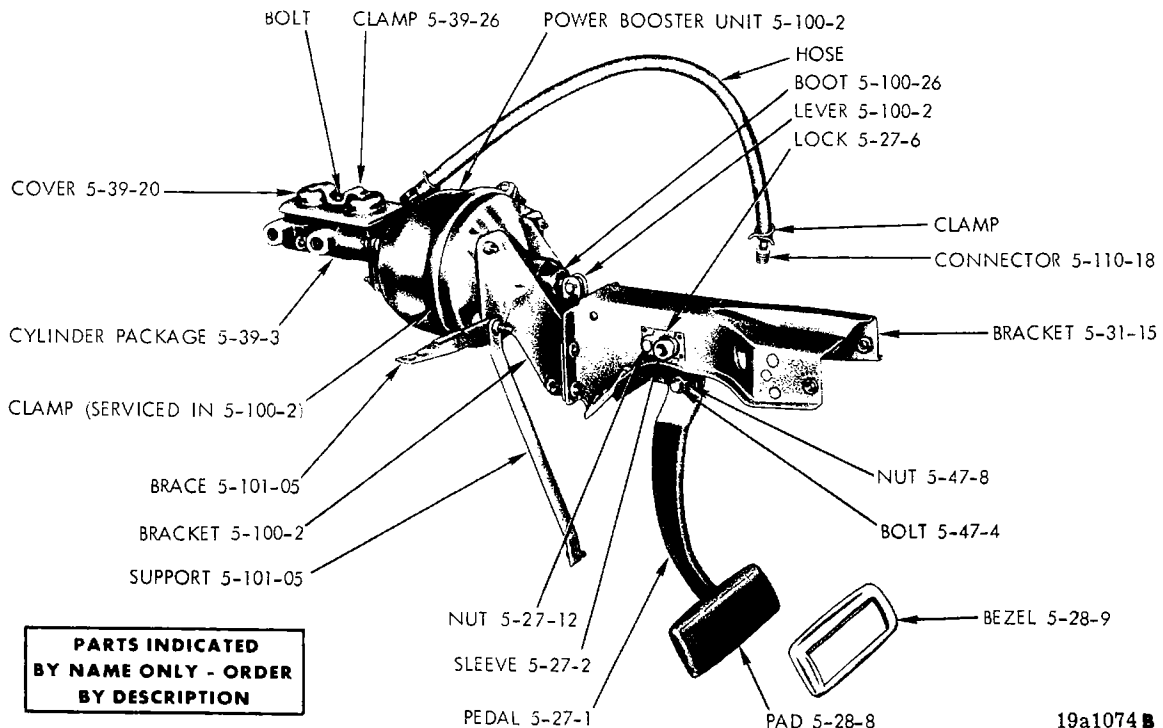

19a1074 B

BRAKE PEDAL AND BRACKET (WITH BOOSTER) - VALIANT AND DART

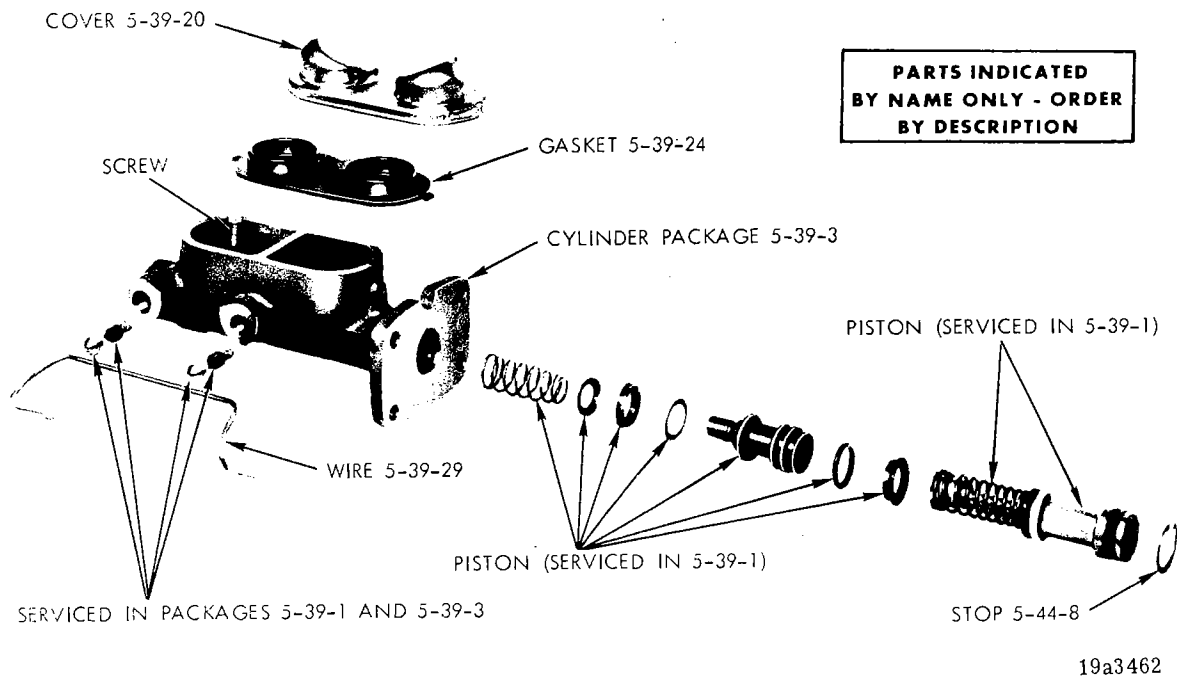

MASTER CYLINDER - WITH DRUM BRAKES (1971)

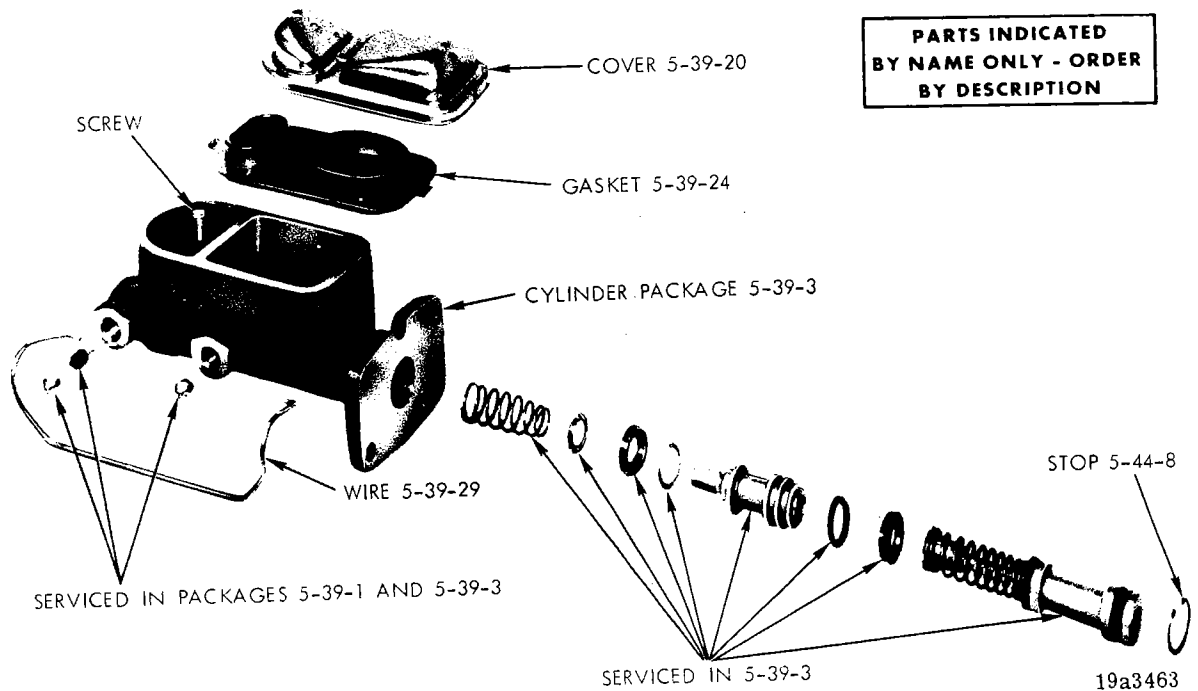

MASTER CYLINDER - WITH DISC BRAKES (1971)

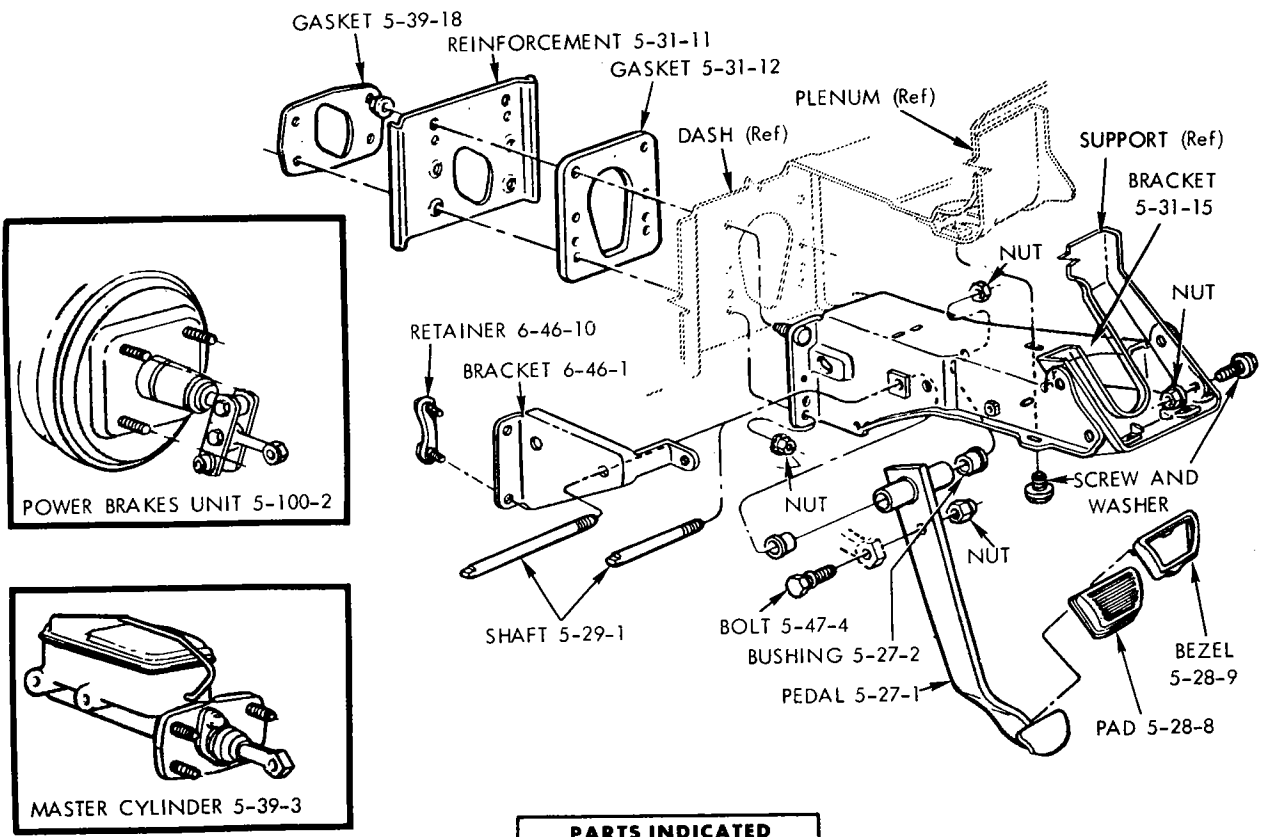

**PARTS INDICATED
BY NAME ONLY - ORDER
BY DESCRIPTION**

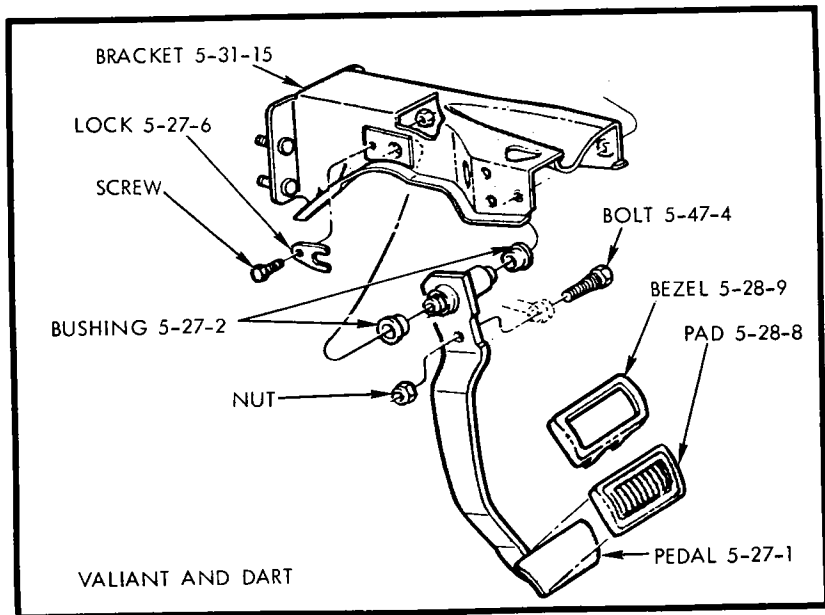

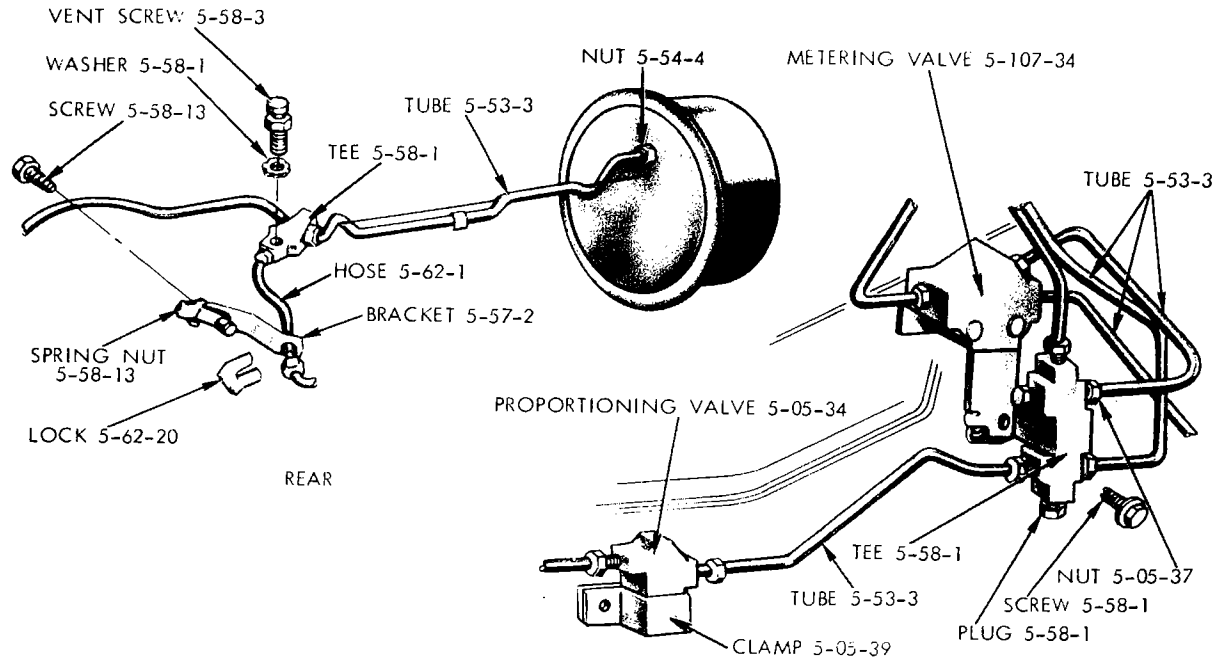

BELVEDERE AND CORONET (TYPICAL OF PLYMOUTH, DODGE, CHRYSLER AND IMPERIAL)

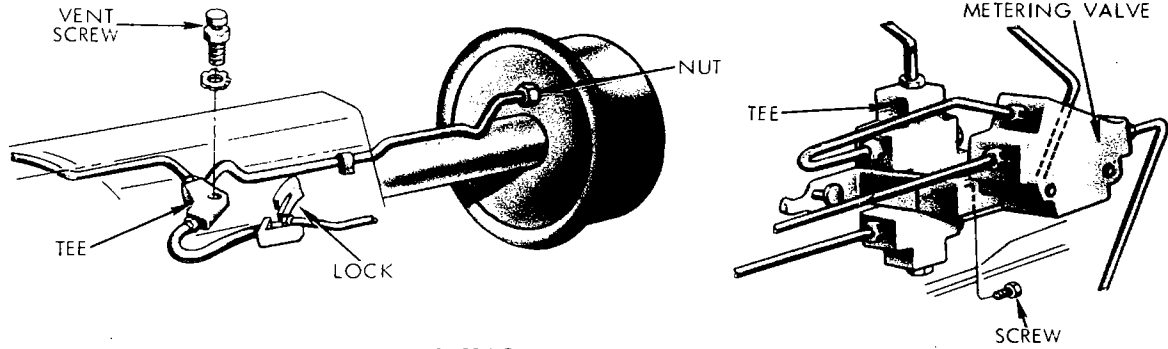

BARRACUDA AND CHALLENGER

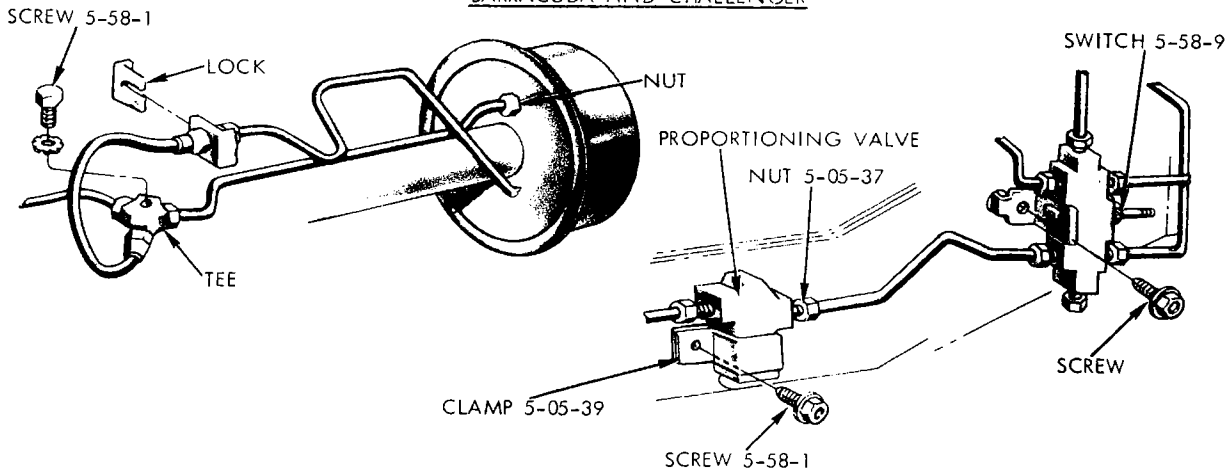

VALIANT AND DART

19a2897 A

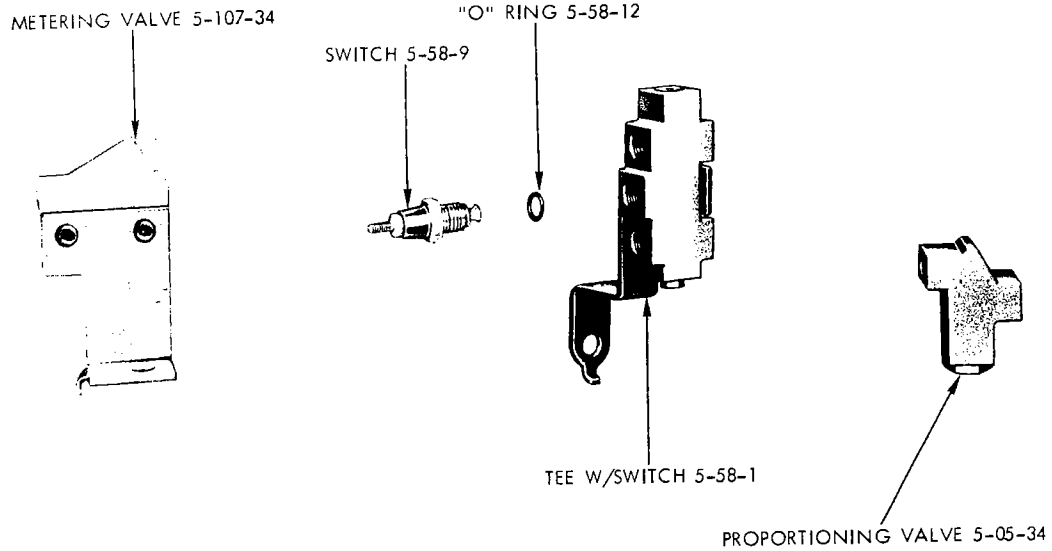

19a3087

TEE AND VALVES

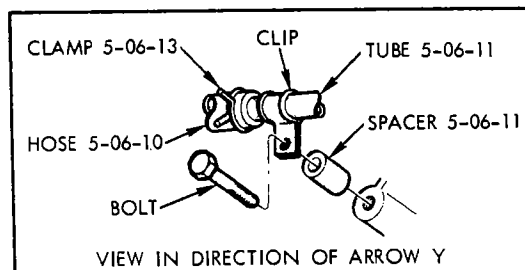
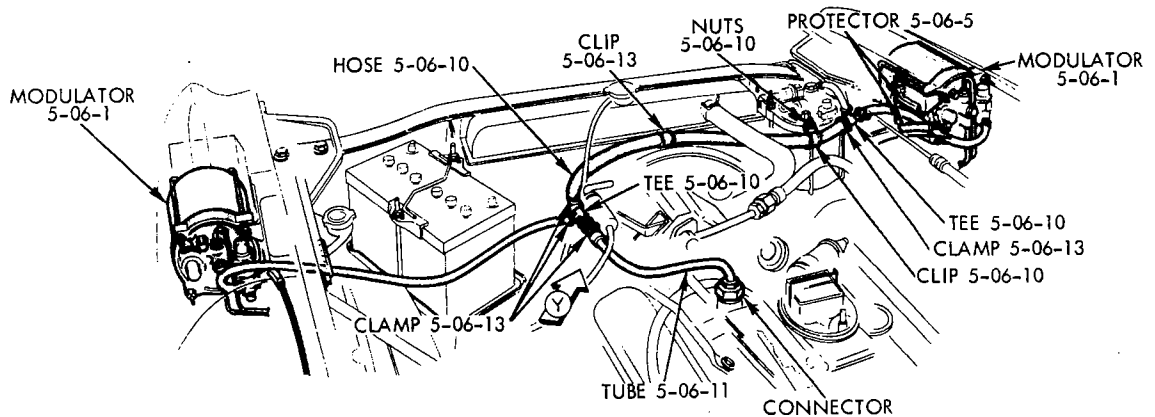

19a3709

CODE	PART NAME	ENG. TYPE OR CU.IN.	V	B	L	R	W	P	D	C	C	C	Y	PART NUMBER
			1-2	1-2	1-2	1-2	1-2	1-2	1-2	1	2	3	1	
5-01-0 BRAKE FLUID														
5-01-2	FLUID, Hi Temp.													
	12 oz.		AR	AR	AR	AR	AR	AR	AR	AR	AR	AR	AR	2933 249
	1 Quart		AR	AR	AR	AR	AR	AR	AR	AR	AR	AR	AR	2933 250
	1 Gallon		AR	AR	AR	AR	AR	AR	AR	AR	AR	AR	AR	2933 251
	5 Gallon		AR	AR	AR	AR	AR	AR	AR	AR	AR	AR	AR	2933 252
	30 Gallon		AR	AR	AR	AR	AR	AR	AR	AR	AR	AR	AR	2933 253
	FLUID, Heavy Duty,													
	1 Gallon	Canada	AR	AR	AR	AR	AR	AR	AR	AR	AR	AR	AR	2458 409
	5 Gallon	Canada	AR	AR	AR	AR	AR	AR	AR	AR	AR	AR	AR	2458 410
	Super Heavy Duty,													
	123 oz.	Canada	AR	AR	AR	AR	AR	AR	AR	AR	AR	AR	AR	2458 412
	1 Gallon	Canada	AR	AR	AR	AR	AR	AR	AR	AR	AR	AR	—	2458 413
	5 Gallon	Canada	AR	AR	AR	AR	AR	AR	AR	AR	AR	AR	AR	2458 414

5-03-0 WHEEL BRAKE SHOE AND LINING

5-03-1	LINING PACKAGE, For Bonding													
	9" Brakes		1	—	1	—	—	—	—	—	—	—	—	3579 268
	10 x 2 1/4" Frt., 10 x 1 3/4" Rr.	70	1	—	1	—	—	—	—	—	—	—	—	3420 957
	10 x 2 1/4" Frt., 10 x 1 3/4" Rr.	71	1	—	1	—	—	—	—	—	—	—	—	3579 277
	10 x 2 1/2" Frt., 10 x 1 3/4" Rr.	70	—	1	—	1	1	—	—	—	—	—	—	3420 955
	10 x 2 1/2" Frt., 10 x 2 1/2" Rr.	70	—	1	—	1	1	—	—	—	—	—	—	3420 958
	11" x 3" Frt., 11 x 3" Rr.	70	—	1	—	1	1	1	1	1	1	1	—	3420 964
	11 x 2 3/4" Frt., 11" x 2" Rr.	70	—	—	—	—	—	1	1	—	—	—	—	3420 959
	11 x 2 3/4" Frt., 11 x 2 1/2" Rr.	70	—	1	—	1	1	1	1	—	—	—	—	3420 960
	11 x 3" Frt., 11 x 2 1/2" Rr.	70	—	1	—	1	1	1	1	—	—	—	—	3420 963
	TAXI, 11 x 3 Rrt., 11 x 2 1/2" Rr.	70	—	—	—	1	1	—	—	—	—	—	—	2585 683
	TAXI, 11 x 3 Frt., 11 x 3" Rr.	70	—	—	—	—	—	1	1	—	—	—	—	2585 685
5-03-3	SHOE and LINING PACKAGE, FRONT (For One Axle)								1					
	9" Brakes	70	1	—	1	—	—	—	—	—	—	—	—	3004 851
	9" Brakes	71	1	—	1	—	—	—	—	—	—	—	—	3579 269
	10 x 2 1/4" Brakes	70	1	—	1	—	—	—	—	—	—	—	—	3420 145
	10 x 2 1/4" Brakes	71	1	—	1	—	—	—	—	—	—	—	—	3579 274
	10 x 2 1/2" Brakes		—	1	—	1	1	—	—	—	—	—	—	3420 146
	11 x 2 3/4" Brakes	70	—	—	—	—	—	1	1	1	—	—	—	3420 147
	11 x 3" Brakes w/Auto Adj.		—	1	—	1	1	1	1	1	1	1	1	3420 148
	11 x 3" Brakes w/Man. Adj.	70	—	1	—	1	1	1	1	1	1	1	—	3420 956
	SHOE and LINING PACKAGE, REAR (For One Axle)													
	9" Brakes	70	1	—	1	—	—	—	—	—	—	—	—	3004 858
	9" Brakes	71	1	—	1	—	—	—	—	—	—	—	—	3579 270
	10" x 1 3/4" Brakes	70	1	1	1	1	1	—	—	—	—	—	—	3420 952
	10 x 1 3/4" Brakes	71	1	—	1	—	—	—	—	—	—	—	—	3579 275
	10 x 2 1/2" Brakes		—	1	—	1	1	—	—	—	—	—	—	3420 146
	11" x 2" Brakes		—	—	—	—	—	1	1	—	—	—	—	3420 953
	11 x 2 1/2" Brakes w/Auto. Adj.		—	1	—	1	1	1	1	1	1	1	—	3420 954
	11 x 2 1/2" Brakes w/Man. Adj.		—	1	—	1	1	1	1	1	1	1	—	3420 149
	11 x 3" Brakes w/Man. Adj.	70	—	—	—	—	—	1	1	1	1	1	—	3420 150
	11" x 3" w/Auto Adj.	70	—	—	—	—	—	—	—	—	—	—	1	3420 148
	11 x 3" w/Auto. Adj.	71	—	—	—	—	—	—	—	—	—	—	1	= 3579 294
	SHOE and LINING PACKAGE (Axle Set)													
	For Disc Brakes	70	1	—	1	—	—	—	—	—	—	—	—	3004 759
	For Disc Brakes	71	1	—	1	—	—	—	—	—	—	—	—	3579 276
	For Disc Brakes	70	—	1	—	1	1	1	1	1	1	1	1	3004 828
	For Disc Brakes	71	—	1	—	1	1	1	1	1	1	1	1	3579 254
	For Disc Brakes H/Duty		—	1	—	—	—	—	—	—	—	—	—	3579 266

CARLINES J - Challenger B - Barracuda V - Valiant L - Dart R - Belvedere - Satellite W - Coronet - Charger P - Plymouth D - Dodge C - Chrysler Y - Imperial

AR Indicates use as required.

Indicates parts not listed in any previous parts book.

Numerals in parentheses () refer to notes.

★ Indicates change or addition.

Printed in U.S.A.
January 1972

CODE	PART NAME	ENG. TYPE OR CU.IN.	V	B	L	R	W	P	D	C	C	C	Y	PART NUMBER
			1-2	1-2	1-2	1-2	1-2	1-2	1-2	1	2	3	1	
5-03-0 WHEEL BRAKE SHOE AND LINING Cont'd.														
5-03-6	RIM and WEB, Front Wheel Brakes													
	10 x 2 1/4" Brakes		4	—	4	—	—	—	—	—	—	—	—	2880 530
	10 x 2 1/2" Brakes		—	4	—	4	4	—	—	—	—	—	—	2880 529
	10 x 2 3/4" Brakes		—	—	—	—	—	4	4	4	4	—	—	2880 544
	11 x 3" Brakes w/Auto. Adj.		—	4	—	4	4	4	4	4	4	4	—	2880 545
	9" x 2" Brakes		4	—	4	—	—	—	—	—	—	—	—	2880 595
	RIM and WEB, Front w/Auto. Adj. Lever Pin													
	9" x 2" Brakes		1	—	1	—	—	—	—	—	—	—	—	2944 674-5
	10 x 2 1/4" Brakes		1	—	1	—	—	—	—	—	—	—	—	2944 676-7
	10 x 2 1/2" Brakes		—	1	—	1	1	—	—	—	—	—	—	2944 678-9
	11 x 2 3/4" Brakes		—	—	—	—	—	1	1	1	1	—	—	2944 680-1
	11 x 3 Brakes		—	1	—	1	1	1	1	1	1	1	—	2944 682-3
	11 x 3" Brakes	71	—	1	—	1	1	1	1	—	—	—	—	2944 682-3
	RIM and WEB, Rear Wheel Brakes													
	9" x 2" Brakes		4	—	4	—	—	—	—	—	—	—	—	2880 632
	10 x 1 3/4" Brakes	70	4	4	4	4	4	—	—	—	—	—	—	2880 547
	10 x 1 3/4" Brakes	71	4	—	4	—	—	—	—	—	—	—	—	2880 547
	10 x 2 1/2" Brakes		—	4	—	4	4	—	—	—	—	—	—	2880 529
	11 x 2" Brakes		—	—	—	—	—	4	4	—	—	—	—	2880 584
	11 x 2 1/2" Brakes		—	4	—	4	4	4	4	4	4	4	—	2880 585
	11 x 3" Brakes w/Man. Adj.		—	—	—	—	—	4	4	4	4	4	4	2880 545
	RIM and WEB, Rr. w/Auto. Adj. Lever Pin													
	9" x 2" Brakes		1	—	1	—	—	—	—	—	—	—	—	2944 684-5
	10" x 1 3/4" Brakes		1	—	1	—	—	—	—	—	—	—	—	2944 686-7
	10 x 2 1/2" Brakes		—	1	—	1	1	—	—	—	—	—	—	2944 678-9
	11 x 2" Brakes		—	—	—	—	—	1	1	—	—	—	—	2944 688-9
	11 x 2 1/2" Brakes		—	1	—	1	1	1	1	1	1	1	—	2944 690-1
	11 x 3" Brakes	70	—	—	—	—	—	—	—	—	—	—	1	2944 682-3
5-03-23	SPRING, Brake Shoe Return FRONT and REAR													
	9" Brakes		8	—	8	—	—	—	—	—	—	—	—	2881 676
	10" Brakes (Primary)		4	4	4	4	4	—	—	—	—	—	—	2267 044
	10" Brakes (Secondary)		4	4	4	4	4	—	—	—	—	—	—	2260 835
	11" Brakes		—	8	—	8	8	8	8	8	8	8	8	2260 789
5-05-0 DISC BRAKES														
5-05-1	HOUSING, Disc Brakes	70	1	—	1	—	—	—	—	—	—	—	—	2925 220-1
	Housing, Disc. Brake Also Specify 1-3579276	71	1	—	1	—	—	—	—	—	—	—	—	2925 220-1
	HOUSING, Complete		1	—	1	—	—	—	—	—	—	—	—	2925 160-1
	Housing (C Body)	71	—	—	—	—	1	1	1	1	1	1	1	3579 264-5
	C Body (Partl.)	70	—	—	—	—	1	1	1	1	1	1	1	2925 206-7
	C Body (Partl.)	71	—	—	—	—	1	1	1	1	1	1	—	= 3461 762-3
	E and B Body (Partl.)	70	—	1	—	1	1	—	—	—	—	—	—	2944 712-3
	E And B Body (Partl.)	71	—	1	—	1	1	—	—	—	—	—	—	3461 964-5
5-05-2	SCREW, Disc Brake Hsg.		4	—	4	—	—	—	—	—	—	—	—	2881 597
	Screw, Disc Brake Hsg. To Knuckle		4	—	4	—	—	—	—	—	—	—	—	6027 984
			—	4	—	4	4	—	—	—	—	—	—	6028 323
			—	—	—	—	—	4	4	4	4	4	4	6028 320
	WASHER, Disc Brake Hsg. to Knuckle		4	—	4	—	—	—	—	—	—	—	—	6028 758
	SCREW and WASHER, Disc Hsg. Clip Mtg.		4	—	4	—	—	—	—	—	—	—	—	2781 018
5-05-3	HUB w/DISC													
	V, L	70	1	—	1	—	—	—	—	—	—	—	—	2660 296-7
	V, L	71	2	—	2	—	—	—	—	—	—	—	—	3580 502
	B, J, R, W	70	—	1	—	1	1	—	—	—	—	—	—	3461 818-9
	B, J, R, W	71	—	2	—	2	2	—	—	—	—	—	—	= 3580 506
	P, D, C	70	—	—	—	—	—	1	1	1	1	1	—	2925 174-5

CARLINES

J - Challenger
B - BarracudaV - Valiant
L - DartR - Belvedere - Satellite
W - Coronet - ChargerP - Plymouth
D - DodgeC - Chrysler
Y - Imperial

AR Indicates use as required.

Indicates parts not listed in any previous parts book.

Numerals in parentheses () refer to notes.

★ Indicates change or addition.

Printed in U.S.A.
January 1972

CODE	PART NAME	ENG. TYPE OR CU.IN.	V	B	L	R	W	P	D	C	C	C	Y	PART NUMBER
			1-2	1-2	1-2	1-2	1-2	1-2	1-2	1	2	3	1	
5-05-0 DISC BRAKES Cont'd.														
5-05-3	HUB w/DISC Cont'd.													
	Y	70	—	—	—	—	—	—	—	—	—	—	1	2925 212-3
	Y	71	—	—	—	—	—	—	—	—	—	—	2	3580 522
	Y, W/Skid Control	71	—	—	—	—	—	—	—	—	—	—	2	3461 948
	PACKAGE, Hub w/Disc	70	—	1	—	1	1	—	—	—	—	—	—	3549 801-2
	Package, Hub W/Disc	71	—	—	—	—	—	2	2	2	2	2	—	= 3549 840
5-05-5	TUBE, Disc Hsg. Crossover		1	—	1	—	—	—	—	—	—	—	—	2881 594-5
5-05-8	SPRING, Disc Brake Otr. Shoe	70	—	2	—	2	2	2	2	2	2	2	2	2925 199
		71	—	2	—	2	2	2	2	2	2	2	2	3461 894
5-05-9	SEAL and BOOT PACKAGE		1	—	1	—	—	—	—	—	—	—	—	2808 699
	SEAL, BOOT and BUSHING PACKAGE	70	—	1	—	1	1	1	1	1	1	1	1	3004 865
		71	—	1	—	1	1	1	1	1	1	1	1	3579 255
5-05-10	PISTON, Disc Brake		8	—	8	—	—	—	—	—	—	—	—	2881 591
	Disc Brake		—	2	—	2	2	2	2	2	2	2	2	2925 201
5-05-16	SHIELD, Disc Brake Splash													
	V, L		2	—	2	—	—	—	—	—	—	—	—	2823 288
			—	1	—	1	1	—	—	—	—	—	—	2944 710-1
	P, D, C		—	—	—	—	1	1	1	1	1	1	—	2925 186-7
	Y	70	—	—	—	—	—	—	—	—	—	—	1	2925 216-7
	Y.	71	—	—	—	—	—	—	—	—	—	—	1	3580 674-5
5-05-17	SEAL, Disc Brake Splash Shield to Knuckle		2	2	2	2	2	2	2	2	2	2	2	2944 704
5-05-26	BOOT, Frt. Whl. Disc Brk. Piston		8	—	8	—	—	—	—	—	—	—	—	2944 733
5-05-29	CLIP, Frt. Whl. Disc Brake Shoe - Anti-Rattle	70	4	—	4	—	—	—	—	—	—	—	—	2881 596
5-05-34	PROPORTIONING VALVE, Brake Tube	70	1	1	1	1	1	—	—	—	—	—	—	2852 045
	NOTE: For Further Information See Part Type Code 5-58-1													
5-05-35	LOCK WASHER, Disc Brake Hsg.		4	—	4	—	—	—	—	—	—	—	—	2881 598
5-05-37	NUT, Tee Tube To Prpg. Valve	70	1	1	1	1	1	—	—	—	—	—	—	2852 044
	Master Cyl. To Brake Tee Frt.		1	1	1	—	—	—	—	—	—	—	—	2852 044
	Tee To Lt. Hose Tube	70	1	—	1	1	1	1	1	1	1	1	—	2852 044
	Tee To Lt. or Rt. Hose Tube Tee		1	1	1	1	1	1	1	1	1	1	—	2852 044
	Tee To Metering Valve Tube Tee		—	1	—	1	1	1	1	1	1	1	1	2852 044
	Modulator To J/Blk. Brake Tube	71	—	—	—	—	—	—	—	—	—	—	4	2852 044
	J/Blk. Brake Tube	71	—	—	—	—	—	—	—	—	—	—	2	2852 044
	Mtrg. Valve To Modulator Brake Tube	71	—	—	—	—	—	—	—	—	—	—	1	2852 044
5-05-39	CLAMP, Brake Tube Prpg. Valve	70	1	1	1	1	1	—	—	—	—	—	—	2852 043
5-05-41	PIN, Disc Brake Hsg. Locating		—	—	—	—	4	4	4	4	4	4	4	2925 208
	B, J, R, W Up to March 71 Approx.		—	4	—	4	4	—	—	—	—	—	—	2944 719
	After March 71 Approx.		—	4	—	4	4	—	—	—	—	—	—	= 3621 960
5-05-43	ADAPTER, Disc Brake		—	—	—	—	2	2	2	2	2	2	—	2925 209
	B, J, R, W		—	1	—	1	1	—	—	—	—	—	—	3461 976-7
	P,D,C.	71	—	—	—	—	2	2	2	2	2	2	—	3461 755
	Y		—	—	—	—	—	—	—	—	—	—	2	2944 727
5-05-45	BUSHING PACKAGE, Locating Pin Inner and Outer		—	4	—	4	4	4	4	4	4	4	4	3004 864
5-05-46	POSITIONER, Disc Brakes	70	—	2	—	2	2	2	2	2	2	2	2	2944 722-3
		71	—	2	—	2	2	2	2	2	2	2	2	3461 770-1
5-05-47	SHIELD, Metering Valve	70	—	—	—	1	1	—	—	—	—	—	—	3404 695

5-06-0 WHEEL SKID CONTROL

5-06-1	MODULATOR, Whl. Slip Brk. Cont.													
	Frt. Up to Feb. 71 Approx.	71	—	—	—	—	—	—	—	—	—	—	2	3461 391
	After Feb. 71 Approx.	71	—	—	—	—	—	—	—	—	—	—	2	= 3580 032
	REAR, Up to Feb. 71 Approx.	71	—	—	—	—	—	—	—	—	—	—	1	3461 336

CARLINES

J - Challenger
B - BarracudaV - Valiant
L - DartR - Belvedere - Satellite
W - Coronet - ChargerP - Plymouth
D - DodgeC - Chrysler
Y - Imperial

AR Indicates use as required.

Indicates parts not listed in any previous parts book.

Numerals in parentheses () refer to notes.

★ Indicates change or addition.

Printed in U.S.A.
January 1972

CODE	PART NAME	ENG. TYPE OR CU.IN.	V	B	L	R	W	P	D	C	C	C	Y	PART NUMBER
			1-2	1-2	1-2	1-2	1-2	1-2	1-2	1	2	3	1	
5-06-0 WHEEL SKID CONTROL Cont'd.														
5-06-1	MODULATOR Cont'd.													
	REAR, After Feb. 71 Approx.	71	—	—	—	—	—	—	—	—	—	—	1	≠ 3580 034
	Hose, Whl. Slip Brk. Cont. Frt.													
	And Rr. Modulator	71	—	—	—	—	—	—	—	—	—	—	3	6029 256
5-06-2	BRACKET, Whl. Slip Brk. Cont. Frt.													
	Modulator.	71	—	—	—	—	—	—	—	—	—	—	2	3461 381
	Rear	71	—	—	—	—	—	—	—	—	—	—	1	3461 387
5-06-3	BRACE, Whl. Slip Brk. Cont. Frt.													
	Modulator	71	—	—	—	—	—	—	—	—	—	—	2	3461 379
5-06-4	SUPPORT, Whl. Slip Brk. Cont. Rr.													
	Modulator	71	—	—	—	—	—	—	—	—	—	—	1	3461 384
5-06-5	PROTECTOR, Whl. Slip Brk. Cont. Frt.													
	Modulator Vac. Hose	71	—	—	—	—	—	—	—	—	—	—	2	3461 396
5-06-6	BRACKET, Logic Cont. Whl. Slip System													
	Upper	71	—	—	—	—	—	—	—	—	—	—	1	3488 502
	Lower	71	—	—	—	—	—	—	—	—	—	—	1	3488 501
	Screw, Logic Controller Brkt.													
	Mtg.	71	—	—	—	—	—	—	—	—	—	—	4	9414 597
	Nut And Coned Washer Logic													
	Controller Brkt. Mtg.	71	—	—	—	—	—	—	—	—	—	—	2	6025 004
5-06-7	CONTROL - Unit Electronic Skid	71	—	—	—	—	—	—	—	—	—	—	1	3488 093
	Screw, Logic Controller Mtg.	71	—	—	—	—	—	—	—	—	—	—	3	9417 075
	Clip, Logic Controller Wiring	71	—	—	—	—	—	—	—	—	—	—	1	6015 288
5-06-8	RING, Rr. Whl. Slip Brk. Cont. Drive	71	—	—	—	—	—	—	—	—	—	—	2	3461 943
5-06-9	SENSOR and Wiring Frt. Whl. Slip	71	—	—	—	—	—	—	—	—	—	—	1	3461 946-7
	Rear	71	—	—	—	—	—	—	—	—	—	—	1	3461 944-5
	Clip, Frt. Whl. Slip Brake Cont.													
	Speed Sensor Wiring	71	—	—	—	—	—	—	—	—	—	—	2	6015 238
5-06-10	TEE, Whl. Slip Cont. Vac. Hose To Rt. Frt.													
	And Rr. Modulator	71	—	—	—	—	—	—	—	—	—	—	1	3461 394
	To Lt. Frt. Modulator	71	—	—	—	—	—	—	—	—	—	—	1	3461 393
	Hose, Whl. Slip Brake Control													
	Tube To Tee Vac.	71	—	—	—	—	—	—	—	—	—	—	1	6029 302
	Hose, Whl. Slip Brake Control													
	Tee To Tee Vac.	71	—	—	—	—	—	—	—	—	—	—	1	6029 302
	Clip, Whl. Slip Brake Control													
	Vac. Hose Rr. Modulator	71	—	—	—	—	—	—	—	—	—	—	1	9413 545
	Nut, Whl. Slip Brake Control													
	Vac. Hose Rr. Modulator Clip	71	—	—	—	—	—	—	—	—	—	—	1	120 376
5-06-11	TUBE, Whl. Slip Brk. Cont. Int. Man.	71	—	—	—	—	—	—	—	—	—	—	1	3461 398
	Junction Blk. Brake	71	—	—	—	—	—	—	—	—	—	—	2	3466 733
	Package - Jumper Tube	71	—	—	—	—	—	—	—	—	—	—	1	≠ 3461 427
	Spacer, Whl. Slip Brake Control													
	Tube Mtg.	71	—	—	—	—	—	—	—	—	—	—	2	6023 533
5-06-12	JUNCTION BLOCK, - Brake Tube	71	—	—	—	—	—	—	—	—	—	—	2	3466 732
5-06-13	CLIP, Modulator To Union Rr. Brk. Tube	71	—	—	—	—	—	—	—	—	—	—	4	2883 929
	S-Clip, Modulator To Union Rr. Brk.													
	Tube	71	—	—	—	—	—	—	—	—	—	—	5	2925 705
	Clip, Whl. Slip Brk. Cont. Vac. Hose													
	Shroud	71	—	—	—	—	—	—	—	—	—	—	1	3461 395
	Clamp, Whl. Slip Brake Control													
	Vac. Hose Tee	71	—	—	—	—	—	—	—	—	—	—	4	870 469
	Clamp, Whl. Slip Brake Control													
	Vac. Hose Modulator	71	—	—	—	—	—	—	—	—	—	—	3	443 828
5-06-14	RETAINER, Upper Control Arm													
	Anti-Skid Wiring	71	—	—	—	—	—	—	—	—	—	—	2	3513 492
5-06-15	SOCKET, Whl. Slip Brk. Cont.													
	System Warning	71	—	—	—	—	—	—	—	—	—	—	1	2097 003

CARLINES J - Challenger B - Barracuda V - Valiant L - Dart

R - Belvedere - Satellite W - Corcoran - Charger

P - Plymouth D - Dodge

C - Chrysler Y - Imperial

AR Indicates use as required.

Indicates parts not listed in any previous parts book.

Numerals in parentheses () refer to notes.

★ Indicates change or addition.

Printed in U.S.A.
January 1972

CODE	PART NAME	ENG. TYPE OR CU.IN.	V	B	L	R	W	P	D	C	C	C	Y	PART NUMBER
			1-2	1-2	1-2	1-2	1-2	1-2	1-2	1	2	3	1	
5-06-0 WHEEL SKID CONTROL Cont'd.														
5-06-15	SOCKET Cont'd. Fuseholder, Whl. Slip Brake Cont. System	71	—	—	—	—	—	—	—	—	—	—	1	2257 679
5-06-16	WIRING, Whl. Slip Control System (Eng. Compt.)	71	—	—	—	—	—	—	—	—	—	—	1	3513 504
	Whl. Slip Brk. Control System (Inst. Panel)	71	—	—	—	—	—	—	—	—	—	—	1	3513 519
	Whl. Slip Brk. Control (Body) Up to March 71 Approx.	71	—	—	—	—	—	—	—	—	—	—	1	3513 612
	After March 71 Approx.	71	—	—	—	—	—	—	—	—	—	—	1	3513 737
5-12-0 WHEEL CYLINDER PISTON PUSH ROD														
5-12-1	ROD, Frt. and Rr. Wheel Brake Cyl. Piston		4	4	4	4	4	4	4	4	4	4	4	2260 787
5-13-0 WHEEL BRAKE SUPPORT														
5-13-1	SUPPORT, Frt. 9" Brake 10 x 2 1/4" Brakes		2	—	2	—	—	—	—	—	—	—	—	2880 501
	10 x 2 1/2" Brakes		2	—	2	—	—	—	—	—	—	—	—	3461 534-5
	11 x 2 3/4" Brakes		—	2	—	2	2	—	—	—	—	—	—	3461 536
	11 x 3" Brakes		—	2	—	2	2	—	—	—	—	—	—	3461 537
	11 x 3" Brakes	70	—	—	—	—	—	2	2	2	2	—	—	3461 538
	11 x 3" Brakes	71	—	—	—	—	—	2	2	2	2	2	—	3461 539
	11 x 3" Brakes		—	—	—	—	—	2	2	—	—	—	—	3461 539
	SUPPORT, Rear 9" Brakes		1	—	1	—	—	—	—	—	—	—	—	2880 568-9
	10 x 1 3/4" w/7 1/4" Axle		1	1	1	—	—	—	—	—	—	—	—	2880 570-1
	10 x 1 3/4" w/8 3/4 Axle	70	1	—	1	1	1	—	—	—	—	—	—	2880 582-3
	10 x 1 3/4" w/8 3/4 Axle	71	1	—	1	—	—	—	—	—	—	—	—	2880 582-3
	10 x 2 1/2" Brakes		—	1	—	1	1	—	—	—	—	—	—	2880 602-3
	11 x 2" Brakes		—	—	—	—	—	1	1	—	—	—	—	2880 626-7
	11 x 2 1/2" Brakes		—	1	—	1	1	1	1	1	1	1	—	2880 646-7
	11 x 3" Brakes	70	—	—	—	—	—	1	1	1	1	1	1	2880 648-9
	11 x 3" Brakes	71	—	—	—	—	—	—	—	—	—	—	1	3461 986-7
	Plug, Rr. Wheel Brakes Support		—	—	—	—	—	—	—	—	—	—	2	3461 985
5-13-7	GASKET, Axle Hsg. Brake Support Plate 7/64" Thk. 2.74" I.D.		4	—	4	—	—	—	—	—	—	—	—	2467 095
	7/64" Thk. 2.87" I.D.		2	2	2	2	2	2	2	2	2	2	2	2070 933
	7/64" Thk. 2.92" I.D.		2	2	2	2	2	2	2	2	2	2	2	2881 314
5-13-9	BOLT, Frt. Wheel Brake Mtg. Upper, 10" and 11" Brakes		4	4	4	4	4	4	4	4	4	4	—	2207 604
	Upper, 9" Brakes		4	—	4	—	—	—	—	—	—	—	—	2072 682
	Lower 10" and 11" Brakes		—	4	—	4	4	4	4	4	4	4	—	6027 605
	Lower 9" Brakes		4	—	4	—	—	—	—	—	—	—	—	2072 681
	BOLT, Frt. Wheel Brake Mtg. Lower Frt. 10" Brakes	70	4	—	4	—	—	—	—	—	—	—	—	9422 752
	Lower Frt. 10" Brakes	71	4	—	4	—	—	—	—	—	—	—	—	6028 757
	Lower Rr. 10" Brakes		4	—	4	—	—	—	—	—	—	—	—	6025 739
	Bolt, Rr. Wheel Brake Mtg. W/Teeth		10	10	10	10	10	10	10	10	10	10	10	2404 164
	W/O Teeth	70	10	—	10	10	10	—	—	—	—	—	—	3432 222
	Rr.	70	8	8	8	8	8	8	8	8	8	8	—	2265 572
	Rr.	71	8	—	8	8	8	8	8	—	—	—	—	3507 259
5-13-10	NUT, Frt. Whl. Brake Mtg. Bolt Lower Frt. Lower Rr.		2	—	2	—	—	—	—	—	—	—	—	6028 512
	Frt. Whl. Brake Mtg. Bolt Upper		4	4	4	4	4	4	4	4	4	4	—	601 014
	NUT, Rr. Whl. Brake Mtg. Bolt Rt.		1	1	1	1	1	1	1	1	1	1	1	2404 168
	Nut, Rr. Whl. Brake Mtg. Bolt		9	9	9	9	9	9	9	9	9	9	9	6026 131
	Rr. Whl. Brake Mtg. Bolt (Lock Nut Type)	70	AR	AR	AR	AR	AR	AR	AR	AR	AR	AR	AR	1927 232

CARLINES

J - Challenger
B - BarracudaV - Valiant
L - DartR - Belvedere - Satellite
W - Coronet - ChargerP - Plymouth
D - DodgeC - Chrysler
Y - Imperial

AR Indicates use as required.

Indicates parts not listed in any previous parts book.

Numerals in parentheses () refer to notes.

★ Indicates change or addition.

Printed in U.S.A.
January 1972

CODE	PART NAME	ENG. TYPE OR CU.IN.	V	B	L	R	W	P	D	C	C	C	Y	PART NUMBER
			1-2	1-2	1-2	1-2	1-2	1-2	1-2	1	2	3	1	
5-13-0 WHEEL BRAKE SUPPORT Cont'd.														
5-13-22	SEAL, Frt. Whl. Brake Support To													
	Strg. - Knuckle 10", 11" Brakes	70	2	2	2	2	2	2	2	2	2	2	—	2266 890
	10, 11" Brakes	71	2	2	2	2	2	2	2	2	2	2	—	2944 704
	9" Brakes		2	—	2	—	—	—	—	—	—	—	—	2401 960
5-13-35	COVER, Whl. Brake Adj. Screw Hole		4	4	4	4	4	4	4	4	4	4	4	2072 614
5-20-0 WHEEL BRAKE ADJUSTER														
5-20-1	SCREW, Man. Adj.		—	—	—	2	2	2	2	2	2	2	—	2265 201
	Auto. Adj.		2	2	2	2	2	2	2	2	2	2	2	2881 686-7
5-20-4	SPRING, Man. Adj. Screw Lock		—	—	—	2	2	2	2	2	2	2	—	2944 844
5-20-9	LEVER, Auto. Adj.		2	2	2	2	2	2	2	2	2	2	2	3461 665
5-20-10	CABLE, Auto. Adj.													
	9" Brakes		2	—	2	—	—	—	—	—	—	—	—	3461 662
	10" Brakes		2	2	2	2	2	—	—	—	—	—	—	3461 663
	11" Brakes		—	2	—	2	2	2	2	2	2	2	2	3461 664
5-20-11	GUIDE, Auto. Adj. Cable		2	2	2	2	2	2	2	2	2	2	2	2260 793
5-20-15	NUT, Auto. Adj. Pivot Screw													
	Auto. Adj.		1	1	1	1	1	1	1	1	1	1	1	2944 692-3
	NUT, Screw Lock, Man. Adj.		—	—	—	2	2	2	2	2	2	2	—	2260 671
5-20-17	BUTTON, Auto. Adj.		4	4	4	4	4	4	4	4	4	4	4	2944 586
	Washer, Auto. Adj. Button		4	4	4	4	4	4	4	4	4	4	4	6027 559
	SOCKET, Man. Adj. Screw		—	—	—	4	4	4	4	4	4	4	—	2265 068
5-20-20	SPRING, Auto. Adj. Lever		2	2	2	2	2	2	2	2	2	2	2	2944 580-1
	Auto. Adj. 9" Brakes		4	—	4	—	—	—	—	—	—	—	—	2880 593
	Auto. Adj. 10" Brakes		4	4	4	4	4	—	—	—	—	—	—	2880 525
	Auto. Adj. 11" Brakes		—	4	—	4	4	4	4	4	4	4	4	2880 555
	SPRING, Auto. Adj. Cable		4	4	4	4	4	4	4	4	4	4	4	3461 660
5-25-0 BRAKE SHOE GUIDE														
5-25-9	PLATE, Brake Shoe Guide													
	9" Brakes		4	—	4	—	—	—	—	—	—	—	—	2881 675
	10" Brakes		4	4	4	4	4	—	—	—	—	—	—	2267 045
	11" Brakes		—	4	—	4	4	4	4	4	4	4	4	2260 788
5-26-0 BRAKE SHOE GUIDE SPRING														
5-26-1	SPRING, Brake Shoe Hold Down													
	9", 10" and 11" Brakes		8	8	8	8	8	8	8	8	8	8	8	2260 791
	BRAKE SHOE HOLD DOWN SPRING													
	RETAINER and PIN PACKAGE	70	1	1	1	1	1	1	1	1	1	1	—	2808 525
5-26-2	RETAINER, Hold Down Spring													
	9", 10" and 11" Brakes		8	8	8	8	8	8	8	8	8	8	8	2260 792
5-26-4	PIN, Hold Down Spring													
	2 1/8" Lgh. Fig. 12 Stamped on Head		4	—	4	—	—	4	4	—	—	—	—	2405 720
	2 11/32" Lgh. Fig. 1 Stamped on Head		4	4	4	4	4	4	4	4	4	4	—	2260 548
	2 5/8" Lgh. Fig. 10 Stamped on Head		—	4	—	4	4	4	4	4	4	4	4	2260 549
5-27-0 BRAKE PEDAL AND BUSHING														
5-27-1	PEDAL, w/Man. Trans. Exc. 340 Eng.		1	—	1	—	—	—	—	—	—	—	—	2823 617
	w/Man. Trans. w/340 Eng.		1	—	1	—	—	—	—	—	—	—	—	2883 454
	w/Auto. Trans.		1	—	1	—	—	—	—	—	—	—	—	2823 618
	w/Power Brakes, w/Auto. Trans.	70	—	—	—	1	1	—	—	—	—	—	—	2996 417
	w/Man. or Power Brakes, w/Man.													
	Trans.	70	—	—	—	1	1	—	—	—	—	—	—	2880 650
	w/Man. Brakes, w/Auto. Trans.	70	—	—	—	1	1	—	—	—	—	—	—	2880 651
	w/Man. Brakes, w/Man. Trans.		—	—	—	—	—	1	1	1	1	1	—	2950 013
	w/Power Brakes, w/Man. Trans.		—	—	—	—	—	1	1	1	1	1	—	2950 018

CARLINES

J - Challenger
B - BarracudaV - Valiant
L - DartR - Belvedere - Satellite
W - Coronet - ChargerP - Plymouth
D - DodgeC - Chrysler
Y - Imperial

AR Indicates use as required.

Indicates parts not listed in any previous parts book.

Numerals in parentheses () refer to notes.

★ Indicates change or addition.

Printed in U.S.A.
January 1972

CODE	PART NAME	ENG. TYPE OR CU.IN.	V	B	L	R	W	P	D	C	C	C	Y	PART NUMBER
			1-2	1-2	1-2	1-2	1-2	1-2	1-2	1	2	3	1	
5-27-0 BRAKE PEDAL AND BUSHING Cont'd.														
5-27-1	PEDAL Cont'd.													
	w/Man. Brakes, w/Auto. Trans.	70	—	—	—	—	—	1	1	1	1	—	—	2950 011
	w/Man. Brakes, w/Auto Trans.	71	—	—	—	—	—	1	1	1	1	—	—	2950 276
	w/Power Brakes, w/Auto. Trans.	70	—	—	—	—	—	1	1	1	1	1	1	2925 579
	w/Power Brakes w/Auto Trans.	71	—	—	—	—	—	1	1	1	1	1	1	3467 229
	w/Man. or Power Brakes, w/Man. Trans.	70	—	1	—	—	—	—	—	—	—	—	—	2950 877
	w/Man. or Power Brakes w/Man. Trans.	71	—	1	—	1	1	—	—	—	—	—	—	3575 106
	w/Man. or Power Brakes, w/Auto. Trans.	70	—	1	—	—	—	—	—	—	—	—	—	2950 878
	w/Man. OR Power Brakes w/Auto. Trans.	71	—	1	—	1	1	—	—	—	—	—	—	3575 107
5-27-2	SLEEVE, Brake Pedal, Exc. 340 Eng.		1	—	1	—	—	—	—	—	—	—	—	2073 634
	V,L 340 Eng.		1	—	1	—	—	—	—	—	—	—	—	2883 461
	P, D, C,Y		—	—	—	—	—	1	1	1	1	1	1	2950 289
	B,J	70	—	1	—	—	—	—	—	—	—	—	—	2996 419
	BUSHING, Brake Pedal Hub, Exc. 340 Eng. w/340 Eng.		2	—	2	—	—	—	—	—	—	—	—	2467 771
			2	—	2	—	—	—	—	—	—	—	—	2883 482
			—	2	—	2	2	2	2	2	2	2	2	2467 770
5-27-6	LOCK, Brake Pedal Sleeve, Exc. 340 Eng. w/340 Eng.		1	—	1	—	—	—	—	—	—	—	—	2781 105
			1	—	1	—	—	—	—	—	—	—	—	2883 463
5-27-12	NUT, Brake Pedal Sleeve Lock Screw		1	—	1	—	—	—	—	—	—	—	—	2208 008

5-28-0 BRAKE PEDAL PAD

5-28-8	PAD, w/Auto. Trans.	70	1	—	1	1	1	—	—	—	—	—	—	2643 707
	w/Auto Trans.	71	1	—	1	—	—	—	—	—	—	—	—	3575 101
	w/Man. Trans.	70	1	—	1	1	1	—	—	—	—	—	—	2643 712
	w/Man. Trans.	71	1	—	1	—	—	—	—	—	—	—	—	2643 712
	w/man. Trans.		—	1	—	1	1	—	—	—	—	—	—	2950 887
	w/Auto. Trans.		—	1	—	1	1	—	—	—	—	—	—	2950 899
	w/Man. Brakes, w/Bezel	70	—	—	—	—	—	1	1	1	1	1	—	2530 426
	w/Man. Trans.	71	1	—	1	—	—	1	1	1	1	1	—	3467 530
	w/Man. Brakes, w/o Bezel	70	—	—	—	—	—	1	1	—	—	—	—	2467 768
	w/Man. Brakes, w/Bezel	70	—	—	—	—	—	1	1	1	1	1	—	2461 708
	w/Man. Brakes, w/o Bezel	70	—	—	—	—	—	1	1	—	—	—	—	2461 709
	w/Power Brakes, w/o Bezel, w/Disc	70	—	—	—	—	—	1	1	1	1	1	1	2461 709
	w/Auto. Trans.	71	—	—	—	—	—	1	1	1	1	1	1	2950 279
5-28-9	BEZEL, Brake Pedal Pad w/Man. Trans.	70	1	—	1	1	1	—	—	—	—	—	—	2643 714
	w/Auto. Trans.	70	1	—	1	1	1	—	—	—	—	—	—	2643 709
	w/Auto. Trans.	71	1	—	1	—	—	—	—	—	—	—	—	3575 102
	w/Man. Trans.	70	—	1	—	—	—	—	—	—	—	—	—	2950 898
	w/Man. Trans.	71	—	1	—	1	1	—	—	—	—	—	—	2950 898
	w/Auto. Trans.	70	—	1	—	—	—	—	—	—	—	—	—	2950 900
	w/Auto. Trans.	71	—	1	—	1	1	—	—	—	—	—	—	2950 900
	w/Disc Pwr. Brakes w/Auto. Trans.		—	—	—	—	—	1	1	1	1	1	1	2823 557
	w/o Disc w/Auto. Trans.		—	—	—	—	—	1	1	1	1	1	—	2467 766
	w/Man. Trans.		1	—	1	—	—	1	1	1	1	1	—	2467 769

5-29-0 BRAKE PEDAL SHAFT

5-29-1	SHAFT, Brake Pedal													
	w/Auto. Trans.		—	1	—	1	1	—	—	—	—	—	—	3467 022
	w/Man. Trans.	70	—	—	—	1	1	—	—	—	—	—	—	3467 024
	w/Man. Trans.		—	1	—	1	1	—	—	—	—	—	—	3467 023

CARLINES

J - Challenger
B - BarracudaV - Valiant
L - DartR - Belvedere - Satellite
W - Coronet - ChargerP - Plymouth
D - DodgeC - Chrysler
Y - Imperial

AR Indicates use as required.

Indicates parts not listed in any previous parts book.

Numerals in parentheses () refer to notes.

★ Indicates change or addition.

Printed in U.S.A.
January 1972

CODE	PART NAME	ENG. TYPE OR CU.IN.	V	B	L	R	W	P	D	C	C	C	Y	PART NUMBER
			1-2	1-2	1-2	1-2	1-2	1-2	1-2	1	2	3	1	
5-31-0 BRAKE PEDAL BRACKET														
5-31-11	REINFORCEMENT, Brake Pedal Bracket													
	Power Brakes		—	1	—	1	1	—	—	—	—	—	—	2950 686
	Man. Brakes	70	—	1	—	—	—	—	—	—	—	—	—	2950 684
	Power Brakes	71	—	1	—	1	1	—	—	—	—	—	—	3575 105
	Man. Brakes	70	—	—	—	1	1	—	—	—	—	—	—	2534 248
	Power Brakes	70	—	—	—	1	1	—	—	—	—	—	—	2534 271
	Man. Brakes	70	—	—	—	—	—	1	1	1	1	1	1	2925 584
	Power Brakes	70	—	—	—	—	—	1	1	1	1	—	—	2950 016
	Man. Brakes	71	—	—	—	—	—	1	1	1	1	—	—	3575 139
5-31-12	GASKET, Bracket Reinforcement	70	—	—	—	1	1	—	—	—	—	—	—	2534 258
	Pedal, Bracket Reinforcement		—	—	—	—	—	1	1	1	1	1	1	2925 582
	B, J, R, W.		—	1	—	1	1	—	—	—	—	—	—	2950 883
5-31-13	NUT and WASHER, Brkt. Reinf. to Dash	70	—	AR	—	—	—	—	—	—	—	—	—	2076 232
5-31-15	BRACKET, Brake Pedal													
	Power Brakes	70	—	1	—	—	—	—	—	—	—	—	—	2950 874
	Power Brakes	71	—	1	—	—	—	—	—	—	—	—	—	3467 952
	Man. Brakes	70	—	1	—	—	—	—	—	—	—	—	—	2950 873
	Man. Brakes	71	—	1	—	—	—	—	—	—	—	—	—	3467 951
	V,L	70	1	—	1	—	—	—	—	—	—	—	—	3467 084
	V,L. Exc. 340 Eng.	71	1	—	1	—	—	—	—	—	—	—	—	3467 518
	V,L w/340 Eng.	71	1	—	1	—	—	—	—	—	—	—	—	3575 120
	R,W	70	—	—	—	1	1	—	—	—	—	—	—	2881 572
	Power Brakes	71	—	—	—	1	1	—	—	—	—	—	—	3467 122
	Man. Brakes	71	—	—	—	1	1	—	—	—	—	—	—	3467 123
	P,D,C,Y	70	—	—	—	—	—	1	1	1	1	1	1	2996 490
	P,D,C,Y.	71	—	—	—	—	—	1	1	1	1	1	1	3467 543
5-39-0 MASTER CYLINDER														
5-39-1	MASTER CYLINDER REPAIR													
	PACKAGE WITH DISC BRAKES													
	V, L	70	1	—	1	—	—	—	—	—	—	—	—	3549 828
	V,L	71	1	—	1	—	—	—	—	—	—	—	—	3579 258
	426 Eng.	70	—	1	—	1	1	—	—	—	—	—	—	3420 968
	P, D, C, Y	70	—	—	—	—	—	1	1	1	1	1	1	3420 120
	B,J,R,W,P,D,C,Y.	71	—	1	—	1	1	1	1	1	1	1	1	3579 260
	Except 426 Eng.	70	—	1	—	—	—	—	—	—	—	—	—	3420 969
	Except 426 Eng.	70	—	—	—	1	1	—	—	—	—	—	—	3420 967
	WITH DRUM BRAKES													
	w/Man. and Pwr. Brakes	70	1	1	1	—	—	—	—	—	—	—	—	3420 962
	w/Man. And Pwr. Brakes	71	1	—	1	—	—	—	—	—	—	—	—	3579 257
	w/Manual Brakes After Approx. June 1, 71	71	1	—	1	—	—	—	—	—	—	—	—	= 3621 969
	w/Manual Brakes	71	—	1	—	1	1	1	1	1	1	1	—	3579 259
	w/Man. Brakes Except Sta. Wgn. P, D, C	70	—	—	—	1	1	1	1	1	1	1	—	2808 578
	w/Power Brakes	70	—	1	—	—	—	—	—	—	—	—	—	2808 578
5-39-3	MASTER CYLINDER WITH													
	DISC BRAKES													
	V,L	70	1	—	1	—	—	—	—	—	—	—	—	2808 600
	V,L	71	1	—	1	—	—	—	—	—	—	—	—	3461 178
	w/o 426 Eng.	70	—	1	—	—	—	—	—	—	—	—	—	2944 453
	w/426 Eng.		—	1	—	1	1	—	—	—	—	—	—	2944 476
	w/o 426 Eng.	70	—	—	—	1	1	—	—	—	—	—	—	2944 477
	P,D,C,Y	70	—	—	—	—	—	1	1	1	1	1	1	2883 089
	B,J,R,W,P,D,C,Y	71	—	1	—	1	1	1	1	1	1	1	1	3461 176
	WITH DRUM BRAKES													
	w/Man. and Power Brakes	70	1	—	1	—	—	—	—	—	—	—	—	3420 961
	w/Man. And Power Brakes	71	1	—	1	—	—	—	—	—	—	—	—	3461 184
	w/Manual Brakes	71	—	1	—	1	1	—	—	—	—	—	—	3461 184
	w/Man. and Power Brakes	70	—	1	—	1	1	1	1	1	1	1	—	2808 577
CARLINES	J - Challenger B - Barracuda	V - Valiant L - Dart	R - Belvedere - Satellite W - Coronet - Charger	P - Plymouth D - Dodge	C - Chrysler Y - Imperial									

AR Indicates use as required.

Indicates parts not listed in any previous parts book.

Numerals in parentheses () refer to notes.

★ Indicates change or addition.

Printed in U.S.A.
January 1972

CODE	PART NAME	ENG. TYPE OR CU.IN.	V	B	L	R	W	P	D	C	C	C	Y	PART NUMBER
			1-2	1-2	1-2	1-2	1-2	1-2	1-2	1	2	3	1	
5-39-0 MASTER CYLINDER Cont'd.														
5-39-3	MASTER CYLINDER WITH DISC BRAKES Cont'd.													
	w/Power Brakes	71	—	1	—	1	1	—	—	—	—	—	—	3461 182
	w/Manual Brakes	71	—	—	—	—	—	1	1	1	1	1	—	3461 182
5-39-11	BOLT, Master Cyl. Mtg.		—	4	—	4	4	4	4	4	4	—	—	2260 046
5-39-12	SPACER, Master Cyl. to Booster	70	—	1	—	—	—	—	—	—	—	—	—	2944 482
5-39-18	GASKET, Master Cyl. Mtg.	70	1	1	1	1	1	1	1	1	1	—	—	2401 862
		71	1	—	1	—	—	—	—	—	—	—	—	3461 212
	Power Brake Mtg. To Dash	71	1	—	1	—	—	—	—	—	—	—	—	3461 212
	Power Brake Mtg. to Dash w/426 Eng.		—	1	—	1	1	—	—	—	—	—	—	2401 862
	Power Brake Mtg. To Dash	71	—	—	—	—	—	1	1	1	1	1	—	2401 862
5-39-20	COVER, Master Cyl. Reservoir													
	w/Disc Exc. Wgn.	70	1	—	1	1	1	1	1	1	1	1	1	2881 511
	w/Disc Brakes	71	1	1	1	1	1	1	1	1	1	1	1	2944 225
	w/Pwr. Drum, Sta. Wgn.	70	—	—	—	1	1	—	—	—	—	—	—	2881 511
	w/Man. Drum	70	1	1	1	1	1	1	1	1	1	1	—	2823 999
	w/Man. Drum	71	1	1	1	1	1	1	1	1	1	—	—	3461 046
	w/Disc	70	—	1	—	—	—	—	—	—	—	—	—	2944 465
	w/Disc, w/426 Eng.		—	1	—	1	1	—	—	—	—	—	—	2944 465
5-39-24	GASKET, Reservoir Cover													
	Use w/2944465 Cover		—	1	—	1	1	—	—	—	—	—	—	2944 466
	Use w/2823999 Cover	70	1	1	1	1	1	1	1	1	1	1	—	2823 994
	Use w/3461046 Cover	71	1	1	1	1	1	1	1	1	1	—	—	3461 047
	Use w/2881511 Cover		1	—	1	1	1	1	1	1	1	1	1	2881 512
	Use w/2944225 Cover	71	1	1	1	1	1	1	1	1	1	1	1	2944 227
5-39-26	CLAMP, Master Cyl. Cover	70	1	1	1	1	1	1	1	1	1	—	—	2823 950
5-39-29	WIRE, Master Cyl. Cover Bail	70	1	—	1	—	—	—	—	—	—	—	—	2881 513
		71	1	1	1	1	1	1	1	1	1	—	—	3461 202
	w/Disc Brakes	70	1	—	1	—	—	—	—	—	—	—	—	2944 381
	w/Disc Brakes	71	1	1	1	1	1	1	1	1	1	1	1	3461 201
	B,J	70	—	1	—	—	—	—	—	—	—	—	—	2944 467
	w/426 Eng.		—	1	—	1	1	—	—	—	—	—	—	2944 467
	Except 426 Eng.	70	—	—	—	1	1	1	1	1	1	1	1	2944 381
5-40-0 MASTER CYLINDER BOOT														
5-40-1	BOOT, Master Cyl.													
	w/Disc Brakes	70	1	—	1	1	1	—	—	—	—	—	—	1828 388
	w/Disc Brakes	71	1	—	1	—	—	—	—	—	—	—	—	1828 388
	w/Man. Drum Brakes		1	1	1	1	1	1	1	1	1	—	—	1828 388
5-40-4	RETAINER, Master Cyl. Boot													
	w/Disc Brakes	70	1	—	1	1	1	—	—	—	—	—	—	1828 389
	w/Disc Brakes	71	1	—	1	—	—	—	—	—	—	—	—	3461 205
	w/Man. Drum Brakes	70	1	1	1	1	1	1	1	1	1	—	—	1828 389
	w/Man. Drum Brakes	71	1	1	1	1	1	1	1	1	1	—	—	3461 205
5-44-0 MASTER CYLINDER PISTON														
5-44-3	PISTON, Master Cyl.													
	w/Disc	70	1	—	1	—	—	—	—	—	—	—	—	2881 503
5-44-6	SPRING, Master Cyl. Piston	71	1	1	1	1	1	1	1	1	1	1	1	2944 222
5-44-8	STOP, Master Cyl. Primary Piston													
	w/Disc	70	—	1	—	—	—	—	—	—	—	—	—	2265 635
	w/Pwr.Drum	70	1	1	1	1	1	1	1	1	1	1	—	2265 635
	w/Man. Drum	70	1	1	1	1	1	1	1	1	1	—	—	1828 389
	w/Man. Drum	71	1	1	1	1	1	1	1	1	1	1	1	6029 170
5-44-9	SCREW, Master Cyl. Primary Piston	70	AR	AR	AR	AR	AR	AR	AR	AR	AR	AR	—	2200 341
	Master Cyl. Secondary Piston													
	Stop	71	1	1	1	1	1	1	1	1	1	1	1	6028 159
5-44-11	SEAL, Master Cyl. Stop Screw													
	w/Disc Brakes		1	1	1	1	1	1	1	1	1	1	1	2881 519
CARLINES	J - Challenger B - Barracuda	V - Valiant L - Dart	R - Belvedere - Satellite W - Coronet - Charger	P - Plymouth D - Dodge	C - Chrysler Y - Imperial									
AR Indicates use as required.			Numerals in parentheses () refer to notes.						Printed in U.S.A. January 1972					
# Indicates parts not listed in any previous parts book.			★ Indicates change or addition.											

CODE	PART NAME	ENG. TYPE OR CU.IN.	V	B	L	R	W	P	D	C	C	C	Y	PART NUMBER
			1-2	1-2	1-2	1-2	1-2	1-2	1	2	3	1		
5-47-0 MASTER CYLINDER PISTON PUSH ROD														
5-47-2	ROD, Master Cyl. Push													
	w/Disc Brakes	70	1	—	1	—	—	—	—	—	—	—	—	2265 640
	w/Disc Brakes	71	1	—	1	—	—	—	—	—	—	—	—	3461 211
	w/Disc Brakes	71	—	1	—	1	1	—	—	—	—	—	—	2534 246
	Rod, Output Push W/Disc Brakes	71	—	1	1	1	1	1	1	1	1	1	—	2944 499
	w/Man. Drum Brakes (Pri. Piston)	70	1	—	1	—	—	—	—	—	—	—	—	2265 640
	w/Man. Drum Brakes (Pri. Piston)	71	1	—	1	—	—	—	—	—	—	—	—	3461 211
	w/Man. Drum Brakes		—	1	—	1	1	—	—	—	—	—	—	2944 196
	w/Man. Drum Brakes	70	—	—	—	1	1	—	—	—	—	—	—	2534 246
	w/Man. Drum Brakes	70	—	—	—	—	—	1	1	1	1	—	—	2409 978
	W/Man. Drum Brakes Pri. Piston	71	—	—	—	—	—	1	1	1	1	1	—	3461 210
5-47-4	BOLT, Master Cyl. Push Rod		1	1	1	1	1	1	1	1	1	1	1	2201 181
5-47-10	RING, Master Cyl. Push Rod Retainer													
	w/Disc Brakes		1	—	1	—	—	—	—	—	—	—	—	2074 960
	w/Man. Drum Brake		1	1	1	1	1	1	1	1	1	—	—	2074 960
5-52-0 MASTER CYLINDER BRAKE TUBE														
5-52-4	NUT, Master Cyl. to Brake Tee Tube													
	Fr.		AR	AR	AR	AR	AR	AR	AR	AR	AR	AR	AR	6026 887
	Fr.		AR	AR	AR	AR	AR	AR	AR	AR	AR	AR	AR	6026 436
	Rr.		AR	AR	AR	AR	AR	AR	AR	AR	AR	AR	AR	6026 888
	Rr.		AR	AR	AR	AR	AR	AR	AR	AR	AR	AR	AR	0137 396
5-52-10	TUBE, Master Cyl. to Brake Tee													
	Fr. w/Man. Brakes		—	—	—	—	—	1	1	1	1	—	—	2880 409
	Rr. w/Man. Brakes		—	—	—	—	—	1	1	1	1	—	—	2880 411
5-53-0 BRAKE TUBING AND COVER														
5-53-3	TUBING, 25 Foot Roll													
	3/16" O.D.		1	1	1	1	1	1	1	1	1	1	1	1843 251
	1/4" O.D.		1	1	1	1	1	1	1	1	1	1	1	1843 252
	5/16" O.D.		1	1	1	1	1	1	1	1	1	1	1	1843 253
	3/8" O.D.		1	1	1	1	1	1	1	1	1	1	1	1843 254
5-53-4	COVER, Tubing 25 Foot Roll													
	3/16" O.D. Tubing		1	1	1	1	1	1	1	1	1	1	1	1843 257
	1/4" O.D. Tubing		1	1	1	1	1	1	1	1	1	1	1	1843 258
5-54-0 REAR AXLE BRAKE TUBE														
5-54-4	NUT, Rr. Axle Brake Tube Outer	70	2	2	2	2	2	2	2	2	2	2	2	2643 974
		71	2	2	2	2	2	2	2	2	2	2	2	6029 113
	Brk. Tee To Rt. and Lt. Hose Tube w/o Disc Brakes		1	1	1	1	1	1	1	1	1	1	1	2643 974
	Brk. Tee to Rr. Hose Tube w/o Disc Brakes		1	1	1	1	1	1	1	1	1	1	1	2643 974
	Tee to Rt. And Lt. Hose Tube	71	—	—	—	—	—	—	—	—	—	—	2	2643 974
	J/Blk. To Rt. And Lt. Hose Brk. Tube w/Skid Control	71	—	—	—	—	—	—	—	—	—	—	2	2643 974
	Metering Valve To Rt. and Lt. Tube W/Disc Brakes		—	1	—	1	1	1	1	1	1	1	1	2643 974
	w/Disc Brakes	71	—	—	—	—	—	1	1	1	1	1	1	2643 974
5-55-0 BRAKE TUBE														
5-55-1	TUBE, Frt. Whl. Brake Hose to Whl. Cyl.													
	w/9" Drum Brakes Rt.		1	—	1	—	—	—	—	—	—	—	—	2856 083
	w/9" Drum Brakes Lt.		1	—	1	—	—	—	—	—	—	—	—	2856 081
	w/10" Drum Brakes	70	1	—	1	—	—	—	—	—	—	—	—	3461 672-3
	w/10" Drum Brakes	71	1	—	1	—	—	—	—	—	—	—	—	3461 960-1
	Nut, Tube Cyl. End.	70	2	—	2	—	—	—	—	—	—	—	—	6028 547
		71	2	—	2	—	—	—	—	—	—	—	—	= 6029 159

CARLINES

J - Challenger
B - BarracudaV - Valiant
L - DartR - Belvedere - Satellite
W - Coronet - ChargerP - Plymouth
D - DodgeC - Chrysler
Y - Imperial

AR Indicates use as required.

Indicates parts not listed in any previous parts book.

Numerals in parentheses () refer to notes.

★ Indicates change or addition.

Printed in U.S.A.
January 1972

CODE	PART NAME	ENG. TYPE OR CU.IN.	V	B	L	R	W	P	D	C	C	C	Y	PART NUMBER
			1-2	1-2	1-2	1-2	1-2	1-2	1-2	1	2	3	1	
5-56-0 BRAKE TUBE CLIP														
5-56-2	CLIP, Brake Tee to Rr. Hose Tube Frt. Reinf. Brake Tee to Rr. Hose Tube Rr. Reinf.		1	—	1	—	—	1	1	1	1	1	—	2123 341
	Brake Tee to Prpg. Valve Tube 70		1	—	1	—	—	—	—	—	—	—	—	2883 929
	Brake Tee to Rr. Hose Tube Frt.		2	—	2	1	1	—	—	—	—	—	—	2123 341
	Brake Tee to Rr. Hose Tube Rr.		3	—	3	4	4	—	—	—	—	—	—	2123 341
	Brake Tee to Rr. Hose Tube		—	AR	—	2	2	5	5	5	5	AR	5	2123 341
	Brake Tee to Rr. Hose Tube (Barb Type)		1	—	1	—	—	—	—	—	—	—	—	2207 933
	Brake Tee to Rr. Hose Tube (Barb Type) 70		—	—	—	1	1	—	—	—	—	—	—	2467 719
	Metering Valve to Rt. Hose Tube		—	—	—	—	—	5	5	5	5	5	—	1119 423
	Metering Valve To Rt. Hose Tube Center 71		—	—	—	—	—	—	—	—	—	—	1	2073 041
	Metering Valve to Rr. Hose Tube Sill		—	—	—	—	—	1	1	1	1	1	1	2781 518
	Metering Valve to Rr. Hose Tube		—	—	—	—	—	5	5	5	5	5	5	2123 341
	Brake Tee to Metering Valve Tube		—	—	—	—	—	1	1	1	1	1	—	1119 423
	Brake Tee to Rt. Hose Tube		—	—	—	—	—	5	5	5	5	5	—	1119 423
	Brake Tee to Rr. Hose Tube Sill		—	—	—	—	—	1	1	1	1	1	1	2781 518
	Master Cyl. to Brake Tee Tube		1	1	1	1	1	1	1	1	1	1	1	2465 517
	Tube Sill 71		—	—	—	—	—	1	1	1	1	1	1	3466 870
5-57-0 BRAKE TUBE BRACKET														
5-57-2	BRACKET, Frt. Whl. Brake Hose to Knuckle w/Drum Brakes, w/10" Brakes 70		1	—	1	—	—	—	—	—	—	—	—	3461 890-1
	w/Disc Brakes, w/10" Brakes		1	—	1	—	—	—	—	—	—	—	—	3461 676-7
	w/Drum Brakes, w/9" Brakes Rt.		1	—	1	—	—	—	—	—	—	—	—	2852 374
	w/Drum Brakes, w/9" Brakes Lt.		1	—	1	—	—	—	—	—	—	—	—	2852 373
	w/Drum Brakes, w/9" Brakes 71		1	—	1	—	—	—	—	—	—	—	—	3461 962-3
	BRACKET, Frt. Whl. Brake Hose to Frame Y		—	—	—	—	—	2	2	2	2	2	—	2944 988
	Bracket, Rr. Axle Brake Hose 70		—	—	—	1	1	—	—	—	—	—	2	2944 989
	Rr. Axle Brake Hose		—	—	—	—	—	1	1	1	1	1	1	2823 304
	Brake Tube Rr. Hose 71		—	1	—	—	—	—	—	—	—	—	—	2460 676
	Brake Tube Rr. Hose 71		1	—	1	—	—	—	—	—	—	—	—	3466 396
	Brake Tube Rr. Hose 71		—	—	—	1	1	—	—	—	—	—	—	3466 397
	Nut, Brake Tube Rr. Hose Brkt.		—	—	—	—	—	—	—	—	—	—	—	3404 975
	Screw 71		—	—	—	—	—	1	1	1	1	1	1	6029 355
5-58-0 BRAKE TUBE TEE														
5-58-1	TEE, Brake Tube Warning Warning		1	—	1	1	1	—	—	—	—	—	—	3420 021
	w/Warning Switch w/o/Screw		1	1	1	1	—	—	—	—	—	—	—	2925 882
	Brake Tube W/Warning Switch W/Screw		—	1	—	1	1	—	—	—	—	—	—	3404 607
	Warning 70		—	—	—	—	—	1	1	1	1	1	1	2925 883
	Brake Tube Pr. Pg. W/Disc Brakes W/O Screw		1	—	1	1	1	—	—	—	—	—	—	3466 350
	Brake Tube Pr. Pg. W/Disc Brakes W/Screw		—	1	—	1	1	—	—	—	—	—	—	3466 351
	TEE, Rr. Axle Brake Hose		1	1	1	1	1	1	1	1	1	1	1	3404 742
	Rr. Axle Brake Hose 70		—	—	—	1	1	—	—	—	—	—	—	2856 076
	Rr. Axle Brake Tube 70		1	—	1	—	—	—	—	—	—	—	—	1940 621
	Rr. Axle Brake Tube 70		—	—	—	—	—	1	1	1	1	1	1	3404 742
	Brake Tube 71		—	—	—	—	—	1	1	1	1	—	—	3466 792
	Union, Rr. Brake Tube W/ Anti-Skid Control 71		—	—	—	—	—	—	—	—	—	—	1	3466 783
	NOTE: For Further Information See P.T.C. 5-107-34													

CARLINES

J - Challenger
B - BarracudaV - Valiant
L - DartR - Belvedere - Satellite
W - Coronet - ChargerP - Plymouth
D - DodgeC - Chrysler
Y - Imperial

AR Indicates use as required.

Indicates parts not listed in any previous parts book.

Numerals in parentheses () refer to notes.

★ Indicates change or addition.

Printed in U.S.A.
January 1972

CODE	PART NAME	ENG. TYPE OR CU.IN.	V	B	L	R	W	P	D	C	C	C	Y	PART NUMBER
			1-2	1-2	1-2	1-2	1-2	1-2	1-2	1	2	3	1	
5-58-0 BRAKE TUBE TEE Cont'd.														
5-58-12	"O"RING, Brake Tee to Indicator	70	1	1	1	1	1	1	1	1	1	1	1	2881 984
	Brake Tee to Indicator	71	1	1	1	1	1	—	—	—	—	—	—	2881 984
	Metering Valve to Indicator	71	—	—	—	—	—	1	1	1	1	1	1	2881 984
5-58-13	SPRING NUT	70	—	—	—	1	1	—	—	—	—	—	—	152 267
	SCREW, Spring Nut	70	—	—	—	1	1	—	—	—	—	—	—	6026 860
5-62-0 BRAKE FLEXIBLE HOSE														
5-62-1	HOSE, Frt. Whl. Brake													
	9" and 10" Brakes		2	—	2	—	—	—	—	—	—	—	—	3461 729
	10" and 11" Brakes		—	2	—	2	2	—	—	—	—	—	—	3461 730
	w/Drum Brakes		—	—	—	—	—	2	2	2	2	2	—	3461 731
	w/Disc Brakes		—	2	—	2	2	2	2	2	2	2	2	2925 163
	HOSE, Rr. Axle Brakes		1	1	1	1	1	—	—	—	—	—	—	3461 728
	B, J	70	—	1	—	—	—	—	—	—	—	—	—	3461 727
	P, D, C, Y		—	—	—	—	—	1	1	1	1	1	1	3461 725
5-62-7	GASKET, Frt. Whl. Brake Cyl. Hose		—	2	—	2	2	2	2	2	2	2	—	2072 612
5-62-20	LOCK, Frt. or Rr. Axle Brake Hose		AR	AR	AR	AR	AR	AR	AR	AR	AR	AR	AR	2208 893
5-63-0 WHEEL CYLINDER REPAIR PACKAGE														
5-63-1	CYLINDER REPAIR PACKAGE, Frt.													
	9" Brakes		2	—	2	—	—	—	—	—	—	—	—	3549 819
	10 and 11" Brakes	70	2	—	2	2	2	2	2	2	2	2	2	3549 803
	10 and 11" Brakes	71	2	2	2	2	2	2	2	2	2	2	—	3420 140
	CYLINDER PACKAGE, Rr.													
	9" Brakes	70	2	2	2	—	—	—	—	—	—	—	—	2808 695
	9" Brakes	71	2	2	2	—	—	—	—	—	—	—	—	= 3420 999
	10 and 11" Brakes	70	2	2	2	2	2	2	2	2	2	2	2	2808 697
	10 and 11" Brakes	71	2	2	2	2	2	2	2	2	2	2	2	= 3421 000
	11 x 3" Brakes	70	—	—	—	—	—	—	—	—	—	—	2	3549 804
5-64-0 WHEEL BRAKE CYLINDER														
5-64-1	CYLINDER, Frt. Whl., Complete													
	9" Brakes		1	—	1	—	—	—	—	—	—	—	—	2881 620-1
	10 and 11" Brakes Rt.		1	1	1	1	1	—	—	—	—	—	—	3420 995
	11" Brakes Lt.		—	—	—	—	—	1	1	1	1	1	—	3420 995
	10 and 11" Brakes Lt.		1	1	1	1	1	—	—	—	—	—	—	3420 996
	11" Brakes Rt.		—	—	—	—	—	1	1	1	1	1	—	3420 996
	CYLINDER, Rr. Whl., Complete													
	9" Brakes		2	—	2	—	—	—	—	—	—	—	—	3461 656
	10" and 11" Brakes		2	2	2	2	2	2	2	2	2	2	2	3420 997
5-64-2	SCREW, Frt. Whl. Brake													
	Cyl. Mtg.	70	4	—	4	—	—	—	—	—	—	—	—	6028 434
	W/9" Brakes	71	4	—	4	—	—	—	—	—	—	—	—	6026 058
	W/10 and 11" Brakes	71	—	4	—	4	4	4	4	4	4	—	—	6028 921
	Screw, Rr. Whl. Brake Cyl. Mtg.													
	W/10 and 11" Brakes		—	4	—	4	4	4	4	4	4	4	4	6028 921
5-64-7	SEAL, Rr. Whl. Brake Cyl. to Support		2	2	2	2	2	2	2	2	2	2	2	2534 663
5-66-0 WHEEL CYLINDER TUBE INSERT														
5-66-6	INSERT, Cyl. Tube		2	2	2	2	2	2	2	2	2	2	2	2072 678
5-67-0 WHEEL CYLINDER BLEEDER SCREW														
5-67-1	SCREW, Bleeder w/o Disc Brakes		2	2	2	2	2	2	2	2	2	2	2	2881 619
	Bleeder w/Disc Brakes		2	2	2	2	2	2	2	2	2	2	2	2781 019
CARLINES	J - Challenger B - Barracuda	V - Valiant L - Dart	R - Belvedere W - Cororet - Charger	Satellite	P - Plymouth D - Dodge	C - Chrysler Y - Imperial								

AR Indicates use as required.

Indicates parts not listed in any previous parts book.

Numerals in parentheses () refer to notes.

★ Indicates change or addition.

Printed in U.S.A.
January 1972

CODE	PART NAME	ENG. TYPE OR CU.IN.	V	B	L	R	W	P	D	C	C	C	Y	PART NUMBER
			1-2	1-2	1-2	1-2	1-2	1-2	1-2	1	2	3	1	
5-69-0 WHEEL CYLINDER BOOT														
5-69-1	BOOT, Frt. Whl. Cyl.													
	9" Brakes		4	—	4	—	—	—	—	—	—	—	—	2881 624
	10" and 11" Brakes		4	4	4	4	4	4	4	4	4	4	—	3461 513
	BOOT, Rr. Whl. Cyl.													
	9" Brakes		4	—	4	—	—	—	—	—	—	—	—	2881 604
	10" and 11" Brakes		4	4	4	4	4	4	4	4	4	4	4	2881 618
5-70-0 WHEEL CYLINDER PISTON														
5-70-1	PISTON, Frt. Whl. Brake Cyl.													
	9" Brakes		4	—	4	—	—	—	—	—	—	—	—	2072 655
	PISTON, Rr. Whl. Brake Cyl.													
	9" Brakes		4	—	4	—	—	—	—	—	—	—	—	2072 656
	10" and 11" Brakes		4	4	4	4	4	4	4	4	4	4	4	2260 843
5-71-0 WHEEL CYLINDER PISTON CUP														
5-71-1	CUP, Frt. Whl. Brake Cyl. Piston													
	9" Brakes		4	—	4	—	—	—	—	—	—	—	—	1669 337
	10" and 11" Brakes		4	4	4	4	4	4	4	4	4	4	—	3461 511
	CUP, Rr. Whl. Brake Cyl. Piston													
	9" Brakes		4	—	4	—	—	—	—	—	—	—	—	2265 574
	10" and 11" Brakes		4	4	4	4	4	4	4	4	4	4	4	2260 844
5-71-2	SPRING, Frt. Whl. Cyl. Piston													
	9" and 10" Brakes		2	2	2	—	—	—	—	—	—	—	—	1923 765
	SPRING, Rr. Whl. Cyl. Piston													
	9" Brakes		2	—	2	—	—	—	—	—	—	—	—	2072 637
	10" and 11" Brakes		2	2	2	2	2	2	2	2	2	2	2	1923 765
5-100-0 POWER BRAKE POWER UNIT														
5-100-1	FOR FIELD INSTALLATION													
	Power Brake Package													
	Drum and Disc Midland Ross	70	1	—	1	—	—	—	—	—	—	—	—	3420 972
	Drum and Disc 10" Brakes	71	1	—	1	—	—	—	—	—	—	—	—	3579 290
	w/9" Drum Brakes All w/Disc													
	Brakes		1	—	1	—	—	—	—	—	—	—	—	= 3549 094
	Drum	70	—	1	—	—	—	—	—	—	—	—	—	3420 971
	Drum 10" And 11" Brakes	71	—	1	—	1	1	—	—	—	—	—	—	3579 292
	Drum, except Sta. Wgn.	70	—	—	—	1	1	—	—	—	—	—	—	3004 622
	Drum, Sta. Wgn.	70	—	—	—	1	1	—	—	—	—	—	—	3420 001
	Drum	70	—	—	—	—	—	1	1	1	1	1	—	3004 867
	Drum, P, D, Wgn. C-All	71	—	—	—	—	—	1	1	1	1	1	—	3549 942
	Drum, P, D Exc. Wgn.	71	—	—	—	—	—	1	1	—	—	—	—	3549 943
	KIT, Booster Modification													
	w/Power Brakes	71	1	1	1	1	1	—	—	—	—	—	—	= 3621 997
5-100-2	POWER UNIT, WITH DISC BRAKES													
	V,L	70	1	—	1	—	—	—	—	—	—	—	—	3461 104
	V,L	71	1	—	1	—	—	—	—	—	—	—	—	3461 110
	w/o 426 Eng.	70	—	1	—	—	—	—	—	—	—	—	—	3420 987
	Less Linkage w/340 Eng.													
	w/3-2 Bbl. Carb.	70	—	1	—	—	—	—	—	—	—	—	—	3461 118
	Less Linkage w/340 Eng.													
	w/3-2 Bbl. Carb.	71	—	1	—	—	—	—	—	—	—	—	—	3579 272
	Less Linkage, w/426 Eng.	70	—	1	—	—	—	—	—	—	—	—	—	2944 486
	w/Linkage w/426 Eng.	71	—	1	—	1	1	—	—	—	—	—	—	3461 301
	Less Linkage, w/o 426 Eng.	70	—	1	—	—	—	—	—	—	—	—	—	2944 490
	Less Linkage	71	—	1	—	1	1	—	—	—	—	—	—	3579 272
	Less Linkage, w/426 Eng.	70	—	—	—	1	1	—	—	—	—	—	—	2881 801
	P,D,C,Y	70	—	—	—	—	—	1	1	1	1	1	1	3461 034

CARLINES

J - Challenger
B - BarracudaV - Valiant
L - DartR - Belvedere - Satellite
W - Coronet - ChargerP - Plymouth
D - DodgeC - Chrysler
Y - Imperial

AR Indicates use as required.

Indicates parts not listed in any previous parts book.

Numerals in parentheses () refer to notes.

★ Indicates change or addition.

Printed in U.S.A.
January 1972

CODE	PART NAME	ENG. TYPE OR CU.IN.	V	B	L	R	W	P	D	C	C	C	Y	PART NUMBER
			1-2	1-2	1-2	1-2	1-2	1-2	1-2	1	2	3	1	
5-100-0 POWER BRAKE POWER UNIT Cont'd.														
5-100-2	POWER UNIT Cont'd.													
	w/Man. Trans.	71	—	—	—	—	—	1	1	1	1	1	—	3461 278
	w/Auto. Trans.	71	—	—	—	—	—	1	1	1	1	1	—	3579 267
		71	—	—	—	—	—	—	—	—	—	—	1	3461 278
	BENDIX, R.W.	70	—	—	—	1	1	—	—	—	—	—	—	2883 056
	POWER UNIT, With Drum Brakes	70	1	—	1	—	—	—	—	—	—	—	—	2944 006
	V,L.	71	1	—	1	—	—	—	—	—	—	—	—	3461 110
	V, L w/198, 225, 318 Eng. w/Power													
	Drum Brakes	71	1	—	1	—	—	—	—	—	—	—	—	= 3461 109
	Less Linkage, w/o 426 Eng.	70	—	1	—	—	—	—	—	—	—	—	—	2944 489
	Less Linkage w/o 426 Eng. w/10" Brakes.	71	—	1	—	1	1	—	—	—	—	—	—	3461 287
	Less Linkage w/o 426 Eng. w/11" Brakes	71	—	1	—	1	1	—	—	—	—	—	—	3579 272
	w/Power Brakes	71	—	1	—	1	1	—	—	—	—	—	—	= 3461 360
	w/426 Eng.	70	—	1	—	—	—	—	—	—	—	—	—	2944 309
	Less Linkage, w/426 Eng.	70	—	1	—	—	—	—	—	—	—	—	—	2881 800
	W/426 Eng.	71	—	1	—	1	1	—	—	—	—	—	—	3461 300
	w/426 Eng.	70	—	—	—	1	1	—	—	—	—	—	—	2944 160
	w/o 426 Eng.	70	—	—	—	1	1	—	—	—	—	—	—	3004 608
	P, D. Sta. Wgn. Only C-All													
	Midland Ross	70	—	—	—	—	—	1	1	1	1	1	—	3004 829
	P, D. Sta. Wgn. Bendix	70	—	—	—	—	—	1	1	—	—	—	—	3461 140
	P, D Exc. Sta. Wgn.	70	—	—	—	—	—	1	1	—	—	—	—	3549 834
	For Field Installed Unit	70	—	—	—	—	—	1	1	1	1	1	—	2944 041
	For Field Installed Unit	71	—	—	—	—	—	1	1	1	1	1	—	3461 310
5-100-15	SPRING, Power Brake Lever Push Rod	70	—	1	—	1	1	—	—	—	—	—	—	2534 228
5-100-18	BUSHING, Pwr. Brkae Lever Push Rod, Lwr	70	—	1	—	1	1	—	—	—	—	—	—	2534 231
	Pwr. Brake Lever Push Rod, Upr.	70	—	1	—	1	1	—	—	—	—	—	—	2534 346
5-100-20	ROD, Brake Pedal to Booster Linkage		1	—	1	—	—	—	—	—	—	—	—	3461 010
	Brake Pedal to P/Brake Linkage	71	—	1	—	1	1	—	—	—	—	—	—	3461 148
	Master Cyl. Output Push		—	1	—	1	1	1	1	1	1	1	—	2944 499
	Lever Push	70	—	1	—	—	—	—	—	—	—	—	—	2944 289
	Plunger Push	70	—	—	—	1	1	—	—	—	—	—	—	2534 233
	Pedal Push	71	—	1	—	1	1	1	1	1	1	1	—	3461 148
	Plunger Push, w/o Disc Brakes	70	—	—	—	—	—	1	1	1	1	1	—	2944 009
	Plunger Push, w/Disc Brakes		—	—	—	—	—	1	1	1	1	1	1	2944 116
5-100-26	BOOT, Pedal Linkage to Firewall		1	—	1	—	—	—	—	—	—	—	—	2643 731
	Plunger to Push Rod w/Power and Disc Brakes		—	1	—	1	1	—	—	—	—	—	—	3461 001
	Plunger to Push Rod w/ Auto. Trans. w/Disc Brakes		—	—	—	—	—	1	1	1	1	1	—	3461 001
	Push Rod w/o Disc Brakes		—	1	—	1	1	1	1	1	1	1	—	2823 375
	Valve Oper, Push Rod		—	1	—	1	1	1	1	1	1	1	1	2534 349
	Push Rod w/Disc Brakes		—	1	—	1	1	1	1	1	1	1	—	3461 005
	Plunger to Push Rod		1	1	1	1	1	1	1	1	1	1	1	2944 020
	GUARD, Brake Pedal Linkage													
	w/426 Eng.		—	1	—	1	1	—	—	—	—	—	—	2467 592
5-100-32	RETAINER, Rr. Cyl. Shell Boot w 426 Eng.	70	—	1	—	1	1	—	—	—	—	—	—	2823 993
	Push Rod Boot	70	—	—	—	1	1	1	1	1	1	1	—	2823 378
	Push Rod to Plunger		1	1	1	1	1	1	1	1	1	1	1	2401 166
	Master Cylinder Push Rod Seal		—	1	—	1	1	1	1	1	1	1	1	2401 885
	CLIP, Plunger to Push Rod	70	—	1	—	—	—	—	—	—	—	—	—	3461 002
5-100-34	LEVER, w/Reaction Ring		1	1	1	1	1	1	1	1	1	1	1	2944 019
5-100-62	SCREW, Master Cyl. Push Rod	70	—	—	—	1	1	1	1	1	1	1	—	2660 776
	Master Cyl. Push Rod	70	1	1	1	—	—	—	—	—	—	—	—	2944 497
	Master Cyl. Push Rod.	71	1	1	1	1	1	1	1	1	1	1	1	2660 776

CARLINES J - Challenger
B - Barracuda

V - Valiant
L - Dart

R - Belvedere - Satellite
W - Coronet - Charger

P - Plymouth
D - Dodge

C - Chrysler
Y - Imperial

AR Indicates use as required.

Indicates parts not listed in any previous parts book.

Numerals in parentheses () refer to notes.

★ Indicates change or addition.

Printed in U.S.A.
January 1972

CODE	PART NAME	ENG. TYPE OR CU.IN.	V	B	L	R	W	P	D	C	C	C	Y	PART NUMBER
			1-2	1-2	1-2	1-2	1-2	1-2	1-2	1	2	3	1	
5-100-115	LINKAGE, Brake Pedal w/426 Eng.	70	—	1	—	—	—	—	—	—	—	—	—	2944 488
	w/426 Eng.	70	—	—	—	1	1	—	—	—	—	—	—	2467 594
5-100-161	SEAL, Valve Body to Reaction Hub		—	—	—	1	1	1	1	1	1	1	1	2266 942
	Vacuum	70	—	—	—	1	1	1	1	1	1	1	1	2401 126
	Valve Body to Rr. Cyl. Shell		—	1	—	1	1	1	1	1	1	1	1	
5-100-167	BUSHING, M/Cyl. Push Rod to Plunger		1	—	—	—	—	—	—	—	—	—	—	2401 853
5-100-180	RETAINER, Valve Silencer w/426 Eng.	71	—	1	—	1	1	—	—	—	—	—	—	2401 135
5-100-189	HUB and LEVER, w/o 426 Eng.	70	—	—	—	1	1	—	—	—	—	—	—	2534 226
		71	1	—	1	—	—	—	—	—	—	—	—	3461 262
		71	—	1	—	1	1	1	1	1	1	1	—	3461 295
	HUB and LEVER, w/426 Eng.	70	—	—	—	1	1	—	—	—	—	—	—	2823 989
	w/o 426 Eng.	70	—	1	—	—	—	—	—	—	—	—	—	2944 286
	w/426 Eng.	70	—	1	—	—	—	—	—	—	—	—	—	2944 487
	Bolt, P/Brake Lever Hub Exc.		—	—	—	—	—	—	—	—	—	—	—	
	426 Eng.	71	—	1	—	1	1	—	—	—	—	—	—	6029 291
5-100-191	PIN, Lever Pivot w/426 Eng.	70	—	1	—	1	1	—	—	—	—	—	—	2074 986
5-100-192	WASHER, Linkage Pin Spring		2	—	2	—	—	—	—	—	—	—	—	869 770
	Pedal Linkage Clevis Bowed w/426 Eng.	70	—	2	—	2	2	—	—	—	—	—	—	2467 600
	Valve Oper. Rod Bowed w/426 Eng.	70	—	2	—	2	2	—	—	—	—	—	—	2075 005
5-100-194	PIN, Valve Oper. Rod Clevis w/426 Eng.	70	—	1	—	1	1	—	—	—	—	—	—	2075 006
	Brake Pedal Linkage Clevis		—	1	—	1	1	—	—	—	—	—	—	2075 006
	Power Brake Linkage Clevis	71	—	2	—	2	2	—	—	—	—	—	—	2075 006
	Power Brake Push Rod Clevis	71	1	2	1	2	2	2	2	2	2	2	—	2075 006
	Power Brake Hub Linkage Clevis	71	1	—	1	—	—	—	—	—	—	—	—	3461 281
	Power Brake Linkage Lever Clevis	71	1	—	1	—	—	—	—	—	—	—	—	3461 282
5-100-197	SILENCER, Valve Body Rr. w/Disc Brakes	70	—	—	—	1	1	1	1	1	1	1	1	2401 154
	Valve Body Rr. w/426 Eng.	71	—	1	—	1	1	—	1	—	—	—	—	3461 302
	Valve	70	—	—	—	2	2	2	2	2	2	2	—	2823 380
	Valve, Rr. w/o 426 Eng.		—	1	—	1	1	1	1	1	1	1	—	3461 008
5-100-198	SLEEVE, Power Brake Lever Hub	70	—	1	—	—	—	—	—	—	—	—	—	2944 290
	R, W	70	—	—	—	1	1	—	—	—	—	—	—	2534 227
	B,J,R,W.	71	—	1	—	1	1	—	—	—	—	—	—	2534 227
5-100-199	RETAINER, Valve Silencer	70	—	1	—	1	1	1	1	1	1	1	—	2823 381
		71	—	1	—	1	1	1	1	1	1	1	—	3461 290
5-100-206	SEAL and PLATE		—	1	—	1	1	1	1	1	1	1	—	2401 894
	PLATE, Rr. Cyl. Shell Brkt. Mtg. w/426 Eng.	70	—	1	—	1	1	—	—	—	—	—	—	2467 593
5-100-212	GROMMET, Vacuum Connector to Frt. Hsg.		1	1	1	1	1	1	1	1	1	1	1	2467 576
5-100-214	BRACE, Power Brake To Fender Shld.	71	1	—	1	—	—	—	—	—	—	—	—	2881 890

5-101-0 POWER UNIT MOUNTING BRACKET

5-101-1	BRACKET and STUDS, w/426 Eng.	Rt. 70	—	1	—	1	1	—	—	—	—	—	—	2823 991
	w/426 Eng.	Lt. 70	—	1	—	1	1	—	—	—	—	—	—	2823 990
	Bracket, P/Brake Mtg.	Rt. 71	1	—	1	—	—	—	—	—	—	—	—	3461 280
		Lt. 71	1	—	1	—	—	—	—	—	—	—	—	3461 279
5-101-5	SUPPORT, Power Brake to Dash Pnl.		1	—	1	—	—	—	—	—	—	—	—	2823 604
	BRACE, Power Brake to Fender Shield		1	—	1	—	—	—	—	—	—	—	—	2823 603
5-101-16	SPACER, Bracket to Booster w/426 Eng.	70	—	4	—	4	4	—	—	—	—	—	—	2823 992

5-105-0 POWER BRAKE VACUUM CONNECTOR

5-105-1	VALVE and GROMMET PACKAGE													
	w/Drum or Disc Brakes, Midland Ross	70	1	—	1	—	—	—	—	—	—	—	—	2808 609
	w/Drum or Disc Brakes Midland Ross		1	1	1	1	1	1	1	1	1	1	—	3420 974
	w/Drum or Disc Brakes Bendix		—	1	—	1	1	1	1	1	1	1	—	3420 973

CARLINES J - Challenger V - Valiant
B - Barracuda L - Dart

R - Belvedere - Satellite P - Plymouth
W - Coronet - Charger D - Dodge

C - Chrysler
Y - Imperial

AR Indicates use as required.

Indicates parts not listed in any previous parts book.

Numerals in parentheses () refer to notes.

★ Indicates change or addition.

Printed in U.S.A.
January 1972

CODE	PART NAME	ENG. TYPE OR CU.IN.	V	B	L	R	W	P	D	C	C	C	Y	PART NUMBER
			1-2	1-2	1-2	1-2	1-2	1-2	1-2	1	2	3	1	
5-101-0 POWER BRAKE VACUUM CONNECTOR Cont'd.														
5-105-1	VALVE AND GROMMET PACKAGE Cont'd.													
	w/Drum or Disc Brakes Midland Ross		—	1	—	1	1	1	1	1	1	1	1	3004 625
	w/Drum or Disc Brakes Bendix 70		—	—	—	1	1	1	1	1	1	1	1	3004 626
	w/426 Eng., Bendix		—	1	—	1	1	—	—	—	—	—	—	3420 128
	w/Drum Brakes w/o Disc Bendix 70		—	—	—	1	1	1	1	1	1	1	1	3420 129
	Valve Package, Booster Check W/340 Eng. W/Disc Brakes		—	1	—	—	—	—	—	—	—	—	—	3579 263
5-105-6	GROMMET, Vacuum Check Valve 70		—	—	—	1	1	1	1	1	1	1	1	2823 377
	w/426 Eng.		—	1	—	1	1	—	—	—	—	—	—	2823 377
5-105-10	SEAL, Frt. Cyl. Shell w/426 Eng.		—	1	—	1	1	—	—	—	—	—	—	2401 128
5-105-14	CAP, Vacuum Hose and Check Valve Bendix Midland Ross 71		—	1	—	1	1	1	1	1	1	1	1	2944 022
			1	1	1	1	1	1	1	1	1	1	1	2944 127
5-107-0 BOOSTER BRAKE TUBE														
5-107-15	TUBE, Brake Tee to Metering Valve		—	1	—	1	1	—	—	—	—	—	—	3404 615
5-107-34	VALVE, Metering w/Disc Brakes 71		—	1	—	1	1	—	—	—	—	—	—	3466 157
	w/Disc Brakes 70		—	—	—	1	1	—	—	—	—	—	—	3466 156
	70		—	—	—	—	—	1	1	1	1	1	—	3466 155
	70		—	—	—	—	—	—	—	—	—	—	1	3466 154
	W/Switch 71		—	—	—	—	—	1	1	1	1	1	1	3466 781
	Metering Proportioning W/H.D. Disc Brakes 71		—	—	—	—	—	1	1	—	—	—	—	3466 795
5-107-35	SLEEVE, Metering Valve to Rt. Hose Tube 70		—	—	—	—	—	—	—	—	—	—	2	2880 485
	Tee To Rt. Hose Tube w/Anti Skid 71		—	—	—	—	—	—	—	—	—	—	2	2880 485
5-107-36	SEAL, Brake Tube Metering Valve 70		—	—	—	—	—	1	1	1	1	1	1	2880 499
	71		—	—	—	—	—	1	1	1	1	1	1	3466 782
	Plug, Brake Tube Metering Valve W/Anti-Skid 71		—	—	—	—	—	—	—	—	—	—	1	3466 780
5-107-37	SHIELD, Metering Valve 70		—	—	—	1	1	—	—	—	—	—	—	3404 695
5-110-0 POWER BRAKE HOSE CHECK VALVE														
5-110-18	CONNECTOR													
	2 WAY, w/A/Cond. w/o ATC		1	1	1	1	1	1	1	1	1	1	1	1944 092
	2 Way w/A/Cond. 71		1	—	1	—	1	1	—	—	—	—	—	2405 466
	2 Way W/O A/Cond. 71		—	1	—	1	1	1	1	1	1	1	—	3461 304
	1 WAY, w/o A/Cond.		1	1	1	1	1	1	1	1	1	1	—	1944 154
	3 WAY, w/A/Cond.		—	—	—	—	1	1	1	1	1	1	1	1948 838
	3 Way W/A/Cond. W/440 Eng. 71		—	—	—	—	1	1	—	—	—	—	—	3461 311
	3 Way W/O A/Cond. W/383 Eng. 71		—	—	—	—	1	1	—	—	—	—	—	3461 323
	4 WAY, w/ATC		—	—	—	—	—	—	—	—	—	—	1	2460 416
	4 Way W/A/Cond. W/440 Eng. 71		—	—	—	—	1	—	—	—	—	—	—	3461 324
5-111-0 POWER BRAKE VACUUM HOSE														
5-111-17	HOSE, Power Brake to Intake Manifold w/383, 440 Eng.		—	1	—	1	1	1	1	1	1	1	1	2883 083
	HOSE, Flexible Vacuum Hose .34 I.D.		AR	AR	AR	AR	AR	AR	AR	AR	AR	AR	AR	0883 031
5-111-19	CLAMP, Hose 70		2	2	2	2	2	2	2	2	2	2	2	448 797
5-113-0 POWER BRAKE AIR CLEANER														
5-113-17	FILTER, Plunger to Push Rod Boot		—	1	—	1	1	1	1	1	1	1	—	3461 003
	Push Rod Boot 70		—	1	—	—	—	—	—	—	—	—	—	3461 009
	71		—	1	—	1	1	1	1	1	1	1	—	3461 291
	Booster Hub		—	1	—	1	1	1	1	1	1	1	—	3461 004
	Air Cleaner, Bendix 70		—	—	—	2	2	2	2	2	2	2	—	2823 379
	Frt. Hsg. Air Inlet, Midland Ross		1	1	1	1	1	1	1	1	1	1	1	2467 575
	Rr. Cyl. Shell w/426 Eng. 70		—	1	—	1	1	—	—	—	—	—	—	2401 139
5-113-20	HUB, Air Intake		1	1	1	1	1	1	1	1	1	1	1	2467 578
5-113-21	COVER, Air Int. and Filter 70		1	—	1	1	1	1	1	1	1	1	—	2467 577
	Air Intake and Filter 71		1	1	1	1	1	1	1	1	1	1	1	3461 268

CARLINES

J - Challenger
B - BarracudaV - Valiant
L - DartR - Belvedere - Satellite
W - Coronet - ChargerP - Plymouth
D - DodgeC - Chrysler
Y - Imperial

AR Indicates use as required.

Indicates parts not listed in any previous parts book.

Numerals in parentheses () refer to notes.

★ Indicates change or addition.

Printed in U.S.A.
January 1972