

**PARTS INDICATED
 BY NAME ONLY - ORDER
 BY DESCRIPTION**

19a3567A

REAR AXLE DIFFERENTIAL AND CARRIER - 7 1/4" DIA. - VALIANT,
 DART, BELVEDERE, CORONET, CHALLENGER AND BARRACUDA

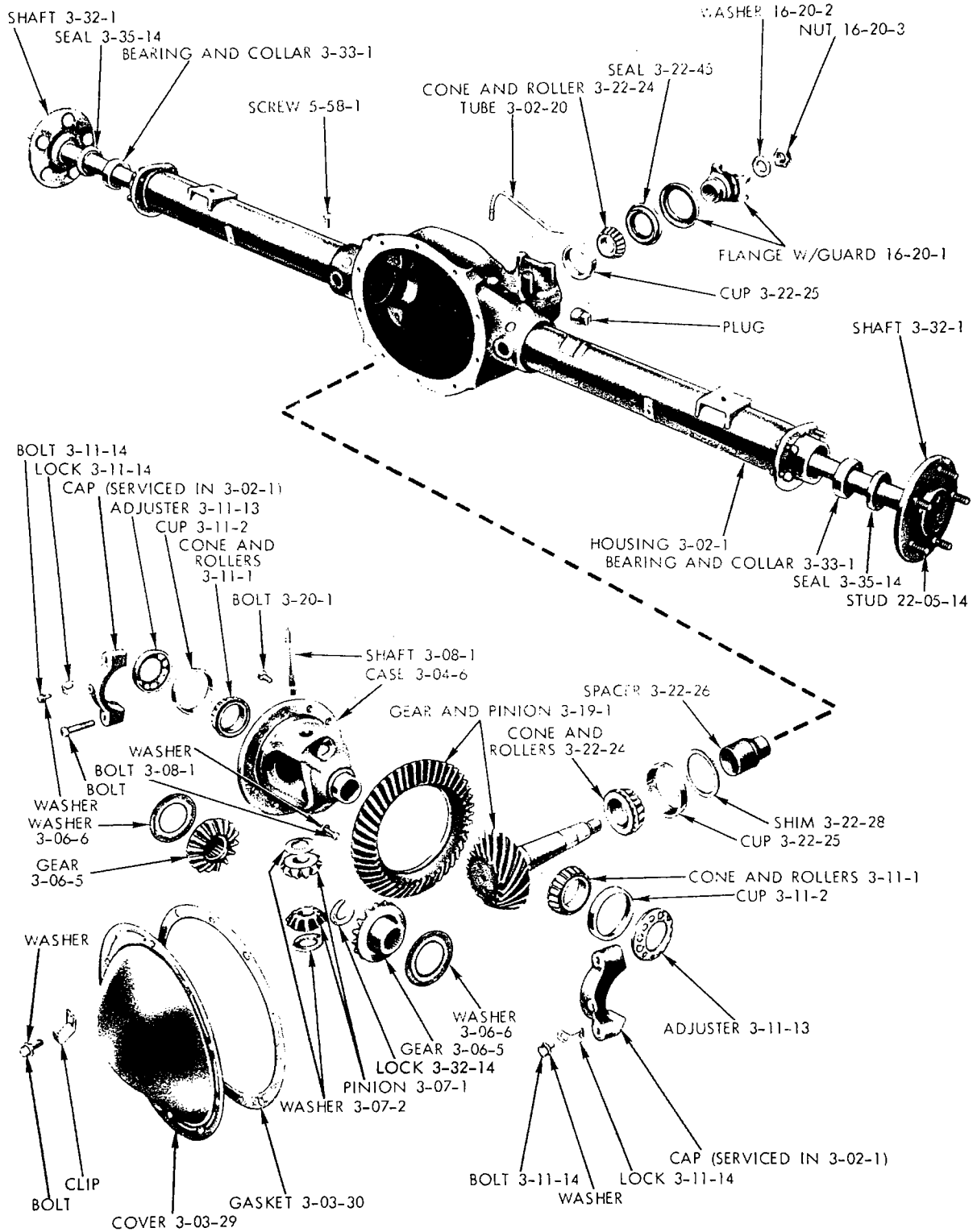

**PARTS INDICATED
BY NAME ONLY - ORDER
BY DESCRIPTION**

19a2718B

REAR AXLE DIFFERENTIAL AND CARRIER - 8 1/4" DIA. GEAR TYPE - BELVEDERE, SATELLITE, CORONET, CHARGER, PLYMOUTH AND DODGE

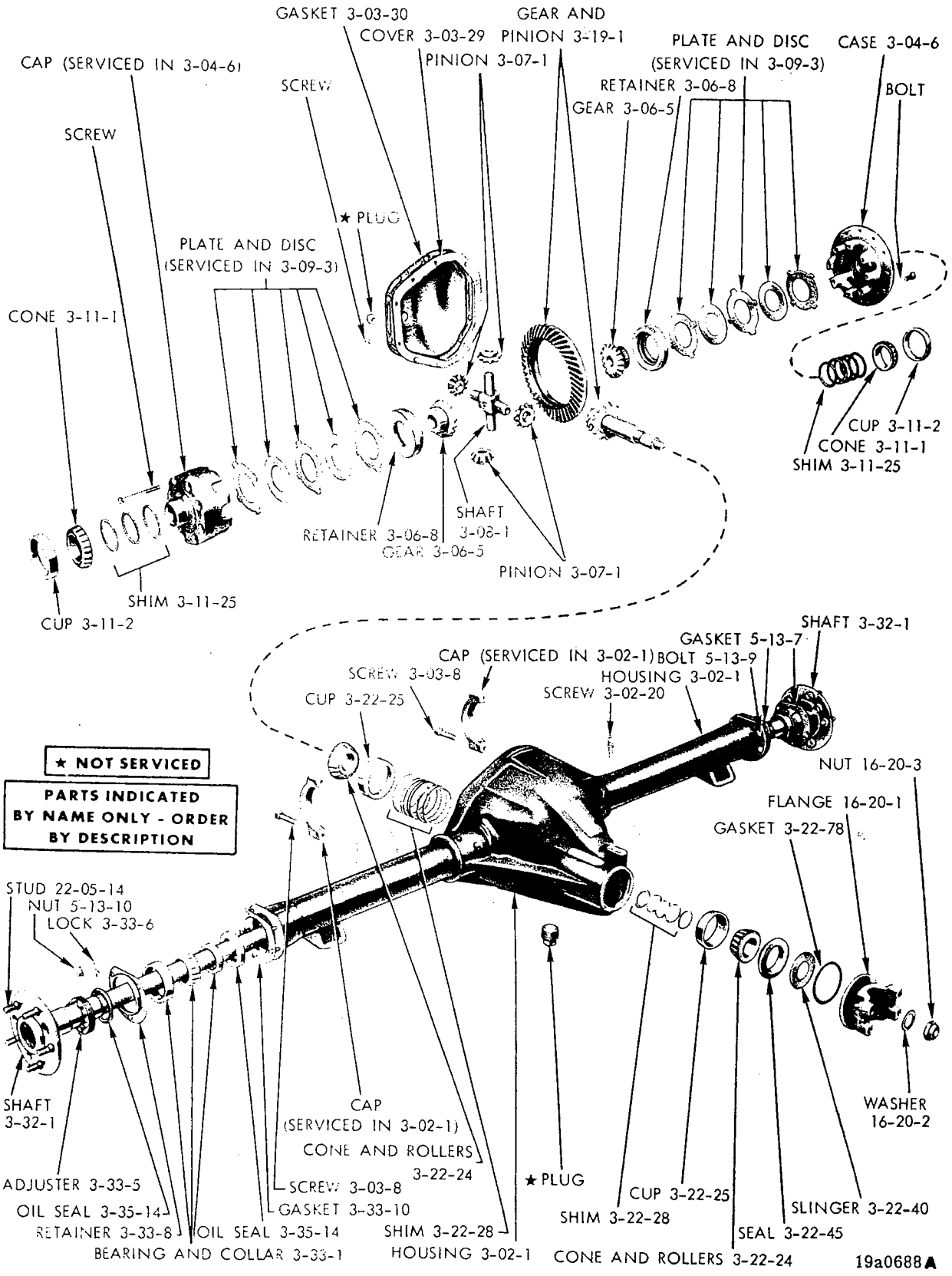

*** NOT SERVICED**
PARTS INDICATED BY NAME ONLY - ORDER BY DESCRIPTION

REAR AXLE DIFFERENTIAL AND CARRIER - WITH 9 3/4" DIA. GEAR - WITH 4 SPEED TRANSMISSION - WITH 426 AND 440 ENGINE - BARRACUDA, CHALLENGER, ROAD RUNNER, GTX, SUPER BEE, CHARGER AND CORONET (1970)

19a0688A

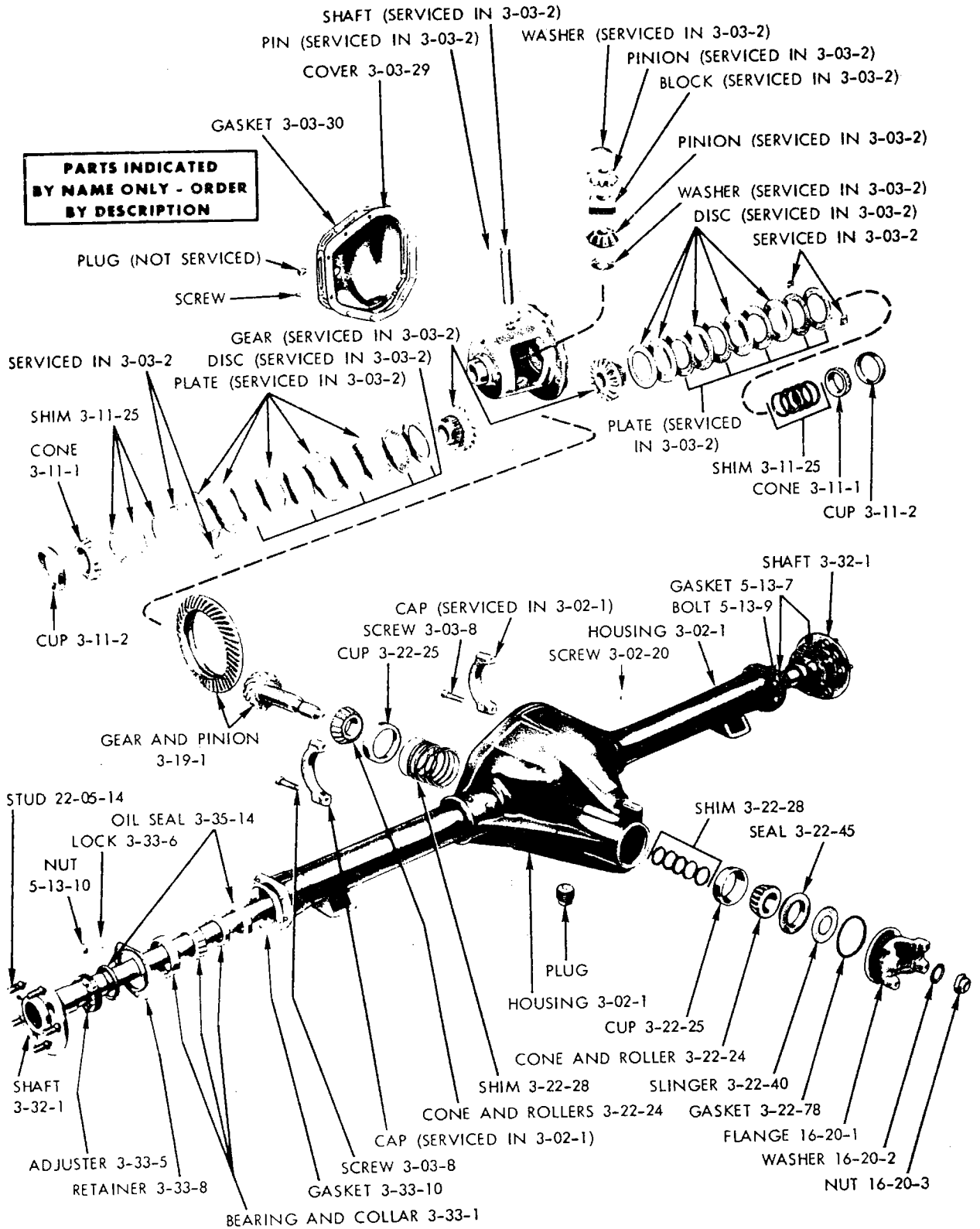

19a3707

REAR AXLE DIFFERENTIAL AND CARRIER - WITH 9 3/4" DIA. GEAR - WITH 4 SPEED MANUAL TRANSMISSION - WITH 426 AND 440 ENGINES - BARRACUDA, CHALLENGER, ROAD RUNNER, GTX AND CHARGER - WITH SURE-GRIP (1971)

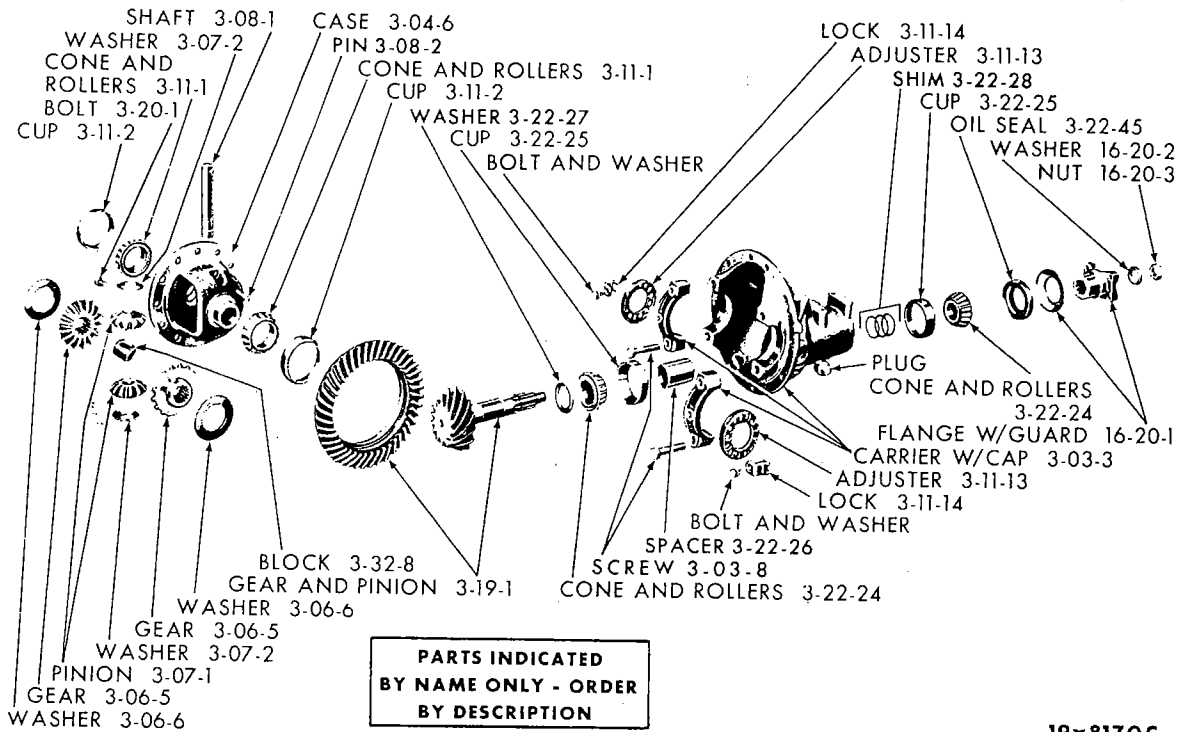

REAR AXLE DIFFERENTIAL AND CARRIER (WITHOUT SURE-GRIP) - 8 3/4" DIA. GEAR TYPE

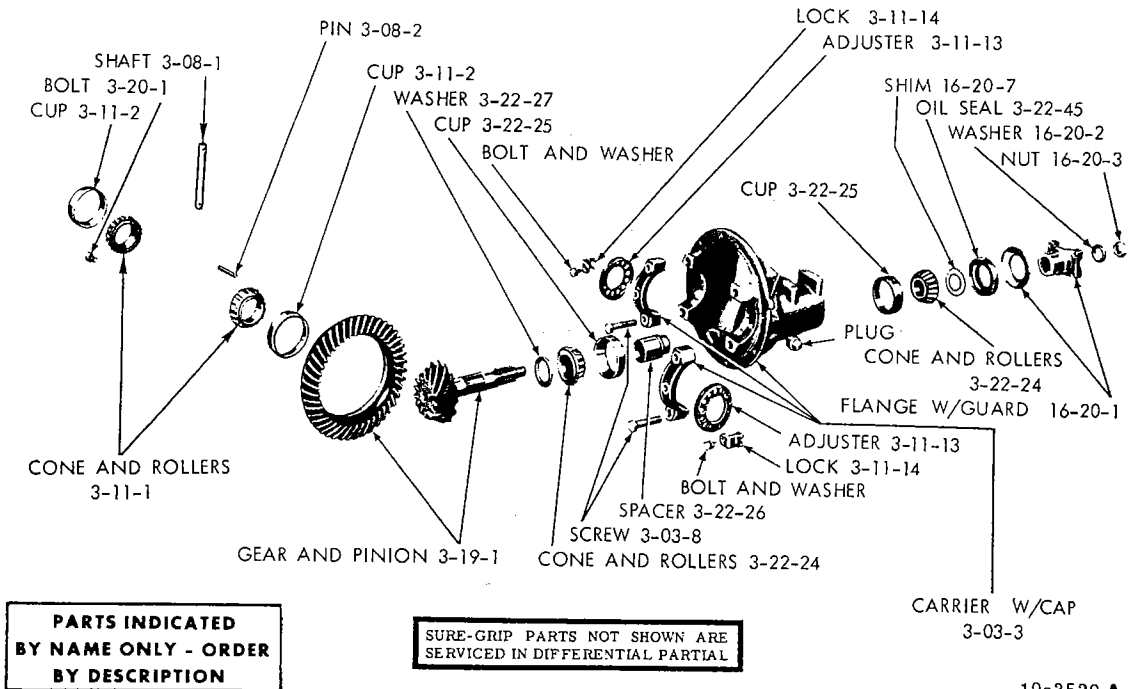

REAR AXLE DIFFERENTIAL AND CARRIER (WITH SURE-GRIP) - 8 3/4" DIA. GEAR TYPE

CODE	PART NAME	ENG. TYPE OR CU.IN.	V	B	L	R	W	P	D	C	C	C	Y	PART NUMBER
			1-2	1-2	1-2	1-2	1-2	1-2	1-2	1	2	3	1	
3-02-0 REAR AXLE HOUSING														
NOTE: The 7 1/4" diameter gear axle has a 1 3/8" diameter stem and is embossed with carrier part number 2070 062 or 2070 051 below the yoke. It has a separate cover and uses (9) nine cover screws.														
NOTE: The 8 3/4" diameter gear axles with a 1 3/8" diameter pinion shaft has Carrier part number 1820657 or 2070741 embossed 2 inches below the yoke. It has a banjo type housing with welded on cover. It has (10) ten nuts that fasten the carrier assembly to the housing.														
NOTE: The 1970 B,J,P,D,C and Y models with 8 3/4" diameter gear axle only used a 1 7/8" diameter pinion shaft. Carrier part number 2881 488 or 2881 489 is embossed 2 inches below the yoke.														
NOTE: The 1970 R and W models with 8 3/4" diameter gear axle used a 1 3/4" and 1 7/8" diameter pinion shaft. Carrier part number 2881 488 or 2881 489 is embossed 2 inches below the yoke.														
NOTE: The 1971 8 3/4" diameter gear axle with 1 7/8" diameter pinion shaft has carrier part number 2881 488 or 2881 489 embossed 2 inches below the yoke.														
NOTE: The 1971 model 8 3/4" diameter gear axles only used 1 3/8" and 1 7/8" diameter stems.														
NOTE: The 8 1/4" diameter gear axle has a 1 5/8" diameter pinion shaft and carrier part number 2852 905 embossed on it. It has a separate cover and uses (10) ten cover screws.														
NOTE: Differential and Carriers have a metal tag bolted on them giving the ratio of the rear axle.														
NOTE: Some 1969 8 1/4" dia. gear axles were used on the 1970 R and W models. See the 1969 book for parts.														
NOTE: Some 1969 8 1/4" dia. gear axles were used on the 1970 R and W models. See the 1969 book for parts.														
3-02-1	HOUSING, 7 1/4" dia. Gear, 53 13/64" lgh.		1	—	1	—	—	—	—	—	—	—	—	3432 647
	w/8 3/4" dia. Gear, One Piece Tube Type, 52 37/64" lgh.		1	—	1	—	—	—	—	—	—	—	—	3432 295
	w/8 3/4" dia. Gear, 56 7/16" lgh.		—	1	—	—	—	—	—	—	—	—	—	2852 882
	w/9 3/4" dia. Gear	8	—	1	—	—	—	—	—	—	—	—	—	3432 212
	w/7 1/4" dia. Gear, 57 7/64" lgh. 70		—	1	—	—	—	—	—	—	—	—	—	3507 234
	w/7 1/4" dia. Gear 71		—	1	—	—	—	—	—	—	—	—	—	3507 463
	w/7 1/4" dia. Gear, Except Sta. Wgn. 54 9/32" lgh.	6	—	—	—	1	1	—	—	—	—	—	—	3507 246
	w/7 1/4" dia., except Sta. Wgn., w/3507 246 Housing and 2 of 2852 948 Outer Seals	6	—	—	—	1	1	—	—	—	—	—	—	# 3579 289
	w/7 1/4" dia. Gear, except Sta. Wgn. 71	6	—	—	—	1	1	—	—	—	—	—	—	3507 500
	w/8 1/4" dia. Gear, w/2.45, 2.71 and 3.21 to 1 Ratio 59 5/32" lgh. 70		—	—	—	1	1	—	—	—	—	—	—	2881 055
	w/8 1/4" dia., w/2.45, 2.71, 2.94 and 3.21 to 1 ratio, used with Small Shaft Bearing, 62" Track 71		—	—	—	1	1	—	—	—	—	—	—	3507 527
	w/8 1/4" dia. Gear, w/2.45, 2.71 and 3.21 to 1 ratio, Used with Large Shaft Bearings 71		—	—	—	1	1	—	—	—	—	—	—	# 3507 168
	w/8 3/4" dia. Gear, One Piece Tube Type, 54 29/32" lgh. 70		—	—	—	1	1	—	—	—	—	—	—	2852 838
	w/8 3/4" dia. Gear Axle, One Piece Tube Type, except Sta. Wgn., 57 47/64" lgh. 71		—	—	—	1	1	—	—	—	—	—	—	3507 502
	w/8 3/4" dia. Gear, Sta. Wgn., 59 1/8" lgh. 71		—	—	—	1	1	—	—	—	—	—	—	3507 501
	w/9 3/4" dia. Gear 70	8	—	—	—	1	1	—	—	—	—	—	—	3432 555
	w/9 3/4" dia. Gear 71	8	—	—	—	1	1	—	—	—	—	—	—	3507 530
	w/8 1/4" dia. Gear, w/2.71 and 3.21 to 1 Ratio, 62" Track 8		—	—	—	—	—	1	—	—	—	—	—	3432 843
	w/8 3/4" dia. Gear, P, C1, Sta. Wgn., D, One Piece Tube Type, 59 1/8" lgh., w/9/16" Center Hole in Seat 71		—	—	—	—	—	1	1	1	—	—	—	3432 298
	w/8 3/4" dia. Gear, P, C1, Sta. Wgn., D, One Piece Tube Type, w/1 5/8" Center Hole In Seat 71		—	—	—	—	—	1	1	1	—	—	—	3507 658
	w/8 3/4" Dia. Gear, Except Sta. Wgn., One Piece Tube Type, 57 3/4"		—	—	—	—	—	—	—	—	—	—	—	

CARLINES J - Challenger B - Barracuda V - Valiant L - Dart R - Belvedere - Satellite W - Coronet - Charger P - Plymouth D - Dodge C - Chrysler Y - Imperial

AR Indicates use as required. # Indicates parts not listed in any previous parts book. Numerals in parentheses () refer to notes. ★ Indicates change or addition. Printed in U.S.A. January 1972

3-03-0 REAR AXLE DIFFERENTIAL AND CARRIER

NOTE: Differential with Carrier and Tubes and Differential, with Carrier are shown below in Chart Form by Ratio. The chart also includes other information such as Gear size and Stem size.

NOTE: The Differential with Carrier and Housing does not include axle shafts.

NOTE: Component parts for Cone and Spring type Carriers are not serviced separately. For replacement refer to Code 3-03-2 Differential, Partial.

NOTE: Cone and Spring type Carriers can be identified by orange paint around the filler plug. Also, by removing the filler plug and looking inside.

3-03-1 DIFFERENTIAL, w/CARRIER AND HOUSING

RATIO	GEAR DIA.	STEM DIA.	WITH OR W/O SURE GRIP	MODEL	REMARKS	SERVICE NO.
2.76 To 1	7 1/4"	1 3/8"	w/o	V, L	See Note 5	3432 440
2.76 to 1	7 1/4"	1 3/8"	w/o	V1, L1	71 See Note 6	= 3507 725
2.76 To 1	7 1/4"	1 3/8"	w/o	B, J	70	3507 223
2.76 to 1	7 1/4"	1 3/8"	w/o	B, J	71 UP TO approx. June 1971, See Note 5	3507 516
2.76 to 1	7 1/4"	1 3/8"	w/o	B, J	71 AFTER approx. June 1971, See Note 6	= 3507 721
2.76 To 1	7 1/4"	1 3/8"	With	V1, L1	See Note 5	3432 448
2.76 to 1	7 1/4"	1 3/8"	with	V1, L1	71 See Note 6	= 3507 726
2.93 To 1	7 1/4"	1 3/8"	w/o	R1, W1	70	3507 221
2.93 to 1	7 1/4"	1 3/8"	w/o	R1, W1	71	3507 519
3.23 to 1	7 1/4"	1 3/8"	w/o	V1, L1	See Note 5	3432 441
3.23 to 1	7 1/4"	1 3/8"	w/o	V1, L1	71 See Note 6	= 3507 727
3.23 To 1	7 1/4"	1 3/8"	w/o	R1, W1	70	3507 222
3.23 to 1	7 1/4"	1 3/8"	w/o	R1, W1	71	3507 520
3.23 To 1	7 1/4"	1 3/8"	w/o	B1, J1	70	3507 224
3.23 to 1	7 1/4"	1 3/8"	w/o	B, J	71	3507 517
3.23 To 1	7 1/4"	1 3/8"	With	B1, J1	70	3507 225
3.55 To 1	7 1/4"	1 3/8"	w/o	V1, L1	See Note 5	3432 443
3.55 to 1	7 1/4"	1 3/8"	w/o	V1, L1	71 See Note 6	= 3507 728
3.91 To 1	7 1/4"	1 3/8"	w/o	V1, L1	70	3432 442
2.45 To 1	8 1/4"	1 5/8"	w/o	R2, W2	70	3432 613
2.45 to 1	8 1/4"	1 5/8"	w/o	R2, W2	71 See Note 3	3507 521
2.45 to 1	8 1/4"	1 5/8"	w/o	R2, W2	71 See Note 4	= 3507 169
2.71 To 1	8 1/4"	1 5/8"	w/o	R2, W2	70	3432 614
2.71 to 1	8 1/4"	1 5/8"	w/o	R2, W2	71 See Note 3	3507 522
2.71 to 1	8 1/4"	1 5/8"	w/o	R2, W2	71 See Note 4	= 3507 170
2.71 To 1	8 1/4"	1 5/8"	w/o	P2	71	3432 842
2.71 to 1	8 1/4"	1 5/8"	w/o	D2	71	3507 568
3.21 to 1	8 1/4"	1 5/8"	w/o	R, W	71 See Note 3	3507 524
3.21 to 1	8 1/4"	1 5/8"	w/o	R2, W2	71 See Note 4	= 3507 171
3.21 to 1	8 1/4"	1 5/8"	w/o	D1, P	71	3507 390
3.54 To 1	9 3/4"	---	With	B2, J2	70	3432 213
3.54 To 1	9 3/4"	---	With	B2, J2	71	3507 550
3.54 To 1	9 3/4"	---	With	R2, W2	70	3432 556
3.54 To 1	9 3/4"	---	With	R2, W2	71	3507 552
4.10 To 1	9 3/4"	---	With	B2, J2	70	3432 214
4.10 To 1	9 3/4"	---	With	R2, W2	70	3432 557
4.10 To 1	9 3/4"	---	With	R, W	71	3507 553
DIFFERENTIAL w/CARRIER, w/o HOUSING						
2.76 To 1	8 3/4"	---	w/o	B2, J2, R, W, P2, D2, C1	70 See Note 1	2881 375
2.76 To 1	8 3/4"	---	With	R, W, P2, D2, C	70 See Note 1	2881 379
2.94 To 1	8 3/4"	---	With	R, W, Y	70 See Note 1	2881 494
2.94 To 1	8 3/4"	---	w/o	R, W, P, D, Y	70 See Note 1	2881 492
2.94 to 1	8 3/4"	1 3/8"	w/o	R, W, P, D	71 See Note 1	2881 372
3.23 To 1	8 3/4"	With	V, L	B2, J2, R, W, P, D, C	70 See Note 1	2881 382
3.23 To 1	8 3/4"	---	w/o	V, L, B2, J2, R, W, P, D, C	70 See Note 1	2881 381
3.23 to 1	8 3/4"	1 3/8"	w/o	V, L, B2, J2, R,		

CARLINES J - Challenger V - Valiant R - Belvedere - Satellite P - Plymouth C - Chrysler
 B - Barracuda L - Dart W - Coronet - Charger D - Dodge Y - Imperial

3-03-0 REAR AXLE DIFFERENTIAL AND CARRIER Cont'd.

3-03-1 DIFFERENTIAL, w/CARRIER Cont'd.

RATIO	GEAR DIA.	STEM DIA.	WITH OR W/O SURE GRIP	MODEL	REMARKS	SERVICE NO.
3.55 To 1	8 3/4"	1 3/8"	w/o	W, P2, D2	71 See Note 1	2881 381
3.55 To 1	8 3/4"	1 7/8"	With	R, W, P, D	70 See Note 1	2881 304
3.91 To 1	8 3/4"	1 3/8"	w/o	V2, L2, B2, J2, R2, W2	70 See Note 1	2931 860
3.91 To 1	8 3/4"	1 7/8"	With	R1, W1	70 See Note 1	2931 811
2.76 To 1	8 3/4"	1 7/8"	w/o	V, L, B2, J2, R, W, P2, D2, C	70 See Note 1	3432 219
2.76 To 1	8 3/4"	1 7/8"	With	P2, D2, C	See Note 2	3507 428
2.76 To 1	8 3/4"	1 7/8"	With	P2, D, C	70 See Note 2	3507 446
2.94 to 1	8 3/4"	1 7/8"	With	R, W, Y	71 See Note 2	3507 446
2.94 to 1	8 3/4"	1 7/8"	w/o	R, W, P, D, Y	See Note 2	3507 441
2.94 to 1	8 3/4"	1 7/8"	w/o	R, W, P, D, Y	70 See Note 2	3507 423
3.23 To 1	8 3/4"	1 7/8"	With	V, L, B2, J2, R, W, P, C	71 See Note 2	3507 423
3.23 to 1	8 3/4"	1 7/8"	With	V, L, B, J, R, W, Y	70 See Note 2	3507 448
3.23 To 1	8 3/4"	1 7/8"	w/o	V, L, B2, J2, R, W, P, D, C	71 See Note 2	3507 448
3.23 To 1	8 3/4"	1 7/8"	w/o	V, L, B, J, R, W, P, D2, C, Y	70 See Note 2	3507 429
3.55 To 1	8 3/4"	1 3/8"	w/o	R, W, P, D	71 See Note 2	3507 429
3.55 To 1	8 3/4"	1 7/8"	With	V2, L2, B2, J2, R2, W2	See Note 2	3507 404
3.91 To 1	8 3/4"	1 3/8"	w/o	R1, W1	70 See Note 2	3507 449
3.91 To 1	8 3/4"	1 7/8"	With	V2, L2, B2, J2, R2, W2	70 See Note 2	3507 405
3.91 To 1	8 3/4"	1 7/8"	With	V2, L2, B, J, R2, W2	70 See Note 2	3507 450
3.91 To 1	8 3/4"	1 7/8"	With	V2, L2, B, J, R2, W2	71 See Note 2	3507 450

- NOTE: 1 Used with 10 Tooth Pinion Spline with 1 1/8" Diameter Nut
- NOTE: 2 Used with 29 Tooth Pinion Spline with 1 1/4" Diameter Nut
- NOTE: 3 Used with Small Shaft Bearings
- NOTE: 4 Used with Large Shaft Bearings

NOTES

CARLINES J - Challenger V - Valiant R - Belvedere - Satellite P - Plymouth C - Chrysler
 B - Barracuda L - Dart W - Coronet - Charger D - Dodge Y - Imperial

AR Indicates use as required.
 # Indicates parts not listed in any previous parts book.

Numerals in parentheses () refer to notes.
 ★ Indicates change or addition.

Printed in U.S.A.
 January 1972

CODE	PART NAME	ENG. TYPE OR CU.IN.	V	B	L	R	W	P	D	C	C	C	Y	PART NUMBER
3-03-0 REAR AXLE DIFFERENTIAL AND CARRIER Cont'd.														
NOTE: 5 without Collapsible Spacer														
NOTE: 6 with Collapsible Spacer														
3-03-2	DIFFERENTIAL, Partial, w/7 1/4" dia. Gear, w/Sure-Grip, w/o Gear and Pinion Set, w/1 5/8" O.D.													
	Hubs, w/Sure-Grip	70	6	1	1	1	—	—	—	—	—	—	—	2881 342
		71	6	1	—	1	—	—	—	—	—	—	—	2881 342
	w/1 25/32" O.D. Hubs, w/Sure-Grip	70	6	1	1	1	—	—	—	—	—	—	—	3432 437
	w/8 3/4" dia. Gear, w/Sure Grip, w/o Gear and Pinion set B2, J2, Cone and Spring Type Clutch	70		1	1	1	1	1	1	1	1	1	—	2881 343
	B2, J2	71		1	1	1	1	1	1	1	1	1	1	2881 343
	w/9 3/4" dia. Gear, w/Sure-Grip, w/o Gear and Pinion Set	71		—	1	—	1	1	—	—	—	—	—	3507 531
3-03-3	CARRIER, w/CAPS, w/8 3/4" dia. Gear, 1 3/8" dia. Stem	70		1	—	1	1	1	1	—	—	—	—	1820 698
	w/8 3/4" dia. Gear, 1 3/8" dia. Stem	71		1	1	1	1	1	1	—	—	—	—	1820 698
	w/8 3/4" dia. Gear, 1 3/8" and 1 7/8" dia. Stem, B2, J2	70		—	1	—	—	—	—	—	—	—	—	2881 098
	w/8 3/4" dia. Gear, 1 3/4" and 1 7/8" dia. Stem,	70		—	—	—	1	1	1	1	1	1	1	2881 098
	w/8 3/4" dia. Gear, 1 7/8" dia. Stem	71		—	1	1	1	1	1	1	1	1	1	2881 098
	w/8 3/4" dia. Gear, 1 3/4" dia. Stem, Canada	70		—	—	—	—	—	1	1	—	—	—	1634 984
3-03-8	SCREW, Differential Brg., Cap, w/7 1/4" dia. Gear	70		4	4	4	4	4	—	—	—	—	—	9419 882
	Phosphate Coated, 3/8"-16x2	71		4	—	4	—	—	—	—	—	—	—	9419 882
	3/8" - 16 x 2"	71		4	—	4	—	—	—	—	—	—	—	= 3507 572
	w/8 3/4" dia. Gear, B2, J2			4	4	4	4	4	4	4	4	4	4	314 948
	B2, J2, 1/2 - 13 x 2 39/64" lgh.			4	4	4	4	4	4	4	4	4	4	3432 695
	w/9 3/4" dia. Gear	70		4	—	4	4	—	—	—	—	—	—	181 170
		71		4	—	4	4	—	—	—	—	—	—	181 170
3-03-25	GASKET, Carrier, w/8 3/4" dia. Gear, B2, J2			1	1	1	1	1	1	1	1	1	1	1673 367
3-03-26	BOLT, Hsg. to Carrier, w/8 3/4" dia. Gear, B2 J2			10	10	10	10	10	10	10	10	10	10	1115 927
3-03-29	COVER, Carrier, w/7 1/4" dia. Gear, R1, W1, except Sta. Wgn.			1	1	1	1	1	—	—	—	—	—	2070 119
	w/8 1/4" dia. Gear, 1 5/8" dia. Stem, R, W, w/2.71, 2.45 and 3.21 to 1 ratio, P2, w/2.71 and 3.21 to 1 ratio	70		—	—	—	1	1	1	—	—	—	—	2852 921
	w/8 1/4" dia. Gear, 1 5/8" dia. Stem, R, W, w/2.45, 2.71, 2.94 and 3.21 to 1 ratio, P, D, w/2.71 and 3.21 to 1 ratio	71		—	—	—	1	1	1	1	—	—	—	2852 921
	COVER, w/CLIPS, w/9 3/4" dia. Gear, w/426 and 440 Engines		8	—	1	—	1	1	—	—	—	—	—	3432 299
3-03-30	GASKET, Carrier Cover, w/7 1/4" dia. Gear, R1, W1, except Sta. Wgn.			1	1	1	1	1	—	—	—	—	—	2070 120
	w/9 3/4" dia. Gear, w/426 and 440 Engines		8	—	1	—	1	1	—	—	—	—	—	2515 343
	w/8 1/4" dia. Gear, 1 5/8" dia. Stem, R, W, w/2.45, 2.71 and 3.21 to 1 ratio, P2, w/2.71 and 3.21 to 1 ratio	70		—	—	—	1	1	1	—	—	—	—	2852 922

CARLINES	J - Challenger B - Barracuda	V - Valiant L - Dart	R - Belvedere - Satellite W - Coronet - Charger	P - Plymouth D - Dodge	C - Chrysler Y - Imperial
----------	---------------------------------	-------------------------	--	---------------------------	------------------------------

AR Indicates use as required. Numerals in parentheses () refer to notes. Printed in U.S.A. January 1972
 # Indicates parts not listed in any previous parts book. ★ Indicates change or addition.

CODE	PART NAME	ENG. TYPE OR CU.IN.	V	B J	L	R	W	P	D	C	C	C	Y	PART NUMBER
3-03-0 REAR AXLE DIFFERENTIAL AND CARRIER Cont'd.														
3-03-30	GASKET Cont'd. w/8 1/4" dia. Gear, R, W, w/2.45, 2.71, 2.94 and 3.21 to 1 ratio, P, D, w/2.71 and 3.21 to 1 ratio	71	—	—	—	1	1	1	1	—	—	—	—	2852 922
3-03-31	NUT, Hsg. to Carrier Bolt, w/8 3/4" dia. Gear	70 71	10	10	10	10	10	10	10	10	10	10	10	6027 412 6028 915
3-03-35	PLUG, Carrier Cover Filler, w/7 1/4" Dia. Gear, R1, W1, except Wgn. w/8 1/4" dia. Gear	70	8	1	1	1	1	—	—	—	—	—	—	1392 371 1392 371
3-03-36	GASKET, Carrier Cover Filler Plug, w/7 1/4" dia. Gear, R1, W1, except Sta. Wgn. w/8 1/4" dia. Gear	70	8	1	1	1	1	—	—	—	—	—	—	2070 122 2070 122
3-4-0 DIFFERENTIAL CASE														
3-04-6	CASE, w/o Sure-Grip, w/7 1/4" dia. Gear, R1, W1, except Sta. Wgn. w/o Sure-Grip, w/7 1/4" dia. Gear, R1, W1, except Sta. Wgn., UP TO approx. Aug. 1971 AFTER approx. Aug. 1971 w/o Sure-Grip, w/8 3/4" dia. Gear, B2, J2 w/Sure-Grip, w/9 3/4" dia. Gear, w/426 and 440 Engines w/o Sure-Grip, w/8 1/4" dia. Gear, 1 5/8" dia. Stem, R, W, P, w/2.71 and 3.21 to 1 ratio, w/225 and 318 Eng. w/o Sure-Grip, w/8 1/4" dia. Gear, R, W, w/2.71, 2.94 and 3.21 to 1 ratio, w/ 225 and 318 Eng., D, w/2.71 and 3.21 to 1 ratio, w/225, 318 and 360 Eng. w/o Sure-Grip, w/8 1/4" dia. Gear, 1 5/8" dia. Stem, w/2.45 to 1 ratio, w/383 Eng.	70 71 71 70 70 71 8	1	1	1	1	1	—	—	—	—	—	—	2404 193 2404 193 = 3507 166 3004 986 1929 751 2881 423 2881 423 3432 435
3-04-10	SCREW, Case, w/9 3/4" dia. Gear, w/Sure- Grip, w/426, 440 Eng.	70	8	—	8	—	8	8	—	—	—	—	—	1929 760
3-06-0 DIFFERENTIAL SIDE GEAR														
3-06-5	GEAR, w/o Sure-Grip, w/7 1/4" dia. Gear, R1, W1, except Sta. Wgn. w/o Sure-Grip, w/8 3/4" dia. Gear, B2, J2, O.D. of Long Neck or Hub 1.686, Select Fit w/o Sure-Grip, w/8 3/4" dia. Gear, B2, J2, O.D. of Long Neck or Hub 1.688, Select Fit w/o Sure-Grip, w/8 3/4" dia. Gear, O.D. of Long Neck or Hub 1.686 w/o Sure-Grip, w/8 3/4" dia. Gear, O.D. of Long Neck or Hub 1.688 w/o Sure-Grip, w/8 1/4" dia. Gear, 1 5/8" dia. Stem, R, W, w/2.45, 2.71 and 3.21 to ratio, P, w/2.71 and	70 70 70 71 71	2	2	2	2	2	—	—	—	—	—	—	2404 194 2404 202 2404 203 2404 202 2404 203

CARLINES

J - Challenger
B - BarracudaV - Valiant
L - DartR - Belvedere - Satellite
W - Coronet - ChargerP - Plymouth
D - DodgeC - Chrysler
Y - Imperial

AR Indicates use as required.

Indicates parts not listed in any previous parts book.

Numerals in parentheses () refer to notes.

★ Indicates change or addition.

Printed in U.S.A.
January 1972

CODE	PART NAME	ENG. TYPE OR CU.IN.	V	B	L	R	W	P	D	C	C	C	Y	PART NUMBER
			1-2	1-2	1-2	1-2	1-2	1-2	1-2	1	2	3	1	
3-06-0 DIFFERENTIAL SIDE GEAR Cont'd.														
3-06-5	GEAR Cont'd.													
	3.21 to 1 ratio	70	—	—	—	2	2	2	—	—	—	—	—	2852 908
	w/o Sure-Grip, w/8 1/4" dia. Gear, 1 5/8" dia. Stem, R, W, w/2.45, 2.71, 2.94 and 3.21 to 1 ratio, P, D, w/2.71 and 3.21 to 1 ratio	71	—	—	—	2	2	2	2	—	—	—	—	2852 908
	w/Sure-Grip, w/9 3/4" dia. Gear, w/426 and 440 Engines, Early Type, 23T	8	—	2	—	2	2	—	—	—	—	—	—	2852 514
	w/Sure-Grip, 9 3/4" dia. Gear, w/426 and 440 Engines, Late Type, 35T	70	8	—	2	—	2	2	—	—	—	—	—	2955 837
3-06-6	WASHER, Thrust, w/7 1/4" dia. Gear, R1, W1, except Sta. Wgn., w/o Sure-Grip													
	w/8 3/4" dia. Gear, B2, J2, w/o Sure-Grip		2	2	2	2	2	—	—	—	—	—	—	2404 196
	w/8 1/4" dia. Gear, 1 5/8" dia. Stem, R, W, w/2.45, 2.71 and 3.21 to 1 ratio, P, w/2.71 and 3.21 to 1 ratio, w/o Sure-Grip	70	—	—	—	2	2	2	—	—	—	—	—	2852 911
	w/8 1/4" dia. Gear, 1 5/8" dia. Stem, R, W, w/2.45, 2.71, 2.94 and 3.21 to 1 ratio, P, D, w/2.71 and 3.21 to 1 ratio	71	—	—	—	2	2	2	2	—	—	—	—	2852 911
3-06-8	RETAINER, w/Sure-Grip, w/9 3/4" dia. Gear, w/426 and 440 Engines	70	8	—	2	—	2	2	—	—	—	—	—	2852 513
3-07-0 DIFFERENTIAL PINION														
3-07-1	PINION, w/o Sure-Grip, w/7 1/4" dia. Gear, R1, W1, except Sta. Wgn.													
	w/o Sure-Grip, w/8 3/4" dia. Gear, B2, J2		2	2	2	2	2	—	—	—	—	—	—	2404 195
	w/Sure-Grip, w/9 3/4" dia. Gear, w/426 and 440 Engines	70	8	—	2	—	2	2	—	—	—	—	—	1929 756
	w/o Sure-Grip, w/8 1/4" dia. Gear, 1 5/8" dia. Stem, R, W, w/2.45, 2.71 and 3.21 to 1 ratio, P, w/2.71 and 3.21 to 1 ratio	70	—	—	—	2	2	2	—	—	—	—	—	2852 909
	w/o Sure-Grip, w/8 1/4" dia. Gear, 1 5/8" dia. Stem, R, W, w/2.45, 2.71, 2.94 and 3.21 to 1 ratio, P, D, w/2.71 and 3.21 to 1 ratio	71	—	—	—	2	2	2	2	—	—	—	—	2852 909
3-07-2	WASHER, w/o Sure-Grip, w/7 1/4" dia. Gear, R1, W1, except Sta. Wgn													
	w/o Sure-Grip, w/8 3/4" dia. Gear, B2, J2		2	2	2	2	2	—	—	—	—	—	—	2404 197
	w/o Sure-Grip, w/8 1/4" dia. Gear, 1 5/8" dia. Stem, R, W, w/2.45, 2.71 and 3.21 to 1 ratio, P, w/2.71 and 3.21 to 1 ratio	70	—	—	—	2	2	2	—	—	—	—	—	2852 912
	w/o Sure-Grip, w/8 1/4" dia. Gear, 1 5/8" dia. Stem, R, W, w/2.45, 2.71, 2.94 and 3.21 to 1 ratio, P, D, w/2.71 and 3.21 to 1 ratio	71	—	—	—	2	2	2	2	—	—	—	—	2852 912
3-08-0 DIFFERENTIAL PINION SHAFT														
3-08-1	SHAFT, w/o Sure-Grip, w/7 1/4" dia. Gear, R1, W1, except Sta. Wgn.		1	1	1	1	1	—	—	—	—	—	—	2404 198

CARLINES	J - Challenger B - Barracuda	V - Valiant L - Dart	R - Belvedere - Satellite W - Coronet - Charger	P - Plymouth D - Dodge	C - Chrysler Y - Imperial
----------	---------------------------------	-------------------------	--	---------------------------	------------------------------

AR Indicates use as required. Numerals in parentheses () refer to notes. Printed in U.S.A. January 1972
 # Indicates parts not listed in any previous parts book. ★ Indicates change or addition.

CODE	PART NAME	ENG. TYPE OR CU.IN.	V	B J	L	R	W	P	D	C	C	C	Y	PART NUMBER	
															1-2
3-08-0 DIFFERENTIAL PINION SHAFT Cont'd.															
3-08-1	SHAFT Cont'd.														
	w/o Sure-Grip, w/8 3/4" dia. Gear, B2, J2	70			1	1	1	1	1	AR	1	1	1	1	1633 928
	w/and w/o Sure-Grip, w/8 3/4" dia. Gear, w/1 3/8" dia. Stem, B2, J2	71			1	1	1	1	1	1	1	1	1	1633 928	
	w/Sure-Grip, 9 3/4" Dia. Gear, w/426 and 440 Engines	70	8		—	2	—	2	2	—	—	—	—	2852 516	
	w/Sure-Grip, w/9 3/4" dia. Gear, w/426 and 440 Eng.	71	8		—	1	—	1	1	—	—	—	—	1922 276	
	w/o Sure-Grip, w/8 1/4" dia. Gear, 1 5/8" dia. Stem, R, W, w/2.45, 2.71 and 3.21 to 1 ratio, P, w/2.71 and 3.21 to 1 ratio	70			—	—	—	1	1	1	—	—	—	2852 913	
	w/o Sure-Grip, w/8 1/4" dia. Gear, 1 5/8" dia. Stem, R, W, w/2.45, 2.71, 2.94 and 3.21 to 1 ratio, P, D, w/2.71 and 3.21 to 1 ratio	71			—	—	—	1	1	1	1	—	—	2852 913	
	SCREW, Shaft Lock		8		—	—	—	1	1	1	1	—	—	6028 045	
	WASHER		8		—	—	—	1	1	1	1	—	—	120 214	
3-08-2	PIN, Lock, w/7 1/4" dia. Gear, w/o Sure- Grip, R1, W1, except Sta. Wgn.	70			1	1	1	1	1	—	—	—	—	152 229	
	w/8 3/4" dia. Gear, w/o Sure-Grip, B2, J2	70			1	1	1	1	1	1	1	1	1	455 313	
	w/8 3/4" dia. Gear, w/and w/o Sure-Grip, w/1 3/8" dia. Stem, B2, J2	71			1	1	1	1	1	1	1	1	1	455 313	

3-09-0 DIFFERENTIAL CLUTCH PARTS

3-09-1	DISC, Differential Clutch, w/Sure- Grip, w/9 3/4" dia. Gear w/426 and 440 Eng., Flat Type	70	8		—	2	—	2	2	—	—	—	—	1929 758
	Dished Type	70	8		—	2	—	2	2	—	—	—	—	2238 893
3-09-2	PLATE, Differential Clutch, w/Sure- Grip, w/9 3/4" dia. Gear, w/426 and 440 Eng., Flat Type	70	8		—	4	—	4	4	—	—	—	—	1929 759
	Dished Type	70	8		—	2	—	2	2	—	—	—	—	2228 429
3-09-3	REPAIR KIT, Differential, w/Sure-Grip w/9 3/4" dia. Gear, w/426 and 440 Eng.	70	8		—	1	—	1	1	—	—	—	—	2852 523

3-11-0 DIFFERENTIAL BEARINGS

3-11-1	CONE, w/ROLLERS, w/7 1/4" dia. Gear, R1, W1, except Sta. Wgn.				2	2	2	2	2	—	—	—	—	1937 771
	w/8 3/4" dia. Gear, B2, J2, 2" I.D.				2	2	2	2	2	2	2	2	2	2852 729
	w/8 1/4" dia. Gear, 1 5/8" dia. Stem, R,W, w/2.45, 2.71 and 3.71 to 1 ratio, P, w/2.71 and 3.21 to 1 ratio, 1 25/32" I.D.	70			—	—	—	2	2	2	—	—	—	2881 194
	w/8 1/4" dia. Gear, 1 5/8" dia. Stem, R, W, w/2.45, 2.71, 2.94 and 3.21 ratio, P, D, w/2.71 and 3.21 to 1 Ratio, 1 25/32" I.D.	71			—	—	—	2	2	2	2	—	—	2881 194
	w/9 3/4" dia. Gear, w/426, 440 Eng.	70	8		—	2	—	2	2	—	—	—	—	1799 296

CARLINES

J - Challenger
B - BarracudaV - Valiant
L - DartR - Belvedere - Satellite
W - Coronet - ChargerP - Plymouth
D - DodgeC - Chrysler
Y - Imperial

AR Indicates use as required.

Indicates parts not listed in any previous parts book.

Numerals in parentheses () refer to notes.

★ Indicates change or addition.

Printed in U.S.A.
January 1972

CODE	PART NAME	ENG. TYPE OR CU.IN.	V	B	L	R	W	P	D	C	C	C	Y	PART NUMBER
			1-2	1-2	1-2	1-2	1-2	1-2	1-2	1	2	3	1	
3-11-0 DIFFERENTIAL BEARINGS Cont'd.														
3-11-1	CONE w/ROLLERS Cont'd. w/9 3/4" dia. Gear, w/426 and 440 Eng. 71	8	—	2	—	2	2	—	—	—	—	—	—	1799 296
3-11-2	CUP, w/7 1/4" dia. Gear, R1, W1, except Sta. Wgn., 2 57/64" O.D. w/8 3/4" dia. Gear, B2 J2, 3 17/64" O.D. w/9 3/4" dia. Gear, w/426 and 440 Eng. 70	8	—	2	—	2	2	—	—	—	—	—	—	1799 295
	w/9 3/4" dia. Gear, w/426 and 440 Eng., w/4-Speed Trans. 71	8	—	2	—	2	2	—	—	—	—	—	—	1799 295
	w/8 1/4" dia. Gear, 1 5/8" dia. Stem, R, W, w/2.45, 2.71 and 3.21 to 1 ratio, P, w/2.71 and 3.21 to 1 ratio, 2 57/64" O.D. 70	—	—	—	2	2	2	—	—	—	—	—	—	2881 193
	w/8 1/4" dia. Gear, 1 5/8" dia. Stem, R, W, w/2.45, 2.71, 2.94 and 3.21 to 1 ratio, P, D, w/2.71 and 3.21 to 1 ratio, 2 57/64" O.D. 71	—	—	—	2	2	2	2	—	—	—	—	—	2881 193
3-11-3	SPACER, Adj., w/7 1/4" dia. Gear, R1, W1, except Sta. Wgn. .2500" thk.	2	2	2	2	2	—	—	—	—	—	—	—	2070 848
	.2520" thk.	2	2	2	2	2	—	—	—	—	—	—	—	2070 849
	.2540" thk.	2	2	2	2	2	—	—	—	—	—	—	—	2070 082
	.2560" thk.	2	2	2	2	2	—	—	—	—	—	—	—	2070 441
	.2580" thk.	2	2	2	2	2	—	—	—	—	—	—	—	2070 442
	.2600" thk.	2	2	2	2	2	—	—	—	—	—	—	—	2070 084
	.2620" thk.	2	2	2	2	2	—	—	—	—	—	—	—	2070 443
	.2640" thk.	2	2	2	2	2	—	—	—	—	—	—	—	2070 444
	.2660" thk.	2	2	2	2	2	—	—	—	—	—	—	—	2070 086
	.2680" thk.	2	2	2	2	2	—	—	—	—	—	—	—	2070 445
	.2700" thk.	2	2	2	2	2	—	—	—	—	—	—	—	2070 446
	.2720" thk.	2	2	2	2	2	—	—	—	—	—	—	—	2070 088
	.2740" thk.	2	2	2	2	2	—	—	—	—	—	—	—	2070 447
	.2760" thk.	2	2	2	2	2	—	—	—	—	—	—	—	2070 448
	.2780" thk.	2	2	2	2	2	—	—	—	—	—	—	—	2070 090
	.2800" thk.	2	2	2	2	2	—	—	—	—	—	—	—	2070 449
	.2820" thk.	2	2	2	2	2	—	—	—	—	—	—	—	2070 450
	.2840" thk.	2	2	2	2	2	—	—	—	—	—	—	—	2070 092
	.2860" thk.	2	2	2	2	2	—	—	—	—	—	—	—	2070 696
	.2880" thk.	2	2	2	2	2	—	—	—	—	—	—	—	2070 697
	.2900" thk.	2	2	2	2	2	—	—	—	—	—	—	—	2070 698
	.2920" thk.	2	2	2	2	2	—	—	—	—	—	—	—	2070 850
	.2940" thk.	2	2	2	2	2	—	—	—	—	—	—	—	2070 851
3-11-13	ADJUSTER, w/8 3/4" dia. Gear, B2, J2 w/8 1/4" dia. Gear, 1 5/8" dia. Stem, R, W, w/2.45, 2.71 and 3.21 to 1 ratio, P, w/2.71 and 3.21 to 1 ratio 70	—	—	—	2	2	2	—	—	—	—	—	—	2852 916
	w/8 1/4" dia. Gear, 1 5/8" dia. Stem, R, W, w/2.45, 2.71, 2.94 and 3.21 to 1 ratio, P, D, w/2.71 and 3.21 to 1 ratio 71	—	—	—	2	2	2	2	—	—	—	—	—	2852 916

CARLINES J - Challenger B - Barracuda V - Valiant L - Dart R - Belvedere - Satellite W - Coronet - Charger P - Plymouth D - Dodge C - Chrysler Y - Imperial

AR Indicates use as required.

Indicates parts not listed in any previous parts book.

Numerals in parentheses () refer to notes.

★ Indicates change or addition.

Printed in U.S.A. January 1972

CODE	PART NAME	ENG. TYPE OR CU.IN.	V	B	L	R	W	P	D	C	C	C	Y	PART NUMBER
			1-2	1-2	1-2	1-2	1-2	1-2	1-2	1	2	3	1	
3-11-0 DIFFERENTIAL BEARINGS Cont'd.														
3-11-14	LOCK, Adj., w/8 3/4" dia. Gear, B2, J2 w/8 1/4" dia. Gear, 1 5/8" dia. Stem, R, W, w/2.45, 2.71 and 3.21 to 1 Ratio, P, w/2.71 and 3.21 to 1 Ratio	70	2	2	2	2	2	2	2	2	2	2	2	308 247
	w/8 1/4" dia. Gear, 1 5/8" dia. Stem, R, W, w/2.45, 2.71, 2.94 and 3.21 to 1 ratio, P, D, w/2.71 and 3.21 to 1 ratio	71	—	—	—	2	2	2	2	—	—	—	—	2852 917
	SCREW, Adj. Lock, w/8 3/4" dia. Gear w/8 1/4" dia. Gear		2	2	2	2	2	2	2	2	2	2	2	181 082
			—	—	—	2	2	2	—	—	—	—	—	180 075
3-11-25	SHIM, Adj., w/9 3/4" dia. Gear, w/426 and 440 Engines	.003" thk. .005" thk.	8 8	— —	AR AR	— —	AR AR	AR AR	— —	— —	— —	— —	— —	1795 152 1795 153

NOTES

CARLINES

J - Challenger
B - Barracuda

V - Valiant
L - Dart

R - Belvedere - Satellite
W - Coronet - Charger

P - Plymouth
D - Dodge

C - Chrysler
Y - Imperial

AR Indicates use as required.

Indicates parts not listed in any previous parts book.

Numerals in parentheses () refer to notes.

★ Indicates change or addition.

Printed in U.S.A.
January 1972

3-19-0 DRIVE GEAR AND PINION SET

NOTE: Differential Gear and Pinions are serviced by MATCHED SET numbers only. They are catalogued below in charted form by ratio. The chart includes other information such as Gear and Pinion numbers which generally are stamped on the item, and may be used as reference to confirm the correct Gear and Pinion Set they are contained in. The SET NUMBER must be ordered for replacement of either Gear or Pinion.

3-19-1 GEAR and PINION SET							SERVICE SET
RATIO	GEAR DIA.	STEM DIA.	GEAR NO.	PINION	MODEL		NUMBER
2.76 To 1	7 1/4"	1 3/8"	2800 275	2800 276	V,L,B,J See Note 3		2800 281
2.76 to 1 Pkg.	7 1/4"	1 3/8"	2800 275	3507 747	V1, L1, B, J, 71 See Note 4	=	3621 939
2.93 To 1	7 1/4"	1 3/8"	2070 480	2643 201	R1,W1 See Note 3		2643 204
2.93 to 1 Pkg.	7 1/4"	1 3/8"	-----	-----	V1, L1, 71 See Note 4	=	3621 927
3.23 To 1	7 1/4"	1 3/8"	2070 558	2643 202	V1,L1,B1,J1,R1,W1 See Note 3		2643 205
3.23 to 1 Pkg.	7 1/4"	1 3/8"	2070 558	3507 745	V1, L1, 71 See Note 4	=	3621 928
3.55 To 1	7 1/4"	1 3/8"	2070 559	2643 203	V,L 71 See Note 3		2643 206
3.55 to 1 Pkg.	7 1/4"	1 3/8"	2070 559	3507 744	V1, L1, 71 See Note 4	=	3621 929
3.55 To 1	7 1/4"	1 3/8"	2070 559	2643 203	V1, L1 70		2643 206
3.91 To 1	7 1/4"	1 3/8"	2070 560	2467 131	V,L 70		2467 135
3.91 to 1 Pkg.	7 1/4"	1 3/8"	-----	-----	V1, L1, 71 See Note 4	=	3621 930
2.71 to 1	7 1/4"	1 3/8"	2852 928	2852 929	R, W, D, 71 See Note 3		2931 892
2.71 To 1	8 1/4"	1 5/8"	2852 928	2852 929	R2,W2,P2		2931 892
2.45 To 1	8 1/4"	1 5/8"	2852 923	2852 924	R2, W2		2852 927
3.21 To 1	8 1/4"	1 5/8"	2852 938	2852 939	R, W, P 70		2852 942
3.21 To 1	8 1/4"	1 5/8"	2852 938	2852 939	R,W,P,D1 71		2852 942
2.76 To 1	8 3/4"	1 3/8"	2070 684	2070 685	B, J, P2, D2 70 See Note 1		2070 689
2.94 To 1	8 3/4"	1 3/8"	2643 118	2643 102	R, W, P, D See Note 1		2643 103
3.23 To 1	8 3/4"	1 3/8"	2070 611	2070 612	V, L, B, J, R, W, P, D		
					See Note 1		2070 816
3.55 To 1	8 3/4"	1 3/8"	2070 898	2070 899	V2, L2, R, W, P, D 70		
					See Note 1		2070 915
3.91 To 1	8 3/4"	1 3/8"	2070 225	2070 226	V2, L2, R1, W1 70 See Note 1		2070 300
2.76 To 1	8 3/4"	1 3/4"	2070 684	2070 686	R, W 70		2070 690
2.76 to 1	8 3/4"	1 3/4"	2070 684	2070 686	P, D, Canada 70		2070 690
2.94 To 1	8 3/4"	1 3/4"	2643 118	2643 119	R, W 70		2643 120
3.23 To 1	8 3/4"	1 3/4"	2800 270	2800 271	R, W 70		2800 274
3.23 To 1	8 3/4"	1 3/4"	2070 611	2070 613	R, W 70		2070 817
3.23 To 1	8 3/4"	1 3/4"	2070 611	2070 613	P, D, Canada 70		2070 817
2.76 to 1 Pkg.	8 3/4"	1 7/8"	2070 684	3507 394	B2,J2,P2,D2,C 70 See Note 2	=	3549 061
2.94 To 1	8 3/4"	1 7/8"	2852 738	2881 464	R, W, P, D, C, Y 70 See Note 1		2881 497
3.23 To 1	8 3/4"	1 7/8"	2800 270	2881 465	B2, J2, P, D, C 70 See Note 1		2881 498
3.55 To 1	8 3/4"	1 7/8"	2881 325	2931 877	B2, J2, R2, W2 70 See Note 1		2931 878
3.91 To 1	8 3/4"	1 7/8"	3432 215	3432 216	B2, J2, R2, W2 70 See Note 1		3432 217
3.54 To 1	9 3/4"	-----	2852 531	2852 537	B2, J2, R2, W2		2852 575
4.10 To 1	9 3/4"	-----	1922 311	2953 804	B2, J2, R2, W2		2953 805
2.76 To 1	8 3/4"	1 3/8"	2070 684	3507 316	B, J, P, D 70 See Note 2		3507 323
2.76 To 1	8 3/4"	1 3/8"	2070 684	3507 316	V,L,P,D,C1, 71 See Note 2		3507 323
2.94 To 1	8 3/4"	1 3/8"	2643 118	3507 317	R,W,P,D See Note 2		3507 324
3.23 To 1	8 3/4"	1 3/8"	2070 611	3507 318	V,L, B2, J2, R, W, P, D		
					See Note 2		3507 325
3.23 To 1	8 3/4"	1 3/8"	2070 611	3507 318	V, L, B2, J2, R, W, P2, D2 71		
					See Note 2		3507 325
3.55 To 1	8 3/4"	1 3/8"	2070 898	3507 319	V2, L2, R, W, P, D See Note 2		3507 326
3.91 To 1	8 3/4"	1 3/8"	2070 225	3507 320	V, L, R, W 70 See Note 2		3507 327
3.91 To 1	8 3/4"	1 3/8"	2070 225	3507 320	V2, L2, 71 See Note 2		3507 327
2.76 To 1	8 3/4"	1 7/8"	2070 684	3507 394	B2, J2, R, W, P, D, C See Note 2		3507 455
2.94 To 1	8 3/4"	1 7/8"	2852 738	3507 395	R, W, Y See Note 2		3507 456
3.23 To 1	8 3/4"	1 7/8"	2800 270	3507 396	B2,J2,R,W,P,D,C,Y See Note 2		3507 457
3.55 To 1	8 3/4"	1 7/8"	2881 325	3507 397	B, J, R, W, D 70 See Note 2		3507 458
3.55 To 1	8 3/4"	1 7/8"	2881 325	3507 397	B2, J2, R2, W2 71 See Note 2		3507 458
3.91 To 1	8 3/4"	1 7/8"	3432 215	3507 398	B, J, R, W 70 See Note 2		3507 459
3.91 To 1	8 3/4"	1 7/8"	3432 215	3507 398	B, J, R2, W2 71 See Note 2		3507 459
4.10 To 1	8 3/4"	1 7/8"	1673 362	3507 399	70 See Note 2		3507 460

NOTE: 1 Used with 10 Tooth Pinion Spline with 1 1/8" Diameter Nut

NOTE: 2 Used with 29 Tooth Pinion Spline with 1 1/4" Diameter Nut

NOTE: 3 Used without Collapsible Spacer

NOTE: 4 Used with Collapsible Spacer in 1971 Models

CARLINES	J - Challenger B - Barracuda	V - Valiant L - Dart	R - Belvedere - Satellite W - Coronet - Charger	P - Plymouth D - Dodge	C - Chrysler Y - Imperial
----------	---------------------------------	-------------------------	--	---------------------------	------------------------------

AR Indicates use as required.

Indicates parts not listed in any previous parts book.

Numerals in parentheses () refer to notes.

★ Indicates change or addition.

Printed in U.S.A.

January 1972

CODE	PART NAME	ENG. TYPE OR CU.IN.	V	B	L	R	W	P	D	C	C	C	Y	PART NUMBER
			1-2	1-2	1-2	1-2	1-2	1-2	1-2	1	2	3	1	
3-19-0 DRIVE GEAR AND PINION SET Cont'd.														
3-19-15	BOLT, w/WASHER, Drive Pinion Carrier													
	Cover, w/9 3/4" dia. Gear	70	8	—	10	—	10	10	—	—	—	—	—	2908 482
		71		—	10	—	10	10	—	—	—	—	—	2954 031
3-20-0 DRIVE GEAR BOLT OR SCREW														
3-20-1	BOLT or SCREW, w/7 1/4" dia. Gear		8	8	8	8	8	—	—	—	—	—	—	2881 499
	3/8" - 24 w/.388"-.391" dia.													
	Shoulder	71	8	8	8	8	8	—	—	—	—	—	—	= 2931 799
	w/8 3/4" dia. Gear		12	12	12	12	12	12	12	12	12	12	12	2881 499
	3/8" - 24 w/.388"-.391-- dia.													
	Shoulder	71	12	12	12	12	12	12	12	12	12	12	12	= 2931 799
	w/9 3/4" dia. Gear		8	—	12	—	12	12	—	—	—	—	—	1795 170
	w/8 1/4" dia. Gear	70	—	—	—	10	10	10	—	—	—	—	—	2881 499
	w/8 1/4" dia. Gear	71	—	—	—	10	10	10	10	—	—	—	—	2881 499
	SCREW PACKAGE, w/8 3/4" dia. Gear (Consists of 12 Screws part number 2931 799)		1	1	1	1	1	1	1	1	1	1	1	= 3621 458
3-22-0 DRIVE PINION BEARINGS														
3-22-24	CONE, w/ROLLERS, Frt. Brg., w/7 1/4" Dia. Gear, 1 3/8" dia. Stem, R1, W1, except Sta. Wgn.		1	1	1	1	1	—	—	—	—	—	—	2070 316
	Rr.		1	1	1	1	1	—	—	—	—	—	—	2070 318
	Frt., w/8 3/4" dia. Gear		1	1	1	1	1	1	1	1	1	1	1	1820 552
	Rr. w/1 3/8" dia. Stem	70	1	1	1	1	1	1	—	—	—	—	—	1401 809
		71	1	1	1	1	1	1	1	—	—	—	—	1401 809
	Rr., w/1 3/4" dia. Stem	70	—	—	—	1	1	—	—	—	—	—	—	2808 226
	Rr., w/1 7/8" dia. Stem	70	—	1	—	1	1	1	1	—	—	—	1	2852 731
	Rr., w/1 7/8" dia. Stem	71	—	1	—	1	1	1	1	1	1	1	1	2852 731
	Frt., w/9 3/4" dia. Gear, w/426 and 440 Eng.	8	—	1	—	1	1	—	—	—	—	—	—	1799 300
		8	—	1	—	1	1	—	—	—	—	—	—	1327 846
	Frt., w/8 1/4" dia. Gear, 1 5/8" dia. Stem, R, W, w/2.45, 2.71 and 3.21 to 1 ratio, P, w/2.71 and 3.21 to 1 ratio	70	—	—	—	1	1	1	—	—	—	—	—	2070 316
	Rr.	70	—	—	—	1	1	1	—	—	—	—	—	2800 484
	Frt., w/8 1/4" dia. Gear, 1 5/8" dia. Stem, R, W, w/2.45, 2.71, 2.94 and 3.21 to 1 ratio, P, D, w/2.71 and 3.21 to 1 ratio	71	—	—	—	1	1	1	1	—	—	—	—	2070 316
	Rr.	71	—	—	—	1	1	1	1	—	—	—	—	2800 484
	Frt., w/8 3/4" dia. Gear, 1 3/4" dia. Stem, Canada	70	—	—	—	—	—	1	1	—	—	—	—	1401 809
3-22-25	CUP, Frt. Brg., w/7 1/4" dia. Gear, 1 3/8" dia. Stem, R1, W1, except Sta. Wgn.		1	1	1	1	1	—	—	—	—	—	—	2070 317
	Rr.		1	1	1	1	1	—	—	—	—	—	—	2070 319
	Frt., w/8 3/4" dia. Gear		1	1	1	1	1	1	1	1	1	1	1	1820 551
	Rr., 1 7/8" dia. Stem	70	—	1	—	1	1	1	1	1	—	—	1	2852 732
	Rr., 1 7/8" dia. Stem	71	—	1	—	1	1	1	1	1	1	1	1	2852 732
	Rr., w/1 3/8" dia. Stem	70	1	1	1	1	1	1	1	—	—	—	—	1401 810
		71	1	1	1	1	1	1	1	1	—	—	—	1401 810
	Rr., w/1 3/4" dia. Gear	70	—	—	—	1	1	—	—	—	—	—	—	1327 847
	Frt., w/9 3/4" dia. Gear, w/426 and 440 Eng.	8	—	1	—	1	1	—	—	—	—	—	—	1799 299
	Rr.	8	—	1	—	1	1	—	—	—	—	—	—	1327 847

CARLINES J - Challenger V - Valiant
B - Barracuda L - Dart

R - Belvedere - Satellite
W - Coronet - Charger

P - Plymouth
D - Dodge

C - Chrysler
Y - Imperial

AR Indicates use as required.

Numerals in parentheses () refer to notes.

Printed in U.S.A.

Indicates parts not listed in any previous parts book.

★ Indicates change or addition.

January 1972

CODE	PART NAME	ENG. TYPE OR CU.IN.	V	B	L	R	W	P	D	C	C	C	Y	PART NUMBER
			1-2	1-2	1-2	1-2	1-2	1-2	1-2	1	2	3	1	
3-22-0 DRIVE PINION BEARINGS Cont'd.														
3-22-25	CLIP Cont'd.													
	Frnt., w/8 1/4" dia. Gear, 1 5/8" dia. Stem, R, W, w/2.45, 2.71 and 3.21 to 1 ratio, P, w/2.71 and 3.21 to 1 ratio	70	—	—	—	1	1	1	—	—	—	—	—	2070 317
	Rr.	70	—	—	—	1	1	1	—	—	—	—	2800 485	
	Frnt., w/8 1/4" dia. Gear, 1 5/8" dia. Stem, R, W, w/2.45, 2.71, 2.94 and 3.21 to 1 ratio, P, D, w/2.71 and 3.21 to 1 ratio	71	—	—	—	1	1	1	1	—	—	—	2070 317	
	Rr.	71	—	—	—	1	1	1	1	—	—	—	2800 485	
	Frnt., w/8 3/4" dia. Gear, 1 3/4" dia. Stem, Canada	70	—	—	—	—	—	1	1	—	—	—	1401 810	
	Rr., w/8 3/4" dia. Gear, 1 3/4" dia. Stem, Canada	70	—	—	—	—	—	1	1	—	—	—	1327 847	
3-22-26	SPACER, Frnt. Brg. Adj., w/7 1/4" dia. Gear, 1 3/8" dia. Stem, R1, W1, except Sta. Wgn.,													
	.074" thk.		AR	AR	AR	AR	AR	AR	—	—	—	—	—	2070 094
	.075" thk.		AR	AR	AR	AR	AR	AR	—	—	—	—	—	2070 454
	.076" thk.		AR	AR	AR	AR	AR	AR	—	—	—	—	—	2070 095
	.077" thk.		AR	AR	AR	AR	AR	AR	—	—	—	—	—	2070 455
	.078" thk.		AR	AR	AR	AR	AR	AR	—	—	—	—	—	2070 096
	.079" thk.		AR	AR	AR	AR	AR	AR	—	—	—	—	—	2070 456
	.080" thk.		AR	AR	AR	AR	AR	AR	—	—	—	—	—	2070 097
	.081" thk.		AR	AR	AR	AR	AR	AR	—	—	—	—	—	2070 457
	.082" thk.		AR	AR	AR	AR	AR	AR	—	—	—	—	—	2070 098
	.083" thk.		AR	AR	AR	AR	AR	AR	—	—	—	—	—	2070 458
	.084" thk.		AR	AR	AR	AR	AR	AR	—	—	—	—	—	2070 099
	.085" thk.		AR	AR	AR	AR	AR	AR	—	—	—	—	—	2070 459
	.086" thk.		AR	AR	AR	AR	AR	AR	—	—	—	—	—	2070 100
	.087" thk.		AR	AR	AR	AR	AR	AR	—	—	—	—	—	2070 460
	.088" thk.		AR	AR	AR	AR	AR	AR	—	—	—	—	—	2070 101
	.089" thk.		AR	AR	AR	AR	AR	AR	—	—	—	—	—	2070 461
	.090" thk.		AR	AR	AR	AR	AR	AR	—	—	—	—	—	2070 102
	.091" thk.		AR	AR	AR	AR	AR	AR	—	—	—	—	—	2070 462
	.092" thk.		AR	AR	AR	AR	AR	AR	—	—	—	—	—	2070 103
	.093" thk.		AR	AR	AR	AR	AR	AR	—	—	—	—	—	2070 463
	.094" thk.		AR	AR	AR	AR	AR	AR	—	—	—	—	—	2070 104
	.095" thk.		AR	AR	AR	AR	AR	AR	—	—	—	—	—	2070 464
	.096" thk.		AR	AR	AR	AR	AR	AR	—	—	—	—	—	2070 105
	.097" thk.		AR	AR	AR	AR	AR	AR	—	—	—	—	—	2070 465
	.098" thk.		AR	AR	AR	AR	AR	AR	—	—	—	—	—	2070 106
	.099" thk.		AR	AR	AR	AR	AR	AR	—	—	—	—	—	2070 466
	.100" thk.		AR	AR	AR	AR	AR	AR	—	—	—	—	—	2070 107
	.101" thk.		AR	AR	AR	AR	AR	AR	—	—	—	—	—	2070 467
	.102" thk.		AR	AR	AR	AR	AR	AR	—	—	—	—	—	2070 108
	.103" thk.		AR	AR	AR	AR	AR	AR	—	—	—	—	—	2070 468
	.104" thk.		AR	AR	AR	AR	AR	AR	—	—	—	—	—	2070 109
	.105" thk.		AR	AR	AR	AR	AR	AR	—	—	—	—	—	2070 469
	.106" thk.		AR	AR	AR	AR	AR	AR	—	—	—	—	—	2070 110
	Frnt. Brg., w/7 1/4" dia. Gear, 1 3/8" dia. Stem, Collapsible Type	71	1	1	1	—	—	—	—	—	—	—	—	# 3507 575
	Brg. Adj., w/8 3/4" dia. Gear, 1 3/4" and 1 7/8" dia. Stem, Collapsible Type, 2 63/64" lgh.	70	1	1	1	1	1	1	1	1	1	1	1	2931 687
	w/8 3/4" dia. Gear, 1 7/8" dia. Stem, Collapsible Type,													

CARLINES J - Challenger B - Barracuda V - Valiant L - Dart R - Belvedere - Satellite W - Coronet - Charger P - Plymouth D - Dodge C - Chrysler Y - Imperial

AR Indicates use as required. Numerals in parentheses () refer to notes. Printed in U.S.A. January 1972
 # Indicates parts not listed in any previous parts book. ★ Indicates change or addition.

CODE	PART NAME	ENG. TYPE OR CU.IN.	V	B	L	R	W	P	D	C	C	C	Y	PART NUMBER
			1-2	1-2	1-2	1-2	1-2	1-2	1-2	1	2	3	1	
3-22-0 DRIVE PINION BEARINGS Cont'd.														
3-22-26	SPACER Cont'd.													
	2 63/64" lgh.	71	—	1	—	1	1	1	1	1	1	1	1	2931 687
	Rr., w/8 3/4" dia. Gear, 1 3/8" dia.													
	Stem, 2 11/16" lgh.	70	1	1	1	1	1	1	1	—	—	—	—	1738 826
		71	1	1	1	1	1	1	1	—	—	—	—	1738 826
	w/8 1/4" dia. Gear, 1 5/8" dia.													
	Stem, R, W, w/2.45, 2.71 and 3.21													
	to 1 ratio, P, w/2.71 and 3.21													
	to 1 ratio, Collapsible Type	70	—	—	—	1	1	1	—	—	—	—	—	2931 874
	w/8 1/4" dia. Gear, 1 5/8" dia.													
	Stem, R, W, w/2.45, 2.71, 2.94 and													
	3.21 to 1 ratio, P, D, w/2.71 and													
	3.21 to 1 ratio	71	—	—	—	1	1	1	1	—	—	—	—	2931 874
3-22-27	WASHER, Rr. Brg., w/7 1/4" and 8 3/4"													
	Dia. Gear, 1 3/8" dia. Stem,													
	.084" thk. 70		AR	AR	AR	AR	AR	AR	AR	—	—	—	—	1738 794
	.086" thk. 70		AR	AR	AR	AR	AR	AR	AR	—	—	—	—	1738 795
	.088" thk. 70		AR	AR	AR	AR	AR	AR	AR	—	—	—	—	1738 796
	.090" thk. 70		AR	AR	AR	AR	AR	AR	AR	—	—	—	—	1738 797
	.092" thk. 70		AR	AR	AR	AR	AR	AR	AR	—	—	—	—	1738 798
	.094" thk. 70		AR	AR	AR	AR	AR	AR	AR	—	—	—	—	1738 799
	.096" thk. 70		AR	AR	AR	AR	AR	AR	AR	—	—	—	—	1738 800
	.098" thk. 70		AR	AR	AR	AR	AR	AR	AR	—	—	—	—	1738 801
	.100" thk. 70		AR	AR	AR	AR	AR	AR	AR	—	—	—	—	1738 802
	Rr., w/7 1/4" and 8 3/4" dia. Gear,													
	1 3/8" dia. Stem													
	.084" thk. 71		AR	AR	AR	AR	AR	AR	AR	AR	—	—	—	1738 794
	.086" thk. 71		AR	AR	AR	AR	AR	AR	AR	AR	—	—	—	1738 795
	.088" thk. 71		AR	AR	AR	AR	AR	AR	AR	AR	—	—	—	1738 796
	.090" thk. 71		AR	AR	AR	AR	AR	AR	AR	AR	—	—	—	1738 797
	.092" thk. 71		AR	AR	AR	AR	AR	AR	AR	AR	—	—	—	1738 798
	.094" thk. 71		AR	AR	AR	AR	AR	AR	AR	AR	—	—	—	1738 799
	.096" thk. 71		AR	AR	AR	AR	AR	AR	AR	AR	—	—	—	1738 800
	.098" thk. 71		AR	AR	AR	AR	AR	AR	AR	AR	—	—	—	1738 801
	.100" thk. 71		AR	AR	AR	AR	AR	AR	AR	AR	—	—	—	1738 802
	Rr. Brg., w/8 3/4" dia. Gear, 1 3/4"													
	dia. Stem, Canada													
	.084" thk. 70		—	—	—	—	—	AR	AR	—	—	—	—	1738 812
	.086" thk. 70		—	—	—	—	—	AR	AR	—	—	—	—	1738 813
	.088" thk. 70		—	—	—	—	—	AR	AR	—	—	—	—	1738 814
	.090" thk. 70		—	—	—	—	—	AR	AR	—	—	—	—	1738 815
	.092" thk. 70		—	—	—	—	—	AR	AR	—	—	—	—	1738 816
	.094" thk. 70		—	—	—	—	—	AR	AR	—	—	—	—	1738 817
	.096" thk. 70		—	—	—	—	—	AR	AR	—	—	—	—	1738 818
	.098" thk. 70		—	—	—	—	—	AR	AR	—	—	—	—	1738 819
	.100" thk. 70		—	—	—	—	—	AR	AR	—	—	—	—	1738 820
3-22-28	SHIM, Frt. Brg. Adj., w/8 3/4" dia. Gear,													
	1 3/8" dia. Stem, 1 19/32"													
	O.D.													
	.014" thk. 70		2	—	2	2	2	2	2	—	—	—	—	1820 703
	.016" thk. 70		2	—	2	2	2	2	2	—	—	—	—	1820 704
	.018" thk. 70		2	—	2	2	2	2	2	—	—	—	—	1820 705
	.020" thk. 70		2	—	2	2	2	2	2	—	—	—	—	1820 706
	.022" thk. 70		2	—	2	2	2	2	2	—	—	—	—	1828 725
	.024" thk. 70		2	—	2	2	2	2	2	—	—	—	—	1829 440
	.026" thk. 70		2	—	2	2	2	2	2	—	—	—	—	1829 441
	Frt. Brg. Adj., w/8 3/4" dia. Gear, 1													
	3/8" dia. Stem,													
	1 19/32" O.D.													
	.014" thk. 71		2	2	2	2	2	2	2	2	—	—	—	1820 703
	.016" thk. 71		2	2	2	2	2	2	2	2	—	—	—	1820 704

CARLINES

J - Challenger
B - BarracudaV - Valiant
L - DartR - Belvedere - Satellite
W - Coronet - ChargerP - Plymouth
D - DodgeC - Chrysler
Y - Imperial

AR Indicates use as required.

Indicates parts not listed in any previous parts book.

Numerals in parentheses () refer to notes.

★ Indicates change or addition.

Printed in U.S.A.
January 1972

CODE	PART NAME	ENG. TYPE OR CU.IN.	V	B	L	R	W	P	D	C	C	C	Y	PART NUMBER
			1-2	1-2	1-2	1-2	1-2	1-2	1-2	1	2	3	1	
3-22-0 DRIVE PINION BEARINGS Cont'd.														
3-22-28	SHIM Cont'd.													
	.018" thk. 71		2	2	2	2	2	2	2	2	—	—	—	1820 705
	.020" thk. 71		AR	AR	AR	AR	AR	AR	AR	AR	—	—	—	1820 706
	.022" thk. 71		2	2	2	2	2	2	2	2	—	—	—	1828 725
	.024" thk. 71		2	2	2	2	2	2	2	2	—	—	—	1829 440
	.026" thk. 71		2	2	2	2	2	2	2	2	—	—	—	1829 441
	Frnt. Brg. Adj., w/8 3/4" dia. Gear, 1 3/4" dia. Stem, Canada .014" thk. 70		—	—	—	—	—	—	AR	AR	—	—	—	1738 805
	.016" thk. 70		—	—	—	—	—	—	AR	AR	—	—	—	1738 806
	.018" thk. 70		—	—	—	—	—	—	AR	AR	—	—	—	1738 807
	.022" thk. 70		—	—	—	—	—	—	AR	AR	—	—	—	1829 442
	.024" thk. 70		—	—	—	—	—	—	AR	AR	—	—	—	1829 443
	.026" thk. 70		—	—	—	—	—	—	AR	AR	—	—	—	1829 444
	w/9 3/4" dia. Gear, Frnt., w/426 and 440 Engines													
	.014" thk. 8		—	2	—	2	2	—	—	—	—	—	—	2881 085
	.015" thk. 8		—	2	—	2	2	—	—	—	—	—	—	2881 181
	.016" thk. 8		—	2	—	2	2	—	—	—	—	—	—	2881 086
	.018" thk. 8		—	2	—	2	2	—	—	—	—	—	—	2881 087
	.020" thk. 8		—	2	—	2	2	—	—	—	—	—	—	2881 088
	.021" thk. 8		—	2	—	2	2	—	—	—	—	—	—	2881 182
	.022" thk. 8		—	2	—	2	2	—	—	—	—	—	—	2881 089
	.023" thk. 8		—	2	—	2	2	—	—	—	—	—	—	2881 183
	Rr. .003" thk. 8		—	2	—	2	2	—	—	—	—	—	—	1922 314
	.005" thk. 8		—	2	—	2	2	—	—	—	—	—	—	1922 315
	Rr., w/8 3/4" dia. Gear, 1 7/8" dia. Stem, 2 45/64" O.D., w/3 Inside Tabs,													
	.020" thk. 8		—	AR	—	—	—	—	—	—	—	—	—	3432 320
	.021" thk. 8		—	AR	—	—	—	—	—	—	—	—	—	3432 321
	.022" thk. 8		—	AR	—	—	—	—	—	—	—	—	—	3432 322
	.023" thk. 8		—	AR	—	—	—	—	—	—	—	—	—	3432 323
	.024" thk. 8		—	AR	—	—	—	—	—	—	—	—	—	3432 324
	.025" thk. 8		—	AR	—	—	—	—	—	—	—	—	—	3432 325
	.026" thk. 8		—	AR	—	—	—	—	—	—	—	—	—	3432 326
	.027" thk. 8		—	AR	—	—	—	—	—	—	—	—	—	3432 327
	.028" thk. 8		—	AR	—	—	—	—	—	—	—	—	—	3432 328
	.029" thk. 8		—	AR	—	—	—	—	—	—	—	—	—	3432 329
	.030" thk. 8		—	AR	—	—	—	—	—	—	—	—	—	3432 330
	.031" thk. 8		—	AR	—	—	—	—	—	—	—	—	—	3432 331
	.032" thk. 8		—	AR	—	—	—	—	—	—	—	—	—	3432 332
	.033" thk. 8		—	AR	—	—	—	—	—	—	—	—	—	3432 333
	.034" thk. 8		—	AR	—	—	—	—	—	—	—	—	—	3432 334
	.035" thk. 8		—	AR	—	—	—	—	—	—	—	—	—	3432 335
	.036" thk. 8		—	AR	—	—	—	—	—	—	—	—	—	3432 336
	.037" thk. 8		—	AR	—	—	—	—	—	—	—	—	—	3432 337
	.038" thk. 8		—	AR	—	—	—	—	—	—	—	—	—	3432 338
	Frnt., w/8 1/4" dia. Gear, 1 5/8" dia. Stem, R, W, w/2.45, 2.71 and 3.21 to 1 ratio, P, w/2.71 and 3.21 to 1 ratio, 1 11/32" O.D. 70 .020" thk.		—	—	—	1	1	1	—	—	—	—	—	2931 817
	Rr., 3 3/32" O.D. 70 .060" thk.		—	—	—	1	1	1	—	—	—	—	—	2931 960
	70 .061" thk.		—	—	—	1	1	1	—	—	—	—	—	2931 961
	70 .062" thk.		—	—	—	1	1	1	—	—	—	—	—	2931 962
	70 .063" thk.		—	—	—	1	1	1	—	—	—	—	—	2931 963
	70 .064" thk.		—	—	—	1	1	1	—	—	—	—	—	2931 964
	70 .065" thk.		—	—	—	1	1	1	—	—	—	—	—	2931 965
	70 .066" thk.		—	—	—	1	1	1	—	—	—	—	—	2931 966

CARLINES J - Challenger B - Barracuda V - Valiant L - Dart R - Belvedere - Satellite W - Coronet - Charger P - Plymouth D - Dodge C - Chrysler Y - Imperial

AR Indicates use as required. Numerals in parentheses () refer to notes. Printed in U.S.A. January 1972
Indicates parts not listed in any previous parts book. ★ Indicates change or addition.

CODE	PART NAME	ENG. TYPE OR CU.IN.	V	B	L	R	W	P	D	C	C	C	Y	PART NUMBER
			1-2	1-2	1-2	1-2	1-2	1-2	1-2	1	2	3	1	
3-22-0 DRIVE PINION BEARINGS Cont'd.														
3-22-28	SHIM Cont'd.													
	70 .067" thk.		—	—	—	1	1	1	—	—	—	—	—	2931 967
	70 .068" thk.		—	—	—	1	1	1	—	—	—	—	—	2931 968
	70 .069" thk.		—	—	—	1	1	1	—	—	—	—	—	2931 969
	70 .070" thk.		—	—	—	1	1	1	—	—	—	—	—	2931 970
	70 .071" thk.		—	—	—	1	1	1	—	—	—	—	—	2931 971
	70 .072" thk.		—	—	—	1	1	1	—	—	—	—	—	2931 972
	70 .073" thk.		—	—	—	1	1	1	—	—	—	—	—	2931 973
	70 .074" thk.		—	—	—	1	1	1	—	—	—	—	—	2931 974
	70 .075" thk.		—	—	—	1	1	1	—	—	—	—	—	2931 975
	70 .076" thk.		—	—	—	1	1	1	—	—	—	—	—	2931 976
	70 .077" thk.		—	—	—	1	1	1	—	—	—	—	—	2931 977
	70 .078" thk.		—	—	—	1	1	1	—	—	—	—	—	2931 978
	Frnt., w/8 1/4" dia. Gear, 1 5/8" dia. Stem, R, W, w/2.45, 2.71, 2.94 and 3.21 to 1 ratio, P, D, w/2.71 and 3.21 to 1 ratio, 1 11/32"													
	O.D.	71 .020" thk.	—	—	—	1	1	1	1	—	—	—	—	2931 817
	Rr., 3 3/32" O.D.	71 .060" thk.	—	—	—	1	1	1	1	—	—	—	—	2931 960
		71 .061" thk.	—	—	—	1	1	1	1	—	—	—	—	2931 961
		71 .062" thk.	—	—	—	1	1	1	1	—	—	—	—	2931 962
		71 .063" thk.	—	—	—	1	1	1	1	—	—	—	—	2931 963
		71 .064" thk.	—	—	—	1	1	1	1	—	—	—	—	2931 964
		71 .065" thk.	—	—	—	1	1	1	1	—	—	—	—	2931 965
		71 .066" thk.	—	—	—	1	1	1	1	—	—	—	—	2931 966
		71 .067" thk.	—	—	—	1	1	1	1	—	—	—	—	2931 967
		71 .068" thk.	—	—	—	1	1	1	1	—	—	—	—	2931 968
		71 .069" thk.	—	—	—	1	1	1	1	—	—	—	—	2931 969
		71 .070" thk.	—	—	—	1	1	1	1	—	—	—	—	2931 970
		71 .071" thk.	—	—	—	1	1	1	1	—	—	—	—	2931 971
		71 .072" thk.	—	—	—	1	1	1	1	—	—	—	—	2931 972
		71 .073" thk.	—	—	—	1	1	1	1	—	—	—	—	2931 973
		71 .074" thk.	—	—	—	1	1	1	1	—	—	—	—	2931 974
		71 .075" thk.	—	—	—	1	1	1	1	—	—	—	—	2931 975
		71 .076" thk.	—	—	—	1	1	1	1	—	—	—	—	2931 976
		71 .077" thk.	—	—	—	1	1	1	1	—	—	—	—	2931 977
		71 .078" thk.	—	—	—	1	1	1	1	—	—	—	—	2931 978
	Rr., w/8 3/4" dia. Gear, 1 3/4" and 1 7/8" dia. Stem, 2 45/64"													
	O.D. w/3 Inside Tabs	.020" thk. 70	—	—	—	1	1	1	1	1	—	—	1	3432 320
		.021" thk. 70	—	—	—	1	1	1	1	1	—	—	1	3432 321
		.022" thk. 70	—	—	—	1	1	1	1	1	—	—	1	3432 322
		.023" thk. 70	—	—	—	1	1	1	1	1	—	—	1	3432 323
		.024" thk. 70	—	—	—	1	1	1	1	1	—	—	1	3432 324
		.025" thk. 70	—	—	—	1	1	1	1	1	—	—	1	3432 325
		.026" thk. 70	—	—	—	1	1	1	1	1	—	—	1	3432 326
		.027" thk. 70	—	—	—	1	1	1	1	1	—	—	1	3432 327
		.028" thk. 70	—	—	—	1	1	1	1	1	—	—	1	3432 328
		.029" thk. 70	—	—	—	1	1	1	1	1	—	—	1	3432 329
		.030" thk. 70	—	—	—	1	1	1	1	1	—	—	1	3432 330
		.031" thk. 70	—	—	—	1	1	1	1	1	—	—	1	3432 331
		.032" thk. 70	—	—	—	1	1	1	1	1	—	—	1	3432 332
		.033" thk. 70	—	—	—	1	1	1	1	1	—	—	1	3432 333
		.034" thk. 70	—	—	—	1	1	1	1	1	—	—	1	3432 334
		.035" thk. 70	—	—	—	1	1	1	1	1	—	—	1	3432 335
		.136" thk. 70	—	—	—	1	1	1	1	1	—	—	1	3432 336
		.037" thk. 70	—	—	—	1	1	1	1	1	—	—	1	3432 337
		.038" thk. 70	—	—	—	1	1	1	1	1	—	—	1	3432 338

CARLINES J - Challenger V - Valiant R - Belvedere - Satellite P - Plymouth C - Chrysler
 B - Barracuda L - Dart W - Coronet - Charger D - Dodge Y - Imperial

AR Indicates use as required.

Indicates parts not listed in any previous parts book.

Numerals in parentheses () refer to notes.

★ Indicates change or addition.

Printed in U.S.A.
 January 1972

CODE	PART NAME	ENG. TYPE OR CU.IN.	V	B	L	R	W	P	D	C	C	C	Y	PART NUMBER
			1-2	1-2	1-2	1-2	1-2	1-2	1-2	1	2	3	1	
3-22-0 DRIVE PINION BEARINGS Cont'd.														
3-22-28	SHIM Cont'd.													
	Frnt., w/8 3/4" dia. Gear, 1 3/8" and 1 7/8" dia. Stem .020" thk. 70		—	—	—	—	—	1	1	1	1	1	1	2931 818
	Rr., w/8 3/4" dia. Gear, 1 7/8" dia. Stem, 2 45/64" O.D., w/3 Inside Tabs		—	—	—	1	1	1	1	1	1	1	1	3432 320
	71 .021" thk.		—	—	—	1	1	1	1	1	1	1	1	3432 321
	71 .022" thk.		—	—	—	1	1	1	1	1	1	1	1	3432 322
	71 .023" thk.		—	—	—	1	1	1	1	1	1	1	1	3432 323
	71 .024" thk.		—	—	—	1	1	1	1	1	1	1	1	3432 324
	71 .025" thk.		—	—	—	1	1	1	1	1	1	1	1	3432 325
	71 .026" thk.		—	—	—	1	1	1	1	1	1	1	1	3432 326
	71 .027" thk.		—	—	—	1	1	1	1	1	1	1	1	3432 327
	71 .028" thk.		—	—	—	1	1	1	1	1	1	1	1	3432 328
	71 .029" thk.		—	—	—	1	1	1	1	1	1	1	1	3432 329
	71 .030" thk.		—	—	—	1	1	1	1	1	1	1	1	3432 330
	71 .031" thk.		—	—	—	1	1	1	1	1	1	1	1	3432 331
	71 .032" thk.		—	—	—	1	1	1	1	1	1	1	1	3432 332
	71 .033" thk.		—	—	—	1	1	1	1	1	1	1	1	3432 333
	71 .034" thk.		—	—	—	1	1	1	1	1	1	1	1	3432 334
	71 .035" thk.		—	—	—	1	1	1	1	1	1	1	1	3432 335
	71 .036" thk.		—	—	—	1	1	1	1	1	1	1	1	3432 336
	71 .037" thk.		—	—	—	1	1	1	1	1	1	1	1	3432 337
	71 .038" thk.		—	—	—	1	1	1	1	1	1	1	1	3432 338
	Frnt., w/8 3/4" dia. Gear, 1 7/8" dia. Stem 71 .020" thk.		—	1	—	1	1	1	1	1	1	1	1	2931 818
3-22-40	SLINGER, Frnt. Brg. Oil, w/9 3/4" dia. Gear	8	—	1	—	1	1	—	—	—	—	—	—	1795 193
3-22-45	OIL SEAL, Frnt. Brg., w/7 1/4" dia. Gear, 1 3/8" dia. Stem, R1, W1, except Sta. Wgn., 3 5/32" O.D.		1	1	1	1	1	—	—	—	—	—	—	2881 041
	Frnt., w/8 3/4" dia. Gear, 1 3/8", 1 3/4" and 1 7/8" dia. Stem, 3 3/8" O.D. 70		1	1	1	1	1	1	1	1	1	1	1	2931 862
	Frnt., w/8 3/4" dia. Gear, 1 3/8" and 1 7/8" dia. Stem, 3 3/8" O.D. 71		1	1	1	1	1	1	1	1	1	1	1	2931 862
	Frnt., w/9 3/4" dia. Gear, w/426 and 440 Engines	8	—	1	—	1	1	—	—	—	—	—	—	# 3507 585
	Frnt., w/8 3/4" dia. Gear, 1 3/4" dia. Stem, Canada 70		—	—	—	—	—	1	1	—	—	—	—	1828 719
	Frnt., w/8 1/4" dia. Gear, 1 5/8" dia. Stem, R, W, w/2.45, 2.71 and 3.21 to 1 ratio, P, w/2.71 and 3.21 to 1 ratio 70		—	—	—	1	1	1	—	—	—	—	—	2881 041
	Frnt., w/8 1/4" dia. Gear, 1 5/8" dia. Stem, R, W, w/2.45, 2.71, 2.94 and 3.21 to 1 ratio, P, D, w/2.71 and 3.21 to 1 ratio 71		—	—	—	1	1	1	1	—	—	—	—	2881 041
3-22-78	GASKET, Frnt. Brg. Oil Seal, w/9 3/4" dia. Gear, w/426 and 440 Engines 70	8	—	1	—	1	1	—	—	—	—	—	—	1791 591

3-32-0 DRIVE SHAFT

3-32-1	SHAFT, w/7 1/4" dia. Gear, 1 3/8" dia. Stem		2	—	2	—	—	—	—	—	—	—	—	2404 442
	w/8 3/4" dia. Gear, 1 3/8" dia. Stem, 27 11/16" lgn. 70		2	—	2	—	—	—	—	—	—	—	—	2800 182
	w/8 3/4" dia. Gear, 27 11/16" lgh. 71		2	—	2	—	—	—	—	—	—	—	—	2800 182

CARLINES	J - Challenger B - Barracuda	V - Valiant L - Dart	R - Bevedere - Satellite W - Coronet - Charger	P - Plymouth D - Dodge	C - Chrysler Y - Imperial
----------	---------------------------------	-------------------------	---	---------------------------	------------------------------

AR Indicates use as required.

- Indicates parts not listed in any previous parts book.

Numerals in parentheses () refer to notes.

★ Indicates change or addition.

Printed in U.S.A.
January 1972

CODE	PART NAME	ENG. TYPE OR CU.IN.	V	B	L	R	W	P	D	C	C	C	Y	PART NUMBER
3-32-0 DRIVE SHAFT Cont'd.														
3-32-1	SHAFT Cont'd.													
	w/7 1/4" dia. Gear, 1 3/8" dia. Stem, 30 33/64" Lgh. 70		—	2	—	—	—	—	—	—	—	—	—	3432 792
	w/7 1/4" dia. Gear, 1 3/8" dia. Stem, R1, W1, except Sta. Wgn. 71		—	2	—	2	2	—	—	—	—	—	—	3432 792
	w/8 3/4" dia. Gear, 1 3/8" and 1 7/8" dia. Stem, 29 31/32" Lgh., w/o Studs		—	2	—	—	—	—	—	—	—	—	—	3432 780
	w/9 3/4" dia. Gear, w/426 and 440 Eng., Rt.	8	—	1	—	—	—	—	—	—	—	—	—	3432 209
	Lt., 30 7/16" Lgh.	8	—	1	—	—	—	—	—	—	—	—	—	3432 210
	w/7 1/4" dia. Gear, 1 3/8" dia. Stem, R1, W1, except Sta. Wgn. 70	6	—	—	—	2	2	—	—	—	—	—	—	3432 798
	w/8 1/4" dia. Gear, 1 5/8" dia. Stem, w/2.45, 2.71 and 3.21 to 1 ratio, 29 37/64" Lgh. 70		—	—	—	2	2	—	—	—	—	—	—	3432 820
	w/8 1/4" dia. Gear, 1 5/8" dia. Stem, w/2.45, 2.71, 2.94 and 3.21 to 1 ratio, w/1.40" dia. journal, 31" Lgh., Early Type 71		—	—	—	2	2	—	—	—	—	—	—	3507 475
	w/9 3/4" dia. Gear, w/426 and 440 Eng., Early Type 23T., Rt. Lt. 70	8	—	—	—	1	1	—	—	—	—	—	—	2881 010
	Lt. 70	8	—	—	—	1	1	—	—	—	—	—	—	2881 011
	w/9 3/4" dia. Gear, w/426 and 440 Eng., Late Type, 35T., Rt., 28 9/32" Lgh. 70	8	—	—	—	1	1	—	—	—	—	—	—	3507 160
	Lt., 29 21/32" Lgh. 70	8	—	—	—	1	1	—	—	—	—	—	—	3507 161
	w/9 3/4" dia. Gear, w/426 and 440 Eng., Rt. 71	8	—	—	—	1	1	—	—	—	—	—	—	3507 507
	Lt. 71	8	—	—	—	1	1	—	—	—	—	—	—	3507 508
	w/8 3/4" dia. Gear, 1 3/8", 1 3/4" and 1 7/8" dia. Stem 70		—	—	—	2	2	—	—	—	—	—	—	3432 774
	w/8 3/4" dia. Gear, except Sta. Wgn., 30 5/8" Lgh. 71		—	—	—	2	2	2	—	2	2	2	—	3432 830
	w/8 3/4" dia. Gear, R, W, P, C, Sta., Wgn., D 71		—	—	—	2	2	2	2	2	—	—	—	3432 786
	w/8 1/4" dia. Gear, 1 5/8" dia. Stem, w/1.62" dia. journal, 30 63/64" Lgh., Late Type, 27T 71		—	—	—	2	2	—	—	—	—	—	—	2931 864
	w/8 1/4" dia. Gear, 1 5/8" dia. Stem, w/2.71 and 3.21 to 1 ratio, 30 63/64" Lgh., 27T		—	—	—	—	—	2	—	—	—	—	—	2931 864
	w/8 3/4" dia. Gear, 1 3/8" and 1 7/8" dia. Stem, except Sta. Wgn. 70		—	—	—	—	—	2	—	2	2	2	—	3432 830
	w/8 3/4" dia. Gear, 1 3/8" and 1 7/8" dia. Stem, P, C1, Sta. Wgn., D 70		—	—	—	—	—	2	2	2	—	—	—	3432 786
	w/8 1/4" dia. Gear, 1 5/8" dia. Stem, 31 43/64" Lgh. 71		—	—	—	—	—	—	2	—	—	—	—	3507 490
	w/8 3/4" dia. Gear, 1 7/8" dia. Stem, 29" Lgh. 70	8	—	—	—	—	—	—	—	—	—	—	2	3432 832
	w/8 3/4" dia. Gear 71	8	—	—	—	—	—	—	—	—	—	—	2	3507 557
	RETAINER, w/8 3/4" dia. Gear		2	2	2	2	2	2	2	2	2	2	2	6026 648
3-32-8	BLOCK, Thrust, w/8 3/4" dia. Gear		1	1	1	1	1	1	1	1	1	1	1	2467 268
	w/9 3/4" dia. Gear		1	1	1	1	1	1	1	1	1	1	1	3507 545
3-32-9	SPACER, Thrust Block, w/9 3/4" dia. Gear, w/Sure-Grip, w/426 and 440 Engines 70	8	—	2	—	2	2	—	—	—	—	—	—	2852 517
3-32-12	RIVET, Thrust Spacer, w/9 3/4" dia. Gear 70	8	—	—	—	1	1	—	—	—	—	—	—	104 148
CARLINES	J - Challenger B - Barracuda	V - Valiant L - Dart	R - Belvedere - Satellite W - Coronet - Charger	P - Plymouth D - Dodge	C - Chrysler Y - Imperial									

AR Indicates use as required.

Indicates parts not listed in any previous parts book.

Numerals in parentheses () refer to notes.

★ Indicates change or addition.

Printed in U.S.A.
January 1972

CODE	PART NAME	ENG. TYPE OR CU.IN.	V	B	L	R	W	P	D	C	C	C	Y	PART NUMBER
			1-2	1-2	1-2	1-2	1-2	1-2	1-2	1	2	3	1	
3-32-0 DRIVE SHAFT Cont'd.														
3-32-14	LOCK, Drive Shaft, w/8 1/4" dia. Gear, 1 5/8" dia. Stem, R, W, w/2.45, 2.71 and 3.21 to 1 ratio, P, w/ 2.71 and 3.21 to 1 ratio 70		—	—	—	2	2	2	—	—	—	—	—	2852 883
	w/8 1/4" dia. Gear, 1 5/8" dia. Stem, R, W, w/2.45, 2.71, 2.94 and 3.21 to 1 ratio, P, D, w/2.71 and 3.21 to 1 ratio 71		—	—	—	2	2	2	2	—	—	—	2852 883	
3-33-0 DRIVE SHAFT BEARING														
3-33-1	REPAIR PACKAGE, Drive Shaft Bearing, w/7 1/4" dia. Gear, 1 3/8" dia. Stem, 6 1/2" Brg. w/8 1/4", 8 3/4" and 9 3/4" dia. Gear, Rt.		2	—	2	—	—	—	—	—	—	—	—	= 3420 090
	Lt.		1	1	1	1	1	1	1	1	1	1	—	= 3621 992
	Rt.		1	1	1	1	1	1	1	1	1	1	—	= 3621 993
	Lt.		—	—	—	—	—	—	—	—	—	—	1	= 3683 956
	Lt.		—	—	—	—	—	—	—	—	—	—	1	= 3683 957
	w/7 1/4" dia. Gear 1 3/8" dia. Stem, R1, W1, except Sta. Wgn., 7" Brg.		—	2	—	2	2	—	—	—	—	—	—	= 3420 091
	BEARING, COLLAR and CUP PACKAGE, w/8 1/4" dia. Gear, 1 5/8" dia. Stem, w/1330 Yoke 70		—	—	—	—	—	—	—	—	—	—	2	2808 586
	BEARING, w/COLLAR, w/8 1/4" dia. Gear, 1 5/8" dia. Stem, w/2.45, 2.71 and 3.21 to 1 ratio, 2 1/4" O.D. 70		—	—	—	2	2	—	—	—	—	—	—	2852 949
	w/8 1/4" dia. Gear, 1 5/8" dia. Stem, w/2.45, 2.71, 2.94 and 3.21 to 1 ratio, 2 1/4" O.D., Small Type 71		—	—	—	2	2	—	—	—	—	—	—	2852 949
	w/2.71 and 3.21 to 1 ratio, 2 17/32" O.D., Large Type 71		—	—	—	2	2	2	2	—	—	—	—	2931 851
	w/2.71 and 3.21 to 1 ratio, 2 17/32" O.D. 70		—	—	—	—	—	2	—	—	—	—	—	2931 851
3-33-2	CUP, w/8 3/4" dia. Gear, 2 7/8" O.D. 70		—	2	—	2	2	2	2	2	2	2	2	2467 103
3-33-6	LOCK, Brg. Adj., w/8 3/4" and 9 3/4" dia. Gear		1	1	1	1	1	1	1	1	1	1	1	2467 166
3-33-8	RETAINER, Brg., w/7 1/4" dia. Gear, w/o Slot on Outer Edge 70	6	2	2	2	—	—	—	—	—	—	—	—	2467 096
	w/o Slot on Outer Edge 71	6	2	—	2	—	—	—	—	—	—	—	—	2467 096
	w/Slot on Outer Edge w/7 1/4" dia. Gear, R1, W1, except Sta. Wgn., w/Slot on Outer Edge		2	—	2	—	—	—	—	—	—	—	—	2467 459
	w/8 3/4" dia. Gear, w/3 Holes 70		—	2	—	2	2	—	—	—	—	—	—	2800 437
	w/9 3/4" dia. Gear, Rt. 8		2	—	2	2	—	—	—	—	—	—	—	2881 059
	Lt. 8		—	1	—	1	1	—	—	—	—	—	—	2404 115
	Lt. 8		—	1	—	1	1	—	—	—	—	—	—	2404 475
3-33-10	GASKET, Brg. Retainer, w/9 3/4" dia. Gear, 4 5/8" Width, Steel 8		—	2	—	2	2	—	—	—	—	—	—	2070 933
3-35-0 DRIVE SHAFT OIL SEAL														
3-35-14	OIL SEAL, w/7 1/4" dia. Gear, Inner Steel and Leather		2	—	2	—	—	—	—	—	—	—	—	2404 052
	Steel and Rubber 71		2	—	2	—	—	—	—	—	—	—	—	3432 691
	w/7 1/4" dia. Gear, Inner, 2 19/64" O.D.		—	2	—	2	2	—	—	—	—	—	—	2852 948
	w/8 3/4" dia. Gear, Outer, 2 7/16" O.D.		2	2	2	2	2	2	2	2	2	2	2	2404 216

CARLINES

J - Challenger
B - Barracuda

V - Valiant
L - Dart

R - Belvedere - Satellite
W - Coronet - Charger

P - Plymouth
D - Dodge

C - Chrysler
Y - Imperial

AR Indicates use as required.

Indicates parts not listed in any previous parts book.

Numerals in parentheses () refer to notes.

★ Indicates change or addition.

Printed in U.S.A.
January 1972

