

GROUP 3 - AXLE - REAR

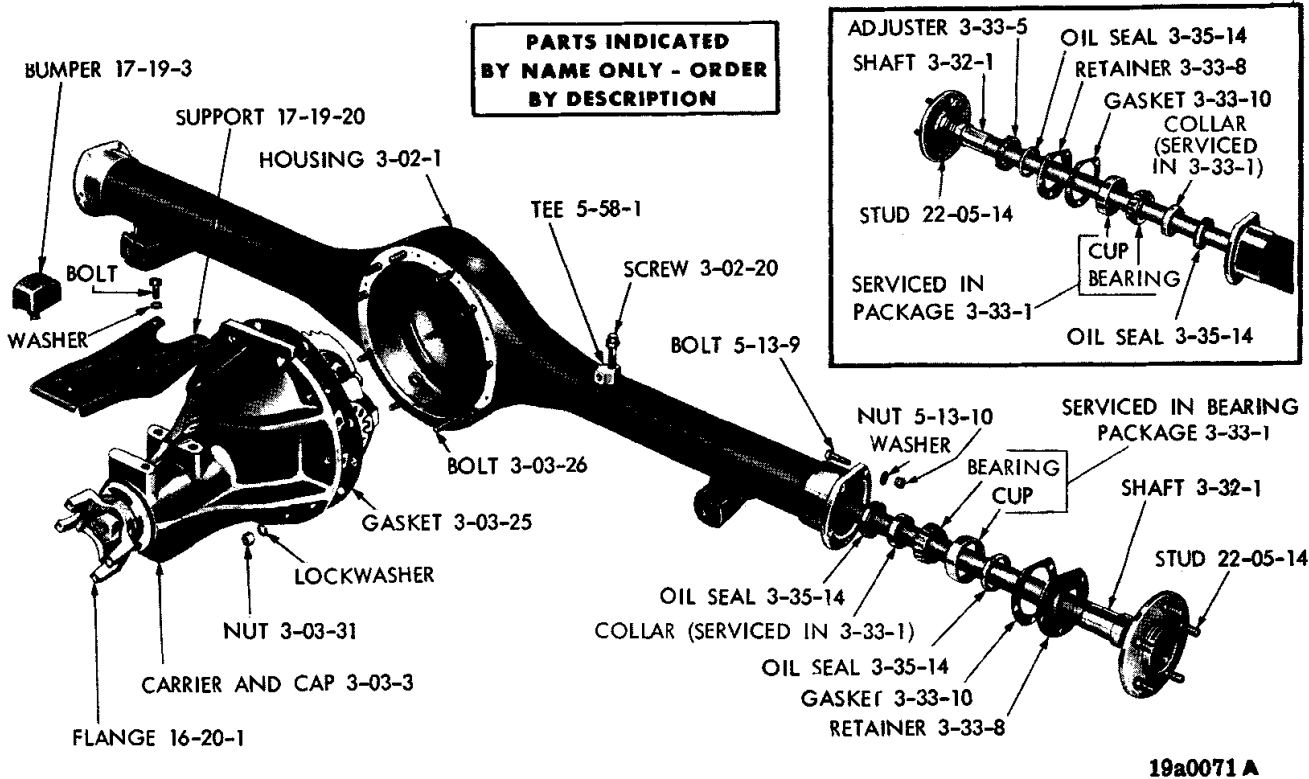

REAR AXLE HOUSING AND CARRIER - EXCEPT VALIANT AND DART

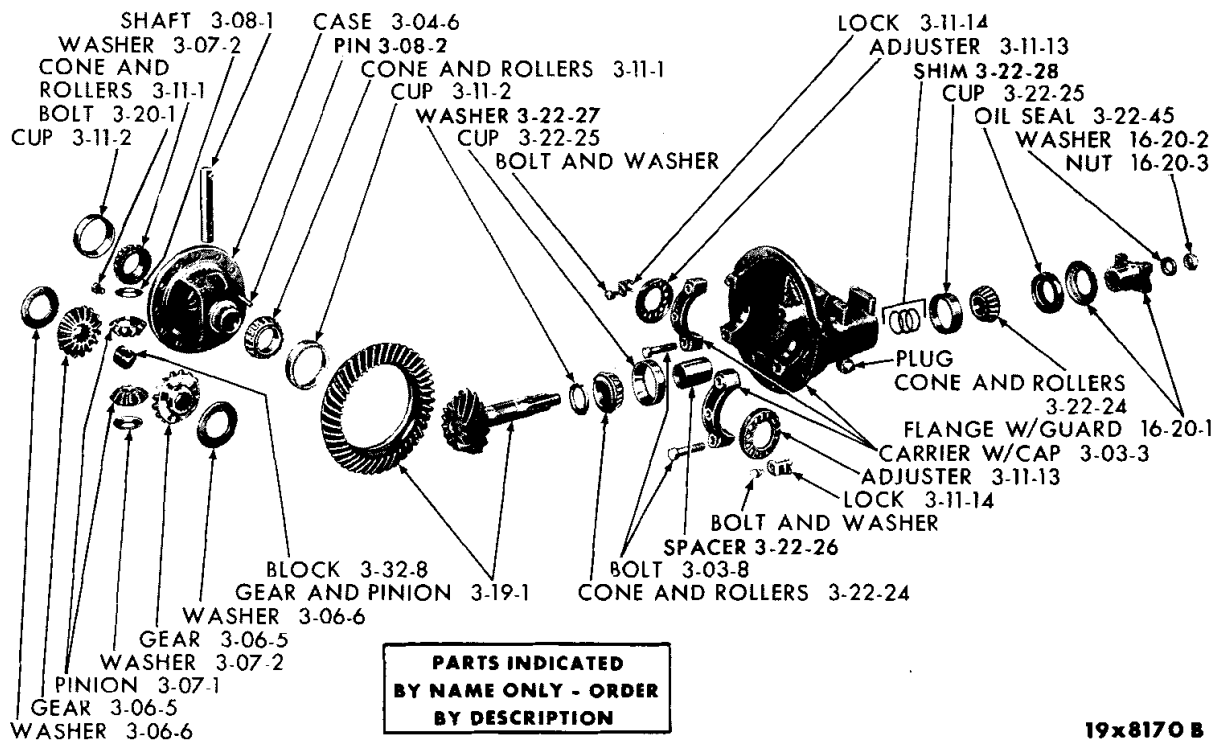

REAR AXLE DIFFERENTIAL - EXCEPT VALIANT AND DART

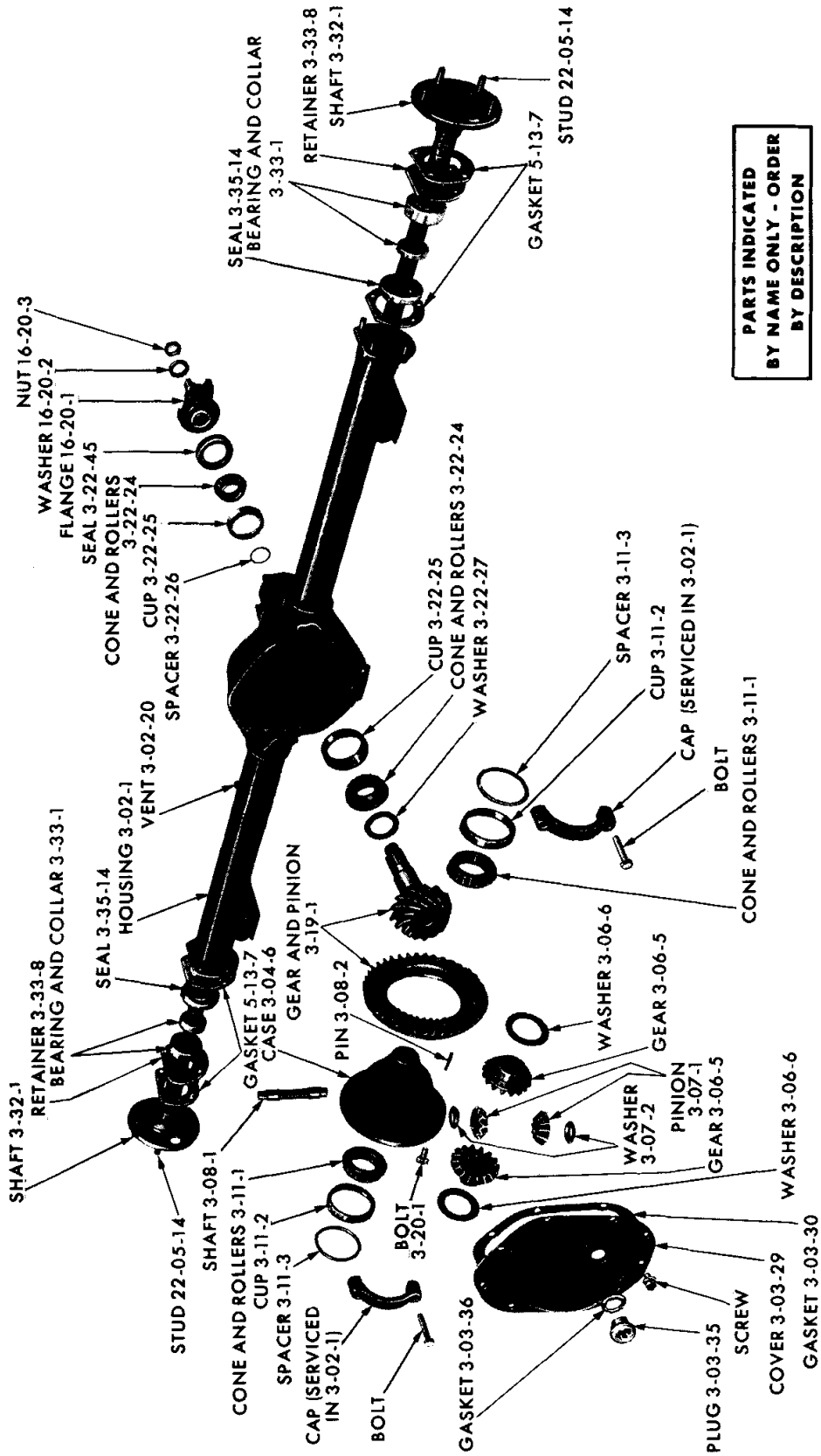

PARTS INDICATED BY NAME ONLY - ORDER BY DESCRIPTION

19x8727G

REAR AXLE DIFFERENTIAL AND CARRIER - VALIANT AND DART

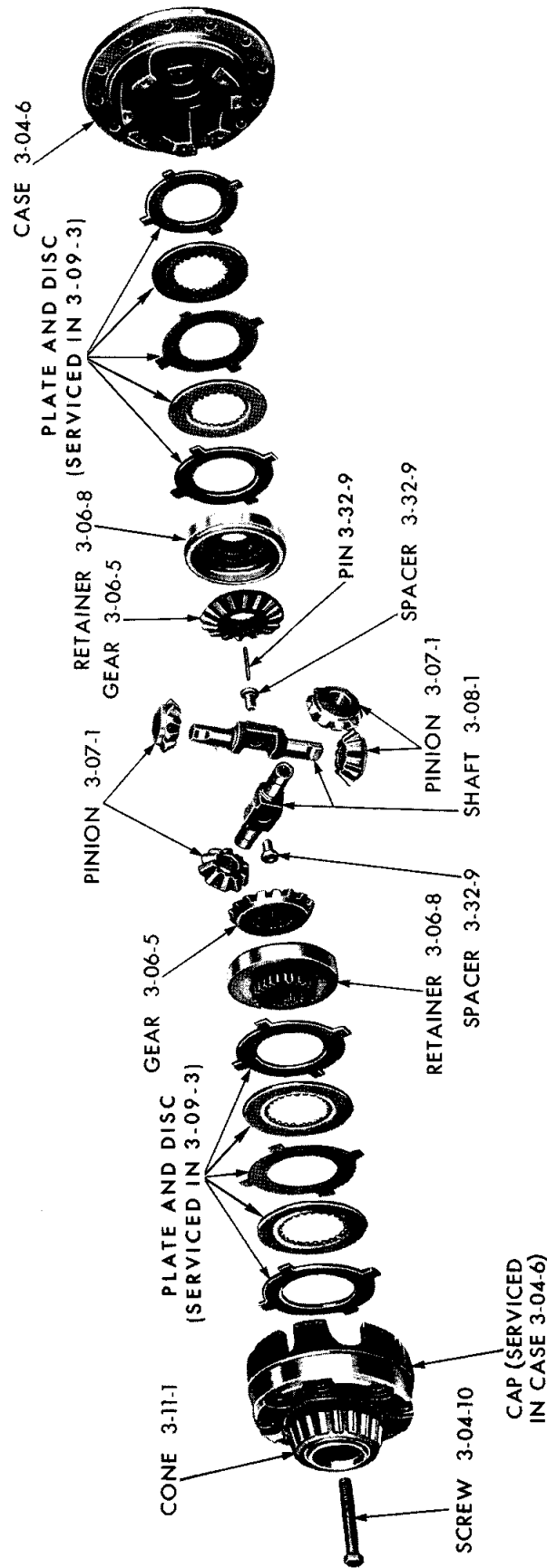

19x8320D

"SURE-GRIP" REAR AXLE DIFFERENTIAL



CODE	PART NAME AND DESCRIPTION	C Y L	PER CAR	VALIANT	PLYMOUTH BELVEDERE	PLYMOUTH FURY	IMPERIAL
				DART	DODGE CORONET	DODGE POLARA	
						CHRYSLER	

NOTE: Two Types of Differentials are being used in production on 8 cylinder cars. With 1 3/8" diameter pinion shaft, the Carrier has part number 1820 657 or 2070 741 embossed 2 inches below the yoke. With 1 3/4" diameter pinion shaft, the Carrier has part number 1634 985 or 2070 742 embossed 2 inches below the yoke.

**3-01-0 REAR AXLE CONTROL STRUT**

3-01-25	STRUT . . . . .		1	-----	-----	-----	1730 160
3-01-28	BUSHING . . . . .		1	-----	-----	-----	1635 600
3-01-30	SPACER, UP TO Ser. No. 129749 . . . . .		★	-----	-----	-----	1731 769
	AFTER Ser. No. 129749 . . . . .		★	-----	-----	-----	2462 334
3-01-33	HANGER, w/BOLTS, UP TO Ser. No. 129749 . .		2	-----	-----	-----	2403 248
	AFTER Ser. No. 129749 . . . . .		2	-----	-----	-----	2462 337
	BRACKET, Frame, Rt. . . . .		1	-----	-----	-----	1829 998
	Lt. . . . .		1	-----	-----	-----	1829 999
3-01-34	BOLT, Hanger . . . . .		8	-----	-----	-----	2403 247
	WASHER . . . . .		8	-----	-----	-----	6022 190

**3-02-0 REAR AXLE HOUSING**

3-02-1	HOUSING . . . . .		1	E2467 414			
			1	-----	2404 143	2404 229	2404 208
3-02-20	SCREW, Vent . . . . .		1	2404 119	2404 119	2404 119	2124 715

**3-03-0 REAR AXLE DIFFERENTIAL AND CARRIER**

3-03-1	DIFFERENTIAL, w/CARRIER and TUBES, 2.93 to 1 ratio . . . . . 3.23 to 1 ratio . . . . . 3.55 to 1 ratio . . . . . 3.91 to 1 ratio . . . . . 3.55 to 1 ratio . . . . . 2.93 to 1 ratio, w/Sure-Grip . . . . . 3.23 to 1 ratio, w/Sure-Grip . . . . .		1	2467 327			
			1	2467 328			
		6	1	2467 138			
		6	1	*2643 134			
		8	1	2467 142			
			1	2467 329			
			1	2467 330			
	2.93 to 1 ratio, w/8 1/4" dia. Gear, except Sta. Wgn. . . . . 3.31 to 1 ratio, w/8 1/4" dia. Gear, except Sta. Wgn. . . . .	6	1	-----	2404 289		
		6	1	-----	2404 290		
	2.94 to 1 ratio, w/8 3/4" dia. Gear, P, D2-L, w/318 cu.in. Engine, C1, C2 . . . . . 3.23 to 1 ratio, w/8 3/4" dia. Gear, P, D, C1 . . . . .		1	-----	E2800 065	E2800 065	
			1	-----	2404 334	2404 334	
	3.55 to 1 ratio, w/ 8 3/4" dia. Gear, 1 3/8" dia. Stem, P, D2-L w/318 cu.in. Engine . . . . .		1	-----	*2404 335	*2404 335	
	3.91 to 1 ratio, w/8 3/4" dia. Gear, 1 3/8" dia. Stem . . . . . 2.76 to 1 ratio, w/8 3/4" dia. Gear, 1 3/4" dia. Stem, P2, D2, C . . . . . 3.55 to 1 ratio, w/ 8 3/4" dia. Gear, 1 3/4" dia. Stem, P, D2 . . . . . 2.76 to 1 ratio, w/Sure-Grip, 8 3/4" dia. Gear, 1 3/8" dia. Stem . . . . . 3.23 to 1 ratio, w/Sure-Grip, 8 3/4" dia. Gear, 1 3/8" dia. Stem . . . . .		1	-----	2404 313		
		8	1	-----	2404 332	2404 332	
			1	-----	-----	2404 335	
		8	1	-----	2070 693		
			1	-----	2070 774		

TYPE LETTERS Indicate: V - Valiant R - Belvedere P - Plymouth C - Chrysler  
L - Dart W - Coronet D - Dodge Y - Imperial

★ Indicates use as required. Numerals in parentheses ( ) refer to notes. Printed in U.S.A.  
 ☐ Indicates parts not listed in any previous parts book. Prices and specifications subject to change without notice.  
 \* Indicates change or addition. March 1966 Supersedes May 1965.

# 1965 PASSENGER CAR PARTS CATALOG

AXLE-REAR

CODE	PART NAME AND DESCRIPTION	C Y L	PER CAR	VALIANT	PLYMOUTH BELVEDERE	PLYMOUTH FURY	IMPERIAL
				DART	DODGE CORONET	DODGE POLARA	

## 3-03-0 REAR AXLE DIFFERENTIAL AND CARRIER - Cont'd

3-03-1	DIFFERENTIAL, w/CARRIER and TUBES - Cont'd 2.94 to 1 ratio, w/Sure-Grip, 8 3/4" dia. Gear, 1 3/8" dia. Stem . . . . .		1	-----	E2800 059		
	2.76 to 1 ratio, w/Sure-Grip, 8 3/4" dia. Gear, 1 3/4" dia. Stem, P, D2, C1, C2, C3 except Sta. Wgn. . . . .	8	1	-----		2404 490	
	3.23 to 1 ratio, w/Sure-Grip, 8 3/4" dia. Gear, 1 3/4" dia. Stem . . . . .		1	-----	2404 492	2404 492	
	3.91 to 1 ratio, w/Sure-Grip, 8 3/4" dia. Gear, 1 3/4" dia. Stem . . . . .	8	1	-----	2404 493		
	4.56 to 1 ratio, w/Sure-Grip, 8 3/4" dia. Gear, 1 3/4" dia. Stem . . . . .	8	1	-----	2467 085		
	2.94 to 1 ratio, 8 3/4" dia. Gear, 1 3/4" dia. Stem . . . . .		1	-----			E2800 065
	2.93 to 1 ratio, w/Sure-Grip, 8 3/4" dia. Gear, 1 3/4" dia. Stem . . . . .		1	-----			2467 362
3-03-2	DIFFERENTIAL, Partial, w/Sure-Grip . . . . .		1	2404 390	2070 824	2070 824	2070 824
3-03-3	CARRIER, w/CAPS, w/8 1/4" dia. Gear, except Sta. Wgn. . . . . w/8 3/4" dia. Gear, w/1 3/8" dia. Stem, D2, C1, except Sta. Wgn., P . . . . . w/8 3/4" dia. Gear, w/1 3/4" dia. Stem . . . . .	6	1	-----	2070 782		
			1	-----	1820 698	1820 698	
			1	-----	1634 984	1634 984	1634 984
3-03-8	SCREW, Cap . . . . .		4	-----	314 948	314 948	314 948
3-03-25	GASKET, Carrier . . . . .		1	-----	1673 367	1673 367	1673 367
3-03-26	BOLT, Housing to Carrier . . . . .		★ 1	----- -----	1135 197	1135 197	1135 197 2404 480
3-03-29	COVER, Carrier . . . . .		1	2070 119			
3-03-30	GASKET, Cover . . . . .		1	2070 120			
3-03-31	NUT, Housing to Carrier Bolt . . . . .		★	-----	1485 066	1485 066	1485 066
3-03-35	PLUG, Carrier Cover Filler, 7/8"-18 . . . . .		1	*1392 371			
3-03-36	GASKET, Plug . . . . .		1	2070 122			

## 3-04-0 DIFFERENTIAL CASE

3-04-6	CASE, UP TO approx. Ser. No. 564338 . . . . .	6	1	2070 537			
	AFTER approx. Ser. No. 564338 . . . . .	6	1	2404 193			
		8	1	2404 193			
	w/Sure-Grip . . . . .		1	2404 414			
	w/2.93 to 1 ratio, w/8 1/4" dia. Gear, except Sta. Wgn. . . . .	6	1	-----	2070 704		
	w/3.31 to 1 ratio, w/8 1/4" dia. Gear, except Sta. Wgn. . . . .	6	1	-----	2070 706		
	w/8 3/4" dia. Gear . . . . .		1	-----	1850 370	1850 370	1850 370
	w/Sure-Grip . . . . .		1	-----	2240 222	2240 222	2240 222
3-04-10	SCREW, Case Cap, w/Sure-Grip . . . . .		8	2404 421	1945 751	1945 751	1945 751

## 3-06-0 DIFFERENTIAL SIDE GEAR

3-06-5	GEAR, UP TO approx. Ser. No. 564338 . . . . .	6	2	2070 023			
	AFTER approx. Ser. No. 564338 . . . . .	6	2	2404 194			
		8	2	2404 194			

TYPE LETTERS indicate: V - Valiant R - Belvedere P - Plymouth C - Chrysler  
L - Dart W - Coronet D - Dodge Y - Imperial

★Indicates use as required. Numerals in parentheses ( ) refer to notes. Printed in U.S.A.  
 †Indicates parts not listed in any previous parts book. Prices and specifications subject to change without notice.  
 March 1966 Supersedes May 1965. \* Indicates change or addition.

CODE	PART NAME AND DESCRIPTION	C Y L	PER CAR	VALIANT	PLYMOUTH BELVEDERE	PLYMOUTH FURY	IMPERIAL
				DART	DODGE CORONET	DODGE POLARA CHRYSLER	
<b>3-06-0 DIFFERENTIAL SIDE GEAR - Cont'd</b>							
3-06-5	GEAR - Cont'd						
	w/Sure-Grip . . . . .		2	2404 418			
	w/8 1/4" dia. Gear, except Sta. Wgn. . . . .	6	2	-----	2404 206		
	w/8 3/4" dia. Gear, Flange dia. 1.686 . . . . .		2	-----	2404 202	2404 202	2404 202
	w/8 3/4" dia. Gear, Flange dia. 1.688 . . . . .		2	-----	2404 203	2404 203	2404 203
	w/Sure-Grip . . . . .		2	-----	1829 448	1829 448	1829 448
3-06-6	WASHER, Thrust, UP TO approx.						
	Ser. No. 564338 . . . . .	6	2	2070 024			
	AFTER approx. Ser. No. 564338 . . . . .	6	2	2404 196			
		8	2	2404 196			
	w/8 1/4" dia. Gear, except Sta. Wgn. . . . .	6	1	-----	2070 820		
	w/8 3/4" dia. Gear . . . . .		2	-----	1633 960	1633 960	1633 960
3-06-8	RETAINER, w/Sure-Grip . . . . .		2	2404 417	1829 447	1829 447	1829 447
<b>3-07-0 DIFFERENTIAL PINION</b>							
3-07-1	PINION, UP TO approx. Ser. No. 564338 . . . . .	6	2	2070 025			
	AFTER approx. Ser. No. 564338 . . . . .	6	2	2404 195			
		8	2	2404 195			
	w/Sure-Grip . . . . .		2	2404 419	1829 449	1829 449	1829 449
	w/8 1/4" dia. Gear, except Sta. Wgn. . . . .	6	2	-----	1326 219		
	w/8 3/4" dia. Gear . . . . .		2	-----	1633 959	1633 959	1633 959
3-07-2	WASHER, UP TO approx. Ser. No. 564338 . . . . .	6	2	2070 026			
	AFTER approx. Ser. No. 564338 . . . . .	6	2	2404 197			
		8	2	2404 197			
	w/8 1/4" dia. Gear, except Sta. Wgn. . . . .	6	2	-----	2070 821		
	w/8 3/4" dia. Gear . . . . .		2	-----	1633 961	1633 961	1633 961
<b>3-08-0 DIFFERENTIAL PINION SHAFT</b>							
3-08-1	SHAFT, UP TO approx. Ser. No. 564338 . . . . .	6	1	2070 027			
	AFTER approx. Ser. No. 564338 . . . . .	6	1	2404 198			
		8	1	2404 198			
	w/Sure-Grip . . . . .		2	2404 420			
	w/8 1/4" dia. Gear, except Sta. Wgn. . . . .	6	1	-----	663 480		
	w/8 3/4" dia. Gear . . . . .		1	-----	*1633 928	*1633 928	*1633 928
	w/Sure-Grip . . . . .		2	-----	1829 446	1829 446	1829 446
3-08-2	PIN, Lock . . . . .		2	152 229			
			1	-----	1633 937	1633 937	1633 937
<b>3-09-0 DIFFERENTIAL CLUTCH PARTS</b>							
3-09-3	REPAIR KIT, Differential, w/Sure-Grip . . . . .		1	2404 427	2070 845	2070 845	2070 845
<b>3-11-0 DIFFERENTIAL BEARINGS</b>							
3-11-1	CONE, w/ROLLERS . . . . .		2	1937 771			
	w/8 1/4" dia. Gear, except Sta. Wgn. . . . .	6	2	-----	698 404		
	w/8 3/4" dia. Gear . . . . .		2	-----	1790 523	1790 523	1790 523
3-11-2	CUP . . . . .		2	1937 770	698 403	698 403	698 403
3-11-3	SPACER, Adjusting, .2500" thk. . . . .		★	2070 848			
	.2520" thk. . . . .		★	2070 849			
	.2540" thk. . . . .		★	2070 082			
	.2560" thk. . . . .		★	2070 441			
	.2580" thk. . . . .		★	2070 442			
	.2600" thk. . . . .		★	2070 084			
	.2620" thk. . . . .		★	2070 443			

TYPE LETTERS Indicate: V - Valiant R - Belvedere P - Plymouth C - Chrysler  
L - Dart W - Coronet D - Dodge Y - Imperial

★ Indicates use as required. Numerals in parentheses ( ) refer to notes. Printed in U.S.A.  
Ⓢ Indicates parts not listed in any previous parts book. Prices and specifications subject to change without notice.  
\* Indicates change or addition. March 1966 Supersedes May 1965.

CODE	PART NAME AND DESCRIPTION	C Y L	PER CAR	VALIANT	PLYMOUTH BELVEDERE	PLYMOUTH FURY	IMPERIAL
				DART	DODGE CORONET	DODGE POLARA CHRYSLER	
<b>3-11-O DIFFERENTIAL BEARINGS - Cont'd</b>							
3-11-3	SPACER - Cont'd						
	.2640" thk. . . . .		★	2070 444			
	.2660" thk. . . . .		★	2070 086			
	.2680" thk. . . . .		★	2070 445			
	.2700" thk. . . . .		★	2070 446			
	.2720" thk. . . . .		★	2070 088			
	.2740" thk. . . . .		★	2070 447			
	.2760" thk. . . . .		★	2070 448			
	.2780" thk. . . . .		★	2070 090			
	.2800" thk. . . . .		★	2070 449			
	.2820" thk. . . . .		★	2070 450			
	.2840" thk. . . . .		★	2070 092			
	.2860" thk. . . . .		★	2070 696			
	.2880" thk. . . . .		★	2070 697			
	.2900" thk. . . . .		★	2070 698			
	.2920" thk. . . . .		★	2070 850			
	.2940" thk. . . . .		★	2070 851			
3-11-13	ADJUSTER . . . . .		2	----	601 864	601 864	601 864
3-11-14	LOCK, Adjuster . . . . .		2	----	308 247	308 247	308 247
<b>3-19-O DRIVE GEAR AND PINION SET</b>							
3-19-1	GEAR and PINION SET, 2.93 to 1 ratio . . . .	6	1	2467 132			
	3.23 to 1 ratio . . . . .	6	1	2467 326			
	3.55 to 1 ratio . . . . .		1	2467 134			
	3.91 to 1 ratio . . . . .	6	1	2467 135			
	2.93 to 1 ratio, w/Sure-Grip . . . . .	6	1	2467 325			
	3.23 to 1 ratio, w/Sure-Grip . . . . .	6	1	2467 326			
	2.93 to 1 ratio . . . . .	8	1	2467 325			
	3.23 to 1 ratio . . . . .	8	1	2467 326			
	2.93 to 1 ratio, 8 1/4" dia. Gear, except Sta. Wgn. . . . .	6	1	----	2070 808		
	3.31 to 1 ratio, 8 1/4" dia. Gear, except Sta. Wgn. . . . .	6	1	----	2070 809		
	2.93 to 1 ratio, 8 3/4" dia. Gear, 1 3/8" dia. Stem, P, D2-L w/318 cu.in. Eng. . . .		1	----	2070 569	2070 569	
	3.23 to 1 ratio, 8 3/4" dia. Gear, 1 3/8" dia. Stem, P, D2, C1 . . . . .		1	----	2070 816	2070 816	
	3.55 to 1 ratio, 8 3/4" dia. Gear, 1 3/8" dia. Stem, P, D2-L w/318 cu.in. Eng. . . .		1	----	2070 915	2070 915	
	3.91 to 1 ratio, 8 3/4" dia. Gear, 1 3/8" dia. Stem . . . . .		1	----	2070 300		
	2.76 to 1 ratio, 8 3/4" dia. Gear, 1 3/8" dia. Stem . . . . .	8	1	----	2070 689		
	2.93 to 1 ratio, 8 3/4" dia. Gear, 1 3/4" dia. Stem, P, D2, C1, C2 . . . . .		1	----	E2643 120	E2643 120	E2643 120
	3.55 to 1 ratio, 8 3/4" dia Gear, 1 3/4" dia. Stem P, D2 . . . . .		1	----	----	2070 916	
	2.76 to 1 ratio, 8 3/4" dia. Gear, 1 3/4" dia. Stem . . . . .	8	1	----	*2070 690	*2070 690	
	3.23 to 1 ratio, 8 3/4" dia., Gear, 1 3/4" dia. Stem . . . . .		1	----	2070 817	2070 817	
	3.91 to 1 ratio, 8 3/4" dia. Gear, 1 3/4" dia. Stem . . . . .	8	1	----	2404 127		
	4.56 to 1 ratio, 8 3/4" dia. Gear, 1 3/4" dia. Stem . . . . .	8	1	----	1738 823		

TYPE LETTERS indicate: V - Valiant R - Belvedere P - Plymouth C - Chrysler  
 L - Dart W - Coronet D - Dodge Y - Imperial

★Indicates use as required. Numerals in parentheses ( ) refer to notes. Printed in U.S.A.  
 EIndicates parts not listed in any previous parts book. Prices and specifications subject to change without notice.  
 \* Indicates change or addition.  
 March 1966 Supersedes May 1965. Page 3-8



CODE	PART NAME AND DESCRIPTION	CYL	PER CAR	VALIANT	PLYMOUTH BELVEDERE	PLYMOUTH FURY	IMPERIAL
				DART	DODGE CORONET	DODGE POLARA CHRYSLER	
<b>3-20-O DRIVE GEAR BOLT</b>							
3-20-1	BOLT . . . . .		12	*1675 485	*1675 485	*1675 485	*1675 485
	w/Sure-Grip . . . . .		12	1945 768	1945 768	1945 768	1945 768
<b>3-22-O DRIVE PINION BEARINGS</b>							
3-22-24	CONE, Front Bearing, w/ROLLERS . . . . .		1	2070 316			
	Rear . . . . .		1	2070 318			
	Front, w/1 3/8" dia. Stem, D2, C1, except Sta. Wgn., P . . . . .		1	----	1820 552	1820 552	
	Rear, w/1 3/8" dia. Stem, D2, C1, except Sta. Wgn., P . . . . .		1	----	1401 809	1401 809	
	Front, w/1 3/4" dia. Stem . . . . .		1	----	1401 808	1401 808	1401 808
	Rear, w/1 3/4" dia. Stem . . . . .		1	----	1404 472	1404 472	1404 472
3-22-25	CUP, Front Bearing . . . . .		1	2070 317			
	Rear . . . . .		1	2070 319			
	Front, w/1 3/8" dia. Stem, D2, C1, except Sta. Wgn., P . . . . .		1	----	1820 551	1820 551	
	Rear, w/1 3/8" dia. Stem, D2, C1, except Sta. Wgn., P . . . . .		1	----	1401 810	1401 810	
	Front, w/1 3/4" dia. Stem . . . . .		1	----	1401 810	1401 810	1401 810
	Rear, w/1 3/4" dia. Stem . . . . .		1	----	1327 847	1327 847	1327 847
3-22-26	SPACER, Front Bearing Adjusting, .074" thk.		★	2070 094			
	.075" thk. . . . .		★	2070 454			
	.076" thk. . . . .		★	2070 095			
	.077" thk. . . . .		★	2070 455			
	.078" thk. . . . .		★	2070 096			
	.079" thk. . . . .		★	2070 456			
	.080" thk. . . . .		★	2070 097			
	.081" thk. . . . .		★	2070 457			
	.082" thk. . . . .		★	2070 098			
	.083" thk. . . . .		★	2070 458			
	.084" thk. . . . .		★	2070 099			
	.085" thk. . . . .		★	2070 459			
	.086" thk. . . . .		★	2070 100			
	.087" thk. . . . .		★	2070 460			
	.088" thk. . . . .		★	2070 101			
	.089" thk. . . . .		★	2070 461			
	.090" thk. . . . .		★	2070 102			
	.091" thk. . . . .		★	2070 462			
	.092" thk. . . . .		★	2070 103			
	.093" thk. . . . .		★	2070 463			
	.094" thk. . . . .		★	2070 104			
	.095" thk. . . . .		★	2070 464			
	.096" thk. . . . .		★	2070 105			
	.097" thk. . . . .		★	2070 465			
	.098" thk. . . . .		★	2070 106			
	.099" thk. . . . .		★	2070 466			
	.100" thk. . . . .		★	2070 107			
	.101" thk. . . . .		★	2070 467			
	.102" thk. . . . .		★	2070 108			
	.103" thk. . . . .		★	2070 468			
	.104" thk. . . . .		★	2070 109			
	.105" thk. . . . .		★	2070 469			
	.106" thk. . . . .		★	2070 110			

TYPE LETTERS indicate: V - Valiant R - Belvedere P - Plymouth C - Chrysler  
 L - Dart W - Coronet D - Dodge Y - Imperial

★ Indicates use as required. Numerals in parentheses ( ) refer to notes. Printed in U.S.A.  
 □ Indicates parts not listed in any previous parts book. Prices and specifications subject to change without notice.  
 \* Indicates change or addition. March 1966 Supersedes May 1965.

Page 3-9

# 1965 PASSENGER CAR PARTS CATALOG

AXLE-REAR

CODE	PART NAME AND DESCRIPTION	CYL	PER CAR	VALIANT	PLYMOUTH BELVEDERE	PLYMOUTH FURY	IMPERIAL
				DART	DODGE CORONET	DODGE POLARA CHRYSLER	
<b>3-22-0 DRIVE PINION BEARINGS - Cont'd</b>							
3-22-26	SPACER, Rear Bearing, w/8 1/4" dia. Stem, except Sta. Wgn. . . . .	6	1	----	2070 709		
	w/8 3/4" dia. Gear, 1 3/8" dia. Stem, D2, C1, except Sta. Wgn., P . . . . .		1	----	1738 826	1738 826	
3-22-27	WASHER, Rear Bearing, .084" thk. . . . .		★	1738 794			
	.086" thk. . . . .		★	1738 795			
	.088" thk. . . . .		★	1738 796			
	.090" thk. . . . .		★	1738 797			
	.092" thk. . . . .		★	1738 798			
	.094" thk. . . . .		★	1738 799			
	.096" thk. . . . .		★	1738 800			
	.098" thk. . . . .		★	1738 801			
	.100" thk. . . . .		★	1738 802			
	w/1 3/8" dia. Stem, .084" thk., D2, C1, except Sta. Wgn., P . . . . .		★	----	1738 794	1738 794	
	w/1 3/8" dia. Stem, .086" thk., D2, C1, except Sta. Wgn., P . . . . .		★	----	1738 795	1738 795	
	w/1 3/8" dia. Stem, .088" thk., D2, C1, except Sta. Wgn., P . . . . .		★	----	1738 796	1738 796	
	w/1 3/8" dia. Stem, .090" thk., D2, C1, except Sta. Wgn., P . . . . .		★	----	1738 797	1738 797	
	w/1 3/8" dia. Stem, .092" thk., D2, C1, except Sta. Wgn., P . . . . .		★	----	1738 798	1738 798	
	w/1 3/8" dia. Stem, .094" thk., D2, C1, except Sta. Wgn., P . . . . .		★	----	1738 799	1738 799	
	w/1 3/8" dia. Stem, .096" thk., D2, C1, except Sta. Wgn., P . . . . .		★	----	1738 800	1738 800	
	w/1 3/8" dia. Stem, .098" thk., D2, C1, except Sta. Wgn., P . . . . .		★	----	1738 801	1738 801	
	w/1 3/8" dia. Stem, .100" thk., D2, C1, except Sta. Wgn., P . . . . .		★	----	1738 802	1738 802	
	w/1 3/4" dia. Stem, .084" thk. . . . .		★	----	1738 812	1738 812	1738 812
	w/1 3/4" dia. Stem, .086" thk. . . . .		★	----	1738 813	1738 813	1738 813
	w/1 3/4" dia. Stem, .088" thk. . . . .		★	----	1738 814	1738 814	1738 814
	w/1 3/4" dia. Stem, .090" thk. . . . .		★	----	1738 815	1738 815	1738 815
	w/1 3/4" dia. Stem, .092" thk. . . . .		★	----	1738 816	1738 816	1738 816
	w/1 3/4" dia. Stem, .094" thk. . . . .		★	----	1738 817	1738 817	1738 817
	w/1 3/4" dia. Stem, .096" thk. . . . .		★	----	1738 818	1738 818	1738 818
	w/1 3/4" dia. Stem, .098" thk. . . . .		★	----	1738 819	1738 819	1738 819
	w/1 3/4" dia. Stem, .100" thk. . . . .		★	----	1738 820	*1738 820	1738 820
3-22-28	SHIM, Front Bearing Adjusting, w/1 3/8" dia. Stem, .014" thk., D2, C1, except Sta Wgn., P . . . . .		★	----	1820 703	1820 703	
	w/1 3/8" dia. Stem, .016" thk., D2, C1, except Sta. Wgn., P . . . . .		★	----	1820 704	1820 704	
	w/1 3/8" dia. Stem, .018" thk., D2, C1, except Sta. Wgn., P . . . . .		★	----	1820 705	1820 705	
	w/1 3/8" dia. Stem, .020" thk., D2, C1, except Sta. Wgn., P . . . . .		★	----	1820 706	1820 706	
	w/1 3/8" dia. Stem, .022" thk., D2, C1, except Sta. Wgn., P . . . . .		★	----	1828 725	1828 725	

TYPE LETTERS Indicate: V - Valiant R - Belvedere P - Plymouth C - Chrysler  
 L - Dart W - Coronet D - Dodge Y - Imperial

★ Indicates use as required. Numerals in parentheses ( ) refer to notes. Printed in U.S.A.  
 ☉ Indicates parts not listed in any previous parts book. Prices and specifications subject to change without notice.  
 March 1966 Supersedes May 1965. Page 3-10 \* Indicates change or addition.

CODE	PART NAME AND DESCRIPTION	CYL	PER CAR	VALIANT	PLYMOUTH BELVEDERE	PLYMOUTH FURY	IMPERIAL
				DART	DODGE CORONET	DODGE POLARA CHRYSLER	
<b>3-22-0 DRIVE PINION BEARINGS - Cont'd</b>							
3-22-28	SHIM - Cont'd						
	w/1 3/8" dia. Stem, .024" thk., D2, C1, except Sta. Wgn., P . . . . .		★	----	1829 440	1829 440	
	w/1 3/8" dia. Stem, .026" thk., D2, C1, except Sta. Wgn., P . . . . .		★	----	1829 441	1829 441	
	w/1 3/4" dia. Stem, .014" thk. . . . .		★	----	1738 805	1738 805	1738 805
	w/1 3/4" dia. Stem, .016" thk. . . . .		★	----	1738 806	1738 806	1738 806
	w/1 3/4" dia. Stem, .018" thk. . . . .		★	----	1738 807	1738 807	1738 807
	w/1 3/4" dia. Stem, .022" thk. . . . .		★	----	1829 442	1829 442	1829 442
	w/1 3/4" dia. Stem, .024" thk. . . . .		★	----	1829 443	1829 443	1829 443
	w/1 3/4" dia. Stem, .026" thk. . . . .		★	----	1829 444	1829 444	1829 444
3-22-45	OIL SEAL, Front Bearing . . . . .		1	2070 113			
	Front Bearing, w/1 3/8" dia. Stem, D2, C1, except Sta. Wgn., P . . . . .		1	----	1738 831	1738 831	
	w/1 3/4" dia. Stem . . . . .		1	----	*2404 135	*2404 135	*2404 135
<b>3-32-0 DRIVE SHAFT</b>							
3-32-1	SHAFT . . . . .		2	2404 442			
			2	----	2404 233	2404 228	2404 139
3-32-8	BLOCK, Thrust . . . . .		1	----	2467 268	2467 268	2467 268
3-32-9	SPACER, Thrust Block, w/Sure-Grip . . . . .		2	----	1829 445	1829 445	1829 445
	PIN, w/Sure-Grip . . . . .		1	----	273 703	273 703	273 703
3-32-13	PLUG, Shaft Access Hole . . . . .		2	----	----	----	2404 437
<b>3-33-0 DRIVE SHAFT BEARINGS</b>							
3-33-1	BEARING, COLLAR and CUP PACKAGE . . . . .		2	2421 349	2525 415	2525 415	2525 415
3-33-5	ADJUSTER, Bearing, Right . . . . .		1	----	2404 160	2404 160	2404 160
3-33-6	LOCK, Adjuster, Right . . . . .		1	----	2467 166	2467 166	2467 166
3-33-8	RETAINER, Bearing, w/9" Brakes . . . . .		2	2467 096			
	w/10" Brakes . . . . .		2	2467 459			
	Right . . . . .		1	----	2404 115	2404 115	2404 115
	Left . . . . .		1	----	2404 475	2404 475	2404 475
3-33-10	GASKET, Bearing Retainer . . . . .		2	----	2070 933	2070 933	2070 933
3-33-11	NUT, Adjuster Lock Bolt . . . . .		2	----	2404 168	2404 168	2404 168
	Bearing Retainer Bolt . . . . .		9	----	1927 232	1927 232	1927 232
<b>3-35-0 DRIVE SHAFT OIL SEAL</b>							
3-35-14	OIL SEAL, Bearing . . . . .		2	2404 052			
	Inner . . . . .		2	----	2404 215	2404 215	2404 215
	Outer . . . . .		2	----	2404 216	2404 216	2404 216

TYPE LETTERS Indicate:

V - Valiant  
L - Dart

R - Belvedere  
W - Coronet

P - Plymouth  
D - Dodge

C - Chrysler  
Y - Imperial

★ Indicates use as required.

□ Indicates parts not listed in any previous parts book.

\* Indicates change or addition.

Prices and specifications subject to change without notice.

Printed in U.S.A.

