

19a0181

PROPELLER SHAFT (TRANSMISSION END) -
PLYMOUTH, DODGE AND CHRYSLER

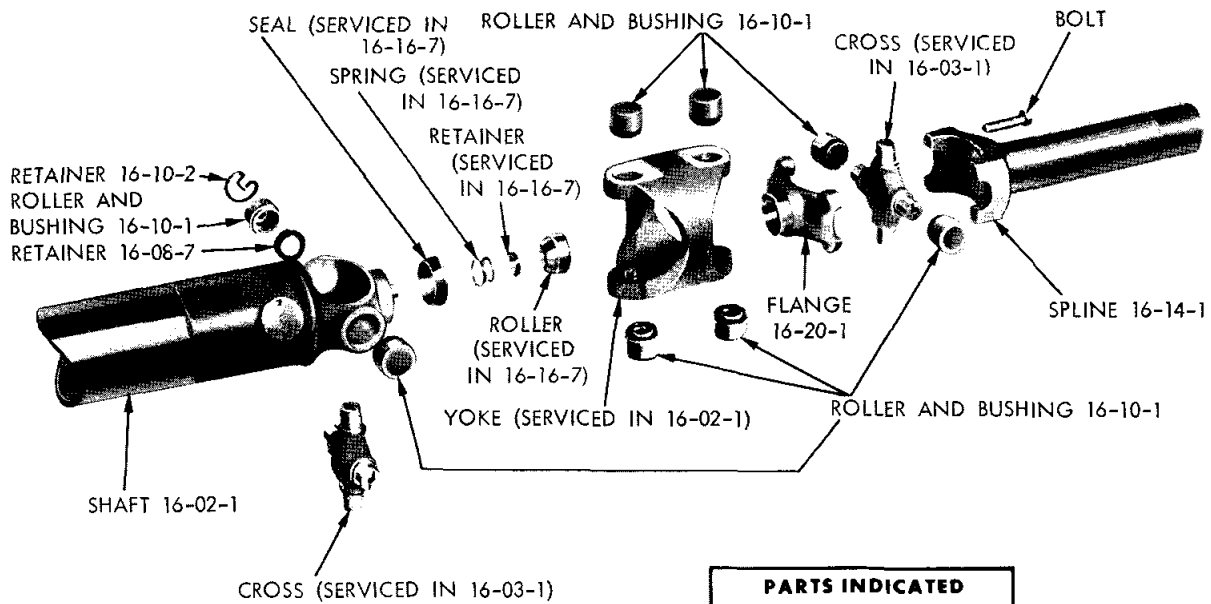

**PARTS INDICATED
BY NAME ONLY - ORDER
BY DESCRIPTION**

19a0180 A

PROPELLER SHAFT (CONSTANT VELOCITY) - CHRYSLER C3-H

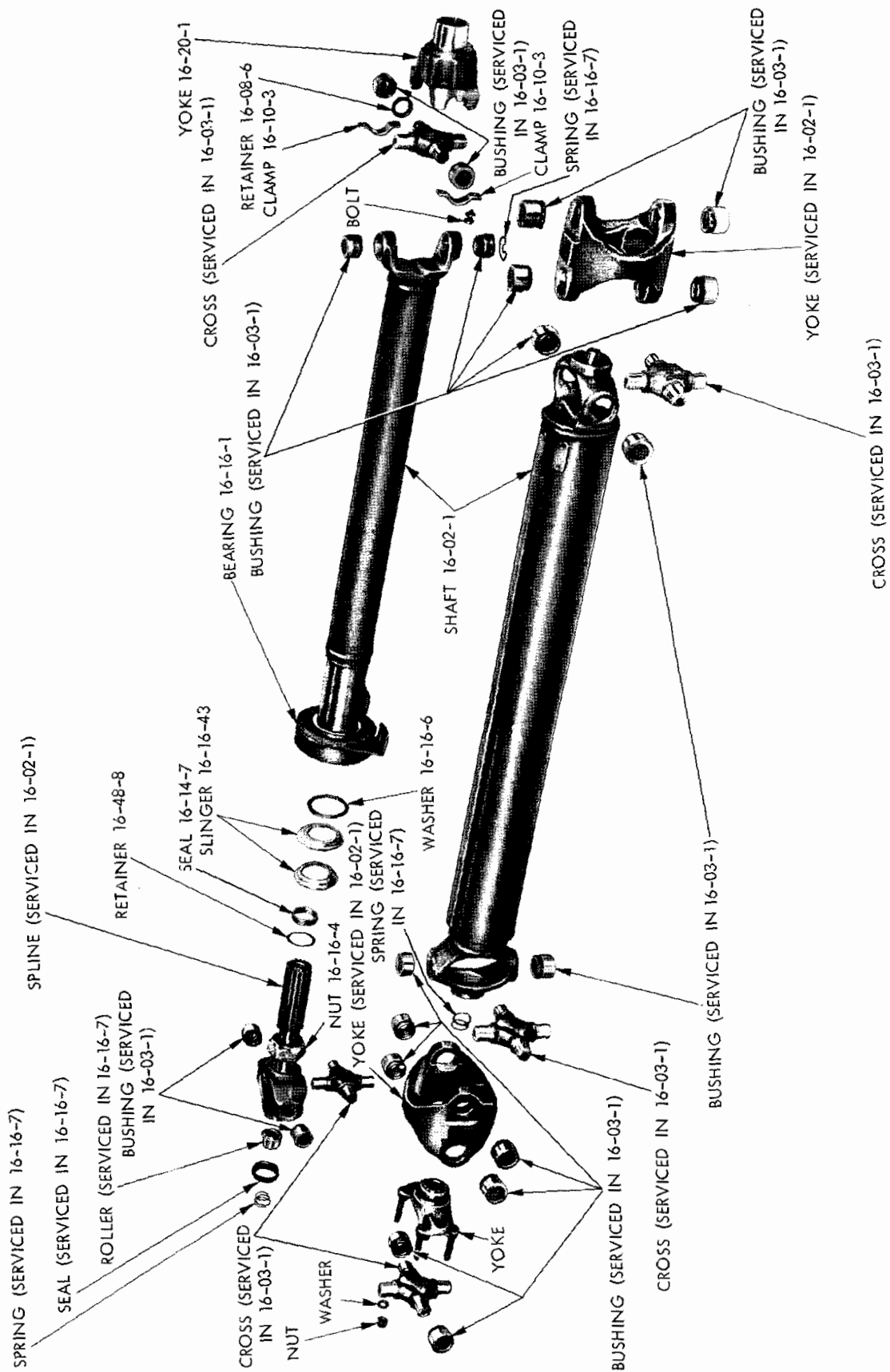

19a0179A

PROPELLER SHAFT CENTER BEARING - IMPERIAL

16-02-0 PROPELLER SHAFT

NOTE 1: When it becomes necessary to service Propeller Shafts or Front Universal Joints on cars equipped with the 426 Cubic Inch Hemispherical Engine and all V8 Engine Police Cars, it is Recommended that the Shaft be Replaced as A Complete Assembly.

NOTE 2: Length measurement of Shafts are from center of Pin hole Trans. End to Center of Bearing Hole Axle End.

CODE	MODEL	CU. IN. ENG.	TRANSMISSION	LENGTH	DIA.	U-JOINTS	PART NO.
16-02-1	SHAFT						
	V1, V2, All, L1, L2 Sta. Wgn.	170, 225, 273	3, 4 Spd. and Auto.	53 13/32 in.	3 in.	With	2530 895
	V1, V2, All, L1, L2, Sta. Wgn.	170, 225	3, 4 Spd. and Auto.	53 13/32 in.	3 in.	w/Out	2206 974
	L1, L2, except Sta. Wgn.	170, 225, 273	3, 4 Spd. and Auto.	58 13/32 in.	2 3/4 in.	With	2405 880
	L1, L2, except Sta. Wgn.	170, 225, 273	3, 4 Spd. and Auto.	58 13/32 in.	3 in.	With	2405 879
	V2 All, L2 Sta. Wgn.	273	3 Spd. Heavy Duty	53 13/32 in.	2 3/4 in.	With	⊕2530 890
	L2 except Sta. Wgn.	273	4 Spd. and Auto.	58 3/8 in.	3 in.	With	2405 879
	V2 All, L2 Sta. Wgn.	273	4 Spd. and Auto.	53 13/32 in.	2 3/4 in.	w/Out	2206 974
	L2 except Sta. Wgn.	273	4 Spd. and Auto.	58 13/32 in.	3 in.	w/Out	2401 462
	R1, R2, All, W1, W2, Sta. Wgn.	225, 273	Auto.	53 7/8 in.	2 3/4 in.	With	⊕2533 190
	R1, R2, All, W1, W2, Sta. Wgn.	225, 273	3 Spd.	55 63/64 in.	3 in.	With	2405 631
	R1, R2, All, W1, W2, Sta. Wgn.	225, 273	3 Spd.	55 63/64 in.	3 in.	w/Out	2405 632
	W1, W2, P1, except Sta. Wgn.	225, 273	3 Spd.	56 7/8 in.	3 in.	With	2530 850
	W1, W2, P1, except Sta. Wgn.	225, 273	Auto.	54 3/4 in.	2 3/4 in.	With	⊕2533 191
	P1, Sta. Wgn.	225	3 Spd.	58 63/64 in.	3 1/4 in.	With	2405 644
P1, Sta. Wgn.	225	Auto.	56 7/8 in.	3 in.	With	2530 850	
R2 All W2 Sta. Wgn.	318, 361, 383, 426	Auto.	53 1/2 in.	2 3/4 in.	With	2533 143	
R1, R2, except Sta. Wgn., Police and Taxi	225, 273	Auto.	53 1/2 in.	2 3/4 in.	With	2533 143	
W1, W2, Sta. Wgn., Police Cars	225, 273	Auto.	53 1/2 in.	2 3/4 in.	With	2533 143	
R2 All, W2 Sta. Wgn. Police Cars	318, 361, 383	Auto.	53 1/2 in.	2 3/4 in.	With	2533 143	
R2 All, W2 Sta. Wgn.	318, 361, 383	3 Spd.	56 in.	3 in.	With	2405 634	
W2, except Sta. Wgn.	318, 361, 383	3 Spd.	56 13/16 in.	3 in.	With	2530 862	
W1, W2, except Sta. Wgn., Police and Taxi	225, 273	Auto.	54 3/8 in.	2 3/4 in.	With	2533 144	
W2, except Sta. Wgn.	318, 361, 383, 426	Auto.	54 3/8 in.	2 3/4 in.	With	2533 144	
R2 All, W2 Sta. Wgn.	361, 383, 426	4 Spd.	53 7/8 in.	3 in.	With	2405 640	
R2, W2, Hemispherical	426	Auto.	53 in.	3 in.	With	*2530 885	
R2, W2, Hemispherical	426	4 Spd.	53 in.	3 in.	With	*2530 868	

TYPE LETTERS Indicate: V - Valiant R - Belvedere P - Plymouth C - Chrysler
 L - Dart W - Coronet D - Dodge Y - Imperial

★Indicates use as required. Numerals in parentheses () refer to notes. Printed in U.S.A.
 ⊕Indicates parts not listed in any previous parts book. Prices and specifications subject to change without notice.
 * Indicates change or addition. March 1966 Supersedes May 1965.

16-02-0 PROPELLER SHAFT - Cont'd

CODE	MODEL	CU. IN. ENG.	TRANSMISSION	LENGTH	DIA	U-JOINTS	PART NO.
16-02-1	SHAFT - Cont'd						
	P1, P2, except Sta. Wgn.	318, 383, 426	Auto.	54 1/8 in.	2 3/4 in.	With	2533 134
	P1, P2, Sta. Wgn.	225, 318, 383, 426	Auto.	56 3/16 in.	3 in.	With	2660 588
	D2	318, 383, 413	3 Spd.	58 7/8 in.	3 1/4 in.	With	2533 154
	D2, w/4 bbl. Carb.	383, 413, 426	Auto.	56 3/16 in.	2 3/4 in.	With	*2660 580
	D2	383, 426	4 Spd.	56 7/8 in.	3 1/4 in.	With	2530 871
	P2, Sta. Wgn.	383, 413, 426	3 Spd.	58 7/8 in.	3 1/4 in.	With	2533 154
	D2, w/2 bbl. Carb.	383	Auto.	56 3/16 in.	3 in.	With	2660 588
	D2, w/4 bbl. Carb., 2.76 to 1 Axle Ratio	318, 383	Auto.	56 3/16 in.	2 3/4 in.	With	*2660 580
	P2, except Sta. Wgn.	318, 383, 426	3 Spd.	56 7/8 in.	3 1/4 in.	With	2530 871
	P2, Sta. Wgn.	318, 383, 426	4 Spd.	56 7/8 in.	3 1/4 in.	With	2530 871
	D2, California Police	383, 413	Auto.	56 11/16 in.	3 in.	With	*2533 213
	W2, P2, except Sta. Wgn.	361, 383, 426	4 Spd.	54 3/4 in.	3 in.	With	2530 865
	C1, except Sta. Wgn.	383	Auto.	58 3/16 in.	3 in.	With	2660 590
	C1, Sta. Wgn.	383	3 Spd.	58 7/8 in.	3 1/4 in.	With	2533 154
	C1, Sta. Wgn.	383	4 Spd.	56 7/8 in.	3 1/4 in.	With	2530 871
	C1, except Sta. Wgn.	383	4 Spd.	58 7/8 in.	3 1/4 in.	With	2533 154
	C1, Sta. Wgn.	383	3 Spd.	58 7/8 in.	3 1/4 in.	With	2533 154
	C1, Sta. Wgn.	383	Auto.	56 3/16 in.	2 3/4 in.	With	*2660 580
	C2	383, 413	Auto.	58 13/32 in.	3 in.	With	2660 590
	C1, C2, except Sta. Wgn.	383, 413	3 Spd.	60 7/8 in.	3 1/4 in.	With	2530 878
	C2	383, 413	4 Spd.	58 7/8 in.	3 1/4 in.	With	2533 154
	C2, C3, except Sta. Wgn.	383, 413	Auto.	55 1/4 in.	3 1/4 in.	With	2660 589
	C3, Sta. Wgn.	413	Auto.	53 11/16 in.	3 1/4 in.	With	2530 923
	C1, Sta. Wgn. w/2, 4 bbl. Carb. 2.76 to 1 Axle Ratio	383	Auto.	56 3/16 in.	2 3/4 in.	With	2660 580
	C1, except Sta. Wgn. w/2 and 4 bbl. Carb. 2.76 to 1 Axle Ratio	383	Auto.	58 1/8 in.	2 3/4 in.	With	2660 584
	Y1	413	Auto.	61 5/8 in.	---	With	2533 201

CODE	PART NAME AND DESCRIPTION	C Y L	PER CAR	VALIANT	PLYMOUTH BELVEDERE	PLYMOUTH FURY	IMPERIAL
				DART	DODGE CORONET	DODGE POLARA CHRYSLER	
16-02-5	BOLT, Trans. Flange, 3/8"-24 x 1 1/8" lgh., 3/4" Round Head		4	2466 208	2466 208		
	3/8"-24 x 1 1/8" lgh., Round Head		4	1942 069	1942 069	1942 069	
	Axle End, 1/4"-28 x 5/8" lgh., Hex. Head		4	2460 883	2460 883	2460 883	2460 883
	STUD, Propeller Shaft Yoke, Trans. End, Y3		8	-----	-----	-----	⊖6025 420
	NUT, Propeller Shaft Yoke Stud, Y3		8	-----	-----	-----	⊖6025 421
16-03-0 UNIVERSAL JOINT							
16-03-1	JOINT PACKAGE, Ball and Pin Type, w/170, 225, 273, cu. in. Eng.		1	2298 940	2298 940	2298 940	
	w/318, 361, 383, 426 cu. in. Eng.		8	-----	2298 941	2298 941	
	Cross and Roller Type, except Y1		★	1752 624	1752 624	1752 624	
	Cross and Roller, Rear, C3		1	-----	-----	1752 624	
	CROSS and BEARING KIT, Universal Joint						
	Needles, Constant Velocity, Y1, C3		5	-----	-----	*2533 202	*2533 202
	Front, C2, C3		8	-----	-----	2533 202	

TYPE LETTERS Indicate: V - Valiant R - Belvedere P - Plymouth C - Chrysler
 L - Dart W - Coronet D - Dodge Y - Imperial

★ Indicates use as required. Numerals in parentheses () refer to notes. Printed in U.S.A.
 ⊖ Indicates parts not listed in any previous parts book. Prices and specifications subject to change without notice.
 * Indicates change or addition.
 March 1966 Supersedes May 1965.

CODE	PART NAME AND DESCRIPTION	C Y L	PER CAR	VALIANT	PLYMOUTH BELVEDERE	PLYMOUTH FURY	IMPERIAL
				DART	DODGE CORONET	DODGE POLARA	
16-03-0 UNIVERSAL JOINT - Cont'd							
16-03-3	ROLLER PACKAGE		★	638 637	638 637	638 637	
16-03-7	PIN, Universal Joint, w/170, 225, 273 cu. in. Eng., 2 5/8" lgh., 19/32" dia.		1	579 445	579 445	579 445	
	w/318, 361, 383, 413, 426 cu. in. Eng., 2 7/8" lgh., 19/32" dia.	8	1	-----	1739 923	1739 923	
16-03-10	BALL and ROLLER		2	1739 927	1739 927	1739 927	
16-03-16	WASHER, Thrust		2	605 004	605 004	605 004	
16-03-19	COVER, Universal Grease		1	602 820			
		6	1	-----	2266 923		
		6	1	-----	-----	2266 923	
		8	1	-----	2266 922	2266 922	
16-03-20	GASKET, Universal Joint, w/170, 225, 273 cu. in. Eng.		1	1616 185	1616 185	1616 185	
	w/318, 361, 383, 426 cu. in. Eng.	8	1	-----	1635 098	1635 098	
16-04-0 UNIVERSAL JOINT BODY							
16-04-1	BODY, w/170, 225, 273 cu. in. Eng.		1	*1734 159	*1734 159	*1734 159	
	w/318, 361, 383, 426 cu. in. Eng.	8	1	-----	1739 920	1739 920	
16-06-0 UNIVERSAL JOINT CENTERING BUTTON							
16-06-1	BUTTON, Centering, w/170, 225, 273 cu. in. Eng.		1	* 629 768			
		6	1	-----	629 768	629 768	
	w/318, 361, 383, 426 cu. in. Eng., C1, C2 . . .	8	1	-----	1739 924	1739 924	
16-06-3	SPRING, Centering Button, C1, C2		2	1739 926	1739 926	1739 926	
16-07-0 UNIVERSAL JOINT COVER							
16-07-3	CLAMP, Dust Cover, 1 5/8" I.D.		1	870 540	870 540	870 540	
	2 1/2" I.D.		1	870 539	870 539		
	2 3/4" I.D.	8	1	1532 943	1532 943	1532 943	
16-07-4	COVER PACKAGE, Dust, w/170, 225, 273 cu. in. Eng.		1	1603 397	1603 397	1603 397	
	w/318, 361, 383, 426 cu. in. Eng.	8	1	-----	2275 514	2275 514	
16-08-0 UNIVERSAL JOINT CROSS							
16-08-6	SEAL, Dust		4	857 999	857 999	857 999	
16-08-7	RETAINER, Dust Seal		4	1739 912	1739 912	1739 912	
	Rear, C3		1	-----	-----	1739 912	
16-10-0 UNIVERSAL JOINT CROSS ROLLER AND BUSHING							
16-10-1	ROLLER and BUSHING		★	1739 913	1739 913	1739 913	
	Rear, C3		★	-----	-----	1739 913	
16-10-2	RETAINER, Roller and Bushing		★	858 006	858 006	858 006	
	Rear, C3		2	-----	-----	858 006	
16-10-3	CLAMP, Roller and Bushing		2	1828 824	1828 824	1828 824	
	Rear, C3		1	-----	-----	1828 824	
	Trans. End		2	-----	-----	-----	2533 181

TYPE LETTERS Indicate: V - Valiant R - Belvedere P - Plymouth C - Chrysler
L - Dart W - Coronet D - Dodge Y - Imperial

★ Indicates use as required. Numerals in parentheses () refer to notes. Printed in U.S.A.
 Ⓜ Indicates parts not listed in any previous parts book. Prices and specifications subject to change without notice.
 * Indicates change or addition. March 1966 Supersedes May 1965.

CODE	PART NAME AND DESCRIPTION	C Y L	PER CAR	VALIANT	PLYMOUTH BELVEDERE	PLYMOUTH FURY	IMPERIAL
				DART	DODGE CORONET	DODGE POLARA	
						CHRYSLER	
16-14-0 PROPELLER SHAFT SPLINE OR SLIDING YOKE							
16-14-1	YOKE, w/225, 273, 318, 361, 383, 413, 426 cu. in. Eng., w/Auto. Trans., except C3		1	-----	2405 665	E2660 669	
	w/383, 413 cu. in. Eng., C2, C3	8	1	-----	-----	2460 929	
	w/413 cu. in. Eng., Y1	8	1	-----	-----	-----	*1739 915
16-14-7	SEAL, Spline Oil		1	-----	-----	-----	2533 208
16-14-8	RETAINER, Spline Oil Seal		1	-----	-----	-----	2533 209
16-16-0 PROPELLER SHAFT CENTER BEARING							
16-16-1	BEARING, Centering		1	-----	-----	-----	2533 204
16-16-4	NUT, Centering Bearing Lock		1	-----	-----	-----	2533 207
16-16-6	WASHER, Bearing Lock		1	-----	-----	-----	2533 206
16-16-7	CENTERING REPLACEMENT KIT		★	-----	-----	-----	2533 203
	CENTERING REPLACEMENT KIT, C2, C3	8	1	-----	-----	2533 203	
16-16-43	SLINGER, Centering Bearing Dust		2	-----	-----	-----	2533 205
16-17-0 PROPELLER SHAFT CENTER BEARING INSULATOR							
16-17-1	INSULATOR, Center Bearing, except Cv. Cp.		1	-----	-----	-----	1945 831
	Cv. Cp.		1	-----	-----	-----	1856 942
16-20-0 PROPELLER SHAFT FLANGE							
16-20-1	FLANGE, Trans. Output, V1, L1, w/170, 225 cu. in. Eng., Auto. Trans.	6	1	2464 438			
	V2, L2, w/273 cu. in. Eng., Auto. Trans.	8	1	2464 438			
	V1, L1, w/170, 225 cu. in. Eng., 3 Speed Trans.	6	1	2400 964			
	V1, V2, L1, L2, w/225, 170 cu. in. Eng., 4 Speed Trans.		1	2400 977			
	R1, W1, R2, W2, P1, w/225, 273 cu. in. Eng., 3 Speed Heavy Duty Trans.	8	1	-----	*2400 977		
	R1, W1, P1, w/225 cu. in. Eng., 3 Speed Trans.	6	1	-----	2400 976		
	R2, W2, P2, w/318, 361, 383, 426, cu. in. Eng., 3 Speed Trans.	8	1	-----	*2400 978		
	R2, W2, w/361, 383, 413 cu. in. Eng., 4 Speed Trans.	8	1	-----	2400 978		
	R1, W1, w/170 cu. in. Eng., Auto. Trans.	6	1	-----	2466 762		
	R2, W2, w/273 cu. in. Eng., Auto. Trans.	8	1	-----	2466 762		
	R1, W1, P1, w/225 cu. in. Eng., Auto. Trans.	6	1	-----	2466 762	2466 762	
	D2, C1, C2, w/361, 383, 413 cu. in. Eng., 3 Speed Trans.	8	1	-----	-----	2400 978	
	P2, D2, C1, w/361, 383, 413 cu. in. Eng., 4 Speed Trans.	8	1	-----	-----	2400 978	
	YOKE, Trans. Output	8	1	-----	-----	-----	2405 674
	FLANGE PACKAGE, Axle Pinion, w/27 Splines		1	2240 614			
	YOKE, Axle Pinion, w/Oil Seal GUARD, 10 Splines		1	-----	2404 479	2404 479	
			1	-----	-----	-----	2467 256
16-20-8	NUT PACKAGE, Trans. Output Flange, includes WASHER		1	2298 967	2298 967	2298 967	2298 967
	NUT, Axle Pinion Flange		1	1556 638	1556 638	1556 638	1556 638
	WASHER, Axle Flange		1	1556 556	1556 556	1556 556	1556 556

TYPE LETTERS Indicate:

V - Valiant
L - Dart

R - Belvedere
W - Coronet

P - Plymouth
D - Dodge

C - Chrysler
Y - Imperial

★Indicates use as required.

EIndicates parts not listed in any previous parts book.
March 1966 Supersedes May 1965.

Numerals in parentheses () refer to notes.

Prices and specifications subject to change without notice.

Printed in U.S.A.

* Indicates change or addition.