

SHORT ENGINE - V8 CYLINDER

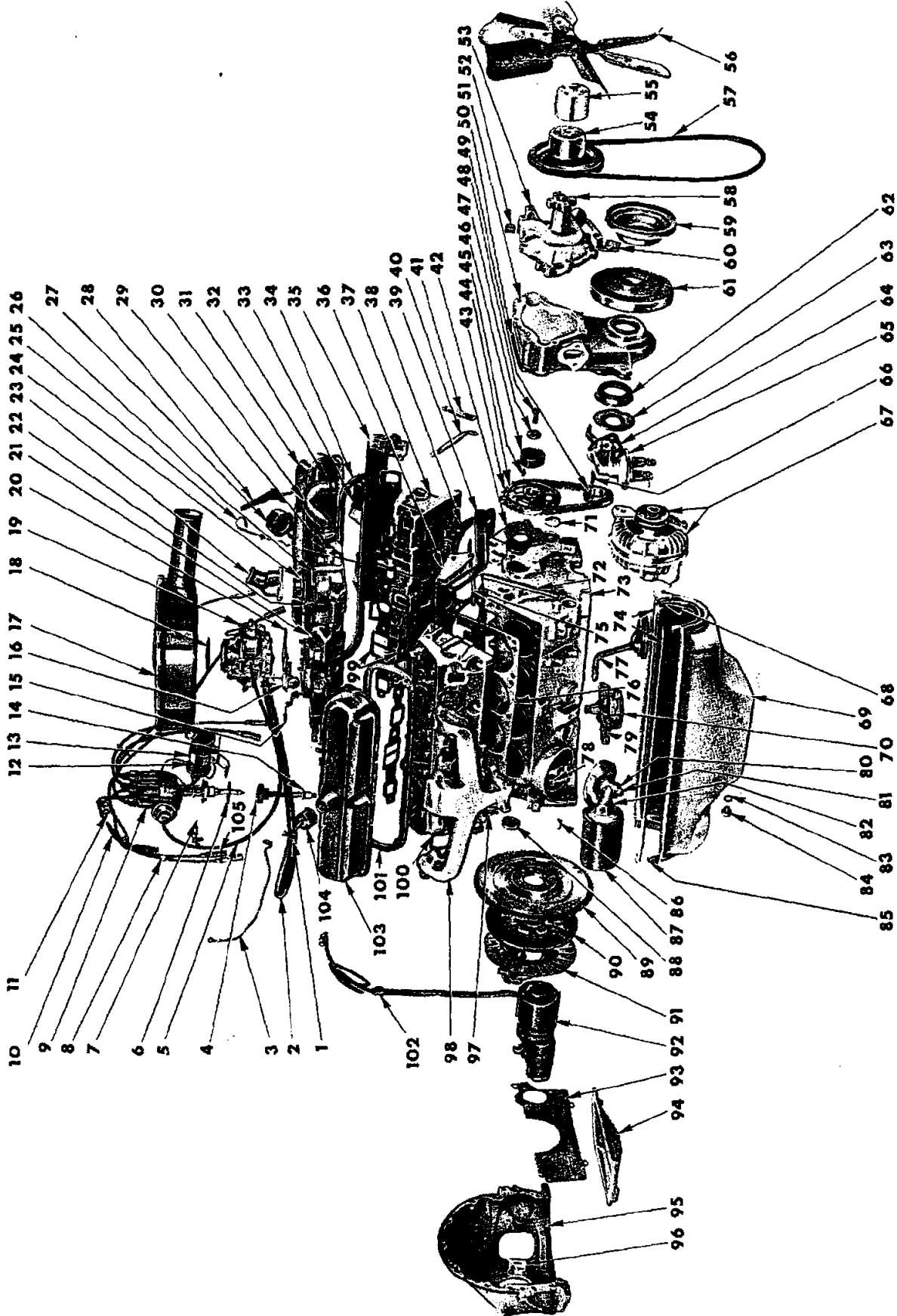

191-6983

ENGINE EXTERNAL PARTS (V8 CYLINDER) - 273 CU. IN. DISPLACEMENT

ENGINE EXTERNAL PARTS (V8 CYLINDER) - 273 CU. IN. DISPLACEMENT

Ref. No.	Name	Part Type Code	Ref. No.	Name	Part Type Code
1	Clamp		54	Pulley	7-06-14
2	Hose	10-02-53	55	Spacer	7-02-16
3	Cable	Not Serviced	56	Fan	7-02-1
4	Shaft	10-09-1	57	Belt	7-03-1
5	Tube	8-37-320	58	Hub	7-05-1
6	Gasket	8-27-4	59	Pulley	7-06-1
7	Clamp	8-27-26	60	Indicator	9-23-40
8	Grommet	8-36-92	61	Damper	9-13-5
9	Distributor	8-27-1	62	Oil Seal	9-23-18
10	Cable Set	8-36-1	63	Oil Slinger	9-07-17
11	Bracket	8-36-4	64	Gasket	14-74-1
12	Coil	8-35-4	65	Pump	14-73-1
13	Bracket	8-35-41	66	Key	9-08-5
14	Bushing	10-09-7	67	Alternator	8-28-3
15	Bracket	14-26-6	68	Gasket	10-24-1
16	Choke	14-39-45	69	Pan	10-24-4
17	Air Cleaner	14-29-2	70	Cover	10-07-7
18	Gasket	14-29-5	71	Plug	9-02-16
19	Carburetor	14-30-1	72	Tube	10-03-7
20	Gasket	14-30-2	73	Block (Serviced in 9-01-24)	
21	Manifold	9-48-7	74	Gasket	10-24-1
22	Sending Unit	8-37-155	75	Gasket (Serviced in 9-50-1)	
23	Elbow	9-05-5	76	Gasket	9-03-5
24	Thermostat	7-41-4	77	Strainer w/Pipe	10-23-7
25	Indicator	10-03-4	78	Plug	
26	Gasket	9-05-6	79	Pump	10-07-6
27	Air Cleaner	10-01-21	80	Gasket	10-07-8
28	Bracket	14-06-10	81	Bolt	
29	Nipple	7-48-22	82	Base	10-26-12
30	By-Pass Hose	7-14-9	83	Gasket	10-24-38
31	Cover	9-03-28	84	Plug	10-24-37
32	Clamp		85	Gasket	10-24-1
33	Gasket	9-50-5	86	Plug	9-02-17
34	Gasket	9-03-29	87	Filter	10-26-6
35	Manifold	9-48-6	88	Plug	9-16-17
36	Bracket	8-28-36	89	Flywheel	9-45-1
37	Head	9-03-4	90	Disc	6-13-1
38	Gasket	9-03-5	91	Plate	6-14-1
39	Strap	8-28-15	92	Starting Motor	8-52-4
40	Brace	9-48-155	93	Seal	6-10-10
41	Brace	9-48-155	94	Pan	6-10-2
42	Block (Serviced in 9-01-24)		95	Housing	6-09-1
43	Chain	9-20-1	96	Pivot	6-22-15
44	Sprocket	9-17-5	97	Counterweight	9-58-12
45	Key	9-17-5	98	Manifold	9-48-6
46	Eccentric	9-15-2	99	Gasket (Serviced in 9-50-1)	
47	Washer	9-15-10	100	Gasket	9-50-5
48	Screw		101	Gasket	9-03-29
49	Sprocket	9-08-5	102	Cable	8-01-17
50	Gasket	9-23-17	103	Cover	9-03-28
51	Cover	9-23-5	104	Cap	10-02-66
52	Nipple	7-48-22	105	Nipple	8-36-96
53	Pump	7-42-1			

PARTS INDICATED BY NAME ONLY - ORDER BY DESCRIPTION

19L9984

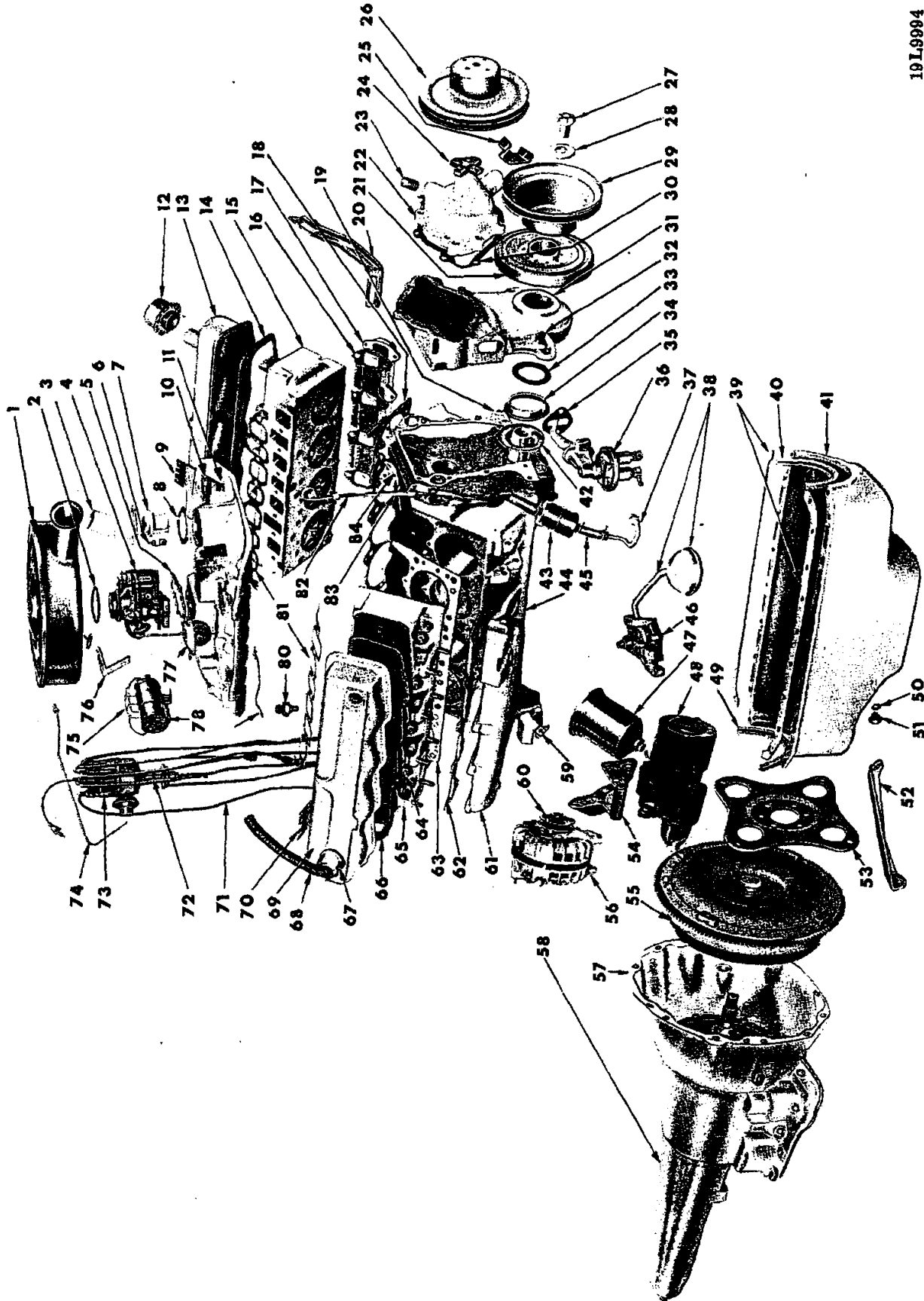

ENGINE EXTERNAL PARTS (V8 CYLINDER) - 318 CU. IN. DISPLACEMENT

ENGINE EXTERNAL PARTS (V8 CYLINDER) - 318 CU. IN. DISPLACEMENT

Ref. No.	Name	Part Type Code	Ref. No.	Name	Part Type Code
1	Air Cleaner	14-29-7	43	Filter	14-67-1
2	Gasket	14-29-5	44	Block (Serviced in 9-01-24)	
3	Elbow	9-05-5	45	Hose	14-67-2
4	Carburetor	14-30-1	46	Pump	10-07-6
5	Gasket	14-30-2	47	Filter	10-26-6
6	Sending Unit	8-37-155	48	Starter	8-52-4
7	Thermostat	7-41-4	49	Gasket (Serviced in 10-24-1)	
8	Gasket	9-05-6	50	Gasket	10-24-36
9	Bracket	8-36-4	51	Plug	10-24-37
10	Nipple	7-48-22	52	Bracket	21-03-28
11	Manifold	9-48-6	53	Plate	9-46-8
12	Air Cleaner	10-01-21	54	Bracket	8-28-36
13	Cover	9-03-28	55	Torque Converter	9-46-4
14	Gasket	9-03-29	56	Alternator	8-28-3
15	Head	9-03-4	57	Case, Transmission	21-03-1
16	Gasket	9-50-5	58	Extension, Transmission	21-04-1
17	Manifold	9-48-6	59	Shield	9-58-12
18	Gasket	9-03-5	60	Pulley	8-28-3
19	Gasket	9-23-17	61	Manifold	9-48-6
20	Strap	8-28-15	62	Gasket	9-50-5
21	Damper	9-13-5	63	Gasket	9-03-5
22	Pump, Water	7-42-1	64	Spark Plug	8-36-114
23	Nipple	7-48-22	65	Head	9-03-4
24	Hub	7-05-1	66	Gasket	9-03-29
25	Indicator	9-23-40	67	Cap	10-02-66
26	Pulley	7-06-14	68	Hose	10-02-53
27	Screw	9-07-8	69	Cover	9-03-28
28	Washer	9-07-22	70	Bracket	8-36-4
29	Pulley	7-06-1	71	Cable Set	8-36-1
30	Gasket	7-44-3	72	Distributor	8-27-4
31	Cover	9-23-5	73	Cap	8-27-71
32	Screw		74	Ground Cable	Not Serviced
33	Gasket (Serviced in 9-23-18)		75	Resistor	8-35-22
34	Oil Seal	9-23-18	76	Bracket	14-06-10
35	Gasket	14-74-1	77	Choke	14-39-45
36	Pump Package	14-73-1	78	Coil	8-35-4
37	Tube	14-89-2	79	Gasket (Serviced in 9-50-1)	
38	Strainer w/Pipe	10-23-7	80	Switch	8-53-327
39	Gasket Set	10-24-1	81	Gasket (Serviced in 9-50-1)	
40	Gasket Set	10-24-1	82	Indicator	10-03-4
41	Pan	10-24-4	83	Tube	10-03-7
42	Oil Slinger	9-07-17	84	Gasket (Serviced in 9-50-1)	

PARTS INDICATED BY NAME ONLY - ORDER BY DESCRIPTION

19L 9995

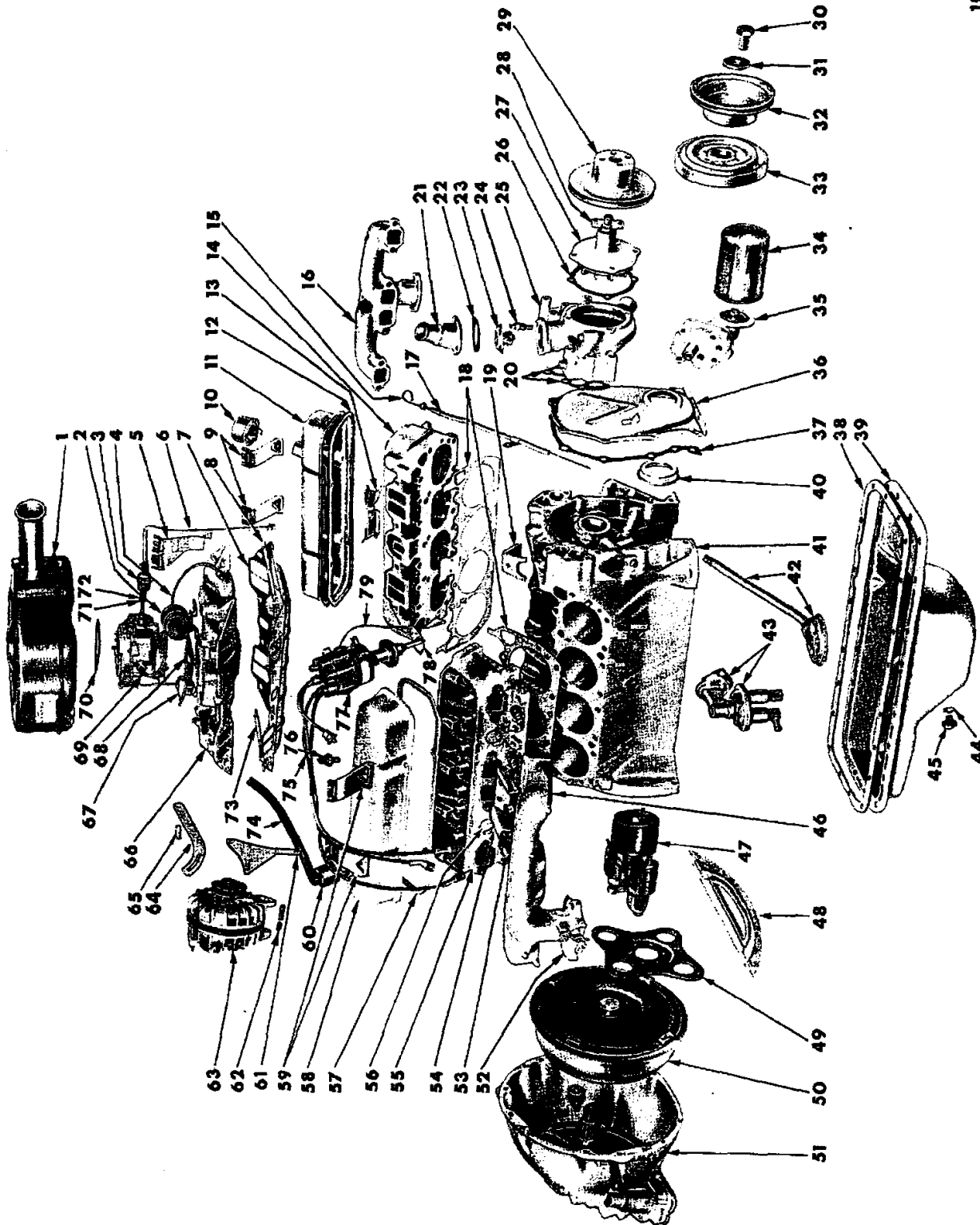

ENGINE EXTERNAL PARTS (V8 CYLINDER) - 361, 383 AND 413 CU. IN. DISPLACEMENT

ENGINE EXTERNAL PARTS (V8 CYLINDER) - 361, 383 AND 413 CU. IN. DISPLACEMENT

Ref. No.	Name	Part Type Code	Ref. No.	Name	Part Type Code
1	Air Cleaner	14-29-2	41	Block (Serviced in Short Engine 9-01-24)	
2	Coil	8-35-4	42	Strainer w/Pipe	10-23-7
3	Filter	14-67-1	43	Pump Package, Fuel	14-73-1
4	Cable	8-36-49	44	Gasket	10-24-38
5	Bracket	8-36-4	45	Plug	10-24-37
6	Tube	14-89-2	46	Manifold	9-48-6
7	Gasket	9-50-6	47	Starter	8-52-4
8	Reinforcement	9-48-27	48	Cover	21-03-6
9	Bracket	8-36-4	49	Plate	9-46-8
10	Air Cleaner	10-01-21	50	Torque Converter	9-46-4
11	Cover	9-03-28	51	Case, Transmission	21-03-1
12	Gasket	9-03-29	52	Shield	9-58-12
13	Shield	8-36-124	53	Spark Plug	8-36-114
14	Head	9-03-4	54	Shield	8-36-124
15	Indicator	10-03-4	55	Head	9-03-4
16	Manifold	9-48-6	56	Plug	9-02-16
17	Tube	10-03-7	57	Gasket	9-03-29
18	Gasket	9-03-5	58	Cover	9-03-28
19	Clamp	8-27-26	59	Bracket	8-36-4
20	Gasket	7-44-4	60	Cap	10-02-66
21	Elbow	9-05-5	61	Bracket	8-28-36
22	Gasket	9-05-6	62	Spacer	8-28-14
23	Thermostat	7-41-4	63	Alternator	8-28-3
24	Sending Unit	8-37-155	64	Strap	8-28-15
25	Housing	7-43-1	65	Spacer	8-28-292
26	Gasket	7-44-3	66	Manifold	9-48-7
27	Pump	7-42-1	67	Choke	14-39-45
28	Hub	7-05-1	68	Gasket	14-30-2
29	Pulley	7-06-14	69	Carburetor	14-30-1
30	Screw	9-07-8	70	Gasket	14-29-5
31	Washer	9-07-22	71	Clamp	
32	Pulley	7-06-1	72	Hose	14-87-2
33	Damper	9-13-5	73	Reinforcement	9-48-27
34	Filter	10-26-6	74	Hose	10-02-53
35	Pump	10-07-6	75	Cable Set	8-36-1
36	Cover	9-23-5	76	Switch	8-53-327
37	Gasket	9-23-17	77	Distributor	8-27-1
38	Gasket	10-24-8	78	Gasket	8-27-4
39	Pan	10-24-4	79	Lead	8-27-205
40	Oil Seal	9-23-18			

PARTS INDICATED BY NAME ONLY - ORDER BY DESCRIPTION

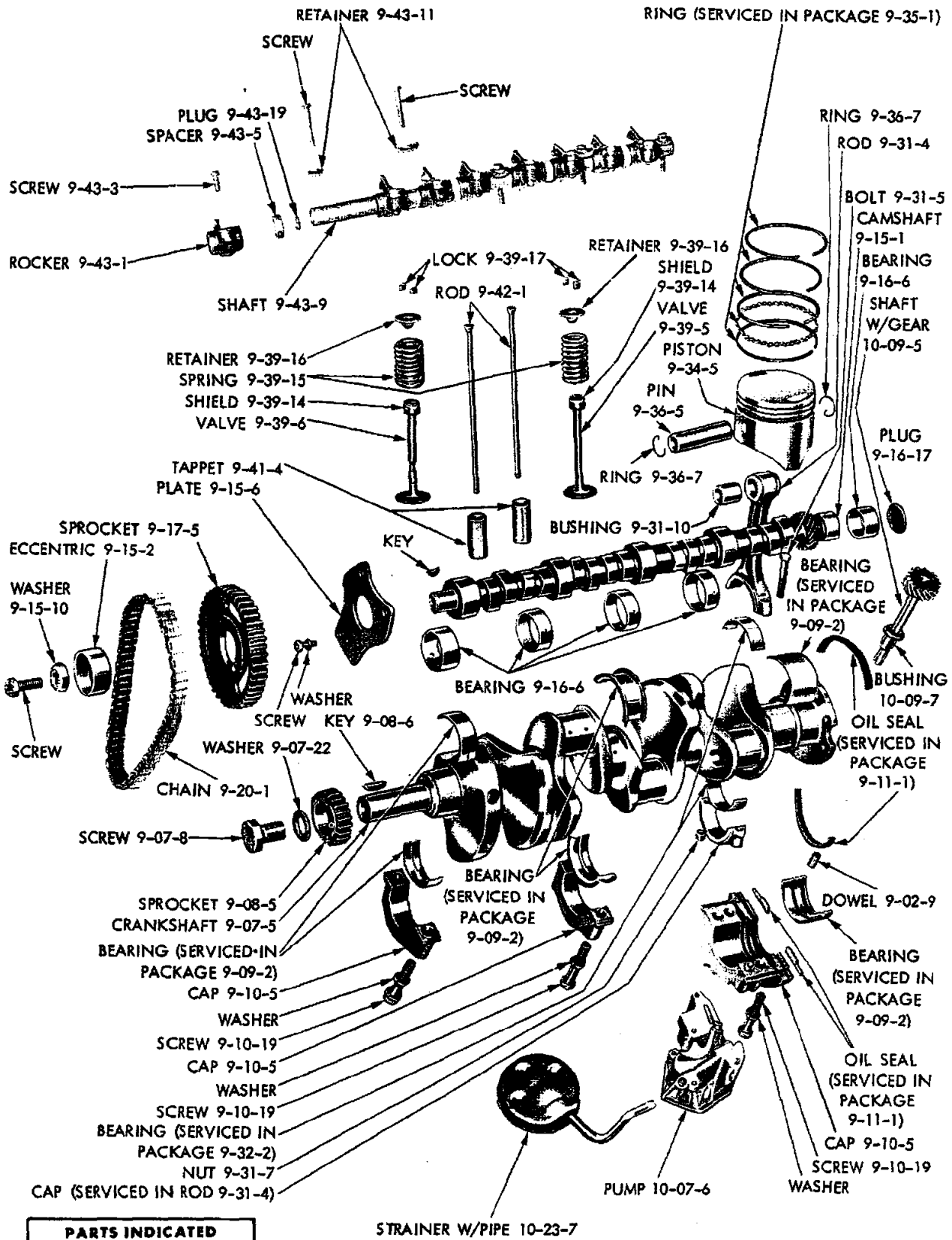

**PARTS INDICATED
BY NAME ONLY - ORDER
BY DESCRIPTION**

19x9986A

ENGINE INTERNAL PARTS (V8 CYLINDER) - 273 CU. IN. DISPLACEMENT

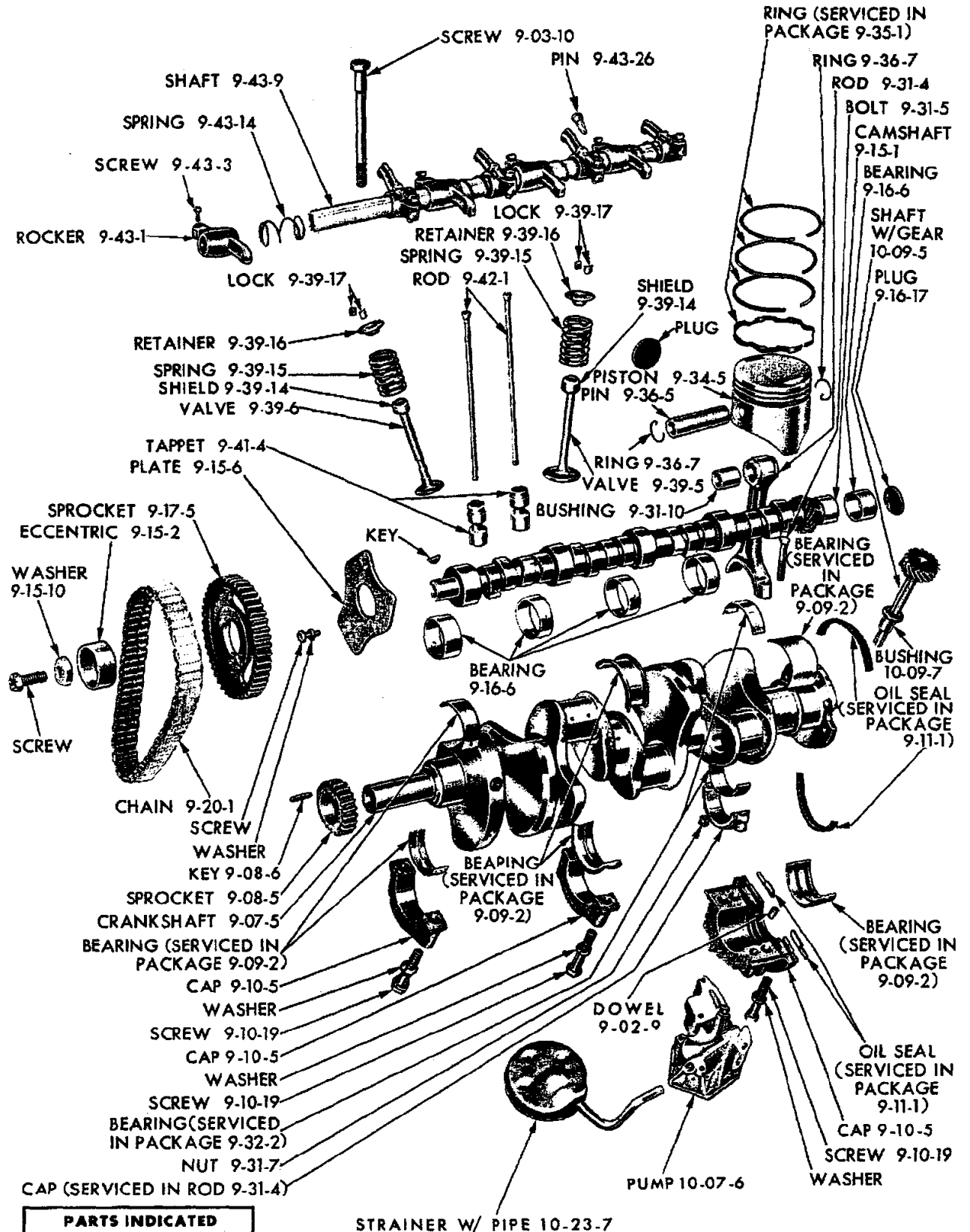

**PARTS INDICATED
BY NAME ONLY - ORDER
BY DESCRIPTION**

19x6914F

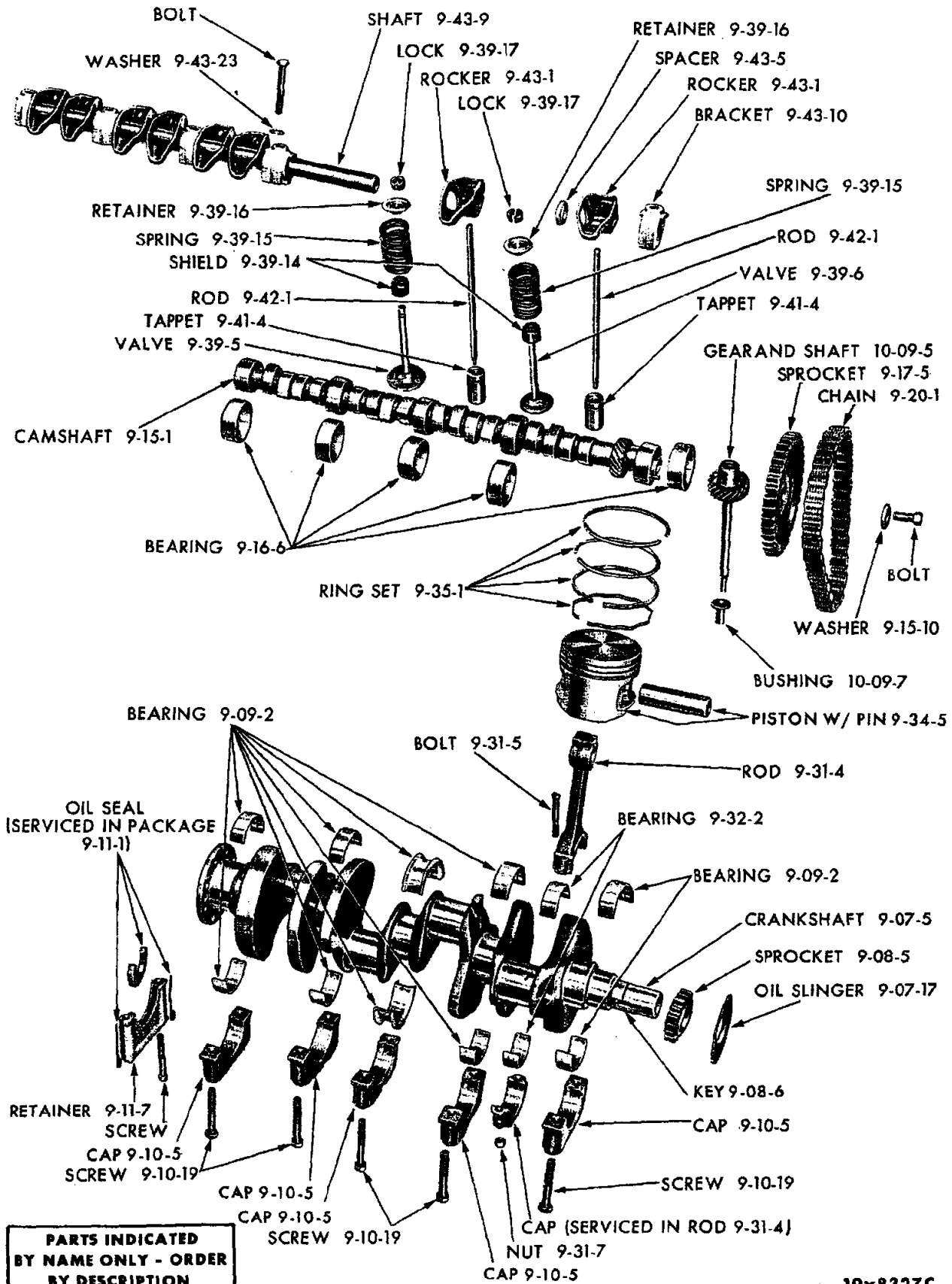

**PARTS INDICATED
BY NAME ONLY - ORDER
BY DESCRIPTION**

19x8327C

ENGINE INTERNAL PARTS - 361, 383 AND 413 CU. IN. DISPLACEMENT

PARTS INDICATED BY NAME ONLY - ORDER BY DESCRIPTION

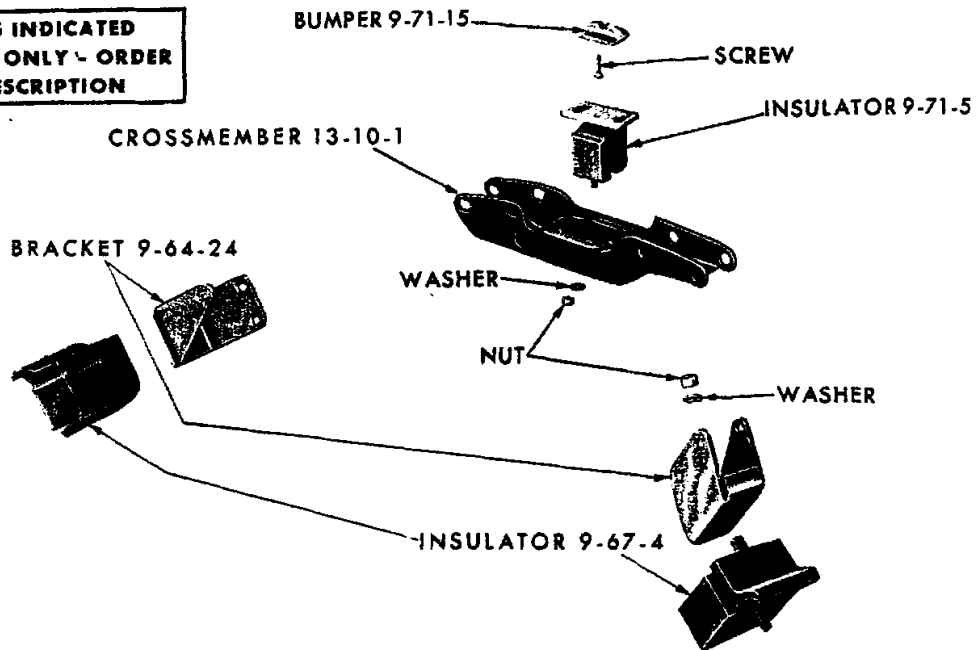

19a0314

ENGINE MOUNTINGS (V8 CYLINDER) - VALIANT VV2 AND DART VL2

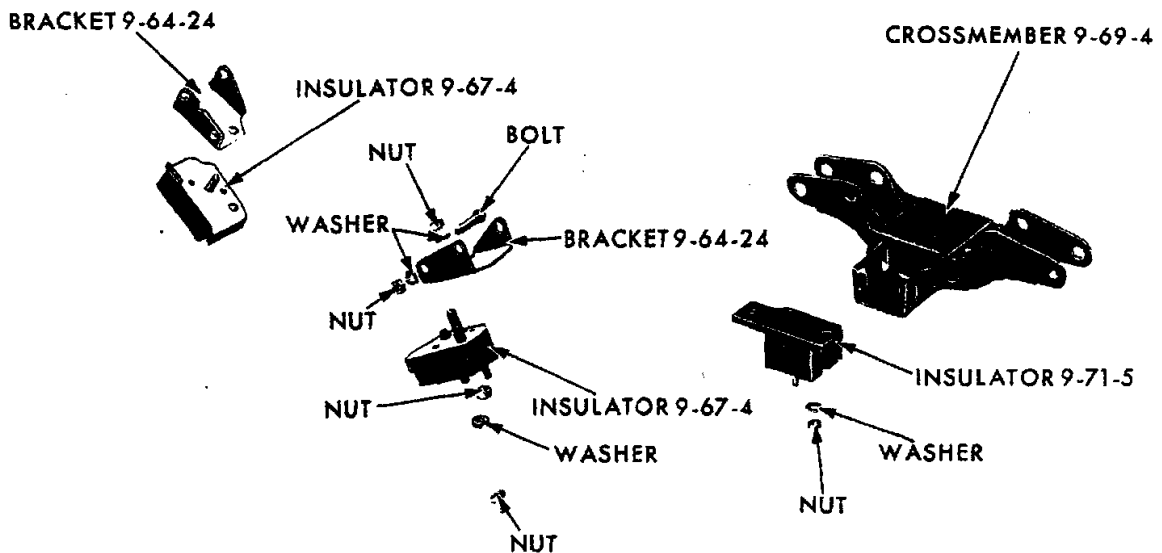

PARTS INDICATED BY NAME ONLY - ORDER BY DESCRIPTION

19x9337A

ENGINE MOUNTINGS (V8 CYLINDER) - PLYMOUTH VP2 AND DODGE VD2

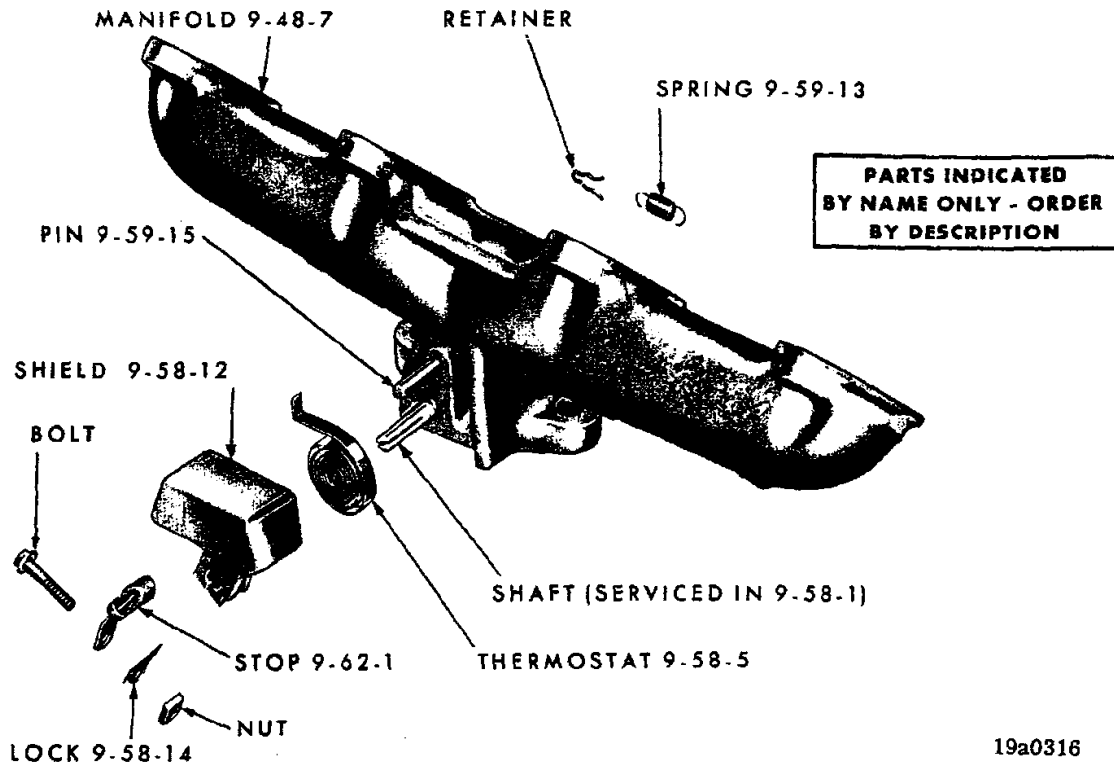

19a0316

ENGINE MANIFOLD HEAT CONTROLS - V8 CYLINDER

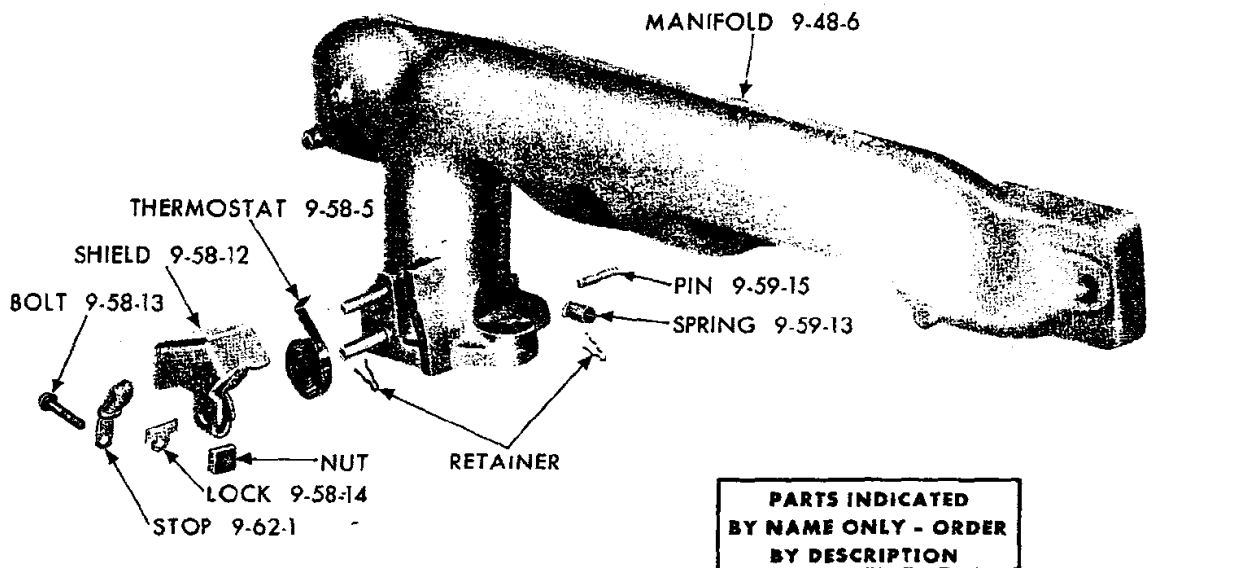

19x8318A

MANIFOLD HEAT CONTROLS (V8 CYLINDER) - 361, 383 AND 413 CU. IN. DISPLACEMENT (EXCEPT VC2-300K)

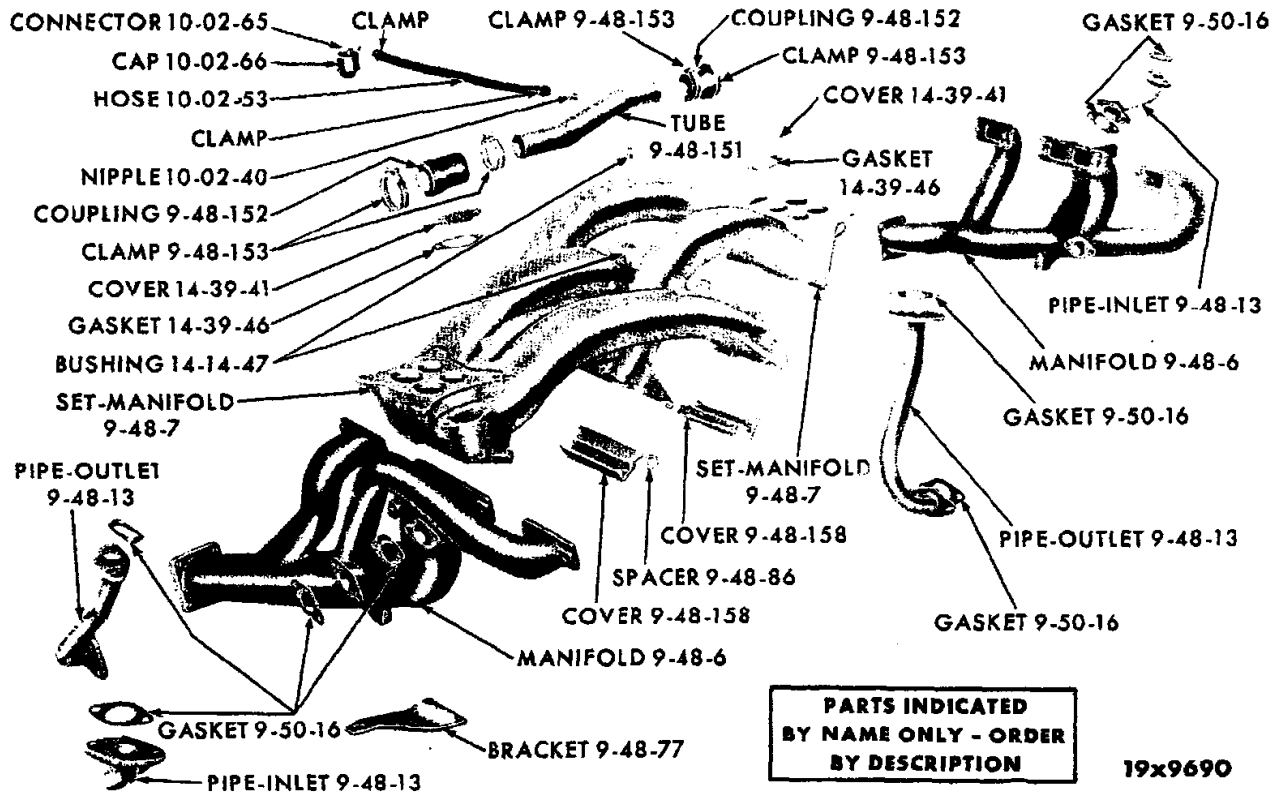

RAM MANIFOLD - CHRYSLER VC2-300K

NOTES

NOTE: The following symbols are used in connection with engine numbers:
 Engine numbers without symbols indicate "Standard Cylinder's and Crankshaft Bearings".
 The Letter "A" immediately following the engine number indicates Bore .020" (.508 MM.) Larger than Standard.
 The Letter "B" immediately following the engine identification number indicates Main and Connecting Rod Bearings .010" (.245 MM.) Smaller than Standard.
 The Letters "AB" immediately following the engine identification number indicates Cylinder Bore .020 (.508 MM.) Larger than Standard and the Main and Connecting Rod Bearings .010" (.254 MM.) Smaller than Standard.
 The Letters in the circular pads at either end of the engine number are for the use of factory inspectors only and should not be connected with the engine number. Always mention Serial Numbers when ordering major assemblies.

CODE	PART NAME AND DESCRIPTION	PER CAR	CUBIC INCH DISPLACEMENT					
			273	318	361	383	413	426

EIGHT CYLINDER ENGINES

NOTE: It will be noted below, part numbers listed for the 426 cubic inch Engine may be identified, "Standard", "Maximum Performance" or "Hemispherical". "Standard" indicates the 426 Engine designed for normal street driving. "Maximum Performance" or "Hemispherical" indicates the racing version of the same Engine. Where parts are not specifically identified, they apply to all 426 Engines. The "Hemispherical" Engine will enter production approximately April 1, 1964.

9-01-0 ENGINE ASSEMBLY

9-01-5	GASKET SET, Engine, VV2, VL2	1	2525 028						
	VP2, VD2	1	----	2525 091					
	VP2, VA3, VC1	1	----	----	*2585 206				
	VP2, VD2, VA3, VC2 . .	1	----	----	----	*2585 206			
	VA3 Police, VC1 Police, VC2, VC2-300K w/One Four Barrel Carburetor, VC3, VY1	1	----	----	----	----		*2585 208	
	VC2-300K w/Two Four Barrel Carburetor . . .	1	----	----	----	----		*2448 781	
	VP2, VD2, Maximum Perf.	1	----	----	----	----		----	2448 783
	VP2, VD2, Std.	1	----	----	----	----		----	*2585 208
	VP2, VD2, Hemispherical	1	----	----	----	----		----	*2525 471

NOTE: Short Engine Assemblies Consists of: The Cylinder Block with Pistons and Rings, Crankshaft and Bearings, Connecting Rods and Bearings, Camshaft and Bearings, Camshaft Thrust Plate, Camshaft and Crankshaft Sprockets and Timing Chain. On the 8 Cylinder Short Engine Assemblies some of the above parts have been left off to obtain a greater interchangeability.

9-01-24	SHORT ENGINE VV2, VL2	1	2465 551						
	VV2, VL2, w/Low Compression, Export .	1	2465 553						
	VP2, VD2	1	----	*2532 674					
	VP2, VD2, w/Low Compression, Export .	1	----	*2532 675					
	VP2, VD2 Police, VA3, VC1	1	----	----	2268 314				
	VA3, VC1, w/Low Compression, Export .	1	----	----	*2532 679				
	VP2, VD2, VA3, VC2 .	1	----	----	----	2268 318			
	VD2, VC2, w/Low Compression, Export .	1	----	----	----	*2532 682			
	VA3 Police, VC1 Police, VC2, VC3, VY1	1	----	----	----	----	2268 310		
	VC3, VY1, w/Low Compression, Export .	1	----	----	----	----	2268 312		
	VP2, VD2, w/12.5 to 1 Compression Ratio, Maximum Performance	1	----	----	----	----	----		2465 301

1964 PASSENGER CAR PARTS CATALOG

ENGINE

CODE	PART NAME AND DESCRIPTION	PER CAR	CUBIC INCH DISPLACEMENT				
			273	318	361	383	413

EIGHT CYLINDER ENGINES

9-01-0 ENGINE ASSEMBLY - Cont'd

9-01-24	SHORT ENGINE - Cont'd VP2, VD2, w/10.5 to 1 Compression Ratio, Std.	1	----	----	----	----	----	*2532 685
	VP2, VD2, w/12.5 to 1 Compression Ratio, Hemispherical	1	----	----	----	----	----	E2536 906

9-02-0 CYLINDER BLOCK

9-02-7	DOWEL, Cylinder Block to Clutch Housing or Torque Converter Housing	2	1122 532	1122 532	1122 532	1122 532	1122 532	1122 532
9-02-9	DOWEL, Cylinder Block to No. 5 Bearing Cap .	1	1408 853	1408 853				
9-02-16	PLUG, Cylinder Block Core Hole	1	2406 387					
	PLUG, Cylinder Block Camshaft Rear Bearing	*	2406 356	2406 356	2406 356	2406 356	2406 356	2406 356
9-02-17	PLUG, Cylinder Block Oil Line	*	----	----	2402 649	2402 649	2402 649	2402 649
		1	1324 464	1324 464				

9-03-0 CYLINDER HEAD

9-03-4	HEAD, Cylinder, VV2, VL2	2	*2532 080					
	VP2, VD2	2	----	2402 116				
	VP2, VD2, VA3, VC1 . .	2	----	----	2406 732			
	VP2, VD2, VA3, VC2 . .	2	----	----	----	*2406 732		
	VA3 Police, VC1 Police, VC2, VC2-300K w/One Four Barrel Carburetor, VC3, VY1	2	----	----	----	----	*2406 732	
	VC2-300K w/Two Four Barrel Carburetors . .	2	----	----	----	----	*2406 734	
	VP2, VD2, Maximum Performance	2	----	----	----	----	----	2406 736
	VP2, VD2, Std.	2	----	----	----	----	----	2406 732
	VP2, VD2, Hemispherical	2	----	----	----	----	----	2468 014
9-03-5	GASKET, Cylinder Head .	2	2463 338					
	VP2, VD2	2	----	*2525 062				
	VP2, VD2, VA3, VC1 . .	2	----	----	1851 579			
	VP2, VD2, VA3, VC2 . .	2	----	----	----	1851 579		
	VA3 Police, VC1 Police, VC2, VC2-300K w/One Four Barrel Carburetor, VC3, VY1	2	----	----	----	----	*1851 579	
	VC2-300K w/Two Four Barrel Carburetors . .	2	----	----	----	----	*1859 429	
	VP2, VD2, Maximum Performance	2	----	----	----	----	----	1859 429
	VP2, VD2, Std.	2	----	----	----	----	----	1851 579
	VP2, VD2, Hemispherical	2	----	----	----	----	----	2468 010
9-03-10	SCREW, Cylinder Head, Short, 1/2" x 1 7/8" . .	10	2463 258					
	Long, 1/2" x 3 5/8" . .	8	2463 259					
	Long, 1/2" x 4 5/8" . .	2	2463 260					
	Short	10	----	1618 695				
	Long	10	----	1618 696				

* Indicates use as required.

Numerals in parentheses () refer to notes.

Printed in U.S.A.

⊠ Indicates parts not listed in any previous parts book.

Prices and specifications subject to change without notice.

March 15, 1965 Supersedes March 16, 1964.

Page 9-28

* Indicates change or addition.

CODE	PART NAME AND DESCRIPTION	PER CAR	CUBIC INCH DISPLACEMENT				
			273	318	361	383	413

EIGHT CYLINDER ENGINES

9-03-0 CYLINDER HEAD - Cont'd

9-03-10	SCREW - Cont'd							
	Short	24	-----	-----	1739 605	1739 605	1739 605	
	Long	10	-----	-----	1739 606	1739 606	1739 606	
	Short, except Hemispherical	24	-----	-----	-----	-----	-----	1739 605
	Long, except Hemispherical	10	-----	-----	-----	-----	-----	1739 606
	Short, Hemispherical . .	16	-----	-----	-----	-----	-----	2468 193
	Long, Hemispherical . .	10	-----	-----	-----	-----	-----	2468 192
	STUD, Cylinder Head, Hemispherical	8	-----	-----	-----	-----	-----	*6025 714
9-03-11	NUT, Cylinder Head Stud, Hemispherical	8	-----	-----	-----	-----	-----	2468 006
9-03-12	WASHER, Cylinder Head Screw, except Hemispherical	32	-----	-----	-----	-----	-----	2402 351
	WASHER, Cylinder Head Screw and Stud, Hemispherical	34	-----	-----	-----	-----	-----	*6025 713
9-03-18	PLUG, Cylinder Head, Core Hole	★	2406 387	-----	2406 387	2406 387	2406 387	2406 387
		★	-----	-----	2402 649	2402 649	2402 649	2402 649
9-03-28	COVER, Cylinder Head, Right	1	2465 543	2202 812	-----	-----	-----	-----
	Left	1	2465 383	2402 746	-----	-----	-----	-----
	Right	1	-----	-----	2463 365	2463 365	2463 365	-----
	Left	1	-----	-----	2463 366	2463 366	2463 366	-----
	Maximum Perf.	2	-----	-----	-----	-----	-----	2463 163
	Right, Std.	1	-----	-----	-----	-----	-----	2465 394
	Left, Std.	1	-----	-----	-----	-----	-----	2463 857
	Right, Hemispherical . .	1	-----	-----	-----	-----	-----	*2532 715
	Left, Hemispherical . .	1	-----	-----	-----	-----	-----	*2468 219
	STUD	12	-----	-----	6024 845	6024 845	6024 845	6024 845
	WASHER	★	-----	-----	6022 181	6022 181	6022 181	6022 181
	WASHER	★	-----	-----	6022 582	6022 582	6022 582	6022 582
9-03-29	GASKET, Cylinder Head Cover	2	2463 290	2128 407	2463 168	2463 168	2463 168	-----
	Except Hemispherical . .	2	-----	-----	-----	-----	-----	2463 168
	Hemispherical	2	-----	-----	-----	-----	-----	2468 022

9-05-0 CYLINDER HEAD WATER OUTLET ELBOW

9-05-5	ELBOW, 3/4" neck angle	1	1855 393	1855 393	1855 393	1855 393	1855 393	1855 393
	2" neck angle	1	1855 605	1855 605	1855 605	1855 605	1855 605	1855 605
9-05-6	GASKET, Elbow	1	50 082	50 082	50 082	50 082	50 082	50 082

9-07-0 CRANKSHAFT

9-07-5	CRANKSHAFT, w/Manual Trans. VV2, VL2	1	2268 119	-----	-----	-----	-----	-----
	w/Automatic Trans. VV2, VL2	1	2463 551	-----	-----	-----	-----	-----
	VP2, VD2	1	-----	2268 119	-----	-----	-----	-----
	VP2, VD2, VA3, VC1 . .	1	-----	-----	2268 114	-----	-----	-----
	VP2, VD2, VA3, VC2 . .	1	-----	-----	-----	2268 114	-----	-----
	VA3 Police, VC1 Police, VC2, VC3, VY1	1	-----	-----	-----	-----	2264 354	-----
	VP2, VD2, Maximum Performance	1	-----	-----	-----	-----	-----	2406 240
	VP2, VD2, Standard . .	1	-----	-----	-----	-----	-----	2264 354
	VP2, VD2, Hemispherical	1	-----	-----	-----	-----	-----	2463 549
9-07-8	SCREW, Crankshaft, 3/4" x 2 1/4"	1	1821 414	1821 414	-----	-----	-----	-----
	3/4" x 1 1/4"	1	-----	1821 177	-----	-----	-----	-----
		1	-----	-----	1731 525	1731 525	1731 525	-----

★ Indicates use as required.

⊠ Indicates parts not listed in any previous parts book.

Numerals in parentheses () refer to notes.

Printed in U.S.A.

Prices and specifications subject to change without notice.

1964 PASSENGER CAR PARTS CATALOG

ENGINE

CODE	PART NAME AND DESCRIPTION	PER CAR	CUBIC INCH DISPLACEMENT				
			273	318	361	383	413

EIGHT CYLINDER ENGINES

9-07-O CRANKSHAFT - Cont'd

9-07-8	SCREW - Cont'd							
	Except Hemispherical . . .	1	----	----	----	----	----	1731 525
	Hemispherical	1	----	----	----	----	----	1821 414
9-07-12	BUSHING, Crankshaft							
	Transmission Drive							
	Pinion, w/Manual Trans.	1	53 298	53 298	53 298	53 298	53 298	53 298
	INSERT, Crankshaft Torque							
	Converter Pilot,							
	w/Automatic Trans. . .	1	2463 126					
9-07-17	OIL SLINGER	1	1618 686	1618 686	1618 686	1618 686	1618 686	1618 686
9-07-22	WASHER, Screw	1	1855 561	1855 561	1855 561	1855 561	1855 561	
	Except Hemispherical . .	1	----	----	----	----	----	1855 561
	Hemispherical	1	----	----	----	----	----	2463 649

9-08-O CRANKSHAFT SPROCKET

9-08-5	SPROCKET, w/approx.							
	.637 wide Timing Chain	1	*2463 385	*2463 385				
	w/approx. 1.017" wide							
	Timing Chain	1	----	*1947 404				
		1	----	----	2128 912	2128 912	2128 912	2128 912
	KEY	1	152 191	152 191	152 191	152 191	152 191	152 191

9-09-O CRANKSHAFT BEARING PACKAGE

NOTE: When .001 thicker wall crankshaft main bearings are used for engine in production on identification mark is stamped on the machined surface of the crankshaft center counterweight for six cylinder engines and No. 3 counterweight for V8 cylinder engines. When the thicker wall crankshaft bearings are used the crankshaft will be marked M1, M2, M3, M4 or M5 depending on which journal has the .001 thicker wall bearing.

NOTE: Crankshaft Bearing Packages consist of one upper and one lower bearing.

JOURNAL		ENGINE (Cu. In. Displ.)						426 Maximum Performance and Hemispherical
PER CAR	BEARING SIZE Standard and Undersize	273 & 318	361	383	413	426 Standard		
	No. 1						2448 379	
	No's 1, 2 & 4 - 273, 318 Eng's.							
1&3	Std.	2084 005	2084 810	2084 810	2084 814	2084 814		
1&3	.001	2084 006	2084 811	2084 811	2084 815	2084 815		
1&3	.002	2084 007	2084 812	2084 812	2084 816	2084 816		
1&3	.003	2275 387	2275 391	2275 391	2275 395	2275 395		
1&3	.010	2084 008	2084 813	2084 813	2084 817	2084 817		
1&3	.012	2275 388	2275 392	2275 392	2275 396	2275 396		
	No's. 2, 4 and 5 -						2448 380	
	Ex. 273, 318 Eng's.							
3	Std.		2084 833	2084 833	2084 829	2084 829		
3	.001		2084 834	2084 834	2084 830	2084 830		
3	.002		2084 835	2084 835	2084 831	2084 831		
3	.003		2275 393	2275 393	2275 397	2275 397		
3	.010		2084 836	2084 836	2084 832	2084 832		
3	.012		2275 394	2275 394	2275 398	2275 398		
	No. 3						2448 381	
1	Std.	1879 627	1818 524	1818 524	1879 378	1879 378		
1	.001	1879 628	1818 525	1818 525	1879 379	1879 379		
1	.002	1879 629	1818 526	1818 526	1879 380	1879 380		
1	.003	2275 389	1818 527	1818 527	1879 381	1879 381		
1	.010	1879 630	1818 528	1818 528	1879 382	1879 382		
1	.012	2275 390	1818 529	1818 529	1879 383	1879 383		
	No. 5 - 273, 318 Eng's.							
1	Std.	1643 151						
1	.001	1643 152						
1	.002	1643 153						
1	.003	1643 154						
1	.010	1643 155						

* Indicates use as required.

Numerals in parentheses () refer to notes.

CODE	PART NAME AND DESCRIPTION	PER CAR	CUBIC INCH DISPLACEMENT				
			273	318	361	383	413

EIGHT CYLINDER ENGINES

9-10-0 CRANKSHAFT BEARING CAP

9-10-2	OIL SEAL PACKAGE, Crankshaft Bearing No. 5 Cap.	1	1326 091	1326 091				
9-10-5	CAP, Nos. 1, 2 and 4. . .	3	1632 519	*1632 519				
	No. 3	1	2463 582	2463 582				
	No. 5	1	2275 446	2275 446				
	Nos. 1, 2 and 4	3	-----	-----	1852 914	1852 914		
	No. 3	1	-----	-----	1852 915	1852 915		
	No. 5	1	-----	-----	2206 315	2206 315		
	Nos. 1, 2 and 4 Std. . . .	3	-----	-----	-----	-----	*1852 910	*1852 910
	No. 3 Std.	1	-----	-----	-----	-----	*1852 911	*1852 911
	No. 5 Std.	1	-----	-----	-----	-----	2206 316	2206 316
9-10-19	SCREW, Crankshaft Bearing Cap	10	1618 695	1618 695				
		10	-----	-----	1408 867	1408 867	1408 867	
		10	-----	-----	-----	-----	-----	*1408 867
	Hemispherical	10	-----	-----	-----	-----	-----	6025 048
9-10-26	WASHER, Crankshaft Bearing Cap Bolt, Hemispherical	10	-----	-----	-----	-----	-----	2468 135
	Side, Hemispherical	6	-----	-----	-----	-----	-----	*1536 242

9-11-0 CRANKSHAFT REAR BEARING OIL SEAL

9-11-1	OIL SEAL PACKAGE	1	1326 093	1326 093				
		1	-----	-----	2275 365	2275 365	2275 365	2275 365
9-11-7	RETAINER	1	-----	-----	1945 473	1945 473	1945 473	1945 473
	SCREW	2	-----	-----	9418 005	9418 005	9418 005	9418 005

9-13-0 CRANKSHAFT VIBRATION DAMPER

9-13-5	DAMPER	1	1947 235					
	w/Manual Trans.	1	-----	1947 235				
	w/Automatic Trans.	1	-----	2402 090				
		1	-----	-----	2275 897	2275 897	2275 897	
	Except Hemispherical . . .	1	-----	-----	-----	-----	-----	2275 897
	Hemispherical	1	-----	-----	-----	-----	-----	*2532 105

9-15-0 CAMSHAFT

9-15-1	CAMSHAFT	1	2463 360	2268 990				
	w/Two Barrel Carburetor, VP2, VD2, VA3, VC1, VC2	1	-----	-----	2268 405	2268 405		
	w/Four Barrel Carburetor, VP2, VD2	1	-----	-----	-----	2129 203		
	VA3 Police, VC1 Police, VC2, VC2-300K w/One Four Barrel Carburetor VC2-300K w/Two Four Barrel Carburetors	1	-----	-----	-----	-----	*2129 203	
	VC3, VY1	1	-----	-----	-----	-----	*2406 369	
		1	-----	-----	-----	-----	2268 405	
	PACKAGE, Camshaft, w/Valve Tappet, Assembly, Maximum Performance, w/11 to 1 Compression Ratio	1	-----	-----	-----	-----	-----	2495 055
	PACKAGE, Camshaft, w/Valve Tappet, Assembly, Maximum Performance, w/12.5 to 1 Compression Ratio	1	-----	-----	-----	-----	-----	2525 077

* Indicates use as required. Numerals in parentheses () refer to notes. Printed in U.S.A.
 † Indicates parts not listed in any previous parts book. Prices and specifications subject to change without notice.
 * Indicates change or addition. Page 9-31 March 15, 1965 Supersedes March 16, 1964.

CODE	PART NAME AND DESCRIPTION	PER CAR	CUBIC INCH DISPLACEMENT				
			273	318	361	383	413

EIGHT CYLINDER ENGINES

9-15-0 CAMSHAFT - Cont'd

9-15-1	PACKAGE, Camshaft Camshaft, Std.	1	-----	-----	-----	-----	-----	-----	2129 203
	PACKAGE, Camshaft, w/Valve Tappet, Assembly, Hemispherical	1	-----	-----	-----	-----	-----	-----	*2525 495
9-15-2	ECCENTRIC, Camshaft . . .	1	1618 718	1618 718					
9-15-6	PLATE, Sprocket Thrust	1	1946 992	1946 992					
9-15-10	WASHER, Sprocket Retaining Screw	1	1618 732	1618 732					
		1	-----	-----	6023 053	6023 053	6023 053	6023 053	6023 053

9-16-0 CAMSHAFT BEARING

9-16-6	BEARING, Camshaft No. 1	1	1632 522	1632 522					
	No. 2	1	1632 523	1632 523					
	No. 3	1	1632 524	1632 524					
	No. 4	1	1632 525	1632 525					
	No. 5	1	1632 526	1632 526					
	No. 1 except 426 Hemispherical	1	-----	-----	1821 771	1821 771	1821 771	1821 771	1821 771
	No. 2 except 426 Hemispherical	1	-----	-----	1821 772	1821 772	1821 772	1821 772	1821 772
	No. 3 except 426 Hemispherical	1	-----	-----	1821 773	1821 773	1821 773	1821 773	1821 773
	No. 4 except 426 Hemispherical	1	-----	-----	1821 774	1821 774	1821 774	1821 774	1821 774
	No. 5 except 426 Hemispherical	1	-----	-----	1821 775	1821 775	1821 775	1821 775	1821 775
9-16-17	PLUG, Camshaft Rear Bearing.	1	1821 722	1821 722					
		★	-----	-----	*2402 905	*2402 905	*2402 905	*2402 905	*2402 905
		★	-----	-----	E2463 041	E2463 041	E2463 041	E2463 041	E2463 041

9-17-0 CAMSHAFT SPROCKET

9-17-5	SPROCKET, w/approx. .637" wide Timing Chain	1	*2463 386	*2463 386					
	w/approx. 1.017" wide Timing Chain	1	-----	*1618 666					
		1	-----	-----	1737 622	1737 622	1737 622	1737 622	1737 622
	KEY	1	106 751	106 751					

9-20-0 TIMING CHAIN

9-20-1	CHAIN, .637" wide	1	*2463 384	*2463 384					
	1.017" wide	1	-----	*1618 736					
		1	-----	-----	2202 499	2202 499	2202 499	2202 499	2202 499

9-23-0 CHAIN CASE COVER

9-23-5	COVER	1	1944 773	1944 773					
		1	-----	-----	2120 627	2120 627	2120 627	2120 627	2120 627
	WASHER	12	-----	-----	6022 181	6022 181	6022 181	6022 181	6022 181
9-23-17	GASKET, Cover.	1	2129 012	2129 012					
		1	-----	-----	2264 794	2264 794	2264 794	2264 794	2264 794
9-23-18	OIL SEAL, Cover	1	1618 683	1618 683					
		1	-----	-----	1737 771	1737 771	1737 771	1737 771	1737 771
9-23-40	INDICATOR, Timing	1	1947 236	1947 236					
	w/Leece-Neville Alternator	1	-----	1851 861					

★ Indicates use as required.

Numerals in parentheses () refer to notes.

Printed in U.S.A.

E Indicates parts not listed in any previous parts book.
March 15, 1965 Supersedes March 16, 1964.

Prices and specifications subject to change without notice.
* Indicates change or addition.

CODE	PART NAME AND DESCRIPTION	PER CAR	CUBIC INCH DISPLACEMENT				
			273	318	361	383	413

EIGHT CYLINDER ENGINES

9-31-0 CONNECTING ROD

NOTE: Connecting Rod includes Bearing Cap, Bolt, Nut, Lockwasher and Bushing but does not include Bearing.

9-31-4	ROD	8	2406 785	2406 785				
		8	-----	-----	2406 766	2406 766		
	VA3 Police, VC1 Police, VC2, VC2-300K w/One Four Barrel Carburetor, VC3, VY1	8	-----	-----	-----	-----	E2406 770	
	VC2-300K w/Two Four Barrel Carburetors . .	8	-----	-----	-----	-----	*2406 394	
	Maximum Performance .	8	-----	-----	-----	-----	-----	2406 885
	Std.	8	-----	-----	-----	-----	-----	E2406 770
	Hemispherical	8	-----	-----	-----	-----	-----	*2532 709
9-31-5	BOLT, Bearing Cap . . .	16	1944 865	1944 865				
		16	-----	-----	1737 694	1737 694	1737 694	
	Except Hemispherical . .	16	-----	-----	-----	-----	-----	1737 694
	Hemispherical	16	-----	-----	-----	-----	-----	2468 005
9-31-7	NUT, Cap Bolt	★	1737 695	1737 695	1737 695	1737 695	1737 695	
	Except Hemispherical . .	16	-----	-----	-----	-----	-----	1737 695
	Hemispherical	16	-----	-----	-----	-----	-----	2468 006
9-31-10	BUSHING	8	1618 701	1618 701				

9-32-0 CONNECTING ROD BEARING PACKAGES

NOTE: When .001 thicker wall connecting rod bearings are used for engines in production an identification mark is stamped on the machined surface of the crankshaft center counterweight for six cylinder engines and No. 3 counterweight for V8 cylinder engines. When the thicker wall connecting rod bearings are used the crankshaft will be marked R1, R2, R3, R4 or R5 depending on which journal has the .001 thicker wall bearing.

NOTE: Connecting rod bearing packages consist of one upper and one lower bearing.

9-32-2	BEARING PACKAGE, Std.	8	1879 617	1879 617				
	.001 U/S	8	1879 618	1879 618				
	.002 U/S	8	1879 619	1879 619				
	.003 U/S	8	1879 620	1879 620				
	.010 U/S	8	1879 621	1879 621				
	.012 U/S	8	1879 622	1879 622				
	Std.	8	-----	-----	1818 698	1818 698	1818 698	
	.001 U/S	8	-----	-----	1818 699	1818 699	1818 699	
	.002 U/S	8	-----	-----	1818 700	1818 700	1818 700	
	.003 U/S	8	-----	-----	1818 701	1818 701	1818 701	
	.010 U/S	8	-----	-----	1818 702	1818 702	1818 702	
	.012 U/S	8	-----	-----	1818 703	1818 703	1818 703	
	Std., Maximum Performance	8	-----	-----	-----	-----	-----	*2448 330
	Std. Hemispherical . . .	8	-----	-----	-----	-----	-----	*2525 484
	Std., Std.	8	-----	-----	-----	-----	-----	1881 794
	.001 U/S., Std.	8	-----	-----	-----	-----	-----	1881 795
	.002 U/S., Std.	8	-----	-----	-----	-----	-----	1881 796
	.003 U/S., Std.	8	-----	-----	-----	-----	-----	2275 413
	.010 U/S., Std.	8	-----	-----	-----	-----	-----	1881 797
	.012 U/S., Std.	8	-----	-----	-----	-----	-----	2275 414

★ Indicates use as required.

E Indicates parts not listed in any previous parts book.

* Indicates change or addition.

Numerals in parentheses () refer to notes.

Prices and specifications subject to change without notice.

March 15, 1965 Supersedes March 16, 1964.

CODE	PART NAME AND DESCRIPTION	PER CAR	CUBIC INCH DISPLACEMENT				
			273	318	361	383	413

EIGHT CYLINDER ENGINES

9-34-0 PISTON, W/PIN

NOTE: The following pistons include pin and pin retaining rings.

9-34-5	PISTON, Std. 3.62" Bore.	8	2495 072				
	.005 O/S From 3.62" Bore	8	2495 073				
	.020 O/S From 3.62" Bore	8	2495 074				
	.040 O/S From 3.62" Bore	8	2495 075				
	Std. 3.62" Bore L. C.						
	Export	8	2525 012				
	.005 O/S From 3.62"						
	Bore L. C. Export . .	8	2525 013				
	.020 O/S From 3.62"						
	Bore L. C. Export . .	8	2525 014				
<hr/>							
	Std. 3.91" Bore	8	-----	1843 004			
	.005 O/S From 3.91"						
	Bore	8	-----	1843 005			
	.020 O/S From 3.91"						
	Bore	8	-----	1843 006			
	.040 O/S From 3.91"						
	Bore	8	-----	1843 007			
	Std. 3.91" Bore L. C.						
	Export	8	-----	1843 316			
	.005 O/S From 3.91"						
	Bore L. C. Export . .	8	-----	1843 317			
	.020 O/S From 3.91"						
	Bore L. C. Export . .	8	-----	1843 318			
<hr/>							
	Std. 4.12" Bore	8	-----	-----	2240 333		
	.005 O/S From 4.12"						
	Bore	8	-----	-----	2240 334		
	.020 O/S From 4.12"						
	Bore	8	-----	-----	2240 335		
	.040 O/S From 4.12"						
	Bore	8	-----	-----	2240 336		
	Std. 4.12" Bore L. C.						
	Export	8	-----	-----	*2240 337		
	.005 O/S From 4.12"						
	Bore L. C. Export . .	8	-----	-----	2240 338		
	.020 O/S From 4.12"						
	Bore L. C. Export . .	8	-----	-----	2240 339		
<hr/>							
	Std. 4.25" Bore	8	-----	-----	-----	1879 333	
	.020 O/S From 4.25"						
	Bore	8	-----	-----	-----	1879 335	
	.040 O/S From 4.25"						
	Bore	8	-----	-----	-----	1879 336	
	Std. 4.25" Bore L. C.						
	Export	8	-----	-----	-----	1879 648	
	.005 O/S From 4.25"						
	Bore L. C. Export . .	8	-----	-----	-----	1879 649	
	.020 O/S From 4.25"						
	Bore L. C. Export . .	8	-----	-----	-----	1879 650	
<hr/>							
	Std. 4.18" Bore	8	-----	-----	-----	1879 337	
	.020 O/S From 4.18"						
	Bore	8	-----	-----	-----	1879 339	
	.040 O/S From 4.18"						
	Bore	8	-----	-----	-----	1879 340	
	Std. 4.18" Bore L. C.						
	Export	8	-----	-----	-----	1879 638	
	.005 O/S From 4.18"						
	Bore L. C. Export . .	8	-----	-----	-----	1879 639	
	.020 O/S From 4.18"						
	Bore L. C. Export . .	8	-----	-----	-----	1879 640	

★ Indicates use as required.

Numerals in parentheses () refer to notes.

Printed in U.S.A.

⊠ Indicates parts not listed in any previous parts book.

Prices and specifications subject to change without notice.

March 15, 1965 Supersedes March 16, 1964.

* Indicates change or addition.

CODE	PART NAME AND DESCRIPTION	PER CAR	CUBIC INCH DISPLACEMENT				
			273	318	361	383	413

EIGHT CYLINDER ENGINES

9-34-O PISTON, W/PIN -Cont'd

9-34-5	PISTON - Cont'd. Std. 4.25" Bore w/11 to 1 Compression Ratio, Maximum Performance .005 O/S From 4.25" Bore, w/11 to 1 Compression Ratio, Maximum Performance	8	----	----	----	----	----	2495 044
	Std. 4.25" Bore, w/12.5 to 1 Compression Ratio, Maximum Performance .005 O/S From 4.25" Bore, w/12.5 to 1 Compression Ratio, Maximum Performance	8	----	----	----	----	----	2495 045
	Std. 4.25" Bore, w/12.5 to 1 Compression Ratio, Maximum Performance .005 O/S From 4.25" Bore, w/12.5 to 1 Compression Ratio, Maximum Performance	8	----	----	----	----	----	2448 703
	Std. 4.25" Bore, w/12.5 to 1 Compression Ratio, Maximum Performance .005 O/S From 4.25" Bore, w/12.5 to 1 Compression Ratio, Maximum Performance	8	----	----	----	----	----	2448 704
	Std. 4.25" Bore w/10.3 to 1 Compression Ratio, Std.005 O/S From 4.25" Bore, w/10.3 to 1 Compression Ratio, Std. .020 O/S From 4.25" Bore, w/10.3 to 1 Compression Ratio, Std. .040 O/S From 4.25" Bore, w/10.3 to 1 Compression Ratio, Std.	8	----	----	----	----	----	2525 008
		8	----	----	----	----	----	2525 009
		8	----	----	----	----	----	2525 010
		8	----	----	----	----	----	2525 011
	Std. 4.25" Bore w/11 to to 1 Compression Ratio, Hemispherical005 O/S From 4.25" Bore w/11 to 1 Compression Ratio, Hemispherical	8	----	----	----	----	----	*2525 418
	Std. 4.25" Bore w/12.5 to 1 Compression Ratio, Nos. 1, 3, 5 and 7, Hemispherical	8	----	----	----	----	----	*2525 420
		4	----	----	----	----	----	*2525 422
	Std. 4.25" Bore w/12.5 to 1 Compression Ratio, Nos. 2, 4, 6 and 8, Hemispherical005 O/S From 4.25" Bore w/12.5 to 1 Compression Ratio, Nos. 1, 3, 5 and 7, Hemispherical	4	----	----	----	----	----	*2525 423
		4	----	----	----	----	----	*2525 424
		4	----	----	----	----	----	*2525 425

9-35-O PISTON RING SETS

9-35-1	SET, Piston Ring, Std. to .009 O/S From 3.62" Bore	1	2525 407				
	.020 to .029 O/S From 3.62" Bore	1	2525 408				
	.040 to .049 O/S From 3.62" Bore	1	2525 409				

★ Indicates use as required.
 ☐ Indicates parts not listed in any previous parts book.
 • Indicates change or addition.

Numerals in parentheses () refer to notes.

Printed in U.S.A.

1964 PASSENGER CAR PARTS CATALOG

ENGINE

CODE	PART NAME AND DESCRIPTION	PER CAR	CUBIC INCH DISPLACEMENT					
			273	318	361	383	413	426

EIGHT CYLINDER ENGINES

9-35-O PISTON RING SETS - Cont'd

9-35-1	SET - Cont'd						
	Std. to .009 O/S From						
	3.91" Bore	1	----	2421 703			
	.020 to .029 O/S From						
	3.91" Bore	1	----	2421 704			
	.040 to .049 O/S From						
	3.91" Bore	1	----	2421 705			
	Std. to .009 O/S From						
	4.12" Bore	1	----	----	1843 330		
	.020 to .029 O/S From						
	4.12" Bore	1	----	----	1843 331		
	.040 to .049 O/S From						
	4.12" Bore	1	----	----	1843 332		
	Std. to .009 O/S From						
	4.25" Bore	1	----	----	----	1881 693	
	.020 to .029 O/S From						
	4.25" Bore	1	----	----	----	1881 694	
	.040 to .049 O/S From						
	4.25" Bore	1	----	----	----	1881 695	
	Std. to .009 O/S From						
	4.18" Bore	1	----	----	----	----	1881 699
	.020 to .029 O/S From						
	4.18" Bore	1	----	----	----	----	1881 700
	.040 to .049 O/S From						
	4.18" Bore	1	----	----	----	----	1881 701
	Std. to .009 O/S From						
	4.25" Bore, Maximum	1	----	----	----	----	2448 374
	Performance						
	Std. to .009 O/S From						
	4.25" Bore, Std.	1	----	----	----	----	1881 693
	.020 to .029 O/S From						
	4.25" Bore, Std.	1	----	----	----	----	1881 694
	.040 to .049 O/S From						
	4.25" Bore, Std.	1	----	----	----	----	1881 695
	Std. to .009 O/S From						
	4.25" Bore w/12.5 to 1	1	----	----	----	----	*2525 497
	Compression Ratio,						
	Hemispherical						

9-36-O PISTON PIN

9-36-5	PIN, Std.	8	2463 268	1618 738			
	.003 O/S	8	2463 269	1618 739			
	.008 O/S	8	2463 270	1618 740			
9-36-7	RING, Retaining	18	1324 470	1324 470			

9-39-O VALVE

9-39-1	GASKET PACKAGE, Valve	1	2525 029	2525 092			
	Grinding	1	----	----	2448 778	2448 778	
	VA3 Police, VC1 Police,						
	VC2, VC2-300K w/One						
	Four Barrel Carburetor,	1	----	----	----	----	*2448 780
	VC3, VY1						
	VC2-300K w/Two Four						
	Barrel Carburetors	1	----	----	----	----	*2448 782
	Maximum Perf.	1	----	----	----	----	2448 784
	Std.	1	----	----	----	----	2448 780
	Hemispherical	1	----	----	----	----	*2525 472

★ Indicates use as required.

☐ Indicates parts not listed in any previous parts book.
March 15, 1965 Supersedes March 16, 1964.

Numerals in parentheses () refer to notes.

Printed in U.S.A.
Prices and specifications subject to change without notice.

* Indicates change or addition.

CODE	PART NAME AND DESCRIPTION	PER CAR	CUBIC INCH DISPLACEMENT					
			273	318	361	383	413	426

EIGHT CYLINDER ENGINES

9-39-0 VALVE - Cont'd

9-39-5	VALVE, Intake, Std.	8	2465 335	1945 318				
	.005 O/S	8	2465 336	1945 319				
	.015 O/S	8	2465 337	1945 320				
	.030 O/S	8	2465 338	1945 321				
	Std.	8	----	----	2206 103	2206 103	2206 103	
	.005 O/S	8	----	----	2206 104	2206 104	2206 104	
	.015 O/S	8	----	----	2206 105	2206 105	2206 105	
	.030 O/S	8	----	----	2206 106	2206 106	2206 106	
	Std., Maximum Performance	8	----	----	----	----	----	2402 318
	.005 O/S, Maximum Performance	8	----	----	----	----	----	2402 319
	.015 O/S, Maximum Performance	8	----	----	----	----	----	2402 320
	.030 O/S, Maximum Performance	8	----	----	----	----	----	2402 321
	Std., Std.	8	----	----	----	----	----	2206 103
	.005 O/S, Std.	8	----	----	----	----	----	2206 104
	.015 O/S, Std.	8	----	----	----	----	----	2206 105
	.030 O/S, Std.	8	----	----	----	----	----	2206 106
	Std., Hemispherical	8	----	----	----	----	----	2532 107
	.005 O/S, Hemispherical	8	----	----	----	----	----	2532 108
	.015 O/S, Hemispherical	8	----	----	----	----	----	2532 109
	.030 O/S, Hemispherical	8	----	----	----	----	----	2532 110
9-39-6	VALVE, Exhaust, Std.	8	2465 339	1852 248				
	.005 O/S	8	2465 340	1852 251				
	.015 O/S	8	2465 341	1852 252				
	.030 O/S	8	2465 342	1852 253				
	Std. except VC2-300K w/Two Four Barrel Carburetors	8	----	----	*1737 698	*1737 698	*1737 698	
	.005 O/S except VC2-300K w/Two Four Barrel Carburetors	8	----	----	*1739 612	*1739 612	*1739 612	
	.015 O/S except VC2-300K w/Two Four Barrel Carburetors	8	----	----	*1739 613	*1739 613	*1739 613	
	.030 O/S except VC2-300K w/Two Four Barrel Carburetors	8	----	----	*1739 614	*1739 614	*1739 614	
	Std., VC2-300K w/Two Four Barrel Carburetors	8	----	----	----	----	*1851 771	
	.005 O/S, VC2-300K w/Two Four Barrel Carburetors	8	----	----	----	----	*1851 772	
	.015 O/S, VC2-300K w/Two Four Barrel Carburetors	8	----	----	----	----	*1851 773	
	.30 O/S, VC2-300K w/Two Four Barrel Carburetors	8	----	----	----	----	*1851 774	
	Std., Maximum Performance	8	----	----	----	----	----	2402 322
	.005 O/S, Maximum Performance	8	----	----	----	----	----	2402 323
	.015 O/S, Maximum Performance	8	----	----	----	----	----	2402 324
	.030 O/S, Maximum Performance	8	----	----	----	----	----	2402 325

★ Indicates use as required. Numerals in parentheses () refer to notes. Printed in U.S.A.
 ☐ Indicates parts not listed in any previous parts book. Prices and specifications subject to change without notice.
 * Indicates change or addition. March 15, 1965 Supersedes March 16, 1964.
 Page 9-37

1964 PASSENGER CAR PARTS CATALOG

ENGINE

CODE	PART NAME AND DESCRIPTION	PER CAR	CUBIC INCH DISPLACEMENT					
			273	318	361	383	413	

EIGHT CYLINDER ENGINES

9-39-0 VALVE - Cont'd								
9-39-6	VALVE - Cont'd							
	Std., Std.	8	----	----	----	----	----	1737 698
	.005 O/S, Std.	8	----	----	----	----	----	1739 612
	.015 O/S, Std.	8	----	----	----	----	----	1739 613
	.030 O/S, Std.	8	----	----	----	----	----	1739 614
	Std., Hemispherical. . .	8	----	----	----	----	----	2532 111
	.005 O/S, Hemispherical	8	----	----	----	----	----	2532 112
	.015 O/S, Hemispherical	8	----	----	----	----	----	2532 113
	.030 O/S, Hemispherical	8	----	----	----	----	----	2532 114
9-39-11	OIL SEAL PACKAGE, Intake Valve Stem, except Hemispherical .	1	----	----	----	----	----	*2448 733
	OIL SEAL PACKAGE, Intake Valve Stem, Hemispherical	1	----	----	----	----	----	2525 449
9-39-14	SHIELD, Valve Stem Oil .	16	2205 958					
	Intake Valve Stem Oil .	8	----	2205 958				
	Exhaust Valve Stem Oil .	8	----	2205 959				
	Shield, Valve Stem Oil .	16	----	----	2121 686	2121 686	2121 686	2121 686
9-39-15	SPRING	16	1739 534	1739 534				
	w/Two Barrel Carburetor	16	----	----	1944 854	1944 854		
	w/Four Barrel Carburetor, UP TO Engine No. V38-10-7	16	----	----		1855 042		
	SPRING, Intake, w/Four Barrel Carburetor, AFTER Engine No. V38-10-7 . .	8	----	----		1855 042		
	SPRING, Exhaust, w/Four Barrel Carburetor, AFTER Engine No. V38-10-7	8	----	----		1944 854		
	SPRING, VA3 Police, VC1 Police, VC2 except VC2-300K, w/Two Four Barrel Carburetors, UP TO Engine No. V41-10-7	16	----	----			*1855 042	
	SPRING, Intake, VA3 Police, VC1 Police, VC2 except VC2-300K, w/Two Four Barrel Carburetors, AFTER Engine No. V41-10-7	8	----	----			*1855 042	
	SPRING, Exhaust, VA3 Police, VC1 Police, VC2 except VC2-300K, w/Two Four Barrel Carburetors, AFTER Engine No. V41-10-7	8	----	----			*1944 854	
	SPRING, w/DAMPER VC2-300K, w/Two Four Barrel Carburetors . .	16	----	----			*2402 011	
	VC3, VY1	16	----	----			1944 854	
	SPRING, Outer, w/ DAMPER, Maximum Performance	16	----	----				2402 265

* Indicates use as required. Numerals in parentheses () refer to notes. Printed in U.S.A.
 ☒ Indicates parts not listed in any previous parts book. Prices and specifications subject to change without notice.
 March 15, 1965 Supersedes March 16, 1964. Page 9-38 * Indicates change or addition.

CODE	PART NAME AND DESCRIPTION	PER CAR	CUBIC INCH DISPLACEMENT				
			273	318	361	383	413

EIGHT CYLINDER ENGINES

9-39-O VALVE - Cont'd

9-39-15	SPRING w/DAMPER, Inner and Outer, Hemispherical	16	-----	-----	-----	-----	-----	*2532 258
	SPRING, Inner, Maximum Performance and Hemispherical	16	-----	-----	-----	-----	-----	*2202 547
	SPRING, UP TO Engine No. V42-10-7, Std. . . .	16	-----	-----	-----	-----	-----	1855 042
	SPRING, Intake, AFTER Engine No. V42-10-7, Std.	8	-----	-----	-----	-----	-----	1855 042
	SPRING, Exhaust, AFTER Engine No. V42-10-7, Std.	8	-----	-----	-----	-----	-----	1944 854
9-39-16	RETAINER, Valve Spring. Maximum Performance Std.	16 16 16	*2402 045 ----- -----	*2402 045 ----- -----	*2402 045 ----- -----	*2402 045 ----- -----	*2402 045 ----- -----	2202 546 *2402 045 2468 109
	Hemispherical	16	-----	-----	-----	-----	-----	
9-39-17	LOCK, Intake Valve Spring Retainer	16	381 875	381 875	381 875	381 875	381 875	
	LOCK, Exhaust Valve Spring Retainer	16	1614 666	1614 666	1614 666	1614 666	1614 666	
	LOCK, Valve Spring Retainer, Maximum Performance	32	-----	-----	-----	-----	-----	2402 312
	LOCK, Intake Valve Spring Retainer, Std.	16	-----	-----	-----	-----	-----	381 875
	LOCK, Exhaust Valve Spring Retainer, Std.	16	-----	-----	-----	-----	-----	1614 666
	LOCK, Valve Spring Re- tainer, Hemispherical	32	-----	-----	-----	-----	-----	2264 658
9-39-21	SPACER, Valve Spring . .	★ ★	1639 947 -----	1639 947 -----	1859 144 -----	1859 144 -----	1859 144 -----	1859 144

9-41-O VALVE TAPPET

9-41-1	SILENCER PACKAGE, Tappet Chamer except VC2-300K w/Two Four Barrel Carburetors . .	1 1	----- -----	----- -----	*1879 747 -----	*1878 747 -----	*1879 747 -----	1879 747
	Std.	1	-----	-----	-----	-----	-----	
9-41-4	TAPPET, Valve Std. . .	16	2203 250	2203 250				
	.001 O/S	16	2203 252	2203 252				
	.008 O/S	16	*2269 024	*2269 024				
	.030 O/S	16	1739 359	1739 359				
	Std. except VC2-300K, w/Two Four Barrel Carburetors	16	-----	-----	*2084 029	*2084 029	*2084 029	
	.001 O/S except VC2-300K, w/Two Four Barrel Carburetors	16	-----	-----	*2084 030	*2084 030	*2084 030	
	.008 O/S except VC2-300K, w/Two Four Barrel Carburetors	16	-----	-----	*2084 031	*2084 031	*2084 031	
	.030 O/S except VC2-300K, w/Two Four Barrel Carburetors	16	-----	-----	*2084 032	*2084 032	*2084 032	

★ Indicates use as required.

Numerals in parentheses () refer to notes.

Printed in U.S.A.

□ Indicates parts not listed in any previous parts book.

Prices and specifications subject to change without notice.

* Indicates change or addition.

CODE	PART NAME AND DESCRIPTION	PER CAR	CUBIC INCH DISPLACEMENT				
			273	318	361	383	413

EIGHT CYLINDER ENGINES

9-41-0 VALVE TAPPET - Cont'd

9-41-4	TAPPET - Cont'd							
	Std. VC2-300K, w/Two Four Barrel Carburetors	16	-----	-----	-----	-----	*2203 250	
	.001 O/S VC2-300K w/Two Four Barrel Carburetors	16	-----	-----	-----	-----	*2203 252	
	.008 O/S VC2-300K, w/Two Four Barrel Carburetors	16	-----	-----	-----	-----	*2269 024	
	.030 O/S VC2-300K, w/Two Four Barrel Carburetors	16	-----	-----	-----	-----	*1739 359	
	Std., Maximum Performance, Hemispherical	16	-----	-----	-----	-----	-----	2402 288
	.001 O/S., Maximum Performance, Hemispherical	16	-----	-----	-----	-----	-----	2402 289
	.008 O/S., Maximum Performance, Hemispherical	16	-----	-----	-----	-----	-----	2402 290
	.030 O/S., Maximum Performance, Hemispherical	16	-----	-----	-----	-----	-----	2402 719
	Std., Std.	16	-----	-----	-----	-----	-----	2084 029
	.001 O/S, Std.	16	-----	-----	-----	-----	-----	2084 030
	.008 O/S, Std.	16	-----	-----	-----	-----	-----	2084 031
	.030 O/S, Std.	16	-----	-----	-----	-----	-----	2084 032

9-42-0 VALVE PUSH ROD

9-42-1	ROD	16	2465 343	1637 721				
		16	-----	-----	1737 757	1737 757		
	Except VC2-300K, w/Two Four Barrel Carburetor	16	-----	-----	-----	-----	*1851 669	
	VC2-300K, w/Two Four Barrel Carburetors . .	16	-----	-----	-----	-----	*2129 010	
	Maximum Performance .	16	-----	-----	-----	-----	-----	2402 326
	Std.	16	-----	-----	-----	-----	-----	1851 669
	ROD, Intake Valve Push, Hemispherical	8	-----	-----	-----	-----	-----	2468 092
	ROD, Exhaust Valve Push, Hemispherical	8	-----	-----	-----	-----	-----	2468 094

9-43-0 VALVE ROCKER

9-43-1	ROCKER.	16	2465 332					
	Intake Valve	8	-----	1859 919				
	Exhaust Valve	8	-----	1854 953				
	ROCKER, Right, except VC2-300K w/Two Four Barrel Carburetors . .	8	-----	-----	*1737 646	*1737 646	*1737 646	
	Left, except VC2-300K w/Two Four Barrel Carburetors	8	-----	-----	*1737 645	*1737 645	*1737 645	
	Right, w/Adjusting SCREW and NUT, VC2-300K, w/Two Four Barrel Carburetors . .	8	-----	-----	-----	-----	*2463 242	
	Left, w/Adjusting SCREW and NUT, VC2-300K, w/Two Four Barrel Carburetors . .	8	-----	-----	-----	-----	*2463 243	
	Right, w/Adjusting SCREW and NUT, Maximum Performance	8	-----	-----	-----	-----	-----	2463 242

★ Indicates use as required. Numerals in parentheses () refer to notes. Printed in U.S.A.
 □ Indicates parts not listed in any previous parts book. Prices and specifications subject to change without notice.

CODE	PART NAME AND DESCRIPTION	PER CAR	CUBIC INCH DISPLACEMENT				
			273	318	361	383	413

EIGHT CYLINDER ENGINES

9-43-0 VALVE ROCKER - Cont'd							
9-43-1	ROCKER - Cont'd						
	Left, w/Adjusting SCREW and NUT, Maximum Performance	8	----	----	----	----	2463 243
	Right, Std.	8	----	----	----	----	1737 646
	Left, Std.	8	----	----	----	----	1737 645
	ROCKER, Intake Valve, Hemispherical	8	----	----	----	----	2468 173
ROCKER, Exhaust Valve, Hemispherical	8	----	----	----	----	2468 174	
9-43-2	BUSHING, Intake Valve Rocker, Hemispherical	8	----	----	----	----	*2468 898
	BUSHING, Exhaust Valve Rocker, Hemispherical	8	----	----	----	----	2468 132
9-43-3	SCREW, Adjusting	16	1855 238	1855 238			
	VC2-300K, w/Two Four Barrel Carburetors . .	16	----	----		*2402 525	
		16	----	----		----	2402 525
	NUT, VC2-300K, w/Two Four Barrel Carburetors	16	----	----		*6023 587	*6023 587
9-43-5	SPACER, Valve Rocker .	8	2463 324				
	Except VC2-300K, w/Two Four Barrel Carburetors	8	----	----	*1737 756	*1737 756	*1737 756
	Std.	8	----	----	----	----	1737 756
9-43-9	SHAFT, Valve Rocker . .	2	2463 321	1618 671			
		2	----	----	2465 850	2485 850	2465 850
	SHAFT, Valve Rocker, except Hemispherical .	2	----	----	----	----	2465 850
	SHAFT, Intake Valve Rocker, Hemispherical	2	----	----	----	----	2468 124
	SHAFT, Exhaust Valve Rocker, Hemispherical	2	----	----	----	----	2468 126
9-43-10	BRACKET, Rocker Shaft Support Off Set, Hemispherical	2	----	----	----	----	2468 091
	BRACKET, Rocker Shaft Support, Hemispherical	4	----	----	----	----	2468 089
	BRACKET, Rocker Shaft Support, Intermediate, Hemispherical	4	----	----	----	----	2468 088
9-43-11	RETAINER, Shaft, End and Center	6	*2463 322	----	*2463 282	*2463 282	*2463 282
	Shaft, Intermediate . . .	4	*2463 323	----	*2463 283	*2463 283	*2463 283
	Shaft, End and Center, except Hemispherical .	6	----	----	----	----	2463 282
	Shaft, Intermediate, except Hemispherical .	4	----	----	----	----	2463 283
9-43-14	SPRING, Shaft	8	----	1632 106			
	VC2-300K, w/Two Four Barrel Carburetor . .	8	----	----		*2202 557	
	Maximum Performance .	8	----	----		----	*2202 557
	Hemispherical	14	----	----		----	*2468 128
	Hemispherical	2	----	----		----	*1632 106
9-43-19	PLUG, Shaft	4	1324 268	1858 802			
		*	----	----	1324 268	1324 268	1324 268
9-43-26	PIN, Shaft Bracket Locating	2	----	1870 476			

* Indicates use as required. Numerals in parentheses () refer to notes. Printed in U.S.A.
 † Indicates parts not listed in any previous parts book. Prices and specifications subject to change without notice.

CODE	PART NAME AND DESCRIPTION	PER CAR	CUBIC INCH DISPLACEMENT					
			273	318	361	383	413	426

EIGHT CYLINDER ENGINES

9-45-0 FLYWHEEL							
9-45-1	FLYWHEEL, w/Ring	1	2463 256				
	GEAR, VV2, VL2	1	----	2264 597	2264 597	2264 597	
	VP2, VD2	1	----				
	VA3, VC1, VC2, except the Four Speed Trans.	1	----		2264 653	2264 653	2264 653
	VA3, VC2, w/Four Speed Trans.	1	----		2264 597	2264 597	2264 597
	Maximum Performance .	1	----				*2402 215
	Hemispherical	1	----				⊠2536 400
	BOLT	6	----		6023 145	6023 145	6023 145
	BOLT, Maximum Performance	6	----				*6023 145
	BOLT, Hemispherical . .	8	----				⊠9411 259
9-45-2	GEAR, Flywheel Ring, VV2, VL2	1	2121 196				
	VP2, VD2	1	----	1941 648	1941 648	1941 648	1941 648
	VA3, VC1, VC2, except Four Speed Trans. . .	1	----		1673 646	1673 646	1673 646
	VA3, VC2, w/Four Speed Trans.	1	----		1941 648	1941 648	1941 648
	GEAR, Torque Converter Starter Ring	1	2121 196	1941 648	1941 648	1941 648	1941 648
9-46-0 TORQUE CONVERTER							
9-46-4	TORQUE CONVERTER . .	1	2204 403	2125 090	2125 090	2125 090	
	Except VC2-300K w/Two Four Barrel Carburetors	1	----				*2125 090
	VC2-300K, w/Two Four Barrel Carburetors . .	1	----				*2464 314
	Std.	1	----				*2125 090
	w/11 3/4" Dia. Maximum Performance	1	----				*2464 314
	w/10 3/4" dia. Hemispherical	1	----				*2466 323
	PLUG, Drain	1	444 614	444 614	444 614	444 614	444 614
9-46-8	PLATE, Torque Converter Drive	1	2400 885	2204 768	2204 768	2204 768	
	Except VC2-300K, w/Two Four Barrel Carburetors	1	----				*2204 768
	VC2-300K, w/Two Four Barrel Carburetors . .	1	----				*2464 231
	Std.	1	----				*2204 768
	w/11 3/4" dia. Maximum Performance	1	----				*2464 231
	w/10 3/4" dia. Hemispherical	1	----				⊠2466 715
9-46-21	SCREW, Drive Plate to Torque Converter . . .	4	1949 765	1949 765	1949 765	1949 765	
	Except VC2-300K, w/Two Four Barrel Carburetors	4	----				*1949 765
	VC2-300K, w/Two Four Barrel Carburetors . .	4	----				*6024 318
	SCREW, Drive Plate to Crankshaft	6	1949 424	1949 424	1949 424	1949 424	
	Except VC2-300K, w/Two Four Barrel Carburetors	6	----				*1949 424
	VC2-300K, w/Two Four Barrel Carburetors . .	6	----				*6024 293

* Indicates use as required.

Numerals in parentheses () refer to notes.

Printed in U.S.A.

⊠ Indicates parts not listed in any previous parts book.

Prices and specifications subject to change without notice.

March 15, 1965.

Page 9-42

* Indicates change or addition.

CODE	PART NAME AND DESCRIPTION	PER CAR	CUBIC INCH DISPLACEMENT					
			273	318	361	383	413	426

EIGHT CYLINDER ENGINES

9-46-O TORQUE CONVERTER - Cont'd

9-46-21	SCREW - Cont'd Maximum Performance	6	-----	-----	-----	-----	-----	-----	*6024 293
	Hemispherical	8	-----	-----	-----	-----	-----	-----	B6025 528
9-46-27	TUBE, Transmission Oil Cooler Inlet and Outlet	★	1843 253	1843 253	1843 253	1843 253	1843 253	1843 253	1843 253
9-46-31	OIL COOLER, Radiator Core	1	1903 792	1903 792	1903 792	1903 792	-----	-----	-----
		1	-----	-----	-----	-----	1903 791	-----	1903 791
9-46-33	BRACKET, Transmission Oil Cooler Tube	1	*1949 176	1949 176	1949 176	1949 176	1949 176	-----	-----
	Except Hemispherical	1	-----	-----	-----	-----	-----	-----	1949 176
	Hemispherical	1	-----	-----	-----	-----	-----	-----	2532 235
9-46-40	CONNECTOR, Transmission Oil Cooler Tube, Radiator and Trans. End	★	118 749	118 749	118 749	118 749	118 749	118 749	118 749
	ELBOW, Transmission Inlet	1	2205 237	-----	-----	-----	-----	*2205 237	-----
9-46-43	NUT, Transmission Oil Cooler Tube Radiator End, Transmission End	★	1941 667	1941 667	1941 667	1941 667	1941 667	1941 667	1941 667
9-46-94	DOWEL, Cylinder Block to Clutch Housing or Torque Converter Transmission Housing Eccentric .007 Over Center except Hemispherical	★	1736 347	1736 347	1736 347	1736 347	1736 347	1736 347	1736 347
	Eccentric .014 Over Center except Hemispherical	★	1736 348	1736 348	1736 348	1736 348	1736 348	1736 348	1736 348
	Eccentric .021 Over Center except Hemispherical	★	1736 353	1736 353	1736 353	1736 353	1736 353	1736 353	1736 353
9-46-130	SEAL, Transmission Torque Converter Impeller Hub	1	2124 705	1942 020	1942 020	1942 020	1942 020	1942 020	1942 020
9-46-228	ROLLER, Overrunning Clutch	8	670 776	670 776	670 776	670 776	670 776	670 776	670 776

9-48-O MANIFOLD

9-48-6	MANIFOLD, Exhaust, Right	1	2465 766	2129 194					
	Left	1	2465 848	2268 127					
	Right, VP2, VD2	1	-----	-----	2205 905	2205 905			
	Left, VP2, VD2	1	-----	-----	2203 091	2203 091			
	Right, VA3, VC1, VC2 Except VC2-300K, w/Two Four Barrel Carburetors, VC3, VY1	1	-----	-----	*1854 990	*1854 990	*1854 990		
	Left, VA3, VC1, VC2 Except VC2-300K, w/Two Four Barrel Carburetors, VC3, VY1	1	-----	-----	*1739 800	*1739 800	*1739 800		
	Right, VC2-300K, w/Two Four Barrel Carburetors	1	-----	-----	-----	-----	-----	*2269 013	
	Left, VC2-300K, w/Two Four Barrel Carburetors	1	-----	-----	-----	-----	-----	*2269 093	

★ Indicates use as required.

Numerals in parentheses () refer to notes.

Printed in U.S.A.

⊠ Indicates parts not listed in any previous parts book.

Prices and specifications subject to change without notice.

* Indicates change or addition.

1964 PASSENGER CAR PARTS CATALOG

ENGINE

CODE	PART NAME AND DESCRIPTION	PER CAR	CUBIC INCH DISPLACEMENT				
			273	318	361	383	413

EIGHT CYLINDER ENGINES

9-48-0 MANIFOLD - Cont'd

9-48-6	MANIFOLD - Cont'd							
	Right, Header, Maximum Performance	1	-----	-----	-----	-----	-----	2402 335
	Left, Header, Maximum Performance	1	-----	-----	-----	-----	-----	2402 337
	Right, Std.	1	-----	-----	-----	-----	-----	2205 905
	Left, Std.	1	-----	-----	-----	-----	-----	2203 091
	Right, Header, Hemispherical	1	-----	-----	-----	-----	-----	2468 657
	Left, Header, Hemispherical	1	-----	-----	-----	-----	-----	2468 658
	SCREW, Exhaust Manifold	4	9421 360					
	STUD	1	-----	*6024 380				
9-48-7	MANIFOLD, Intake	1	2463 253	2448 757				
	w/Two Barrel Carburetor, VP2, VD2, VA3, VC1, VC2	1	-----	-----	1859 299	1859 299		
	w/Four Barrel Carburetor VP2, VD2	1	-----	-----	-----	1859 300		
	VA3 Police, VC1 Police, VC2 except VC2-300K, w/Two Four Barrel Carburetors, VC3, VY1	1	-----	-----	-----	-----	*1858 623	
	Right, VC2-300K, w/Two Four Barrel Carburetors	1	-----	-----	-----	-----	*2421 368	
	Left, VC2-300K, w/Two Four Barrel Carburetors	1	-----	-----	-----	-----	*2421 369	
	Maximum Performance Std.	1	-----	-----	-----	-----	-----	2465 214
	Hemispherical	1	-----	-----	-----	-----	-----	1858 623
	WASHER, Intake Manifold to Cylinder Screw and Stud	16	-----	-----	-----	-----	-----	2468 418
	SCREW, Intake Manifold	10	9421 218					6022 181
	SCREW	8	-----	9419 882				
	SCREW, w/WASHER, Intake Manifold to Cylinder Head	4	-----	-----	-----	-----	-----	
	Hemispherical	4	-----	-----	-----	-----	-----	E6025 689
	Hemispherical	6	-----	-----	-----	-----	-----	E6025 690
	Hemispherical	4	-----	-----	-----	-----	-----	E6025 691
9-48-8	CONNECTOR, Intake Manifold Vacuum Control VA3, VC1, VC2	1	-----	1858 955	1858 955	1858 955		
		1	-----	-----	-----	-----	1858 955	
		1	-----	-----	-----	-----	-----	1944 092
9-48-9	PLUG, Intake Manifold Core Hole	6	-----	-----	-----	-----	-----	2406 356
	PLUG, Intake Manifold Screw Hole	6	-----	-----	-----	-----	-----	1392 371
9-48-13	PIPE, Intake Manifold Heat Inlet, Right, VC2-300K, w/Two Four Barrel Carburetors . .	1	-----	-----	-----	-----	*2402 686	
	Left, VC2-300K, w/Two Four Barrel Carburetors	1	-----	-----	-----	-----	*2402 684	
	PIPE, Intake Manifold Heat Outlet, Right VC2-300K, w/Two Four Barrel Carburetors . .	1	-----	-----	-----	-----	*2402 643	
	Left, VC2-300K, w/Two Four Barrel Carburetors	1	-----	-----	-----	-----	*2402 641	

* Indicates use as required.

E Indicates parts not listed in any previous parts book.

Numerals in parentheses () refer to notes.

Printed in U.S.A.

Prices and specifications subject to change without notice.

* Indicates change or addition.

CODE	PART NAME AND DESCRIPTION	PER CAR	CUBIC INCH DISPLACEMENT				
			273	318	361	383	413

EIGHT CYLINDER ENGINES

9-48-0 MANIFOLD -Cont'd								
9-48-13	WASHER, Pipe Flange Screw	16	-----	-----	-----	-----	6022 185	
9-48-14	WASHER, Exhaust Manifold Screw	4	2121 223					
9-48-27	REINFORCEMENT, Intake Manifold Gasket End .	2	-----	-----	1859 332	1859 332		
	426 Std. Eng.	2	-----	-----	-----	-----	1851 665	1851 665
9-48-38	SEAL, Intake Manifold Screw Hole Plug . . .	6	-----	-----	-----	-----	-----	2128 962
9-48-43	SCREW, Exhaust Manifold, 5/16" x 2 1/8"	4	9413 845					
	STUD, Exhaust Manifold Flange	1	-----	6024 380				
	STUD, Exhaust Manifold, Lower.	8	-----	1613 782				
	STUD, Exhaust Manifold .	★	-----	-----	1613 782	1613 782	1613 782	1613 782
9-48-44	NUT, Exhaust Manifold Stud, Long	★	-----	-----	2268 282	2268 282	-----	2268 282
	VC2-300K, w/Two Four Barrel Carburetors . .	3	-----	-----	-----	-----	*2268 282	
	NUT, Exhaust Manifold Stud	★	-----	-----	1737 695	1737 695	1737 695	1737 695
9-48-45	WASHER, Intake Manifold Screw, VC2-300K	★	-----	-----	-----	-----	567 331	
9-48-56	SHIELD, Intake Manifold Heat	1	2463 264	1619 627				
	SHIELD, Exhaust Manifold Heat, Right, VP2, VD2	1	-----	-----	2463 531	2463 531		
9-48-77	BRACKET, Exhaust Manifold Steady, VC2-300K, w/Two Four Barrel Carburetors . .	2	-----	-----	-----	-----	*2202 426	
9-48-86	SPACER, Exhaust Manifold Steady Bracket, VC2-300K, w/Two Four Barrel Carburetors	4	-----	-----	-----	-----	*1947 751	
9-48-151	TUBE, Intake Manifold Equalizer, VC2-300K, w/Two Four Barrel Carburetors	1	-----	-----	-----	-----	*2206 153	
9-48-152	COUPLING, Intake Manifold Equalizer Tube, VC2-300K, w/Two Four Barrel Carburetors . .	2	-----	-----	-----	-----	*1947 403	
9-48-153	CLAMP, Intake Manifold Equalizer Tube Coupling VC2-300K, w/Two Four Barrel Carburetors . .	2	-----	-----	-----	-----	* 870 469	
9-48-155	BRACE, Exhaust Manifold Left to Cylinder Block VV2, VL2	1	2465 162					

★ Indicates use as required.

⊠ Indicates parts not listed in any previous parts book.

* Indicates change or addition.

Numerals in parentheses () refer to notes.

Prices and specifications subject to change without notice.

1964 PASSENGER CAR PARTS CATALOG

ENGINE

CODE	PART NAME AND DESCRIPTION	PER CAR	CUBIC INCH DISPLACEMENT				
			273	318	361	383	413

EIGHT CYLINDER ENGINES

9-48-0 MANIFOLD - Cont'd

9-48-155	BRACE, Exhaust Manifold Left to Cylinder Head, VV2, VL2	1	2465 161					
	SCREW, w/WASHER, Ex- haust Manifold, Left to Cylinder Head Brace. .	1	*6022 254					
9-48-158	COVER, Exhaust Crossover, Right and Left VC2-300K, w/Two Four Barrel Carburetors . .	2	-----	-----	-----	-----	-----	*2120 757

9-50-0 MANIFOLD GASKETS

9-50-1	GASKET SET, Intake Manifold	1	2495 081					
	GASKET SET, Manifold. .	1	-----	2525 090				
	GASKET SET, Intake Manifold, Maximum Performance	1	-----	-----	-----	-----	-----	2421 363
	GASKET SET, Intake Mani- fold, Hemispherical . .	1	-----	-----	-----	-----	-----	E2525 470
	GASKET SET, Exhaust Manifold, VC2-300K, w/Two Four Barrel Carburetors Exhaust Manifold, Maximum Performance	1	-----	-----	-----	-----	*2448 791	
		1	-----	-----	-----	-----	-----	2448 791
9-50-4	GASKET, Intake Manifold Heat Pipe Flange Upper VC2-300K, w/Two Four Barrel Carburetors . .	4	-----	-----	-----	-----	*1947 429	
9-50-5	GASKET, Exhaust Manifold, Left, w/Heat Shield . .	1	2465 845					
	GASKET, Exhaust Manifold	2	-----	1670 508				
	GASKET, Exhaust Manifold, Hemispherical	2	-----	-----	-----	-----	-----	2468 053
9-50-6	GASKET, Intake Manifold. Std.	1	-----	-----	1737 709	1737 709	1851 664	
		1	-----	-----	-----	-----	-----	1851 664
9-50-16	GASKET, Intake Manifold Heat Pipe Flange, Upper, VC2-300K, w/Two Four Barrel Carburetors, Lower	4	-----	-----	-----	-----	*1947 428	
	VC2-300K, w/Two Four Barrel Carburetors, Lower	4	-----	-----	-----	-----	*1947 429	

9-58-0 MANIFOLD HEAT CONTROL VALVE THERMOSTAT

9-58-1	PACKAGE, Manifold Heat Control	1	2525 034	2240 684				
	VP2, VD2	1	-----	-----	2279 887	2279 887		
	VA3, VC1, VC2 except VC2-300K, w/Two Four Barrel Carburetors, VC3, VY1	1	-----	-----	*2525 081	*2525 081	*2525 081	
9-58-5	THERMOSTAT	1	960 003	960 003				
	VP2, VD2	1	-----	-----	2128 933	2128 933		
	VA3, VC1, VC2 except VC2-300K, w/Two Four Barrel Carburetors, VC3, VY1	1	-----	-----	* 960 003	* 960 003	* 960 003	

* Indicates use as required.

E Indicates parts not listed in any previous parts book.

March 15, 1965.

Numerals in parentheses () refer to notes.

Prices and specifications subject to change without notice.

* Indicates change or addition.

CODE	PART NAME AND DESCRIPTION	PER CAR	CUBIC INCH DISPLACEMENT				
			273	318	361	383	413

EIGHT CYLINDER ENGINES

9-58-0 MANIFOLD HEAT CONTROL VALVE THERMOSTAT - Cont'd

9-58-12	COUNTERWEIGHT	1	2465 810					
	SHIELD	1	----	1670 515				
	VP2, VD2	1	----	----	1944 616	1944 616		
	VA3, VC1, VC2 except VC2-300K, w/Two Four Barrel Carburetors, VC3, VY1	1	----	----	*1670 515	*1670 515	*1670 515	
9-58-13	BOLT, Counterweight . .	1	1736 012					
	BOLT, Shield, except VC2-300K, w/Two Four Barrel Carburetors . .	1	----	*1736 012	*1736 012	*1736 012	*1736 012	
9-58-14	LOCK, Counterweight . .	1	1409 594					
	LOCK, Shield, except VC2-300K, w/Two Four Barrel Carburetors . .	1	----	*1409 594	*1409 594	*1409 594	*1409 594	

9-59-0 MANIFOLD HEAT CONTROL VALVE

9-59-13	SPRING, Valve, except VC2-300K, w/Two Four Barrel Carburetors . . .	1	*1558 897	*1558 897	*1558 897	*1558 897	*1558 897	
9-59-15	PIN, Valve, except VC2-300K, w/Two Four Barrel Carburetors . . .	1	*1639 597	*1639 597	*1639 597	*1639 597	*1639 597	

9-62-0 MANIFOLD HEAT CONTROL VALVE STOP

9-62-1	STOP, Valve, except VC2-300K, w/Two Four Barrel Carburetors . . .	1	* 683 057	* 683 057	* 683 057	*683 057	*683 057	
--------	---	---	-----------	-----------	-----------	----------	----------	--

9-64-0 ENGINE FRONT SUPPORT

9-64-5	SUPPORT, Right, VA3, VC1, VC2, VC3	1	----	----	2120 238	2120 238	2120 238	
	SUPPORT, Left, VA3, VC1, VC2, VC3	1	----	----	2120 237	2120 237	2120 237	
	SUPPORT, Right, VY1 . .	1	----	----	----	----	2128 572	
	SUPPORT, Left, VY1 . . .	1	----	----	----	----	2128 571	
	NUT, to Frame Stud, VA3, VC1, VC2, VC3, VY1	2	----	----	6023 353	6023 353	6023 353	
	WASHER, to Cylinder Block, VA3, VC1, VC2, VC3, VY1	6	----	----	6023 050	6023 050	6023 050	
9-64-13	STUD, Engine Front Support to Frame VA3, VC1, VC2, VC3, VY1	2	----	----	2128 773	2128 773	2128 773	
9-64-18	WASHER, Engine Front Support to Frame Stud VA3, VC1, VC2, VC3, VY1	2	2128 774	----	2128 774	2128 774	2128 774	
9-64-22	SHIELD, Engine Front Support Heat, Right, VA3, VC1, VC2, VC3, VY1	1	----	----	2128 935	2128 935	2128 935	
	Left, VA3, VC1, VC2 Except VC2-300K, w/Two Four Barrel Carburetors, VC3, VY1	1	----	----	*2128 936	*2128 936	*2128 936	
	Left, VC2-300K, w/Two Four Barrel Carburetors	1	----	----	----	----	*2406 371	

★ Indicates use as required. Numerals in parentheses () refer to notes. Printed in U.S.A.
 ☐ Indicates parts not listed in any previous parts book. Prices and specifications subject to change without notice.
 * Indicates change or addition. Page 9-47 March 15, 1965.

1964 PASSENGER CAR PARTS CATALOG

ENGINE

CODE	PART NAME AND DESCRIPTION	PER CAR	CUBIC INCH DISPLACEMENT				
			273	318	361	383	413

EIGHT CYLINDER ENGINES

9-64-O ENGINE FRONT SUPPORT - Cont'd

9-64-24	BRACKET, Engine Front Support Insulator, Right, VV2, VL2	1	2465 378					
	Left, VV2, VL2	1	2465 379					
	BRACKET, Engine Front Support Insulator . . .	2	-----	2402 185				
	Right, VP2, VD2	1	-----	-----	2268 220	2268 220	-----	
	Left, VP2, VD2	1	-----	-----	2268 216	2268 216	-----	
	Right, except Hemispherical	1	-----	-----	-----	-----	-----	2268 220
	Left, except Hemispherical	1	-----	-----	-----	-----	-----	2268 216
	Right, Hemispherical . .	1	-----	-----	-----	-----	-----	2468 151
	Left, Hemispherical . .	1	-----	-----	-----	-----	-----	2468 150
	Engine Front Support Insulator, Upper, w/Station Wagon P. D	2	-----	-----	E2536 139	E2536 139	E2536 139	E2539 136
	Engine Front Support Insulator, w/Station Wagon	2	-----	E2532 757				
	Frame, Right, w/Station Wagon	1	-----	E2532 758				
	Frame, Left, w/Station Wagon	1	-----	E2532 759				
	BRACKET and INSULATOR PACKAGE, Engine Front Support, w/Station Wagon, P. D	1	-----	-----	E2585 391	E2585 391	E2585 391	E2585 391
	WASHER, Bracket to Cylinder Block Bolt . .	6	6023 050	6023 050	6023 050	6023 050	-----	6023 050

9-67-O ENGINE FRONT SUPPORT INSULATOR

9-67-4	INSULATOR, Engine Front Support	2	2465 508					
	Right, VP2, VD2	1	-----	2402 182	2402 182	2402 182	-----	
	Left, VP2, VD2	1	-----	2402 183	2402 183	2402 183	-----	
	Engine Front Support, w/Station Wagon	2	-----	E2536 136				
	INSULATOR and BRACKET PACKAGE, Engine Front Support, w/Station Wagon	1	-----	E2585 293				
	NUT, Insulator to Frame Bolt	2	6023 353					
	INSULATOR, Left, except Hemispherical	1	-----	-----	-----	-----	-----	*2402 183
	Left, Hemispherical . .	1	-----	-----	-----	-----	-----	2468 184
	Right, Hemispherical . .	1	-----	-----	-----	-----	-----	*2532 708
	Right, except Hemispherical	1	-----	-----	-----	-----	-----	*2402 182

9-69-O FRAME ENGINE REAR SUPPORT CROSSMEMBER

9-69-4	CROSSMEMBER, Frame Transmission and Engine Mounting	1	2260 287					
	Except w/Floor Mounting Trans., VP2, VD2	1	-----	2265 423	2265 423	2265 423	-----	2265 423
	w/Floor Mounting Trans., VP2, VD2	1	-----	2208 740	2208 740	2208 740	-----	2208 740

★ Indicates use as required.

Numerals in parentheses () refer to notes.

Printed in U.S.A.

⊘ Indicates parts not listed in any previous parts book.

Prices and specifications subject to change without notice.

March 15, 1965.

* Indicates change or addition.

CODE	PART NAME AND DESCRIPTION	PER CAR	CUBIC INCH DISPLACEMENT					
			273	318	361	383	413	426

EIGHT CYLINDER ENGINES

9-69-0 FRAME ENGINE REAR SUPPORT CROSSMEMBER - Cont'd

9-69-4	CROSSMEMBER - Cont'd							
	w/Manual Trans., VA3, VC1, VC2	1	----	----	2122 578	2122 578		
	w/Automatic Trans., VA3, VC1, VC2, VC3 . .	1	----	----	2265 408	2265 408	2265 408	
	VY1 except Cv. Cp. . .	1	----	----	----	----	2265 420	
	VY1 Cv. Cp.	1	----	----	----	----	2265 418	
9-69-6	BRACKET, Frame Engine, Rear Support Crossmember, Right, VY1, CV. Cp.	1	----	----	----	----	1940 300	
	Left, VY1, Cv. Cp. . .	1	----	----	----	----	1940 301	
9-69-21	NUT, Engine Rear Support, VV2, VL2, VP2, VD2 . .	2	2129 684	2129 684	2129 684	2129 684	----	2129 684

9-70-0 FRAME ENGINE REAR SUPPORT CROSSMEMBER BRACKET

9-70-9	NUT, Frame Engine Rear Support Crossmember, Lower, VA3, VC1, VC2, VC3	4	----	----	1946 141	1946 141	1946 141	
--------	---	---	------	------	----------	----------	----------	--

9-71-0 ENGINE REAR SUPPORT INSULATOR

9-71-5	INSULATOR, Engine Rear Support, VV2, VL2 . .	1	2265 836					
	INSULATOR, Engine Rear Support, w/Automatic Trans., VP2, VD2 . .	1	----	*2265 826	*2265 826	*2265 826	----	*2265 826
	w/Three and Four Speed Manual Trans., VP2, VD2,	1	----	*2405 872	*2405 872	*2405 872		
	w/Four Speed Manual Trans., VP2, VD2	1	----	----	----	----		*2401 653
	w/Automatic Trans., VA3, VC1, VC2, VC3 . .	1	----	----	2201 990	2201 990	2201 990	
	w/Manual 3 Speed Trans., VA3, VC1, VC2	1	----	----	1734 529	1734 529	1734 529	
	w/Manual 4 Speed Trans., VA3, VC1, VC2	1	----	----	1946 362	1946 362	1946 362	
VY1	1	----	----	----	----	2206 979		
BOLT, to Frame, w/Manual 3 Speed Trans., VA3, VC1, VC2	2	----	----	6024 076	6024 076	6024 076		
NUT, w/Manual 3 Speed Trans., VA3, VC1, VC2	1	----	----	6022 805	6022 805	6022 805		
SCREW, w/WASHER, w/Manual 4 Speed Trans., VA3, VC1, VC2	2	----	----	6024 473	6024 473	6024 473		
SCREW, w/WASHER, VY1	2	----	----	----	----	B6025 419		
9-71-12	SPACER, Engine Rear Support Insulator, w/Manual 4 Speed Trans., VA3, VC1, VC2	1	----	----	2460 499	2460 499	2460 499	
	VY1	1	----	----	----	----	*2533 185	

* Indicates use as required.

Numerals in parentheses () refer to notes.

Printed in U.S.A.

⊠ Indicates parts not listed in any previous parts book.

Prices and specifications subject to change without notice.

* Indicates change or addition.

1964 PASSENGER CAR PARTS CATALOG

ENGINE

CODE	PART NAME AND DESCRIPTION	PER CAR	CUBIC INCH DISPLACEMENT				
			318	361	383	413	426

EIGHT CYLINDER ENGINES

9-71-0 ENGINE REAR SUPPORT INSULATOR - Cont'd

9-71-15	BUMPER, Engine Rear Support Insulator . . .	1	2206 965				
	STOP, Engine Rear Support Insulator, VA3, VC1, VC2, VC3	1	-----	-----	2201 989	2201 989	2201 989
9-71-16	SPRING, Engine Rear Support Insulator, w/Automatic Trans., VA3, VC1, VC2, VC3	1	-----	-----	2201 991	2201 991	2201 991
	w/Manual Trans., VA3, VC1, VC2	1	-----	-----	2122 278	2122 278	2122 278
9-71-17	PLATE, Engine Rear Support Insulator Spring, w/Manual Trans., VA3, VC1, VC2	1	-----	-----	2203 897	2203 897	2203 897
9-71-13	STUD, w/WASHER, Engine Rear Support Insulator, w/Automatic Trans., VA3, VC1, VC2, VC3	1	-----	-----	2201 985	2201 985	2201 985
	w/Manual Trans., VA3, VC1, VC2	1	-----	-----	2122 275	2122 275	2122 275
9-71-19	WASHER, Engine Rear Support Insulator, w/Manual Trans., VA3, VC1, VC2	1	-----	-----	2122 279	2122 279	2122 279

NOTES

★ Indicates use as required.
 ☐ Indicates parts not listed in any previous parts book.
 March 15, 1965.

Numerals in parentheses () refer to notes.