

SWAY ELIMINATOR - PLYMOUTH TP1-2 AND DODGE TD1-2

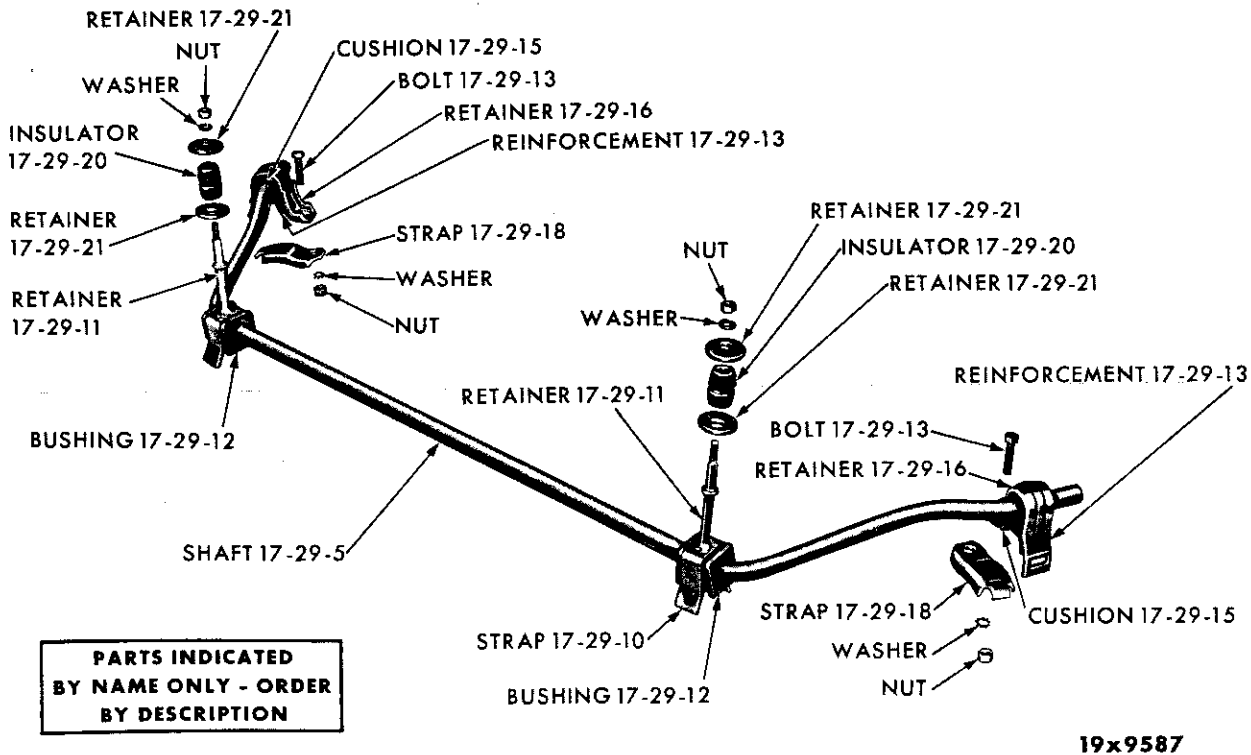

SWAY ELIMINATOR - DODGE TA3 AND CHRYSLER TC1-2-3

CODE	PART NAME AND DESCRIPTION	C Y L.	PER CAR	VALIANT DART	PLYMOUTH DODGE	CHRYSLER IMPERIAL
17-11-O REAR SPRINGS						
17-11-3	SPRING, Std., except Sub., w/170 cu. in. Eng., Right, TV1	6	1	2421 761		
	Std., except Sub., w/170 cu. in. Eng., Left, TV1	6	1	2275 851		
	Std., except Sub., w/225 cu. in. Eng., Right, TV1	6	1	2421 739		
	Std., except Sub., w/225 cu. in. Eng., Left, TV1	6	1	2298 935		
	Std., except Sub., w/170 cu. in. Eng., Right, TL1	6	1	2275 851		
	Std., except Sub., w/170 cu. in. Eng., Left, TL1	6	1	2421 761		
	Std., except Sub., w/225 cu. in. Eng., Right, TL1	6	1	2298 935		
	Std., except Sub., w/225 cu. in. Eng., Left, TL1	6	1	2421 739		
	Std., Sub., Right	6	1	2275 853		
	Std., Sub., Left	6	1	2421 742		
	Heavy Duty, except Sub., Right	6	1	2298 513		
	Heavy Duty, except Sub., Left	6	1	2421 741		
	Heavy Duty, Sub., Right	6	1	2275 856		
	Heavy Duty, Sub., Left	6	1	2275 857		
	Std., 2D., Sp. Cl. Cp.	6	2	----	2275 858	
	Std., 4D., Sp. 4D.	6	2	----	2275 858	
	Std., Sub., Right	6	1	----	2275 863	
	Std., Sub., Left	6	1	----	2275 864	
	Heavy Duty, except Sub.	6	2	----	2448 340	
	Heavy Duty, Sub., Right	6	1	----	2275 866	
	Heavy Duty, Sub., Left	6	1	----	2275 867	
	Std., 2D., Sp. Cl. Cp., 4D., w/318 cu. in. Eng.	8	2	----	2275 858	
	Std., Cv. Cp., Sp. 4D., w/318 cu. in. Eng.	8	2	----	2275 859	
	Std., except Sub., w/361 cu. in. Eng., TP2, TD2	8	2	----	2298 929	
	Std., Sub., Right, TP2, TD2	8	1	----	2275 864	
	Std., Sub., Left, TP2, TD2	8	1	----	2275 865	
	Heavy Duty, 2D., Sp. Cl. Cp., w/318 cu. in. Eng.	8	2	----	2448 340	
	Heavy Duty, Cv. Cp., 4D., Sp. 4D., w/318 cu. in. Eng.	8	2	----	2448 341	
	Heavy Duty, w/361, 383, 426 cu. in. Eng.	8	2	----	2448 341	
	Heavy Duty, Sub., Right, TP2, TD2	8	1	----	2275 867	
	Heavy Duty, Sub., Left, TP2, TD2	8	1	----	2275 868	
	Std., except Sub., Right, TA3, TC1, TC2 except 300J	8	1	----	2448 300	2448 300
	Std., except Sub., Left, TA3, TC1, TC2 except 300J	8	1	----	2448 301	2448 301
	w/Dual Air Conditioning, except Sub., Right, TA3, TC1, TC2 except 300J	8	1	----	2448 301	2448 301
	w/Dual Air Conditioning, except Sub., Left, TA3, TC1, TC2 except 300J	8	1	----	2448 302	2448 302
	w/o Dual Air Conditioning, TC2 w/413 cu. in. Eng., except 300J	8	2	----	----	*2240 240
	w/Dual Air Conditioning, TC2 w/413 cu. in. Eng., except 300J, Right	8	1	----	----	2240 240
	w/Dual Air Conditioning, TC2 w/413 cu. in. Eng., except 300J, Left	8	1	----	----	2084 909
	TC2-300J	8	2	----	----	2448 306
	Std., except Sub., TC3	8	2	----	----	*2240 240
	w/Dual Air Conditioning, except Sub., Right, TC3	8	1	----	----	2240 240
	w/Dual Air Conditioning, except Sub., Left, TC3	8	1	----	----	2084 909
	Std., Sub., Right, TA3, TC1, TC3	8	1	----	2448 304	2448 304
	Std., Sub., Left, TA3, TC1, TC3	8	1	----	2448 305	2448 305
	Heavy Duty, except Sub., TA3, TC1, TC2 except 300J, TC3	8	2	----	2448 303	2448 303
	Heavy Duty, Sub., Right, TA3, TC1, TC3	8	1	----	2275 870	2275 870
	Heavy Duty, Sub., Left, TA3, TC1, TC3	8	1	----	2275 871	2275 871

★ Indicates use as required. Numerals in parentheses () refer to notes. Printed in U.S.A.
 □ Indicates parts not listed in any previous parts book. Prices and specifications subject to change without notice.
 * Indicates change or addition. Page 17-3 Jan. 3, 1964 Supersedes Dec. 14, 1962.

1963 PASSENGER CAR PARTS CATALOG

SPRINGS

CODE	PART NAME AND DESCRIPTION	C Y L.	PER CAR	VALIANT DART	PLYMOUTH DODGE	CHRYSLER IMPERIAL
17-11-O REAR SPRINGS - Cont'd						
17-11-3	SPRING - Cont'd					
	Std., Right, TY1	8	1	----	----	2421 757
	Std., Left, TY1	8	1	----	----	2421 758
	w/Dual Air Conditioning, Right, TY1	8	1	----	----	2421 756
	w/Dual Air Conditioning, Left, TY1	8	1	----	----	2448 399
	Heavy Duty, Right, TY1	8	1	----	----	2421 760
	Heavy Duty, Left, TY1	8	1	----	----	2421 762
17-11-7	PLATE, w/STUD, Right		1	2071 766	1856 346	1856 346
	Left		1	2071 767	1856 347	1856 347
17-12-O REAR SPRING LEAF						
17-12-3	BOOSTER PACKAGE, No. 2 Leaf except Sub., TA3, TC1, TC2	8	★	----	E2403 790	E2403 790
17-12-4	LEAF, Main, Std., w/170 cu. in. Eng.	6	2	2448 351		
	Std., w/225 cu. in. Eng.	6	2	2448 350		
	Std., except TA3		2		2084 819	
	w/361 cu. in. Eng., TP2, TD2	8	2	----	2298 918	
	Std., TA3, TC1, TC2	8	2	----	*2084 825	*2084 825
	Std., or w/Dual Air Conditioning, except Sub., TC3	8	2	----	----	2084 823
	Std., Sub., TC3	8	2	----	----	2084 825
	TC2-300J	8	2	----	----	2448 352
	Std., or w/Dual Air Conditioning, TY1	8	2	----	----	2448 706
	Heavy Duty, except Sub., except TA3		2	2196 785	2084 818	
	Heavy Duty, Sub., except TA3		2	2196 786	2084 818	
	Heavy Duty or w/Dual Air Conditioning, except Sub., TA3, TC1, TC2	8	2	----	2084 820	2084 820
	Heavy Duty, Sub., TA3, TC1	8	2	----	2084 821	2084 821
	Heavy Duty, except Sub., TC3	8	2	----	----	2084 824
	Heavy Duty, Sub., TC3	8	2	----	----	2298 920
	Heavy Duty, TY1	8	2	----	----	2448 707
17-12-6	INTERLEAF, TY1	8	4	----	----	2123 781
17-12-12	INTERLINER	6	★	1948 396		
	2 1/2" x 2 1/2"		★	----	2122 359	2122 359
	2 1/2" x 3 1/2"		★	----	2123 785	2123 785
17-14-O REAR SPRING CENTER BOLT						
17-14-10	BOLT		2	1944 361	1944 361	1944 361
17-15-O REAR SPRING CLIP						
17-15-1	CLIP, 5 3/8" lgh.	6	4	2071 771		
	5 7/8" lgh.	6	4	2071 787		
	7" lgh.		4	----	1489 747	1489 747
	7 3/8" lgh.		4	----	1635 666	1635 666
17-15-6	NUT		8	6023 020	6023 021	6023 021
17-15-24	INSULATOR, Alignment Clip.		2	1829 929	1829 929	1829 929
17-15-25	CLIP, Alignment, 1" lgh.		2	1820 812	1820 812	1820 812
	1 1/4" lgh., TC1, TC2		2	1820 152	1820 152	1820 152
	1 1/2" lgh.		2	----	1820 153	1820 153
	1 7/8" lgh., TY1	8	2	----	----	1820 813
17-15-28	SCREW, Alignment		4	1485 510	1485 510	1485 510
17-15-30	WASHER, Screw		4	1530 398	1530 398	1530 398

★ Indicates use as required. Numerals in parentheses () refer to notes. Printed in U.S.A.
 ☐ Indicates parts not listed in any previous parts book. Prices and specifications subject to change without notice.
 Jan. 3, 1964 Supersedes Dec. 14, 1962. Page 17-4 * Indicates change or addition.

CODE	PART NAME AND DESCRIPTION	C Y L.	PER CAR	VALIANT DART	PLYMOUTH DODGE	CHRYSLER IMPERIAL
17-16-O REAR SPRING SHACKLE						
17-16-1	SHACKLE and BUSHING PACKAGE	6	2	2196 010		
	Except Sub., except TA3		2	----	1450 961	
	Except Sub., TA3	8	2	----	1450 087	1450 087
	Sub., except TA3		2	----	2275 543	
	Sub., TA3, TC1, TC3	8	2	----	2084 236	2084 236
17-16-8	BUSHING, Shackle		8	1940 725	1400 269	1400 269
17-17-O REAR SPRING SILENT BLOCK						
17-17-3	BUSHING, Front Pivot, TC1, TC2, TC3		2	2071 763	1948 869	1948 869
	TY1	8	2	----	----	2403 245
17-17-4	BOLT		2	2071 761	1948 876	1948 876
	WASHER, Coned, except TA3		8	6022 191	6022 191	
17-17-5	NUT		2	2071 772	1948 877	1948 877
17-19-O REAR SPRING BUMPER						
17-19-3	BUMPER, Axle Drive Pinion Carrier, except TA3		1	2206 637	2206 637	
	TA3, TC1, TC2, TC3	8	1	----	1948 338	1948 338
	TY1	8	1	----	----	2206 637
	w/426 cu.in. Eng.	8	1	----	1948 338	
	Side Rail Rear Axle, except TA3		2	2206 940	2206 940	
	Std., TA3, TC1, TC2, TC3	8	2	----	2206 884	2206 884
	Heavy Duty, TA3, TC1, TC2, TC3	8	2	----	2206 939	2206 939
	Std., TY1	8	2	----	----	2206 941
	Heavy Duty, TY1	8	2	----	----	2206 942
17-19-4	BRACKET, Center Floor Pan Pinion Carrier . . .	6	1	2242 396		
17-19-6	NUT, Axle Drive Pinion Carrier Bumper Retainer,		1	----	1943 997	1943 997
	TA3, TC1, TC2, TC3	8				
17-19-10	PLATE, Side Rail Rear Axle Bumper, TC1,		2	2206 883	2206 883	2206 883
	TC2, TC3					
17-19-20	SUPPORT, Bumper, except TA3		1	*2403 901	*2403 903	
	TA3, TC1, TC2, TC3	8	1	----	1948 351	1948 351
	w/426 cu.in. Eng., w/PLATE	8	1	----	2403 265	
	REINFORCEMENT, Center Floor Pan Pinion		1	----	2251 351	
	Carrier Bumper, except TA3	8	1	----	----	*2403 905
	TY1	8	1	----	----	
	WASHER	6	3	6022 185		
17-23-O SHOCK ABSORBERS						
17-23-3	ABSORBER PACKAGE, Front Shock, Std., except		2	2298 803	2448 337	
	TA3		2	----	*2298 805	*2298 805
	Front, Std., TA3	8	2	----	2275 883	
	Front, Heavy Duty, except TA3		2	2298 804	2298 807	2298 807
	Front, Heavy Duty, TA3	8	2	----	2448 338	
	Rear, Std., except TA3		2	2240 317	2298 912	2298 912
	Rear, Std., except Sub., TA3, TC1, TC2, TC3 . .	8	2	----	2240 358	2240 358
	Rear, Std., Sub., TA3, TC1, TC3	8	2	----	----	2298 900
	Rear, Std., TY1	8	2	----	2275 849	
	Rear, Heavy Duty, except TA3		2	2298 912	2240 360	2240 360
	Rear, Heavy Duty, TA3	8	2	----	2275 848	
	Rear, Heavy Duty, 1 3/8" dia., except TA3 . . .		2	----	----	
	Rear, Heavy Duty, 1 3/8" dia., TA3, TC1, TC2,	8	2	----	2240 362	2240 362
	TC3					

★ Indicates use as required. Numerals in parentheses () refer to notes. Printed in U.S.A.
 □ Indicates parts not listed in any previous parts book. Prices and specifications subject to change without notice.
 * Indicates change or addition. Jan. 3, 1964 Supersedes Dec. 14, 1962.

CODE	PART NAME AND DESCRIPTION	C Y L.	PER CAR	VALIANT DART	PLYMOUTH DODGE	CHRYSLER IMPERIAL
17-23-O SHOCK ABSORBERS - Cont'd						
17-23-52	BUSHING, Front Shock Absorber Upper Mounting		2	2206 923	2206 923	2206 923
	Lower Mounting		2	1635 588	1635 588	1635 588
	Rear, Upper, except TA3		2	1319 902	2201 554	
	Rear, Upper, TA3	8	2	----	1319 902	1319 902
	Rear, Lower		2	1319 902	1319 902	1319 902
17-23-53	WASHER, Pivot Bushing Retainer Inner, Rear		4	1319 555	1319 555	1319 555
	Outer		4	1319 554	1319 554	1319 554
	Upper, Front		4	2206 925	2206 925	2206 925
17-23-56	STUD, Upper Mounting, Rear, TA3		2	2071 714	1948 884	1948 884
	BOLT, Upper Mounting, Rear, except TA3		2	----	182 785	
	BOLT, Lower Mounting, Front		2	6022 823	6022 823	6022 823
17-23-57	NUT, Upper Stud, Rear, TA3		2	*6023 890	*6023 890	*6023 890
	Upper Mounting Bolt, Rear, except TA3		2	----	1929 355	
	Lower Mounting Bolt, Front		2	6022 831	6022 831	6022 831
	WASHER, Rear Upper Stud	6	2	*6024 248		
17-24-O SHOCK ABSORBER BRACKET						
17-24-3	BRACKET, Rear, Right, except TA3		1	----	2188 050	
	Left		1	----	2188 051	
17-24-28	SUPPORT, Front Shock Absorber, TA3	8	2	----	1675 821	1675 821
17-29-O SWAY ELIMINATOR SHAFT						
17-29-5	SHAFT, except TA3		1	----	1857 906	
	TA3, TC1, TC2, TC3	8	1	----	1671 437	1671 437
	TY1	8	1	----	----	1672 964
17-29-6	BRACKET, Support, Right, except TA3		1	----	1858 100	
	Left, except TA3		1	----	1858 101	
	Frame, TA3, TC1, TC2, TC3	8	2	----	1824 879	1824 879
17-29-9	SPACER, Support Bracket, except TA3		2	----	1858 105	
17-29-10	STRAP, Bushing		2	----	1673 065	1673 065
17-29-11	RETAINER, Bushing, TA3	8	2	----	1673 060	1673 060
17-29-12	BUSHING, except TA3		2	----	1824 935	1824 936
	TA3	8	2	----	1824 936	
17-29-13	REINFORCEMENT, Cushion, TA3	8	2	----	1672 989	1672 989
17-29-14	BOLT, Cushion Strap, except TA3		2	----	6023 012	1824 934
	TA3	8	2	----	1824 934	
17-29-15	CUSHION, except TA3		2	----	1731 341	1673 090
	TA3	8	2	----	1673 090	
17-29-16	RETAINER, Cushion		2	----	1672 988	1672 988
17-29-18	STRAP, Cushion, except TA3		2	----	1857 911	2207 036
	TA3	8	2	----	2207 036	
17-29-20	INSULATOR, Link		2	----	1734 315	1734 315
17-29-21	RETAINER, Insulator		2	----	1558 352	1558 352

★ Indicates use as required.

Numerals in parentheses () refer to notes.

Printed in U.S.A.

E Indicates parts not listed in any previous parts book.

Prices and specifications subject to change without notice.

Jan. 3, 1964 Supersedes Sept. 4, 1962.

Page 17-6

* Indicates change or addition.