

PROPELLER SHAFT - AXLE END

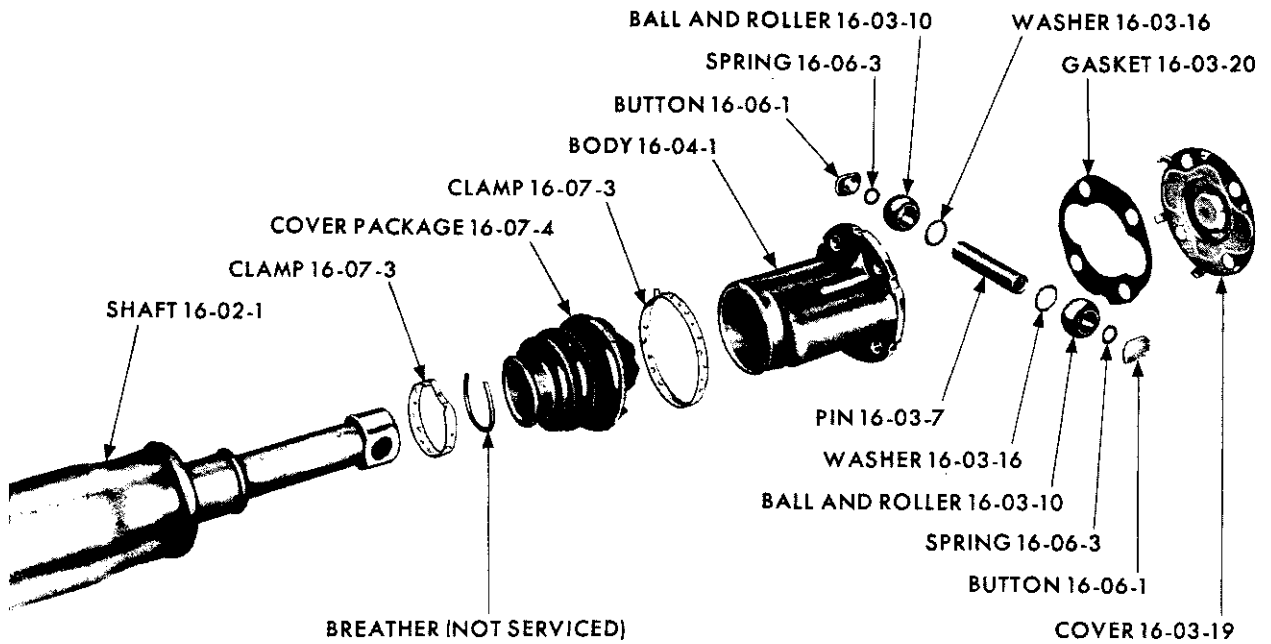

PROPELLER SHAFT - TRANSMISSION END

**PARTS INDICATED  
BY NAME ONLY - ORDER  
BY DESCRIPTION**

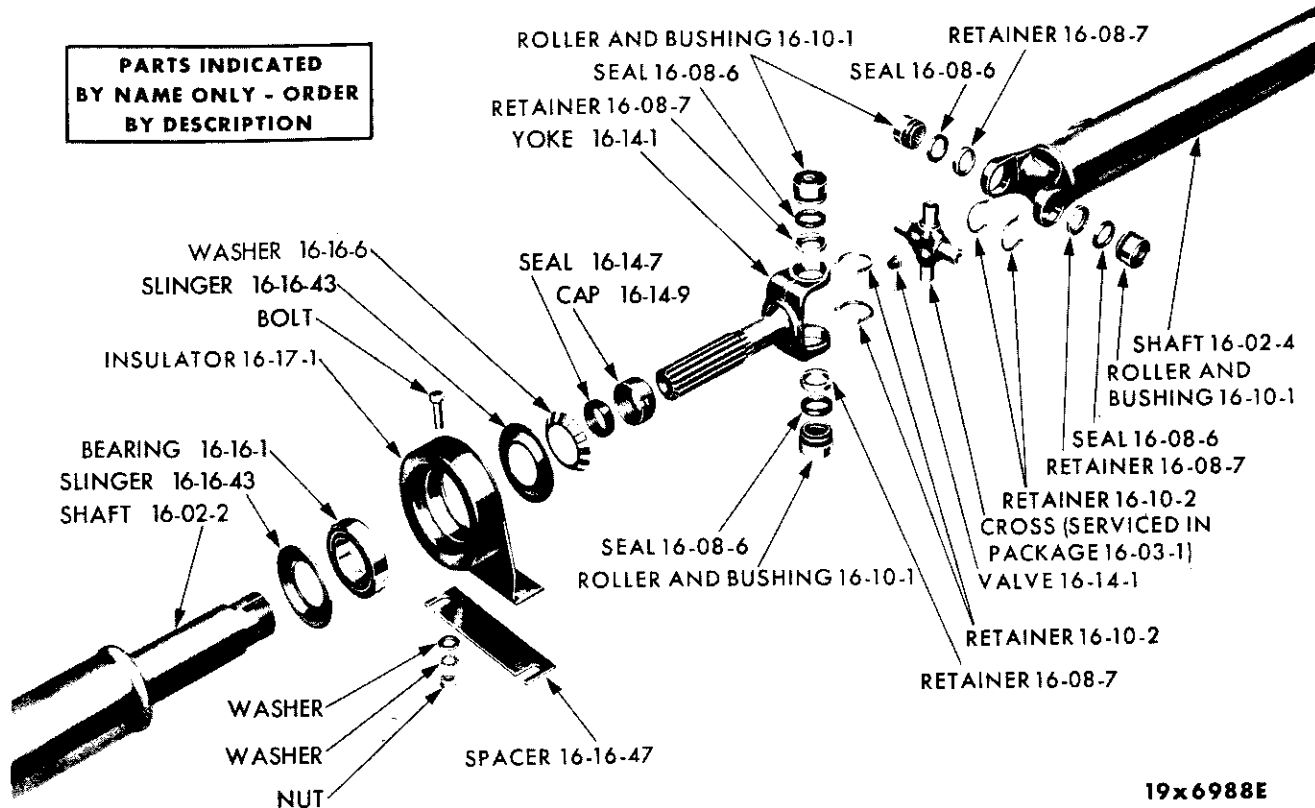

19x6988E

PROPELLER SHAFT CENTER BEARING - IMPERIAL TY1

## NOTES

NOTE: When it becomes necessary to service propeller shafts or front universal joints on cars equipped with the 426 Cubic Inch Maximum Performance engine and all V-8 engine Police Cars, it is recommended that the shaft be replaced as a complete assembly. Part numbers of the complete assemblies as follows:

MODEL	ENGINE	PROP. ASSY. PART NO.
TC1	361	2401 478
Police	413	2401 478
TA3	361	2401 478
Police	383	2401 478
TC2 Power Pack	413	2401 478
300 J	413	2401 478
TP2 All Police	318	2401 350
TD2 Sub. Police	318	2405 877
	383 w/Std. Trans.	2401 350
	383 w/Auto. Trans.	2405 877
TD2 All Police	318	2401 489
Exc. Sub.	318	2405 878
	383 w/Std. Trans.	2401 489
	383 w/Auto. Trans.	2405 878
TP2	426 w/Auto. Trans.	2405 877
	426 w/Std. Trans.	2401 668
TD2	426 w/Auto. Trans.	2405 878
	426 w/Std. Trans.	2401 670

CODE	PART NAME AND DESCRIPTION	C Y L.	PER CAR	VALIANT DART	PLYMOUTH DODGE	CHRYSLER IMPERIAL
<b>16-02-0 PROPELLER SHAFT</b>						
16-02-1	SHAFT, 53 13/32" lgh., 3 1/4" dia., w/Std. and 3 Speed Auto. Trans., w/170, 225 cu. in. Eng., TV1 All, TL1 Sub. . . . .	6	1	*2206 974		
	58 3/8" lgh., 2 3/4" dia., TL1, w/3 Speed Auto. Trans., except Sub. . . . .	6	1	*2405 881		
	58 13/32" lgh., 3" dia., 170, 225 cu. in. Eng. w/Std. and 3 Speed Auto. Trans., TL1, except Sub. . . . .	6	1	2401 462		
	55 3/4" lgh., 3" dia., w/Std. Trans., TP1 All, TD1 Sub. . . . .	6	1	----	2401 362	
	58 3/4" lgh., 3" dia., w/Std. and Std. Heavy Duty Trans., TD1, TD2, except Sub. . . . .	6	1	----	2401 485	
	56 5/8" lgh., 2 3/4" dia., w/3 Speed Auto. Trans., except Sub. . . . .	6	1	----	*2401 487	
	55 5/8" lgh., 2 3/4" dia., w/3 Speed Auto. Trans., TP1, All, TD1 Sub. . . . .	6	1	----	2401 359	
	53 5/8" lgh., 2 3/4" dia., w/3 Speed Auto. Trans., TP2, All, TD2 Sub. . . . .	8	1	----	2401 355	
	55 3/4" lgh., 3" dia. w/Std. Heavy Duty Trans., TP2 All, TD2 Sub. . . . .	8	1	----	2401 351	
	53 5/8" lgh., 3" dia., w/4 Speed Std. Trans., TP2 All, TD2 Sub. . . . .	8	1	----	2405 873	
	56 5/8" lgh., 3" dia., w/4 Speed Std. Trans., TD2, except Sub. . . . .	8	1	----	2405 874	
	56 5/8" lgh., 2 3/4" dia., w/3 Speed Auto. Trans., TD2, w/426, 361 cu. in. Eng., except Sub. . . . .	8	1	----	*2401 493	
	55 3/4" lgh., 3" dia., w/Std. Heavy Duty Trans., 318, 383 cu. in. Eng., includes U/JOINTS, TP2, All, TD2 Sub., Police Cars . . . . .	8	1	----	2401 350	

★ Indicates use as required. Numerals in parentheses ( ) refer to notes. Printed in U.S.A.  
 ☐ Indicates parts not listed in any previous parts book. Prices and specifications subject to change without notice.  
 \* Indicates change or addition.

# 1963 PASSENGER CAR PARTS CATALOG

PROPELLER SHAFT  
AND UNIV. JOINT

CODE	PART NAME AND DESCRIPTION	CY L.	PER CAR	VALIANT DART	PLYMOUTH DODGE	CHRYSLER IMPERIAL
<b>16-02-O PROPELLER SHAFT - Cont'd</b>						
16-02-1	SHAFT - Cont'd					
	53 5/8" lgh., 2 3/4" dia., w/3 Speed Auto. Trans., 318, 383 cu. in. Eng., includes U/JOINTS, TP2 All, TD2 Sub., Police Cars, TP2 w/426 cu. in. Eng. . . . .	8	1	----	2405 877	
	58 3/4" lgh., 3" dia., w/Std. Heavy Duty Trans., 318, 383 cu. in. Eng., includes U/JOINTS, TD2, except Sub. Police Cars . . .	8	1	----	2401 489	
	56 3/4" lgh., 2 3/4" dia., w/3 Speed Auto. Trans., 318, 383 cu. in. Eng., includes U/JOINTS, TD2, except Sub., Police Cars, TD2 w/426 cu. in. Eng. . . . .	8	1	----	2405 878	
	54" lgh., 3" dia., w/Std. Heavy Duty Trans., 426 cu. in. Eng., includes U/JOINTS, TP2 . . .	8	1	----	2401 668	
	57 1/4" lgh., 3" dia., w/Std. Heavy Duty Trans., 426 cu. in. Eng., includes U/JOINTS, TD2 . . . . .	8	1	----	2401 670	
	58 7/8" lgh., 3" dia., w/Std. Heavy Duty Trans., TC1, 361 cu. in. Eng., TC1, w/413 cu. in. Eng., w/Heavy Duty and 3 Speed Auto. Trans., Police Cars, TA3 w/Heavy Duty and 3 Speed Auto. Trans., w/383, 413 cu. in. Eng., Police Cars, TA3 w/Heavy Duty Trans., 361 cu. in. Eng., TC2, 413 cu. in. Eng. includes U/JOINTS . . . . .	8	1	----	2401 478	2401 478
	58 7/8" lgh., 3" dia., w/3 Speed Auto. Trans., 361, 383 cu. in. Eng. TA3, TC1, TC2, includes U/JOINTS . . . . .	8	1	----	*2401 478	*2401 478
16-02-2	SHAFT, 25 13/16" lgh., 2 3/4" dia., Front, TY1 .	8	1	----		2200 527
16-02-4	SHAFT, 33 5/8" lgh., 2 3/4" dia., Rear, TY1 . .	8	1	----		1946 297
16-02-5	SCREW, Propeller Shaft Axle End, 9/16 lgh., 1/4" dia. . . . .		4	952 538	952 538	952 538
	Trans. Flange, 1 1/8" lgh., 3/8" dia. . . . .		4	1942 069	1942 069	1942 069
<b>16-03-O UNIVERSAL JOINT</b>						
16-03-1	JOINT PACKAGE, Ball and Pin Type . . . . .	6	1	2298 940	2298 940	
	JOINT PACKAGE, Ball and Pin Type . . . . .	8	1	----	2298 941	2298 941
	JOINT PACKAGE, Cross and Roller . . . . .		1	1752 624	1752 624	1752 624
16-03-3	ROLLER PACKAGE . . . . .		1	638 637	638 637	638 637
16-03-7	PIN, Universal Joint . . . . .	6	1	579 445	579 445	
		8	1	----	1739 923	1739 923
16-03-10	BALL, w/ROLLER . . . . .		2	1739 927	1739 927	1739 927
16-03-16	WASHER, Thrust . . . . .		2	605 004	605 004	605 004
16-03-19	COVER, Grease . . . . .	6	1	602 820	2266 923	
		8	1	----	2266 922	2266 922
16-03-20	GASKET, Universal Joint . . . . .	6	1	1616 185	1616 185	
		8	1	----	1635 098	1635 098
<b>16-04-O UNIVERSAL JOINT BODY</b>						
16-04-1	BODY . . . . .	6	1	1734 159	1734 159	
		8	1	----	1739 920	1739 920
<b>16-06-O UNIVERSAL JOINT CENTERING BUTTON</b>						
16-06-1	BUTTON . . . . .	6	2	629 768	629 768	
		8	2	----	1739 924	1739 924

★ Indicates use as required. Numerals in parentheses ( ) refer to notes. Printed in U.S.A.  
 ☐ Indicates parts not listed in any previous parts book. Prices and specifications subject to change without notice.  
 Jan. 25, 1963 Supersedes Dec. 14, 1962. \* Indicates change or addition.

CODE	PART NAME AND DESCRIPTION	CYL	PER CAR	VALIANT DART	PLYMOUTH DODGE	CHRYSLER IMPERIAL
<b>16-06-0 UNIVERSAL JOINT CENTERING BUTTON - Cont'd</b>						
16-06-3	SPRING, Centering Button		2	1739 926	1739 926	1739 926
<b>16-07-0 UNIVERSAL JOINT COVER</b>						
16-07-3	CLAMP, Cover, Large		1	870 539	870 539	870 539
	Small		1	870 540	870 540	870 540
	Long		1	*1532 943	1532 943	1532 943
16-07-4	DUST COVER PACKAGE	6 8	1 1	1603 397 -----	1603 397 *1450 448	*1450 448
<b>16-08-0 UNIVERSAL JOINT CROSS</b>						
16-08-6	SEAL, Dust		*	857 999	857 999	857 999
16-08-7	RETAINER, Dust Seal		8	1739 912	1739 912	1739 912
<b>16-10-0 UNIVERSAL CROSS ROLLER AND BUSHING</b>						
16-10-1	ROLLER, w/BUSHING		4	1739 913	1739 913	1739 913
16-10-2	RETAINER, Roller Bushing		4	858 006	858 006	858 006
16-10-3	CLAMP, Roller Bushing		2	1828 824	1828 824	1828 824
<b>16-14-0 PROPELLER SHAFT SPLINE OR SLIDING YOKE</b>						
16-14-1	YOKE, TY1	8	1	-----	-----	1739 915
	VALVE, TY1	8	1	-----	-----	* 106 671
16-14-7	SEAL, Spline, TY1		8	-----	-----	1672 049
16-14-9	CAP, Spline Oil Seal		8	-----	-----	1672 050
<b>16-16-0 PROPELLER SHAFT CENTER BEARING</b>						
16-16-1	BEARING, Shaft Center, TY1	8	1	-----	-----	1672 051
16-16-6	WASHER, Center Bearing Lock, TY1	8	1	-----	-----	1638 151
16-16-25	RING, Shaft Bearing Snap, Outer, Thin, TY1	8	*	-----	-----	640 280
16-16-43	SLINGER, Bearing Dust, TY1	8	2	-----	-----	1672 053
16-16-47	SPACER, Insulator, except Cv. Cp., TY1	8	*	-----	-----	1945 836
	Cv. Cp., TY1	8	*	-----	-----	1856 944
<b>16-17-0 PROPELLER SHAFT CENTER BEARING HOUSING INSULATOR</b>						
16-17-1	INSULATION, Center Bearing, except Cv. Cp., TY1	8	1	-----	-----	1945 831
	Cv. Cp., TY1	8	1	-----	-----	1856 942
	BOLT, Insulator	8	2	-----	-----	181 643
	NUT, Insulator Bolt	8	2	-----	-----	120 369
	WASHER	8	2	-----	-----	138 489
<b>16-20-0 PROPELLER SHAFT FLANGE</b>						
16-20-1	FLANGE, Trans. End w/Std. and 3 Speed Auto. Trans.	6	1	2400 974		
	TP1, TD1, w/170 and 225 cu. in. Eng., w/3 Speed Auto. Trans.	6	1	-----	2400 975	
	TP1, TD1, w/Std. Trans., 225 cu. in. Eng.	6	1	-----	2400 976	
	TP1, TD1, w/170 and 225 cu. in. Eng., w/Std. Heavy Duty Trans., Taxi and Police Cars	6	1	-----	*2400 977	
	w/Std. Heavy Duty and 3 Speed Auto. Trans., except TY1, also w/4 Speed Trans.	8	1	-----	*2400 978	*2400 978
	TY1	8	1	-----	-----	2400 979
	TP1, TD1, w/A727 3 Speed Auto. Trans., Taxi and Police Cars	6	1	-----	2400 977	

★ Indicates use as required.

Numerals in parentheses ( ) refer to notes.

Printed in U.S.A.

☐ Indicates parts not listed in any previous parts book.

Prices and specifications subject to change without notice.

\* Indicates change or addition.

