

GROUP 3 - AXLE - REAR

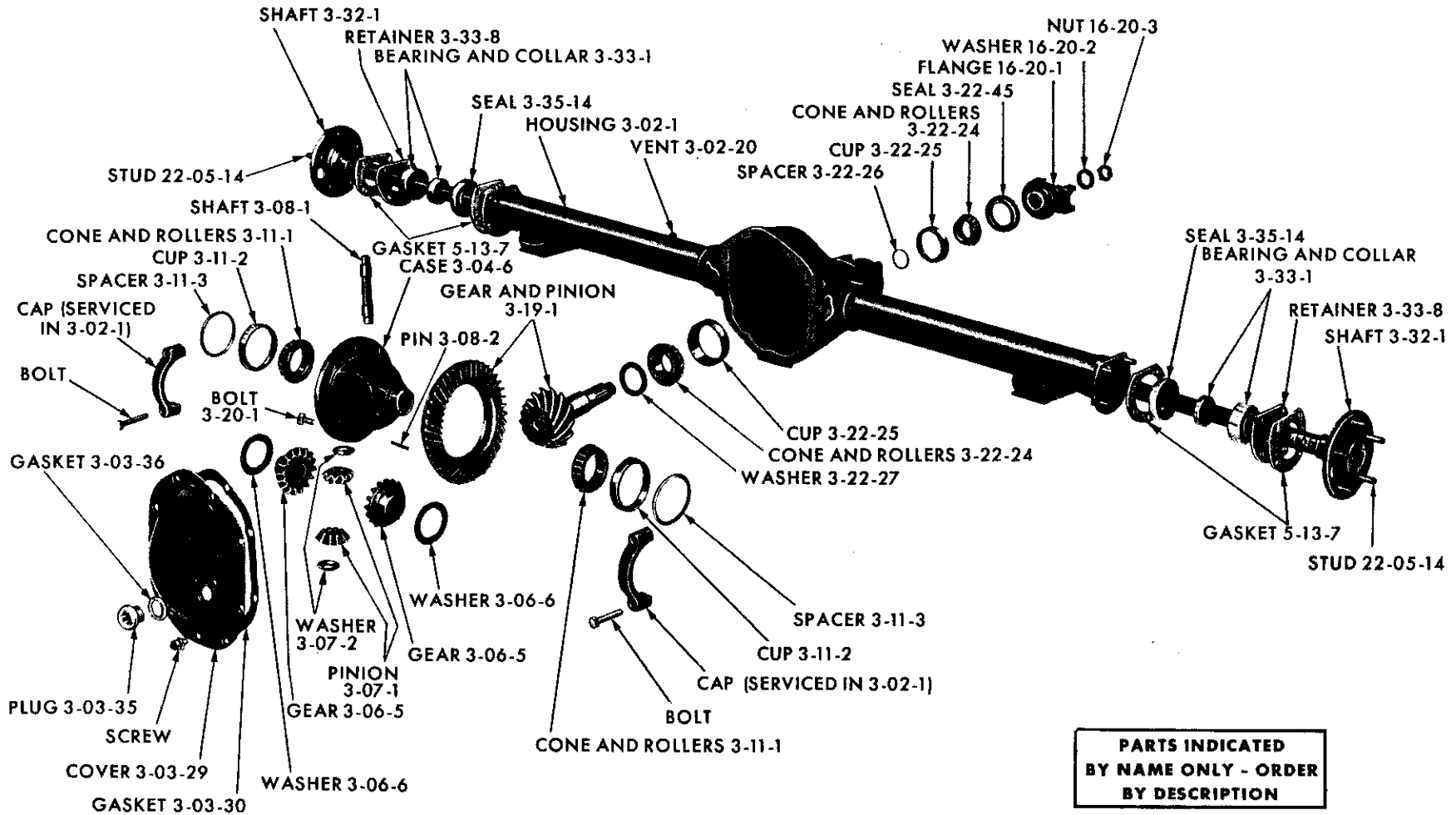

PARTS INDICATED BY NAME ONLY - ORDER BY DESCRIPTION

19x8727G

REAR AXLE DIFFERENTIAL AND CARRIER - VALIANT TV1 AND DART TL1

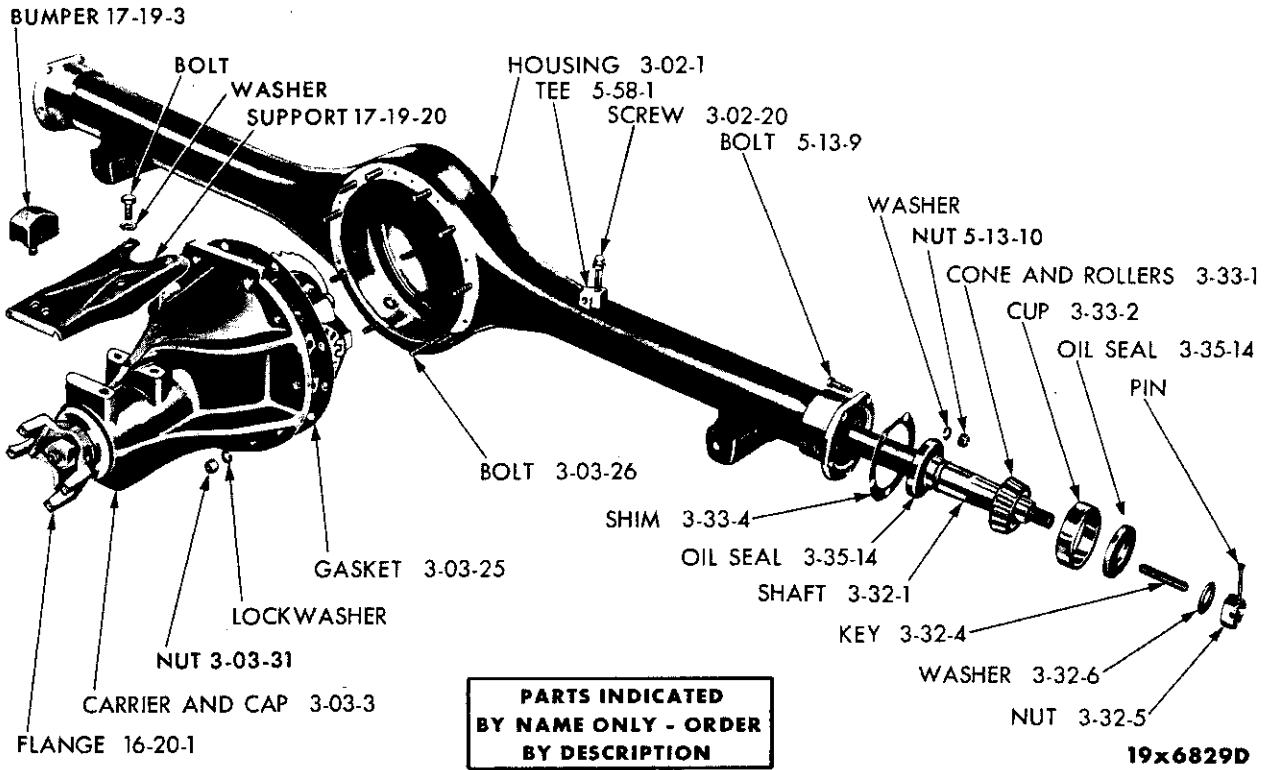

REAR AXLE HOUSING AND CARRIER - EXCEPT VALIANT TV1 AND DART TL1

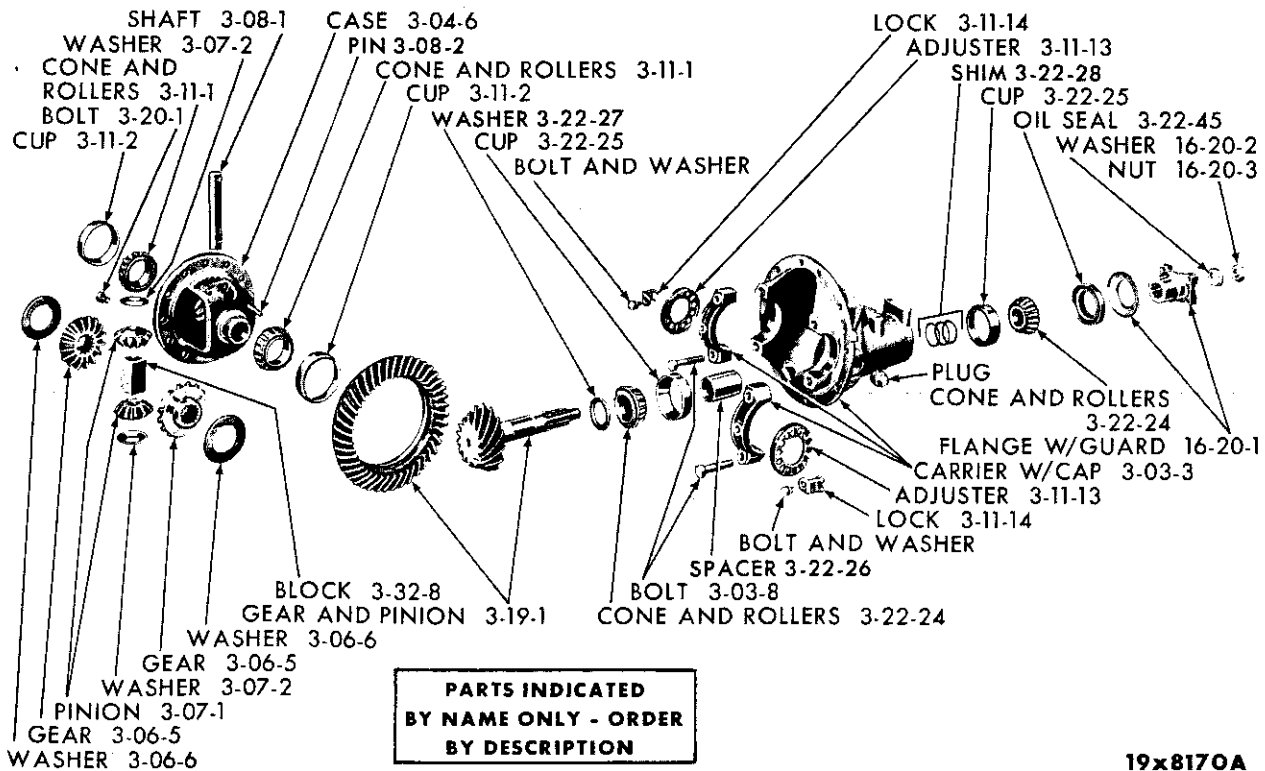

REAR AXLE - EXCEPT VALIANT TV1 AND DART TL1

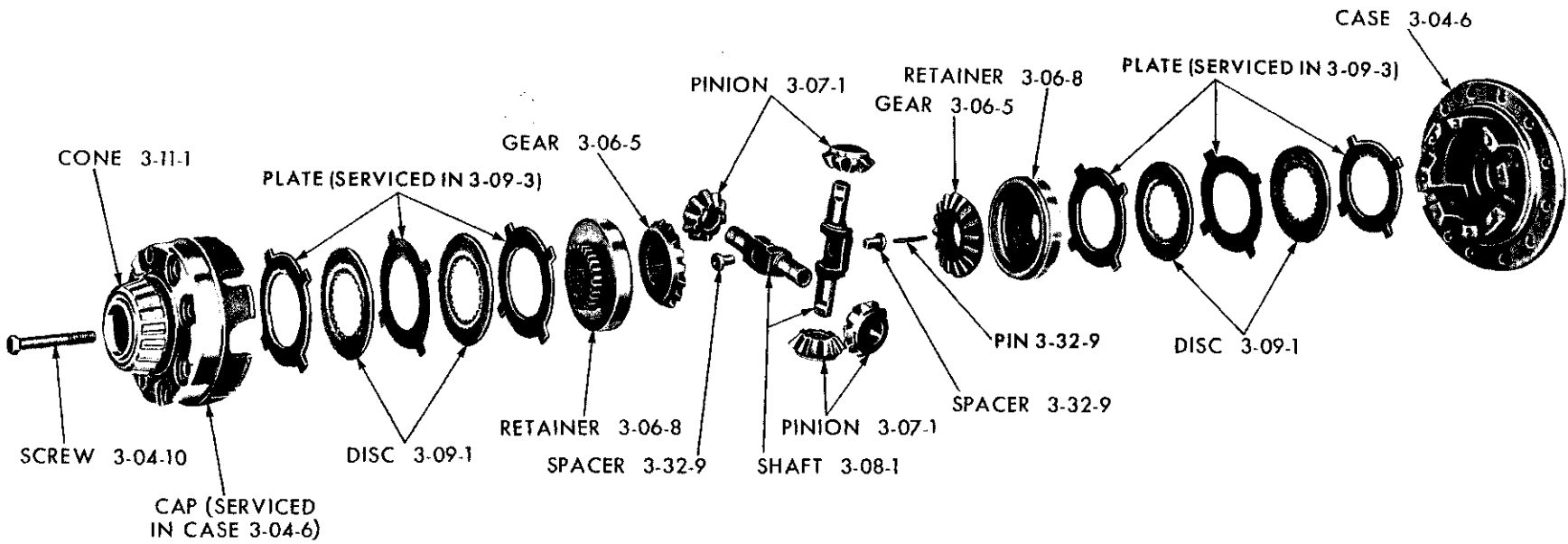

19x8320C

"NO-SPIN" REAR AXLE DIFFERENTIAL - EXCEPT VALIANT TV1 AND DART TL1



CODE	PART NAME AND DESCRIPTION	C Y L.	PER CAR	VALIANT DART	PLYMOUTH DODGE	CHRYSLER IMPERIAL
------	---------------------------	--------------	------------	-----------------	-------------------	----------------------

NOTE: Two Types of Differentials are being used in production on 8 cylinder cars. With 1 3/8" diameter pinion shaft. The carrier has part number 1820 657 or 2070 741 embossed on it 2" below the yoke.  
 With 1 3/4" diameter pinion shaft. The carrier has part number 1634 985 or 2070 742 embossed on it 2" below the yoke.

**3-01-0 REAR AXLE CONTROL STRUT**

3-01-25	STRUT, TY1 . . . . .	8	2	----	----	1730 160
3-01-28	BUSHING, TY1 . . . . .	8	4	----	----	1635 600
3-01-30	SPACER, TY1 . . . . .	8	*	----	----	1731 769
3-01-33	HANGER, w/BOLTS, TY1 . . . . .	8	2	----	----	2403 248
	BRACKET, Frame, Right, TY1 . . . . .	8	1	----	----	*1829 998
	Left . . . . .	8	1	----	----	*1829 999
3-01-34	BOLT, Hanger, TY1 . . . . .	8	8	----	----	2403 247

**3-02-0 REAR AXLE HOUSING**

3-02-1	HOUSING . . . . .	6	1	2404 073		
	TP1, TP2, TD1, TD2 . . . . .		1	----	2070 539	
	TA3, TC1, TC2, TC3 . . . . .	8	1	----	2070 960	2070 960
	TY1 . . . . .	8	1	----	----	2070 961
3-02-9	SPACER, Housing to Carrier Bolt Nut, TA3 . . .	8	1	----	1940 447	1940 447
3-02-20	SCREW, Vent . . . . .	6	1	2404 119		
	TC1, TC2, TC3 . . . . .		1	----	2404 119	2404 119
	TY1 . . . . .	8	1	----	----	2124 715

**3-03-0 REAR AXLE DIFFERENTIAL AND CARRIER**

3-03-1	DIFFERENTIAL, w/CARRIER and TUBES, 3.23					
	to 1 ratio . . . . .	6	1	2404 076		
	3.55 to 1 ratio . . . . .	6	1	2404 077		
	3.91 to 1 ratio . . . . .	6	1	2404 078		
	2.93 to 1 ratio, w/225 cu. in. Engine . . . . .	6	1	2404 075		
	2.93 to 1 ratio, w/8 1/4" dia. Gear, except Sub.	6	1	----	2070 797	
	3.31 to 1 ratio, w/8 1/4" dia. Gear, except Sub.	6	1	----	2070 798	
	2.76 to 1 ratio, w/Sure-Grip, w/1 3/8" dia. Stem, TP1, TP2, TD1, TD2-L, TD2-M, TD2-H		1	----	2070 693	
	3.91 to 1 ratio, w/Sure-Grip, w/1 3/4" dia. Stem, TP2, TD2, TC2-300J . . . . .	8	1	----	2404 129	2404 129
	3.23 to 1 ratio, w/Sure-Grip, w/1 3/8" dia. Stem, TP1, TP2, TD1, TD2-L, TD2-M, TD2-H		1	----	2070 774	
	2.76 to 1 ratio, w/8 3/4" dia. Gear, w/1 3/8" dia. Stem, TA3, TC1, except Sub., TP2, TD2-L, TD2-M, TD2-H . . . . .	8	1	----	2070 654	2070 654
	2.93 to 1 ratio, w/8 3/4" dia. Gear, w/1 3/4" dia. Stem, TP1, TP2, TD1, TD2-L, TD2-M, TD2-H . . . . .		1	----	2070 579	
	3.23 to 1 ratio, w/8 3/4" dia. Gear, w/1 3/8" dia. Stem, TP1, TP2, TD1, TD2-L, TD2-M, TD2-H . . . . .		1	----	2070 771	
	3.55 to 1 ratio, w/8 3/4" dia. Gear, w/1 3/8" dia. Stem, TP1, TP2, TD1, TD2-L, TD2-M, TD2-H		1	----	2070 908	
	3.91 to 1 ratio, w/8 3/4" dia. Gear, w/1 3/8" dia. Stem, TP1, TP2, TD1, TD2-L, TD2-M, TD2-H		1	----	1828 517	
	2.93 to 1 ratio, w/1 3/4" dia. Stem, TY1 . . . . .	8	1	----	----	2070 579
	3.23 to 1 ratio, w/1 3/4" dia. Stem, TC1, TC2, TC3 . . . . .	8	1	----	2070 811	2070 811
	2.76 to 1 ratio, w/1 3/4" dia. Stem, TC1 Sub., TC3 . . . . .	8	1	----	2070 853	2070 853

★ Indicates use as required. Numerals in parentheses ( ) refer to notes. Printed in U.S.A.  
 B Indicates parts not listed in any previous parts book. Prices and specifications subject to change without notice.  
 \* Indicates change or addition. Jan. 3, 1964 Supersedes Dec. 14, 1962.

# 1963 PASSENGER CAR PARTS CATALOG

AXLE-REAR

CODE	PART NAME AND DESCRIPTION	CYL.	PER CAR	VALIANT DART	PLYMOUTH DODGE	CHRYSLER IMPERIAL
<b>3-03-O REAR AXLE DIFFERENTIAL AND CARRIER - Cont'd</b>						
3-03-1	DIFFERENTIAL - Cont'd 2.93 to 1 ratio, w/Sure-Grip, w/1 3/4" dia. Stem, TY1 . . . . .	8	1	----	----	2070 583
	3.23 to 1 ratio, w/Sure-Grip, w/1 3/4" dia. Stem, TC1, TC2 . . . . .	8	1	----	2070 813	2070 813
	2.76 to 1 ratio, w/Sure-Grip, TA3, TC1, TC3 . . . . .	8	1	----	2070 856	2070 856
3-03-2	DIFFERENTIAL ASSEMBLY, Partial, w/Sure-Grip . . . . .		1	----	2070 824	2070 824
3-03-3	CARRIER, w/CAPS, w/8 1/4" dia. Gear, except Sub. w/8 3/4" dia. Gear, 1 3/8" dia. Stem, TA3, TC1, except Sub., TP1, TP2, TD1, TD2-L, TD2-M, TD2-H . . . . .	6	1	----	2070 782	
	w/8 3/4" dia. Gear, 1 3/4" dia. Stem . . . . .	8	1	----	1820 698 1634 984	1820 698 1634 984
3-03-8	SCREW, Cap . . . . .		4	----	314 948	314 948
3-03-25	GASKET, Carrier . . . . .		1	----	1673 367	1673 367
3-03-26	BOLT, Housing to Carrier . . . . . TY1 . . . . .	8	★ 1	----	1135 197 ----	1135 197 E2404 480
3-03-29	COVER, Carrier . . . . .	6	1	2070 119		
3-03-30	GASKET, Cover . . . . .	6	1	2070 120		
3-03-31	NUT, Housing to Carrier Bolt . . . . . w/Fiber WASHER, TA3 . . . . .	8	★ 1	----	1485 066 1940 596	1485 066 1940 596
3-03-35	PLUG, Cover Filler . . . . .	6	1	*1392 371		
3-03-36	GASKET, Plug . . . . .	6	1	2070 122		
<b>3-04-O DIFFERENTIAL CASE</b>						
3-04-6	CASE . . . . .	6	1	2070 537		
	w/2.93 to 1 ratio, 8 1/4" dia. Gear, except Sub. w/3.31 to 1 ratio, 8 1/4" dia. Gear, except Sub. w/8 3/4" dia. Gear . . . . .	6 6 1	1 1 1	---- ---- ----	2070 704 2070 706 1850 370	1850 370
	w/Sure-Grip . . . . .	1	1	----	*2240 222	*2240 222
3-04-10	SCREW, Case Cap, w/Sure-Grip . . . . .		8	----	1945 751	1945 751
<b>3-06-O DIFFERENTIAL SIDE GEAR</b>						
3-06-5	GEAR . . . . .	6	2	2070 023		
	w/8 1/4" dia. Gear, except Sub. . . . .	6	2	----	2070 242	
	w/8 3/4" dia. Gear . . . . .		2	----	2070 148	2070 148
	w/Sure-Grip . . . . .		2	----	1829 448	1829 448
3-06-6	WASHER, Thrust . . . . .	6	2	2070 024		
	w/8 1/4" dia. Gear, except Sub. . . . .	6	2	----	2070 820	
	w/8 3/4" dia. Gear . . . . .		2	----	1633 960	1633 960
3-06-8	RETAINER, w/Sure-Grip . . . . .		2	----	1829 447	1829 447
<b>3-07-O DIFFERENTIAL PINION</b>						
3-07-1	PINION . . . . .	6	2	2070 025		
	w/8 1/4" dia Gear, except Sub. . . . .	6	2	----	1326 219	
	w/8 3/4" dia. Gear . . . . .		2	----	1633 959	1633 959
	w/Sure-Grip . . . . .		4	----	1829 449	1829 449

★ Indicates use as required.

Numerals in parentheses ( ) refer to notes.

Printed in U.S.A.

E Indicates parts not listed in any previous parts book.

Prices and specifications subject to change without notice.

Jan. 3, 1964 Supersedes Dec. 14, 1962.

\* Indicates change or addition.

CODE	PART NAME AND DESCRIPTION	CYL.	PER CAR	VALIANT DART	PLYMOUTH DODGE	CHRYSLER IMPERIAL
<b>3-07-O DIFFERENTIAL PINION - Cont'd</b>						
3-07-2	WASHER . . . . .	6	2	2070 026		
	w/8 1/4" dia. Gear, except Sub. . . . .	6	2	----	2070 821	
	w/8 3/4" dia. Gear . . . . .		2	----	1633 961	1633 961
<b>3-08-O DIFFERENTIAL PINION SHAFT</b>						
3-08-1	SHAFT . . . . .	6	1	2070 027		
	w/8 1/4" dia. Gear, except Sub. . . . .	6	1	----	663 480	
	w/8 3/4" dia. Gear . . . . .		1	----	1633 928	1633 928
	w/Sure-Grip . . . . .		2	----	1829 446	1829 446
3-08-2	PIN, Lock . . . . .	6	1	152 229		
		1	----	----	1633 937	1633 937
<b>3-09-O DIFFERENTIAL CLUTCH PARTS</b>						
3-09-1	DISC, Clutch, w/Sure-Grip . . . . .		2	----	1829 451	1829 451
3-09-3	REPAIR KIT, Differential, w/Sure-Grip . . . . .		1	----	2070 845	2070 845
<b>3-11-O DIFFERENTIAL BEARINGS</b>						
3-11-1	CONE, w/ROLLERS . . . . .	6	2	1937 771		
	w/8 1/4" dia. Gear, except Sub. . . . .	6	2	----	698 404	
	w/8 3/4" dia. Gear . . . . .		2	----	1790 523	1790 523
3-11-2	CUP . . . . .	6	2	1937 770		
			2	----	698 403	698 403
3-11-3	SPACER, Adjusting, .2500" thk. . . . .	6	2	*2070 848		
	.2520" thk. . . . .	6	2	*2070 849		
	.2540" thk. . . . .	6	2	*2070 082		
	.2560" thk. . . . .	6	2	*2070 441		
	.2580" thk. . . . .	6	2	2070 442		
	.2600" thk. . . . .	6	2	2070 084		
	.2620" thk. . . . .	6	2	2070 443		
	.2640" thk. . . . .	6	2	2070 444		
	.2660" thk. . . . .	6	2	2070 086		
	.2680" thk. . . . .	6	2	2070 445		
	.2700" thk. . . . .	6	2	2070 446		
	.2720" thk. . . . .	6	2	2070 088		
	.2740" thk. . . . .	6	2	2070 447		
	.2760" thk. . . . .	6	2	2070 448		
	.2780" thk. . . . .	6	2	2070 090		
	.2800" thk. . . . .	6	2	2070 449		
	.2820" thk. . . . .	6	2	2070 450		
	.2840" thk. . . . .	6	2	2070 092		
	.2860" thk. . . . .	6	2	*2070 696		
	.2880" thk. . . . .	6	2	*2070 697		
	.2900" thk. . . . .	6	2	*2070 698		
	.2920" thk. . . . .	6	2	*2070 850		
	.2940" thk. . . . .	6	2	*2070 851		
3-11-13	ADJUSTER . . . . .		2	----	601 864	601 864
3-11-14	LOCK, Adjuster . . . . .		2	----	308 247	308 247
<b>3-19-O DRIVE GEAR AND PINION SET</b>						
3-19-1	GEAR and PINION SET, 3.23 to 1 ratio . . . . .	6	1	2070 563		
	3.55 to 1 ratio . . . . .	6	1	2070 564		
	3.91 to 1 ratio . . . . .	6	1	2070 565		
	2.93 to 1 ratio, w/225 cu.in. Engine . . . . .	6	1	2070 596		
	2.93 to 1 ratio, 8 1/4" dia. Gear, except Sub. . . . .	6	1	----	2070 808	
	3.31 to 1 ratio, 8 1/4" dia. Gear, except Sub. . . . .	6	1	----	2070 809	

★ Indicates use as required. Numerals in parentheses ( ) refer to notes. Printed in U.S.A.  
 ☐ Indicates parts not listed in any previous parts book. Prices and specifications subject to change without notice.  
 \* Indicates change or addition. Jan. 3, 1964 Supersedes Sept. 4, 1962.

CODE	PART NAME AND DESCRIPTION	C Y L.	PER CAR	VALIANT DART	PLYMOUTH DODGE	CHRYSLER IMPERIAL
<b>3-19-0 DRIVE GEAR AND PINION SET - Cont'd</b>						
3-19-1	GEAR and PINION SET - Cont'd					
	2.93 to 1 ratio, 8 3/4" dia. Gear, 1 3/8" dia. Stem, TP1, TP2, TD1, TD2-L, TD2-M, TD2-H.		1	----	2070 569	
	3.23 to 1 ratio, 8 3/4" dia. Gear, 1 3/8" dia. Stem, TP1, TP2, TD1, TD2-L, TD2-M, TD2-H.		1	----	2070 816	
	3.55 to 1 ratio, 8 3/4" dia. Gear, 1 3/8" dia. Stem, TP1, TP2, TD1, TD2-L, TD2-M, TD2-H.		1	----	2070 915	
	3.91 to 1 ratio, 8 3/4" dia. Gear, 1 3/8" dia. Stem, TP1, TP2, TD1, TD2-L, TD2-M, TD2-H.		1	----	2070 300	
	2.76 to 1 ratio, 8 3/4" dia. Gear, 1 3/8" dia. Stem, TA3, TC1, except Sub., TP1, TP2, TD1, TD2-L, TD2-M TD2-H . . . . .		1	----	2070 689	2070 689
	3.55 to 1 ratio, 8 3/4" dia. Gear, 1 3/4" dia. Stem, TP2, TD2, w/383 and 426 cu. in. Engine, TC2-300J . . . . .	8	1	----	2070 916	2070 916
	3.91 to 1 ratio, 8 3/4" dia. Gear, 1 3/4" dia. Stem, TP2, TD2, TC2-300J . . . . .	8	1	----	2404 127	2404 127
	4.3 to 1 ratio, 8 3/4" dia. Gear, 1 3/4" dia. Stem, TP2, TD2, w/383 and 426 cu. in. Engine, TC2-300J . . . . .	8	1	----	1738 822	1738 822
	4.56 to 1 ratio, 8 3/4" dia. Gear, 1 3/4" dia. Stem, TP2, TD2, w/383 and 426 cu. in. Engine, TC2-300J . . . . .	8	1	----	1738 823	1738 823
	4.89 to 1 ratio, 8 3/4" dia. Gear, 1 3/4" dia. Stem, TP2, TD2, w/383 and 426 cu. in. Engine, TC2-300J . . . . .	8	1	----	1738 824	1738 824
	2.93 to 1 ratio, 8 3/4" dia. Gear, 1 3/4" dia. Stem, TP2, TD2, TY1 . . . . .	8	1	----	2070 570	2070 570
	3.23 to 1 ratio, 8 3/4" dia. Gear, 1 3/4" dia. Stem, TC1, TC2, TC3 . . . . .	8	1	----	2070 817	2070 817
	2.76 to 1 ratio, 8 3/4" dia. Gear, 1 3/4" dia. Stem, TC1, TC3 . . . . .	8	1	----	2070 690	2070 690
<b>3-20-0 DRIVE GEAR BOLT</b>						
3-20-1	BOLT . . . . .		★ 12	1675 485	1675 485	1675 485
	w/Sure-Grip . . . . .			----	1945 768	1945 768
<b>3-22-0 DRIVE PINION BEARINGS</b>						
3-22-24	CONE, Front Bearing, w/ROLLERS . . . . .	6	1	2070 316		
	Rear . . . . .	6	1	2070 318		
	Front, w/1 3/8" dia. Stem, TA3, TC1, except Sub., TP1, TP2, TD1, TD2-L, TD2-M, TD2-H.		1	----	1820 552	1820 552
	Rear, w/1 3/8" dia. Stem, TA3, TC1 except Sub., TP1, TP2, TD1, TD2-L, TD2-M, TD2-H . . . . .		1	----	1401 809	1401 809
	Front, w/1 3/4" dia. Stem . . . . .	8	1	----	1401 808	1401 808
	Rear, w/1 3/4" dia. Stem . . . . .	8	1	----	1404 472	1404 472
3-22-25	CUP, Front Bearing . . . . .	6	1	2070 317		
	Rear . . . . .	6	1	2070 319		
	Front, w/1 3/8" dia. Stem, TA3, TC1 except Sub., TP1, TP2, TD1, TD2-L, TD2-M, TD2-H.		1	----	1820 551	1820 551
	Rear, w/1 3/8" dia. Stem, TA3, TC1 except Sub., TP1, TP2, TD1, TD2-L, TD2-M, TD2-H.		1	----	1401 810	1401 810
	Front, w/1 3/4" dia. Stem . . . . .	8	1	----	1401 810	1401 810
	Rear, w/1 3/4" dia. Stem . . . . .	8	1	----	1327 847	1327 847
3-22-26	SPACER, Front Bearing Adjusting, .074" thk. . .	6	★	2070 094		
	.075" thk. . . . .	6	★	2070 454		
	.076" thk. . . . .	6	★	2070 095		
	.077" thk. . . . .	6	★	2070 455		

★ Indicates use as required.

Numerals in parentheses ( ) refer to notes.

Printed in U.S.A.

☐ Indicates parts not listed in any previous parts book.

Prices and specifications subject to change without notice.



CODE	PART NAME AND DESCRIPTION	C Y L	PER CAR	VALIANT DART	PLYMOUTH DODGE	CHRYSLER IMPERIAL
<b>3-22-0 DRIVE PINION BEARINGS - Cont'd</b>						
3-22-26	SPACER - Cont'd					
	.078" thk. . . . .	6	★	2070 096		
	.079" thk. . . . .	6	★	2070 456		
	.080" thk. . . . .	6	★	2070 097		
	.081" thk. . . . .	6	★	2070 457		
	.082" thk. . . . .	6	★	2070 098		
	.083" thk. . . . .	6	★	2070 458		
	.084" thk. . . . .	6	★	2070 099		
	.085" thk. . . . .	6	★	2070 459		
	.086" thk. . . . .	6	★	2070 100		
	.087" thk. . . . .	6	★	2070 460		
	.088" thk. . . . .	6	★	2070 101		
	.089" thk. . . . .	6	★	2070 461		
	.090" thk. . . . .	6	★	2070 102		
	.091" thk. . . . .	6	★	2070 462		
	.092" thk. . . . .	6	★	2070 103		
	.093" thk. . . . .	6	★	2070 463		
	.094" thk. . . . .	6	★	2070 104		
	.095" thk. . . . .	6	★	2070 464		
	.096" thk. . . . .	6	★	2070 105		
	.097" thk. . . . .	6	★	2070 465		
	.098" thk. . . . .	6	★	2070 106		
	.099" thk. . . . .	6	★	2070 466		
	.100" thk. . . . .	6	★	2070 107		
	.101" thk. . . . .	6	★	2070 467		
	.102" thk. . . . .	6	★	2070 108		
	.103" thk. . . . .	6	★	2070 468		
	.104" thk. . . . .	6	★	2070 109		
	.105" thk. . . . .	6	★	2070 469		
	.106" thk. . . . .	6	★	2070 110		
	SPACER, Rear Bearing, w/8 1/4" dia. Gear, except Sub. . . . .	6	1	----	2070 709	
	w/8 3/4" dia Gear, 1 3/8" dia. Stem, TA3, TC1, except Sub., TP1, TP2, TD1, TD2-L, TD2-M, TD2-H . . . . .		1	----	1738 826	1738 826
3-22-27	WASHER, Rear Bearing, .084" thk. . . . .	6	★	1738 794		
	.086" thk. . . . .	6	★	1738 795		
	.088" thk. . . . .	6	★	1738 796		
	.090" thk. . . . .	6	★	1738 797		
	.092" thk. . . . .	6	★	1738 798		
	.094" thk. . . . .	6	★	1738 799		
	.096" thk. . . . .	6	★	1738 800		
	.098" thk. . . . .	6	★	1738 801		
	.100" thk. . . . .	6	★	1738 802		
	w/1 3/8" dia. Stem, .084" thk., TA3, TC1, except Sub., TP1, TP2, TD1, TD2-L, TD2-M, TD2-H.		★	----	1738 794	1738 794
	w/1 3/8" dia. Stem, .086" thk., TA3, TC1, except Sub., TP1, TP2, TD1, TD2-L, TD2-M, TD2-H.		★	----	1738 795	1738 795
	w/1 3/8" dia. Stem, .088" thk., TA3, TC1, except Sub., TP1, TP2, TD1, TD2-L, TD2-M, TD2-H.		★	----	1738 796	1738 796
	w/1 3/8" dia. Stem, .090" thk., TA3, TC1, except Sub., TP1, TP2, TD1, TD2-L, TD2-M, TD2-H.		★	----	1738 797	1738 797
	w/1 3/8" dia. Stem, .092" thk., TA3, TC1, except Sub., TP1, TP2, TD1, TD2-L, TD2-M, TD2-H.		★	----	1738 798	1738 798
	w/1 3/8" dia. Stem, .094" thk., TA3, TC1, except Sub., TP1, TP2, TD1, TD2-L, TD2-M, TD2-H.		★	----	1738 799	1738 799
	w/1 3/8" dia. Stem, .096" thk., TA3, TC1, except Sub., TP1, TP2, TD1, TD2-L, TD2-M, TD2-H.		★	----	1738 800	1738 800

★ Indicates use as required. Numerals in parentheses ( ) refer to notes. Printed in U.S.A.  
 ☐ Indicates parts not listed in any previous parts book. Prices and specifications subject to change without notice.  
 \* Indicates change or addition.

# 1963 PASSENGER CAR PARTS CATALOG

AXLE-REAR

CODE	PART NAME AND DESCRIPTION	C Y L	PER CAR	VALIANT DART	PLYMOUTH DODGE	CHRYSLER IMPERIAL
<b>3-22-0 DRIVE PINION BEARINGS - Cont'd</b>						
3-22-27	WASHER - Cont'd w/1 3/8" dia. Stem, .098" thk., TA3, TC1, except Sub., TP1, TP2, TD1, TD2-L, TD2-M, TD2-H.		★	----	1738 801	1738 801
	w/1 3/8" dia. Stem, .100" thk. TA3, TC1, except Sub., TP1, TP2, TD1, TD2-L, TD2-M, TD2-H.		★	----	1738 802	1738 802
	w/1 3/4" dia. Stem, .084" thk. . . . .	8	★	----	1738 812	1738 812
	w/1 3/4" dia. Stem, .086" thk. . . . .	8	★	----	1738 813	1738 813
	w/1 3/4" dia. Stem, .088" thk. . . . .	8	★	----	1738 814	1738 814
	w/1 3/4" dia. Stem, .090" thk. . . . .	8	★	----	1738 815	1738 815
	w/1 3/4" dia. Stem, .092" thk. . . . .	8	★	----	1738 816	1738 816
	w/1 3/4" dia. Stem, .094" thk. . . . .	8	★	----	1738 817	1738 817
	w/1 3/4" dia. Stem, .096" thk. . . . .	8	★	----	1738 818	1738 818
	w/1 3/4" dia. Stem, .098" thk. . . . .	8	★	----	1738 819	1738 819
	w/1 3/4" dia. Stem, .100" thk. . . . .	8	★	----	1738 820	1738 820
3-22-28	SHIM, Front Bearing Adjusting, w/1 3/8" dia. Stem, .014" thk., TA3, TC1, except Sub., TP1, TP2, TD1, TD2-L, TD2-M, TD2-H . . . . .		★	----	1820 703	1820 703
	w/1 3/8" dia. Stem, .016" thk., TA3, TC1, except Sub., TP1, TP2, TD1, TD2-L, TD2-M, TD2-H		★	----	1820 704	1820 704
	w/1 3/8" dia. Stem, .018" thk., TA3, TC1, except Sub., TP1, TP2, TD1, TD2-L, TD2-M, TD2-H.		★	----	1820 705	1820 705
	w/1 3/8" dia. Stem, .020" thk, TA3, TC1, except Sub., TP1, TP2, TD1, TD2-L, TD2-M, TD2-H . . . . .		★	----	*1820 706	
	w/1 3/8" dia. Stem, .022" thk., TA3, TC1, except Sub., TP1, TP2, TD1, TD2-L, TD2-M, TD2-H.		★	----	1828 725	1828 725
	w/1 3/8" dia. Stem, .024" thk., TA3, TC1, except Sub., TP1, TP2, TD1, TD2-L, TD2-M, TD2-H.		★	----	1829 440	1829 440
	w/1 3/8" dia. Stem, .026" thk., TA3, TC1, except Sub., TP1, TP2, TD1, TD2-L, TD2-M, TD2-H.		★	----	1829 441	1829 441
	w/1 3/4" dia. Stem, .014" thk. . . . .	8	★	----	1738 805	1738 805
	w/1 3/4" dia. Stem, .016" thk. . . . .	8	★	----	1738 806	1738 806
	w/1 3/4" dia. Stem, .018" thk. . . . .	8	★	----	1738 807	1738 807
	w/1 3/4" dia. Stem, .022" thk. . . . .	8	★	----	1829 442	1829 442
	w/1 3/4" dia. Stem, .024" thk. . . . .	8	★	----	1829 443	1829 443
	w/1 3/4" dia. Stem, .026" thk. . . . .	8	★	----	1829 444	1829 444
3-22-45	OIL SEAL, Front Bearing . . . . .	6	1	2070 113		
	w/1 3/8" dia. Stem, TA3, TC1, except Sub., TP1, TP2, TD1, TD2-L, TD2-M, TD2-H . . . . .		1	----	1738 831	1738 831
	w/1 3/4" dia. Stem . . . . .	8	1	----	1828 719	1828 719
<b>3-32-0 DRIVE SHAFT</b>						
3-32-1	SHAFT, w/BEARING, COLLAR and STUDS, Right.	6	1	2404 054		
	Left . . . . .	6	1	2404 055		
	w/1 3/8" dia. Pinion Stem, TP1, TP2, TD1, TD2-L, TD2-M, TD2-H . . . . .		2	----	2070 573	
	w/Sure-Grip, w/1 3/8" dia. Pinion Stem, w/2.76 and 3.23 to 1 ratio, TP1, TP2, TD1, TD2-L, TD2-M, TD2-H . . . . .		2	----	2070 695	
	w/1 3/4" dia. Pinion Stem, TP2, TD2 . . . . .	8	2	----	2404 003	
	w/Sure-Grip, w/1 3/4" dia. Pinion Stem, w/3.23 and 3.91 to 1 ratio, TP2, TD2 . . . . .	8	2	----	2404 050	
	TA3, TC1, TC2, TC3 . . . . .	8	2	----	1675 448	1675 448
	w/Sure-Grip, TA3, TC1, TC2, TC3 . . . . .	8	2	----	1829 266	1829 266
	TY1 . . . . .	8	2	----	----	1675 449
	w/Sure-Grip, TY1 . . . . .	8	2	----	----	1829 267
3-32-4	KEY . . . . .		2	----	1118 149	1118 149

★ Indicates use as required.

Numerals in parentheses ( ) refer to notes.

Printed in U.S.A.

⊠ Indicates parts not listed in any previous parts book.

Prices and specifications subject to change without notice.

Jan. 3, 1964 Supersedes Dec. 14, 1962.

\* Indicates change or addition.



