

19x8915

STANDARD TRANSMISSION (HEAVY DUTY) - PLYMOUTH SP1-2, DODGE SD1-2 AND CHRYSLER SC1-2

PARTS INDICATED
BY NAME ONLY - ORDER
BY DESCRIPTION

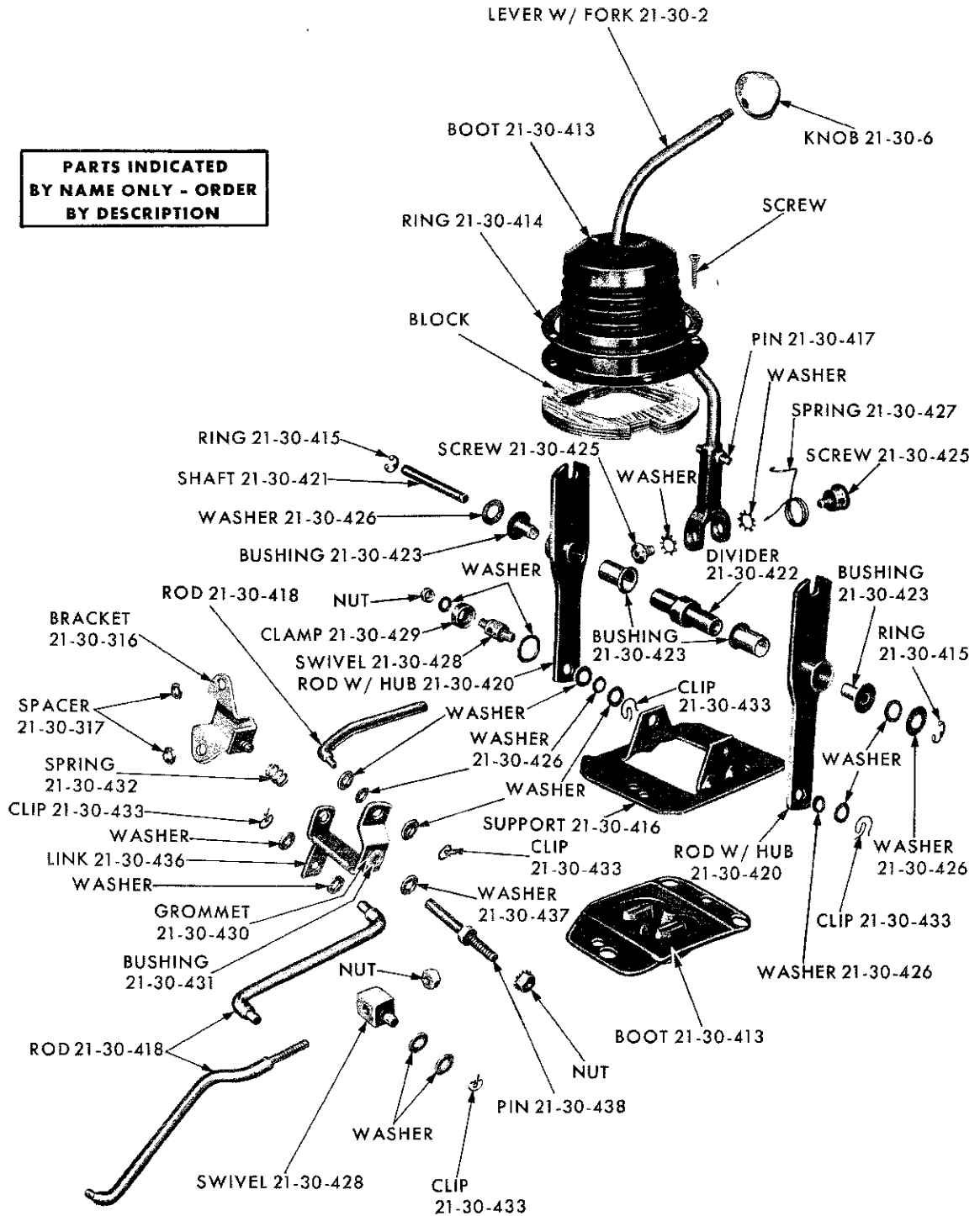

19x9342

STANDARD TRANSMISSION CONTROLS - CHRYSLER SC1-2

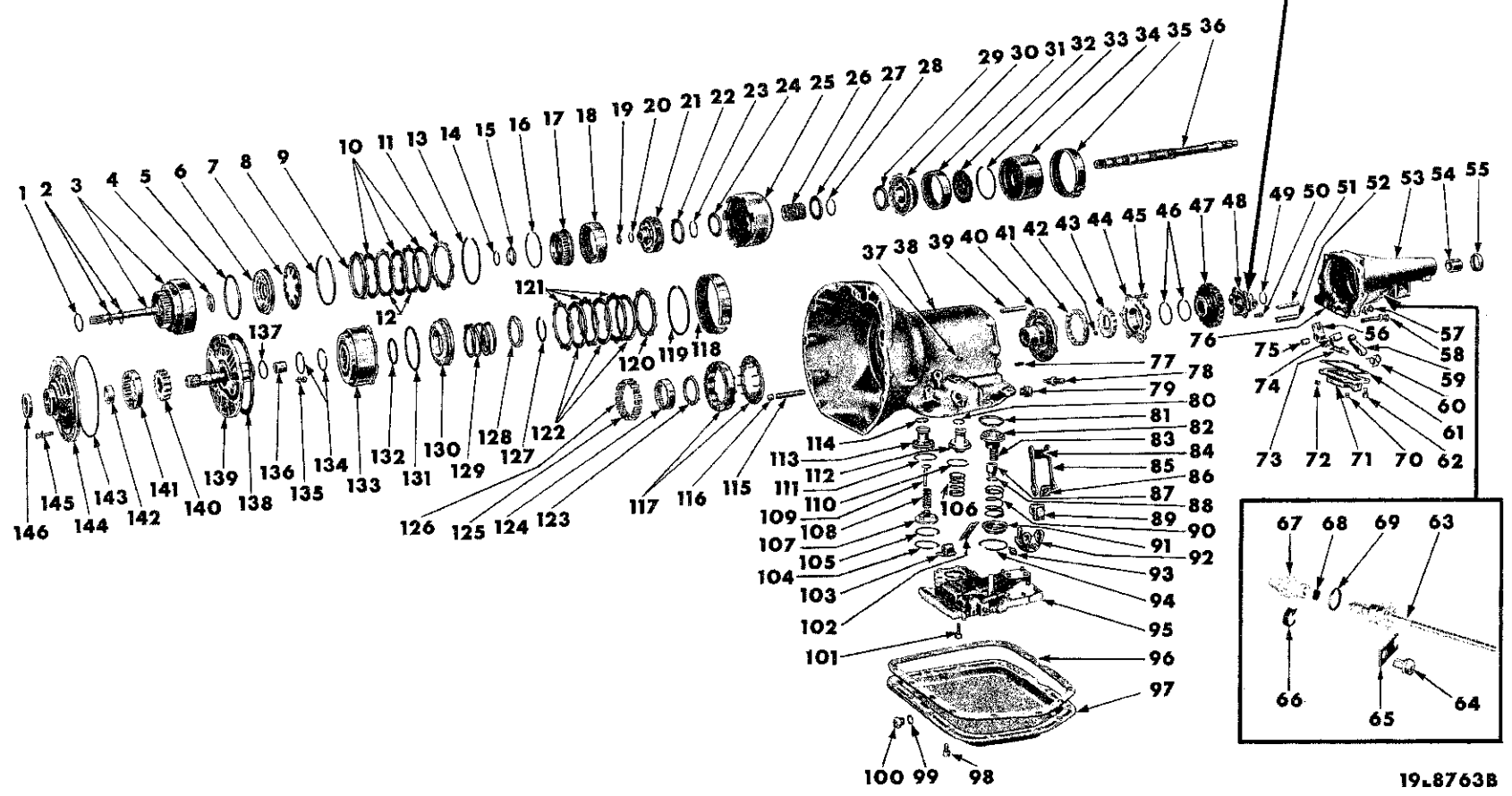
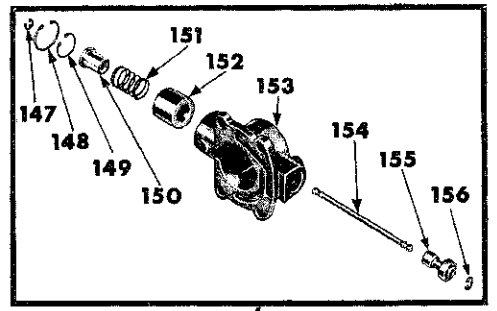

19-8763B

AUTOMATIC 3-SPEED TRANSMISSION - 6 CYLINDER

AUTOMATIC 3-SPEED TRANSMISSION - 6 CYLINDER

Ref. No.	Name	Part Type Code	Ref. No.	Name	Part Type Code
1	Washer	21-133-65	80	Ring	21-137-202
2	Ring	21-129-7	81	Seal	21-137-50
3	Shaft, Input	21-129-5	82	Piston, Reverse	21-137-35
4	Seal	21-133-17	83	Spring	21-137-41
5	Seal	21-133-17	84	Anchor	21-136-41
6	Piston	21-133-15	85	Link	21-136-44
7	Spring	21-133-20	86	Strut	21-136-41
8	Snap Ring	21-133-25	87	Plug	21-137-47
9	Plate	21-133-39	88	Snap Ring	21-137-44
10	Disc	21-133-36	89	Lever, Short	21-136-47
11	Plate	21-133-38	90	Spring	21-137-53
12	Plate	21-133-39	91	Retainer	21-137-56
13	Snap Ring	21-133-43	92	Lever, w/Stem	21-136-47
14	Snap Ring	21-134-40	93	Screw	21-136-52
15	Washer	21-134-45	94	Snap Ring	21-137-59
16	Snap Ring	21-134-40	95	Body, w/Transfer Plate	21-139-4
17	Support	21-134-36	96	Gasket	21-119-5
18	Gear	21-134-38	97	Pan	21-119-3
19	Washer	21-05-35	98	Screw	21-119-3
20	Snap Ring	21-05-19	99	Gasket	21-119-12
21	Carrier, Front	21-134-5	100	Plug	21-119-11
22	Washer	21-133-48	101	Screw	
23	Ring	21-133-46	102	Strut	21-136-15
24	Plate	21-133-47	103	Lever	21-136-20
25	Shell	21-133-42	104	Snap Ring	21-137-19
26	Gear, Sun	21-133-40	105	Ring	21-137-8
27	Plate	21-133-47	106	Spring	21-137-205
28	Ring	21-133-46	107	Guide	21-137-13
29	Washer	21-133-48	108	Spring	21-137-22
30	Carrier, Rear	21-134-5	109	Rod	21-137-11
31	Gear	21-134-38	110	Ring	21-137-202
32	Support	21-134-36	111	Ring	21-137-8
33	Snap Ring	21-134-40	112	Piston, Accumulator	21-137-200
34	Drum, Reverse	21-136-65	113	Piston, Kickdown	21-137-5
35	Band, Reverse	21-136-30	114	Ring	21-137-8
36	Shaft, Output	21-05-1	115	Shaft	21-136-23
37	Seal	21-139-47	116	Plug	
38	Case	21-03-1	117	Retainer and Cam	21-136-228
39	Shaft	21-136-49			
40	Housing, Rear	21-118-40	118	Band, Kickdown	21-136-5
41	Rotor, Outer	21-118-7	119	Snap Ring	21-133-43
42	Ball		120	Plate	21-133-39
43	Rotor, Inner (Serviced in 21-118-6)		121	Plate	21-133-38
44	Cover	21-118-53	122	Disc	21-133-36
45	Screw		123	Washer	21-136-237
46	Ring	21-138-38	124	Race	21-136-232
47	Support	21-138-10	125	Spring	21-136-236
48	Housing (Serviced in 21-138-2)		126	Roller	21-136-235
49	Snap Ring	21-138-7	127	Snap Ring	21-133-43
50	Screw		128	Retainer	21-133-22
51	Shaft	4-10-8	129	Spring	21-133-20
52	Bushing	4-10-12	130	Piston	21-133-15
53	Extension	21-04-1	131	Seal	21-133-17
54	Bushing	21-04-11	132	Seal	21-133-17
55	Oil Seal	21-05-12	133	Retainer, Front	21-133-7
56	Lever	4-10-7	134	Ring	21-129-13
57	Screw		135	Screw	
58	Screw		136	Bushing	21-129-23
59	Sprag	4-10-10	137	Washer	21-133-65
60	Spring	4-10-11	138	Gasket	21-129-24
61	Gasket	4-10-16	139	Shaft, Reacting, w/Support	21-129-10
62	Screw		140	Rotor, Inner (Serviced in 21-118-6)	
63	Cable	21-84-1	141	Rotor, Outer (Serviced in 21-118-6)	
64	Screw		142	Bushing	21-118-47
65	Retainer	21-84-7	143	Oil Seal	21-118-45
66	Clip	21-85-61	144	Housing, Front	21-118-40
67	Pinion	21-85-5	145	Screw	21-118-55
68	Seal	21-85-56	146	Oil Seal	21-118-42
69	Seal	21-84-28	147	Snap Ring	21-138-29
70	Plug		148	Snap Ring	21-138-19
71	Cover	4-10-15	149	Snap Ring	21-138-19
72	Plug		150	Weight	21-138-13
73	Adapter	4-10-2	151	Spring	21-138-15
74	Spacer	4-10-9	152	Weight	21-138-13
75	Bearing	4-10-19	153	Body (Serviced in 21-138-2)	
76	Gasket	21-04-2	154	Shaft	21-138-26
77	Pin		155	Valve	21-138-23
78	Screw	21-136-17	156	Snap Ring	21-138-29
79	Switch	21-113-24			

PARTS INDICATED BY NAME ONLY - ORDER BY DESCRIPTION

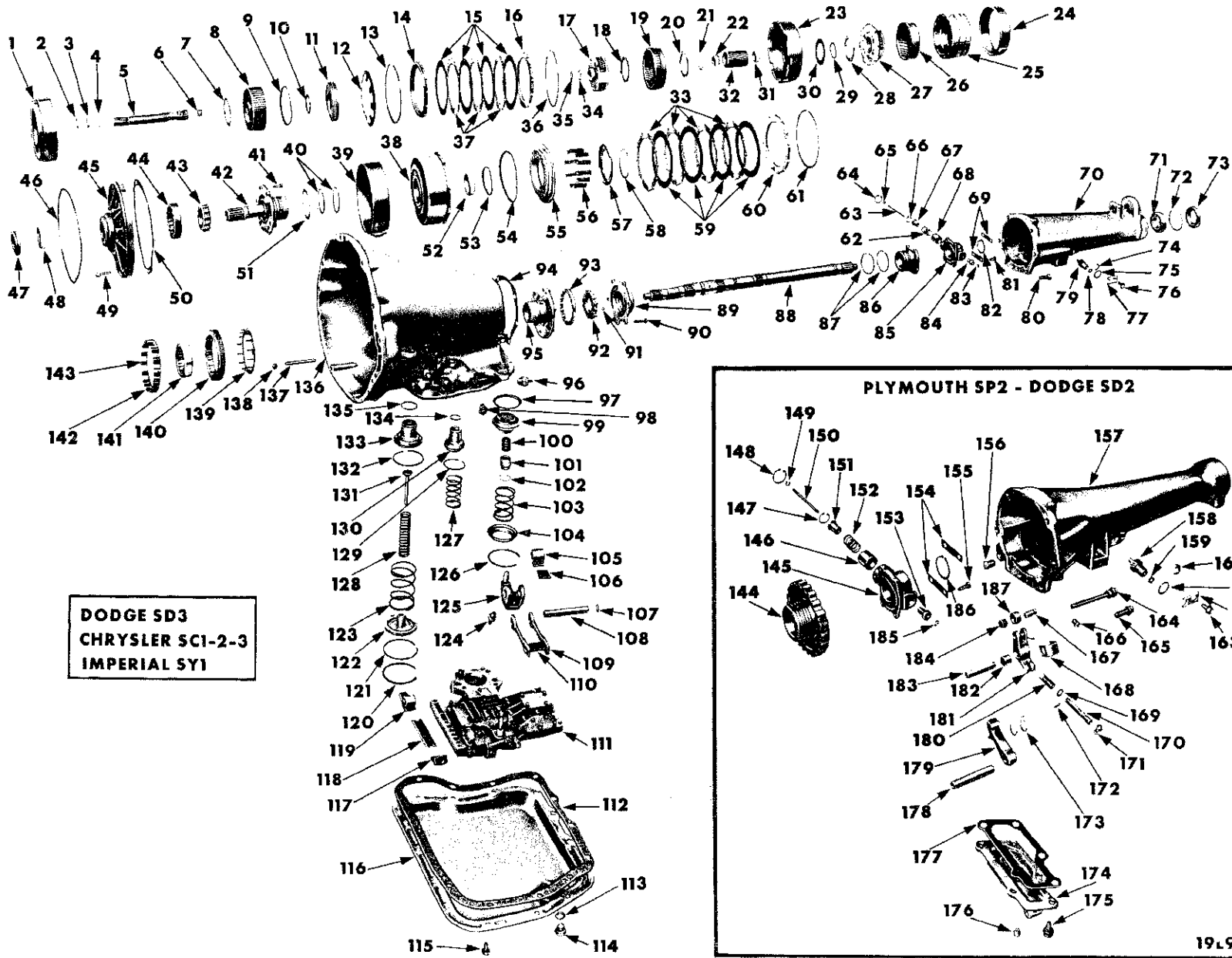

**DODGE SD3
CHRYSLER SC1-2-3
IMPERIAL SY1**

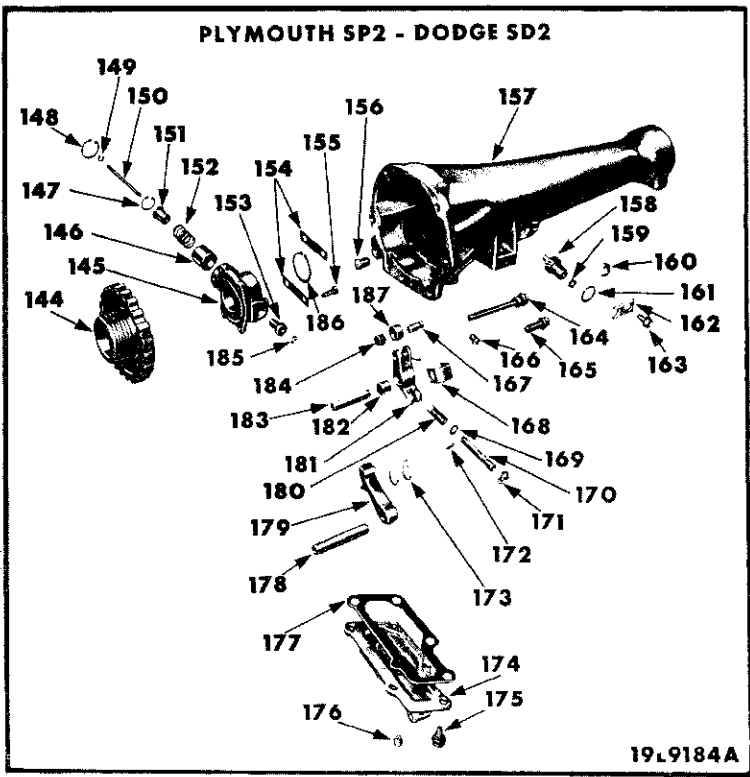

AUTOMATIC 3-SPEED TRANSMISSION - V8 CYLINDER

AUTOMATIC 3-SPEED TRANSMISSION - V8 CYLINDER

Ref. No.	Name	Part Type Code	Ref. No.	Name	Part Type Code
1	Retainer	21-133-7	95	Housing	21-118-40
2	Ring	21-129-7	96	Switch	21-113-24
3	Ring	21-129-7	97	Seal	21-137-50
4	Ring	21-133-25	98	Screw	21-136-17
5	Shaft, Input	21-129-5	99	Piston	21-137-35
6	Bushing	21-129-6	100	Spring	21-137-41
7	Washer	21-133-65	101	Plug	21-137-47
8	Retainer, Piston	21-133-7	102	Ring	21-137-44
9	Seal	21-133-17	103	Spring	21-137-53
10	Seal	21-133-17	104	Retainer	21-137-56
11	Piston	21-133-15	105	Lever	21-136-47
12	Spring	21-133-20	106	Strut	21-136-41
13	Ring	21-133-25	107	Ring	21-136-55
14	Plate	21-133-39	108	Shaft	21-136-49
15	Disc	21-133-36	109	Link	21-136-44
16	Plate	21-133-39	110	Anchor	21-136-41
17	Carrier	21-134-5	111	Body, w/Plate	21-139-4
18	Washer	21-134-30	112	Gasket	21-119-5
19	Gear	21-134-38	113	Gasket	21-119-12
20	Washer	21-133-48	114	Plug	21-119-11
21	Ring	21-133-46	115	Bolt	
22	Bushing (Serviced in 21-133-40)		116	Pan	21-110-3
23	Shell	21-133-42	117	Anchor	21-136-15
24	Band	21-136-30	118	Strut	21-136-15
25	Drum	21-136-65	119	Lever	21-136-20
26	Gear	21-134-38	120	Ring	21-137-19
27	Carrier	21-134-5	121	Ring	21-137-8
28	Washer	21-134-30	122	Guide	21-137-13
29	Ring	21-133-46	123	Spring	21-137-22
30	Plate	21-133-47	124	Screw	21-136-52
31	Bushing (Serviced in 21-133-40)		125	Lever	21-136-47
32	Gear	21-133-40	126	Ring	21-137-59
33	Plate	21-133-38	127	Spring	21-137-205
34	Ring	21-05-19	128	Spring	21-137-22
35	Washer	21-05-35	129	Ring	21-137-202
36	Ring	21-133-43	130	Piston	21-137-200
37	Plate	21-133-38	131	Rod	21-137-11
38	Retainer	21-133-7	132	Ring	21-137-8
39	Band	21-136-5	133	Piston	21-137-5
40	Ring	21-129-13	134	Ring	21-137-202
41	Bolt		135	Ring	21-137-8
42	Shaft, Reaction	21-129-10	136	Case	21-03-1
43	Rotor (Serviced in 21-118-6)		137	Shaft	21-136-23
44	Rotor (Serviced in 21-118-6)		138	Plug	
45	Housing	21-118-40	139	Retainer	21-136-233
46	Seal	21-118-45	140	Cam	21-136-231
47	Seal	21-118-42	141	Race	21-136-232
48	Bushing	21-118-47	142	Spring	21-136-236
49	Bolt	21-118-49	143	Roller	21-136-235
50	Gasket	21-118-54	144	Support	21-136-10
51	Washer	21-133-65	145	Body (Serviced in 21-138-2)	
52	Bushing (Serviced in 21-133-7)		146	Weight	21-138-13
53	Seal	21-133-17	147	Ring	21-138-19
54	Seal	21-133-17	148	Ring	21-138-19
55	Piston	21-133-15	149	Ring	21-138-29
56	Spring	21-133-20	150	Shaft	21-138-26
57	Retainer	21-133-22	151	Weight	21-138-13
58	Ring	21-133-43	152	Spring	21-138-15
59	Disc	21-133-36	153	Valve	21-138-23
60	Plate	21-133-39	154	Lock	21-138-21
61	Ring	21-133-43	155	Bolt	
62	Spring	21-138-15	156	Plug	
63	Shaft	21-138-26	157	Extension	21-04-1
64	Ring	21-138-19	158	Pinion	21-85-5
65	Ring	21-138-29	159	Seal	21-85-56
66	Ring	21-138-19	160	Clip	21-85-61
67	Weight	21-138-13	161	Seal	21-84-28
68	Weight	21-138-13	162	Retainer	21-84-7
69	Lock	21-138-21	163	Bolt	
70	Extension	21-04-1	164	Screw	
71	Bearing	21-04-11	165	Screw	
72	Ring	21-04-12	166	Plug	
73	Seal	21-05-12	167	Shaft (Serviced in 4-10-7)	
74	Clip	21-85-61	168	Spacer	4-10-9
75	Seal	21-84-28	169	Washer	4-10-4
76	Bolt		170	Adapter	4-10-2
77	Clamp	21-84-7	171	Spring	4-10-3
78	Seal	21-85-56	172	Pin	
79	Pinion	21-85-5	173	Spring	4-10-11
80	Bolt		174	Cover	4-10-15
81	Bolt		175	Screw	
82	Ring	21-138-7	176	Plug	
83	Ring	21-138-29	177	Gasket	4-10-16
84	Valve	21-138-23	178	Bushing	4-10-12
85	Housing (Serviced in 21-138-2)		179	Sprag	4-10-10
86	Support	21-138-10	180	Spring	4-10-3
87	Ring	21-138-38	181	Lever	4-10-7
88	Shaft, Output	21-05-1	182	Bearing (Serviced in 4-10-7)	
89	Cover	21-118-53	183	Shaft	4-10-8
90	Screw		184	Roller	4-10-19
91	Ball		185	Ring	21-138-29
92	Rotor (Serviced in 21-118-6)		186	Ring	21-138-7
93	Rotor	21-118-7	187	Roller	4-10-17
94	Gasket	21-04-2			

PARTS INDICATED BY NAME ONLY - ORDER BY DESCRIPTION

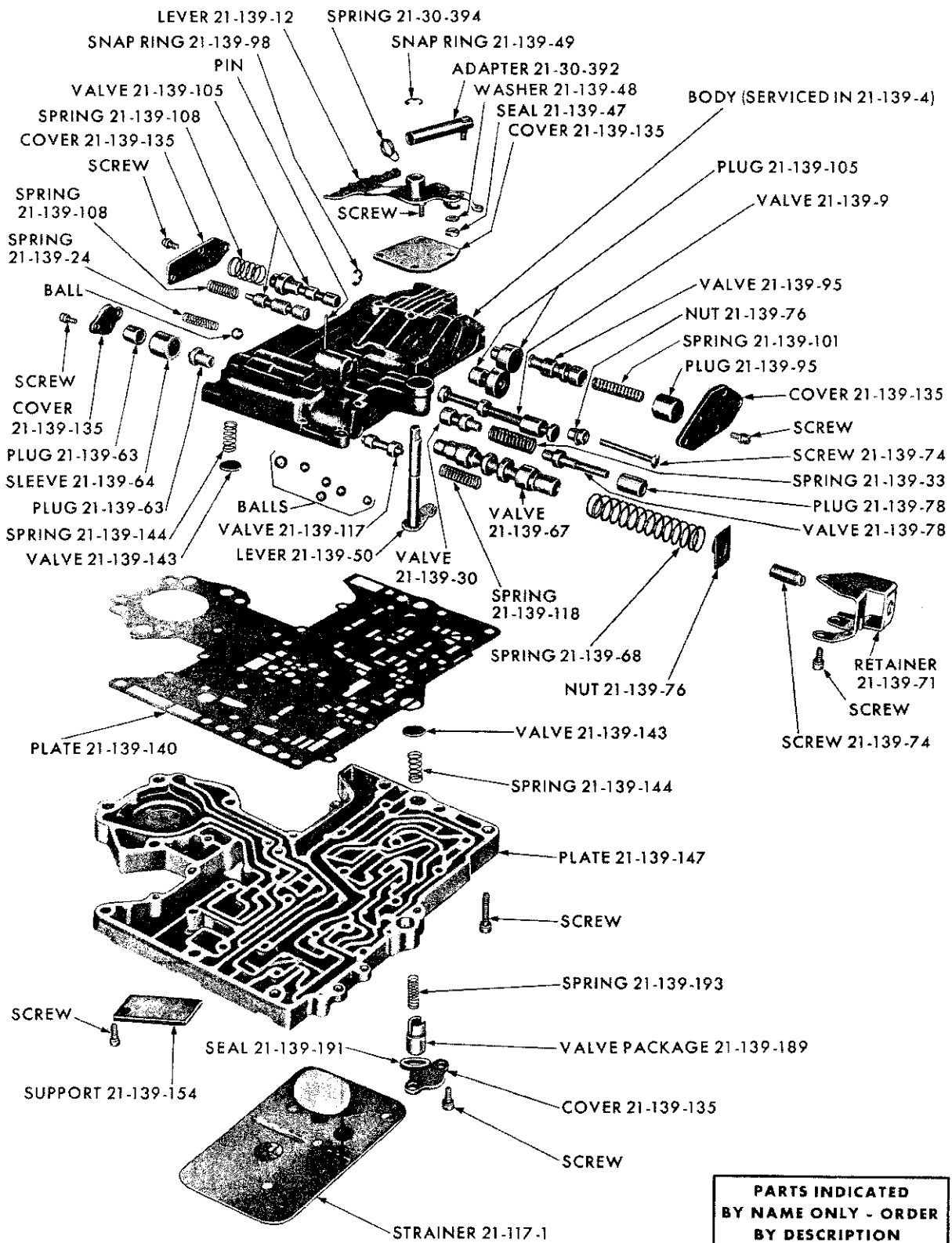

**PARTS INDICATED
BY NAME ONLY - ORDER
BY DESCRIPTION**

19x8761C

AUTOMATIC 3-SPEED TRANSMISSION VALVE BODY AND VALVES

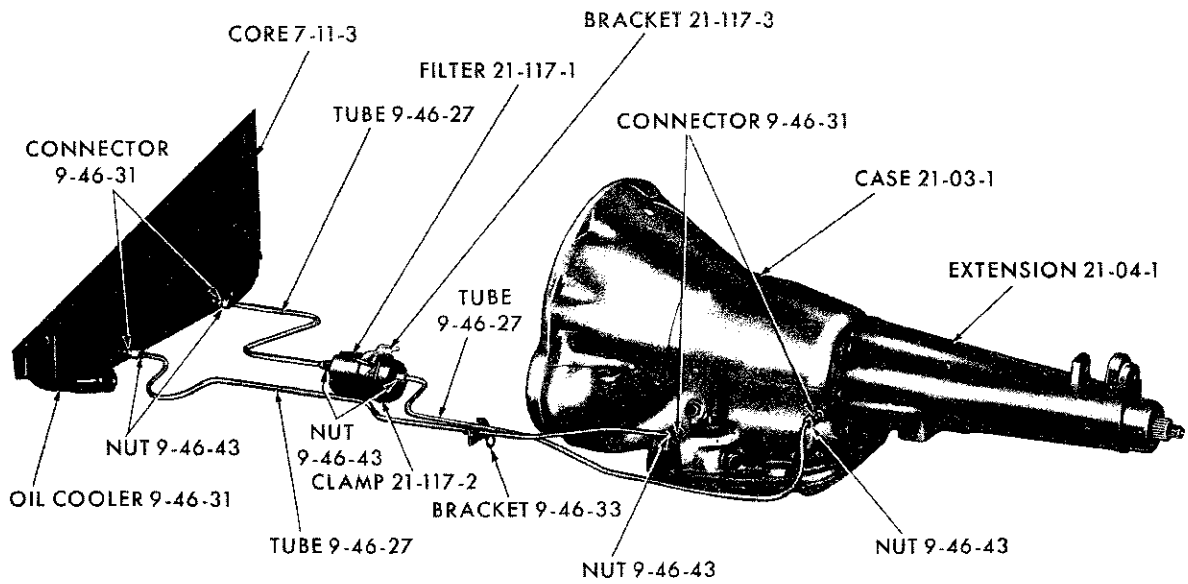

19x9340

TRANSMISSION COOLER SYSTEM

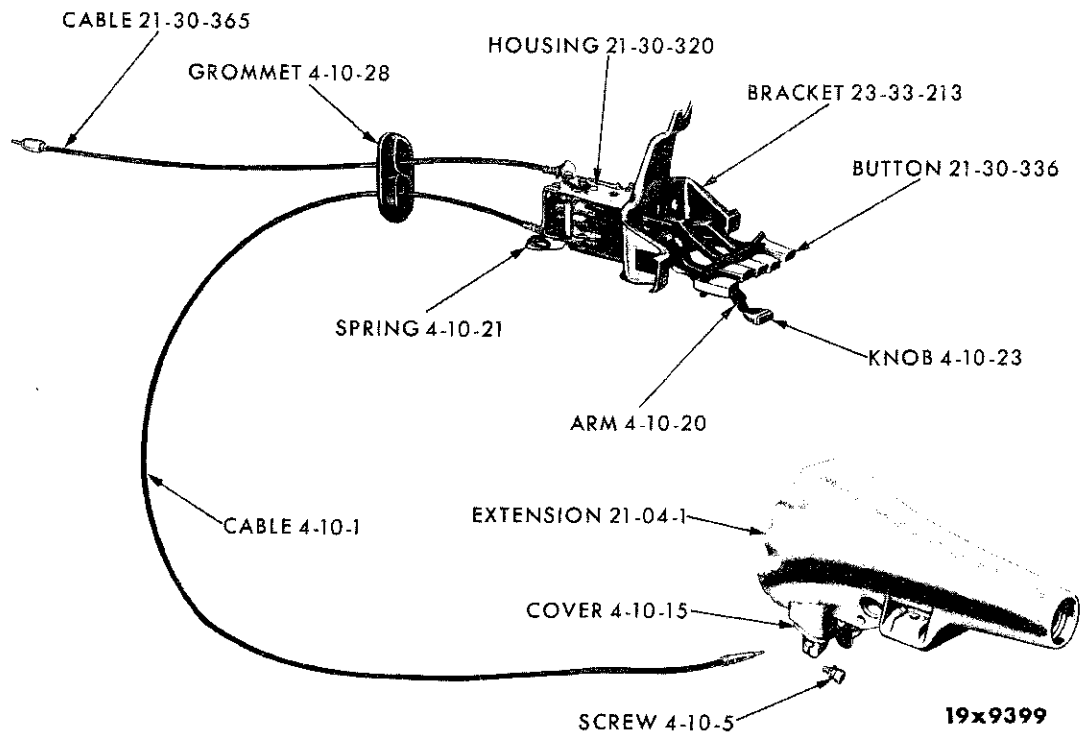

19x9399

TRANSMISSION PARKING LOCK SYSTEM

CODE	PART NAME AND DESCRIPTION	CYL.	PER CAR	VALIANT LANCER	PLYMOUTH DODGE	CHRYSLER IMPERIAL
------	---------------------------	------	---------	----------------	----------------	-------------------

STANDARD TRANSMISSION

21-01-0 TRANSMISSION SETS OR PACKAGES

NOTE: Standard Transmission listed as Heavy Duty is used on SP1, SP2, SD1, SD2, also Police Cars, Taxies and all extreme usage. Heavy Duty Standard Transmission is also Standard Equipment on SP2 Sport Fury, SD2 Polara, SC1, SC2 w/413 cu.in. Engine w/Single 4 Barrel Carburetor and on all SP2, SD2, AFTER Engine No. 86488. Standard Transmission has an Aluminum Extension. Heavy Duty Transmission has a Cast Iron Extension.

21-01-3	GASKET SET		1	2196 062	2275 896 (1)	
	Heavy Duty Trans.		1	----	2275 893 (2)	
	SD3, SC1, SC2	8	1	----	2240 320	2240 320

21-02-0 TRANSMISSION ASSEMBLY

21-02-1	TRANSMISSION	6	1	2204 883	2204 881	
	Heavy Duty Trans.	6	1	----	2204 876	
	UP TO Engine No. 86488	8	1	----	2204 870	
	Heavy Duty Trans.	8	1	----	*2400 801 (2)	
	SD3	8	1	----	2400 238	
	SP2, SD2, w/413 cu. in. Engine	8	1	----	E2400 690	
	SC1, SC2.	8	1	----	----	*2400 238
21-02-6	VENT, SC1, SC2		1	1139 204	1139 204	1139 204

21-03-0 TRANSMISSION CASE

21-03-1	CASE, SP1, SP2, SD1, SD2		1	2205 075	2205 075 (1)	
	SP1, SP2, SD1, SD2, Heavy Duty Trans., SD3, SC1, SC2		1	----	2205 077 (2)	2205 077
	SP2, SD2, w/413 cu. in. Engine	8	1	----	E2424 271	
21-03-24	PLUG, Back-Up Light Switch Hole, SC1, SC2		1	1139 153	1139 153	1139 153
21-03-25	GASKET, Plug, SC1, SC2		1	1302 807	1302 807	1302 807

21-04-0 TRANSMISSION CASE EXTENSION

21-04-1	EXTENSION, SP1, SP2, SD1, SD2		1	2125 145	1949 367 (1)	
	Heavy Duty Trans., SP1, SP2, SD1, SD2		1	----	2125 228 (2)	
	SD3, SC1, SC2	8	1	----	2124 457	2124 457
	SP2, SD2, w/413 cu. in. Engine	8	1	----	E2400 700	
21-04-2	GASKET, SP1, SP2, SD1, SD2		1	1949 361	1949 361 (1)	
	SP1, SP2, SD1, SD2, Heavy Duty Trans., SD3, SC1, SC2		1	----	2124 519 (2)	2124 519
	SP2, SD2, w/413 cu. in. Engine	8	1	----	*1921 480	
21-04-11	BUSHING, Extension, SP1, SP2, SD1, SD2		1	2124 607	1941 887 (1)	
	BEARING, Extension, SP1, SP2, SD1, SD2, Heavy Duty Trans., SD3, SC1, SC2		1	----	1672 194 (2)	1672 194
	SP2, SD2, w/413 cu. in. Engine	8	1	----	*1672 194	
	WASHER, Extension Bearing	8	1	----	*6023 561	
21-04-12	SNAP RING, Bearing, w/413 cu. in. Engine		8	----	*6023 560	

NOTE 1: SP2-L-M-H UP TO Engine No. 86488. SD2-L-M-H UP TO Engine No. 86488. SP1, SD1

NOTE 2: SP2-L-M-H, SD2-L-M-H, Heavy Duty Trans. Special Equipment on UP TO Engine No. 86488. Heavy Duty Trans. is Standard Equipment on AFTER Engine No.86488 also Standard Equipment on SP2 Sport Fury, SD2 Polara.

1962 PASSENGER CAR PARTS CATALOG

CODE	PART NAME AND DESCRIPTION	C Y L	PER CAR	VALIANT LANCER	PLYMOUTH DODGE	CHRYSLER IMPERIAL
------	---------------------------	-------------	------------	-------------------	-------------------	----------------------

STANDARD TRANSMISSION

21-09-0 TRANSMISSION MAIN DRIVE PINION

21-09-2	PINION, 24 T., 18 T., 23 Splines, 10 1/2" lgh.	6	1	2204 944	2204 944	
	24 T., 18 T., 23 Splines, 10 17/32" lgh., Heavy Duty Trans.	6	1	----	2125 195	
	24 T., 22 T., 23 Splines, 10 17/32 lgh., SP2, SD2	8	1	----	1949 371 (5)	
	24 T., 20 T., 23 Splines, 10 25/32" lgh., Heavy Duty Trans., SP2, SD2	8	1	----	2124 937 (2)	
	24T., 20T., 24 Splines, 12 29/32" lgh., SD3, SC1, SC2	8	1	----	*2124 683	*2124 683
	SP2, SD2, w/413 cu. in. Engine	8	1	----	E2400 694	
21-09-5	BEARING, SP 1, SP2, SD1, SD2		1	1633 718	1633 718 (1)	
	SP1, SP2, SD1, SD2, Heavy Duty Trans., SD3, SC1, SC2	8	1	----	2124 516 (2)	2124 516
21-09-19	SLINGER, Bearing, SC1, SC2		1	1633 669	1633 669	1633 669
	SP2, SD2, w/413 cu. in. Engine	8	1	----	*1921 471	
21-09-23	SNAP RING, Bearing., .088" thk., SP1, SP2, SD1, SD2		★	631 823	631 823 (1)	
	.091" thk., SP1, SP2, SD1, SD2		★	631 824	631 824 (1)	
	.094" thk., SP1, SP2, SD1, SD2		★	631 825	631 825 (1)	
	.097" thk., SP1, SP2, SD1, SD2		★	640 332	640 332 (1)	
	.086" thk., SP1, SP2, SD1, SD2, Heavy Duty Trans., SC1, SC2		★	----	2125 113 (4)	2125 113 (4)
	.090" thk., SP1, SP2, SD1, SD2, Heavy Duty Trans., SC1, SC2		★	----	2125 114 (4)	2125 114 (4)
	.094" thk., SP1, SP2, SD1, SD2, Heavy Duty Trans., SC1, SC2		★	----	2125 115 (4)	2125 115 (4)
	.098" thk., SP1, SP2, SD1, SD2, Heavy Duty Trans., SC1, SC2		★	----	2125 116 (4)	2125 116 (4)
	.088" thk., SP1, SD1, Heavy Duty Trans., SP2, SD2, SD3, SC1, SC2		★	----	631 823 (3)	631 823 (3)
	.091" thk., SP1, SD1, Heavy Duty Trans., SP2, SD2, SD3, SC1, SC2		★	----	631 824 (3)	631 824 (3)
	.094" thk., SP1, SD1, Heavy Duty Trans., SP2, SD2, SD3, SC1, SC2		★	----	631 825 (3)	631 825 (3)
	.097" thk., SP1, SD1, Heavy Duty Trans., SP2, SD2, SD3, SC1, SC2		★	----	640 332 (3)	640 332 (3)
	Inner, SP2, SD2, w/413 cu. in. Engine	8	1	----	*1921 472	
	Outer.	8	1	----	*1569 909	
21-09-25	WASHER, Bearing		1	631 877	631 877 (1)	
	SP2, SD2, w/413 cu. in. Engine	8	1	----	*1921 473	

- NOTE 1: SP2-L-M-H UP TO Engine No. 86488. SD2-L-M-H UP TO Engine No. 86488.
SP1, SD1
- NOTE 2: SP2-L-M-H, SD2-L-M-H, Heavy Duty Trans. Special Equipment on UP TO Engine No. 86488.
Heavy Duty Trans. is Standard Equipment on AFTER Engine No. 86488 also Standard Equipment on SP2 Sport Fury, SD2 Polara.
- NOTE 3: SP1, SD1, AFTER Engine No. S17-11-61 and S22-11-61, Heavy Duty Trans.
SP2-L-M-H, SD2-L-M-H, UP TO Engine No. 86488, Heavy Duty Trans.
SP2-P AFTER Engine No. S36-11-61. SD2-P AFTER Engine No. S36-11-61.
SC1 AFTER Engine No. S36-11-61. SC2 AFTER Engine No. S41-11-61.
SD3
- NOTE 4: SP1, SD1, UP TO Engine No. S17-11-61 and S22-11-61.
SP2-L-M-H, SD2-L-M-H, AFTER Engine No. 86488.
SP2-P UP TO Engine No. S36-11-61. SD2-P UP TO Engine No. S36-11-61.
SC1 UP TO Engine No. S36-11-61. SC2 UP TO Engine No. S41-11-61.
- NOTE 5: SP2-L-M-H UP TO Engine No. 86488. SD2-L-M-H UP TO Engine No. 86488.

★ Indicates use as required. Numerals in parentheses () refer to notes. Printed in U.S.A.
 □ Indicates parts not listed in any previous parts book. Prices and specifications subject to change without notice.
 March 8, 1963 Supersedes May 1, 1962. Page 21-10 * Indicates change or addition.

CODE	PART NAME AND DESCRIPTION	C Y L.	PER CAR	VALIANT LANCER	PLYMOUTH DODGE	CHRYSLER IMPERIAL
------	---------------------------	--------------	------------	-------------------	-------------------	----------------------

STANDARD TRANSMISSION

21-09-O TRANSMISSION MAIN DRIVE PINION - Cont'd

21-09-29	RETAINER, Bearing		1	2204 491	2204 491 (1)	
	SP1, SP2, SD1, SD2, Heavy Duty Trans.		1	----	2124 945 (2)	
	SD3, SC1, SC2	8	1	----	2124 396	2124 396
	SP2, SD2, w/413 cu. in. Engine	8	1	----	E2400 438	
21-09-30	OIL SEAL, Pinion		1	1949 343	1949 343	
	SD3, SC1, SC2	8	1	----	1949 933	1949 933
21-09-33	GASKET, Bearing Retainer, .009" thk.		★	865 180	865 180 (1)	
	.0135" thk.		★	865 181	865 181 (1)	
	.0225" thk.		★	672 709	672 709 (1)	
	.009" thk., SP1, SP2, SD1, SD2, Heavy Duty Trans., SD3, SC1, SC2		★	----	2124 496 (2)	2124 496
	.0135" thk., SP1, SP2, SD1, SD2, Heavy Duty Trans., SD3, SC1, SC2		★	----	2124 497 (2)	2124 497
	.0225" thk., SP1, SP2, SD1, SD2, Heavy Duty Trans., SD3, SC1, SC2		★	----	2124 499 (2)	2124 499
	SP2, SD2, w/413 cu. in. Engine	8	1	----	*1921 475	

21-10-O TRANSMISSION GEARS

21-10-4	GEAR, Sliding, First and Reverse, 29 T., 6 Splines		1	1853 855	1853 855 (1)	
	First and Reverse, 28 T., 34 Splines, SP1, SP2, SD1, SD2, Heavy Duty Trans., SD3, SC1, SC2 . First and Reverse, SP2, SD2, w/413 cu.in.Engine	8	1	----	2124 561 (2)	2124 561
					E2400 683	
21-10-16	GEAR, Second Speed, 24 T., 24 T.	6	1	2205 134	2205 134	
	Second Speed, 24 T., 25 T.	8	1	----	1322 765 (3)	
	Second Speed, 24 T., 24 T., SP1, SP2, SD1, SD2, Heavy Duty Trans., SD3, SC1, SC2		1	----	2124 560 (2)	2124 560
	Second Speed, SP2, SD2, w/413 cu. in. Engine, 36T., 27T.	8	1	----	E2400 692	

21-11-O TRANSMISSION REVERSE IDLER GEAR

21-11-1	GEAR, 15 T.		1	1853 695	1853 695 (1)	
	14 T., SP1, SP2, SD1, SD2, Heavy Duty Trans., SD3, SC1, SC2		1	----	2124 562 (2)	2124 562
	SP2, SD2, w/413 cu. in. Engine	8	1	----	E1921 501	
21-11-2	ROLLER, Bearing, SC1, SC2		22	666 927	666 927	666 927
	Bushing, SP2, SD2, w/413 cu.in. Engine.	8	1	----	E1921 503	
21-11-9	WASHER		2	666 924	666 924 (1)	
	SP1, SP2, SD1, SD2, Heavy Duty Trans., SD3, SC1, SC2		2	----	2204 978 (2)	2204 978

21-12-O TRANSMISSION REVERSE IDLER GEAR SHAFT

21-12-1	SHAFT, SC1, SC2		1	1635 290	1635 290	1635 290
	SP2, SD2, w/413 cu. in. Engine	8	1	----	E1921 504	
21-12-2	KEY, SC1, SC2		1	1635 293	1635 293	1635 293

NOTE 1: SP2-L-M-H UP TO Engine No. 86488. SD2-L-M-H UP TO Engine No. 86488.
SP1, SD1

NOTE 2: SP2-L-M-H, SD2-L-M-H, Heavy Duty Trans. Special Equipment on UP TO Engine No. 86488.
Heavy Duty Trans. is Standard Equipment on AFTER Engine No. 86488 also Standard Equipment on
SP2 Sport Fury, SD2 Polara.

NOTE 3: SP2-L-M-H UP TO Engine No. 86488. SD2-L-M-H UP TO Engine No. 86488.

★ Indicates use as required.

Numerals in parentheses () refer to notes.

Printed in U.S.A.

⊘ Indicates parts not listed in any previous parts book.

Prices and specifications subject to change without notice.

* Indicates change or addition.

1962 PASSENGER CAR PARTS CATALOG

CODE	PART NAME AND DESCRIPTION	C Y L.	P E R C A R	VALIANT LANCER	PLYMOUTH DODGE	CHRYSLER IMPERIAL
------	---------------------------	--------------	----------------------------	-------------------	-------------------	----------------------

STANDARD TRANSMISSION

21-14-O TRANSMISSION CLUTCH GEAR

21-14-1	SYNCHRONIZER UNIT	1	2205 058	2205 058 (1)		
	SP1, SP2, SD1, SD2, Heavy Duty Trans., SC1, SC2	1	----	2124 467 (4)	2124 467 (4)	
		1	----	2400 315 (5)	2400 315 (5)	
	SP2, SD2, w/413 cu. in. Engine	8	1	----	*1921 487	
21-14-5	GEAR, 24 T.	1	1853 672	1853 672 (1)		
	24 T., SP1, SP2, SD1, SD2, Heavy Duty Trans., SC1, SC2	1	----	2124 392 (4)	2124 392 (4)	
	24 T.	1	----	2204 666 (5)	2204 666 (5)	
	Second and Direct, SP2, SD2, w/413 cu. in. Engine	8	1	----	*1921 486	
21-14-6	SLEEVE	1	1676 197	1676 197 (1)		
	SP1, SP2, SD1, SD2, Heavy Duty Trans., SD3, SC1, SC2	1	----	2124 387 (2)	2124 387	
21-14-15	SPRING, Synchronizer Stop Ring	1	2205 061	2205 061 (1)		
	SP1, SP2, SD1, SD2, Heavy Duty Trans., SC1, SC2 .	1	----	2204 503 (4)	2204 503 (4)	
		1	----	2205 061 (5)	2205 061 (5)	
21-14-19	RING, Synchronizer Stop, Outer	2	2205 059	2205 059 (1)		
	Inner	★	1322 763	1322 763 (1)		
	Outer, SP1, SP2, SD1, SD2, Heavy Duty Trans., SD3, SC1, SC2	2	----	2124 468 (2)	2124 468	
	Inner, SP1, SP2, SD1, SD2, Heavy Duty Trans., SD3, SC1, SC2	2	----	2124 472 (2)	2124 472	
	SP2, SD2, w/413 cu. in. Engine	8	1	----	*1921 499	
21-14-20	SNAP RING, .088" thk., SC1, SC2	★	631 823	631 823 (4)	631 823 (4)	
	.091" thk., SC1, SC2	★	631 824	631 824 (4)	631 824 (4)	
	.094" thk., SC1, SC2	★	631 825	631 825 (4)	631 825 (4)	
	.097" thk., SC1, SC2	★	640 332	640 332 (4)	640 332 (4)	
		1	----	2205 192 (5)	2205 192 (5)	

21-15-O TRANSMISSION COUNTERSHAFT GEAR

21-15-2	GEAR, 33 T., 24 T., 18 T., 14 T., 6.83" lgh. . .	6	1	2205 132	2205 132	
	33 T., 25 T., 17 T., 13 T., Heavy Duty Trans. .	6	1	----	2124 386	
	29 T., 23 T., 18 T., 14 T.	8	1	----	1853 627 (3)	
	31 T., 25 T., 17 T., 13 T., SP2, SD2, Heavy Duty Trans., SD3, SC1, SC2	8	1	----	2124 384 (2)	2124 384
	SP2, SD2, w/413 cu. in. Engine	8	1	----	2400 696	
21-15-33	WASHER, Thrust, .057" thk.	★	1633 763	1633 763 (1)		
	.062" thk.	★	1633 762	1633 762 (1)		
	.057" thk., SP1, SP2, SD1, SD2, Heavy Duty Trans., SD3, SC1, SC2	★	----	2124 505 (2)	2124 505	

- NOTE 1: SP2-L-M-H UP TO Engine No. 86488. SD2-L-M-H UP TO Engine No. 86488.
SP1, SD1
- NOTE 2: SP2-L-M-H, SD2-L-M-H, Heavy Duty Trans. Special Equipment on UP TO Engine No. 86488.
Heavy Duty Trans., is Standard Equipment on AFTER Engine No. 86488 also Standard Equipment on
SP2 Sport Fury, SD2 Polara.
- NOTE 3: SP2-L-M-H UP TO Engine No. 86488. SD2-L-M-H UP TO Engine No. 86488.
- NOTE 4: SP1, SD1, UP TO Engine No. S17-11-61 and S22-11-61.
SP2-L-M-H, SD2-L-M-H, UP TO Engine No. 86488, Heavy Duty Trans.
SP2-P UP TO Engine No. S36-11-61. SD2-P UP TO Engine No. S36-11-61.
SC1 UP TO Engine No. S36-11-61. SC2 UP TO Engine No. S41-11-61.
- NOTE 5: SP1, SD1, AFTER Engine No. S17-11-61 and S22-11-61, Heavy Duty Trans.
SP2-L-M-H, SD2-L-M-H, AFTER Engine No. 86488.
SP2-P AFTER Engine No. S36-11-61. SD2 AFTER Engine No. S36-11-61.
SC1 AFTER Engine No. S36-11-61. SC2 AFTER Engine No. S41-11-61.
SD3

CODE	PART NAME AND DESCRIPTION	CYL	PER CAR	VALIANT LANCER	PLYMOUTH DODGE	CHRYSLER IMPERIAL
------	---------------------------	-----	---------	----------------	----------------	-------------------

STANDARD TRANSMISSION

21-15-O TRANSMISSION COUNTERSHAFT GEAR - Cont'd

21-15-33	WASHER - Cont'd .062" thk., SP1, SP2, SD1, SD2, Heavy Duty Trans., SD3, SC1, SC2		★	----	2124 504 (2)	2124 504
	Front, SP2, SD2, w/413 cu. in. Engine	8	1	----	*1921 492	
	Rear, SP2, SD2, w/413 cu. in. Engine	8	1	----	*1921 493	

21-16-O TRANSMISSION MAIN SHAFT

21-16-3	SHAFT, 6, 23, Splines, 22 1/4" lgh.	6	1	2125 179		
	6, 23, Splines, 25 1/2" lgh.		1	----	1949 365 (1)	
	6, 34, 23, Splines, 25" lgh., SP1, SP2, SD1, SD2, Heavy Duty Trans., SC1, SC2		1	----	2124 554 (3)	2124 554 (3)
	32, 34, 23, Splines, 25 1/4" lgh.		1	----	2204 665 (4)	2204 665 (4)
	SP2, SD2, w/413 cu. in. Engine	8	1	----	22400 697	

21-17-O TRANSMISSION MAIN SHAFT PILOT BEARING

21-17-2	ROLLER, SC1, SC2		★	1949 834	1949 834	1949 834
	SP2, SD2, w/413 cu. in. Engine	8	14	----	*1921 482	
21-17-7	SNAP RING, Roller		1	601 108	601 108 (1)	
	SP1, SP2, SD1, SD2, Heavy Duty Trans., SD3, SC1, SC2		1	----	862 173 (2)	862 173
21-17-9	SPACER, Bearing Roller, SP2, SD2, w/413 cu. in. Engine	8	1	----	*1923 509	

21-19-O TRANSMISSION MAIN SHAFT BEARING

21-19-2	BEARING		1	1633 718	1633 718 (1)	
	Front, SP1, SP2, SD1, SD2, Heavy Duty Trans., SD3, SC1, SC2		1	----	620 521 (2)	620 521
	SP2, SD2, w/413 cu. in. Engine	8	1	----	* 620 521	
21-19-15	SNAP RING, Inner, .088" thk., SC1, SC2		★	631 823	631 823	631 823
	Inner, .091" thk., SC1, SC2		★	631 824	631 824	631 824
	Inner, .095" thk., SC1, SC2		★	631 825	631 825	631 825
	Inner, .097" thk., SC1, SC2		★	640 332	640 332	640 332
	Outer, .086" thk.		★	640 280	640 280 (1)	
	Outer, .089" thk.		★	631 809	631 809 (1)	
	Outer, .092" thk.		★	631 810	631 810 (1)	
	Outer, .095" thk.		★	640 331	640 331 (1)	
	Outer, .087" thk., SP1, SP2, SD1, SD2, Heavy Duty Trans., SD3, SC1, SC2		★	----	2124 508 (2)	2124 508

NOTE 1: SP2-L-M-H UP TO Engine No. 86488.
SP1, SD1

SD2-L-M-H UP TO Engine No. 86488.

NOTE 2: SP2-L-M-H, SD2-L-M-H, Heavy Duty Trans., Special Equipment on UP TO Engine No. 86488.
Heavy Duty Trans., is Standard Equipment on AFTER Engine No. 86488, also Standard Equipment on
SP2 Sport Fury, SD2 Polara, SD3.

NOTE 3: SP1, SD1, UP TO Engine No. S17-11-61 and S22-11-61.
SP2-L-M-H, SD2-L-M-H, UP TO Engine No. 86488, Heavy Duty Trans.
SP2-P UP TO Engine No. S36-11-61 SD2-P UP TO Engine No. S36-11-61.
SC1 UP TO Engine No. S36-11-61. SC2 UP TO Engine No. S41-11-61.

NOTE 4: SP1, SD1, AFTER Engine No. S17-11-61 and S22-11-61, Heavy Duty Trans.
SP2-L-M-H, SD2-L-M-H, AFTER Engine No. 86488.
SP2-P AFTER Engine No. S36-11-61. SD2 AFTER Engine No. S36-11-61.
SC1 AFTER Engine No. S36-11-61. SC2 AFTER Engine No. S41-11-61.
SD3

★ Indicates use as required.

Numerals in parentheses () refer to notes.

Printed in U.S.A.

⊠ Indicates parts not listed in any previous parts book.

Prices and specifications subject to change without notice.

* Indicates change or addition.

CODE	PART NAME AND DESCRIPTION	C Y L.	PER CAR	VALIANT LANCER	PLYMOUTH DODGE	CHRYSLER IMPERIAL
------	---------------------------	--------------	------------	-------------------	-------------------	----------------------

STANDARD TRANSMISSION

21-19-O TRANSMISSION MAIN SHAFT BEARING - Cont'd

21-19-15	SNAP RING - Cont'd					
	Outer, .090" thk., SP1, SP2, SD1, SD2, Heavy Duty Trans., SD3, SC1, SC2		★	----	2124 509 (2)	2124 509
	Outer, .093" thk., SP1, SP2, SD1, SD2, Heavy Duty Trans., SD3, SC1, SC2		★	----	2124 510 (2)	2124 510
	Outer, .096" thk., SP1, SP2, SD1, SD2, Heavy Duty Trans., SD3, SC1, SC2		★	----	2124 511 (2)	2124 511
	Outer, SP2, SD2, w/413 cu. in. Engine	8	2	----	*1921 481	
	Inner, SP2, SD2, w/413 cu. in. Engine	8	1	----	*1921 472	

21-22-O TRANSMISSION MAIN SHAFT BEARING OIL SEAL

21-22-2	OIL SEAL		1	1942 401	1854 449 (1)	
	SP1, SP2, SD1, SD2, Heavy Duty Trans., SD3, SC1, SC2		1	----	2205 080 (2)	2205 080
	SP2, SD2, w/413 cu. in. Engine	8	1	----	*2205 080	

21-24-O TRANSMISSION COUNTERSHAFT

21-24-2	COUNTERSHAFT		1	1635 282	1635 282 (1)	
	SP1, SP2, SD1, SD2, Heavy Duty Trans., SD3, SC1, SC2		1	----	2124 393 (2)	2124 393
	SP2, SD2, w/413 cu. in. Engine	8	1	----	*1921 491	
21-24-19	PLATE or WASHER, Thrust, SP1, SP2, SD1, SD2, Heavy Duty Trans., SD3, SC1, SC2		1	----	2124 474 (2)	2124 474
	Rear, SP2, SD2, w/413 cu. in. Engine	8	1	----	*1921 494	
21-24-22	KEY, SC1, SC2		1	1635 293	1635 293	1635 293

21-25-O TRANSMISSION COUNTERSHAFT BEARING

21-25-2	ROLLER		44	666 927	666 927 (1)	
	SP1, SP2, SD1, SD2, Heavy Duty Trans., SD3, SC1, SC2		88	----	2124 502 (2)	2124 502
	SP2, SD2, w/413 cu. in. Engine	8	80	----	*1921 495	
21-25-4	SPACER		1	697 812	697 812 (1)	
	SP1, SP2, SD1, SD2, Heavy Duty Trans., SD3, SC1, SC2		1	----	2124 473 (2)	2124 473
	SP2, SD2, w/413 cu. in. Engine	8	1	----	*1921 496	
21-25-6	WASHER or RING, Roller Thrust		2	1630 878	1630 878 (1)	
	SP1, SP2, SD1, SD2, Heavy Duty Trans., SD3, SC1, SC2		4	----	2124 506 (2)	2124 506
	SP2, SD2, w/413 cu. in. Engine	8	4	----	*1921 497	

21-29-O TRANSMISSION CASE COVER

21-29-3	COVER		1	1949 345	1949 345 (1)	
	SP1, SP2, SD1, SD2, Heavy Duty Trans., SD3, SC1, SC2		1	----	2124 465 (2)	2124 465
21-29-3	HOUSING, SP2, SD2, w/413 cu. in. Engine	8	1	----	*1921 506	
21-29-25	GASKET, Cover		1	1949 346	1949 346 (1)	
	SP1, SP2, SD1, SD2, Heavy Duty Trans., SD3, SC1, SC2		1	----	2124 466 (2)	2124 466
	SP2, SD2, w/413 cu. in. Engine	8	1	----	*1921 507	

NOTE 1: SP2-L-M-H UP TO Engine No. 86488. SD2-L-M-H UP TO Engine No. 86488.
SP1, SD1

NOTE 2: SP2-L-M-H, SD2-L-M-H, Heavy Duty Trans. Special Equipment on UP TO Engine No. 86488.
Heavy Duty Trans. is Standard Equipment on AFTER Engine No. 86488 also Standard Equipment on SP2 Sport Fury, SD2 Polara.

★ Indicates use as required.

Numerals in parentheses () refer to notes.

Printed in U.S.A.

⊠ Indicates parts not listed in any previous parts book.

Prices and specifications subject to change without notice.

March 8, 1963 Supersedes May 1, 1962.

Page 21-14

* Indicates change or addition.

CODE	PART NAME AND DESCRIPTION	CYL.	PER CAR	VALIANT LANCER	PLYMOUTH DODGE	CHRYSLER IMPERIAL
------	---------------------------	------	---------	----------------	----------------	-------------------

STANDARD TRANSMISSION

21-30-O TRANSMISSION GEARSHIFT LEVER AND RODS

21-30-2	LEVER, w/KNOB, SP1, SP2, SD1, SD2		1	*2266 176	*2266 176	
	WASHER, Spring		1	6023 046	6023 046	
	LEVER, w/FORK, SD3, SC1, SC2	8	1	----	2203 480	2203 480
	LEVER, SP2, SD2, w/413 cu. in. Engine	8	1	----	E2404 890	
21-30-5	INSULATOR, Lever		1	2265 662	2265 662	
21-30-6	KNOB, SD3, SC1, SC2	8	1	----	2208 140	2208 140
21-30-315	PLATE, Control Bell Crank to Floor Pan Bracket, SD3, SC1, SC2	8	1	----	2203 483	2203 483
21-30-316	BRACKET, Control Bell Crank to Extension, SD3, SC1, SC2	8	1	----	2203 498	2203 498
	Control Bell Crank to Floor, SD3, SC1, SC2 . .	8	1	----	2208 189	2208 189
21-30-317	SPACER, Control Bell Crank to SD3, SC1, SC2 . .	8	2	----	6022 279	6022 279
21-30-413	BOOT, Control, Upper, SD3, SC1, SC2	8	1	----	2260 856	2260 856
	Lower, SD3, SC1, SC2	8	1	----	2074 506	2074 506
	SP2, SD2, w/413 cu. in. Engine	8	1	----	E2419 709	
21-30-414	RING, Upper Boot, SD3, SC1, SC2	8	1	----	2073 554	2073 554
	Lower, SP2, SD2, w/413 cu. in. Engine	8	1	----	E2419 710	
	Upper, SP2, SD2, w/413 cu. in. Engine	8	1	----	E2419 711	
21-30-415	RING, Shaft Lock, SD3, SC1, SC2	8	1	----	1946 343	1946 343
21-30-416	SUPPORT, Gearshift Control Lever, SD3, SC1, SC2	8	1	----	2208 188	2208 188
21-30-417	PIN, Control Lever, SD3, SC1, SC2	8	1	----	2073 553	2073 553
21-30-418	ROD, Control, 1st and Reverse, SD3, SC1, SC2 . .	8	1	----	2203 493	2203 493
	Rear, 2nd and 3rd, SD3, SC1, SC2	8	1	----	2203 488	2203 488
	Front, 2nd and 3rd, SD3, SC1, SC2	8	1	----	2203 494	2203 494
	1st and Reverse, SP2, SD2, w/413 cu. in. Engine.	8	1	----	E2404 881	
	2nd and 3rd, SP2, SD2, w/413 cu. in. Engine . . .	8	1	----	E2404 880	
21-30-420	LEVER, Control Rod, SD3, SC1, SC2	8	2	----	2203 475	2203 475
21-30-421	SHAFT, Gearshift Control Lever, SD3, SC1, SC2 .	8	1	----	2073 555	2073 555
21-30-422	DIVIDER, Lever Rod, SD3, SC1, SC2	8	1	----	2073 557	2073 557
21-30-423	BUSHING, Lever Hub, SD3, SC1, SC2	8	2	----	2073 558	2073 558
	Lever Shaft, SD3, SC1, SC2	8	2	----	2073 556	2073 556
21-30-425	SCREW, Lever Pivot, Rear, SD3, SC1, SC2	8	1	----	2074 526	2074 526
	Front, SD3, SC1, SC2	8	1	----	2074 525	2074 525
21-30-426	WASHER, Lever Shaft, Plain, SD3, SC1, SC2 . . .	8	2	----	2073 574	2073 574
	WASHER, Control Rod Spring, SD3, SC1, SC2 . .	8	★	----	6025 070	6025 070
	WASHER, Control Rod, Plain, SD3, SC1, SC2 . .	8	★	----	631 217	631 217
	WASHER, Rear Swivel Spring, SD3, SC1, SC2 . .	8	1	----	391 888	391 888
21-30-427	SPRING, Lever, SD3, SC1, SC2	8	1	----	2073 565	2073 565
	SP2, SD2, w/413 cu. in. Engine	8	1	----	E2404 885	
21-30-428	SWIVEL, Rod, 1st and Reverse, SD3, SC1, SC2 . .	8	1	----	2074 521	2074 521
	2nd and 3rd, SD3, SC1, SC2	8	1	----	2074 535	2074 535
	SP2, SD2, w/413 cu. in. Engine	8	2	----	E2404 859	

★ Indicates use as required.

Numerals in parentheses () refer to notes.

Printed in U.S.A.

E Indicates parts not listed in any previous parts book.

Prices and specifications subject to change without notice.

* Indicates change or addition.

Page 21-15

March 8, 1963 Supersedes May 1, 1962.

CODE	PART NAME AND DESCRIPTION	C Y L	PER CAR	VALIANT LANCER	PLYMOUTH DODGE	CHRYSLER IMPERIAL
------	---------------------------	-------------	------------	-------------------	-------------------	----------------------

STANDARD TRANSMISSION

21-30-0 TRANSMISSION GEARSHIFT LEVER AND RODS - Cont'd

21-30-429	CLAMP, Rod Swivel, SD3, SC1, SC2	8	1	----	2074 543	2074 543
21-30-430	GROMMET, Gearshift Control Bell Crank Bushing, SD3, SC1, SC2	8	1	----	2074 539	2074 539
21-30-431	BUSHING, Bell Crank, SD3, SC1, SC2	8	1	----	2074 553	2074 553
21-30-432	SPRING, Control Bell Crank to Trans. Extension Bracket Stud, SD3, SC1, SC2	8	1	----	2074 534	2074 534
21-30-433	CLIP, Rod, SD3, SC1, SC2	8	★	----	1137 669	1137 669
21-30-434	BRACKET, Gearshift Control Shaft, w/LEVERS, SP2, SD2, w/413 cu. in. Engine	8	1	----	E2404 882	
21-30-435	STUD, Bell Crank to Trans. Extension Bracket, SD3, SC1, SC2	8	1	----	2074 508	2074 508
21-30-436	LINK or BELL CRANK, Control, w/BUSHING, SD3, SC1, SC2	8	1	----	2203 495	2203 495
21-30-437	WASHER, Bell Crank Bushing, SD3, SC1, SC2 . .	8	1	----	2074 554	2074 554
21-30-438	PIN, Bell Crank to Floor Pan Bracket, SD3, SC1, SC2	8	1	----	2074 547	2074 547

21-34-0 TRANSMISSION GEARSHIFT RAIL

21-34-42	PIN, Interlock, SC1, SC2	8	1	1949 356	1949 356	1949 356
	SP2, SD2, w/413 cu. in. Engine		1	----	*1921 522	
21-34-45	SLLEEVE, Interlock, SC1, SC2		1	1949 355	1949 355	1949 355
	Thin, SP2, SD2, w/413 cu. in. Engine	8	★	----	*1921 518	
	Medium, SP2, SD2, w/413 cu. in. Engine	8	★	----	*1921 519	
	Thick, SP2, SD2, w/413 cu. in. Engine	8	★	----	*1921 520	
	Extra Thick, SP2, SD2, w/413 cu. in. Engine	8	★	----	*1921 521	
21-34-47	SPRING, Interlock Ball		1	2205 131	2205 131 (1)	
	SP1, SP2, SD1, SD2, Heavy Duty Trans., SD3, SC1, SC2		1	----	1853 745 (2)	1853 745
	SP2, SD2, w/413 cu. in. Engine	8	1	----	*1921 523	

21-39-0 TRANSMISSION GEARSHIFT FORK

21-39-3	FORK, Low and Reverse		1	1949 351	1949 351 (1)	
	Second and Direct		1	2125 059	2125 059 (1)	
	Low and Reverse, SP1, SP2, SD1, SD2, Heavy Duty Trans., SD3, SC1, SC2		1	----	2124 463 (2)	2124 463
	Second and Direct, SP1, SP2, SD1, SD2, Heavy Duty Trans., SD3, SC1, SC2		1	----	2124 462 (2)	2124 462
	Low and Reverse, SP2, SD2, w/413 cu. in. Engine	8	1	----	*1921 517	
	Second and Direct, SP2, SD2, w/413 cu. in. Engine	8	1	----	*1921 516	

21-42-0 TRANSMISSION REMOTE CONTROL GEARSHIFT

21-42-11	LEVER, Low and Reverse		1	1949 347	1949 347 (1)	
	Second and Direct		1	1949 352	1949 352 (1)	

NOTE 1: SP1-L-M-H UP TO Engine No. 86488. SD2-L-M-H UP TO Engine No. 86488.
SP1, SD1

NOTE 2: SP2-L-M-H, SD2-L-M-H, Heavy Duty Trans., Special Equipment on UP TO Engine No. 86488,
Heavy Duty Trans. is Standard Equipment on AFTER Engine No. 86488, also Standard Equipment on
SP2 Sport Fury, SD2 Polara.

★ Indicates use as required. Numerals in parentheses () refer to notes. Printed in U.S.A.
 □ Indicates parts not listed in any previous parts book. Prices and specifications subject to change without notice.
 March 8, 1963 Supersedes May 1, 1962. Page 21-16 * Indicates change or addition.

CODE	PART NAME AND DESCRIPTION	C Y L.	PER CAR	VALIANT LANCER	PLYMOUTH DODGE	CHRYSLER IMPERIAL
------	---------------------------	--------------	------------	-------------------	-------------------	----------------------

STANDARD TRANSMISSION

21-42-O TRANSMISSION REMOTE CONTROL GEARSHIFT - Cont'd

21-42-11	LEVER - Cont'd Low and Reverse, SP1, SP2, SD1, SD2, Heavy Duty Trans., SD3, SC1, SC2		1	----	2124 523 (2)	2124 523
	Second and Direct, SP1, SP2, SD1, SD2, Heavy Duty Trans., SD3, SC1, SC2		1	----	2124 494 (2)	2124 494
	Low and Reverse, SP2, SD2, w/413 cu.in.Engine	8	1	----	*1923 508	
	Second and Direct, SP2, SD2, w/413 cu.in.Engine	8	1	----	*1921 508	
21-42-16	PIN, SC1, SC2		2	6022 161	6022 161	6022 161
21-42-23	LEVER, Operating, Low and Reverse	6	1	2204 903		
	Second and Direct	6	1	2204 904		
	Low and Reverse, SP1, SP2, SD1, SD2		1	----	2204 907 (1)	
	Low and Reverse, Heavy Duty Trans., SP1, SP2, SD1, SD2		1	----	2204 932 (2)	
	Second and Direct, SP1, SP2, SD1, SD2		1	----	2208 160	
	Low and Reverse, SD3, SC1, SC2	8	1	----	2204 398	2204 398
	Second and Direct, SD3, SC1, SC2	8	1	----	2204 397	2204 397
	Low and Reverse, SP2, SD2, w/413 cu.in.Engine	8	1	----	E2400 699	
	Second and Direct, SP2, SD2, w/413 cu.in.Engine	8	1	----	E2400 698	
21-42-31	SEAL, Gearshift Lever, Shaft, SC1, SC2		2	*1949 350	*1949 350	*1949 350
	SP2, SD2, w/413 cu. in. Engine	8	2	----	*1921 513	
21-42-42	BUSHING, Operating Lever Grommet		2	1676 200	1676 200	
21-42-43	GROMMET, Operating Lever		2	1941 699	1941 699	

21-84-O TRANSMISSION SPEEDOMETER CABLE SHAFT AND HOUSING

21-84-1	HOUSING, w/SHAFT, 58" lgh.	6	1	2290 459		
	78" lgh.		1	----	2290 461	
	58" lgh., SD3, SC1, except Sub., SC2	8	1	----	2290 459	2290 459
	59 1/32" lgh., SD3, SC1, Sub. (also specify 1 of 1370460)	8	1	----	1819 948	1819 948
	59 1/32" lgh., SC1 except Sub., SC2, w/3.23 Ratio and 15 x 7.60 Tires (also specify 1 of 1370460) w/ADAPTER	8	1	----	----	1819 948
21-84-4	SHAFT, 58" lgh.	6	1	2290 469		
	58 43/64" lgh.	6	1	E2426 164		
	78" lgh.		1	----	2290 471	
	62 43/64" lgh., SD3, SC1, except Sub., SC2	8	1	----	2076 656	2076 656
	65" lgh., SD3, SC1, Sub.	8	1	----	2209 229	2209 229
	65" lgh., SC1 except Sub., SC2, w/3.23 Ratio and 15 x 7.60 Tires, w/ADAPTER	8	1	----	----	2209 229
	58" lgh., SD3, SC1, except Sub., SC2	8	1	----	2290 469	2290 469
	59 1/32" lgh., SD3, SC1, Sub.	8	1	----	1163 782	1163 782
21-84-7	CLAMP, Cable		1	2204 942	2204 942	2204 942
21-84-28	SEAL, Speedometer Cable Adapter		1	1942 259	1942 259	1942 259

NOTE 1: SP2-L-M-H UP TO Engine No. 86488.
SP1, SD1

SD2-L-M-H UP TO Engine No. 86488.

NOTE 2: SP2-L-M-H, SD2-L-M-H, Heavy Duty Trans., Special Equipment on UP TO Engine No. 86488.
Heavy Duty Trans., is Standard Equipment on AFTER Engine No. 86488, also Standard Equipment on
SP2 Sport Fury, SD2 Polara.

★ Indicates use as required.

Numerals in parentheses () refer to notes.

Printed in U.S.A.

E Indicates parts not listed in any previous parts book.

Prices and specifications subject to change without notice.

* Indicates change or addition.

Page 21-17

March 8, 1963 Supersedes May 1, 1962.

CODE	PART NAME AND DESCRIPTION	CYL	PER CAR	VALIANT LANCER	PLYMOUTH DODGE	CHRYSLER IMPERIAL
------	---------------------------	-----	---------	----------------	----------------	-------------------

STANDARD TRANSMISSION

21-85-O TRANSMISSION SPEEDOMETER PINION

21-85-4	GEAR, Speedometer Drive, SP2, SD2, w/413 cu. in. Engine	8	1	----	B2400 437	
21-85-5	PINION, SP2, SD2, w/413 cu. in. Engine, w/3.23 Ratio	8	1	----	*2204 355	
	SP2, SD2, w/413 cu. in. Engine, w/3.91 Ratio	8	1	----	*2204 357	

STANDARD TRANSMISSION SV1, SL1, SP1, SP2, SD1, SD2 - A903

	3.23 to 1 Ratio		3.31 to 1 Ratio		3.55 to 1 Ratio		3.91 to 1 Ratio	
Tire Size	Pinion Teeth		Pinion Teeth		Pinion Teeth		Pinion Teeth	
6.50 x 13	2204 358	19 DB	----	----	2204 359	20 G	2204 359	20 G
6.70 x 13	2204 356	17 O	----	----	2204 358	19 DB	2204 360	21 GR
6.50 x 14	2204 357	18 DP	2204 358	19 DB	2204 359	20 G	2204 359	20 G
7.00 x 14	2204 357	18 DP	2204 357	18 DP	2204 358	19 DB	2204 360	21 GR
7.50 x 14	2204 356	17 O	2204 356	17 O	2204 358	19 DB	2204 360	21 GR
6.70 x 15	2204 356	17 O	2204 356	17 O	2204 357	18 DP	2204 359	20 G

COLORS OF PINIONS

DB-DARK BLUE O-ORANGE DP-DARK PURPLE G-GREEN GR-GRAY

HEAVY DUTY STANDARD TRANSMISSION SP1, SP2, SD1, SD2, SD3, SC1, SC2 - A745

	3.23 to 1 Ratio		3.55 to 1 Ratio		3.91 to 1 Ratio	
Tire Size	Pinion Teeth		Pinion Teeth		Pinion Teeth	
6.50 x 14	1949 402	18 N	1949 404	20 B	1949 406	22 Y
7.00 x 14	1949 402	18 N	1949 403	19 R	1949 405	21 LB
7.50 x 14	1949 401	17 LP	1949 403	19 R	1949 405	21 LB
8.00 x 14	1949 401	17 LP	----	----	----	----
8.50 x 14	1949 401	17 LP	----	----	----	----
6.70 x 15	1949 401	17 LP	1949 402	18 N	1949 404	20 B
7.60 x 15	1949 401	17 LP	----	----	----	----

COLORS OF PINIONS

N-NATURAL B-BLACK Y-YELLOW LP-LIGHT PURPLE R-RED LB-LIGHT BLUE

CODE	PART NAME AND DESCRIPTION	CYL	PER CAR	VALIANT LANCER	PLYMOUTH DODGE	CHRYSLER IMPERIAL
21-85-9	ADAPTER, Drive Pinion, w/3.91 to 1 Ratio and 6.50 x 13" tires	6	1	2291 133		
	w/3.91 to 1 Ratio and 6.50 x 14" Tires	6	1	----	2291 141	
	SD3, Sub. use w/7.10 x 15, 7.60 x 15, 8.50 x 14 Tires	8	1	----	2291 140	2291 140
	w/3.91 Ratio, SP2, SD2, w/413 cu.in. Engine	8	1	----	*2291 141	
	w/3.23 Ratio, SP2, SD2, w/413 cu.in. Engine	8	1	----	*2291 140	
21-85-29	SNAP RING, Speedometer Drive Gear, SP2, SD2, w/413 cu. in. Engine	8	2	----	*6023 560	
21-85-56	SEAL, Pinion, SC1, SC2	1		2124 328	2124 328	2124 328
21-85-61	CLIP, Pinion, SC1, SC2	1		1942 174	1942 174	1942 174

* Indicates use as required. Numerals in parentheses () refer to notes. Printed in U.S.A.
 † Indicates parts not listed in any previous parts book. Prices and specifications subject to change without notice.
 March 8, 1963 Supersedes May 1, 1962. Page 21-18 * Indicates change or addition.

CODE	PART NAME AND DESCRIPTION	CYL.	PER CAR	VALIANT LANCER	PLYMOUTH DODGE	CHRYSLER IMPERIAL
------	---------------------------	------	---------	----------------	----------------	-------------------

AUTOMATIC 3 - SPEED TRANSMISSION

21-01-O TRANSMISSION SETS OR PACKAGES

21-01-3	SEAL and GASKET PACKAGE, UP TO Trans. No. 523930	6	1	2275 422	2275 422	
	AFTER Trans. No. 523930	6	1	2298 952	2298 952	
	SP2, SD2, UP TO Trans. No. 117651	8	1	----	2275 499	
	SP2, SD2, AFTER Trans. No. 117651	8	1	----	2298 953	
	SD3	8	1	----	2275 499	2275 499

21-02-O TRANSMISSION ASSEMBLY

21-02-1	TRANSMISSION, UP TO Trans. No. 523930	6	1	2204 917	2204 841	
	AFTER Trans. No. 523930	6	1	2400 154	2400 155	
	w/225 cu.in. Engine, UP TO Trans. No. 523930	6	1	2204 916		
	w/225 cu.in. Engine, AFTER Trans. No. 523930	6	1	2400 156		
	SP2, SD2, w/318 cu. in. Engine	8	1	----	*2400 157	
	SP2, SD2, w/361 and 383 cu. in. Engine	8	1	----	*2400 158	
	SP2, SD2, w/413 cu. in. Engine	8	1	----	⊠2408 007	
	SD3	8	1	----	1942 275	1942 275
	SC1 Police Cars w/383 cu. in. Engine, SC2 w/413 cu. in. Engine	8	1	----	----	2205 190
21-02-8	BAFFLE, Vent	8	1	----	2400 479	2400 479

21-03-O TRANSMISSION CASE

21-03-1	CASE, UP TO Trans. No. 523930	6	1	2125 237	2125 237	
	AFTER Trans. No. 523930	6	1	2400 099	2400 099	
	SP2, SD2, w/318 cu. in. Engine	8	1	----	*2400 130	
	SP2, SD2, w/361, 383 and 413 cu.in.Engine,SD3.	8	1	----	*2400 131	2400 131
21-03-6	COVER, Case, Torque Converter	6	1	1949 767	1949 767	
	SP2, SD2, w/318 cu. in. Engine	8	1	----	*2125 057	
	SP2, SD2, w/361, 383 and 413 cu. in. Engine	8	1	----	*1942 248	
	SD3	8	1	----	1942 248	1942 248
21-03-7	COVER, Torque Converter Drain, SP2, SD2, w/318 cu. in. Engine	8	1	----	*2204 728	
21-03-23	SCREW, Cylinder Block to Transmission Case	6	1	2124 411	2124 411	
	Case to Cylinder Block	6	2	2124 410	2124 410	
	Cylinder Block to Transmission Case	8	2	★ 6023 187	6023 187	6023 187
	Bracket to Cylinder Block	8	2	----	6012 042	6012 042
	Bracket to Case, SP2, SD2	6	2	6023 143	6023 143	
	Bracket to Case	8	2	----	6023 143	
	Bracket to Case	6	2	6022 258	6022 258	
	Bracket to Cylinder Block, SP2, SD2	8	2	----	6022 258	
21-03-28	BRACKET, Case to Cylinder Block, Left Side	6	1	1949 701	1949 701	
	Left Side, SP2, SD2	8	1	----	2204 707	
	Right Side, SP2, SD2	8	1	----	2204 702	

21-04-O TRANSMISSION CASE EXTENSION

21-04-1	EXTENSION, UP TO Trans.,No. 523930	6	1	2204 395	1942 530	
	AFTER Trans.,No. 523930	6	1	2400 134	2400 136	
	SP2, SD2	8	1	----	*2400 065	
	SD3	8	1	----	2204 676	2204 676
21-04-2	GASKET, UP TO Trans. No. 523930	6	1	2125 239	2125 239	
	AFTER Trans. No. 523930	6	1	2205 322	2205 322	
	SP2, SD2, SC1, SC2, SC3, SY1, UP TO Trans. No. 117651	8	1	----	2124 860	2124 860

★ Indicates use as required. Numerals in parentheses () refer to notes. Printed in U.S.A.
 ⊠ Indicates parts not listed in any previous parts book. Prices and specifications subject to change without notice.
 * Indicates change or addition. Page 21-19 March 8, 1963 Supersedes May 1, 1962.

CODE	PART NAME AND DESCRIPTION	CYL	PER CAR	VALIANT LANCER	PLYMOUTH DODGE	CHRYSLER IMPERIAL
------	---------------------------	-----	---------	----------------	----------------	-------------------

AUTOMATIC 3 - SPEED TRANSMISSION

21-04-O TRANSMISSION CASE EXTENSION - Cont'd

21-04-2	GASKET - Cont'd SP2, SD2, SC1, SC2, SC3, SY1, AFTER Trans., No. 117651, SD3	8	1	----	2400 064	2400 064
21-04-6	BOLT, Extension, w/Nylon PELLET	8	1	----	----	E6023 515
21-04-11	BUSHING BEARING	6 8	1 1	2124 607 ----	2124 607 1672 194	1672 194
21-04-12	SNAP RING, Bearing	8	1	----	1736 432	1736 432

21-05-O TRANSMISSION OUTPUT SHAFT

21-05-1	SHAFT, w/PLUG	6 8	1 1	1942 413 ----	2240 627 2124 840	2124 840
21-05-12	OIL SEAL, Output Shaft	6 8	1 1	1942 401 ----	1942 401 2205 080	2205 080
21-05-19	SNAP RING, Output Shaft	6 8	1 1	6022 859 ----	6022 859 6022 816	6022 816
21-05-35	WASHER, Output Shaft Thrust, .052" thk., Natural, Fiber068" thk., Red, Fiber083" thk., Black, Fiber	6 6 6 8	1 1 1 1	1942 454 1942 455 1942 456 ----	1942 454 1942 455 1942 456 2125 104	2125 104

21-30-O TRANSMISSION GEARSHIFT BUTTON AND CABLE

21-30-28	SOCKET, Selector Bulb, w/CABLE, SP1, SP2, SD1, SD2 SD3, SC1, SC2, SC3 SY1	8 8 8	1 1 1	----	2226 796 2257 275 ----	1885 977 2197 939
21-30-320	HOUSING, w/SLIDES SP1, SP2, SD1, SD2 SD3	6 8	1 1	2266 413 ----	2265 186 1946 547	1946 547
21-30-325	ACTUATOR, Back-Up Light Switch, SD3 RIVET	8 8	1 1	----	1676 629 131 284	1676 629 131 284
21-30-329	BRACKET, Reverse Slide Light Switch, SP1, SP2, SD1, SD2		1	2123 249	2123 249	
21-30-336	BUTTON, Neutral, SV1 Drive, SV1 First, SV1 Second, SV1 Reverse, SV1	6 6 6 6 6	1 1 1 1 1	2401 276 2401 277 2401 279 2401 278 2401 275		
	BUTTON, Neutral, SL1 Drive, SL1 First, SL1 Second, SL1 Reverse, SL1	6 6 6 6 6	1 1 1 1 1	2265 178 2265 179 2265 181 2265 180 2265 177		
	BUTTON, w/COVER, Neutral, SP1, SP2 Drive, SP1, SP2 First, SP1, SP2 Second, SP1, SP2 Reverse, SP1, SP2		1 1 1 1 1	----	2260 858 2260 859 2260 861 2260 860 2260 857	

★ Indicates use as required. Numerals in parentheses () refer to notes. Printed in U.S.A.
 □ Indicates parts not listed in any previous parts book. Prices and specifications subject to change without notice.
 March 8, 1963 Supersedes May 1, 1962. Page 21-20 * Indicates change or addition.

CODE	PART NAME AND DESCRIPTION	CYL.	PER CAR	VALIANT LANCER	PLYMOUTH DODGE	CHRYSLER IMPERIAL
------	---------------------------	------	---------	----------------	----------------	-------------------

AUTOMATIC 3 - SPEED TRANSMISSION

21-30-0 TRANSMISSION GEARSHIFT BUTTON AND CABLE - Cont'd

21-30-336	BUTTON, w/COVER, Neutral, SD1, SD2		1	----	2208 183	
	Drive, SD1, SD2		1	----	2208 184	
	First, SD1, SD2		1	----	2208 186	
	Second, SD1, SD2		1	----	2208 185	
	Reverse, SD1, SD2		1	----	2208 182	
	BUTTON, w/COVER, Neutral, SD3	8	1	----	2200 884	
	Drive, SD3	8	1	----	2200 885	
	First, SD3	8	1	----	2200 887	
	Second, SD3	8	1	----	2200 886	
	Reverse, SD3	8	1	----	2200 883	
	BUTTON, w/COVER, Neutral, SC1, SC2, SC3	8	1	----	----	1946 505
	Drive, SC1, SC2, SC3	8	1	----	----	1946 508
	First, SC1, SC2, SC3	8	1	----	----	1946 514
	Second, SC1, SC2, SC3	8	1	----	----	1946 511
	Reverse, SC1, SC2, SC3	8	1	----	----	1946 502
	BUTTON, w/COVER, Neutral, SY1	8	1	----	----	2200 862
	Drive, SY1	8	1	----	----	2200 864
	First, SY1	8	1	----	----	2200 868
	Second, SY1	8	1	----	----	2200 866
	Reverse, SY1	8	1	----	----	2200 860
21-30-340	BUMPER, Slide		4	*1731 143	*1731 143	*1731 143
21-30-345	SPRING, Slide		5	1639 970	1639 970	1639 970
21-30-365	CABLE, Control, 42" lgh.	6	1	2266 403		
	44" lgh., SP1, SP2		1	----	2266 404	
	42" lgh., SD1, SD2		1	----	2266 403	
	48" lgh., w/361 cu. in. Engine	8	1	----	*2266 405	
	48" lgh., SD3	8	1	----	*2266 405	*2266 405
21-30-370	BRACKET, Cable, on Housing		1	1673 921	1673 921	1673 921
21-30-375	FLANGE or WHEEL, Control Cable Adjusting		1	1856 492	1856 492	1856 492
21-30-390	SEAL, Cable, on Trans.		1	1316 813	1316 813	1316 813
21-30-392	ADAPTER, Control Cable, w/PIN		1	1941 636	1941 636	1941 636
21-30-394	SPRING, Control Cable Adapter		1	1673 184	1673 184	1673 184

21-84-0 TRANSMISSION SPEEDOMETER CABLE, INCLUDES SHAFT AND HOUSING

21-84-1	HOUSING, w/SHAFT, 58" lgh.		1	2290 459		
	78" lgh., SP1, SP2, SD1, SD2		1	----	2290 461	
	70" lgh., SD3	8	1	----	2257 840	2257 840
	w/Auto. Pilot, 31 3/8" lgh.	8	1	----	----	1972 351
21-84-4	SHAFT, 58" lgh.	6	1	2290 469		
	78" lgh., SP1, SP2, SD1, SD2		1	----	2290 471	
	64 43/64" lgh., SD3	8	1	----	2209 229	2209 229
	28 5/32" lgh., w/Auto. Pilot	8	1	----	----	1887 657
	w/Auto. Pilot, 31 3/8" lgh.	8	1	----	----	1972 352
21-84-7	CLAMP, Cable		1	2204 942	2204 942	2204 942
21-84-28	SEAL, Cable Adapter		1	1942 259	1942 259	1942 259

★ Indicates use as required.

Numerals in parentheses () refer to notes.

Printed in U.S.A.

☐ Indicates parts not listed in any previous parts book.

Prices and specifications subject to change without notice.

* Indicates change or addition.

AUTOMATIC 3 - SPEED TRANSMISSION

21-85-O TRANSMISSION SPEEDOMETER PINION

21-85-5 PINION

6 CYLINDER CARS ONLY

Tire Size	2.76 to 1 Ratio		2.93 to 1 Ratio		3.23 to 1 Ratio		3.31 to 1 Ratio		3.55 to 1 Ratio		3.91 to 1 Ratio	
	Pinion	Teeth	Pinion	Teeth	Pinion	Teeth	Pinion	Teeth	Pinion	Teeth	Pinion	Teeth
6.50 x 13	-----	----	2204	356 17 O	2204	358 19 DB	-----	----	2204	359 20 G	2204	359 20 G
6.70 x 13	-----	----	2204	355 16 B	2204	356 17 O	-----	----	2204	358 19 DB	2204	360 21 GR
6.50 x 14	2204	355 16 B	2204	355 16 B	2204	357 18 DP	2204	358 19 DB	2204	359 20 G	2204	359 20 G
7.00 x 14	2204	355 16 B	2204	355 16 B	2204	357 18 DP	2204	357 18 DP	2204	358 19 DB	2204	360 21 GR
7.50 x 14	2204	355 16 B	2204	355 16 B	2204	356 17 O	2204	356 17 O	2204	358 19 DB	2204	360 21 GR
6.70 x 15	2204	355 16 B	2204	355 16 B	2204	356 17 O	2204	356 17 O	2204	357 18 DP	2204	359 20 G

8 CYLINDER CARS ONLY

Tire Size	2.76 to 1 Ratio		2.93 to 1 Ratio		3.23 to 1 Ratio		w/Auto. Pilot 2.93 to 1 Ratio		w/Auto. Pilot 3.23 to 1 Ratio		3.91 to 1 Ratio	
	Pinion	Teeth	Pinion	Teeth	Pinion	Teeth	Pinion	Teeth	Pinion	Teeth	Pinion	Teeth
7.00 x 14	2204	356 17 O	2204	357 18 DP	2204	359 20 C	-----	----	-----	----	-----	----
7.50 x 14	2204	356 17 O	2204	357 18 DP	2204	358 19 DB	-----	----	-----	----	*2204	360 21 GR
8.00 x 14	2204	355 16 B	2204	356 17 O	2204	358 19 DB	2204	358 19 DB	2204	360 21 GR	-----	----
8.50 x 14	2204	355 16 B	2204	356 17 O	2204	358 19 DB	2204	358 19 DB	2204	360 21 GR	-----	----
9.00 x 14	-----	----	2204	355 16 B	2204	357 18 DP	2204	358 19 DB	2204	359 20 G	-----	----
6.70 x 15	2204	355 16 B	2204	356 17 O	2204	358 19 DB	-----	----	-----	----	-----	----
7.60 x 15	-----	----	-----	----	2204	357 18 DP	-----	----	2204	359 20 G	-----	----
8.20 x 15	-----	----	2204	355 16 B	-----	----	2204	357 18 DP	-----	----	-----	----

COLOR OF PINIONS

B-BLUE DP-DARK PURPLE G-GREEN O-ORANGE DB-DARK BLUE GR-GRAY

CODE	PART NAME AND DESCRIPTION	CYL.	PER CAR	VALIANT LANCER	PLYMOUTH DODGE	CHRYSLER IMPERIAL
21-85-9	ADAPTER, Drive Pinion, w/3.91 to 1 ratio and 6.50 x 14" Tires	6	1	-----	2291 141	
	SP2, SD2, w/413 cu. in. Engine, w/7.50 x 14 Tires and 3.91 Ratio	8	1	-----	*2291 141	
21-85-56	SEAL, Pinion		1	2124 328	2124 328	2124 328
21-85-61	CLIP, Pinion		1	1942 174	1942 174	1942 174

21-113-O TRANSMISSION NEUTRAL STARTER SWITCH

21-113-24	SWTCH PACKAGE, w/WASHER and "O" RING, on Trans.		1	1704 283	1704 283	1704 283
21-113-28	"O" RING, Mounting		1	1316 849	1316 849	1316 849
21-113-29	WASHER, Mounting		1	1704 482	1704 482	1704 482

21-117-O TRANSMISSION OIL PUMP STRAINER

NOTE: See Code 9-46-27 for Tubes.

21-117-1	STRAINER		1	1949 964	1949 964	1949 964
	FILTER, Oil, Attached to Oil Pan		1	2400 124	2400 124	2400 124

★ Indicates use as required. Numerals in parentheses () refer to notes. Printed in U.S.A.
 □ Indicates parts not listed in any previous parts book. Prices and specifications subject to change without notice.
 March 8, 1963 Supersedes May 1, 1962. Page 21-22 * Indicates change or addition.

CODE	PART NAME AND DESCRIPTION	CYL	PER CAR	VALIANT LANCER	PLYMOUTH DODGE	CHRYSLER IMPERIAL
------	---------------------------	-----	---------	----------------	----------------	-------------------

AUTOMATIC 3 - SPEED TRANSMISSION

21-117-O TRANSMISSION OIL PUMP STRAINER - Cont'd						
21-117-2	CLAMP, Oil Filter		1	2268 908	2268 908	2268 908
21-117-3	BRACKET, Oil Filter	6	1	2400 126	2400 126	2400 078
		8	1	----	2400 078	
21-118-O TRANSMISSION OIL PUMP						
21-118-6	ROTOR PACKAGE, Front Pump	6	1	2240 302	2240 302	2275 497 2275 496
		6	1	2196 795	2196 795	
		8	1	----	2275 497	
		8	1	----	2275 496	
21-118-7	ROTOR, Rear Pump, Outer		1	1672 296	1672 296	1672 296
21-118-40	HOUSING, Front Pump, w/BUSHING	6	1	2204 712	2204 712	2400 492 1942 105
		6	1	1942 463	1942 463	
		8	1	----	2400 492	
		8	1	----	1942 105	
21-118-42	OIL SEAL, Front Pump Housing, 2 1/4" O.D.	6	1	2124 705	2124 705	1942 020
		8	1	----	1942 020	
21-118-45	OIL SEAL, Front Pump Housing, 8 17/64" O.D.	6	1	2204 709	2204 709	1942 021
		8	1	----	1942 021	
21-118-47	BUSHING, Front Pump Housing	6	1	2204 953	2204 953	2205 041
		8	1	----	2205 041	
21-118-53	COVER, Rear Pump Housing		1	1942 107	1942 107	1942 107
21-118-54	GASKET, Front Pump Housing	8	1	----	2124 846	2124 846
21-118-55	SCREW, Front Pump Housing, w/WASHER		★	2124 600	2124 600	2124 600
21-118-57	SHIELD, Front Pump Housing Vent	8	1	----	2204 993	2204 993
21-119-O TRANSMISSION OIL PAN						
21-119-3	PAN, Oil	6	1	2205 314	2205 314	2124 865 6023 355
		8	1	----	2124 865	
	SCREW		★	6023 355	6023 355	6023 355
21-119-5	GASKET, Oil Pan	6	1	2205 299	2205 299	2124 867
		8	1	----	2124 867	
21-119-11	PLUG, Oil Pan Drain		1	863 986	863 986	863 986
21-119-12	GASKET, Drain Plug		1	863 987	863 987	863 987
21-119-15	TUBE, Oil Filler	6	1	2204 641	2204 641	2204 929
		8	1	----	*2204 788	
		8	1	----	*2204 716	
		8	1	----	2204 929	
		8	1	----	⊠2400 652	
21-119-19	INDICATOR, Oil Level	6	1	2204 643	2204 643	2204 799
		8	1	----	2204 799	
		8	1	----	⊠2400 655	
21-119-25	SEAL, Oil Filler Tube		1	1316 815	1316 815	1316 815

★ Indicates use as required. Numerals in parentheses () refer to notes. Printed in U.S.A.
 ⊠ Indicates parts not listed in any previous parts book. Prices and specifications subject to change without notice.
 * Indicates change or addition. Page 21-23 March 8, 1963 Supersedes May 1, 1962.

CODE	PART NAME AND DESCRIPTION	CYL.	PER CAR	VALIANT LANCER	PLYMOUTH DODGE	CHRYSLER IMPERIAL
------	---------------------------	------	---------	----------------	----------------	-------------------

AUTOMATIC 3 - SPEED TRANSMISSION

21-129-O TRANSMISSION INPUT SHAFT AND TORQUE CONVERTER REACTION SHAFT

21-129-5	SHAFT, Input, w/Rear Clutch Piston RETAINER . . .	6	1	2125 201	2125 201	
	SHAFT, Input	6	1	2125 200	2125 200	
	SHAFT, Input, w/BUSHING.	8	1	----	*2124 831	*2124 831
21-129-6	BUSHING, Input Shaft	8	1	----	2205 242	2205 242
21-129-7	RING, Input Shaft Seal	6	2	1941 831	1941 831	
		8	2	----	1942 041	1942 041
	SNAP RING, Input Shaft	6	1	6022 859	6022 859	
21-129-10	SHAFT, Reaction, w/SUPPORT, 27T., 6 5/8" lgh.	6	1	1942 419	1942 419	
		8	1	----	2124 810	2124 810
21-129-13	RING, Reaction Shaft Support Seal	6	2	1942 389	1942 389	
		8	2	----	2124 813	2124 813
21-129-23	BUSHING, Reaction Shaft	6	1	2205 302	2205 302	
		8	1	----	2205 240	2205 240
21-129-24	GASKET, Reaction Shaft Support	6	1	1942 390	1942 390	

21-133-O TRANSMISSION CLUTCH

21-133-5	RETAINER, Front Clutch Piston, w/DISC, PISTON and SPRING	6	1	2205 326		
	Front Clutch, w/225 cu. in. Engine, Heavy Duty and Taxi	6	1	2204 979		
	Front Clutch	6	1	----	2204 979	
	Front Clutch	8	1	----	2124 814	2124 814
	Front, SP2, SD2, w/413 cu. in. Engine	8	1	----	22400 724	
21-133-7	RETAINER, Front Clutch Piston, w/BUSHING	6	1	2205 325	2204 980	
	Front Clutch, w/225 cu. in. Engine, Heavy Duty and Taxi	6	1	2204 980		
	Front Clutch Piston, w/BUSHING	8	1	----	2124 815	2124 815
	Rear Clutch Piston, 28T., 62T.	8	1	----	*2124 833	*2124 833
	Rear Clutch, SD2	8	1	----	2204 976	2124 836
	Rear Clutch, SP2, SD2, w/361 cu. in. Engine, SD3	8	1	----	2124 836	
21-133-10	BUSHING, Front Clutch Retainer	6	1	2205 303	2205 303	
		8	1	----	2205 241	2205 241
21-133-15	PISTON, Front Clutch	6	1	1942 395	1942 395	
		6	1	2125 198	2125 198	
		8	1	----	2124 819	2124 819
		8	1	----	2204 645	2204 645
21-133-17	SEAL, Front Clutch Piston, Inner	6	1	1942 396	1942 396	
	Outer	6	1	1942 397	1942 397	
	Rear Clutch Piston, Inner	6	1	2125 187	2125 187	
	Outer	6	1	1942 397	1942 397	
	Front Clutch Piston, Inner	8	1	----	2124 820	2124 820
	Outer	8	1	----	2124 821	2124 821
	Rear Clutch Piston, Inner	8	1	----	1942 054	1942 054
	Outer	8	1	----	2124 835	2124 835
21-133-20	SPRING, Front Clutch Piston Return	6	1	2205 233	1942 467	
		6	1	1942 467		

★ Indicates use as required. Numerals in parentheses () refer to notes. Printed in U.S.A.
 □ Indicates parts not listed in any previous parts book. Prices and specifications subject to change without notice.
 March 8, 1963 Supersedes May 1, 1962. Page 21-24 * Indicates change or addition.

CODE	PART NAME AND DESCRIPTION	CYL.	PER CAR	VALIANT LANCER	PLYMOUTH DODGE	CHRYSLER IMPERIAL
------	---------------------------	------	---------	----------------	----------------	-------------------

AUTOMATIC 3 - SPEED TRANSMISSION

21-133-O TRANSMISSION CLUTCH - Cont'd						
21-133-20	SPRING - Cont'd					
	Rear Clutch	6	1	1942 414	1942 414	
	Front Clutch	8	10	----	2124 822	2124 822
	Rear Clutch	8	1	----	1942 015	1942 015
21-133-22	RETAINER, Front Clutch Piston Spring	6	1	1942 399	1942 399	
		8	1	----	2124 823	2124 823
21-133-25	SNAP RING, Rear Clutch Piston Spring, 5 27/64" O.D.	6	1	1942 415	1942 415	
	Rear Clutch Piston Spring, 7 3/16" O.D.	8	1	----	1942 057	1942 057
	Rear Clutch Piston Retainer, 1 5/16" O.D.	8	1	----	2124 872	2124 872
21-133-36	DISC, Front Clutch Driving	6	★	2205 203	1942 404	
	Front Clutch Driving, w/225 cu. in. Engine, Heavy Duty and Taxi	6	4	1942 404		
	Rear Clutch Driving	6	3	1942 418	1942 418	
	Front Clutch Driving	8	4	----	2124 827	2124 827
	Rear Clutch Driving	8	★	----	2124 838	2124 838
	Front Clutch Driving, SP2, SD2, w/413 cu.in.Eng.	8	4	----	E2400 725	
21-133-38	PLATE, Front Clutch	6	★	1942 403	1942 403	
	Rear Clutch	6	2	1942 403	1942 403	
	Front Clutch	8	4	----	2124 826	2124 826
	Rear Clutch	8	★	----	2124 826	2124 826
21-133-39	PLATE, Front Clutch Pressure	6	1	1942 402	1942 402	
	Rear Clutch Pressure, Front	6	1	1949 930	1949 930	
	Rear Clutch Pressure, Rear	6	1	1942 402	1942 402	
	Front Clutch Pressure	8	1	----	2124 825	2124 825
	Rear Clutch Pressure, Front	8	1	----	2124 837	2124 837
	Rear Clutch Pressure, Rear	8	1	----	2124 825	2124 825
21-133-40	GEAR, Sun, w/BUSHING	6	1	1942 434	1942 434	
		8	1	----	1942 076	1942 076
21-133-42	SHELL, Sun Gear Driving	6	1	1942 438	1942 438	
		8	1	----	2124 847	2124 847
21-133-43	SNAP RING, Front Clutch, Outer	6	1	1942 421	1942 421	
	Front Clutch, Inner	6	1	1942 400	1942 400	
	Rear Clutch Retainer, .060" thk.	6	★	1942 421	1942 421	
	Rear Clutch Retainer, .068" thk.	6	★	1942 422	1942 422	
	Rear Clutch Retainer, .076" thk.	6	★	1942 423	1942 423	
	Front Clutch, Inner, 3 1/4" O. D.	8	1	----	2124 824	2124 824
	Front Clutch, 7" O. D.	8	1	----	1942 063	1942 063
	Rear Clutch Retainer, .060" thk., 7" O. D.	8	★	----	1942 063	1942 063
	Rear Clutch Retainer, .074" thk., 7" O. D.	8	★	----	1942 064	1942 064
	Rear Clutch Retainer, .088" thk., 7" O. D.	8	★	----	1942 065	1942 065
21-133-46	RING, Sun Gear Driving Shell Lock	6	2	1942 439	1942 439	
		8	2	----	1736 521	1736 521
21-133-47	PLATE, Sun Gear Driving Shell Thrust	6	2	2124 258	2124 258	
		8	1	----	1942 080	1942 080
21-133-48	WASHER, Sun Gear Driving Shell Thrust	6	2	2205 223	2205 223	
	Sun Gear Driving Shell Thrust, w/3 Tabs	8	1	----	1942 081	1942 081

★ Indicates use as required. Numerals in parentheses () refer to notes. Printed in U.S.A.
 E Indicates parts not listed in any previous parts book. Prices and specifications subject to change without notice.
 * Indicates change or addition. Page 21-25 March 8, 1963 Supersedes May 1, 1962.

CODE	PART NAME AND DESCRIPTION	CYL.	PER CAR	VALIANT LANCER	PLYMOUTH DODGE	CHRYSLER IMPERIAL
------	---------------------------	------	---------	----------------	----------------	-------------------

AUTOMATIC 3 - SPEED TRANSMISSION

21-133-O TRANSMISSION CLUTCH - Cont'd

21-133-65	WASHER, Front Clutch Thrust, Front and Rear, Plastic	6	2	2204 369	2204 369	
	Front Clutch Thrust, Front, Natural, .043" thk. . .	8	★	----	2204 621	2204 621
	Front Clutch Thrust, Front, Green, .061" thk. . .	8	★	----	2204 622	2204 622
	Front Clutch Thrust, Front, Red, .084" thk. . . .	8	★	----	2204 623	2204 623
	Front Clutch Thrust, Front, Yellow, .102" thk. . .	8	★	----	2400 284	2400 284
	Front Clutch Thrust, Rear, Green, .061" thk. . . .	8	1	----	2204 622	2204 622

21-134-O TRANSMISSION FRONT AND REAR PLANET PINION CARRIER AND COMPONENTS

21-134-5	CARRIER, w/PINIONS and WASHERS, Front	6	1	2298 931	2298 931	
	Rear	6	1	*2421 262	*2421 262	
	CARRIER, w/PINIONS, Front	8	1	----	1942 070	1942 070
	Rear	8	1	----	1942 074	1942 074
21-134-30	WASHER, Front and Rear Planet Pinion Carrier Thrust, w/3 Tabs	8	2	----	1942 081	1942 081
21-134-36	SUPPORT, Front Annulus Gear	6	1	1942 446	1942 446	
	Rear Annulus	6	1	1942 450	1942 450	
21-134-38	GEAR, Front and Rear Annulus	6	2	1942 443	1942 443	
	Front Annulus	8	1	----	2124 841	2124 841
	Rear Annulus	8	1	----	1942 086	1942 086
21-134-40	SNAP RING, Front and Rear Annulus Gear	6	2	1942 444	1942 444	
	Front Annulus Gear Support	6	1	1942 448	1942 448	
21-134-45	WASHER, Front Annulus Gear Support Thrust	6	1	1942 447	1942 447	

21-136-O TRANSMISSION BANDS

21-136-5	BAND, Kickdown	6	1	2204 792	2204 792	
	SP2, SD2, w/413 cu. in. Engine	8	1	----	2124 342	2124 342
		8	1	----	E2400 726	
21-136-15	STRUT, Kickdown Band	6	1	1630 896	1630 896	
	STRUT, Kickdown Band	8	1	----	2124 848	2124 848
	ANCHOR, Kickdown Band	8	1	----	1942 120	1942 120
21-136-17	SCREW, Kickdown Band Adjusting	6	1	1942 477	1942 477	
	UP TO Trans. No. 321977	8	1	----	*1736 215	*1736 215
	AFTER Trans. No. 321977	8	1	----	E2400 389	E2400 389
21-136-20	LEVER, Kickdown Band	6	1	2204 952		
	w/225 cu. in. Engine, Heavy Duty and Taxi	6	1	2125 067		
		8	1	----	2125 067	
	w/318 cu. in. Engine	8	1	----	*2204 952	
	SP2, SD2, w/361 and 383 cu. in. Engine	8	1	----	*2125 067	
	SD3	8	1	----	2125 067	2125 067
	SP2, SD2, w/413 cu. in. Engine	8	1	----	*2124 579	
21-136-23	SHAFT, Kickdown Band Lever		1	1942 132	1942 132	1942 132
21-136-30	BAND, Reverse	6	1	1942 487	1942 487	
		8	1	----	1942 133	1942 133
21-136-41	ANCHOR, Reverse Band	6	1	1942 496	1942 496	
	STRUT, Reverse Band	6	1	1942 497	1942 497	
	STRUT, Reverse Band	8	1	----	2204 823	2204 823

★ Indicates use as required. Numerals in parentheses () refer to notes. Printed in U.S.A.
 E Indicates parts not listed in any previous parts book. Prices and specifications subject to change without notice.
 March 8, 1963 Supersedes May 1, 1962. Page 21-26 * Indicates change or addition.

CODE	PART NAME AND DESCRIPTION	C Y L.	PER CAR	VALIANT LANCER	PLYMOUTH DODGE	CHRYSLER IMPERIAL
------	---------------------------	--------------	------------	-------------------	-------------------	----------------------

AUTOMATIC 3 - SPEED TRANSMISSION

21-136-O TRANSMISSION BANDS - Cont'd						
21-136-44	LINK, Reverse Band	6	1	1942 494	1942 494	2204 820
		8	2	----	2204 820	
21-136-47	LEVER, Reverse Band, w/STEM	6	1	1942 491	1942 491	1942 137
		6	1	1942 140	1942 140	
		8	1	----	1942 137	
		8	1	----	2124 493	
21-136-49	SHAFT, Reverse Band Lever	6	1	1942 493	1942 493	2124 857
		8	1	----	2124 857	
21-136-52	SCREW, Reverse Band Adjusting	6	1	1942 543	1942 543	1942 141
		8	1	----	1942 141	
21-136-55	SEAL, Reverse Band Lever Shaft	8	1	----	1550 711	1550 711
21-136-65	DRUM, Reverse	6	1	1942 451	1942 451	2124 843
		8	1	----	2124 843	
21-136-228	CAM and RETAINER PACKAGE, "O" Running Clutch	6	1	2279 960	2279 960	
21-136-229	WASHER, Cam Screw	6	5	1823 543	1823 543	
21-136-231	CAM, "O" Running Clutch	8	1	----	1942 095	1942 095
21-136-232	RACE, "O" Running Clutch	6	1	⊠2400 365	⊠2400 365	2124 844
		8	1	----	2124 844	
21-136-233	RETAINER, "O" Running Clutch Spring	8	1	----	1942 096	1942 096
21-136-235	ROLLER, "O" Running Clutch Cam	6	10	670 776	670 776	670 776
		8	12	----	670 776	
21-136-236	SPRING, "O" Running Clutch Cam Roller	6	10	1942 187	1942 187	1942 187
		8	12	----	1942 187	
21-136-237	WASHER, "O" Running Clutch Race Thrust, UP TO Trans. No. 541302	6	1	*2204 727	*2204 727	⊠2400 528
		6	1	⊠2400 528	⊠2400 528	
21-137-O TRANSMISSION SERVOS						
21-137-5	PISTON, Kickdown Servo	6	1	1942 478	1942 478	2124 850
		8	1	----	2124 850	
21-137-8	RING, Kickdown Servo Piston Seal, Small	6	1	1672 287	1672 287	2124 851
		6	1	1636 470	1636 470	
		6	1	1636 470	1636 470	
		8	1	----	2124 851	
		8	1	----	1942 123	
21-137-11	ROD, Kickdown Servo Piston	6	1	1942 482	1942 482	2124 853
		8	1	----	2124 853	
21-137-13	GUIDE, Kickdown Servo Piston Rod	6	1	1942 485	1942 485	2124 856
		8	1	----	2124 856	
21-137-19	SNAP RING, Kickdown Servo Piston Rod Guide	6	1	1942 486	1942 486	1942 130
		8	1	----	1942 130	

★ Indicates use as required.

Numerals in parentheses () refer to notes.

Printed in U.S.A.

⊠ Indicates parts not listed in any previous parts book.

Prices and specifications subject to change without notice.

* Indicates change or addition.

CODE	PART NAME AND DESCRIPTION	C Y L.	PER CAR	VALIANT LANCER	PLYMOUTH DODGE	CHRYSLER IMPERIAL
------	---------------------------	--------------	------------	-------------------	-------------------	----------------------

AUTOMATIC 3 - SPEED TRANSMISSION

21-137-O TRANSMISSION SERVOS - Cont'd

21-137-22	SPRING, Kickdown Servo Piston	6	1	1942 481	1942 481	
	Inner	8	1	----	2124 852	2124 852
	Outer	8	1	----	2125 069	2125 069
	Inner SP2, SD2, w/413 cu. in. Engine	8	1	----	⊠2400 729	
21-137-35	PISTON, Reverse Servo	6	1	1942 498	1942 498	
		8	1	----	1942 147	1942 147
21-137-41	SPRING, Reverse Servo Piston Cushion		1	1823 941	1823 941	1823 941
21-137-44	SNAP RING, Reverse Servo Piston Plug		1	1823 940	1823 940	1823 940
21-137-47	PLUG, Reverse Servo Piston		1	1942 152	1942 152	1942 152
21-137-50	RING, Reverse Servo Piston Seal, Rubber	6	1	1942 499	1942 499	
		8	1	----	1942 148	1942 148
21-137-53	SPRING, Reverse Servo Piston	6	1	1942 458	1942 458	
		8	1	----	1942 149	1942 149
21-137-56	RETAINER, Reverse Servo Piston Spring	6	1	1942 501	1942 501	
		8	1	----	1942 150	1942 150
21-137-59	SNAP RING, Reverse Servo Piston Spring Retainer	6	1	1942 502	1942 502	
		8	1	----	1942 130	1942 130
21-137-200	PISTON, Accumulator		1	1942 163	1942 153	1942 153
21-137-202	RING, Accumulator Piston Seal, Small		1	1941 831	1941 831	1941 831
	Large		1	2124 255	2124 255	2124 255
21-137-205	SPRING, Accumulator Piston	6	1	1942 156	1942 156	
		8	1	----	2125 109	2125 109

21-138-O TRANSMISSION GOVERNOR

21-138-2	REPAIR PACKAGE, Governor	6	1	2196 998	2196 998	
		8	1	----	2275 498	2275 498
	SP2, SD2, w/361 and 383 cu. in. Engine, SC1 Police Cars w/383 cu. in. Engine, SC2 w/413 cu. in. Engine	8	1	----	*2298 514	*2298 514
	SP2, SD2, w/413 cu. in. Engine	8	1	----	⊠2421 377	
21-138-7	SNAP RING, Governor Body	6	1	6022 583	6022 583	
		8	1	----	6022 817	6022 817
21-138-10	SUPPORT, Governor	6	1	1942 466	1942 466	
	SP2, SD2	8	1	----	1942 108	
	SD3	8	1	----	1949 838	1949 838
21-138-13	WEIGHT, Governor, Outer		1	1636 461	1636 461	1636 461
	Inner		1	1636 462	1636 462	1636 462
	Inner SP2, SD2, w/413 cu. in. Engine	8	1	----	⊠2400 705	
21-138-15	SPRING, Governor Weight	6	1	2124 662		
	w/225 cu. in. Engine, Heavy Duty and Taxi	6	1	1949 858	1949 858	1949 858
	SP2, SD2, w/361, 383 and 413 cu. in. Engine, SC1 Police Cars w/383 cu. in. Engine, SC2 w/413 cu. in. Engine	8	1	----	*1949 859	*1949 859

★ Indicates use as required.

Numerals in parentheses () refer to notes.

Printed in U.S.A.

⊠ Indicates parts not listed in any previous parts book.

Prices and specifications subject to change without notice.

March 8, 1963 Supersedes May 1, 1962.

* Indicates change or addition.

CODE	PART NAME AND DESCRIPTION	CYL.	PER CAR	VALIANT LANCER	PLYMOUTH DODGE	CHRYSLER IMPERIAL
------	---------------------------	------	---------	----------------	----------------	-------------------

AUTOMATIC 3 - SPEED TRANSMISSION

21-138-O TRANSMISSION GOVERNOR - Cont'd

21-138-19	SNAP RING, Governor Weight, Outer	1		1636 465	1636 465	1636 465
	Inner	1		1636 464	1636 464	1636 464
21-138-21	LOCK, Body Bolt	2		2125 024	2125 024	2125 024
21-138-23	VALVE, Governor	1		2124 663	2124 663	2124 663
21-138-26	SHAFT, Governor Valve	1		1556 082	1556 082	1556 082
21-138-29	SNAP RING, Governor Valve Shaft	2		1638 461	1638 461	1638 461
21-138-38	RING, Governor Support Seal	2		1942 109	1942 109	1942 109

21-139-O TRANSMISSION VALVE BODY AND VALVES

21-139-4	BODY, w/Transfer PLATE	6	1	*2400 430	*2400 430	*2400 431
		8	1	-----	*2400 431	*2400 431
21-139-9	VALVE, Manual	1		1942 211	1942 211	1942 211
21-139-12	LEVER, Manual Valve	1		1942 223	1942 223	1942 223
21-139-24	SPRING, Manual Valve Lever Detent	1		1942 225	1942 225	1942 225
21-139-30	VALVE, Throttle	1		1636 423	1636 423	1636 423
21-139-33	SPRING, Throttle Valve	1		1949 847	1949 847	1949 847
21-139-47	SEAL, Throttle Lever Shaft	1		*2205 300	*2205 300	*2205 300
21-139-48	WASHER, Throttle Lever Shaft	1		1949 565	1949 565	1949 565
21-139-49	SNAP RING, Throttle Valve Lever Shaft	1		1539 430	1539 430	1539 430
21-139-50	LEVER, Throttle Valve	1		1949 652	1949 652	1949 652
21-139-63	PLUG, Regulator Valve Throttle Pressure	1		1942 245	1942 245	1942 245
	Regulator Valve Line Pressure	1		1942 218	1942 218	1942 218
21-139-64	SLEEVE, Regulator Valve Line Pressure Plug	1		1942 213	1942 213	1942 213
21-139-67	VALVE, Regulator	1		2124 733	2124 733	2124 733
21-139-68	SPRING, Regulator Valve	1		2124 734	2124 734	2124 734
21-139-71	RETAINER, Regulator Valve Spring	1		2124 735	2124 735	2124 735
21-139-74	SCREW, Line Pressure Adjusting	1		2124 736	2124 736	2124 736
	Throttle Pressure Adjusting	8	1	-----	6023 343	6023 343
21-139-76	NUT, Line Pressure Adjusting Screw	1		2124 737	2124 737	2124 737
	Throttle Pressure Adjusting Screw Lock	1		1949 523	1949 523	1949 523
21-139-78	VALVE, Kickdown	1		1941 623	1941 623	1941 623
	PLUG, Kickdown Detent	1		1941 624	1941 624	1941 624
21-139-95	VALVE, Shuttle	1		1854 275	1854 275	1854 275
	PLUG, Shuttle Valve	1		1854 274	1854 274	1854 274
21-139-98	SNAP RING, Shuttle Valve	1		1539 430	1539 430	1539 430
21-139-101	SPRING, Shuttle Valve	1		2124 697	2124 697	2124 697

★ Indicates use as required.

Numerals in parentheses () refer to notes.

Printed in U.S.A.

⊞ Indicates parts not listed in any previous parts book.

Prices and specifications subject to change without notice.

* Indicates change or addition.

CODE	PART NAME AND DESCRIPTION	CYL	PER CAR	VALIANT LANCER	PLYMOUTH DODGE	CHRYSLER IMPERIAL
------	---------------------------	-----	---------	----------------	----------------	-------------------

AUTOMATIC 3 - SPEED TRANSMISSION

21-139-O TRANSMISSION VALVE BODY AND VALVES - Cont'd

21-139-105 VALVE, 1-2 Shift	1	1	1941 602	1941 602	1941 602	
PLUG, 1-2 Shift Valve	1	1	1941 603	1941 603	1941 603	
VALVE, 2-3 Shift	1	1	1941 600	1941 600	1941 600	
PLUG, 2-3 Shift Valve	1	1	1941 601	1941 601	1941 601	
21-139-108 SPRING, 1-2 Shift Valve	1	1	2204 547	2204 547	2204 547	
2-3 Shift Valve	1	1	1942 231	1942 231	1942 231	
21-139-117 VALVE, Torque Converter Control	1	1	2124 256	2124 256	2124 256	
21-139-118 SPRING, Torque Converter Control Valve	1	1	2124 257	2124 257	2124 257	
21-139-135 COVER, Regulator Valve	1	1	2205 034	2205 034	2205 034	
Shift Valve	1	1	1942 228	1942 228	1942 228	
Shift Valve Plug	1	1	1942 230	1942 230	1942 230	
Shuttle Valve	1	1	1942 227	1942 227	1942 227	
Reverse Blocker Valve	1	1	2205 034	2205 034	2205 034	
21-139-140 PLATE, Valve Body	6	1	2205 053	2205 053		
	8	1	---- ---	2204 576	2204 576	
21-139-143 VALVE, Front and Rear Pump Check	2	2	2124 552	2124 552	2124 552	
21-139-144 SPRING, Front and Rear Pump Check Valve	2	2	1942 233	1942 233	1942 233	
21-139-147 PLATE, Transfer, UP TO Trans. No. 550203	6	1	*2204 893			
AFTER Trans. No. 550203	6	1	E2400 339			
	6	1	---- ---	*2204 893		
	8	1	---- ---	2205 182	2205 182	
21-139-154 SUPPORT, Transfer Plate	1	1	1942 237	1942 237	1942 237	
21-139-189 VALVE PACKAGE, Reverse Blocker, w/SEAL and SPRING	1	1	2275 523	2275 523	2275 523	
21-139-191 SEAL, Reverse Blocker Valve	1	1	2204 885	2204 885	2204 885	
21-139-193 SPRING, Reverse Blocker	1	1	2204 890	2204 890	2204 890	
21-142-O TRANSMISSION CONTROL LEVERS						
21-142-12 LEVER, Throttle Control	6	1	2120 817	2264 701		
SP2, SD2, SC1, SC2, SC3	8	1	---- ---	*2264 744	*2206 397	
SY1	8	1	---- ---	---- ---	2264 602	
SD3	8	1	---- ---	*2206 397		
21-142-20 INSULATOR, Throttle Control Lever Sound	1	1	1859 767	*1859 767	1859 767	
21-142-21 BUSHING, Throttle Control Lever	1	1	1859 768	*1859 768	1859 768	

NOTES

★ Indicates use as required. Numerals in parentheses () refer to notes. Printed in U.S.A.
 □ Indicates parts not listed in any previous parts book. Prices and specifications subject to change without notice.
 * Indicates change or addition.
 May 1, 1962. Page 21-30