

19x8820B

HYDRAULIC BRAKE SYSTEM - VALIANT SV1 AND LANCER SL1

GROUP 5 - 5 BRAKE-SERVICE

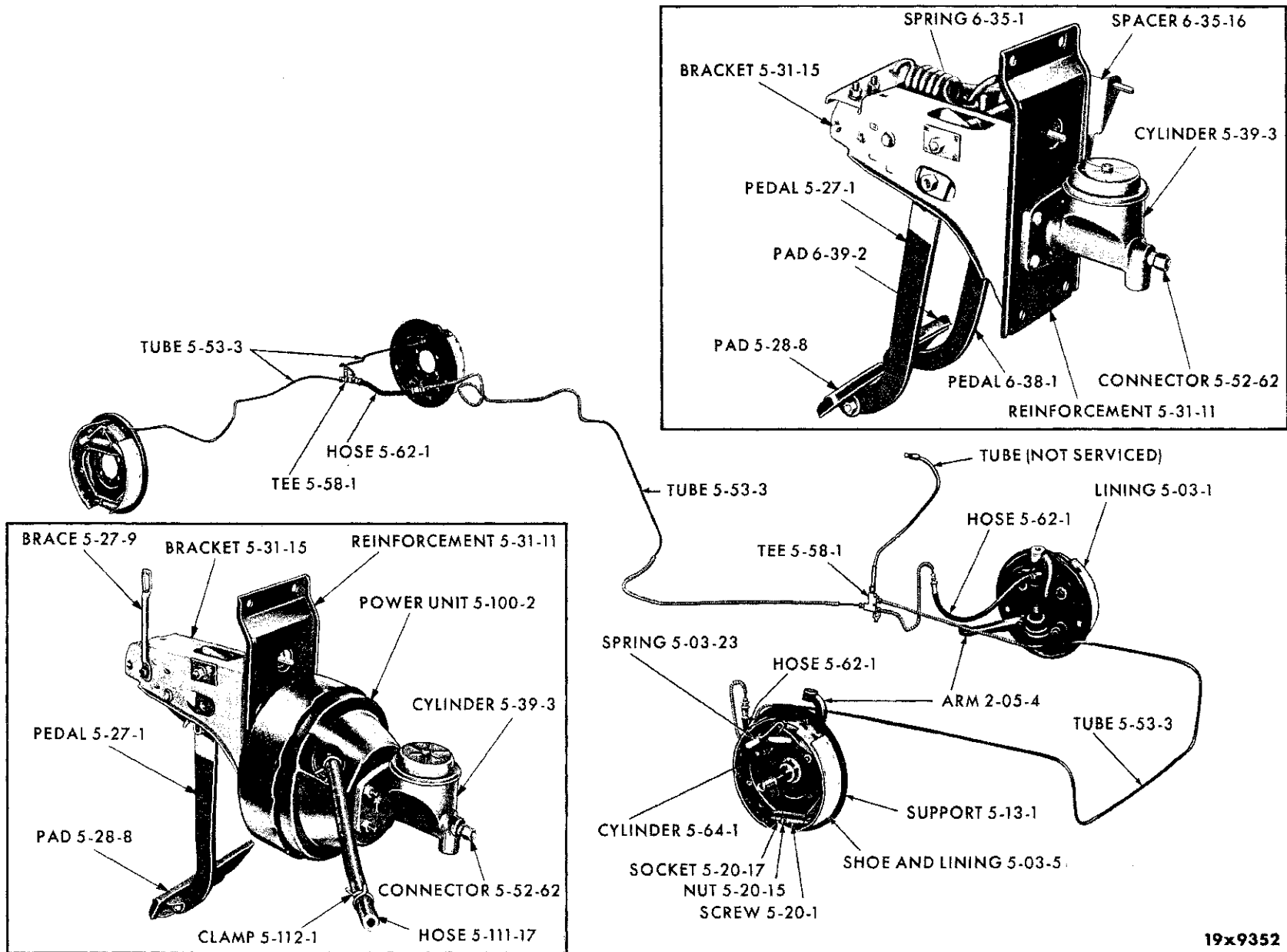

19x9352

HYDRAULIC BRAKE SYSTEM - PLYMOUTH SP1-2 AND DART SD1-2

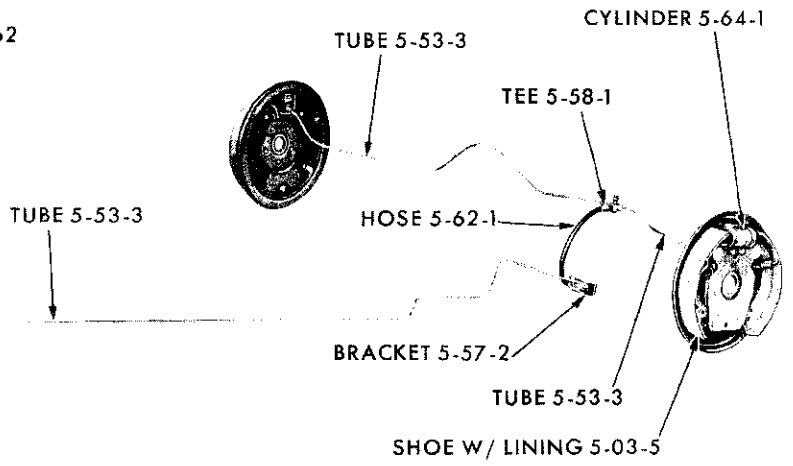
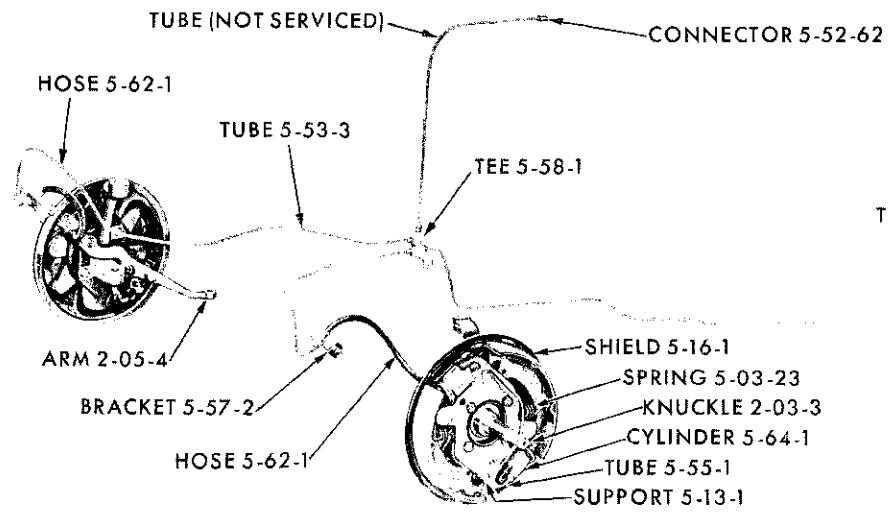
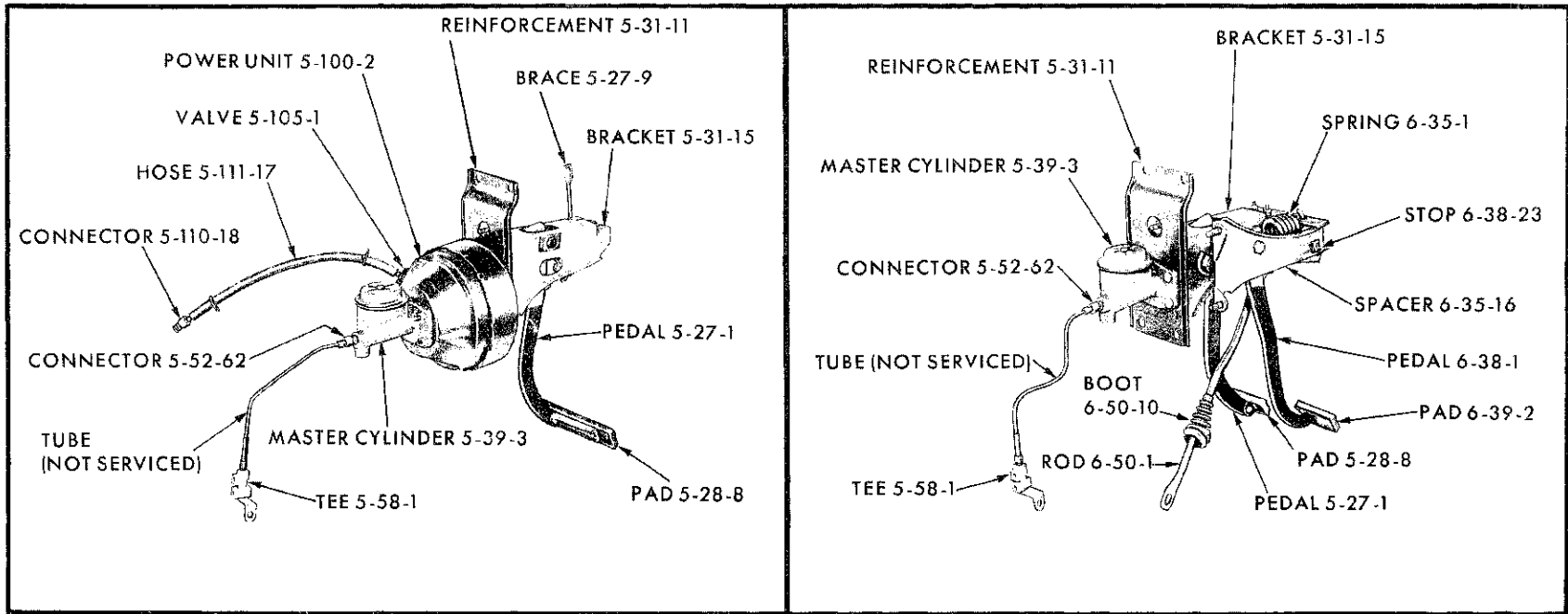

19x9344

HYDRAULIC BRAKE SYSTEM - DODGE SD3, CHRYSLER SC1-2-3 AND IMPERIAL SY1



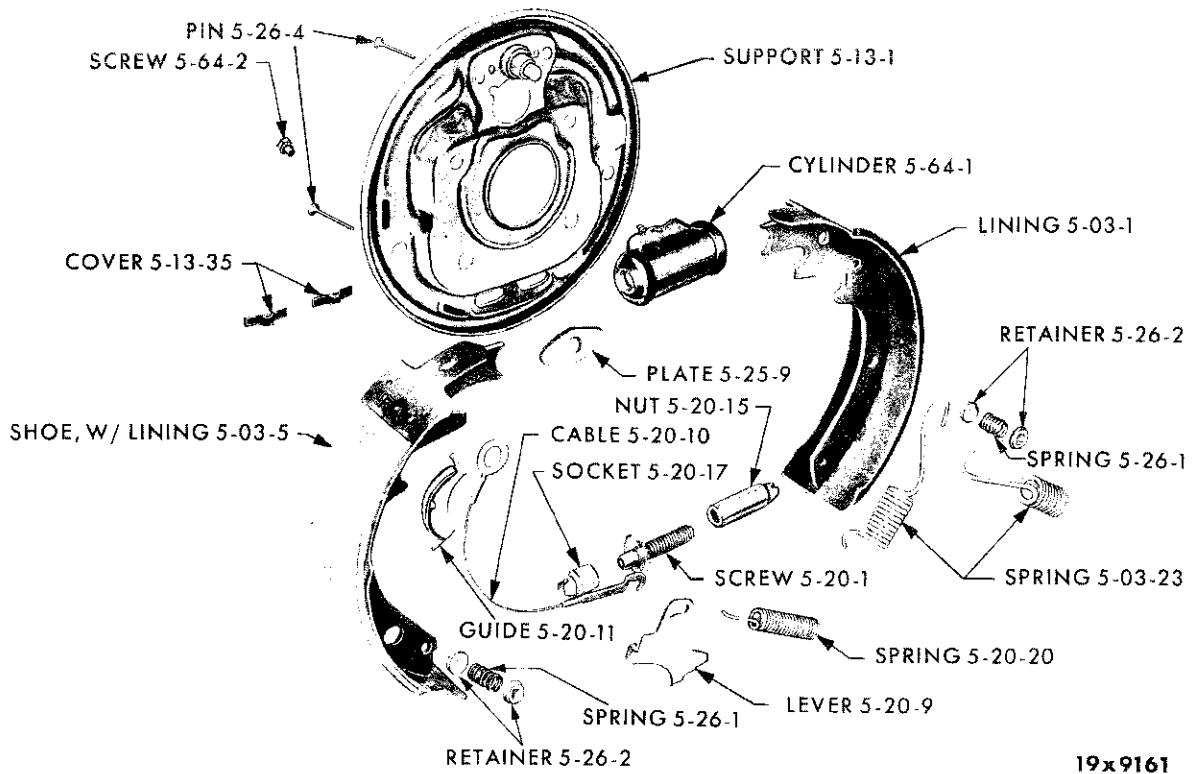

FRONT WHEEL BRAKE - PLYMOUTH SP1-2 AND DODGE SD1-2

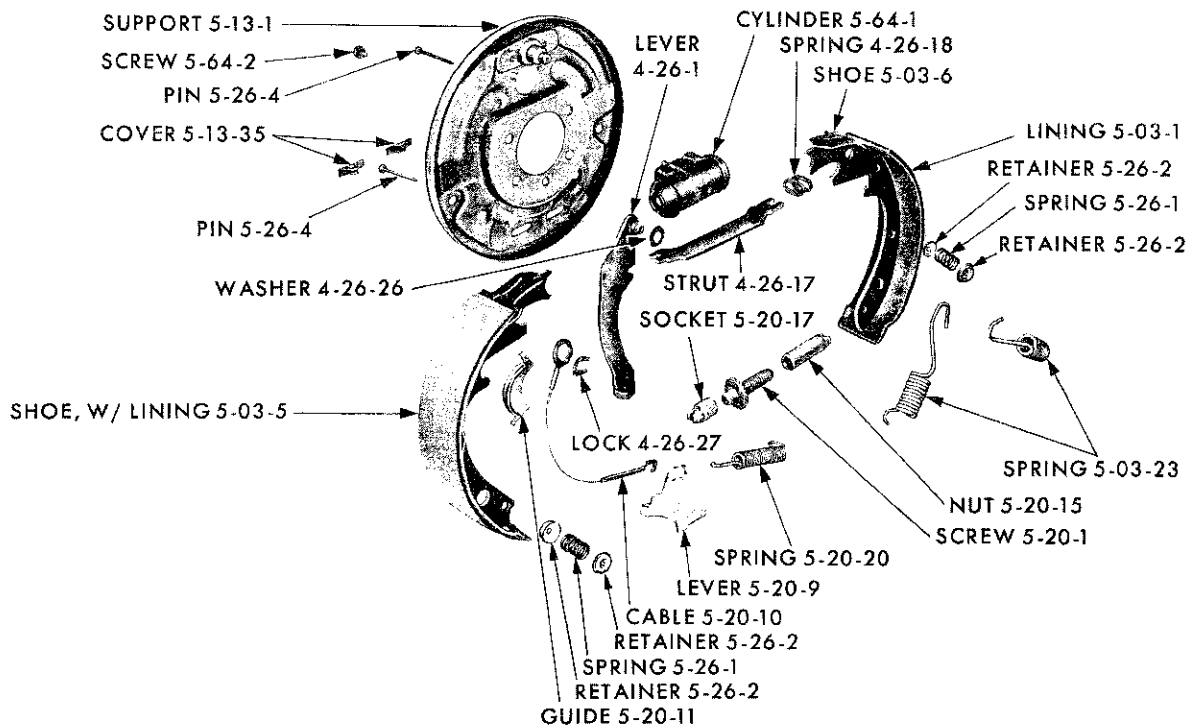

REAR WHEEL BRAKE - PLYMOUTH SP1-2 AND DODGE SD1-2

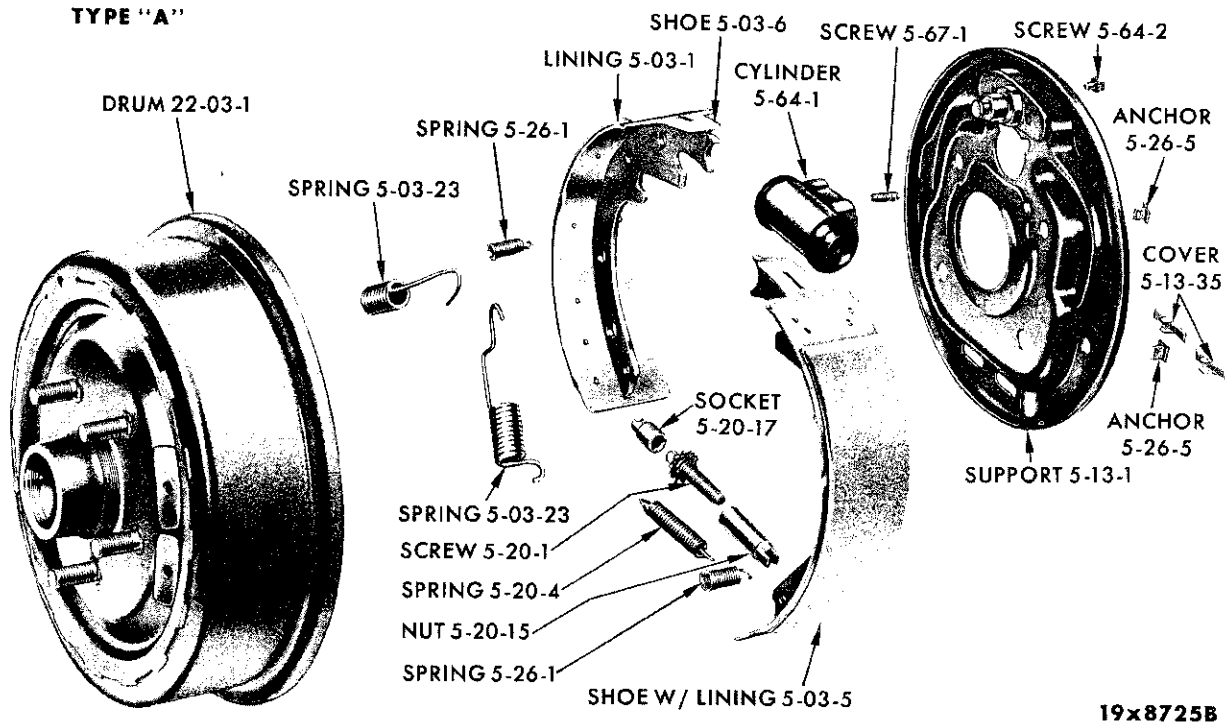

FRONT WHEEL BRAKE - VALIANT SV1 AND LANCER SL1

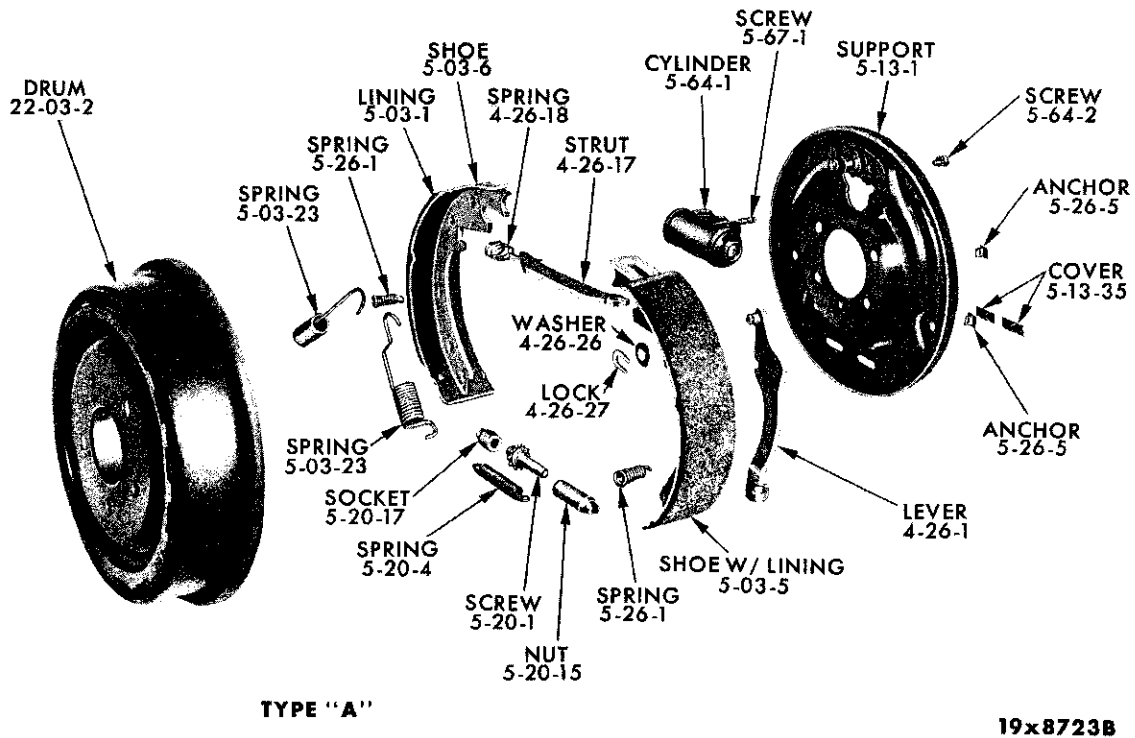

REAR WHEEL BRAKE - VALIANT SV1 AND LANCER SL1

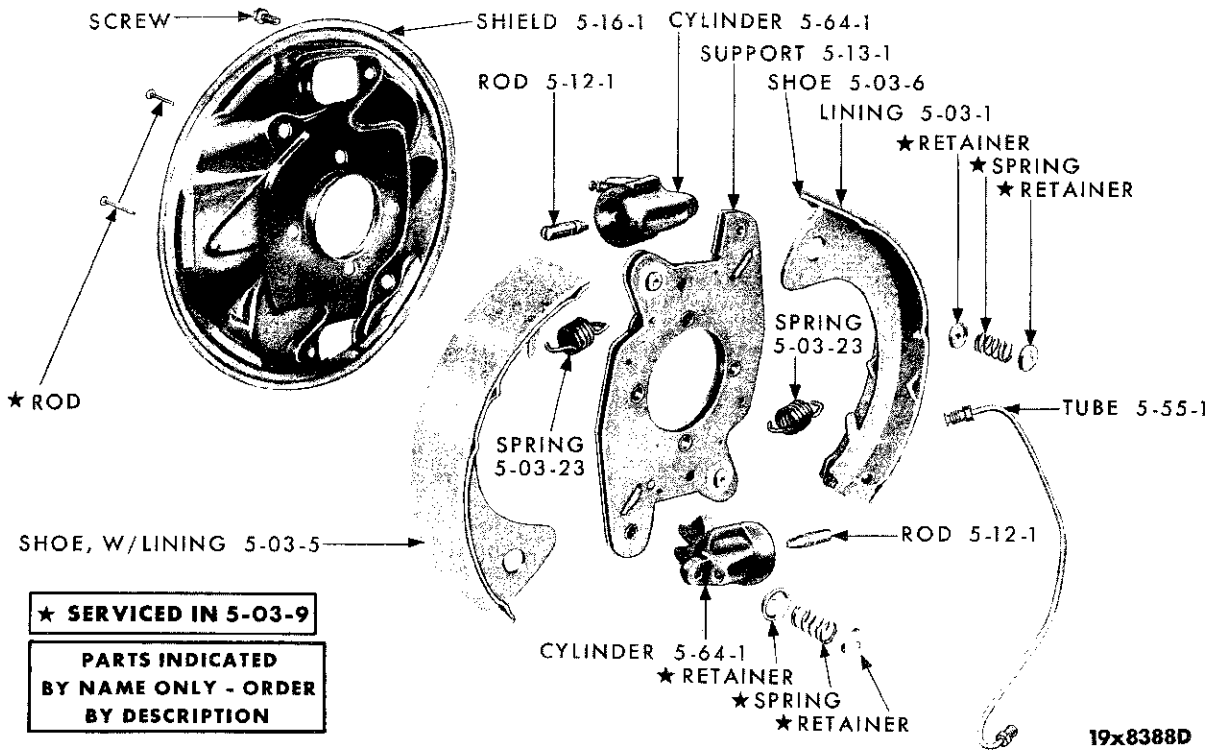

FRONT WHEEL BRAKE - DODGE SD3, CHRYSLER SC1-2-3 AND IMPERIAL SY1

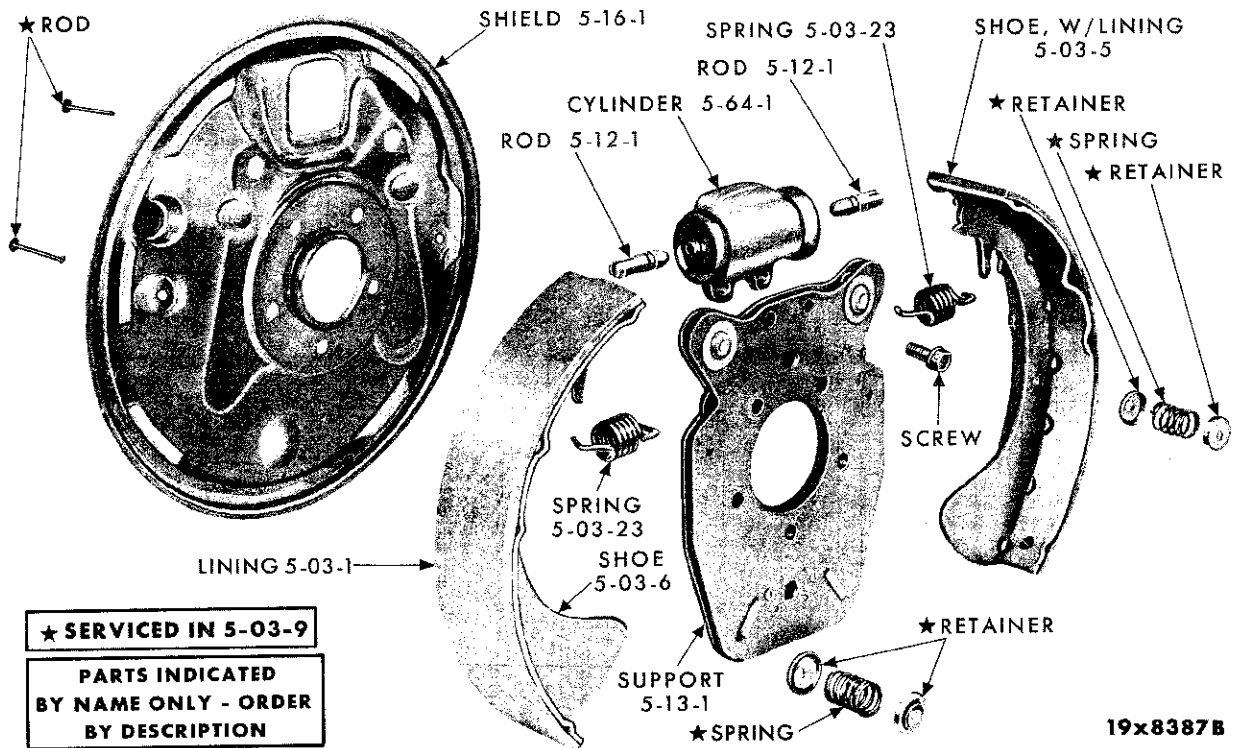

REAR WHEEL BRAKE - DODGE SD3, CHRYSLER SC1-2-3 AND IMPERIAL SY1

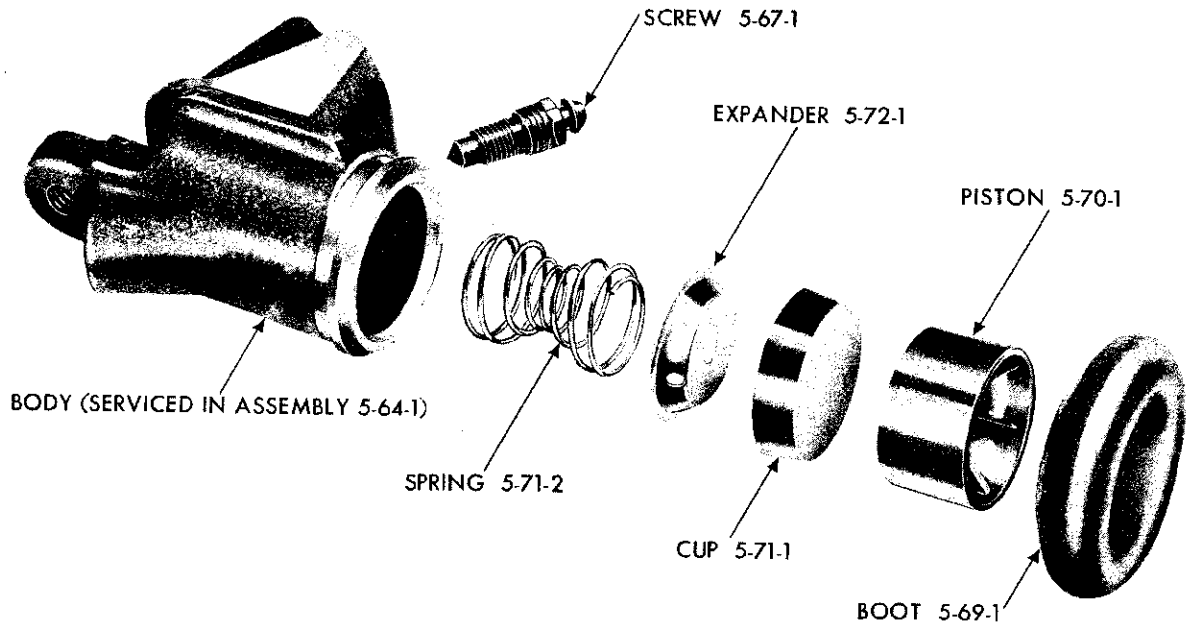

19x6947

FRONT WHEEL CYLINDER - DODGE SD3, CHRYSLER SC1-2-3 AND IMPERIAL SY1

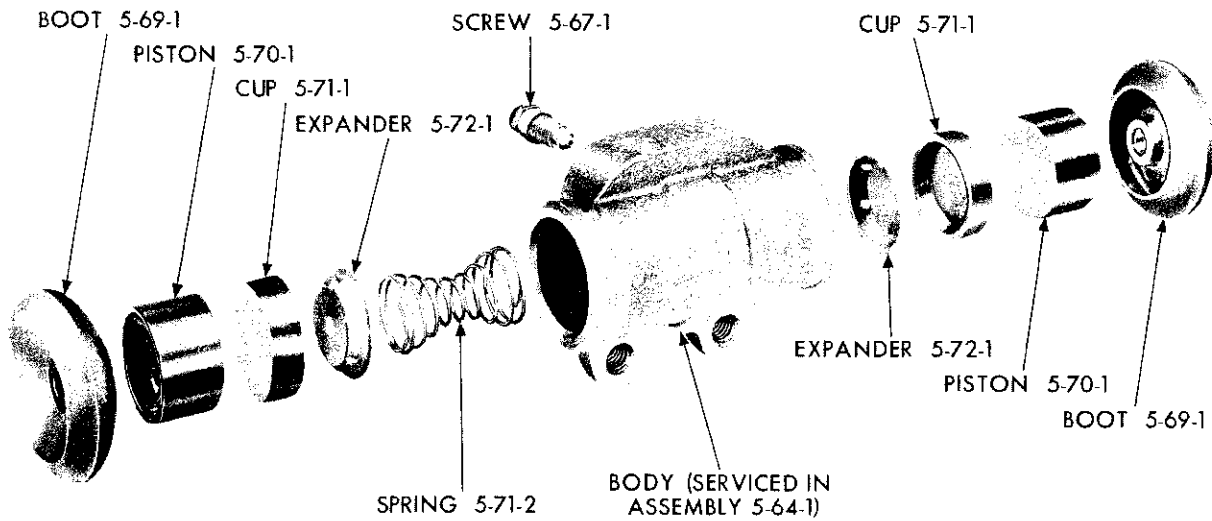

19x6949A

REAR WHEEL CYLINDER - DODGE SD3, CHRYSLER SC1-2-3 AND IMPERIAL SY1



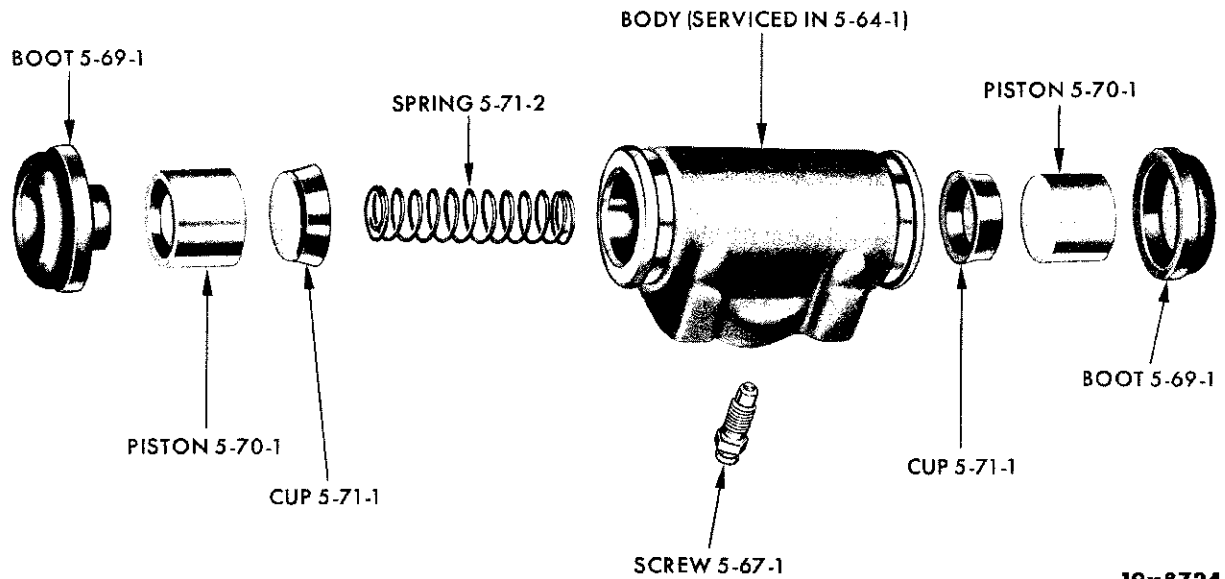

19x8724

FRONT AND REAR WHEEL CYLINDER - EXCEPT CHRYSLER SC1-2-3 AND IMPERIAL SY1

**PARTS INDICATED  
BY NAME ONLY - ORDER  
BY DESCRIPTION**

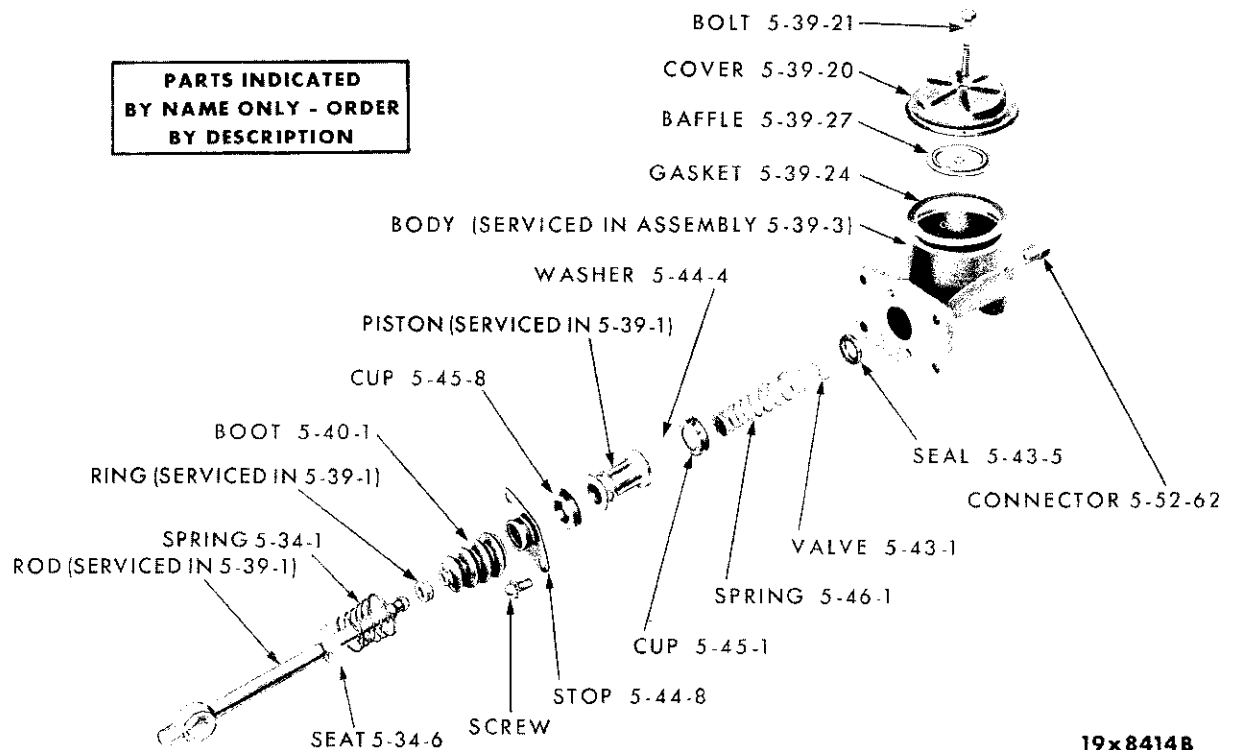

19x8414B

MASTER CYLINDER (WITHOUT POWER BRAKES) - EXCEPT IMPERIAL SY1



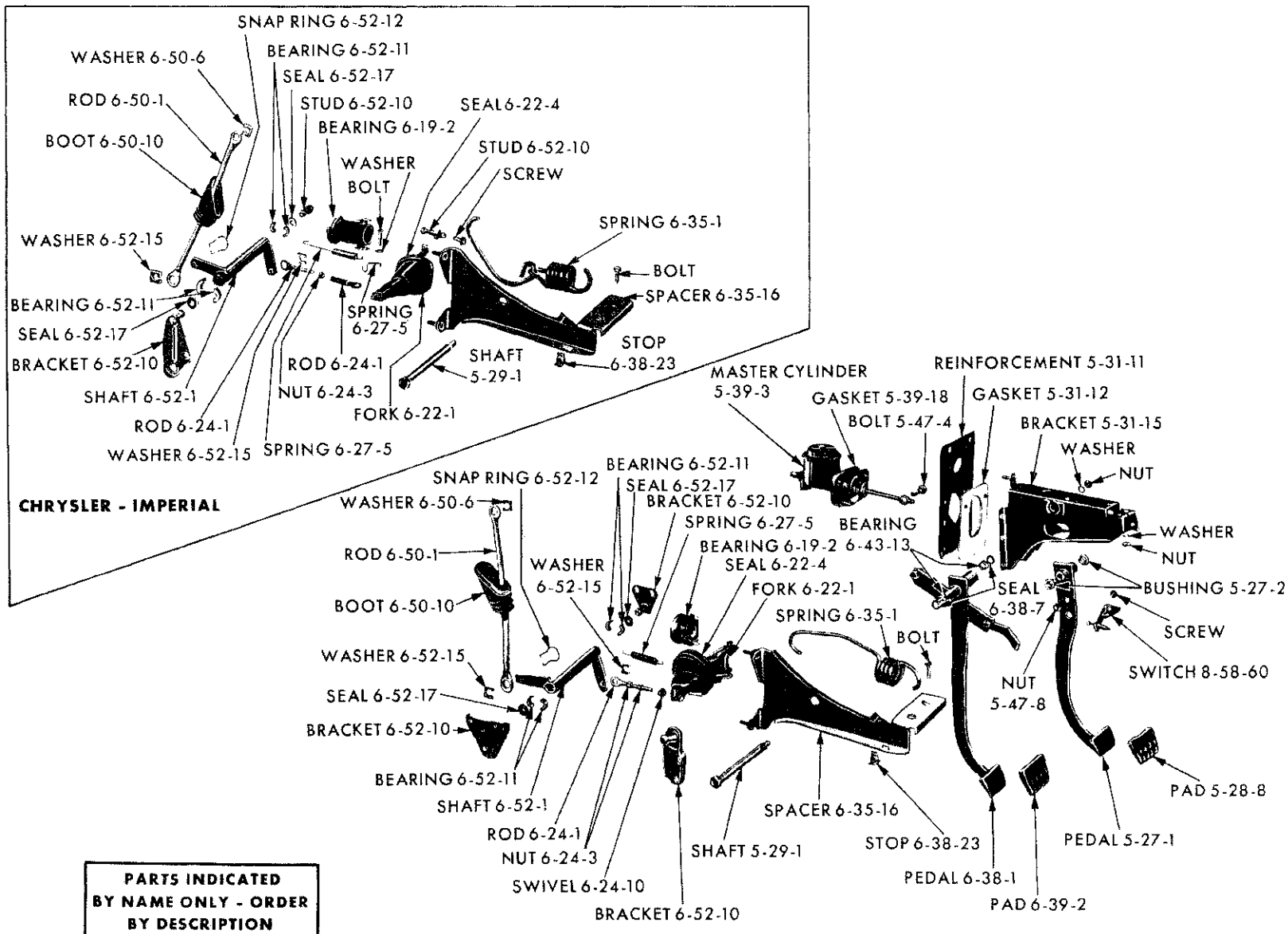

**PARTS INDICATED  
BY NAME ONLY - ORDER  
BY DESCRIPTION**

BRAKE AND CLUTCH PEDAL LINKAGE - PLYMOUTH SP1-2, DODGE SD1-2-3, CHRYSLER SC1-2-3 AND IMPERIAL SY1

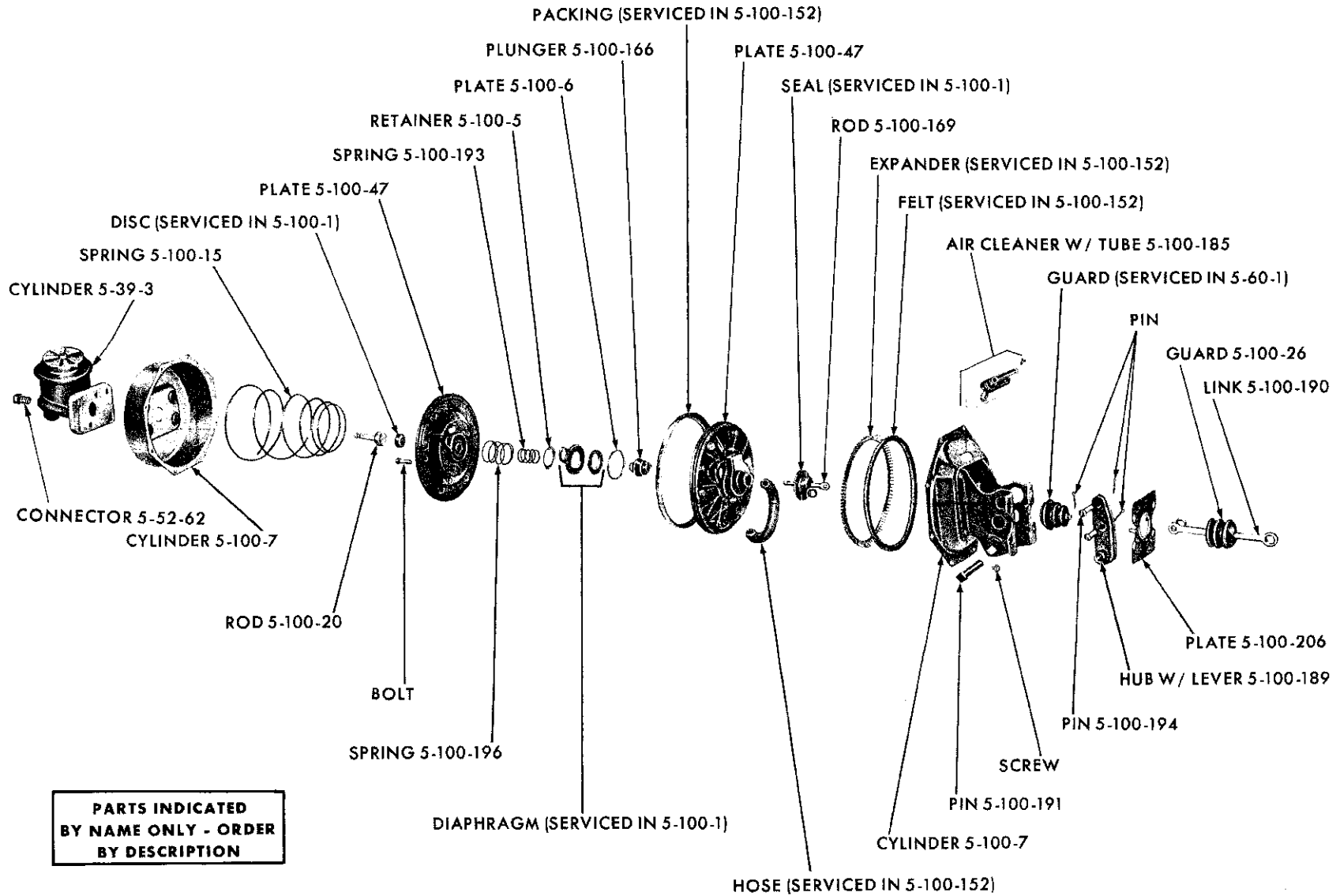

**PARTS INDICATED  
BY NAME ONLY - ORDER  
BY DESCRIPTION**

19x8754A

BOOSTER BRAKE (BENDIX) - VALIANT SV1 AND LANCER SL1

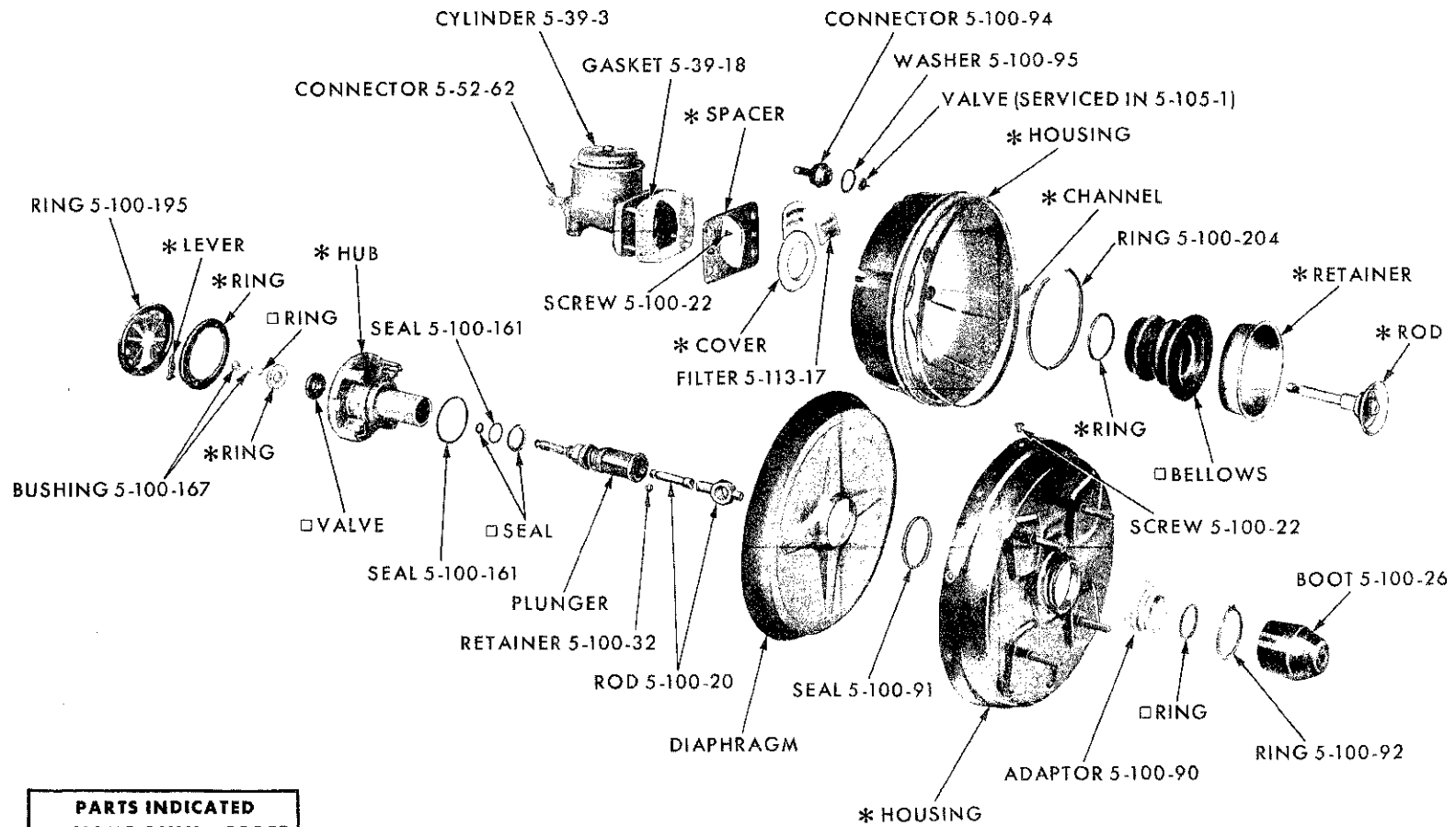

**PARTS INDICATED  
BY NAME ONLY - ORDER  
BY DESCRIPTION**

SERVICED IN 5-100-1  
 SERVICED IN 5-100-2

19x9380

BOOSTER BRAKE CYLINDER (MIDLAND-ROSS TYPE) - PLYMOUTH SP1-2 AND DODGE SD1-2



CODE	PART NAME AND DESCRIPTION	C Y L.	PER CAR	VALIANT LANCER	PLYMOUTH DODGE	CHRYSLER IMPERIAL
<b>5-01-0 BRAKE FLUID</b>						
5-01-2	BRAKE FLUID, 12 oz. Can . . . . .		★	*2421 352	*2421 352	*2421 352
	1 Quart Can . . . . .		★	1879 270	1879 270	1879 270
	1 Gallon Can . . . . .		★	1879 271	1879 271	1879 271
	5 Gallon Can . . . . .		★	1879 272	1879 272	1879 272
	30 Gallon Drum . . . . .		★	1879 273	1879 273	1879 273
<b>5-03-0 WHEEL BRAKE SHOE AND LINING</b>						
5-03-1	LINING PACKAGE, except Taxi . . . . .	6	1	2298 942		
	Taxi . . . . .	6	1	2298 943		
	10" Brakes . . . . .		1	----	2298 842	
	11" Brakes, Taxi . . . . .		1	----	2421 314	
	11" Brakes, Heavy Duty and Police Cars . . . . .		1	----	2298 848	
	11" Brakes, SD3, SC1, Except Sub. . . . .	8	1	----	2298 543	2298 543
	12" Brakes, SD3, SC1, SC2, SC3 . . . . .	8	1	----	2298 836	2298 836
	12" Brakes, SC2 w/413 cu. in. Engine . . . . .	8	1	----	----	1879 690
	12" Brakes, SC1 Police Car . . . . .	8	1	----	----	2240 227
5-03-5	SHOE, w/LINING, Front Wheel, Front Shoe . . . . .	6	2	2266 294		
	Front Wheel, Rear Shoe, UP TO Type see Note 1 . . . . .	6	2	2266 295		
	Front Wheel, Rear Shoe, AFTER Type see Note 2 . . . . .	6	2	2267 041		
	Rear Wheel, Front Shoe . . . . .	6	2	2266 296		
	Rear Wheel, Rear Shoe, UP TO Type see Note 1 . . . . .	6	2	2266 297		
	Rear Wheel, Rear Shoe, AFTER Type see Note 2 . . . . .	6	2	2267 043		
	Front and Rear Wheel, Front Shoe, 10" Brakes . . . . .		4	----	2265 777	
	Front and Rear Wheel, Rear Shoe, 10" Brakes . . . . .		4	----	2265 781	
	Front Wheel, Front Shoe, 11" Brakes, Taxi . . . . .		2	----	2401 806	
	Front Wheel, Rear Shoe, 11" Brakes, Taxi . . . . .		2	----	2401 807	
	Rear Wheel, Front Shoe, 11" Brakes, Taxi . . . . .		2	----	2401 800	
	Rear Wheel, Rear Shoe, 11" Brakes, Taxi . . . . .		2	----	2401 801	
	Front Wheel, Front Shoe, 11" Brakes, Heavy Duty and Police Cars . . . . .		2	----	2401 011	
	Front Wheel, Rear Shoe, 11" Brakes, Heavy Duty and Police Cars . . . . .		2	----	2401 012	
	Rear Wheel, Front Shoe, 11" Brakes, Heavy Duty and Police Cars . . . . .		2	----	2401 007	
	Rear Wheel, Rear Shoe, 11" Brakes, Heavy Duty and Police Cars . . . . .		2	----	2401 008	
	Front and Rear Wheel, 11" Brakes, SD3, SC1, except Sub. . . . .	8	8	----	2266 393	2266 393
	Front and Rear Wheel, 12" Brakes, SD3, SC1, SC2, SC3 . . . . .	8	8	----	2200 122	2200 122
	Front and Rear Wheel, 12" Brakes, SC2. w/413 cu. in. Engine . . . . .	8	8	----	----	2200 118
	Front and Rear Wheel, Front Shoe, 12" Brakes, SY1 . . . . .	8	4	----	----	1857 063
	Front and Rear Wheel, Rear Shoe, 12" Brakes, SY1 . . . . .	8	4	----	----	2200 122
	Front and Rear Wheel, Front Shoe, SC1 Police Car . . . . .	8	4	----	----	2201 634
	Front and Rear Wheel, Rear Shoe, SC1 Police Car . . . . .	8	4	----	----	2200 118

NOTE 1: UP TO Type Shoe, w/LINING, Identified by One White Stripe on Side of Lining.

NOTE 2: AFTER Type Shoe, w/LINING, Identified by Two White Stripes on Side of Lining.

★ Indicates use as required. Numerals in parentheses ( ) refer to notes. Printed in U.S.A.  
 ☐ Indicates parts not listed in any previous parts book. Prices and specifications subject to change without notice.  
 \* Indicates change or addition. Page 5-9 March 8, 1963 Supersedes May 1, 1962.

CODE	PART NAME AND DESCRIPTION	C Y L.	PER CAR	VALIANT LANCER	PLYMOUTH DODGE	CHRYSLER IMPERIAL
<b>5-03-0 WHEEL BRAKE SHOE AND LINING - Cont'd</b>						
5-03-6	SHOE, Front Wheel . . . . .	6	4	2072 664		
	Rear Wheel . . . . .	6	4	2072 670		
	Front Wheel, 10" x 2 1/2" Brakes . . . . .		4	----	2260 812	
	Rear Wheel, 10" x 2 1/2" Brakes . . . . .		4	----	2260 812	
	Front Wheel, 11" x 3" Brakes . . . . .		4	----	2260 654	
	Rear Wheel, 11" x 2 1/2" Brakes . . . . .		4	----	2260 886	
	Front and Rear Wheels, 11" x 2 1/2" Brakes, SD3, SC1, except Sub. . . . .	8	8	----	*1943 806	*1943 806
	Front and Rear Wheels, 12" x 2 1/2" Brakes, SD3 . . . . .	8	8	----	*1943 674	*1943 674
5-03-9	DAMPENER PACKAGE, SD3 . . . . .	8	8	----	*2084 257	*2084 257
5-03-23	SPRING, Brake Shoe Return . . . . .	6	8	2072 719		
	Front Shoe, 10" Brakes . . . . .		4	----	2267 044	
	Rear Shoe, 10" Brakes . . . . .		4	----	2260 835	
	11" Brakes, SP1, SP2, SD1, SD2 . . . . .		8	----	*2260 789	
	11" Brakes, SD3, SC1, except Sub. . . . .	8	8	----	*2266 881	*2266 881
	12" Brakes, SD3 . . . . .	8	8	----	*2267 066	*2267 066
<b>5-12-0 WHEEL CYLINDER PISTON PUSH ROD</b>						
5-12-1	ROD, SP1, SP2, SD1, SD2 . . . . .		8	----	*2260 787	
	SD3 . . . . .	8	8	----	*1329 890	*1329 890
<b>5-13-0 WHEEL BRAKE SUPPORT</b>						
5-13-1	SUPPORT, Front . . . . .	6	2	2072 609		
	Rear, Right . . . . .	6	1	2072 628		
	Rear, Left . . . . .	6	1	2072 629		
	Front, 10" Brakes . . . . .		2	----	2265 581	
	Rear, Right, 10" Brakes . . . . .		1	----	2265 584	
	Rear, Left, 10" Brakes . . . . .		1	----	2265 585	
	Front, 11" Brakes . . . . .		2	----	2265 563	
	Rear, Right, 11" Brakes . . . . .		1	----	2265 564	
	Rear, Left, 11" Brakes . . . . .		1	----	2265 565	
	Front, Right, 11" Brakes, SD3, SC1, except Sub. . . . .	8	1	----	*1943 838	*1943 838
	Front, Left, 11" Brakes, SD3, SC1, except Sub. . . . .	8	1	----	*1943 839	*1943 839
	Rear, 11" Brakes, SD3, SC1, except Sub. . . . .	8	2	----	*1943 813	*1943 813
	Front, Right, 12" Brakes, SD3, SC1, SC2, SC3 . . . . .	8	1	----	*1943 796	*1943 796
	Front, Left, 12" Brakes, SD3, SC1, SC2, SC3 . . . . .	8	1	----	*1943 797	*1943 797
	Front, Right, 12" Brakes, SY1 . . . . .	8	1	----	----	1943 798
	Front, Left, 12" Brakes, SY1 . . . . .	8	1	----	----	1943 799
	Rear, 12" Brakes, SD3 . . . . .	8	2	----	*1943 832	*1943 832
5-13-7	GASKET, Brake Support Plate . . . . .		★	2070 932	2070 933	
5-13-9	BOLT, Support Mounting, Front, Upper . . . . .		★	2072 682	2207 604	
	Front, Lower . . . . .		★	2072 681	2207 606	
	Rear . . . . .		★	2070 041	2265 572	
	Front, 7/16" - 20 x 1 3/4", SD3 . . . . .	8	4	----	*1615 460	*1615 460
	Front, 7/16" - 20 x 2 3/4", SD3 . . . . .	8	2	----	*1850 938	*1850 938
	Front, 7/16" - 20 x 3 1/8", SD3 . . . . .	8	2	----	*1943 691	*1943 691
	Rear, 3/8" - 24 x 1 1/4", SD3 . . . . .	8	10	----	*1484 652	*1484 652
5-13-10	NUT, Support Mounting Bolt, Front Upper . . . . .		★	601 014	601 014	601 014
	Front, Lower, SP1, SP2, SD1, SD2 . . . . .		★	*1825 351	* 128 027	
	SD3 . . . . .		4	----	* 272 314	* 272 314
	Rear . . . . .		★	1927 232	120 369	120 369
5-13-22	SEAL, to Strg. Knuckle . . . . .		2	2072 684	2266 890	
5-13-35	COVER, Adjusting Screw Hole . . . . .		8	1664 564	1664 564	

★ Indicates use as required.

Numerals in parentheses ( ) refer to notes.

Printed in U.S.A.

⊠ Indicates parts not listed in any previous parts book.

Prices and specifications subject to change without notice.

May 1, 1962 Supersedes Nov. 30, 1961.

\* Indicates change or addition.



CODE	PART NAME AND DESCRIPTION	C Y L	PER CAR	VALIANT LANCER	PLYMOUTH DODGE	CHRYSLER IMPERIAL
<b>5-16-O WHEEL BRAKE DUST SHIELD</b>						
5-16-1	SHIELD, Front, Right, 11" Brakes, SD3, SC1, except Sub. . . . .	8	1	-----	*1857 056	*1857 056
	Sub. . . . .	8	1	-----	*1857 056	*1857 056
	Left, 11" Brakes, SD3, SC1, except Sub. . . . .	8	1	-----	*1857 057	*1857 057
	Rear, 11" Brakes, SD3, SC1, except Sub. . . . .	8	2	-----	*1857 061	*1857 061
	Front, Right, 12" Brakes, w/o Trough, SD3, SC1, SC2, SC3 . . . . .	8	1	-----	*1943 666	*1943 666
	Left, 12" Brakes, w/o Trough, SD3, SC1, SC2, SC3 . . . . .	8	1	-----	*1943 667	*1943 667
	Right, 12" Brakes, w/o Trough, SY1 . . . . .	8	1	-----	-----	1943 686
	Left, 12" Brakes, w/o Trough, SY1 . . . . .	8	1	-----	-----	1943 687
	Right, 12" Brakes, w/TROUGH, SD3, SC1, SC2, SC3 . . . . .	8	1	-----	*2265 236	*2265 236
	Left, 12" Brakes, w/TROUGH, SD3, SC1, SC2, SC3 . . . . .	8	1	-----	*2265 237	*2265 237
	Right, 12" Brakes, w/TROUGH, SY1 . . . . .	8	1	-----	-----	2265 238
	Left, 12" Brakes, w/TROUGH, SY1 . . . . .	8	1	-----	-----	2265 239
	Rear, 12" Brakes, SD3 . . . . .	8	2	-----	*1857 044	*1857 044
<b>5-20-O WHEEL BRAKE ADJUSTER</b>						
5-20-1	SCREW . . . . .	6	4	2072 651		
	w/10" Brakes, Right . . . . .		2	-----	2260 826	
	Left . . . . .		2	-----	2260 827	
	w/11" Brakes, Right . . . . .		2	-----	2260 782	
	Left . . . . .		2	-----	2260 783	
5-20-4	SPRING, Lock . . . . .	6	4	1799 518		
5-20-9	LEVER, Auto. Adjusting, Right . . . . .		2	-----	2260 794	
	Left . . . . .		2	-----	2260 795	
5-20-10	CABLE, w/10" Brakes . . . . .		4	-----	2401 513	
	w/11" Brakes . . . . .		4	-----	2266 270	
5-20-11	GUIDE, Cable . . . . .		4	-----	2260 793	
5-20-15	NUT, Pivot . . . . .	6	4	2072 730		
	w/10" Brakes, Right . . . . .		2	-----	2260 572	
	Left . . . . .		2	-----	2260 573	
	w/11" Brakes, Right . . . . .		2	-----	2260 670	
	Left . . . . .		2	-----	2260 671	
5-20-17	SOCKET . . . . .	6	4	2072 725		
	w/10" Brakes . . . . .		4	-----	2260 824	
	w/11" Brakes . . . . .		4	-----	2265 068	
5-20-18	WASHER, Adjusting Screw Socket End . . . . .		4	-----	2266 271	
5-20-20	SPRING . . . . .		4	-----	2265 069	
<b>5-22-O WHEEL BRAKE ADJUSTING CAM DUST SHIELD SEAL</b>						
5-22-8	SEAL, SD3 . . . . .	8	8	-----	*1633 111	*1633 111
<b>5-25-O BRAKE SHOE GUIDE</b>						
5-25-9	PLATE, w/10" Brakes . . . . .		4	-----	2267 045	
	w/11" Brakes . . . . .		4	-----	2260 788	
<b>5-26-O WHEEL BRAKE SHOE GUIDE OR HOLD-DOWN SPRING</b>						
5-26-1	SPRING, Hold-Down, SP1, SP2, SD1, SD2 . . . . .		8	*2207 520	*2260 791	
	SD3 . . . . .		8	-----	* 600 071	* 600 071

★ Indicates use as required.

Numerals in parentheses ( ) refer to notes.

Printed in U.S.A.

E Indicates parts not listed in any previous parts book.

Prices and specifications subject to change without notice.

\* Indicates change or addition.

Page 5-11

May 1, 1962 Supersedes Nov. 30, 1961.

CODE	PART NAME AND DESCRIPTION	CYL.	PER CAR	VALIANT LANCER	PLYMOUTH DODGE	CHRYSLER IMPERIAL
<b>5-26-O WHEEL BRAKE SHOE GUIDE OR HOLD-DOWN SPRING - Cont'd</b>						
5-26-2	RETAINER, Upper, SP1, SP2, SD1, SD2 . . . . .		8	----	2260 792	
	Lower, SP1, SP2, SD1, SD2 . . . . .		8	----	2260 792	
	Upper, SD3 . . . . .	8	8	----	600 072	600 072
	Lower SD3 . . . . .	8	8	----	600 073	600 073
5-26-4	PIN, Hold-Down Spring, Front Wheel, 10" Brakes .		4	----	2260 548	
	11" Brakes . . . . .		4	----	2260 549	
	Rear Wheel . . . . .		4	----	2260 548	
5-26-5	ANCHOR, Hold-Down Spring . . . . .	6	8	2072 675		
<b>5-27-O BRAKE PEDAL AND BUSHING</b>						
5-27-1	PEDAL, w/Std. Trans., SP1, SP2, SD1, SD2 . . .		1	2260 736	2260 004	
	w/Auto Trans., SP1, SP2, SD1, SD2 . . . . .		1	2260 738	2260 074	
	w/Std. or Auto. Trans., SC1, SC2, SC3, UP TO .	8	1	----	----	2260 005(1)
	w/Std. or Auto. Trans., SD3, SC1, SC2, SC3,	8	1	----	2404 779	2404 779(1)
	AFTER . . . . .	8	1	----	----	2260 065
	SY1 . . . . .	8	1	----	----	
5-27-2	SLEEVE . . . . .	6	1	2073 634		
	BUSHING . . . . .		2	----	1637 779	1637 779
5-27-6	LOCK, Sleeve . . . . .	6	1	2072 816		
	w/Heavy Duty Std. Trans. . . . .	6	1	2207 701		
5-27-9	BRACE, Instrument Panel to Pedal Bracket . . . .		1	----	2161 912	
	Pedal Bracket to Dash Panel . . . . .		1	----	2162 795	
	Pedal Bracket to Lower Reinf., SD3 . . . . .	8	1	----	1901 788	
	Lower Reinf. to Pedal Bracket, SD3 . . . . .	8	1	----	2080 747	
	Windshield Frame to Pedal Bracket, SD3, SC1,	8	1	----	1901 801	1901 801
	SC2, SC3 . . . . .	8	1	----		
5-27-12	NUT, Sleeve Lock Screw . . . . .	6	1	2208 008		
5-27-21	BUSHING, Hub . . . . .	6	2	2072 822		
<b>5-28-O BRAKE PEDAL PAD</b>						
5-28-8	PAD, w/Std. Trans., SP1, SP2, SD1, SD2 . . . . .		1	*1731 228	*1731 228	
	w/Auto. Trans., SP1, SP2, SD1, SD2 . . . . .		1	2260 071	2260 071	
	w/Std. Trans., Diamond Shape, SD3, SC1, SC2 .	8	1	----	*2201 197	*2201 197
	w/Std. Trans., Square Shape, SD3, SC1, SC2 . .	8	1	----	*1940 202	*1940 202
	w/Auto. Trans., SD3, SC1, SC2, SC3 . . . . .		1	----	1820 005	1820 005
	SY1 . . . . .	8	1	----	----	1946 357
<b>5-29-O BRAKE PEDAL SHAFT</b>						
5-29-1	SHAFT, w/Std. Trans., SC1, SC2 . . . . .		1	----	1730 009	1730 009
	w/Auto. Trans. . . . .		1	----	1637 782	1637 782
<b>5-30-O BRAKE PEDAL STOP</b>						
5-30-12	PIN, w/Power Brakes, SD3, SC1, SC2, SC3,	8	1	----	2404 781	2404 781(2)
	AFTER Approx. Serial No. 147528 . . . . .					
<b>5-31-O BRAKE PEDAL BRACKET</b>						
5-31-11	REINFORCEMENT . . . . .	6	1	2207 759		
	w/o Power Brakes, SP1, SP2, SD1, SD2 . . . . .		1	----	2260 008	
	w/Power Brakes, SP1, SP2, SD1, SD2, UP TO . .		1	----	2260 010(2)	
	w/Power Brakes, SP1, SP2, SD1, SD2, AFTER . .		1	----	*2401 405(2)	
	w/o Power Brakes, SD3, SC1, SC2 . . . . .	8	1	----	2260 705	2260 705
	w/Power Brakes, SD3, SC1, SC2, SC3 . . . . .	8	1	----	2260 703	2260 703
	SY1 . . . . .	8	1	----	----	2260 069

NOTE 1: SC1 Approximate Serial No. 147528, SC2 Approximate Serial No. 147528, SC3 Approximate Serial No. 147528.

NOTE 2: SP1 Approximate Serial No. 107605, SP2 Approximate Serial No. 107605, SD1 Approximate Serial No. 110822, SD2 Approximate Serial No. 110822.

\* Indicates use as required.

Numerals in parentheses ( ) refer to notes.

Printed in U.S.A.

E Indicates parts not listed in any previous parts book.

Prices and specifications subject to change without notice.

March 8, 1963 Supersedes May 1, 1962.

Page 5-12

\* Indicates change or addition.

CODE	PART NAME AND DESCRIPTION	CYL.	PER CAR	VALIANT LANCER	PLYMOUTH DODGE	CHRYSLER IMPERIAL
<b>5-31-O BRAKE PEDAL BRACKET - Cont'd</b>						
5-31-12	GASKET, Reinforcement . . . . .		1	2207 760	2260 016	2260 016
5-31-13	NUT, Reinforcement, SC1, SC2, SC3 . . . . .		★	---- --	2076 232	2076 232
	Pedal Bracket . . . . .		1	---- --	2076 232	2076 232
5-31-15	BRACKET, Pedal . . . . .		1	2260 734	*2404 777	*2404 777
5-31-18	STRUT, Support, Right . . . . .	6	1	2207 709		
	Left . . . . .	6	1	2207 710		
<b>5-34-O BRAKE PEDAL RETURN SPRING</b>						
5-34-1	SPRING, w/o Power Brakes, SC1, SC2 . . . . .		1	2260 710	2260 710	2260 710
5-34-6	SEAT, Spring, w/o Power Brakes, SC1, SC2 . . . . .		1	2260 709	2260 709	2260 709
<b>5-39-O MASTER CYLINDER</b>						
5-39-1	SERVICE PACKAGE, w/o Power Brakes, w/o Piston, SP1, SP2, SD1, SD2 . . . . .		1	2196 905	2196 905	
	w/o Power Brakes, w/PISTON, SP1, SP2, SD1, SD2 . . . . .		1	2196 904	2275 516	
	w/Power Brakes, w/PISTON, SP1, SP2, SD1, SD2 . . . . .		1	*2298 939	*2298 939	
	w/o Power Brakes, w/o Piston, SD3, SC1, SC2 . . . . .	8	1	---- --	1879 303	1879 303
	w/o Power Brakes, w/PISTON, SD3, SC1, SC2 . . . . .	8	1	---- --	2275 517	2275 517
	w/Power Brakes, w/PISTON, SD3 . . . . .	8	1	---- --	2275 518	2275 518
5-39-3	CYLINDER, Master, w/o Power Brakes, SP1, SP2, SD1, SD2 . . . . .		1	2275 368	2071 060	
	w/Power Brakes SP1, SP2, SD1, SD2 . . . . .		1	2275 369	2275 519	
	w/o Power Brakes, SD3, SC1, SC2 . . . . .	8	1	---- --	2260 017	2260 017
	w/Power Brakes, SD3 . . . . .	8	1	---- --	2260 018	2260 018
5-39-4	COVER PACKAGE . . . . .		1	1752 470	1752 470	1752 470
5-39-11	BOLT, Mounting, w/o Power Brakes, SC1, SC2 . . . . .		4	---- --	2260 046	2260 046
5-39-18	GASKET, Master Cylinder, w/o Power Brakes, SC1, SC2 . . . . .		1	1559 753	1559 753	1559 753
	w/Power Brakes . . . . .	6	1	2074 965		
5-39-20	COVER . . . . .		1	2265 642	2265 642	2265 642
5-39-21	SCREW, Cover . . . . .		1	1556 675	1556 675	1556 675
5-39-24	GASKET, Cover . . . . .		1	2122 276	2122 276	2122 276
<b>5-40-O MASTER CYLINDER BOOT</b>						
5-40-1	BOOT, w/o Power Brakes, SC1, SC2 . . . . .		1	1828 388	1828 388	1828 388
<b>5-43-O MASTER CYLINDER VALVE</b>						
5-43-1	VALVE . . . . .		1	1318 446	1318 446	1318 446
5-43-5	SEAL . . . . .		1	1617 379	1617 379	1617 379
<b>5-44-O MASTER CYLINDER PISTON</b>						
5-44-8	STOP . . . . .	6	1	1828 389		
	w/o Power Brakes, SC1, SC2 . . . . .		1	---- --	1828 389	1828 389
	w/Power Brakes . . . . .		1	---- --	2265 635	2265 635
5-44-9	SCREW, Stop, w/Power Brakes . . . . .		1	---- --	2200 341	2200 341
	w/o Power Brakes, SC1, SC2 . . . . .		2	6022 201	6022 201	6022 201

★ Indicates use as required.

☐ Indicates parts not listed in any previous parts book.

\* Indicates change or addition.

Numerals in parentheses ( ) refer to notes.

Prices and specifications subject to change without notice.

March 8, 1963 Supersedes May 1, 1962.

Printed in U.S.A.

# 1962 PASSENGER CAR PARTS CATALOG

BRAKE - SERVICE

CODE	PART NAME AND DESCRIPTION	C Y L.	PER CAR	VALIANT LANCER	PLYMOUTH DODGE	CHRYSLER IMPERIAL
<b>5-45-O MASTER CYLINDER PISTON CUP</b>						
5-45-8	CUP, Secondary, SD3	8	1	----	* 958 659	* 958 659
<b>5-46-O MASTER CYLINDER PISTON RETURN SPRING</b>						
5-46-1	SPRING		1	1738 268	1738 268	1738 268
<b>5-47-O MASTER CYLINDER PISTON PUSH ROD</b>						
5-47-4	BOLT, End		1	2201 181	2201 181	2201 181
5-47-8	NUT, End Bolt		1	2122 266	2122 266	2122 266
5-47-10	RING, Push Rod, w/o Power Brakes, SC1, SC2	8	1	----	1737 167	1737 167
<b>5-52-O MASTER CYLINDER BRAKE TUBE</b>						
5-52-3	NUT, Master Cylinder End		1	1828 461	1828 461	1828 461
	Tee End		1	1739 226	1739 226	1739 226
5-52-62	CONNECTOR		1	1828 396	1828 396	1828 396
	ELBOW, for Field Installed Power Brakes		1	H2421 303	H2298 946	
<b>5-53-O BRAKE TUBING AND COVERS</b>						
5-53-3	TUBING, 25 Foot Roll, 3/16" O.D.		★	1843 251	1843 251	1843 251
	1/4" O.D.		★	1843 252	1843 252	1843 252
	5/16" O.D.		★	1843 253	1843 253	1843 253
	3/8" O.D.		★	1843 254	1843 254	1843 254
5-53-4	COVER, Tube, 25 Foot Roll for 3/16" O.D. Tube.		★	1843 257	1843 257	1843 257
	For 1/4" O.D. Tube		★	1843 258	1843 258	1843 258
	For 5/16" O.D. Tube		★	1843 259	1843 259	1843 259
<b>5-55-O WHEEL CYLINDER CONNECTING TUBE</b>						
5-55-1	TUBE, 11" Brakes, Front, Right, SD3, SC1	8	1	----	*1633 092	*1633 092
	Left, SD3, SC1	8	1	----	*1633 093	*1633 093
	12" Brakes, Front, Right, SD3	8	1	----	*1558 192	*1558 192
	Left, SD3	8	1	----	*1558 191	*1558 191
<b>5-56-O BRAKE TUBE CLIP</b>						
5-56-2	CLIP		★	1119 423	1119 423	1119 423
			★	2123 341	2123 341	2123 341
			★	----	2207 933	
<b>5-57-O BRAKE TUBE BRACKET</b>						
5-57-2	BRACKET, Front, SD3, SC1, SC2	8	2	----	*1739 248	*1739 248
	SC3, SY1	8	2	----	----	2123 212
	Rear, SP1, SP2, SD1, SD2		1	----	*2208 892	
	SD3	8	1	----	*2123 214	*2123 214
<b>5-58-O BRAKE TUBE TEE</b>						
5-58-1	TEE, Master Cylinder to Brake Tube	6	1	2208 853		
	w/o Power Brakes, SP1, SP2, SD1, SD2		1	----	*2207 937	
	w/ Power Brakes, SP1, SP2, SD1, SD2		1	----	*2208 852	
	SD3, SC1, SC2	8	1	----	*2123 217	*2123 217
	SC3, SY1	8	1	----	----	2123 218
	Rear Axle Tube	6	1	1940 621		
	SC1, SC2, SC3		1	----	1118 161	1940 622
	SY1	8	1	----	----	2070 311
5-58-2	SCREW		1	6023 133	6023 133	6023 133

★ Indicates use as required.

Numerals in parentheses ( ) refer to notes.

Printed in U.S.A.

□ Indicates parts not listed in any previous parts book.

Prices and specifications subject to change without notice.

May 1, 1962 Supersedes Nov. 30, 1961.

\* Indicates change or addition.

CODE	PART NAME AND DESCRIPTION	C Y L.	PER CAR	VALIANT LANCER	PLYMOUTH DODGE	CHRYSLER IMPERIAL
<b>5-62-0 BRAKE FLEXIBLE HOSE</b>						
5-62-1	HOSE, Front, SP1, SP2, SD1, SD2 . . . . .		2	2073 023	2200 996	
	SD3, SC1, SC2 . . . . .	8	2	----	1739 249	1739 249
	SC3, SY1 . . . . .	8	2	----	----	1554 347
	Rear, SP1, SP2, SD1, SD2 . . . . .		1	1739 249	2207 918	
	SD3, SC1, SC2, SC3 . . . . .	8	1	----	1739 249	1739 249
	SY1 . . . . .	8	1	----	----	1739 215
5-62-7	GASKET, Front Wheel Hose . . . . .		2	2072 612	1406 748	1406 748
5-62-20	LOCK, Hose to Bracket . . . . .		3	2208 893	2208 893	2208 893
<b>5-63-0 WHEEL CYLINDER SERVICE PACKAGE</b>						
5-63-1	SERVICE PACKAGE, Wheel Cylinder Front, SP1, SP2, SD1, SD2 . . . . .		2	2084 788	2275 535	
	Rear, SP1, SP2, SD1, SD1 . . . . .		2	2084 789	2275 536	
	Front and Rear, SD3 . . . . .	8	4	----	1818 639	1818 639
	Rear, Police and Heavy Duty, 11" Brakes w/13/16" bore . . . . .		2	----	ⓔ2421 347	
5-63-3	SERVICE PACKAGE, Wheel Cylinder Piston, Front, SP1, SP2, SD1, SD2 . . . . .		2	2084 790	2275 539	
	Rear, SP1, SP2, SD1, SD2 . . . . .		2	2084 791	2275 540	
	Front and Rear, SD3 . . . . .	8	4	----	1818 834	1818 834
	Rear, Police and Heavy Duty, 11" Brakes w/13/16" bore . . . . .		2	----	ⓔ2421 346	
<b>5-64-0 WHEEL BRAKE CYLINDER</b>						
5-64-1	CYLINDER, Front, Right, SP1, SP2, SD1, SD2 . .		1	2072 616	2265 362	
	Left, SP1, SP2, SD1, SD2 . . . . .		1	2072 617	2265 363	
	Rear, SP1, SP2, SD1, SD2 . . . . .		2	2072 632	2260 842	
	Front, Upper, Right, SD3 . . . . .	8	1	----	1857 054	1857 054
	Left, SD3 . . . . .	8	1	----	1857 055	1857 055
	Front, Lower, Right, SD3 . . . . .	8	1	----	1857 052	1857 052
	Left, SD3 . . . . .	8	1	----	1857 053	1857 053
	Rear, SD3 . . . . .	8	2	----	1857 051	1857 051
	Rear, Police and Heavy Duty, 11" Brakes w/13/16" bore . . . . .		2	----	ⓔ2401 930	
	Front, Upper, Right, SC1 Police . . . . .	8	1	----	----	2201 666
	Front, Upper, Left, SC1 Police . . . . .	8	1	----	----	2201 667
	Front, Lower, Right, SC1 Police . . . . .	8	1	----	----	2201 668
	Front, Lower, Left, SC1 Police . . . . .	8	1	----	----	2201 669
	Rear, SC1 Police . . . . .	8	2	----	----	2201 499
5-64-2	SCREW, Mounting, SP1, SP2, SD1, SD2 . . . . .		8	2072 615	2266 876	
	SD3 . . . . .	8	8	----	1943 840	1943 840
<b>5-67-0 WHEEL CYLINDER BLEEDER SCREW</b>						
5-67-1	SCREW, SP1, SP2, SD1, SD2 . . . . .		4	2072 658	2072 658	
	SD3 . . . . .	8	6	----	1261 834	1261 834
<b>5-69-0 WHEEL CYLINDER BOOT</b>						
5-69-1	BOOT, Front, SP1, SP2, SD1, SD2 . . . . .		4	2072 625	2260 840	
	Rear, SP1, SP2, SD1, SD3 . . . . .		4	2072 679	2260 846	
	Front and Rear, SD3 . . . . .	8	8	----	1136 872	1136 872
	Front and Rear, SC1 Police . . . . .	8	8	----	----	2201 498
<b>5-70-0 WHEEL CYLINDER PISTON</b>						
5-70-1	PISTON, Front, SP1, SP2, SD1, SD2 . . . . .		4	2072 655	2260 837	
	Rear, SP1, SP2, SD1, SD2 . . . . .		4	2072 656	2260 843	
	Front and Rear, SD3 . . . . .	8	8	----	1312 830	1312 830
	Rear, Police and Heavy Duty, 11" Brakes, w/13/16" bore . . . . .		4	----	ⓔ2401 938	

★ Indicates use as required.

Numerals in parentheses ( ) refer to notes.

Printed in U.S.A.

ⓔ Indicates parts not listed in any previous parts book.

Prices and specifications subject to change without notice.

\* Indicates change or addition.

March 8, 1963 Supersedes May 1, 1962.

# 1962 PASSENGER CAR PARTS CATALOG

BRAKE - SERVICE

CODE	PART NAME AND DESCRIPTION	C Y L.	PER CAR	VALIANT LANCER	PLYMOUTH DODGE	CHRYSLER IMPERIAL
<b>5-71-O WHEEL CYLINDER PISTON CUP</b>						
5-71-1	CUP, Front, SP1, SP2, SD1, SD2 . . . . .		4	1669 337	2260 838	
	Rear, SP1, SP2, SD1, SD2 . . . . .		4	2072 636	2260 844	
	Front and Rear, SD3 . . . . .	8	8	-----	*2260 838	*2260 838
	Rear, Police and Heavy Duty, 11" Brakes w/13/16" bore . . . . .		4	-----	*2072 636	
5-71-2	SPRING, Front, SP1, SP2, SD1, SD2 . . . . .		2	1923 765	2260 839	
	Rear, SP1, SP2, SD1, SD2 . . . . .		2	2072 637	1923 765	
	Front, SD3 . . . . .	8	4	-----	1614 894	1614 894
	Rear, SD3 . . . . .	8	2	-----	1633 106	1633 106
	Rear, Police and Heavy Duty, 11" Brakes w/13/16" bore . . . . .		2	-----	*2072 637	
<b>5-72-O WHEEL CYLINDER PISTON CUP EXPANDER</b>						
5-72-1	EXPANDER, Front and Rear Wheel, SD3 . . . . .	8	8	-----	1674 081	1674 081
<b>5-100-O POWER BRAKE POWER UNIT</b>						
5-100-1	SERVICE PACKAGE, for 2074 930 and 2279 993 Power Unit . . . . .	6	1	*2075 001		
	For 2401 148 and 2298 968 Power Unit . . . . .		1	-----	2421 082	
5-100-2	POWER UNIT . . . . .		1	*2074 930		
	SP1, SP2, SD1, SD2, . . . . .		1	-----	*2421 355	
	SD3 . . . . .	8	1	-----	2201 915	2201 915
5-100-20	ROD, Push, for 2401 148 and 2298 968 Power Unit . . . . .		1	-----	2401 168	
5-100-22	SCREW, Front Housing Spacer, for 2401 148 and 2298 968 Power Unit . . . . .		2	-----	2401 856	
	Front to Rear Housing, for 2401 148 and 2298 968 Power Unit . . . . .		10	-----	E2401 173	
5-100-26	BOOT, Push Rod, for 2401 148 and 2298 968 Power Unit . . . . .		1	-----	2401 165	
5-100-32	RETAINER, Push Rod, for 2401 148 and 2298 968 Power Unit . . . . .		1	-----	2401 166	
5-100-62	SCREW, Push Rod, for 2401 148 and 2298 968 . . . . .		1	-----	2401 852	
5-100-87	RING, Two Stage Reaction, for 2401 148 and 2298 968 Power Unit . . . . .		1	-----	E2401 866	
5-100-90	ADAPTOR, for 2401 148 and 2298 968 Power Unit . . . . .		1	-----	2401 170	
5-100-91	SEAL, Adaptor, for 2401 148 and 2298 968 Power Unit . . . . .		1	-----	2401 163	
	SEAL, Adaptor Retainer, for 2401 148 and 2298 968 Power Unit . . . . .		1	-----	E2401 171	
5-100-92	RING, Adaptor Snap, for 2401 148 and 2298 968 Power Unit . . . . .		1	-----	*2401 164	
5-100-94	CONNECTOR, Vacuum Hose, for 2401 148 and 2298 968 Power Unit . . . . .		1	-----	2401 159	
5-100-95	WASHER, Connector, for 2401 148 and 2298 968 Power Unit . . . . .		1	-----	2401 857	
5-100-105	REINFORCEMENT, Brake Pedal Bellows, SY1 . . . . .	8	1	-----	-----	1750 593

★ Indicates use as required.

Numerals in parentheses ( ) refer to notes.

Printed in U.S.A.

☐ Indicates parts not listed in any previous parts book.

Prices and specifications subject to change without notice.

March 8, 1963 Supersedes May 1, 1962.

\* Indicates change or addition.

CODE	PART NAME AND DESCRIPTION	C Y L.	PER CAR	VALIANT LANCER	PLYMOUTH DODGE	CHRYSLER IMPERIAL
<b>5-100-O POWER BRAKE POWER UNIT - Cont'd</b>						
5-100-161	SEAL, Vacuum, for 2071 072 and 2201 915 Power Unit . . . . .		1	----	2266 942	2266 942
	“O” RING, for 2071 072 and 2201 915 Power Unit . . . . .		1	----	2401 132	2401 132
	SEAL, Valve Body, for 2401 148 and 2298 968 Power Unit . . . . .		1	----	2401 163	
	SEAL, Sleeve, for 2401 148 and 2298 968 Power Unit . . . . .		1	----	2401 172	
5-100-166	RETAINER, Package, Plunger and Push Rod for 2401 148 and 2298 968 Power Unit . . . . .		1	----	2421 084	
5-100-167	BUSHING, Plunger, for 2401 148 and 2298 968 Power Unit . . . . .		2	----	2401 853	
5-100-195	RING, Lever Retaining, for 2401 148 and 2298 968 Power Unit . . . . .		1	----	2401 858	
	Diaphragm Retaining, for 2401 148 and 2298 968 Power Unit . . . . .		1	----	2401 161	
5-100-197	SILENCER, Valve Body, for 2201 915 Power Unit, SD3. . . . .	8	1	----	E2401 154	E2401 154
5-100-206	PLATE and SEAL ASSEMBLY, for 2201 915 Power Unit, SD3 . . . . .	8	1	----	E2401 126	E2401 126
5-100-209	GASKET, Power Brake Mounting to Dash . . . . .	6	1	1559 753		
5-100-210	WASHER, Seal, for 2071 072 and 2201 915 Power Unit . . . . .		1	----	2401 129	2401 129
<b>5-102-O POWER BRAKE VACUUM TANK</b>						
5-102-2	TANK . . . . .	6	1	2071 043		
5-102-11	NUT, Mounting . . . . .	6	★	2076 232		
<b>5-105-O POWER BRAKE VACUUM CHECK VALVE</b>						
5-105-1	VALVE . . . . .		1	2074 934		
	Use with 2071 072 and 2201 915 Power Unit . . . . .		1	----	2401 130	2401 130
	Use with 2401 148 and 2298 968 Power Unit . . . . .		1	----	2421 083	
<b>5-110-O POWER BRAKE TUBE CONNECTOR</b>						
5-110-18	CONNECTOR, w/o Heater . . . . .	6	1	1944 154		
	w/Heater . . . . .	6	1	1944 092		
	2 Way . . . . .		1	----	1944 092	1944 092
	3 Way . . . . .		1	----	1948 838	1948 838
<b>5-111-O POWER BRAKE VACUUM HOSE</b>						
5-111-17	HOSE, (11/32" I.D., sold by the inch) . . . . .		★	*1064 541	*1064 541	*1064 541
	(1/2" I.D., sold by the inch) . . . . .		★	*1671 650	*1671 650	*1671 650
<b>5-112-O POWER BRAKE HOSE CLAMP</b>						
5-112-1	CLAMP . . . . .		★	448 797	448 797	448 797
<b>5-113-O POWER BRAKE AIR CLEANER</b>						
5-113-17	FILTER, for 2401 148 and 2298 968 Power Unit . . . . .		1	----	2401 855	
	For 2201 915 Power Unit, SD3 . . . . .	8	1	----	E2401 155	E2401 155

★ Indicates use as required.

Numerals in parentheses ( ) refer to notes.

Printed in U.S.A.

E Indicates parts not listed in any previous parts book.

Prices and specifications subject to change without notice.

\* Indicates change or addition.

