

GROUP 16 - PROPELLER SHAFT AND UNIVERSAL JOINT

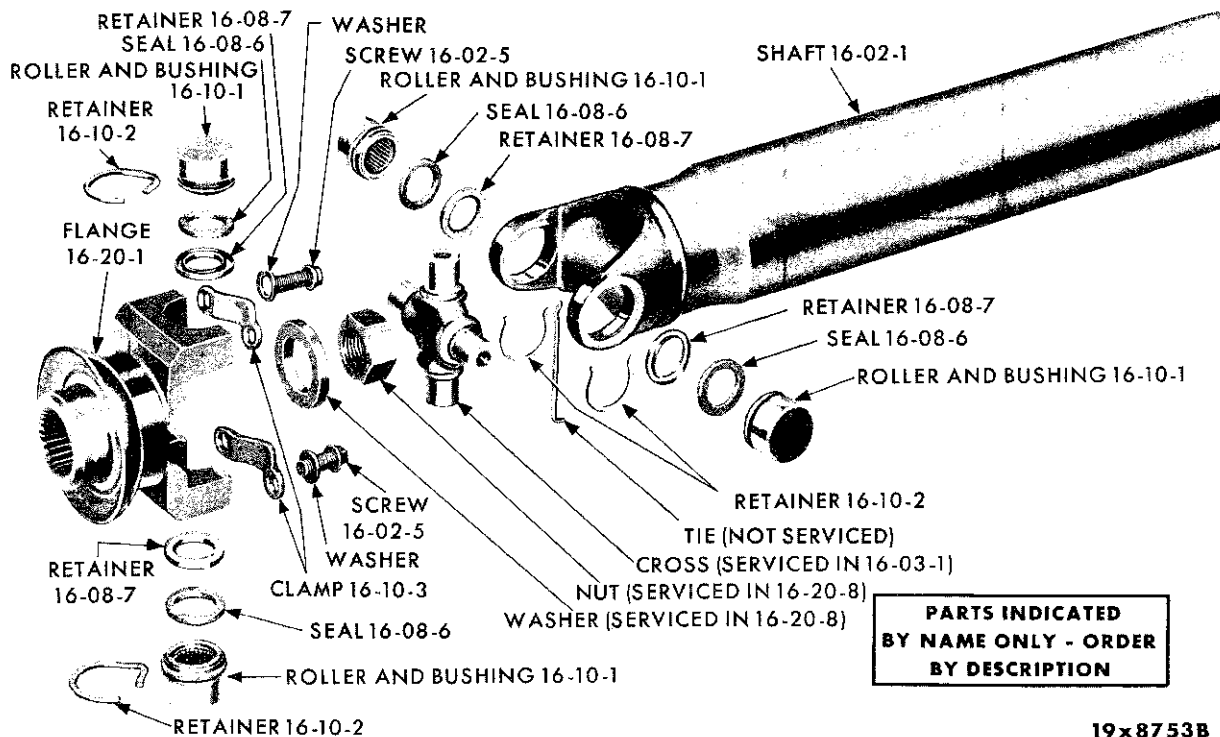

PROPELLER SHAFT - AXLE END

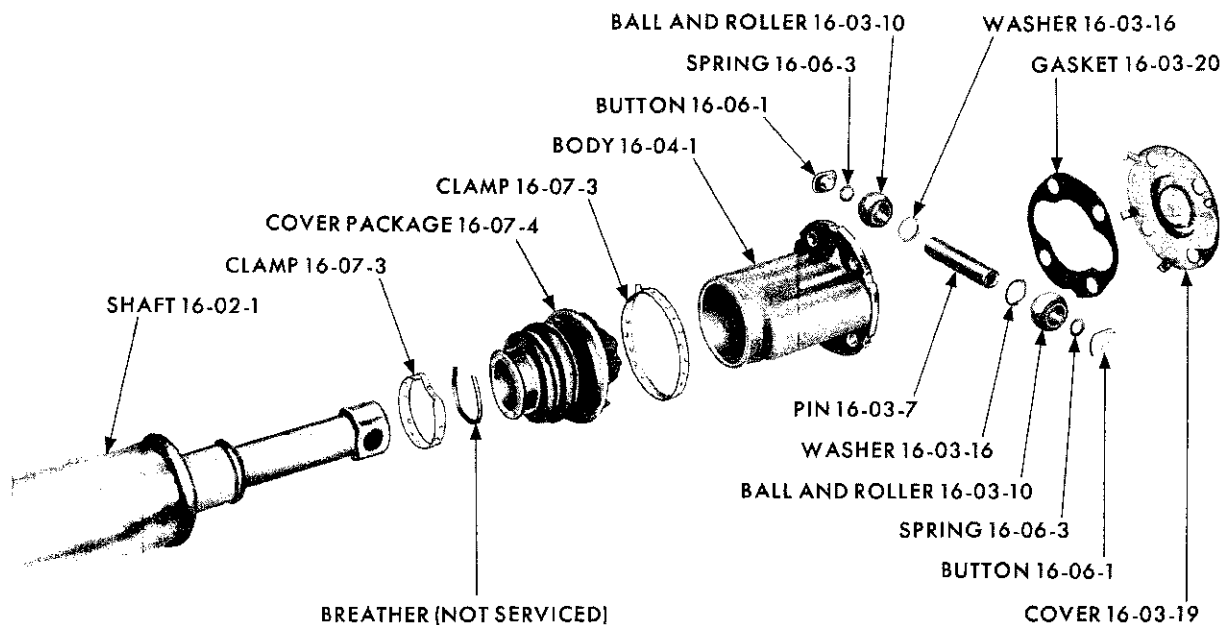

PROPELLER SHAFT - TRANSMISSION END

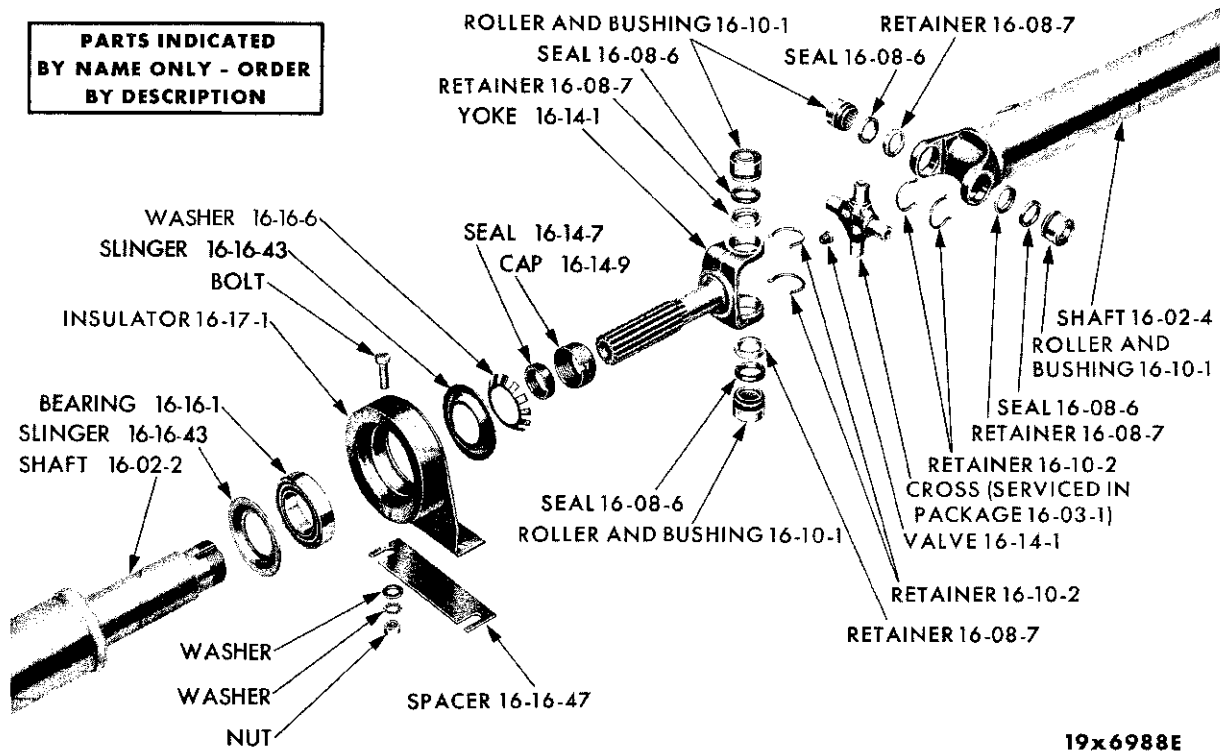

19x6988E

PROPELLER SHAFT CENTER BEARING - IMPERIAL SY1

NOTES

Lined area for notes, currently blank.

CODE	PART NAME AND DESCRIPTION	CYL.	PER CAR	VALIANT LANCER	PLYMOUTH DODGE	CHRYSLER IMPERIAL
------	---------------------------	------	---------	----------------	----------------	-------------------

16-02-0 PROPELLER SHAFT

NOTE 1: Used w/Propeller Shaft No. 2071 017, 2269 974, 2401 359, 2401 362.
 NOTE 2: Used w/Propeller Shaft No. 2401 355, 2206 994, 2200 534, 2401 351, 2401 641, 2401 669.
 NOTE 3: Used w/Propeller Shaft No. 2206 974, 2071 017.
 NOTE 4: Used w/Propeller Shaft No. 2401 359, 2401 362.
 NOTE 5: Used w/Propeller Shaft No. 2401 355, 2401 351.
 NOTE 6: Used w/Propeller Shaft No. 2206 994, 2200 534.
 NOTE 7: When it becomes necessary to service Propeller Shafts or Front Universal Joints on cars with the 413 cu. in. Eng., Police Cars, it is recommended that the Shaft be replaced as a complete assembly.

16-02-1	SHAFT, 53 3/8" lgh., 2 3/4" dia., w/Std. and 3 Speed Auto. Trans. w/3.23, 3.55 Axle Ratio, 170 cu. in. Eng.	6	1	2071 017		
	SHAFT, 53 3/8" lgh., 3" dia., w/Std. Trans., 3.91 Axle Ratio, 170 cu. in. Eng., w/Std. and 3 Speed Trans., 225 cu. in. Eng.	6	1	2206 974		
	53 7/8" lgh. 2 3/4" dia., w/3 Speed Auto. Trans.	6	1	----	2401 359	
	53 3/4" lgh., 2 3/4" dia., SP1, SD1, w/Std. and Std. Heavy Duty Trans., SP2, SD2, w/Std. Trans.		1	----	*2401 362	
	55 7/8" lgh., 3" dia., SP2, SD2, w/Std. Trans.	8	1	----	*2401 351	
	55 7/8" lgh., 3" dia., SP2, SD2, w/Std. Heavy Duty Trans., Includes U/JOINTS, Police Cars	8	1	----	*2401 350	
	53 5/8" lgh., 2 3/4" dia., SP2, SD2, w/3 Speed Auto. Trans.	8	1	----	*2401 355	
	58 3/4" lgh., 3" dia., SD3, w/Std. Heavy Duty Trans., 361 cu. in. Eng., SC1, w/Std. Heavy Duty and 3 Speed Auto. Trans., 361 cu. in. Eng., SC2 w/Heavy Duty and 3 Speed Auto. Trans., 413 cu. in. Eng., SC2, w/Heavy Duty and 3 Speed Auto. Trans., 383 cu. in. Eng., Police Cars	8	1	----	*2401 641	*2401 641
	59 1/4" lgh., 3" dia., SD3, w/Std. Heavy Duty Trans., 361 cu. in. Eng., SC1, w/Std. Heavy Duty and 3 Speed Auto. Trans., 361 cu. in. Eng., SC2 w/Std. Heavy Duty and 3 Speed Auto. Trans., 413 cu. in. Eng., SC2, w/Heavy Duty Std. Trans. and 3 Speed Auto. Trans., 383 cu. in. Eng. Police Cars	8	1	----	*2206 994	*2206 994
	53 5/8" lgh., 2 3/4" dia., w/3 Speed Auto. Trans., SP2, SD2, w/413 cu. in. Eng., Also SP2, SD2, Police Cars, includes U/JOINTS.	8	1	----	*2401 356	
	54" lgh., 3" dia., SP2, SD2, w/Std. Heavy Duty Trans., 413 cu. in. Eng., includes U/JOINTS	8	1	----	*2401 668	
	59 1/4" lgh., 3 1/4" dia., SD3, SC1, SC2, SC3, w/3 Speed Auto. Trans.	8	1	----	2200 534	2200 534
16-02-2	SHAFT, Front, SY1	8	1	----	----	2200 527
16-02-4	SHAFT, Rear, SY1	8	1	----	----	1946 297
16-02-5	SCREW, Axle End, 9/16" lgh., 1/4" dia.		4	952 538	952 538	952 538
	BOLT, Trans. End, 1 5/16" lgh., 3/8" dia.	8	4	----	1326 773	1326 773
	BOLT, Trans. End, 1 1/4" lgh. 3/8" dia.		4	1942 069	1942 069	1942 069

16-03-0 UNIVERSAL JOINT

16-03-1	JOINT PACKAGE, Ball and Pin Type, w/Std. and 3 Speed Auto. Trans.	6	1	2298 940		
	JOINT PACKAGE, Ball and Pin Type, SP1, SD1, w/Std. and 3 Speed Auto. Trans., Note 1		1	----	*2298 940	
	JOINT PACKAGE, Ball and Pin Type, SP2, SD2, w/Std. and 3 Speed Auto. Trans., Note 2	8	1	----	----	*2298 941

★ Indicates use as required. Numerals in parentheses () refer to notes. Printed in U.S.A.
 ☐ Indicates parts not listed in any previous parts book. Prices and specifications subject to change without notice.
 * Indicates change or addition. Page 16-3 March 8, 1963 Supersedes May 1, 1962.

1962 PASSENGER CAR PARTS CATALOG

PROPELLER SHAFT
AND UNIV. JOINT

CODE	PART NAME AND DESCRIPTION	C Y L.	PER CAR	VALIANT LANCER	PLYMOUTH DODGE	CHRYSLER IMPERIAL
16-03-0 UNIVERSAL JOINT - Cont'd						
16-03-1	JOINT PACKAGE, Ball and Pin Type, SD3, SC1, SC2, w/Std. Heavy Duty Trans., SD3, SC1, SC2, SC3, w/3 Speed Auto. Trans.	8	1	-----	-----	2298 941
	JOINT PACKAGE, Cross and Roller Type, SV1, SL1, SP1, SD1, w/Std. and 3 Speed Auto. Trans., SP2, SD2, SD3, SC1, SC2, w/Heavy Duty and 3 Speed Auto. Trans., SC3, SY1		*	1752 624	1752 624	1752 624
16-03-3	ROLLER		1	* 638 637	* 638 637	* 638 637
16-03-7	PIN, Note 1		1	579 445	579 445	579 445
	Note 2		1	1739 923	1739 923	1739 923
16-03-10	BALL, w/ROLLER		2	1739 927	1739 927	1739 927
16-03-16	WASHER, Thrust		1	605 004	605 004	605 004
16-03-19	COVER, Grease, Note 3		1	602 820	602 820	602 820
	Note 6		1	1635 092	1635 092	1635 092
	Note 4		1	2266 923	2266 923	2266 923
	Note 5		1	2266 922	2266 922	2266 922
16-03-20	GASKET, Note 1		1	1616 185	1616 185	1616 185
	Note 2		1	1635 098	1635 098	1635 098
16-04-0 UNIVERSAL JOINT BODY						
16-04-1	BODY, Note 1		1	1734 159	1734 159	1734 159
	Note 2	8	1	-----	1739 920	1739 920
16-06-0 UNIVERSAL JOINT CENTERING BUTTON						
16-06-1	BUTTON, Note 1		2	629 768	629 768	629 768
	Note 2		2	-----	1739 924	1739 924
16-06-3	SPRING, Centering Button		2	1739 926	1739 926	1739 926
16-07-0 UNIVERSAL JOINT COVER						
16-07-3	CLAMP, Cover, Small		1	870 540	870 540	870 540
	Large, Note 1		1	870 539	870 539	870 539
	Large, Note 2		1	1532 943	1532 943	1532 943
16-07-4	COVER PACKAGE, Dust, Note 1		1	1603 397	1603 397	1603 397
	Note 2		1	-----	2275 514	2275 514
16-08-0 UNIVERSAL JOINT CROSS						
16-08-6	SEAL, Dust		4	857 999	857 999	857 999
16-08-7	RETAINER, Seal		4	1739 912	1739 912	1739 912
16-10-0 UNIVERSAL CROSS ROLLER AND BUSHING						
16-10-1	ROLLER, w/BUSHING		4	1739 913	1739 913	1739 913
16-10-2	RETAINER, Roller Bushing		2	858 006	858 006	858 006
16-10-3	CLAMP, Roller Bushing		2	1828 824	1828 824	1828 824

★ Indicates use as required.

Numerals in parentheses () refer to notes.

Printed in U.S.A.

⊔ Indicates parts not listed in any previous parts book.

Prices and specifications subject to change without notice.

March 8, 1963 Supersedes May 1, 1962.

* Indicates change or addition.

CODE	PART NAME AND DESCRIPTION	CYL	PER CAR	VALIANT LANCER	PLYMOUTH DODGE	CHRYSLER IMPERIAL
16-14-O PROPELLER SHAFT SPLINE OR SLIDING YOKE						
16-14-1	YOKE, SY1		1	----	----	1739 915
	VALVE, Pressure Release, SY1		1	----	----	* 106 671
16-14-7	SEAL, Spline, SY1		1	----	----	1672 049
16-14-9	CAP, Seal, SY1		1	----	----	1672 050
16-16-O PROPELLER SHAFT CENTER BEARING						
16-16-1	BEARING, SY1		1	----	----	1672 051
16-16-6	WASHER, Lock, SY1		1	----	----	1638 151
16-16-25	RING, Shaft Bearing Snap, Outer, Thin		★	640 280	640 280	640 280
16-16-43	SLINGER, Bearing Dust, SY1		1	----	----	1672 053
16-16-47	SPACER, Bearing, except Conv. Cp., SY1		★	----	----	1945 836
	Conv. Cp., SY1		★	----	----	1856 944
16-17-O PROPELLER SHAFT CENTER BEARING HOUSING INSULATOR						
16-17-1	INSULATOR, except Cv. Cp., SY1		1	----	----	1945 831
	Cv. Cp., SY1		1	----	----	1856 942
16-20-O PROPELLER SHAFT FLANGE						
NOTE: For Trans. Shaft Flange not shown see Part Type Code 4-01-1 Hand Brake Drum and Flange Assembly.						
16-20-1	FLANGE, Trans. End, w/Std. and 3 Speed Auto. Trans.	6	1	1949 378	----	----
	Heavy Duty Std. Trans.	6	1	----	2400 012	
	w/3 Speed Auto. Trans.	6	1	----	2400 010	
	w/Std. Trans.	6	1	----	2124 279	
	Heavy Duty Std. Trans. and 3 Speed Auto. Trans.	8	1	----	2400 013	2125 130
	Std. Trans.	8	1	----	2400 011	
	ADAPTER, Trans. Flange, SY1	8	1	----	----	2200 214
	FLANGE PACKAGE, Axle End		1	2240 614	2240 612	2240 612
16-20-2	WASHER, Axle End		1	2070 117	1556 556	1556 556
16-20-3	NUT, Axle End		1	1556 638	1556 638	1556 638
16-20-5	SCREW, Trans. Flange		4	1942 069	1942 069	
	w/Internal Brake	8	4	----	1326 773	1326 773
	Axle End		4	952 538	952 538	952 538
16-20-8	NUT PACKAGE, Trans. Output Flange, includes WASHER		1	*2298 967	*2298 967	*2298 967

NOTES

★ Indicates use as required. Numerals in parentheses () refer to notes. Printed in U.S.A.
 □ Indicates parts not listed in any previous parts book. Prices and specifications subject to change without notice.
 * Indicates change or addition. Page 16-5 March 8, 1963 Supersedes May 1, 1962.

