

GROUP 5 - BRAKE-SERVICE

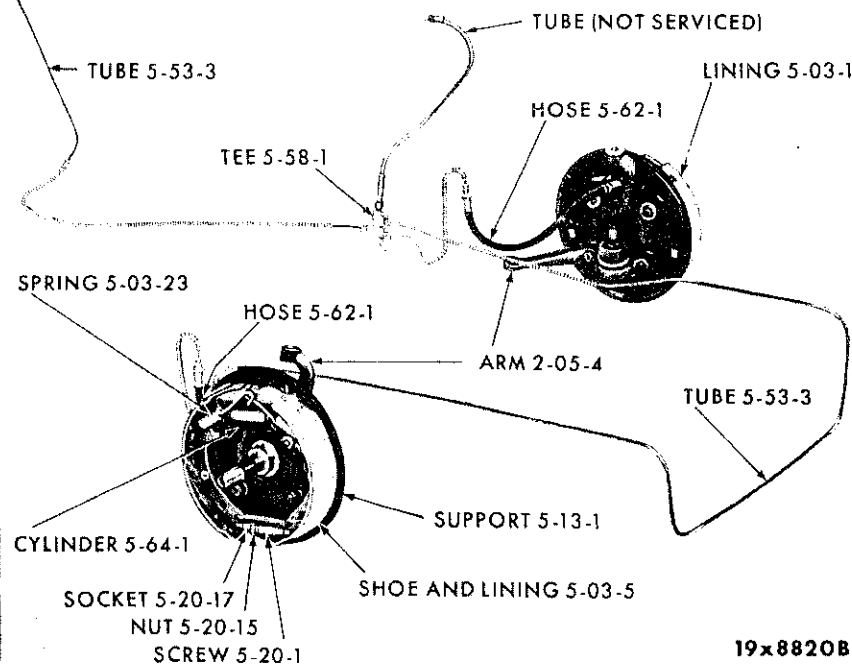

19x8820B

HYDRAULIC BRAKE SYSTEM - VALIANT RV1

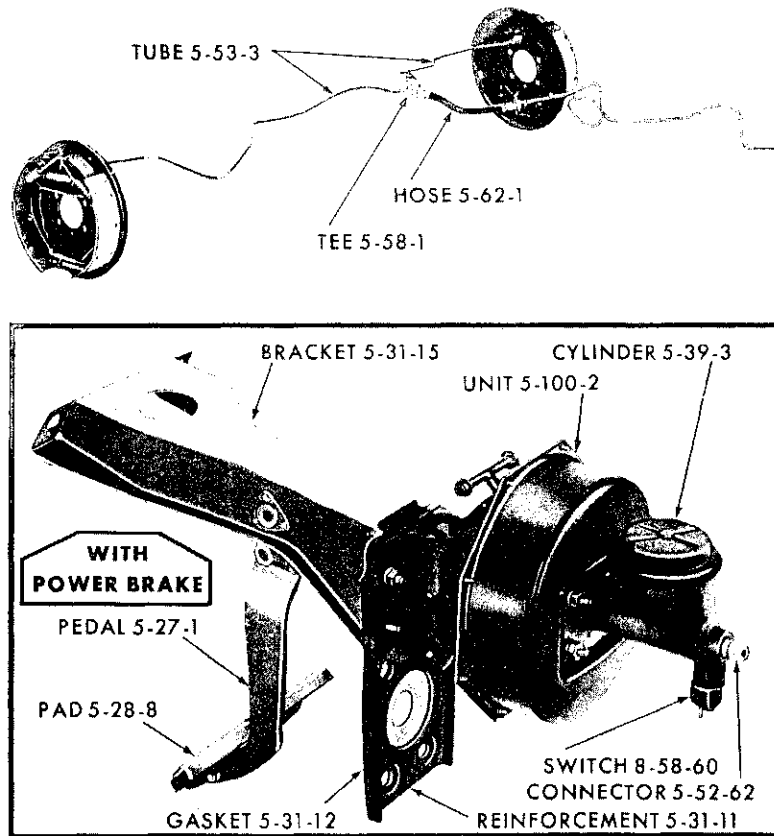
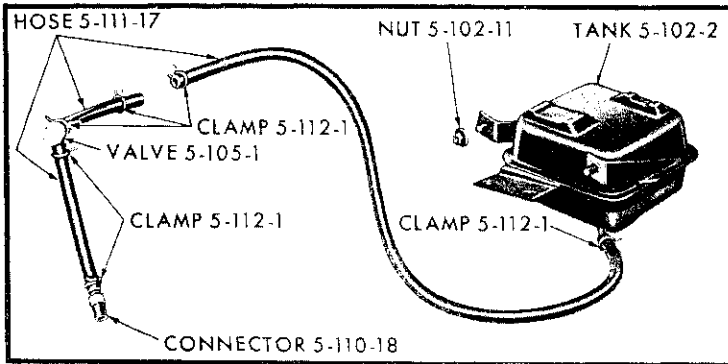
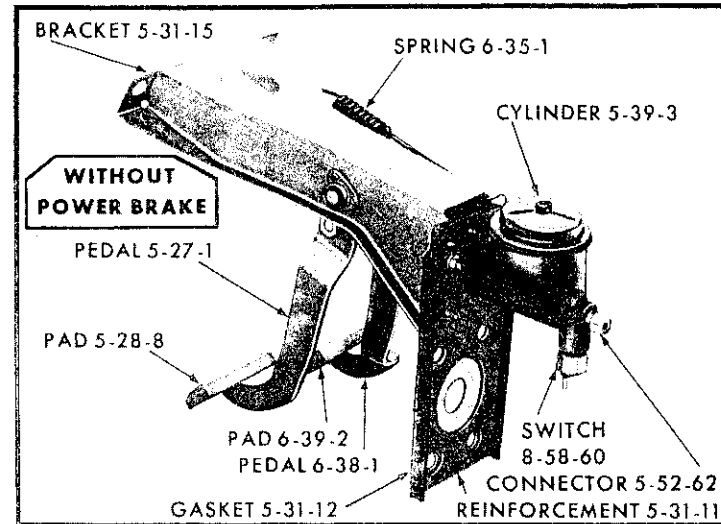
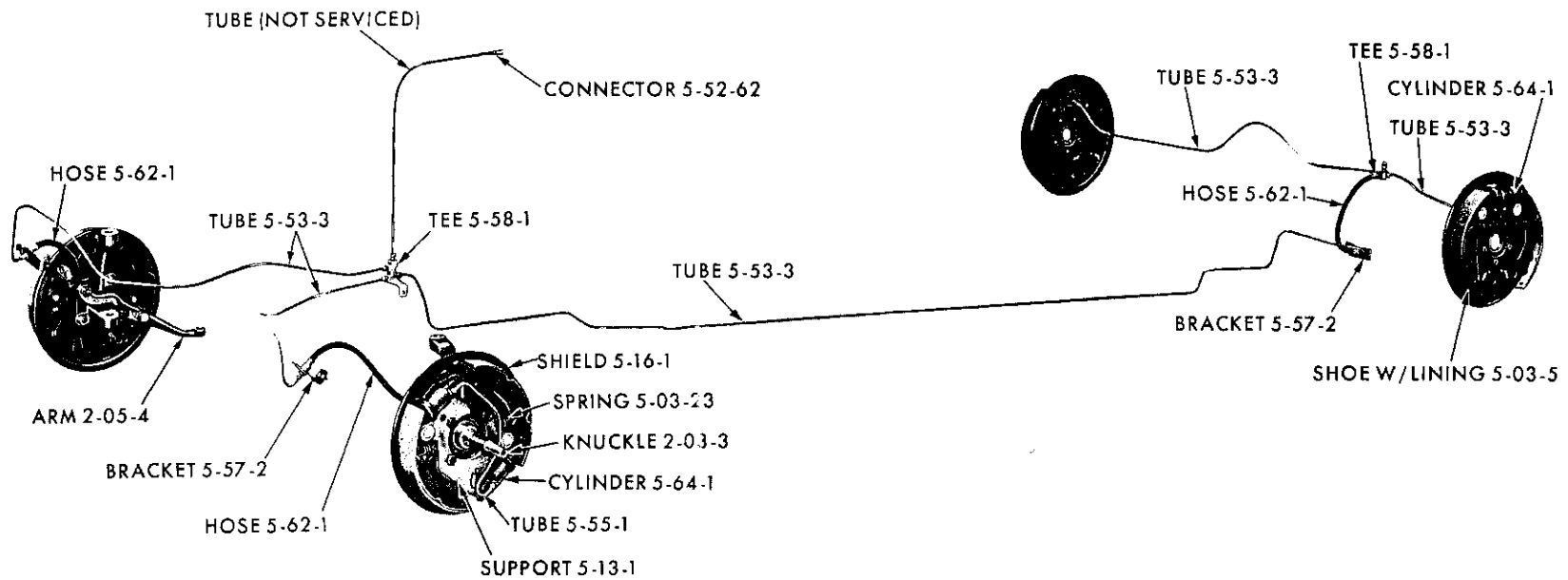
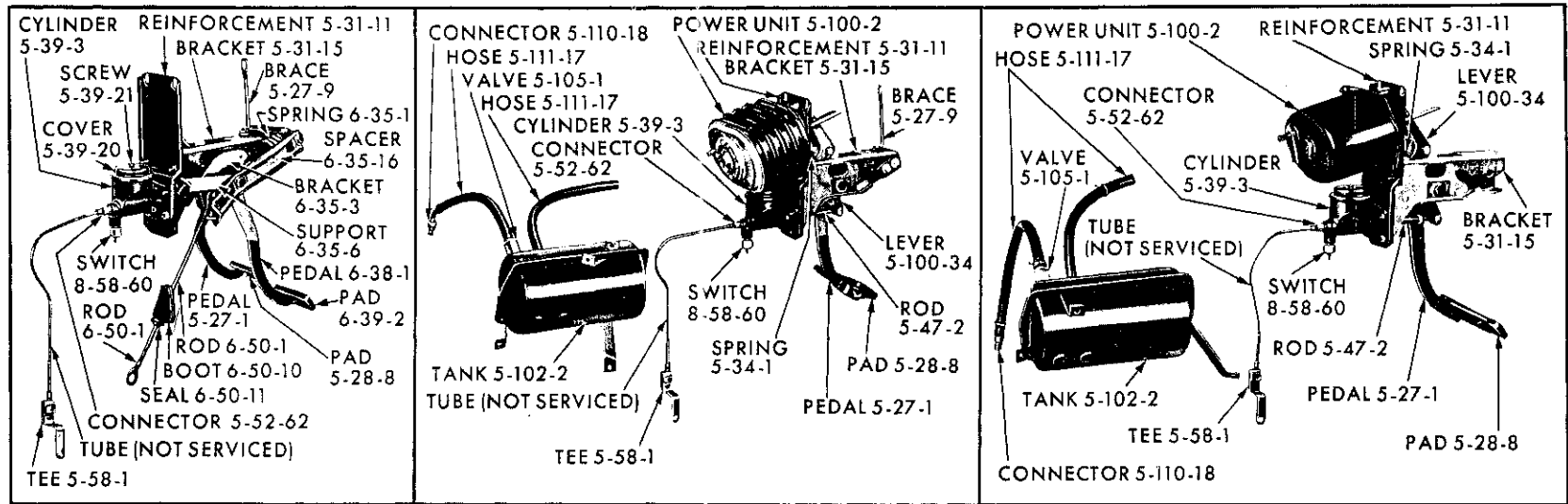

HYDRAULIC BRAKE SYSTEM - EXCEPT VALIANT RV1

19x8500C

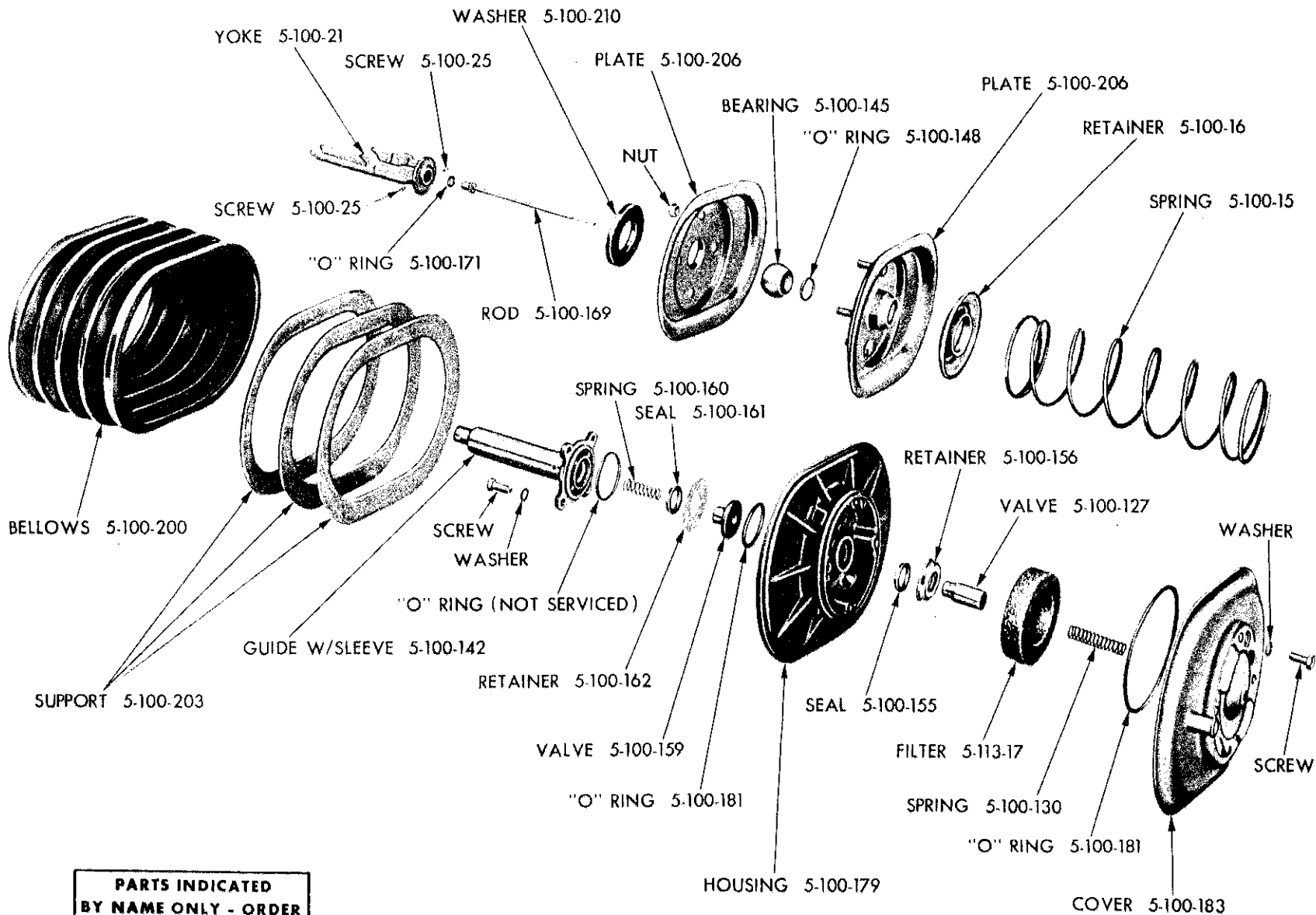

**PARTS INDICATED
 BY NAME ONLY - ORDER
 BY DESCRIPTION**

19x6981A

POWER BRAKE POWER UNIT (BELLOWS TYPE) - EXCEPT VALIANT RV1

**PARTS INDICATED
BY NAME ONLY - ORDER
BY DESCRIPTION**

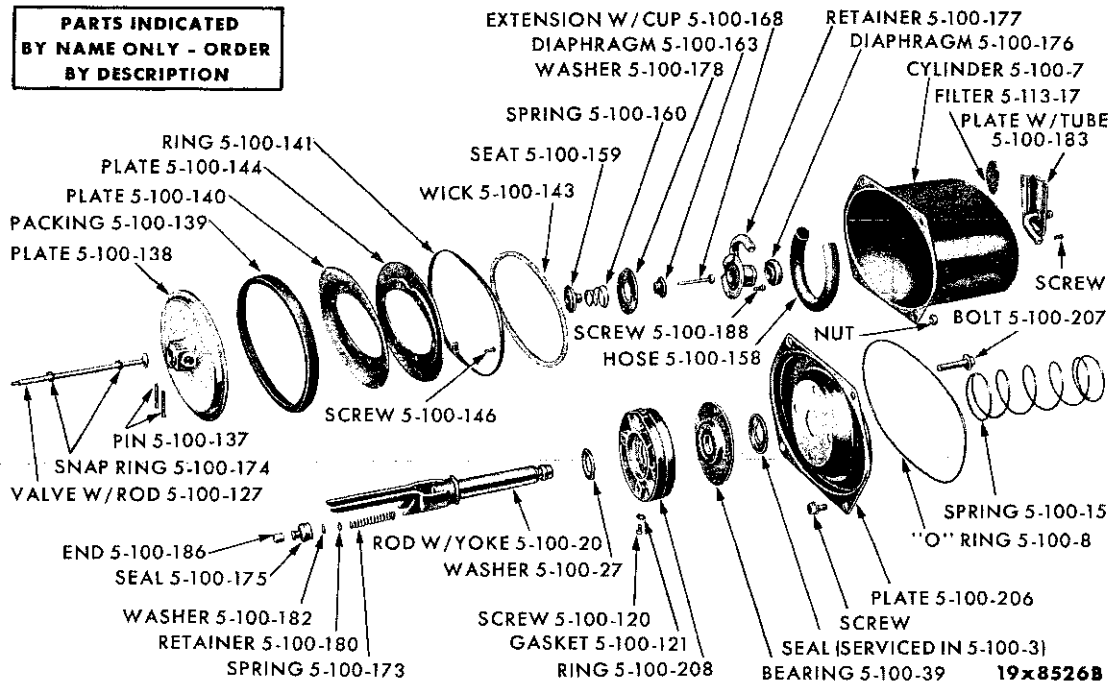

POWER BRAKE POWER UNIT (CYLINDER TYPE) - EXCEPT VALIANT RV1

NOTES

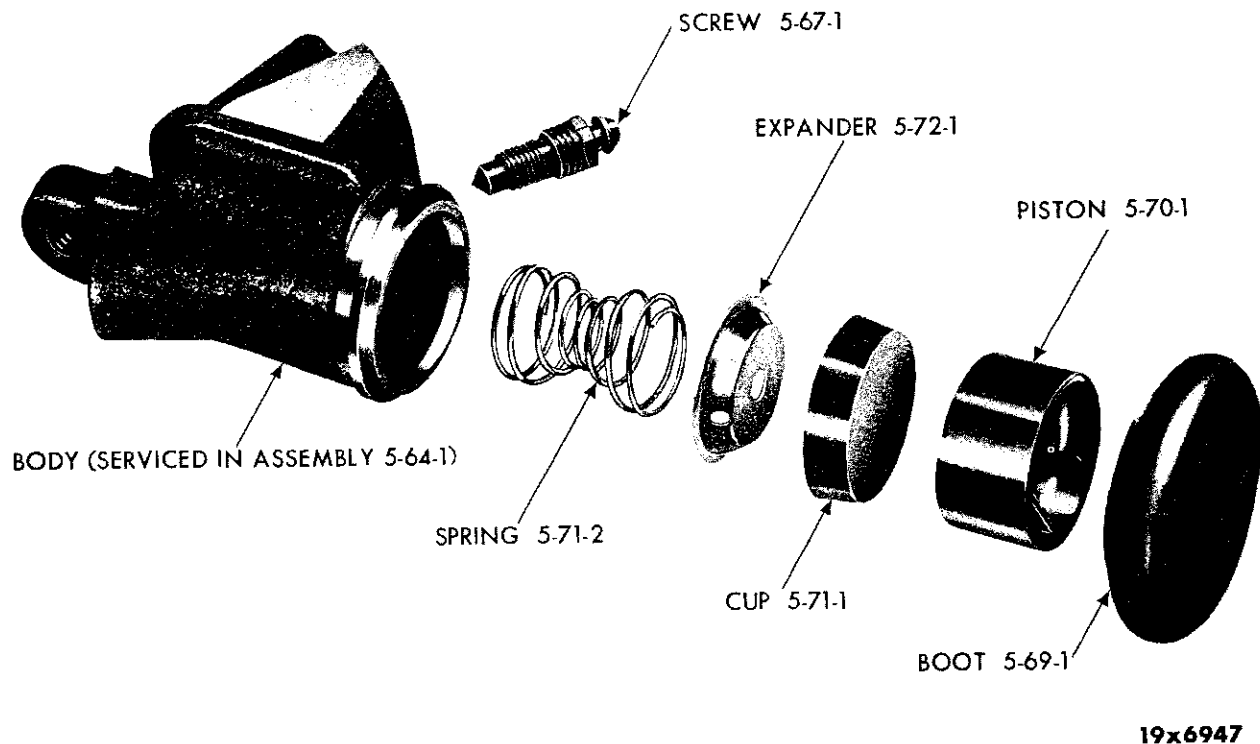

FRONT WHEEL BRAKE CYLINDER - EXCEPT VALIANT RV1

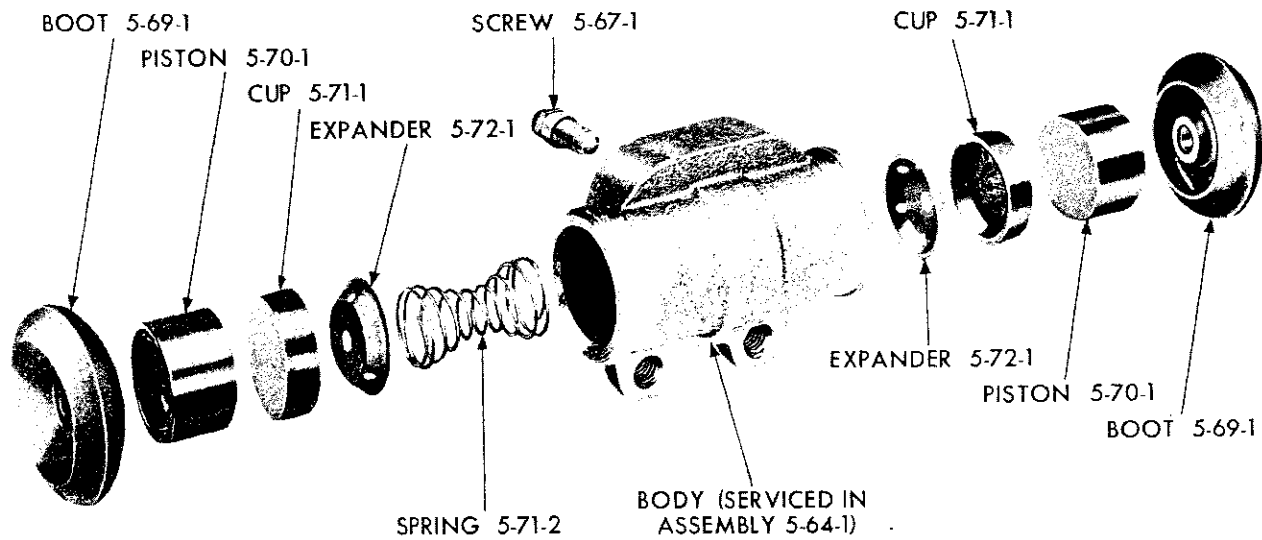

19x6949A

REAR WHEEL BRAKE CYLINDER - EXCEPT VALIANT RV1

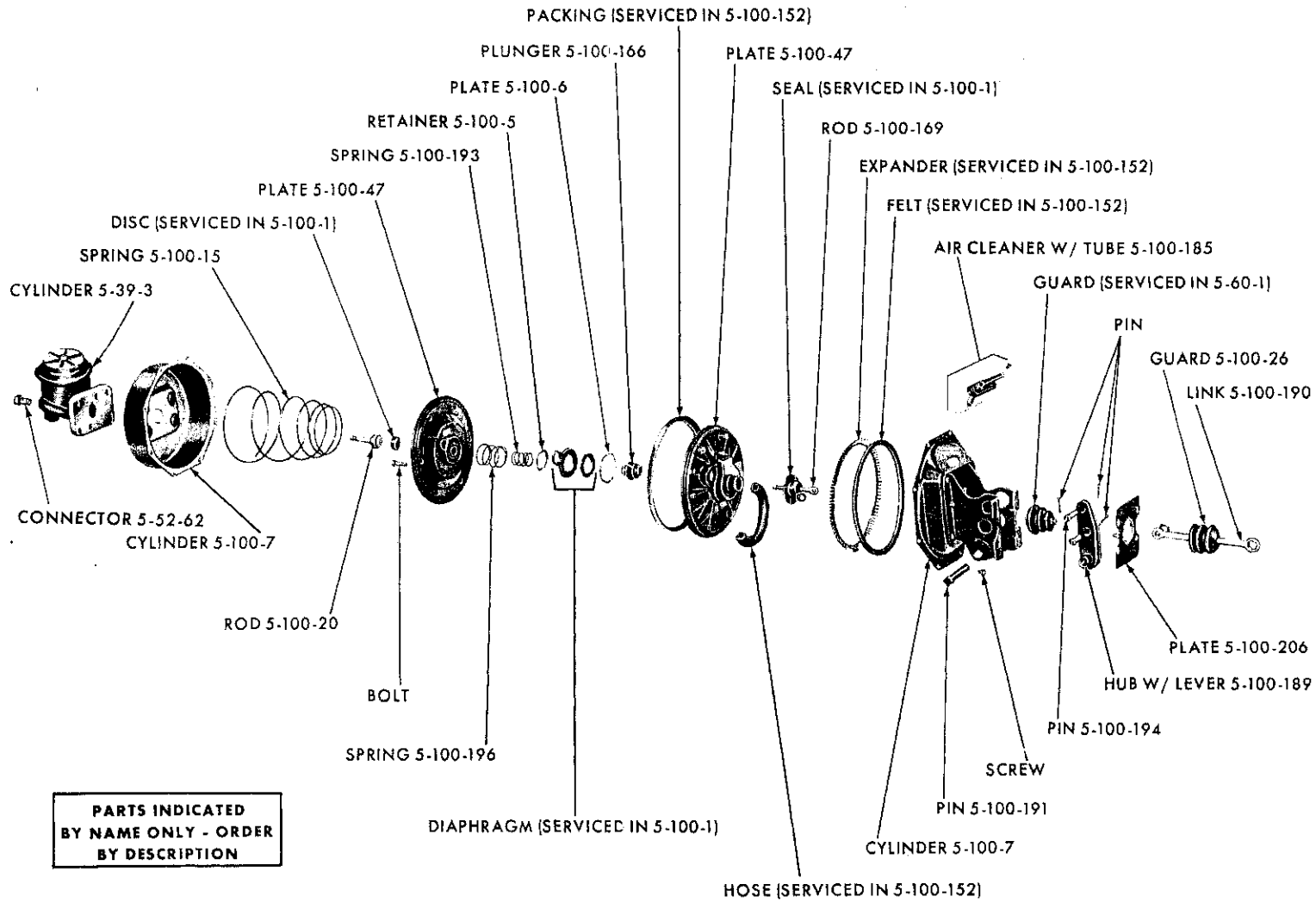

**PARTS INDICATED
BY NAME ONLY - ORDER
BY DESCRIPTION**

19x8754A

POWER BRAKE - VALIANT RV1

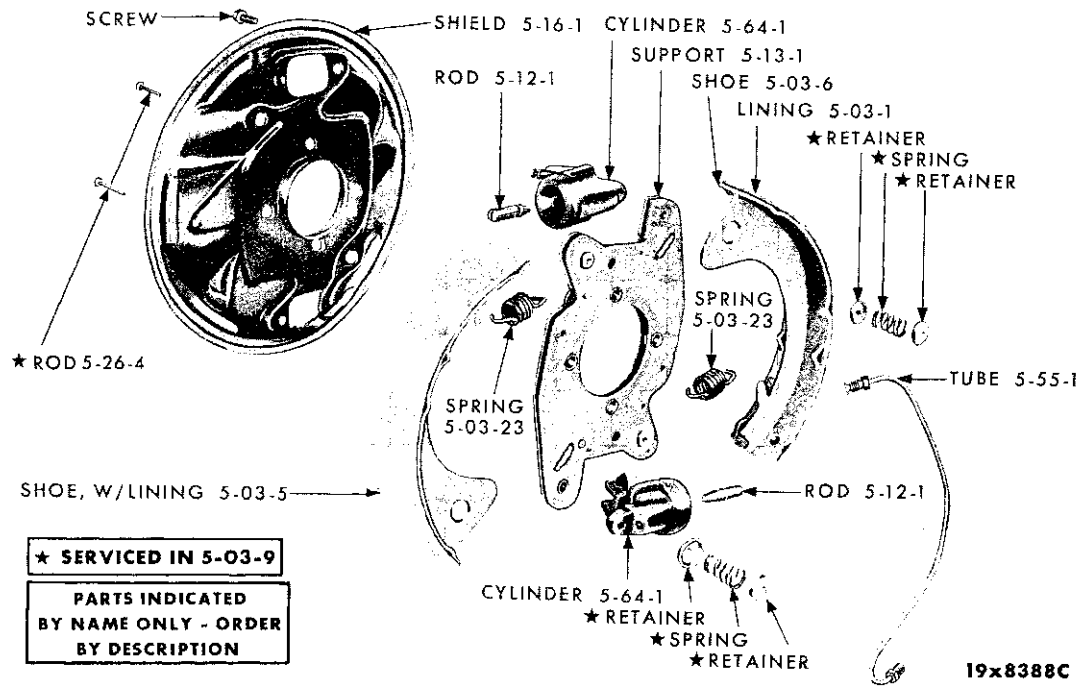

FRONT WHEEL BRAKE - EXCEPT VALIANT RV1

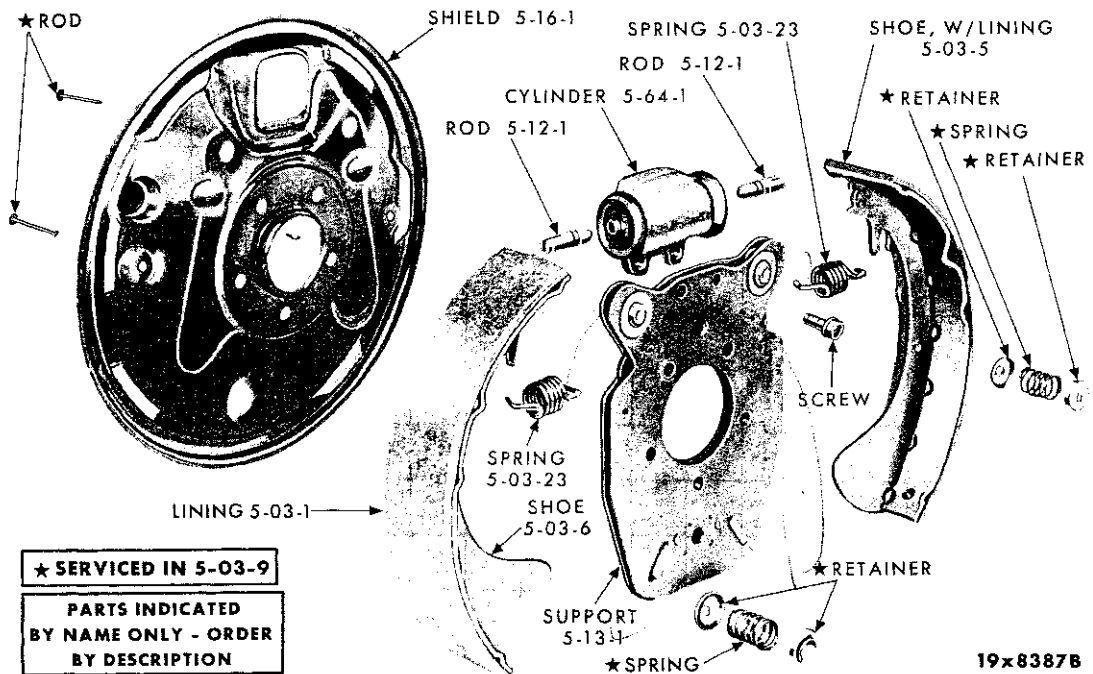

REAR WHEEL BRAKE - EXCEPT VALIANT RV1

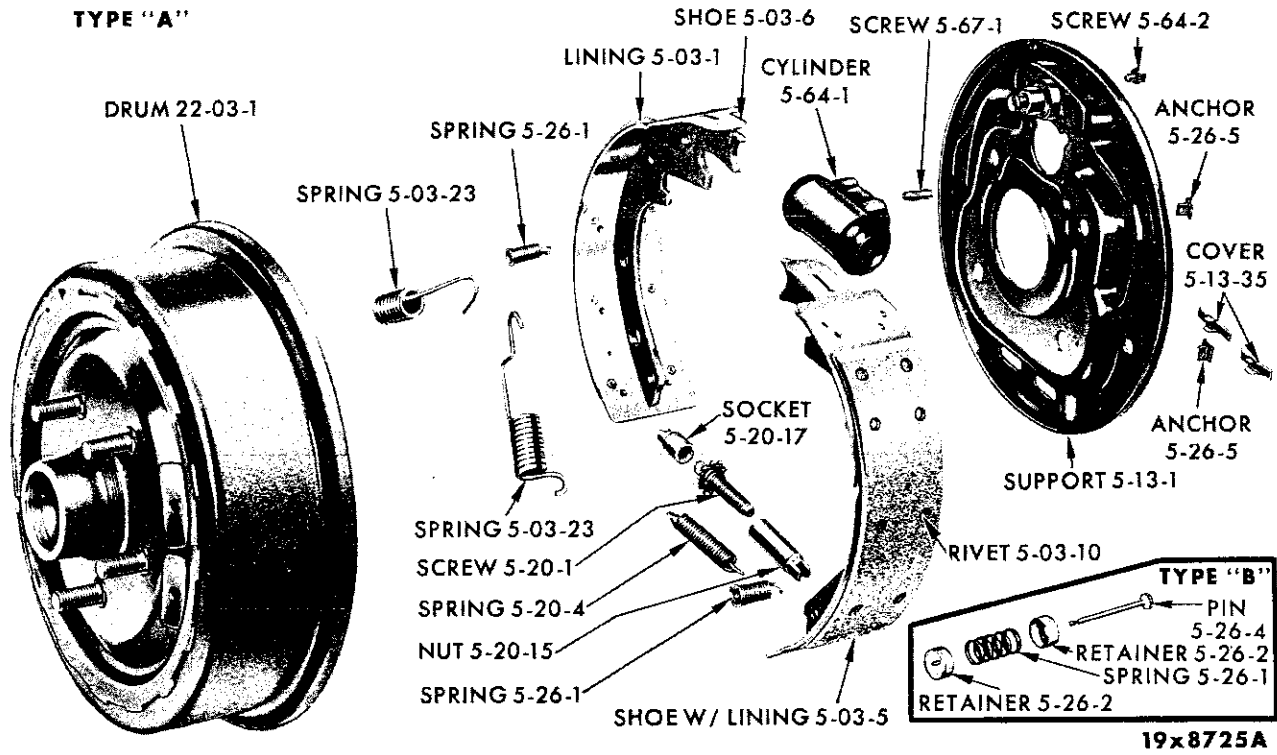

FRONT WHEEL BRAKE - VALIANT RV1

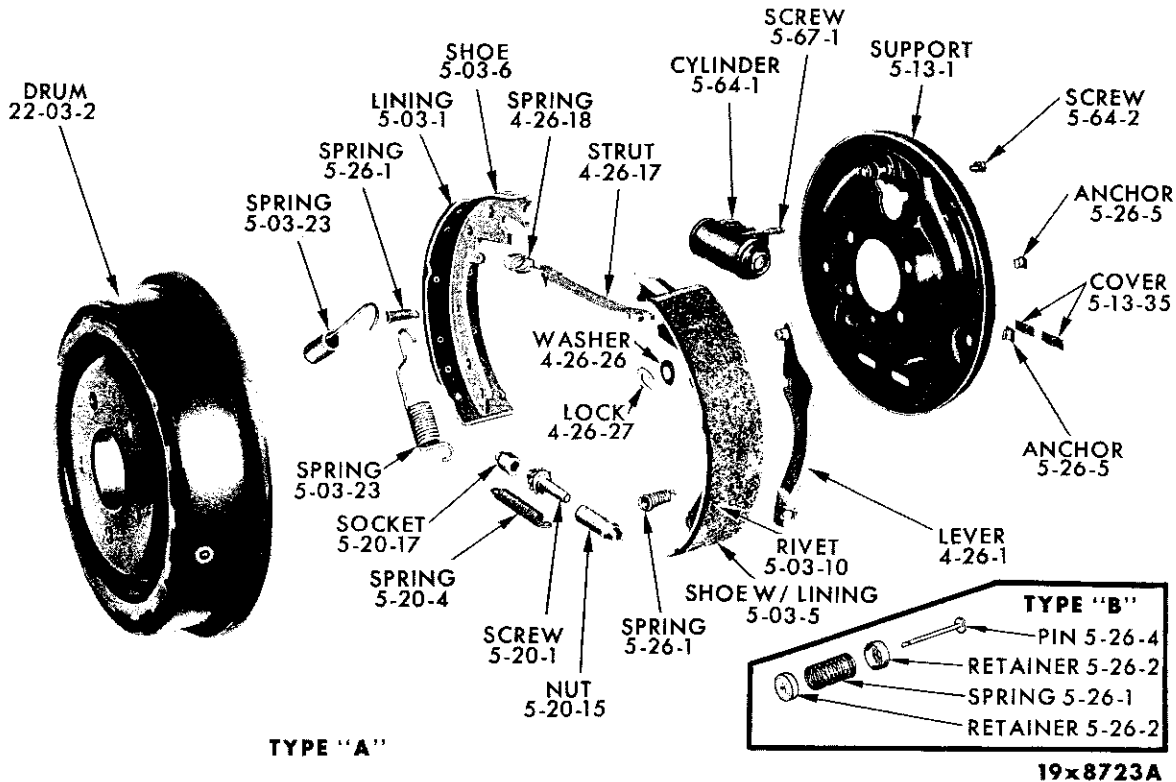

REAR WHEEL BRAKE - VALIANT RV1

PARTS INDICATED BY NAME ONLY ARE STANDARD PARTS - ORDER BY DESCRIPTION.

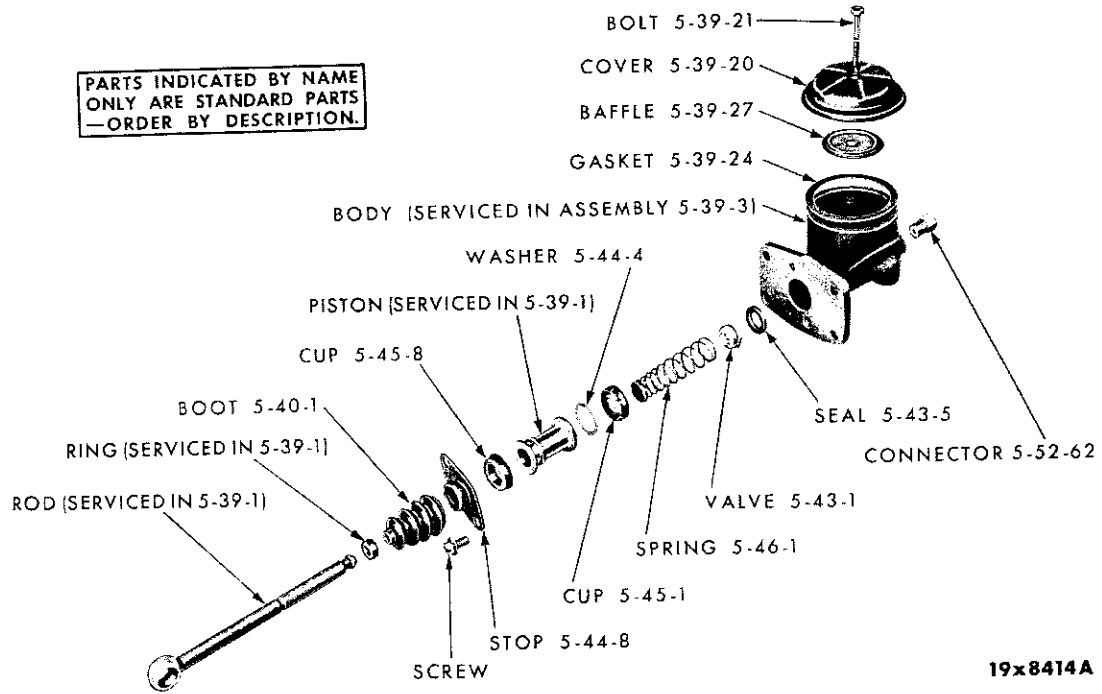

MASTER CYLINDER

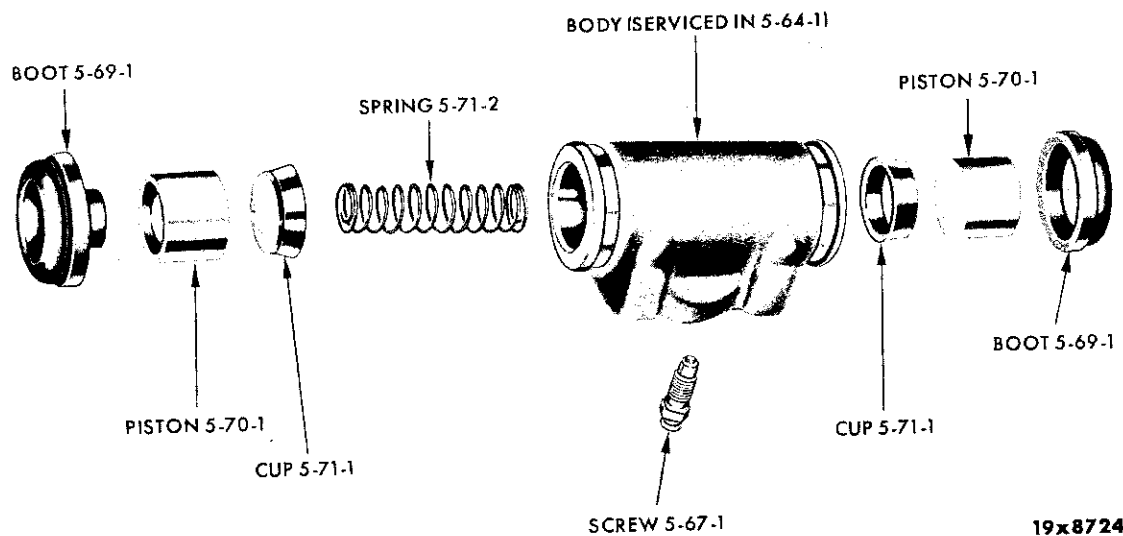

WHEEL CYLINDER - VALIANT RV1

CODE	PART NAME AND DESCRIPTION	CYL.	PER CAR	VALIANT	PLYMOUTH	DESOTO	CHRYSLER	IMPERIAL
5-01-0 BRAKE FLUID								
5-01-2	BRAKE FLUID, 8 oz. Can . . .		★	1879 268	1879 268	1879 268	1879 268	1879 268
	1 Pint Can		★	1879 269	1879 269	1879 269	1879 269	1879 269
	1 Quart Can		★	1879 270	1879 270	1879 270	1879 270	1879 270
	1 Gallon Can		★	1879 271	1879 271	1879 271	1879 271	1879 271
	5 Gallon Can		★	1879 272	1879 272	1879 272	1879 272	1879 272
	30 Gallon Drum		★	1879 273	1879 273	1879 273	1879 273	1879 273
5-03-0 WHEEL BRAKE SHOE AND LINING								
5-03-1	LINING PACKAGE	6	1	2196 077				
	11" x 2" Brakes, RP1, RP2, except Sub.		1	----	2240 387			
	Sub.		1	----	1879 398			
	Taxi		1	----	B2298 517			
	11" x 2 1/2" Brakes, RS1, RC1 except Sub., RC2		1	----	----	1879 401	1879 401	
	12" x 2 1/2" Brakes		1	----	2196 092	2196 092	2196 092	1879 404
	12" x 2 1/2" Brakes, Police Cars		1	----	1879 690	----	1879 690	
5-03-5	SHOE, w/LINING, Front Wheel, Front Shoe	6	2	2072 660				
	Front Wheel, Rear Shoe	6	2	2072 661				
	Rear Wheel, Front Shoe	6	2	2072 666				
	Rear Wheel, Rear Shoe	6	2	2072 667				
	Front Wheel, 11" x 2" Brakes, except Sub.		4	----	2207 504			
	Front Wheel, 11" x 2 1/2" Brakes, RP1, RP2, Sub., RC1 except Sub., RC2		4	----	1948 139	1948 139	1948 139	
	Rear Wheel, 11" x 2" Brakes		4	----	1943 814			
	Rear Wheel, 11" x 2 1/2" Brakes, RC1 except Sub., RC2		4	----	----	1948 139	1948 139	
	Front and Rear Wheels, Taxi		8	----	B2265 795			
	Front and Rear Wheels, 12" x 2 1/2" Brakes		8	----	2200 122	2200 122	2200 122	
	Front and Rear Wheels, 12" x 2 1/2" Brakes, Front Shoe		8	4	----	----	----	1857 063
	Front and Rear Wheels, 12" x 2 1/2" Brakes, Rear Shoe		8	4	----	----	----	2200 122
	12" x 2 1/2" Brakes, Police Cars		8	----	2200 118	----	2200 118	
5-03-6	SHOE, Front Wheel	6	4	2072 664				
	Rear Wheel	6	4	2072 670				
	Front Wheel, 11" x 2" Brakes, except Sub.		4	----	1943 805			
	11" x 2 1/2" Brakes, RP1, RP2, Sub., RC1 except Sub., RC2		4	----	1943 806	1943 806	1943 806	
	Rear Wheel, 11" x 2" Brakes		4	----	1943 805			
	11" x 2 1/2" Brakes, RC1 except Sub., RC2		8	4	----	1943 806	1943 806	
	Front and Rear Wheels, 12" x 2 1/2" Brakes		8	----	1943 674	1943 674	1943 674	1943 674
5-03-9	DAMPENER PACKAGE		8	----	2084 257	2084 257	2084 257	2084 257
5-03-10	RIVET, Lining	6	80	1664 537				
5-03-23	SPRING, Shoe Return	6	8	2072 719				
	11" Brakes, RC1 except Sub., RC2		8	----	*2266 881	*2266 881	*2266 881	
	12" Brakes		8	----	*2267 066	*2267 066	*2267 066	*2267 066
5-12-0 WHEEL CYLINDER PISTON PUSH ROD								
5-12-1	ROD		8	----	1329 890	1329 890	1329 890	1329 890
5-13-0 WHEEL BRAKE SUPPORT								
5-13-1	SUPPORT, Front	6	2	2072 609				
	Rear, Right	6	1	2072 628				
	Rear, Left	6	1	2072 629				

★ Indicates use as required.

Numerals in parentheses () refer to notes.

Printed in U.S.A.

☐ Indicates parts not listed in any previous parts book.

Prices and specifications subject to change without notice.

* Indicates change or addition.

CODE	PART NAME AND DESCRIPTION	CYL.	PER CAR	VALIANT	PLYMOUTH	DESOTO	CHRYSLER	IMPERIAL
5-13-O WHEEL BRAKE SUPPORT - Cont'd								
5-13-1	SUPPORT - Cont'd. Front, Right, 11" Brakes, RC1 except Sub., RC2		1	----	1943 838	1943 838	1943 838	
	Front, Left, 11" Brakes, RC1 except Sub., RC2		1	----	1943 839	1943 839	1943 839	
	Rear, 11" Brakes, RC1 except Sub., RC2		2	----	1943 813	1943 813	1943 813	
	Front, Right, 12" Brakes		1	----	1943 796	1943 796	1943 796	1943 798
	Front, Left, 12" Brakes		1	----	1943 797	1943 797	1943 797	1943 799
	Rear, 12" Brakes		2	----	1943 832	1943 832	1943 832	1943 832
5-13-7	GASKET, Brake Support Plate, Rear	6	4	2070 370				
5-13-9	BOLT, Support, Mounting, Front, Upper	6	4	2072 682				
	Front, Lower	6	4	2072 681				
	Rear	6	8	2070 041				
	Front, 7/16" - 20 x 1 3/4"		4	----	1615 460	1615 460	1615 460	1615 460
	Front, 7/16" - 20 x 2 3/4"		2	----	1850 938	1850 938	1850 938	1850 938
	Front, 7/16" - 20 x 3 1/8"		2	----	1943 691	1943 691	1943 691	1943 691
	Rear, 3/8" - 24 x 1 1/4"		10	----	1484 652	1484 652	1484 652	1484 652
5-13-10	NUT, Support Mounting Bolt. Front, Upper	6	4	601 014				
	Front, Lower	6	4	1825 351				
	Rear	6	8	1927 232				
	Front		4	----	273 705	273 705	273 705	273 705
	Front		4	----	601 014	601 014	601 014	601 014
	Rear		10	----	120 369	120 369	120 369	120 369
5-13-22	SEAL, to Strg. Knuckle	6	2	2072 684				
5-13-35	COVER, Adjusting Screw Hole	6	8	1664 564				
5-16-O WHEEL BRAKE DUST SHIELD								
5-16-1	SHIELD, Front, Right, 11" x 2" Brakes, except Sub.		1	----	1857 058			
	Left, 11" x 2" Brakes, except Sub.		1	----	1857 059			
	Right, 11" x 2 1/2" Brakes, RP1, RP2, Sub., RC1 except Sub., RC2		1	----	1857 056	1857 056	1857 056	
	Left, 11" x 2 1/2" Brakes, RP1, RP2, Sub., RC1 except Sub., RC2		1	----	1857 057	1857 057	1857 057	
	Right, 12" x 2 1/2" Brakes, w/o Trough		1	----	1943 666	1943 666	1943 666	1943 686
	Right, 12" x 2 1/2" Brakes, w/TROUGH		1	----	2265 236	2265 236	2265 236	2265 238
	Left, 12" x 2 1/2" Brakes, w/o Trough		1	----	1943 667	1943 667	1943 667	1943 687
	Left, 12" x 2 1/2" Brakes, w/TROUGH		1	----	2265 237	2265 237	2265 237	2265 239
	Rear, 11" x 2" Brakes, except Sub. 11" x 2 1/2" Brakes, RC1 except Sub., RC2	8	2	----	1857 062	1857 061	1857 061	
	12" x 2 1/2" Brakes		2	----	1851 044	1857 044	1857 044	1857 044
5-20-O WHEEL BRAKE ADJUSTER								
5-20-1	SCREW	6	4	2072 651				
5-20-4	SPRING, Lock	6	4	1799 518				
5-20-15	NUT, Pivot	6	4	2072 730				
5-20-17	SOCKET	6	4	2072 652				
5-22-O WHEEL BRAKE ADJUSTING CAM DUST SHIELD SEAL								
5-22-8	SEAL		8	----	1633 111	1633 111	1633 111	1633 111

* Indicates use as required.

Numerals in parentheses () refer to notes.

Printed in U.S.A.

⊠ Indicates parts not listed in any previous parts book.
May 31, 1961 Supersedes Jan. 6, 1961.

Prices and specifications subject to change without notice.
* Indicates change or addition.

CODE	PART NAME AND DESCRIPTION	CY L	PER CAR	VALIANT	PLYMOUTH	DESOTO	CHRYSLER	IMPERIAL
5-26-O BRAKE SHOE GUIDE								
5-26-1	SPRING, Hold-Down, Type "A"	6	8	2207 520				
	Type "B"	6	8	2260 804				
5-26-2	RETAINER, Spring, Upper, Type "B"	6	8	600 072				
	Lower, Type "B"	6	8	600 073				
5-26-4	PIN, Hold-Down Spring, Type "B"	6	8	2265 097				
5-26-5	ANCHOR, Hold-Down Spring, Type "A"	6	8	2072 675				
5-27-O BRAKE PEDAL AND BUSHING								
5-27-1	PEDAL, w/Std. Trans.	6	1	2074 970				
	w/Auto. Trans.	6	1	2074 971				
	w/o Power Brakes		1	----	1940 173	1940 173	1940 173	
	w/Power Brakes		1	----	1940 166	1940 166	1940 166	1738 271
5-27-2	SLEEVE	6	1	2073 634				
	BUSHING		2	----	1637 779	1637 779	1637 779	1637 779
5-27-6	LOCK, Sleeve	6	1	2072 816				
	w/Heavy Duty Std. Trans.	6	1	2207 701				
5-27-7	SCREW, Sleeve Lock	6	1	6006 120				
5-27-9	BRACE, Instrument Panel to Pedal Bracket		1	----	1901 774	1901 788		
	Windshield Frame to Pedal Bracket		1	----	1901 801	1901 801	1901 801	
5-27-10	PIN, Power Brake Pedal to Arm		1	----	1637 773	1637 773	1637 773	1637 773
5-27-12	NUT, Sleeve Lock Screw	6	1	2208 008				
5-27-15	WASHER, Power Brake Pedal Trigger Spring		1	----	6000 165	6000 165	6000 165	6000 165
5-27-21	BUSHING, Hub	6	2	2072 822				
5-27-22	ARM, Power Brake Pedal Trigger		1	----	1675 214	1675 214	1675 214	1675 214
5-27-35	PIVOT, Power Brake Pedal Trigger		1	----	1635 344	1635 344	1635 344	1635 344
5-28-O BRAKE PEDAL PAD								
5-28-8	PAD, w/Std. Trans., RC1		1	1616 898	2201 197	2201 197	2201 197	
	w/Auto. Trans.		1	2207 747	1820 005	1820 005	1820 005	1946 357
5-29-O BRAKE PEDAL SHAFT								
5-29-1	SHAFT, w/Std. Trans.		1	----	1730 009	1730 009	1730 009	
	w/Auto. Trans.		1	----	1637 782	1637 782	1637 782	1637 782
5-31-O BRAKE PEDAL BRACKET								
5-31-11	REINFORCEMENT	6	1	2072 826				
	w/o Power Brakes		1	----	1940 195	1940 195	1940 195	1940 195
	w/Power Brakes		1	----	1940 194	1940 194	1940 194	1675 223
5-31-12	GASKET, Reinforcement	6	1	2072 825				
		8	1	----	----	----	----	2200 058
5-31-13	NUT, Reinforcement		2	----	2076 232	2076 232	2076 232	
5-31-15	BRACKET, w/Hydraulic Switch w/Mechanical Switch	6	1	*2073 637				
	w/o Power Brakes	6	1	B2260 684				
	w/Power Brakes		1	----	B2200 345	B2200 345	B2200 345	
5-31-18	STRUT, Support, Right	6	1	2074 966	B2200 344	B2200 344	B2200 344	B2200 344
	Left	6	1	2073 615				
	STRUT ASSEMBLY, Support, Right	6	1	2207 709				
	Left	6	1	2207 710				

★ Indicates use as required.

Numerals in parentheses () refer to notes.

Printed in U.S.A.

⊠ Indicates parts not listed in any previous parts book.

Prices and specifications subject to change without notice.

* Indicates change or addition.

CODE	PART NAME AND DESCRIPTION	C Y L.	PER CAR	VALIANT	PLYMOUTH	DESOTO	CHRYSLER	IMPERIAL
5-34-O BRAKE PEDAL RETURN SPRING								
5-34-1	SPRING, w/Power Brakes . . .		1	---- ---	1730 077	1730 077	1730 077	1730 077
	w/o Power Brakes		1	2260 710	2260 710	2260 710	2260 710	---- ---
5-34-6	SEAT, Spring, w/o Power Brakes		1	2260 709	2260 709	2260 709	2260 709	
5-39-O MASTER CYLINDER								
5-39-1	REPAIR PACKAGE, w/o Power Brakes, w/o Piston	6	1	2196 905				
	w/o Power Brakes, w/PISTON .	6	1	2196 904				
	w/Power Brakes, w/PISTON . .	6	1	2196 906				
	w/o Power Brakes, w/o Piston		1	---- ---	1879 303	1879 303	1879 303	
	w/o Power Brakes, w/PISTON .		1	---- ---	*2240 245	*2240 245	*2240 245	
	w/Power Brakes, w/PISTON . .		1	---- ---	*2275 518	*2275 518	*2275 518	*2275 518
5-39-3	CYLINDER, Master, w/o Power Brakes, w/Hydraulic Switch		1	2074 963	1829 400	1829 400	1829 400	
	w/o Power Brakes, w/Mechanical Switch		1	*2275 368	*2275 370	*2275 370	*2275 370	
	w/Power Brakes		1	2275 369	*2275 371	*2275 371	*2275 371	*2275 371
5-39-4	COVER PACKAGE		1	1752 470	1752 470	1752 470	1752 470	1752 470
5-39-18	GASKET, w/o Power Brakes . .	6	1	1559 753				
	w/Power Brakes	6	1	2074 965				
			1	---- ---	1559 753	1559 753	1559 753	1559 753
5-39-20	COVER		1	1731 225	1731 225	1731 225	1731 225	1731 225
5-39-21	SCREW, Cover		1	1731 227	1731 227	1731 227	1731 227	1731 227
	w/Power Brakes, w/Mechanical Switch		1	E2275 369	E2275 371	E2275 371	E2275 371	E2275 371
5-39-24	GASKET, Cover		1	2122 276	2122 276	2122 276	2122 276	2122 276
5-39-27	BAFFLE, Cover		1	1731 226	1731 226	1731 226	1731 226	1731 226
5-40-O MASTER CYLINDER BOOT								
5-40-1	BOOT, w/o Power Brakes . . .		1	1828 388	1828 388	1828 388	1828 388	
	w/Power Brakes		1	---- ---	1316 628	1316 628	1316 628	1316 628
5-40-3	COLLAR, w/Power Brakes . . .		1	---- ---	1316 627	1316 627	1316 627	1316 627
5-43-O MASTER CYLINDER VALVE								
5-43-1	VALVE		1	1318 446	1318 446	1318 446	1318 446	1318 446
5-43-5	SEAL		1	1617 379	1617 379	1617 379	1617 379	1617 379
5-44-O MASTER CYLINDER PISTON								
5-44-3	PISTON		1	---- ---	1828 659	1828 659	1828 659	1828 659
5-44-8	STOP	6	1	1828 389				
	w/o Power Brakes		1	---- ---	1828 389	1828 389	1828 389	
	w/Power Brakes		1	---- ---	1556 664	1556 664	1556 664	1556 664
5-45-O MASTER CYLINDER PISTON CUP								
5-45-8	CUP, Secondary		1	---- ---	958 659	958 659	958 659	958 659
5-46-O MASTER CYLINDER PISTON RETURN SPRING								
5-46-1	SPRING		1	1738 268	1738 268	1738 268	1738 268	1738 268
5-47-O MASTER CYLINDER PISTON PUSH ROD								
5-47-2	ROD, w/Power Brakes		1	---- ---	1731 202	1731 202	1731 202	1731 202
5-47-3	END, w/Power Brakes		1	---- ---	1675 218	1675 218	1675 218	1675 218
5-47-4	BOLT, End	6	1	2201 181				
	w/o Power Brakes		1	---- ---	2201 181	2201 181	2201 181	
	PIN, w/Power Brakes		1	---- ---	1637 784	1637 784	1637 784	1637 784

★ Indicates use as required.

Numerals in parentheses () refer to notes.

Printed in U.S.A.

⊞ Indicates parts not listed in any previous parts book.
March 1, 1962 Supersedes May 31, 1961.

Prices and specifications subject to change without notice.

* Indicates change or addition.

CODE	PART NAME AND DESCRIPTION	CYL	PER CAR	VALIANT	PLYMOUTH	DESOTO	CHRYSLER	IMPERIAL
5-100-0 POWER BRAKE POWER UNIT - Cont'd								
5-100-2	POWER UNIT	6	1	2074 930				
	Bellows Type		1	----	1675 213	1675 213	1675 213	1675 213
	Cylinder Type		1	----	1735 620	1735 620	1735 620	1735 620
	Cylinder Type, w/Ram Manifold	8	1	----	2123 040	2123 040	2123 040	
5-100-3	CYLINDER SEAL PACKAGE, for 1735 620 and 2123 040							
	Power Unit		1	----	1940 787	1940 787	1940 787	1940 787
5-100-34	LEVER, Brake Pedal		1	----	1738 272	1738 272	1738 272	1738 272
5-100-35	BUSHING, Lever Pin		2	----	1637 793	1637 793	1637 793	1637 793
5-100-105	REINFORCEMENT, Bellows	8	1	----	----	----	----	1750 593
5-100-110	CAM, Pedal Adjusting		1	----	1737 157	1737 157	1737 157	1737 157
5-100-111	COLLAR, Adjusting Cam		1	----	1674 302	1674 302	1674 302	1674 302
5-100-113	WASHER, Adjusting Cam, Plain		1	----	1685 757	1685 757	1685 757	1685 757
	WASHER, Adjusting Cam, Lock		1	----	1737 158	1737 158	1737 158	1737 158
5-100-152	PISTON PACKING PACKAGE, for 2074 930 Power Unit	6	1	2075 000				
	For 1735 620 and 2123 040 Power Unit		1	----	1820 003	1820 003	1820 003	1820 003
5-100-157	PACKAGE, Diaphragm Plate and Piston Plate, for 2074 930 Power Unit	6	1	2240 625				

COMPONENT PARTS FOR POWER BRAKE POWER UNITS

CODE	PART NAME	PER CAR	POWER UNIT		
			2074 930	1675 213	1735 620 and 2123 040
5-100-5	RETAINER, Diaphragm	1	2074 977		
5-100-6	PLATE, Diaphragm	1	2074 978		
5-100-7	SHELL, Front	1	2074 990		
	SHELL, Rear	1	2074 991		
	SHELL	1	----	----	1739 852
5-100-8	SEAL, Shell	1	----	----	1739 853
5-100-15	SPRING, Return	1	2074 999	----	1739 839
5-100-20	ROD, Push	1	2074 998	----	1739 842
5-100-21	YOKE	1	----	1820 011	
5-100-25	SCREW, Set	2	----	1675 003	
5-100-26	GUARD, Push Rod	1	2074 987		
5-100-27	WASHER, Push Rod Stop Cushion	1	----	----	1675 099
5-100-39	BEARING, Push Rod	1	----	----	1940 790
5-100-47	PLATE, Piston, Front	1	2074 984		
	Rear	1	2074 982		
5-100-120	SCREW, Inspection Hole	1	----	1673 634	
5-100-121	GASKET, Inspection Hole Screw	1	----	1674 993	1675 137
5-100-127	VALVE, Air	1	----	1674 944	1739 847
5-100-130	SPRING, Air Valve	1	----	1676 486	
5-100-137	PIN, Piston Plate Spiral	2	----	----	1675 009
5-100-138	PLATE, Piston	1	----	----	1739 832
5-100-139	PACKING, Piston	1	----	----	1739 834
5-100-140	PLATE, Piston Packing	1	----	----	1739 836
5-100-141	RING, Piston Packing	1	----	----	1739 835
5-100-142	GUIDE, w/SLEEVE	1	----	1820 009	
5-100-144	PLATE, Packing Wick	1	----	----	1739 838
5-100-145	BEARING, Guide Sleeve	1	----	1674 970	
5-100-146	SCREW, Piston Packing Plate	6	----	----	1675 143
5-100-148	SEAL, Bearing to Guide Sleeve	1	----	1674 972	
	"O" RING, Bearing to Mounting Plate	1	----	1674 974	
5-100-155	SEAL, Air Valve	1	----	1674 949	
5-100-156	RETAINER, Air Valve Seal	1	----	1674 950	
5-100-158	HOSE, Vacuum	1	----	----	1675 124
5-100-159	VALVE, Vacuum	1	----	1674 952	

★ Indicates use as required. Numerals in parentheses () refer to notes. Printed in U.S.A.
 ☐ Indicates parts not listed in any previous parts book. Prices and specifications subject to change without notice.
 * Indicates change or addition. March 1, 1962 Supersedes May 31, 1961.

5-100-O POWER BRAKE POWER UNIT - Cont'd

COMPONENT PARTS FOR POWER BRAKE POWER UNITS - Cont'd

CODE	PART NAME	PER CAR	POWER UNIT		
			2074 930	1675 213	1735 620 and 2123 040
5-100-159	SEAT, Poppet Valve	1	----	----	1675 118
5-100-160	SPRING, Vacuum Valve	1	----	1674 955	1675 122
5-100-161	SEAL, Vacuum Valve	1	----	1674 949	
5-100-162	RETAINER, Vacuum Valve Seal	1	----	1674 954	
5-100-163	DIAPHRAGM, Poppet Valve Seat	1	----	----	1675 123
5-100-166	PLUNGER, Vacuum Valve	1	2074 981	----	
5-100-168	EXTENSION, Valve Stem, w/CUP	1	----	----	1675 109
5-100-169	ROD, Valve	1	2074 997	1820 012	
5-100-171	"O" RING, Valve Rod Bumper	1	----	1674 989	
5-100-173	SPRING, Valve Stem	1	----	----	1676 487
5-100-174	RING, Valve Stem Snap	2	----	----	1675 104
5-100-175	SEAL, Valve Stem	1	----	----	1675 128
5-100-176	DIAPHRAGM, Valve Applying	1	----	----	1675 112
5-100-177	RETAINER, Diaphragm	1	----	----	1675 113
5-100-178	WASHER, Diaphragm Retainer	1	----	----	1675 117
5-100-179	HOUSING, Valve	1	----	1674 942	
5-100-180	RETAINER, Valve Stem Spring	1	----	----	1673 620
5-100-181	"O" RING, Valve Housing to Guide	1	----	1674 957	
	"O" RING, Valve Housing to Cover	1	----	1674 991	
5-100-182	WASHER, Valve Stem	1	----	----	1820 025
5-100-183	PLATE, Air Cleaner, for 1735 620 Unit	1	----	----	1820 002
	PLATE, Air Cleaner, for 2123 040 Unit	1	----	----	2123 517
	COVER, Valve Housing	1	----	1820 013	
5-100-185	CLEANER, Air, w/TUBE	1	2074 992	----	
5-100-186	END, Valve Stem	1	----	----	1739 849
5-100-188	SCREW, Diaphragm Retainer	4	----	----	1675 143
5-100-189	HUB, w/LEVERS	1	2074 985	----	
5-100-190	LINK, Pedal	1	2074 989	----	
5-100-191	PIN, Lever Pivot	1	2074 986	----	
5-100-192	WASHER, Bowed	2	2075 005	----	
5-100-193	SPRING, Valve Return	1	2074 980	----	
5-100-194	PIN, Clevis	2	2075 006	----	
5-100-196	SPRING, Poppet Return	1	2074 979	----	
5-100-200	BELLOWS	1	----	1820 007	
5-100-201	SPRING, Bellows Return	1	----	1820 010	
5-100-202	RETAINER, Bellows Return Spring	1	----	1674 965	
5-100-203	PLATE, Bellows Spacer	3	----	1820 008	
5-100-206	PLATE, Mounting, Inner	1	----	1674 966	
	PLATE, Mounting, Outer	1	2074 988	1674 968	
	PLATE, End	1	----	----	1739 851
5-100-207	BOLT, End Plate	4	----	----	1675 146
	BOLT, Mounting Ring	4	----	----	1735 640
5-100-208	RING, Mounting	1	----	----	1675 132
5-100-210	WASHER, Stop and Seal	1	----	1674 975	

★ Indicates use as required. Numerals in parentheses () refer to notes. Printed in U.S.A.
 ☐ Indicates parts not listed in any previous parts book. Prices and specifications subject to change without notice.
 May 31, 1961 Supersedes Jan. 6, 1961. Page 5-14 * Indicates change or addition.

