

GROUP 16 - PROPELLER SHAFT AND UNIVERSAL JOINT

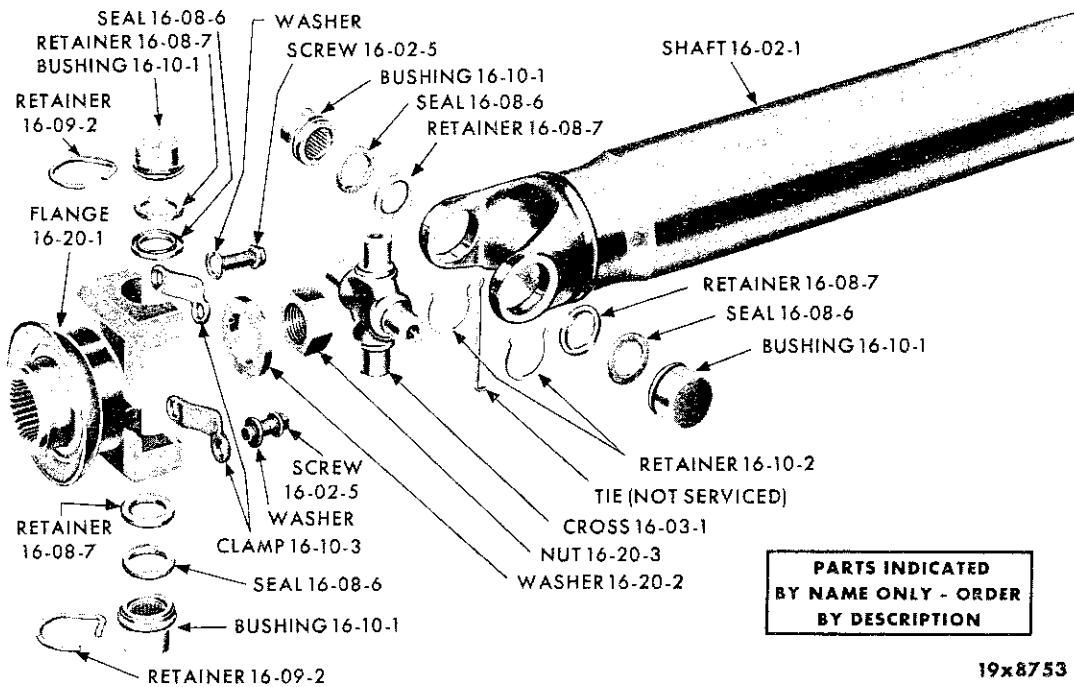

PROPELLER SHAFT (AXLE END)

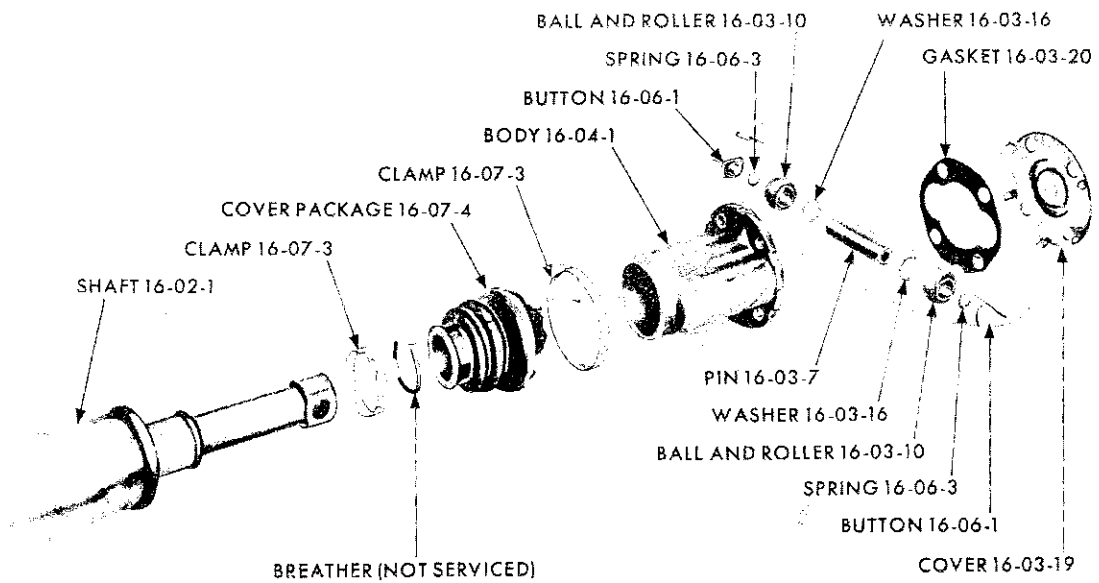

PROPELLER SHAFT (TRANSMISSION END)

CODE	PART NAME AND DESCRIPTION	C Y L.	PER CAR	VALIANT	PLYMOUTH	DESOTO	CHRYSLER	IMPERIAL
16-02-0 PROPELLER SHAFT								
NOTE 1: Used with Propeller Shaft No. 1372699, 1856963, 1856923, 1734118, 1856961, 2071017 and 2206974.								
NOTE 2: Used with Propeller Shaft No. 1739930, 2200534 and 1856931.								
16-02-1	SHAFT, 59" Lgh., 2 3/4" Dia., w/PowerFlite Trans., Sub.	8	1	----	1856 963			
	59" Lgh., 2 3/4" Dia., w/3 Speed Auto. Trans., Sub.	8	1	----	1856 931			
	59" Lgh., 3 1/4" Dia., Heavy Duty Manual Trans. w/Eng. Stamped 318	8	1	----	1856 931			
	SHAFT, 55" Lgh. 2 3/4" Dia., w/Manual Trans., except Sub.	6	1	----	1732 699			
	53 3/8" Lgh., 2 3/4" Dia., w/170 cu.in. Eng.	6	1	*2071 017				
	53 3/8" Lgh., 3" Dia., w/225 cu.in. Eng.	6	1	*2206 974				
	55" Lgh., 3 1/4" Dia., w/Std. and Heavy Duty Manual Trans. except Sub.	6	1	----	1856 921			
	59" Lgh., 3 1/4" Dia., w/Manual Trans., Sub.	6	1	----	1856 923			
	55" Lgh., 3" Dia., w/Manual Trans. w/Eng. Stamped 318, except Sub.	8	1	----	1734 118			
	55" Lgh., 2 1/2" O.D. w/PowerFlite Trans. except Sub.	8	1	----	1856 921			
	55" Lgh., 3" Dia., w/3 Speed Auto. and PowerFlite Trans., except Sub.	6	1	----	1734 118			
	59" Lgh., 2 3/4" Dia., w/3 Speed Auto. Trans., Sub.	6	1	----	1856 963			
	59" Lgh., 2 3/4" Dia., w/Manual Trans., Sub.	8	1	----	*1856 923			
	55" Lgh., 2 3/4" Dia., w/Heavy Duty Manual Trans., w/Eng. Stamped 36, except Sub.	8	1	----	1739 930			
	55" Lgh., 2 3/4" Dia., w/3 Speed Auto. Trans., except Sub.	8	1	----	1739 930			
	59" Lgh., 2 3/4" Dia., w/PowerFlite Trans., Sub.	8	1	----	1856 963			
	59" Lgh., 3 1/4" Dia., w/Manual or PowerFlite Trans.	8	1	----	1856 923			
	55" Lgh., 2 3/4" Dia., Special Police	8	1	----	1739 930			
	59 1/4" Lgh., 3 1/4" Dia. RS1, RC1, w/Manual Trans., RS1, RC1, RC2, RC3, RC4, w/3 Speed Auto. Trans.	8	1	----		2200 534	2200 534	
16-02-2	SHAFT, Front, 29 1/4" Lgh.	8	1	----				2200 527
16-02-4	SHAFT, Rear, 33 1/16" Lgh.	8	1	----				1946 297
16-02-5	SCREW, Flange, Axle End	4		952 538	952 538	952 538	952 538	
	Bolt, Flange, Trans. End	4		----	1326 773	1326 773	1326 773	
	Bolt, Flange, Trans. End, w/Auto Trans., RS1	4		----	1946 283	1946 283	1946 283	
16-03-0 UNIVERSAL JOINT								
16-03-1	JOINT PACKAGE, Front, Note 1	1		1603 398	1603 398			
	JOINT PACKAGE, Ball and Pin Type, Note 2	1		----	*1752 680	*1752 680	*1752 680	
	JOINT PACKAGE, Cross and Roller Type	1		1752 624	1752 624	1752 624	1752 624	1752 624
16-03-3	ROLLER PACKAGE	1		638 637	638 637	638 637	638 637	638 637
16-03-7	PIN, Note 1	2		579 445	579 445			
	PIN, Note 2	8	2	----	1739 923	1739 923	1739 923	
16-03-10	BALL, w/ROLLER, Note 1	2		1550 466	1550 466			
	Note 2	8	2	----	1739 927	1739 927	1739 927	

★ Indicates use as required.

Numerals in parentheses () refer to notes.

Printed in U.S.A.

☐ Indicates parts not listed in any previous parts book.

Prices and specifications subject to change without notice.

* Indicates change or addition.

1961 PASSENGER CAR PARTS CATALOG

PROP. SHAFT
& U/JOINT

CODE	PART NAME AND DESCRIPTION	CYL.	PER CAR	VALIANT	PLYMOUTH	DESOTO	CHRYSLER	IMPERIAL
16-03-0 UNIVERSAL JOINT - Cont'd								
16-03-16	WASHER, Thrust		2	605 004	605 004	605 004	605 004	
16-03-19	COVER, Grease, Note 1		1	602 820	602 820			
	Note 2	8	1	----	1635 092	1635 092	1635 092	
16-03-20	GASKET, Joint, Note 1		1	1616 185	1616 185			
	Note 2	8	1	----	1635 098	1635 098	1635 098	
16-04-0 UNIVERSAL JOINT BODY								
16-04-1	BODY, Note 1		1	1734 159	1734 159			
	Note 2	8	1	----	1739 920	1739 920	1739 920	
16-06-0 UNIVERSAL JOINT CENTERING BUTTON								
16-06-1	BUTTON, Note 1		2	629 768	629 768			
	Note 2	8	2	----	1739 924	1739 924	1739 924	
16-06-3	SPRING		2	1739 926	1739 926	1739 926	1739 926	
16-07-0 UNIVERSAL JOINT COVER								
16-07-3	CLAMP, 1 5/8" Dia.		1	870 540	870 540	870 540	870 540	
	2 3/4" Dia.		1	----	870 539	870 539	870 539	
16-07-4	COVER PACKAGE, Note 1		1	1603 397	1603 397			
	Note 2		1	----	1450 448	1450 448	1450 448	
16-08-0 UNIVERSAL JOINT CROSS								
16-08-6	SEAL, Dust		1	857 999	857 999	857 999	857 999	
16-08-7	RETAINER, Seal		1	1739 912	1739 912	1739 912	1739 912	
16-09-0 UNIVERSAL JOINT CROSS ROLLER AND BEARING BLOCK								
16-09-2	RETAINER, Roller Bushing.		2	858 007	858 007	858 007	858 007	
16-10-0 UNIVERSAL JOINT CROSS ROLLER AND BUSHING								
16-10-1	ROLLER, w/BUSHING		4	1739 913	1739 913	1739 913	1739 913	
16-10-2	RETAINER, Bushing		2	858 006	858 006	858 006	858 006	
16-10-3	CLAMP, Bushing		2	1828 824	1828 824	1828 824	1828 824	1828 824
16-14-0 PROPELLER SHAFT SPLINE OR SLIDING YOKE								
16-14-1	YOKE, Joint Stub	8	1	----	----	----	----	1739 915
16-14-7	SEAL, Oil	8	1	----	----	----	----	1672 049
16-14-9	CAP, Oil Seal	8	1	----	----	----	----	1672 050
16-16-0 PROPELLER SHAFT CENTER BEARING								
16-16-1	BEARING	8	1	----	----	----	----	1672 051
16-16-6	WASHER, Lock	8	1	----	----	----	----	1638 151
16-16-43	SLINGER, Dust	8	2	----	----	----	----	1672 053
16-16-47	SPACER, Cv. Cp.	8	★	----	----	----	----	1945 836
	Except, Cv. Cp.	8	★	----	----	----	----	1856 944
16-17-0 PROPELLER SHAFT CENTER BEARING HOUSING INSULATOR								
16-17-1	INSULATOR, Cv. Cp.	8	1	----	----	----	----	1856 942
	Except, Cv. Cp.	8	1	----	----	----	----	*1945 831

★ Indicates use as required.

Numerals in parentheses () refer to notes.

Printed in U.S.A.

⊠ Indicates parts not listed in any previous parts book.
May 31, 1961 Supersedes Oct. 3, 1960.

Prices and specifications subject to change without notice.

* Indicates change or addition.

