

GROUP 11 - EXHAUST

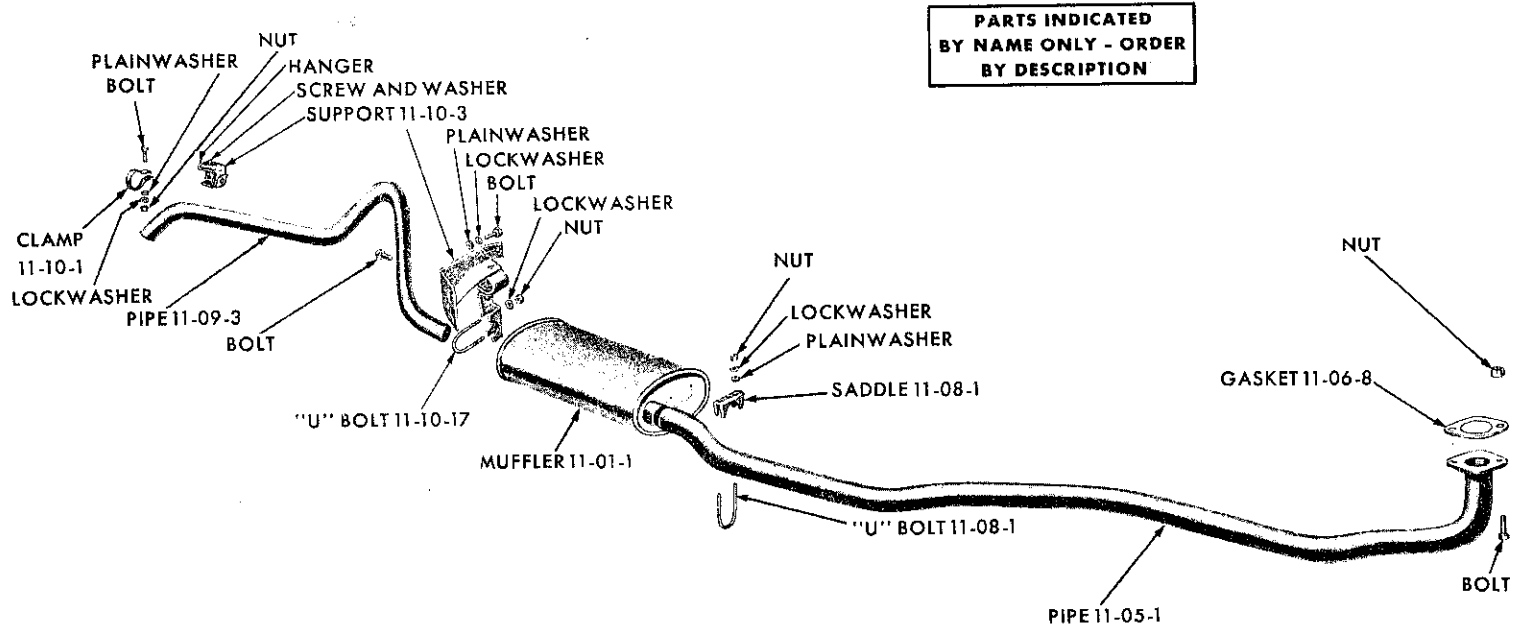

PARTS INDICATED BY NAME ONLY - ORDER BY DESCRIPTION

19x8748B

EXHAUST SYSTEM - VALIANT RV1

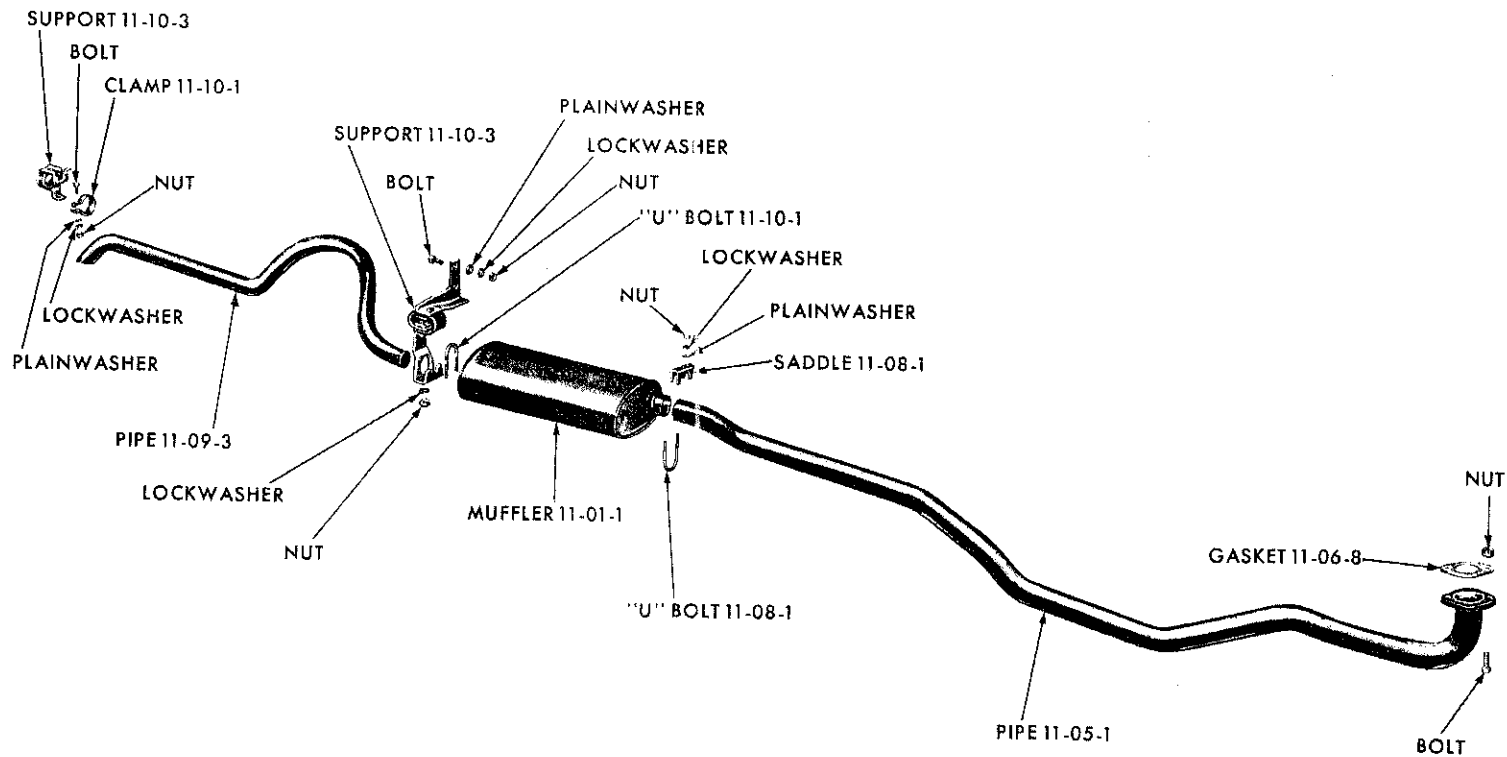

PARTS INDICATED
BY NAME ONLY - ORDER
BY DESCRIPTION

19x8644A

EXHAUST SYSTEM - PLYMOUTH RP1

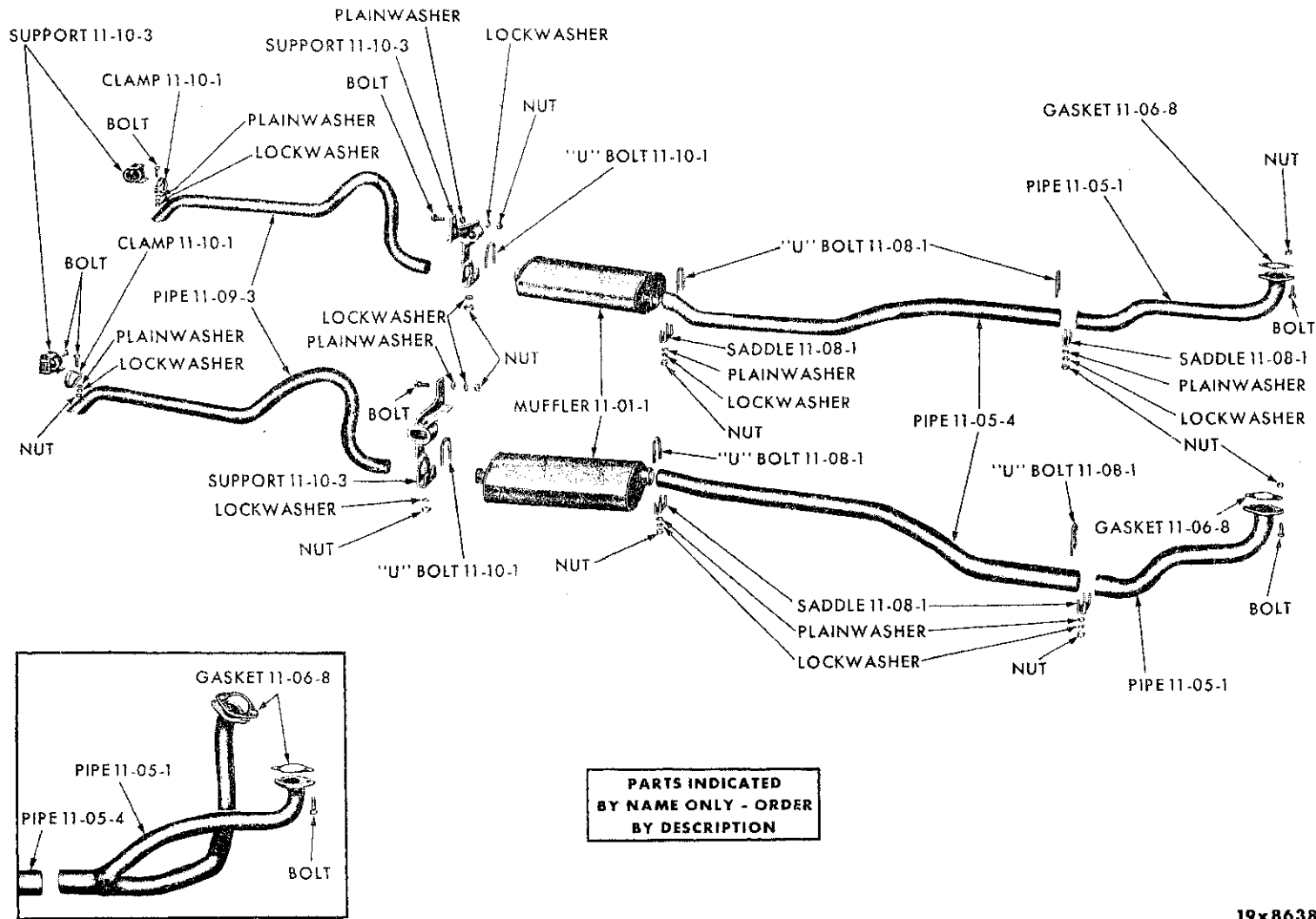

19x8638A

EXHAUST SYSTEM - PLYMOUTH RP2 (HIGH PERFORMANCE)

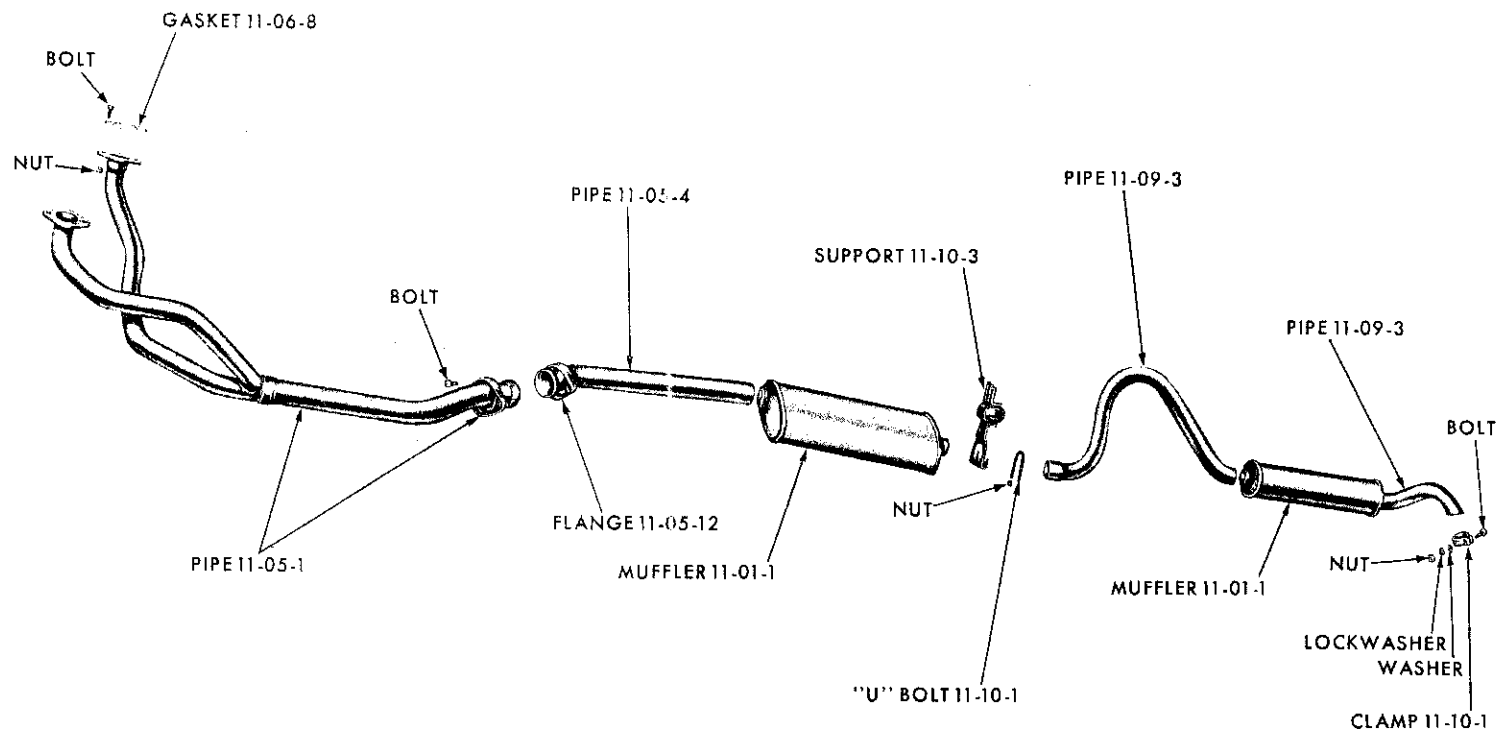

PARTS INDICATED
 BY NAME ONLY - ORDER
 BY DESCRIPTION

19x9098

EXHAUST SYSTEM - CHRYSLER RC1-2-3-4

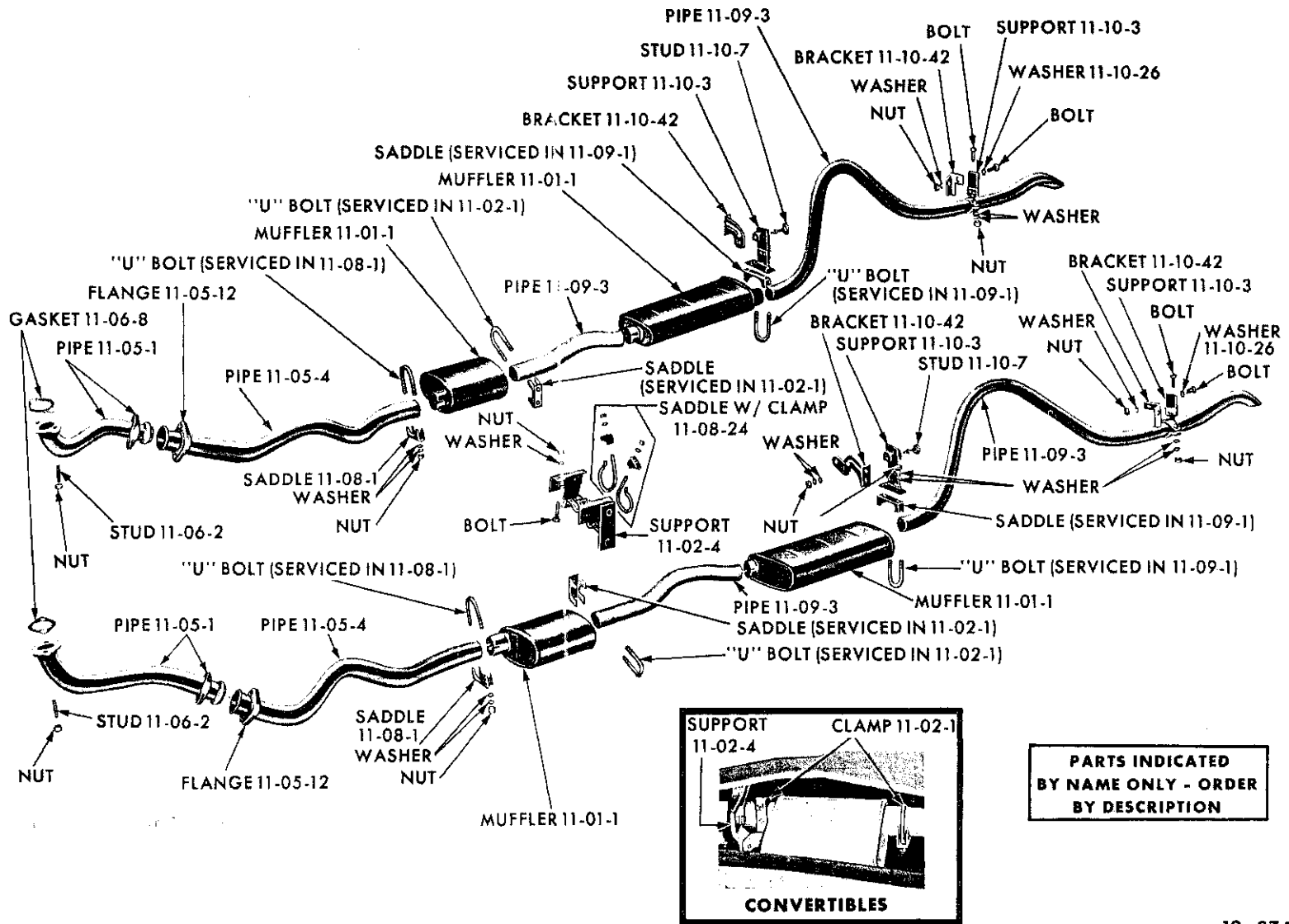

19x8743A

EXHAUST SYSTEM - IMPERIAL RY1

CODE	PART NAME AND DESCRIPTION	C Y L.	PER CAR	VALIANT	PLYMOUTH	DESOTO	CHRYSLER	IMPERIAL
11-01-0 MUFFLER								
11-01-1	MUFFLER, Single Exhaust . . .	6	1	2208 370	2201 424			
	Single Exhaust	8	1	----	2122 831	2122 833	2122 833	
	Dual Exhaust, w/o Ram Manifold or High Performance	8	2	----	2201 424	2122 834		
	Dual Exhaust, w/Ram Manifold or High Performance	8	2	----	2122 831	2122 831	2122 831	
	RC3, Single Exhaust, Front. . .	8	1	----	----	----	2122 833	
	Rear	8	1	----	----	----	2201 418	
	RC3, Dual Exhaust, Front . . .	8	2	----	----	----	2122 835	
	Rear	8	2	----	----	----	2122 834	
	RY1, except Cv., Front.	8	2	----	----	----	----	2123 425
	Rear	8	2	----	----	----	----	1948 309
	RY1 Cv., Front	8	2	----	----	----	----	2122 795
	Rear	8	2	----	----	----	----	2123 470
11-02-0 MUFFLER SUPPORT								
11-02-4	SUPPORT, Front Muffler, RC3, Right	8	1	----	----	----	2122 796	
	Left	8	1	----	----	----	1948 549	
	Except Cv., Front.	8	1	----	----	----	----	1945 709
	Cv., Front Right	8	1	----	----	----	----	1820 319
	Left.	8	1	----	----	----	----	1820 318
11-05-0 EXHAUST PIPE								
11-05-1	PIPE, Single Exhaust	6	1	*2201 448				
	Single Exhaust, except Sub. . .	6	1	----	*2200 377			
	Single Exhaust, Sub.	6	1	----	2200 379			
	Taxi	6	1	----	2201 382			
	Single Exhaust, RP2	8	1	----	2200 463			
	Dual Exhaust, except Sub., Right	8	1	----	2201 352			
	Left	8	1	----	2201 350			
	Dual Exhaust, Sub., Right . . .	8	1	----	2201 358			
	Left	8	1	----	2201 356			
	Dual Exhaust, w/High Performance, Right		1	----	2122 790			
	Left		1	----	2122 788			
	Dual Exhaust, Ram Manifold, Right	8	1	----	2122 689			
	Left	8	1	----	2122 677			
	Single Exhaust, RC1, RC2 . . .	8	1	----	----	2123 462	2123 462	
	Single Exhaust, Code Disc D1, RR-38 Serial No. Pad, RC2 . .	8	1	----	----	----	2201 432	
	Dual Exhaust, Right	8	1	----	----	2123 459		
	Left	8	1	----	----	2123 475		
	Single Exhaust, RC3	8	1	----	----	----	2201 432	
	Dual Exhaust, RC3, Right . . .	8	1	----	----	----	2123 481	
	Left	8	1	----	----	----	2123 479	
	Dual Exhaust, w/Ram Manifold, RC4-300, Right	8	1	----	----	----	2122 705	
	Left	8	1	----	----	----	2122 696	
	By-Pass, w/Ram Manifold, RC4-300, Right	8	1	----	----	----	2122 708	
	Left	8	1	----	----	----	2122 702	
	Dual Exhaust, Right	8	1	----	----	----	----	1948 166
	Left	8	1	----	----	----	----	1948 164
11-05-4	PIPE, Exhaust Extension, Single Exhaust, except Sub.	8	1	----	1948 568			
	Single Exhaust, Sub.	8	1	----	1948 569			
	Single Exhaust	8	1	----	----	2123 469	2123 469	
	Dual Exhaust, RC3, Right. . . .	8	1	----	----	----	2123 492	
	Left	8	1	----	----	----	2123 491	
	Dual Exhaust, except Cv., Right	8	1	----	----	----	----	1948 171
	Left	8	1	----	----	----	----	1948 170

★ Indicates use as required. Numerals in parentheses () refer to notes. Printed in U.S.A.
 ☒ Indicates parts not listed in any previous parts book. Prices and specifications subject to change without notice.
 * Indicates change or addition. March 1, 1962 Supersedes Jan. 6, 1961.

1961 PASSENGER CAR PARTS CATALOG

EXHAUST

CODE	PART NAME AND DESCRIPTION	CYL.	PER CAR	VALIANT	PLYMOUTH	DESOTO	CHRYSLER	IMPERIAL
11-05-0 EXHAUST PIPE - Cont'd								
11-05-9	PIPE, Exhaust Crossover, RC4.	8	1	----	----	----	2122 680	
11-05-12	FLANGE, Extension Pipe Ball Joint, Single Exhaust		1	----	----	1946 639	1946 639	
11-06-0 EXHAUST PIPE FLANGE GASKET AND STUD								
11-06-8	GASKET	6	1	2073 792				
	RP1	6	1	----	2073 792			
	RP2	8	1	----	1636 570			
			2	----	----	1855 029	1855 029	1855 029
11-08-0 EXHAUST PIPE SUPPORT AND CLAMP								
11-08-1	CLAMP PACKAGE, Single Exhaust, RP2		1	1843 009	1603 364			
	Dual Exhaust, w/High Performance, RC4	8	2	----	1603 364	----	1603 364	
			2	----	----	----	----	1843 008
	Crossover Pipe, RC4	8	1	----	1843 009	----	1843 009	
11-08-3	BOLT, Exhaust Pipe Torque Converter Support, Single Exhaust		1	----	----	2123 496	2123 496	
11-08-5	BRACE, Exhaust Pipe, Taxi	6	1	----	E2208 399			
11-09-0 TAIL PIPE								
11-09-3	PIPE, Tail except Sub., Single Exhaust	6	1	2073 793	1948 592			
	Single Exhaust, Sub.	6	1	2073 801	1948 588			
	Single Exhaust, except Sub.	8	1	----	1948 538	1948 538		
	Single Exhaust, Sub.	8	1	----	1948 590			
	Dual Exhaust, except Sub., w/o Ram Manifold or High Performance, Right	8	1	----	*1948 593	1948 593	----	1948 284
	Left	8	1	----	*1948 592	1948 592	----	1948 283
	Dual Exhaust, Sub., w/o Ram Manifold or High Performance, Right	8	1	----	1948 589			
	Left	8	1	----	1948 588			
	Dual Exhaust, except Sub., w/Ram Manifold or High Performance, Police, Right	8	1	----	E2266 034			
	Left	8	1	----	1948 538			
	Dual Exhaust, Sub., w/Ram Manifold or High Performance, Right	8	1	----	1948 591			
	Left	8	1	----	1948 590			
	Single Exhaust, except Sub., RC1, RC2	8	1	----	----	----	1948 538	
	Single Exhaust, Sub., RC1	8	1	----	----	----	1948 590	
	Dual Exhaust, except Sub., RC3, Right	8	1	----	----	----	1948 593	
	Left	8	1	----	----	----	1948 592	
	Dual Exhaust, Sub., RC3, Right	8	1	----	----	----	1948 589	
	Left	8	1	----	----	----	1948 588	
	Right, RC4	8	1	----	----	----	E2266 034	
	Left, RC4	8	1	----	----	----	*1948 538	
	Single Exhaust, Intermediate, except Sub., RC3	8	1	----	----	----	2201 411	
	Dual Exhaust, Intermediate, Right, RC3	8	1	----	----	----	*1948 536	
	Left, RC3	8	1	----	----	----	*1948 535	

★ Indicates use as required. Numerals in parentheses () refer to notes. Printed in U.S.A.
 ☐ Indicates parts not listed in any previous parts book. Prices and specifications subject to change without notice.
 March 1, 1962 Supersedes Jan. 6, 1961. Page 11-6 * Indicates change or addition.

CODE	PART NAME AND DESCRIPTION	C Y L.	PER CAR	VALIANT	PLYMOUTH	DESOTO	CHRYSLER	IMPERIAL
11-09-O TAIL PIPE - Cont'd								
11-09-3	PIPE - Cont'd.							
	Dual Exhaust, Intermediate, except Cv.	8	2	----	----	----	----	*2123 421
	Dual Exhaust, Intermediate, Cv., Right	8	1	----	----	----	----	*1948 267
	Left	8	1	----	----	----	----	1948 266
11-10-O TAIL PIPE SUPPORT								
11-10-1	CLAMP PACKAGE, Rear		1	2240 308	----	2240 312		
	w/High Performance		2	2240 311	2240 312			
	Single Exhaust	8	1	----	----		B2240 312	
	Dual Exhaust	8	2	----	----		B2240 311	B2240 311
11-10-3	SUPPORT, w/INSULATOR, Single Exhaust, except Sub., Front	6	1	2201 406	2123 433			
	Rear	6	1	2073 794				
	Single Exhaust, Sub., Front	6	1	----	2123 438			
	Rear	6	1	----	2123 446			
	Single Exhaust, except Sub., Front	8	1	----	2123 435	2123 440	2123 440	
	Rear Right	8	1	----	2201 386	2123 443		
	Single Exhaust, Sub., Front	8	1	----	2123 440	----	2123 440	
	Rear	8	1	----	2123 446	----	2123 446	
	Dual Exhaust, except Sub., Front	8	2	----	2123 433	2123 438		
	Rear Right	8	1	----	2201 386	2123 443		
	Left	8	1	----	2201 385	2123 442		
	Dual Exhaust, Sub., Front	8	2	----	2123 438			
	Rear Right	8	1	----	2123 447			
	Left	8	1	----	2123 446			
	Dual Exhaust, w/High Performance or Ram Manifold, except Sub., Front	8	2	----	2123 435			
	Rear Right	8	1	----	2201 386			
	Left	8	1	----	2201 385			
	Dual Exhaust, w/Ram Manifold, Sub., Front	8	2	----	2123 440			
	Dual Exhaust, w/Ram Manifold, except Sub., Front	8	2	----	----	2123 440	2123 440	
	Rear Right	8	1	----	----	2123 443		
	Left	8	1	----	----	2123 442		
	Dual Exhaust, RC2, Front	8	2	----	----	----	2123 438	
	Rear Right	8	1	----	----	----	2123 443	
	Left	8	1	----	----	----	2123 442	
	Dual Exhaust, RC3, Front	8	2	----	----	----	2123 438	
	Except Sub., Rear Right	8	1	----	----	----	2123 443	
	Left	8	1	----	----	----	2123 442	
	Sub., Rear Right	8	1	----	----	----	2123 447	
	Left	8	1	----	----	----	2123 446	
	Dual Exhaust, to Rear Muffler, Front	8	2	----	----	----	----	2123 456
	Rear Pipe	8	2	----	----	----	----	2123 401
11-10-8	CLIP, Front Support Bracket to Body Bolt		1	----	1327 986	1327 986	1327 986	
11-10-16	CLAMP, Rear Support		1	2240 308				
11-10-17	U-BOLT, Tail Pipe Support Front	6	1	2073 812				
11-10-18	NUT, Tail Pipe Rear Support to Body, except Sub.		★	----	6012 065	6012 065	6012 065	
11-10-26	WASHER, Rear Support Insulator		1	----	688 900	688 900	688 900	688 900
11-10-42	BRACKET, Front Support, Right		1	----	----	----	----	2123 395
	Left		1	----	----	----	----	2123 396
	w/Brake Tube BRACKET		1	----	----	----	----	2201 403

NOTES

★ Indicates use as required.

Numerals in parentheses () refer to notes.

Printed in U.S.A.

☐ Indicates parts not listed in any previous parts book.

Prices and specifications subject to change without notice.

* Indicates change or addition.

