

GROUP 9 - ENGINE

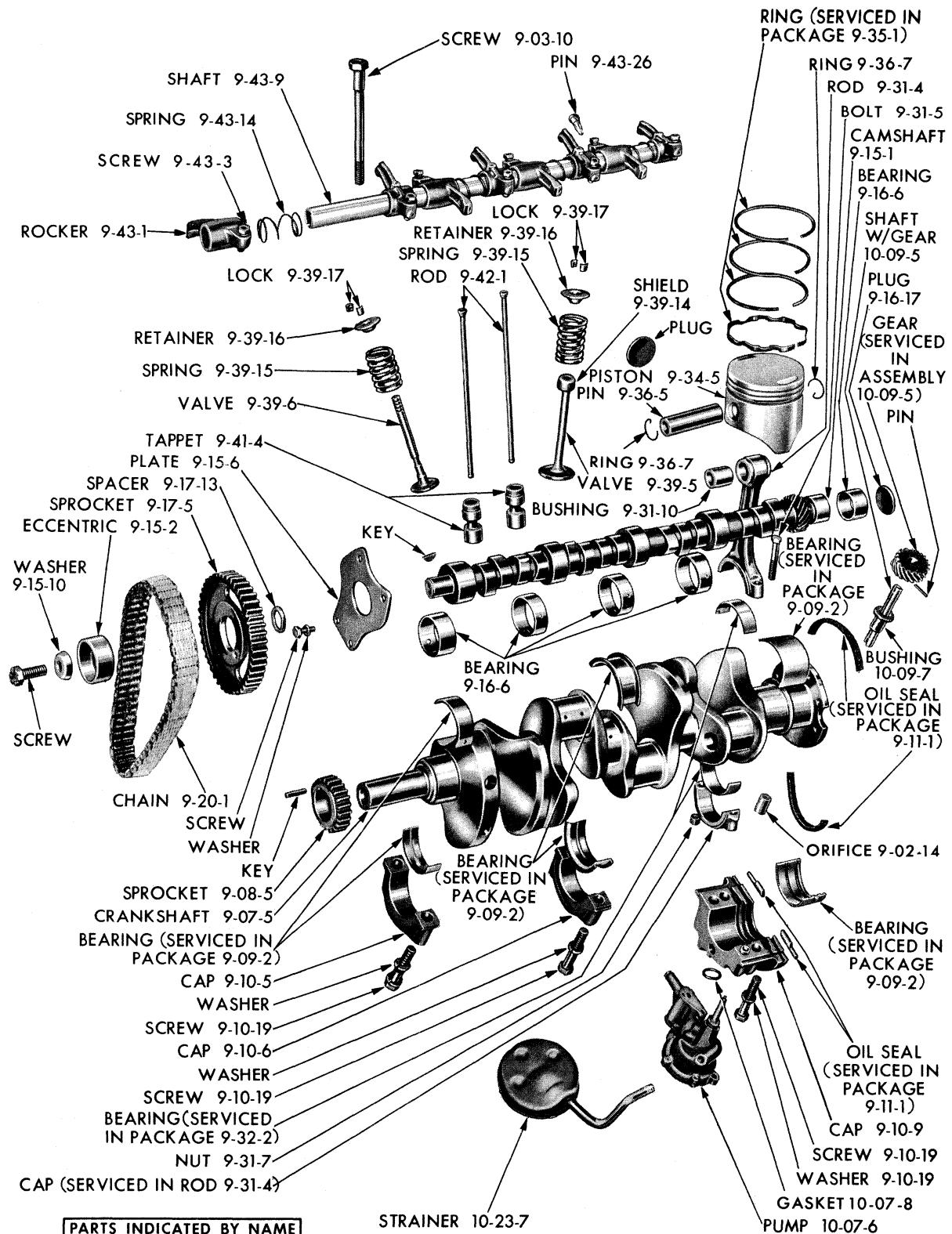

PARTS INDICATED BY NAME
ONLY ARE STANDARD PARTS
—ORDER BY DESCRIPTION.

19x6914C

ENGINE - INTERNAL PARTS - V8 CYLINDER (EXCEPT HIGH PERFORMANCE)

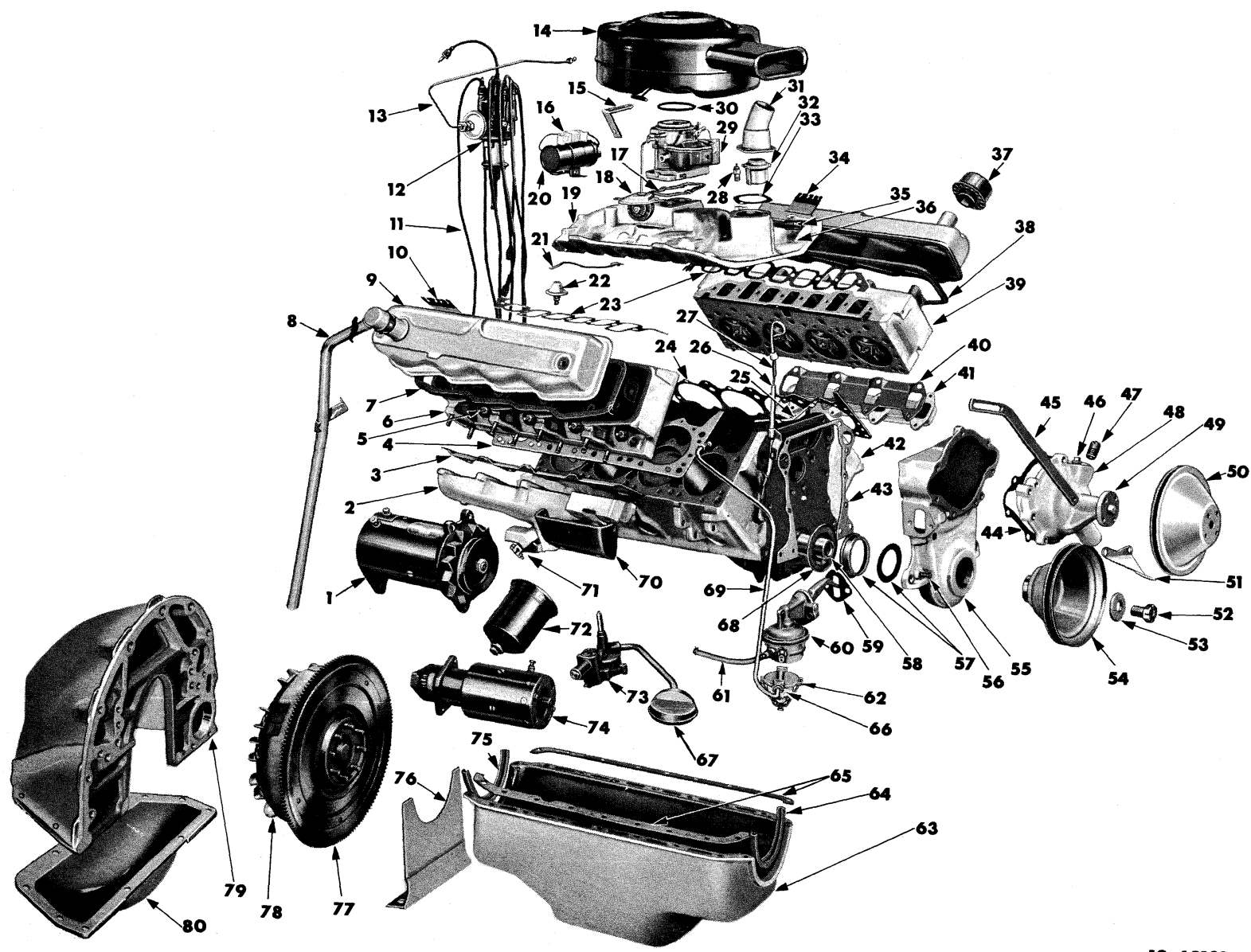

ENGINE - EXTERNAL PARTS - V8 CYLINDER (EXCEPT HIGH PERFORMANCE)

19L6913B

ENGINE - EXTERNAL PARTS - V8 CYLINDER (EXCEPT HIGH PERFORMANCE)

Ref. No.	Name	Part Type Code	Ref. No.	Name	Part Type Code
1	Generator	8-28-3	43	Gasket	9-23-17
2	Manifold	9-48-6	44	Gasket	7-44-3
3	Gasket	9-50-5	45	Strap	8-28-15
4	Gasket	9-03-5	46	Plug	
5	Spark Plug	8-36-114	47	Nipple	7-48-22
6	Head	9-03-4	48	Pump Package	7-42-1
7	Gasket	9-03-29	49	Hub	7-05-1
8	Pipe	10-02-15	50	Pulley	7-06-14
9	Cover	9-03-28	51	Indicator	9-23-40
10	Bracket	8-36-4	52	Screw	9-07-8
11	Cable	8-36-1	53	Washer	9-07-22
12	Distributor	8-27-1	54	Pulley	7-06-1
13	Tube	8-27-320	55	Cover	9-23-5
14	Air Cleaner	14-29-2	56	Screw	9-23-10
15	Bracket	14-06-10	57	Oil Seal	9-23-18
16	Resistor	8-35-22	58	Crankshaft	9-07-5
17	Gasket	14-30-2	59	Gasket	14-74-1
18	Choke, w/Rod	14-64-2	60	Pump	14-73-2
19	Manifold	9-48-7	61	Hose	14-89-57
20	Coil	8-35-4	62	Filter	14-67-1
21	Gasket	9-50-6	63	Pan	10-24-4
22	Switch	8-53-327	64	Gasket (serviced in package 10-24-1)	
23	Gasket	9-50-6	65	Gasket (serviced in package 10-24-1)	
24	Gasket	9-03-5	66	Bowl Package	14-67-8
25	Gasket	9-50-6	67	Strainer	10-23-7
26	Tube	10-03-7	68	Oil Slinger	9-07-17
27	Indicator	10-03-4	69	Tube	14-85-1
28	Sending Unit	8-37-155	70	Bracket	8-28-36
29	Carburetor	14-30-1	71	Shield	9-58-12
30	Gasket	14-29-5	72	Shell	10-26-14
31	Elbow	9-05-5	73	Pump	10-07-6
32	Thermostat	7-41-4	74	Starting Motor	8-52-4
33	Gasket	9-05-6	75	Gasket (serviced in package 10-24-1)	
34	Bracket	8-36-4	76	Cover	9-46-93
35	Nipple	7-48-22	77	Gear	9-45-2
36	Manifold	9-48-6	78	Torque Converter	9-46-4
37	Air Cleaner	10-01-21	79	Housing	9-46-90
38	Gasket	9-03-29	80	Pan	9-46-137
39	Head	9-03-4			
40	Gasket	9-50-5			
41	Manifold	9-48-6			
42	Block				

PARTS INDICATED BY NAME ONLY - ORDER BY DESCRIPTION

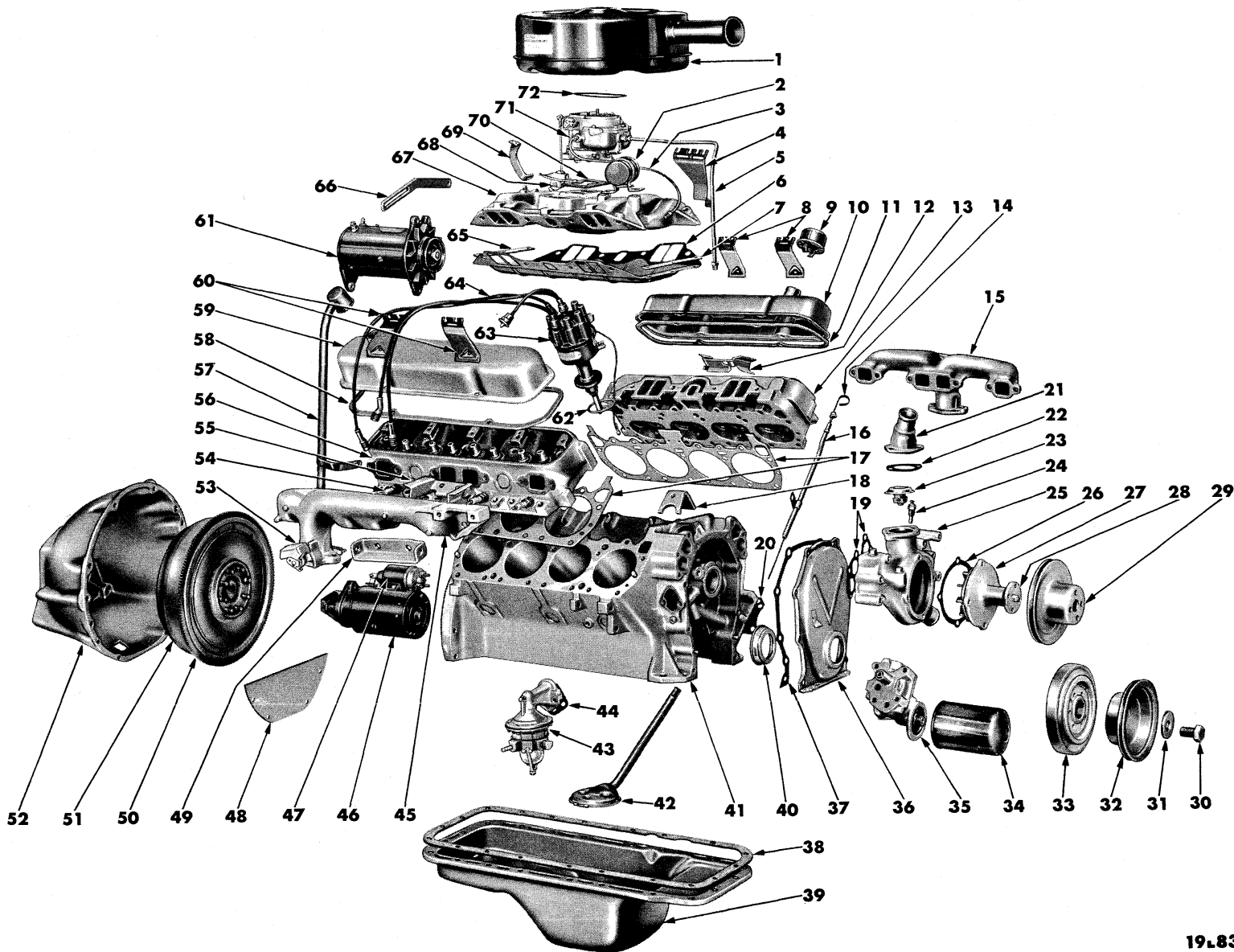

ENGINE - EXTERNAL PARTS - V8 CYLINDER (HIGH PERFORMANCE)

19L8326A

ENGINE - EXTERNAL PARTS - V8 CYLINDER (HIGH PERFORMANCE)

Ref. No.	Name	Part Type Code	Ref. No.	Name	Part Type Code
1	Air Cleaner	14-29-2	38	Gasket	10-24-8
2	Coil	8-35-4	39	Pan	10-24-4
3	Tube	8-77-320	40	Oil Seal	9-23-18
4	Bracket	8-36-4	41	Block (serviced in short engine 9-01-24)	
5	Tube	14-85-1	42	Strainer	10-23-7
6	Gasket	9-50-6	43	Pump Package	14-73-1
7	Reinforcement	9-48-27	44	Gasket	14-74-1
8	Bracket	8-36-4	45	Manifold	9-48-6
9	Air Cleaner	10-01-21	46	Starter	8-52-4
10	Cover	9-03-28	47	Switch	8-52-330
11	Gasket	9-03-29	48	Cover	9-46-93
12	Shield	8-36-124	49	Bracket	8-28-36
13	Head	9-03-4	50	Gear	9-45-2
14	Indicator	10-03-4	51	Torque Converter	9-46-4
15	Manifold	9-48-6	52	Housing	9-46-90
16	Tube	10-03-7	53	Shield	9-58-12
17	Gasket	9-03-5	54	Spark Plug	8-36-114
18	Clamp	8-27-26	55	Shield	8-36-124
19	Gasket	7-44-4	56	Head	9-03-4
20	Gasket	10-07-11	57	Pipe	10-02-15
21	Elbow	9-05-5	58	Gasket	9-03-29
22	Gasket	9-05-6	59	Cover	9-03-28
23	Thermostat	7-41-4	60	Bracket	8-36-4
24	Fitting		61	Generator	8-28-3
25	Housing	7-43-1	62	Retainer	8-27-4
26	Gasket	7-44-3	63	Distributor	8-27-1
27	Pump Package	7-42-1	64	Cable Set	8-36-1
28	Hub	7-05-1	65	Reinforcement	9-48-27
29	Pulley	7-06-14	66	Strap	8-28-15
30	Screw	9-07-8	67	Manifold	9-48-7
31	Washer	9-07-22	68	Choke	14-64-2
32	Pulley	7-06-1	69	Bracket	14-29-12
33	Damper	9-13-5	70	Gasket	14-34-2
34	Oil Filter	10-26-6	71	Carburetor	14-30-1
35	Pump	10-07-6	72	Gasket	14-29-5
36	Cover	9-23-5			
37	Gasket	9-23-17			

PARTS INDICATED BY NAME ONLY - ORDER BY DESCRIPTION

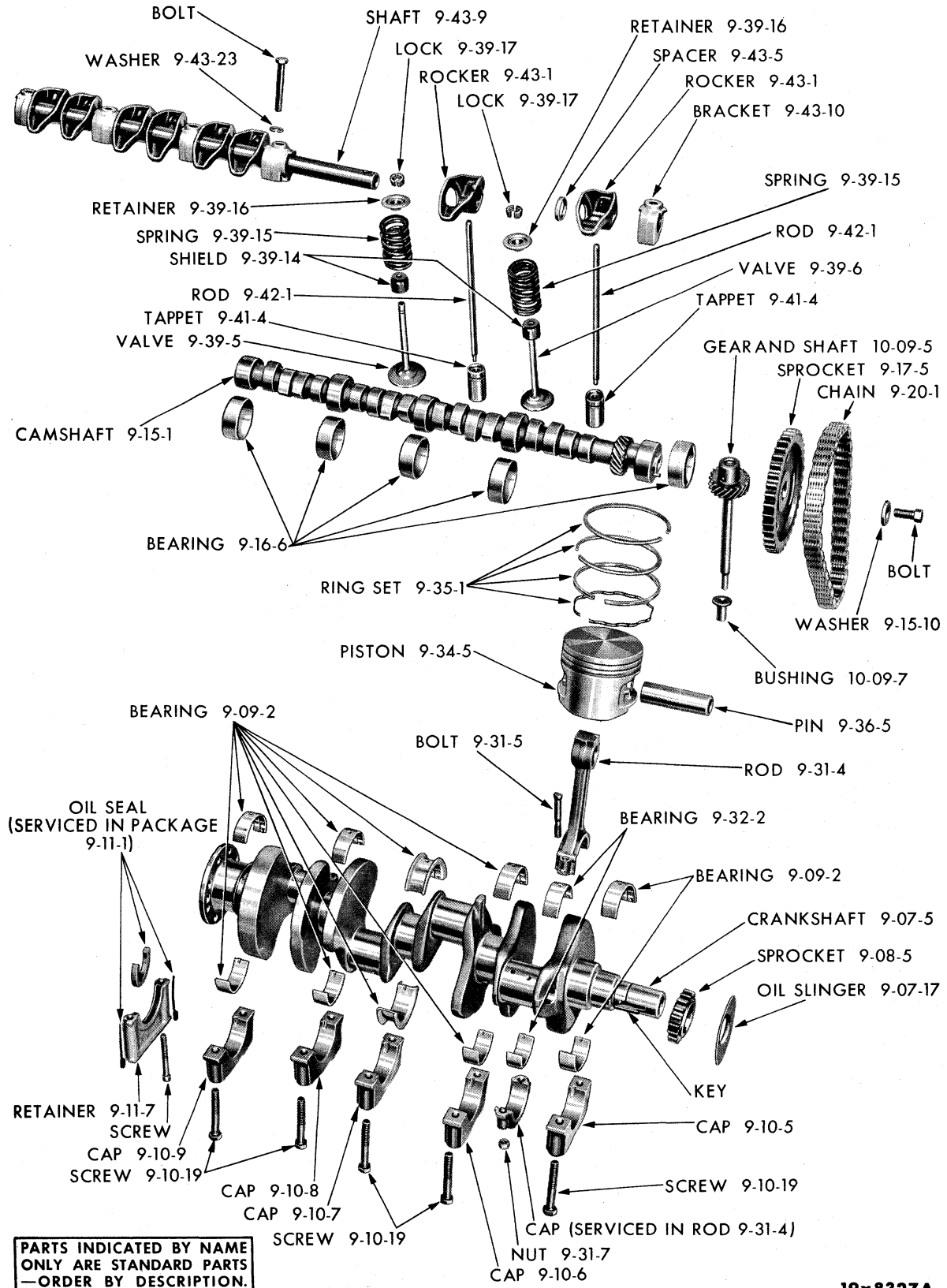

19x8327A

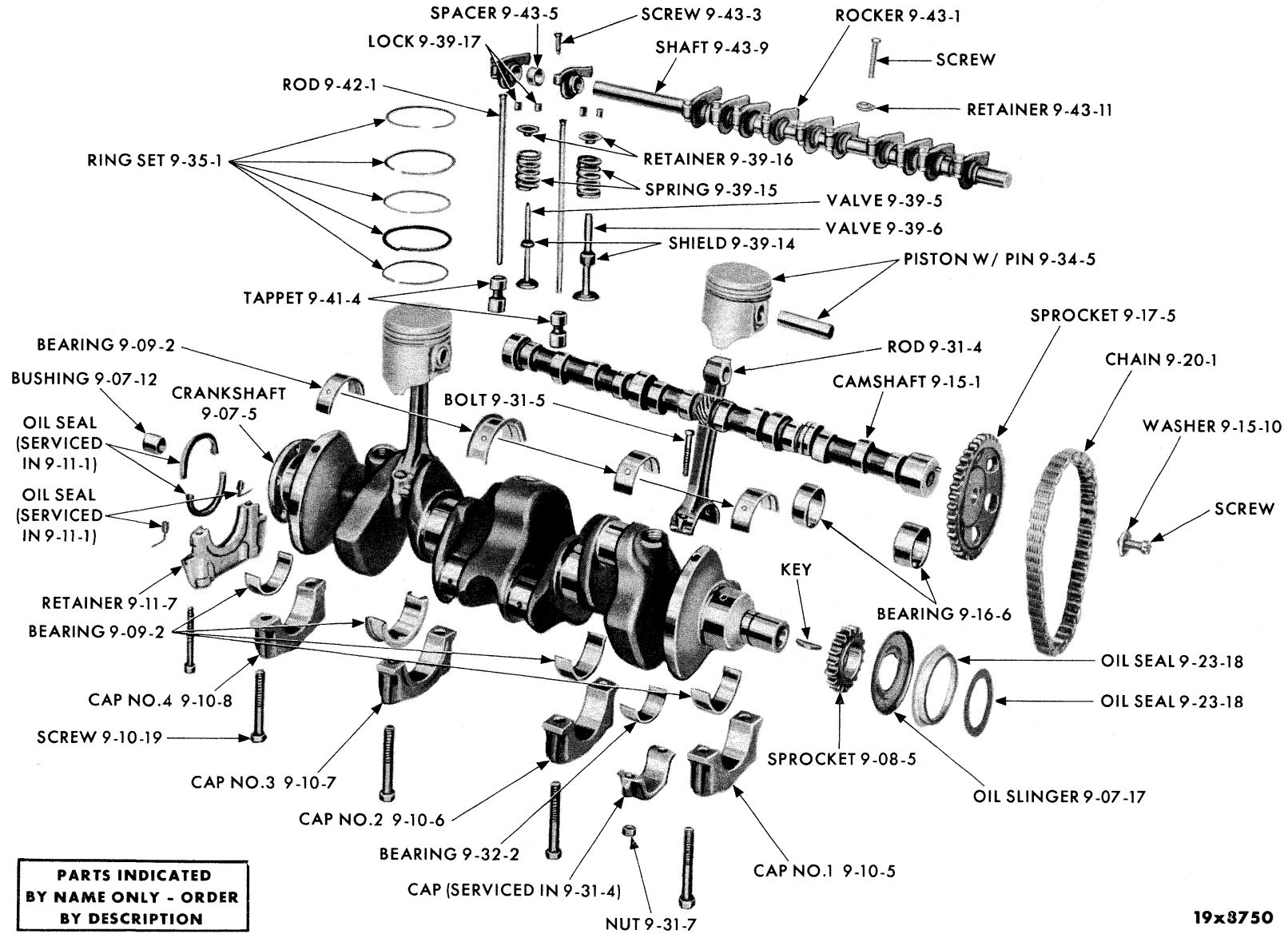

**PARTS INDICATED
BY NAME ONLY - ORDER
BY DESCRIPTION**

19x8750

ENGINE - INTERNAL PARTS - 6 CYLINDER

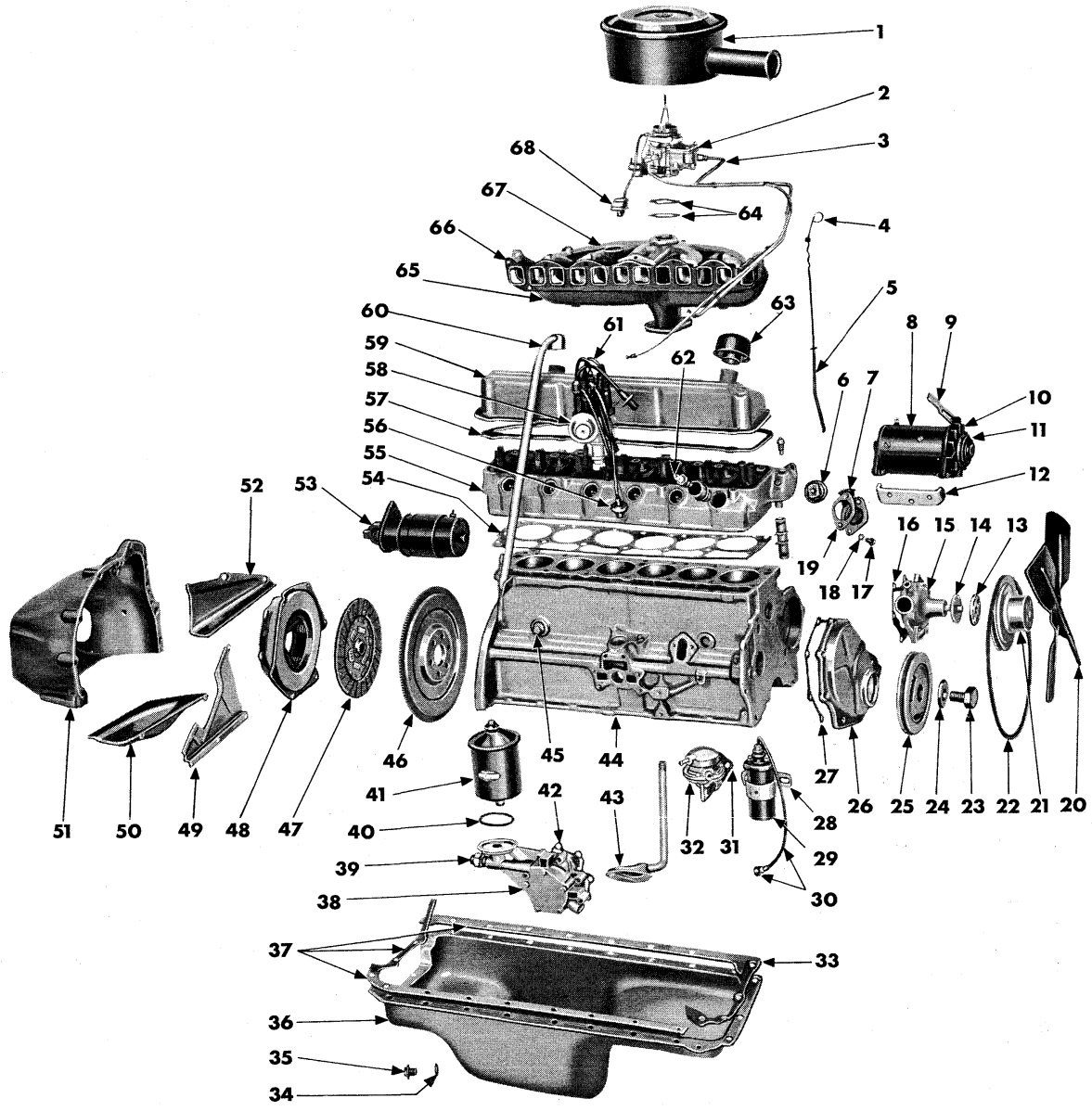

ENGINE - EXTERNAL PARTS - 6 CYLINDER

19L8794

ENGINE - EXTERNAL PARTS - 6 CYLINDER

Ref. No.	Name	Part Type Code	Ref. No.	Name	Part Type Code
1	Air Cleaner	14-29-2	35	Plug	10-24-37
2	Carburetor	14-30-1	36	Pan	10-24-4
3	Tube	14-89-2	37	Gasket (Serviced in 10-26-1)	
4	Indicator	10-03-4	38	Pump	10-07-6
5	Tube	10-03-7	39	Cap	10-22-40
6	Thermostat	7-41-4	40	Gasket (Serviced in 10-26-6)	
7	Elbow	9-05-5	41	Filter	10-26-6
8	Generator	8-28-3	42	Gasket	10-07-11
9	Strap	8-28-15	43	Strainer	10-23-7
10	Fan	8-28-299	44	Block	9-02-5
11	Pulley	8-28-297	45	Plug	
12	Bracket	8-28-36	46	Flywheel	9-45-1
13	Spacer	7-02-16	47	Disc	6-13-1
14	Hub	7-05-1	48	Cover, w/Plate	6-14-1
15	Pump Package	7-42-4	49	Seal	6-10-10
16	Gasket	7-44-4	50	Pan	6-10-2
17	Screw		51	Housing	6-09-1
18	Washer		52	Strut	6-09-11
19	Gasket	9-05-6	53	Starter	8-52-4
20	Fan	7-02-1	54	Gasket	9-03-5
21	Pulley	7-06-14	55	Head	9-03-4
22	Belt	7-03-1	56	Cover	8-36-117
23	Screw	9-07-8	57	Gasket	9-03-29
24	Washer	9-07-22	58	Distributor	8-27-1
25	Damper	9-13-5	59	Cover	9-03-28
26	Cover	9-23-5	60	Pipe	10-02-15
27	Gasket	9-23-17	61	Cable Set	8-36-1
28	Bracket	8-35-41	62	Spark Plug	8-36-114
29	Coil	8-35-4	63	Air Cleaner	10-01-21
30	Cable	8-36-49	64	Gasket	14-30-2
31	Gasket	14-74-1	65	Manifold	9-48-6
32	Pump Package	14-73-1	66	Gasket (Serviced in 9-50-1)	
33	Gasket	10-24-1	67	Manifold	9-48-7
34	Gasket	10-24-38	68	Choke	14-39-45

PARTS INDICATED BY NAME ONLY - ORDER BY DESCRIPTION

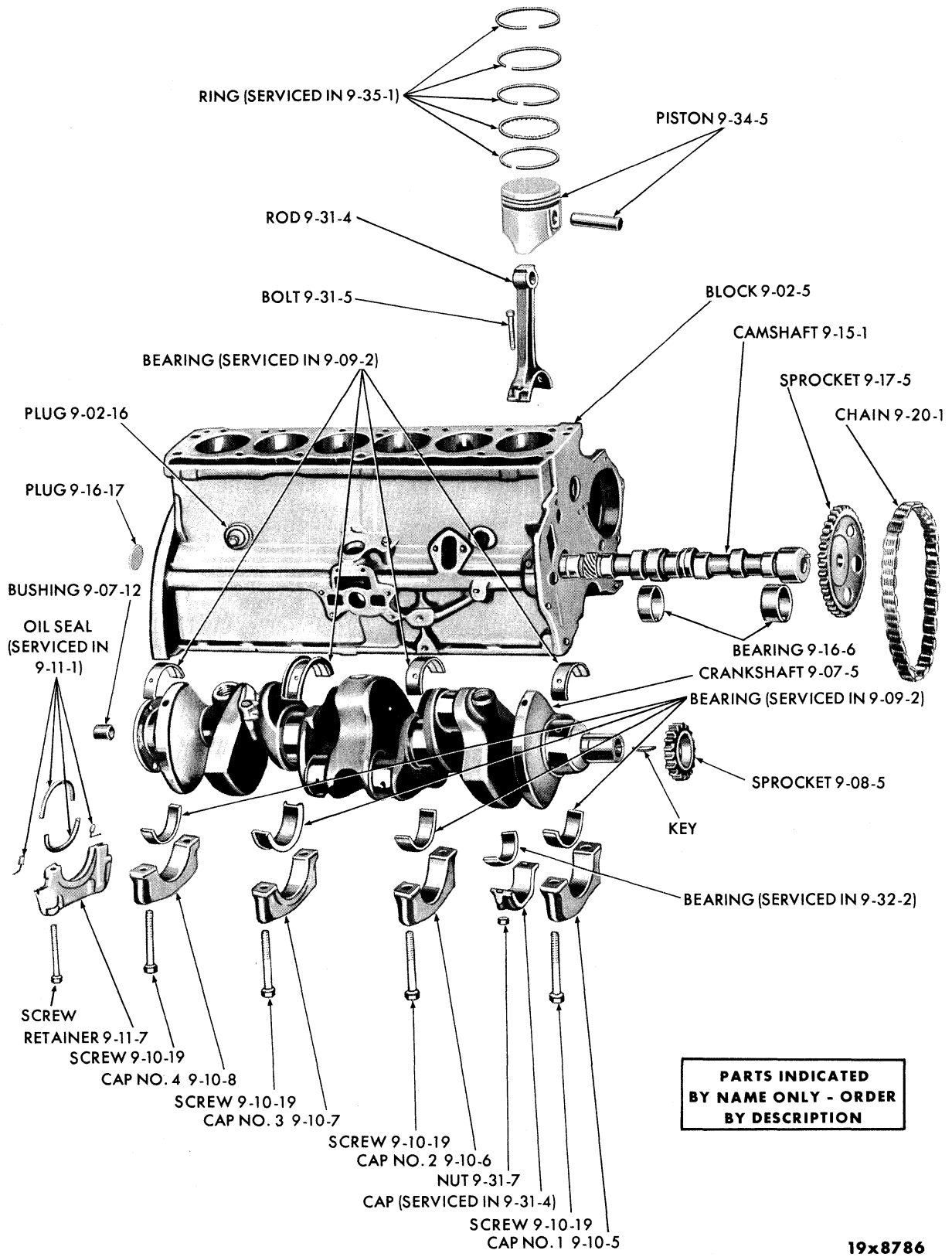

**PARTS INDICATED
BY NAME ONLY - ORDER
BY DESCRIPTION**

19x8786

SHORT ENGINE - 6 CYLINDER

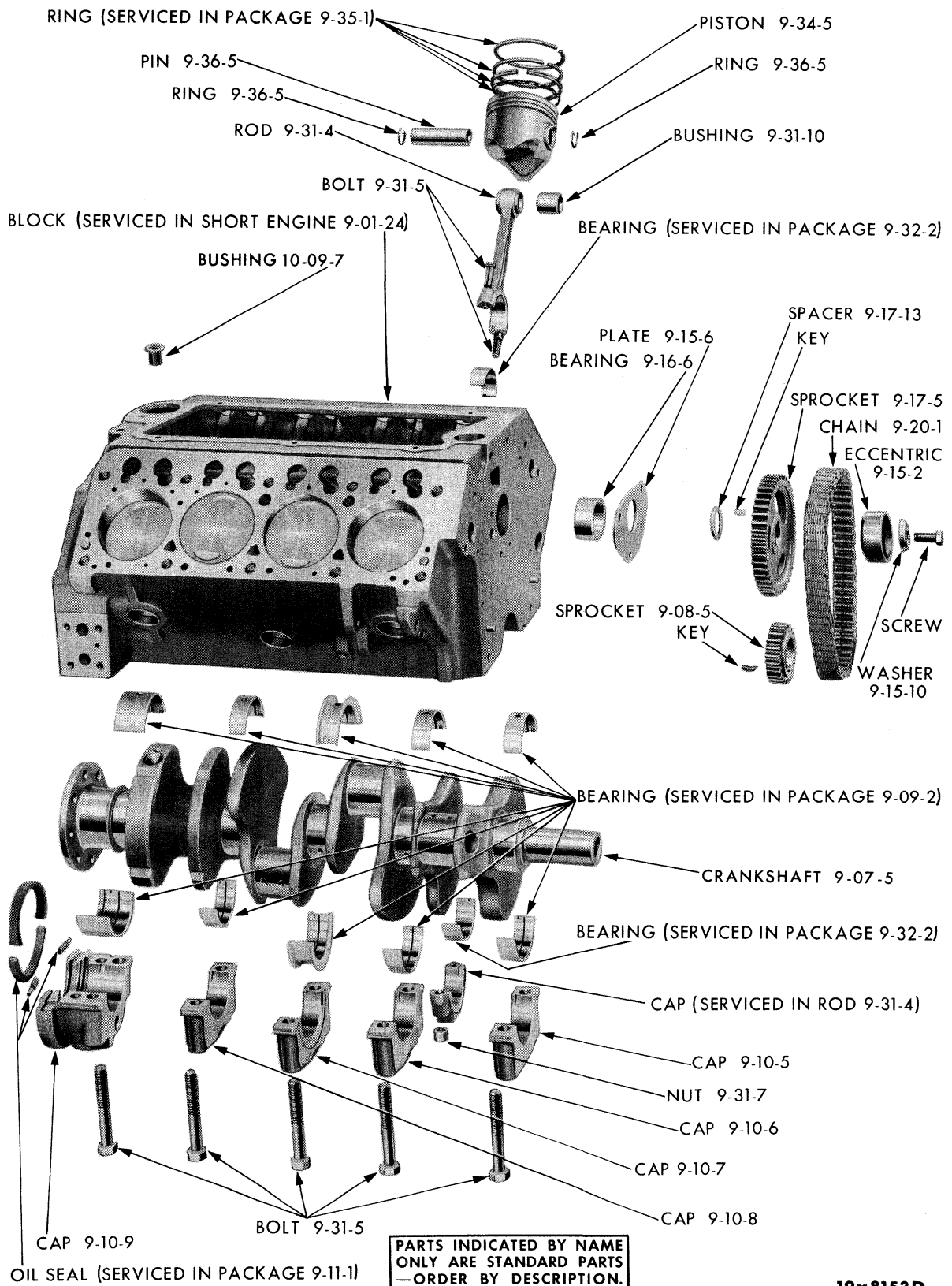

19x8153D

SHORT ENGINE - V8 CYLINDER

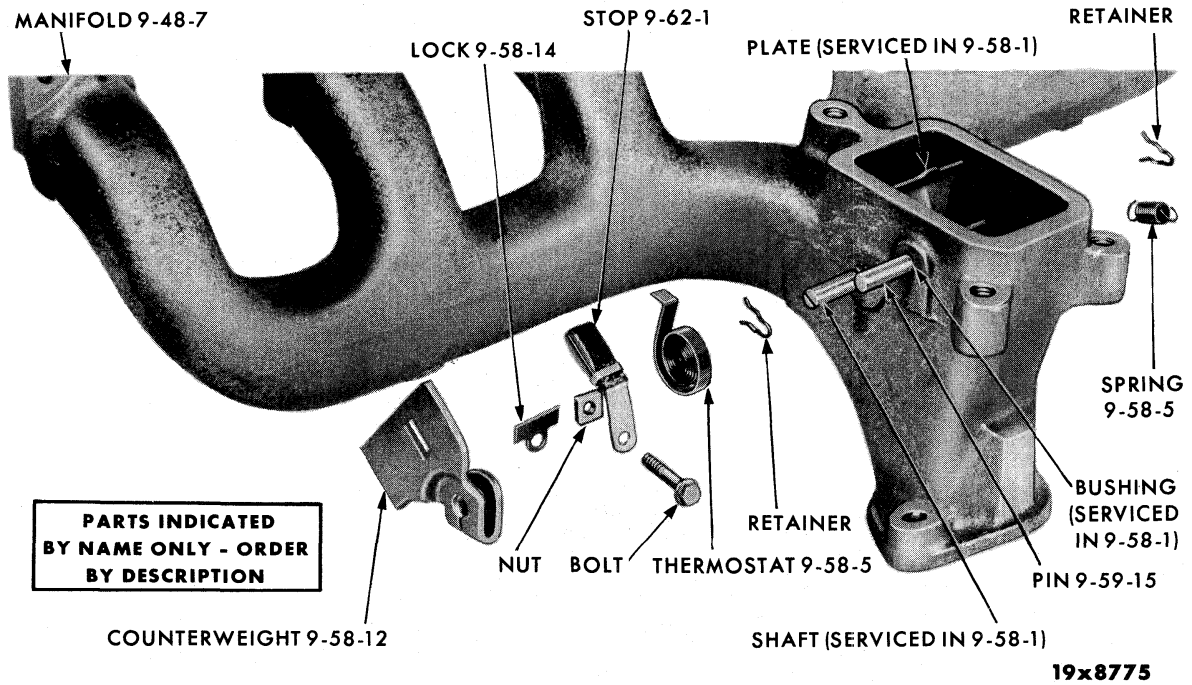

MANIFOLD HEAT CONTROLS - 6 CYLINDER

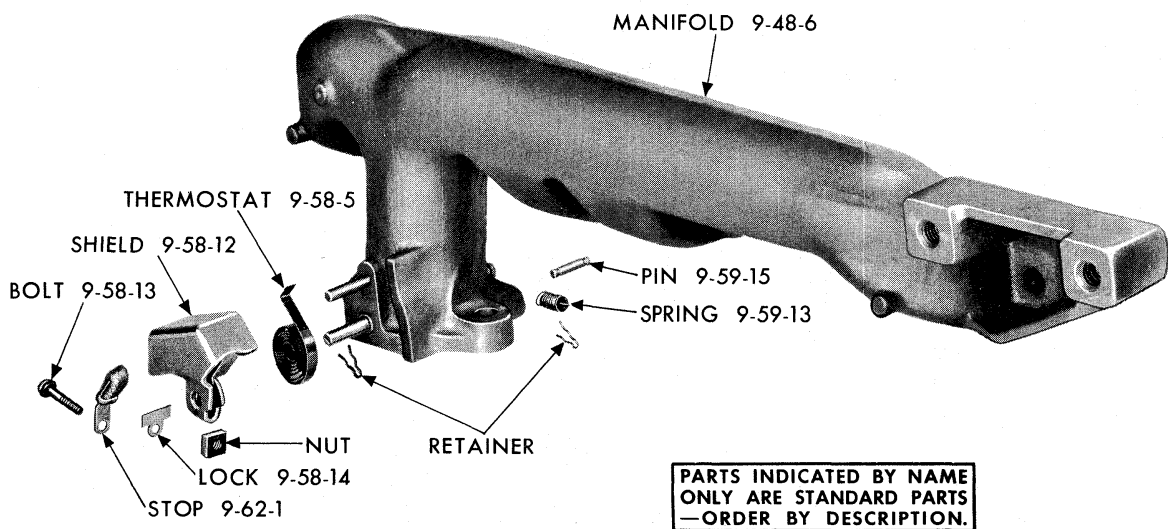

MANIFOLD HEAT CONTROLS - V8 CYLINDER

CODE	PART NAME AND DESCRIPTION	NO. OF CYL.	PLYMOUTH	DODGE	DESOTO	CHRYSLER AND IMPERIAL	PER CAR	PART NUMBER
------	---------------------------	-------------	----------	-------	--------	-----------------------	---------	-------------

GROUP 9 - ENGINE

9-01-0 ENGINE ASSEMBLY

NOTE: The following symbols are used in connection with engine numbers:

Engine numbers without symbols indicate "Standard Cylinders and Crankshaft Bearings."
 The Letter "A" immediately following the engine number indicated Bore .020" (.508 MM.) Larger than Standard.
 The Letter "B" immediately following the engine number indicated Main and Connecting Rod Bearings .010" (.245 MM.) Smaller than Standard.
 The Letters "AB" immediately following the engine number indicate Cylinder Bore .020" (.508 MM.)

Larger than Standard and the Main and Connecting Rod Bearings .010" (.254 MM.) Smaller than Standard.

The letters in the circular pads at either end of the engine number are for the use of factory inspectors only and should not be connected with the engine number.
 Always mention Serial Numbers when ordering major assemblies.

NOTE A: PC1 - Engine parts that are required for service on Chrysler Windsor model PC1 which has an engine stamping beginning with P38 - and starting with Serial No. 81 - 03167320 and intermittently to and including Serial No. 81-03168115 must be specified as a PS3 - DeSoto as listed.

PC2 - Engine parts that are required for service on Chrysler Saratoga PC2 which has a 413 cubic inch engine stamping beginning with P41 - and starting with Serial No. 82 - 0316884 and intermittently to and including Serial No. 82 - 03168116 must be specified as a New Yorker PC3 as listed.

9-01-5	GASKET SET	6	60	60	-	-	1	2196 045
	PD4, UP TO	8	60 (1)	60 (1)	-	-	1	2084 225
	PD4, AFTER	8	60 (1)	60 (1)	-	-	1	2196 087
	PP2 w/High Performance, PP2 w/Ram Manifold, PD4-D500, PD4 w/High Performance, PD1, PD2	8	60	60	60	-	1	1879 701
						60 (A)	1	*1879 702
NOTE:	Short Engine Assemblies consist of: The Cylinder Block with Pistons and Rings, Crankshaft and Bearings, Connecting Rods and Bearings, Camshaft and Bearings, Camshaft Thrust Plate, Camshaft and Crankshaft Sprockets and Timing Chain. On the 8 Cylinder Short Engine Assemblies some of the above parts have been left off to obtain a greater interchangeability.							
9-01-24	SHORT ENGINE, w/Standard Trans.	6	60	60	-	-	1	2128 793
	w/Automatic Trans.	6	60	60	-	-	1	2128 795
	w/Standard Trans., Export	6	60	60	-	-	1	2128 794
	w/Automatic Trans., Export	6	60	60	-	-	1	⊘2206 134
	PD4	8	60	60	-	-	1	1859 497
	PP2 w/High Performance, PP2 w/Ram Manifold, PD4-D500, PD4 Police Cars, PD1, PS1 w/361 cu. in. Engine	8	60	60	60	-	1	*1859 480
	PP2 Police Cars with one four Barrel Carburetor, two four Barrel Carburetors and w/Ram Manifold, PD1 w/High Performance, PD1-D500, PD1 Police Cars with one four Barrel Carburetor and with two four Barrel Carburetors, PD4 Police Cars with one four Barrel Carburetor, two four Barrel Carburetors and w/Ram Manifold, PD2, PS1 w/High Performance, PS1 w/Ram Manifold, PS1 w/Ram Manifold, PS3, w/383 cu. in. Engine	8	60	60	60	-	1	*2128 668

NOTE 1: Engine No. 65030.

NOTE A: See Note A

★ Indicates use as required.

⊘ Indicates parts not listed in any previous parts book.

* Indicates change or addition.

Numerals in parentheses () refer to notes.

Prices and specifications subject to change without notice.

1960 PASSENGER CAR PARTS CATALOG

ENGINE

CODE	PART NAME AND DESCRIPTION	NO. OF CYL.	PLYMOUTH	DODGE	DESOTO	CHRYSLER AND IMPERIAL	PER CAR	PART NUMBER
9-01-0 ENGINE ASSEMBLY - Cont'd								
9-01-24	SHORT ENGINE - Cont'd							
	PC1 w/Standard Trans.	8	-	-	-	60	1	2129 903
	PC1, PC2 w/Automatic Trans.	8	-	-	-	60 (A)	1	*1859 488
	PC3, PY1, PC3-300	8	-	-	-	60 (A)	1	*1859 492
	Export PD4	8	60	60	-	-	1	1859 499
	Export PS1, PD1, PD2 RHD.	8	-	60	60	-	1	1859 482
	Export PD2 LHD. PS1, PS3	8	-	60	60	-	1	1859 486
	Export PC1, PC2, w/Automatic Trans.	8	-	-	-	60	1	1859 490
	Export PC1 w/Standard Trans.	8	-	-	-	60	1	2129 904
	Export PC3, PY1	8	-	-	-	60	1	1859 494
9-02-0 CYLINDER BLOCK								
9-02-5	BLOCK, w/PISTONS and RINGS	6	60	60	-	-	1	2128 555
	L.C., Export	6	60	60	-	-	1	2128 556
9-02-7	DOWEL, Cylinder Block to Clutch Housing or Torque Converter Housing	8	60	60	60	60	2	1122 532
9-02-9	DOWEL, Cylinder Block to Bearing Cap, PD4.	8	60	60	-	-	1	1408 853
9-02-14	ORIFICE, Oil Line, PD4	8	60	60	-	-	1	1821 557
9-02-16	PLUG, Core Hole	6	60	60	-	-	1	2121 197
		6	60	60	-	-	4	2121 198
		8	60	60	60	60	6	1821 721
9-03-0 CYLINDER HEAD								
9-03-4	HEAD, w/Core Hole PLUG, UP TO	6	60 (2)	60 (2)	-	-	1	*2121 236
	AFTER	6	60 (2)	60 (2)	-	-	1	E2205 848
	PD4	8	60	60	-	-	2	1733 932
	PP2 w/High Performance, PP2 w/Ram Manifold, PD4 Police Cars, PD1, PS1, PC1, PC2	8	60	60	60	60 (A)	2	*2128 553
	PP2 Police Cars, PD4 w/High Performance, PD4-D500, PD1-D500, PD1 w/High Performance, PD2, PS1 w/High Performance, PS1 w/Ram Manifold, PS3, PC3, PY1.	8	-	60	60	60 (A)	2	*2128 589
9-03-5	GASKET	6	60	60	-	-	1	1947 578
	PD4	8	60	60	-	-	2	1947 354
	PP2 w/High Performance, PP2 w/Ram Manifold, PP2 Police Cars, PD1, PD2, PD4 w/High Performance, PD4-D500	8	60	60	60	60	2	1851 579
9-03-10	SCREW	6	60	60	-	-	14	1947 687
	Short, PD4	8	60	60	-	-	10	1618 695
	Long, PD4	8	60	60	-	-	10	1618 696
	Short, PP2 w/High Performance, PP2 w/Ram Manifold, PP2 Police Cars, PD1, PD2, PD4 w/High Performance, PD4-D500	8	60	60	60	60	24	1739 605
	Long, PP2 w/High Performance, PP2 w/Ram Manifold, PP2 Police Cars, PD1, PD2, PD4 w/High Performance, PD4-D500	8	60	60	60	60	10	1739 606
9-03-18	PLUG, Cylinder Head Core Hole, PP2 w/High Performance, PP2 w/Ram Manifold, PD4-D500, PD4 w/High Performance, PD1, PD2	8	60	60	60	60	4	1551 067
9-03-28	COVER, UP TO	6	60 (2)	60 (2)	-	-	1	*2121 469
	AFTER	6	60 (2)	60 (2)	-	-	1	E2129 617
	Right, PD4 UP TO	8	60 (1)	60 (1)	-	-	1	1859 432
	Left, PD4 UP TO	8	60 (1)	60 (1)	-	-	1	1945 506
	Right, PD4 AFTER	8	60 (1)	60 (1)	-	-	1	2128 404
	Left, PD4 AFTER	8	60 (1)	60 (1)	-	-	1	2128 405
	PP2 w/High Performance, PP2 w/Ram Manifold, PP2 Police Cars, PD1, PD2, PD4 w/High Performance, PD4-D500, PD4 Police Cars, Left	8	60	60	60	60	1	*1851 924

NOTE 1: Engine No. 65030.

NOTE 2: Engine No. P22-6-6.

NOTE A: See Page 9-7.

★ Indicates use as required. Numerals in parentheses () refer to notes. Printed in U.S.A.
 E Indicates parts not listed in any previous parts book. Prices and specifications subject to change without notice.
 Dec. 9, 1960 Supersedes April 20, 1960. Page 9-8 * Indicates change or addition.

CODE	PART NAME AND DESCRIPTION	NO. OF CYL.	PLYMOUTH	DODGE	DESOTO	CHRYSLER AND IMPERIAL	PER CAR	PART NUMBER
9-03-0 CYLINDER HEAD - Cont'd								
9-03-28	COVER - Cont'd PP2 High Performance, PP2 Ram Manifold, PP2 Police Cars, PD1, PD2, PD4 w/High Performance, PD4-D500, PD4 Police Cars, Right	8	60	60	60	60	1	⊕2205 836
9-03-29	GASKET, Cover	6	60	60	-	-	1	2121 244
	PD4 AFTER	8	60	60	-	-	2	*2128 407
	PP2 w/High Performance, PP2 w/Ram Manifold, PP2 Police Cars, PD1, PD2, PD4 w/High Performance, PD4-D500, PD4 Police Cars	8	60	60	60	60	2	1821 440
9-05-0 CYLINDER HEAD WATER OUTLET ELBOW								
9-05-5	ELBOW, w/o Power Steering	6	60	60	-	-	1	2121 524
	w/Power Steering	6	60	60	-	-	1	2121 908
		8	60	60	60	60	1	1855 393
	w/Air Conditioning, PP2 w/High Performance, PP2 w/Ram Manifold, PD4-D500, PD4 w/High Performance, PD1, PD2	8	60	60	60	60	1	1855 605
	w/Air Conditioning Model E	8	60	60	60	60	1	1859 542
9-05-6	GASKET, Cylinder Water Outlet Elbow	6	60	60	-	-	1	1947 671
		8	60	60	60	60	1	50 082
9-07-0 CRANKSHAFT								
9-07-5	CRANKSHAFT, w/Std., Trans., UP TO	6	60 (2)	60 (2)	-	-	1	*2120 466
	w/Automatic Trans., UP TO	6	60 (2)	60 (2)	-	-	1	*2120 774
	AFTER	6	60 (2)	60 (2)	-	-	1	⊕2202 488
	PD4	8	60	60	-	-	1	1859 752
	PP2 w/High Performance, PP2 w/Ram Manifold, PD1, PD2, PD4-D500, PD4 w/High Performance	8	60	60	60	-	1	1851 869
	w/Automatic Trans.	8	-	-	-	60 (A)	1	*1851 527
	w/Std. Trans., PC1	8	-	-	-	60	1	2129 735
9-07-8	SCREW	6	60 (1)	60 (1)	-	-	1	2128 569
	w/Std. Trans., PD4	8	60	60	-	-	1	1821 414
	w/Automatic Trans.	8	60	60	60	60	1	1731 525
	w/Air Condition Model E PD4	8	60	60	-	-	1	1821 177
9-07-12	BUSHING, Crankshaft, Transmission Drive Pinion Pilot, PC1	6-8	60	60	-	60	1	53 298
9-07-17	OIL SLINGER	6-8	60	60	60	60	1	1618 686
9-07-22	WASHER, Screw	6-8	60 (1)	60 (1)	60	60	1	1855 561
9-08-0 CRANKSHAFT SPROCKET								
9-08-5	SPROCKET	6	60	60	-	-	1	1737 621
	PD4	8	60	60	-	-	1	1632 280
	PP2 w/High Performance, PP2 w/Ram Manifold, PD1, PD2, PD4-D500, PD4 w/High Performance	8	60	60	60	60	1	1737 621

NOTE 1: UP TO Engine No. P22-1-27.

NOTE 2: Engine No. P22-5-31.

NOTE A: See Page 9-7.

★ Indicates use as required.

⊕ Indicates parts not listed in any previous parts book.

* Indicates change or addition.

Numerals in parentheses () refer to notes.

Prices and specifications subject to change without notice.

1960 PASSENGER CAR PARTS CATALOG

ENGINE

CODE	PART NAME AND DESCRIPTION	NO. OF CYL.	PLYMOUTH	DODGE	DESOTO	CHRYSLER AND IMPERIAL	PER CAR	PART NUMBER
------	---------------------------	-------------	----------	-------	--------	-----------------------	---------	-------------

9-09-0 CRANKSHAFT BEARING PACKAGES

NOTE: When .001 thicker wall crankshaft main bearings are used for engines in production an identification mark is stamped on the machined surface of the crankshaft center counterweight for six cylinder engines and No. 3 counterweight for V8 cylinder engines. When the thicker wall crankshaft bearings are used the crankshaft will be marked M1, M2, M3, M4 or M5 depending on which journal has the .001 thicker wall bearing.

NOTE: Crankshaft Bearing Packages consist of one upper and one lower bearing.

9-09-2	BEARING PACKAGE, No. 1 Std.	6	60	60	-	-	2	*2084 391
	No. 3, Std.	6	60	60	-	-	1	2084 399
	Nos. 2 and 4, Std.	6	60	60	-	-	1	*2084 395
	No. 1, .001 U/S	6	60	60	-	-	2	*2084 392
	No. 3, .001 U/S	6	60	60	-	-	1	2084 400
	Nos. 2 and 4, .001 U/S	6	60	60	-	-	1	*2084 396
	No. 1, .002 U/S	6	60	60	-	-	2	*2084 393
	No. 3, .002 U/S	6	60	60	-	-	1	2084 401
	Nos. 2 and 4, .002 U/S	6	60	60	-	-	1	*2084 397
	No. 1, .010 U/S	6	60	60	-	-	2	*2084 394
	No. 3, .010 U/S	6	60	60	-	-	1	2084 402
	Nos. 2 and 4, .010 U/S	6	60	60	-	-	1	*2084 398
	Nos. 1, 2 and 4, Std., PD4	8	60	60	-	-	3	2084 005
	No. 3, Std., PD4	8	60	60	-	-	1	1879 627
	No. 5, Std., PD4	8	60	60	-	-	1	1643 151
	Nos. 1, 2 and 4, .001 U/S, PD4	8	60	60	-	-	3	2084 006
	No. 3, .001 U/S, PD4	8	60	60	-	-	1	1879 628
	No. 5, .001 U/S, PD4	8	60	60	-	-	1	1643 152
	Nos. 1, 2 and 4, .002 U/S, PD4	8	60	60	-	-	3	2084 007
	No. 3, .002 U/S, PD4	8	60	60	-	-	1	1879 629
	No. 5, .002 U/S, PD4	8	60	60	-	-	1	1643 153
	Nos. 1, 2 and 4, .003 U/S, PD4	8	60	60	-	-	3	E2275 387
	No. 3, .003 U/S, PD4	8	60	60	-	-	1	E2275 389
	Nos. 1, 2 and 4, .010 U/S, PD4	8	60	60	-	-	3	2084 008
	No. 3, .010 U/S, PD4	8	60	60	-	-	1	1879 630
	No. 5, .010 U/S, PD4	8	60	60	-	-	1	1643 155
	Nos. 1, 2 and 4, .012 U/S, PD4	8	60	60	-	-	3	E2275 388
	No. 3, .003 U/S, PD4	8	60	60	-	-	1	E2275 390
	No. 1, Std., PP2 w/High Performance, PP2 w/Ram Manifold, PP2 Police Cars, PD1, PD2, PD4-D500, PD4 w/High Performance, PD4 Police Cars	8	60	60	60	-	1	2084 810
	Nos. 2, 4 and 5, Std., PP2 w/High Performance, PP2 w/Ram Manifold, PP2 Police Cars, PD1, PD2, PD4-D500, PD4 w/High Performance, PD4 Police Cars	8	60	60	60	-	3	2084 833
	No. 3, Std., PP2 w/High Performance, PP2 w/Ram Manifold, PD1, PD2, PD4-D500, PD4 w/High Performance	8	60	60	60	-	1	1818 524
	No. 1, .001 U/S, PP2 w/High Performance, PP2 w/Ram Manifold, PP2 Police Cars, PD1, PD2, PD4-D500, PD4 w/High Performance, PD4 Police Cars	8	60	60	60	-	1	2084 811
	Nos. 2, 4 and 5, .001 U/S, PP2 w/High Performance, PP2 w/Ram Manifold, PP2 Police Cars, PD1, PD2, PD4-D500, PD4 w/High Performance, PD4 Police Cars	8	60	60	60	-	3	2084 834
	No. 3, .001 U/S, PP2 w/High Performance, PP2 w/Ram Manifold, PD1, PD2, PD4-D500, PD4 w/High Performance	8	60	60	60	-	1	1818 525
	No. 1, .002 U/S, PP2 w/High Performance, PP2 w/Ram Manifold, PD1, PD2, PD4-D500, PD4 w/High Performance	8	60	60	60	-	1	2084 812
	Nos. 2, 4 and 5, .002 U/S, PP2 w/High Performance, PP2 w/Ram Manifold, PP2 Police Cars, PD1, PD2, PD4-D500, PD4 w/High Performance, PD4 Police Cars	8	60	60	60	-	3	2084 835

★ Indicates use as required.

Numerals in parentheses () refer to notes.

Printed in U.S.A.

E Indicates parts not listed in any previous parts book.

Prices and specifications subject to change without notice.

Dec. 9, 1960 Supersedes April 20, 1960.

* Indicates change or addition.

CODE	PART NAME AND DESCRIPTION	NO. OF CYL.	PLYMOUTH	DODGE	DESOTO	CHRYSLER AND IMPERIAL	PER CAR	PART NUMBER
9-09-0 CRANKSHAFT BEARING PACKAGES - Cont'd								
9-09-2	BEARING PACKAGE - Cont'd							
	No. 3, .002 U/S, PP2 w/High Performance, PP2 w/Ram Manifold, PD1, PD2, PD4-D500, PD4 w/High Performance	8	60	60	60	-	1	1818 526
	No. 1, .003 U/S, PP2 Police Cars, PP2 w/High Performance, PP2 w/Ram Manifold, PD1, PD2, PD4-D500, PD4 w/High Performance	8	60	60	60	-	1	E2275 391
	Nos. 2, 4 and 5, .003 U/S, PP2 w/High Performance, PP2 w/Ram Manifold, PP2 Police Cars, PD1, PD2, PD4-D500, PD4 w/High Performance	8	60	60	60	-	3	E2275 393
	No. 1, .010 U/S, PP2 w/High Performance, PP2 w/Ram Manifold, PD1, PD2, PD4-D500, PD4 w/High Performance	8	60	60	60	-	1	2084 813
	Nos. 2, 4 and 5, .010 U/S, PP2 w/High Performance, PP2 w/Ram Manifold, PP2 Police Cars, PD1, PD2, PD4-D500, PD4 w/High Performance, PD4 Police Cars . . .	8	60	60	60	-	3	2084 836
	No. 3, .010 U/S, PP2 w/High Performance, PP2 w/Ram Manifold, PD1, PD2, PD4-D500, PD4 w/High Performance	8	60	60	60	-	1	1818 528
	No. 1, .012 U/S, PP2 w/High Performance, PP2 w/Ram Manifold, PP2 Police Cars, PD1, PD2, PD4-D500, PD4 w/High Performance	8	60	60	60	-	1	E2275 392
	Nos. 2, 4 and 5, .012 U/S, PP2 w/High Performance, PP2 Ram Manifold, PP2 Police Cars, PD1, PD2, PD4-D500, PD4 High Performance	8	60	60	60	-	3	E2275 394
	No. 1, Std.	8	-	-	-	60 (A)	1	*2084 814
	Nos. 2, 4 and 5 Std.	8	-	-	-	60 (A)	3	*2084 829
	No. 3, Std.	8	-	-	-	60 (A)	1	*1879 378
	No. 1, .001 U/S	8	-	-	-	60 (A)	1	*2084 815
	Nos. 2, 4 and 5, .001 U/S	8	-	-	-	60 (A)	3	*2084 830
	No. 3, .001 U/S	8	-	-	-	60 (A)	1	*1879 379
	No. 1, .002 U/S	8	-	-	-	60 (A)	1	*2084 816
	Nos. 2, 4 and 5, .002 U/S	8	-	-	-	60 (A)	3	*2084 831
	No. 3, .002 U/S	8	-	-	-	60 (A)	1	*1879 380
	No. 1, .003 U/S	8	-	-	-	60 (A)	1	E2275 395
	Nos. 2, 4 and 5, .003 U/S	8	-	-	-	60 (A)	3	E2275 397
	No. 1, .010 U/S	8	-	-	-	60 (A)	1	*2084 817
	Nos. 2, 4 and 5, .010 U/S	8	-	-	-	60 (A)	3	*2084 832
	No. 3, .010 U/S	8	-	-	-	60 (A)	1	*1879 382
	No. 1, .012 U/S	8	-	-	-	60 (A)	1	E2275 396
	Nos. 2, 4 and 5, .012 U/S	8	-	-	-	60 (A)	3	E2275 398
9-10-0 CRANKSHAFT BEARING CAP								
9-10-2	PACKAGE, Crankshaft Bearing, No. 5 Cap Oil Seal, PD4	8	60	60	-	-	1	1326 091
9-10-5	CAP, No. 1	6	60	60	-	-	1	2084 403
	PD4	8	60	60	-	-	1	1643 168
	PP2 w/High Performance, PP2 w/Ram Manifold, PD1, PD2, PD4 w/High Performance, PD4-D500	8	60	60	60	-	1	1879 327
		8	-	-	-	60 (A)	1	*1879 325
9-10-6	CAP, No. 2	6	60	60	-	-	1	2084 403
	PD4	8	60	60	-	-	1	1643 168
	PP2 w/High Performance, PP2 w/Ram Manifold, PD1, PD2, PD4 w/High Performance, PD4-D500	8	60	60	60	-	1	1879 327
		8	-	-	-	60 (A)	1	*1879 325

NOTE A: See Page 9-7.

1960 PASSENGER CAR PARTS CATALOG

CODE	PART NAME AND DESCRIPTION	NO. OF CYL.	PLYMOUTH	DODGE	DESOTO	CHRYSLER AND IMPERIAL	PER CAR	PART NUMBER
9-10-0 CRANKSHAFT BEARING CAP - Cont'd								
9-10-7	CAP, No. 3	6	60	60	-	-	1	2084 405
	PD4	8	60	60	-	-	1	1643 169
	PP2 w/High Performance, PP2 w/Ram Manifold, PD1, PD2, PD4 w/High Performance, PD4-D500	8	60	60	60	-	1	1879 328
		8	-	-	-	60 (A)	1	*1879 326
9-10-8	CAP, No. 4	6	60	60	-	-	1	2084 404
	PD4	8	60	60	-	-	1	1643 168
	PP2 w/High Performance, PP2 w/Ram Manifold, PD1, PD2, PD4 w/High Performance, PD4-D500	8	60	60	60	-	1	1879 327
		8	-	-	-	60 (A)	1	*1879 325
9-10-9	CAP, No. 5, PD4	8	60	60	-	-	1	1643 170
	PP2 w/High Performance, PP2 w/Ram Manifold, PD1, PD2, PD4 w/High Performance, PD4-D500	8	60	60	60	-	1	1879 327
		8	-	-	-	60 (A)	1	*1879 325
9-10-19	SCREW	6	60	60	-	-	8	1408 867
		8	60	60	60	60	10	1408 867
9-11-0 CRANKSHAFT REAR BEARING OIL SEAL								
9-11-1	PACKAGE	6	60	60	-	-	1	2084 411
	PD4	8	60	60	-	-	1	1326 093
	PP2 w/High Performance, PP2 w/Ram Manifold, PD1, PD2, PD4-D500, PD4 w/High Performance	8	60	60	60	60	1	1818 781
9-11-7	RETAINER	6	60	60	-	-	1	1947 557
	PP2 w/High Performance, PP2 w/Ram Manifold, PD1, PD2, PD4-D500, PD4 w/High Performance	8	60	60	60	60	1	1821 389
9-13-0 CRANKSHAFT VIBRATION DAMPER								
9-13-5	DAMPER	6	60	60	-	-	1	2120 953
	PD4, Std. Trans.	8	60	60	-	-	1	1947 235
	PP2 w/High Performance, PP2 w/Ram Manifold, PD1, PD2, PD4-D500, PD4 w/High Performance	8	60	60	60	60	1	1947 897
9-15-0 CAMSHAFT								
9-15-1	CAMSHAFT	6	60	60	-	-	1	2128 644
	PD4	8	60	60	-	-	1	1947 016
	PP2 w/Power Package, PD4-H	8	60	60	-	-	1	1944 712
	PP2 w/High Performance, PP2 w/Ram Manifold, PD4 w/High Performance Police Only, PD4-D500, PD1 w/High Performance Police Only, PD1-D500, PS1 w/High Performance, PS1 w/Ram Manifold, PS3 w/High Performance, PS3 w/Ram Manifold, PC3-300	8	60	60	60	60	1	2129 203
	PD1, PD2, PD4 w/High Performance	8	-	60	60	60	1	1739 608
9-15-2	ECCENTRIC, PD4	8	60	60	-	-	1	1618 718
9-15-6	PLATE, Sprocket Hub Thrust, PD4	8	60	60	-	-	1	1946 992
9-15-10	WASHER, Sprocket Retaining	6	60	60	-	-	1	1739 607
	PD4	8	60	60	-	-	1	1618 732
	PP2 w/High Performance, PP2 w/Ram Manifold, PD1, PD2, PD4 w/High Performance, PD4-D500	8	60	60	60	60	1	1739 607

NOTE A: See Page 9-7.

* Indicates use as required.

Numerals in parentheses () refer to notes.

Printed in U.S.A.

⊠ Indicates parts not listed in any previous parts book.

Prices and specifications subject to change without notice.

Dec. 9, 1960 Supersedes April 20, 1960.

* Indicates change or addition.

CODE	PART NAME AND DESCRIPTION	NO. OF CYL.	PLYMOUTH	DODGE	DESOTO	CHRYSLER AND IMPERIAL	PER CAR	PART NUMBER
9-16-0 CAMSHAFT BEARING								
9-16-6	BEARING, No. 1	6	60	60	-	-	1	2121 725
	No. 2	6	60	60	-	-	1	1821 772
	No. 3	6	60	60	-	-	1	2121 726
	No. 4	6	60	60	-	-	1	2121 727
	No. 1, PD4	8	60	60	-	-	1	1632 522
	No. 2, PD4	8	60	60	-	-	1	1632 523
	No. 3, PD4	8	60	60	-	-	1	1632 524
	No. 4, PD4	8	60	60	-	-	1	1632 525
	No. 5, PD4	8	60	60	-	-	1	1632 526
	No. 1, PP2 w/High Performance, PP2 w/Ram Manifold, PD1, PD2, PD4 w/High Perform- ance, PD4-D500	8	60	60	60	60	1	1821 771
	No. 2, PP2 w/High Performance, PP2 w/Ram Manifold, PD1, PD2, PD4 w/High Perform- ance, PD4-D500	8	60	60	60	60	1	1821 772
	No. 3, PP2 w/High Performance, PP2 w/Ram Manifold, PD1, PD2, PD4 w/High Perform- ance, PD4-D500	8	60	60	60	60	1	1821 773
	No. 4, PP2 w/High Performance, PP2 w/Ram Manifold, PD1, PD2, PD4 w/High Perform- ance, PD4-D500	8	60	60	60	60	1	1821 774
	No. 5, PP2 w/High Performance, PP2 w/Ram Manifold, PD1, PD2, PD4 w/High Perform- ance, PD4-D500	8	60	60	60	60	1	1821 775
9-16-17	PLUG, Camshaft Rear Bearing	6	60	60	-	-	1	1947 786
	PD4	8	60	60	-	-	1	1821 722
	PP2 High Performance, PP2 Ram Manifold, PP2 Police Cars, PD1, PD2, PD4-D500, PD4 High Performance, PD4 Police Cars, PS1 High Performance, PS1 Ram Manifold	8	60	60	60	60	1	1852 177
9-17-0 CAMSHAFT SPROCKET								
9-17-5	SPROCKET, Camshaft, UP TO	6	60 (1)	60 (1)	-	-	1	*2128 587
	AFTER	6	60 (1)	60 (1)	-	-	1	*1947 560
	PD4	8	60	60	-	-	1	1618 666
	PP2 Ram Manifold, PD1-D500, PD2-D500, PD4-D500, PS1 Ram Manifold, PS3 Ram Manifold, PC3-300	8	60	60	60	60	1	2129 202
	PD4 w/High Performance, PD1, PD2	8	60	60	60	60	1	1737 622
9-17-13	SPACER, PD4	8	60	60	-	-	1	1618 717
9-20-0 TIMING CHAIN								
9-20-1	CHAIN	6	60	60	-	-	1	1737 620
	PD4	8	60	60	-	-	1	1618 736
	PP2 w/High Performance, PP2 w/Ram Manifold, PD1, PD2, PD4-D500, PD4 w/High Performance	8	60	60	60	60	1	1737 620
9-23-0 CHAIN CASE COVER								
9-23-5	COVER	6	60	60	-	-	1	1947 551
	PD4	8	60	60	-	-	1	1944 773
	PP2 High Performance, PP2 Ram Manifold, PP2 Police Cars, PD4-D500, PD4 High Performance, PD4 Police Cars, PD1, PD2	8	60	60	60	60	1	2120 627
9-23-10	SCREW, w/WASHER	6	60	60	-	-	6	1407 234
	PD4	6	60	60	-	-	1	*2121 573
	PD4	8	60	60	-	-	3	180 122
	PD4	8	60	60	-	-	1	180 137
	PP2 High Performance, PP2 Ram Manifold, PP2 Police Cars, PD1, PD2, PD4-D500, PD4 High Performance, PD4 Police Cars, PS1	8	60	60	60	60	4	1407 234

NOTE 1: Engine 40 P22-4-13.

★ Indicates use as required.

Numerals in parentheses () refer to notes.

Printed in U.S.A.

☐ Indicates parts not listed in any previous parts book.

Prices and specifications subject to change without notice.

* Indicates change or addition.

1960 PASSENGER CAR PARTS CATALOG

ENGINE

CODE	PART NAME AND DESCRIPTION	NO. OF CYL.	PLYMOUTH	DODGE	DESOTO	CHRYSLER AND IMPERIAL	PER CAR	PART NUMBER
9-23-0 CHAIN CASE COVER - Cont'd								
9-23-10	SCREW, w/WASHER - Cont'd PP2 High Performance, PP2 Ram Manifold, PP2 Police Cars, PD1, PD2, PD4-D500, PD4 High Performance, PD4 Police Cars, PS1	8	60	60	60	60	3	1945 404
9-23-17	GASKET PD4 PP2 High Performance, PP2 Ram Manifold, PP2 Police Cars, PD1, PD2, PD4-D500, PD4 High Performance, PD4 Police Cars, PS1	6 8	60 60	60 60	- -	- -	1 1	1947 554 2129 012
9-23-18	OIL SEAL PD4 PP2 High Performance, PP2 Ram Manifold, Performance, PD4-D500, PD4 Police Cars, Performance, PD4-D500, PD4 Police Cars.	6 8	60 60	60 60	- -	- -	1 1	1947 581 1618 683
9-23-40	INDICATOR, Timing, Std. Trans., PD4 w/Automatic Trans., PD4	8 8	60 60	60 60	60 -	60 -	1 1	*1737 771 1947 236 1851 861

9-31-0 CONNECTING ROD

NOTE: Connecting Rod includes Bearing Cap, Bolt, Nut, Lockwasher and Bushing but does not include Bearing.

9-31-4	ROD, UP TO AFTER PD4 PP2 w/High Performance, PP2 w/Ram Manifold, PP2 Police Cars, PD1, PD2, PD4-D500, PD4 w/High Performance	6 6 8	60 (1) 60 (1) 60	60 (1) 60 (1) 60	- - -	- - -	6 6 8	*1947 950 E2205 552 1944 866
9-31-5	BOLT, Bearing Cap PD4 PP2 w/High Performance, PP2 w/Ram Manifold, PD1, PD2, PD4-D500, PD4 w/High Performance	6 8	60 60	60 60	- -	- 60 (A)	12 8	1944 865 1944 865 *1851 533
9-31-7	NUT, Cap Bolt	6-8	60	60	60	60	★	1737 695
9-31-10	BUSHING, PD4	8	60	60	-	-	8	1618 701

9-32-0 CONNECTING ROD BEARING PACKAGES

NOTE: When .001 thicker wall connecting rod bearings are used for engines in production an identification mark is stamped on the machined surface of the crankshaft center counterweight for six cylinder engines and No. 3 counterweight for V8 cylinder engines. When the thicker wall connecting rod bearings are used the crankshaft will be marked R1, R2, R3, R4 or R5 depending on which journal has the .001 thicker wall bearing.

NOTE: Connecting rod bearing packages consist of one upper and one lower bearing.

9-32-2	BEARING PACKAGE, Std.001 U/S002 U/S010 U/S Std., PD4001 U/S, PD4002 U/S, PD4003 U/S, PD4010 U/S, PD4 Std., PP2 w/High Performance, PP2 w/Ram Manifold, PP2 Police Cars, PD1, PD2, PD4-D500, PD4 w/High Performance	6 6 6 6 8 8 8 8 8	60 60 60 60 60 60 60 60 60	60 60 60 60 60 60 60 60 60	- - - - - - - - -	- - - - - - - - 60	6 6 6 6 8 8 8 8 8	2084 380 2084 381 2084 382 2084 383 1879 617 1879 618 1879 619 1879 620 1879 621 1818 698
--------	---	---	--	--	---	--	---	--

NOTE A: See Page 9-7.

NOTE 1: Engine No. PP2-7-11.

CODE	PART NAME AND DESCRIPTION	NO. OF CYL.	PLYMOUTH	DODGE	DESOTO	CHRYSLER AND IMPERIAL	PER CAR	PART NUMBER
9-32-0 CONNECTING ROD BEARING PACKAGES - Cont'd								
9-32-2	Bearing Package - Cont'd							
	.001 U/S, PP2 w/High Performance, PP2 w/Ram Manifold, PP2 Police Cars, PD1, PD2, PD4-D500, PD4 w/High Performance	8	60	60	60	60	8	1818 699
	.002 U/S, PP2 w/High Performance, PP2 w/Ram Manifold, PP2 Police Cars, PD1, PD2, PD4-D500, PD4 w/High Performance	8	60	60	60	60	8	1818 700
	.003 U/S, PP2 w/High Performance, PP2 w/Ram Manifold, PP2 Police Cars, PD1, PD2, PD4-D500, PD4 w/High Performance	8	60	60	60	60	8	1818 701
	.010 U/S, PP2 w/High Performance, PP2 w/Ram Manifold, PP2 Police Cars, PD1, PD2, PD4-D500, PD4 w/High Performance	8	60	60	60	60	8	1818 702
	.012 U/S, PP2 w/High Performance, PP2 w/Ram Manifold, PP2 Police Cars, PD1, PD2, PD4-D500, PD4 w/High Performance	8	60	60	60	60	8	1818 703

NOTES

CODE	PART NAME AND DESCRIPTION	NO. OF CYL.	PLYMOUTH	DODGE	DESOTO	CHRYSLER AND IMPERIAL	PER CAR	PART NUMBER
9-34-0	PISTON, W/PIN							
NOTE:	The following pistons have pin and pin retaining rings.							
9-34-5	PISTON, Std.	6	60	60	-	-	6	2084 384
	.005 O/S	6	60	60	-	-	6	2084 385
	.020 O/S	6	60	60	-	-	6	2084 386
	.040 O/S	6	60	60	-	-	6	2084 387
	PISTON, Std., PD4	8	60	60	-	-	8	1843 004
	.005 O/S, PD4	8	60	60	-	-	8	1843 005
	.020 O/S, PD4	8	60	60	-	-	8	1843 006
	.040 O/S, PD4	8	60	60	-	-	8	1843 007
	PISTON, Std., PP2 w/High Performance, PP2 w/Ram Manifold, PD1, PS1	8	60	60	60	-	8	1879 644
	.005 O/S, PP2 w/High Performance, PP2 w/Ram Manifold, PD1, PS1	8	60	60	60	-	8	1879 645
	.020 O/S, PP2 w/High Performance, PP2 w/Ram Manifold, PD1, PS1	8	60	60	60	-	8	1879 646
	.040 O/S, PP2 w/High Performance, PP2 w/Ram Manifold, PD1, PS1	8	60	60	60	-	8	1879 647
	PISTON, Std., PP2 Police Cars, PD4 w/High Performance, PD4-D500, PD1-D500, PD1 w/High Performance, PD2 All, PS1 w/High Performance, PS1 w/Ram Manifold, PS3 All	8	-	60	60	-	8	1879 333
	.005 O/S, PP2 Police Cars, PD4 w/High Performance, PD4-D500, PD1-D500, PD1 w/High Performance, PD2 All, PS1 w/High Performance, PS1 w/Ram Manifold, PS3 All	8	-	60	60	-	8	1879 334
	.020 O/S, PP2 Police Cars, PD4 w/High Performance, PD4-D500, PD1-D500, PD1 w/High Performance, PD2 All, PS1 w/High Performance, PS1 w/Ram Manifold, PS3 All	8	-	60	60	-	8	1879 335
	.040 O/S, PD4 w/High Performance, PD4-D500, PD1-D500, PD1 w/High Performance, PD2 All, PS1 w/High Performance, PS1 w/Ram Manifold, PS3 All	8	-	60	60	-	8	1879 336
	PISTON, Std., PC1, PC2	8	-	-	-	60 (A)	8	*1879 631
	.005 O/S, PC1, PC2	8	-	-	-	60 (A)	8	*1879 632
	.020 O/S, PC1, PC2	8	-	-	-	60 (A)	8	*1879 633
	.40 O/S, PC1, PC2	8	-	-	-	60 (A)	8	*1879 634
	PISTON, Std., PC3, PY1	8	-	-	-	60 (A)	8	*1879 337
	.005 O/S, PC3, PY1	8	-	-	-	60 (A)	8	*1879 338
	.020 O/S, PC3, PY1	8	-	-	-	60 (A)	8	*1879 339
	.040 O/S, PC3, PY1	8	-	-	-	60 (A)	8	*1879 340
	PISTON, Std., L.C. Export	6	60	60	-	-	6	2084 388
	.005 O/S, L.C. Export	6	60	60	-	-	6	2084 389
	.020 O/S, L.C. Export	6	60	60	-	-	6	2084 390
	PISTON, Std., L.C. Export, PD4	8	60	60	-	-	8	1843 316
	.005 O/S, L.C. Export, PD4	8	60	60	-	-	8	1843 317
	.020 O/S, L.C. Export, PD4	8	60	60	-	-	8	1843 318
	PISTON, Std., L.C. Export, PD1, PS1	8	-	60	60	-	8	1879 641
	.005 O/S, L.C. Export, PD1, PS1	8	-	60	60	-	8	1879 642
	.020 O/S, L.C. Export, PD1, PS1	8	-	60	60	-	8	1879 643
	PISTON, Std., L.C. Export, PD2, PS1 w/High Performance, PS3	8	-	60	60	-	8	1879 648
	.005 O/S, L.C. Export, PD2, PS1 w/High Performance, PS3	8	-	60	60	-	8	1879 649
	.020 O/S, L.C. Export, PD2, PS1 w/High Performance, PS3	8	-	60	60	-	8	1879 650
	PISTON, Std., L.C. Export, PC1, PC2	8	-	-	-	60	8	1879 635
	.005 O/S, L.C. Export, PC1, PC2	8	-	-	-	60	8	1879 636
	.020 O/S, L.C. Export, PC1, PC2	8	-	-	-	60	8	1879 637
	PISTON, Std., L.C. Export, PC3, PY1	8	-	-	-	60	8	1879 638
	.005 O/S, L.C. Export, PC3, PY1	8	-	-	-	60	8	1879 639
	.020 O/S, L.C. Export, PC3, PY1	8	-	-	-	60	8	1879 640

NOTE A: See Page 9-7.

★ Indicates use as required.

Numerals in parentheses () refer to notes.

Printed in U.S.A.

⊠ Indicates parts not listed in any previous parts book.

Prices and specifications subject to change without notice.

* Indicates change or addition.

1960 PASSENGER CAR PARTS CATALOG

ENGINE

CODE	PART NAME AND DESCRIPTION	NO. OF CYL.	PLYMOUTH	DODGE	DESOTO	CHRYSLER AND IMPERIAL	PER CAR	PART NUMBER
9-35-0 PISTON RING SETS								
NOTE: The following Multi-Purpose Piston Ring Sets are for use in cylinders with taper wear and also for use in new or rebored cylinders.								
9-35-1	SET, Multi-Purpose, Std. to .009 O/S	6	60	60	-	-	1	22240 640
	.020 to .029 O/S	6	60	60	-	-	1	2196 039
	.040 to .049 O/S	6	60	60	-	-	1	2196 040
	Std., PD4	8	60	60	-	-	1	1752 588
	.020 O/S, PD4	8	60	60	-	-	1	1752 589
	.040 O/S, PD4	8	60	60	-	-	1	1752 590
	Std. to .009 O/S, PP2 w/High Performance, PP2 w/Ram Manifold, PD1, PS1	8	60	60	60	-	1	1843 330
	.020 to .029 O/S, PP2 w/High Performance, PP2 w/Ram Manifold, PD1, PS1	8	60	60	60	-	1	1843 331
	.040 to .049 O/S, PP2 w/High Performance, PP2 w/Ram Manifold, PD1, PS1	8	60	60	60	-	1	1843 332
	Std. to .009 O/S, PD4-D500, PD4 w/High Performance, PD1-D500, PD1 w/High Performance, PD2, PS1 w/Ram Manifold, PS1 w/High Performance, PS3	8	-	60	60	-	1	1881 693
	.020 to .029 O/S, PD4-D500, PD4 w/High Performance, PD1-D500, PD1 w/High Performance, PD2, PS1 w/Ram Manifold, PS1 w/High Performance, PS3	8	-	60	60	-	1	1881 694
	.040 to .049 O/S, PD4-D500, PD4 w/High Performance, PD1-D500, PD1 w/High Performance, PD2, PS1 w/Ram Manifold, PS1 w/High Performance, PS3	8	-	60	60	-	1	1881 695
	Std. to .009 O/S, PC1, PC2	8	-	-	-	60 (A)	1	*1881 696
	.020 to .029 O/S, PC1, PC2	8	-	-	-	60 (A)	1	*1881 697
	.040 to .049 O/S, PC1, PC2	8	-	-	-	60 (A)	1	*1881 698
	Std. to .009 O/S, PC3, PY1	8	-	-	-	60 (A)	1	*1881 699
	.020 to .029 O/S, PC3, PY1	8	-	-	-	60 (A)	1	*1881 700
	.040 to .049 O/S, PC3, PY1	8	-	-	-	60 (A)	1	*1881 701
9-36-0 PISTON PIN								
9-36-5	PIN, Std., PD4	8	60	60	-	-	8	1618 738
	.003 O/S, PD4	8	60	60	-	-	8	1618 739
	.008 O/S, PD4	8	60	60	-	-	8	1618 740
9-36-7	RING, Retaining, PD4	8	60	60	-	-	16	1324 470
9-39-0 VALVE								
9-39-1	GASKET PACKAGE, Valve Grinding	6	60	60	-	-	1	2196 046
	PD4 UP TO	8	60 (1)	60 (1)	-	-	1	2084 226
	PD4 AFTER	8	60 (1)	60 (1)	-	-	1	2196 086
	PP2 w/High Performance, PP2 w/Ram Manifold, PD1, PD2, PD4 w/High Performance, PD4-D500	8	60	60	60	-	1	1879 703
		8	-	-	-	60 (A)	1	*1879 704
9-39-5	VALVE, Intake, Std.	6	60	60	-	-	6	1947 623
	.005 O/S	6	60	60	-	-	6	2121 578
	.015 O/S	6	60	60	-	-	6	2121 579
	.030 O/S	6	60	60	-	-	6	2121 580
	Std., PD4	8	60	60	-	-	8	1945 318
	.005 O/S, PD4	8	60	60	-	-	8	1945 319
	.015 O/S, PD4	8	60	60	-	-	8	1945 320
	.030 O/S, PD4	8	60	60	-	-	8	1945 321

NOTE 1: Engine No. 65030.

NOTE A: See Page 9-7.

CODE	PART NAME AND DESCRIPTION	NO. OF CYL.	PLYMOUTH	DODGE	DESOTO	CHRYSLER AND IMPERIAL	PER CAR	PART NUMBER
9-39-0 VALVE - Cont'd								
9-39-5	VALVE - Cont'd							
	Std., PP2 w/High Performance, PP2 w/Ram Manifold, PD4-D500, PD4 Police Cars, PD1, PS1, PC1, PC2	8	60	60	60	60 (A)	8	*1858 557
	.005 O/S, PP2 w/High Performance, PP2 w/Ram Manifold, PD4-D500, PD4 Police Cars, PD1, PS1, PC1, PC2	8	60	60	60	60 (A)	8	*1858 558
	.015 O/S, PP2 w/High Performance, PP2 w/Ram Manifold, PD4-D500, PD4 Police Cars, PD1, PS1, PC1, PC2	8	60	60	60	60 (A)	8	*1858 559
	.030 O/S, PP2 w/High Performance, PP2 w/Ram Manifold, PD4 Police, PD1, PS1, PS1, PC1, PC2	8	60	60	60	60 (A)	8	*1858 560
	Std., PP2 Police Cars, PD4 w/High Performance, PD4-D500, PD4 Police Cars, PD1 w/High Performance, PD1 Police Cars, PD1-D500, PD2, PS1 w/High Performance, PS1 w/Ram Manifold, PS3, PC3, PY1	8	60	60	60	60 (A)	8	*1851 767
	.005 O/S, PP2 Police Cars, PD4 w/High Performance, PD4-D500, PD4 Police Cars, PD1 w/High Performance, PD1-D500, PD2, PD4 Police Cars, PS1 w/High Performance, PS1 w/Ram Manifold, PS3, PC3, PY1	8	60	60	60	60 (A)	8	*1851 768
	.015 O/S, PP2 Police Cars, PD4 w/High Performance, PD4-D500, PD4 Police Cars, PD1 w/High Performance, PD1-D500, PD2, PS1 w/High Performance, PS1 w/Ram Manifold, PS3, PC3, PY1	8	60	60	60	60 (A)	8	*1851 769
	.030 O/S, PP2 Police Cars, PD4 w/High Performance, PD4-D500, PD4 Police Cars, PD1 w/High Performance, PD1-D500, PD2, PS1 w/High Performance, PS1 w/Ram Manifold, PS3, PC3, PY1	8	60	60	60	60 (A)	8	*1851 770
9-39-6	VALVE, Exhaust, Std.	6	60	60	-	-	6	1947 624
	.005 O/S	6	60	60	-	-	6	2121 581
	.015 O/S	6	60	60	-	-	6	2121 582
	.030 O/S	6	60	60	-	-	6	2121 583
	Std., PD4	8	60	60	-	-	8	1852 248
	.005 O/S, PD4	8	60	60	-	-	8	1637 563
	.015 O/S, PD4	8	60	60	-	-	8	1637 564
	.030 O/S, PD4	8	60	60	-	-	8	1637 565
	Std., PP2 w/High Performance, PP2 w/Ram Manifold, PP2 Police Cars, PD4 w/High Performance, PD4-D500, PD1, PD2	8	60	60	60	60	8	1737 698
	.005 O/S, PP2 w/High Performance, PP2 w/Ram Manifold, PP2 Police Cars, PD4 w/High Performance, PD4-D500, PD1, PD2	8	60	60	60	60	8	1739 612
	.015 O/S, PP2 w/High Performance, PP2 w/Ram Manifold, PD4 w/High Performance, PD4-D500, PD1, PD2	8	60	60	60	60	8	1739 613
	.030 O/S, PP2 w/High Performance, PP2 w/Ram Manifold, PD4 w/High Performance, PD4-D500, PD1, PD2	8	60	60	60	60	8	1739 614
9-39-14	SHIELD, Intake Valve Stem Oil	6	60	60	-	-	6	1630 241
	SHIELD, Exhaust Valve Stem Oil	6	60	60	-	-	6	2128 977
	SHIELD, Intake Valve Stem Oil, PD4	8	60	60	-	-	8	1630 241
	SHIELD, Valve Stem Oil, PP2 w/High Performance, PP2 w/Ram Manifold, PP2 Police Cars, PD4 w/High Performance, PD4-D500, PD1, PD2	8	60	60	60	60	16	1858 782

NOTE A: See Page 9-7.

★ Indicates use as required.

Numerals in parentheses () refer to notes.

Printed in U.S.A.

☐ Indicates parts not listed in any previous parts book.

Prices and specifications subject to change without notice.

* Indicates change or addition.

CODE	PART NAME AND DESCRIPTION	NO. OF CYL.	PLYMOUTH	DODGE	DESOTO	CHRYSLER AND IMPERIAL	PER CAR	PART NUMBER
9-39-0 VALVE - Cont'd								
9-39-15	SPRING	6	60	60	-	-	12	1739 534
	PD4	8	60	60	-	-	16	1739 534
	w/DAMPER, PP2 w/High Performance, PP2 w/Ram Manifold, PP2 Police Cars, PD4-D500, PD4 w/High Performance Police Cars, PD1 w/High Performance Police Cars, PD1-D500, PD2-D500, PS1 w/Ram Manifold, PS3 w/Ram Manifold, PC3-300	8	60	60	60	60	16	1855 042
	SPRING, PD1, PD2, PD4 w/High Performance Police Cars	8	-	60	60	60	16	1944 854
9-39-16	RETAINER, Valve Spring	6	60	60	-	-	12	1619 636
		8	60	60	60	60	16	1619 636
9-39-17	LOCK, Intake Valve Spring Retainer	6-8	60	60	60	60	★	381 875
	Exhaust Valve Spring Retainer	6-8	60	60	60	60	★	1614 666
9-39-21	SPACER, Valve Spring, PD4	8	60	60	-	-	16	1639 947
	PP2 w/High Performance, PP2 w/Ram Manifold, PD1, PD2, PD4 w/High Performance, PD4-D500	8	60	60	60	60	16	1859 144
9-41-0 VALVE TAPPET								
9-41-1	SILENCER PACKAGE, Tappet Chamber, PP2 w/High Performance, PD4 w/High Performance, PD4 w/High Performance Police Cars, PD1, PD2	8	60	60	60	60	1	1879 747
9-41-4	TAPPET, Std.	6	60	60	-	-	12	1945 291
	.001 O/S, PD4	6-8	60	60	-	-	12	1945 292
	.008 O/S, PD4	6-8	60	60	-	-	12	2120 461
	.030 O/S, PD4	6-8	60	60	-	-	12	2120 462
	Std., PD4	8	60	60	-	-	16	1739 356
	Std., PP2 w/High Performance, PP2 w/Ram Manifold, PP2 Police Cars, PD1, PD2, PD4-D500, PD4 Police Cars	8	60	60	60	60	16	1851 904
	.001 O/S, PP2 w/High Performance, PP2 w/Ram Manifold, PP2 Police Cars, PD1, PD2, PD4-D500, PD4 Police Cars	8	60	60	60	60	16	2084 030
	.008 O/S, PP2 w/High Performance, PP2 w/Ram Manifold, PP2 Police Cars, PD1, PD2, PD4-D500, PD4 Police Cars	8	60	60	60	60	16	2084 031
	.030 O/S, PP2 w/High Performance, PP2 w/Ram Manifold, PP2 Police Cars, PD1, PD2, PD4-D500, PD4 Police Cars	8	60	60	60	60	16	2084 032
9-41-12	RETAINER, Valve Tappet Plunger, PP2 w/High Performance, PP2 w/Ram Manifold, PP2 Police Cars, PD4-D500, PD4 w/High Performance, PD1, PD2	8	60	60	60	60	16	1489 340
9-42-0 VALVE PUSH ROD								
9-42-1	ROD, Valve Push	6	60	60	-	-	12	2120 514
	PD4	8	60	60	-	-	16	1637 721
	PP2 w/High Performance, PP2 w/Ram Manifold, PP2 Police Cars, PD1, PD2, PD4 w/High Performance, PD4-D500	8	60	60	60	-	16	1737 757
		8	-	-	-	60 (A)	16	*1851 669
9-43-0 VALVE ROCKER								
9-43-1	ROCKER	6	60	60	-	-	12	1947 594
	Intake Valve, PD4	8	60	60	-	-	8	1947 503
	Exhaust Valve, PD4	8	60	60	-	-	8	1947 504
	Right, PP2 w/High Performance, PP2 w/Ram Manifold, PP2 Police Cars, PD1, PD2, PD4 w/High Performance, PD4-D500	8	60	60	60	60	8	1737 646

NOTE A: See Page 9-7.

★ Indicates use as required.

Numerals in parentheses () refer to notes.

Printed in U.S.A.

E Indicates parts not listed in any previous parts book.

Prices and specifications subject to change without notice.

Dec. 9, 1960 Supersedes April 20, 1960.

Page 9-18

* Indicates change or addition.

CODE	PART NAME AND DESCRIPTION	NO. OF CYL.	PLYMOUTH	DODGE	DESOTO	CHRYSLER AND IMPERIAL	PER CAR	PART NUMBER
9-43-0 VALVE ROCKER - Cont'd								
9-43-1	ROCKER - Cont'd Left, PP2 w/High Performance, PP2 w/Ram Manifold, PP2 Police Cars, PD1, PD2, PD4 w/High Performance, PD4-D500	8	60	60	60	60	8	*1737 645
9-43-3	SCREW, Adjusting	6	60	60	-	-	12	1855 238
	PD4	8	60	60	-	-	16	1855 238
9-43-5	SPACER	6	60	60	-	-	6	2120 694
	PP2 w/High Performance, PP2 w/Ram Manifold, PP2 Police Cars, PD1, PD2, PD4 w/High Performance, PD4-D500	8	60	60	60	60	8	1737 756
9-43-9	SHAFT	6	60	60	-	-	1	1947 614
	PD4	8	60	60	-	-	2	1618 671
	PP2 w/High Performance, PP2 w/Ram Manifold, PP2 Police Cars, PD1, PD2, PD4 w/High Performance, PD4-D500	8	60	60	60	60	2	1821 393
9-43-10	BRACKET, Shaft, End and Center, PP2 w/High Performance, PP2 w/Ram Manifold, PP2 Police Cars, PD1, PD2, PD4 w/High Perform- ance, PD4-D500	8	60	60	60	60	6	1739 594
	Intermediate, PP2 w/High Performance, PP2 w/Ram Manifold, PP2 Police Cars, PD1, PD2, PD4 w/High Performance, PD4-D500	8	60	60	60	60	4	1739 595
9-43-11	RETAINER, Shaft End and Intermediate	6	60	60	-	-	6	1947 616
	RETAINER, Center	6	60	60	-	-	1	1947 617
9-43-14	SPRING, Shaft, PD4	8	60	60	-	-	8	1632 106
9-43-19	PLUG, Shaft	6	60	60	-	-	2	1324 268
	PD4	8	60	60	-	-	4	1858 802
	PP2 w/High Performance, PP2 w/Ram Manifold, PP2 Police Cars, PD1, PD2, PD4 w/High Performance, PD4-D500	8	60	60	60	60	4	1324 268
9-43-23	WASHER, Shaft Bracket Screw, PP2 w/High Performance, PP2 w/Ram Manifold, PP2 Police Cars, PD1, PD2, PD4 w/High Per- formance, PD4-D500	8	60	60	60	60	10	1536 242
9-43-26	SCREW, Shaft Bracket Locating, PD4	8	60	60	-	-	2	1670 476
9-45-0 FLYWHEEL								
9-45-1	FLYWHEEL	6	60	60	-	-	1	1947 561
	PD1, PD4	8	60	60	-	-	1	2121 950
	11" Clutch, PD1, PD2, PD4, PC1	8	60	60	-	60	1	2128 768
9-45-2	GEAR, Flywheel Ring or Torque Converter Starter Ring, for Larger Ring Gear width of 21/32 use Flywheel and Ring Gear Part No. 1947 561, inside dia., 11.193	6	60	60	-	-	1	*2121 195
	Inside dia., 11.443	6	60	60	-	-	1	⊠2264 233
		8	60	60	60	60	1	1673 646
9-45-6	BOLT, PD1, PD2, PD4	8	60	60	-	-	6	1557 704
9-45-7	NUT, Bolt, PD1, PD2, PD4	8	60	60	-	-	6	675 594
9-46-0 TORQUE CONVERTER								
9-46-4	PACKAGE, UP TO Eng. No.	6	60 (1)	60 (1)	-	-	1	2240 301
	TORQUE CONVERTER, UP TO Eng. No.	6	60 (1)	60 (1)	-	-	1	2124 398
	AFTER Eng. No.	6	60 (1)	60 (1)	-	-	1	2125 000
	PD4	8	60	60	-	-	1	1823 934
	PP2 w/High Performance, PP2 w/Ram Manifold, PD1, PD2, PD4-D500, PD4 w/High Performance	8	60	60	60	60	1	1731 860
9-46-8	PLATE, Drive	6	60	60	-	-	1	1949 763
9-46-9	DOWEL, Cylinder Block to Clutch Housing or Torque Converter	6	60	60	-	-	2	1122 532
9-46-10	STUD, Torque Converter Drive Flange	6-8	60	60	60	60	★	1061 157

NOTE 1: Engine No. P-22-1-18.

★ Indicates use as required.

Numerals in parentheses () refer to notes.

Printed in U.S.A.

⊠ Indicates parts not listed in any previous parts book.

Prices and specifications subject to change without notice.

* Indicates change or addition.

1960 PASSENGER CAR PARTS CATALOG

ENGINE

CODE	PART NAME AND DESCRIPTION	NO. OF CYL.	PLYMOUTH	DODGE	DESOTO	CHRYSLER AND IMPERIAL	PER CAR	PART NUMBER
9-46-0 TORQUE CONVERTER - Cont'd								
9-46-11	NUT, Torque Converter to Crankshaft Stud . . .	6-8	60	60	60	60	★	675 594
9-46-21	SCREW, Drive Plate to Crankshaft	6	60	60	-	-	6	1949 424
	SCREW, Drive Plate	6	60	60	-	-	4	1949 765
9-46-31	OIL COOLER, Radiator Core, PC1, PC2	8	60	60	60	60	1	1903 792
	PC3, PY1	8	-	-	-	60	1	1903 791
9-46-33	BRACKET, Transmission Oil Cooler Tube . . .	6-8	60	60	60	60	1	1949 176
9-46-43	NUT, Transmission Oil Cooler Tube Radiator End	6-8	60	60	60	60	2	1949 845
9-46-44	CONNECTOR, Transmission Oil Cooler Tube, Radiator End	6-8	60	60	60	60	2	1949 846
9-46-53	ROLLER, Overrunning Clutch	6	60	60	-	-	8	670 776
9-46-90	HOUSING, PD4	8	60	60	-	-	1	1824 334
	PP2 w/High Performance, PP2 w/Ram Manifold, PD4 w/High Performance, PD4- D500, PD1, PD2	8	60	60	60	60	1	1736 436
9-46-93	COVER, Housing, PD4	8	60	60	-	-	1	1854 314
	PP2 w/High Performance, PP2 w/Ram Manifold, PD4-D500, PD4 w/High Perform- ance, PD1, PD2	8	60	60	60	60	1	1823 548
9-46-107	SCREW, w/WASHER, Cylinder Block to Torque Converter Housing, PD4	8	60	60	-	-	1	1854 523
	PP2 w/High Performance, PP2 w/Ram Manifold, PD4-D500, PD4 w/High Perform- ance, PD1, PD2	8	60	60	60	60	2	6012 042
9-46-124	VALVE, Transmission Torque Converter Control	8	60	60	60	60	1	2124 247
9-46-130	OIL SEAL, Impeller Hub	6	60	60	-	-	1	2124 705
		8	60	60	60	60	1	1738 263
9-46-137	PAN, Housing, PD4	8	60	60	-	-	1	1853 736
9-46-229	SPRING, Overrunning Clutch	8	60	60	60	60	8	1539 546
9-48-0 MANIFOLD								
9-48-6	MANIFOLD, Exhaust	6	60	60	-	-	1	1947 173
	Right, PD4	8	60	60	-	-	1	1634 722
	Left, PD4	8	60	60	-	-	1	1618 650
	Right, PP2 w/High Performance, PP2 Police Cars w/One Four Barrel Carburetor, PD4 w/High Performance, PD4 Police Cars w/One Four Barrel Carburetor, PD1, PD2, PS1, PS3	8	60	60	60	60	1	1946 969
	Left, PP2 w/High Performance, PP2 Police Cars w/One Four Barrel Carburetor, PD4 w/High Performance, PD4 Police Cars w/One Four Barrel Carburetor, PD1, PD2, PS1, PS3	8	60	60	60	60	1	1739 600
	Right, PP2 w/Ram Manifold, PD4-D500, PD1- D500, PD2-D500, PS1 w/Ram Manifold, PS3 w/Ram Manifold, PC3-300	8	60	60	60	60	1	1947 488
	Left, PP2 w/Ram Manifold, PD4-D500, PD1- D500, PD2-D500, PS1 w/Ram Manifold, PS3 w/Ram Manifold, PC3-300	8	60	60	60	60	1	1947 432
	Right, PP2 Police Cars and PD1, PD4 Police Cars w/Two Four Barrel Carburetors	8	60	60	-	-	1	1947 018
	Right, w/Air Condition, PY1	8	-	-	-	60	1	1854 990
9-48-7	MANIFOLD, Intake, UP TO	6	60 (1)	60 (1)	-	-	1	*1947 164
	AFTER	6	60 (1)	60 (1)	-	-	1	⊠2206 290
	PD4	8	60	60	-	-	1	1859 228
	w/Power Package, PD4	8	60	60	-	-	1	1859 298
	PP2 w/High Performance, PD1 w/High Per- formance, PD2, PD4 w/High Performance, PS1 w/High Performance, PS3 w/High Performance	8	60	60	60	-	1	1859 300

NOTE 1: Engine No. P-22-5-31.

★ Indicates use as required.

Numerals in parentheses () refer to notes.

Printed in U.S.A.

⊠ Indicates parts not listed in any previous parts book.

Prices and specifications subject to change without notice.

Dec. 9, 1960 Supersedes April 20, 1960.

Page 9-20

* Indicates change or addition.

CODE	PART NAME AND DESCRIPTION	NO. OF CYL.	PLYMOUTH	DODGE	DESOTO	CHRYSLER AND IMPERIAL	PER CAR	PART NUMBER
9-48-0 MANIFOLD - Cont'd								
9-48-7	MANIFOLD - Cont'd							
	PD1, PS1, PS3	8	60	60	60	-	1	1859 299
	w/o Air Condition, PC1	8	-	-	-	60 (A)	1	*1351 899
	w/Air Condition, PC1	8	-	-	-	60	1	2120 630
	PC2, PC3, PY1	8	-	-	-	60	1	1858 623
	PP2 w/Ram Manifold, PD4-D500, PD1-D500, PD2-D500, PS1 w/Ram Manifold, PS3 w/Ram Manifold, PC3-300, Right	8	60	60	60	60	1	1947 162
	PP2 w/Ram Manifold, PD4-D500, PD1-D500, PD2-D500, PS1 w/Ram Manifold, PS3 w/Ram Manifold, PC3-300, Left	8	60	60	60	60	1	1947 541
	PP2 Police Cars and PD1, PD4 Police Cars w/Two Four Barrel Carburetors	8	60	60	-	-	1	1827 899
9-48-8	CONNECTOR, Vacuum Control, Heater	6-8	60	60	60	60	1	1858 955
9-48-12	STUD, Intake and Exhaust Manifold	6	60	60	-	-	11	2121 585
	STUD, Exhaust Manifold End	6	60	60	-	-	2	2121 585
9-48-14	WASHER, Intake and Exhaust Manifold Stud.	6	60	60	-	-	13	2121 223
9-48-27	REINFORCEMENT, Intake Manifold Gasket End, PP2 w/High Performance, PP2 w/Ram Manifold, PP2 Police Cars, PD4 w/High Performance, PD4-D500, PD4 Police Cars, PD1, PD2	8	60	60	60	-	2	*1859 332
		8	-	-	-	60 (A)	2	*1351 635
9-48-40	SCREW, Intake Manifold, PD4	8	60	60	-	-	8	1859 465
	PD4	8	60	60	-	-	8	1859 466
	w/Air Condition, PD4	8	60	60	-	-	1	1821 174
	w/Air Condition, PD4	8	60	60	-	-	1	1821 178
	PP2 w/High Performance, PP2 w/Ram Manifold, PP2 Police Cars, PD4 w/High Performance, PD4-D500, PD4 Police Cars, PD1, PD2	8	60	60	60	60	★	2120 467
	PP2 w/High Performance, PP2 w/Ram Manifold, PP2 Police Cars, PD4 w/High Performance, PD4-D500, PD4 Police Cars, PD1, PD2	8	60	60	60	60	★	2120 468
	PP2 w/High Performance, PP2 w/Ram Manifold, PD4 w/High Performance, PD4- D500, PD1, PD2, w/Air Condition, Com- pressor Study Bracket, 2 1/2" Long	8	60	60	60	60	★	
	2" Long	8	60	60	60	60	★	
	pressor Study Bracket, 2 1/2" Long	8	60	60	60	60	★	*2120 468
	2" Long	8	60	60	60	60	★	*2120 467
9-48-43	STUD, Exhaust Manifold, PP2 w/High Per- formance, PP2 w/Ram Manifold, PP2 Police Cars, PD4 w/High Performance, PD4-D500, PD4 Police Cars, PD1, PD2	8	60	60	60	60	10	1613 782
	STUD, Exhaust, Right, PP2 w/High Perform- ance, PP2 Police Cars, PD4 w/High Perform- ance, PD4 Police Cars, PD1, PD2	8	60	60	60	60	2	2120 505
9-48-56	SHIELD, Intake Manifold Heat, PD4	8	60	60	-	-	1	1619 627
9-48-124	ELBOW, Intake Manifold Heat Inlet, PP2 w/Ram Manifold, PD4-D500, PD1-D500, PD2-D500, PS1 w/Ram Manifold, PS3 w/Ram Manifold	8	60	60	60	-	2	1947 732
	PC3-300	8	-	-	-	60	2	1947 430
9-48-126	TUBE, Exhaust Manifold Heat PP2, PD1, PD4, Police Cars w/Two Four Barrel Carburetors	8	60	60	-	-	1	1325 850
9-48-138	SHIELD, Heat Tube Splash PP2, PD1, PD4, Police Cars w/Two Four Barrel Carburetors	8	60	60	-	-	1	1854 853
9-48-151	TUBE, Intake Manifold Equalizer, PP2 w/Ram Manifold, PD4-D500, PD1-D500, PD2-D500, PS1 w/Ram Manifold, PS3 w/Ram Manifold, PC3-300	8	60	60	60	60	1	1947 402

NOTE A: See Page 9-7.

★ Indicates use as required.

Numerals in parentheses () refer to notes.

Printed in U.S.A.

☐ Indicates parts not listed in any previous parts book.

Prices and specifications subject to change without notice.

* Indicates change or addition.

1960 PASSENGER CAR PARTS CATALOG

ENGINE

CODE	PART NAME AND DESCRIPTION	NO. OF CYL.	PLYMOUTH	DODGE	DESOTO	CHRYSLER AND IMPERIAL	PER CAR	PART NUMBER
9-48-0 MANIFOLD - Cont'd								
9-48-152	COUPLING, Intake Manifold Equalizer Tube, PP2 w/Ram Manifold, PD4-D500, PD1-D500, PD2-D500, PS1 w/Ram Manifold, PS3 w/Ram Manifold, PC3-300	8	60	60	60	60	2	1947 403
9-48-153	CLAMP, Intake Manifold Equalizer Tube Coupling, PP2 Ram Manifold, PD4-D500, PD1-D500, PD2-D500, PS1 w/Ram Manifold, PS3 w/Ram Manifold, PC3-300	8	60	60	60	60	2	870 469
9-50-0 MANIFOLD GASKETS								
9-50-1	GASKET SET	6	60	60	-	-	1	2084 416
	PD4	8	60	60	-	-	1	2084 347
9-50-3	GASKET, Intake to Exhaust Manifold	6	60	60	-	-	1	E2206 120
9-50-4	GASKET, Intake Manifold Heat Inlet Elbow, PP2 w/Ram Manifold, PD4-D500, PD1-D500, PD2-D500, PS1 w/Ram Manifold, PS3 w/Ram Manifold, PC3-300	8	60	60	60	60	2	1947 429
9-50-5	GASKET, Exhaust Manifold, Right, PD4	8	60	60	-	-	1	1639 194
	Left, PD4	8	60	60	-	-	1	1670 508
9-50-6	GASKET, Intake Manifold, PP2 w/High Performance, PP2 w/Ram Manifold, PP2 Police Cars, PD4 w/High Performance, PD4-D500, PD1, PD2, PD4 Police Cars	8	60	60	60	-	1	*1737 709
		8	-	-	-	60 (A)	1	*1851 664
9-50-16	GASKET, Intake Manifold Heat Inlet Elbow to Exhaust Manifold, PP2 w/Ram Manifold, PD4-D500, PD1-D500, PD2-D500, PS1 w/Ram Manifold, PS3 w/Ram Manifold, PC3-300	8	60	60	60	60	2	1947 428
9-58-0 MANIFOLD HEAT CONTROL VALVE THERMOSTAT								
9-58-1	PACKAGE, Manifold Heat Control	6	60	60	-	-	1	2084 797
	PD4	8	60	60	-	-	1	2084 792
	PP2 w/High Performance, PP2 Police Cars, PD4 w/High Performance, PD1, PD2, PD4 Police Cars	8	60	60	60	60	1	2084 794
	Right, PP2 w/Ram Manifold, PD4-D500, PD1-D500, PD2-D500, PS1 w/Ram Manifold, PS3 w/Ram Manifold, PC3-300	8	60	60	60	60	1	2196 074
	Left, PP2 w/Ram Manifold, PD4-D500, PD1-D500, PD2-D500, PS1 w/Ram Manifold, PS3 w/Ram Manifold, PC3-300	8	60	60	60	60	1	2084 795
9-58-5	THERMOSTAT	6	60	60	-	-	1	2121 554
		8	60	60	60	60	1	960 003
	PP2 w/Ram Manifold, PD4-D500, PD1-D500, PD2-D500, PS1 w/Ram Manifold, PS3 w/Ram Manifold, PC3-300	8	60	60	60	60	2	2128 933
9-58-12	COUNTERWEIGHT	6	60	60	-	-	1	2121 430
	SHIELD	8	60	60	60	60	1	1670 515
	PP2 w/Ram Manifold, PD4-D500, PD1-D500, PD2-D500, PS1 w/Ram Manifold, PS3 w/Ram Manifold, PC3-300, Right	8	60	60	60	60	1	1670 515
	PP2 w/Ram Manifold, PD4-D500, PD1-D500, PD2-D500, PS1 w/Ram Manifold, PS3 w/Ram Manifold, PC3-300, Left	8	60	60	60	60	1	1944 616
9-58-13	BOLT, Manifold Heat Control Thermostat Shield Clamp	6-8	60	60	60	60	1	1736 012
	PP2 w/Ram Manifold, PD4-D500, PD1-D500, PD2-D500, PS1 w/Ram Manifold, PS3 w/Ram Manifold, PC3-300	8	60	60	60	60	2	1736 012

NOTE A: See Page 9-7.

★ Indicates use as required.

Numerals in parentheses () refer to notes.

Printed in U.S.A.

⊠ Indicates parts not listed in any previous parts book.

Prices and specifications subject to change without notice.

Dec. 9, 1960 Supersedes April 20, 1960.

Page 9-22

* Indicates change or addition.

CODE	PART NAME AND DESCRIPTION	NO. OF CYL.	PLYMOUTH	DODGE	DESOTO	CHRYSLER AND IMPERIAL	PER CAR	PART NUMBER
9-58-0 MANIFOLD HEAT CONTROL VALVE THERMOSTAT - CONT'D								
9-58-14	LOCK, Manifold Heat Control Thermostat Shield	6-8	60	60	60	60	1	1409 594
	PP2 w/Ram Manifold, PD4-D500, PD1-D500, PD2-D500, PS1 w/Ram Manifold, PS3 w/Ram Manifold, PC3-300	8	60	60	60	60	2	1409 594
9-59-0 MANIFOLD HEAT CONTROL VALVE								
9-59-13	SPRING, Manifold Heat Control Valve	6-8	60	60	60	60	1	1558 897
	PP2 w/Ram Manifold, PD4-D500, PD1-D500, PD2-D500, PS1 w/Ram Manifold, PS3 w/Ram Manifold, PC3-300	8	60	60	60	60	2	1558 897
9-59-15	PIN, Spring	6-8	60	60	60	60	1	1639 597
	PP2 w/Ram Manifold, PD4-D500, PD1-D500, PD2-D500, PS1 w/Ram Manifold, PS3 w/Ram Manifold, PC3-300	8	60	60	60	60	2	1639 597
9-62-0 MANIFOLD HEAT CONTROL VALVE STOP								
9-62-1	STOP	6	60	60	-	-	1	2121 455
			60	60	60	60	1	683 057
	PP2 w/Ram Manifold, PD4-D500, PD1-D500, PD2-D500, PS1 w/Ram Manifold, PS3 w/Ram Manifold, PC3-300	8	60	60	60	60	2	683 057
9-64-0 ENGINE FRONT SUPPORT								
9-64-5	SUPPORT, Right, PD4	8	60	60	-	-	1	2120 236
	Left, PD4	8	60	60	-	-	1	2120 232
	PP2 w/High Performance, PP2 w/Ram Manifold, PD4 w/High Performance, PD4-D500, PD1, PD2, PC1, Right	8	60	60	60	60	1	2120 238
	PP2 w/High Performance, PP2 w/Ram Manifold, PD4 w/High Performance, PD4-D500, PD1, PD2, PC1, Left	8	60	60	60	60	1	2120 237
	PC2, PC3, PY1, Right	8	-	-	-	60	1	2128 572
	PC2, PC3, PY1, Left	8	-	-	-	60	1	2128 571
9-64-13	STUD, Engine Front Support to Frame	8	60	60	60	60	2	2128 773
9-64-17	NUT, Engine Front Support to Frame Stud, UP TO	8	60	60 (1)	60 (1)	60 (1)	2	*2128 775
	NUT, Engine Front Support to Frame Stud, AFTER	8	-	60 (1)	60 (1)	60 (1)	2	E2202 834
9-64-18	WASHER, Engine Front Support to Frame Stud	8	60	60	60	60	2	2128 774
9-64-22	SHIELD, Engine Front Support Heat, Left	6	60	60	-	-	1	2128 999
	PD4, Right	8	60	60	-	-	1	2128 943
	PD4, Left	8	60	60	-	-	1	2128 944
	PP2 Ram Manifold, PP2 w/High Performance, PD1, PD2, PD4-D500, PD4 w/High Performance, Right	8	60	60	60	60	1	2128 935
	PP2 Ram Manifold, PP2 w/High Performance, PD1, PD2, PD4-D500, PD4 w/High Performance, Left	8	60	60	60	60	1	2128 936
9-67-0 ENGINE FRONT SUPPORT INSULATOR								
9-67-4	INSULATOR, Right	6	60	60	-	-	1	2128 479
	Left	6	60	60	-	-	1	2128 821

NOTE 1: RD2 Serial No. 6103114084, RS1 Serial No. 7203119431, PC1 Serial No. 8103138130.

1960 PASSENGER CAR PARTS CATALOG

ENGINE

CODE	PART NAME AND DESCRIPTION	NO. OF CYL.	PLYMOUTH	DODGE	DESOTO	CHRYSLER AND IMPERIAL	PER CAR	PART NUMBER
9-69-0 FRAME ENGINE REAR SUPPORT CROSSMEMBER								
9-69-4	CROSSMEMBER, w/Automatic Trans.	6	60	60	-	-	1	2123 346
	PC1	6-8	60	60	60	60	1	2122 578
	PC2, PC3	8	-	-	-	60	1	2122 575
	Cv.Cp., PY1	8	-	-	-	60	1	1940 304
	Except Cv. Cp., PY1	8	-	-	-	60	1	1829 984
9-69-6	BRACKET, Frame Engine Rear Support Crossmember, Right, Cv.Cp., PY1	8	-	-	-	60	1	1940 300
	Left, Cv.Cp., PY1	8	-	-	-	60	1	1940 301
9-69-28	SCREW, w/WASHER, w/Automatic Trans. . . .	6	60	60	-	-	2	2200 024
9-70-0 FRAME ENGINE REAR SUPPORT CROSSMEMBER BRACKET								
9-70-9	NUT, Frame Engine Rear Support Cross- member to Bracket Bolt, PC1, PC2, PC3 . .	8	60	60	60	60	4	1946 141
9-71-0 ENGINE REAR SUPPORT INSULATOR								
9-71-5	INSULATOR	6	60	60	-	-	1	1946 362
	PC1, PC2, PC3, PY1 except Cv. Cp.	8	60	60	60	60	1	1734 529
	PY1 Cv.Cp.	8	-	-	-	60	1	1533 850
9-71-15	STOP, PC1, PC2, PC3	6-8	60	60	60	60	1	2122 280
9-71-16	SPRING, PC1, PC2, PC3	6-8	60	60	60	60	1	2122 278
9-71-17	PLATE, Spring, PC1, PC2, PC3	6-8	60	60	60	60	1	2122 277
9-71-18	STUD, w/WASHER, PC1, PC2, PC3	6-8	60	60	60	60	1	2122 275
9-71-19	WASHER, Stud, Upper, PC1, PC2, PC3	6-8	60	60	60	60	1	2122 279

NOTES

★ Indicates use as required. Numerals in parentheses () refer to notes. Printed in U.S.A.
 ☐ Indicates parts not listed in any previous parts book. Prices and specifications subject to change without notice.
 Dec. 9, 1960 Supersedes April 20, 1960. Page 9-24 * Indicates change or addition.