

**PARTS INDICATED
BY NAME ONLY - ORDER
BY DESCRIPTION**

- ★ NOT SERVICED
- SERVICED IN 24-25-3
- ▷ SERVICED IN 24-25-95
- * SERVICED IN 24-25-246

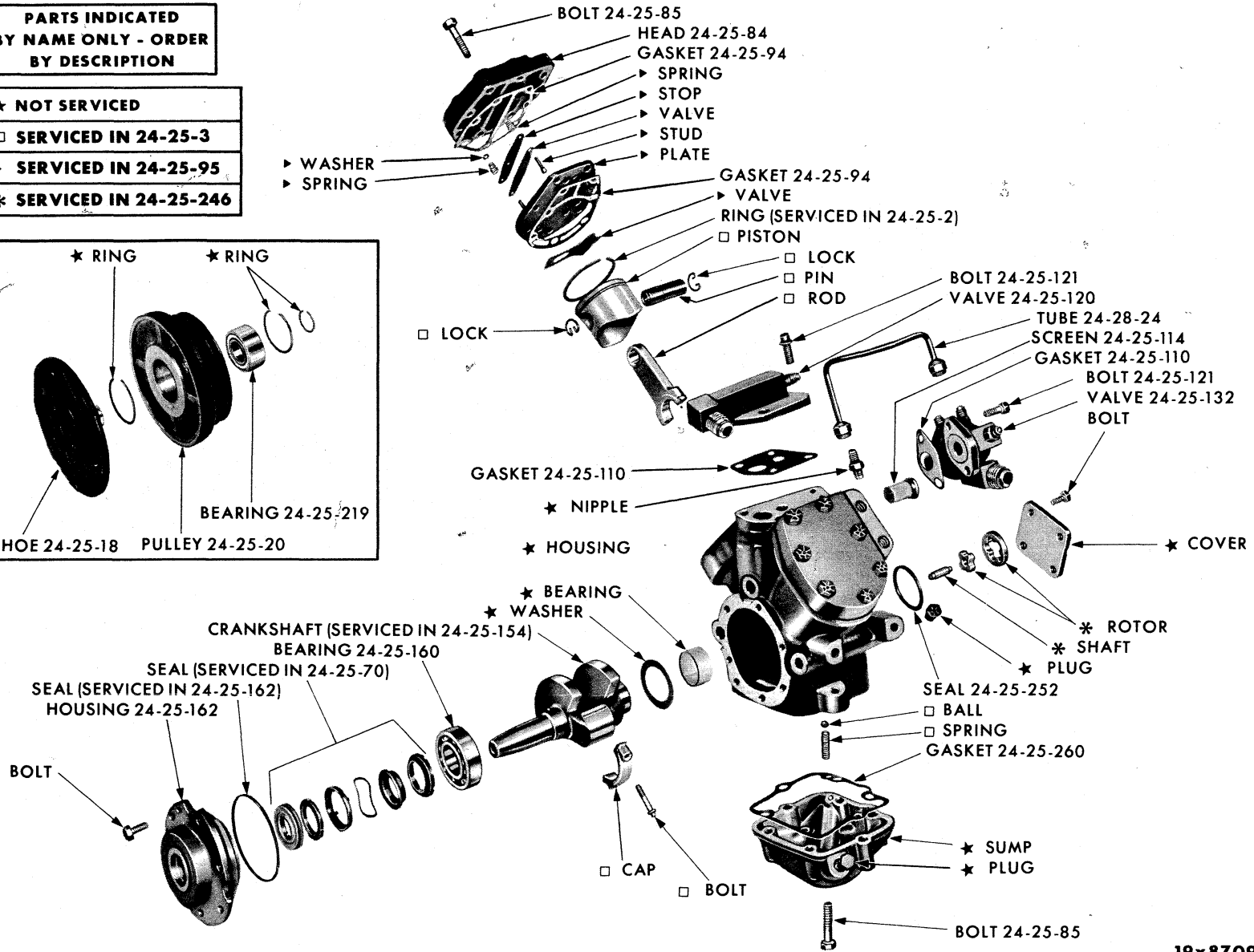
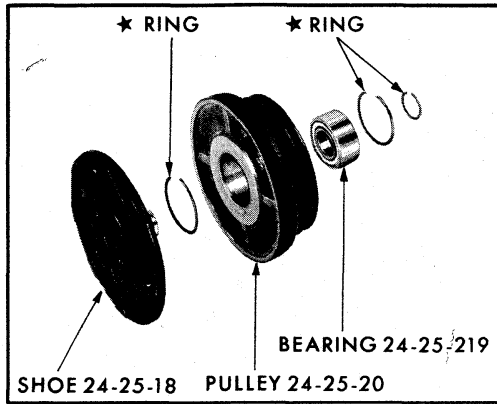

19x8709A

AIR CONDITIONING AIR COMPRESSOR

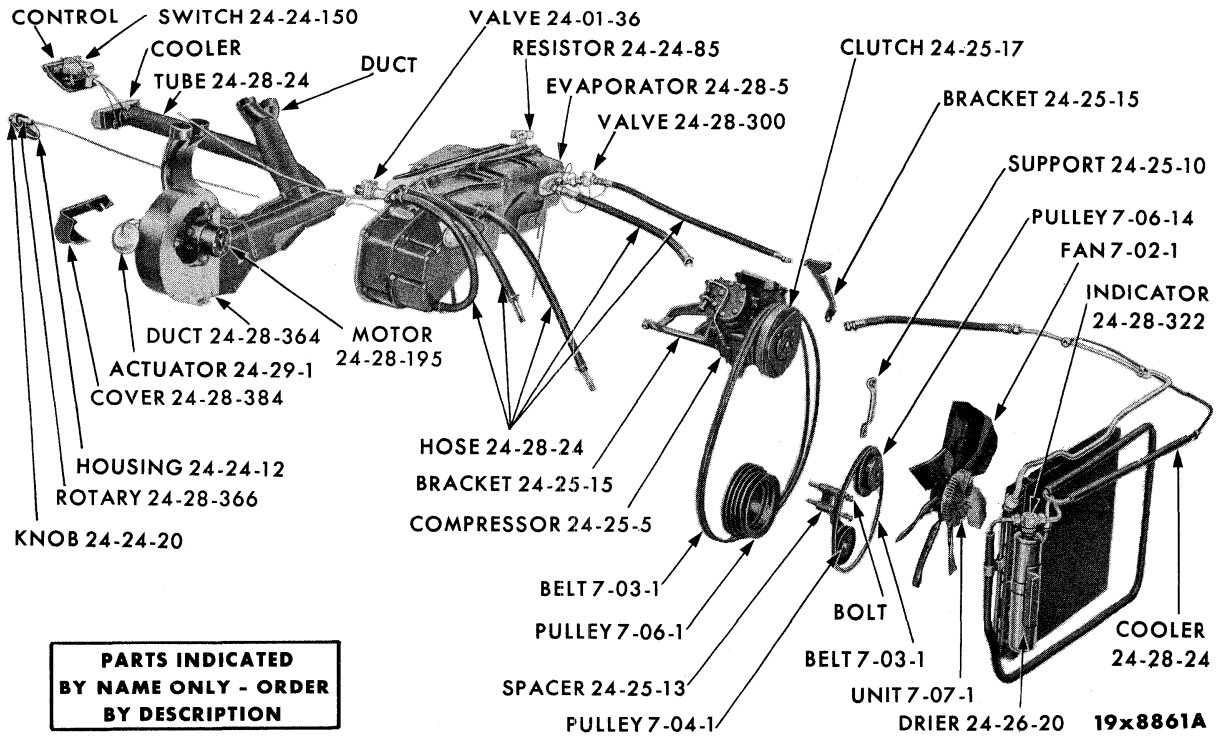

AIR CONDITIONING SYSTEM - COWL TYPE

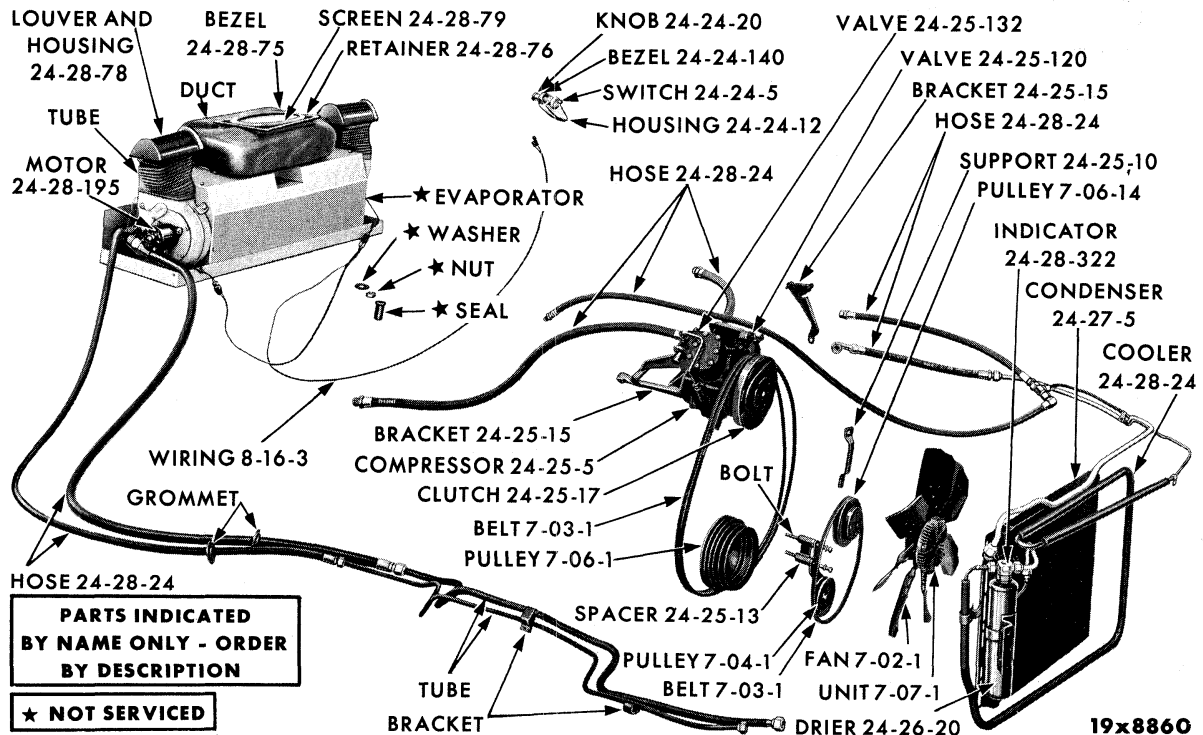

AIR CONDITIONING SYSTEM - TRUNK TYPE

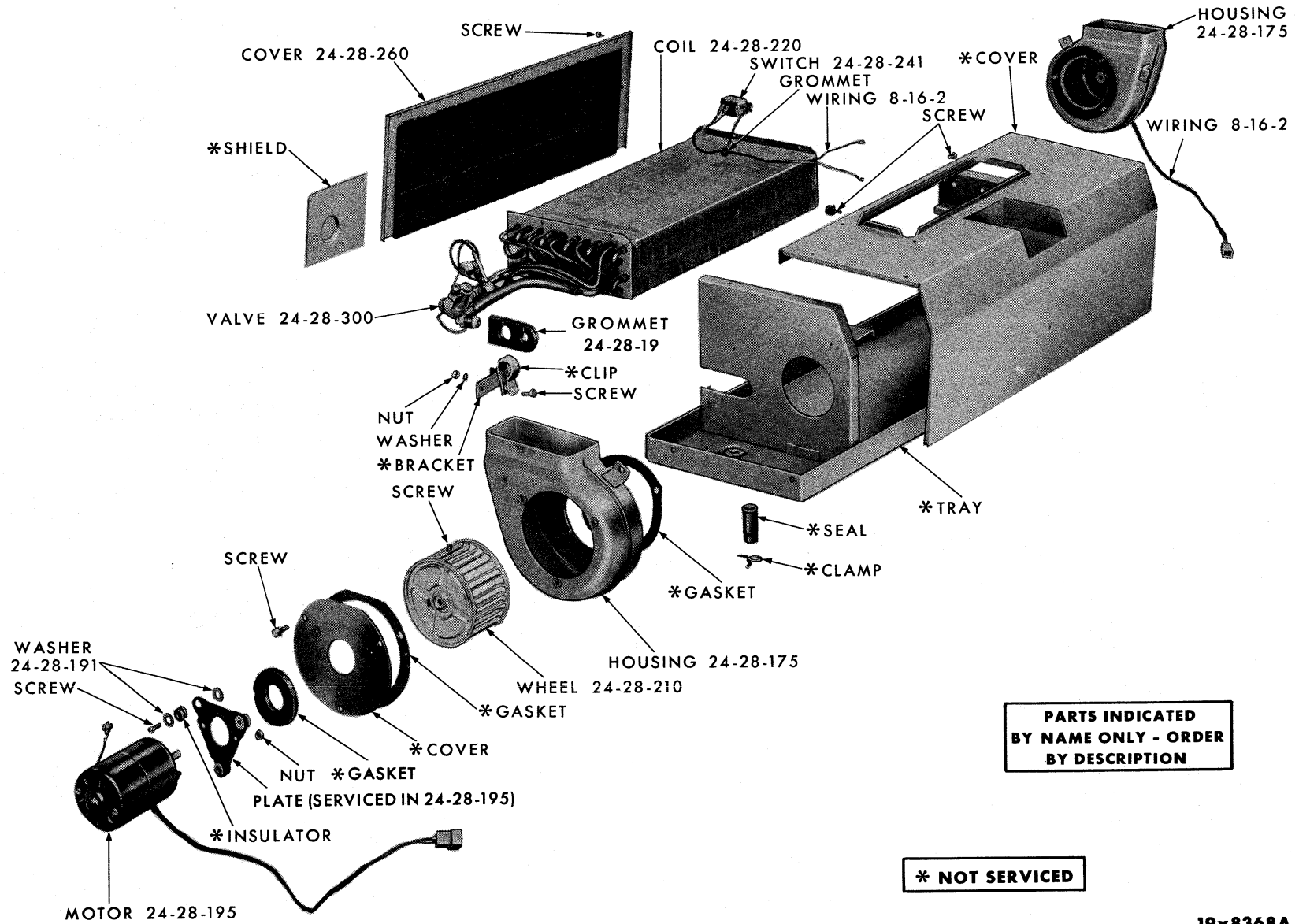

PARTS INDICATED BY NAME ONLY - ORDER BY DESCRIPTION

* NOT SERVICED

19x8368A

AIR CONDITIONING EVAPORATOR - TRUNK TYPE

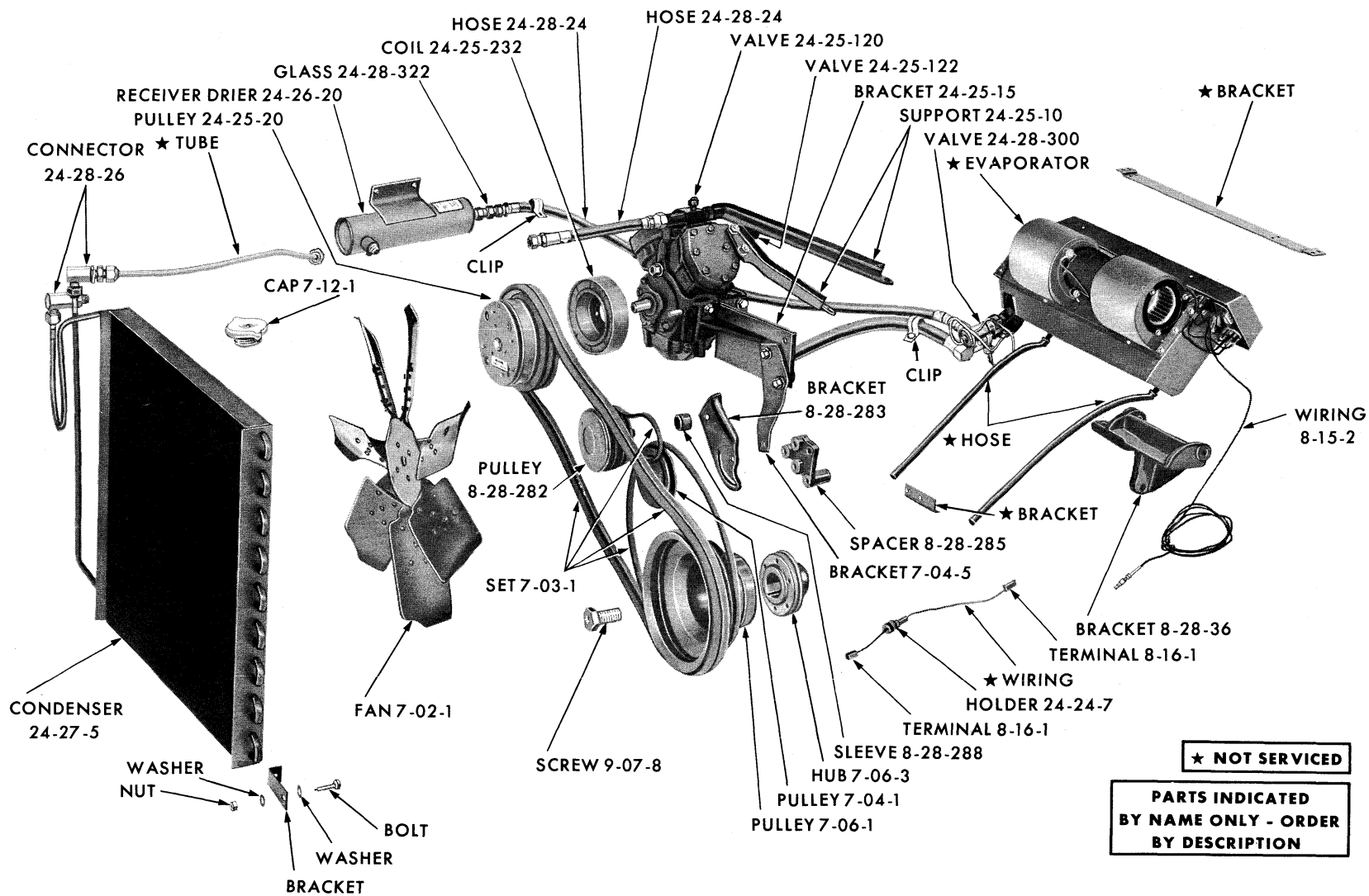

19x8849

AIR CONDITIONING SYSTEM - MOPAR MODEL "E"

TYPE	PART NUMBER	LENGTH	HOSE OUTSIDE DIA.	THREAD DIA.	LOCATION
A	1627107	25 in.	3/4 in. O.D.	5/8 in.-18	EXPANSION VALVE TO LIQUID TEE
	1658031	36 in.	1 in.	7/8 in.-14	SUCTION TO UNDERBODY TUBE
	1704447	94 in.	1 in.	5/8 in.-14	EVAPORATOR TO UNDERBODY SUCTION TUBE
	1885859	60 in.	1 in.	5/8 in.-14	SUCTION HOSE UNDERBODY TO TEE
	1887254	68 1/2 in.	1 in.	7/8 in.-14	SUCTION EVAPORATOR TO UNDERBODY TUBE
	2096522	26 in.	1 in.	7/8 in.-14	COMPRESSOR TO SUCTION TUBE
	2097052	80 in.	3/4 in.	5/8 in.-18	LIQUID UNDERBODY TO LIQUID TUBE
B	2219127	18 7/8 in.	7/8 in.	3/4 in.-16	DISCHARGE HOSE TO MUFFLER
	1315466				VALVE TO HEATER AND HEATER TO PUMP (50 FT. ROLL)
C	1595160	29 in.	1 in.		CONTROL VALVE TO ENGINE
	1779885	12 in.	2 1/2 in.		HEATER TO ENGINE (INLET AND RETURN)
	1779886	41 in.	2 1/2 in.		ENGINE TO VALVE
	2096932	46 in.	1 in.		HEATER TO PUMP (PRE-FORMED)
D	2096839	18 1/2 in.	7/8 in.	3/4 in.-16	MUFFLER TO DISCHARGE TUBE
	2219048	17 in.	7/8 in.	3/4 in.-16	MUFFLER TO DISCHARGE TUBE
E	1971676	66 in.	1/4 in.		VACUUM BY-PASS (PLASTIC)
	1885860	68 in.	3/4 in.	5/8 in.-18	EXPANSION VALVE TO UNDERBODY TUBE (LIQUID)
F	1993669	42 in.	5/8 in.	7/8 in.-14	EVAPORATOR TO SUCTION VALVE
	2097180	60 in.	3/4 in.	5/8 in.-18	TEE TO UNDERBODY TUBE (LIQUID)
	2097200	72 in.	3/4 in.	5/8 in.-18	TEE TO UNDERBODY TUBE (LIQUID)
	2097202	60 in.	1 in.	7/8 in.-14	TEE TO UNDERBODY TUBE (SUCTION)
G	1748269	10 in.	3/8 in.	3/4 in.-16	DISCHARGE VALVE TO RECEIVER DRIER TUBE (MODEL E)
	1993670	9 in.	3/8 in.	3/4 in.-16	DISCHARGE VALVE TO RECEIVER DRIER TUBE (MODEL E)
	1993671	38 in.	3/8 in.	5/8 in.-18	EXPANSION VALVE TO RECEIVER DRIER (MODEL E)
	2096831	18 3/4 in.	3/4 in.	7/8 in.-14	TEE TO EVAPORATOR (SUCTION) (FRONT)
	2096835	23 in.	1 in.	5/8 in.-18	RECEIVER DRIER TO EXPANSION VALVE
H	2096838	14 in.	7/8 in.	3/4 in.-16	CONDENSER TO MUFFLER (DISCHARGE)
I	2097009	31 1/2 in.	1 in.	7/8 in.-14	EVAPORATOR TO COMPRESSOR (SUCTION)
	1689313	52 in.	2 1/4 in.		DUCT TO SPOT COOLER
J	2096989	26 in.	2 3/4 in.		DEFROSTER
	2097121	18 in.	3 1/4 in.		AIR OUTLET TO DUCT
	2197020	18 in.	3 1/4 in.		AIR OUTLET TO DUCT
K	2097122		1/4 in.		CONTROL TUBE W/TEE AND CONNECTOR (PLASTIC)
L	2096847	39 1/2 in.	3/8 in.		DRIER TO LIQUID TEE W/FINS (STEEL)
	2219091	42 3/4 in.	3/8 in.		DRIER TO LIQUID TUBE

19x8865

AIR CONDITIONING HOSE CHART

CODE	REMARKS	PER CAR	PLYMOUTH	DODGE	DESOTO	CHRYSLER AND IMPERIAL
------	---------	---------	----------	-------	--------	-----------------------

GROUP 24 - AIR CONDITIONING

24-01-0 AIR CONDITIONING

24-01-1	PACKAGE, Air Conditioning Common, Model "E"	1	2196 337	2196 337	2196 337	2196 337
24-01-5	PACKAGE, Adapter, PP2, PD4, w/Eng. Stamped 318	1	2196 339	2196 339	----	----
	PP2, PD1, PD2, PD4, PS1, PS3, w/Eng. Stamped 361, 383	1	2196 347	2196 347	2196 347	----
	PP1, PD3	1	2196 338	2196 338	----	----
	PC1, PC2, PC3, PY1	1	----	----	----	2196 349
24-01-18	COVER, Heater Core, Eng. Side	1	2096 255	2096 255	2096 255	2096 255
24-01-24	CORE, Heater Model 906	1	1879 904	1879 904	1879 904	1879 904
24-01-26	SEAL, Heater Core Tube, Model 906	2	1604 116	1604 116	1604 116	1604 116
24-01-33	RETAINER, Air Outlet, Model 905	2	1689 670	1689 670	1689 670	1689 670
	Louver Model 905 except PY1	4	----	----	----	2197 896
24-01-36	VALVE, Temperature Control Model 905 except PY1	1	1972 779	1972 779	1972 779	1972 779
	Model 905 PY1	1	----	----	----	1972 781
24-01-48	CLAMP, Temperature Control Cable, PY1	1	*1971 407	*1971 407	*1971 407	*1971 407
24-01-65	CABLE, Temperature Control, includes HOUSING	1	1819 748	1819 748	1819 748	1819 748
24-01-87	NIPPLE, Heater Hose Return, w/B. Eng. w/Std Manifold	1	1779 257	1779 257	1779 257	1779 257
	Heater Hose Return, w/A'Eng. Stamped 318	1	1971 061	1971 061	----	----
	Heater Hose Inlet, w/B Eng. Stamped 361, 318, 413	1	1971 061	1971 061	1971 061	1971 061

24-24-0 CONTROL

24-24-5	SWITCH, Toggle	1	*1886 178	*1972 596	*1886 178	----
	Sub.	1	----	----	----	2084 450
	Fan, Model E	1	1991 571	1991 571	1991 571	1991 571
	Rear Unit except PY1 and Sub., w/Dual Unit	1	----	----	2096 782	2084 450
	Rear Unit, PY1, w/Dual Unit	1	----	----	----	2084 449
24-24-7	FUSE HOLDER, Model E	1	1885 608	1885 608	1885 608	1885 608
24-24-8	NUT, Blower Motor Switch Mounting	1	----	1688 542	----	1971 521
	Rear Unit except PY1	1	----	----	----	1971 521
24-24-11	BLOCK, Fuse, w/Male Terminal	1	----	----	----	2197 136
	Rear Unit Single 4D. Sed.	1	----	----	----	2197 136
24-24-12	HOUSING, Blower Motor Switch	1	----	----	----	1972 146
	Rear Unit except PY1	1	----	----	----	1972 146
	Floor Damper Control except PY1	1	----	----	----	1972 146
24-24-20	KNOB, Blower Motor Switch	1	1887 591	1887 860	----	1887 991
	Rear Unit except PY1 and PD4	1	----	2096 309	----	----
	PD4	1	----	2096 309	----	----
	Model "E"	8	1991 570	1991 570	1991 570	1991 570
24-24-85	BLOCK, Resister, includes BRACKET, PY1	1	1972 049	1972 049	1972 049	1972 049
24-24-112	PACKAGE, Control Bezel, Push Button Type, except PY1	1	----	----	----	2084 054
24-24-137	NUT, Control Switch Mounting	1	----	1972 548	1972 548	1971 521
	Rear Unit Single	1	----	----	----	1439 758
	Rear Unit Single PY1	1	----	----	----	1439 758
	Rear Unit 4 D. Sub.	2	1688 542	1688 542	1688 542	----
24-24-140	BEZEL, Control, Push Button Type except PY1 Model 905	1	----	----	----	2084 054
	BEZEL, Blower Switch, Sub. w/Front Unit	1	----	----	----	2084 054
	PD1, PD2, PD4	1	----	1972 558	1972 558	----
	BEZEL, Blower Switch Rear Unit, w/Frt. Unit	1	----	----	1972 558	----
24-24-142	STUD, Damper Control model 905 except PY1	2	----	----	----	6010 020
24-24-150	SWITCH, Vacuum Push Button Control	1	2096 084	2096 084	2096 084	2096 084
24-24-156	KNOB, Temperature Control, except PY1	1	2096 858	2096 865	2096 865	1972 499
	PY1	1	----	----	----	1972 218

★ Indicates use as required.

□ Indicates parts not listed in any previous parts book.

* Indicates change or addition.

Printed in U.S.A.

Prices and specifications subject to change without notice.

CODE	REMARKS	PER CAR	PLYMOUTH	DODGE	DESOTO	CHRYSLER AND IMPERIAL
24-24-O CONTROL - Cont'd						
24-24-158	SCREW, Vacuum Switch Mounting	2	6006 036	6006 036	6006 036	6006 036
24-24-159	PLATE, Temperature Control, includes ARM and SWITCH					
	Model 905 except PY1	1	2097 730	1887 835	1887 835	2097 100
	Model 905 PY1	1	-----	-----	-----	1887 453
24-24-160	KNOB, Floor Air Damper Control except PD4 and PY1	1	1887 591	1887 860	1887 909	1887 991
	PD4	1	-----	2096 309	-----	-----
	PY1	1	-----	-----	-----	1887 935
24-24-164	EXTENSION, Push Button Control includes Cover except PY1, Heat	1	-----	-----	-----	1887 674
	Max Cool	1	-----	-----	-----	1887 672
24-24-166	SOCKET, Control Lamp	1	2096 586	2097 008	2097 008	2097 008
24-24-167	SOCKET, Control Lamp, includes HOOD and BRACKET, except PY1	1	-----	-----	-----	2197 001
24-24-170	PAD, Push Button Extension, except PY1	1	-----	-----	-----	2080 388

24-25-O COMPRESSOR

NOTE: For Compressor and Generator Belt see Part Type Code 7-03-1.

24-25-2	PACKAGE, Compressor Piston Ring Replacement	1	2196 301	2196 301	2196 301	2196 301
24-25-3	PACKAGE, Compressor Piston and Connecting Rod Replacement	1	1426 500	1426 500	1426 500	1426 500
24-25-5	COMPRESSOR	1	1989 773	1989 773	1989 773	1989 773
24-25-10	SUPPORT, Compressor					
	Front, w/Eng. Stamped 361, 413 and 383	1	1947 657	1947 657	1947 657	1947 657
	Right Compressor Head, w/Eng. Stamped 318	1	1738 414	1738 414	-----	-----
	Left Compressor Head, w/Eng. Stamped 318	1	1738 415	1738 415	-----	-----
24-25-13	SPACER, Compressor Mtg. to Fan Idler Bracket to Block, w/Eng. Stamped 361, 314, 383		*1980 568	*1980 568	*1980 568	*1980 568
24-25-15	BRACE, Compressor Steady, w/Eng. Stamped 361, 383 and 413	1	1852 933	1852 933	1852 933	1858 620
	Except PY1	1	-----	-----	-----	1947 789
	BRACKET, Compressor Mounting, w/Eng. Stamped 361, 383 and 413	1	1852 932	1852 932	1852 932	-----
	BRACKET, Compressor Mtg. w/Eng. Stamped 318	1	*1980 572	*1980 572	*1980 572	-----
	w/Eng. Stamped 361, 413, 383	1	*1980 566	*1980 566	*1980 566	-----
	Used w/Eng. Stamped 383 and 413	1	-----	-----	-----	*1980 576
	BRACKET, Compressor Side used w/Eng. Stamped 361 and 383	1	-----	-----	-----	1858 622
	PACKAGE, Compressor Front Bracket, w/Ram Manifold w/Eng. Stamped 361	1	1855 441	1855 441	1855 441	1858 621
24-25-16	BRUSH, Compressor Drive Clutch, includes HOLDER and BRACKET w/7 1/2" O.D. Clutch	1	2240 288	2240 288	2240 288	2240 288
24-25-17	CLUTCH, Compressor Drive 7 1/2" O.D.	1	2097 507	2097 507	2097 507	2097 507
24-25-18	SHOE, Compressor Clutch, includes HUB, used w/7 1/2" O.D. Clutch	1	1886 328	1886 328	1886 328	1886 328
24-25-20	PULLEY, Compressor, Clutch, includes HUB and BEARING, used w/5 1/8" O.D. Clutch	1	2097 996	2097 996	2097 996	2097 996
24-25-70	PACKAGE, Compressor Shaft Gas Seal	1	2097 106	2097 106	2097 206	2097 106
24-25-84	HEAD, Compressor, Right	1	1426 501	1426 501	1426 501	1426 501
	HEAD, Compressor, Left	1	1738 330	1738 330	1738 330	1738 330
	SCREW, Compressor Head	14	1738 329	1738 329	1738 329	1738 329
	SCREW, Compressor Sump	6	1730 587	1730 587	1730 587	1730 587
24-25-93	PACKAGE, Valve Plate Replacement	2	1730 587	1730 587	1730 587	1730 587
24-25-94	GASKET, Valve Plate to Crankcase	2	1734 837	1734 837	1734 837	1734 837
	GASKET, Cylinder Head	2	1378 313	1378 313	1378 313	1378 313
	PLATE, Valve, includes VALVES	2	1377 904	1377 904	1377 904	1377 904
24-25-95	GASKET, Discharge Valve	1	1734 837	1734 837	1734 837	1734 837
24-25-110	GASKET, Suction Valve	1	1982 508	1982 508	1982 508	1982 508
	GASKET, Suction Valve	1	1378 081	1378 081	1378 081	1378 081

★ Indicates use as required.

□ Indicates parts not listed in any previous parts book.

Dec. 9, 1960 Supersedes April 20, 1960.

Page 24-4

Printed in U.S.A.
Prices and specifications subject to change without notice.

* Indicates change or addition.

CODE	REMARKS	PER CAR	PLYMOUTH	DODGE	DESOTO	CHRYSLER AND IMPERIAL
24-25-O COMPRESSOR - Cont'd						
24-25-114	SCREEN, Suction	1	1982 507	1982 507	1982 507	1982 507
24-25-120	VALVE, Discharge Service, with Left Hand Mtg. Compressor Stamped 1947 497	1	1986 054	1986 054	1986 054	1986 054
	With Right Hand Mtg. Compressor Stamped 1947 499	1	1986 053	1986 053	1986 053	1986 053
	w/Compressor Stamped 1990558	1	1743 634	1743 634	1743 634	1743 634
24-25-121	SCREW, Service Valve	★	1747 993	1747 993	1747 993	1747 993
24-25-122	VALVE, Compressor Suction, used w/Compressor Stamped 1990558	1	1993 685	1993 685	1993 685	1993 685
24-25-127	CAP, Compressor Suction Valve, 1/4" Flare Model "E"	1	*1989 202	*1989 202	*1989 202	*1989 202
	CAP, Compressor Discharge Valve, 1/2" Flare Model "E"	1	*1989 208	*1989 208	*1989 208	*1989 208
24-25-132	VALVE, Pressure Regulator, with Left Hand Mtg., Compressor Stamped 1947 497	1	1986 052	1986 052	1986 052	1986 052
	With Right Hand Mtg. Compressor Stamped 1947 499	1	1986 051	1986 051	1986 051	1986 051
24-25-133	CORE, Pressure Regulator Valve	★	1992 947	1992 947	1992 947	1992 947
24-25-154	PACKAGE, Compressor Crankshaft	1	2196 304	2196 304	2196 304	2196 304
24-25-156	SCREW, Clutch Pulley Mounting, used w/7 1/2" O.D. Clutch	1	1819 843	1819 843	1819 843	1819 843
	Used w/5 1/8" O.D. Clutch	1	1658 638	1658 638	1658 638	1658 638
24-25-157	WASHER, Clutch Pulley Mounting, used w/7 1/2" O.D. Clutch	1	1648 240	1648 240	1648 240	1648 240
	Used w/5 1/8" O.D. Clutch	1	2097 102	2097 102	2097 102	2097 102
24-25-160	BEARING, Crankshaft, Ball	1	1854 829	1854 829	1854 829	1854 829
24-25-162	PACKAGE, Crankshaft Bearing Housing	1	2196 315	2196 315	2196 315	2196 315
24-25-189	SEAL, Crankshaft Bearing Housing	1	1377 831	1377 831	1377 831	1377 831
24-25-219	BEARING, Compressor Clutch	1	1769 318	1769 318	1769 318	1769 318
24-25-232	COIL, Clutch Field, used w/5 1/8" O.D. Clutch	1	2097 105	2097 105	2097 105	2097 105
	Used w/7 1/2" O.D. Clutch	1	2097 995	2097 995	2097 995	2097 995
24-25-233	SCREW, Clutch Field Coil Mounting, used w/5 1/8" O.D. Clutch	3	2097 109	2097 109	2097 109	2097 109
24-25-234	RING, Compressor Drive Clutch Internal, used w/5 1/8" O.D. Clutch	1	2097 103	2097 103	2097 103	2097 103
	External, used w/5 1/8" O.D. Clutch	1	2097 101	2097 101	2097 101	2097 101
24-25-235	PACKAGE, Insulator, Field Coil and Brush Lead	1	1843 226	1843 226	1843 226	1843 226
24-25-246	PACKAGE, Oil Pump Replacement	1	2196 306	2196 306	2196 306	2196 306
24-25-252	SEAL, Oil Pump Cover	1	1747 988	1747 988	1747 988	1747 988
24-25-258	SUMP, Compressor Oil	1	*1747 962	*1747 962	*1747 962	*1747 962
24-25-260	GASKET, Oil Sump	1	1377 825	1377 825	1377 825	1377 825
24-26-O RECEIVER DRIER						
24-26-20	PACKAGE, Receiver Drier, Model 906 Model "E"	1	1880 658	1880 658	1880 658	1880 658
		1	1742 766	1742 766	1742 766	1742 766
24-26-26	PLUG, Receiver Drier Fusible, Stamped 212, Model "E"	1	1744 767	1744 767	1744 767	1744 767
24-26-100	MUFFLER, Compressor, Includes TUBES, w/Eng. Stamped 318	1	1887 106	1887 106	1887 106	----
	Includes TUBES, w/Eng. Stamped 361, 383 and 413	1	2219 063	2219 063	2219 063	2219 063
24-27-O CONDENSER						
24-27-5	CONDENSER	1	1863 900	1863 900	1863 900	1863 900
	CONDENSER, Model "E"	1	1748 059	1748 059	1748 059	1748 059
24-28-O EVAPORATOR UNIT						
24-28-3	COVER, Quarter Panel Hose and Wiring Upper Right Sub.	1	2168 877	2168 877	2168 877	2168 877
	Upper Left Sub.	1	2168 878	2168 878	2168 878	2168 878
	Lower Right Sub.	1	----	----	----	2168 879
	Lower Left Sub.	1	----	----	----	2168 880
24-28-4	CLIP, Drier Actuator Rod	1	6008 145	6008 145	6008 145	6008 145
	By-Pass Door Actuator	1	6008 144	6008 144	6008 144	6008 144
	Deflector Outlet Rod	1	6008 145	6008 145	6008 145	6008 145
	Seal to Hood	4	6010 094	6010 094	6020 094	6010 094

★ Indicates use as required.

☐ Indicates parts not listed in any previous parts book.

* Indicates change or addition.

Printed in U.S.A.

Prices and specifications subject to change without notice.

CODE	REMARKS	PER CAR	PLYMOUTH	DODGE	DESOTO	CHRYSLER AND IMPERIAL
24-28-0 EVAPORATOR UNIT - Cont'd						
24-28-5	UNIT, Evaporator, Model 906	1	2096 325	2096 325	2096 325	2096 325
	Sub.	1	1886 232	1886 232	1886 232	1886 232
24-28-9	NUT, Fresh Air Door Adjusting	1	6008 157	6008 157	6008 157	6008 157
24-28-19	GROMMET, Coil Suction Tube Rear Unit	1	1658 766	1658 766	1658 766	1658 766
24-28-22	SCREW, Heater Housing Mounting, Model 906	14	6015 014	6015 014	6015 014	6015 014
24-28-24	HOSE, Refrigerant (see chart in front of Group 24)					
	HOSE, Evaporator Drain	1	1971 913	1971 913	1971 913	1971 913
24-28-25	HOUSING, Evaporator, includes DAMPER, DOOR and LINKS, Model 905	1	2096 332	2096 332	2096 332	2096 332
	HOUSING, w/LINKAGE and SEAL	1	2096 259	2096 259	2096 259	2096 259
24-28-26	CONNECTOR	2	1748 066	1748 066	1748 066	1748 066
24-28-36	PACKAGE, Tubing Sealing Washer Replacement	★	2196 341	2196 341	2196 341	2196 341
24-28-45	RETAINER, Fresh Air Damper Hinge Pin	2	6006 079	6006 079	6006 079	6006 079
24-28-52	NUT, Roof Rail Upper Cover	2	6006 486	6006 486	6006 486	6006 486
24-28-60	COVER, Evaporator Housing, Rear Unit Rear, except Sub.	1	1648 380	1648 380	1648 380	1648 380
24-28-70	GRILLE, Air Outlet, Rear Unit, except PY1 and Sub.	1	1887 501	1887 501	1887 501	1887 501
	Rear Unit, PY1	1	----	----	----	1885 901
24-28-71	SCREEN, Inlet Grille, Rear Unit, PY1	1	----	----	----	1570 956
24-28-72	CLIP, Inlet Grille, Rear Unit, except PY1 and Sub.	4	1331 850	1331 850	1331 850	1331 850
24-28-73	DUCT, Evaporator Inlet, Rear Unit, except PY1 and Sub.	1	1972 360	1972 360	1972 360	1972 360
	PY1	1	----	----	----	1648 430
24-28-75	BEZEL, Air Outlet, includes ADAPTER, Model 905	1	1972 996	----	----	----
	Right, except PY1, Model 905	1	----	----	----	1972 960
	Left, except PY1, Model 905	1	----	----	----	1972 961
	BEZEL, Air Inlet, Rear Unit, except Sub. and PY1	1	1819 014	1819 014	1819 014	1819 014
24-28-76	RETAINER, Inlet Duct Rear Unit to Shelf, except PY1 and Sub.	1	2097 010	2097 010	2097 010	2097 010
	PY1		----	----	----	1648 460
	Rear Roof Unit, Sub.	4	1689 670	1689 670	1689 670	1689 670
24-28-78	GRILLE, Air Outlet, Includes Radio GRILLE, Model 906	1	----	2096 070	2096 070	----
	LOUVER, Air Outlet, Includes FRAME, Model 905, PY1	2	2096 716	2096 716	2096 716	2096 716
	Includes FRAME, Model 905, except PY1	4	----	----	----	*2096 715
	Includes HOUSING, Rear Unit	2	2096 940	2096 940	2096 940	2096 940
	Roof Unit, Sub.	4	1838 380	1838 380	1838 380	1838 380
	ADAPTER, Outlet Louver, includes BRACKET and BEZEL, Rear Unit, Sub.	4	1753 579	1753 579	1753 579	1753 579
	GRILLE, Model "E"	1	1985 565	1985 565	1985 565	1985 565
24-28-79	SCREEN, Inlet Grille, Rear Unit, PY1	1	----	----	----	1570 956
24-28-90	DOOR, Fresh Air, includes LINKAGE	1	1830 632	1830 632	1830 632	1830 632
24-28-91	NUT, Fresh Air Door Linkage Adjusting	1	6008 157	6008 157	6008 157	6008 157
24-28-98	VANE, Air Deflector, Horizontal, Model "E"	3	1985 567	1985 567	1985 567	1985 567
	Air Deflector, Vertical w/LEVER, Model "E"	4	1991 567	1991 567	1991 567	1991 567
	Air Deflector, Vertical Model "E"	8	*1991 572	*1991 572	*1991 572	*1991 572
24-28-132	TUBE, Distribution Duct to Spot Cooler, Flexible, 2 1/2" x 26", Model 905	1	2096 989	2096 989	2096 989	1689 313
	Defroster, Flexible, 2 3/4" x 11 1/2", Model 905	1	1972 124	1972 124	1972 124	----
	Air Outlet Flexible, 3 1/4" x 18", Model 905	1	----	----	----	2197 020
	Air Outlet 3" x 33", PY1	1	1658 630	1658 630	1658 630	1658 630
24-28-175	HOUSING, Blower, Rear Unit, except Sub. Model "E"	2	1648 394	1648 394	1648 394	1648 394
		2	1991 576	1991 576	1991 576	1991 576
24-28-176	SEAL, Distribution Duct Inlet, Model 906	1	1887 757	1887 757	1887 757	1887 757
24-28-191	WASHER, Blower Motor Insulator, Rear Unit	6	6006 065	6006 065	6006 065	6006 065

★ Indicates use as required.

☐ Indicates parts not listed in any previous parts book.

Dec. 9, 1960 Supersedes April 20, 1960.

Page 24-6

Printed in U.S.A.
Prices and specifications subject to change without notice.

* Indicates change or addition.

CODE	REMARKS	PER CAR	PLYMOUTH	DODGE	DESOTO	CHRYSLER AND IMPERIAL
24-28-O EVAPORATOR UNIT - Cont'd						
24-28-195	MOTOR, Blower, Model 905	1	1879 579	1879 579	1879 579	1879 579
	Rear Unit, except Sub.	2	1887 401	1887 401	1887 401	1887 401
	Roof Unit, Sub.	2	1886 266	1886 266	1886 266	1886 266
	Model "E"	1	1985 536	1985 536	1985 536	1985 536
24-28-196	TERMINAL PACKAGE, Control Panel Lamp, PY1	1	----	----	----	1843 227
	Except PY1	1	----	----	----	1843 226
	SOCKET, Control Lamp	1	1689 538	----	----	----
24-28-197	INSULATOR, Motor Mtg.	6	117 957	117 957	117 957	117 957
24-28-199	BRACKET, Blower Motor Mtg., Model 906	1	1880 211	1880 211	1880 211	1880 211
24-28-200	SPACER, Motor Mtg. Bracket	3	1605 271	1605 271	1605 271	1605 271
24-28-204	WASHER, Blower Motor Housing Mounting Rear Unit, except Sub.	12	6006 065	6006 065	6006 065	6006 065
24-28-210	WHEEL, Blower, Model 906	1	1880 842	1880 442	1880 442	1880 442
	Rear Unit, except Sub.	2	1235 644	1235 644	1235 644	1235 644
	Right, Model "E"	1	1985 539	1985 539	1985 539	1985 539
	Left, Model "E"	1	1985 537	1985 537	1985 537	1985 537
24-28-220	COIL, Evaporator, includes HOUSING, Model 905	1	2096 325	2096 325	2096 325	2096 325
	Less Housing, Model 906	1	2096 253	2096 253	2096 253	2096 253
	Rear Unit, except Sub.	1	1880 642	1880 642	1880 642	1880 642
	Roof Unit, Sub.	1	1886 249	1886 249	1886 249	1886 249
	Model "E"	1	1991 581	1991 581	1991 581	1991 581
24-28-241	SWITCH, Thermal, Model "E"	1	1991 566	1991 566	1991 566	1991 566
24-28-295	PACKAGE, Distribution Defroster Door	1	2084 295	2084 295	2084 295	2084 295
24-28-300	VALVE, Expansion, except Sub.	1	1879 580	1879 580	1879 580	1879 580
	Sub.	1	1887 364	1887 364	1887 364	1887 364
	Model "E"	1	1991 619	1991 619	1991 619	1991 619
24-28-318	TEE, Liquid Tube, Rear Unit, w/Dual Unit	1	1885 692	1885 692	1885 692	1885 692
	TEE, Suction Tube, Rear Unit, w/Dual Unit	1	1886 011	1886 011	1886 011	1886 011
	TEE, Control Vacuum Tube, Plastic	2	1886 109	1886 109	1886 109	1886 109
24-28-322	INDICATOR PACKAGE, Liquid, includes CAP and GASKET	1	1880 657	1880 657	1880 657	1880 657
	Model "E"	1	1744 768	1744 768	1744 768	1744 768
24-28-357	NUT, Damper Control	1	1972 548	1972 548	1972 548	1971 521
24-28-361	CLIP, Temperature Control Cable	1	6015 143	6015 143	6015 143	6015 143
24-28-364	DUCT, Distribution	1	⊕1972 594	⊕1972 594	⊕1972 594	⊕1972 594
24-28-366	ROTARY, Floor Air Damper Control, includes CABLE, Except PY1	1	2096 109	2096 110	2096 111	2096 112
	PY1	1	----	----	----	2096 113
24-28-367	CLAMP, Defroster Door, PS3	1	1971 407	1971 407	1971 407	1971 407
24-28-368	WASHER, Defroster Door	1	1971 463	1971 463	1971 463	1971 463
24-28-370	NOZZLE, Defroster, Left	1	----	1971 693	1971 693	----
24-28-378	NUT, Defroster Door Shaft	1	1829 825	1829 825	1829 825	1829 825
24-28-379	OUTLET DOOR PACKAGE, Distribution Duct Defroster	1	*2084 295	*2084 295	*2084 295	----
24-28-382	BEZEL, Air Damper Control	1	----	1972 590	1972 590	----
24-28-384	COVER, Deflector Lever except RD2	1	⊕2097 152	⊕2097 152	⊕2097 152	⊕2097 152
24-28-387	SPOT COOLER, Model 906	1	⊕1972 372	⊕1972 372	⊕1972 372	⊕1972 372
24-29-O ACTUATOR						
24-29-1	VACUUM, By-Pass Door, Model 906	1	1885 824	1885 824	1885 824	1885 824
	Recirculating Door	1	2097 128	2097 128	2097 128	2097 128
	Deflector	1	2197 131	2197 131	2197 131	2197 131
	Defroster	1	2219 090	2219 090	2219 090	2219 090
	Fresh Air Door	1	1879 843	1879 843	1879 843	1879 843

★ Indicates use as required.

⊕ Indicates parts not listed in any previous parts book.

* Indicates change or addition.

Printed in U.S.A.

Prices and specifications subject to change without notice.

