

GROUP 3 - AXLE-REAR

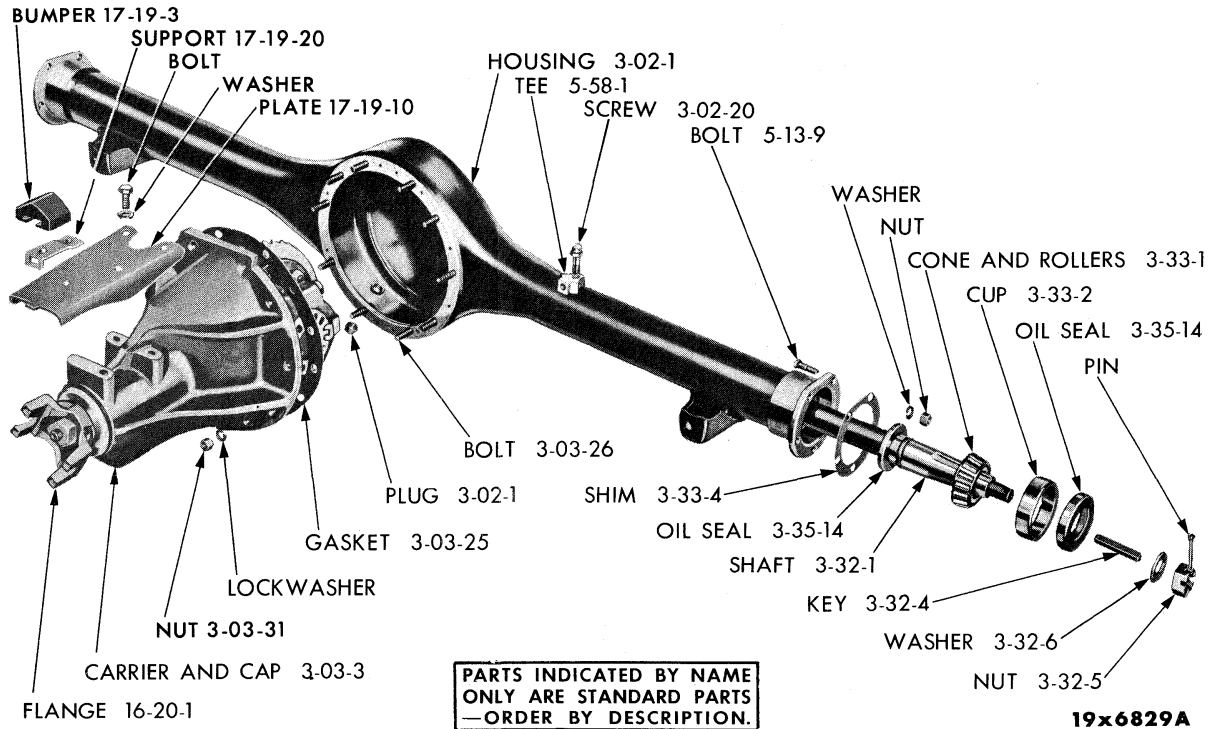

REAR AXLE HOUSING AND SHAFT

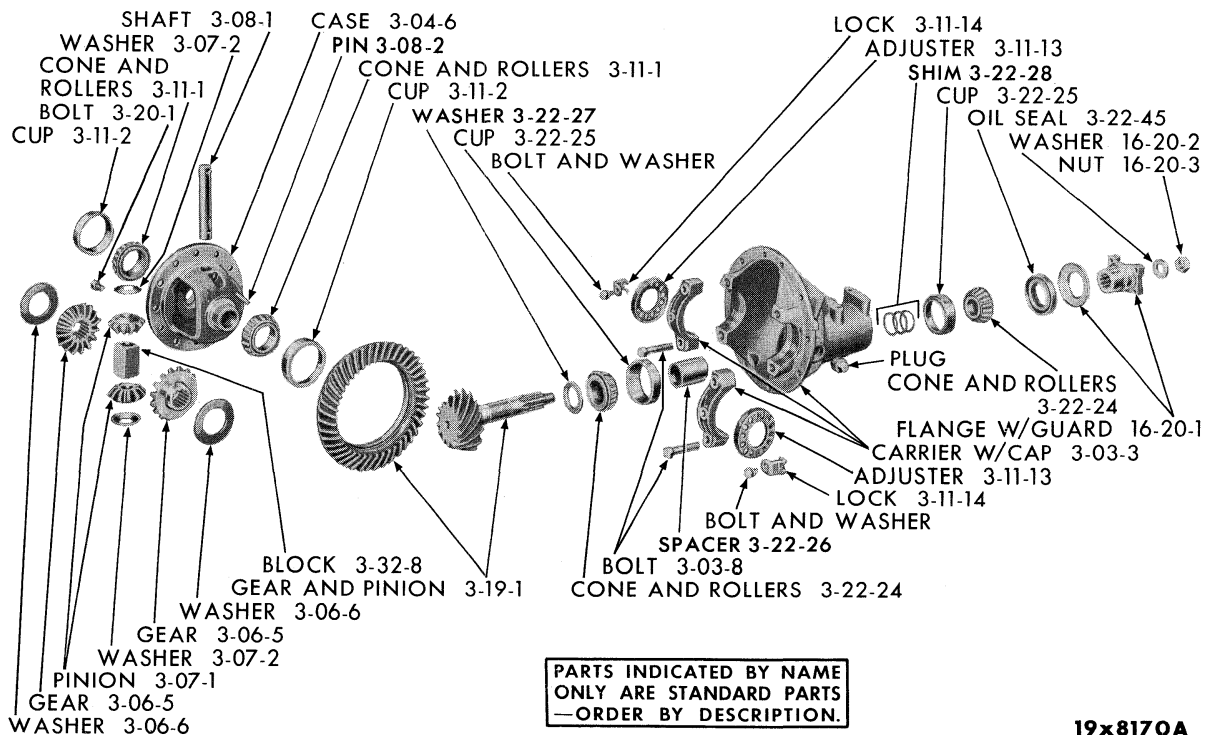

REAR AXLE DIFFERENTIAL AND CARRIER

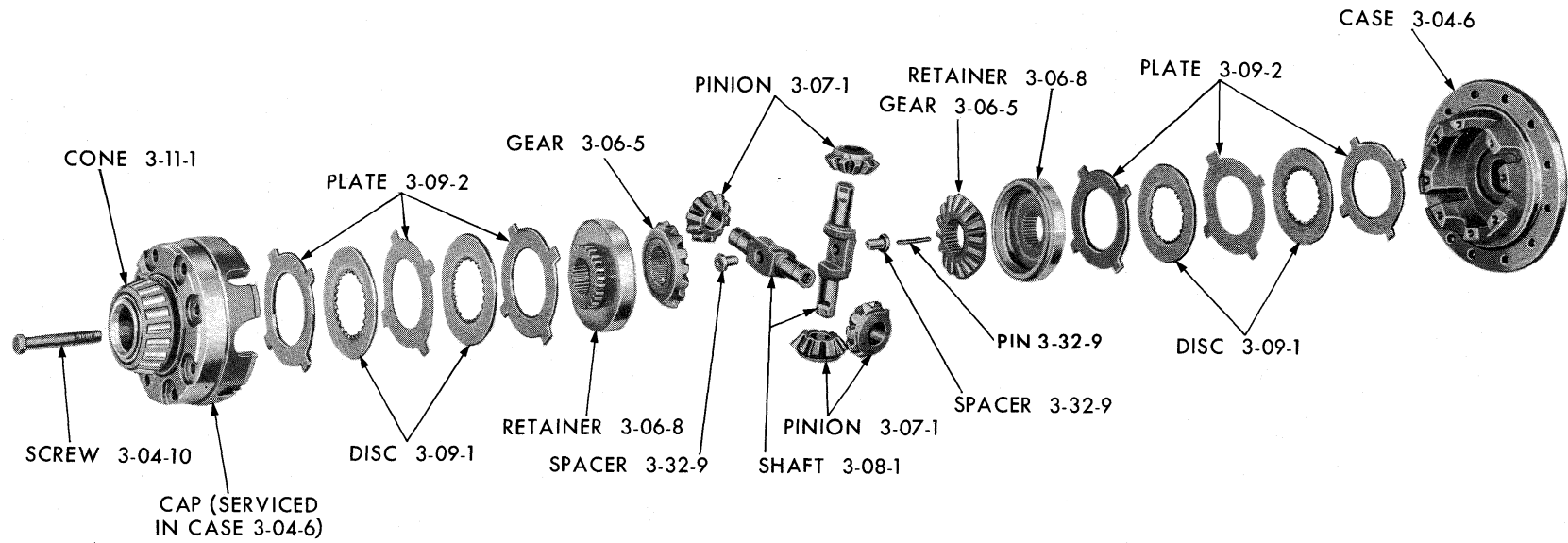

19x8320B

"SURE-GRIP" REAR AXLE DIFFERENTIAL

CODE	PART NAME AND DESCRIPTION	NO. OF CYL.	PLYMOUTH	DODGE	DESOTO	CHRYSLER AND IMPERIAL	PER CAR	PART NUMBER
------	---------------------------	-------------	----------	-------	--------	-----------------------	---------	-------------

GROUP 3 - AXLE-REAR

3-01-0 REAR AXLE CONTROL STRUT								
3-01-25	STRUT, MY1	8	-	-	-	59	2	1730 160
3-01-28	BUSHING, MY1	8	-	-	-	59	4	1635 600
3-01-30	SPACER, MY1	8	-	-	-	59	★	1731 769
3-01-33	HANGER, MY1	8	-	-	-	59	2	1731 738
3-01-34	BOLT, Hanger, MY1	8	-	-	-	59	8	1731 789
3-01-35	NUT, Bolt, MY1	8	-	-	-	59	8	1736 993
3-02-0 REAR AXLE HOUSING								
3-02-1	HOUSING	6	59	59	-	-	1	1673 401
	MC1, MC2, MC3	8	59	59	59	59	1	1673 402
	MY1	8	-	-	-	59	1	1673 395
	w/Air Suspension, MY1	8	-	-	-	59	1	1940 614
3-02-20	SCREW, Vent	6-8	59	59	59	59	1	925 525
3-03-0 REAR AXLE DIFFERENTIAL AND CARRIER								
3-03-1	DIFFERENTIAL, w/CARRIER, 3.73 to 1 ratio	6	59	59	-	-	1	1828 699
	3.9 to 1 ratio	6	59	59	-	-	1	1828 700
	3.31 to 1 ratio	8	59	59	59	59	1	1850 732
	3.31 to 1 ratio, Sure-Grip	8	59	59	59	59	1	1850 758
	3.54 to 1 ratio, MS1	8	59	59	59	-	1	1828 515
	3.73 to 1 ratio, Sure-Grip	8	59	-	-	-	1	⊠1850 364
	3.91 to 1 ratio, MD2, MS1	8	59	59	59	-	1	1828 517
	2.93 to 1 ratio	8	59	59	59	59	1	1829 338
	3.15 to 1 ratio, MD3, MC1 Sub., MC3 Sub.	8	59	59	-	59	1	1850 730
	3.73 to 1 ratio	8	59	-	-	-	1	*1828 516
	2.93 to 1 ratio, Sure-Grip	8	-	59	59	59	1	1829 496
3-03-2	DIFFERENTIAL, Assembly, Partial, w/Sure-Grip	8	59	59	59	59	1	1829 264
3-03-3	CARRIER, w/CUPS	6	59	59	-	-	1	1828 447
	MS1	8	59	59	59	-	1	1820 698
	MS2, MS3	8	-	-	59	59	1	1634 984
3-03-8	SCREW, Cap	6-8	59	59	59	59	4	314 948
3-03-25	GASKET	6	59	59	-	-	1	1318 011
		8	59	59	59	59	1	1673 367
3-03-26	BOLT, Housing to Carrier	6-8	59	59	59	59	★	1135 197
3-03-31	NUT, Housing to Carrier	6-8	59	59	59	59	★	1485 066
	w/Air Suspension	8	59	59	59	59	1	1940 596
3-04-0 DIFFERENTIAL CASE								
3-04-6	CASE	6	59	59	-	-	1	1485 093
	4.1, 4.3 and 4.78 ratio	6	59	-	-	-	1	1485 094
		8	59	59	59	59	1	1850 370
	w/Sure-Grip	8	59	59	59	59	1	*1945 749
3-04-10	SCREW, Case Cap, w/Sure-Grip	6-8	59	59	59	59	8	*1945 751
3-06-0 DIFFERENTIAL SIDE GEAR								
3-06-5	GEAR	6	59	59	-	-	2	⊠2070 242
		8	59	59	59	59	2	1675 450
	w/Sure-Grip	8	59	59	59	59	2	1829 448

★ Indicates use as required.

⊠ Indicates parts not listed in any previous parts book.

* Indicates change or addition.

1959 PASSENGER CAR PARTS LIST

AXLE - REAR

CODE	PART NAME AND DESCRIPTION	NO. OF CYL.	PLYMOUTH	DODGE	DESOTO	CHRYSLER AND IMPERIAL	PER CAR	PART NUMBER
3-06-0 DIFFERENTIAL SIDE GEAR Cont'd								
3-06-6	WASHER, Thrust	6 8	59 59	59 59	- 59	- 59	2 2	632 587 1633 960
3-06-8	RETAINER, w/Sure-Grip	8	59	59	59	59	2	*1829 447
3-07-0 DIFFERENTIAL PINION								
3-07-1	PINION	6 8	59 59	59 59	- 59	- 59	2 2	1326 219 1633 959
	w/Sure-Grip	8	59	59	59	59	4	*1829 449
3-07-2	WASHER, Thrust	6 8	59 59	59 59	- 59	- 59	2 2	663 479 1633 961
3-08-0 DIFFERENTIAL PINION SHAFT								
3-08-1	SHAFT	6 8	59 59	59 59	- 59	- 59	1 1	1142 006 1633 928
	w/Sure-Grip	8	59	59	59	59	2	*1829 446
	PIN	6	59	59	-	-	1	* 141 232
3-08-2	PIN, Lock	8	59	59	59	59	1	1633 937
3-09-0 REAR AXLE DIFFERENTIAL CLUTCH PARTS								
3-09-1	DISC, Clutch, w/Sure-Grip	8	59	59	59	59	4	*1829 451
3-09-2	PLATE, Clutch, w/Sure-Grip, .058" thk.	8	59	59	59	59	2	*1850 804
	w/Sure-Grip, .092" thk.	8	59	59	59	59	4	*1829 450
3-11-0 DIFFERENTIAL BEARINGS								
3-11-1	CONE, w/ROLLERS	6 8	59 59	59 59	- 59	- 59	2 2	698 404 1790 523
3-11-2	CUP	6-8	59	59	59	59	2	698 403
3-11-13	ADJUSTER	6-8	59	59	59	59	2	601 864
3-11-14	LOCK, Adjuster	6-8	59	59	59	59	2	308 247
3-19-0 DRIVE GEAR AND PINION SET								
3-19-1	GEAR and PINION SET, 3.73 to 1 ratio	6	59	59	-	-	1	1567 900
	3.9 to 1 ratio	6	59	59	-	-	1	1141 541
	4.1 to 1 ratio	6	59	-	-	-	1	1567 835
	3.31 to 1 ratio, MS1	8	59	59	59	-	1	*1850 379
	3.54 to 1 ratio, MS1	8	59	59	59	-	1	1673 379
	3.73 to 1 ratio	8	59	-	-	-	1	1673 380
	3.91 to 1 ratio, MD2, MS1	8	59	59	59	-	1	1673 381
	2.93 to 1 ratio, MS1	8	59	59	59	-	1	1828 440
	3.15 to 1 ratio, MD3, MC1 Sub., MC3 Sub.	8	59	59	-	59	1	1850 373
	3.73 to 1 ratio, w/Sure-Grip, 12" Brakes.	8	59	-	-	-	1	E1673 388
	2.93 to 1 ratio, MD3-H, MS1, w/Sure-Grip,	8	-	59	59	-	1	*1828 441
	3.31 to 1 ratio, MD3-H, MS1, w/Sure-Grip.	8	-	59	59	-	1	*1850 380
	2.93 to 1 ratio, MD2-500, MD3-500, MS2, MS3	8	-	59	59	59	1	*1828 441
	3.31 to 1 ratio, MD2-500, MD3-500. MS1	8	-	59	59	59	1	*1850 380
	w/12 x 2 1/2" Brakes, MS2, MS3	8	-	59	59	59	1	*1850 380
3-20-0 DRIVE GEAR BOLT								
3-20-1	BOLT	6 8	59 59	59 59	- 59	- 59	10 12	663 481 1675 485
	w/Sure-Grip	6-8	59	59	59	59	12	E1945 768
3-20-2	LOCK, Nut	6	59	59	-	-	5	663 482

* Indicates use as required. Numerals in parentheses () refer to notes. Printed in U.S.A.
 E Indicates parts not listed in any previous parts book. Prices and specifications subject to change without notice.
 May 25, 1959 Supersedes Dec. 30, 1958. Page 3-2 * Indicates change or addition.

CODE	PART NAME AND DESCRIPTION	NO. OF CYL.	PLYMOUTH	DODGE	DESOTO	CHRYSLER AND IMPERIAL	PER CAR	PART NUMBER
3-22-0 DRIVE PINION BEARINGS								
3-22-24	CONE, Front Bearing, w/ROLLERS, MS1 . . .	6-8	59	59	59	-	1	1820 552
	Front, MS2, MS3	8	-	-	59	59	1	1401 808
	Rear, MS1	6-8	59	59	59	-	1	1401 809
	Rear, MS2, MS3	8	-	-	59	59	1	1404 472
3-22-25	CUP, Front, MS1	6-8	59	59	59	-	1	1820 551
	Front, MS2, MS3	8	-	-	59	59	1	1401 810
	Rear, MS1	6-8	59	59	59	-	1	1401 810
	Rear, MS2, MS3	8	-	-	59	59	1	1327 847
3-22-26	SPACER, Rear Bearing, MS1	6-8	59	59	59	-	1	1738 826
3-22-27	WASHER, Rear Bearing, .084" thk., MS1 . . .	6-8	59	59	59	-	★	1738 794
	.086" thk., MS1	6-8	59	59	59	-	★	1738 795
	.088" thk., MS1	6-8	59	59	59	-	★	1738 796
	.090" thk., MS1	6-8	59	59	59	-	★	1738 797
	.092" thk., MS1	6-8	59	59	59	-	★	1738 798
	.094" thk., MS1	6-8	59	59	59	-	★	1738 799
	.096" thk., MS1	6-8	59	59	59	-	★	1738 800
	.098" thk., MS1	6-8	59	59	59	-	★	1738 801
	.100" thk., MS1	6-8	59	59	59	-	★	1738 802
	.084" thk., MS2, MS3	8	-	-	59	59	★	1738 812
	.086" thk., MS2, MS3	8	-	-	59	59	★	1738 813
	.088" thk., MS2, MS3	8	-	-	59	59	★	1738 814
	.090" thk., MS2, MS3	8	-	-	59	59	★	1738 815
	.092" thk., MS2, MS3	8	-	-	59	59	★	1738 816
	.094" thk., MS2, MS3	8	-	-	59	59	★	1738 817
	.096" thk., MS2, MS3	8	-	-	59	59	★	1738 818
	.098" thk., MS2, MS3	8	-	-	59	59	★	1738 819
	.100" thk., MS2, MS3	8	-	-	59	59	★	1738 820
3-22-28	SHIM, Front Bearing Adjusting, .010" thk., MS1	6-8	59	59	59	-	★	1820 701
	.014" thk., MS1	6-8	59	59	59	-	★	1820 703
	.016" thk., MS1	6-8	59	59	59	-	★	1820 704
	.018" thk., MS1	6-8	59	59	59	-	★	1820 705
	.024" thk., MS1	6-8	59	59	59	-	★	1829 440
	.026" thk., MS1	6-8	59	59	59	-	★	1829 441
	.010" thk., MS2, MS3	8	-	-	59	59	★	1738 803
	.014" thk., MS2, MS3	8	-	-	59	59	★	1738 805
	.016" thk., MS2, MS3	8	-	-	59	59	★	1738 806
	.018" thk., MS2, MS3	8	-	-	59	59	★	1738 807
	.022" thk., MS2, MS3	8	-	-	59	59	★	1829 442
	.024" thk., MS2, MS3	8	-	-	59	59	★	1829 443
	.026" thk., MS2, MS3	8	-	-	59	59	★	1829 444
3-22-45	OIL SEAL, Front Bearing, MD2, MS1, 3" O. D.	6-8	59	59	59	-	1	*1738 831
	MD3, MS2, MS3, 3 1/4" O. D.	8	-	59	59	59	1	*1828 719
3-32-0 DRIVE SHAFT								
3-32-1	SHAFT, 31 5/8" lgh., MD2 except Sp. 4 D. Sed. and Cv.Cp., also specify 1 of 1673 373 Oil Seal	6-8	59	59	-	-	2	1675 448
	31 5/8" lgh., MD2, Sp. 4 D. Sed. and Cv.Cp., MD3, MC1, MC2, MC3	8	-	59	59	59	2	1675 448
	32 31/64" lgh., MY1	8	-	-	-	59	2	1675 449
	w/Sure-Grip, 31 1/2" lgh., MC1, MC2, MC3	8	59	59	59	59	2	*1829 266
	w/Sure-Grip, 32 3/8" lgh., MY1	8	-	-	-	59	2	1829 267
3-32-4	KEY	6-8	59	59	59	59	2	1118 149
3-32-5	NUT	6-8	59	59	59	59	2	53 553
3-32-6	WASHER	6-8	59	59	59	59	2	50 652
3-32-8	BLOCK, Thrust	6	59	59	-	-	1	651 402
		8	59	59	59	59	1	1675 432
3-32-9	SPACER, Thrust Block	6	59	59	-	-	2	663 607
	w/Sure-Grip	8	59	59	59	59	2	*1829 445
	PIN, w/Sure-Grip	8	59	59	59	59	1	273 752

★ Indicates use as required. Numerals in parentheses () refer to notes. Printed in U.S.A.
 ☐ Indicates parts not listed in any previous parts book. Prices and specifications subject to change without notice.
 * Indicates change or addition. Page 3-3 May 25, 1959 Supersedes Dec. 30, 1958.

