

GROUP 16 - PROPELLER SHAFT AND UNIVERSAL JOINT

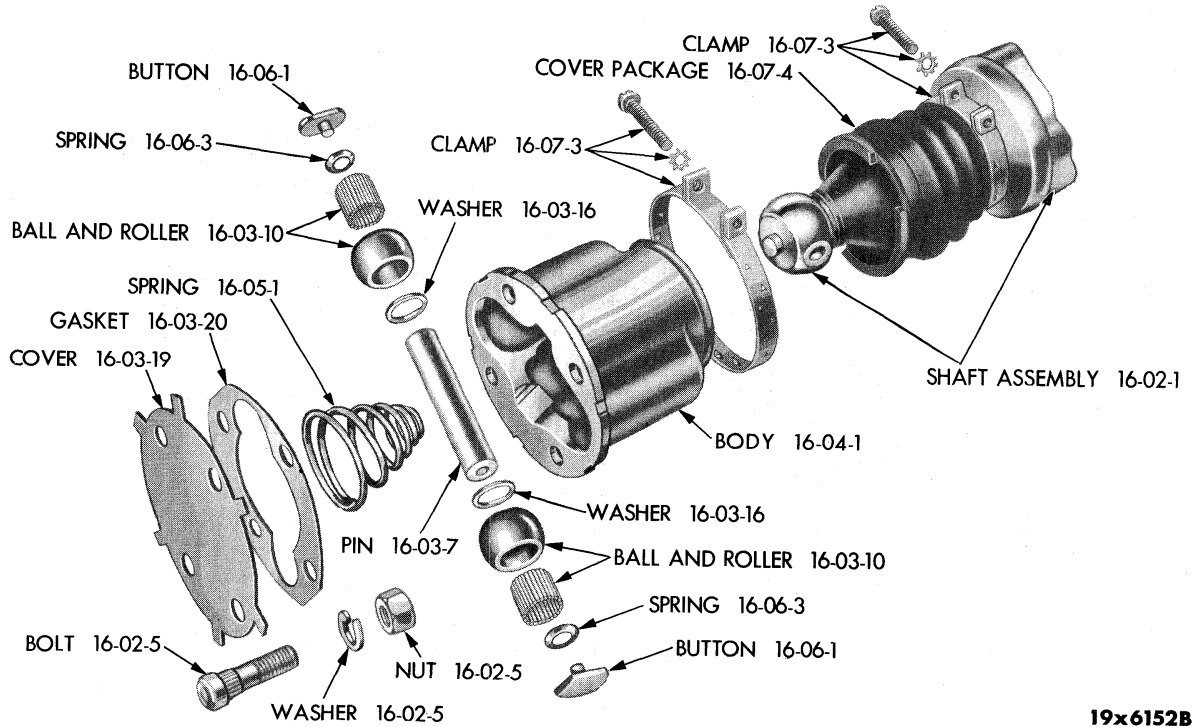

FRONT AND REAR UNIVERSAL JOINT AND PROPELLER SHAFT (BALL AND PIN TYPE)

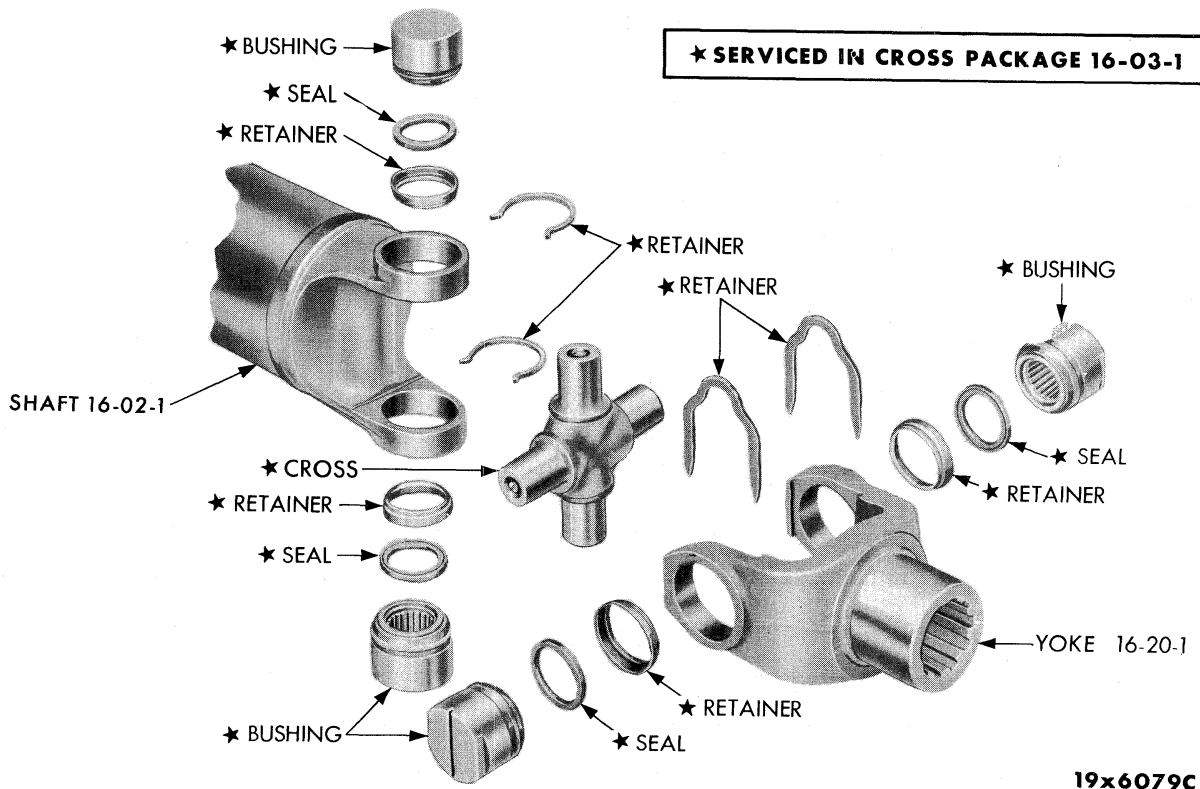

PROPELLER SHAFT AND UNIVERSAL JOINT

CODE	PART NAME AND DESCRIPTION	NO. OF CYL.	PLYMOUTH	DODGE	DESOTO	CHRYSLER AND IMPERIAL	PER CAR	PART NUMBER
------	---------------------------	-------------	----------	-------	--------	-----------------------	---------	-------------

GROUP 16 - PROPELLER SHAFT AND UNIVERSAL JOINT

16-02-0 PROPELLER SHAFT								
16-02-1	SHAFT, 54 13/16" lgh., w/Std. Trans., w/o Overdrive, except Sub.	6	59	-	-	-	1	1829 231
	55" lgh., w/Std. Trans., w/High Performance, w/Overdrive, w/PowerFlite, except Sub.	6-8	59	-	-	-	1	1734 118
	55" lgh., w/Std. Trans., w/o Overdrive, except Sub.	8	59	-	-	-	1	1856 961
	54 31/32" lgh., w/Auto. 3 Speed Trans., except Sub.	8	59	-	-	-	1	1739 930
	59" lgh., w/Std. Trans., MP2 Sub.	8	59	59	-	-	1	1856 963
	58 13/16" lgh., w/Std. Trans., MP1 Sub., MD1	6	59	59	-	-	1	1856 917
	58 31/32" lgh., MP2 Sub., MD2 w/Auto. 3 Speed Trans., MD3, MS1 w/PowerFlite Trans., 3 1/4" dia.	8	59	59	59	-	1	1856 931
	58 31/32" lgh., MP2 Sub., w/Auto. 3 Speed Trans., 2 3/4" dia.	8	59	59	59	59	1	1856 933
16-02-2	SHAFT, Front, 27 3/32" lgh., MY1	8	-	-	-	59	1	1734 135
	27 3/32" lgh., w/Air Suspension, MY1	8	-	-	-	59	1	1943 645
16-02-4	SHAFT, Rear, w/o Air Suspension, 33 1/16" lgh., MY1.	8	-	-	-	59	1	1946 297
	Rear, w/Air Suspension, 33 1/16" lgh., MY1.	8	-	-	-	59	1	1946 298
16-02-5	STUD, Trans. Flange, except MS1	6-8	59	59	59	59	4	*1946 283
	MS1	8	-	-	59	-	4	1326 773
	BOLT, MY1	8	-	-	-	59	4	853 156
	SCREW, Axle End	6-8	59	59	59	59	4	952 538
16-03-0 UNIVERSAL JOINT								
16-03-1	JOINT PACKAGE, Front, MS1	6-8	59	59	59	-	1	1603 398
	w/Auto. 3 Speed Trans., MC1, MC2, MC3	8	59	59	59	59	1	1752 680
	Rear Center Bearing, MY1	8	-	-	-	59	1	1752 623
	Except MY1	8	59	59	59	59	1	1752 624
	MY1	8	-	-	-	59	2	1752 624
16-03-3	ROLLER PACKAGE	6-8	59	59	59	59	★	638 637
16-03-7	PIN, w/Std. Trans., MS1	6-8	59	59	59	-	1	579 445
	MC1, MC2, MC3, w/Auto. 3 Speed Trans., MS1 w/PowerFlite	8	59	59	59	59	1	1739 923
16-03-10	BALL, w/ROLLER, w/Std. Trans., MS1	6-8	59	59	59	-	2	1550 466
	MC1, MC2, MC3, w/Auto. 3 Speed Trans., MS1 w/PowerFlite	8	59	59	59	59	2	1739 927
16-03-16	WASHER, Thrust, MC1, MC2, MC3	6-8	59	59	59	59	2	605 004
16-03-19	COVER, Grease, w/Std. Trans., MS1	6-8	59	59	59	-	1	602 820
	MC1, MC2, MC3, w/Auto. 3 Speed Trans., MS1 w/PowerFlite	8	59	59	59	59	1	1635 092
16-03-20	GASKET, w/Std. Trans., MS1	6-8	59	59	59	-	1	1616 185
	MC1, MC2, MC3, w/Auto. 3 Speed Trans., MS1 w/PowerFlite	8	59	59	59	59	1	1635 098
16-04-0 UNIVERSAL JOINT BODY								
16-04-1	BODY, w/Std. Trans., MS1	6-8	59	59	59	-	1	*1734 159
	MC1, MC2, MC3, w/Auto. 3 Speed Trans., MS1 w/PowerFlite	8	59	59	59	-	1	1739 920

★ Indicates use as required.

Numerals in parentheses () refer to notes.

Printed in U.S.A.

☐ Indicates parts not listed in any previous parts book.

Prices and specifications subject to change without notice.

* Indicates change or addition.

1959 PASSENGER CAR PARTS LIST

PROPELLER SHAFT AND
UNIVERSAL JOINT

CODE	PART NAME AND DESCRIPTION	NO. OF CYL.	PLYMOUTH	DODGE	DESOTO	CHRYSLER AND IMPERIAL	PER CAR	PART NUMBER
16-06-0 UNIVERSAL JOINT CENTERING BUTTON								
16-06-1	BUTTON, w/Std. Trans., MS1	6-8	59	59	59	-	2	629 768
	MC1, MC2, MC3, w/Auto. 3 Speed Trans., MS1 w/PowerFlite	8	59	59	59	59	2	1739 924
16-06-3	SPRING, MC1, MC2, MC3	6-8	59	59	59	59	2	1739 926
16-07-0 UNIVERSAL JOINT DUST COVER								
16-07-3	CLAMP, Short	6-8	59	59	59	59	1	870 540
	Long, w/Auto. 3 Speed Trans.	8	59	59	59	59	★	1532 943
	Long, 2 1/2", MS1 w/Std. Trans.	6-8	59	59	59	-	1	870 539
	Long, 2 3/4", MS1 w/Std. Trans., w/Power- flite	6-8	59	59	59	-	1	1532 943
16-07-4	COVER PACKAGE, Dust, w/Auto. 3 Speed Trans.	8	59	59	59	59	1	1450 448
	w/Std. Trans.	6-8	59	59	59	-	1	1603 397
	w/PowerFlite	8	-	-	59	-	1	1450 448
16-08-0 UNIVERSAL JOINT CROSS								
16-08-6	SEAL, Axle End, except MY1	6-8	59	59	59	59	4	857 999
	MY1	8	-	-	-	59	12	857 999
16-08-7	RETAINER, Seal, Axle End, except MY1	6-8	59	59	59	59	4	1739 912
	MY1	8	-	-	-	59	12	1739 912
16-09-0 UNIVERSAL JOINT CROSS ROLLER AND BEARING BLOCK								
16-09-1	ROLLER and BEARING BLOCK, except MY1	6-8	59	59	59	59	2	1739 914
	MY1	8	-	-	-	59	4	1739 914
16-09-2	RETAINER, except MY1	6-8	59	59	59	59	2	858 007
	MY1	8	-	-	-	59	4	858 007
16-10-0 UNIVERSAL JOINT CROSS ROLLER AND BUSHING								
16-10-1	ROLLER, w/BUSHING, except MY1	6-8	59	59	59	59	2	1739 913
	MY1	8	-	-	-	59	6	1739 913
16-10-2	RETAINER, except MY1	6-8	59	59	59	59	2	858 006
	MY1	8	-	-	-	59	6	858 006
16-10-3	CLAMP, Bushing	6-8	59	59	59	59	2	1828 824
16-14-0 PROPELLER SHAFT SPLINE OR SLIDING YOKE								
16-14-1	YOKE, MY1	8	-	-	-	59	1	1739 915
16-14-7	SEAL, Oil, MY1	8	-	-	-	59	1	1672 049
16-14-9	CAP, Oil Seal, MY1	8	-	-	-	59	1	1672 050
16-16-0 PROPELLER SHAFT CENTER BEARING								
16-16-1	BEARING, MY1	8	-	-	-	59	1	1672 051
16-16-6	WASHER, Lock, MY1	8	-	-	-	59	1	1638 151
16-16-43	SLINGER, Dust, MY1	8	-	-	-	59	2	1672 053
16-16-47	SPACER, MY1	8	-	-	-	59	★	1945 836
16-17-0 PROPELLER SHAFT CENTER BEARING HOUSING AND INSULATOR								
16-17-1	INSULATOR, MY1	8	-	-	-	59	1	1856 942
	w/Air Suspension, MY1	8	-	-	-	59	1	1856 948

★ Indicates use as required.

☐ Indicates parts not listed in any previous parts book.
May 25, 1959 Supersedes Dec. 30, 1958.

Numerals in parentheses () refer to notes.

Prices and specifications subject to change without notice.

* Indicates change or addition.

Printed in U.S.A.

