

GROUP 24 - AIR CONDITIONING

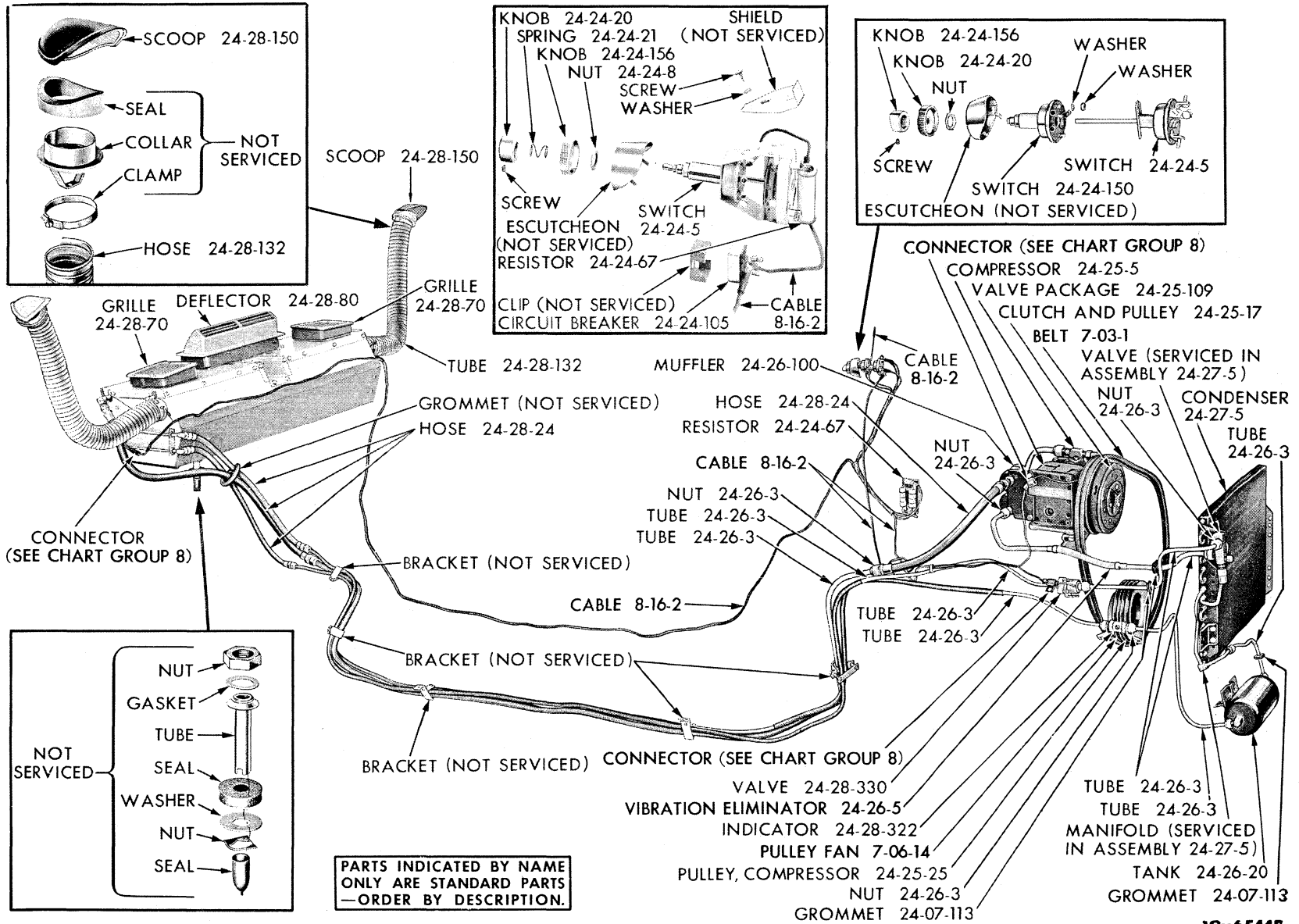
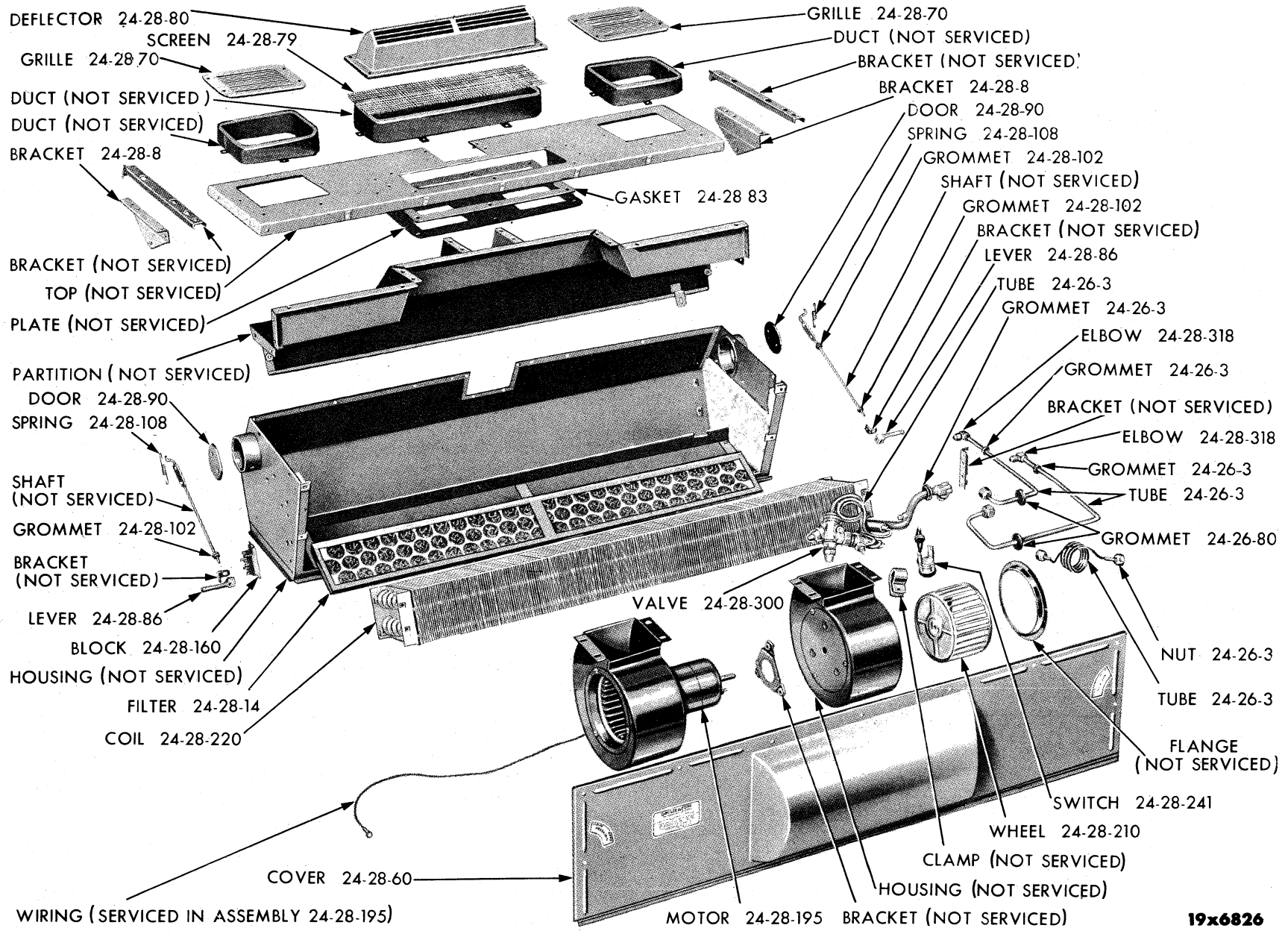
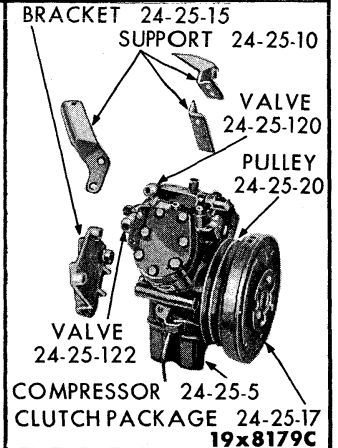
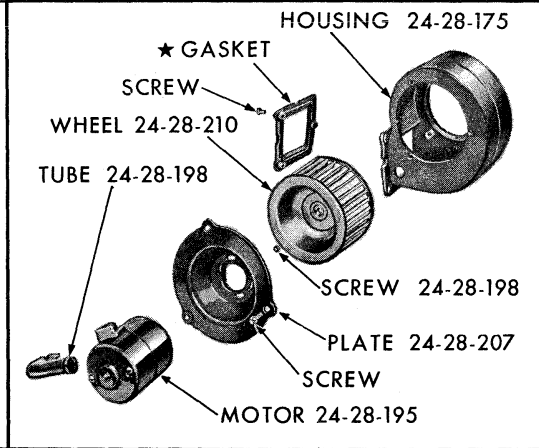
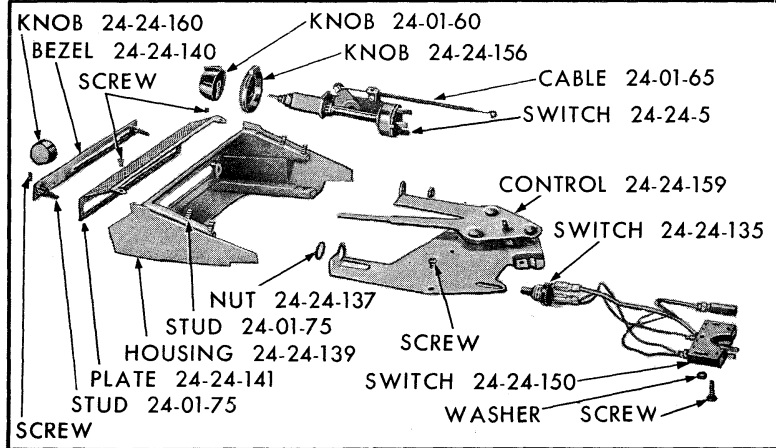
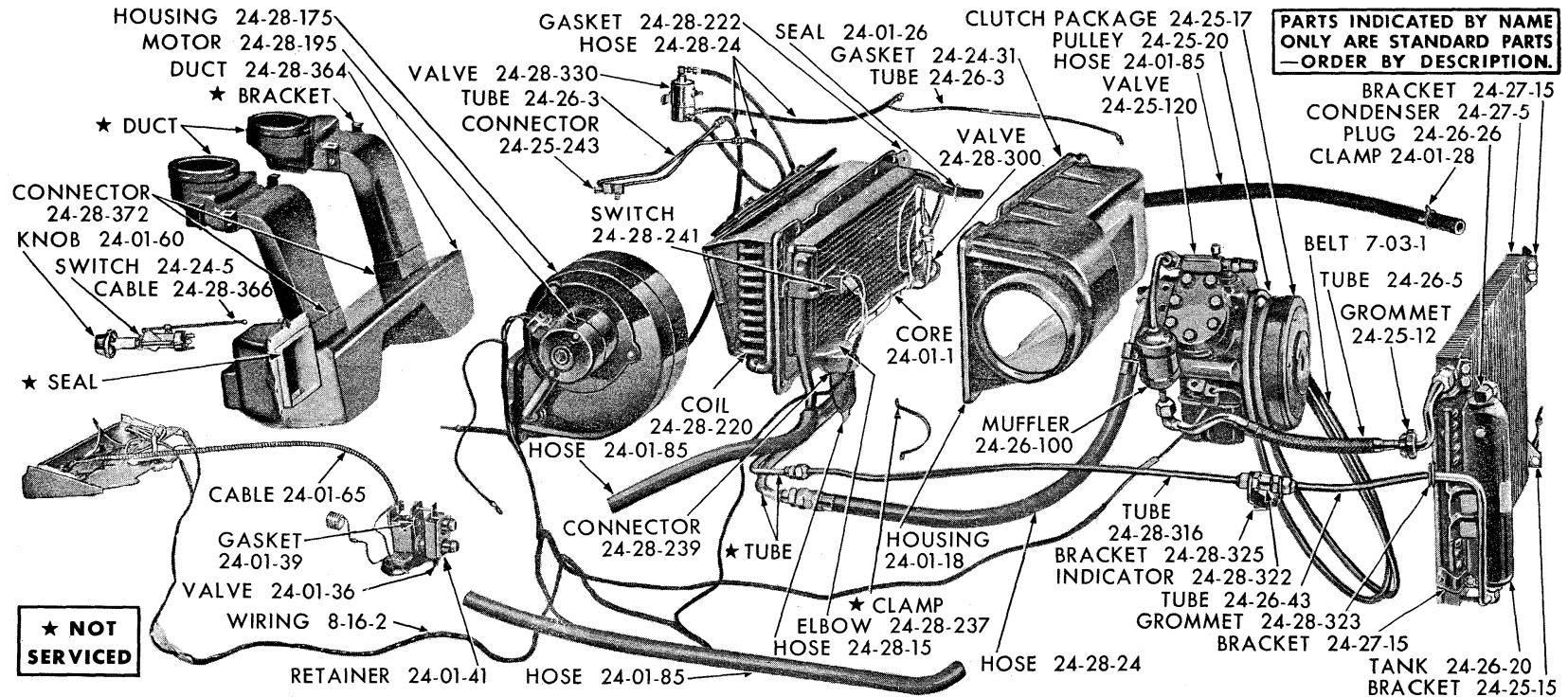

Plate 24-1

AIR CONDITIONING SYSTEM - 1955-56 MODELS



19x6826



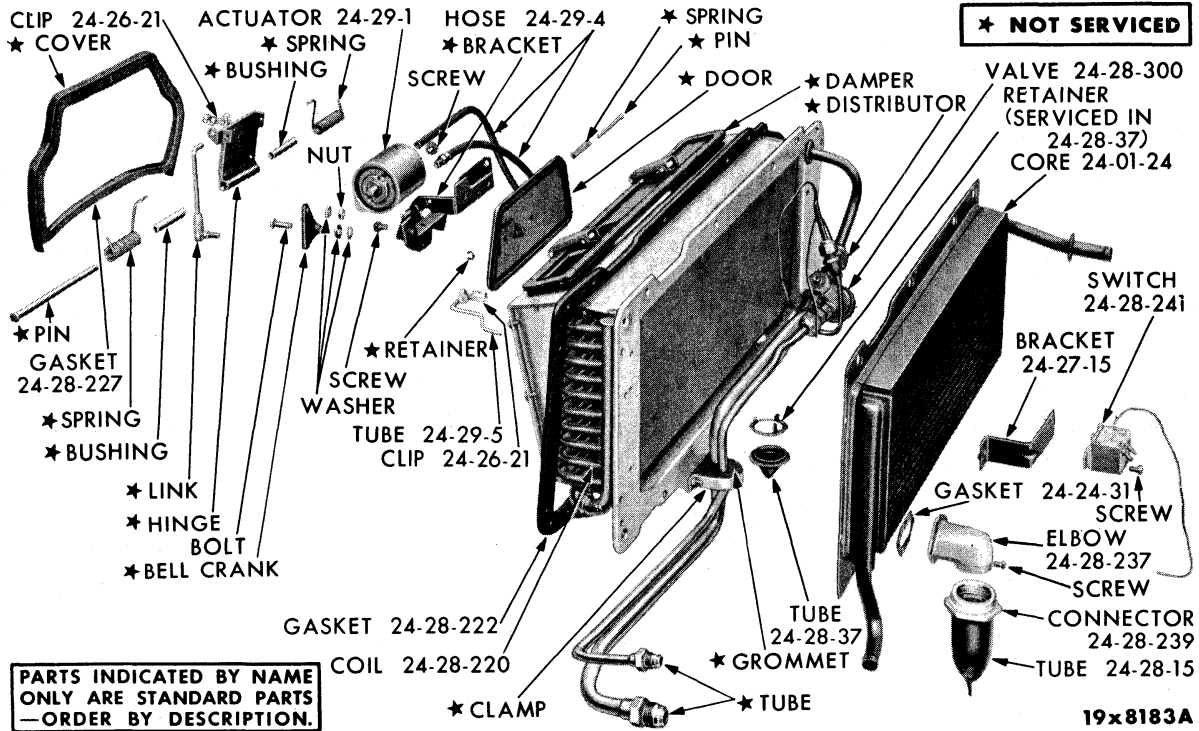

Plate 24-4

AIR CONDITIONING EVAPORATOR - MODEL 900

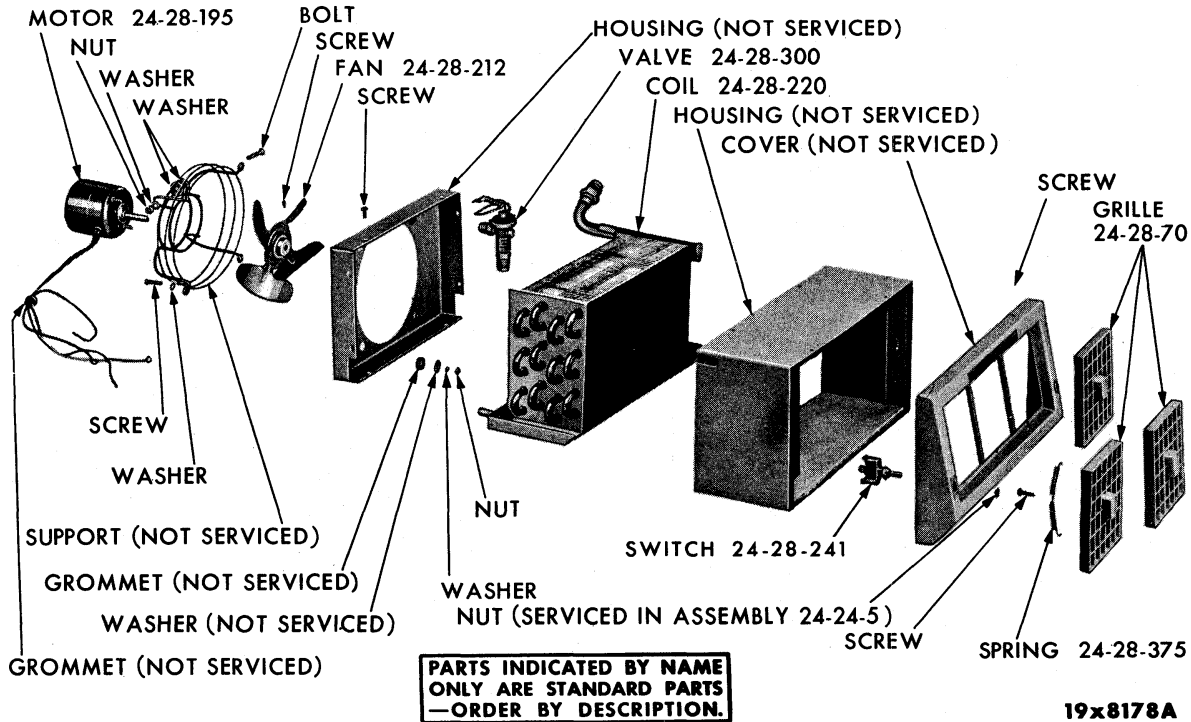
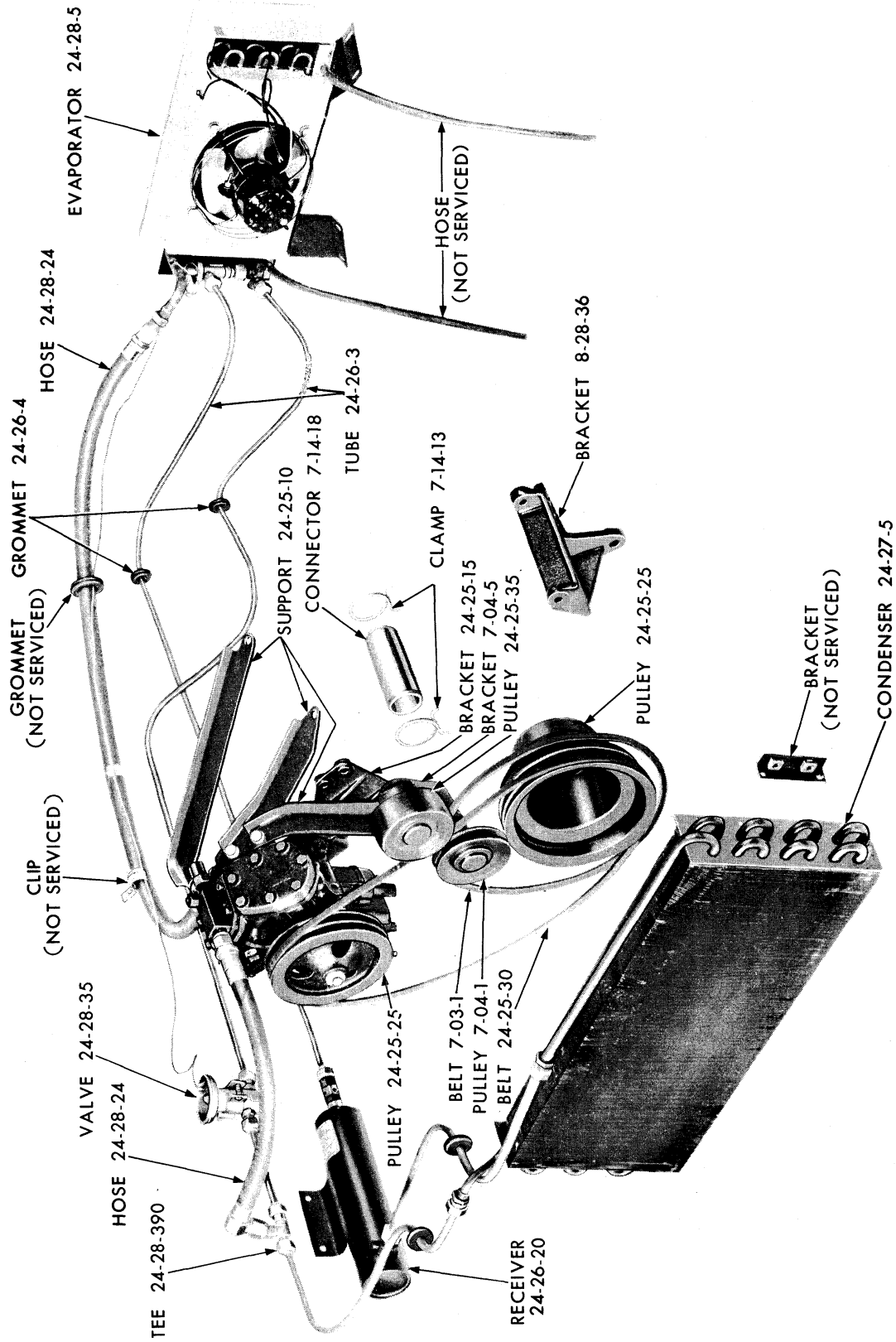

Plate 24-5

AIR CONDITIONING EVAPORATOR - MODEL A



19x8177

AIR CONDITIONING SYSTEM - MODEL A

Plate 24-6

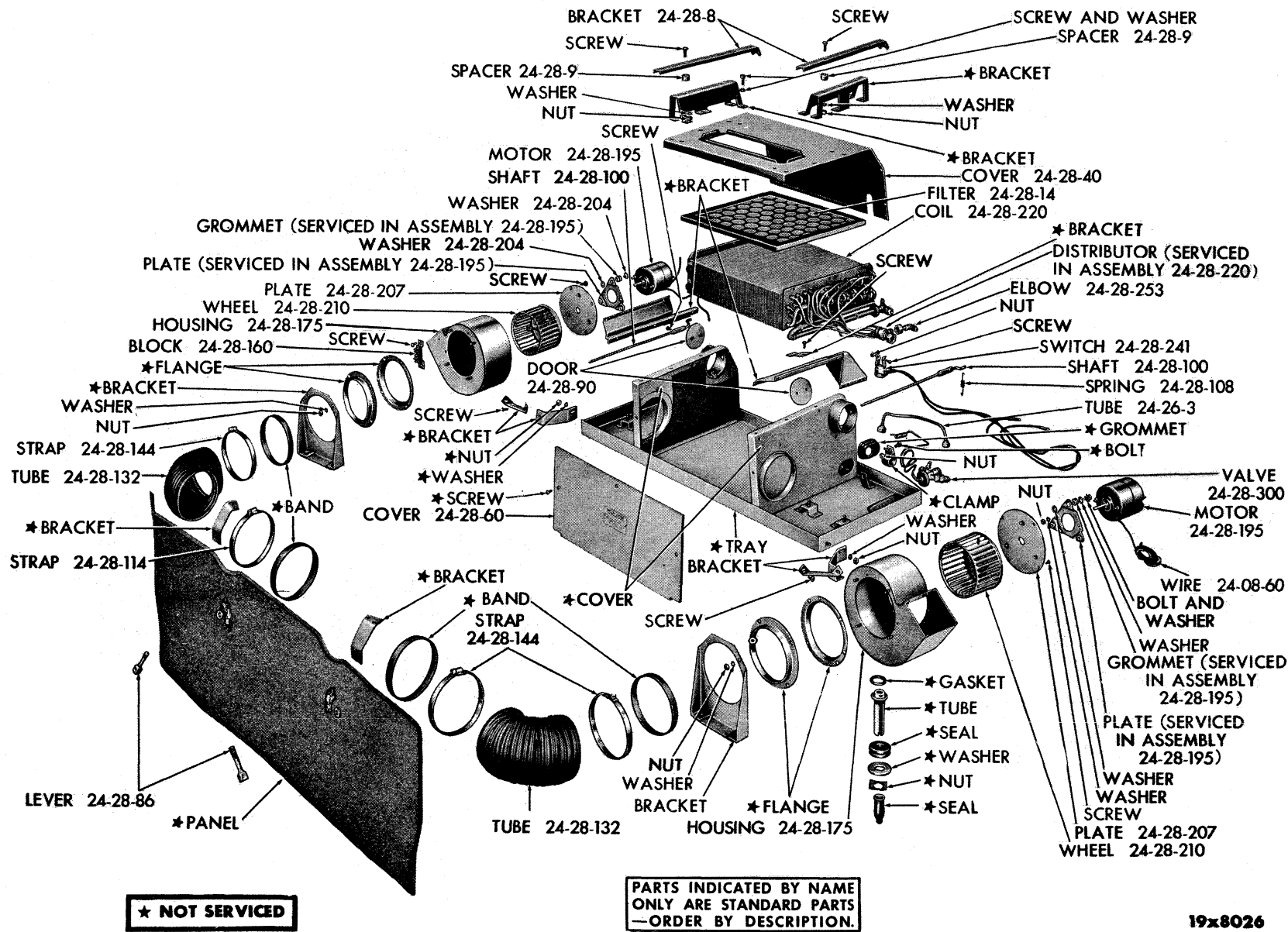

19x8026

Plate 24-7

AIR CONDITIONING UNIT - CROWN IMPERIAL C70

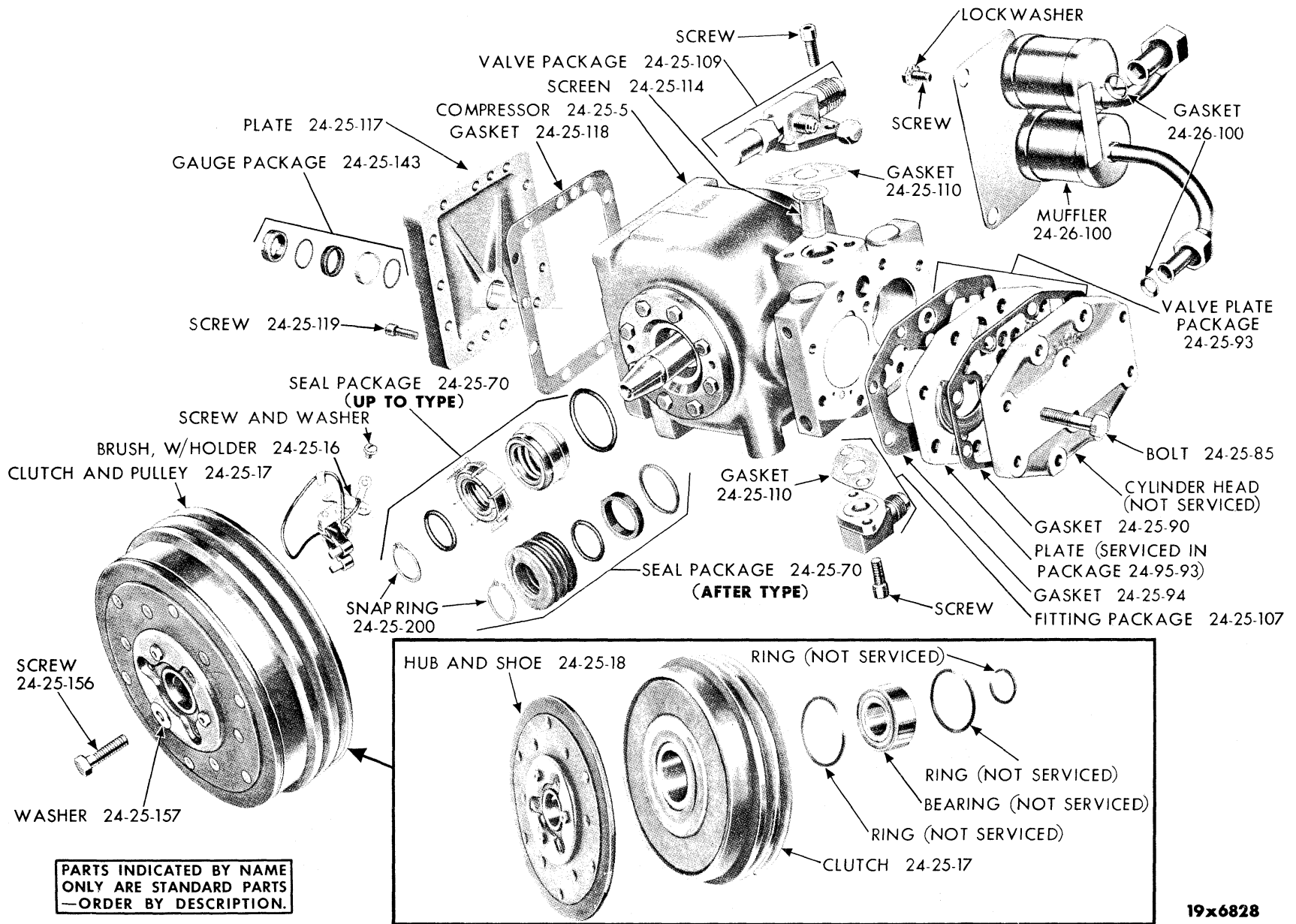

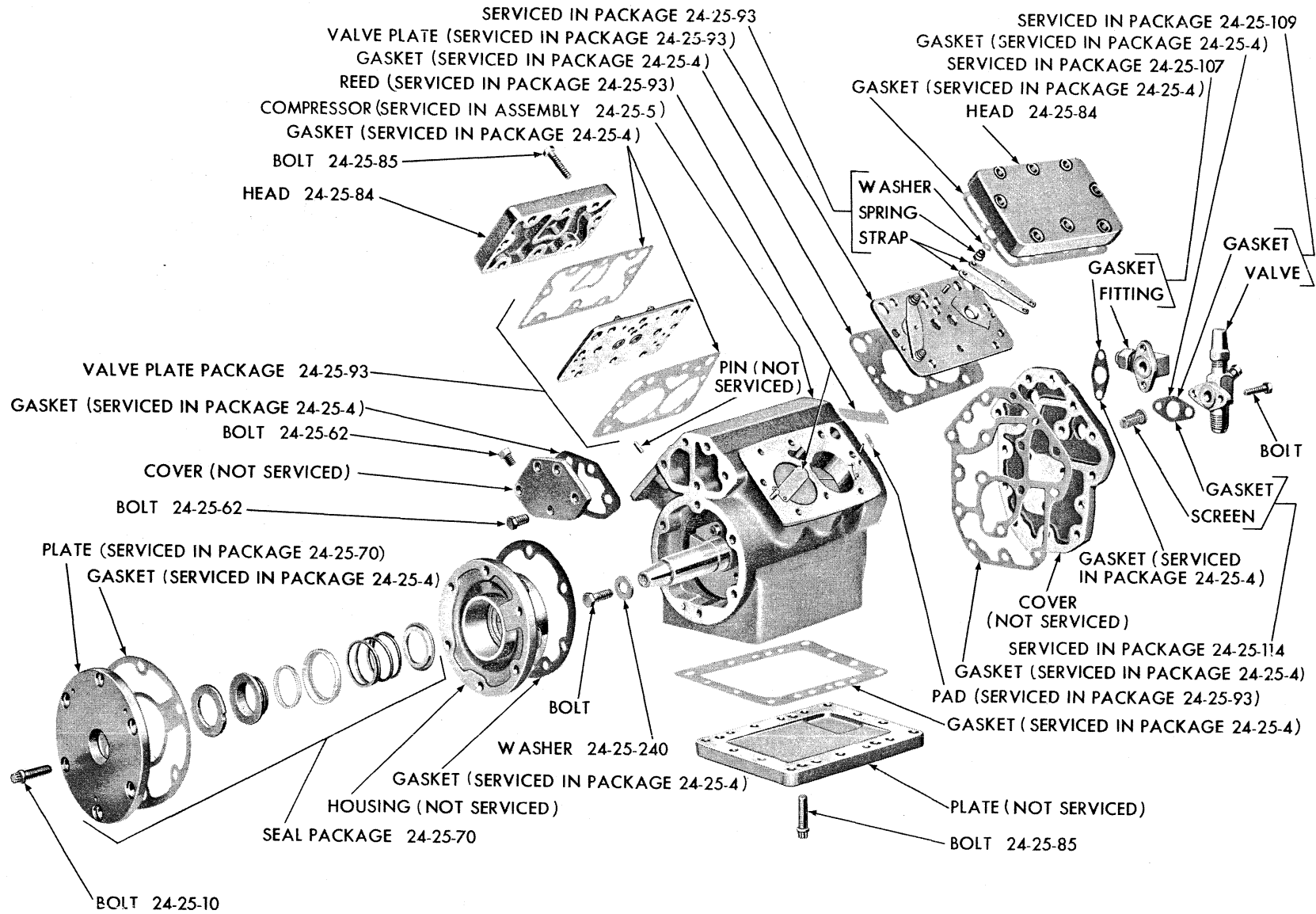

19x6892

Plate 24-9

AIR CONDITIONING COMPRESSOR - 1632 218

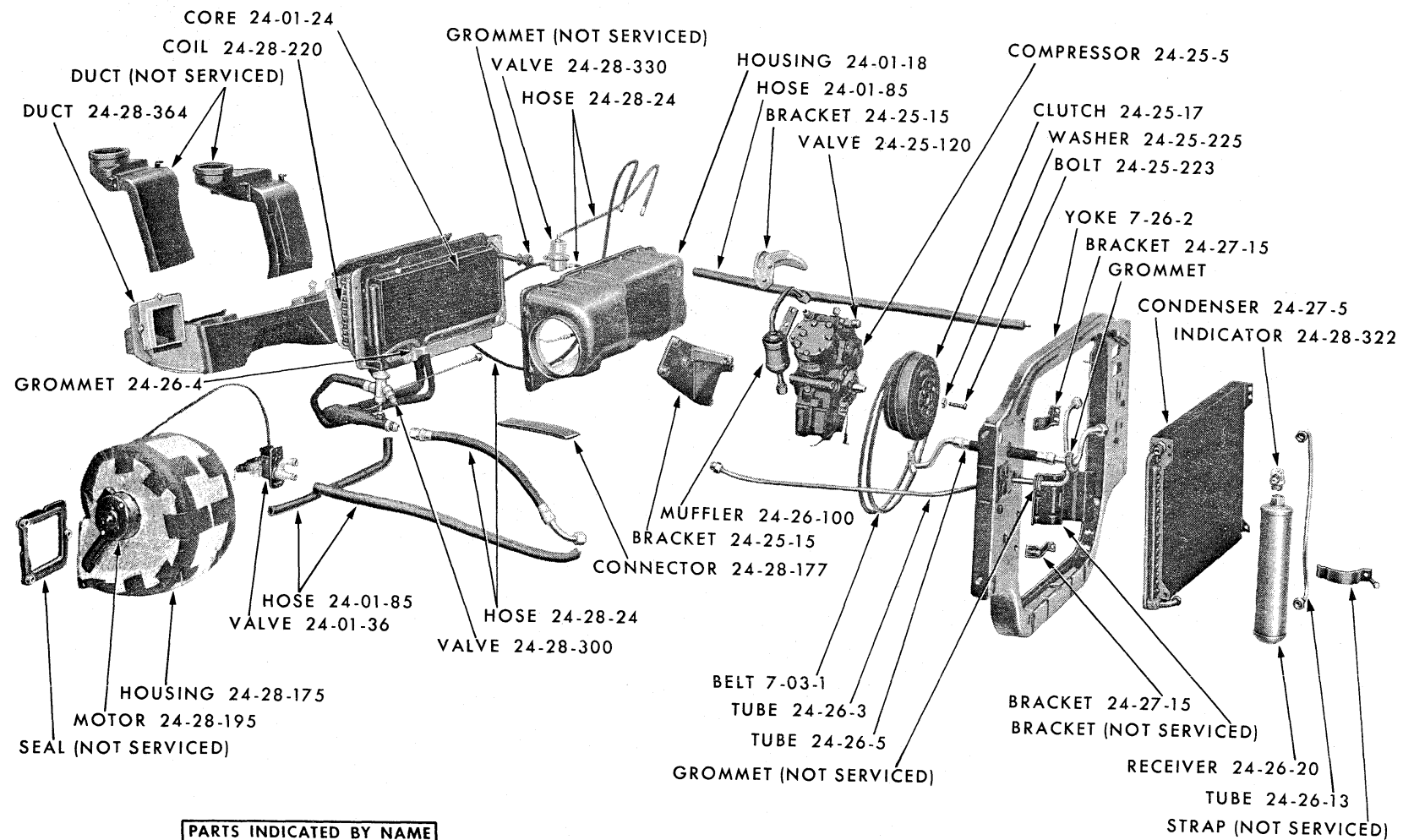

PARTS INDICATED BY NAME
ONLY ARE STANDARD PARTS
—ORDER BY DESCRIPTION.

19x8351

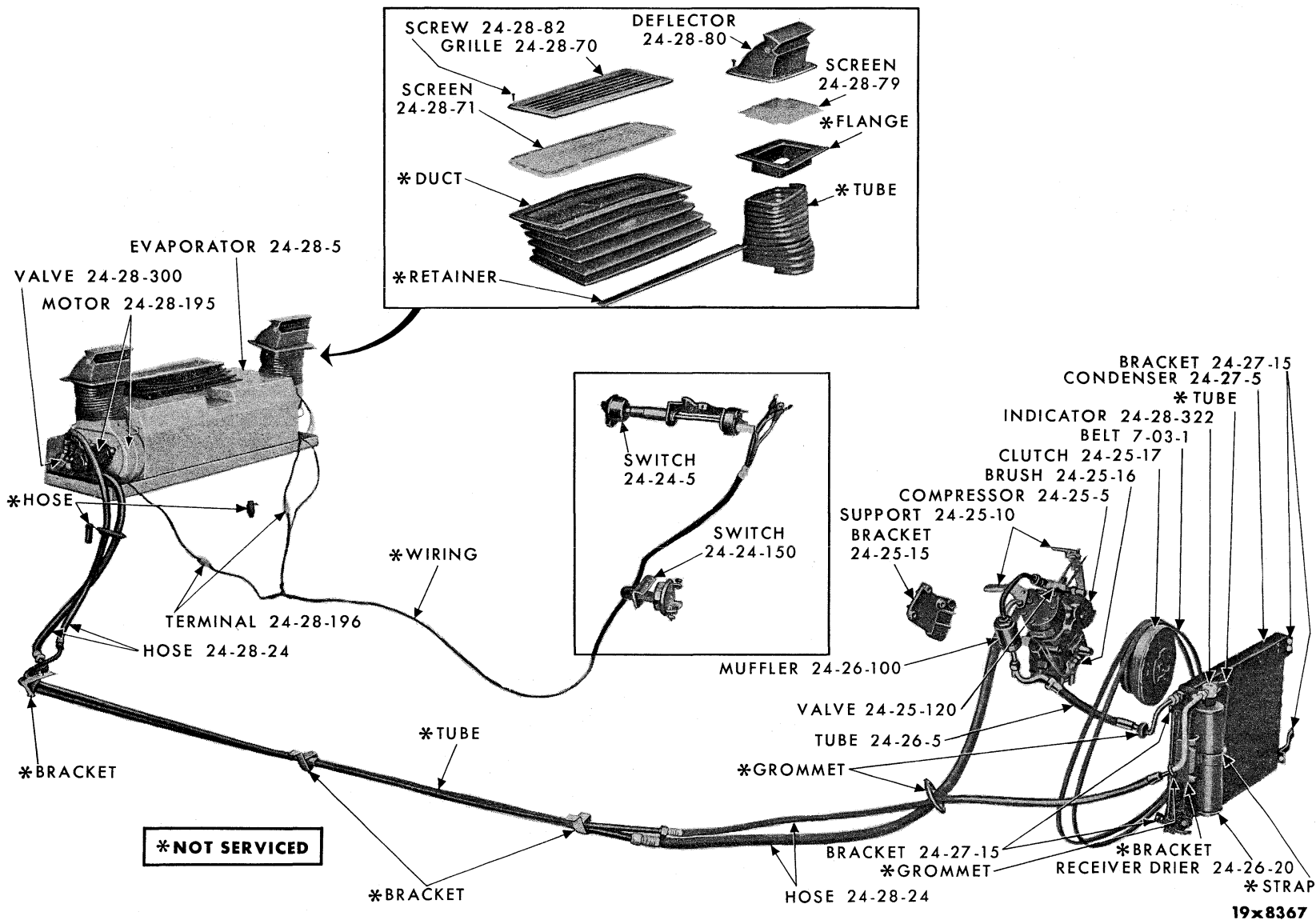
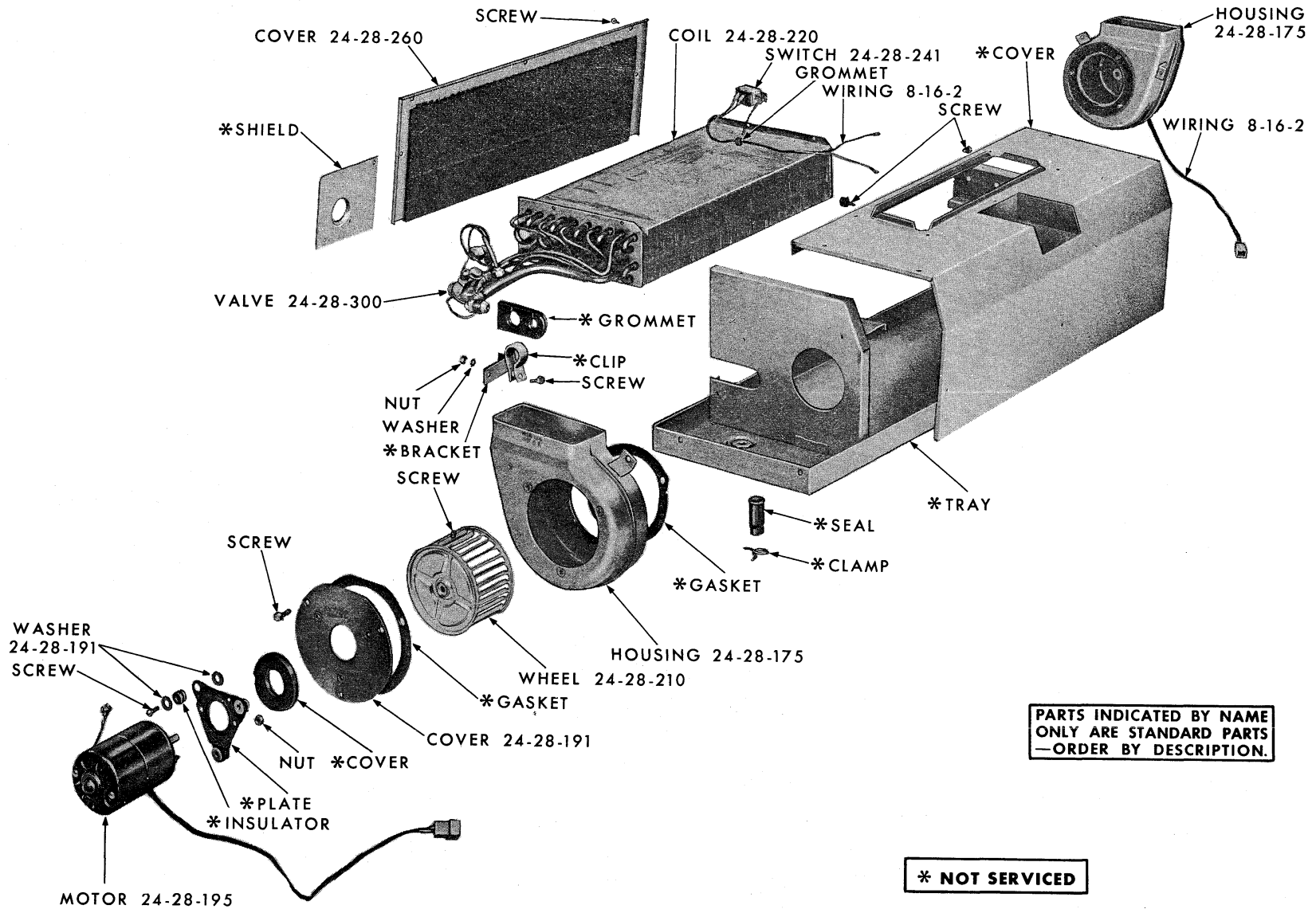

Plate 24-12

AIR CONDITIONING SYSTEM - REAR UNIT



19x8368

Plate 24-13

AIR CONDITIONING EVAPORATOR - REAR UNIT

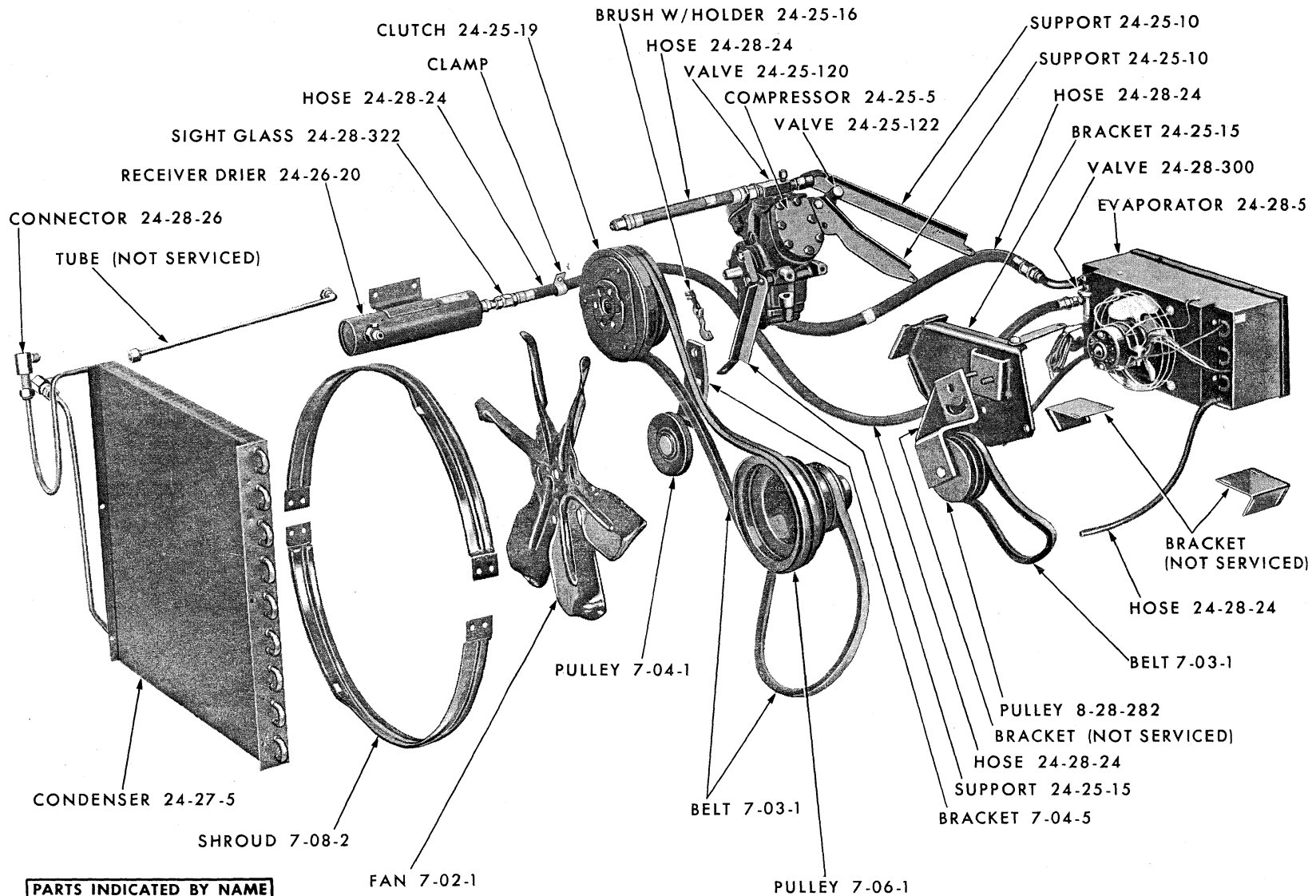

**PARTS INDICATED BY NAME
 ONLY ARE STANDARD PARTS
 —ORDER BY DESCRIPTION.**

19x8386

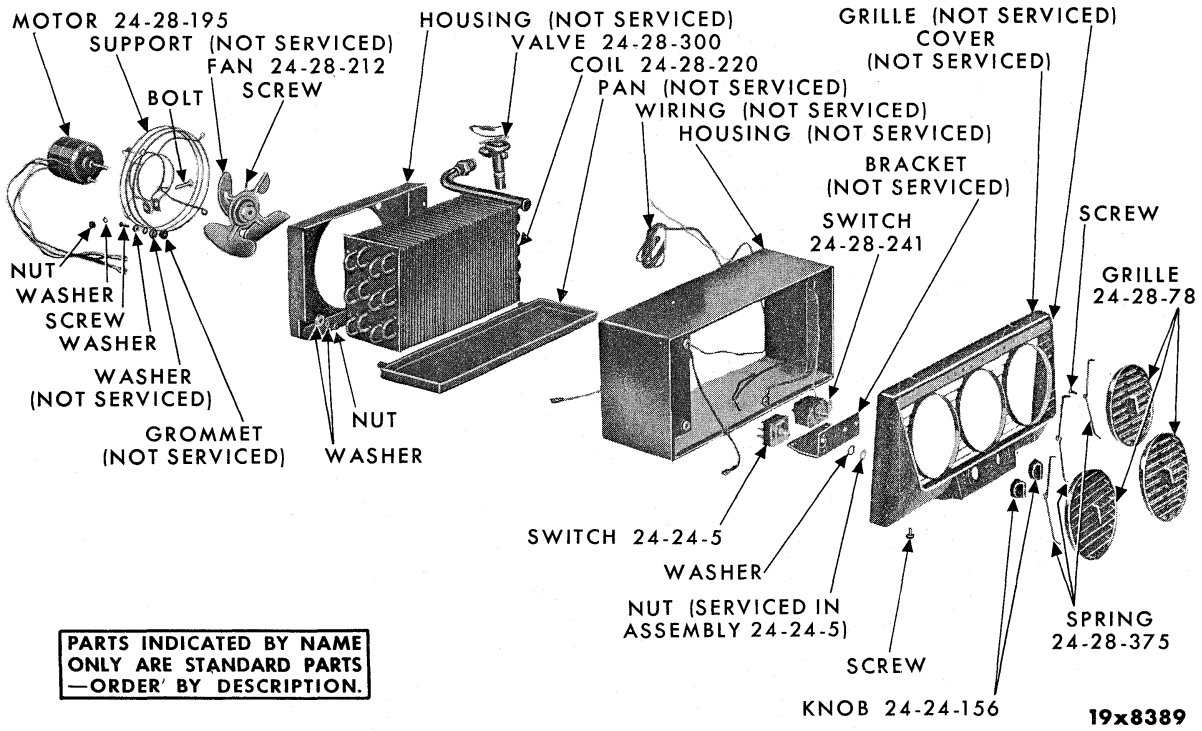
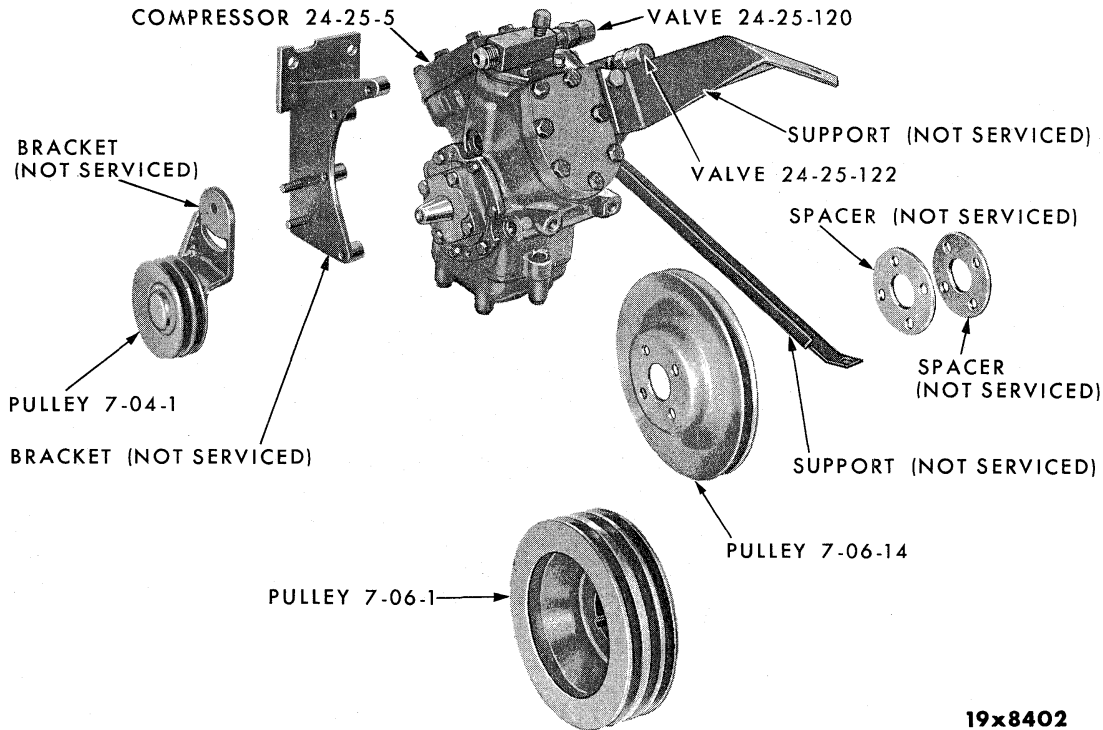
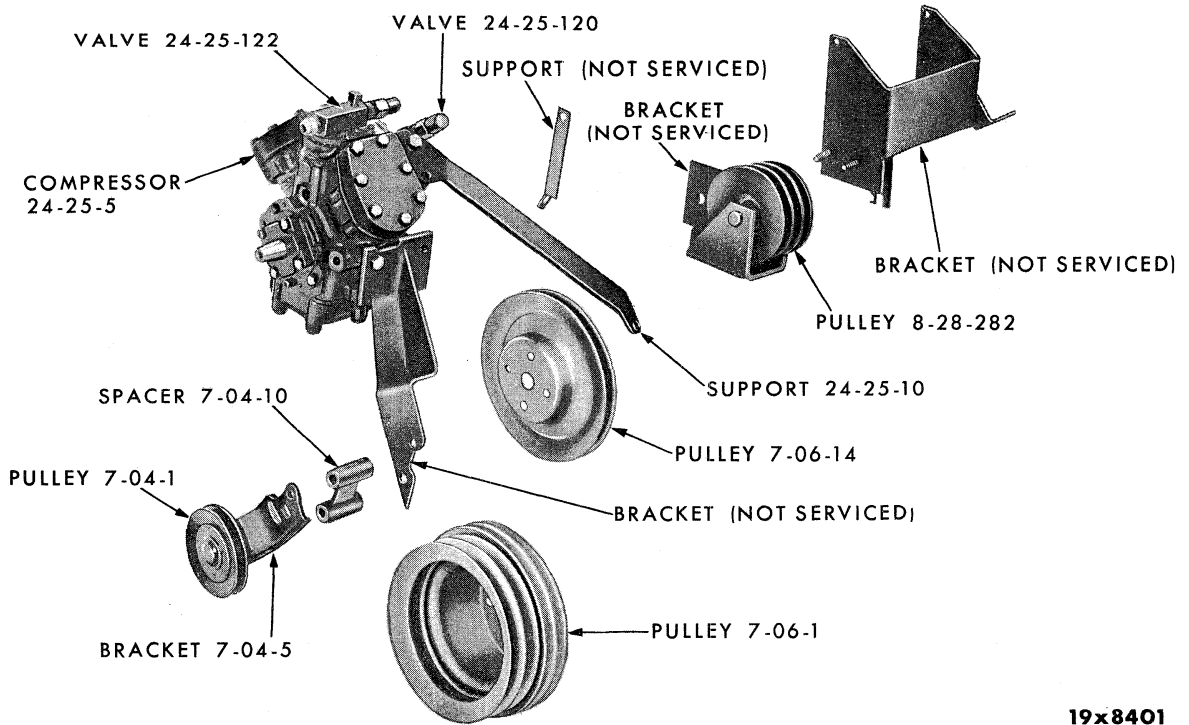

Plate 24-15

AIR CONDITIONING EVAPORATOR - MODEL C



AIR CONDITIONING COMPRESSOR, PULLEY AND BRACKETS - PLYMOUTH LP1-2, DODGE LD1-2-3



19x8401

AIR CONDITIONING COMPRESSOR, PULLEY, AND BRACKETS - PLYMOUTH LP2 FURY (WITH 350 CU. IN. ENGINE), DODGE LD2-D500, DESOTO LS1-2-3

Plate 24-17

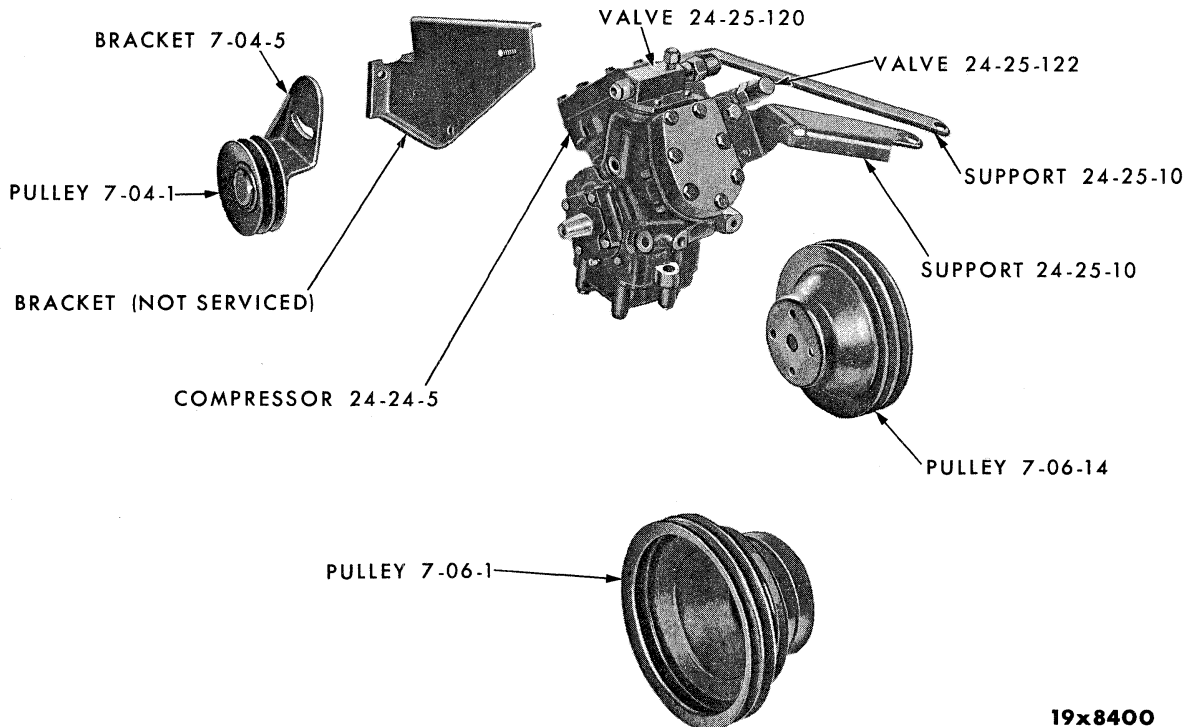

19x8400

AIR CONDITIONING COMPRESSOR, PULLEY AND BRACKETS - CHRYSLER LC1-2-3, IMPERIAL LY1

Plate 24-18

Printed in U.S.A.

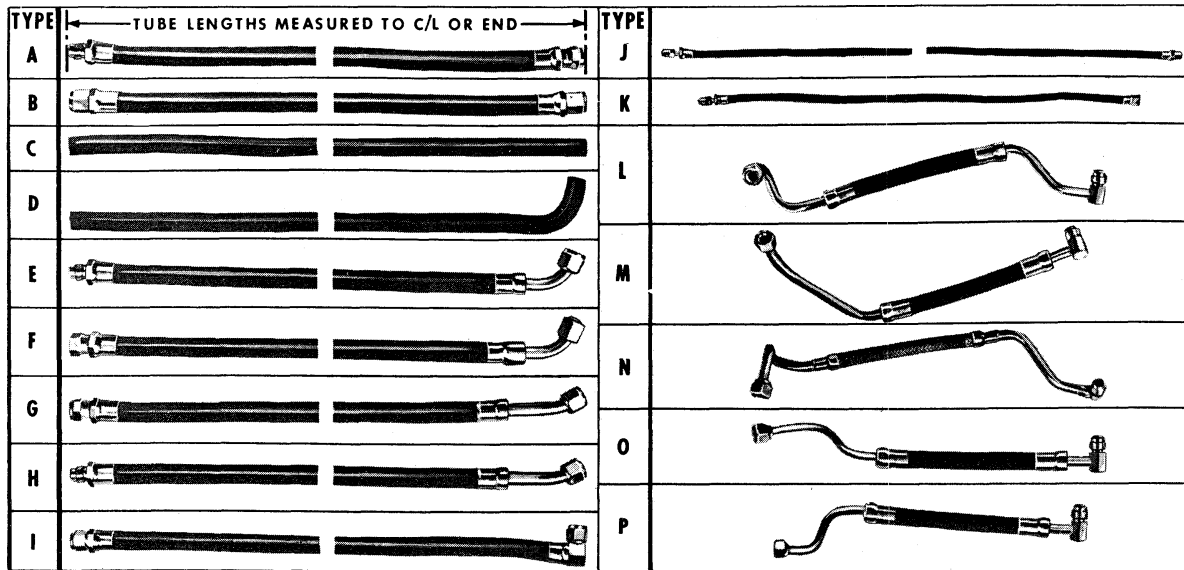

TYPE	PART NUMBER	LENGTH	HOSE OUTSIDE DIAMETER	THREAD DIAMETER	MODEL YEAR	LOCATION
A	1627 107	25"	3/4"	5/8"-18	1955-56	LIQUID REAR UNIT EVAPORATOR END
	1627 110	43"	1"	7/8"-14	1955	EVAPORATOR TO COMPRESSOR
	1658 029	38"	3/4"	5/8"-18	1956-58	LIQUID REAR UNIT EVAPORATOR AND FRT. TEE
	1658 031	36"	1"	7/8"-14	1955-58	SUCTION REAR UNIT EVAPORATOR, ALSO FRT. TEE
	1704 447	94"	1"	7/8"-14	195	EVAPORATOR TO COMPRESSOR - SUBURBANS
	1885 859	60"	1"	7/8"-14	1958	SUCTION HOSE EVAPORATOR END
	1885 860	68"	3/4"	5/8"-16	1958	EVAPORATOR TO COMPRESSOR, SUB.
B	1742 762	50"	1"	7/8"-14	195 -5	EVAPORATOR TO COMPRESSOR MODEL A, A-1 & C
	1744 403	54 3/4"	3/4"	7/8"-18	1957	EVAPORATOR TO RECEIVER DRIER MODEL A-1
	1748 269	10"	3/8"	1/2"	1958	COMPRESSOR TO CONDENSER, MODEL C
	1748 931	12"	3/8"	1/2"	1958	COMPRESSOR TO CONDENSER W/"B" ENG. MODEL C
	1819 007	27"	1"	7/8"-14	1958	EVAPORATOR TO COMPRESSOR MODEL A- & A-1
C	1064 541	AS REQ.	3/4"	—	1956-58	HEATER HOSE 3/8" I.D.
	1315 466	50'ROLL	15/16"	—	1956-58	HEATER HOSE 5/8" I.D.
	1841 062	32"	3/8"	—	1956-58	ACTUATOR TO ENGINE 3/16" I.D.
D	1595 160	12"	15/16"	—	1957-58	CONTROL VALVE TO HEATER
	1688 920	40"	15/16"	—	1957-58	CONTROL VALVE TO ENGINE
	1779 886	41"	15/16"	—	1957-58	CONTROL VALVE TO ENGINE
	1886 330		18"	15/16"	1958	VALVE TO HEATER
E	1686 056	51"	1"	7/8"-14	1958	EVAPORATOR TO COMPRESSOR
	1704 485	28"	1"	7/8"-14	1956	EVAPORATOR TO COMPRESSOR
	1885 786	21"	1"	7/8"-14	1958	COMPRESSOR TO CONDENSER
F	1819 811	28"	1"	7/8"-14	1957-58	EVAPORATOR TO COMPRESSOR
G	1819 008	29 5/8"	1"	7/8"-14	1957	EVAPORATOR TO COMPRESSOR
H	1688 902	18"	1"	7/8"-14	1956	EVAPORATOR TO COMPRESSOR
	1886 121	28"	1"	7/8"-14	1957-58	EVAPORATOR TO CONDENSER
I	1742 796	15 3/4"	1"	3/4"-16	1957	COMPRESSOR TO CONDENSER MODEL A- AND A-1
J	1819 541	33"	3/8"	3/8"-24	1957-58	ACTUATOR TO SOLENOID, ALSO TO ENGINE
	1841 867	20"	3/8"	3/8"-24	1957-58	SOLENOID TO ENG. AND ACTUATOR TO ENG.
	1842 649	35"	3/8"	3/8"-24	1958	ACTUATOR TO SOLENOID
	1842 650	16 1/2"	3/8"	3/8"-24	1958	ENGINE TO SOLENOID
K	1819 539	21"	3/8"	3/8"-24	1957-58	ACTUATOR TO ENG., ALSO ENG. TO SOLENOID
L	1841 118	16 5/8"	7/8"	3/4"-16	1957-58	COMPRESSOR TO CONDENSER
	1886 132	17 3/4"	3/4"	3/4"-16	1958	COMPRESSOR TO CONDENSER
M	1841 117	17 3/4"	7/8"	3/4"-16	1957-58	COMPRESSOR TO CONDENSER
	1841 120	14 1/2"	7/8"	3/4"-16	1957-58	COMPRESSOR TO CONDENSER P31, LP2
	1885 910	14 1/2"	7/8"	3/4"-16	1958	COMPRESSOR TO CONDENSER LCI
	1886 331	17 3/4"	7/8"	3/4"-16	1958	COMPRESSOR TO CONDENSER
N	1841 119	15 1/2"	7/8"	3/4"-16	1957-58	COMPRESSOR TO CONDENSER
O	1885 801	15 7/8"	1"	3/4"-16	1958	COMPRESSOR TO CONDENSER
P	1885 895	13 7/8"	1"	3/4"-16	1958	COMPRESSOR TO CONDENSER

19x8384A

CODE	REMARKS	PER CAR	PLYMOUTH	DODGE	DESOTO	CHRYSLER AND IMPERIAL
24-01-0 AIR CONDITIONING						
24-01-1	PACKAGE, Air Conditioning					
1957	Model A-1	1	1841 402	1841 402	1841 402	1841 402
	Conversion Model-A to Model A-1	1	1879 297	1879 297	1879 297	1879 297
1958	Rear Unit Common except LY1 and Sub. Note 2	1	*1886 150	*1886 150	*1886 150	*1886 150
1958-58	Model C Cool Aire	1	⊖1886 810	⊖1886 810	⊖1886 810	⊖1886 810
1958	LY1, Rear Unit Complete Package Note 2	1	----	----	----	⊖1886 155
1958	Rear Unit Complete except LY1 and Sub. Note 3	1	⊖1887 107	⊖1887 107	⊖1887 107	⊖1887 107
1958	Rear Unit Complete LY1 Note 3	1	----	----	----	⊖1887 116
24-01-5	SUPPLEMENTARY PACKAGE					
1958	Rear Unit except LY1 and Sub. Note 2	1	*1886 151	⊖1886 152	⊖1886 153	⊖1886 154
1957-58	Adapter Model C except B Eng. P31, LP2, LD	1	⊖1886 525	⊖1886 525	----	----
1957-58	Model C D66, D67, D70, S27, LD2	1	⊖1886 811	⊖1886 812	⊖1886 812	----
1957-58	Model C C75-1, LC1	1	----	----	----	⊖1886 814
1957-58	Model C except C75-1 and LC1	1	----	----	----	⊖1886 813
1958	Model C LP1, LD1	1	⊖1886 525	----	----	----
1958	Model C LP2 w/B Eng. LD3, LS1	1	⊖1886 523	⊖1886 523	⊖1886 523	----
1958	Model C LS2, LS3	1	----	----	⊖1886 524	----
1958	Adapter Rear Unit w/A Eng. Note 3	1	⊖1887 108	----	----	----
1958	Rear Unit w/B Eng. Note 3	1	⊖1887 109	----	----	----
1958	Rear Unit LD2, LS1, LC1, Note 3	1	----	⊖1887 110	⊖1887 112	⊖1887 114
1958	Rear Unit LD3, Note 3	1	----	⊖1887 111	----	----
1958	Rear Unit LS2, LS3, LC2, LC3, Note 3	1	----	----	⊖1887 113	⊖1887 115
24-01-8	CLAMP, Temperature Control Valve Cable	1	1770 371	1770 371	1770 371	1770 371
24-01-18	HOUSING, Evaporator and Heater Core, Eng. Side					
1957-58	Note 1	1	*1753 142	*1753 142	*1753 142	*1753 142
1958	Model 901	1	1841 984	1841 984	1841 984	1841 984
1958	Model 902	1	1886 028	1886 028	1886 028	1886 028
24-01-24	CORE, Heater					
1957-58	Note 1	1	1689 656	1689 656	1689 656	1689 656
1958	Model 901	1	1842 409	1842 409	1842 409	1842 409
1958	Model 902	1	1886 037	1886 037	1886 037	1886 037
24-01-26	SEAL, Heater Core Tube					
1957	Round 3/8" thick 9/16" Hole Dia.	1	*1604 116	*1604 116	*1604 116	*1604 116
1957-58	2" long 3/4" thick 3/4" Hole Dia.	1	*1838 035	*1838 035	*1838 035	*1838 035
24-01-28	CLAMP, Heater Hose					
1957-58		6	870 469	870 469	870 469	870 469
24-01-29	ELBOW, Heater Hose					
1957-58	S27, LS1	1	*1779 259	*1779 861	*1779 861	*1838 024
1958	LD2, Return Sub.	1	----	*1605 496	----	----
1958	Inlet, LS2, LS3	1	----	----	*1838 177	----
24-01-33	RETAINER, Outlet Door Frame, Note 1	2	1689 670	1689 670	1689 670	1689 670
24-01-36	VALVE, Temperature Control					
1957-58	Note 1	1	1819 515	1819 515	1819 515	1819 515
1958	Model 901, 902	1	*1885 834	*1885 834	*1885 834	*1885 834
24-01-37	PLATE, Heater Control					
1957-58		1	----	----	1769 395	1769 395
24-01-39	GASKET, Temperature Control Valve					
1957-58		1	1641 674	1641 674	1641 674	1641 674
24-01-41	RETAINER, Temperature Control Valve Gasket					
1957-58		1	1819 514	1819 514	1819 514	1819 514
24-01-48	CLAMP, Control Cable					
1957-58	Front Unit	1	*1770 371	*1770 371	*1770 371	*1770 371
24-01-55	CONTROL, Defroster					
1957-58		1	----	*1838 021	----	----
24-01-56	RETAINER, Defroster Control Gear					
1957-58		1	----	*1605 236	----	----

NOTE 1: Used w/Model 900.

NOTE 2: Use with Factory Installed Front Unit, 3 Speed Motor.

NOTE 3: Used w/o Front Unit.

* Indicates use as required.

Numerals in parentheses () refer to notes.

Printed in U.S.A.

⊖ Indicates parts not listed in any previous parts book.

* Indicates change or addition.

Prices and specifications subject to change without notice.

1955-58 PASSENGER CAR PARTS LIST

CODE	REMARKS	PER CAR	PLYMOUTH	DODGE	DESOTO	CHRYSLER AND IMPERIAL
24-01-57	WASHER, Defroster Control Rack 1957-58	1	*1305 254	*1305 254	*1305 254	*1305 254
24-01-59	NUT, Defroster Control 1957-58	1	----	1439 758	----	----
24-01-60	KNOB, Heater and Defroster Switch 1957-58	1	1770 264	----	1779 184	----
24-01-65	CABLE, Heater Temperature Control 1957-58 except IM, LY1 IM, LY1	1 1	1779 758 ----	1779 758 ----	1779 758 ----	1779 758 1819 748
24-01-75	STUD, Heater Control Housing 1957-58 Note 3	☆	----	6010 020	6010 020	6010 020
24-01-87	NIPPLE, Heater Hose Return 1957-58 S27, LS1, 3" Long Return to Pump 2" lgh. Return to Pump Elbow Type 2 1/2" lgh. 1957-58 Heater Hose Inlet	1 1 1 1	*1779 257 ---- *1779 259 1779 258	*1779 257 ---- ---- 1779 258	*1779 257 ---- ---- 1779 258	---- 1779 258 ---- *1779 257
24-24-0 CONTROL						
24-24-5	SWITCH, Blower Motor 1955 Economy Unit 1956 Economy Unit 1955-56 Deluxe Unit 1955-56 C70 1955 1956 1957 Note 1 Blower Motor and Temperature Control 1956 Blower and Defroster Control 1957-58 except IM and LY1 1957-58 IM, LY1 1957 Note 2, Blower Motor 1957-58 Rear Unit, IM, LY1 1957-58 Rear Unit except IM, LY1 1958 Rear Unit 1958 Model C					
		1	1648 247	1648 247	1648 248	----
		1	1658 124	1658 124	1658 125	----
		1	----	1626 810	1626 811	----
		1	----	----	----	1648 635
		1	----	----	----	1626 810
		1	----	----	----	1688 560
		1	1743 625	1743 625	1743 625	1743 625
		1	----	1689 048	----	1689 048
		1	*1779 024	*1704 360	*1819 829	*1779 025
		1	----	----	----	1779 031
		1	1744 423	1744 423	1744 423	1744 423
		1	----	----	----	*1880 744
		1	*1880 747	*1880 747	*1880 747	*1880 747
		1	----	----	*1886 023	*1886 023
		1	⊠1746 733	⊠1746 733	⊠1746 733	⊠1746 733
24-24-6	BRACKET, Mounting 1955 1956 1957-58 Blower Motor Switch Rear Unit except Sub.					
		1	----	1641 748	----	----
		1	----	1688 948	----	----
		1	----	----	----	1769 515
24-24-7	HOLDER, Fuse 1958 Rear Unit	1	*1885 608	*1885 608	*1885 608	*1885 608
24-24-8	NUT, Blower Motor Switch 1955-58 1955-58 Rear Unit 1957-58 Blower and Defroster Control	1 1 1	6008 070 *1439 758 *6008 070	6008 070 *1439 758 *6008 070	6008 070 *1439 758 *6008 070	6008 070 *1439 758 *6008 070
24-24-10	VALVE, Eng. to Actuator 1958 LS1	1	*1851 302	*1851 302	*1851 302	----
24-24-15	PACKAGE, Temperature Control Resistor Insulator Replacement 1957-58	1	1843 412	1843 412	1843 412	1843 412
24-24-20	KNOB, Blower Motor Switch 1955-56 Economy Unit 1955-56 Deluxe Unit 1958 Front and Rear Unit 1958 Front and Rear Unit LY1 1958 Front Unit LY1 1957-58 Blower Motor Switch, except IM, LS1 Rear Unit 1957-58 IM, LY1 Rear Unit 1957-58 Front Unit IM, LY1	1 1 1 1 1 1 1 1 1	1648 981 ---- *1770 531 ---- ---- ---- *1770 531 ---- ---- ----	1648 981 ---- *1770 531 ---- ---- ---- *1769 739 ---- ---- ----	1648 981 ---- ---- ---- ---- ---- *1770 902 ---- ---- ----	---- 1622 762 ---- *1753 290 *1779 025 ---- *1704 425 *1753 849 *1753 290

NOTE 1: Used w/MoPar Model A.

NOTE 2: Used w/Mopar Model A-1.

NOTE 3: Used w/Model 900.

★ Indicates use as required.

Numerals in parentheses () refer to notes.

Printed in U.S.A.

⊠ Indicates parts not listed in any previous parts book.
Nov. 10, 1958 Supersedes Feb. 14, 1958.

Prices and specifications subject to change without notice.
* Indicates change or addition.

CODE	REMARKS	PER CAR	PLYMOUTH	DODGE	DESOTO	CHRYSLER AND IMPERIAL
24-24-21	SPRING, Blower Motor Switch					
	1955	1	1648 012	1648 012	1648 012	---- --
	1956 except C70	1	1648 012	1648 012	1648 012	1648 012
	1958 Defroster Control except LS2, LS3	1	1819 370	1819 370	1819 370	1819 370
24-24-26	CONNECTOR, Wiring to Motor					
	1958	1	* 611 898	* 611 898	* 611 898	* 611 898
24-24-67	RESISTOR, Blower Motor					
	1955 Deluxe Unit except C70	1	1571 708	1571 708	1571 708	1571 708
	1955 C70	1	----	----	----	1571 709
	1956-58 Rear Unit 3 Speed Motor	1	*1571 709	1571 709	1571 709	1571 709
24-24-90	BEZEL, Blower Motor Switch, w/STUDS					
	1955 Deluxe Unit	1	*1648 973	----	1658 333	----
	1956 Economy Unit	1	*1648 973	----	1658 073	----
	1957-58 Bezel, Heater Control	1	1753 857	----	----	----
	1957 Escutcheon, Switch, Note 1	1	----	----	----	1658 336
	1957-58 Escutcheon, Air Direction Control	1	----	1770 455	----	----
	1958 LY1	1	----	----	----	*1769 699
24-24-92	STUD, Switch Bezel					
	1955-56	3	----	----	662 274	----
	1955-56 Escutcheon	2	----	----	----	6006 174
	1957 Control Mounting, Note 1	2	----	6010 020	*6010 020	----
	1958 Heater Control Bezel	2	946 932	----	----	----
24-24-105	CIRCUIT BREAKER, Deluxe Unit					
	1955 except C70	1	1689 022	1689 022	1689 022	1689 022
	1955-56 C70 8 Sed.	2	----	----	----	1566 038
	1955 Economy Unit	2	1540 427	1540 427	1540 427	----
	1956 Deluxe Unit, except C70	2	----	1540 427	1540 427	1540 427
	1956 Economy Unit	2	1642 477	1642 477	1540 427	----
24-24-107	BAR, Circuit Breaker					
	1955-56	1	1436 330	1436 330	1436 330	1436 330
24-24-108	BRACKET, Circuit Breaker Mounting					
	1955-56 Economy Unit	1	1479 060	1479 060	1479 060	----
24-24-109	SCREW, Circuit Breaker Mounting Bracket					
	1955-56 Economy Unit	2	1331 768	1331 768	1331 768	----
24-24-124	WIRING, Dual Control					
	1955	1	1658 914	----	----	----
	1955-56 C70 Limo. Front and Rear	1	----	----	----	1648 999
	1955-56 C70 8 Sed., IM, w/Front Controls	1	----	1658 914	1658 914	1648 996
	WIRING, Air Conditioning and Heater Motor Harness					
	1957 Note 1	1	1779 748	1779 748	1779 748	1779 748
24-24-125	CLIP, Temperature Control Cable Support					
	1957-58	1	----	*1819 335	*1819 335	*1819 335
	Control Cable LS2, LS3, AFTER Note 2					
	1957-58 Control Cable Support	1	*1302 783	*1302 783	*1302 783	*1302 783
	1958 Control Cable	1	1769 372	1769 372	1769 372	1769 372
24-24-126	CONNECTOR, Motor Wiring					
	1958 Rear Unit	2	* 611 898	* 611 898	* 611 898	* 611 898
24-24-130	RELAY, Selector Wiring					
	1955-56 C70	2	----	----	----	1538 314
24-24-135	SWITCH, Selector Toggle					
	1955-56 C70	1	----	----	----	1648 939
	1957-58 Control Selector, except IM, LY1	1	1770 194	1770 194	1770 194	1770 194
	1957-58 IM, LY1, Front Unit	1	----	----	----	*1770 193
	1958 Rear Unit w/Dual Unit Sub.	1	*1886 178	*1886 178	*1886 178	*1886 178
24-24-137	NUT, Selector Switch Mounting					
	1955-56 C70	1	----	----	----	1688 542
	1957-58	1	1770 195	1770 195	1770 195	1770 195
	1958 Rear Unit, Sub.	1	*1688 542	*1688 542	*1688 542	*1688 542
24-24-139	HOUSING, Heater Control					
	1957-58 except IM, LY1	1	1819 363	1770 500	1819 363	1819 363
24-24-140	BEZEL, Heater					
	1957-58 Temperature Control	1	*1753 857	----	*1769 395	----
	1957-58 except IM, LY1	1	----	----	----	1769 401
	1957-58 IM, LY1	1	----	----	----	1769 699

NOTE 1: Used w/Model 900.

NOTE 2: S27 Serial No. 58020039 LSI All.

* Indicates use as required.

Numerals in parentheses () refer to notes.

Printed in U.S.A.

□ Indicates parts not listed in any previous parts book.

Prices and specifications subject to change without notice.

* Indicates change or addition

1955-58 PASSENGER CAR PARTS LIST

AIR CONDITIONING

CODE	REMARKS	PER CAR	PLYMOUTH	DODGE	DESOTO	CHRYSLER AND IMPERIAL
24-24-141	TRIM PLATE, Control Housing					
	1957	1	1819 172	----	----	1769 403
	1957 C75, C76	1	----	----	----	1769 403
	1958 LC1, LC2, LC3	1	----	----	----	1841 155
24-24-142	STUD, Control Plate					
	1958 except LY1	★	----	6010 020	6010 020	6010 020
	1958 Control Bezel, Front Unit	2	* 946 932	----	----	----
24-24-143	SCREW, Control Moulding					
	1958	1	----	----	6000 160	----
24-24-145	WASHER, Thermostat Hole Plug					
	1958	1	*1689 700	*1689 700	*1689 700	*1689 700
24-24-150	SWITCH, Temperature Control					
	1955-56 Economy Unit	1	1648 938	1648 938	1648 938	----
	1955 Deluxe Unit	1	1648 263	1648 263	1648 264	1648 263
	1956 Deluxe Unit	1	----	1648 263	1648 264	1688 562
	1956 C70	1	----	----	----	1648 644
	1958 Single, w/o Cable	2	*1879 906	*1879 906	*1879 906	*1879 906
	1957 Double, w/CABLES	1	*1770 177	*1770 177	*1770 177	*1770 177
	1957 w/o Cable Front Unit	1	*1769 954	*1769 954	*1769 954	*1769 954
	Rear Unit	1	----	----	*1886 023	*1886 023
	1958 Rear Unit	1	⊖1886 178	⊖1886 178	⊖1886 178	⊖1886 178
	1958 Rear Unit w/Dual Unit LY1	1	----	----	----	⊖1880 744
	1958 Model C	1	⊖1748 083	⊖1748 083	⊖1708 083	⊖1748 083
24-24-152	NUT, Temperature Control Switch Mounting					
	1956	1	1648 985	1648 985	1648 985	----
24-24-153	ESCUTCHEON, Blower Motor Switch					
	1956 Economy Unit	1	1648 973	1648 973	----	----
24-24-154	BRACKET, Control to Distribution Duct					
	1958	1	----	1880 002	1880 002	----
	1958 to Dash	1	----	----	⊖1880 013	----
	1958 to Distribution Duct	1	----	----	⊖1880 013	----
24-24-156	KNOB, Temperature Control					
	1955-56	1	----	----	----	1622 765
	1957-58 except IM, LY1	1	----	1769 479	----	1769 479
	1957-58 Air Control except IM, LY1	1	----	----	----	1753 229
	1957-58 Air Control IM, LY1	1	----	----	----	1753 290
	1957-58 Toggle IM, LY1	1	----	----	----	1770 206
	1958 Air Direction Control, Front Unit	1	----	*1769 740	----	----
	1957-58 Model C	2	⊖1748 921	⊖1748 921	⊖1748 921	⊖1748 921
24-24-157	SPRING, Temperature Control Switch Knob					
	1956	1	----	----	----	1648 012
24-24-158	SCREW, Temperature Control Bracket					
	1958	1	----	*6000 160	----	----
24-24-159	CONTROL, Air Conditioning					
	1957-58 except IM, LY1 UP TO Note 3	1	*1842 206	*1842 204	*1842 206	*1842 204
	1957-58 IM, LY1	1	----	----	----	1842 205
24-24-160	KNOB, Control Lever					
	1957-58 IM, LY1	1	1770 297	----	*1770 902	1769 481

24-25-O COMPRESSOR

NOTE: For Compressor and Generator Drive Belt, See Part Type Code 7-03-1.

24-25-3	PISTON PACKAGE, Compressor Replacement, includes Connecting Rod, Bearing and Piston Ring					
	1957-58 Note 1	★	1818 922	1818 922	1818 922	1818 922
24-25-4	GASKET PACKAGE, Compressor Replacement					
	1956 Note 2	1	----	----	----	1631 611
24-25-5	COMPRESSOR					
	1955 Model No. HH-9977-1	1	1670 489	1670 489	1670 489	1670 489
	1956 2 Cylinder Square Type Model No. HH-9985-1	1	1639 712	1639 712	1639 712	1639 712

NOTE 1: w/V Type Compressor Model No. 3925, 3926, 1377829.

NOTE 2: w/V Type Compressor Model No. 4AO-400.

NOTE 3: LD2 Ser. No. 47113

LD3 24708 LSI, 13417

★ Indicates use as required.

Numerals in parentheses () refer to notes.

Printed in U.S.A.

Nov. 10, 1958 Supersedes Feb. 14, 1958.

Prices and specifications subject to change without notice.

* Indicates change or addition.

CODE	REMARKS	PER CAR	PLYMOUTH	DODGE	DESOTO	CHRYSLER AND IMPERIAL
1956	4 Cylinder V Type Model No. 4AO-400	1	----	----	----	1632 218
1956	Square Type Model No. HH-9991-1	1	1731 492	1731 492	1731 492	1731 492
1957	Square Type Model No. HH-9997-1	1	1737 848	1737 848	1737 848	1737 848
1957-58	V Type, Model No. 3925	1	1377 829	1377 829	1377 829	1377 829
1957-58	V Type, Model No. 3926	1	1851 761	1851 761	1851 761	1851 761
1957-58		1	*1859 133	*1859 133	*1859 133	*1859 133
24-25-8	LUBRICANT, Compressor					
1955-56	1 Quart Container	★	1450 769	1450 769	1450 769	1450 769
24-25-9	STRUT, Compressor					
1956	UP TO Note 3 Rear	1	1670 250	1639 771	1671 058	1670 591
1956	Rear Note 3	1	----	----	----	1730 497
1956	Front Note 3	1	----	----	----	1730 501
24-25-10	SUPPORT, Compressor					
1955	Front	1	1618 885	1618 885	----	1615 491
1955	Rear	1	1618 886	1618 886	----	1616 254
1955	except C68-300 Rear	1	----	----	1617 176	1615 490
1955	C68-300 Rear	1	----	----	----	1637 738
1956	Rear	1	1670 248	1639 767	----	----
1956	Bracket, Support	1	1670 242	1639 766	----	----
1957	Manifold to Compressor Head, Left					
	S27, Note 1	1	1738 414	*1738 393	*1738 393	*1738 366
	Right, S27, Note 1	1	1738 415	*1738 394	*1738 394	*1738 367
1957	Front, S27, Note 4	1	1738 368	1738 397	1738 397	----
	Rear, S27, Note 4	1	1738 369	1738 398	1738 398	----
1957	Front, S25, S26, Note 4	1	----	----	1738 382	----
1957	Rear, S25, S26, Note 4	1	----	----	1738 383	----
1957	Water Outlet Manifold to Compressor Head, Left, S27, Note 1	1	----	1738 392	1738 392	----
1957	Water Pump to Cylinder Head, Left, S25, S26, Note 1	1	1738 413	----	1738 379	----
1957	Manifold to Cylinder Head, Right, Note 1	1	----	----	1738 380	----
	Left, Note 1	1	----	----	1738 381	----
1957	Water Outlet to Compress Head, Note 1	1	----	----	----	1738 385
1956	except C71 Note 2 Front	1	----	----	----	1637 671
1956	C71 Note 2 Front	1	----	----	----	1637 672
1956	C71, Note 2 Rear	1	----	----	----	1670 597
1956	C70, C72, C73, Note 2 Rear	1	----	----	----	1671 014
1957	Front, Model A-1, S25, S26	1	----	----	1738 382	----
1957	Rear, Model A-1, S25, S26	1	----	----	1738 383	----
1957		1	----	----	*1738 379	----
	Compressor Head to Manifold, Right					
1957-58	LD2	1	*1738 415	*1738 394	----	*1738 387
1957-58	Left, LD2	1	*1738 414	*1738 393	----	*1738 386
1957-58	Compressor to Cylinder Block	1	----	----	----	1747 715
1958	Compressor Head to Water Pump LD2	1	1738 413	1738 392	----	----
1958	Compressor Head to Water Outlet	1	----	----	----	1738 385
1958	Compressor to Exhaust, Right Model C LS3, LY1	1	----	----	1981 815	1981 815
1958	Compressor to Block Lower Support w/B Eng.	1	1748 902	1748 902	1748 902	----

NOTE 1: w/V Type Compressor.

NOTE 2: With Square Type Compressor Model 19985-1.

NOTE 3: C70, C73, FROM Eng. No. CE56-7024 to CE56-9912, C71, FROM Eng. No. WE56-45817 to WE56-63609 also intermittently FROM WE56-75453 to WE56-76356 and FROM WE56-78931 to WE56-79611. C72 FROM Eng. No. NE56-24857 to WE-34300.

NOTE 4: w/Square Type Compressor Model No. HH-9997-1.

★ Indicates use as required.

Numerals in parentheses () refer to notes.

Printed in U.S.A.

⊠ Indicates parts not listed in any previous parts book.

Prices and specifications subject to change without notice.

* Indicates change or addition.

1955-58 PASSENGER CAR PARTS LIST

AIR CONDITIONING

CODE	REMARKS	PER CAR	PLYMOUTH	DODGE	DESOTO	CHRYSLER AND IMPERIAL
24-25-13	SPACER, Compressor Rear Bracket					
1955		1	----	----	1630 636	----
1957	Front Support, w/Power Steering, S25, S26, Note 3	1	----	----	1738 384	----
1957	Rear, S25, S26, Note 1	1	----	----	1735 752	----
24-25-14	STUD, Compressor Bracket to Water Pump Housing					
1956		2	----	842 295	----	842 295
24-15-15	BRACKET, Compressor Support					
1955		1	1618 884	1618 884	----	1615 492
1956		1	1639 949	1639 765	----	----
1955		1	----	----	1617 177	----
1955	Front	1	----	----	1617 173	----
1956	Rear	1	----	----	1671 075	----
1956	Front Inner	1	----	----	1671 076	----
1956	Rear Outer	1	----	----	1671 062	----
1956	Rear	1	----	----	----	1637 670
1956	Note 2	1	----	----	----	----
1957	D-500 Note 3	1	----	1821 395	1730 842	----
1957	D-500 Note 1	1	----	1821 396	----	----
	Compressor Mounting					
1957	C76, IM, Note 2	1	----	----	1733 481	----
1957-58	Note 1, except Model C	1	*1730 844	----	----	----
1957-58	Model C	1	⊖1747 764	----	----	----
1958	LP2-Fury, LD-500, LS Adventurer	1	1852 932	1852 932	1852 932	----
1957	S27 Note 1	1	----	1730 870	1730 870	----
1957	S25, S26, Note 1	1	----	----	1730 842	----
1957	S27 w/Square Type Compressor	1	----	⊖1730 873	⊖1730 873	----
1957	w/Square Type Compressor	1	⊖1733 504	----	----	----
1957-58	C75, LC2, Note 1	1	----	----	----	1733 454
1957-58	C76, LC3, LY1, IM, Note 1	1	----	----	----	1730 852
1958	LD2	1	----	1730 870	----	----
1958	LD3	1	----	1827 966	1827 966	----
1958	LC1	1	----	----	----	1827 879
	Compressor Steady, Side					
1958	LP2-Fury, LD-500, LS Adventurer	1	1855 441	1855 441	1855 441	----
	Compressor Steady, w/o Fuel Injection					
1958	LP2-Fury, LD-500, LS-Adventurer	1	1852 933	1852 933	1852 933	----
1958	LD3	1	----	*1851 748	*1851 748	----
1958	LC1, LY1	1	----	----	----	*1851 488
24-25-16	BRUSH HOLDER and BRACKET					
1955-56		1	1626 839	1626 839	1626 839	1626 839
1957	Single Male Terminal	1	*1769 495	*1769 495	*1769 495	*1769 495
1958	Single Female Terminal	1	*1880 049	----	*1880 049	*1880 049
1958	Double Female Terminal	1	----	*1885 454	----	----
24-25-17	CLUTCH PACKAGE, Compressor Drive, Includes PULLEY, BRUSH and Brush HOLDER					
1955	except C70 Deluxe	1	1604 981	1604 981	1604 981	1604 981
1955	C70	1	----	----	----	1622 578
1956	Deluxe Note 2	1	1622 578	1622 578	1622 578	1622 578
1956	Note 4	1	----	----	----	1658 651

NOTE 1: w/V Type Compressor.

NOTE 2: w/Square Type Compressor Model HH-19985-1.

NOTE 3: w/Square Type Compressor Model No. HH-9997-1.

NOTE 4: w/V Type Compressor Model No. HAO-400.

★ Indicates use as required.

Numerals in parentheses () refer to notes.

Printed in U.S.A.

⊖ Indicates parts not listed in any previous parts book.
Nov. 10, 1958 Supersedes Feb. 14, 1958.

Page 24-16

Prices and specifications subject to change without notice.
* Indicates change or addition.

CODE	REMARKS	PER CAR	PLYMOUTH	DODGE	DESOTO	CHRYSLER AND IMPERIAL
24-25-18	HUB, Compressor Drive 1955-56 includes Shoe	1	1626 835	1626 835	1626 835	1626 835
24-25-19	CLUTCH, Compressor Drive, Includes FIELD COIL and PULLEY 1955	1	1626 834	1626 834	1626 834	1626 834
	1956	1	*1658 707	1658 707	1658 707	*1658 707
	1957-58 UP TO Note 5	1	*1769 498	*1769 498	*1769 498	*1769 498
	1957-58 AFTER Note 5	1	----	*1886 328	*1886 328	*1886 328
24-25-20	PULLEY, Compressor 1955-56	1	*1674 789	*1674 789	*1674 789	*1674 789
	1956 w/HUB and BEARING	1	*1658 633	*1658 633	1658 633	1658 633
24-25-25	PULLEY, Compressor and Generator Drive 1955 Double Groove, 6 9/16" O.D.	1	1618 891	1618 891	----	----
	1956 Double Groove, 5 1/2" O.D.	1	1670 239	----	----	----
	1956 Double Groove, 6 9/16" O.D.	1	----	1618 891	----	----
	1956 Triple Groove, 6 3/4" O.D.	1	----	----	1634 461	1634 461
	1957 4 Groove, 7 1/8" O.D.	1	1732 893	----	----	----
	1957 4 Groove, 7 1/8" O.D., includes Hub S27	1	----	1735 922	1735 922	----
	1957 Note 4	1	*1743 275	*1743 275	*1743 275	*1743 275
	1957 4 Groove, 7 1/8" O.D., S25, S26	1	----	----	1732 887	1732 887
	1958 LD2	1	1852 584	1735 922	----	----
	1958 Fury, LD-500, LD3, LS Adventurer	1	*1851 253	*1851 253	*1851 253	----
	1958 LC1	1	----	----	----	*1827 875
	1958 LC2, LC3, LY1	1	----	----	----	*1732 887
24-25-35	PULLEY, Compressor Belt Idler 1957 Note 4	1	*1743 633	*1743 633	*1743 633	*1743 633
24-25-45	BRACKET, Compressor Idler Pulley 1957 Note 4	1	*1743 303	*1743 303	*1743 303	*1743 303
24-25-70	SEAL PACKAGE, Compressor Shaft 1955-56 UP TO Note 1	1	1670 561	1670 561	1670 561	1670 561
	1955-56 AFTER Note 1	1	1676 760	1676 760	1676 760	1676 760
	1956 Note 2	1	----	----	----	*1631 608
	1957-58 Note 2	1	*1734 836	*1734 836	*1734 836	*1734 836
	1957 Note 3	1	*1676 760	*1676 760	*1676 760	*1676 760
24-25-84	HEAD, Cylinder 1955-56 Note 2	2	----	----	----	*1631 565
24-25-85	SCREW, Cylinder Head 1955-56 Note 3	10	*1631 306	*1631 306	*1631 306	*1631 306
	1956 except IM, Note 2	14	----	----	----	*1631 603
	1956 except IM, Note 2	2	----	----	----	*1631 604
	1956 except IM, Bottom Plate, Note 2	16	----	----	----	*1631 605
	1957-58 Note 2	14	*1730 587	*1730 587	*1730 587	*1730 587
	1957 Note 3	10	*1631 306	*1631 306	*1631 306	*1631 306
24-25-88	SCREW, Cylinder Head Seal 1955-56	2	1631 307	1631 307	1631 307	1631 307
24-25-92	ADAPTER, Actuator Breather, on Eng. Front Unit	1	1838 120	1838 120	1838 120	1838 120
24-25-93	PLATE PACKAGE, Cylinder Head Valve 1955-56 Note 3	2	1631 269	1631 269	1631 269	1631 269
	1956 Note 2	1	----	----	----	1631 607
	1957-58 Note 2	★	1734 837	1734 837	1734 837	1734 837
	1957 Note 3	★	1631 269	1631 269	1631 269	1631 269

NOTE 1: Compressor Serial No. 72201.

NOTE 2: w/V Type Compressor.

NOTE 3: w/Square Type Compressor.

NOTE 4: Used w/MoPar Model A and A-1.

NOTE 5: LD2 approximate Ser. No. 33580, LD3 approximate 7715, LS1 approximate 9207, LS2 Ser. No. 10779, LS3 9249, LC1 Eng. No. 58W-11652, LC2 58S-8179, LC3 58N-9022, LY1 58C-8958, LC-300 58113-1405.

★ Indicates use as required.

Numerals in parentheses () refer to notes.

Printed in U.S.A.

☐ Indicates parts not listed in any previous parts book.

Prices and specifications subject to change without notice.

* Indicates change or addition.

1955-58 PASSENGER CAR PARTS LIST

AIR CONDITIONING

CODE	REMARKS	PER CAR	PLYMOUTH	DODGE	DESOTO	CHRYSLER AND IMPERIAL
24-25-94	GASKET, Valve Plate					
	1955-56	1	1631 297	1631 297	1631 297	1631 297
	1957-58 to Crankcase, Note 1	2	1378 313	1378 313	1378 313	1378 313
	1957 Note 2	1	1631 297	1631 297	1631 297	1631 297
	1957-58 to Cylinder Head, Note 1	2	1377 904	1377 904	1377 904	1377 904
	1955-57 Note 2	1	*1631 296	*1631 296	*1631 296	*1631 296
24-25-95	PLATE, Compressor Valve					
	1957-58 Note 1	2	1730 580	1730 580	1730 580	1730 580
24-25-107	FITTING PACKAGE, Discharge					
	1955-56 Note 2	1	1631 272	1631 272	1631 272	1631 272
	1956 Note 1	1	----	----	----	1631 609
24-25-108	VALVE PACKAGE, Compressor Discharge					
	1957 Note 2	1	1676 762	1676 762	1676 762	1676 762
24-25-109	VALVE PACKAGE, Shut-Off					
	1955-56 Note 2	1	1631 273	1631 273	1631 273	1631 273
	1956 Note 1	1	----	----	----	1631 610
	1957 Note 2	1	1676 761	1676 761	1676 761	1676 761
24-25-110	GASKET, Discharge Suction Valve					
	1955-57 Note 2	2	1631 294	1631 294	1631 294	1631 294
	1957-58 Discharge Valve, Note 1	1	1731 531	1731 531	1731 531	1731 531
	GASKET, Suction Service Valve					
	1957-58	1	1378 081	1378 081	1378 081	1378 081
24-25-111	SCREW, Suction Shut-Off Valve					
	1955-57 Note 2	4	1631 305	1631 305	1631 305	1631 305
	1957 Shut-Off Valve	12	1631 305	1631 305	1631 305	1631 305
24-25-112	LEAF, Suction Valve					
	1955-57 Note 2	2	1631 281	1631 281	1631 281	1631 281
24-25-113	PIN, Suction Valve					
	1955-56	4	1631 282	1631 282	1631 282	1631 282
24-25-114	SCREEN, Suction					
	1955-57 Note 2	1	1631 284	1631 284	1631 284	1631 284
	1957-58 Note 1	1	1378 244	1378 244	1378 244	1378 244
	SCREEN PACKAGE, Suction Strainer					
	1956 Note 1	1	----	----	----	1631 612
24-25-115	GASKET, Suction Screen Recess					
	1955-56	1	1631 299	1631 299	1631 299	1631 299
	1957-58 Note 1	1	1378 245	1378 245	1378 245	1378 245
	1957 Note 2	1	1676 739	1676 739	1676 739	1676 739
24-25-117	PLATE, Bottom					
	1955-56	1	1631 286	1631 286	1631 286	1631 286
24-25-118	GASKET, Bottom Plate					
	1955-57 Note 2	1	1631 298	1631 298	1631 298	1631 298
24-25-119	SCREW, Bottom Plate					
	1955-56	16	1631 305	1631 305	1631 305	1631 305
24-25-120	VALVE, Compressor Service Discharge					
	1957-58 Note 1	1	1731 521	1731 521	1731 521	1731 521
	1957 Note 3	1	1743 634	1743 634	1743 634	1743 634
24-25-121	SCREW, Compressor Discharge Valve					
	1957-58 Note 1	4	1731 625	1731 625	1731 625	1731 625
24-25-122	VALVE, Service Suction					
	1957-58 Note 1	1	*1855 557	1739 361	1739 361	1739 361
	1957-58 Model C	1	1855 557	*1855 557	*1855 557	*1855 557
24-25-124	SCREW, Suction Service Valve					
	1957-58 Note 1	2	1732 788	1732 788	1732 788	1732 788
24-25-130	VALVE, Oil Check					
	1955-56	Export	1	1631 289	1631 289	1631 289
24-25-136	OIL SLINGER					
	1955-56	Export	1	1631 283	1631 283	1631 283

NOTE 1: w/V Type Compressor.

NOTE 2: w/Square Type Compressor.

NOTE 3: Used w/Model A and A-1 and Model C.

★ Indicates use as required.

Numerals in parentheses () refer to notes.

Printed in U.S.A.

☐ Indicates parts not listed in any previous parts book.
Nov. 10, 1958 Supersedes Feb. 14, 1958.

Page 24-18

Prices and specifications subject to change without notice.
* Indicates change or addition.

CODE	REMARKS	PER CAR	PLYMOUTH	DODGE	DESOTO	CHRYSLER AND IMPERIAL
24-25-139	PLUG, Oil Filler 1955-56 Note 2	1	1631 288	1631 288	1631 288	1631 288
	1956 Note 4	1	-----	-----	-----	1631 560
	1957 Note 2	1	1676 668	1676 668	1676 668	1676 668
24-25-143	GAUGE PACKAGE, Compressor Oil Sight 1955-56	1	1631 271	1631 271	1631 271	1631 271
24-25-146	GASKET, Oil Sight Gauge Glass 1955-56	1	1631 300	1631 300	1631 300	1631 300
24-25-148	INDICATOR, Oil Level 1956	1	1670 368	-----	-----	-----
24-25-149	TUBE, Oil Level Indicator 1956 Economy Unit	1	1670 369	-----	-----	-----
24-25-150	CLIP, Oil Level Indicator Tube 1956	1	1670 370	-----	-----	-----
24-25-152	KEY, Crankshaft 1955-57 Note 2	1	1631 310	1631 310	1631 310	1631 310
24-25-155	CRANKSHAFT 1955-56	Export	1	1631 274	1631 274	1631 274
24-25-156	SCREW, Magnetic Clutch Lock 1955-56	1	1632 487	1632 487	1632 487	1632 487
	1957-58 Drive Clutch Mounting	1	1819 843	1819 843	1819 843	1819 843
24-25-157	WASHER, Crankshaft 1955-56	1	1630 224	1630 224	1630 224	1630 224
	Clutch Mounting 1957-58	1	*1648 240	*1648 140	*1648 240	*1648 240
24-25-159	PIN, Crankshaft Oil Hole 1957-58 Note 3	1	1377 866	1377 866	1377 866	1377 866
24-25-160	BEARING, Compressor Crank Shaft, Ball 1957-58	1	1854 829	1854 829	1854 829	1854 829
24-25-170	COUNTERWEIGHT 1955-56	Export	2	1631 279	1631 279	1631 279
24-25-173	SCREW, Counterweight 1955-56 Note 2	Export	2	1631 301	1631 301	1631 301
	1955-56 Note 2	Export	2	1631 302	1631 302	1631 302
	1956 Note 2	4	-----	-----	-----	1631 598
24-25-174	WASHER, Counterweight Screw Lock 1955-56	Export	4	1631 311	1631 311	1631 311
24-25-185	BEARING 1956 Front	Export Only	1	*1631 275	*1631 275	*1631 275
	1956 Rear	Export Only	1	*1631 276	*1631 276	*1631 276
24-25-188	HOUSING, Rear Bearing 1955-56	Export	1	1631 278	1631 278	1631 278
24-25-189	SEAL, Crankshaft Bearing Housing 1957-58 Note 3	1	1377 831	1377 831	1377 831	1377 831
24-25-190	GASKET, Front and Rear Bearing Housing 1955-56	Export	2	1631 295	1631 295	1631 295
	1957 Note 2	2	1676 738	1676 738	1676 738	1676 738
24-25-192	SEAL, 1957-58 Crankshaft Oil Seal Seat to Bearing Housing	1	*1577 832	*1377 832	*1377 832	*1377 832
24-25-193	SCREW, Front and Rear Bearing Housing Seal 1955-56 Note 2	4	1631 303	1631 303	1631 303	1631 303
	1957 Crankshaft Bearing, Note 3	5	1732 830	1732 830	1732 830	1732 830
24-25-196	SCREW, Bearing Housing and Seal Plate 1955-57 Note 3	8	1631 304	1631 304	1631 304	1631 304
24-25-200	RING, Front Bearing Seal Snap 1955-56 UP TO Note 1	1	1631 287	1631 287	1631 287	1631 287
	1955-56 AFTER Note 1	1	1631 477	1631 477	1631 477	1631 477
	1957 Note 2	1	1631 477	1631 477	1631 477	1631 477
24-25-210	SCREW, Crankshaft Bearing Housing, Socket Head 1957-58 Note 1	1	1733 998	1733 998	1733 998	1733 998
	1957 Crankshaft Bearing Housing	5	1732 830	1732 830	1732 830	1732 830

NOTE 1: C68 Eng. No. NE55-26661.

C69, C70 Eng. No. CE55-5796.

NOTE 2: Square Type Compressor

NOTE 3: V Type Compressor.

NOTE 4: w/V Type Compressor.

★ Indicates use as required.

Numerals in parentheses () refer to notes.

Printed in U.S.A.

☐ Indicates parts not listed in any previous parts book.

Prices and specifications subject to change without notice.

* Indicates change or addition.

Page 24-19

Nov. 10, 1958 Supersedes Feb. 14, 1958.

1955-58 PASSENGER CAR PARTS LIST

AIR CONDITIONING

CODE	REMARKS	PER CAR	PLYMOUTH	DODGE	DESOTO	CHRYSLER AND IMPERIAL
24-25-219	BEARING, Compressor Clutch 1956 Note 2	1	----	1704 497	1704 497	1704 497
24-25-228	SNAP RING, Clutch Bearing 1956	2	----	1658 636	1658 636	1658 636
24-25-232	COIL, Clutch Field 1956 Note 1	1	1658 647	1658 647	1658 647	1658 647
	1956 Note 2	1	----	----	----	1658 648
24-25-243	CONNECTOR, Oil Gauge Tube, Tee 1957-58	1	----	----	*1738 585	1738 585
24-25-249	PACKAGE, Relief Valve Ball Replacement 1957-58	1	1843 474	1843 474	1843 474	1843 474
24-25-251	SPRING, Oil Pump Pressure 1957-58 Note 2	1	1378 318	1378 318	1378 318	1378 318
24-25-252	SEAL, Oil Pump Cover 1957-58 Note 2	1	1377 551	1377 551	1377 551	1377 551
24-25-260	GASKET, Oil Sump 1957-58	1	1377 825	1377 825	1377 825	1377 825
24-25-261	SCREW, Oil Sump 1957 3" Long	2	*1738 336	*1738 336	*1738 336	*1738 336
	1957-58 2 1/4" long	4	1732 928	1732 928	1732 928	1732 928
	1958 1 5/8" Long	2	*1854 797	*1854 797	*1854 797	*1854 797
24-26-O REFRIGERANT TUBING AND RECEIVER TANK						
24-26-1	CLIP, Recirculating Door to Link 1958 Model-901	1	666 790	666 790	666 790	666 790
	1958 Fresh Damper Link Model-901	1	666 790	666 790	666 790	666 790
24-26-3	TUBE, Refrigerant, 25 Ft. Roll 1/4" Dia.	★	1556 710	1556 710	1556 710	1556 710
	Nut	★	151 311	151 311	151 311	151 311
	TUBE, 5/16" Dia.	★	1556 711	1556 711	1556 711	1556 711
	Nut	★	151 312	151 312	151 312	151 312
	TUBE, 3/8" Dia.	★	1638 010	1638 010	1638 010	1638 010
	Nut	★	151 313	151 313	151 313	151 313
	TUBE, 1/2" Dia.	★	1556 712	1556 712	1556 712	1556 712
	TUBE, 5/8" Dia.	★	1556 713	1556 713	1556 713	1556 713
	Nut	★	151 316	151 316	151 316	151 316
	TUBE, 13 ft. Roll 1957 3/8" O.D. Note 3	★	1743 642	1743 642	1743 642	1743 642
24-26-4	GROMMET, 3/8" Tube	★	1743 639	1743 639	1743 639	1743 639
	1957-58 Suction and Liquid Tube, w/GROOVE	1	1838 198	1838 198	1838 198	*1838 198
	1957-58 Outlet Tube	1	1838 035	1838 035	1838 035	1838 035
24-26-5	TUBE, Compressor to Condenser, Includes Vibration ELIMINATOR					
	1955-56 w/Tee Fitting, 41" lgh.	1	----	1571 327	1571 327	1571 327
	1955-56 w/o Tee Fitting, 28 1/2" lgh.	1	1753 358	----	----	----
	1955-56 w/o Tee Fitting, 31 1/4" lgh.	1	----	1642 094	1642 094	1642 094
	1956 w/o Tee Fitting, 34 1/2" lgh.	1	----	1753 355	----	----
	1956 w/o Tee Fitting, 40 1/4" lgh.	1	----	----	1753 357	1753 357
	1957 Note 1	1	1779 724	----	----	----
	1957 Note 1	1	----	1841 059	----	----
	TUBE, Compressor to Condenser 1957 except S27	1	1779 724	1841 059	1779 894	1841 118
	1957 S27	1	----	----	1841 059	----
	1958 LS3	1	1885 769	1885 769	1885 773	*1885 773
	TUBE, Compressor Muffler to Condenser, Includes Vibration ELIMINATOR					
	1957 w/V Type Compressor	1	----	----	----	*1819 318
24-26-13	TUBE, to Receiver Tank 1957-58 S27, LS1, LC1	1	*1779 723	*1779 723	*1779 723	*1779 723

NOTE 1: w/Square Type Compressor

NOTE 2: V Type Compressor

NOTE 3: Used with Model A and A-1.

★ Indicates use as required.

Numerals in parentheses () refer to notes.

Printed in U.S.A.

☐ Indicates parts not listed in any previous parts book.
Nov. 10, 1958 Supersedes Feb. 14, 1958.

Page 24-20

Prices and specifications subject to change without notice.
* Indicates change or addition.

CODE	REMARKS	PER CAR	PLYMOUTH	DODGE	DESOTO	CHRYSLER AND IMPERIAL
24-26-20	TANK, Receiver					
	1955-56	1	1648 415	1648 415	1648 415	1648 415
	1957-58 Note 4, 5 and 6	1	*1742 766	*1742 766	*1742 766	*1742 766
	1957-58 w/Upper and Lower Connector, Less Tubes	1	⊠1769 716	⊠1769 716	⊠1769 716	⊠1769 716
	1957-58 w/Inlet and Outlet Tubes w/Brass Safety Plug 1/8" Pipe Thd.	1	*1770 186	*1770 186	*1770 186	*1770 186
	1958 Package use w/Upper Connector w/Sight Glass	1	----	*1880 658	*1880 658	*1880 658
	PACKAGE, Receiver Drier includes Gasket					
	1958 Front Unit except LS1, LC1	1	----	----	1880 658	1880 658
24-26-21	STUD, w/CLIP, Receiver Tank Mounting					
	1955-56	2	6006 130	6006 130	6006 130	6006 130
	CLIP, Mounting					
	1957-58 Note 3	2	666 790	666 790	666 790	666 790
24-26-26	PLUG, Receiver Tank Safety					
	1957 Note 5 and 6	1	*1744 767	*1744 767	*1744 767	*1744 767
	1958 Brass Stamped 210	1	1540 439	1540 439	1540 439	1540 439
	1958 Steel Stamped 212	1	*1842 461	*1842 461	*1842 461	*1842 461
	1958 Fuse Brass Stamped 214	1	1842 423	1842 423	1842 423	1842 423
24-26-43	TUBE, Receiver Tank to Liquid Indicator					
	1957-58 S27, LS1, Note 3	1	1779 713	1779 713	1841 095	----
	1957-58 except S27, LS1, Note 3	1	----	----	1779 711	1779 711
	Receiver Drier to Evaporator					
	1958 LS2, LS3, LC2, LC3	1	----	----	⊠1842 739	⊠1842 739
	1958 LY1	1	----	----	----	⊠1842 740
24-26-54	ELIMINATOR, Suction Tube Vibration					
	1955	1	1527 390	1527 390	1527 390	1527 390
24-26-76	SCREW, Tube Mounting Clip					
	1955-56	1	----	6000 160	----	6000 160
24-26-90	CLIP, Evaporator Tube					
	1955-56 on Fender	1	----	1263 079	----	----
	1956 Compressor to Solenoid Tube	1	----	1263 079	----	----
24-26-100	MUFFLER, Compressor					
	1955	1	1622 524	1622 524	1622 524	1622 524
	MUFFLER, Suction					
	1956 Note 1	1	1670 487	1670 487	1670 487	1670 487
	1956 Condenser to Compressor Note 1	1	1670 488	1670 488	1670 488	1670 488
	1957-58 except LC1, use w/V Type Compressor AFTER Note 2	1	1838 140	1838 140	1838 140	1838 140
	UP TO Note 2	1	----	----	----	1819 374
	1958 LC1	1	----	----	----	⊠1842 429
	1958 w/350 cu. in. Eng. w/2 Barrel Carburetor LS3 except MC1	1	*1885 793	*1885 793	*1885 793	*1885 793
	1959 MC1	1	----	----	----	⊠1842 429
	1955-56 Gasket, Suction Tube	1	152 182	152 182	152 182	152 182
	1955-56 Gasket, Condenser Tube	1	152 181	152 181	152 181	152 181
24-27-O CONDENSER						
24-27-5	CONDENSER					
	1955-56	1	1624 100	1624 100	1624 100	1624 100
	1957-58 Note 3 LS1, LC1	1	*1686 540	*1686 250	*1686 250	*1686 250
	1957 Note 4	1	1743 629	1743 629	1743 629	1743 629
	1957 Note 5	1	1744 412	1744 412	1744 412	1744 412
	1958 LS2, LS3, LC2, LC3, LY1 Model 903	1	----	----	*1863 466	*1863 466
	1957-58 Model C	1	⊠1748 059	⊠1748 059	⊠1748 059	⊠1748 059

NOTE 1: Square Type Compressor.

NOTE 2: C75-1 Serial No. W57-18757
C76 Serial No. N57-10760

C75-2 Serial No. L57-10223
IM Serial No. C57-11436

NOTE 3: Used w/model 900-901-902

NOTE 4: Used w/model A

NOTE 5: Used with Model A-1

NOTE 6: Used w/Model C.

1955-58 PASSENGER CAR PARTS LIST

AIR CONDITIONING

CODE	REMARKS	PER CAR	PLYMOUTH	DODGE	DESOTO	CHRYSLER AND IMPERIAL
24-27-15	BRACKET, Condenser					
	1955-56 Upper	2	1599 923	1599 923	----	----
	1955-56 Lower	2	1599 911	1599 911	----	----
	1955-56	4	----	1599 923	1599 902	1599 902
	1957-58 Upper	2	1686 251	1686 251	1686 251	1686 251
	1957-58 Lower Right	1	1686 960	1686 960	1686 960	1686 960
	1957-58 Lower Left	1	1686 961	1686 961	1686 961	1686 961
24-28-0 EVAPORATOR UNIT						
24-28-3	COVER, Quarter Panel Hose and Wire					
	1958 Sub. Right	1	⊠1878 662	----	----	----
	1958 Sub. Left	1	⊠1878 663	----	----	----
24-28-5	UNIT, Evaporator					
	1956 except Sub. Economy	1	1689 091	1689 091	1689 091	----
	1956 except Sub. DeLuxe	1	----	1689 160	1689 160	1689 160
	1957 Note 4	1	1743 665	1743 665	1743 665	1743 665
	1957 Note 3	1	1744 694	1744 694	1744 694	1744 694
	1958 Rear Unit except Sub.	1	*1880 231	*1880 231	*1880 231	*1880 231
	1957-58 Model C	1	⊠1746 734	⊠1746 734	⊠1746 734	⊠1746 734
	1958 Sub.	1	*1886 232	*1886 232	*1886 232	*1886 232
24-28-6	SEAL, Evaporator Unit Mounting					
	1955-56 Economy Unit Hole Dia. 7/8"	2	1648 411	1648 411	1648 411	----
	1956 Hole Dia. 17/32"	3	*1401 575	1401 573	*1401 573	----
24-28-7	CLIP, Evaporator Mounting Bolt					
	1955-56	4	1626 586	1626 586	1626 586	1626 586
24-28-8	BRACKET, Evaporator Unit Mounting					
	1955-56 Deluxe Unit except C70 Right	1	----	1658 692	1658 692	1658 692
	1955-56 except C70 Left	1	----	1658 693	1658 693	1658 693
	1955-56 Economy Unit Support	2	1648 397	1648 397	1648 397	----
	1955-56 Deluxe Unit, C70 Limo.	2	----	----	----	1648 196
	1955-56 Deluxe Unit, to Shelf C70 Limo.	2	----	----	----	1648 197
	1955-56 Deluxe Unit, Support C70 Limo. Right	1	----	----	----	1648 193
	1955-56 C70 Limo. Left	1	----	----	----	1648 194
	1957-58 Note 1	2	1743 617	1743 617	1743 617	1743 617
24-28-9	SPACER, Evaporator Unit Support, Rear Unit					
	1955-56 Rear Unit	2	*1310 445	*1310 445	*1310 445	*1310 445
24-28-10	STUD, Shelf Panel Mounting Bracket					
	1955-56	2	----	897 230	897 230	897 230
24-28-12	BUMPER, Evaporator Unit					
	1955-56 except C70 Limo.	2	972 724	972 724	972 724	972 724
24-28-14	FILTER, Evaporator Unit Air					
	1955-56 Deluxe Unit except C70 Limo.	1	1570 824	1570 824	1570 824	1570 824
	1955-56 Economy Unit	1	1648 374	1648 374	1648 374	----
	1955-56 Deluxe Unit, C70 Limo.	1	----	----	----	1648 207
24-28-15	HOSE, Evaporator Drain 50 foot Roll					
	1956	★	1315 466	1315 466	1315 466	1315 466
	1957-58 Evaporator Coil Drain, Formed Model-900	1	1704 647	1704 647	1704 647	1704 647
24-28-19	GROMMET, Evaporator Drain Hose					
	1956 11/16" I.D.	1	1704 399	1704 399	1704 399	1704 399
	1956 15/16" I.D.	2	1704 398	1704 398	1704 398	1704 398
	1957-58 3/8" I.D.	1	*1744 666	*1744 666	*1744 666	*1744 666
	1958 Side Shield Tube	1	*1779 168	*1779 168	*1779 168	*1779 168
24-28-22	SCREW, Heater Blower Motor Mounting					
	Heater and Air Conditioning Housing Mounting	15	6015 014	6015 014	6015 014	6015 119
	1958 Blower to Dash Front Unit LS1	12	*6015 014	*6015 014	*6015 014	*6015 119
	1958 Model 901 LS2, LS3	3	6015 014	6015 014	6015 014	----
	1958 Model 902 LS2, LS3	3	----	----	1838 158	180 034
	1958 Model 902 LS2, LS3	3	----	----	1838 158	180 034
24-28-24	HOSE, Evaporator Unit Hot Gas					

For Air Conditioning Hose see Hose Chart in Front of Group 24

NOTE 1: Used with Model A and A-1

NOTE 2: Used with Model-900

NOTE 3: Used with Model A-1

NOTE 4: Used w/Model A and Model C

★ Indicates use as required.

Numerals in parentheses () refer to notes.

Printed in U.S.A.

⊠ Indicates parts not listed in any previous parts book.

Prices and specifications subject to change without notice.

Nov. 10, 1958 Supersedes Feb. 14, 1958.

Page 24-22

* Indicates change or addition.

CODE	REMARKS	PER CAR	PLYMOUTH	DODGE	DESOTO	CHRYSLER AND IMPERIAL
24-28-25	HOUSING, Evaporator 1955-56 Deluxe Unit, C70 Limo. 1955-56 Economy Unit	1 1	---- 1648 367	---- 1648 367	---- 1648 367	1648 159 ----
24-28-26	CONNECTOR, Condenser Tube 1957-58 Model C	2	1748 066	1748 066	1748 066	1748 066
24-28-31	GASKET, Heater Core Housing 1957 Model 900	1	1841 796	1841 796	1841 796	1841 796
24-28-34	DOOR, Recirculating 1958 includes Bracket	1	1753 116	1753 116	1853 116	1753 116
24-28-35	VALVE, By-Pass, Note 1	1	1743 287	1743 287	1743 287	1743 287
24-28-40	COVER, Evaporator Housing, Top 1955-56 Deluxe Unit, C70 Limo. 1955-56 Economy Unit	1 1	---- 1648 372	---- 1648 372	---- 1648 372	1648 165 ----
24-28-60	COVER, Evaporator Housing 1955-56 Deluxe Unit, except C70 Limo. Rear 1955-56 Deluxe Unit, C70 Limo. 1955-58 Rear Unit, except Sub.	1 1 1	---- ---- 1648 380	1622 276 ---- 1648 380	1622 276 ---- 1648 380	1622 276 1641 779 1648 380
24-28-61	NUT, Rear Top Cover 1956 (width 7/16") 1956 (width 5/16")	★ ★	---- ----	1688 761 1688 760	1688 761 1688 760	1688 761 1688 760
24-28-63	GASKET, Evaporator Rear Cover 1955-56 Deluxe Unit	2	1622 278	1622 278	1622 278	1622 278
24-28-70	GRILLE, Air Return, Deluxe Unit, Prime 1955-56 except C70 Limo. 1955-58 Rear Unit, except Sub. 1957 Outlet, Note 1 1958 Inlet, Rear Unit except LY1 and Sub. 1958 Inlet, Rear Unit LY1	2 1 3 2 1	---- 1546 352 1743 659 1886 018 ----	1546 354 1546 352 1743 659 1886 018 ----	1546 354 1546 352 1743 659 1886 018 ----	1546 354 1546 352 1743 659 1886 018 1885 901
24-28-71	SCREEN, Air Return Grille 1956-58 Rear Unit C70 Limo. LY1	1	----	----	----	1648 462
24-28-72	CLIP, Grille and Bezel Mounting 1958 Rear Unit except LY1 and Sub.	4	1331 850	1331 850	1331 850	1331 850
24-28-75	BEZEL, Inlet Grille 1958 Rear Unit except Sub. 1958 Rear Unit Sub.	1 1	1819 014 1753 579	1819 014 1753 579	1819 014 1753 579	1819 014 1753 579
24-28-78	GRILLE, Air Directional 1957-58 Model C 1957 Outlet Note 1	3 3	1748 236 1743 659	1748 236 1743 659	1748 236 1743 659	1748 236 1743 659
24-28-79	SCREEN, Air Outlet Deflector 1955-56 Deluxe Unit 1955-58 Rear Unit Inlet, except Sub. 1956-58 Rear Unit Outlet, except Sub.	1 1 1	---- 1570 956 1648 412	1594 416 1570 956 1648 412	1594 416 1570 956 1648 412	1594 416 ---- 1648 412
24-28-80	DEFLECTOR, Air Outlet Grille 1955 Deluxe Unit Wing Gray 1955-56 Deluxe, Prime 1955-58 Rear Unit except Sub.	1 1 2	1627 200 ---- 1648 401	---- 1595 170 1648 401	---- 1595 170 1648 401	---- 1595 170 1648 401
24-28-82	SCREW, Air Outlet Deflector Shield 1955-58 Rear Unit except Sub.	4	1648 413	1648 413	1648 413	1648 413
24-28-83	GASKET, Air Outlet Deflector 1955 Deluxe Unit	1	1626 937	----	----	----
24-28-84	ADAPTER, Air Outlet Deflector Housing 1955 Deluxe Unit	1	1626 940	----	----	----
24-28-85	SHIELD, Air Outlet Deflector 1956-58 Rear Unit except Sub.	2	1648 417	1648 417	1648 417	1648 417
24-28-86	LEVER, Fresh Air Door Control 1955-56 Deluxe Unit	2	975 397	975 397	975 397	975 397
24-28-90	DOOR, Fresh Air 1955-56 Deluxe Unit 1957-58 Outlet, Front Unit	2 2	1622 304 1704 173	1622 304 1704 173	1622 304 1704 173	1622 304 1704 173
24-28-100	SHAFT, Fresh Air Door 1955-56 Deluxe Unit, C70 Limo. Right 1955-56 Deluxe Unit, C70 Limo. Left	1 1	---- ----	---- ----	---- ----	1648 276 1648 277

NOTE 1: Used w/Model A and Model A-1

NOTE 2: Used w/Model-900

★ Indicates use as required.

Numerals in parentheses () refer to notes.

Printed in U.S.A.

☐ Indicates parts not listed in any previous parts book.

Prices and specifications subject to change without notice.

* Indicates change or addition.

1955-58 PASSENGER CAR PARTS LIST

AIR CONDITIONING

CODE	REMARKS	PER CAR	PLYMOUTH	DODGE	DESOTO	CHRYSLER AND IMPERIAL
24-28-102	GROMMET, Fresh Air Door Control Shaft					
	1955-56	2	1622 310	1622 310	1622 310	1622 310
24-28-108	SPRING, Fresh Air Door Control					
	1955-56 Deluxe Unit	2	1622 298	1622 298	1622 298	1622 298
24-28-112	WASHER, Air Outlet Shield					
	1956	4	6015 004	6015 004	6015 004	6015 004
24-28-132	TUBE, Fresh Air					
	1955 Deluxe Unit	2	1658 630	1658 630	1658 630	1658 630
	1956 C70 Limo.	2	----	----	----	1689 312
24-28-136	TUBE, Evaporator Unit Inlet					
	1955-56 C70 Limo.	2	----	----	----	1689 126
24-28-144	STRAP, Fresh Air Inlet					
	1955-56 Deluxe Unit, C70 Limo.	4	----	----	----	1648 425
	1955-56 Air Duct, Deluxe Unit C70 Limo.	4	----	----	----	1689 128
24-28-150	SCOOP, Air					
	1955 Deluxe and Economy Unit w/Screen Right	1	1621 306	1621 306	1621 306	1621 306
	1955 w/Screen Left	1	1621 307	1621 307	1621 307	1621 307
	1956 w/Screen Right	1	----	1705 746	----	----
	1956 w/Screen Left	1	----	1705 746	----	----
24-28-152	SEAL, Air Scoop					
	1955-56	4	----	1527 751	1527 751	1527 751
	1956 UP TO Note 2	4	----	----	----	*1651 828
	1956 AFTER Note 2	4	----	----	----	*1620 571
	WASHER, Air Scoop Seal					
	1956	4	----	----	1439 256	1439 256
24-28-153	SCREEN, Air Scoop					
	1955 Deluxe Unit Right	1	1646 340	1646 340	1646 340	1646 340
	1955 Left	1	1646 341	1646 341	1646 341	1646 341
24-28-154	WELT, Air Scoop					
	1955 Deluxe Unit	1	----	----	1621 798	1621 798
	1956 Specify 1651 702 (sold by the foot)	★	----	----	----	----
24-28-156	BRACKET, includes Inlet Collar					
	1955-56	2	1620 573	1620 573	1620 573	1620 573
24-28-159	CLIP, Solenoid Wiring					
	1955-56 Deluxe Unit	1	1263 079	1263 079	1263 079	1263 079
	1955-56 Compressor Wiring	1	1302 783	1302 783	1302 783	1302 783
	1955-56 Dash Wiring	1	1263 079	1263 079	1263 079	1263 079
24-28-160	BLOCK, Wiring Terminal					
	1955 Deluxe Unit	1	913 297	913 297	913 297	913 297
	1956	1	----	683 995	683 995	683 995
	1955 C70 Limo.	1	----	----	----	683 995
	1956 C70 Limo.	1	----	----	----	913 297
	1956 Economy Unit	1	913 297	913 297	913 297	----
24-28-163	BRUSH PACKAGE, Blower Motor					
	1955-56 Deluxe Unit	1	1571 050	1571 050	1571 050	1571 050
	1957-58 Note 1	1	*1627 011	*1627 011	*1627 011	*1627 011
	1957-58 Front Unit	1	1841 385	1841 385	1841 385	1841 385
24-28-175	HOUSING, Blower Motor Wheel					
	1956 Deluxe Unit, C70 Limo. Right	1	----	----	----	1648 174
	1956 Left	1	----	----	----	1648 175
	1956-58 3 Speed Motor - Rear Unit	2	1648 394	1648 394	1648 394	*1648 394
	HOUSING, Heater and Air Conditioning Blower					
	1958 Front Unit w/INSULATION	2	*1880 730	*1880 730	*1880 730	*1880 730
24-28-177	CONNECTOR, Housing to Blower					
	1957-58 Front Unit	1	1689 674	1689 674	1689 674	1689 674
24-28-179	NUT, Blower Housing Anchor					
	1956 Economy Unit	6	327 072	327 072	327 072	----
24-28-191	COVER, Blower Motor					
	1956-58 3 Speed Motor - Rear Unit	2	1253 110	1253 110	1253 110	1253 110
24-28-195	MOTOR, Blower, Deluxe Unit					
	1955 Except C70	1	1622 186	1622 186	1622 186	1622 186
	1955 Economy Unit, 6 Volt	1	1383 840	1383 840	1383 840	1383 840
	1957-58 Front Unit w/Rear Unit 3 Speed	1	*1753 363	*1753 363	*1753 363	*1753 363

NOTE 1: Used w/Model A, Model A-1 and Model C.

NOTE 2: C71 Motor No. W56-59482, C72 Motor No. N56-30903, C73 Motor No. C56-10039.

★ Indicates use as required.

Numerals in parentheses () refer to notes.

Printed in U.S.A.

⊔ Indicates parts not listed in any previous parts book.
Nov. 10, 1958 Supersedes Feb. 14, 1958.

Prices and specifications subject to change without notice.
* Indicates change or addition.

CODE	REMARKS	PER CAR	PLYMOUTH	DODGE	DESOTO	CHRYSLER AND IMPERIAL
1955-56	12 Volt Rear Unit	2	----	*1689 405	*1689 405	*1689 405
1957	w/Model A and A-1 Unit	1	*1742 761	*1742 761	*1742 761	*1742 761
1957-58	Front Unit 3 Speed	1	*1842 762	*1842 762	*1842 762	*1842 762
1956	Economy Unit	2	1498 951	1498 951	1498 951	----
1957-58	3 Speed w/RESISTOR Rear Unit	2	1880 738	1880 738	1880 738	1880 738
1957-58	3 Speed w/o Resistor, Rear Unit	2	⊠1885 498	⊠1885 498	⊠1885 498	⊠1885 498
1958	Front Unit w/Dual Unit 3 Speed	2	*1753 363	*1753 363	*1753 363	*1753 363
1958	Rear Single Unit	2	*1886 266	1886 266	*1886 266	*1886 266
1958	Rear Unit Sub.	1	*1886 266	*1886 266	*1886 266	*1886 266
1958	Model C	1	⊠1980 745	⊠1980 745	⊠1980 745	⊠1980 745
24-28-196	INSULATOR, Motor Cable Connector, 4 Pole, Female					
1957-58	4 Pole Female	1	*1753 562	*1753 562	*1753 562	*1753 562
	3 Pole, Female	1	1753 563	1753 563	1753 563	1753 563
1958	Single Pole, Female Front Unit	1	1843 227	1843 227	1843 227	1843 227
24-28-197	COVER, Blower Motor Wheel					
1958		2	1253 110	1253 110	1253 110	1253 110
24-28-198	TUBE, Blower Motor Vent					
1957-58	Front Unit	1	1753 174	1753 174	1753 174	1753 174
24-28-204	WASHER, Blower Motor					
1955-56		12	872 177	872 177	872 177	872 177
1958	3 Speed w/o Resistor Rear Unit	12	*6006 065	*6006 065	6006 065	6006 065
24-28-207	PLATE, Blower Motor, w/GASKET					
1957-58	Front Unit	1	1753 162	1753 162	1753 162	1753 162
24-28-210	WHEEL, Blower Motor					
1955-56	Deluxe Unit, 1956 except C70 Limo. Right	1	1527 091	1527 091	1527 091	1527 091
1955-56	1956 except C70 Limo. Left	1	1527 190	1527 190	1527 190	1527 190
1957-58	Front Unit	1	1753 814	1753 814	1753 814	1753 814
1958	3 Speed Rear Unit	2	*1235 644	*1235 644	*1235 644	*1235 644
24-28-212	FAN, Blower					
1957	Note 2	1	1743 641	1743 641	1743 641	1743 641
24-28-214	ARMATURE, Blower Motor					
1956	6 Volt	1	----	1571 029	1571 029	1571 029
1958	12 Volt 3 Speed	1	1879 415	1879 415	1879 415	1879 415
24-28-215	WASHER, Armature Thrust					
1955-56	Deluxe Unit	★	----	1571 031	1571 031	1571 031
24-28-218	HOLDER, Blower Motor Brush					
1955-56		1	----	1571 034	1571 034	1571 034
24-28-219	SPRING, Blower Motor Brush					
1955-56		1	----	1571 033	1571 033	1571 033
24-28-220	COIL, Evaporator Unit					
1955-56	Deluxe Unit, except C70 Limo.	1	1622 291	1622 291	1622 291	1622 291
1955-56	C70 Limo.	1	----	----	----	1648 172
1957-58	w/o Core, Note 1	1	*1819 999	*1819 999	*1819 999	*1819 999
1957	Note 2	1	1743 317	1743 317	1743 317	1743 317
1958	Rear Unit except Sub.	1	*1880 642	*1880 642	*1880 642	*1880 642
1958	w/Heater CORE Model 902	1	1886 051	1886 051	1886 051	1886 051
1958	w/o Heater CORE Model 902	1	1886 050	1886 050	1886 050	1886 050
1958	w/Heater CORE Model 901	1	1841 970	1841 970	1841 970	1841 970
1958	w/o Heater CORE Model 901	1	1841 971	1841 971	1841 971	1841 971
1957-58	Rear Unit Sub.	1	*1886 249	*1886 249	*1886 249	*1886 249
1957-58	Model C	1	⊠1748 957	⊠1748 957	⊠1748 957	⊠1748 957
24-28-222	GASKET, Evaporator Coil to Dash					
1957-58	Model 900-901	1	*1689 711	*1689 711	*1689 711	*1689 711
24-28-224	PACKAGE, Brush Holder and Spring					
1957-58		1	⊠1881 732	⊠1881 732	⊠1881 732	⊠1881 732
24-28-227	GASKET, Evaporator Coil to Plenum Chamber					
1958	Front Unit	1	1769 100	1769 100	1769 100	1769 100
24-28-237	ELBOW, Evaporator Drain Tube					
1957-58	Note 1	1	1704 148	1704 148	1704 148	1704 148
24-28-239	CONNECTOR, Evaporator Drain Tube					
1957-58	Note 1	1	1753 185	1753 185	1753 185	1753 185

NOTE 1: Used w/Model 900.

NOTE 2: Used w/Model A and Model A-1.

★ Indicates use as required.

Numerals in parentheses () refer to notes.

Printed in U.S.A.

⊠ Indicates parts not listed in any previous parts book.

Prices and specifications subject to change without notice.

* Indicates change or addition.

1955-58 PASSENGER CAR PARTS LIST

AIR CONDITIONING

CODE	REMARKS	PER CAR	PLYMOUTH	DODGE	DESOTO	CHRYSLER AND IMPERIAL
24-28-241	SWITCH, Evaporator Unit Suction Tube, Thermo. 1955-56 Except C70 Limo. w/50" Wiring UP TO Note 3 D63 AFTER Note 3	1	1658 130	1658 130	1658 130	1658 130
	1957-58 All	1	1770 329	1770 329	1770 329	1770 329
	1955-56 C70 Limo. w/6" Wiring	1	1648 884	1648 884	1648 884	1648 884
	1957 Note 4	1	1744 397	1744 397	1744 397	1744 397
	1957-58 Model C	1	⊠1748 085	⊠1748 083	⊠1748 083	⊠1748 083
24-28-242	CONNECTOR, Double Wade 1955-56 Deluxe Unit	2	1345 869	1345 869	1345 869	1345 869
24-28-244	GROMMET, Thermo Switch Tube 1957-58 Note 2	1	1704 625	1704 625	1704 625	1704 625
24-28-247	GASKET, Drain Elbow 1957-58 Note 2	1	1704 132	1704 132	1704 132	1704 132
24-28-248	KNOB, Thermo Switch 1958 Model A-1 and C	1	*1424 537	*1424 637	*1424 637	*1424 637
24-28-253	ELBOW, Distributor 1956	1	1622 385	1622 385	1622 385	1622 385
24-28-289	ELBOW, Tube 1955-56	1	1622 385	1622 385	1622 385	1622 385
24-28-300	VALVE, Expansion 1955-58 Rear Unit	1	*1875 580	*1875 580	*1875 580	*1875 580
	1957-58 Front Unit	1	1753 354	1753 354	1753 354	1753 354
	1957-58 Note 5	1	*1743 286	*1743 286	*1743 286	*1743 286
24-28-303	BRACKET, Expansion Valve Mounting 1955-56	1	1527 874	1527 874	1527 874	1527 874
24-28-305	SPACER, Expansion Valve Mounting to Fender Shield LD2, LD3, LS1	1	----	*1242 698	*1242 698	----
24-28-307	CAP, Tubing Note 5	1	1879 300	1879 300	1879 300	----
24-28-316	TUBE, Liquid Indicator to Evaporator Unit 1957-58 S27, IM, LY1	1	*1841 094	*1841 094	*1841 094	*1838 041
	1957 except S27 and IM	1	----	----	1838 040	1838 040
	1958 except LS1, Note 2	1	----	*1841 094	*1838 040	*1838 040
	1958 LS1 Note 2	1	----	----	1841 094	----
24-28-318	ELBOW, Liquid Supply Tube 1955-57	1	1622 385	1622 385	1622 385	1622 385
	TEE, Liquid Tube 1958 Rear Unit, Front, Sub.	1	*1885 692	*1885 692	*1885 692	*1885 692
	1958 Tee Suction Rear Unit, Front, w/Dual Unit	1	⊠1886 011	⊠1886 011	⊠1886 011	⊠1886 011
	1958 Tee Liquid Rear Unit, Front, w/Dual Unit	1	*1885 692	*1885 692	*1885 692	*1885 692
24-28-322	INDICATOR, or Sight Glass, Liquid 1955-58 Cn Side Shield	1	*1622 503	*1622 503	*1622 503	*1622 503
	1957 Note 1 and Note 4	1	1744 768	1744 768	1744 768	1744 768
	1958 PACKAGE, Indicator includes GASKET and Cap, Front	1	*1880 657	*1880 657	*1880 657	*1880 657
24-28-325	BRACKET, Liquid Indicator 1957-58 on Liquid Tube Right	1	*1622 660	*1622 660	*1622 660	*1622 660
	1958-58 on Liquid Tube Left	1	*1622 661	*1622 661	*1622 661	*1622 661
24-28-330	VALVE, Solenoid 1955 Except C70	1	1626 678	1626 678	1626 678	1626 678
	1955 C70	1	----	----	----	1626 832
	1956	1	1626 832	1626 832	1626 832	1626 832
	1956 C70, C73	1	----	----	----	1626 678
	1957-58 3 Way	1	1753 584	1753 584	1753 584	1753 584
	1957 Note 1 and Note 4	1	*1743 286	*1743 286	*1743 286	*1743 286
24-28-332	CONNECTOR, Solenoid Valve 1955-56 Single Wade, Deluxe Unit	1	1310 489	1310 489	1310 489	1310 489

NOTE 1: Used w/Model A and Model C.

NOTE 2: Used w/Model 900.

NOTE 3: D63 Serial No. 35067702.

NOTE 4: Used w/Model A-1.

NOTE 5: Used w/Model A, A-1 and Model C.

★ Indicates use as required.

Numerals in parentheses () refer to notes.

Printed in U.S.A.

⊠ Indicates parts not listed in any previous parts book.

Prices and specifications subject to change without notice.

Nov. 10, 1958 Supersedes Feb. 14, 1958.

Page 24-26

* Indicates change or addition.

CODE	REMARKS	PER CAR	PLYMOUTH	DODGE	DESOTO	CHRYSLER AND IMPERIAL
24-28-338	CONNECTOR, Magnetic Clutch 1955-56 Single Wade, Deluxe Unit	1	1310 489	1310 489	1310 489	1310 489
24-28-355	DOOR, Outlet includes Frame 1957-58	2	1704 173	1704 173	1704 173	1704 173
24-28-364	DUCT, Distribution 1957-58 IM, LY1	1	----	----	----	1841 141
24-28-365	SCREW, Distributor 1957-58 Distribution Duct Mounting	5	*6006 125	*6006 125	*6006 125	*6006 125
	1957-58 Blower Motor Wheel, Front Unit	3	925 353	925 353	925 353	925 353
	1958 LS2	3	----	----	*1885 808	*1885 808
24-28-366	CABLE, Air Damper Control 1957-58 Front Unit	1	*1779 766	*1779 766	*1779 764	*1779 766
24-28-367	CLAMP, Heater Air Damper Control Cable 1957-58 Front Unit	1	1770 371	1770 371	1770 371	1770 371
	1957-58 Defroster Control, Front Unit	1	*1770 371	*1770 371	*1770 371	*1770 371
24-28-368	WASHER, Air Damper Lever 1958	1	6015 004	6015 004	6015 004	6015 004
24-28-369	GRILLE, Side Cowl Distribution 1957-58 Front Unit IM, LY1	1	----	----	----	*1819 029
24-28-370	NOZZLE, Side Cowl Distribution 1957-58 Front Unit IM, LY1	1	----	----	----	*1841 142
	1957-58 Distribution Duct, All	1	⊠1880 232	⊠1880 232	⊠1880 232	⊠1880 232
24-28-371	HOSE, Side Cowl Distribution 1957-58 Front Unit IM, LY1	1	----	----	----	*1540 102
24-28-372	CONNECTOR, Outlet Duct to Distribution Duct Front Unit					
	1957 Right, UP TO Note 3	1	*1769 839	*1769 839	*1769 839	*1769 839
	1957 Left, UP TO Note 3	1	*1769 840	*1769 840	*1769 840	*1769 840
	1958 Front Unit AFTER Note 3 Right	1	*1841 773	*1841 773	*1841 773	*1841 773
	1958 Front Unit AFTER Note 3 Left	1	*1841 774	*1841 774	*1841 774	*1841 774
24-28-373	SPACER, Distribution 1958 Front Unit Mounting 1 1/8" lgh.	3	*1838 398	*1838 398	*1838 398	*1885 792
	1958 1 3/8" lgh.	3	----	----	⊠1885 752	⊠1885 752
24-28-374	REINFORCEMENT, Distribution Duct Nozzle 1957-58 Front Unit	1	1842 736	1842 736	1842 736	1842 736
	Upper					
24-28-375	SPRING, Evaporator Grille 1957 Note 1	1	1744 027	1744 027	1744 027	1744 027
	1957-58 Model C	3	⊠1748 234	⊠1748 234	⊠1748 234	⊠1748 234
24-28-377	SWIVEL, Distribution Duct Damper Shaft Lever 1958 Model 902	1	----	----	----	1308 286
24-28-380	BRACKET, Evaporator Grille 1957 Note 1	1	1744 061	1744 061	1744 061	1744 061
	1958 Support to Distribution Duct	1	1880 012	----	----	----
24-28-381	FRAME, Outlet Door w/SEZEL and BRACKET 1958 Front Unit	2	⊠1704 186	⊠1704 186	⊠1704 186	⊠1704 186
24-28-385	VALVE, By-Pass, Note 1	1	1743 287	1743 287	1743 287	1743 287
24-28-390	TEE, By-Pass Tube, Note 1	1	1744 026	1744 026	1744 026	1744 026
24-29-0 ACTUATOR						
24-29-1	ACTUATOR 1957-58 Front Unit	1	1770 106	1770 106	1770 106	1770 106
24-29-2	ADAPTER, Actuator Breather Fitting, on Eng.	1	1838 120	1838 120	1838 120	1838 120
24-29-5	TUBE, Actuator Return Engine to Solenoid 1957-58 except LC1, LC2, LC3, LY1	1	861 541	861 541	861 541	861 551
	1957-58 Actuator Supply except LC3, LY1	1	861 541	861 541	861 541	861 541
24-29-7	SCREW, Actuator Mounting 1958 LS1	1	6006 218	6006 218	6006 218	----
24-29-10	VALVE, Eng. to Actuator, w/Check BALL	1	*1851 302	1851 302	1851 302	*1851 302

NOTE 1: Used w/Model A.

NOTE 2: Used w/Model 900.

NOTE 3: LD2 Ser. No. 14316 Det. Blt., 6949 L. A. Blt., LD3 8466 Det. Blt., 5862 L. A. Blt., LSI 4433 Det. Blt., 2336 L. A. Blt.

★ Indicates use as required.

Numerals in parentheses () refer to notes.

Printed in U.S.A.

⊠ Indicates parts not listed in any previous parts book.

Prices and specifications subject to change without notice.

* Indicates change or addition.

Page 24-27

November 10, 1958.

