

GROUP 1 - ACCESSORIES

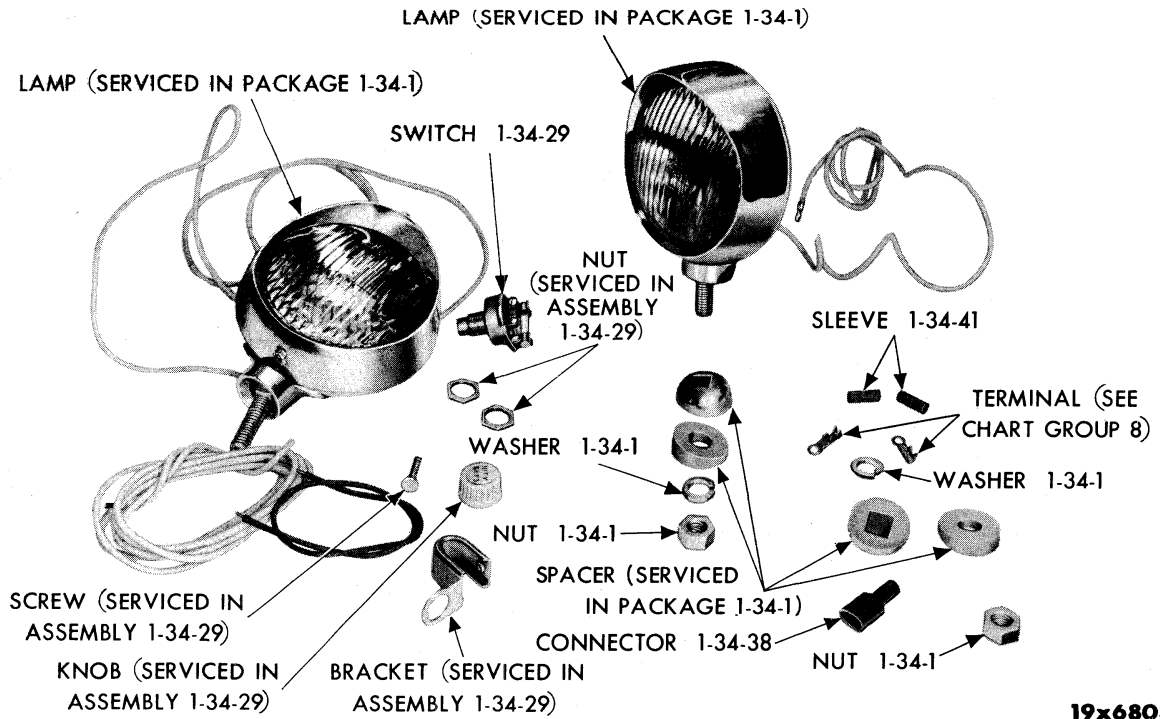

19x6803

Plate 1-1

FOGLIGHT PACKAGE (1-34-1)

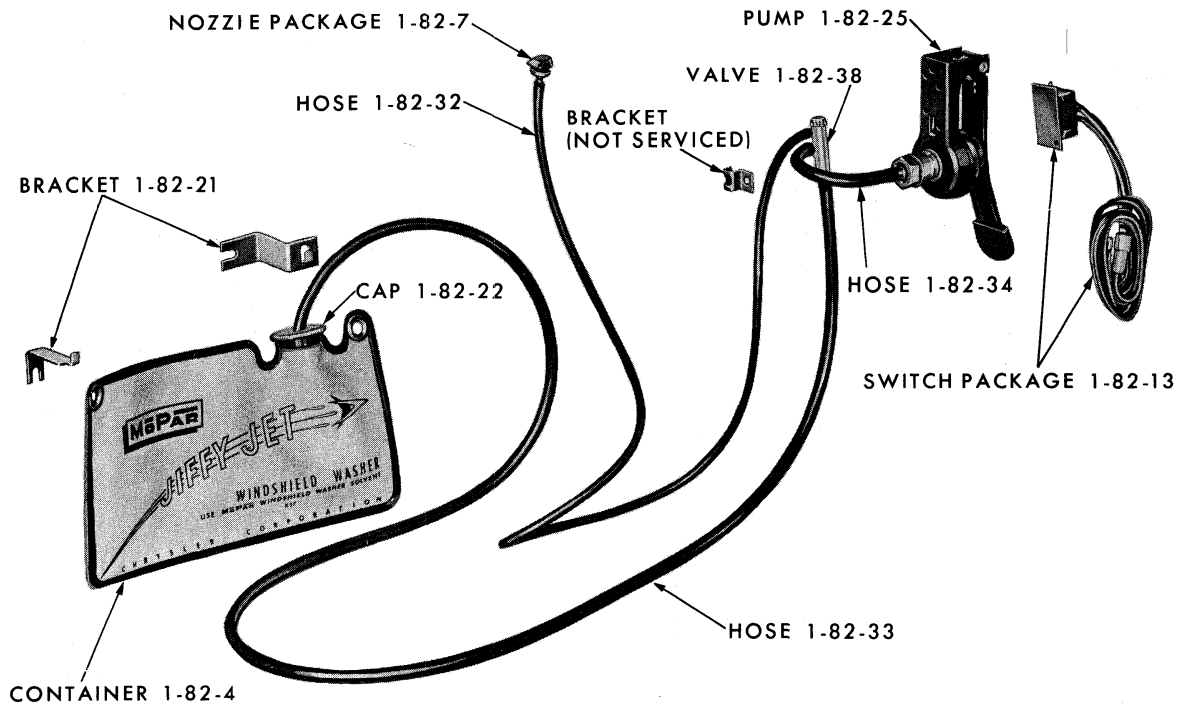

19x8372

Plate 1-2

WINDSHIELD WASHER SYSTEM

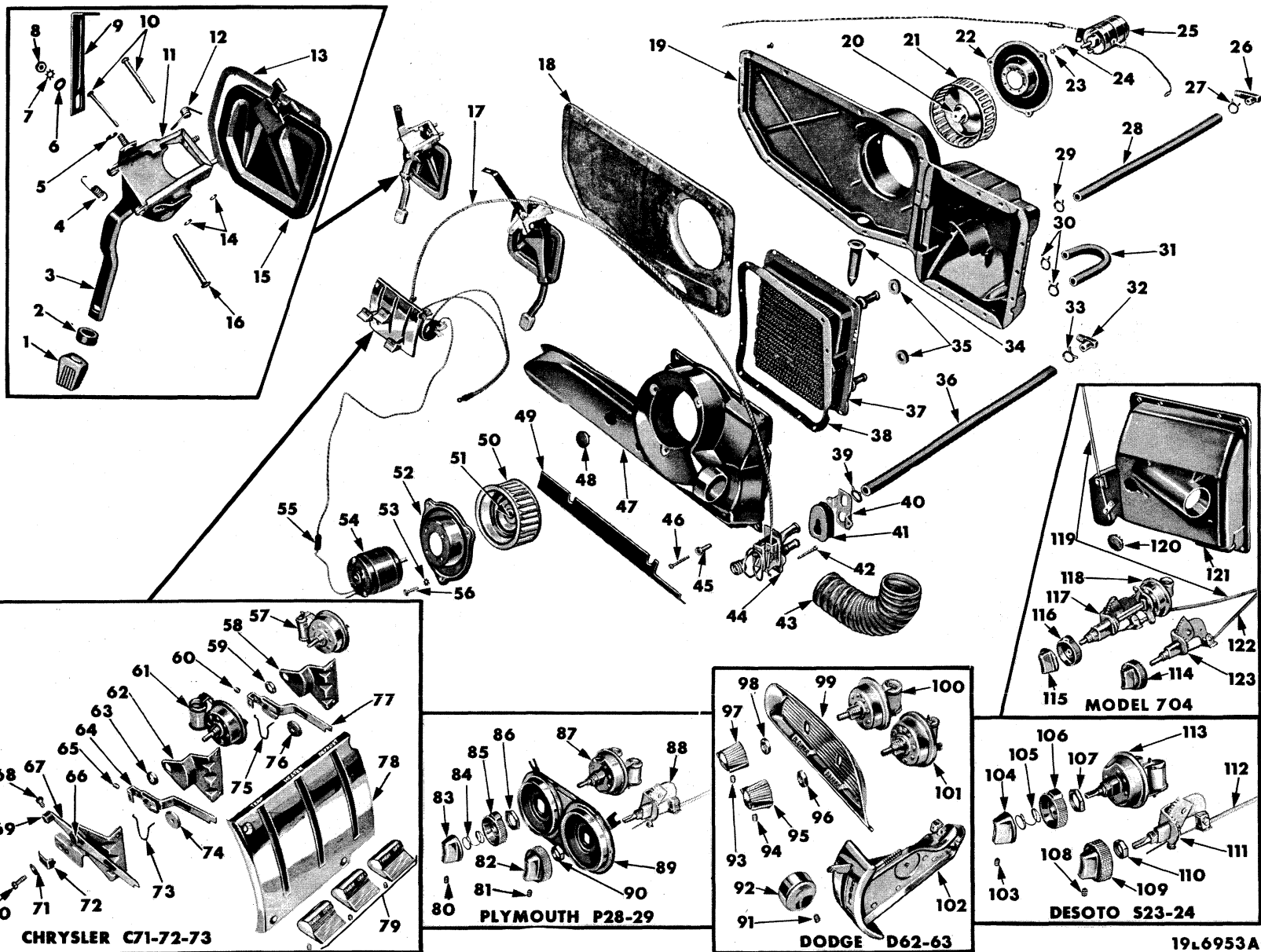

Plate 1-3

HEATER - MODELS 702 AND 704

HEATER - MODELS 702 AND 704

Plate 1-3

Ref. No.	Name	Part Type Code	Ref. No.	Name	Part Type Code
1	Pad	1-48-384	63	Nut	1-48-779
2	Bumper	Not Serviced	64	Arm	Not Serviced
3	Arm	Not Serviced	65	Screw	1-48-770
4	Spring	Not Serviced	66	Washer	1-48-938
5	Retainer	Not Serviced	67	Arm, w/BRACKET	1-48-934
6	Washer	1-48-369	68	Screw	1-48-953
7	Washer	1-48-369	69	Pivot	1-48-952
8	Nut	1-48-369	70	Screw	1-48-950
9	Brace	1-48-369	71	Washer	1-48-950
10	Pin	Not Serviced	72	Clamp	1-48-950
11	Lever	Not Serviced	73	Spring	1-48-938
12	Spring	Not Serviced	74	Follower	Not Serviced
13	Gasket	1-48-366	75	Spring	Not Serviced
14	Retainer	Not Serviced	76	Follower	Not Serviced
15	Door	Not Serviced	77	Arm	Not Serviced
16	Pin	Not Serviced	78	Plate	1-48-70
17	Cable	1-48-941	79	Knob & Screw	1-48-801
18	Insulation	1-48-126	80	Screw	1-48-801
19	Housing	1-48-125	81	Screw	1-48-942
20	Screw	1-48-46	82	Knob	1-48-942
21	Wheel	1-48-46	83	Knob	1-48-801
22	Plate & Gasket	1-48-611	84	Spring	1-48-197
23	Washer	1-48-611	85	Knob	1-48-191
24	Screw	1-48-611	86	Nut	1-48-779
25	Motor	1-48-599	87	Switch	1-48-770
26	Elbow	1-48-575	88	Temperature Control Body, w/RACK	1-48-940
27	Clamp	1-48-559	89	Panel	1-48-70
28	Hose	1-48-555	90	Nut	1-48-937
29	Clamp	1-48-559	91	Screw	1-48-942
30	Clamp	1-48-559	92	Knob	1-48-942
31	Hose	1-48-555	93	Screw	1-48-801
32	Elbow	1-48-575	94	Screw	1-48-801
33	Clamp	1-48-559	95	Knob	1-48-801
34	Hose	Not Serviced	96	Nut	1-48-309
35	Seal	Not Serviced	97	Knob	1-48-801
36	Hose	1-48-555	98	Nut	1-48-779
37	Core	1-48-88	99	Plate	1-48-70
38	Gasket	Not Serviced	100	Switch	1-48-770
39	Clamp	1-48-559	101	Switch	1-48-300
40	Retainer	1-48-860	102	Arm, w/PLATE	Not Serviced
41	Gasket	1-48-858	103	Screw	1-48-801
42	Screw	1-48-854	104	Knob	1-48-801
43	Tube	1-48-151	105	Spring	1-48-197
44	Valve	1-48-854	106	Knob	1-48-941
45	Spacer	Not Serviced	107	Nut	1-48-779
46	Screw	Not Serviced	108	Screw	1-48-942
47	Housing	1-48-125	109	Knob	1-48-942
48	Plug	Not Serviced	110	Nut	1-48-937
49	Retainer	Not Serviced	111	Temperature Control Body, w/RACK	1-48-940
50	Wheel	1-48-225	112	Cable	1-48-941
51	Screw	1-48-225	113	Switch	1-48-770
52	Plate, w/GASKET	Not Serviced	114	Knob	1-48-942
53	Washer	Not Serviced	115	Knob	1-48-801
54	Motor	1-48-268	116	Knob	1-43-191
55	Connector	1-48-656	117	Control	1-48-175
56	Screw	Not Serviced	118	Switch	1-48-770
57	Switch	1-48-300	119	Cable	1-48-176
58	Bracket	1-48-310	120	Plug	Not Serviced
59	Nut	1-48-309	121	Housing	1-48-125
60	Screw	1-48-300	122	Cable	1-48-941
61	Switch	1-48-770	123	Temperature Control Body, w/RACK	Not Serviced
62	Bracket	1-48-780			

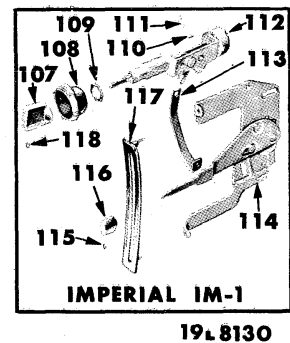
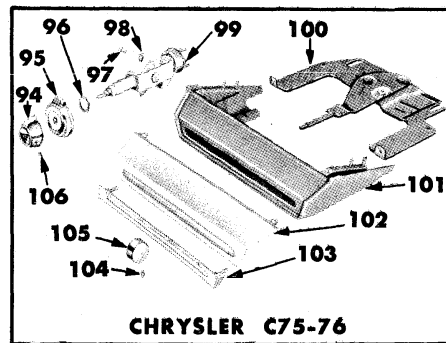
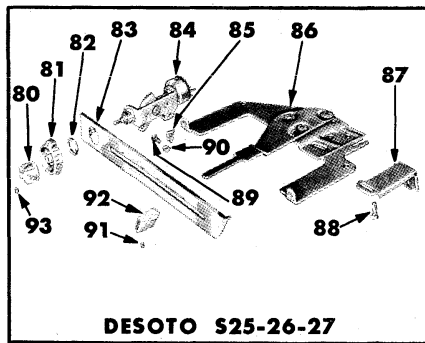
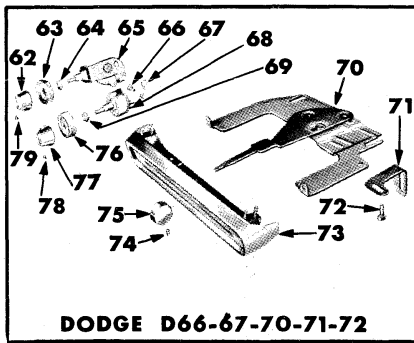
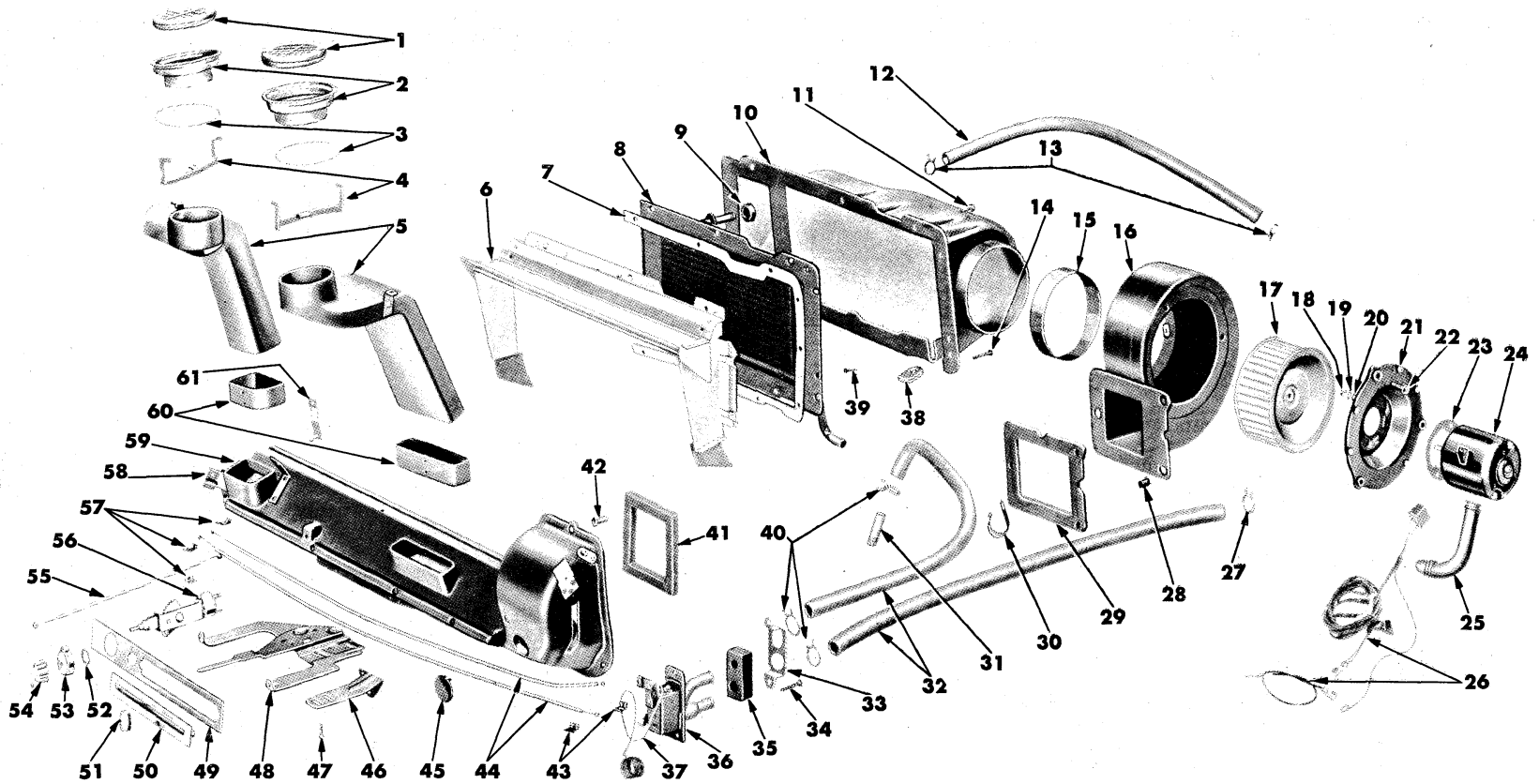

Plate 1-4

HEATER - MODEL 705

Plate 1-4

HEATER - MODEL 705

Ref. No.	Name	Part Type Code	Ref. No.	Name	Part Type Code
1	Louver	1-48-235	60	Connector	Not Serviced
2	Adapter & Bracket	1-48-236	61	Lever	1-48-708
3	Retainer	1-48-239	62	Knob	1-48-191
4	Bracket	Not Serviced	63	Escutcheon	1-48-192
5	Defroster Duct	1-48-141	64	Nut	1-48-779
6	Rain Trap (Plymouth only)	Not Serviced	65	Defroster Control	1-48-175
7	Gasket	Not Serviced	66	Set Screw	
8	Core	1-48-88	67	Set Screw	
9	Grommet	Not Serviced	68	Blower Switch	1-48-770
10	Housing	1-48-125	69	Nut	1-48-779
11	Screw	1-48-128	70	Temperature Control	1-48-940
12	Hose	1-48-555	71	Bracket	Not Serviced
13	Clamp	1-48-559	72	Screw	
14	Screw	Not Serviced	73	Housing	1-48-70
15	Connector	1-48-131	74	Set Screw	
16	Housing	1-48-45	75	Knob	1-48-942
17	Wheel	1-48-46	76	Escutcheon	1-48-773
18	Nut		77	Knob	1-48-801
19	Lockwasher		78	Set Screw	
20	Washer		79	Set Screw	
21	Plate	Not Serviced	80	Knob	1-48-801
22	Screw	1-48-613	81	Knob	1-48-191
23	Gasket	Not Serviced	82	Nut	1-48-779
24	Motor	1-48-599	83	Plate	1-48-72
25	Tube	1-48-646	84	Switch	1-48-770
26	Wiring	Not Serviced	85	Clamp	1-48-267
27	Clamp	1-48-559	86	Temperature Control	1-48-940
28	Spacer	Not Serviced	87	Bracket	Not Serviced
29	Gasket	Not Serviced	88	Screw	
30	Clamp	Not Serviced	89	Set Screw	
31	Nipple	1-48-572	90	Nut	
32	Hose	1-48-555	91	Set Screw	
33	Retainer	1-48-860	92	Knob	1-48-942
34	Screw		93	Set Screw	
35	Gasket	1-48-858	94	Knob	1-48-801
36	Valve	1-48-854	95	Knob	1-48-191
37	Tube	Not Serviced	96	Nut	1-48-779
38	Seal	Not Serviced	97	Screw	
39	Stud	Not Serviced	98	Clamp	1-48-267
40	Clamp	1-48-559	99	Switch	1-48-770
41	Gasket	Not Serviced	100	Temperature Control	1-48-940
42	Spacer	Not Serviced	101	Housing	1-48-70
43	Clamp	1-48-267	102	Trim Plate	1-48-72
44	Cable	1-48-941	103	Bezel	1-48-70
45	Plug	Not Serviced	104	Set Screw	
46	Bracket	Not Serviced	105	Knob	1-48-942
47	Screw		106	Set Screw	
48	Temperature Control	1-48-940	107	Knob	1-48-801
49	Plate	23-33-56	108	Knob	1-48-191
50	Bezel	1-48-70	109	Nut	1-48-779
51	Knob	1-48-942	110	Clamp	1-48-267
52	Nut	1-48-779	111	Screw	
53	Knob	1-48-191	112	Switch	1-48-770
54	Knob	1-48-801	113	Bracket	Not Serviced
55	Cable	1-48-725	114	Temperature Control	1-48-940
56	Switch	1-48-770	115	Set Screw	
57	Clamp	1-48-267	116	Knob	1-48-942
58	Bracket	Not Serviced	117	Bezel	1-48-70
59	Distribution Duct	1-48-707	118	Set Screw	

Parts Indicated By Name Only, Are Standard Parts - Order By Description.

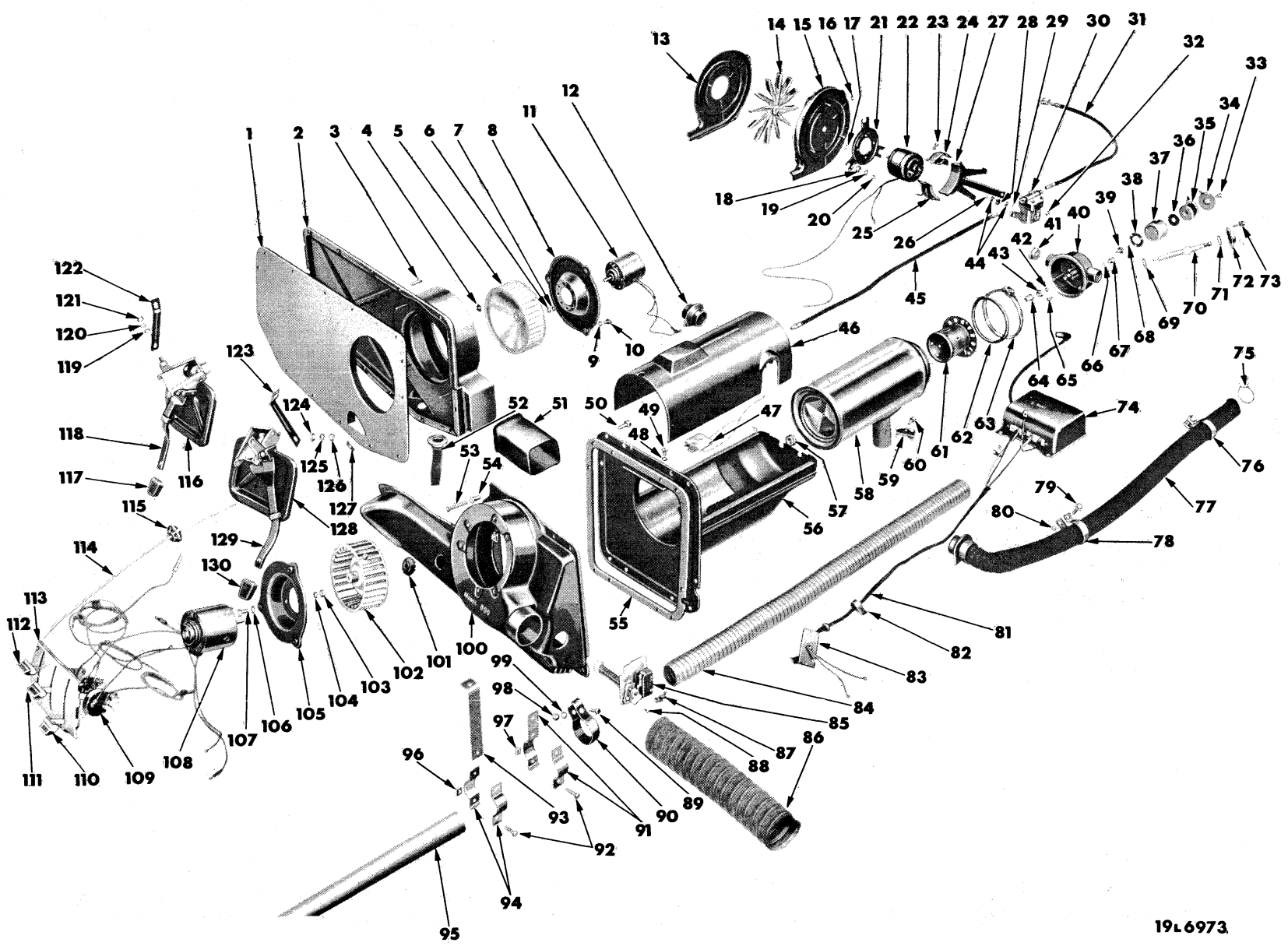

19L6973

HEATER - MODEL 800

Plate 1-5

Plate 1-5

HEATER-MODEL 800

Ref. No.	Name	Part Type Code	Ref. No.	Name	Part Type Code
1	Insulation	1-48-126	66	Washer	
2	Housing	Not Serviced	67	Valve Seat, Service in Base Assy.	1-48-990
3	Screw and Washer		68	Spring, Service in Base Assy.	1-48-990
4	Nut		69	Washer, Serviced in Pkg.	1-48-996
5	Wheel	1-48-46	70	Package (Spark Plug and Washer)	1-48-996
6	Nut		71	Washer, Serviced in Pkg.	1-48-996
7	Washer		72	Cap	1-48-968
8	Plate, w/Gasket	1-48-611	73	Screw and Washer	
9	Washer		74	Unit	1-48-985
10	Screw		75	Clamp	1-48-559
11	Motor	1-48-599	76	Clamp	1-48-559
12	Grommet	1-48-972	77	Hose	1-48-555
13	Housing	1-48-960	78	Clamp	1-48-559
14	Wheel	1-48-961	79	Screw and Washer	
15	Housing	1-48-960	80	Nut	
16	Nut		81	Harness	Not Serviced
17	Nut		82	Clip	Not Serviced
18	Grommet		83	Plate	Not Serviced
19	Washer		84	Tube	1-48-977
20	Nut		85	Thermostat	1-48-854
21	Bracket	Not Serviced	86	Tube	1-48-151
22	Motor	1-48-973	87	Bracket	Not Serviced
23	Screw		88	Screw	
24	Clamp	Not Serviced	89	Bolt	
25	Clamp	Not Serviced	90	Clamp	1-48-978
26	Washer		91	Clamp	1-48-978
27	Bracket	Not Serviced	92	Screw	
28	Washer		93	Clamp	1-48-978
29	Coupling	1-48-964	94	Clamp	1-48-978
30	Pump	1-48-962	95	Tube	Not Serviced
31	Tube	1-48-983	96	Nut	
32	Nut		97	Nut	
33	Screw and Washer		98	Nut	
34	Cover, Service in Base Assy.	1-48-990	99	Washer	
35	Package, Coil and Washer	1-48-998	100	Housing	1-48-125
36	Package, Coil and Washer	1-48-998	101	Plug	Not Serviced
37	Case, Service in Base Assy.	1-48-990	102	Wheel	1-48-225
38	Gasket, Service in Base Assy.	1-48-990	103	Nut	
39	Valve, Service in Base Assy.	1-48-990	104	Washer	
40	Base	1-48-990	105	Plate, w/Gasket	Not Serviced
41	Port	Not Serviced	106	Washer	
42	Nut		107	Bolt	
43	Washer	Not Serviced	108	Motor	1-48-268
44	Connector	1-48-963	109	Switch	1-48-300
45	Tube	1-48-983	110	Knob	1-48-801
46	Case (Heater Burner) (Upper Half)	Not Serviced	111	Knob	1-48-801
47	Overheat Switch,	1-48-980	112	Knob	1-48-801
48	Washer		113	Panel	1-48-70
49	Screw		114	Cable	1-48-941
50	Screw and Washer		115	Grommet	
51	Adapter	1-48-133	116	Door	1-48-365
52	Hose	1-48-555	117	Pad	1-48-384
53	Screw		118	Arm	Not Serviced
54	Spacer		119	Washer	1-48-369
55	Gasket	Not Serviced	120	Washer	1-48-369
56	Case (Heater Burner) (Lower Half)	Not Serviced	121	Nut	1-48-369
57	Grommet	1-48-969	122	Brace	1-48-369
58	Exchanger	1-48-967	123	Brace	1-48-369
59	Clamp	1-48-978	124	Washer	
60	Screw and Washer		125	Washer	
61	Plate	1-48-959	126	Nut	
62	Gasket	1-48-966	127	Clip	
63	Clamp	1-48-994	128	Door	1-48-365
64	Nozzle	1-48-971	129	Arm	Not Serviced
65	Screw		130	Pad	1-48-384

Parts Indicated By Name Only, Are Standard Parts - Order By Description.

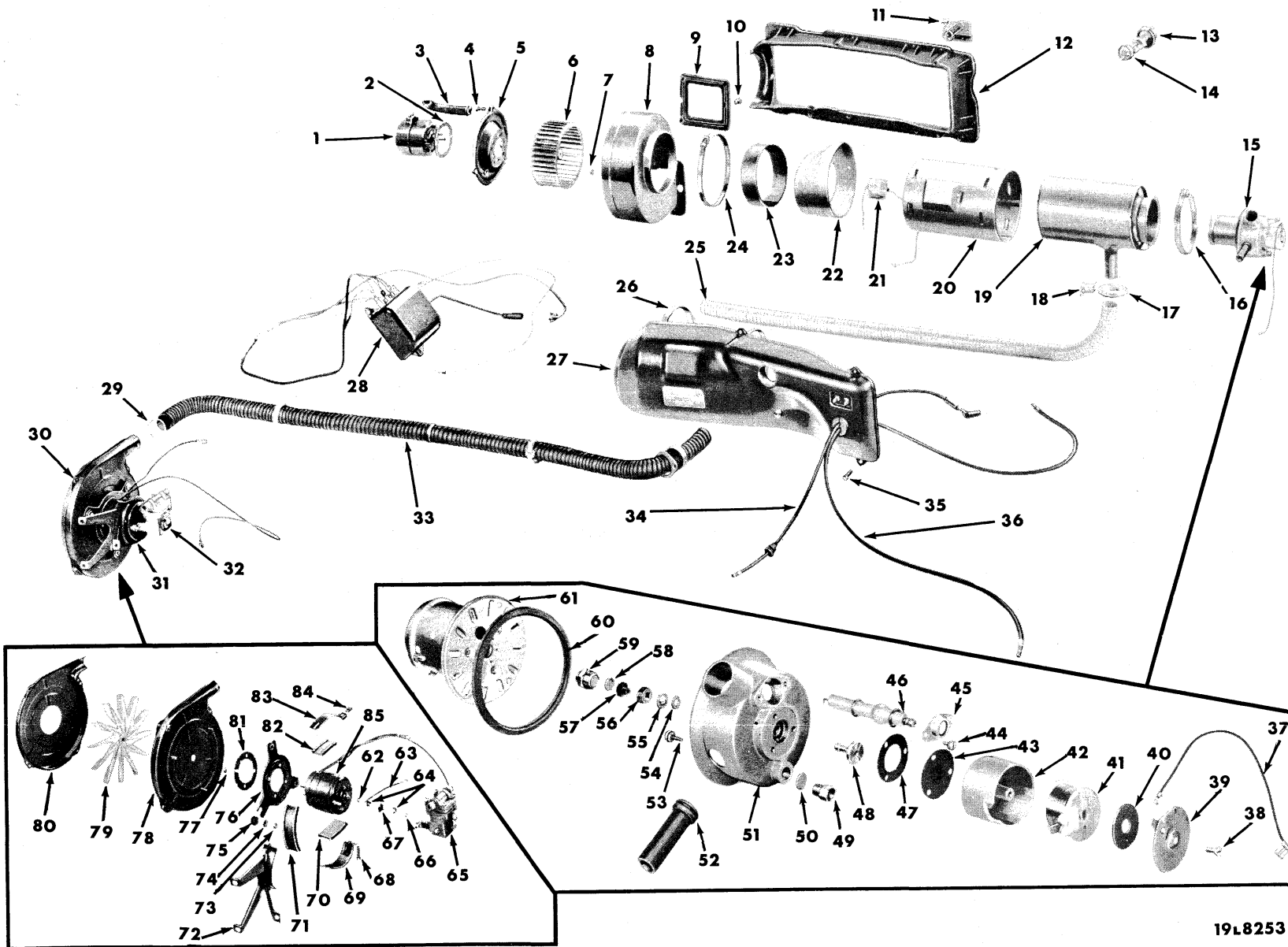

19L8253

Plate 1-6

HEATER - MODEL 801

Plate 1-6

HEATER - MODEL 801

Ref. No.	Name	Part Type Code	Ref. No.	Name	Part Type Code
1	Motor	1-48-599	46	Spark Plug (serviced in Spark Plug Package 1-48-996)	
2	Gasket	Not Serviced	47	Gasket (serviced in Valve Package 1-48-993)	
3	Tube	1-48-646	48	Valve (serviced in Valve Package 1-48-993)	
4	Screw	1-48-613	49	Connector	
5	Plate	Not Serviced	50	Screen	1-48-999
6	Wheel	1-48-46	51	Base	1-48-990
7	Nut		52	Vent Tube	1-48-984
8	Housing	1-48-45	53	Screw	Not Serviced
9	Gasket	Not Serviced	54	Gasket (serviced in Valve Seat Package 1-48-995)	
10	Spacer	Not Serviced	55	Seat (serviced in Valve Seat Package 1-48-995)	
11	Thermostat	1-48-854	56	Screw (serviced in Valve Seat Package 1-48-995)	
12	Housing	Not Serviced	57	Spacer (serviced in Nozzle Package 1-48-991)	
13	Knob	1-48-801	58	Washer	Not Serviced
		1-48-191	59	Nozzle (serviced in Nozzle Package 1-48-991)	
14	Switch	1-48-770	60	Gasket	1-48-966
15	Base	1-48-990	61	Mixer & Plate	1-48-959
16	Clamp	1-48-994	62	Washer	
17	Ferrule	Not Serviced	63	Tube	1-48-983
18	Clamp	1-48-978	64	Connector	1-48-963
19	Exchanger	1-48-967	65	Pump	1-48-962
20	Shield	Not Serviced	66	Washer	
21	Switch	1-48-980	67	Coupling	1-48-964
22	Adapter	Not Serviced	68	Screw	Not Serviced
23	Connector	Not Serviced	69	Clamp	Not Serviced
24	Strap	Not Serviced	70	Mounting Pad	Not Serviced
25	Hose	1-48-992	71	Mounting Pad	Not Serviced
26	Strap	Not Serviced	72	Bracket	Not Serviced
27	Cover	Not Serviced	73	Washer	
28	Ignition Unit	1-48-985	74	Nut	
29	Clamp	1-48-599	75	Grommet	
30	Housing	1-48-960	76	Bracket	Not Serviced
31	Motor	1-48-973	77	Sleeve	Not Serviced
32	Pump	1-48-962	78	Housing	1-48-960
33	Hose & Grommet	1-48-992	79	Wheel	1-48-961
34	Cable	Not Serviced	80	Housing	1-48-960
35	Screw	1-48-979	81	Stiffener	Not Serviced
36	Tube	1-48-983	82	Mounting Pad	Not Serviced
37	Tube	1-48-983	83	Clamp	Not Serviced
38	Screw	Not Serviced	84	Nut	
39	Cover	1-48-997	85	Motor	1-48-973
40	Washer (serviced in Coil & Washer Package 1-48-998)				
41	Coil (serviced in Coil & Washer Package 1-48-998)				
42	Cup	Not Serviced			
43	Disc (serviced in Valve Package 1-48-993)				
44	Screw	Not Serviced			
45	Cap	1-48-968			

NOTE - PARTS INDICATED BY PART NAME ONLY ARE STANDARD PARTS - ORDER BY DESCRIPTION

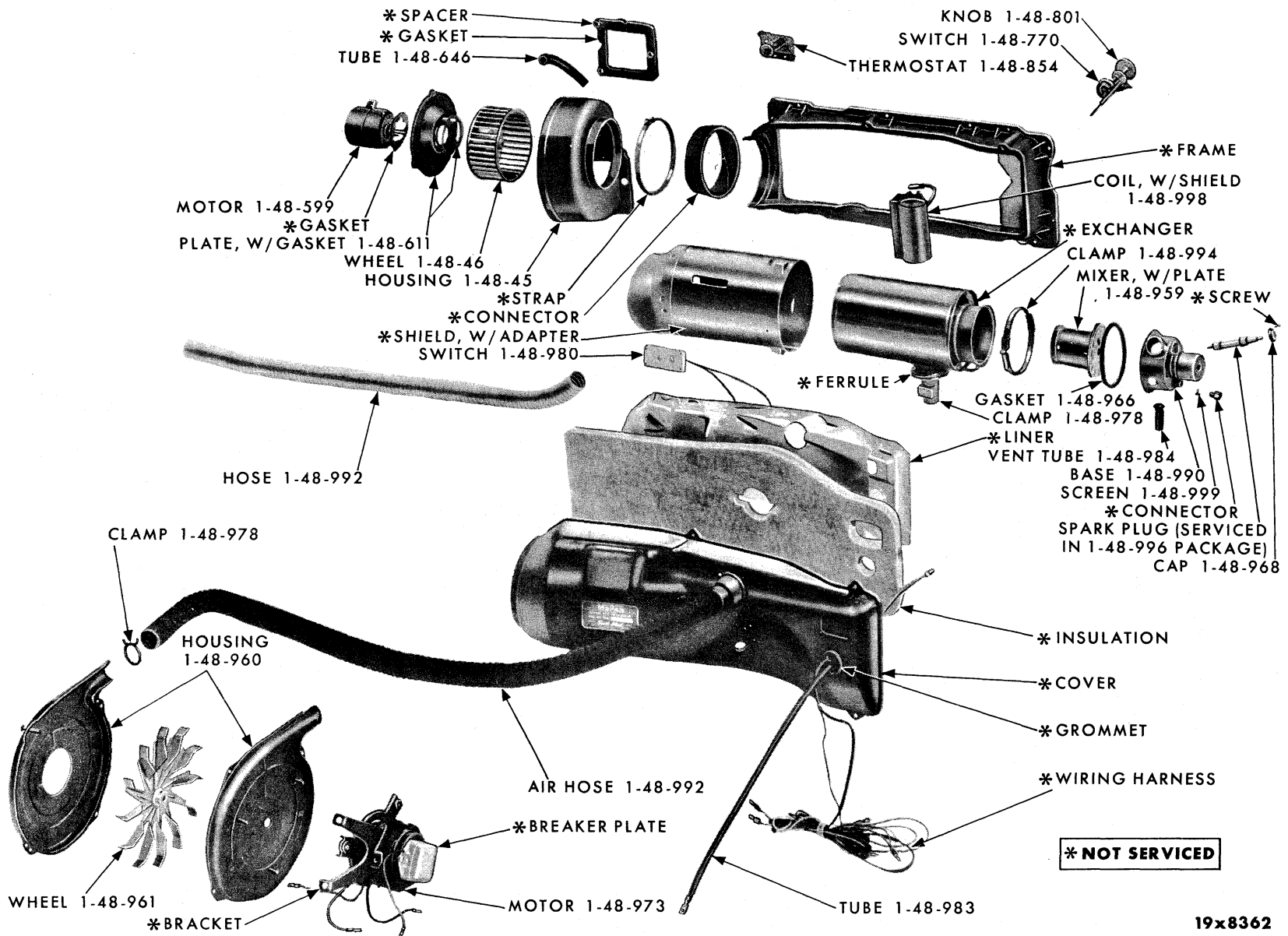

19x8362

Plate 1-7

HEATER - MODEL 803

CODE	PART NAME AND DESCRIPTION	NO. OF CYL.	PLYMOUTH	DODGE	DESOTO	CHRYSLER AND IMPERIAL	PER CAR	PART NUMBER
1-01-0 BUMPER OR GRILLE GUARD								
1-01-1	PACKAGE, Front Bumper Guard	6-8	57-58	-	-	-	1	1843 292
1-08-0 HEAD LAMP PACKAGE								
1-08-1	PACKAGE, Dual Headlamp Conversion, S25, S26, LS2, LC2	8	-	-	57-58	57-58	1	1819 670
1-09-0 HAND BRAKE SIGNAL LAMP								
1-09-1	PACKAGE	6-8	57-58	57-58	-	-	1	1770 721
		8	-	-	57-58	-	1	1770 727
	Bulb.	6-8	56	56	56	-	1	142 453
1-10-0 BACK-UP LAMP								
1-10-1	PACKAGE, w/Std. Trans.	6-8	57	-	-	-	1	1819 087
	w/Std. Trans.	6-8	-	57	57	-	1	1819 091
	w/Std. Trans. except Sub.	6-8	58	-	-	-	1	1838 384
	w/PowerFlite and Auto. 3 Speed Trans. except Sub.	6-8	58	-	-	-	1	1838 385
	w/Std. Trans. Sub.	6-8	58	-	-	-	1	1838 386
	w/PowerFlite and Auto. 3 Speed Trans. Sub.	6-8	58	-	-	-	1	1838 387
	w/Std. Trans.	6-8	-	58	-	-	1	1841 973
	w/PowerFlite and Auto. 3 Speed Trans.	6-8	-	58	-	-	1	1841 974
	w/Std. Trans. LS1 Sub.	8	-	-	58	-	1	1838 391
	w/PowerFlite and Auto. 3 Speed Trans. LS1 Sub.	8	-	-	58	-	1	1838 392
	w/Std. Trans. LS1 except Sub.	8	-	-	58	-	1	1841 975
	w/PowerFlite and Auto. 3 Speed Trans. LS1 except Sub.	8	-	-	58	-	1	1841 976
1-10-3	SWITCH, w/Std. Trans., D55-1, D55-2, D63-1, D63-2.	6-8	55	55-56	-	-	1	1343 998
	w/PowerFlite, D55-1, D55-2, D63-1, D63-2.	6-8	55	55-56	-	-	1	1603 328
1-10-17	BULB, 21 Cp., 6-8 voltage, D55-1, D55-2	6-8	55	55	-	-	2	142 308
	D63-1, D63-2	6-8	-	56	-	-	2	142 456
1-10-28	SPRING, Socket, D55-1, D55-2	6-8	55	55	-	-	2	44 758
1-10-34	CONTACT, Socket, D55-1, D55-2	6-8	55	55	-	-	2	657 572
1-10-47	GASKET, Switch Mounting, w/o Power-Flite, D55-1, D55-2, D63-1, D63-2.	6-8	-	55-56	-	-	1	1302 807
1-12-0 CIGAR LIGHTER PACKAGE								
NOTE:	For Components see Part Type Code 8-20-0							
1-12-1	PACKAGE	6-8	57-58	-	-	-	1	1770 761
1-13-0 UNDERHOOD LIGHT								
1-13-1	PACKAGE	6-8	56	56	56	56	1	1688 202
		6-8	57-58	57-58	57-58	57-58	1	*1770 734
1-13-5	BULB.	6-8	55	55	55	55	1	142 304
1-13-8	SOCKET, Bracket and Wires, Underhood Light	6-8	56	56	56	56	1	1704 280
		6-8	57	57	57	57	1	1770 830
1-13-10	SWITCH	6-8	55-56	55-56	55-56	55-56	1	1838 957
		6-8	58	58	58	58	1	1688 514
	Nut	6-8	55-56	55-56	55-56	55-56	2	120 368
1-14-0 MAP AND COURTESY LIGHT								
1-14-4	PACKAGE, Map and Courtesy Light.	6-8	-	57	-	-	1	1770 751
1-14-40	PACKAGE, Courtesy	6-8	55	55	-	-	1	1627 023
		6-8	57	57	-	-	1	1770 736
		6-8	58	58	-	-	1	1842 277

★ Indicates use as required. Numerals in parentheses () refer to notes. Printed in U.S.A.
 □ Indicates parts not listed in any previous parts book. Prices and specifications subject to change without notice.
 * Indicates change or addition. Page 1-11 Nov. 10, 1958 Supersedes Feb. 14, 1958.

CODE	PART NAME AND DESCRIPTION	NO. OF CYL.	PLYMOUTH	DODGE	DESOTO	CHRYSLER AND IMPERIAL	PER CAR	PART NUMBER
1-19-0 GLOVE COMPARTMENT LIGHT								
1-19-1	PACKAGE	6-8	56-58	56-58	-	-	1	*1648 614
	S27, LS1	8	-	-	57-58	-	1	1770 738
	Bulb, P26, D55-1, D55-2	6-8	55	55	-	-	1	115 273
	Bulb.	6-8	56	56	-	-	1	131 282
1-21-0 CLOCK								
1-21-1	PACKAGE, Steering Wheel Clock, Deluxe Wheel	6-8	57-58	-	-	-	1	1819 810
	PACKAGE, Steering Wheel Clock, S25, S26, C75, C76, LS2, LS3, LC1, LC2, LC3	8	-	-	57-58	57-58	1	1819 809
	Instrument Panel Clock	6-8	57-58	-	-	-	1	1770 722
		6-8	-	57-58	-	-	1	*1770 723
		8	-	-	57-58	-	1	1770 724
	LC1	8	-	-	-	58	1	1841 045
	Bulb.	6-8	-	56	56	56	1	127 934
1-21-5	SLEEVE, Wire Terminal	6-8	55-56	-	55	-	★	1264 933
1-21-7	CONNECTOR, Extension Feed Cable (triple)	6-8	55	55	-	-	1	657 560
	CONNECTOR, Extension Feed Cable	6-8	56	56	55-56	55-56	1	1658 840
1-21-8	NUT, Clock Reset Cable Mounting	6-8	58	-	-	-	1	898 504
1-21-9	SCREW, Clock (to housing)	8	56	-	56	-	1	1648 361
	STUD, Clock Mounting	8	56	-	-	-	2	946 934
	Instrument Panel Clock Mounting	8	-	-	56	-	2	1234 662
1-21-10	SPACER, Instrument Panel Clock Mounting	8	-	-	56	-	2	1704 479
1-21-12	CONTACT, Clock Lamp Socket, C75, C76	6-8	56-58	56-58	56-58	56-58	1	*657 572
1-21-19	BULB, Instrument Panel, 2 Cp., 6-8 voltage, C67	6-8	-	55	55	55	1	125 588
1-21-21	ADAPTER, Clock, to Instrument Panel Mounting	6-8	56	-	-	-	1	1658 080
1-21-22	SOCKET, Lamp	6-8	-	56-57	56-57	56	1	1605 517
		8	58	58	58	57-58	1	1689 538
1-21-24	KNOB, Instrument Panel Clock Reset	6-8	57	-	-	-	1	1300 611
		6-8	58	-	-	-	1	1819 269
1-21-30	FUSE, Instrument Panel Clock, C75	6-8	56	56	55-56	56-57	1	*150 836
		6-8	58	58	-	-	1	*149 559
1-23-0 OUTSIDE FINISH MOULDINGS								
1-23-1	PACKAGE, Sportone Moulding. Fender and Door Moulding, LP1-L, LP2-L, LP1-M, LP2-M	6-8	58	-	-	-	1	⊠1952 286
	PACKAGE, Spring Special, LS1 4 D., Sp. 4 D.	8	-	-	58	-	1	⊠1879 540
	LS1 Sp. Cl. Cp., Cv. Cp.	8	-	-	58	-	1	⊠1879 541
	LS1 4 D. Sub.	8	-	-	58	-	1	⊠1879 544
	LS2, LS3 4 D., Sp. 4 D.	8	-	-	58	-	1	⊠1879 542
	LS2, LS3 Sp. Cl. Cp., Cv. Cp.	8	-	-	58	-	1	⊠1879 543
	LS3 4 D. Sub.	8	-	-	58	-	1	⊠1879 545
	LC1 Sp. Cl. Cp., w/Special Two Tone Paint	8	-	-	-	58	1	⊠1879 249
	LC1 Sp. Cl. Cp., w/o Special Two Tone Paint	8	-	-	-	58	1	⊠1879 548
	LC1 Sp. 4 D., w/Special Two Tone Paint	8	-	-	-	58	1	⊠1879 551
	LC1 Sp. 4 D., w/o Special Two Tone Paint	8	-	-	-	58	1	⊠1879 550
	LC1 4 D. Sed., w/Special Two Tone Paint	8	-	-	-	58	1	⊠1879 553
	LC1 4 D. Sed., w/o Special Two Tone Paint	8	-	-	-	58	1	⊠1879 552
	LP2, LC3 3 P. Cp., Spring Special	8	-	-	-	58	1	⊠1879 554
	LC2, LC3 Sp. 4 D., Spring Special	8	-	-	-	58	1	⊠1879 555
	LC2, LC3 Cv. Cp., 4 D. Sed., Spring Special	8	-	-	-	58	1	⊠1879 556
	PACKAGE, Spring Special Side Mouldings and Medallions, LD1 Cl. Sed., LD2 Cl. Sed., Sp. Cl. Cp., Cv. Cp., LD3 Sp. Cl. Cp., Cv. Cp.	8	-	58	-	-	1	⊠1952 290
	LD1 4 D. Sed., LD2 4 D. Sed., Sp. 4 D., LD3 4 D. Sed., Sp. 4 D.	8	-	58	-	-	1	⊠1952 291

★ Indicates use as required. Numerals in parentheses () refer to notes. Printed in U.S.A.
 ⊠ Indicates parts not listed in any previous parts book. Prices and specifications subject to change without notice.
 Nov. 10, 1958 Supersedes Feb. 14, 1958 Page 1-12 * Indicates change or addition.

CODE	PART NAME AND DESCRIPTION	NO. OF CYL.	PLYMOUTH	DODGE	DESOTO	CHRYSLER AND IMPERIAL	PER CAR	PART NUMBER
	LP1-L, LP2-L, Cl.Sed., 3 Cp.	6-8	58	-	-	-	1	1865 730
	LP1-L, LP2-L, 4D.Sed.	6-8	58	-	-	-	1	1865 731
	LP1-M Cl.Sed., Sp. Cl. Cp., LP2-M Cl.Sed., Sp. Cl. Cp., LP1-H Cl.Sed., Sp. Cl. Cp., LP2-H Cl.Sed., Sp. Cl. Cp., Cv. Cp.	6-8	58	-	-	-	1	1865 732
	LP1-M, LP2-M, LP1-H, LP2-H, 4D.Sed., Sp. 4D.	6-8	58	-	-	-	1	1865 733
1-23-15	PACKAGE, Body Side Sill Moulding, LP1-H, LP2-H, except 4 D. Sub.	6-8	58	-	-	-	1	Ⓜ1952 287
	LP1-H, LP2-H, 4 D. Sub.	6-8	58	-	-	-	1	Ⓜ1952 288
1-23-45	PACKAGE, Fuel Tank Filler Opening C75, C76, LC1, LC2, LC3	6-8	57-58	-	-	-	1	1818 533
		6-8	-	57-58	57-58	57-58	1	1818 557
1-30-O TRUNK COMPARTMENT LAMP								
1-30-1	PACKAGE, D66, D67, D72, S25, S27, LS1, LS2, C75, LC1	6-8	57-58	57-58	57-58	57-58	1	1779 409
1-30-8	SWITCH, C67	6-8	55-56	55-56	-	55	1	1571 542
1-30-9	BULB, C67	6-8	55	55	-	55	1	142 447
1-31-O EXHAUST SYSTEM								
1-31-1	DEFLECTOR, Deluxe Tubular Exhaust, LD1 .	6-8	56	56-58	56	-	★	1603 368
	Super Deluxe Streamlined D66, D67, D72, LD1	6-8	56	56-58	56	-	★	Ⓜ1879 683
1-31-5	PACKAGE, Dual Exhaust, P31 except Sub., Cv. Cp.	8	57	-	-	-	1	1818 538
	D66, D67-1, except Cv. Cp.	8	-	57	-	-	1	1818 537
	LP2 except Sub.	8	58	-	-	-	1	1818 538
	LD2-L1, LD2-L2, Cl.Sed., Sp. Cl. Cp., 4D. Sed., Sp. 4D., LD2-M Sp. Cl. Cp., 4D.Sed., Sp. 4D.	8	-	58	-	-	1	1818 537
1-32-O VISOR								
1-32-2	VISOR, Tinted Plexiglass, Inside, Right . . .	6-8	57-58	57-58	57-58	57-58	1	1774 694
	Left.	6-8	57-58	57-58	57-58	57-58	1	1774 695
1-34-O FOG LIGHT								
1-34-4	LAMP, Assembly	6-8	56	-	56	56	2	1568 380
1-34-24	BULB, Sealed Beam Unit.	6-8	55	55	55	55	2	1436 959
1-34-29	SWITCH	6-8	55	55	55	55	1	688 080
		6-8	56	56	56	56	1	1661 758
1-34-38	CONNECTOR, Cable "Y"	6-8	55-56	55-56	55-56	55-56	1	689 867
1-34-41	SLEEVE, Cable Terminal	6-8	55-56	55-56	55-56	55-56	★	1264 933
1-39-O FUEL TANK LOCKING CAP								
1-39-2	CAP, w/KEYS, C75, C76, LC1, LC2, LC3 . .	6-8	57-58	57-58	57-58	57-58	1	1820 187
	LY1	8	-	-	-	58	1	1856 510
1-39-7	RING, Fuel Tank Filler Tube Locking Cap, Sub.	6-8	57-58	57-58	57-58	57-58	1	1820 205
1-42-O POWER BRAKE								
1-42-1	PACKAGE, C71	6-8	55-56	55-56	55-56	55-56	1	1603 252
	C75, C76, LC1, LC2, LC3	6-8	57-58	57-58	57-58	57-58	1	1818 530
1-45-O FENDER SKIRT								
1-45-1	PACKAGE, except Cv. Cp. and Sub.	6-8	57	-	-	-	1	*1752 676
	Except Cv. Cp. and Sub.	6-8	-	57	-	-	1	*1752 675
	Except Cv. Cp. and Sub.	6-8	58	-	-	-	1	*1752 676
	LD1, LD2, LD3-H Sp. 2 D., 4 D. Sed., Sp. 4D.	6-8	-	58	-	-	1	*1752 675

★ Indicates use as required.

Numerals in parentheses () refer to notes.

Printed in U.S.A.

Ⓜ Indicates parts not listed in any previous parts book.

Prices and specifications subject to change without notice.

* Indicates change or addition.

1955-58 PASSENGER CAR PARTS LIST

CODE	PART NAME AND DESCRIPTION	NO. OF CYL.	PLYMOUTH	DODGE	DESOTO	CHRYSLER AND IMPERIAL	PER CAR	PART NUMBER
------	---------------------------	-------------	----------	-------	--------	-----------------------	---------	-------------

1-48-0 HOT WATER HEATER AND COMPONENT PARTS

NOTE: For Heater and Air Conditioning Unit see Group 24 - Air Conditioning.

NOTE: For Gas Heater and Components see separate section on following pages.

1-48-1	HEATER PACKAGE, Model 705, C75, C76 . .	6-8	57	57	57	57	1	1819 043
	IM	8	-	-	-	57	1	1838 247
	LP1, LP2, LD1, LD2, LD3, LS1, LS2, LS3, LC1, LC2, LC3	6-8	58	58	58	58	1	1842 645
	LY1	8	-	-	-	58	1	1842 646

PART TYPE CODE	PART NAME	MODEL 700	MODEL 701	MODEL 702	MODEL 704	MODEL 705	UNDER-SEAT
----------------	-----------	-----------	-----------	-----------	-----------	-----------	------------

NOTE: Quantity is (1) per car unless otherwise indicated.

1-48-21	CONTROL PACKAGE, P30, P31	----	----	----	----	1819 044	----
	D66, D67, D70, D71, D72	----	----	----	----	1819 045	----
	S25, S26, S27	----	----	----	----	1819 046	----
	C75, C76, LC1, LC2, LC3	----	----	----	----	1819 047	----
	LP1, LP2	----	----	----	----	1842 647	----
	LD1, LD2, LD3	----	----	----	----	1842 744	----
	LS1, LS2, LS3	----	----	----	----	1842 745	----
1-48-36	STUD, Heater Temperature Fresh Air Vent Control Bezel Mounting (as req'd)	----	----	----	----	6010 020	----
1-48-45	HOUSING, Heater Blower	----	----	----	----	1753 158	----
1-48-46	WHEEL, Blower	1571 585	1571 585	1571 585	1571 585	1689 692	----
	Screw, Set.	139 011	139 011	139 011	139 011	139 011	----
1-48-70	PANEL, Control, P28, P29	----	----	1648 351	1648 351	----	----
	PANEL, Control Group Panel Mounting, except C70	----	----	1604 232	----	----	----
	D66, D67, D70, D71, D72, LD1, LD2, LD3	----	----	----	----	1838 050	----
	C75, C76, LC1, LC2, LC3	----	----	----	----	1819 363	----
	Trim Plate, C75, C76	----	----	----	----	1769 403	----
	Bezel, Heater Control, P30, P31, LP1, LP2	----	----	----	----	1769 348	----
	C75, C76, LC1, LC2, LC3	----	----	----	----	1769 402	----
	IM, LY1	----	----	----	----	1769 697	----
1-48-72	PLATE, Heater Temperature and Fresh Air Control, S25, S26, S27, LS1, LS2, LS3	----	----	----	----	1769 397	----
	LC1, LC2, LC3	----	----	----	----	1841 155	----
1-48-88	CORE, w/GASKET	1605 274	1605 274	1605 274	1605 274	1689 716	----
	C70	----	----	----	----	----	1648 955
	Nut (4 req.)	120 614	120 614	120 614	120 614	----	----
1-48-90	PAD or SEAL, Heater Core Shell (as req.)	1604 114	1604 116	1604 116	1604 116	1604 116	----
1-48-125	HOUSING, Engine Side	1605 276	1605 276	1605 276	1605 276	----	----
	Passenger Side	1648 062	1648 091	1648 062	1648 091	----	----
	Insulator and Gasket, Heater	----	----	----	----	1770 608	----
1-48-126	INSULATOR, Housing, Engine Side	1641 548	1641 548	1641 548	1641 548	----	----
	Nut (3 req.)	445 175	445 175	445 175	445 175	----	----
1-48-128	SCREW, Housing to Dash (21 req.)	925 353	925 353	925 353	925 353	----	----
	(12 req.)	----	----	----	----	1753 526	----
1-48-131	CONNECTOR, Heater Housing to Blower.	----	----	----	----	1689 674	----
1-48-137	DEFROSTER PACKAGE, Rear Shelf Panel	----	----	----	----	1819 775	----
1-48-141	DUCT, Heater Defroster, C75, C76, Right	----	----	----	----	1769 784	----
	Left	----	----	----	----	1769 785	----

* Indicates use as required.

Numerals in parentheses () refer to notes.

Printed in U.S.A.

⊠ Indicates parts not listed in any previous parts book.

Prices and specifications subject to change without notice.

Nov. 10, 1958 Supersedes Feb. 14, 1958.

* Indicates change or addition.

PART TYPE CODE	PART NAME	MODEL 700	MODEL 701	MODEL 702	MODEL 704	MODEL 705	UNDER-SEAT
----------------	-----------	-----------	-----------	-----------	-----------	-----------	------------

NOTE: Quantity is (1) per car unless otherwise indicated.

	Right, P30 UP TO Ser. No. 14377579, P31 UP TO Ser. No. 16305281	-----	-----	-----	-----	1769 784	-----
	Left, P30 UP TO Ser. No. 14393210, P31 UP TO Ser. No. 16349006	-----	-----	-----	-----	1769 785	-----
	Right, P30 AFTER Ser. No. 14377579, P31 AFTER Ser. No. 16305281, LP1, LP2, LD1, LD2, LD3, LS1, LS2, LS3, LC1, LC2, LC3	-----	-----	-----	-----	1838 312	-----
	Left, P30 AFTER Ser. No. 14393210, P31 AFTER Ser. No. 16349006, LP1, LP2, LD1, LD2, LD3, LS1, LS2, LS3, LC1, LC2, LC3	-----	-----	-----	-----	1838 317	-----
	DUCT, Heater Defroster, LY1, Right . .	-----	-----	-----	-----	E1879 916	-----
	Left	-----	-----	-----	-----	E1879 917	-----
1-48-151	TUBE, Defroster Rear Shelf	1540 102	1540 102	1540 102	1540 102	1540 102	-----
	Rear Shelf Panel Defroster	-----	-----	-----	-----	1540 102	-----
1-48-158	GRILLE, Defroster Rear Shelf Outlet . .	-----	-----	-----	-----	*1770 497	-----
	Inlet	-----	-----	-----	-----	*1819 018	-----
1-48-159	BEZEL, Rear Shelf Panel Defroster Inlet Grille	-----	-----	-----	-----	*1819 014	-----
1-48-175	CONTROL, Defroster, P26, P27	1622 721	1622 721	-----	-----	-----	-----
	P28, P29	-----	-----	-----	1648 627	-----	-----
	D66, D67, D70, D71, D72, LD1, LD2, LD3	-----	-----	-----	-----	1838 021	-----
	Screw, Clamp, P26, P27	155 043	155 043	-----	-----	-----	-----
	P28, P29	-----	-----	-----	*155 194	-----	-----
1-48-179	CLAMP, Defroster Control Cable Mounting Screw	-----	1308 130	-----	1308 130	-----	-----
	Nut	-----	132 915	-----	132 915	-----	-----
	CLAMP, Heater Distributing Duct Air Damper Control Cable	-----	120 614	-----	120 614	-----	-----
1-48-191	KNOB, Defroster Switch, P26, P27, P28, P29, S21, S22, S23, S24	1595 251	1595 251	1595 251	1595 251	-----	-----
	D55, D56, D62, D63	1595 258	-----	1595 258	-----	-----	-----
	P30, P31, LP1, LP2	-----	-----	-----	-----	1770 264	-----
	D66, D67, D70, D71, D72, LD1, LD2, LD3	-----	-----	-----	-----	1769 740	-----
	S25, S26, S27, LS1, LS2, LS3	-----	-----	-----	-----	1779 184	-----
	C75, C76, LC1, LC2, LC3	-----	-----	-----	-----	1704 764	-----
	IM, LY1	-----	-----	-----	-----	1753 289	-----
	Screw, Set	140 907	-----	140 907	-----	-----	-----
1-48-192	ESCUTCHEON, Defroster Control Mounting, D66, D67, D70, D71, D72, LD1, LD2, LD3	-----	-----	-----	-----	1689 717	-----
1-48-197	SPRING, Defroster Fan Switch Control Knob, P28, P29, S23, S24	-----	-----	1648 012	1648 012	1819 370	-----
1-48-202	WASHER, Defroster Control Lock	-----	1305 254	-----	1305 254	-----	-----
1-48-203	NUT, Defroster Control Mounting, D55, D56, D66, D67, D70, D71, D72, LD1, LD2, LD3	1439 758	-----	-----	-----	1439 758	-----
1-48-205	RETAINER, Defroster Control Gear and Stem, D66, D67, D70, D71, D72, LD1, LD2, LD3	-----	-----	-----	-----	1605 236	-----
1-48-208	SWIVEL, Heater Distribution Duct Air Damper Control Cable	-----	-----	-----	-----	1308 286	-----
1-48-209	SCREW, Defroster Control Swivel, P26, P27, D55, D56	988 098	988 098	-----	-----	-----	-----
	Washer	152 012	152 012	-----	-----	-----	-----
1-48-225	WHEEL, Defroster Blower	1605 395	1605 395	1605 395	1605 395	-----	-----
	Screw, Set	140 882	140 882	139 011	139 011	-----	-----
	WHEEL, Rear Shelf Defroster Blower . .	-----	-----	-----	-----	1239 241	-----

* Indicates use as required. Numerals in parentheses () refer to notes. Printed in U.S.A.
 E Indicates parts not listed in any previous parts book. Prices and specifications subject to change without notice.
 * Indicates change or addition. Page 1-15 Nov. 10, 1958 Supersedes Feb. 14, 1958.

1955-58 PASSENGER CAR PARTS LIST

PART TYPE CODE	PART NAME	MODEL 700	MODEL 701	MODEL 702	MODEL 704	MODEL 705	UNDER-SEAT
----------------	-----------	-----------	-----------	-----------	-----------	-----------	------------

NOTE: Quantity is (1) per car unless otherwise indicated.

1-48-228	SCREW, Defroster Motor and Wheel to Housing (3 req.)	-----	-----	925 353	-----	-----	-----
	Rear Shelf Panel Defroster Blower Mounting, Plate Mounting, LC1, LC2, LC3	-----	-----	-----	-----	1331 768	-----
1-48-235	LOUVER, Defroster Outlet (2 req.)	-----	-----	-----	-----	1753 582	-----
	LP1, LP2 (2 req.)	-----	-----	-----	-----	*1880 627	-----
1-48-236	ADAPTER, Defroster Outlet Louver Bezel (2 req.)	-----	-----	-----	-----	1753 579	-----
1-48-237	BRACKET, Heater Defroster Outlet Louver Bezel Mounting, (2 req.)	-----	-----	-----	-----	E1838 028	-----
1-48-239	RETAINER, Louver Adapter (2 req.)	-----	-----	-----	-----	1689 670	-----
1-48-240	CLIP, Heater Defroster Outlet Louver Retaining, LP1, LP2, (3 req.)	-----	-----	-----	-----	*1842 965	-----
1-48-263	SWIVEL, Defroster Damper Lever	-----	1308 286	-----	1308 286	-----	-----
	Screw	-----	122 159	-----	122 159	-----	-----
	Washer	-----	152 012	-----	152 012	-----	-----
1-48-264	HOUSING, Rear Shelf Panel Defroster Blower	-----	-----	-----	-----	1819 470	-----
1-48-267	CLAMP, Heater Distribution Duct Cable Mounting (2 req.)	-----	-----	-----	-----	1770 371	-----
1-48-268	MOTOR, Defroster	1653 365	1653 365	1653 367	1653 367	-----	-----
	Rear Shelf Panel	-----	-----	-----	-----	1770 214	-----
	Nut (3 req.)	120 614	120 614	120 614	120 614	-----	-----
1-48-269	GASKET, Defroster Motor to Mounting Bracket	1641 905	1641 905	1641 905	1641 905	-----	-----
1-48-270	PLATE, Defroster Blower Motor Mounting, w/GASKET	1605 389	1605 389	1605 389	1605 389	-----	-----
1-48-271	ARMATURE, Defroster Blower Motor, For Motor stamped part No. 1605 379	1605 597	-----	-----	-----	-----	-----
	For Motor stamped part No. 1605 383	-----	-----	1658 586	-----	-----	-----
1-48-272	BRUSH SET, Defroster Motor. For Motor stamped part No. 1658 201	-----	-----	1297 877	-----	-----	-----
	For Motor stamped part No. 1658 200	-----	-----	1300 662	-----	-----	-----
	PACKAGE, Defroster Blower Motor Brush and Spring. For Motors stamped part Nos. 1605 379, 1605 383 and 1605 375	1605 595	-----	1605 595	1605 595	-----	-----
	For Motors stamped part Nos. 1605 383, 1658 198, 1605 375 and 1658 202	-----	-----	1658 587	1658 587	-----	-----
	PACKAGE, Rear Shelf Panel Defroster Motor Brush and Spring. For Motor stamped part No. 1770 214 D66, D67, D72, LD1, LD2, LD3, S25, S26, S27, LS1, LS2, LS3, C75, C76, LC1, LC2, LC3, IM, LY1	-----	-----	-----	-----	1841 382	-----
1-48-273	BRUSH, Defroster Blower Motor. For Motors stamped part Nos. 1605 379, 1605 375 and 1605 383 (2 req.)	1605 594	-----	1605 594	1605 594	-----	-----
1-48-275	SPRING, Defroster Motor Brush. For Motors stamped part Nos. 1571 617 and 1658 200	1237 244	1237 244	1237 244	-----	-----	-----
	For Motor stamped part No. 1658 201	-----	-----	1300 660	-----	-----	-----
1-48-276	WASHER, Defroster Motor Commutator End Arm. For Motors stamped part Nos. 1605 379 and 1658 202 (as req.)	1605 589	-----	-----	1605 589	-----	-----

★ Indicates use as required.

Numerals in parentheses () refer to notes.

Printed in U.S.A.

☐ Indicates parts not listed in any previous parts book.

Prices and specifications subject to change without notice.

Nov. 10, 1958 Supersedes Feb. 14, 1958.

* Indicates change or addition.

PART TYPE CODE	PART NAME	MODEL 700	MODEL 701	MODEL 702	MODEL 704	MODEL 705	UNDER-SEAT
NOTE: Quantity is (1) per car unless otherwise indicated.							
1-48-300	SWITCH, Defroster, D62, D63	----	----	1627 482	----	----	----
	C70	1605 477	----	----	----	----	----
	C71, C72, C73	----	----	1605 477	----	----	----
	Rear Window, w/o Nut	----	----	----	----	1779 862	----
1-48-309	NUT, Defroster Switch Mounting	1439 758	1439 758	1439 758	1439 758	1439 758	----
	Heater Defroster Switch Mounting, Rear Window (2 req'd.)	----	----	----	----	1688 542	----
1-48-310	BRACKET, Defroster Switch Mounting, C67, C68, C69, C71, C72, C73	1595 311	----	1595 311	----	----	----
	Screw (as req.)	132 825	----	132 825	----	----	----
1-48-323	GROMMET, Heater Outlet Tube	----	----	----	----	11838 035	----
1-48-341	CLAMP, Heater Distribution Duct Inlet Damper Control Cable	----	----	----	----	1308 130	----
	CLIP, Heater Temperature Cable and Inlet Damper Cable, LC1, LC2, LC3, LY1	----	----	----	----	1263 079	----
1-48-345	SWIVEL, Heater Distribution Duct Inlet Damper Control Cable	----	----	----	----	1308 286	----
1-48-351	GASKET, Heater Intake, C70	----	----	----	----	----	1648 220
1-48-352	FAN, Heater, C70	----	----	----	----	----	1648 954
1-48-365	DOOR, Fresh Air, Right	1605 397	1605 397	1605 397	1605 397	----	----
	Left	1605 398	1605 398	1605 398	1605 398	----	----
	Complete	----	----	----	----	1772 556	----
	Partial	----	----	----	----	1771 892	----
1-48-366	GASKET, Fresh Air Door, Right	1605 347	1605 347	1605 347	1605 347	----	----
	Left	1605 348	1605 348	1605 348	1605 348	----	----
	Door Frame	----	----	----	----	1698 354	----
	Fresh Air Door Frame, w/o Air Cond. LY1	----	----	----	----	1698 354	----
1-48-369	BRACE, Fresh Air Door Hinge Support, Right	1605 530	1605 530	1605 530	1605 530	----	----
	Left	1605 531	1605 531	1605 531	1605 531	----	----
	Nut (as req.)	120 367	120 367	120 367	120 367	----	----
	Washer (as req.)	121 753	121 753	121 753	121 753	----	----
	Washer (as req.)	120 392	120 392	120 392	120 392	----	----
1-48-370	PIN, Fresh Air Door Hinge (2 req.)	----	----	----	----	6006 092	----
1-48-381	WASHER, Fresh Air Door Control lever Pivot Pin Spring (2 req.)	*6015 004	*6015 004	*6015 004	*6015 004	----	----
1-48-384	PAD, Fresh Air Door Control Lever (2 req.)	1688 308	1688 308	1688 308	1688 308	----	----
	P30, P31, D66, D67, D70, D71, D72, IM C75, C76	----	----	----	----	1688 308	----
		----	----	----	----	1771 850	----
1-48-387	ARM, Fresh Air Door, w/PEDAL	----	----	----	----	1771 894	----
1-48-388	NUT, Fresh Air Door, w/WASHER (4 req.)	----	----	----	----	1772 533	----
1-48-555	HOSE, Heater to Pump (50 foot roll) (as req'd.)	1315 466	1315 466	1315 466	1315 466	1315 466	----
	Valve to Heater	1605 532	1605 532	1605 532	1605 532	1779 885	----
	Engine to Valve, except P31, LP1, LD1	1595 160	1595 160	1595 160	1595 160	1595 160	----
	Engine to Valve, P31. LP2	----	----	----	----	1779 886	----
	Housing Drain, Engine Side	----	----	1605 270	1605 270	----	----
1-48-558	CLIP, Heater Hose, except C67, C68, C69, C70, C71, C72, C73 (as req.)	1302 783	----	1302 783	1302 783	1302 783	----
	C67, C68, C69, C70, C71, C72, C73	869 789	----	869 789	----	----	----
1-48-559	CLAMP, Hose (6 req.)	870 469	870 469	870 469	870 469	870 469	----
	CLAMP PACKAGE, Universal Hose - Small (50 per pkg.)	1450 499	1450 499	1450 499	1450 499	1450 499	----
1-48-572	NIPPLE, Hose Inlet, P28, P29	*1779 257	*1779 257	1688 913	1688 913	----	----
	P30, P31, D72, C75, C76, IM	*1779 257	*1779 257	----	----	1779 258	----
	D66, D67, D70, D71, S25, S26, S27	*1779 257	*1779 257	----	----	1779 257	----
	Heater Hose Inlet, from Pump, LP1, LP2, LD1	----	----	----	----	1779 258	----

★ Indicates use as required. Numerals in parentheses () refer to notes. Printed in U.S.A.
 □ Indicates parts not listed in any previous parts book. Prices and specifications subject to change without notice.
 * Indicates change or addition. Page 1-17 Nov. 10, 1958 Supersedes Feb. 14, 1958.

1955-58 PASSENGER CAR PARTS LIST

PART TYPE CODE	PART NAME	MODEL 700	MODEL 701	MODEL 702	MODEL 704	MODEL 705	UNDER-SEAT
NOTE: Quantity is (1) per car unless otherwise indicated.							
	Heater Hose Return, LP1, LD1, LC1, LC2, LC3					1779 258	
	Heater Hose Return, LD2, LD3, LS1, LS2, LS3.					1779 257	
	Heater Hose Inlet, LD2, LD3, LS1.					1779 257	
1-48-575	ELBOW, Hose Inlet, except C67, C68, C69, C70, C71, C72, C73	1594 611	1594 611		1594 611		
	C67, C68, C69, C70, C71, C72, C73	1605 495		1605 495			
	D66, D67, D70, D71, LD2, S27.					1779 861	
	S25, S26, C75, C76, LC1, LC2, LC3, IM, LY1					1838 024	
	Hose Return, except C67, C68, C69, C70, C71, C72, C73	1436 113	1436 113	1436 113	1436 113		
	C67, C68, C69, C70, C71, C72, C73.	1605 496		1605 496			1605 496
	P31, LP2					1779 259	
	D66, D67, D70, D71, S27					1779 257	
	Heater Hose Inlet, S25 UP T J Ser. No. 5535372, S26 UP TO Ser. No. 5041125					1605 495	
	Heater Hose Return, C76-300, LC3-300.					1605 496	
1-48-599	MOTOR, Heater Blower, P26, P27, D55, D56, S21, S22, C67, C68, C69.	1653 364	1653 364				
	P28, P29, D62, D63, S23, S24, C70, C71, C72, C73			1653 366	1653 366		
	C70						1648 225
	w/TUBE.					1752 276	
	Nut (2 req.)	120 614	120 614	120 614	120 614		
1-48-608	GASKET, Motor to Mounting Bracket			1641 905	1641 905		
1-48-611	PLATE, Heater Blower Motor Mounting, w/GASKET.	1594 904		1594 904	1594 904	1753 165	
	Screw (3 req.)	180 022		180 022	180 022		
	Washer (3 req.)	120 392		120 392	120 392		
1-48-613	STUD or SCREW, Heater Blower Motor Mounting (3 req.)	925 353	925 353	925 353	925 353	925 353	
	Washer (3 req.)	120 392	120 392	120 392	120 392	120 392	
1-48-615	BRUSH SET, Heater Blower Motor. For Motors stamped part Nos. 1595 277, 1571 609 and 1658 393	1658 609	1658 609	1658 609	1658 609		
	For Motors stamped part Nos. 1595 276, 1571 610 and 1658 203.	1297 877	1297 877	1297 877	1297 877		
	For Motors stamped part Nos. 1571 611, 1622 527, 1658 204 and 1658 205	1300 662	1300 662	1300 662	1300 662		
	For Motor stamped part No. 1689 714					1841 385	
	BRUSH and SPRING PACKAGE, Heater Blower Motor. For Motors stamped part Nos. 1605 374, 1605 375, 1605 383 and 1689 684.	1605 595	1605 595	1605 595	1605 595	1605 595	
	For Motor stamped part No. 1658 202.						1658 587
	PACKAGE, Heater Blower Motor Brush and Spring, for Motor stamped part No. 1689 714					1841 385	
1-48-617	BRUSH, Heater Blower Motor. For Motors stamped part Nos. 1605 374, 1605 375 and 1605 383 (2 req.)	1605 594	1605 594	1605 594	1605 594		
1-48-618	HOLDER, Heater Blower Motor. For Motor stamped part No. 1689 714 (2 req.)					1571 034	
	C70 (2 req.)						1495 160

★ Indicates use as required. Numerals in parentheses () refer to notes. Printed in U.S.A.
 ☐ Indicates parts not listed in any previous parts book. Prices and specifications subject to change without notice.
 Nov. 10, 1958 Supersedes Feb. 14, 1958. Page 1-18 * Indicates change or addition.

PART TYPE CODE	PART NAME	MODEL 700	MODEL 701	MODEL 702	MODEL 704	MODEL 705	UNDER-SEAT
NOTE: Quantity is (1) per car unless otherwise indicated.							
1-48-620	SPRING, Heater Blower Motor Brush, For Motors stamped part Nos. 1571 609, 1595 277, 1658 392 and 1658 393 (2 req.)	1383 839	1383 839	1383 839	1383 839	----	----
	For Motors stamped part Nos. 1571 610, 1595 276 and 1658 203 (2 req.)	1300 660	1300 660	1300 660	1300 660	----	----
	For Motors stamped part Nos. 1571 611, 1622 527 and 1658 204 (2 req.)	1237 244	1237 244	1237 244	1237 244	----	----
	For Motor stamped part No. 1689 714 (2 req.)	----	----	----	----	1571 033	----
1-48-622	HEAD, Blower Commutator End, For Motor stamped part No. 1689 684, P30, P31	----	----	----	----	1818 881	----
1-48-640	ARMATURE, Heater Blower Motor, For Motors stamped part Nos. 1605 374 and 1658 175	1605 593	1605 593	----	1605 593	----	----
	For Motor stamped part No. 1689 684, P30, P31	----	----	----	----	1818 879	----
1-48-641	WASHER, Heater Blower Motor Commutator End Arm. For Motors stamped part Nos. 1605 374, 1605 375 and 1605 383 (as req.)	1605 589	1605 589	1605 589	1605 589	----	----
1-48-643	COIL, Blower Complete Field, For Motor stamped part No. 1689 684, P30, P31	----	----	----	----	1818 882	----
1-48-644	HEAD, Blower Drive End, For Motor stamped part No. 1689 684, P30, P31	----	----	----	----	1818 880	----
1-48-645	BOLT, Blower Thru, For Motor stamped part No. 1689 684, P30, P31	----	----	----	----	1818 886	----
1-48-646	TUBE, Heater Blower Motor Cooling	----	----	----	----	1753 174	----
1-48-651	CLIP, Cable, on Heater Duct (2 req.)	1308 484	1308 484	1308 484	1308 484	----	----
1-48-656	CONNECTOR, Motor Wire	1310 489	1310 489	1310 489	1310 489	----	----
1-48-679	SPACER, Heater Blower Mounting Grommet (3 req.)	1483 733	1483 733	----	----	----	----
1-48-684	GROMMET, Heater Blower Mounting (3 req.)	1540 195	1540 195	----	----	----	----
1-48-707	DUCT, Heater Distribution, P30, P31, LP1, LP2, D66, D67, D70, D71, D72, LD1, LD2, LD3, S25, S26, S27, LS1, LS2, LS3, C75, C76, LC1, LC2, LC3 Side Cowl Duct, IM, LY1	----	----	----	----	1769 841 *1885 810	----
1-48-708	LEVER and PIN, Heater Distribution Duct Air Damper	----	----	----	----	1770 369	----
1-48-713	GRILLE, Heater Duct, w/FILLER, IM	----	----	----	----	1819 029	----
1-48-725	CABLE, Heater Distribution Duct Air Damper Control, w/HOUSING, P30, P31, C75, C76, IM	----	----	----	----	1779 766	----
	D66, D67, D72, UP TO Note 1	----	----	----	----	1779 764	----
	D66, D67, D72, AFTER Note 1, D70, D71, All	----	----	----	----	1779 766	----
	CABLE and HOUSING, Heater Distributing Duct Air Damper Control, LP1, LP2, LD1, LD2, LD3, LC1, LC2, LC3, LY1 LS1, LS2, LS3	----	----	----	----	1779 766 1779 764	----

NOTE 1: D66 Ser. No. 35187949
D72 Ser. No. 32259644

D67 Ser. No. 37255607

★ Indicates use as required.

Numerals in parentheses () refer to notes.

Printed in U.S.A.

☐ Indicates parts not listed in any previous parts book.

Prices and specifications subject to change without notice.

* Indicates change or addition

1955-58 PASSENGER CAR PARTS LIST

PART TYPE CODE	PART NAME	MODEL 700	MODEL 701	MODEL 702	MODEL 704	MODEL 705	UNDER-SEAT
NOTE:	Quantity 1 per vehicle unless otherwise indicated.						
1-48-730	SCREW, Heater Distribution Duct Mounting (3 req.)	----	----	----	----	1819 921	----
1-48-747	SCREW, Heater Distribution Duct Air Damper Shaft to Duct Mounting, w/WASHER	----	----	----	----	1770 484	----
1-48-749	WASHER, Heater Distribution Duct Air Damper Shaft Mounting	----	----	----	----	6015 004	----
1-48-770	SWITCH, Heater Blower Motor	----	1622 731	----	----	----	----
	Heater and Defroster, P26, P27	1604 943	----	----	1648 736	1648 546	----
	P28, P29	----	----	1648 736	1648 546	----	----
	D55, D56	1604 442	----	1627 482	----	----	----
	D62, D63	----	----	1627 479	----	----	----
	S21, S22, S23, S24	1604 942	----	1605 477	----	----	----
	C67, C68, C69	1595 145	----	----	----	----	----
	C70, C71, C72, C73	1605 477	----	----	----	----	----
	P30, P31, LP1, LP2	----	----	----	----	1779 040	----
	D66, D67, D70, D71, D72, LD1, LD2, LD3	----	----	----	----	1770 176	----
	S25, S26, S27, LS1, LS2, LS3	----	----	----	----	1819 831	----
	C75, C76, LC1, LC2, LC3	----	----	----	----	1779 041	----
	IM, LY1	----	----	----	----	1779 036	----
	On Left Rear Arm Rest, C70	----	----	----	----	----	1648 357
1-48-773	ESCUTCHEON, Heater Blower Switch Mounting, D66, D67, D70, D71, D72, LD1, LD2, LD3	----	----	----	----	1689 717	----
1-48-779	NUT, Heater Switch and Defroster Control Mounting, P26, P27, P28, P29, P30, P31, S21, S22, S23, S24, S25, S26, S27, C75, C76, IM	*6008 070	*6008 070	*6008 070	*6008 070	*6008 070	----
	D55, D56, D62, D63, D66, D67, D70, D71, D72, C67, C68, C69, C70, C71, C72, C73	1439 758	----	1439 758	----	1439 758	1439 758
	Heater Blower Switch Mounting, LD1, LD2, LD3	----	----	----	----	1439 758	----
	LC1, LC2, LC3, LY1	----	----	----	----	6008 070	----
1-48-780	BRACKET, Switch Mounting, C67, C68, C69, C70, C71, C72, C73	1595 311	----	1595 311	----	----	----
1-48-785	ARM, Heater and Defroster Switch Control, C67, C68, C69, C70, C71, C72, C73 (2 req.)	1622 509	----	1622 509	----	----	----
1-48-786	FOLLOWER, Heater Switch Control Arm (2 req.)	----	----	1622 511	----	----	----
1-48-801	KNOB, Heater Switch Control, P26, P27, P28, P29, S21, S22, S23, S24	1595 254	1595 254	1595 254	1595 254	----	----
	Heater and Defroster Switch, D55, D56, D62, D63 (2 req.)	1595 258	----	1595 258	----	----	----
	C67, C68, C69, C70, C71, C72, C73 (3 req.)	1604 321	----	1604 321	----	----	----
	Heater Switch Control, P30, P31, LP1, LP2	----	----	----	----	1770 531	----
	Temperature Control, D66, D67, D70, D71, D72, LD1, LD2, LD3	----	----	----	----	1769 739	----
	S25, S26, S27, LS1, LS2, LS3	----	----	----	----	1770 902	----
	Blower Switch, C75, C76, LC1, LC2, LC3	----	----	----	----	1704 425	----
	IM, LY1	----	----	----	----	1753 849	----
1-48-832	RESISTOR, Switch, C70	----	----	----	----	----	1648 692
1-48-854	VALVE, Temperature Control Water Shut-Off, C70	1688 946	1688 946	1688 946	1688 946	1819 516	670 647
1-48-858	GASKET, Temperature Control Mounting	1641 674	1641 674	1641 674	1641 674	1641 674	----

★ Indicates use as required.

Numerals in parentheses () refer to notes.

Printed in U.S.A.

⊠ Indicates parts not listed in any previous parts book.

Prices and specifications subject to change without notice.

Nov. 10, 1958 Supersedes Feb. 14, 1958.

* Indicates change or addition.

PART TYPE CODE	PART NAME	MODEL 700	MODEL 701	MODEL 702	MODEL 704	MODEL 705	UNDER-SEAT
NOTE: Quantity is (1) per car unless otherwise indicated.							
1-48-860	RETAINER, Temperature Control Valve Mounting Gasket, P26, P27, P28, P29, D55, D56, D62, D63	1819 514	1819 514	1819 514	1819 514	1819 514	----
	S21, S22, S23, S24, C67, C68, C69, C70, C71, C72, C73	1641 673	1641 673	1641 673	1641 673	1819 514	----
1-48-928	HOLDER, Heater Wiring Fuse, LS1, LD1, LD2, LD3	----	----	----	----	*1885 608	----
1-48-934	ARM, Temperature Control, w/BRACKET, S25, S26, S27, LS1, LS2, LS3	----	----	----	----	1770 902	----
	C67, C68, C69, C70, C71, C72, C73	1604 261	----	1604 261	----	----	----
1-48-938	WASHER, Temperature Control Body to Gear	1305 254	1305 254	1305 254	1305 254	----	----
	Temperature Control Body to Gear.	1305 254	1305 254	1305 254	1305 254	----	----
1-48-940	CONTROL, Temperature, P26, P27.	1605 232	1605 232	----	----	----	----
	P28, P29	----	----	1648 345	1648 345	----	----
	P30, P31, LP1, LP2	----	----	----	----	1819 876	----
	D55, D56, D62, D63	1605 516	----	1605 516	----	----	----
	S21, S22, S23, S24	1605 231	----	1605 231	----	----	----
	S25, S26, S27, LS1, LS2, LS3	----	----	----	----	1769 365	----
	D66, D67, D70, D71, D72, LD1, LD2, LD3, IM	----	----	----	----	1769 364	----
	C75, C76, LC1, LC2, LC3, LY1.	----	----	----	----	1769 364	----
1-48-941	CABLE, Temperature Control, except IM, LY1	1626 983	1626 983	1626 983	1626 983	1779 758	----
	IM, LY1	----	----	----	----	1819 748	----
1-48-942	KNOB, Temperature Control, P26, P27, P28, P29, S21, S22, S23, S24	1595 266	1595 266	1595 266	1595 266	----	----
	D55, D56, D62, D63	1622 461	----	1622 461	----	----	----
	S25, S26, S27, LS1, LS2, LS3	----	----	----	----	1769 556	----
	P30, P31, LP1, LP2	----	----	----	----	1770 297	----
	D66, D67, D70, D71, D72, LD1, LD2, LD3, C75, C76, LC1, LC2, LC3	----	----	----	----	1769 479	----
	IM, LY1 (2 req'd)	----	----	----	----	1769 481	----
1-48-950	CLAMP, Temperature Control Cable, D55, D56, D62, D63, C67, C68, C69, C71, C72, C73.	1308 130	----	1308 130	----	----	----
	Control Valve Cable	----	----	----	----	1770 371	----
1-48-952	PIVOT, Temperature Control Arm	1308 286	1308 286	1308 286	1308 286	----	----
1-48-953	SCREW, Temperature Control Arm Pivot	988 098	988 098	988 098	988 098	----	----
	Temperature Control Swivel, P26, P27	1622 625	1622 625	----	----	----	----
1-48-958	CLIP, Heater Temperature Control Cable Support, LS1, LS2, LS3	----	----	----	----	1819 335	----
	LP1, LP2, LC1, LC2, LC3, LY1	----	----	----	----	1302 783	----
1-48-970	RETAINER, Heater Temperature Control Gear and Stem	1605 236	1605 236	1605 236	1605 236	1605 236	----

CODE	PART NAME AND DESCRIPTION	NO. OF CYL.	PLYMOUTH	DODGE	DESOTO	CHRYSLER AND IMPERIAL	PER CAR	PART NUMBER
------	---------------------------	-------------	----------	-------	--------	-----------------------	---------	-------------

NOTE: For heater and air conditioning unit see group 24 - Air Conditioning.

NOTE: For hot water heater and components see separate section on preceding pages.

1-48-1	HEATER, Model 800	8	-	-	56	56	1	1688 409
	Model 801	8	-	-	57	57	1	1769 597
	Model 803	8	-	-	57-58	57-58	1	1841 296

★ Indicates use as required.

Numerals in parentheses () refer to notes.

Printed in U.S.A.

☐ Indicates parts not listed in any previous parts book.

Prices and specifications subject to change without notice.

* Indicates change or addition.

PART TYPE CODE	PART NAME	MODEL 800	MODEL 801	MODEL 803
NOTE: Quantity is (1) per car unless otherwise indicated.				
1-48-36	STUD, Heater Temperature and Fresh Air Vent Control Housing Mounting (as req'd.)	----	----	*6010 020
1-48-45	HOUSING, Heater Blower	----	*1753 158	*1753 158
1-48-46	WHEEL, Blower	1571 585	1689 692	*1689 692
	Screw, set	139 011	----	----
1-48-66	SWIVEL, Heater Dist. Duct Inlet Damper Shaft Lever, LC1, LC2, LC3, LY1	----	----	*1308 286
1-48-70	PANEL, Control Group Panel Mounting, except C70	1604 232	----	----
	BEZEL, Heater Control, C75, C76, LC1, LC2, LC3	----	1769 402	*1769 402
	IM, LY1	----	1769 697	*1769 697
	Housing, C75, C76, LC1, LC2, LC3	----	1819 363	*1819 363
1-48-72	PLATE, Heater Temperature and Fresh Air Control, S25, S26, S27, LS1, LS2, LS3	----	1769 397	*1769 397
	LC1, LC2, LC3	----	----	*1841 155
1-48-92	SCREW, Ground to Dash, except C70	925 353	----	----
1-48-125	HOUSING, Passenger Side	1688 433	----	----
	Engine Side	1688 412	----	----
1-48-126	INSULATOR, Housing	1641 548	----	----
1-48-128	SCREW, Heater Mounting (as req.)	925 353	1753 526	*1838 158
1-48-133	ADAPTER, Heater Housing to Heater	1688 422	----	----
1-48-141	DUCT, Heater Defroster, C75, C76, Right	----	1769 784	----
	Left	----	1769 785	----
	LS1, LS2, LS3, LC1, LC2, LC3, Right	----	----	*1838 312
	Left	----	----	*1838 317
1-48-151	TUBE, Defroster, Rear Shelf	1540 102	----	----
1-48-191	KNOB, Defroster Switch, S23, S24	1595 251	----	----
	S25, S26, S27, LS1, LS2, LS3	----	1779 184	*1779 184
	C75, C76, LC1, LC2, LC3	----	1704 764	*1704 764
	IM, LY1	----	1753 289	*1753 289
1-48-197	SPRING, Defroster Fan Switch Control Knob, S23, S24	1648 012	1819 370	*1819 370
1-48-225	WHEEL, Defroster Blower	1605 395	----	----
	Screw, set	139 011	----	----
1-48-228	SCREW, Blower Wheel to Housing (3 req.)	925 353	----	----
1-48-235	LOUVER, Heater Defroster Outlet (2 req.)	----	1753 582	----
1-48-236	ADAPTER, Heater Defroster Outlet Louver Bezel, w/BACKET (2 req.)	----	1753 579	----
1-48-239	RETAINER, Louver Adapter (2 req.)	----	1689 670	----
1-48-267	CLAMP, Heater Duct Cable (2 req.)	----	1770 371	*1770 371
1-48-268	MOTOR, Defroster	1653 367	----	----
1-48-269	GASKET, Defroster Motor Mounting	1641 905	----	----
1-48-270	PLATE, Defroster Blower Motor Mounting, w/GASKET	1605 389	----	----
1-48-272	BRUSH SET, Defroster Motor, for Motors stamped part Nos. 1658 201, 1692 660	1297 877	----	----
	For Motor stamped part No. 1658 200	1300 662	----	----
	BRUSH and SPRING PACKAGE, for Motor stamped part No. 1605 383	1605 595	----	----
	For Motors stamped part Nos. 1605 383, 1658 198 and 1658 202	1658 587	----	----
1-48-273	BRUSH, Defroster Blower Motor, for Motor stamped part No. 1605 383 (2 req.)	1605 594	----	----
1-48-275	SPRING, Defroster Motor Brush, for Motor stamped part No. 1658 200	1237 244	----	----
	For Motor stamped part No. 1658 201	1300 660	----	----
1-48-300	SWITCH, Defroster, except C70	1605 477	----	----
1-48-309	NUT, Defroster Switch Mounting, except C70	1439 758	----	----
1-48-310	BRACKET, Defroster Switch Mounting, except C70	1595 311	----	----
1-48-341	CLIP, Heater Temperature Cable and Inlet Damper Cable, LC1, LC2, LC3, LY1	----	----	----
1-48-365	DOOR, Fresh Air, Right	1605 397	----	----
	Left	1605 398	----	----
	Complete	----	1772 556	----
	Partial	----	1771 892	----

★ Indicates use as required. Numerals in parentheses () refer to notes. Printed in U.S.A.
 □ Indicates parts not listed in any previous parts book. Prices and specifications subject to change without notice.
 Feb. 14, 1958 Supersedes Oct. 10, 1957. Page 1-22 * Indicates change or addition.

PART TYPE CODE	PART NAME	MODEL 800	MODEL 801	MODEL 803
NOTE: Quantity is (1) per car unless otherwise indicated.				
1-48-366	GASKET, Fresh Air Door, Right.	1605 347	----	----
	Left.	1605 348	----	----
	Fresh Air Door Frame, LY1.	----	1698 354	----
1-48-369	BRACE, Fresh Air Door Hinge Support, Right	1605 530	----	----
	Left.	1605 531	----	----
1-48-370	PIN, Fresh Air Door Hinge (2 req.).	----	6006 092	----
1-48-384	PAD, Fresh Air Door Control Lever (2 req.)	1688 308	----	----
	C75, C76	----	1771 850	----
1-48-387	ARM, Fresh Air Door, w/PEDAL	----	1771 894	----
1-48-388	NUT, Fresh Air Door, w/WASHER (4 req.)	----	1772 533	----
1-48-555	HOSE, Heater Housing Drain	1605 270	----	----
	Heater Burner Blower.	1688 832	----	----
1-48-558	CLIP, Hose to Spark Plug Cover Screw, S23, S24, S25, S26, S27, C75, C76, IM	1302 783	1302 783	----
1-48-559	CLAMP, Hose (6 req.)	870 469	870 469	----
	CLAMP PACKAGE, Universal Hose - Small (50 per pkg.)	1450 499	1450 499	----
1-48-599	MOTOR, Heater Blower	1653 366	1752 276	1752 276
1-48-608	GASKET, Motor Mounting	1641 905	----	----
1-48-611	PLATE, Blower Motor Mounting, w/GASKET	1594 904	----	1753 165
1-48-613	STUD, Heater Blower Motor Mounting (3 req.)	925 353	925 353	925 353
1-48-615	BRUSH SET, Blower Motor, for Motor stamped part No. 1658 393	1658 609	----	----
	For Motors stamped part Nos. 1658 203, 1692 660, 1843 327, 1841 334	1297 877	----	1297 877
	For Motors stamped part Nos. 1658 204 and 1658 205.	1300 662	----	----
	Heater Blower and Fuel Pump Motor, for Motor stamped part No. 1688 440 (2 req.)	1297 877	----	----
	BRUSH and SPRING PACKAGE, for Motor stamped part No. 1605 383	1605 595	----	----
1-48-617	BRUSH, Blower Motor, for Motor stamped part No. 1605 383 (2 req.)	1605 594	----	----
1-48-618	HOLDER, Blower Motor Brush, for Motors stamped part Nos. 1658 201, 1658 203, 1605 381, 1688 440, 1692 660, 1843 327, 1841 334	1495 160	----	1495 160
1-48-620	SPRING, Blower Motor Brush, for Motor stamped part No. 1658 393	1383 839	----	----
	For Motors stamped part Nos. 1658 203, 1692 660, 1843 327, 1841 334 (2 req.)	1300 660	----	1300 660
	For Motor stamped part No. 1658 204 (2 req.)	1237 244	----	----
1-48-641	WASHER, Blower Motor Commutator End Arm, for Motor stamped part No. 1605 383	1605 589	----	----
1-48-646	TUBE, Heater Blower Motor Cooling	----	1753 174	1753 174
1-48-651	CLIP, Motor Cable, on Heater Duct (2 req.)	1308 484	----	----
	To Fender Shield (2 req.)	1263 079	----	----
1-48-656	CONNECTOR, Motor Wire	1310 489	----	----
1-48-707	DUCT, Heater Side Cowl Distribution, IM, LY1	----	E1885 810	----
1-48-708	LEVER and PIN, Heater Distribution Duct Air Damper	----	1770 369	1770 369
1-48-725	CABLE and HOUSING, Heater Distribution Duct Air Damper Control, S25, S26, S27, LS1, LS2, LS3	----	1779 764	1779 764
	C75, C76, IM, LC1, LC2, LC3, LY1.	----	1779 766	1779 766
1-48-749	WASHER, Heater Dist. Duct Air Damper Shaft Mounting.	----	----	6015 004
1-48-770	SWITCH, Heater, S23, S24	1688 815	----	----
	Heater Blower, except C70	1688 812	----	----
	S25, S26, S27	----	1779 922	----
	LS1, LS2, LS3	----	----	1819 830
	C75, C76, LC1, LC2, LC3	----	1779 932	1885 995
	IM, LY1	----	1779 923	1886 008
	SWITCH and COVER, Heater Burner	1779 709	----	----
1-48-779	NUT, Heater Switch Mounting	1439 758	6008 070	6008 070
1-48-780	BRACKET, Heater Switch Mounting, C71, C72, C73	1595 311	----	----

★ Indicates use as required.

Numerals in parentheses () refer to notes.

Printed in U.S.A.

□ Indicates parts not listed in any previous parts book.

Prices and specifications subject to change without notice.

* Indicates change or addition.

PART TYPE CODE	PART NAME	MODEL 800	MODEL 801	MODEL 803
NOTE: Quantity is (1) per car unless otherwise indicated.				
1-48 785	ARM, Heater Switch Control, C71, C72, C73 (2 req.)	1622 509	----	----
1-48-786	FOLLOWER, Heater Switch Control Arm, C71, C72, C73 (2 req.) . .	1622 511	----	----
1-48-801	KNOB, Heater Switch Control, C71, C72, C73 (3 req.)	1604 321	----	----
	Blower Switch, S25, S26, S27, LS1, LS2, LS3	----	1770 902	1770 902
	C75, C76, LC1, LC2, LC3	----	1704 425	1704 425
	IM, LY1	----	1753 849	1753 849
1-48-840	RELAY, Heater, except C70	1692 684	----	----
1-48-854	THERMOSTAT, Heater	1688 420	1770 635	1770 635
1-48-904	SUPPRESSOR, Heater Ignition Coil	----	----	⊠1841 320
1-48-906	PACKAGE, Heater Cam and Grommet	----	----	⊠1886 567
1-48-925	STUD, Heater Temperature and Fresh Air Vent Control Housing Mounting (as req'd.)	----	6010 020	----
1-48-928	HOLDER, Heater Wiring Fuse	----	1239 344	1239 344
1-48-934	ARM, Temperature Control, w/BRACKET, C71, C72, C73	1604 261	----	----
1-48-940	CONTROL, Temperature, S23, S24	1605 231	----	----
	S25, S26, S27, LS1, LS2, LS3	----	1769 365	1769 365
	C75, C76, IM, LC1, LC2, LC3, LY1	----	1769 364	1769 364
1-48-941	CABLE, Temperature Control	1688 863	1626 983	1626 983
	Inlet Damper Control, S25, S26, S27, LS1, LS2, LS3, C75, C76, LC1, LC2, LC3	----	1779 758	1779 758
	IM, LY1	----	1819 748	1819 748
1-48-942	KNOB, Temperature Control, S23, S24	1595 266	----	----
	Heater Control, S25, S26, S27, LS1, LS2, LS3	----	1769 556	1769 556
	C75, C76, LC1, LC2, LC3	----	1769 479	1769 479
	IM, LY1	----	1769 481	1769 481
1-48-946	GROMMET, Heater Wiring (to dash)	----	1498 858	----
1-48-950	CLAMP, Temperature Control Cable, C71, C72, C73	1770 371	----	----
1-48-952	PIVOT, Temperature Control Arm	1308 286	----	----
1-48-953	SCREW, Temperature Control Arm Pivot	988 098	----	----
1-48-959	PLATE, Heater Mixer and Louver	1688 841	1688 841	1885 413
1-48-960	HOUSING, Heater Burner Blower	1688 437	1688 437	1688 437
1-48-961	WHEEL, Heater Burner Blower	1688 828	1688 828	1688 828
1-48-962	FUEL PUMP, Heater Burner Blower	1688 445	1704 576	----
1-48-963	CONNECTOR, Heater Burner Blower Fuel Pump to Blower Motor Spring (2 req.)	1688 830	1688 830	----
	Heater Fuel Line, on Carburetor, LS2, LS3	----	----	862 072
1-48-964	COUPLING, Heater Burner Blower Fuel Pump	1688 831	1688 831	----
1-48-965	CASE, Heater Burner	1779 708	----	----
	CASE, w/SWITCH	1779 709	----	----
1-48-966	GASKET, Heater Burner	1688 843	1688 843	1688 843
1-48-967	EXCHANGER, Heater Burner	1688 849	1769 619	*1769 619
1-48-968	CAP, Heater Spark Plug Retainer	1688 446	1688 446	*1688 446
1-48-969	GROMMET, Heater Burner Spark Plug Lead	1688 833	----	----
1-48-970	RETAINER, Heater Temperature Control Gear and Stem	1605 236	----	----
1-48-972	GROMMET, Heater Burner Blower to Heater (2 req.)	1688 458	----	----
	Blower	1779 777	----	----
1-48-973	MOTOR, Heater Burner Blower	1692 660	1692 660	1841 334
1-48-974	CONNECTOR, Heater Burner Blower Cable and Wiring (2 req.) . .	1310 489	----	----
1-48-976	CLAMP, Heater Heat Exchanger Mounting	----	1819 592	----
1-48-977	TUBE, Heater Exhaust Flexible	1688 423	1736 814	*1736 814
	PACKAGE, Flexible Tube Replacement	1689 255	----	----
1-48-978	CLAMP, Heater Exhaust Tube Mounting (2 req.)	1688 452	870 469	----
	Tube to Heater	1689 374	1770 349	1770 349
	Exhaust Tube	1688 834	----	----
	Heater Air Hose	----	1838 006	1838 006
1-48-979	SCREW, Heater Exhaust Clamp Bracket	6000 160	----	----
1-48-980	SWITCH, Heater Overheat	1688 850	1819 593	1885 429
1-48-981	PIPE, Heater Exhaust	----	1736 812	----

★ Indicates use as required.

Numerals in parentheses () refer to notes.

Printed in U.S.A.

⊠ Indicates parts not listed in any previous parts book.
Nov. 10, 1958 Supersedes Feb. 14, 1958.

Page 1-24

Prices and specifications subject to change without notice.
* Indicates change or addition.

PART TYPE CODE	PART NAME	MODEL 800	MODEL 801	MODEL 803
----------------	-----------	-----------	-----------	-----------

NOTE: Quantity is (1) per car unless otherwise indicated.

1-48-983	TUBE, Heater Fuel	1688 866	1770 636	1841 321
	To Car Fuel Pump	1688 866	1688 866	-----
1-48-984	TUBE, Heater Burner Vent	-----	1819 591	1819 591
1-48-985	UNIT, Heater Ignition	1688 419	*1688 419	-----
1-48-986	CAPACITOR, Heater Ignition Unit (2 req.)	1688 443	1688 443	-----
1-48-987	VIBRATOR, Heater Ignition Unit	1688 457	1688 457	-----
1-48-988	CABLE, Heater Ignition	-----	1770 393	-----
1-48-989	BASE, Heater Burner Blower Ignition Unit	-----	-----	*1841 337
1-48-990	BASE, Heater Burner	1689 020	1770 397	1885 412
1-48-991	PACKAGE, Heater Burner Filter Nozzle	1819 595	1819 595	-----
	NOZZLE, Heater Burner Filter	-----	-----	1885 411
1-48-992	HOSE, Air, w/GROMMET	-----	1769 608	1841 305
1-48-993	PACKAGE, Heater Burner Valve	-----	1819 597	1819 597
1-48-994	CLAMP, Heater Burner and Valve	1688 851	1688 851	1688 851
1-48-995	PACKAGE, Heater Burner Valve Seat	-----	1819 596	1819 596
1-48-996	PACKAGE, Heater Burner Spark Plug and Washer	1689 017	1689 017	*1689 017
1-48-997	COVER, Heater Burner Coil	-----	1819 590	-----
1-48-998	PACKAGE, Heater Burner Coil and Washer	1689 018	1689 018	-----
	Coil Only	1688 459	1688 459	-----
	COIL and SHIELD, Heater	-----	-----	1841 322
1-48-999	SCREEN, Heater Burner Fuel Inlet	1689 021	1689 021	1689 021

CODE	PART NAME AND DESCRIPTION	NO. OF CYL.	PLYMOUTH	DODGE	DESOTO	CHRYSLER AND IMPERIAL	PER CAR	PART NUMBER
1-49-0 RECORD PLAYER								
1-49-10	BRACKET, Hi-Fi Mounting, Front	6-8	56	-	-	-	1	1688 487
	Rear, Adapter	6-8	57	-	-	-	1	1779 856
	Rear	6-8	57	-	-	-	1	1770 886
	Front C75, C76	8	-	-	-	57	2	1770 694
	Rear Right C75, C76	8	-	-	-	57	1	1819 195
	Rear Left C75, C76	8	-	-	-	57	1	1819 196
1-76-0 MIRROR								
1-76-1	MIRROR, Outside Rear View, Fender Mount	6-8	56	-	-	-	1	1697 210
	Outside, Fender Mount, Hooded Type	6-8	57-58	57-58	57-58	57-58	★	1830 501
	MIRROR, Outside Rear View Complete							
	Twin Strut, Fender Mount	6-8	57-58	57-58	57-58	57-58	1	1773 071
	Single Strut, Fender Mount	6-8	57-58	57-58	57-58	57-58	1	1772 447
	Outside, Fender Mount Hooded Type	8	-	-	58	58	★	1839 852
	Remote Control, LC1, LC2, LC3	8	-	-	58	58	1	1839 408
	Remote Control, LY1	8	-	-	-	58	1	*1839 349
	Outside Rear View, Door top, except Cv. Cp., Sp. Cl. Cp., Sp. 4 D. Sed.	6-8	57-58	57-58	57-58	57-58	1	1698 798
1-76-2	MIRROR, Vanity	8	57-58	57-58	57-58	57-58	★	1839 845
1-76-3	MIRROR, Inside Rear View, Prismatic, Aluminum	6-8	57	57	57	57	1	*1772 436
	Prismatic, Chrome	6-8	58	58	58	58	1	1876 332
1-76-10	SCREW, Outside Rear View Mirror Set	6-8	55	55	55-56	55-56	2	1520 437
	SCREW, Outside Rear View Mirror Set	6-8	57-58	57-58	57-58	57-58	2	1698 756
1-76-14	SCREW, Outside Rear View Mirror Mounting Bracket	6-8	55-56	55-56	55-56	55-56	1	892 569
1-76-20	KNOB, Outside Rear View Mirror Remote Control, w/SCREW	8	-	-	58	58	1	*1839 416
	w/CLIP	8	-	-	58	58	1	1901 693

★ Indicates use as required. Numerals in parentheses () refer to notes. Printed in U.S.A.
 □ Indicates parts not listed in any previous parts book. Prices and specifications subject to change without notice.
 * Indicates change or addition. Nov. 10, 1958 Supersedes Feb. 14, 1958.
 Page 1-25

1955-58 PASSENGER CAR PARTS LIST

ACCESSORIES

CODE	PART NAME AND DESCRIPTION	NO. OF CYL.	PLYMOUTH	DODGE	DESOTO	CHRYSLER AND IMPERIAL	PER CAR	PART NUMBER
1-76-21	CABLE, Remote Control Rear View Mirror, LC1, LC2, LC3,	8	-	-	58	58	1	1839 503
	LY1	8	-	-	-	58	1	1839 522
1-76-22	CLIP, Outside Rear View Mirror Remote Control Knob	8	-	-	58	58	1	*6008 152
1-82-0 WINDSHIELD WASHER								
1-82-2	PACKAGE, Model 17, w/o Switch	6-8	57-58	57-58	57-58	57-58	1	1770 728
1-82-4	CONTAINER, Fluid	6-8	55-56	55-56	55-56	55-56	1	1622 678
		6-8	57-58	57-58	57-58	57-58	1	1779 782
1-82-7	PACKAGE, Nozzle Replacement	6-8	57-58	57-58	57-58	57-58	1	1752 452
		6-8	55-56	55-56	55-56	55-56	1	*1450 438
1-82-8	TEE, Hose	6-8	55-56	55-56	55-56	55-56	1	1523 160
1-82-13	PACKAGE, Electric Windshield Wiper Washer Pump Switch.	6-8	55-56	55-56	55-56	55-56	1	1595 117
	Windshield Washer Wiper Switch, S25, S26, C75, LC1, LC2, Variable Speed Wipers	6-8	57-58	57-58	57-58	57-58	1	1819 259
	S27, LSI, Single Speed Wiper	6-8	57-58	57-58	57-58	-	1	1819 272
1-82-14	SWITCH, Wiper, w/Single Speed Wipers	6-8	57-58	57-58	-	-	1	1819 257
	w/Variable Speed Wipers	6-8	57-58	57-58	-	58	1	1819 249
1-82-15	SCREW, Wiper Switch Mounting	6-8	57-58	57-58	-	57-58	2	1819 251
1-82-18	HOSE, Tee to Nozzle, Right and Left 50"	6-8	55-56	55-56	55-56	55-56	1	1523 514
1-82-19	HOSE, Check Valve to Tee	6-8	55-56	55-56	55-56	55-56	1	1622 676
1-82-20	WASHER, Foot Control Compression	6-8	-	56	56	56	1	1241 066
1-82-21	BRACKET, Fluid Container Mounting	6-8	55-56	55-56	55-56	55-56	1	1622 679
	Windshield Washer Fluid Container Mounting, Rear	6-8	57-58	57-58	57-58	57-58	1	1819 175
	Front	6-8	57-58	57-58	57-58	57-58	1	1779 743
	Screw	6-8	56	56	56	56	2	444 267
1-82-22	CAP, Fluid Container	6-8	55-57	55-57	55-57	55-57	1	1604 053
		6-8	58	58	58	58	1	*1838 001
1-82-23	KNOB, Foot Control Pump	6-8	55-56	55-56	55-56	55-56	1	1241 063
1-82-24	PAD, Foot Control Pump Foot.	6-8	55-56	55-56	55-56	55-56	1	1641 633
1-82-25	PUMP, Foot Control	6-8	55-56	55-56	55-56	55-56	1	1253 491
	Nut	6-8	57-58	57-58	57-58	57-58	1	1770 918
	Washer, plain	6-8	55-56	55-56	55-56	55-56	2	271 506
		6-8	55-56	55-56	55-56	55-56	2	120 395
1-82-30	STRAINER	6-8	55-58	55-58	55-58	55-58	1	1571 028
1-82-31	VALVE, Check.	6-8	55-56	55-56	55-56	55-56	1	1527 513
1-82-32	HOSE, Check Valve to Pump.	6-8	55-56	55-56	55-56	55-56	1	1253 485
		6-8	57-58	57-58	57-58	57-58	1	1641 932
1-82-33	HOSE, Check Valve to Strainer	6-8	55-56	55-56	55-56	55-56	1	1641 932
	Check Valve to Strainer	6-8	57-58	57-58	57-58	57-58	1	1770 868
1-82-34	HOSE, Check Valve to Nozzle	6-8	57-58	57-58	57-58	57-58	1	1253 487
1-82-35	CLIP, Windshield Washer Hose Mounting	8	-	-	-	57	1	1436 940
1-82-38	VALVE, Windshield Washer Check	6-8	55-57	55-57	55-57	55-57	1	1527 513
		6-8	58	58	58	58	1	1838 002
1-82-40	CONNECTOR, Cable	6-8	55-56	55-56	55-56	55-56	2	689 867
1-87-0 RADIO								
1-87-2	PACKAGE, Rear Shelf Radio Speaker	6-8	57-58	57-58	57-58	57-58	1	1819 766
	PACKAGE, Speaker, for Dual Installation	6-8	57-58	57-58	57-58	57-58	1	1819 767
1-87-4	PACKAGE, Radio Short Wave Convertor	6-8	58	58	58	58	1	1779 144
1-87-5	SWITCH, Radio Foot Selector	6-8	-	57	-	57-58	1	1819 409
1-87-21	GRILLE, Rear Shelf Speaker, Charcoal Gray	6-8	57-58	57-58	57-58	57-58	1	*1819 018
1-87-22	BEZEL, Rear Shelf Speaker Grille, Charcoal Gray	6-8	57-58	57-58	57-58	57-58	1	1819 014
1-87-45	CABLE, Shelf Panel Radio Speaker	6-8	55-58	55-58	55-58	55-58	1	*1627 125
1-87-70	CONDENSER, Voltage Regulator Battery Terminal	6-8	57	57	57-58	57-58	1	1689 592
		6-8	58	58	-	-	1	1838 119

★ Indicates use as required.

Numerals in parentheses () refer to notes.

Printed in U.S.A.

☐ Indicates parts not listed in any previous parts book.

Prices and specifications subject to change without notice.

Nov. 10, 1958 Supersedes Feb. 14, 1958.

Page 1-26

* Indicates change or addition.

CODE	PART NAME AND DESCRIPTION	NO. OF CYL.	PLYMOUTH	DODGE	DESOTO	CHRYSLER AND IMPERIAL	PER CAR	PART NUMBER
1-87-150	FILTER, Fuel Gauge Radio Interference, Sub. and Est. Wgn.	6-8	55-56	55-56	55-56	55	1	1571 839
1-87-180	KNOB, Radio Control	6-8	-	57-58	-	-	2	1769 736
	Tone Control	6-8	-	57-58	-	-	2	*1704 213
	Est. Wgn.	8	-	-	-	56	1	1627 003
	Rear Speaker Fader Switch except Sub.	6-8	57	-	-	-	1	1689 693
	Radio Control	6-8	58	-	-	-	1	*1689 693
1-87-289	SWITCH, Rear Shelf Radio Speaker Fader.	6-8	57	-	-	-	1	1689 271
	SWITCH, Shelf Panel Radio Speaker Fader, P30, P31, D66, D67, D72, use with 1689 425 Package.	6-8	57	57	-	-	1	1819 889
	D66, D67, D72, use w/1819 766, 1689 440 Package	6-8	57	57	-	-	1	1819 768
	Rear Shelf Radio Speaker, Fader use with 1689 426, 1689 440 Package	6-8	58	58	-	-	1	1819 889
	Use with 1819 766 Pkg.	6-8	58	58	-	-	1	1819 768
	LS1	8	-	-	58	-	1	1819 889
1-87-330	PLATE, w/STUDS, Rear Shelf Radio Speaker w/o Air Conditioning, 4 D., Cl. Cp., Sp. Cl. Cp.	6-8	55-56	55-56	55-56	55-56	1	1627 209
	w/Air Conditioning, 4 D., Cl. Cp., Sp. Cl. Cp., Gray Leathertex	6-8	55-56	55-56	55-56	55-56	1	1627 203
	Nut	6-8	56	-	-	-	4	120 622
1-87-334	GASKET, Rear Shelf Panel Radio Speaker Mounting, w/Air Conditioning, 4D., Cl. Cp., Sp. Cl. Cp.	6-8	55-56	55-56	55-56	55-56	2	1540 295
	Screw, No. 8-32 x 7/8".	8	56	56	56	56	4	167 551
1-87-404	WIRING, Rear Shelf Radio Speaker, D66, D67, D72	6-8	-	57-58	57-58	57-58	1	1769 430
		6-8	55-56	55-56	55-56	55	1	1627 117
		8	-	-	-	56	1	1658 184
1-87-464	HOLDER and FUSE, Radio	8	57-58	57-58	57-58	57-58	1	*1841 698
1-88-0 RADIO ANTENNA								
1-88-1	PACKAGE, Radio Antenna, 60" Manual, Front, S26, S27, Sub., C75, C76	6-8	57	57	57	57	1	1769 436
	Motor Driven, Front	6-8	57	57	57	57	1	1770 277
	60" Dual, Rear, D66, D67, D72	6-8	-	57	-	-	1	1779 068
	Motor Driven, Right Rear, S25, S26, S27, C75, C76, except Sub.	8	-	-	57	57	1	1779 646
	60" Manual, Right Rear, S25, S26, S27, C75, C76, LC1, LC2, LC3, except Sub.	8	-	-	57	57-58	1	*1779 629
	40" Manual, Dual Rear, S25, S26, S27, C75, C76, except Sub.	8	-	-	57	57	1	1779 243
	60" Manual Dual Rear, except Suburban	6-8	57-58	58	-	-	1	1779 068
	60" Manual, Front LS1, LS3, Suburban	6-8	58	58	58	58	1	1769 436
	40" Manual Dual Rear, except Suburban	8	-	-	58	58	1	1779 243
	60" Manual, Right Rear, except Suburban	8	-	-	58	-	1	1779 629
	Motor Driven, Front	6-8	58	58	58	58	1	*1770 277
	Motor Driven, Right Rear, except Suburban	8	-	-	58	58	1	1779 646
1-88-6	ADAPTER, Mounting, Upper 60" Antenna Tubeless	6-8	56	56	-	-	1	1658 460
		8	-	-	56	56	1	1658 329
	Rear Fender Dual, D62, D63 except Sub., Lower	6-8	-	56	-	-	1	1658 510
	Upper	6-8	-	56	-	-	1	1688 205
	S23 except Est. Wgn., S24, Lower	8	-	-	56	-	1	1688 739
	Upper	8	-	-	56	-	1	1688 740
	Lower 60" Antenna, Tubeless.	6-8	56	56	-	-	1	1658 461
		8	-	-	56	56	1	1658 330
	60" Manual, Front Upper	6-8	57	-	-	-	1	1769 444
	90" Manual, Front Right Upper	6-8	57	-	-	-	1	1769 444
	90" Manual, Front Right Lower	6-8	57	-	-	-	1	1769 443
	Motor Driven, Upper	6-8	-	57	-	-	1	1769 444
	Motor Driven, Lower	6-8	-	57	-	-	1	1769 443
	60" Manual, Front Upper	6-8	-	57	-	-	1	1769 444
	90" Manual, Front Right Upper	6-8	-	57	-	-	1	1769 444

★ Indicates use as required.

Numerals in parentheses () refer to notes.

Printed in U.S.A.

☐ Indicates parts not listed in any previous parts book.

Prices and specifications subject to change without notice.

* Indicates change or addition.

1955-58 PASSENGER CAR PARTS LIST

ACCESSORIES

CODE	PART NAME AND DESCRIPTION	NO. OF CYL.	PLYMOUTH	DODGE	DESOTO	CHRYSLER AND IMPERIAL	PER CAR	PART NUMBER
	90" Manual, Front Right Lower	6-8	-	57	-	-	1	1769 443
	40" Manual, Dual Rear Upper, S25, S26, S27, except Sub.	8	-	-	57	-	1	1779 156
	60" Manual, Front Upper, S26, S27, 4 D. Sub.	8	-	-	57	-	1	1769 444
	60" Manual, Front Lower, S26, S27, 4 D. Sub.	8	-	-	57	-	1	1769 443
	90" Manual, Front Right Upper, S26, S27, 4 D. Sub.	8	-	-	57	-	1	1769 444
	40" Manual, Dual Rear Upper, C75, C76, except Sub.	8	-	-	-	57	1	1779 156
	60" Manual, Front Upper, C75, C76	8	-	-	-	57	1	1769 444
	90" Manual, Front Right Upper, C75, C76	8	-	-	-	57	1	1769 444
	90" Manual, Front Right Lower, C75, C76	8	-	-	-	57	1	1769 443
	Motor Driven, Upper, C75, C76	8	-	-	-	57	1	1769 444
	Motor Driven, Lower, C75, C76	8	-	-	-	57	1	1769 443
	40" Manual, Dual Rear Lower, S25, S26, S27, C75, C76, except Sub.	8	-	-	-	57	2	1779 157
	PACKAGE, Radio Antenna Adapter, 60" Manual and Motor Driven, IM	8	-	-	-	57	1	1770 340
	Radio Antenna Mounting 60" Manual Upper, LS1, LS3, Suburban, LC1, LC2, LC3	6-8	58	58	58	58	1	1769 444
	60" Manual Lower, LS1, LS3, Suburban, LC1, LC2, LC3	6-8	58	58	58	58	1	1769 443
	90" Manual Upper, LS1, LS3, Suburban, LC1, LC2, LC3	6-8	58	58	58	58	1	1769 444
	90" Manual Lower, LS1, LS3, Suburban, LC1, LC2, LC3	6-8	58	58	58	58	1	1769 443
	Motor Driven, Front Upper, LC1, LC2, LC3	6-8	-	58	-	58	1	1769 444
	Motor Driven, Front Lower, LC1, LC2, LC3	6-8	-	58	-	58	1	1769 443
	40" Manual, Dual Rear Upper, LS1, LS2, LS3, LC1, LC2, LC3, except Sub.	8	-	-	58	58	2	1779 156
	40" Manual, Dual Rear Lower, LS1, LS2, LS3, LC1, LC2, LC3, except Sub.	8	-	-	58	58	2	1779 157
	Package, 60" Manual and Motor Driven, LY1	8	-	-	-	58	1	1770 340
1-88-25	SCREW, Radio Antenna Mounting, except Sub.	8	-	-	58	-	1	16006 119
1-88-51	PACKAGE, Motor Driven Antenna Shield Hole Cover, S25, S26, LS2, LS3	8	-	-	57-58	-	1	*1838 090
1-88-60	CLIP, Motor Driven Antenna Circuit Breaker Mounting, LC1, LC2	6-8	-	58	-	58	1	*1753 684
1-88-105	INSULATOR, Motor Driven Radio Antenna	8	-	-	55-56	55-56	1	1622 690
1-88-106	GASKET, Insulator Upper	6-8	55	55	55	55	1	1237 312
	Lower	6-8	55-56	55-56	-	-	1	1237 306
1-88-107	GASKET, Radio Antenna, Upper, S25, S26, S27, LS1, LS2, LS3, LC1, LC2, LC3, except Sub.	8	-	-	57-58	-	2	1779 103
	Upper, C75, C76, except Sub.	8	-	-	-	57	2	1779 103
1-88-108	60" Manual Dual Rear, except Sub.	6-8	57	57	-	-	2	*1841 057
	PAD, Radio Antenna Mounting, 60" Manual, Rear Dual, P30, P31, D66, D67, D72, LD1, LD2, LD3, except Sub., Right	6-8	57	57-58	-	-	1	1819 761
	Left	6-8	57	57-58	-	-	1	1819 762
1-88-116	KNOB, Antenna Switch Control, IM, LY1, "Plain"	8	-	-	-	57-58	1	1770 456
	Radio Antenna Switch Control, IM, LY1, "Antenna"	8	-	-	-	57-58	1	1819 827
1-88-117	MOTOR, Radio Antenna, 6 Volt	8	-	-	55	55	1	1688 607
	w/Drive Unit, 12 Volt	8	-	-	56	56	1	1688 608
	w/o Drive Unit, 12 Volt	6-8	57-58	57-58	56-58	56-58	1	1753 520
1-88-118	CIRCUIT BREAKER, Motor Driven Antenna, LC1, LC2	6-8	-	58	-	58	1	*1642 477
1-88-119	DRIVE, Motor Driven Radio Antenna Actuator	8	-	-	55-56	-	1	1779 657
1-88-120	NUT, Mounting	6-8	55-56	55-56	55-56	55-56	1	1163 612
	w/GROMMET	6-8	55-56	55-56	55-56	55-56	1	1310 456
1-88-121	GASKET, Mounting Nut	6-8	55-56	55-56	55-56	55-56	1	1658 332
1-88-123	NUT, Upper Adapter Mounting	6-8	56-58	56-58	56-58	56-58	1	1658 328

★ Indicates use as required. Numerals in parentheses () refer to notes. Printed in U.S.A.
 ☐ Indicates parts not listed in any previous parts book. Prices and specifications subject to change without notice.
 Nov. 10, 1958 Supersedes Feb. 14, 1958. Page 1-28 * Indicates change or addition.

CODE	PART NAME AND DESCRIPTION	NO. OF CYL.	PLYMOUTH	DODGE	DESOTO	CHRYSLER AND IMPERIAL	PER CAR	PART NUMBER
1-88-159	ROD, Radio Antenna Body and Mast	6-8	56	-	-	-	1	1658 323
	Body and Mast, 60" Manual, Rear Left, except Sub.	6-8	57-58	57-58	-	-	1	1838 163
	Body and Mast, 60" Rear Right, except Sub.	8	-	-	57	-	1	1658 323
	Body, Mast and Shield	6-8	-	56	-	-	1	1688 929
	Mast, Motor Driven	8	-	-	55-56	55-56	1	1688 609
	Body, Mast and Shield, S23 except Est. Wgn., S24	8	-	-	56	56	1	1688 929
	Mast, Motor Driven	8	57	57	56-57	56-57	1	1753 521
	Body and Lead In Wire	8	-	-	-	56	1	1658 323
	Body and Mast, 90" Manual, Front Right, S26, S27, Sub.	6-8	57	57	57	57	1	1770 174
	Body, Mast and Shield, 90" Manual, Front Right, S26, S27, Sub.	6-8	57	57	57	57	1	*1770 175
	Body and Mast, 60" Manual, Rear Right, except Sub.	6-8	57-58	57-58	-	-	1	1838 162
	Body, Mast and Shield, 90" Manual, Rear Deck Mounting, Right, Single, except Sub.	8	-	-	57	-	1	1779 660
	Body and Mast, 60" Manual, except Sub.	8	-	-	57	-	1	1688 929
	Body, Mast and Shield, 40" Manual, Left Rear, S25, S26, S27, except Sub., C75, C76	8	-	-	57	57	1	1819 804
	Mast, Motor Driven	6-8	58	58	58	58	1	1753 521
	Body and Mast, 90" Manual, Front, Right, LS1, LS3, Suburban	6-8	58	58	58	58	1	1770 174
	Body, Mast and Shield, 90" Manual, Front, Left, LS1, LS3, Suburban	6-8	58	58	58	58	1	1770 175
	Body and Mast, Right Rear, LS1, LS2, LS3, except Suburban	8	-	-	58	-	1	1658 323
	Body, Mast and Shield, 40" Manual, Right, LS1, LS2, LS3, LC1, LC2, LC3, except Sub.	8	-	-	58	58	1	1819 804
	Body, Mast and Shield, 40" Manual, Left, LS1, LS2, LS3, LC1, LC2, LC3, except Sub.	8	-	-	58	58	1	1819 804
	Body and Mast, 60" Manual, Rr. Mounting, Right, Single, LS1, LS2, LS3, except Sub.	8	-	-	58	-	1	1688 929
1-88-162	CONNECTOR and Lead In WIRE, Radio Antenna "Y", LD3, C75, C76, LC1, LC2, LC3, except Sub.	6-8	57-58	57-58	57-58	57-58	1	1779 072
1-88-169	EXTENSION, Radio Antenna Lead In, except Sub.	8	-	-	57	-	1	1819 171
1-88-180	PACKAGE, Radio Antenna Shield	6-8	56-58	56-58	56-58	56-58	1	1688 944
1-88-205	SWITCH, Motor Driven Radio Antenna	6-8	55	55	55-56	55-56	1	1642 141
	S25, S26, S27, except Sub.	6-8	-	57	57	57	1	1779 863
		6-8	58	58	58	58	1	1779 863
	IM, Factory Installed	8	-	-	-	57	1	*1819 485
	LY1, Factory Installed	8	-	-	-	58	1	E1841 130
1-88-206	NUT, Motor Driven Radio Antenna Switch Mounting, S25, S26, S27, C75, C76, except Sub., LC1, LC2, LC3	6-8	57-58	57-58	57-58	57-58	2	1688 542
	IM, LY1	8	-	-	-	57-58	1	1439 758
1-88-208	BEZEL, Radio Antenna Motor Switch, IM	8	-	-	-	57	1	1604 273
1-88-230	SEAL, Shield	6-8	55-56	55-56	55-56	55-56	1	1163 617
	WASHER, Mounting Nut	6-8	55-56	55-56	55-56	55-56	1	1163 614
1-108-0 SPOTLIGHT								
1-108-1	PACKAGE, Spotlight, Small 5"	6-8	57-58	57-58	57-58	57-58	1	1818 916
	Large 6"	6-8	58	58	58	58	1	1886 136
1-108-2	PACKAGE, Spotlight Mounting Bracket and Gasket Outside, Right	6-8	57-58	57-58	57-58	57-58	1	1818 918
	Left	6-8	57-58	57-58	57-58	57-58	1	1818 917
1-108-5	PACKAGE, Ring, Large 6"	6-8	58	58	58	58	1	1886 134
1-108-17	BULB.	6-8	55	55	55	55	1	1253 120
	Small 5"	6-8	56-58	56-58	56-58	56-58	1	1661 046
1-108-55	MIRROR, Rear View	6-8	55	55	55	55	1	1658 988
1-108-60	MIRROR and HOUSING, Spotlight	6-8	56	56	56	56	1	1704 780
1-108-61	BEZEL, Spotlight Bulb Retaining	6-8	56	56	56	56	1	1704 781

* Indicates use as required.

Numerals in parentheses () refer to notes.

Printed in U.S.A.

E Indicates parts not listed in any previous parts book.

Prices and specifications subject to change without notice.

* Indicates change or addition.

